

(19)



Europäisches Patentamt
European Patent Office
Office européen des brevets



(11) Publication number:

0 529 294 A3

(12)

EUROPEAN PATENT APPLICATION(21) Application number: **92112374.1**(51) Int. Cl.⁵: **B65H 3/52, B65H 5/38**(22) Date of filing: **20.07.92**

(30) Priority: **24.07.91 JP 184549/91**
24.07.91 JP 184551/91

(43) Date of publication of application:
03.03.93 Bulletin 93/09

(84) Designated Contracting States:
DE FR GB IT NL

(88) Date of deferred publication of the search report:
23.06.93 Bulletin 93/25

(71) Applicant: **MITA INDUSTRIAL CO., LTD.**
2-28, 1-chome, Tamatsukuri Chuo-ku
Osaka 540(JP)

(72) Inventor: **Arai, Kiyotaka**
Sunny-Haitsu-Sanbankan 901, 1-7-21, Kamiji
Higashinari-ku, Osaka-shi, Osaka(JP)

(74) Representative: **Patentanwälte Grünecker,**
Kinkeldey, Stockmair & Partner
Maximilianstrasse 58
W-8000 München 22 (DE)

(54) **Sheet feeding mechanism for feeding sheets and sheet guiding equipment for conveying sheets.**

(57) A sheet feeding roller (1) for feeding sheets, an advance preventive member (8) which is abutable on the sheet feeding roller by a spring (2) and is for preventing multiple feeding of sheets are provided, and the advance preventive member has a first acted part, and while a sheet feeding cassette (5) is

pulled out, a first acting part provided to the sheet feeding cassette acts on the first acted part of the advance preventive member, and thereby the advance preventive member is separated from the sheet feeding roller against an urging force of the spring.

FIG. 3

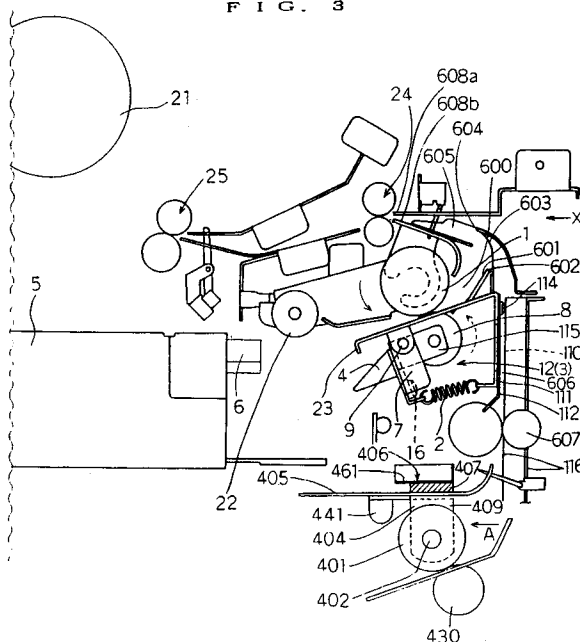

EP 0 529 294 A3



European Patent
Office

EUROPEAN SEARCH REPORT

Application Number

EP 92 11 2374

Page 1

| DOCUMENTS CONSIDERED TO BE RELEVANT | | | |
|--|--|---|---|
| Category | Citation of document with indication, where appropriate, of relevant passages | Relevant to claim | CLASSIFICATION OF THE APPLICATION (Int. Cl.5) |
| X | DE-A-3 221 261 (KONISHIROKU) * page 10, line 28 - page 11, line 15; figure 4 * | 1,2,3,8, 22 | B65H3/52 B65H5/38 |
| Y | --- | 4-7,9,11 | |
| Y | PATENT ABSTRACTS OF JAPAN vol. 005, no. 115 (P-072)24 July 1981 & JP-A-56 057 077 (CANON INC) 19 May 1981 * abstract * | 4,5,9, 10,11 | |
| Y | --- | | |
| Y | PATENT ABSTRACTS OF JAPAN vol. 010, no. 267 (M-516)11 September 1986 & JP-A-61 090 943 (OLYMPUS OPTICAL CO LTD) 9 May 1986 * abstract * | 4,5,9, 10,11 | |
| Y | --- | | |
| Y | EP-A-0 281 073 (MITA INDUSTRIAL CO. LTD.) * the whole document * | 6,7 | |
| X | --- | 12,13,14 | |
| X | PATENT ABSTRACTS OF JAPAN vol. 9, no. 245 (M-418)(1968) 2 October 1985 & JP-A-60 97 142 (FUJI XEROX) 30 May 1985 * abstract * | 1,2 | TECHNICAL FIELDS SEARCHED (Int. Cl.5) |
| | --- | | B65H |
| A | PATENT ABSTRACTS OF JAPAN vol. 012, no. 432 (M-763)15 November 1988 & JP-A-63 165 228 (TOSHIBA CORP) 8 July 1988 * abstract * | 1-5 | |
| A | --- | | |
| A | PATENT ABSTRACTS OF JAPAN vol. 11, no. 131 (M-584)(2578) 24 April 1987 & JP-A-61 273 444 (HITACHI KOKI CO LTD) 3 December 1986 * abstract * | 1-5 | |
| | --- | | |
| The present search report has been drawn up for all claims | | | |
| Place of search THE HAGUE | | Date of completion of the search 18 MARCH 1993 | Examiner MEULEMANS J.P. |
| CATEGORY OF CITED DOCUMENTS | | | |
| X : particularly relevant if taken alone Y : particularly relevant if combined with another document of the same category A : technological background O : non-written disclosure P : intermediate document | | T : theory or principle underlying the invention E : earlier patent document, but published on, or after the filing date D : document cited in the application L : document cited for other reasons & : member of the same patent family, corresponding document | |



CLAIMS INCURRING FEES

The present European patent application comprised at the time of filing more than ten claims.

- ☐ All claims fees have been paid within the prescribed time limit. The present European search report has been drawn up for all claims.
- ☐ Only part of the claims fees have been paid within the prescribed time limit. The present European search report has been drawn up for the first ten claims and for those claims for which claims fees have been paid,
namely claims:
- ☐ No claims fees have been paid within the prescribed time limit. The present European search report has been drawn up for the first ten claims.

LACK OF UNITY OF INVENTION

The Search Division considers that the present European patent application does not comply with the requirement of unity of invention and relates to several inventions or groups of inventions.

namely:

See sheet -B-

- ☒ All further search fees have been paid within the fixed time limit. The present European search report has been drawn up for all claims.
- ☐ Only part of the further search fees have been paid within the fixed time limit. The present European search report has been drawn up for those parts of the European patent application which relate to the inventions in respect of which search fees have been paid,
namely claims:
- ☐ None of the further search fees has been paid within the fixed time limit. The present European search report has been drawn up for those parts of the European patent application which relate to the invention first mentioned in the claims,
namely claims:



European Patent
Office

EUROPEAN SEARCH REPORT

Application Number

EP 92 11 2374

Page 2

| DOCUMENTS CONSIDERED TO BE RELEVANT | | | |
|--|--|---|---|
| Category | Citation of document with indication, where appropriate, of relevant passages | Relevant to claim | CLASSIFICATION OF THE APPLICATION (Int. Cl.5) |
| A | PATENT ABSTRACTS OF JAPAN vol. 12, no. 10 (M-658)(2857) 13 January 1988 & JP-A-62 17 847 (KONISHIROKU PHOTO IND CO LTD) 28 July 1987 * abstract * | 1-5 | |
| A | --- PATENT ABSTRACTS OF JAPAN vol. 9, no. 279 (M-427)(2002) 7 November 1985 & JP-A-60 122 643 (CANON K.K.) 1 July 1985 * abstract * | 1-5 | |
| X | --- PATENT ABSTRACTS OF JAPAN vol. 009, no. 174 (P-374)19 July 1985 & JP-A-60 049 350 (FUJI XEROX KK) 18 March 1985 * abstract * | 15,16,17 | |
| A | --- PATENT ABSTRACTS OF JAPAN vol. 006, no. 210 (M-166)22 October 1982 & JP-A-57 117 437 (TOKYO SHIBAURA DENKI) 21 July 1982 * abstract * | 15,16,17 | |
| A | --- PATENT ABSTRACTS OF JAPAN vol. 007, no. 116 (M-216)20 May 1983 & JP-A-58 036 841 (KONISHIROKU SHASHIN KOGYO) 3 March 1983 * abstract * | 15,16,17 | |
| A | --- PATENT ABSTRACTS OF JAPAN vol. 8, no. 40 (M-278)(1477) 21 February 1984 & JP-A-58 197 142 (FUJI XEROX) 16 November 1983 * abstract * | 15,16,17 | |
| The present search report has been drawn up for all claims | | | |
| Place of search THE HAGUE | | Date of completion of the search 18 MARCH 1993 | Examiner MEULEMANS J.P. |
| CATEGORY OF CITED DOCUMENTS X : particularly relevant if taken alone Y : particularly relevant if combined with another document of the same category A : technological background O : non-written disclosure P : intermediate document T : theory or principle underlying the invention E : earlier patent document, but published on, or after the filing date D : document cited in the application L : document cited for other reasons & : member of the same patent family, corresponding document | | | |



European Patent
Office

EUROPEAN SEARCH REPORT

Application Number

EP 92 11 2374

Page 3

| DOCUMENTS CONSIDERED TO BE RELEVANT | | | |
|--|--|---|---|
| Category | Citation of document with indication, where appropriate, of relevant passages | Relevant to claim | CLASSIFICATION OF THE APPLICATION (Int. Cl.5) |
| X | PATENT ABSTRACTS OF JAPAN vol. 011, no. 025 (M-556)23 January 1987 & JP-A-61 197 338 (HITACHI LTD) 1 September 1986 * abstract * | 18-22 | |
| A | --- PATENT ABSTRACTS OF JAPAN vol. 006, no. 038 (P-105)9 March 1982 & JP-A-56 154 758 (KONISHIROKU PHOTO IND CO LTD) 30 November 1981 * abstract * ----- | 18-22 | |
| | | | TECHNICAL FIELDS SEARCHED (Int. Cl.5) |
| | | | |
| The present search report has been drawn up for all claims | | | |
| Place of search THE HAGUE | | Date of completion of the search 18 MARCH 1993 | Examiner MEULEMANS J.P. |
| CATEGORY OF CITED DOCUMENTS X : particularly relevant if taken alone Y : particularly relevant if combined with another document of the same category A : technological background O : non-written disclosure P : intermediate document T : theory or principle underlying the invention E : earlier patent document, but published on, or after the filing date D : document cited in the application L : document cited for other reasons & : member of the same patent family, corresponding document | | | |



LACK OF UNITY OF INVENTION A PRIORI

The Search Division considers that the present European patent application does not comply with the requirement of unity of invention and relates to several inventions or groups of inventions, namely:

1. Claims 1-11,22:

Shut feeding mechanism comprising a shut feeding roller and an advance preventing member abutable on said shut feeding roller, said advance preventing member being separated from said feeding roller when a sheet cassette is pulled out from the machine, in which the mechanism is used

2. Claims 12,13,14:

A sheet feeding mechanism comprising pad means urged to abut on a sheet feeding roller, the pad means being removably mounted to a guide plate

3. Claims 15,16,17:

A sheet guide equipment

4. Claims 18-21:

A sheet feeding roller holding mechanism