



US 20170086830A1

(19) **United States**

(12) **Patent Application Publication**

Yates et al.

(10) **Pub. No.: US 2017/0086830 A1**

(43) **Pub. Date: Mar. 30, 2017**

(54) **MOTOR-DRIVEN SURGICAL CUTTING INSTRUMENT**

Jun. 1, 2012, now Pat. No. 8,602,287, which is a continuation of application No. 12/235,782, filed on Sep. 23, 2008, now Pat. No. 8,210,411.

(71) Applicant: **Ethicon Endo-Surgery, LLC**,
Guaynabo, PR (US)

Publication Classification

(72) Inventors: **David C. Yates**, West Chester, OH (US); **Frederick E. Shelton, IV**, Hillsboro, OH (US); **Bret W. Smith**, South Lebanon, OH (US); **Brett E. Swensgard**, West Chester, OH (US); **Ryan J. Laurent**, Loveland, OH (US)

(51) **Int. Cl.**
A61B 17/072 (2006.01)
(52) **U.S. Cl.**
CPC *A61B 17/07207* (2013.01); *A61B 2017/00734* (2013.01)

(21) Appl. No.: **15/372,984**

(57) **ABSTRACT**

(22) Filed: **Dec. 8, 2016**

A motor-driven surgical cutting and fastening instrument that comprises an end effector, an electric motor, and a motor control circuit. The motor control circuit is for monitoring a parameter of the electric motor that is indicative of movement of a moveable member of the end effector, and for adjustably controlling the electric motor based on the monitored parameter to thereby adjustably control movement of the moveable member of the end effector during forward rotation of the electric motor.

Related U.S. Application Data

(63) Continuation of application No. 13/784,957, filed on Mar. 5, 2013, now Pat. No. 9,549,732, which is a continuation of application No. 13/486,175, filed on

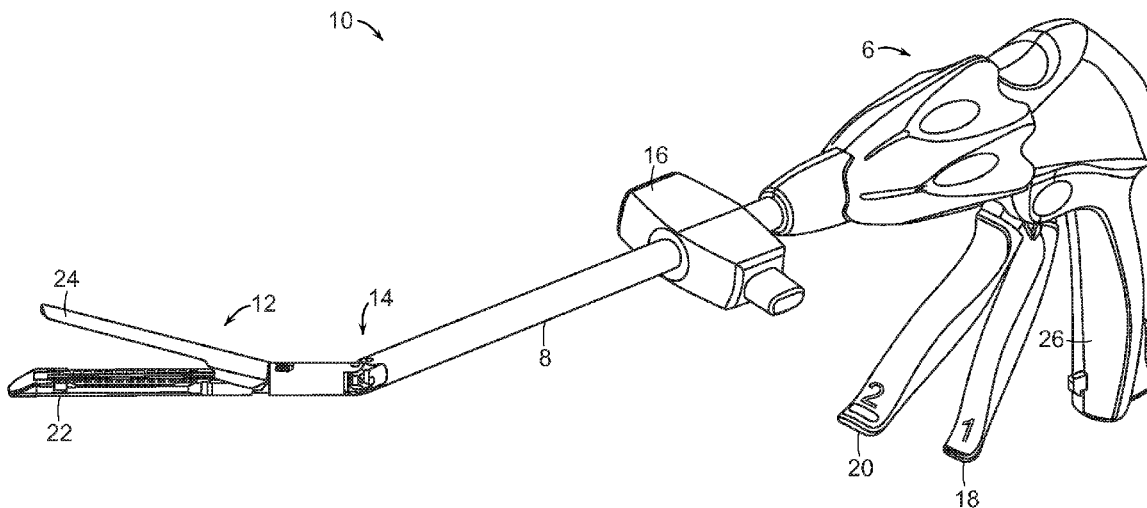

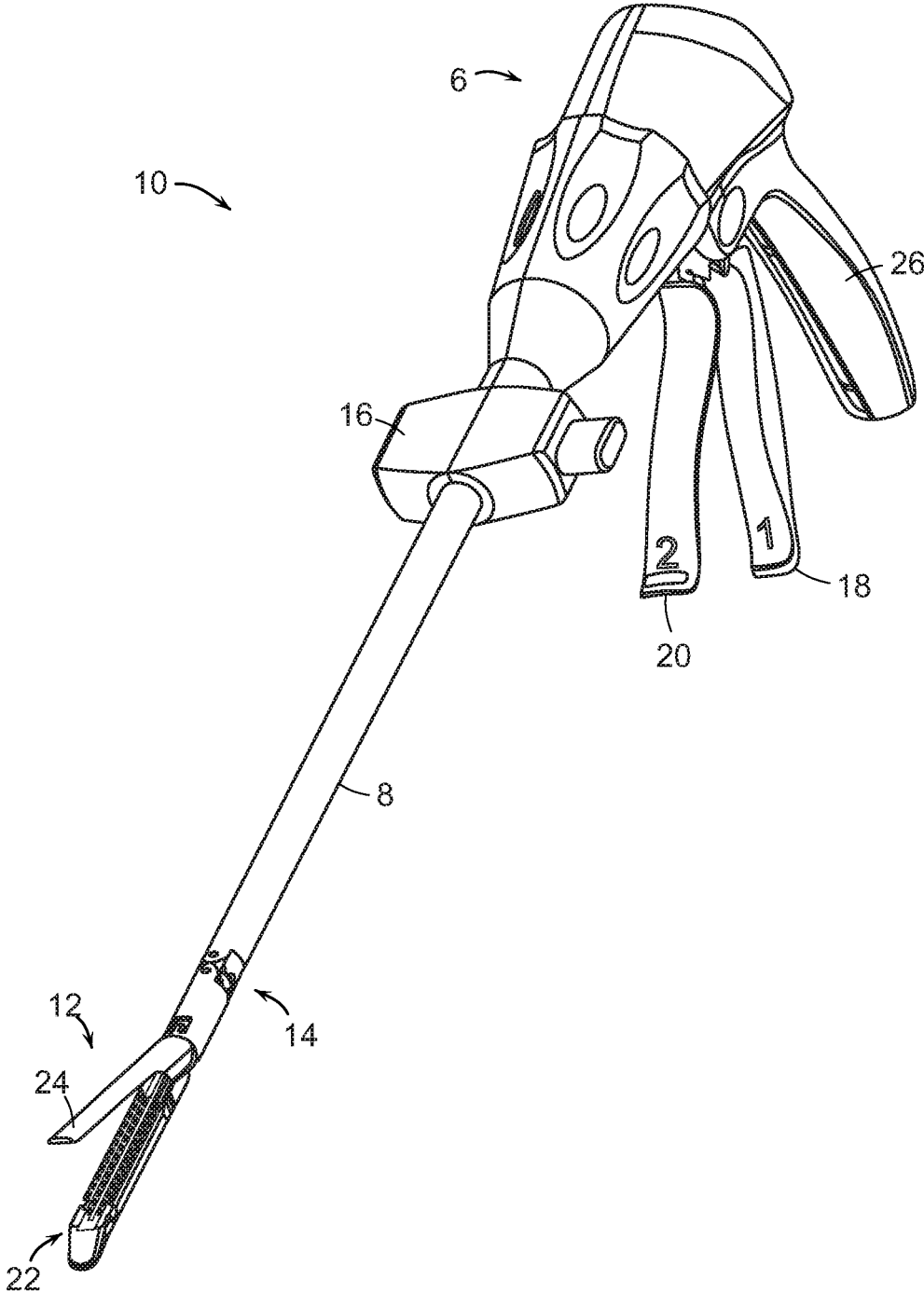

FIG. 1

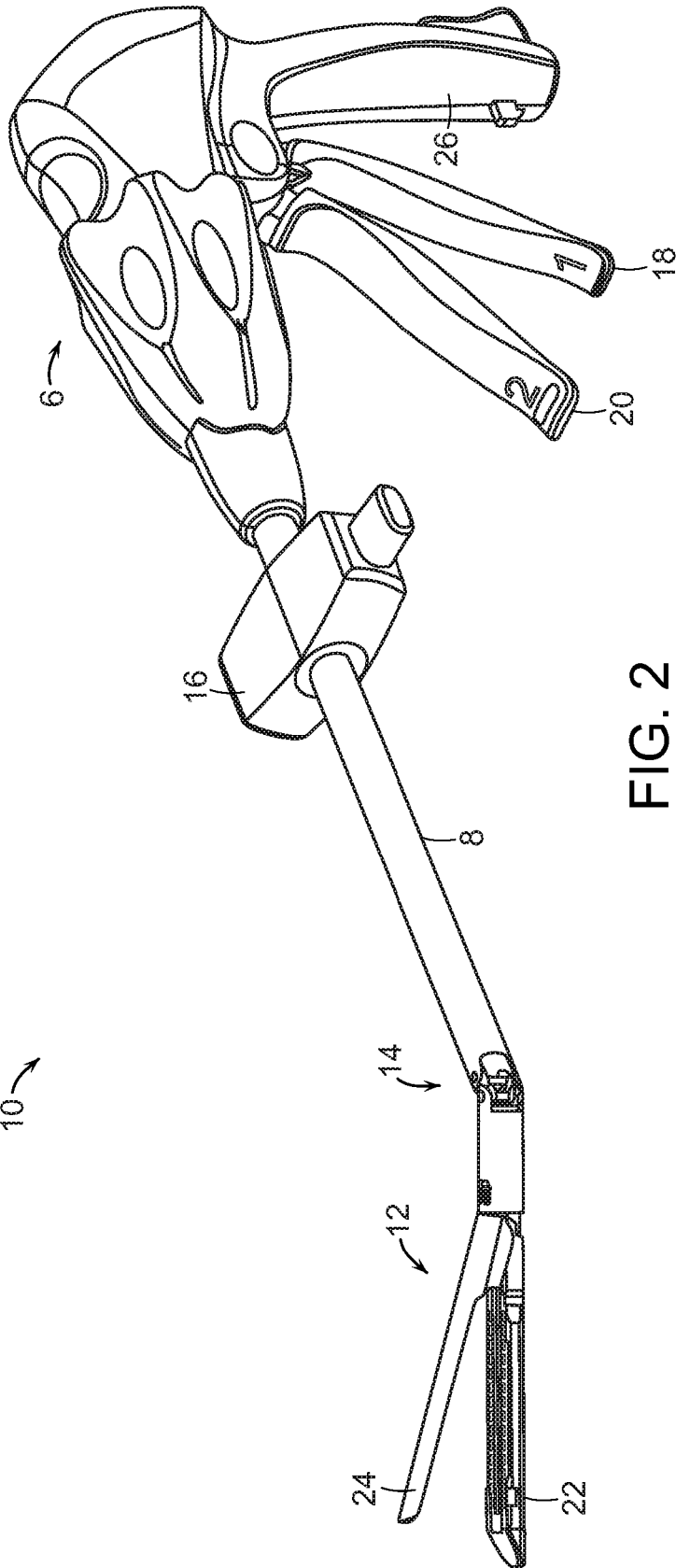

FIG. 2

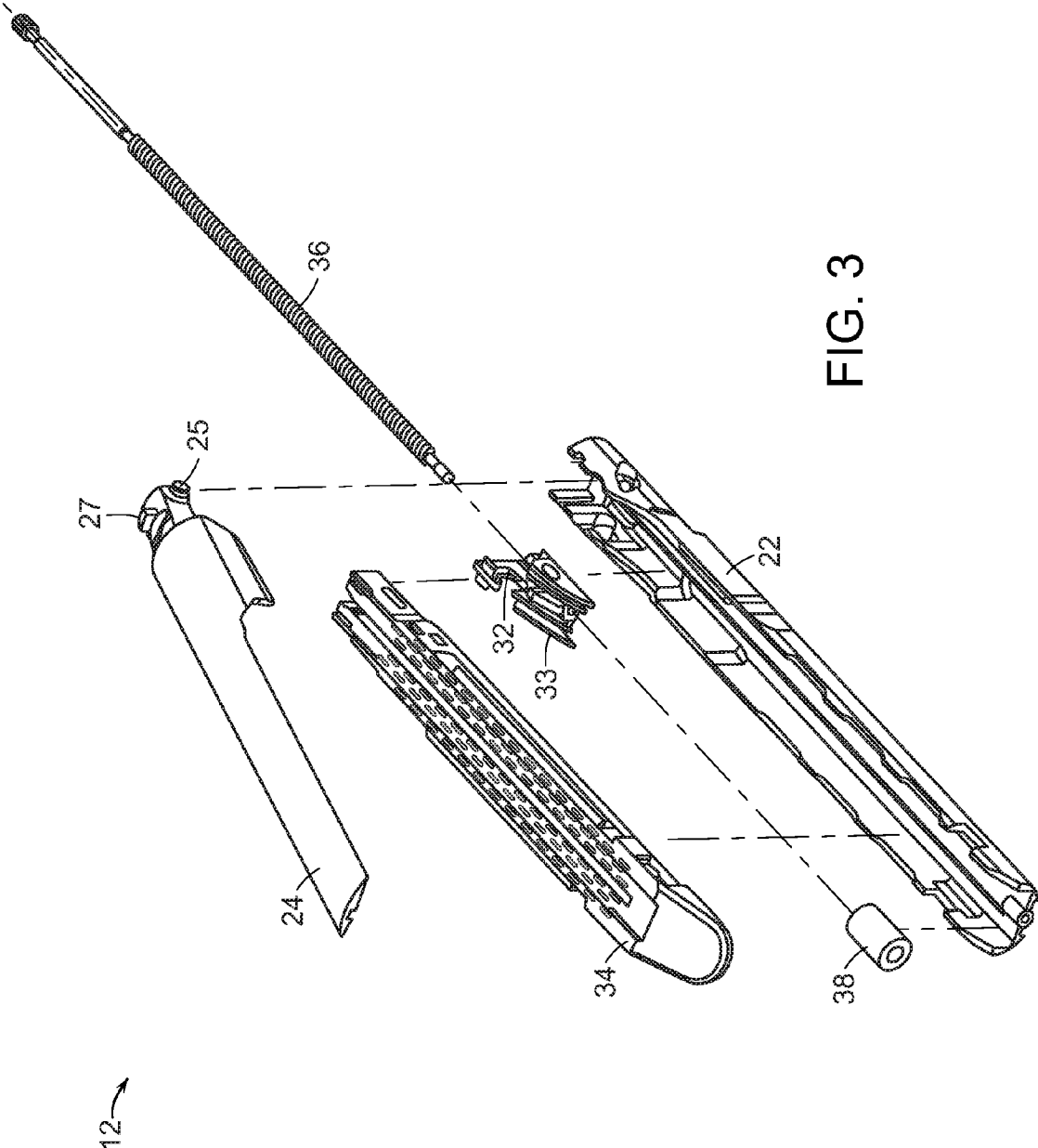
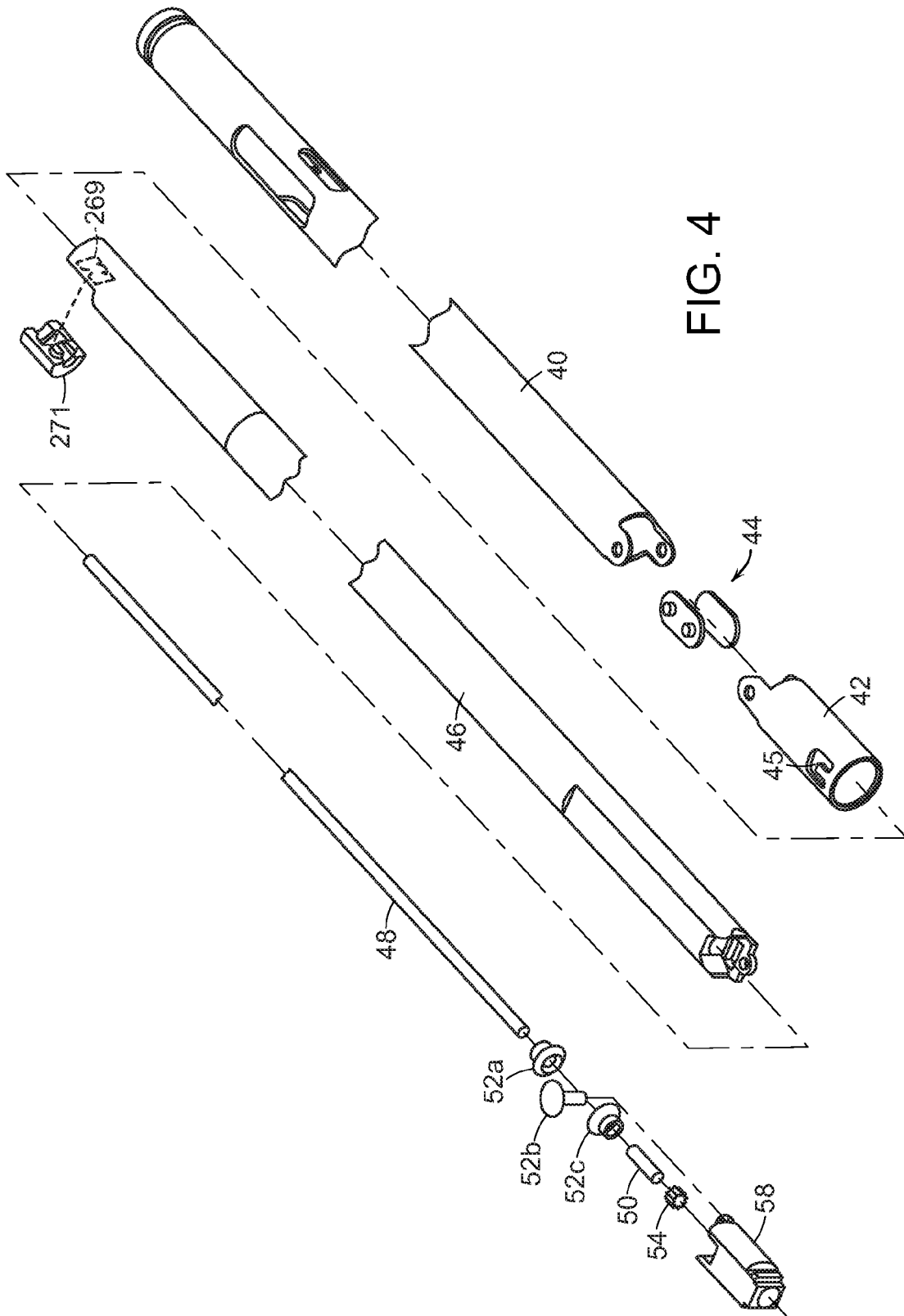

FIG. 3



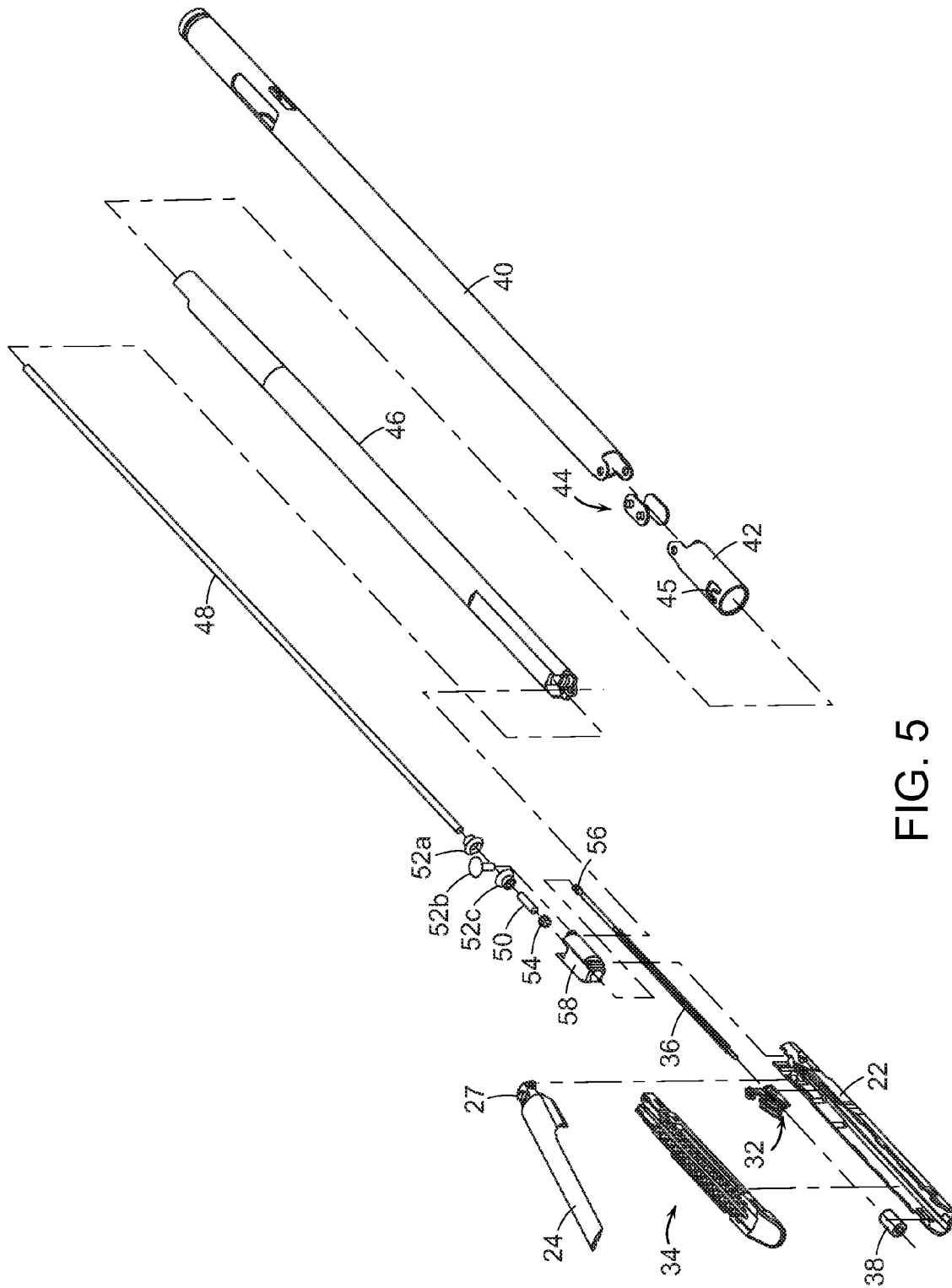

FIG. 5

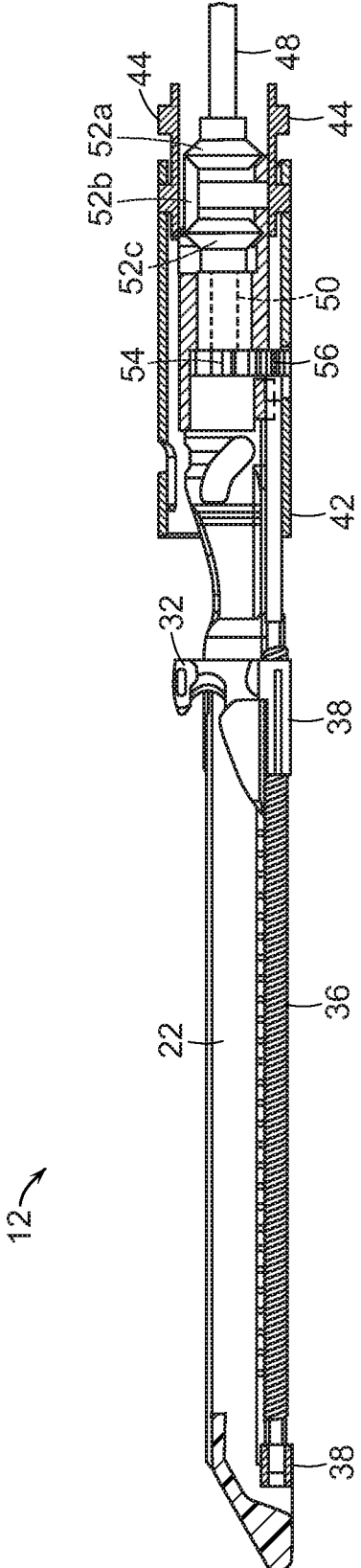

FIG. 6

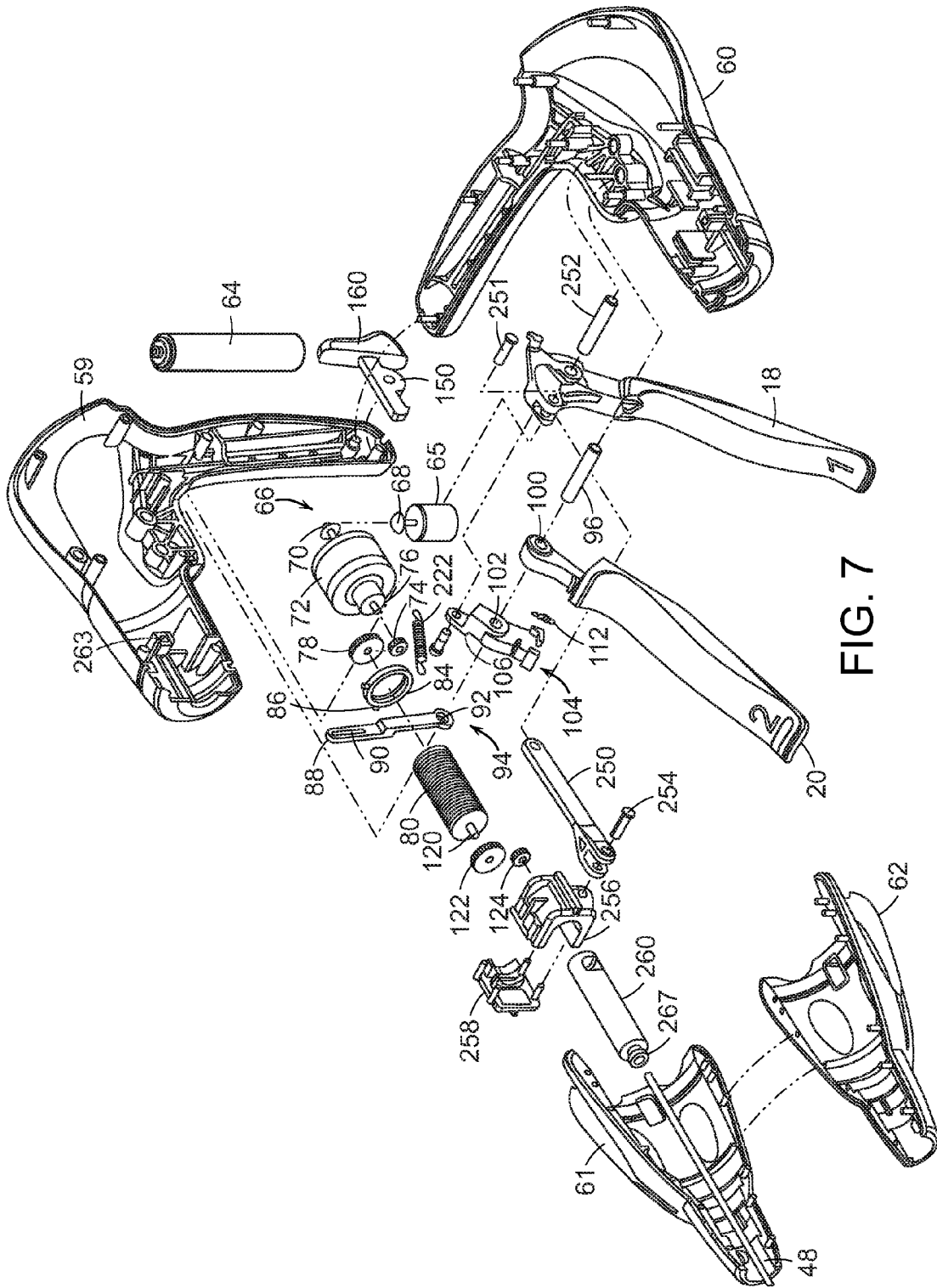

FIG. 7

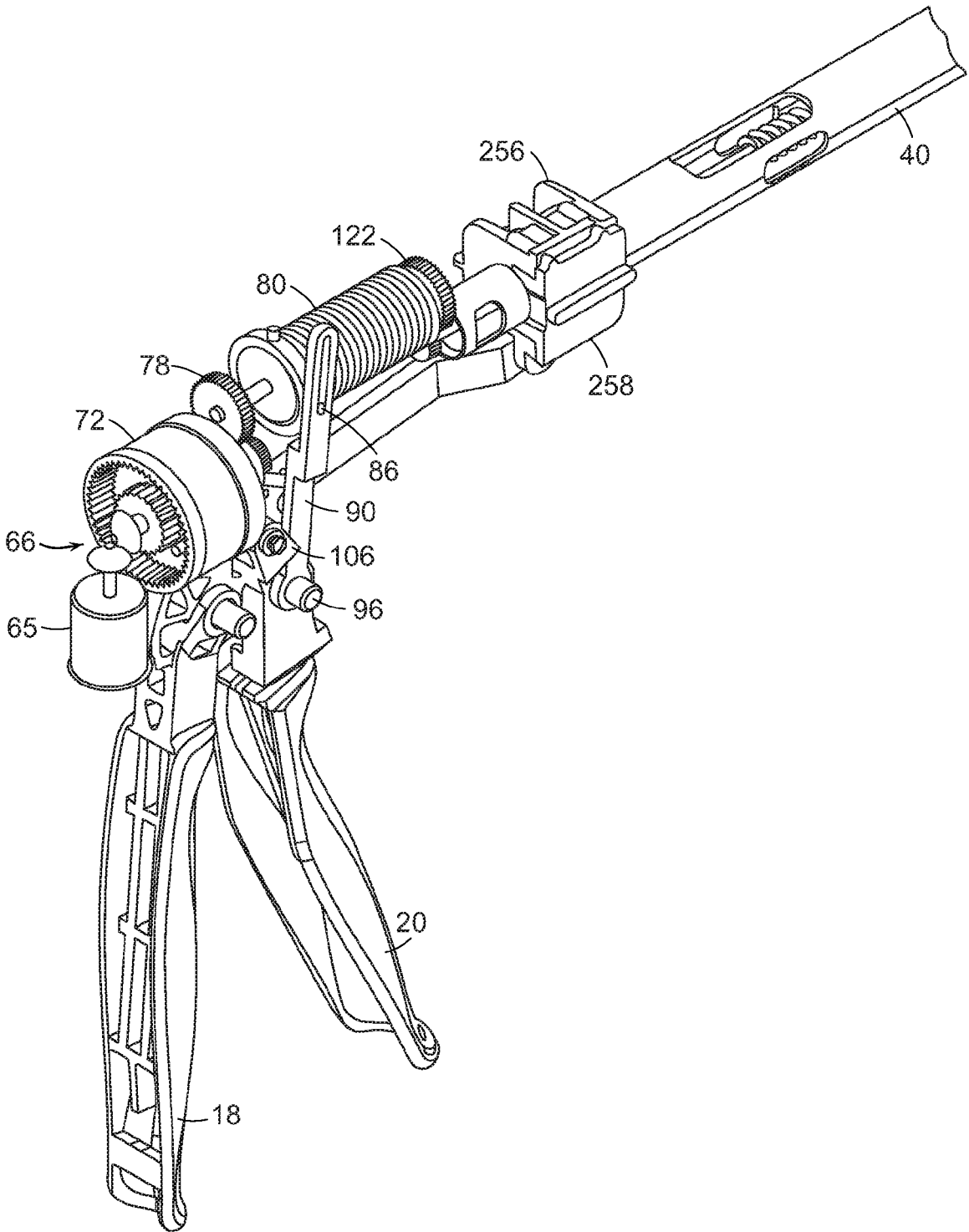

FIG. 8

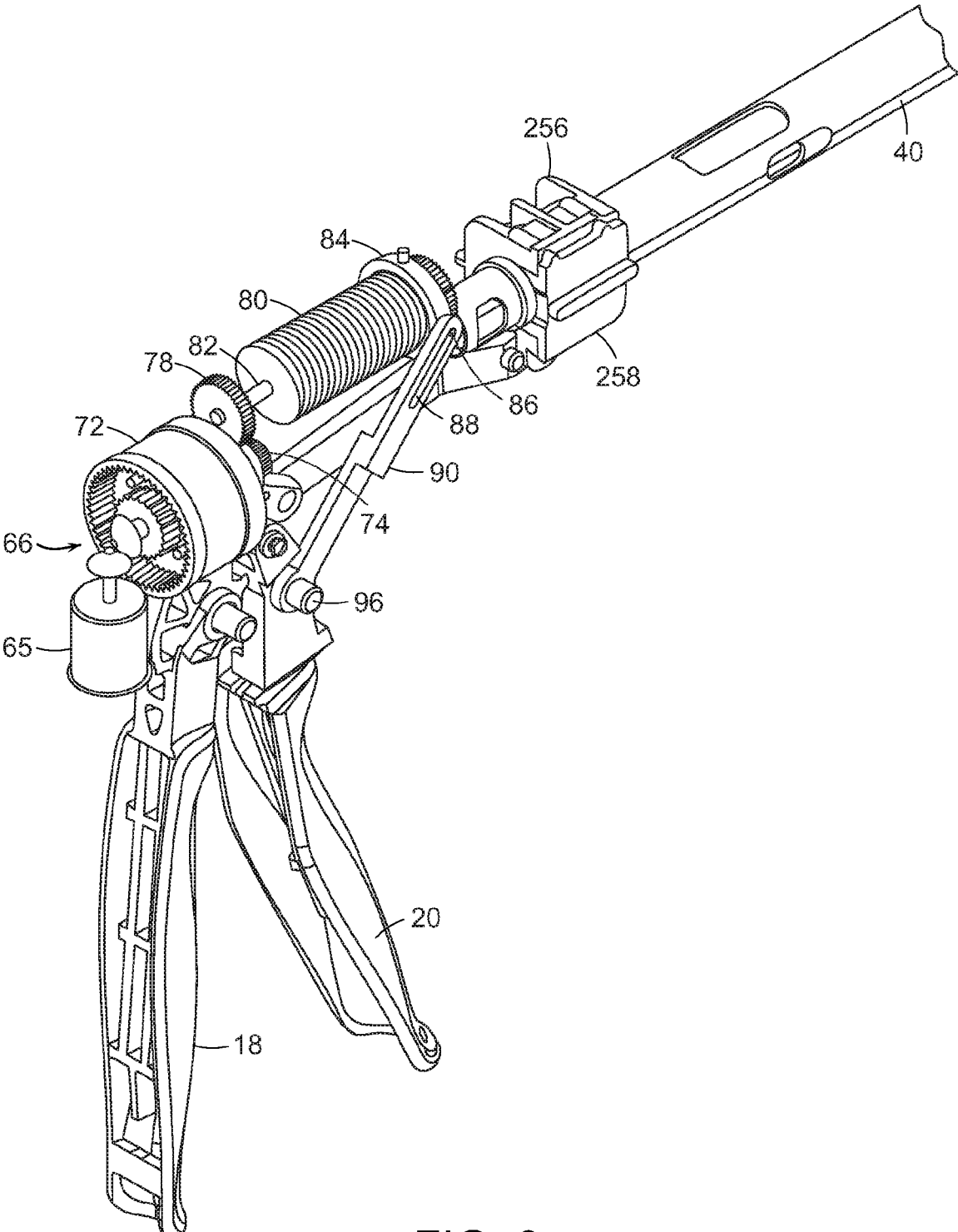

FIG. 9

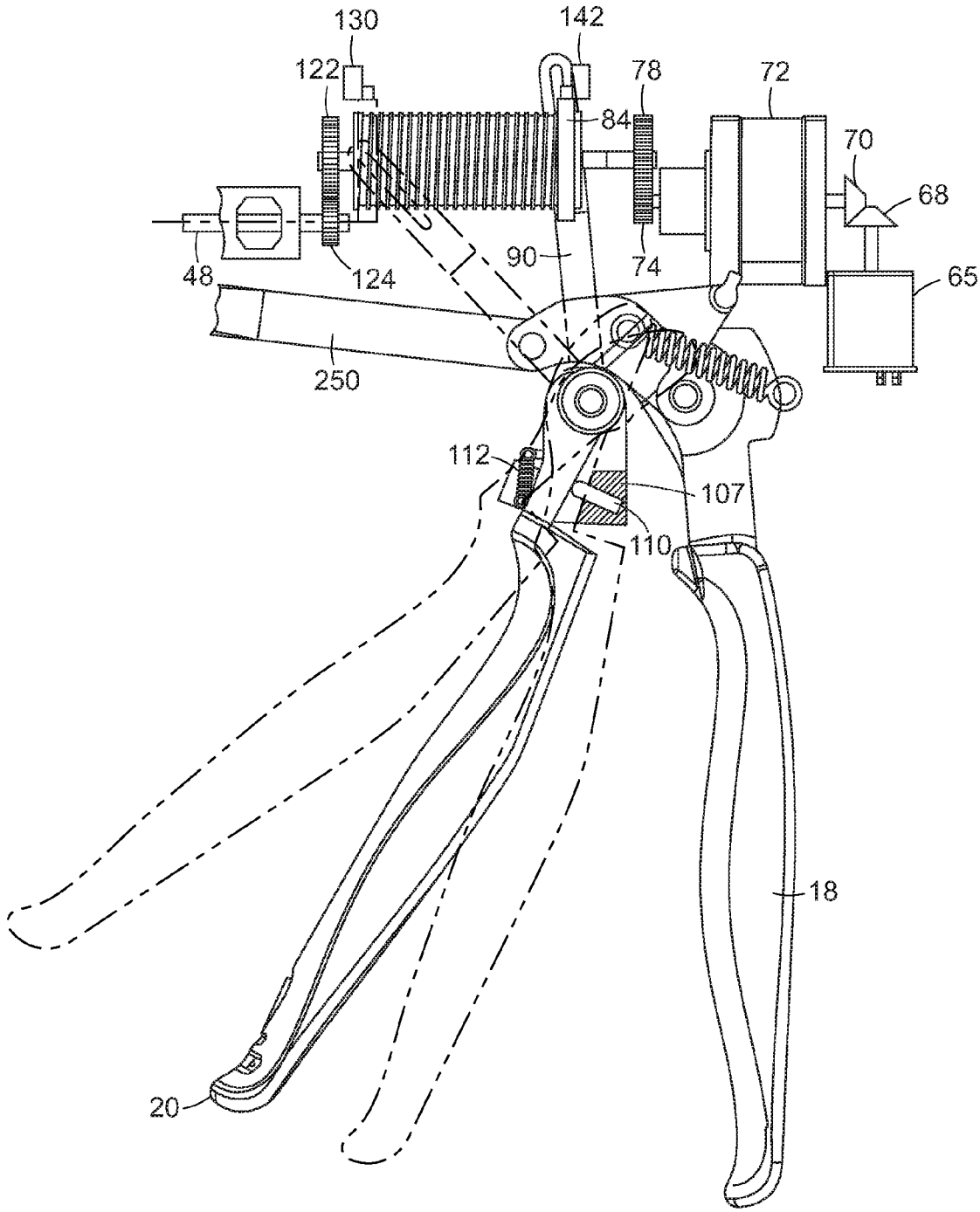
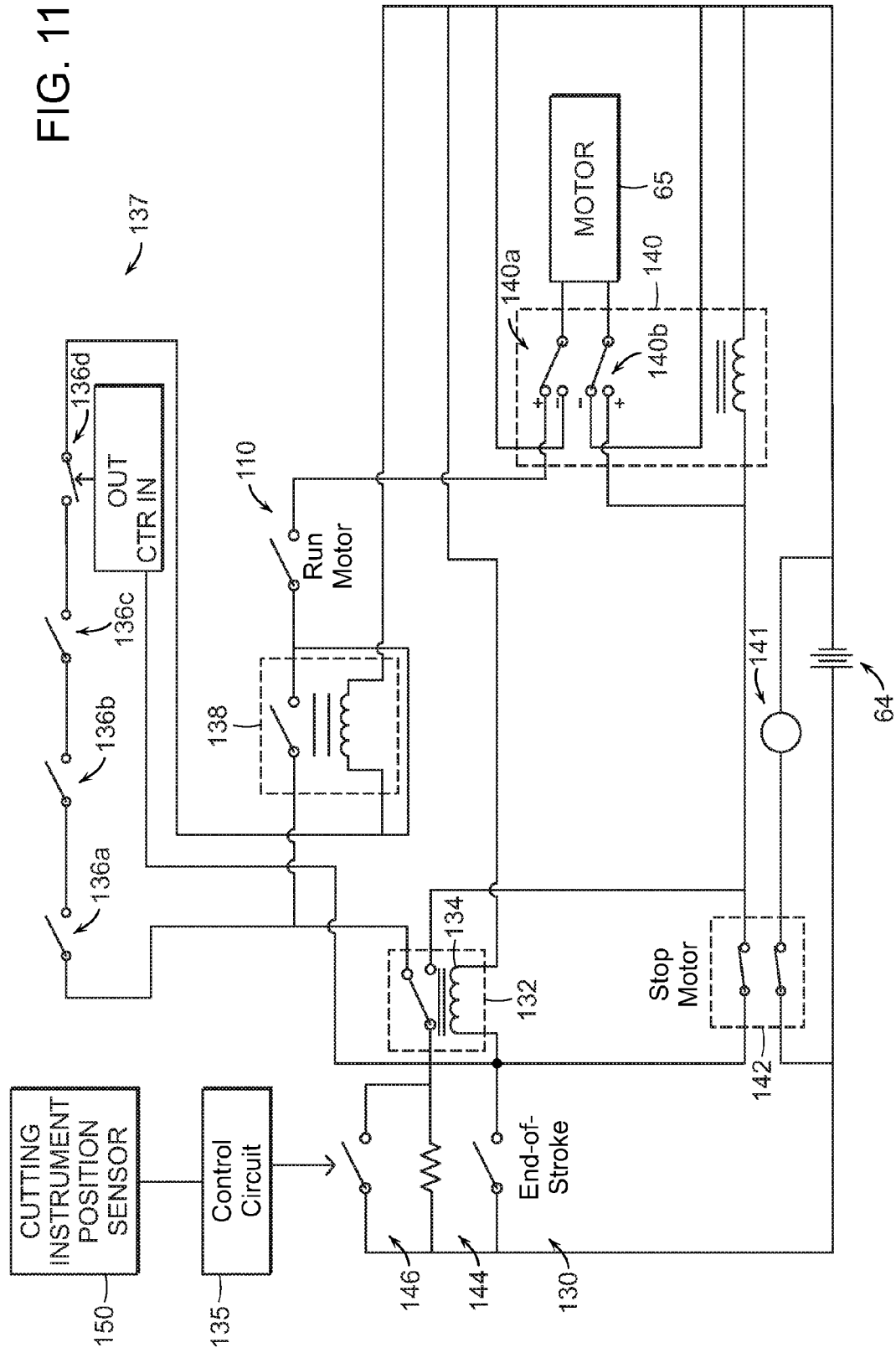

FIG. 10

FIG. 11



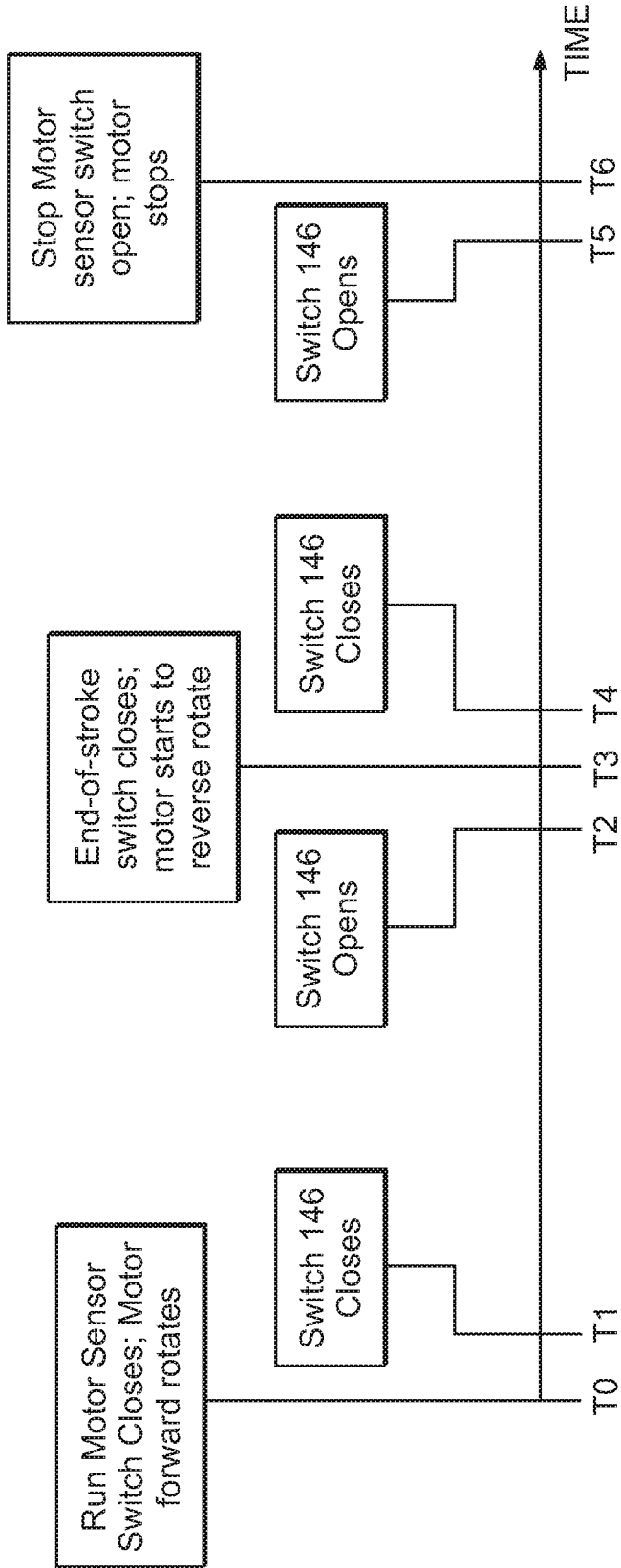

FIG. 12

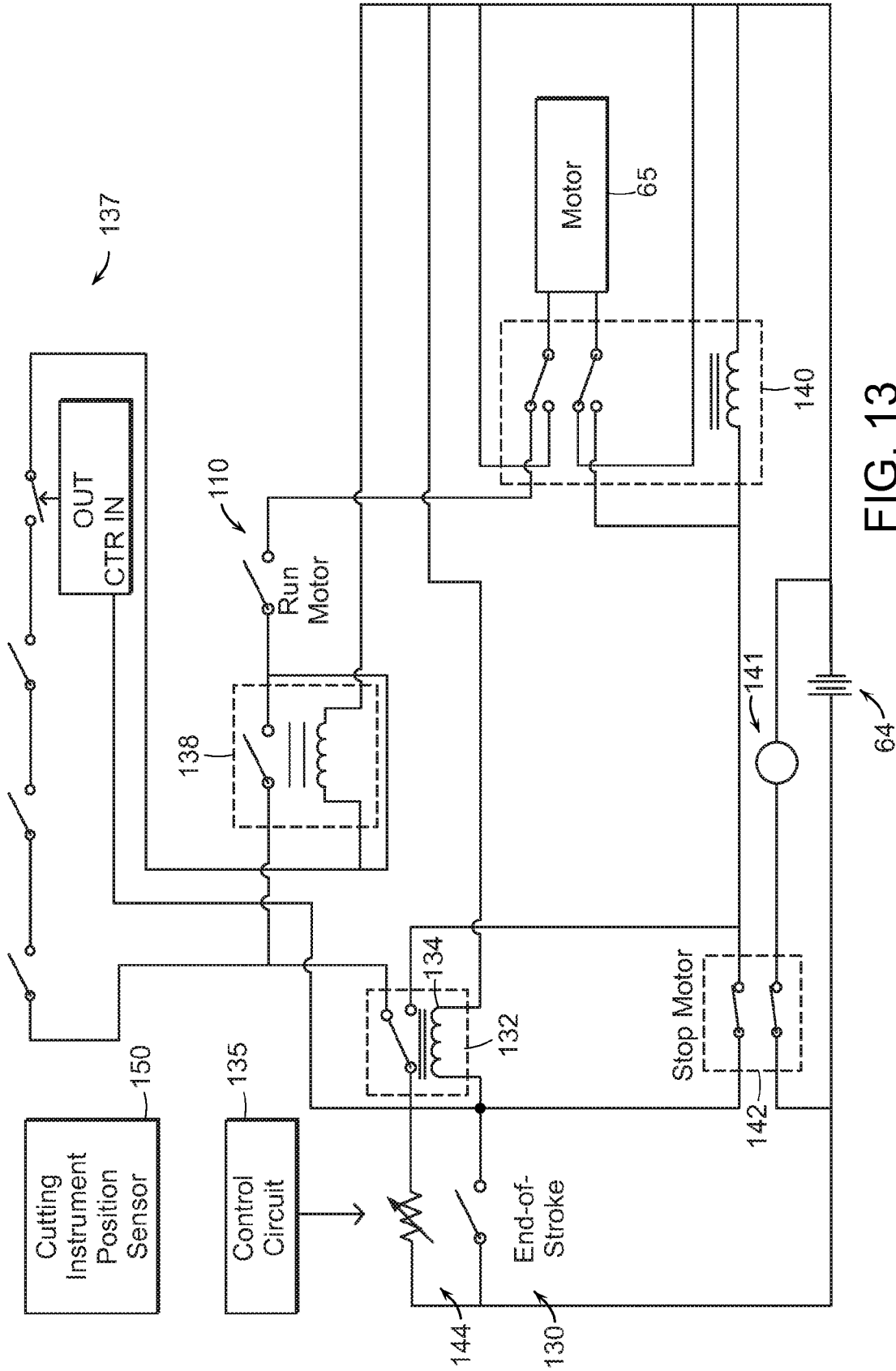

FIG. 13

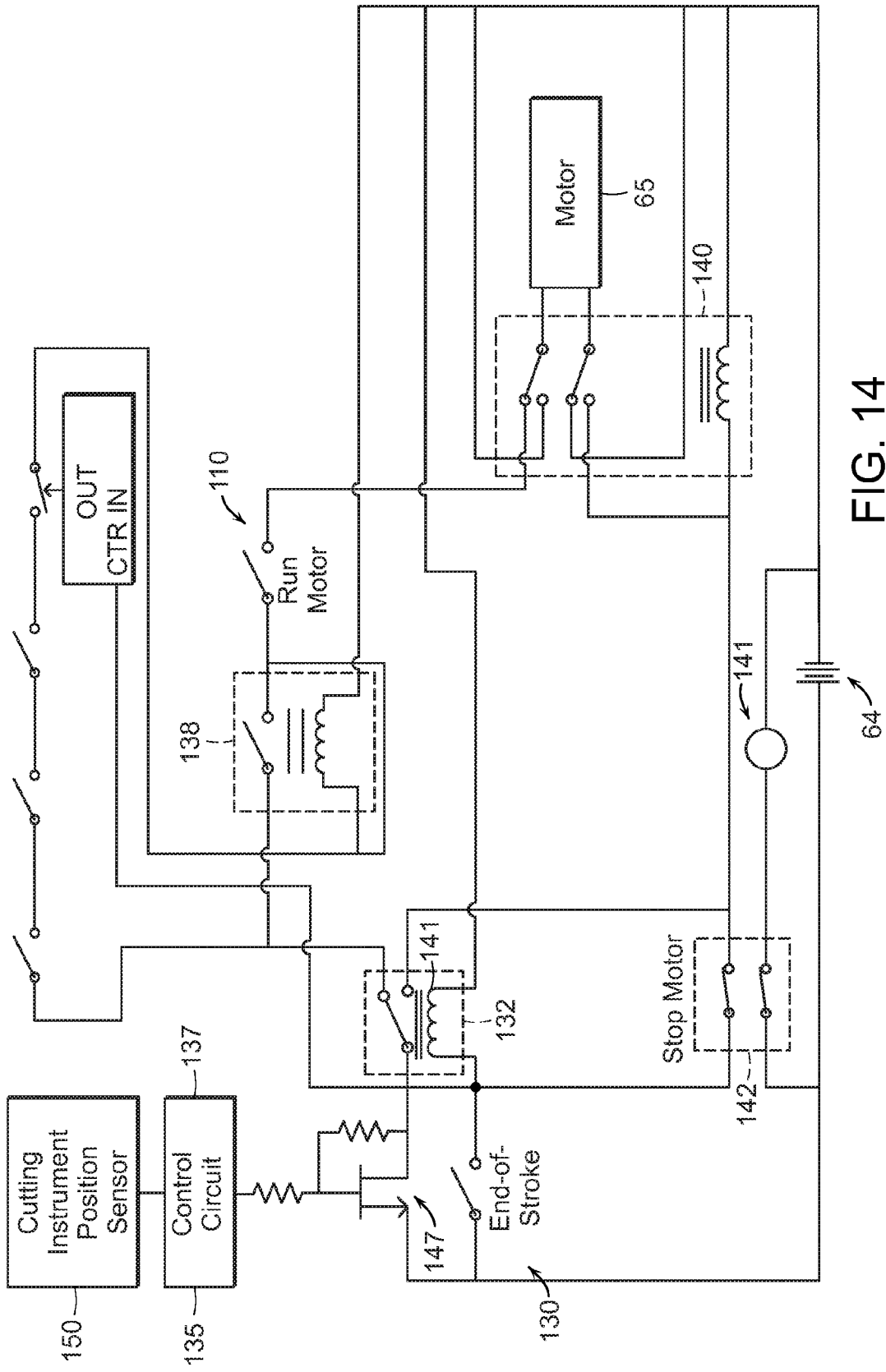

FIG. 14

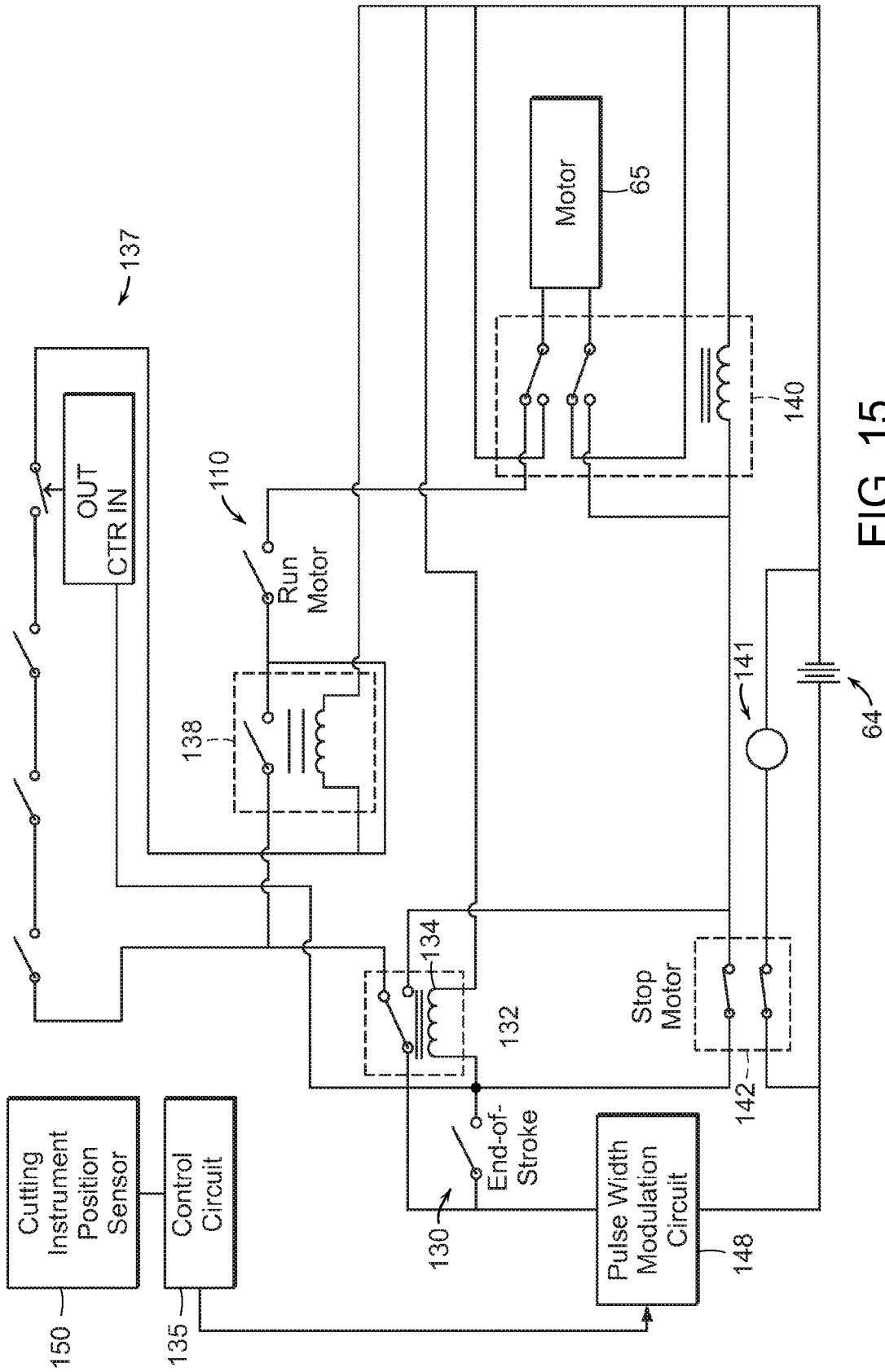

FIG. 15

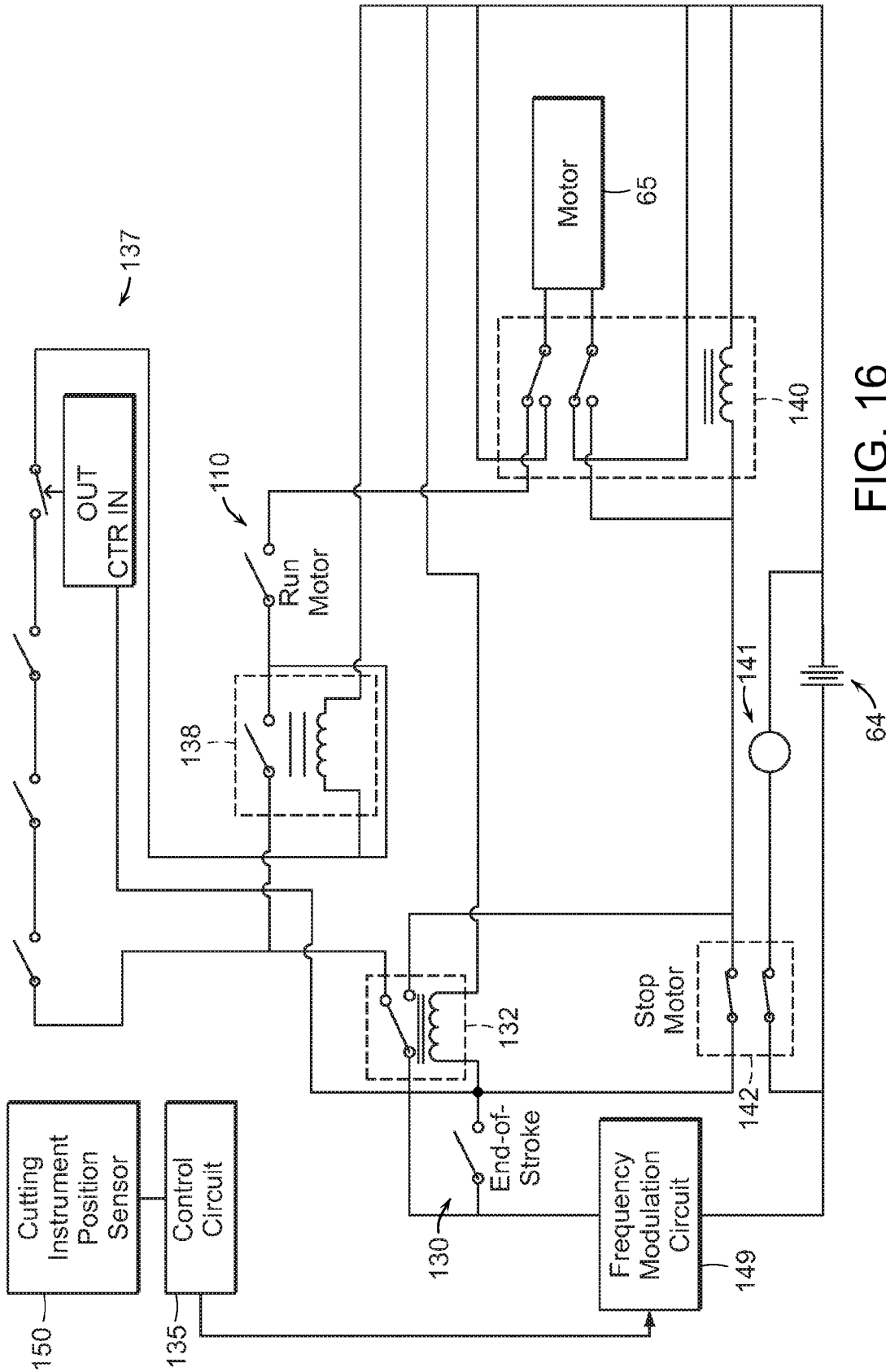

FIG. 16

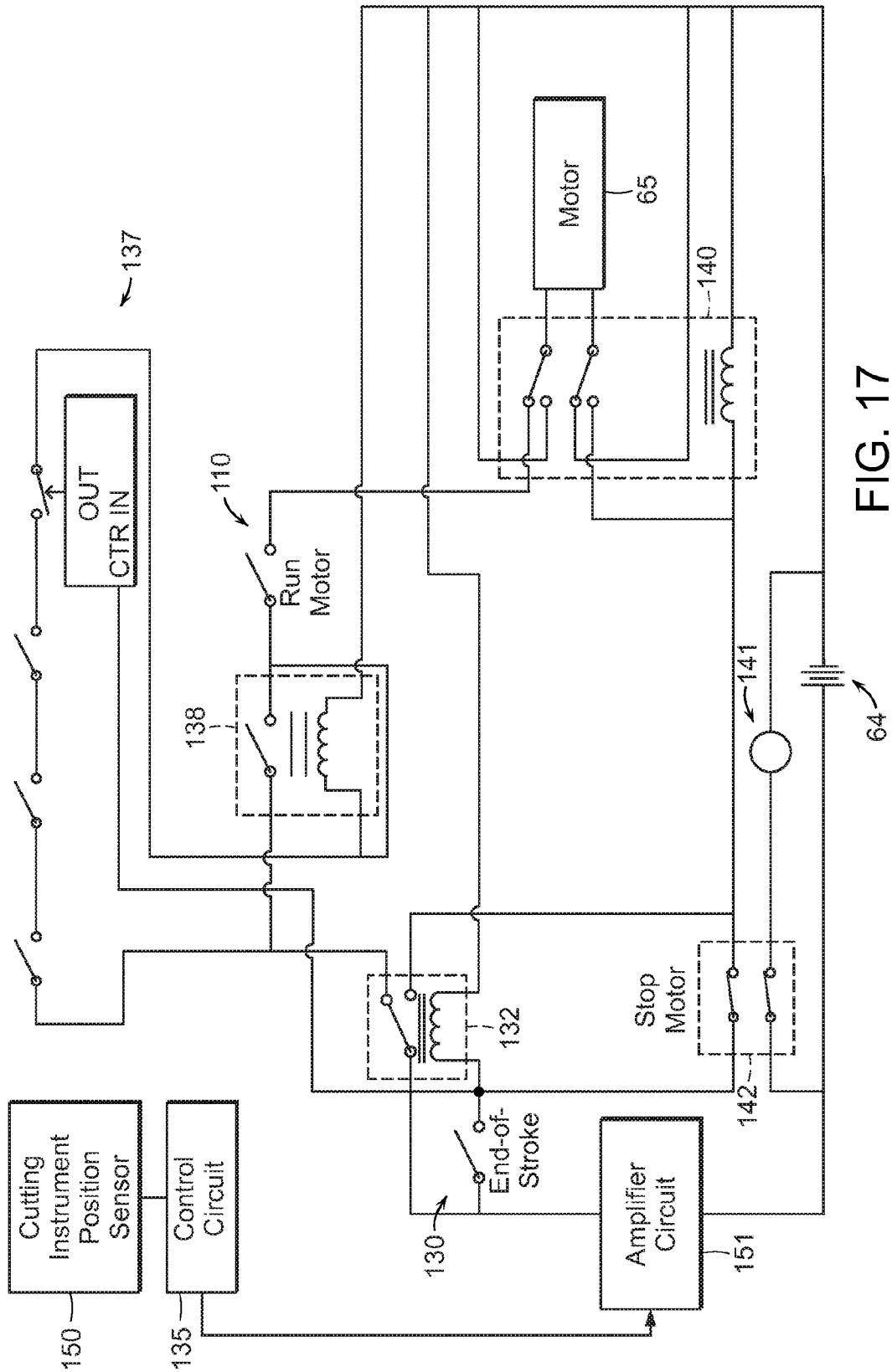

FIG. 17

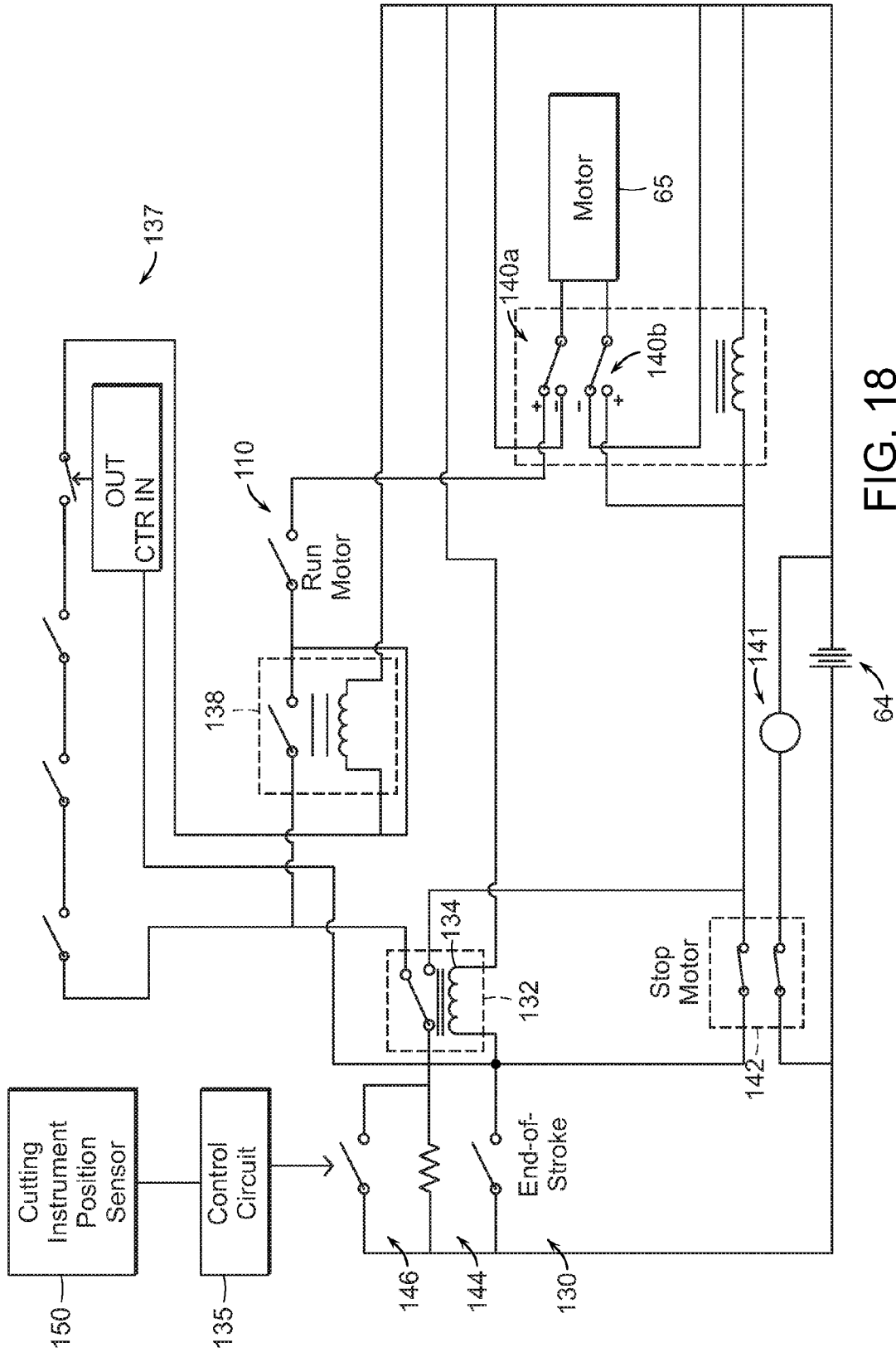

FIG. 18

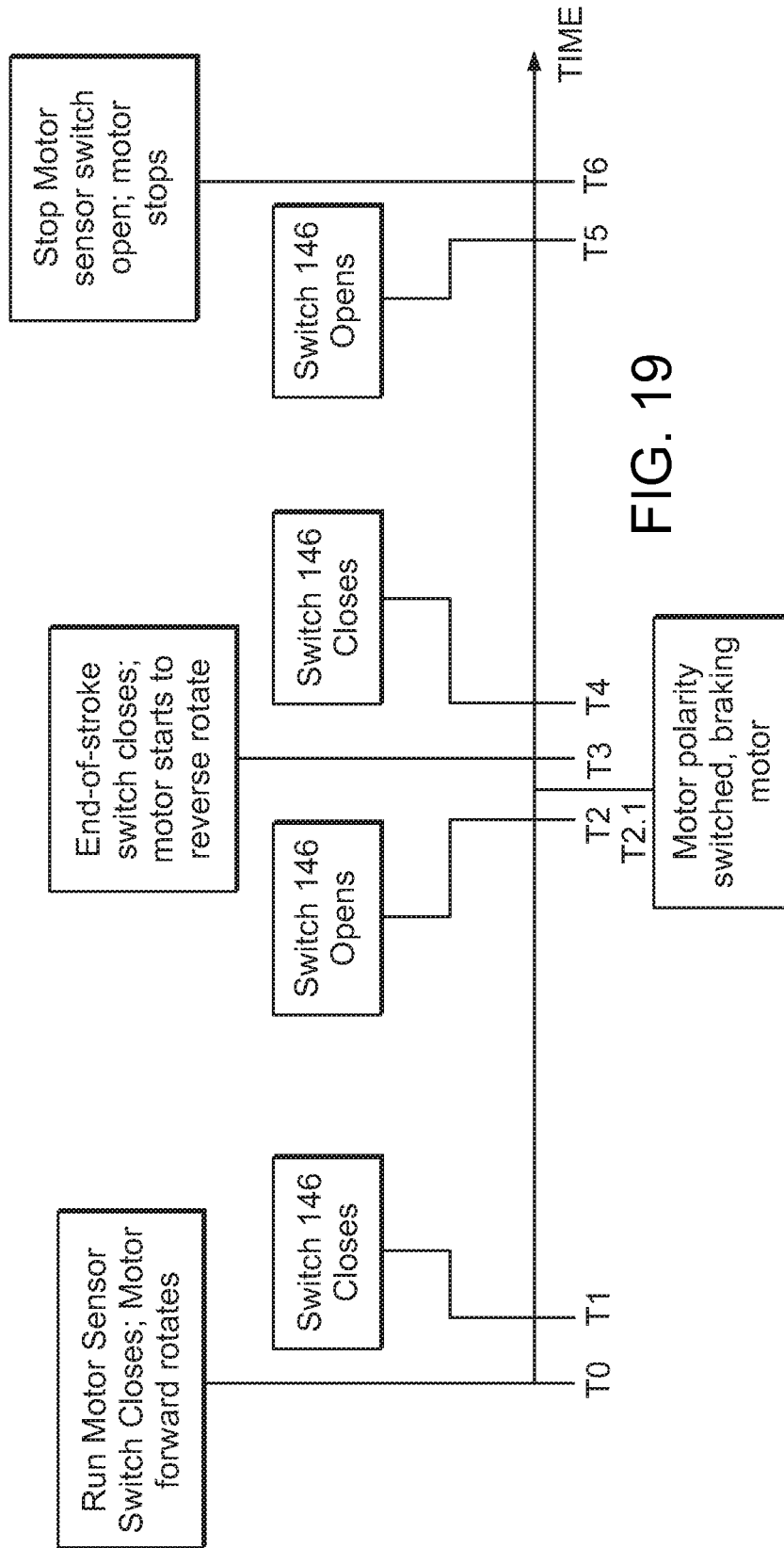

FIG. 19

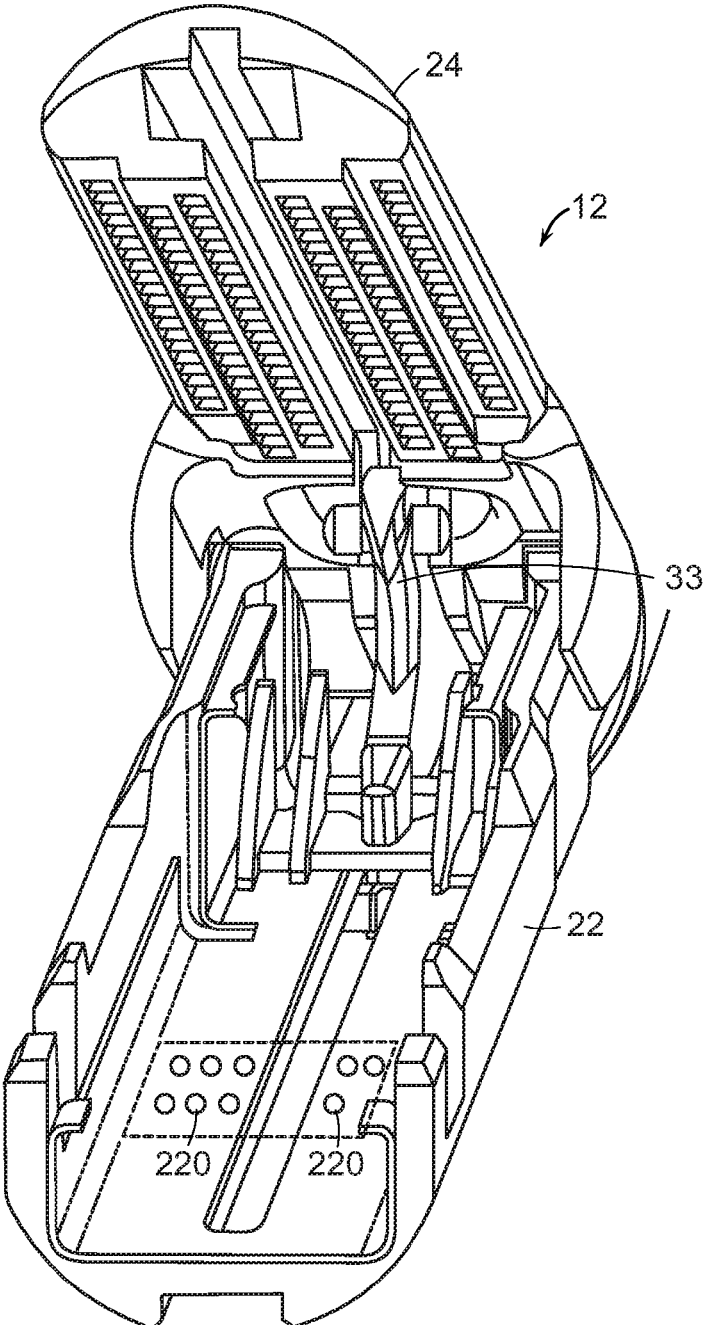

FIG. 20

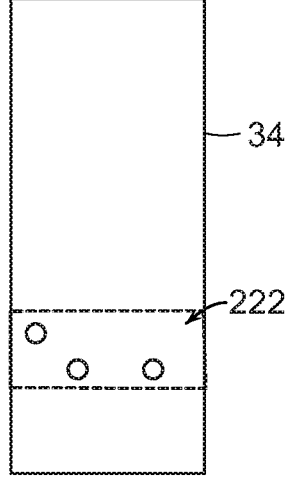

FIG. 21

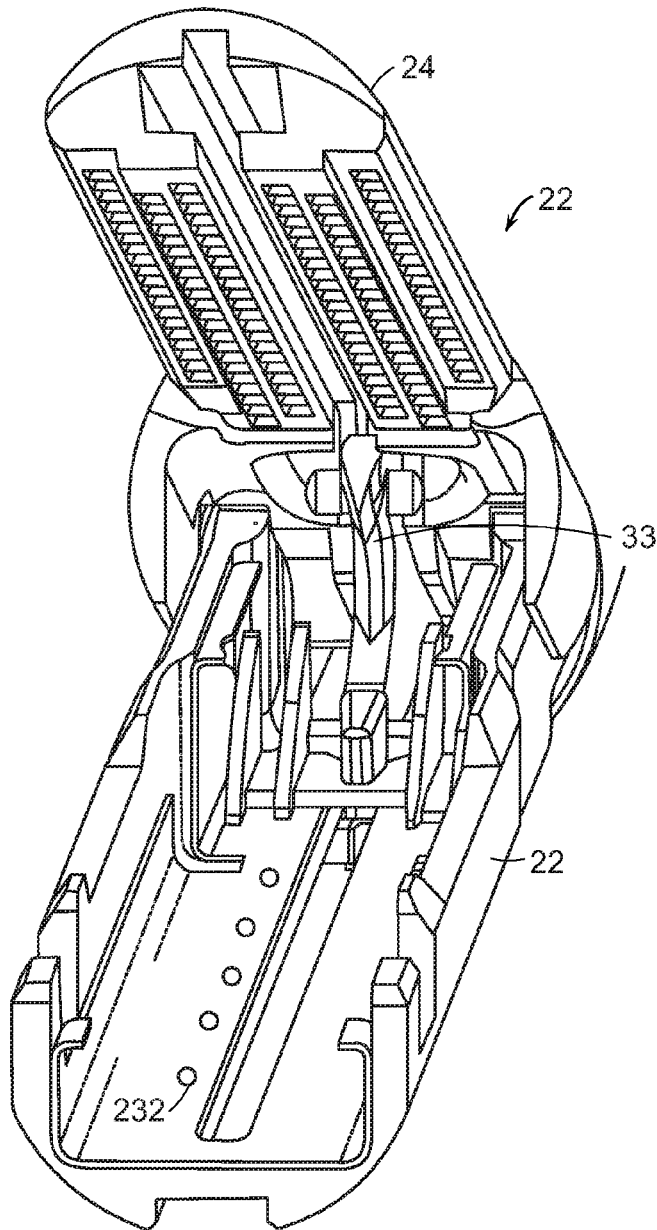

FIG. 23

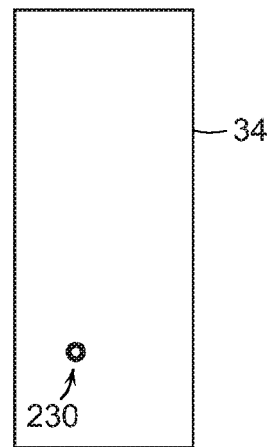

FIG. 22

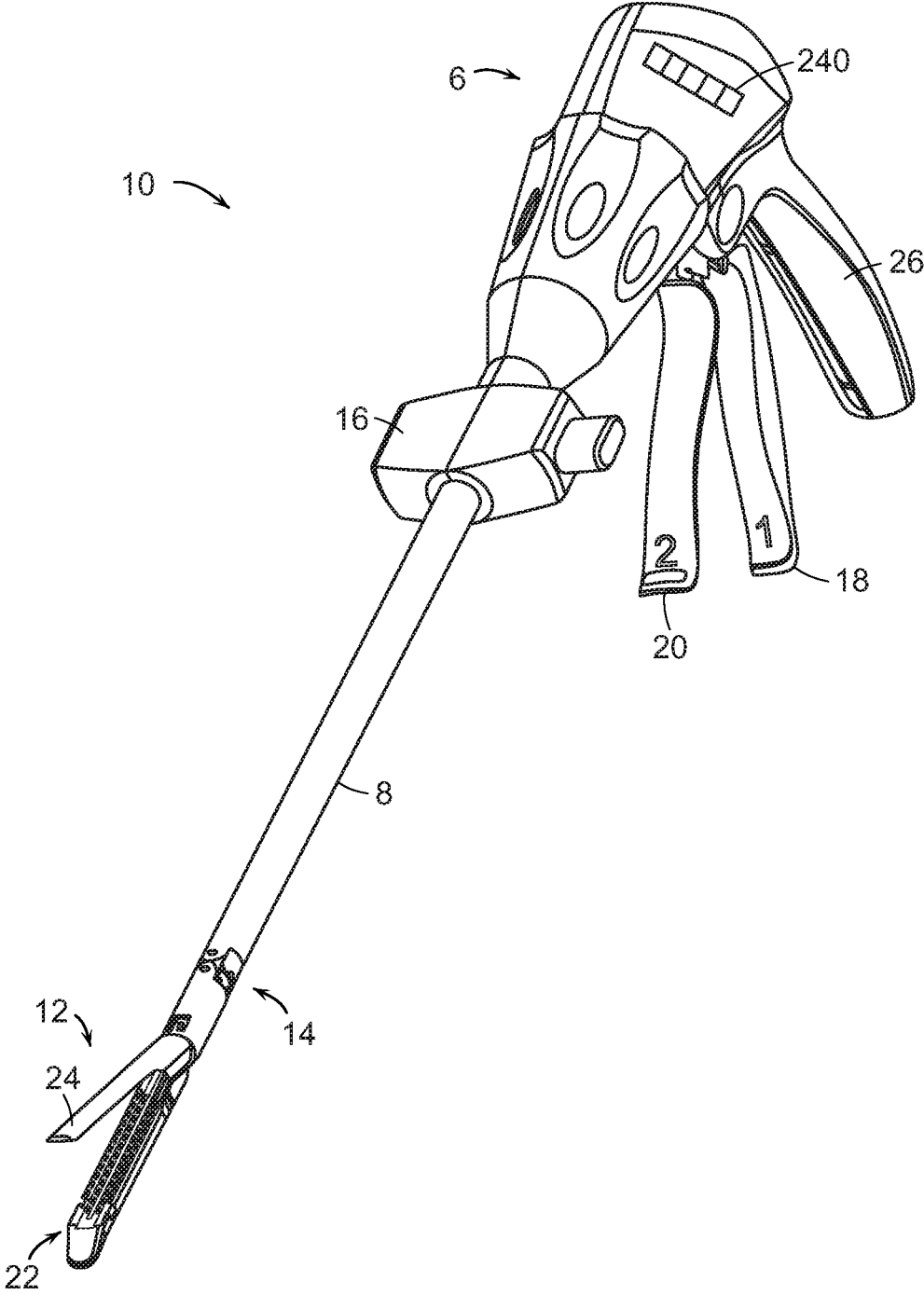

FIG. 24

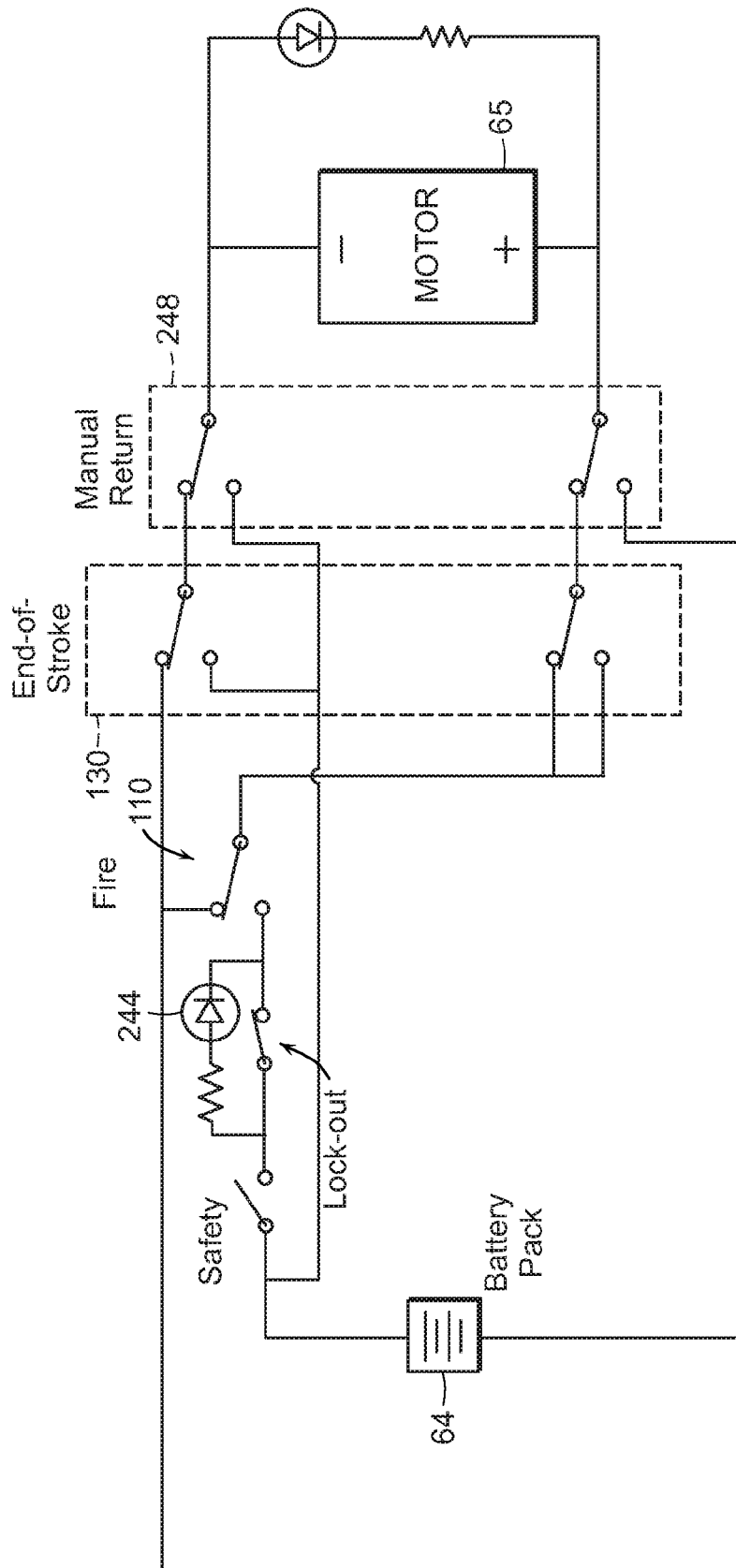

FIG. 25

MOTOR-DRIVEN SURGICAL CUTTING INSTRUMENT

CROSS-REFERENCE TO RELATED APPLICATIONS

[0001] This application is a continuation application claiming priority under 35 U.S.C. §120 to U.S. patent application Ser. No. 13/784,957, entitled MOTOR-DRIVEN SURGICAL CUTTING INSTRUMENT, filed on Mar. 5, 2013, now U.S. Patent Application Publication No. 2013/0175322, which is a continuation application claiming priority under 35 U.S.C. §120 to U.S. patent application Ser. No. 13/486,175, entitled MOTOR-DRIVEN SURGICAL CUTTING INSTRUMENT, filed on Jun. 1, 2012, which issued on Dec. 10, 2013 as U.S. Pat. No. 8,602,287, which is a continuation application claiming priority under 35 U.S.C. §120 to U.S. patent application Ser. No. 12/235,782, entitled MOTOR-DRIVEN SURGICAL CUTTING INSTRUMENT, filed Sep. 23, 2008, which issued on Jul. 3, 2012 as U.S. Pat. No. 8,210,411, the entire disclosures of which are hereby incorporated by reference herein.

BACKGROUND

[0002] Surgical staplers are used to simultaneously make a longitudinal incision in tissue and apply lines of staples on opposing sides of the incision. Such instruments commonly include an end effector having a pair of cooperating jaw members that, if the instrument is intended for endoscopic or laparoscopic applications, are capable of passing through a cannula passageway. One of the jaw members receives a staple cartridge having at least two laterally spaced rows of staples—one on each side of the knife channel. The other jaw member defines an anvil having staple-forming pockets aligned with the rows of staples in the cartridge. The instrument includes a plurality of reciprocating wedges that, when driven distally, pass through openings in the staple cartridge and engage drivers supporting the staples to effect the firing of the staples toward the anvil. Simultaneously, a cutting instrument (or knife) is drawn distally along the jaw member so that the clamped tissue is cut and fastened (e.g., stapled) at the same time.

[0003] An example of a surgical stapler suitable for endoscopic applications is described in published U.S. Patent Application Publication No. 2004/0232196, entitled, SURGICAL STAPLING INSTRUMENT HAVING SEPARATE DISTINCT CLOSING AND FIRING SYSTEMS, now U.S. Pat. No. 7,000,818, the disclosure of which is herein incorporated by reference in its entirety. In use, a clinician is able to close the jaw members of the stapler upon tissue to position the tissue prior to firing. Once the clinician has determined that the jaw members are properly gripping tissue, the clinician can then fire the surgical stapler, thereby severing and stapling the tissue. The simultaneous severing and stapling actions avoid complications that may arise when performing such actions sequentially with different surgical tools that respectively only sever or staple.

[0004] Motor-driven endocutters are known in the art. In such devices, a motor powers the cutting and fastening action of the instrument. It is also known to use an on-board battery, located in the handle of the instrument, to power the motor. Published U.S. Patent Application Publication No. 2007/0175952, entitled MOTOR-DRIVEN SURGICAL CUTTING AND FASTENING INSTRUMENT WITH

LOADING FORCE FEEDBACK, now U.S. Pat. No. 7,416,101, the disclosure of which is herein incorporated by reference in its entirety, describes one such motor-driven surgical instrument.

SUMMARY

[0005] In one general aspect, the present invention is directed to a motor-driven surgical cutting and fastening instrument. According to various embodiments, the instrument may comprise an end effector, a shaft connected to the end effector, and handle connected to the shaft. The end effector may comprise a cutting instrument that, when actuated, longitudinally traverses the end effector to cut tissue clamped in the end effector. The handle may comprise an electric motor for actuating the cutting instrument and a motor control circuit for controlling the motor. The motor control circuit may comprise a power source connected to the motor for electrically powering the motor and a current control circuit, connected to the power source, for varying the current supplied to the motor from the power source. The current control circuit may vary the current supplied to the motor, and consequently, the output torque supplied by the motor, such that the motor has at least (i) a first, low power operational mode for a first portion of a cutting stroke cycle of the cutting instrument, and (ii) a second, high power operational mode for a second portion the cutting stroke cycle of the cutting instrument.

[0006] That way, for example, according to various embodiments, the motor can start out at a low power mode at the beginning of the cutting stroke to provide a soft start quality. After the initial soft start, the motor can ramp up to full power for the majority of the cutting stroke, but then transition to a lower power mode before and shortly after the cutting reverses direction. In addition, the motor may transition from a high power mode to a low power mode before the cutting instrument reaches its final, or home, position when it is being retracted. According circuit configurations for controlling the current supplied to the motor are provided.

[0007] In addition, according to various embodiments, the motor control circuit may actively brake the motor before it reverses direction. For example, the motor control circuit may remove power supplied to the motor just prior to the point in time when the cutting instrument is to reach its end-of-stroke position and the motor reverses direction. In various embodiments, the motor control circuit may comprise a memory that stores data regarding the cartridge loaded in the end effector, from which data the motor control circuit can determine when in the cutting stroke the motor should be actively braked. In other embodiments, the motor control circuit may not include any integrated circuits. In such embodiments, an interface between the end effector and the cartridge may complete an electrical circuit that is connected to the motor control circuit and that has characteristics (e.g., resistance) that control when the motor is actively braked by the motor control circuit.

[0008] These and other benefits of the present invention will be apparent from the description below.

FIGURES

[0009] Various embodiments of the present invention are described herein by way of example in conjunction with the following figures, wherein:

[0010] FIGS. 1, 2, and 24 depict a surgical instrument with an articulatable end effector according to various embodiments of the present invention;

[0011] FIGS. 3-5 are exploded views of an end effector and shaft of the instrument according to various embodiments of the present invention;

[0012] FIG. 6 is a side view of the end effector according to various embodiments of the present invention;

[0013] FIG. 7 is an exploded view of the handle of the instrument according to various embodiments of the present invention;

[0014] FIGS. 8 and 9 are partial perspective views of the handle according to various embodiments of the present invention;

[0015] FIG. 10 is a side view of the handle according to various embodiments of the present invention;

[0016] FIGS. 11, 13-18, and 25 are diagrams of motor control circuit according to various embodiments of the present invention;

[0017] FIGS. 12 and 19 are timing diagrams illustrating operation of the instrument according to various embodiments of the present invention;

[0018] FIGS. 20 and 23 are diagrams of the end effector, without a cartridge, according to various embodiments of the present invention; and

[0019] FIGS. 21-22 are diagrams of a replaceable cartridge according to various embodiments of the present invention.

DESCRIPTION

[0020] FIGS. 1 and 2 depict a motor-driven surgical cutting and fastening instrument 10 according to various embodiments of the present invention. The illustrated embodiment is an endoscopic instrument and, in general, the embodiments of the instrument 10 described herein are endoscopic surgical cutting and fastening instruments. It should be noted, however, that the invention is not so limited and that according to other embodiments of the present invention, the instrument may be a non-endoscopic surgical cutting and fastening instrument, such as a laparoscopic instrument.

[0021] The surgical instrument 10 depicted in FIGS. 1 and 2 comprises a handle 6, a shaft 8, and an articulating end effector 12 pivotally connected to the shaft 8 at an articulation pivot 14. An articulation control 16 may be provided adjacent to the handle 6 to effect rotation of the end effector 12 about the articulation pivot 14. In the illustrated embodiment, the end effector 12 is configured to act as an endocutter for clamping, severing and stapling tissue, although, in other embodiments, different types of end effectors may be used, such as end effectors for other types of surgical devices, such as graspers, cutters, staplers, clip applicators, access devices, drug/gene therapy devices, ultrasound, RF or laser devices, etc. More details regarding RF devices may be found in U.S. Pat. 5,403,312 and commonly assigned U.S. patent application Ser. No. 12/031,573, entitled SURGICAL CUTTING AND FASTENING INSTRUMENT HAVING RF ELECTRODES, filed Feb. 14, 2008, both of which are incorporated by reference in their entirety.

[0022] The handle 6 of the instrument 10 may include a closure trigger 18 and a firing trigger 20 for actuating the end effector 12. It will be appreciated that instruments having end effectors directed to different surgical tasks may have different numbers or types of triggers or other suitable

controls for operating the end effector 12. The end effector 12 is shown separated from the handle 6 by a preferably elongate shaft 8. In one embodiment, a clinician or operator of the instrument 10 may articulate the end effector 12 relative to the shaft 8 by utilizing the articulation control 16, as described in more detail in U.S. Patent Application Publication No. 2007/0158385, entitled SURGICAL INSTRUMENT HAVING AN ARTICULATING END EFFECTOR, now U.S. Pat. No. 7,670,334, which is incorporated herein by reference in its entirety.

[0023] The end effector 12 includes in this example, among other things, a staple channel 22 and a pivotally translatable clamping member, such as an anvil 24, which are maintained at a spacing that assures, when the anvil 24 is in its clamped position, effective stapling and severing of tissue clamped in the end effector 12. The handle 6 includes a downwardly extending pistol grip 26 towards which a closure trigger 18 is pivotally drawn by the clinician to cause clamping or closing of the anvil 24 toward the staple channel 22 of the end effector 12 to thereby clamp tissue positioned between the anvil 24 and channel 22. The firing trigger 20 is farther outboard of the closure trigger 18. Once the closure trigger 18 is locked in the closure position as further described below, the firing trigger 20 may rotate slightly toward the pistol grip 26 so that it can be reached by the operator using one hand. Then the operator may pivotally draw the firing trigger 20 toward the pistol grip 12 to cause the stapling and severing of clamped tissue in the end effector 12. In other embodiments, different types of clamping members besides the anvil 24 could be used.

[0024] It will be appreciated that the terms “proximal” and “distal” are used herein with reference to a clinician gripping the handle 6 of an instrument 10. Thus, the end effector 12 is distal with respect to the more proximal handle 6. It will be further appreciated that, for convenience and clarity, spatial terms such as “vertical” and “horizontal” are used herein with respect to the drawings. However, surgical instruments are used in many orientations and positions, and these terms are not intended to be limiting and absolute.

[0025] In operational use, the closure trigger 18 may be actuated first. Once the clinician is satisfied with the positioning of the end effector 12, the clinician may draw back the closure trigger 18 to its fully closed, locked position proximate to the pistol grip 26. The firing trigger 20 may then be actuated. The firing trigger 20 returns to the open position (shown in FIGS. 1 and 2) when the clinician removes pressure, as described more fully below. A release button on the handle 6, when depressed may release the locked closure trigger 18. The release button may be implemented in various forms such as, for example, as disclosed in U.S. Patent Application Publication No. 2007/0175955, entitled SURGICAL CUTTING AND FASTENING INSTRUMENT WITH CLOSURE TRIGGER LOCKING MECHANISM, which is incorporated herein by reference in its entirety.

[0026] FIG. 3 is an exploded view of the end effector 12 according to various embodiments. As shown in the illustrated embodiment, the end effector 12 may include, in addition to the previously mentioned channel 22 and anvil 24, a cutting instrument 32, a sled 33, a staple cartridge 34 that is removably seated in the channel 22, and a helical screw shaft 36. The cutting instrument 32 may be, for example, a knife. The anvil 24 may be pivotally opened and closed at a pivot point 25 connected to the proximate end of

the channel 22 between open and closed positions, respectively. The anvil 24 may also include a tab 27 at its proximate end that is inserted into a component of the mechanical closure system (described further below) to open and close the anvil 24. When the closure trigger 18 is actuated, that is, drawn in by a user of the instrument 10 toward the pistol grip portion 26, the anvil 24 may pivot about the pivot point 25 into the clamped or closed position. If clamping of the end effector 12 is satisfactory, the operator may actuate the firing trigger 20, which causes the knife 32 and sled 33 to travel longitudinally along the channel 22, thereby cutting tissue clamped within the end effector 12. The movement of the sled 33 along the channel 22 causes the staples of the staple cartridge 34 to be driven through the severed tissue and against the closed anvil 24, which turns the staples to fasten the severed tissue. In various embodiments, the sled 33 may be an integral component of the cartridge 34. U.S. Pat. No. 6,978,921, entitled SURGICAL STAPLING INSTRUMENT INCORPORATING AN E-BEAM FIRING MECHANISM, which is incorporated herein by reference in its entirety, provides more details about such two-stroke cutting and fastening instruments. In various embodiments, the sled 33 may be part of the cartridge 34, such that when the knife 32 retracts following the cutting operation, the sled 33 does not retract.

[0027] It should be noted that although the embodiments of the instrument 10 described herein employ an end effector 12 that staples the severed tissue, in other embodiments different techniques for fastening or sealing the severed tissue may be used. For example, end effectors that use RF energy or adhesives to fasten the severed tissue may also be used. U.S. Pat. No. 5,709,680 entitled ELECTROSURGICAL HEMOSTATIC DEVICE, and U.S. Pat. No. 5,688,270 entitled ELECTROSURGICAL HEMOSTATIC DEVICE WITH RECESSED AND/OR OFFSET ELECTRODES, which are incorporated herein by reference in their entirety, disclose an endoscopic cutting instrument that uses RF energy to seal the severed tissue. Published U.S. Patent Application Publication No. 2007/0102453, now U.S. Pat. No. 7,673,783 and published U.S. Patent Application Publication No. 2007/0102452, now U.S. Pat. No. 7,607,557, which are also incorporated herein by reference, disclose endoscopic cutting instruments that use adhesives to fasten the severed tissue. Accordingly, although the description herein refers to cutting/stapling operations and the like below, it should be recognized that this is an exemplary embodiment and is not meant to be limiting. Other tissue-fastening techniques may also be used.

[0028] FIGS. 4 and 5 are exploded views and FIG. 6 is a side view of the end effector 12 and shaft 8 according to various embodiments. As shown in the illustrated embodiment, the shaft 8 may include a proximate closure tube 40 and a distal closure tube 42 pivotably linked by a pivot links 44. The distal closure tube 42 includes an opening 45 into which the tab 27 on the anvil 24 is inserted in order to open and close the anvil 24, as further described below. Disposed inside the closure tubes 40, 42 may be a proximate spine tube 46. Disposed inside the proximate spine tube 46 may be a main rotational (or proximate) drive shaft 48 that communicates with a secondary (or distal) drive shaft 50 via a bevel gear assembly 52. The secondary drive shaft 50 is connected to a drive gear 54 that engages a proximate drive gear 56 of the helical screw shaft 36. The vertical bevel gear 52b may sit and pivot in an opening 57 in the distal end of

the proximate spine tube 46. A distal spine tube 58 may be used to enclose the secondary drive shaft 50 and the drive gears 54, 56. Collectively, the main drive shaft 48, the secondary drive shaft 50, and the articulation assembly (e.g., the bevel gear assembly 52a-c) are sometimes referred to herein as the “main drive shaft assembly.”

[0029] A bearing 38, positioned at a distal end of the staple channel 22, receives the helical drive screw 36, allowing the helical drive screw 36 to freely rotate with respect to the channel 22. The helical screw shaft 36 may interface a threaded opening (not shown) of the knife 32 such that rotation of the shaft 36 causes the knife 32 to translate distally or proximally (depending on the direction of the rotation) through the staple channel 22. Accordingly, when the main drive shaft 48 is caused to rotate by actuation of the firing trigger 20 (as explained in more detail below), the bevel gear assembly 52a-c causes the secondary drive shaft 50 to rotate, which in turn, because of the engagement of the drive gears 54, 56, causes the helical screw shaft 36 to rotate, which causes the knife driving member 32 to travel longitudinally along the channel 22 to cut any tissue clamped within the end effector. The sled 33 may be made of, for example, plastic, and may have a sloped distal surface. As the sled 33 traverses the channel 22, the sloped forward surface may push up or drive the staples in the staple cartridge through the clamped tissue and against the anvil 24. The anvil 24 turns the staples, thereby stapling the severed tissue. When the knife 32 is retracted, the knife 32 and sled 33 may become disengaged, thereby leaving the sled 33 at the distal end of the channel 22.

[0030] In addition, according to various embodiments, the instrument 10 may comprise a cutting instrument position sensor 150 that senses the position of the cutting instrument 32 within the staple channel 22. In one embodiment, the cutting instrument position sensor 150 may comprise an encoder positioned to sense rotation of the helical screw shaft 36, or any other drive shaft or gear whose rotation is related to the position of the knife 32 in the end effector 12. Because the rotation of the shaft 36 or other drive shafts/gears is proportional to the movement of the cutting instrument 32 along the length of the channel 22, the signal generated by the encoder 150 is also proportional to the movement of the cutting instrument 32 in the channel 22.

[0031] FIGS. 7-10 illustrate an exemplary embodiment of a motor-driven endocutter. The illustrated embodiment provides user-feedback regarding the deployment and loading force of the cutting instrument in the end effector. In addition, the embodiment may use power provided by the user in retracting the firing trigger 20 to power the device (a so-called “power assist” mode). As shown in the illustrated embodiment, the handle 6 includes exterior lower sidepieces 59, 60 and exterior upper side pieces 61, 62 that fit together to form, in general, the exterior of the handle 6. A battery (or “power source” or “power pack”) 64, such as a Li ion battery, may be provided in the pistol grip portion 26 of the handle 6. The battery 64 powers an electric motor 65 disposed in an upper portion of the pistol grip portion 26 of the handle 6. According to various embodiments, a number of battery cells connected in series may be used to power the motor 65. In addition, the power source 64 may be replaceable and/or rechargeable.

[0032] The motor 65 may be a DC brushed driving motor having a maximum rotation of, approximately, 25,000 RPM. In other embodiments, the motor 65 may include a brushless

motor, a cordless motor, a synchronous motor, a stepper motor, or any other suitable electric motor. The motor 64 may drive a 90° bevel gear assembly 66 comprising a first bevel gear 68 and a second bevel gear 70. The bevel gear assembly 66 may drive a planetary gear assembly 72. The planetary gear assembly 72 may include a pinion gear 74 connected to a drive shaft 76. The pinion gear 74 may drive a mating ring gear 78 that drives a helical gear drum 80 via a drive shaft 82. A ring 84 may be threaded on the helical gear drum 80. Thus, when the motor 65 rotates, the ring 84 is caused to travel along the helical gear drum 80 by means of the interposed bevel gear assembly 66, planetary gear assembly 72, and ring gear 78.

[0033] The handle 6 may also include a run motor sensor 110 in communication with the firing trigger 20 to detect when the firing trigger 20 has been drawn in (or “closed”) toward the pistol grip portion 26 of the handle 6 by the operator to thereby actuate the cutting/stapling operation by the end effector 12. The sensor 110 may be a proportional sensor such as, for example, a rheostat or variable resistor. When the firing trigger 20 is drawn in, the sensor 110 detects the movement, and complete the circuit used to power the motor 65. When the sensor 110 is a variable resistor or the like, the current supplied to the motor 65, and hence the output torque of the motor 65, may be generally proportional to the amount of movement of the firing trigger 20. That is, if the operator only draws or closes the firing trigger 20 in a little bit, the rotation of the motor 65 is relatively low. When the firing trigger 20 is fully drawn in (or in the fully closed position), the rotation of the motor 65 is at its maximum. In other words, the harder the user pulls on the firing trigger 20, the more voltage is applied to the motor 65, causing greater rates of rotation. In other embodiments, the sensor 110 may be an on-off type switch. In such an embodiment, when the firing trigger 20 is retracted, the sensor switch 110 is closed, thereby completing the circuit used to power the motor 65.

[0034] The handle 6 may include a middle handle piece 104 adjacent to the upper portion of the firing trigger 20. The handle 6 also may comprise a bias spring 112 connected between posts on the middle handle piece 104 and the firing trigger 20. The bias spring 112 may bias the firing trigger 20 to its fully open position. In that way, when the operator releases the firing trigger 20, the bias spring 112 will pull the firing trigger 20 to its open position, thereby removing actuation of the sensor 110, thereby stopping rotation of the motor 65. Moreover, by virtue of the bias spring 112, any time a user closes the firing trigger 20, the user will experience resistance to the closing operation, thereby providing the user with feedback as to the amount of rotation exerted by the motor 65. Further, the operator could stop retracting the firing trigger 20 to remove thereby force from the sensor 100, to stop thereby the motor 65. As such, the user may stop the deployment of the end effector 12, thereby providing a measure of control of the cutting/fastening operation to the operator.

[0035] The distal end of the helical gear drum 80 includes a distal drive shaft 120 that drives a ring gear 122, which mates with a pinion gear 124. The pinion gear 124 is connected to the main drive shaft 48 of the main drive shaft assembly. In that way, rotation of the motor 65 causes the main drive shaft assembly to rotate, which causes actuation of the end effector 12, as described above.

[0036] The ring 84 threaded on the helical gear drum 80 may include a post 86 that is disposed within a slot 88 of a slotted arm 90. The slotted arm 90 has an opening 92 its opposite end 94 that receives a pivot pin 96 that is connected between the handle exterior side pieces 59, 60. The pivot pin 96 is also disposed through an opening 100 in the firing trigger 20 and an opening 102 in the middle handle piece 104.

[0037] In addition, the handle 6 may include a reverse motor (or end-of-stroke sensor) 130 and a stop motor (or beginning-of-stroke) sensor 142. In various embodiments, the reverse motor sensor 130 may be a limit switch located at the distal end of the helical gear drum 80 such that the ring 84 threaded on the helical gear drum 80 contacts and trips the reverse motor sensor 130 when the ring 84 reaches the distal end of the helical gear drum 80. The reverse motor sensor 130 may be part of the circuit used to control the motor 65. When the reverse motor sensor is activated, the motor control circuit may reverse the direction of the motor 65, thereby withdrawing the knife 32 of the end effector 12 following the cutting operation. The stop motor sensor 142 may be, for example, a normally closed limit switch, and may also be part of the motor control circuit. In various embodiments, it may be located at the proximate end of the helical gear drum 80 so that the ring 84 trips the switch 142 when the ring 84 reaches the proximate end of the helical gear drum 80, indicating that the cutting instrument 32 has reached its proximate (or home or initial) position in the end effector 12.

[0038] In operation, when an operator of the instrument 10 pulls back the firing trigger 20, the sensor 110 detects the deployment of the firing trigger 20 and the motor control circuit causes the motor 65 to forward rotate at, for example, a rate proportional to how hard the operator pulls back the firing trigger 20. The forward rotation of the motor 65 in turn causes the ring gear 78 at the distal end of the planetary gear assembly 72 to rotate, thereby causing the helical gear drum 80 to rotate, causing the ring 84 threaded on the helical gear drum 80 to travel distally along the helical gear drum 80. The rotation of the helical gear drum 80 also drives the main drive shaft assembly as described above, which in turn causes deployment of the knife 32 in the end effector 12. That is, the knife 32 and sled 33 are caused to traverse the channel 22 longitudinally, thereby cutting tissue clamped in the end effector 12. Also, the stapling operation of the end effector 12 is caused to happen in embodiments where a stapling-type end effector is used.

[0039] By the time the cutting/stapling operation of the end effector 12 is complete, the ring 84 on the helical gear drum 80 will have reached the distal end of the helical gear drum 80, thereby causing the reverse motor sensor 130 to be tripped, which causes the motor control circuit to reverse the direction of the motor 65. This in turn causes the knife 32 to retract, and also causes the ring 84 on the helical gear drum 80 to move back to the proximate end of the helical gear drum 80.

[0040] The middle handle piece 104 includes a backside shoulder 106 that engages the slotted arm 90 as best shown in FIGS. 8 and 9. The middle handle piece 104 also has a forward motion stop 107 that engages the firing trigger 20. The movement of the slotted arm 90 is controlled, as explained above, by rotation of the motor 65. When the slotted arm 90 rotates CCW as the ring 84 travels from the proximate end of the helical gear drum 80 to the distal end,

the middle handle piece **104** will be free to rotate CCW. Thus, as the user draws in the firing trigger **20**, the firing trigger **20** will engage the forward motion stop **107** of the middle handle piece **104**, causing the middle handle piece **104** to rotate CCW. Due to the backside shoulder **106** engaging the slotted arm **90**, however, the middle handle piece **104** will only be able to rotate CCW as far as the slotted arm **90** permits. In that way, if the motor **65** should stop rotating for some reason, the slotted arm **90** will stop rotating, and the user will not be able to further draw in the firing trigger **20** because the middle handle piece **104** will not be free to rotate CCW due to the slotted arm **90**.

[0041] Components of an exemplary closure system for closing (or clamping) the anvil **24** of the end effector **12** by retracting the closure trigger **18** are also shown in FIGS. 7-10. In the illustrated embodiment, the closure system includes a yoke **250** connected to the closure trigger **18** by a pin **251** that is inserted through aligned openings in both the closure trigger **18** and the yoke **250**. A pivot pin **252**, about which the closure trigger **18** pivots, is inserted through another opening in the closure trigger **18** which is offset from where the pin **251** is inserted through the closure trigger **18**. Thus, retraction of the closure trigger **18** causes the upper part of the closure trigger **18**, to which the yoke **250** is attached via the pin **251**, to rotate CCW. The distal end of the yoke **250** is connected, via a pin **254**, to a first closure bracket **256**. The first closure bracket **256** connects to a second closure bracket **258**. Collectively, the closure brackets **256**, **258** define an opening in which the proximate end of the proximate closure tube **40** (see FIG. 4) is seated and held such that longitudinal movement of the closure brackets **256**, **258** causes longitudinal motion by the proximate closure tube **40**. The instrument **10** also includes a closure rod **260** disposed inside the proximate closure tube **40**. The closure rod **260** may include a window **261** into which a post **263** on one of the handle exterior pieces, such as exterior lower sidepiece **59** in the illustrated embodiment, is disposed to fixedly connect the closure rod **260** to the handle **6**. In that way, the proximate closure tube **40** is capable of moving longitudinally relative to the closure rod **260**. The closure rod **260** may also include a distal collar **267** that fits into a cavity **269** in proximate spine tube **46** and is retained therein by a cap **271** (see FIG. 4).

[0042] In operation, when the yoke **250** rotates due to retraction of the closure trigger **18**, the closure brackets **256**, **258** cause the proximate closure tube **40** to move distally (i.e., away from the handle end of the instrument **10**), which causes the distal closure tube **42** to move distally, which causes the anvil **24** to rotate about the pivot point **25** into the clamped or closed position. When the closure trigger **18** is unlocked from the locked position, the proximate closure tube **40** is caused to slide proximally, which causes the distal closure tube **42** to slide proximally, which, by virtue of the tab **27** being inserted in the window **45** of the distal closure tube **42**, causes the anvil **24** to pivot about the pivot point **25** into the open or unclamped position. In that way, by retracting and locking the closure trigger **18**, an operator may clamp tissue between the anvil **24** and channel **22**, and may unclamp the tissue following the cutting/stapling operation by unlocking the closure trigger **20** from the locked position.

[0043] Additional configurations for motorized surgical instruments are disclosed in published U.S. Patent Application Publication No. 2007/0175962, entitled MOTOR-

DRIVEN SURGICAL CUTTING AND FASTENING INSTRUMENT WITH TACTILE POSITION FEEDBACK, now U.S. Pat. No. 7,422,139, which is incorporated herein by reference in its entirety.

[0044] FIG. 11 is a schematic diagram of the motor control circuit according to various embodiments of the present invention. In various embodiments, the motor control circuit may include one or more integrated circuits (ICs), such as, for example, a processor, memory, microcontroller, time circuits, etc. In other embodiments, the motor control circuit may not comprise any ICs. Such a non-IC motor control circuit may be advantageous because it is often difficult, complicated, and expensive to sterilize a surgical instrument including ICs.

[0045] When an operator initially pulls in the firing trigger **20** after locking the closure trigger **18**, the sensor **110** is activated (or closed, where the sensor **110** is a switch), allowing current to flow therethrough. If the normally open reverse motor sensor switch **130** is open (meaning the end of the end effector stroke has not been reached), current will flow to a single pole, double throw relay **132**. When the reverse motor sensor switch **130** is not closed, a coil **134** of the relay **132** will not be energized, so the relay **132** will be in its de-energized state.

[0046] As shown in FIG. 11, the circuit may also include a resistive element **144** and a switch **146** connected in parallel, with the paralleled elements connected in series with the relay **132**. The resistive element **144** and the switch **146** are also connected to the power source **64**. The switch **146** may be controlled by a control circuit **148** that is responsive to the cutting instrument position sensor **150**. According to various embodiments, the control circuit **148** may open the switch **146** when the cutting instrument **32** is (i) very near to the beginning of its stroke and (ii) very near to the end of its stroke. For example, the control circuit may open the switch when the cutting instrument **32** is (i) 0.001 inches from the beginning point of its stroke and (ii) 0.001 inches from the end of its stroke, as determined by the cutting instrument position sensor **150**. With the switch **146** open, current flows through the resistive element **144**, and then through the relay **132**, the relay **138**, the run motor sensor switch **110**, to the motor **65**. Current flowing through the resistive element **144** reduces the magnitude of the current delivered to the motor **65**, thereby reducing the power delivered by the motor **65**. Thus, when the cutting instrument **32** is (i) very near to the beginning of its stroke or (ii) very near to the end of its stroke, the power delivered by the motor **65** is reduced. Conversely, once the cutting instrument **32** moves sufficiently far from its beginning point or end of stroke point, the control circuit **148** may close the switch **146**, thereby shorting the resistive element **144**, thereby increasing the current to the motor **65**, thereby increasing the power delivered by the motor.

[0047] According to various embodiments, the electrical circuit further includes lockout sensor switches **136a-d** collectively defining an interlock circuit **137** through which current from the relay **132**, when de-energized, passes in order for electrical operation of the motor **65** to be initiated. Each lockout sensor switch **136a-d** may be configured to maintain an open (i.e., non-conductive) switch state or a closed (i.e., conductive) switch state responsive to the presence or absence, respectively, of a corresponding condition. Any of the corresponding conditions, if present when the instrument **10** is fired, may result in an unsatisfactory cutting

and stapling operation and/or damage to the instrument 10. Conditions to which the lockout sensor switches 136a-d may respond include, for example, (a) the absence of the staple cartridge 34 in the channel 22, (b) the presence of a spent (e.g., previously fired) staple cartridge 34 in the channel 22, and (c) an open (or otherwise insufficiently closed) position of the anvil 24 with respect to the channel 22. Other conditions to which the lockout sensor switches 136a-d may respond, such as component wear, may be inferred based upon an accumulated number of firing operations produced by the instrument 10. Accordingly, in various embodiments, if any of these conditions exists, the corresponding lockout sensor switches 136a-d maintain an open switch state, thus preventing passage of the current necessary to initiate operation of the motor 65. Passage of current by the lockout sensors 136a-d is allowed, in various embodiments, only after all of the conditions have been remedied. It will be appreciated that the above-described conditions are provided by way of example only, and that additional lockout sensor switches for responding to other conditions detrimental to operation of the instrument 10 may be provided. It will similarly be appreciated that for embodiments in which one or more of the above-described conditions may not exist or are of no concern, the number of lockout sensor switches may be fewer than that depicted.

[0048] As shown in FIG. 11, the lockout sensor switch 136a may be implemented using a normally open switch configuration such that a closed switch state is maintained when the staple cartridge 34 is in a position corresponding to its proper receipt by the channel 22. When the staple cartridge 34 is not installed in the channel 22, or is installed improperly (e.g., mis-aligned), the lockout sensor switch 136a maintains an open switch state. Lockout sensor switch 136b may be implemented using a normally open switch configuration such that a closed switch state is maintained only when an unspent staple cartridge 34 (i.e., a staple cartridge 34 having a sled 33 in the unfired position) is present in the channel 22. The presence of a spent staple cartridge 34 in the channel 22 causes the lockout sensor switch 136b to maintain an open switch state. Lockout sensor switch 136c may be implemented using a normally open switch configuration such that a closed switch state is maintained when the anvil 24 is in a closed position with respect to the channel 22. The lockout sensor switch 136c may be controlled in accordance with a time delay feature wherein a closed switch state is maintained only after the anvil 24 is in the closed position for a pre-determined period of time.

[0049] Lockout sensor switch 136d may be implemented using a normally closed switch configuration such that a closed switch state is maintained only when an accumulated number of firings produced by the instrument 10 is less than a pre-determined number. The lockout sensor switch 136d may be in communication with a counter 139 configured for maintaining a count representative of the accumulated number of firing operations performed by the instrument 10, comparing the count to the pre-determined number, and controlling the switch state of the lockout sensor switch 136d based upon the comparison. Although shown separately in FIG. 11, it will be appreciated that counter 139 may be integral with the lockout sensor switch 136d so as to form a common device. Preferably, the counter 139 is implemented as an electronic device having an input for incrementing the maintained count based upon the transition of a

discrete electrical signal provided thereto. It will be appreciated that a mechanical counter configured for maintaining the count based upon a mechanical input (e.g., retraction of the firing trigger 20) may be used instead. When implemented as an electronic device, any discrete signal present in the electrical circuit that transitions once for each firing operation may be utilized for the counter 139 input. As shown in FIG. 11, for example, the discrete electrical signal resulting from actuation of the end-of-stroke sensor 130 may be utilized. The counter 139 may control the switch state of lockout sensor switch 136d such that a closed switch state is maintained when the maintained count is less than a pre-determined number stored within the counter 139. When the maintained count is equal to the pre-determined number, the counter 139 causes the lockout sensor switch 136d to maintain an open switch state, thus preventing the passage of current therethrough. It will be appreciated that the pre-determined number stored by the counter 139 may be selectively adjusted as required. According to various embodiments, the counter 304 may be in communication with an external display (not shown), such as an LCD display, integral to the instrument 10 for indicating to a user either the maintained count or the difference between the pre-determined number and the maintained count.

[0050] According to various embodiments, the interlock circuit 137 may comprise one or more indicators visible to the user of the instrument 10 for displaying a status of at least one of the lockout sensor switches 136a-d. More details regarding such indicators may be found in published U.S. Patent Application Publication No. 2007/0175956, entitled ELECTRONIC LOCKOUTS AND SURGICAL INSTRUMENT INCLUDING SAME, now U.S. Pat. No. 7,644,848, which is incorporated herein by reference in its entirety. This application also includes example mounting arrangements and configurations for the lockout sensor switches 136a-d.

[0051] In the illustrated embodiment, when the lockout sensor switches 136a-d collectively maintain a closed switch state, a single pole, single throw relay 138 is energized. When the relay 138 is energized, current flows through the relay 138, through the run motor switch sensor 110, and to the motor 65 via a double pole, double throw relay 140, thereby powering the motor 65, allowing it to rotate in the forward direction. According to various embodiments, because the output of the relay 138, once energized, maintains the relay 138 in an energized state until relay 132 is energized, the interlock circuit 137 will not function to prevent operation of the motor 165 once initiated, even if one or more of the interlock sensor switches 136a-d subsequently maintains an open switch state. In other embodiments, however, it may be necessary or otherwise desirable to connect the interlock circuit 137 and the relay 138 such that one or more the lockout sensor switches 136a-d must maintain a closed switch state in order to sustain operation of the motor 165 once initiated.

[0052] Rotation of the motor in the forward direction causes the ring 84 to move distally and thereby de-actuate the stop motor sensor switch 142 in various embodiments. Because the switch 142 is normally closed, a solenoid 141 connected to the switch 142 may be energized. The solenoid 141 may be a conventional push-type solenoid that, when energized, causes a plunger (not shown) to be axially extended. Extension of the plunger may operate to retain the closure trigger 18 in the retracted position, thus preventing the anvil 24 from opening while a firing operation is in

progress (i.e., while the switch 142 is not actuated). Upon de-energization of the solenoid 141, the plunger is retracted such that manual release of the closure trigger 18 is possible.

[0053] When the end effector 12 reaches the end of its stroke, the reverse motor sensor 130 will be activated, thereby closing the switch 130 and energizing the relay 132. This causes the relay 132 to assume its energized state (not shown in FIG. 11), which causes current to bypass the interlock circuit 137 and run motor sensor switch 110, and instead causes current to flow to both the normally-closed double pole, double throw relay 140 and back to the motor 65, but in a manner, via the relay 140, that causes the motor 65 to reverse its rotational direction. Because the stop motor sensor switch 142 is normally closed, current will flow back to the relay 132 to keep it energized until the switch 142 opens. When the knife 32 is fully retracted, the stop motor sensor switch 142 is activated, causing the switch 142 to open, thereby removing power from the motor 65, and de-energizing the solenoid 141.

[0054] FIG. 12 illustrates a timeline of the operation of the circuit according to various embodiments. Assuming the lockout switches 136a-d are in their appropriate state, at time T0 the operator retracts the firing trigger 20, closing the run motor sensor switch 110, causing the motor 65 to forward rotate. At this time, the switch 146 is open, so current flows through the resistive element 144, reducing the current to the motor 65 from time T0 to time T1. At time T1, which the cutting instrument is sufficiently far from its initial position, the switch 146 is closed, thereby shorting the resistive element 144 and supplying increased power to the motor 65. From time T1 to time T2, the motor is in its full power mode with the switch 146 closed. At time T2, as the cutting instrument 32 gets near to the end of its stroke, the switch 146 is opened, thereby reducing the current supplied to the motor 65. Thus, from T2 to T3 the motor 65 is at less than full power.

[0055] At time T3, the end-of-stroke sensor switch 130 is closed, causing the motor 65 to reverse rotate. The motor 65 is still in its reduced power state because switch 146 is opened, and the motor 65 remains in its reduced power state until time T4, when the switch 146 is closed because the cutting instrument 32 has moved sufficiently far from its end-of-stroke position. From time T4 to T5 the motor 65 operates at full power retracting the cutting instrument 32. At time T5, as the cutting instrument 32 gets near to its initial (or stop) position, the switch 146 again opens, thereby limiting current to the power 65, thereby reducing the power delivered by the motor 65. At time T6, the stop motor sensor switch 142 is opened, thereby removing current from the motor, causing it to stop rotating.

[0056] In such a switching architecture, the motor-driven instrument 10 exhibits a "soft" start quality by limiting the motor's ability to exert full load immediately. The motor 65 is initially in a reduced power mode (from time T0 to time T1), so as to limit the sudden jerking start. In addition, by starting the soft start mode, the likelihood of the motor overpowering the cartridge lockout mechanism is reduced. In addition, reducing the power prior to the knife reaching its end-of-stroke (or distal) position eases reversal of the motor direction.

[0057] In other embodiments, the parallel-connected switch 146 and resistive element 144 are connected in different places, but preferably they are always in the current loop regardless of whether the motor 65 is being forward

rotated or reverse rotated. In addition, the resistive element 144 may be any type of circuit element or electrical component that provides sufficient resistance. For example, the resistive element 144 could be one or a number of parallel-connected resistors.

[0058] In addition, the resistive element 144 may comprise a variable resistor, as shown in FIG. 13. In such an embodiment, the switch 146 may or may not be used. FIG. 13 shows an embodiment without the switch 146. The control circuit 148 may vary the resistance of the variable resistive element 144 based on the position of the cutting instrument 32, for example. That way, instead of having two power levels for the motor 65, there could be a number of discrete power levels or a continuous range of power levels for the motor 65, depending on the nature of the variable resistive element 144. In various embodiments, the variable resistive element may comprise a string potentiometer or cable position transducer, where, for example, the resistance is related to the position of the knife 32 in the end effector 12. In addition, an active element, such as a transistor, could be used to provide a variable resistance. For example, FIG. 14 illustrates a circuit where a FET 147 is used as a variable resistor to limit the current to the motor 65 in various operational states.

[0059] In yet other embodiments, an integrated switch mode controller, such as the UC2637 from Texas Instrument or some other suitable motor drive circuit, could be used to limit the torque and/or speed of the motor 65 at various times during the cutting stroke cycle, such as a "soft" start, within the lockout region, prior to stopping or reversing direction, etc. According to yet other embodiments, as shown in FIG. 15, a pulse width modulation circuit 148 may be used to control the speed of the motor 65 by driving the motor with short pulses. The duration of the pulses may be varied to control the speed of the motor 65; the longer the pulses, the faster the motor turns, and vice versa. Accordingly, short duration pulses may be used when the cutting instrument 32 is initially leaving or returning to its initial position, or approaching or leaving its end-of-stroke position, etc. In addition, in yet other embodiments, a frequency modulation circuit 149, as shown in FIG. 16, may be used to control the speed of the motor 65. In a frequency modulation circuit, the duty cycle of the pulse remains constant, but the frequency of the pulses changes to vary the speed of the motor. Accordingly, low frequency pulses may be used when the cutting instrument 32 is initially leaving or returning to its initial position, or approaching or leaving its end-of-stroke position, etc., and high frequency pulses may be used when greater motor speed is required.

[0060] In yet other embodiments, an amplifier circuit 151 may be used to control the speed of the motor 65, as shown in FIG. 17. The amplifier circuit 151 may amplify, for example, the current or voltage applied to the motor 65. According to various embodiments, the amplifier circuit 151 may comprise a Darlington transistor pair or some other suitable transistor-based amplifier circuit.

[0061] In other embodiments, rather than an on-off type run motor sensor switch 110, a proportional-type variable resistor sensor could be used instead. In such embodiments, the rate of rotation of the motor 65 would be proportional to the force applied by the operator. The run-motor sensor 110 may provide an open circuit resistance when the firing trigger 20 is not retracted/actuated, and then provide a decreasing resistance as the firing trigger is retracted.

Whether the switch **110** comprises an on-off type switch or a variable resistor, if the operator releases the firing trigger **20** during a procedure while the motor is in the forward direction, power to the motor **65** will be eliminated or at least reduced, thereby providing a dynamic braking feature for the instrument **10**.

[0062] In other embodiments, as shown in FIG. **18**, the switches **140a** and **140b** may be actively controlled, rather than through the relay **140** shown in FIG. **11**, for example. In such embodiments, just before the end of the stroke is sensed, one of the switches **140a**, **140b** may switch polarity so that both switches **140a**, **140b** are connected to the same polarity terminal for the motor **65** (e.g., either both positive or both negative). This will remove power from the motor **65**, causing it to stop. FIG. **18** shows an embodiment where the switches **140a** and **140b** are both connected to the positive terminal. Then, at about the same time the end-of-stroke is sensed or soon thereafter, the other switch **140a**, **140b** may switch polarity, allowing the motor **65** to rotate in the reverse direction. In the example of FIG. **18**, this may be done by switching switch **140a** to the negative terminal. Of course, in other embodiments, the switch **140a** could be first switched to the negative terminal and then the switch **140b** could be switched to the positive terminal. Also, other switching arrangements could be used to temporarily remove power from the motor **65** prior to it switching direction to provide such “active braking.” For example, the switches **140a**, **140b** may still be controlled by an inductive relay, and the circuit may include another switching circuit for actively braking the motor **65**.

[0063] The active braking could be combined with variable power levels supplied to the motor **65** as described above in connection with FIGS. **11** and **12**, for example. FIG. **19** shows a timing diagram that incorporates active braking. At time T2.1, between times T2 and T3, the power may be removed from the motor **65** by switching one of the switches **140a**, **140b**, for example, thereby braking the motor. Then at time T3, the end-of-stroke switch **130** may be closed and the other switch **140a**, **140b** may be switched to supply power to the motor **65**, but in the reverse direction, as described above.

[0064] The control circuit **135** or some other control circuit may control the switching of the switches **140a**, **140b**. According to various embodiments, the control circuit **135** may comprise a processor and memory. For example, the control circuit **135** may comprise an IC-based micro-controller. The memory may store data indicative of the type of cartridge **34** loaded in the end effector **12**. For example, the memory may store data indicative of the length of the cut needed for the cartridge **34**. Based on this data, the control circuit **135** can control when the switches **146**, **140a**, and **140b** switch. As the cartridges **34** are often replaceable in certain types of instruments **10**, the identifying data may be transmitted to the control circuit **135** by a RFID tag or transponder connected to or associated with the cartridge **34** or by some other means. The RFID signal from the tag may be received by the control circuit **135** and stored in memory. In other embodiments, a transponder associated with the cartridge **34** may send identifying data to the control circuit **135** via one or more inductive links, such as described in published U.S. Patent Application Publication No. 2008/0167522, entitled SURGICAL INSTRUMENT WITH WIRELESS COMMUNICATION BETWEEN CONTROL

UNIT AND SENSOR TRANSPONDERS, now U.S. Pat. No. 8,652,120, which is incorporated herein by reference in its entirety.

[0065] According to other embodiments, the control circuit **135** may not contain any integrated circuits. For example, the control circuit **135** may comprise analog timer circuits (e.g., RC-based timer circuits) for controlling the switch timing of the switches **146**, **140a-b**. According to such an embodiment, the control circuit **135** may receive information about the length of the cut for the particular cartridge **34** being used based on the completion of an electrical circuit when the cartridge **34** is inserted into the channel **22**. For example, as shown in FIG. **20**, the channel **22** may comprise a number of contact pads **220** positioned to face the lower surface of the cartridge **34** when the cartridge **34** is loaded in the channel **22**. The lower surface of the cartridge **34** also may comprise a number of contacts **222**, as shown in FIG. **21**. The number and positioning of the contacts **222** on the cartridge **34** may identify the type of cartridge. For example, the number and positioning of the contacts **222** may identify the cut length for the cartridge **34**. All cartridges of the same cut length would preferably have the same contact pattern; cartridges with different cut lengths would have different contact patterns. The circuit completed when the contacts **222** of the cartridge **34** contact the contacts **220** of the channel **22** may have a number of different resistors, a subset of which are connected in the completed circuit when the contacts **222** of the cartridge **34** contact the contacts **220** of the channel **22**. Depending on the contact pattern on the cartridge **34**, different resistors may be in the completed circuit. The resistors may be connected to the control circuit **135**, and may be used in the RC circuits to generate the timing signals for the switches **146**, **140a**, **140b**. That way, the control circuit **135** can control the switches **146**, **140a-b** based on the type of cartridge **34** loaded in the end effector **12**.

[0066] In another embodiment, the lower surface of the cartridge **34** may comprise a plunger **230**, as shown in FIG. **22**. The channel **22** may comprise a number of switches **232**, as shown in FIG. **23**, one of which is actuated by the plunger **230** when the cartridge **34** is loaded in the end effector **12**. The switch **232** may have a different associated resistor circuit. Each of the resistor circuits may be connected to the control circuit **135**, but only one would be activated when the cartridge **34** is loaded in the channel **22**, depending on the location of the plunger **230**. Each replaceable cartridge **34** having the same cut length preferably would have the plunger **230** in the same position. Cartridges **34** with different lengths would preferably have plungers **230** in different positions. Because the end effector **12** may only accommodate a finite number of different cartridges (e.g., 5), the channel **22** would only need a corresponding number of switches **232** and there would only be a corresponding number of acceptable plunger locations.

[0067] In other embodiments, the instrument **10** may comprise an external selector **240**, such as dip switch or other suitable input device, whereby an operator of the instrument or other person could input identifying data for the cartridge **34** being used. As shown in FIG. **24**, the handle may comprise such a selector **240** for embodiments where the control circuit **135** comprises an IC or embodiments where the control circuit **135** does not comprise any ICs.

[0068] FIG. **25** shows another embodiment of the motor circuit. When the run motor (or fire) switch **110** is closed (it

is shown in an open state in FIG. 25), when the safety switch 240 is closed (it is shown open in FIG. 25) indicating that the device safety is set, and when the normally-closed lockout switch 242 it opened indicating that the instrument is not in a lock-out condition, current flows through the safety switch 240, through the lockout indicator 244 (which may be a LED as shown in FIG. 25) to the motor 65. When the end of the cutting stroke is reached, the end-of-stroke or direction switch 130 is switched, reversing the direction of the motor 65 (with the fire switch 110 also having been released). In this state, current also flows through a reverse direction indicator 246, such as an LED, providing a visual indication that the motor direction has been reversed.

[0069] As shown in FIG. 25, the circuit may also comprise a manual return switch 248. The operator may manually flip this switch if the cutting instrument 32 has only been partially fired. Switching the manual return switch 248 causes the motor 65 to reverse rotate, causing the cutting instrument 32 to return to its original or home position.

[0070] The battery 64 of the instrument 10 may comprise one or more series-connected battery cells. In various embodiments, a cell selection switch may control how many of the battery cells are being used to power the motor 65 at a given time to control the power available to the motor 65. This would allow the operator of the instrument to have greater control over both the speed and the power of the motor 65. In another embodiment, the instrument may comprise a power regulator, including, for example, a DC-to-DC converter, that regulates the voltage supplied to the motor. Further, the voltage set point for the power regulator could be set so that the voltage delivered from the power source is less than the voltage at which the power source delivers maximum power. That way, the power source (e.g., a number of series-connected battery cells) could operate on the “left” or increasing side of the power curve, so that increases in power would be available.

[0071] In addition, according to various embodiments, the power source 64 may comprise secondary accumulator devices, such as rechargeable batteries or supercapacitors. Such secondary accumulator devices may be charged repeatedly by replaceable batteries. A charge management circuit may control the charging of the secondary accumulator devices and provide various status signals, such as an alert, when the charging of the secondary accumulator devices is complete.

[0072] In other embodiments, the power source or power pack comprising the secondary accumulator devices may be removable from the instrument and connectable to a remote charger base. The charger base may charge the secondary accumulator devices, such as from the AC electrical mains or a battery. The charger base may also comprise a processor and memory unit. Data stored in a memory of the removable power pack may be downloaded to the charger base, from which it may be uploaded for later use and analysis, such as by the user (e.g., physician), the manufacturer, or distributor of the instrument, etc. The data may comprise operating parameters, such as charge cycle information, as well as ID values for various replaceable components of the instrument, such as the staple cartridge.

[0073] More details regarding such power sources may be found in commonly assigned U.S. patent application Ser. No. 12/031,556, entitled MOTORIZED SURGICAL CUTTING AND FASTENING INSTRUMENT, now U.S. Pat. No. 8,636,736, and Ser. No. 12/031,567, entitled MOTOR-

IZED SURGICAL CUTTING AND FASTENING INSTRUMENT HAVING HANDLE BASED POWER SOURCE, now U.S. Pat. No. 8,657,174, both of which were filed on Feb. 14, 2008, and both of which are incorporated herein by reference in their entirety.

[0074] The devices disclosed herein can be designed to be disposed of after a single use, or they can be designed to be used multiple times. In either case, however, the device can be reconditioned for reuse after at least one use. Reconditioning can include any combination of the steps of disassembly of the device, followed by cleaning or replacement of particular pieces, and subsequent reassembly. In particular, the device can be disassembled, and any number of the particular pieces or parts of the device can be selectively replaced or removed in any combination. Upon cleaning and/or replacement of particular parts, the device can be reassembled for subsequent use either at a reconditioning facility, or by a surgical team immediately prior to a surgical procedure. Those skilled in the art will appreciate that reconditioning of a device can utilize a variety of techniques for disassembly, cleaning/replacement, and reassembly. Use of such techniques, and the resulting reconditioned device, are all within the scope of the present application.

[0075] Preferably, the various embodiments of the invention described herein will be processed before surgery. First, a new or used instrument is obtained and if necessary cleaned. The instrument can then be sterilized. In one sterilization technique, the instrument is placed in a closed and sealed container, such as a thermoformed plastic shell covered with a sheet of TYVEK. The container and instrument are then placed in a field of radiation that can penetrate the container, such as gamma radiation, x-rays, or high-energy electrons. The radiation kills bacteria on the instrument and in the container. The sterilized instrument can then be stored in the sterile container. The sealed container keeps the instrument sterile until it is opened in the medical facility.

[0076] It is preferred that the device is sterilized. This can be done by any number of ways known to those skilled in the art including beta or gamma radiation, ethylene oxide, steam and other methods.

[0077] While the present invention has been illustrated by description of several embodiments and while the illustrative embodiments have been described in considerable detail, it is not the intention of the applicant to restrict or in any way limit the scope of the appended claims to such detail. Additional advantages and modifications may readily appear to those skilled in the art. The various embodiments of the present invention represent vast improvements over prior staple methods that require the use of different sizes of staples in a single cartridge to achieve staples that have differing formed (final) heights.

[0078] Accordingly, the present invention has been discussed in terms of endoscopic procedures and apparatus. However, use herein of terms such as “endoscopic” should not be construed to limit the present invention to a surgical stapling and severing instrument for use only in conjunction with an endoscopic tube (i.e., trocar). On the contrary, it is believed that the present invention may find use in any procedure where access is limited, including but not limited to laparoscopic procedures, as well as open procedures. Moreover, the unique and novel aspects of the various staple cartridge embodiments of the present invention may find

utility when used in connection with other forms of stapling apparatuses without departing from the spirit and scope of the present invention.

1-20. (canceled)

21. A surgical stapler, comprising:

- a handle;
- a shaft extending from said handle;
- a surgical end effector extending from said shaft, wherein said surgical end effector comprises a replaceable staple cartridge;
- a firing member configured to move through a plurality of positions during a firing stroke;
- an electric motor configured to drive said firing member during the firing stroke;
- a control system for controlling said electric motor, said control system comprising:
 - a battery configured to supply pulses to said electric motor;
 - a pulse width modulation circuit configured to control the duration of pulses supplied from said battery to said electric motor and optimize the speed applied to said firing member from said electric motor;

wherein said firing member is configured to move at least partially through said surgical end effector during the firing stroke at a firing speed, wherein said pulse width modulation circuit is configured to reduce the speed of said firing member to below the firing speed at various times during the firing stroke, and wherein said surgical end effector further comprises:

- a proximal end; and
- a distal end, wherein said pulse width modulation circuit is configured to modulate the speed of said firing member below the firing speed as said firing member approaches said distal end.

22. The surgical stapler of claim **21**, further comprising a firing member position sensor configured to detect a plurality of positions of said firing member, wherein said pulse width modulation circuit is configured to control said electric motor based on the detected positions of said firing member.

23. The surgical stapler of claim **21**, wherein said firing member further comprises a cutting element configured to translate in said surgical end effector.

24. The surgical stapler of claim **21**, wherein said pulse width modulation circuit is configured to modulate the speed of said firing member to below the firing speed as said firing member travels within a lockout region.

25. The surgical stapler of claim **21**, wherein said pulse width modulation circuit is configured to modulate the speed of said firing member to below the firing speed during an initial range of positions.

26. A surgical instrument, comprising:

- a handle;
- a shaft extending from said handle;
- a surgical end effector extending from said shaft;
- a firing member configured to move between a proximal position and a distal position during a firing stroke, wherein said firing member is configured to move at a firing speed during a portion of the firing stroke;
- a battery-powered motor configured to drive said firing member during the firing stroke; and
- a control system comprising a pulse width modulation circuit configured to control the duration of pulses supplied to said battery-powered motor, wherein said

pulse width modulation circuit is configured to modulate the speed of said firing member to below the firing speed at various times during the firing stroke including when said firing member approaches the distal position.

27. The surgical instrument of claim **26**, further comprising a firing member position sensor configured to detect a plurality of positions of said firing member, wherein said pulse width modulation circuit is configured to control the duration of pulses based on the detected positions of said firing member.

28. The surgical instrument of claim **26**, wherein said firing member further comprises a cutting element configured to translate in said surgical end effector.

29. The surgical instrument of claim **26**, wherein said surgical end effector comprises a staple.

30. The surgical instrument of claim **26**, further comprising a replaceable staple cartridge positioned in said surgical end effector.

31. The surgical instrument of claim **26**, wherein said pulse width modulation circuit is configured to modulate the speed of said firing member to below the firing speed as said firing member travels within a lockout region.

32. The surgical instrument of claim **26**, wherein said pulse width modulation circuit is configured to modulate the speed of said firing member to below the firing speed during an initial range of positions.

33. A surgical instrument, comprising:

- a handle;
- a shaft extending from said handle;
- a surgical end effector extending from said shaft;
- a firing member configured to move between a proximal position and a distal position during a firing stroke;
- a battery-powered motor configured to drive said firing member during the firing stroke; and
- a control system comprising a pulse width modulation circuit configured to control the duration of pulses supplied to said battery-powered motor, wherein said firing member is configured to move at a speed when pulses of a first duration are supplied to said battery-powered motor, wherein said pulse width modulation circuit is configured to reduce the duration of pulses to less than the first duration at various times during the firing stroke including as said firing member approaches the distal position.

34. The surgical instrument of claim **33**, further comprising a firing member position sensor configured to detect a plurality of positions of said firing member, wherein said pulse width modulation circuit is configured to control the duration of pulses based on the detected positions of said firing member.

35. The surgical instrument of claim **33**, wherein said firing member further comprises a cutting element configured to translate in said surgical end effector.

36. The surgical instrument of claim **33**, wherein said surgical end effector comprises a staple.

37. The surgical instrument of claim **33**, further comprising a replaceable staple cartridge positioned in said surgical end effector.

38. The surgical instrument of claim **33**, wherein the duration of pulses is reduced to less than the first duration as said firing member travels within a lockout region.

39. The surgical instrument of claim 33, wherein the duration of pulses is reduced to less than the first duration during an initial range of positions.

* * * * *