

(19) World Intellectual Property Organization  
International Bureau



(43) International Publication Date  
31 May 2001 (31.05.2001)

PCT

(10) International Publication Number  
**WO 01/37898 A3**

- (51) International Patent Classification<sup>7</sup>: **A61M 5/32** (74) Agent: **ELAND, Stephen, H.**: Dann Dorfman Herrell And Skillman, Suite 720, 1601 Market Street, Philadelphia, PA 19103 (US).
- (21) International Application Number: PCT/US00/42328
- (22) International Filing Date:  
29 November 2000 (29.11.2000)
- (25) Filing Language: English
- (26) Publication Language: English
- (30) Priority Data:  
60/168,146 29 November 1999 (29.11.1999) US
- (71) Applicants (for all designated States except US): **MDC INVESTMENT HOLDINGS, INC.** [US/US]; Delaware Trust Building, Suite 200, 900 Market Street, Wilmington, DE 19801 (US). **BARKER, John** [US/US]; 2333 Aztec Avenue, Venutra, CA 93001 (US).
- (81) Designated States (*national*): AE, AG, AL, AM, AT, AU, AZ, BA, BB, BG, BR, BY, BZ, CA, CH, CN, CR, CU, CZ, DE, DK, DM, DZ, EE, ES, FI, GB, GD, GE, GH, GM, HR, HU, ID, IL, IN, IS, JP, KE, KG, KP, KR, KZ, LC, LK, LR, LS, LT, LU, LV, MA, MD, MG, MK, MN, MW, MX, MZ, NO, NZ, PL, PT, RO, RU, SD, SE, SG, SI, SK, SL, TJ, TM, TR, TT, TZ, UA, UG, US, UZ, VN, YU, ZA, ZW.
- (84) Designated States (*regional*): ARIPO patent (GH, GM, KE, LS, MW, MZ, SD, SL, SZ, TZ, UG, ZW), Eurasian patent (AM, AZ, BY, KG, KZ, MD, RU, TJ, TM), European patent (AT, BE, CH, CY, DE, DK, ES, FI, FR, GB, GR, IE, IT, LU, MC, NL, PT, SE, TR), OAPI patent (BF, BJ, CF, CG, CI, CM, GA, GN, GW, ML, MR, NE, SN, TD, TG).
- (72) Inventors; and
- (75) Inventors/Applicants (for US only): **BOTICH, Michael, J.** [US/US]; 2330 Eagle Creek Lane, Oxnard, CA 93030 (US). **HALSETH, Thor** [US/US]; 367 Buckboard Circle, Simi Valley, CA 93065 (US).
- Published:  
— with international search report
- (88) Date of publication of the international search report:  
10 January 2002

[Continued on next page]

(54) Title: COMBINATION SAFETY NEEDLE ASSEMBLY AND MEDICAL APPARATUS

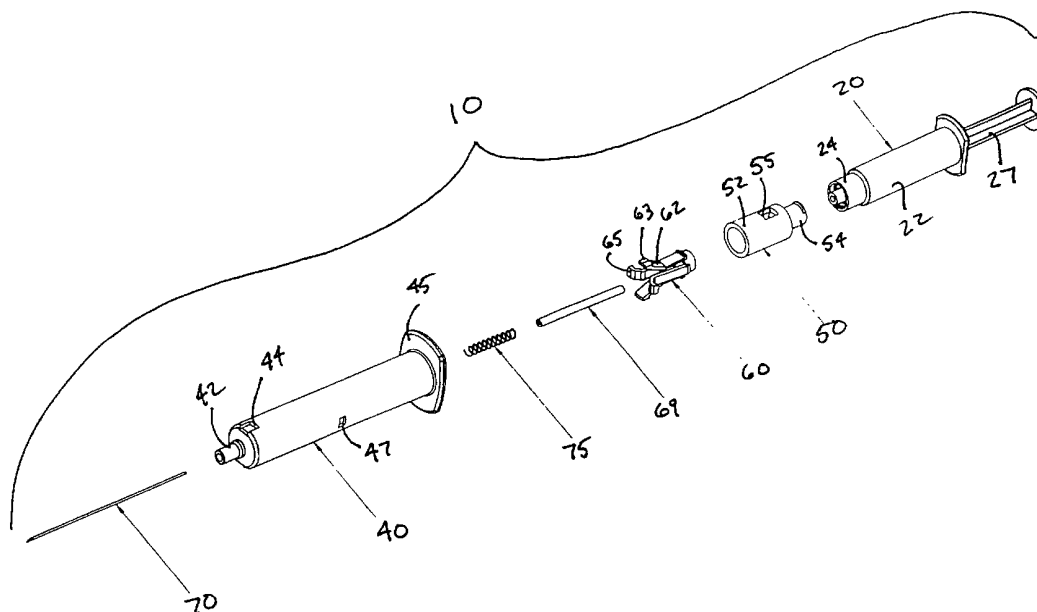

(57) Abstract: A method and apparatus are provided for using a medical device (10) comprised of a medical apparatus (20) and a needle assembly (30). The needle assembly includes a needle (70) having a sharpened tip. Preferably, the medical apparatus (20) is a standard apparatus, such as a syringe or phlebotomy device. The medical apparatus (20) includes a connector (24), such as a Luer connector. The needle assembly (30) is configured so that it can be attached to the medical apparatus (20) and the sharpened tip of the needle (70) is automatically shielded after use to prevent inadvertent contact with the contaminated needle.

WO 01/37898 A3



---

*For two-letter codes and other abbreviations, refer to the "Guidance Notes on Codes and Abbreviations" appearing at the beginning of each regular issue of the PCT Gazette.*

## INTERNATIONAL SEARCH REPORT

International application No.

PCT/US00/42328

**A. CLASSIFICATION OF SUBJECT MATTER**

IPC(7) : A61M 5/32

US CL : 604/195

According to International Patent Classification (IPC) or to both national classification and IPC

**B. FIELDS SEARCHED**

Minimum documentation searched (classification system followed by classification symbols)

U.S. : 604/195, 181,187,192,197,198,171

Documentation searched other than minimum documentation to the extent that such documents are included in the fields searched

Electronic data base consulted during the international search (name of data base and, where practicable, search terms used)

**C. DOCUMENTS CONSIDERED TO BE RELEVANT**

Category *	Citation of document, with indication, where appropriate, of the relevant passages	Relevant to claim No.
X,E	US 6,162,197 A (Mohammad) 19 December 2000 (19.12.2000), see entire document.	6
A <sup>?</sup>	US 6,017,329 A (Hake) 25 January 2000 (25.01.2000), see entire document.	1-21
A <sub>1</sub> E	US 6,190,361 B1 (Gettig et al.) 20 February 2001 (20.02.2001), see entire document.	
A	US 5,045,066 A (Scheuble et al.) 3 September 1991 (03.09.1991), see entire document.	1-21

☐ Further documents are listed in the continuation of Box C.☐ See patent family annex.

* Special categories of cited documents:	
"A" document defining the general state of the art which is not considered to be of particular relevance	"T" later document published after the international filing date or priority date and not in conflict with the application but cited to understand the principle or theory underlying the invention
"E" earlier application or patent published on or after the international filing date	"X" document of particular relevance; the claimed invention cannot be considered novel or cannot be considered to involve an inventive step when the document is taken alone
"L" document which may throw doubts on priority claim(s) or which is cited to establish the publication date of another citation or other special reason (as specified)	"Y" document of particular relevance; the claimed invention cannot be considered to involve an inventive step when the document is combined with one or more other such documents, such combination being obvious to a person skilled in the art
"O" document referring to an oral disclosure, use, exhibition or other means	"&" document member of the same patent family
"P" document published prior to the international filing date but later than the priority date claimed	

Date of the actual completion of the international search

06 May 2001 (06.05.2001)

Date of mailing of the international search report

20 JUN 2001

Name and mailing address of the ISA/US

Commissioner of Patents and Trademarks  
Box PCT  
Washington, D.C. 20231

Facsimile No. (703)305-3230

Authorized officer

Catherine Serka

Telephone No. 703-308-4846