

(19)



(11)

**EP 2 537 968 B1**

(12)

**EUROPEAN PATENT SPECIFICATION**

(45) Date of publication and mention  
of the grant of the patent:  
**06.09.2017 Bulletin 2017/36**

(51) Int Cl.:  
**D01H 4/02 (2006.01) D01H 1/115 (2006.01)**

(21) Application number: **12159062.4**

(22) Date of filing: **12.03.2012**

(54) **Hollow guide shaft unit, air-jet spinning device and spinning machine**

Hohlführungswelleneinheit, Luftspinnvorrichtung und Spinnvorrichtung

Unité d'arbre de guidage creux, fileuse à air et fileuse

(84) Designated Contracting States:  
**AL AT BE BG CH CY CZ DE DK EE ES FI FR GB  
GR HR HU IE IS IT LI LT LU LV MC MK MT NL NO  
PL PT RO RS SE SI SK SM TR**

(30) Priority: **20.06.2011 JP 2011136687**

(43) Date of publication of application:  
**26.12.2012 Bulletin 2012/52**

(73) Proprietor: **Murata Machinery, Ltd.  
Minami-ku  
Kyoto-shi  
Kyoto 601-8326 (JP)**

(72) Inventors:  
• **Sakamoto, Naotaka  
Kyoto-shi, Kyoto 612-8686 (JP)**  
• **Matsui, Toshihiro  
Kyoto-shi, Kyoto 612-8686 (JP)**

(74) Representative: **Stöckeler, Ferdinand  
Schoppe, Zimmermann, Stöckeler  
Zinkler, Schenk & Partner mbB  
Patentanwälte  
Radlkoferstrasse 2  
81373 München (DE)**

(56) References cited:  
**EP-A1- 1 748 094 JP-A- 2011 038 210**

**EP 2 537 968 B1**

Note: Within nine months of the publication of the mention of the grant of the European patent in the European Patent Bulletin, any person may give notice to the European Patent Office of opposition to that patent, in accordance with the Implementing Regulations. Notice of opposition shall not be deemed to have been filed until the opposition fee has been paid. (Art. 99(1) European Patent Convention).

## Description

### BACKGROUND OF THE INVENTION

#### 1. Field of the Invention

**[0001]** The present invention mainly relates to a structure of a hollow guide shaft unit used in an air-jet spinning device adapted to generate a spun yarn by twisting a fiber bundle with an action of airflow.

#### 2. Description of the Related Art

**[0002]** Japanese Unexamined Patent Publication No. 7-126924 discloses this type of air-jet spinning device. The air-jet spinning device of Japanese Unexamined Patent Publication No. 7-126924 introduces a sliver, which is fed from a draft device, to a hollow spindle (hollow guide shaft body) and applies whirling airflow on the sliver to produce a spun yarn. The air-jet spinning device of Japanese Unexamined Patent Publication No. 7-126924 includes a nozzle in which an air injection hole is formed for generating the whirling airflow, and the hollow spindle is attached to a frame of a spindle unit in a non-rotating state with a tip-end thereof inserted in the nozzle. When fixing the hollow spindle to the spindle unit, an appropriate fixing tool such as a bolt is used.

**[0003]** JP 2011-038210 A describes an open-end spinning device configured to secure a sufficient space for carrying out the maintenance and efficiently remove fiber waste or the like blocking a nozzle. The spinning device includes a first nozzle, a first block, a second nozzle, and a second block. The first block supports the first nozzle. The second nozzle is arranged on the downstream side of the first nozzle in the fiber traveling direction. The second block supports the second nozzle 81, and can expose the second nozzle to the exterior by being moved in a direction separated from the first block.

### BRIEF SUMMARY OF THE INVENTION

**[0004]** An object of the present invention is to provide an air-jet spinning device capable of smoothly positioning a hollow guide shaft body and improving workability in replacing the hollow guide shaft body.

**[0005]** This object is achieved by a hollow guide shaft unit according to claim 1.

**[0006]** In the above-described air-jet spinning device, the hollow spindle is preferably arranged at an accurate position in order to improve quality of the spun yarn to be produced. In the air-jet spinning device, in order to produce many types of yarns, there is a need to replaceably provide the hollow spindle.

**[0007]** However, in the structure of Japanese Unexamined Patent Publication No. 7-126924, the hollow spindle is simply fixed with the fixing tool. Therefore, easiness in positioning the hollow spindle and easiness in replacing the hollow spindle have been difficult to be

achieved, and there has been room for improvements.

**[0008]** According to a first aspect of the present invention, a hollow guide shaft unit includes a hollow guide shaft body, a base section, a coupling section, and a displacement-force generating section. The hollow guide shaft body includes a tip-end portion adapted to receive an insert of a twisted fiber bundle, and a fiber bundle passage adapted to receive a passing of the fiber bundle inserted from the tip-end portion. The base section is adapted to support the hollow guide shaft body. The coupling section is adapted to mechanically couple the hollow guide shaft body with the base section. The displacement-force generating section is adapted to generate a force to act upon the hollow guide shaft body so as to displace the tip-end portion of the hollow guide shaft body towards one side within a movable range under a state in which the hollow guide shaft body is mechanically coupled with the base section via the coupling section, the movable range being a range in which the tip-end portion of the hollow guide shaft body can be moved. A play is formed around the hollow guide shaft body under a state in which the hollow guide shaft body is mechanically coupled with the base section via the coupling section. This play enables movement of the tip-end portion of the hollow guide shaft body.

**[0009]** Accordingly, the hollow guide shaft body can be mechanically coupled with the base section by the coupling section, and the hollow guide shaft body can be held by the base section under a state in which a position of the tip-end portion of the hollow guide shaft body is provided with a certain degree of freedom of movement. Therefore, the tip-end portion of the hollow guide shaft body can be precisely repositioned without decoupling the mechanical coupling state, and the quality of the yarn to be spun can be improved. Furthermore, even if the precise positioning is not carried out, since a force of the displacement-force generating section is applied so as to displace the tip-end portion of the hollow guide shaft body towards one side within the movable range, the position of the tip-end portion of the hollow guide shaft body does not greatly fluctuate even with an occurrence of small vibration. Therefore, excessive fluttering of the tip-end portion of the hollow guide shaft body can be prevented, and the workability of maintenance work can be improved. The tip-end portion of the hollow guide shaft body becomes movable with a simple structure of providing a play.

**[0010]** In the above hollow guide shaft unit, the displacement-force generating section is preferably an elastic member that generates an elastic restoring force.

**[0011]** Accordingly, the tip-end portion of the hollow guide shaft body can be displaced towards one side with a stable force from the elastic member. As a result, the position of the tip-end portion of the hollow guide shaft body can be reliably stabilized.

**[0012]** The above hollow guide shaft unit preferably includes a movement restricting section provided between the hollow guide shaft body and the base section

and adapted to generate a force against a movement of the hollow guide shaft body.

**[0013]** Accordingly, the movement of the hollow guide shaft body can be restricted by the restricting section, and the position of the tip-end portion of the hollow guide shaft body can be reliably stabilized.

**[0014]** In the above hollow guide shaft unit, the movement restricting section is preferably a member capable of being elastically deformed.

**[0015]** Accordingly, even if the hollow guide shaft body tends to move by the influence of vibration or the like, momentum at which the hollow guide shaft body tends to move can be absorbed by the elastic deformation of the movement restricting section. As a result, the position of the tip-end portion of the hollow guide shaft body can be reliably stabilized.

**[0016]** In the above hollow guide shaft unit, the movement restricting section includes a first restricting portion and a second restricting portion. The first restricting portion is adapted to restrict a movement of the hollow guide shaft body in a direction substantially perpendicular to the fiber bundle passage. The second restricting portion is adapted to restrict a movement of the hollow guide shaft body in a direction substantially parallel to the fiber bundle passage.

**[0017]** Accordingly, the excessive fluttering of the hollow guide shaft body can be effectively prevented.

**[0018]** In the above hollow guide shaft unit, the first restricting portion and the second restricting portion are provided capable of making contact with the base section. The movement restricting section includes a concave to form a gap with respect to the base section. The hollow guide shaft body and the movement restricting section are provided detachably with respect to the base section.

**[0019]** Accordingly, a contacting area between the movement restricting section and the base section can be reduced by the amount of the concave, and the movement restricting section can be easily attached or detached with respect to the base section.

**[0020]** In the above hollow guide shaft unit, the movement restricting section is preferably provided entirely around an outer peripheral surface of the hollow guide shaft body.

**[0021]** Accordingly, fluttering in a radial direction of the hollow guide shaft body can be satisfactorily and reliably suppressed.

**[0022]** The above hollow guide shaft unit preferably includes a decoupling operation section adapted to decouple by one-action the state in which the hollow guide shaft body is mechanically coupled with the base section via the coupling section.

**[0023]** Accordingly, the above hollow guide shaft body can be detached from the base section with a simple operation of one-action.

**[0024]** According to a second aspect of the present invention, an air-jet spinning device includes the hollow guide shaft unit, a fiber guiding section, a supporting sec-

tion, a positioning section, and a nozzle member. The fiber guiding section is provided to face the hollow guide shaft body and adapted to guide the fiber bundle to the fiber bundle passage. The supporting section is adapted to support at least one of the fiber guiding section and the hollow guide shaft body and to enable switching between a first state in which the hollow guide shaft body is located close to the fiber guiding section and a second state in which the hollow guide shaft body is located away from the fiber guiding section. The positioning section is adapted to determine a position of the tip-end portion of the hollow guide shaft body under the first state with respect to the fiber guiding section. The nozzle member is adapted to form a spinning chamber between the nozzle member and the hollow guide shaft body under the first state, and to inject compressed air from at least one nozzle hole that opens into the spinning chamber to generate whirling airflow in the spinning chamber to be acted upon the fiber bundle.

**[0025]** Accordingly, under the second state, the base section can hold the hollow guide shaft body with the position of the tip-end portion of the hollow guide shaft body having a certain degree of freedom of movement. Under the first state, the tip-end portion of the hollow guide shaft body is accurately positioned with respect to the fiber guiding section by the positioning section. As a result, the quality of the yarn to be spun by the air-jet spinning device can be improved.

**[0026]** In the above air-jet spinning device, the supporting section is adapted to switch between the first state and the second state by moving at least one of the hollow guide shaft body and the fiber guiding section so that the hollow guide shaft body moves in an arcuate path with respect to the fiber guiding section. The displacement-force generating section is adapted to generate a force to be applied to the hollow guide shaft body to displace the tip-end portion of the hollow guide shaft body within the movable range to approach a center of the arcuate path.

**[0027]** Accordingly, with the movement of the hollow guide shaft body in the arcuate path with respect to the fiber guiding section when switching between the first state and the second state, the tip-end portion of the hollow guide shaft body can be smoothly moved without interfering with other members.

**[0028]** In the above air-jet spinning device, the base section includes a supporting surface adapted to support the hollow guide shaft body from a base-end portion at a prescribed inclination angle. The base section can be replaced with another base section having the supporting surface with a different inclination angle.

**[0029]** Accordingly, various layouts of the hollow guide shaft body demanded in the air-jet spinning device can be easily realized.

**[0030]** According to a third aspect of the present invention, an air-jet spinning device includes a hollow guide shaft unit and a nozzle member. The hollow guide shaft unit includes a hollow guide shaft body, a base section,

a coupling section, a decoupling operation section, a displacement-force generating section, and a movement restricting section. The hollow guide shaft body includes a tip-end portion adapted to receive an insert of a twisted fiber bundle, and a fiber bundle passage adapted to receive a passing of the fiber bundle inserted from the tip-end portion. The base section is adapted to support the hollow guide shaft body. The coupling section is adapted to mechanically couple the hollow guide shaft body with the base section. The decoupling operation section is adapted to decouple by one-action the state in which the hollow guide shaft body is mechanically coupled with the base section via the coupling section. The displacement-force generating section is an elastic member that is adapted to generate a force to act upon the hollow guide shaft body so as to displace the tip-end portion of the hollow guide shaft body towards one side within a movable range under a state in which the hollow guide shaft body is mechanically coupled with the base section via the coupling section, the movable range being a range in which the tip-end portion of the hollow guide shaft body can be moved. The movement restricting section is a member provided between the hollow guide shaft body and the base section and entirely around an outer peripheral surface of the hollow guide shaft body, and is capable of being elastically deformed to generate a force against a movement of the hollow guide shaft body. The nozzle member is adapted to form a spinning chamber between the nozzle member and the hollow guide shaft body of the hollow guide shaft unit, and to inject compressed air from at least one nozzle hole that opens into the spinning chamber to generate whirling airflow in the spinning chamber to be acted upon the fiber bundle.

**[0031]** Accordingly, the hollow guide shaft body can be mechanically coupled with the base section by the coupling section, and the hollow guide shaft body can be held by the base section under the state in which the position of the tip-end portion of the hollow guide shaft body is provided with a certain degree of freedom of movement. Therefore, the tip-end portion of the hollow guide shaft body can be precisely repositioned without decoupling the mechanical coupling state, and the quality of the yarn to be spun by the air-jet spinning device can be improved. Furthermore, even if the precise positioning is not carried out, since the elastic force of the displacement-force generating section is stably applied to displace the tip-end portion of the hollow guide shaft body towards one side within the movable range, the position of the tip-end portion of the hollow guide shaft body does not greatly fluctuate even with an occurrence of small vibration. Furthermore, the movement of the hollow guide shaft body in the radial direction is satisfactorily and reliably suppressed by the elastic deformation of the movement restricting section. Therefore, excessive fluttering of the tip-end portion of the hollow guide shaft body can be prevented and workability of maintenance work can be improved. Moreover, the hollow guide shaft body can be easily detached from the base section by operating

the decoupling operation section with one-action.

**[0032]** According to a fourth aspect of the present invention, a spinning machine includes the above-described air-jet spinning device, and a winding section. The winding section is adapted to wind a spun yarn, which has been spun by the air-jet spinning device, into a package.

**[0033]** Accordingly, a spinning machine is provided in which the hollow guide shaft body can be easily replaced, and a high quality yarn can be obtained.

## BRIEF DESCRIPTION OF THE DRAWINGS

### **[0034]**

FIG. 1 is a front view illustrating an overall structure of a fine spinning machine according to one embodiment of the present invention;

FIG. 2 is a longitudinal cross-sectional view of the fine spinning machine;

FIG. 3 is a cross-sectional view illustrating a normal state in which a spindle is located in proximity to a needle holder in the spinning device;

FIG. 4 is a cross-sectional perspective view illustrating the spindle and a structure for supporting the spindle; and

FIG. 5 is a cross-sectional view illustrating a maintenance state in which the spindle is located away from the needle holder.

## DETAILED DESCRIPTION OF PREFERRED EMBODIMENTS

**[0035]** A fine spinning machine (spinning machine) serving as a textile machine according to one embodiment of the present invention will be described with reference to the drawings. "Upstream" and "downstream" respectively refer to upstream and downstream in a travelling direction of a yarn or a fiber at the time of spinning. FIG. 1 is a front view illustrating an overall structure of a fine spinning machine 1 according to one embodiment of the present invention. FIG. 2 is a longitudinal cross-sectional view of the fine spinning machine 1.

**[0036]** The fine spinning machine 1 as a textile machine illustrated in FIG. 1 includes a plurality of spinning units (yarn processing units) 2 arranged in line, a main control device 60, a yarn joining cart 3, a blower box 4, and a motor box 5.

**[0037]** The spinning unit 2 carries out spinning with respect to a supplied sliver 15 to form a package 45 around which a spun yarn 10 is wound. As illustrated in FIG. 1, each spinning unit 2 includes a draft device 7, a spinning device (air-jet spinning device) 9, a yarn slack eliminating device 12, and a winding device (winding section) 13, arranged in this order from the upstream to the downstream.

**[0038]** The draft device 7 is arranged in proximity to an upper end of a frame 6 of the fine spinning machine 1.

The draft device 7 drafts the sliver 15 into a fiber bundle 8 by a rotation of a plurality of rollers. The spinning device 9 carries out the spinning by twisting the fiber bundle 8 fed from the draft device 7 by an action of whirling airflow. The spun yarn 10 produced by the spinning device 9 passes through a yarn clearer 52 adapted to detect a defect of the spun yarn 10, and is then fed to the yarn slack eliminating device 12. The spun yarn 10 that passed the yarn slack eliminating device 12 is wound by the winding device 13 into the package 45. The detailed structure of the spinning unit 2 will be described later.

**[0039]** The main control device 60 collectively manages each component of the fine spinning machine 1. The main control device 60 includes a display 61 and an operation section 62. An operator can check a state of each spinning unit 2 with the display 61 or can instruct a change in a spinning parameter with respect to at least one or all of the spinning units 2 by operating the operation section 62. The main control device 60 can also control and manage the yarn joining cart 3 and the blower box 4, for example, other than the spinning unit 2.

**[0040]** The yarn joining cart 3 includes a splicer (yarn joining device) 43, a suction pipe 44, and a suction mouth 46. The fine spinning machine 1 includes a rail (not illustrated), and the yarn joining cart 3 can move along the rail in a direction parallel to the direction in which the spinning units 2 are arranged. When yarn breakage or yarn cut occurs during spinning in a spinning unit 2, the yarn joining cart 3 travels to the relevant spinning unit 2 and stops at the relevant position. The yarn joining cart 3 then catches a yarn end from the spinning device 9 with the suction pipe 44 and also catches a yarn end from the winding device 13 with the suction mouth 46. The yarn joining cart 3 swings the suction pipe 44 and the suction mouth 46 to respectively guide the caught yarn end from the spinning device 9 and the caught yarn end from the winding device 13 to the splicer 43. The yarn end from the spinning device 9 and the yarn end from the winding device 13 guided to the splicer 43 are joined by the splicer 43. The yarn end from the spinning device 9 and the yarn end from the winding device 13 are thereby joined, and the spinning unit 2 can resume the winding operation.

**[0041]** A blower serving as a negative pressure source (not illustrated) is provided in the blower box 4. The blower is connected to each spinning unit 2 through a duct (not illustrated), and can suck and remove yarn waste, fly waste, and the like generated by the spinning unit 2.

**[0042]** An electric motor (not illustrated), which is a common driving source for the plurality of spinning units 2, is provided in the motor box 5. Power generated by the electric motor is used, for example, to drive some of rollers of the draft device 7 or to drive a traverse rod 77, to be described later, in the winding device 13.

**[0043]** The fine spinning machine 1 includes a doffing cart (not illustrated) adapted to doff the fully-wound package 45. The doffing cart can travel independently from the yarn joining cart 3.

**[0044]** Next, the spinning unit 2 will be described in detail. As described above, the spinning unit 2 includes the draft device 7, the spinning device 9, the yarn slack eliminating device 12, and the winding device 13.

**[0045]** As illustrated in FIG. 2, the draft device 7 includes four pairs of rollers, i.e., a back roller pair 16, a third roller pair 17, a middle roller pair 19 provided with an apron belt 18, and a front roller pair 20. The rollers are driven by power from the motor box 5 or by power of electric motors (not illustrated) provided in each spinning unit 2. Each roller pair is driven with a different rotation speed. As a result, the draft device 7 can draft the sliver 15 supplied from the upstream to form the fiber bundle 8 and feed the fiber bundle 8 to the spinning device 9.

**[0046]** The spinning device 9 is a so-called air-jet spinning device, and includes a whirling airflow generating nozzle arranged at a periphery of a path of the fiber bundle 8. The spinning device 9 generates the whirling airflow at the periphery of the fiber bundle 8 by blowing compressed air from the whirling airflow generating nozzle, so that twists are applied to the fiber bundle 8, and the spun yarn 10 is produced at high speed. The detailed structure of the spinning device 9 will be described later.

**[0047]** The yarn clearer 52 is arranged at a position slightly downstream of the spinning device 9. The spun yarn 10 spun by the spinning device 9 passes through the yarn clearer 52 before being wound by the yarn slack eliminating device 12. By monitoring a thickness of the travelling spun yarn 10, the yarn clearer 52 can detect a yarn defect of the spun yarn 10. A cutter 57 is arranged in proximity to the yarn clearer 52, and cuts the spun yarn 10 when the yarn clearer 52 detects the yarn defect.

**[0048]** The yarn slack eliminating device 12 is adapted to eliminate the slackening of the spun yarn 10 between the spinning device 9 and the winding device 13, and apply an appropriate tension on the spun yarn 10. The yarn slack eliminating device 12 includes a slack eliminating roller 21 and a yarn hooking member 22. The description on the detailed structure of the yarn slack eliminating device 12 will be omitted, but the yarn slack eliminating device 12 winds and accumulates the spun yarn 10 around an outer periphery of the slack eliminating roller 21, and causes the accumulated spun yarn 10 to function as a buffer to absorb a fluctuation in tension of the spun yarn 10 and prevent slackening of the spun yarn 10.

**[0049]** The winding device 13 includes a cradle arm 71, a winding drum 72, and a traverse device 75.

**[0050]** The cradle arm 71 is supported to be swingable about a supporting shaft 70. The cradle arm 71 can rotatably support a bobbin for winding the spun yarn 10. The winding drum 72 is adapted to be driven while making contact with an outer peripheral surface of the bobbin or an outer peripheral surface of the package 45 formed by winding the spun yarn 10 around the bobbin. The traverse device 75 includes a traverse guide 76, to which the spun yarn 10 can be hooked. The traverse guide 76 is fixed to the traverse rod 77 arranged horizontally across the plurality of spinning units 2. The winding drum 72 is driven

by the electric motor (not illustrated) while reciprocating the traverse rod 77, so that the package 45 making contact with the winding drum 72 can be rotated and the spun yarn 10 can be wound into the package 45 while being traversed.

**[0051]** Next, a structure of the spinning device 9 will be described in detail with reference to FIG. 3 to FIG. 5. FIG. 3 is a cross-sectional view illustrating a normal state in which a spindle 24 is located in proximity to a needle holder 25 in the spinning device 9. FIG. 4 is a cross-sectional perspective view illustrating the spindle 24 and a structure for supporting the spindle 24. FIG. 5 is a cross-sectional view illustrating a maintenance state in which the spindle 24 is located away from the needle holder 25.

**[0052]** As illustrated in FIG. 3, the spinning device 9 of the present embodiment includes a spinning nozzle 23 and a spindle unit (hollow guide shaft unit) 35.

**[0053]** The spinning nozzle 23 includes the needle holder (fiber guiding section) 25, and a nozzle block (nozzle member) 26 to which the needle holder 25 is attached. The needle holder 25 and the nozzle block 26 are supported by a nozzle supporting arm 91 (see FIG. 2) attached to the frame 6 of the fine spinning machine 1. As illustrated in FIG. 3, the needle holder 25 is provided with a guiding hole 27 adapted to introduce the fiber bundle 8 drafted by the draft device 7. The needle holder 25 holds a needle 28. A tip-end of the needle 28 is located in a path through which the fiber bundle 8 discharged from the guiding hole 27 to the downstream is fed.

**[0054]** A circular hole 29 is formed in the nozzle block 26 at a position located downstream of the needle holder 25. A tip-end portion 30 of the spindle (hollow guide shaft body) 24 of the spindle unit 35 is inserted in the circular hole 29 with an axial center thereof aligned with an axial center of the circular hole 29. A predetermined gap is formed between an end face of the tip-end portion 30 of the spindle 24 and the needle holder 25, and a spinning chamber 31 is formed at such a portion. A tip-end of the needle 28 projects into the spinning chamber 31 to face the tip-end portion 30 of the spindle 24. A substantially cylindrical whirling airflow generating chamber 32 is formed between the circular hole 29 and the tip-end portion 30.

**[0055]** A plurality of whirling airflow generating nozzles 41 are formed in the nozzle block 26, and an end of each of the whirling airflow generating nozzles 41 is opened to the spinning chamber 31. Each of the whirling airflow generating nozzles 41 is an elongate hole (nozzle hole) formed in the nozzle block 26 so as to connect to an inner wall of the spinning chamber 31 in a tangent direction and to be inclined towards downstream in the yarn feeding direction.

**[0056]** The whirling airflow generating nozzle 41 injects compressed air supplied from a compressed air source (not illustrated) to the spinning chamber 31, and causes whirling airflow to be generated in the spinning chamber 31 in a counterclockwise direction, for example, when seen in an advancing direction of the fiber bundle 8. Ac-

cordingly, twists are applied to the fiber bundle 8. The whirling airflow flows spirally along the whirling airflow generating chamber 32 formed around the tip-end portion 30 of the spindle 24. Thereafter, the whirling airflow is discharged to the outside of the spinning device 9 via a discharge path formed inside the nozzle supporting arm 91.

**[0057]** The spindle unit 35 includes the spindle 24 and a holder attachment 151 adapted to support the spindle 24. A fiber passage (fiber bundle passage) 85 is formed in the spindle 24 as an elongate hole along the axial center of the spindle 24. A hole connected to the fiber passage 85 is opened at the tip-end portion 30 of the spindle 24. The fiber bundle 8 twisted in the spinning chamber 31 is inserted into the hole of the tip-end portion 30, and then fed downstream to pass through an inside of the fiber passage 85.

**[0058]** The spindle 24 is fixed while being inserted to a conical shaft body holding member 87 for positioning the spindle 24.

**[0059]** As illustrated in FIG. 4, the shaft body holding member 87 is formed as a conical member having a shaft hole, and a flange 88 is formed at an outer periphery thereof. A ring-shaped first contacting surface 95 is formed at a portion of the flange 88. A cylindrical second contacting surface 96 arranged perpendicular to the first contacting surface 95 is formed in the shaft body holding member 87. As illustrated in FIG. 3, a ring-shaped flat first positioning surface 97 is formed on a downstream end surface of the tip-end portion of the nozzle supporting arm 91. An attachment hole 94 is formed on the inner side of the first positioning surface 97. A cylindrical second positioning surface 98 is formed on an inner peripheral surface of the attachment hole 94. The first positioning surface 97 and the second positioning surface 98 function as a positioning section for precisely positioning the tip-end portion 30 of the spindle 24 with respect to the needle holder 25.

**[0060]** By inserting a conical portion of the shaft body holding member 87 to the attachment hole 94 of the nozzle supporting arm 91 from below, the first contacting surface 95 is caused to make contact with the first positioning surface 97, and the second contacting surface 96 is caused to make contact with the second positioning surface 98. Accordingly, the spindle 24 can be accurately positioned with respect to the spinning nozzle 23 (the needle holder 25 and the nozzle block 26).

**[0061]** The shaft body holding member 87 is not fixed to the nozzle supporting arm 91 with a bolt or the like, and the conical portion is merely inserted into the attachment hole 94. Therefore, by moving the shaft body holding member 87 from the attachment hole 94, the spindle 24 can be easily detached from the nozzle supporting arm 91 (see FIG. 5). As a result, a maintenance operation of removing the fibers clogged in the spinning chamber 31, the whirling airflow generating chamber 32, or the like, or detaching the spindle 24 to replace with a new one can be easily carried out.

**[0062]** A compressed air introducing hole 102 is formed in the spindle 24 for introducing compressed air into the fiber passage 85. The compressed air introducing hole 102 is connected to a supply source (not illustrated) of the compressed air through a supplying tube 103 connected to the spindle 24.

**[0063]** The fiber passage 85 is formed to axially pass through a center portion of the spindle 24. The fiber bundle 8 that has passed through the fiber passage 85 is discharged from the spindle 24 as the spun yarn 10.

**[0064]** At a position slightly downstream of the shaft body holding member 87, a receiving rubber (movement restricting section) 65 is fixed to the outer side of the spindle 24. The receiving rubber 65 is a rubber member, and can elastically deform. The receiving rubber 65 is formed in a ring shape, but a cutout for passing the supplying tube 103 of the compressed air is provided at one part of the receiving rubber 65. The receiving rubber 65 is provided entirely around the outer side of the spindle 24 by 360 degrees and is in close contact with the outer peripheral surface of the spindle 24.

**[0065]** A first ring portion 66 and a second ring portion 67 serving as a first restricting portion projecting radially outward and a third ring portion 68 serving as a second restricting portion projecting to the downstream are integrally formed to constitute the receiving rubber 65. The first ring portion 66 and the second ring portion 67 project in a direction parallel to each other, and a ring-shaped groove is formed therebetween.

**[0066]** Next, a structure for supporting the spindle 24 will be described. The spindle 24 is attached to a spindle arm (supporting section) 92 attached to the frame 6 of the fine spinning machine 1. As illustrated in FIG. 4, a substantially cylindrical attachment attaching portion 111 is formed on the tip-end of the spindle arm 92. The attachment attaching portion 111 is formed in a hollow shape. A large through-hole is formed at a bottom of the attachment attaching portion 111.

**[0067]** The holder attachment 151 adapted to attach the spindle 24 is attached to an interior of the attachment attaching portion 111. The holder attachment 151 includes a holder main body (base section) 152, and a lock member (coupling section) 153 slidably attached to a bottom of the holder main body 152.

**[0068]** A base end portion of the spindle arm 92 is supported by the frame 6 so as to be swingable about a swing shaft 93 illustrated in FIG. 2. Therefore, by swinging the spindle arm 92 with the spindle 24 attached to the tip-end of the spindle arm 92 via the holder attachment 151, a normal state (first state, FIG. 3) in which the spindle 24 is located close to the needle holder 25 and a maintenance state (second state, FIG. 5) in which the spindle 24 is located away from the needle holder 25 can be switched. In such switching, the spindle 24 moves in an arcuate path with the swing shaft 93, which is a supporting shaft of the spindle arm 92, as a center. Such swinging of the spindle arm 92 (the switching between the normal state and the maintenance state) can be realized, for

example, by using a spring force, or by driving an air cylinder or the like.

**[0069]** As illustrated in FIG. 4, the holder main body 152 is formed in a cup shape opened to the upstream, and a circular accommodation concave 160 is formed inside the holder main body 152. The receiving rubber 65 attached to the spindle 24 can be accommodated in the accommodation concave 160. The bottom of the holder main body 152 is double-bottomed, and a flat plate-like lock main body 181 of the lock member 153 is inserted to a gap formed between the double-bottom.

**[0070]** A circular insertion hole 161 is formed to penetrate through the bottom of the holder main body 152. A downstream end of the spindle 24 (hereinafter sometimes referred to as an inserting portion 170) can be inserted to the insertion hole 161. A ring groove 171 is annularly formed on an outer peripheral surface of the inserting portion 170.

**[0071]** A material of the lock member 153 is synthetic resin, and a push button section (decoupling operation section) 182 and a spring section (displacement-force generating section) 183 are integrally formed with respect to the flat plate-like lock main body 181.

**[0072]** The lock main body 181 is attached to the bottom of the holder main body 152 in a manner that the lock main body 181 can be reciprocated at a predetermined stroke. A lock hole 184 is formed through the lock main body 181 at a position substantially corresponding to the insertion hole 161. A peripheral edge portion of the lock hole 184 can be inserted into the ring groove 171 formed in the inserting portion 170 of the spindle 24.

**[0073]** The push button section 182 and the spring section 183 are both structured as a rib rising perpendicularly from an upper surface (upstream surface) near an end in a longitudinal direction of the lock main body 181. The surface of the push button section 182 is exposed to the outside, so that the operator can push the push button section 182 to slide the lock member 153. The spring section 183 is formed as a slightly-thin rib made of synthetic resin. By applying a lateral (direction perpendicular to the travelling direction of the fiber bundle 8) force upon the upper end of the spring section 183, the spring section 183 can be elastically deformed. The upper end (upstream end) of the spring section 183 makes contact with the outer peripheral surface of the holder main body 152.

**[0074]** Under a state in which the lock member 153 is assembled to the holder main body 152, the spring section 183 is elastically deformed by the upper end of the spring section 183 being pushed by the outer peripheral surface of the holder main body 152 in an A direction in FIG. 3 and FIG. 4. Accordingly, an elastic restoring force is generated at the spring section 183, and the elastic restoring force acts as an urging force for moving the lock member 153 in the direction of an arrow A. This urging force can be used as a returning force of when the operator pushes the push button section 182. The urging force is also used as a force for displacing the tip-end portion 30 of the spindle 24 to one side (details will be

described later).

**[0075]** Next, an attachment operation of the spindle 24 to the holder attachment 151 will be described. When attaching the spindle 24 to the holder attachment 151, the operator first swings the spindle arm 92 to position the spindle arm 92 away from the nozzle supporting arm 91. The operator then pushes the push button section 182 with a finger to move the lock member 153 in a direction opposite to the direction of the arrow A such that an edge of the lock hole 184 formed in the lock main body 181 does not project out from an inner wall of the insertion hole 161. While pushing the push button section 182 with the finger, the operator then inserts the inserting portion 170 of the spindle 24 to the insertion hole 161 and the lock hole 184 from above (upstream) and also inserts the receiving rubber 65 into the accommodation concave 160.

**[0076]** In this step, it is necessary to securely push in the receiving rubber 65 so that all of the first ring portion 66, the second ring portion 67, and the third ring portion 68 of the receiving rubber 65 are reliably made into close contact with the inner wall surface of the accommodation concave 160. However, since a ring-shaped groove is formed between the first ring portion 66 and the second ring portion 67 in the receiving rubber 65, a contacting area of the receiving rubber 65 and the inner wall surface of the accommodation concave 160 is greatly reduced by this amount, and insertion and removal of the receiving rubber 65 with respect to the accommodation concave 160 are facilitated.

**[0077]** Thereafter, when the operator releases the finger from the push button section 182, the lock member 153 moves in the direction of the arrow A by the restoring force of the spring section 183, and the edge of the lock hole 184 formed in the lock main body 181 projects out from the inner wall of the insertion hole 161 to enter the ring groove 171 formed in the inserting portion 170.

**[0078]** In this manner, a state illustrated in FIG. 5 is realized. In this state, since the spindle 24 is mechanically coupled with the holder main body 152 by the lock member 153, the spindle 24 will not be detached from the holder main body 152 even if the spindle 24 is attempted to be removed upward (upstream), for example.

**[0079]** An inner diameter of the insertion hole 161 formed in the holder main body 152 is formed to be slightly greater than an outer diameter of the downstream end of the spindle 24 (the inserting portion 170) to be inserted to the insertion hole 161, and a play of a certain extent in a radial direction of the spindle 24 is ensured. A width of the ring groove 171 formed in the inserting portion 170 is formed to be slightly greater than a thickness of the lock main body 181 to be inserted to the ring groove 171, and a play in an axial direction is also ensured. Furthermore, the ring-shaped receiving rubber 65 to be arranged between the holder main body 152 and the spindle 24 can be elastically deformed.

**[0080]** Therefore, as illustrated in FIG. 5, even in a state in which the spindle 24 is attached to the holder attach-

ment 151 (the tip-end of the spindle arm 92), the spindle 24 is not completely restricted (positioned) and can move with respect to the holder main body 152 within a range of the play (moderate restriction). In other words, the spindle 24 is allowed to move, although by a slight stroke, in the radial direction and in the axial direction, and furthermore, the spindle 24 can move to tilt its axis. Accompanied therewith, the tip-end portion 30 of the spindle 24 can also move within a prescribed range and can also be tilted.

**[0081]** When the spindle 24 moves as described above, the receiving rubber 65 arranged between the spindle 24 and the holder main body 152 elastically deforms in accordance therewith, and generates the restoring force to return the movement of the spindle 24. Specifically, when the spindle 24 is moved in the radial direction (direction substantially orthogonal to the travelling direction of the fiber bundle 8), the first ring portion 66 and the second ring portion 67 mainly generate the elastic force to return the movement. When the spindle 24 is moved in the axial direction (direction substantially parallel to the travelling direction of the fiber bundle 8), the third ring portion 68 mainly generates the elastic force to return the movement. According to such an elastic movement restricting action of the receiving rubber 65, in a state where no force is applied on the spindle 24, the spindle 24 is held at a position where the axial center thereof substantially coincides with the axial center of the accommodation concave 160 of the holder main body 152.

**[0082]** Meanwhile, the elastic deformation of the spring section 183 in the lock member 153 is not completely released even in a state where the spindle 24 is attached to the holder attachment 151 as illustrated in Fig 5. In other words, the elastic restoring force of the spring section 183 is not lost. Since the lock main body 181 is pulled by the elastic restoring force of the spring section 183, the base end portion of the spindle 24 is pushed in the direction of the arrow A by the inner peripheral surface of the lock hole 184 formed in the lock main body 181. In other words, in the state of FIG. 5, the elastic restoring force of the spring section 183 acts as a force in the direction of the arrow A on the inserting portion 170 of the spindle 24. Therefore, the spindle 24 tilts like a see-saw with a middle portion in the axial direction (around where the receiving rubber 65 is arranged) as a supporting point, and the tip-end portion 30 is displaced by a slight distance in the direction of a thick arrow in FIG. 5. As described above, the spring section 183 has a function of generating the force for displacing the tip-end portion 30 of the spindle 24 in a predetermined direction.

**[0083]** The position of the tip-end portion 30 of the spindle 24 can be effectively stabilized by the force generated by the spring section 183. In other words, if the spring force is not acted on the spindle 24 at all, the spindle 24 may flutter due to the influence of vibration and the like, and the position of the tip-end portion 30 may become unstable. The fluttering of the spindle 24 due to the vi-



bration and the like can be weakened to a certain extent by the receiving rubber 65. However, it is difficult to prevent slight fluttering of the spindle 24 in a range in which the receiving rubber 65 hardly deforms elastically. On the other hand, in the present embodiment, the spindle 24 is constantly pressed down so that the tip-end portion 30 is displaced in a predetermined direction by the force of the spring section 183, and a direction as well as a magnitude of the force of the spring section 183 are mostly constant. Therefore, the holder main body 152 can effectively suppress the fluttering of the spindle 24, and can hold the tip-end portion 30 of the spindle 24 in an extremely stable manner at a displaced position.

**[0084]** In particular, in the present embodiment, the tip-end portion 30 of the spindle 24 is displaced towards the swing shaft 93 illustrated in FIG. 2. This structure is extremely advantageous in a structure in which the spindle 24 needs to be moved in an arcuate path (not linear path) with the swing shaft 93 as the center when positioning the spindle 24 with respect to the spinning nozzle 23 (the needle holder 25) as in the present embodiment. In other words, as illustrated in FIG. 5, since the tip-end portion 30 of the spindle 24 is displaced to approach the spinning nozzle 23, even when the spindle 24 moves on the arcuate path, the tip-end portion 30 of the spindle 24 can be smoothly inserted into the nozzle block 26 without colliding with the nozzle block 26 to smoothly shift the spindle 24 to the state of FIG. 3.

**[0085]** Thereafter, the spindle arm 92 is swung towards the nozzle supporting arm 91, and the conical portion of the shaft body holding member 87 fixed to the spindle 24 is inserted into the attachment hole 94 formed in the nozzle supporting arm 91. In this case, the fluttering of the tip-end portion 30 of the spindle 24 is effectively prevented as described above. Therefore, the spindle 24 can be smoothly inserted into the attachment hole 94 without the tip-end portion 30 colliding with other members (e.g., the nozzle block 26) during the movement of the spindle 24.

**[0086]** Eventually, the first contacting surface 95 makes contact with the first positioning surface 97, and the second contacting surface 96 makes contact with the second positioning surface 98. Therefore, the spindle 24 is accurately positioned with respect to the spinning nozzle 23 (the needle holder 25). The state of FIG. 3 is realized in such a manner, and the spinning device 9 can perform spinning.

**[0087]** Next, detachment of the spindle 24 from the holder attachment 151 will be briefly described. First, the spindle arm 92 is swung from the state of FIG. 3 to release the positioning of the spindle 24 to achieve the state of FIG. 5. The push button section 182 is then pushed to move the lock member 153 to release the lock main body 181 from the ring groove 171. The spindle 24 is then gripped and pulled upward to detach the spindle 24 from the holder attachment 151 at the tip-end of the spindle arm 92. As described above, in the present embodiment, a mechanical coupling state of the spindle 24 and the

holder main body 152 is decoupled by one-action of simply pushing the push button section 182, and hence the maintenance workability is excellent.

**[0088]** Next, replacement of the holder attachment 151 will be described. The inner bottom surface (hereinafter sometimes referred to as a supporting surface) of the accommodation concave 160 formed in the holder main body 152 supports the base end portion of the spindle 24. This inner bottom surface has a predetermined inclination, and the spindle 24 is inclined at a predetermined angle when the spindle 24 is supported. Other than the holder attachment 151 described above, other types of holder attachment can be attached to the attachment attaching portion 111 provided at the tip-end of the spindle arm 92. Such a holder attachment may be formed such that the direction in which the accommodation concave 160 is formed (i.e., direction of the supporting surface) is slightly different from that of the holder attachment 151. Therefore, by replacing with a holder attachment having a supporting surface with a different inclination angle, the direction in which the spindle 24 is supported in the state of FIG. 5 (moreover, the movable range of the tip-end portion 30 of the spindle 24) can be variously changed. Accordingly, various layouts of the spindle 24 required according to a type of a yarn to be spun can be easily realized.

**[0089]** As described above, the spindle unit 35 of the spinning device 9 according to the present embodiment includes the spindle 24, the holder main body 152, the lock member 153, and the spring section 183. The spindle 24 includes the tip-end portion 30 adapted to receive an insert of the twisted fiber bundle 8, and the fiber passage 85 adapted to receive a passing of the fiber bundle 8 inserted from the tip-end portion 30. The holder main body 152 supports the spindle 24. The lock member 153 is adapted to mechanically couple the spindle 24 with the holder main body 152. Under a state in which the spindle 24 is mechanically coupled to the holder main body 152 via the lock member 153 (hereinafter referred to as a coupled state), the tip-end portion 30 of the spindle 24 can move within a predetermined range. The spring section 183 is adapted to generate a force in a direction of the arrow A to act upon the lower part of the spindle 24 (the inserting portion 170) so as to displace the tip-end portion 30 towards one side within the movable range (i.e., side illustrated with the thick arrow in FIG. 5).

**[0090]** Thus, the spindle 24 can be mechanically coupled with the holder main body 152 by the lock member 153, and in this state, the holder main body 152 can hold the spindle 24 with the position of the tip-end portion 30 of the spindle 24 provided with a certain degree of freedom of movement. Therefore, by positioning the spindle 24 with the first contacting surface 95 and the second contacting surface 96 (the first positioning surface 97 and the second positioning surface 98) without decoupling such a mechanical coupling state (e.g., FIG. 3), the tip-end portion 30 of the spindle 24 can be precisely repositioned, and the quality of the spun yarn 10 can be im-

proved. Furthermore, even in the state of FIG. 5 in which the positioning is not carried out, since the force of the spring section 183 is acted to displace the tip-end portion 30 of the spindle 24 towards one side, the position of the tip-end portion 30 of the spindle 24 does not greatly fluctuate by the influence of small vibration, for example. Therefore, the excessive fluttering of the tip-end portion 30 of the spindle 24 can be prevented, and the workability of maintenance work can be improved.

**[0091]** In the spindle unit 35 of the present embodiment, under the state in which the spindle 24 is mechanically coupled with the holder main body 152 via the lock member 153, a play in the radial direction and a play in the axial direction are formed around the spindle 24. These plays enable movement of the tip-end portion 30 of the spindle 24.

**[0092]** Accordingly, the tip-end portion 30 of the spindle 24 becomes movable with a simple structure of providing a play.

**[0093]** In the spindle unit 35 of the present embodiment, the spring section 183 functions as an elastic member that generates an elastic restoring force.

**[0094]** Accordingly, the tip-end portion 30 of the spindle 24 can be displaced to one side with a stable force from the elastic member. Therefore, the position of the tip-end portion 30 of the spindle 24 can be reliably stabilized.

**[0095]** The spindle unit 35 of the present embodiment includes the receiving rubber 65 provided between the spindle 24 and the holder main body 152 and adapted to generate a force against a movement of the spindle 24.

**[0096]** Accordingly, the movement of the spindle 24 can be restricted by the receiving rubber 65, and the position of the tip-end portion 30 of the spindle 24 can be reliably stabilized.

**[0097]** In the spindle unit 35 of the present embodiment, the receiving rubber 65 is a member capable of being elastically deformed.

**[0098]** Accordingly, even if the spindle 24 tends to move by the influence of vibration and the like, the momentum at which the spindle 24 tends to move can be absorbed by the elastic deformation of the receiving rubber 65. As a result, the position of the tip-end portion 30 of the spindle 24 can be reliably stabilized.

**[0099]** In the spindle unit 35 of the present embodiment, the receiving rubber 65 includes the first ring portion 66 and the second ring portion 67, as well as the third ring portion 68. The first ring portion 66 and the second ring portion 67 are adapted to restrict a movement of the spindle 24 in a direction substantially perpendicular to the travelling direction (radial direction) of the fiber bundle 8. The third ring portion 68 is adapted to restrict a movement of the spindle 24 in a direction substantially parallel to the travelling direction (axial direction) of the fiber bundle 8.

**[0100]** Accordingly, the excessive fluttering of the spindle 24 can be effectively prevented.

**[0101]** In the spindle unit 35 of the present embodiment, the spindle 24 and the receiving rubber 65 are pro-

vided detachably with respect to the holder main body 152. The first ring portion 66, the second ring portion 67, and the third ring portion 68 of the receiving rubber 65 are all provided capable of making contact with the holder main body 152. Between the first ring portion 66 and the second ring portion 67, the receiving rubber 65 includes a concave (ring-shaped groove) to form a gap with respect to the holder main body 152.

**[0102]** Accordingly, the contacting area between the receiving rubber 65 and the holder main body 152 can be reduced by the amount of the concave, whereby the receiving rubber 65 can be easily attached or detached with respect to the holder main body 152.

**[0103]** In the spindle unit 35 of the present embodiment, the receiving rubber 65 is provided in a ring-shape entirely around an outer peripheral surface of the spindle 24.

**[0104]** Accordingly, the fluttering of the spindle 24 in the radial direction can be satisfactorily and reliably suppressed.

**[0105]** The spindle unit 35 of the present embodiment includes the push button section 182 adapted to decouple by one-action the state in which the spindle 24 is mechanically coupled with the holder main body 152 via the lock member 153.

**[0106]** Accordingly, the spindle 24 can be detached from the holder main body 152 by a simple operation of merely pushing the push button section 182.

**[0107]** The spinning device 9 of the present embodiment includes the spindle unit 35, the needle holder 25, the spindle arm 92, the first positioning surface 97, the second positioning surface 98, and the nozzle block 26. The needle holder 25 is provided to face the spindle 24 and adapted to guide the fiber bundle 8 to the fiber passage 85. The spindle arm 92 is adapted to support the spindle 24, and to enable switching between the normal state (FIG. 3) in which the spindle 24 is located close to the needle holder 25 and the maintenance state (FIG. 5) in which the spindle 24 is located away from the needle holder 25. The first positioning surface 97 and the second positioning surface 98 are adapted to position the tip-end portion 30 of the spindle 24 under the normal state with respect to the needle holder 25. The nozzle block 26 is adapted to form the spinning chamber 31 between the nozzle block 26 and the spindle 24 under the normal state (FIG. 3), and to inject compressed air from the nozzle hole (hole of the whirling airflow generating nozzle 41) that opens into the spinning chamber 31 to generate whirling airflow to be acted upon the fiber bundle 8 in the spinning chamber 31.

**[0108]** Accordingly, the holder main body 152 can hold the spindle 24 with the position of the tip-end portion 30 of the spindle 24 having a certain degree of freedom of movement under the maintenance state (FIG. 5). On the other hand, under the normal state (FIG. 3), the spindle 24 is positioned by the first positioning surface 97 and the second positioning surface 98. Accordingly, the tip-end portion 30 of the spindle 24 can be accurately posi-

tioned with respect to the needle holder 25, and the quality of the spun yarn 10 can be improved.

**[0109]** In the spinning device 9 of the present embodiment, by moving at least one of the spindle 24 and the needle holder 25 so that the spindle 24 moves in an arcuate path with respect to the needle holder 25, the spindle arm 92 can be switched between the normal state (FIG. 3) and the maintenance state (FIG. 5). The spring section 183 is adapted to generate a force to act upon the lower part of the spindle 24 (the inserting portion 170) to displace the tip-end portion 30 of the spindle 24 within the movable range to approach a center of the arcuate path (i.e., the swing shaft 93 illustrated in FIG. 2).

**[0110]** Accordingly, with the movement of the spindle 24 in the arcuate path with respect to the needle holder 25 when switching between the normal state and the maintenance state, the spindle 24 can be smoothly moved without the tip-end portion 30 of the spindle 24 interfering with other members.

**[0111]** In the spinning device 9 of the present embodiment, the inner bottom surface of the accommodation concave 160 of the holder main body 152 is provided as the supporting surface to support the spindle 24 from a base-end portion substantially at a prescribed inclination angle. The holder main body 152 (the holder attachment 151) can be replaced with another holder main body 152 having the supporting surface with a different inclination angle.

**[0112]** Accordingly, various layouts of the spindle 24 demanded in the spinning device 9 can be easily realized.

**[0113]** The fine spinning machine 1 of the present embodiment includes the above-described spinning device 9, and the winding device 13. The winding device 13 is adapted to wind the spun yarn 10, which has been spun by the spinning device 9, into the package 45.

**[0114]** Accordingly, the fine spinning machine 1 is provided in which the replacement operation of the spindle 24 is easy and the package 45 of a high quality spun yarn 10 can be obtained.

**[0115]** Preferred embodiments of the present invention have been described above, but the structures described above can be modified as below.

**[0116]** In the lock member 153, the push button section 182 may be changed to a structure including a lever or the like capable of a pulling operation.

**[0117]** In place of the needle holder 25, a member without the needle 28 (e.g., a block-shaped member formed with the guiding hole 27) may be adopted for the fiber guiding section.

**[0118]** At a position located downstream of the spinning device 9, in place of the yarn slack eliminating device 12 or in addition to the yarn slack eliminating device 12, a delivery roller to be rotationally driven and a nip roller to be pushed against the delivery roller may be arranged, and the spun yarn 10 can be sandwiched between the delivery roller and the nip roller to be fed downstream.

**[0119]** In the embodiments described above, the spring section 183 and the push button section 182 are

integrally formed with the lock member 153, but the spring section 183 and the push button section 182 may be separate members from the lock member 153. A spring made of metal and not synthetic resin (e.g., a coil spring or a plate spring) may be used in place of the spring section 183.

**[0120]** In the embodiments described above, the spindle 24 is attached to the holder attachment 151, which is attached to the tip-end of the spindle arm 92. However, the spindle 24 may be directly attached to the tip-end of the spindle arm 92.

**[0121]** In the embodiments described above, the switching between the normal state of FIG. 3 and the maintenance state of FIG. 5 is carried out by moving the spindle 24 with the swinging of the spindle arm 92. However, the switching between these states can be realized by moving the needle holder 25 side (the nozzle block 26 side) with the swinging of the nozzle supporting arm 91.

**[0122]** In the embodiments described above, the lock member 153, the push button section 182, the spring section 183, and the like are configured as one part of the holder attachment 151. However, the lock member 153, the push button section 182, and the like may be arranged on the spindle arm 92 side, and only the holder main body 152 may be attached to the spindle arm 92 in a replaceable manner.

**[0123]** In the embodiments described above, the needle holder 25 and the nozzle block 26 are separate components. However, the needle holder 25 and the nozzle block 26 may be formed as one component in which the fiber guiding section and the nozzle member are integrated.

## Claims

1. A hollow guide shaft unit for an air-jet spinning device comprising:

a hollow guide shaft body (24) including a tip-end portion (30) adapted to receive an insert of a twisted fiber bundle (8), and a fiber bundle passage (85) adapted to receive a passing of the fiber bundle (8) inserted from the tip-end portion (30);

a base section (152) adapted to support the hollow guide shaft body (24); and

a coupling section (153) adapted to mechanically couple the hollow guide shaft body (24) with the base section (152);

### characterized by

a displacement-force generating section (183) adapted to generate a force to act upon the hollow guide shaft body (24) so as to displace the tip-end portion (30) of the hollow guide shaft body (24) towards one side within a movable range under a state in which the hollow guide

- shaft body (24) is mechanically coupled with the base section (152) via the coupling section (153), the movable range being a range in which the tip-end portion (30) of the hollow guide shaft body (24) can be moved,
- wherein under the state in which the hollow guide shaft body (24) is mechanically coupled with the base section (152) via the coupling section (153), a play is formed around the hollow guide shaft body (24) to enable movement of the tip-end portion (30) of the hollow guide shaft body (24).
2. The hollow guide shaft unit according to claim 1, wherein the displacement-force generating section (183) is an elastic member that generates an elastic restoring force.
  3. The hollow guide shaft unit according to claim 1 or claim 2, further comprising a movement restricting section (65) provided between the hollow guide shaft body (24) and the base section (152) and adapted to generate a force against a movement of the hollow guide shaft body (24).
  4. The hollow guide shaft unit according to claim 3, wherein the movement restricting section (65) is capable of being elastically deformed.
  5. The hollow guide shaft unit according to claim 3 or claim 4, wherein the movement restricting section (65) includes:
    - a first restricting portion (66, 67) adapted to restrict a movement of the hollow guide shaft body (24) in a direction substantially perpendicular to the fiber bundle passage (85), and
    - a second restricting portion (68) adapted to restrict a movement of the hollow guide shaft body (24) in a direction substantially parallel to the fiber bundle passage (85).
  6. The hollow guide shaft unit according to claim 5, wherein the first restricting portion (66, 67) and the second restricting portion (68) are provided capable of making contact with the base section (152), the movement restricting section (65) includes a concave to form a gap between the movement restricting section (65) and the base section (152), and the hollow guide shaft body (24) and the movement restricting section (65) are provided detachably with respect to the base section (152).
  7. The hollow guide shaft unit according to any one of claim 3 through claim 6, wherein the movement restricting section (65) is provided entirely around an outer peripheral surface of the hollow guide shaft body (24).
  8. The hollow guide shaft unit according to any one of claim 1 through claim 7, further comprising a decoupling operation section (182) adapted to decouple by one-action the state in which the hollow guide shaft body (24) is mechanically coupled with the base section (152) via the coupling section (153).
  9. An air-jet spinning device comprising:
    - the hollow guide shaft unit (35) according to any one of claim 1 through claim 8; and
    - a nozzle member (26) adapted to form a spinning chamber (31) between the nozzle member (26) and the hollow guide shaft body (24), and to inject compressed air from at least one nozzle hole that opens into the spinning chamber (31) to generate whirling airflow in the spinning chamber (31) to be acted upon the fiber bundle (8).
  10. An air-jet spinning device according to claim 9, further comprising:
    - a fiber guiding section (25) provided to face the hollow guide shaft body (24) and adapted to guide the fiber bundle (8) to the fiber bundle passage (85);
    - a supporting section (92) adapted to support at least one of the fiber guiding section (25) and the hollow guide shaft body (24) and to enable switching between a first state in which the hollow guide shaft body (24) is located close to the fiber guiding section (25) and a second state in which the hollow guide shaft body (24) is located away from the fiber guiding section (25); and
    - a positioning section (97, 98) adapted to determine a position of the tip-end portion (30) of the hollow guide shaft body (24) under the first state with respect to the fiber guiding section (25); wherein the nozzle member (26) adapted to form a spinning chamber (31) between the nozzle member (26) and the hollow guide shaft body (24) under the first state.
  11. The air-jet spinning device according to claim 10, wherein the supporting section (92) is adapted to switch between the first state and the second state by moving at least one of the hollow guide shaft body (24) and the fiber guiding section (25) so that the hollow guide shaft moves in an arcuate path with respect to the fiber guiding section (25), and the displacement-force generating section (183) is adapted to generate a force to be applied to the hollow guide shaft body (24) to displace the tip-end portion (30) of the hollow guide shaft body (24) within the movable range to approach a center of the arcuate path.

12. The air-jet spinning device according to claim 10 or claim 11, wherein the base section (152) includes a supporting surface adapted to support the hollow guide shaft body (24) from a base-end portion at a prescribed inclination angle, and the base section (152) can be replaced with another base section (152) having the supporting surface with a different inclination angle.

13. A spinning machine comprising:

the air-jet spinning device (9) according to any one of claim 9 through claim 12; and a winding section (13) adapted to wind a spun yarn (10), which has been spun by the air-jet spinning device (9), into a package (45).

### Patentansprüche

1. Eine Hohle-Führungswelle-Einheit für eine Luftstrahl-Spinnvorrichtung, die folgende Merkmale aufweist:

einen Hohle-Führungswelle-Körper (24), der Folgendes umfasst: einen Spitzenendabschnitt (30), der angepasst ist, einen Einsatz eines verdrehten Faserbündels (8) aufzunehmen, und einen Faserbündeldurchgang (85), der angepasst ist, ein Durchlaufen des von dem Spitzenendabschnitt (30) aus eingesetzten Faserbündels (8) aufzunehmen;

ein Basissegment (152), das angepasst ist, den Hohle-Führungswelle-Körper (24) zu tragen; und

ein Koppelsegment (153), das angepasst ist, den Hohle-Führungswelle-Körper (24) mit dem Basissegment (152) mechanisch zu koppeln;

#### gekennzeichnet durch

ein Verschiebekraft-Erzeugungssegment (183), das angepasst ist, eine Kraft zu erzeugen, damit dieselbe auf den Hohle-Führungswelle-Körper (24) einwirkt, um den Spitzenendabschnitt (30) des Hohle-Führungswelle-Körpers (24) in einem Zustand, bei dem der Hohle-Führungswelle-Körper (24) mit dem Basissegment (152) über das Koppelsegment (153) mechanisch gekoppelt ist, zu einer Seite innerhalb eines bewegbaren Bereichs zu verschieben, wobei der bewegbare Bereich ein Bereich ist, in dem der spitze Endabschnitt (30) des Hohle-Führungswelle-Körpers (24) bewegt werden kann,

wobei in dem Zustand, bei dem der Hohle-Führungswelle-Körper (24) mit dem Basissegment (152) über das Koppelsegment (153) mechanisch gekoppelt ist, um den Hohle-Führungswelle-Körper (24) herum ein Spielraum dahin

gehend gebildet ist, dass eine Bewegung des Spitzenendabschnitts (30) des Hohle-Führungswelle-Körpers (24) ermöglicht wird.

2. Die Hohle-Führungswelle-Einheit gemäß Anspruch 1, bei der das Verschiebekraft-Erzeugungssegment (183) ein elastisches Bauglied ist, das eine elastische Rückstellkraft erzeugt.

3. Die Hohle-Führungswelle-Einheit gemäß Anspruch 1 oder Anspruch 2, die ferner ein Bewegungsbeschränkungssegment (65) aufweist, das zwischen dem Hohle-Führungswelle-Körper (24) und dem Basissegment (152) vorgesehen ist und angepasst ist, eine Kraft zu erzeugen, die einer Bewegung des Hohle-Führungswelle-Körpers (24) entgegenwirkt.

4. Die Hohle-Führungswelle-Einheit gemäß Anspruch 3, bei der das Bewegungsbeschränkungssegment (65) elastisch verformt werden kann.

5. Die Hohle-Führungswelle-Einheit gemäß Anspruch 3 oder Anspruch 4, bei der das Bewegungsbeschränkungssegment (65) Folgendes umfasst:

einen ersten Beschränkungsabschnitt (66, 67), der angepasst ist, eine Bewegung des Hohle-Führungswelle-Körpers (24) in einer Richtung, die im Wesentlichen senkrecht zu dem Faserbündeldurchgang (85) ist, zu beschränken, und einen zweiten Beschränkungsabschnitt (68), der angepasst ist, eine Bewegung des Hohle-Führungswelle-Körpers (24) in einer Richtung, die im Wesentlichen parallel zu dem Faserbündeldurchgang (85) ist, zu beschränken.

6. Die Hohle-Führungswelle-Einheit gemäß Anspruch 5, bei der der erste Beschränkungsabschnitt (66, 67) und der zweite Beschränkungsabschnitt (68) dahin gehend vorgesehen sind, dass sie mit dem Basissegment (152) einen Kontakt herstellen können, das Bewegungsbeschränkungssegment (65) eine Rundhohlung umfasst, um zwischen dem Bewegungsbeschränkungssegment (65) und dem Basissegment (152) einen Zwischenraum zu bilden, und der Hohle-Führungswelle-Körper (24) und das Bewegungsbeschränkungssegment (65) bezüglich des Basissegments (152) lösbar vorgesehen sind.

7. Die Hohle-Führungswelle-Einheit gemäß einem der Ansprüche 3 bis 6, bei der das Bewegungsbeschränkungssegment (65) vollständig um eine Außenumfangsoberfläche des Hohle-Führungswelle-Körpers (24) herum vorgesehen ist.

8. Die Hohle-Führungswelle-Einheit gemäß einem der Ansprüche 1 bis 7, die ferner ein Entkopplungsbetätigungssegment (182) aufweist, das angepasst ist,

durch eine Aktion den Zustand zu entkoppeln, bei dem der Hohle-Führungswelle-Körper (24) mit dem Basissegment (152) über das Koppelsegment (153) mechanisch gekoppelt ist.

9. Eine Luftstrahl-Spinnvorrichtung, die folgende Merkmale aufweist:

die Hohle-Führungswelle-Einheit (35) gemäß einem der Ansprüche 1 bis 8 und ein Düsenbauglied (26), das angepasst ist, eine Spinnkammer (31) zwischen dem Düsenbauglied (26) und dem Hohle-Führungswelle-Körper (24) zu bilden und von zumindest einem Düsenloch aus, das in die Spinnkammer (31) mündet, Druckluft zu injizieren, um in der Spinnkammer (31) einen Wirbelluftstrom zu erzeugen, der auf das Faserbündel (8) einwirken soll.

10. Eine Luftstrahl-Spinnvorrichtung gemäß Anspruch 9, die ferner folgende Merkmale aufweist:

ein Faserführungssegment (25), das dahin gehend vorgesehen ist, dass dasselbe dem Hohle-Führungswelle-Körper (24) zugewandt ist, und das angepasst ist, das Faserbündel (8) zu dem Faserbündeldurchgang (85) zu führen; ein Trägersegment (92), das angepasst ist, das Faserführungssegment (25) und/oder den Hohle-Führungswelle-Körper (24) zu tragen und ein Umschalten zwischen einem ersten Zustand, bei dem der Hohle-Führungswelle-Körper (24) sich in der Nähe des Faserführungssegments (25) befindet, und einem zweiten Zustand, bei dem der Hohle-Führungswelle-Körper (24) sich von dem Faserführungssegment (25) entfernt befindet, zu ermöglichen; und ein Positioniersegment (97, 98), das angepasst ist, in dem ersten Zustand eine Position des Spitzenendabschnitts (30) des Hohle-Führungswelle-Körpers (24) bezüglich des Faserführungssegments (25) zu bestimmen; wobei das Düsenbauglied (26) angepasst ist, in dem ersten Zustand eine Spinnkammer (31) zwischen dem Düsenbauglied (26) und dem Hohle-Führungswelle-Körper (24) zu bilden.

11. Die Luftstrahl-Spinnvorrichtung gemäß Anspruch 10, bei der das Trägersegment (92) angepasst ist, zwischen dem ersten Zustand und dem zweiten Zustand umzuschalten, indem der Hohle-Führungswelle-Körper (24) und/oder das Faserführungssegment (25) so bewegt werden, dass die Hohle-Führungswelle sich bezüglich des Faserführungssegments (25) in einem bogenförmigen Weg bewegt, und das Verschiebekraft-Erzeugungssegment (183) angepasst ist, eine auf den Hohle-Führungswelle-Körper (24) anzuwendende Kraft zu erzeugen, um den Spitzenendabschnitt (30) des Hohle-Führungswelle-Körpers (24) innerhalb des bewegbaren Bereichs dahin gehend zu verschieben, dass derselbe einem Mittelpunkt des bogenförmigen Wegs nahekommt.

per (24) anzuwendende Kraft zu erzeugen, um den Spitzenendabschnitt (30) des Hohle-Führungswelle-Körpers (24) innerhalb des bewegbaren Bereichs dahin gehend zu verschieben, dass derselbe einem Mittelpunkt des bogenförmigen Wegs nahekommt.

12. Die Luftstrahl-Spinnvorrichtung gemäß Anspruch 10 oder Anspruch 11, bei der das Basissegment (152) eine Trägeroberfläche umfasst, die angepasst ist, den Hohle-Führungswelle-Körper (24) von einem Basisendabschnitt aus mit einem vorgeschriebenen Neigungswinkel zu tragen, und das Basissegment (152) durch ein anderes Basissegment (152) ersetzt werden kann, das die Trägeroberfläche mit einem anderen Neigungswinkel aufweist.

13. Eine Spinnmaschine, die folgende Merkmale aufweist:

die Luftstrahl-Spinnvorrichtung (9) gemäß einem der Ansprüche 8 bis 12 und ein Wickelsegment (13), das angepasst ist, ein gesponnenes Garn (10), das durch die Luftstrahl-Spinnvorrichtung (9) gesponnen wurde, in einen Wickelkörper (45) zu wickeln.

## Revendications

1. Unité d'arbre de guidage creux pour un dispositif de filage à jet d'air, comprenant:

un corps d'arbre de guidage creux (24) comportant une partie d'extrémité de pointe (30) adaptée pour recevoir un insert d'un faisceau de fibres torsadées (8) et un passage de faisceau de fibres (85) adapté pour recevoir un passage du faisceau de fibres (8) inséré depuis la partie d'extrémité (30);

un segment de base (152) adapté pour supporter le corps d'arbre de guidage creux (24); et un segment de couplage (153) adapté pour coupler mécaniquement le corps d'arbre de guidage creux (24) au segment de base (152);

### caractérisée par

un segment de génération de force de déplacement (183) adapté pour générer une force destinée à agir sur le corps d'arbre de guidage creux (24) de manière à déplacer la partie d'extrémité de pointe (30) du corps d'arbre de guidage creux (24) vers un côté dans une plage mobile dans un état où le corps d'arbre de guidage creux (24) est couplé mécaniquement au segment de base (152) par l'intermédiaire du segment de couplage (153), la plage mobile étant une plage dans laquelle peut être déplacée la partie d'extrémité de pointe (30) du corps d'arbre de guidage creux

- (24),  
dans lequel, à l'état où le corps d'arbre de guidage creux (24) est couplé mécaniquement au segment de base (152) par l'intermédiaire du segment de couplage (153), un jeu est formé autour du corps d'arbre de guidage creux (24) pour permettre le mouvement de la partie d'extrémité de pointe (30) du corps d'arbre de guidage creux (24).
2. Unité d'arbre de guidage creux selon la revendication 1, dans laquelle le segment de génération de force de déplacement (183) est un élément élastique qui génère une force de rappel élastique.
  3. Unité d'arbre de guidage creux selon la revendication 1 ou la revendication 2, comprenant par ailleurs un segment de limitation de mouvement (65) prévu entre le corps d'arbre de guidage creux (24) et le segment de base (152) et adapté pour générer une force opposée à un mouvement du corps d'arbre de guidage creux (24).
  4. Unité d'arbre de guidage creux selon la revendication 3, dans laquelle le segment de limitation de mouvement (65) peut être déformé élastiquement.
  5. Unité d'arbre de guidage creux selon la revendication 3 ou la revendication 4, dans laquelle le segment de limitation de mouvement (65) comporte:
    - une première partie de limitation (66, 67) adaptée pour limiter un mouvement du corps d'arbre de guidage creux (24) dans une direction sensiblement perpendiculaire au passage de faisceau de fibres (85), et
    - une deuxième partie de limitation (68) adaptée pour limiter un mouvement du corps d'arbre de guidage creux (24) dans une direction sensiblement parallèle au passage de faisceau de fibres (85).
  6. Unité d'arbre de guidage creux selon la revendication 5, dans laquelle la première partie de limitation (66, 67) et la deuxième partie de limitation (68) sont prévues à même d'entrer en contact avec le segment de base (152), le segment de limitation de mouvement (65) comporte une partie concave destinée à former un interstice entre le segment de limitation de mouvement (65) et le segment de base (152), et le corps d'arbre de guidage creux (24) et le segment de limitation de mouvement (65) sont prévus amovibles par rapport au segment de base (152).
  7. Unité d'arbre de guidage creux selon l'une quelconque de la revendication 3 à la revendication 6, dans laquelle le segment de limitation de mouvement (65)
- est prévu entièrement autour d'une surface périphérique extérieure du corps d'arbre de guidage creux (24).
8. Unité d'arbre de guidage creux selon l'une quelconque de la revendication 1 à la revendication 7, comprenant par ailleurs un segment d'opération de découplage (182) adapté pour découpler par une action l'état où le corps d'arbre de guidage creux (24) est couplé mécaniquement au segment de base (152) par l'intermédiaire du segment de couplage (153).
  9. Dispositif de filage à jet d'air, comprenant:
    - l'unité d'arbre de guidage creux (35) selon l'une quelconque de la revendication 1 à la revendication 8; et
    - un élément de buse (26) adapté pour former une chambre de filage (31) entre l'élément de buse (26) et le corps d'arbre de guidage creux (24), et pour injecter de l'air comprimé depuis au moins un trou de buse qui débouche dans la chambre de filage (31) pour générer un flux d'air tourbillonnant dans la chambre de filage (31) destiné à agir sur le faisceau de fibres (8).
  10. Dispositif de filage à jet d'air selon la revendication 9, comprenant par ailleurs:
    - un segment de guidage de fibres (25) prévu de manière à faire face au corps d'arbre de guidage creux (24) et adapté pour guider le faisceau de fibres (8) vers le passage de faisceau de fibres (85);
    - un segment de support (92) adapté pour supporter au moins l'un parmi le segment de guidage de fibres (25) et le corps d'arbre de guidage creux (24) et pour permettre de commuter entre un premier état où le corps d'arbre de guidage creux (24) est situé à proximité du segment de guidage de fibres (25) et un deuxième état où le corps d'arbre de guidage creux (24) est situé éloigné du segment de guidage de fibres (25); et
    - un segment de positionnement (97, 98) adapté pour déterminer une position de la partie d'extrémité de pointe (30) du corps d'arbre de guidage creux (24) dans le premier état par rapport au segment de guidage de fibres (25); dans lequel l'élément de buse (26) est adapté pour former une chambre de filage (31) entre l'élément de buse (26) et le corps d'arbre de guidage creux (24) dans le premier état.
  11. Dispositif de filage à jet d'air selon la revendication 10, dans lequel le segment de support (92) est adapté pour commuter entre le premier état et le deuxième état en déplaçant au moins l'un parmi le corps

d'arbre de guidage creux (24) et le segment de guidage de fibres (25) de sorte que l'arbre de guidage creux se déplace selon un trajet arqué par rapport au segment de guidage de fibres (25), et le segment de génération de force de déplacement (183) est adapté pour générer une force à appliquer sur le corps d'arbre de guidage creux (24) pour déplacer la partie d'extrémité de pointe (30) du corps d'arbre de guidage creux (24) dans la plage mobile de manière à se rapprocher d'un centre du trajet arqué.

12. Dispositif de filage à jet d'air selon la revendication 10 ou la revendication 11, dans lequel le segment de base (152) comporte une surface de support adaptée pour supporter le corps d'arbre de guidage creux (24) depuis une partie d'extrémité de base selon un angle d'inclinaison prescrit, et le segment de base (152) peut être remplacé par un autre segment de base (152) présentant la surface de support avec un angle d'inclinaison différent.

13. Machine à filer, comprenant:

le dispositif de filage à jet d'air (9) selon l'une quelconque de la revendication 9 à la revendication 12, et un segment d'enroulement (13) adapté pour enrouler un fil filé (10) qui a été filé par le dispositif de filage à jet d'air (9) pour former un paquet (45).

35

40

45

50

55



FIG. 1

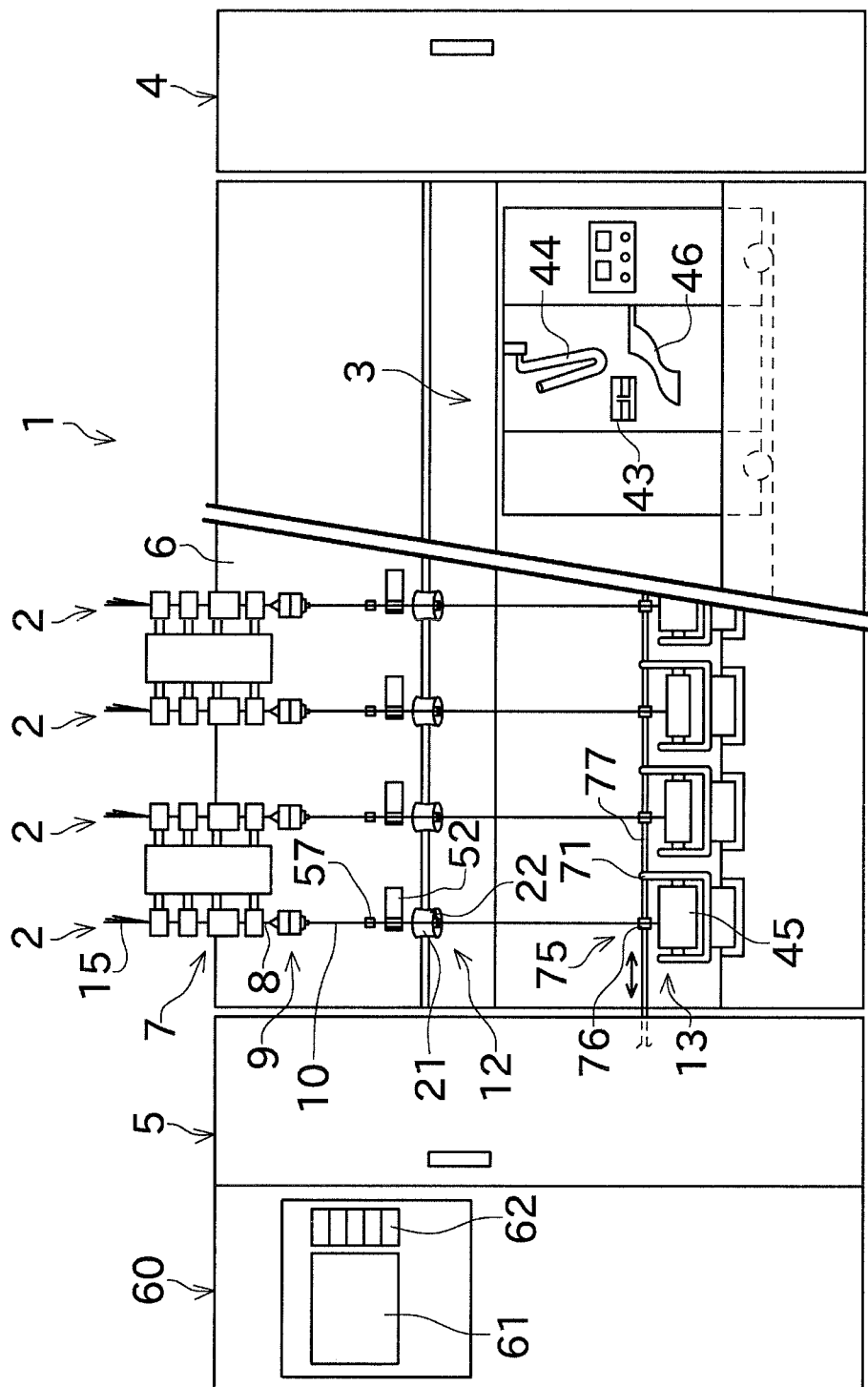

FIG. 2

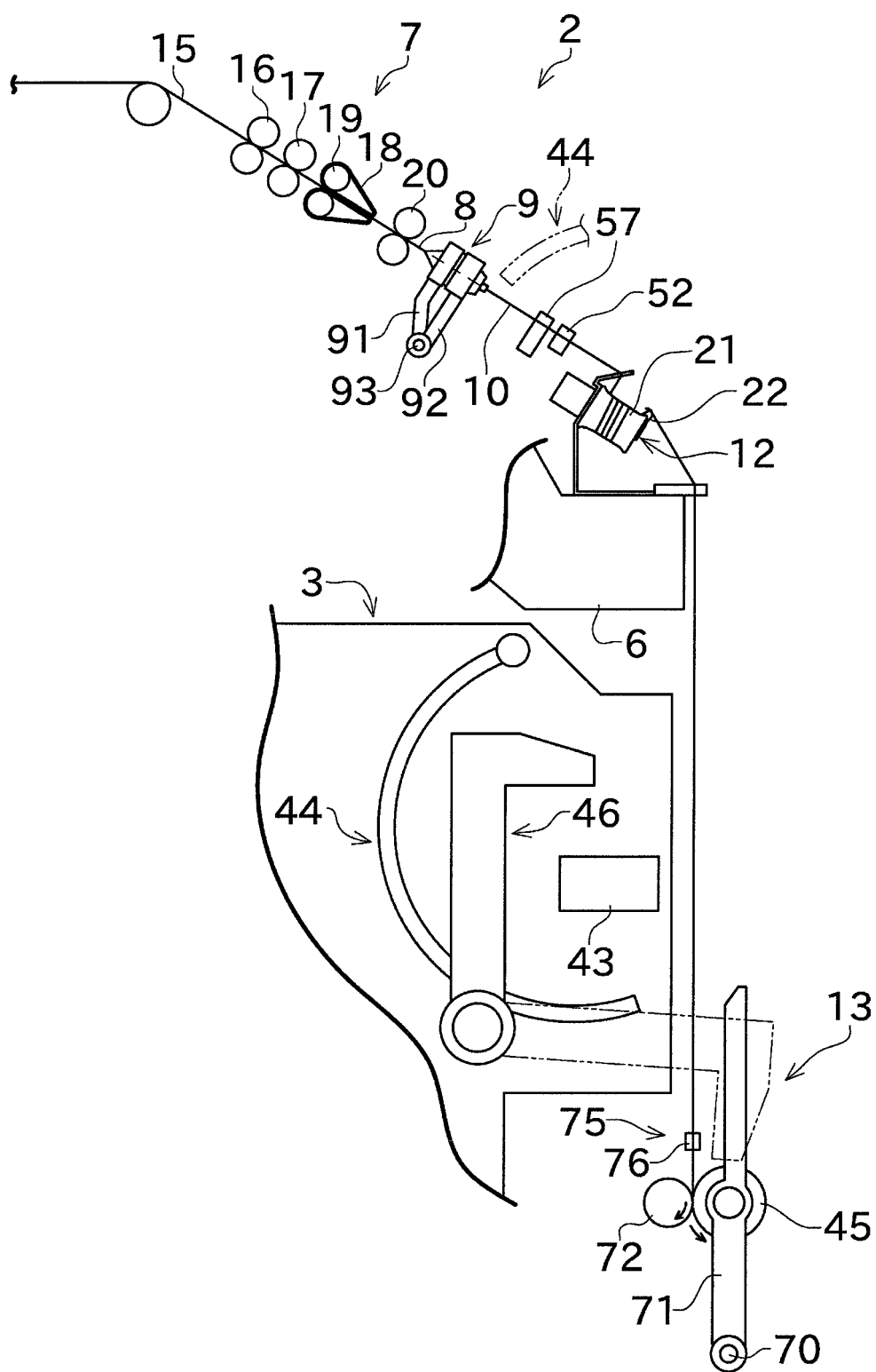

FIG. 3

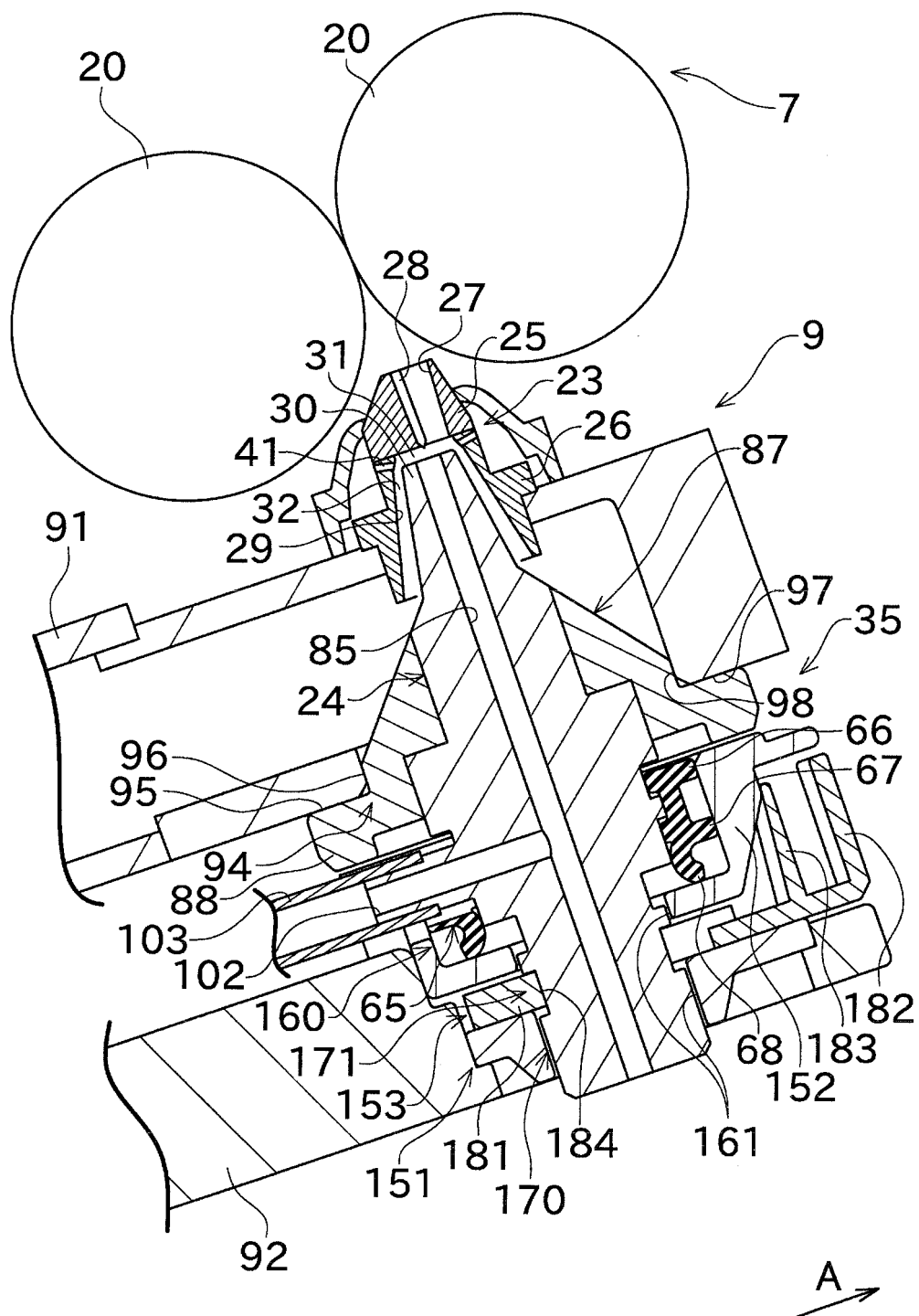

FIG. 4

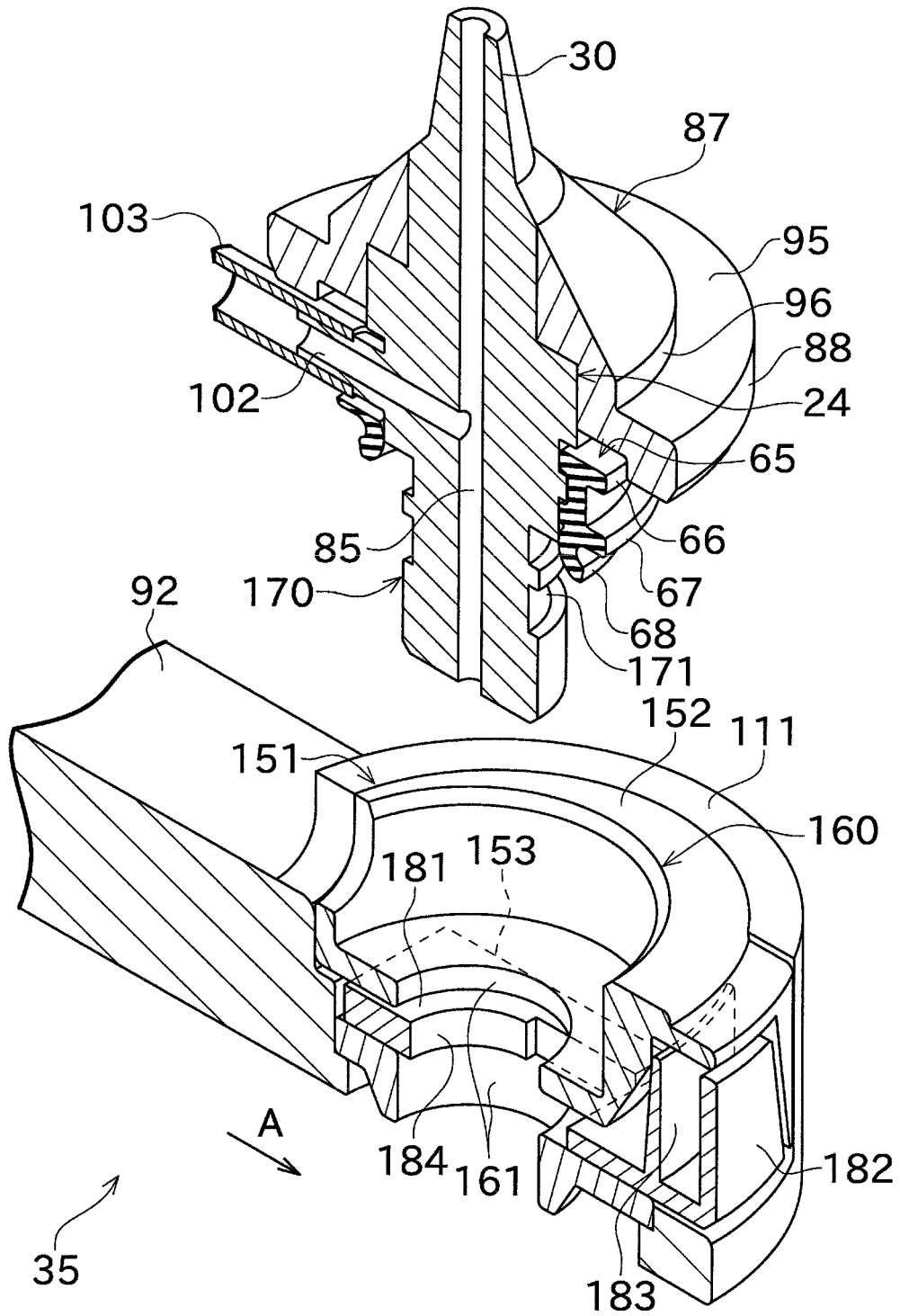
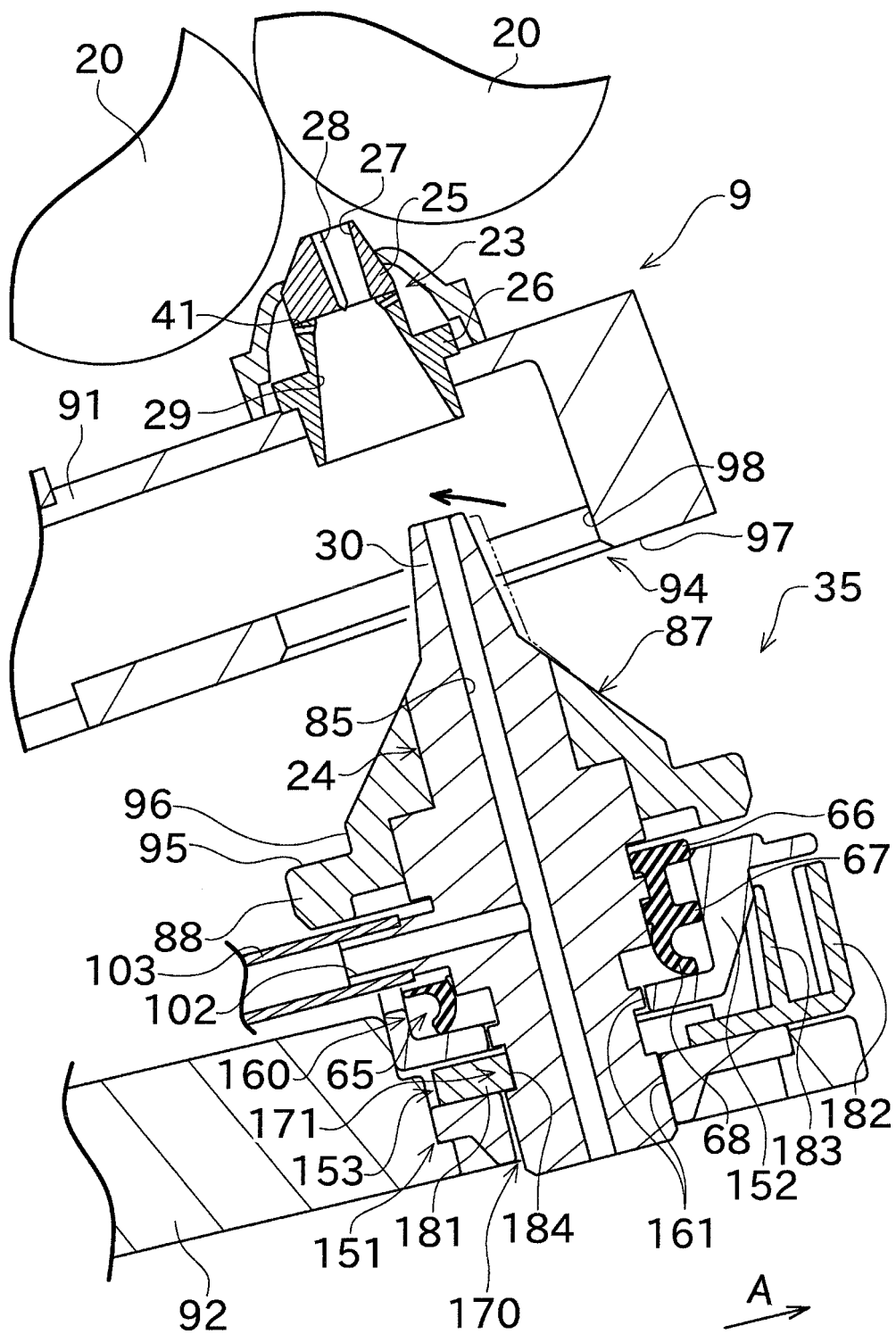

FIG. 5



**REFERENCES CITED IN THE DESCRIPTION**

*This list of references cited by the applicant is for the reader's convenience only. It does not form part of the European patent document. Even though great care has been taken in compiling the references, errors or omissions cannot be excluded and the EPO disclaims all liability in this regard.*

**Patent documents cited in the description**

- JP 7126924 A [0002] [0007]
- JP 2011038210 A [0003]