

(19)



Europäisches Patentamt
European Patent Office
Office européen des brevets



(11)

EP 0 692 055 B1

(12)

EUROPEAN PATENT SPECIFICATION

(45) Date of publication and mention
of the grant of the patent:

04.02.1998 Bulletin 1998/06

(21) Application number: **94912101.6**

(22) Date of filing: **25.03.1994**

(51) Int Cl.⁶: **E04G 1/26**, E04G 21/28

(86) International application number:
PCT/NO94/00069

(87) International publication number:
WO 94/23153 (13.10.1994 Gazette 1994/23)

(54) **A DEVICE FOR ATTACHING CLOTH TO A SCAFFOLD**

VORRICHTUNG ZUM ANBRINGEN VON STOFF AN EINEM GERÜST

DISPOSITIF DE FIXATION D'UNE TOILE A UN ECHAFAUDAGE

(84) Designated Contracting States:
BE DE DK FR GB IE NL SE

(30) Priority: **29.03.1993 NO 931161**

(43) Date of publication of application:
17.01.1996 Bulletin 1996/03

(73) Proprietor: **Malthus Bygg & Maskin AS**
N-4033 Forus (NO)

(72) Inventor: **MAASEIDE, Reidar**
N-4300 Sandnes (NO)

(74) Representative: **Wagner, Karl Heinz**
H. Wagner & Co. AB
Norra Vallgatan 72
211 22 Malmö (SE)

(56) References cited:
WO-A-86/03538 **DE-A- 2 217 826**
NO-B- 117 878 **US-A- 3 121 470**
US-A- 5 038 889

EP 0 692 055 B1

Note: Within nine months from the publication of the mention of the grant of the European patent, any person may give notice to the European Patent Office of opposition to the European patent granted. Notice of opposition shall be filed in a written reasoned statement. It shall not be deemed to have been filed until the opposition fee has been paid. (Art. 99(1) European Patent Convention).

Description

The invention relates to a device for attaching a cloth to a scaffold for screening purposes, said device comprising a rail, provided with a longitudinal open groove, and means for attaching said rail to a stay or spire of said scaffold, said cloth being provided with at least one leech adapted to be passed into a longitudinal open groove of said rail.

It is usual to case a scaffold with cloth or tarpaulin in order to give shelter against wind and rain, but also to prevent undesired scattering of materials from pending works, e.g. in connection with sandblasting and spray painting.

It is known to use tarpaulins having loops or grommets and holes and being lashed to the scaffold with rope. A disadvantage of this known attachment method is that power concentration will arise adjacent the loops, so that the cloth breaks upon extra strains such as wind. Additionally, it is relatively time-consuming to mount the cloth.

DE-A-2 217 826 discloses a device for attaching a cloth to a scaffold, the cloth comprising a leech or the like extending along the side edges of the cloth, said leech being adapted to be passed into a longitudinal open groove of said rail. Further, attaching said rail to a stay or spire of said scaffold is previously known per se.

The object of the present invention is to provide a device of the kind defined in the introduction comprising efficient, adjustable attachment means including a non-rotatable fastener for the real attachment means of the rail.

The object is achieved through a combination of the features defined introductorily as well as in the preamble of claim 1 and the following features constituting the characterizing clause of claim 1: that the attaching means incorporates a screw and in that the rail has a further longitudinal open groove adapted to receive the head of said screw and to prevent the screw from rotating, simultaneously as the screw head may be passed freely along said further longitudinal open groove.

Preferably, the attaching means further comprises a clamp adapted to be attached to the rail by means of the screw and further adapted to grip around a stay or spire of the scaffold, in order to attach the rail to the scaffold.

An embodiment of the invention is described with reference to the attached drawings, wherein:

Figure 1 shows an end view of a stay or spire of a scaffold, having a fastener for cloth;

Figure 2 shows in perspective a corner of a cloth partially in engagement with a fastening device;

Figure 3 shows, seen from behind, a scaffold, wherein two sections are covered with cloth;

Figure 4 shows, seen from the end and partially in section, a horizontal profile attached to the lower edge of a cloth and to the upper edge of another cloth.

In figure 1, reference numeral 1 denotes a tubular spire of a scaffold. A clamp 2 adapted to be attached to the spire 1, is fastened to a rail 3 having a screw 4. The rail 3 is provided with a longitudinal open groove 5 adapted to receive the head of the screw 4, whereby the screw 4 may be moved freely along the rail 3. Firstly, the screw 4 is screwed into a threaded portion within the clamp 2, and the head thereof is passed into the groove. The clamp 2 is passed to desired position along the rail 3, the screw's 4 head being within the groove 5. The clamp 2 is screwed firmly to the rail 3 through turning the clamp 2 around the axis of the screw 4. An appropriate number of clamps are attached to the rail 3 in the way described and, then, the rail 3 is attached to the spire 1 of the scaffold by means of said clamps.

Two open grooves 6, 7 in the rail 3 are adapted to receive a leech 9 on a cloth 8, such as shown in figure 2. The leech 9 may be made through making a guide for a rope at the edge of the cloth 8, possibly by sewing on a rope to the cloth 8. The leech 9 may also be made from a particular edge piece, preferably of plastic, fastened to the cloth 8 along the edge thereof. The shape of the grooves 6, 7 in the rail 3 must be adapted to the profile of the leech. The clamp 2 may advantageously be constituted by half a clamp of the type ordinarily used when assembling the scaffold itself.

In each corner of the cloth 8 it may advantageously exist a hole 10 for attaching a rope, not shown, or a hoisting device, not shown, which is used in order to pull the cloth 8 up along the rail 3 after the leech 9 of the side edges is passed into the lower end of the open groove 6 or 7 of the rail 3. Lowermost, on the horizontal leech of the cloth 8, a rail 3 may be mounted, keeping the cloth 8 stretched, either by its own weight or by means of spring devices 11, which are fastened to the ground or to the framework of the scaffold.

Rails 3 are attached by means of clamps 2 to and along spires 1 of a scaffold, such as shown in figure 3. Cloth 8 having a width adapted to the distance between two spires are passed with one leech engaging into the groove 6 in a vertical rail 3, the leech on the opposite edge of cloth 8 being passed into engagement with the groove 7 in another rail 3 located on a neighbour spire. The cloth 8 is pulled into place by means of ropes attached to the cloth 8 in hole 10.

In order to keep the cloth 8 stretched, a rail 3 may also be attached to the horizontal leech of the cloth 8 and fastened resiliently to the framework of the scaffold or to the ground. In figure 4, a rail 3 is attached on the lower horizontal leech of a cloth 8, and a screw 4 within the groove 5 transfers a force from a spring device 11 to the cloth 8, whereby the cloth 8 is kept tight. The spring device 11 will keep the cloth 8 suitably stretched.

Lowermost, against the ground, it may advantageously be mounted a cloth 12, which is attached to the rail 3 by means of an upper horizontal leech and, which at the lower edge thereof is provided with a hem 13, into which is threaded a pipe 14 of metal as weight. Should the cloth 12 be too long, the remaining portion is rolled onto the pipe 14, the roll being laid on the ground. Thereby, a screening of the scaffold entirely down to the ground is achieved.

Claims

1. A device for attaching a cloth (8) to a scaffold for screening purposes, said device comprising a rail (3), provided with a longitudinal open groove (6, 7), and means for attaching said rail (3) to a stay or spire (1) of said scaffold, said cloth (8) being provided with at least one leech (9) adapted to be passed into a longitudinal open groove (6, 7) of said rail (3),
characterized in that the attaching means incorporates a screw (4) and in that the rail (3) has a further longitudinal open groove (5) adapted to receive the head of said screw (4) and to prevent the screw from rotating, simultaneously as the screw head may be passed freely along said further longitudinal open groove (5).
2. A device as set forth in claim 1,
characterized in that the attaching means further comprises a clamp (2) adapted to be attached to the rail (3) by means of the screw (4) and further adapted to grip around a stay or spire (1) of the scaffold, in order to attach the rail (3) to the scaffold.

Patentansprüche

1. Vorrichtung zum Anbringen von Gewebe (8) an einem Gerüst zum Zwecke des Abschirmens, wobei die Vorrichtung eine Schiene (3) mit einer längsverlaufenden offenen Rille (6, 7) und Befestigungsmittel zum Befestigen der Schiene (3) an einer Stütze oder einem Rohr (1) des genannten Gerüsts aufweist und das Gewebe (8) mindestens eine Verdickung (9) besitzt, die in eine längsverlaufende offene Rille (6, 7) der Schiene (3) eingeführt werden kann,
gekennzeichnet dadurch, dass das Befestigungsmittel eine Schraube (4) enthält und dass die Schiene (3) eine weitere längsverlaufende offene Rille (5) zur Aufnahme des Kopfes der genannten Schraube (4) und zur Verhinderung des Drehens der Schraube aufweist, wobei der Schraubenkopf in der genannten längsverlaufenden offenen Rille (5) gleichzeitig frei hin- und herbewegt werden kann.
2. Vorrichtung nach Anspruch 1,

gekennzeichnet dadurch, dass das Befestigungsmittel weiter eine Klammer (2) aufweist, die mit der Schraube (4) an der Schiene (3) befestigt werden kann und um eine Stütze oder einem Rohr (1) des Gerüsts greift, um die Schiene (3) am Gerüst zu befestigen.

Revendications

1. Un dispositif pour fixer une toile (8) à un échafaudage pour en faire un écran, ledit dispositif comprenant un rail (3) pourvu d'une rainure longitudinale (6, 7) et un moyen de fixation dudit rail (3) à un montant (1) dudit échafaudage, ladite toile (8) étant pourvue d'au moins une ralingue (9) conçue pour être introduite dans une rainure longitudinale (6, 7) dudit rail (3),
caractérisé en ce que le moyen de fixation comprend une vis (4) et en ce que le rail (3) possède encore une rainure longitudinale (5) conçue pour recevoir la tête de ladite vis (4) et pour empêcher la vis de tourner, tout en permettant à la tête de la vis de défiler librement le long de ladite rainure longitudinale (5).
2. Un dispositif selon la revendication 1,
caractérisé en ce que le moyen de fixation comprend en outre un crampon (2) conçu d'une part pour être fixé au rail (3) au moyen de la vis (4) et d'autre part pour saisir un montant (1) de l'échafaudage dans le but de fixer le rail (3) à l'échafaudage.

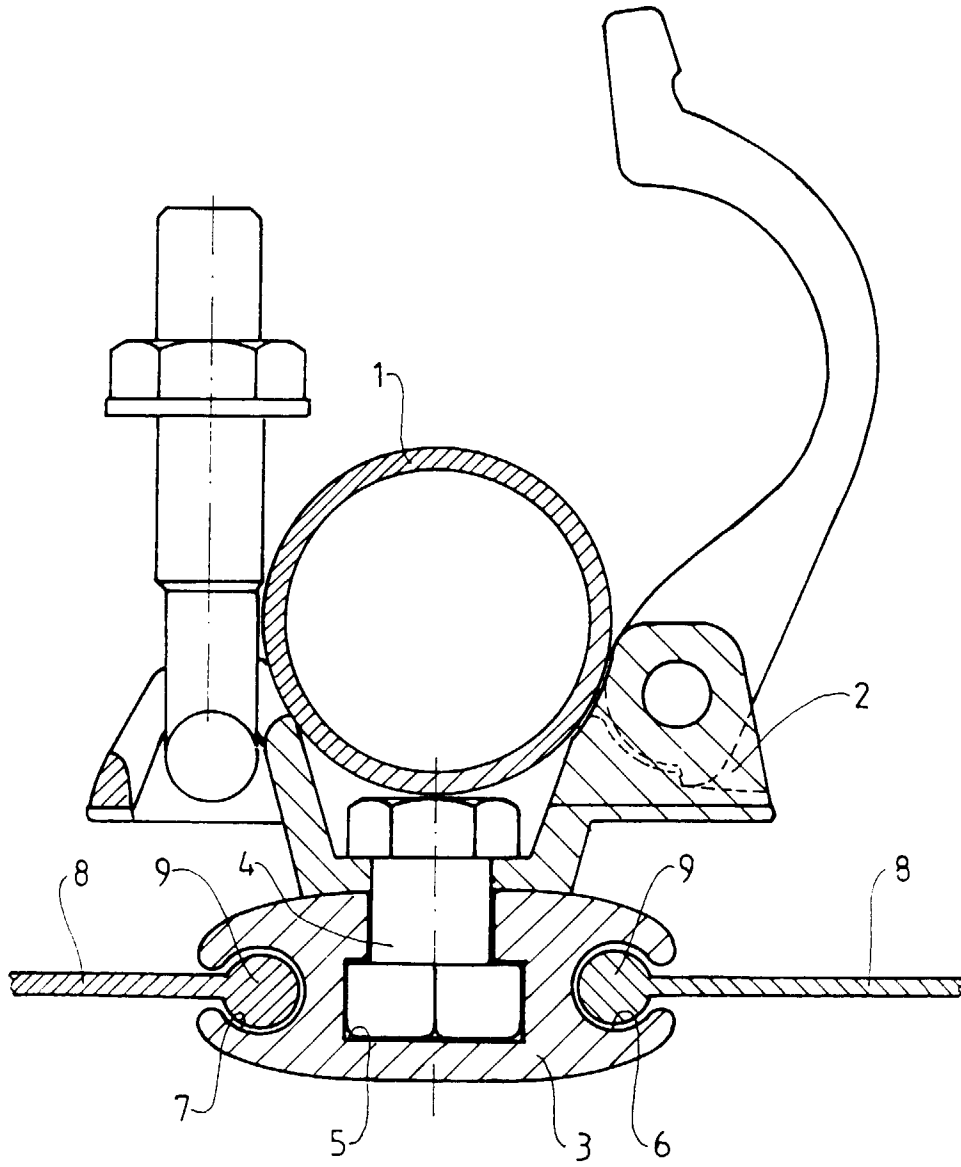

Fig.1

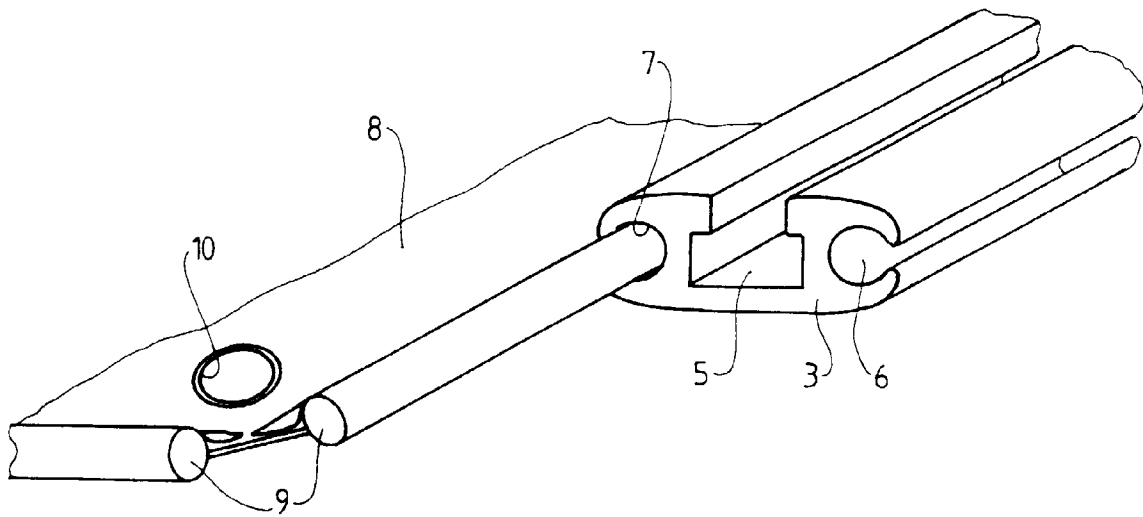

Fig. 2

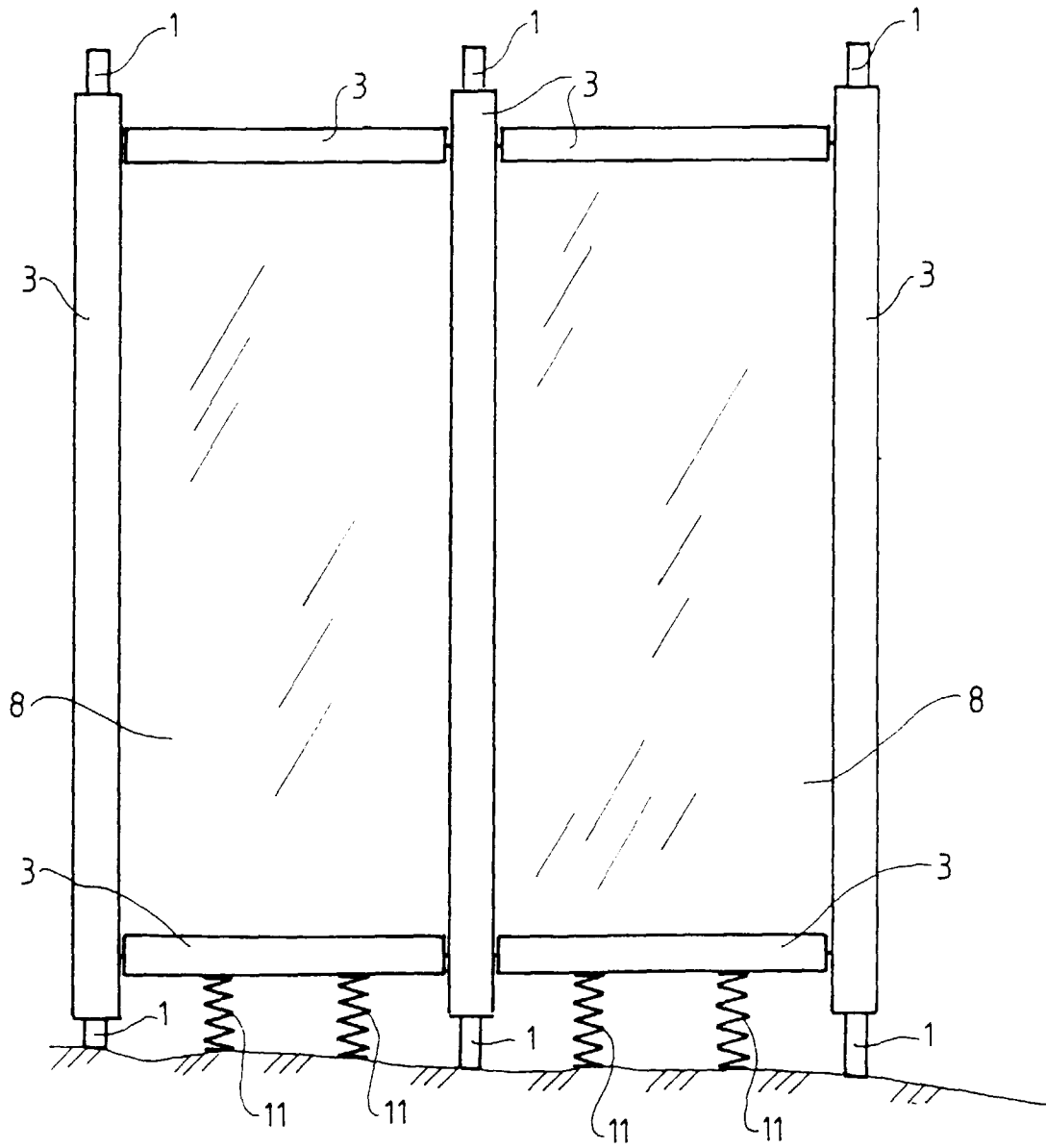

Fig. 3

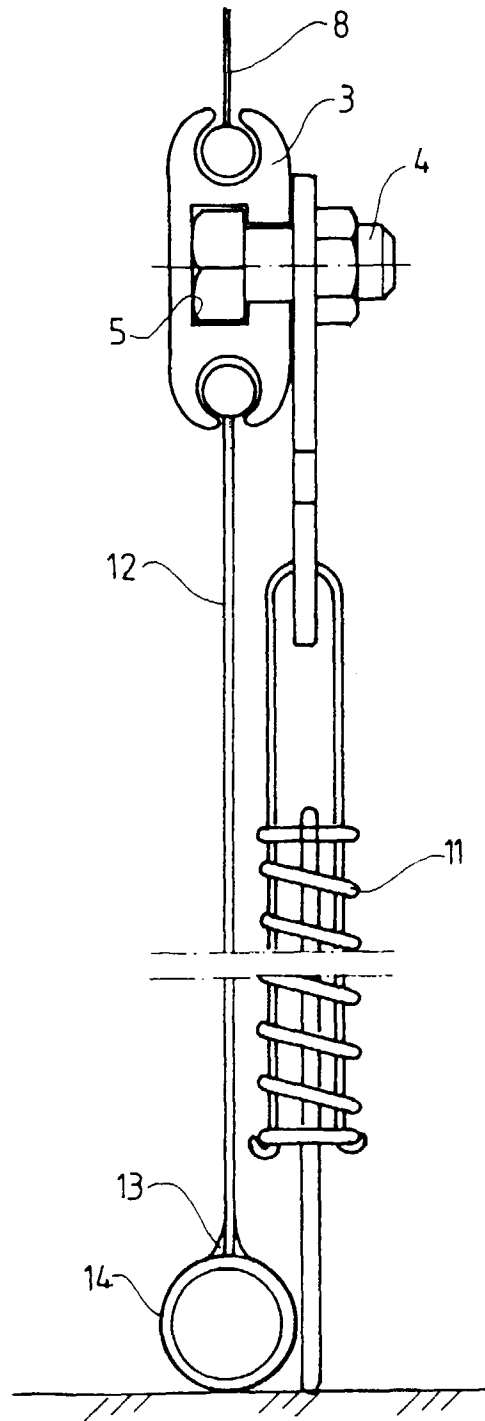

Fig.4