

(19) World Intellectual Property Organization
International Bureau



(43) International Publication Date
12 June 2008 (12.06.2008)

PCT

(10) International Publication Number
WO 2008/068756 A2

(51) International Patent Classification:
A61F 2/28 (2006.01)

(21) International Application Number:
PCT/IL2007/001503

(22) International Filing Date:
5 December 2007 (05.12.2007)

(25) Filing Language: English

(26) Publication Language: English

(30) Priority Data:
60/873,075 5 December 2006 (05.12.2006) US
60/902,146 16 February 2007 (16.02.2007) US
61/001,013 29 October 2007 (29.10.2007) US

(71) Applicant (for all designated States except US): **VAL-TECH CARDIO, LTD.** [IL/IL]; 6 Yoni Netanyahu Street, 60376 Or Yehuda (IL).

(72) Inventors; and

(75) Inventors/Applicants (for US only): **GROSS, Amir** [IL/IL]; 87 Hayarkon Street, 63432 Tel Aviv (IL). **BEINART, Iftah** [IL/IL]; 8 Yitzhak Ben-Tzvi Street, 45373 Hod Hasharon (IL). **ELIACHAR, Eliahu** [IL/IL];

25 Yefe Nof Street, 34371 Haifa (IL). **LILACH, Nir** [IL/IL]; 30063 Kfar Yehoshua (IL). **GROSSFELD, Ram** [IL/IL]; 4a Eitanim Street, 34384 Haifa (IL). **GOLOM, Dmitry** [IL/IL]; 15/3 Yair Stern Street, 35475 Haifa (IL). **MEYER-BRODNITZ, Gideon** [IL/IL]; 2 Hillel Street, 33073 Haifa (IL). **MOSAIUF, Arnon** [IL/IL]; Geva Carmel 75, POB 153, 30855 Geva Carmel (IL).

(74) Agents: **SANFORD T. COLB & CO.** et al.; P.O. Box 2273, 76122 Rehovot (IL).

(81) Designated States (unless otherwise indicated, for every kind of national protection available): AE, AG, AL, AM, AT, AU, AZ, BA, BB, BG, BH, BR, BW, BY, BZ, CA, CH, CN, CO, CR, CU, CZ, DE, DK, DM, DO, DZ, EC, EE, EG, ES, FI, GB, GD, GE, GH, GM, GT, HN, HR, HU, ID, IL, IN, IS, JP, KE, KG, KM, KN, KP, KR, KZ, LA, LC, LK, LR, LS, LT, LU, LY, MA, MD, ME, MG, MK, MN, MW, MX, MY, MZ, NA, NG, NI, NO, NZ, OM, PG, PH, PL, PT, RO, RS, RU, SC, SD, SE, SG, SK, SL, SM, SV, SY, TJ, TM, TN, TR, TT, TZ, UA, UG, US, UZ, VC, VN, ZA, ZM, ZW.

(84) Designated States (unless otherwise indicated, for every kind of regional protection available): ARIPO (BW, GH, GM, KE, LS, MW, MZ, NA, SD, SL, SZ, TZ, UG, ZM, ZW), Eurasian (AM, AZ, BY, KG, KZ, MD, RU, TJ, TM),

[Continued on next page]

(54) Title: SEGMENTED RING PLACEMENT

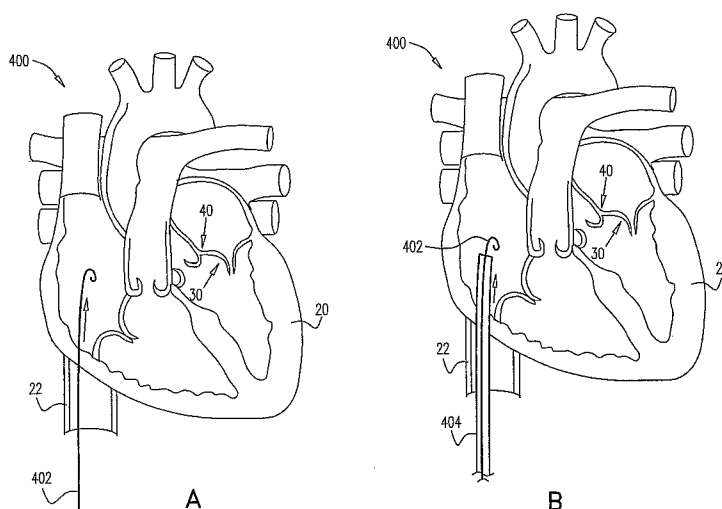

(57) Abstract: Apparatus is provided for repairing a valve (30) of a patient, the valve (30) including an annulus (40) and at least first and second leaflets (32 and 34). The apparatus includes at least a first discrete segment (430) and a second discrete segment (440) of an annuloplasty structure (408), each segment being shaped to provide a respective lateral wall (462), each lateral wall (462) being shaped to define at least one lumen of the respective segment (430 and 440). The apparatus further includes at least a first and a second control wire (480 and 490), each control wire (480 and 490) configured for sliding advancement through both the first and second segments (430 and 440). The first control wire (480) is configured to control a relative disposition of a first end (432) of the first segment (430) and a first end (442) of the second segment (440). The second control wire (490) is configured to control a relative disposition of a second end (434) of the first segment (430) and a second end (444) of the second segment (440). Other embodiments are also described.

WO 2008/068756 A2



European (AT, BE, BG, CH, CY, CZ, DE, DK, EE, ES, FI, FR, GB, GR, HU, IE, IS, IT, LT, LU, LV, MC, MT, NL, PL, PT, RO, SE, SI, SK, TR), OAPI (BF, BJ, CF, CG, CI, CM, GA, GN, GQ, GW, ML, MR, NE, SN, TD, TG).

Published:

— *without international search report and to be republished upon receipt of that report*

SEGMENTED RING PLACEMENT

CROSS-REFERENCES TO RELATED APPLICATIONS

This application is related to a US regular application to Gross et al., entitled, "Segmented ring placement," filed on even date herewith, and claims priority from:

5 (a) US Provisional Patent Application 60/873,075 to Gross et al., entitled, "Mitral valve closure techniques," filed December 5, 2006;

(b) US Provisional Patent Application 60/902,146 to Gross et al., entitled, "Mitral valve closure techniques," filed on February 16, 2007; and

10 (c) a US provisional patent application to Gross et al., entitled, "Segmented ring placement," filed October 29, 2007.

All of these applications are incorporated herein by reference.

FILED OF THE INVENTION

The present invention relates in general to valve repair. More specifically, the present invention relates to percutaneous repair of a mitral valve of a patient.

15 BACKGROUND OF THE INVENTION

Ischemic heart disease causes mitral regurgitation by the combination of ischemic dysfunction of the papillary muscles, and the dilatation of the left ventricle that is present in ischemic heart disease, with the subsequent displacement of the papillary muscles and the dilatation of the mitral valve annulus.

20 Stretching of the leaflets of the valve and of the associated chordae tendineae prevents the valve leaflets from fully coapting when the valve is closed, causing the valve leaflets to prolapse into the left atrium. Mitral regurgitation of blood from the left ventricle into the left atrium results in increased total stroke volume and decreased cardiac output, and ultimate weakening of the left ventricle secondary to a volume
25 overload and a pressure overload of the left atrium.

US Patent Application Publication 2005/0004668 to Aklog et al., which is incorporated herein by reference, describes implantable devices and methods for the repair of a defective cardiac valve. The implantable devices include an annuloplasty ring and a restraining and/or a remodeling structure or mechanism. The annuloplasty

ring functions to reestablish the normal size and shape of the annulus bringing the leaflets in proximity to each other. A device having a remodeling structure further facilitates remodeling of the valve but allows the use of a flexible ring. The restraining structure functions to restrain the abnormal motion of at least a portion of the valve being repaired. The restraining and remodeling structures may include at least one strut across the interior of the circumference of the ring.

US Patent Application Publication 2005/0171601 to Cosgrove, which is incorporated herein by reference, describes an annuloplasty repair segment and template for heart valve annulus repair. The elongate flexible template may form a distal part of a holder that also has a proximal handle. Alternatively, the template may be releasably attached to a mandrel that slides within a delivery sheath, the template being released from the end of the sheath to enable manipulation by a surgeon. A tether connecting the template and mandrel may also be provided. The template may be elastic, temperature responsive, or multiple linked segments. The template may be aligned with the handle and form a two- or three-dimensional curve out of alignment with the handle such that the annuloplasty repair segment attached thereto conforms to the curve. The template may be actively or passively converted between its straight and curved positions. The combined holder and ring are suited for minimally-invasive surgeries in which the combination is delivered to an implantation site through a small access incision with or without a cannula, or through a catheter passed through the patient's vasculature.

US Patent 6,569,198 to Wilson et al., which is incorporated herein by reference, describes an elongated member that includes distal and proximal segments separated by an intermediate segment. The prosthetic device has at least one anchor control wire to anchor the device in the blood vessel and at least one length control wire. A second preferred embodiment is an elongated member that includes distal and proximal segments that are connected by a pivot or hinge joint. A control wire is anchored on the distal segment and pivotally moves the distal and proximal segments closer together. Rotation of the length control wire of the first embodiment or the control wire of the second embodiment reduces the circumference of the valve annulus.

US Patent 6,102,945 to Campbell, which is incorporated herein by reference, describes a support ring for a natural human heart valve, including a first ring portion

having opposite terminal ends and a second ring portion having opposite terminal ends. An interconnector extends through and interconnects the first and second ring portions, to maintain the opposite terminal ends of the first ring portion adjacent the opposite terminal ends of the second ring portion, to form a segmented ring having a first and a second interface between the first and second ring portions. The first ring portion is of a greater length than the second ring portion. The ring portions are separable by severing the interconnector at the first and second interfaces, thus producing two variable size ring segments.

US Patent 6,217,610 to Carpentier et al., which is incorporated herein by reference, describes an expandable annuloplasty ring which may either expand spontaneously, in situ, as the patient grows or be expanded by surgical intervention by balloon dilatation. The distensible annuloplasty ring may be usable in pediatric patients whose growth, subsequent to surgical implantation of the ring, will necessitate subsequent enlargement of the ring to accommodate growth of the annulus. The ring may include relatively expandable segments to enable the enlargement thereof. The ring segments may include engaging teeth which cooperate with notches or slots formed in the tubes to provide some resistance to ring distention, while preventing collapse of the ring in the opposite direction. The teeth may be of different sizes or shapes to regulate the amount of force needed to expand the ring at different stages of the patient's growth. Alternatively, the adjustable ring includes a solid core of non-elastic material which plastically retains its shape upon natural expansion of the annulus, or after surgical expansion. In one embodiment, segments are coupled together with a discontinuity around the ring periphery. Pivot regions are provided between adjacent segments that, along with the discontinuity, enable the ring to expand upon annulus growth. The discontinuity may be positioned along the anterior side of the ring or around the posterior side. A further version makes use of telescoped segments with no discontinuity. The segments are coupled together with tubular sheaths, and expand without decoupling. A fabric covering may be omitted.

US Patent Application Publication 2003/0018358 to Saadat, which is incorporated herein by reference, describes techniques for thermally and/or mechanically treating tissue, such as valvular structures, to reconfigure or shrink the tissue in a controlled manner. Mechanical clips are implanted over the leaflets of a valve, e.g., in the heart, either alone or after thermal treatment to cause the valve to

close more tightly. The clips are delivered by a catheter and may be configured to traverse directly over the valve itself or to lie partially over the periphery of the valve to prevent obstruction of the valve channel. Alternatively, individual anchors with a tensioning element, like a suture, are described as being useful for approximating the valves towards each other.

US Patent Application Publications 2004/0260393 to Rahdert et al. and 2004/0127982 to Machold et al., which are incorporated herein by reference, describe techniques using an implant that is sized and configured to attach in, on, or near the annulus of a dysfunctional heart valve. In use, the implant extends either across the minor axis of the annulus, or across the major axis of the annulus, or both. The implant is described as restoring to the heart valve annulus and leaflets a more functional anatomic shape and tension. The more functional anatomic shape and tension are conducive to coaptation of the leaflets, which, in turn, reduces retrograde flow or regurgitation. In some embodiments, the implant is configured to rest at or near a heart valve annulus and apply a direct mechanical force along the minor axis of the annulus to inwardly displace tissue toward the center of the annulus. For some applications, the implant is configured to extend significantly above the plane of the valve, while for other applications, the implant is configured to extend a short distance above the plane of the valve.

PCT Publication WO 01/26586 to Seguin, which is incorporated herein by reference, describes a device comprising: an implant with an elongated deformable structure, such that the implant can adopt an elongated shape to be inserted into the patient's body through a passage of reduced diameter and a curved shape adapted to perform annuloplasty; and a tubular instrument for receiving at least partly said implant therein, having a rigidity such that it enables the implant to be inserted in the patient's body through said passage; said instrument comprises an orifice at its distal end, providing access to the implant, means for locking the implant in rotation relative thereto, means for maintaining the implant relative thereto, and means for locating its angular orientation inside the patient's body. The device is described as being designed for use in the reconstruction of cardiac valves.

US Patent 5,593,424 to Northrup III, which is incorporated herein by reference, describes an apparatus and method for reducing the circumference of a vascular structure comprising the steps of providing a plurality of sutures and a

plurality of discrete suture support segments of a biocompatible, inert material, each suture support segment having at least two suture holes spaced a predetermined distance (D) apart; individually suturing each discrete suture support segment to the vascular structure with one of the plurality of sutures by effecting a horizontal mattress (U-shaped) suture along the vascular structure through a length of tissue of the vascular structure such that the length (D') of tissue sutured is greater than distance (D); and tightening and tying off the suture, whereby each sutured suture support segment creates an imbrication in the vascular structure, thereby reducing the circumference thereof. A biocompatible, inert stabilizing material is described as being optionally affixed over the suture support segments and the vascular structure prior to tying off the suture to stabilize the interval between the suture support segments and eliminate direct exposure of the segmented apparatus to blood.

US Patent 3,656,185 to Carpentier, which is incorporated herein by reference, describes a cardiac valvular prosthesis, e.g., for the mitral valve, consisting solely of an annular or part-annular member adapted to fit against the base of the cusps of a human heart valve, and suture means for securing the member in place. The prosthesis cooperates with the natural valve cusps of the patient to form the valve.

The following patents and patent applications, which are incorporated herein by reference, may be of interest:

- PCT Publication WO 06/105084 to Cartledge et al.
- PCT Publication WO 03/047467 to Cosgrove et al.
- PCT Publication WO 04/103434 to Martin et al.
- PCT Publication WO 05/046488 to Douk et al.
- PCT Publication WO 06/012013 to Rhee et al.
- PCT Publication WO 06/012038 to Shaouljian et al.
- PCT Publication WO 06/086434 to Powell et al.
- PCT Publication WO 06/097931 to Gross et al.
- PCT Publication WO 07/011799 to Navia et al.
- US Patent 5,306,296 to Wright et al.
- US Patent 5,855,614 to Stevens et al.

- US Patent 6,074,401 to Gardiner et al.
- US Patent 6,619,291 to Hlavka et al.
- US Patent 6,626,899 to Houser et al.
- US Patent 6,629,534, PCT Publication WO 06/116558 and US Patent
- 5 Application Publication 2004/0039442 to St. Goar et al.
- US Patent 6,752,813 to Golfarb et al.
- US Patent 6,764,510 to Vidlund et al.
- US Patent 6,918,917 to Nguyen et al.
- US Patent 6,926,730 to Nguyen et al.
- 10 US Patent 6,986,775 to Morales et al.
- US Patent 7,004,176 to Lau
- US Patent 7,101,395 to Tremulin et al.
- US Patent 7,150,737 to Purdy et al.
- US Patents 7,172,625 and 7,172,625 to Shu et al.
- 15 US Patent 7,175,660 to Cartledge et al.
- US Patent Application Publication 2003/0050693 to Quijano et al.
- US Patent Application Publication 2003/0078465 to Pai et al.
- US Patent Application Publication 2003/0191528 and US Patent 6,805,711 to
- Quijano et al.
- 20 US Patent Application Publication 2003/0199974 to Lee et al.
- US Patent Application Publication 2004/0127983 to Mortier et al.
- US Patent Application Publication 2004/0148021 to Cartledge et al.
- US Patent Application Publication 2004/0193191 to Starksen et al.
- US Patent Application Publication 2004/0236419 to Milo
- 25 US Patent Application Publication 2004/0243227 to Starksen et al.
- US Patent Application Publication 2004/0260394 to Douk et al.
- US Patent Application Publication 2005/0055038 to Kelleher et al.

US Patent Application Publication 2005/0096740 to Langberg et al.

US Patent Application Publication 2005/0222678 to Lashinski et al.

US Patent Application Publication 2005/0288778 to Shaoulia et al.

US Patent Application Publication 2005/0288781 to Moaddeb et al.

5 US Patent Application Publication 2006/0195134 to Crittenden

US Patent Application Publication 2006/0282161 to Huynh et al.

US Patent Application Publication 2006-0247763 to Slater

US Patent Application Publication 2007/0080188 to Spence et al.

10 US Patent Application Publications 2004/0148019 and 2004/0148020 to
Vidlund et al.

US Patent Application Publications 2005/0010287 and 2004/0138745 to
Macoviak et al.

The following articles, which are incorporated herein by reference, may be of
interest:

15 O'Reilly S et al., "Heart valve surgery pushes the envelope," Medtech Insight
8(3): 73, 99-108 (2006)

Dieter RS, "Percutaneous valve repair: Update on mitral regurgitation and
endovascular approaches to the mitral valve," Applications in Imaging, Cardiac
Interventions, Supported by an educational grant from Amersham Health pp. 11-14
20 (2003)

Swain CP et al., "An endoscopically deliverable tissue-transfixing device for
securing biosensors in the gastrointestinal tract," Gastrointestinal Endoscopy 40(6):
730-734 (1994)

25 Odell JA et al., "Early Results of a Simplified Method of Mitral Valve
Annuloplasty," Circulation 92:150-154 (1995)

SUMMARY OF THE INVENTION

In some embodiments of the present invention, a system and minimally-invasive surgical methods are provided for repair of a dilated mitral valve of a patient. An annuloplasty structure, e.g., at least one segment of an annuloplasty ring, is
5 transcatheterally advanced to an atrial surface of an annulus of the mitral valve, using a percutaneous approach. Typically, the annuloplasty structure comprises at least two discrete hollow ring segments which are each anchored at respective positions along the annulus circumference of the mitral valve. In embodiments in which two
10 segments are used, the two segments are typically coupled together by two control wires, e.g., nitinol wires, which are configured for sliding motion through the segments. These wires function as drawstrings to pull the segments into proper orientation once the segments have been anchored to the annulus.

In some embodiments, the segments comprise accordion-like compressible structures which facilitate proper cinching of the annulus when the segments are
15 drawn together. The accordion-like structures, when compressed, enable portions of the segments to independently conform to the configuration of the annulus of the mitral valve of a given patient. In embodiments in which the segments are shaped to define a coil, the coil is configured to be compressed.

Typically, the first of the two segments is sized such that it corresponds with
20 the size of the base of the posterolateral leaflet at the annulus. Similarly, the second segment is designated to be anchored to the annulus at the base of the anteromedial leaflet, and thus is sized in accordance therewith. Such positioning of the segments at the base of respective leaflets of the mitral valve facilitates control of the leaflet corresponding to the respective segment. Additionally, the junctions between the two
25 segments of the annuloplasty ring are adjacent to and mimic the physiological commissures of both leaflets of the mitral valve.

Typically, the annuloplasty structure comprises a flexible, biocompatible material, e.g., nitinol, PTFE (Polytetrafluoroethylene), stainless steel, platinum
30 iridium, titanium, or silicone. In some embodiments, the annuloplasty structure is shaped to define a coil. For some applications, the coil is shaped to define a stent-like net configuration.

Prior to the transcatheter advancement of the system, at least one flexible longitudinal guide member is reversibly coupled at least in part to the annuloplasty structure. In some embodiments, the guide member comprises an anchoring structure at a distal tip thereof. In such an embodiment, the anchoring structure is screwed into
5 the annulus upon rotating a proximal end of the guide member.

The ring segments are typically advanced toward the left atrium of the patient in a generally straight configuration within the catheter that advances them (i.e., the ring segments are not curved within the catheter), the straight configuration defining a respective longitudinal axis of each of the first and second segments. In an
10 embodiment, the two ring segments are shaped to provide a plurality of channels oriented substantially perpendicularly with respect to the longitudinal axis of the segments. The channels are configured for the passage of the anchoring structure therethrough. A bar is disposed within each channel. For example, the bar may be disposed at the base of each channel, i.e., the portion of the channel designated to
15 align with and contact the annulus. Prior to the transcatheter advancement of the system, a flexible longitudinal guide wire is coupled to, e.g., looped around, each bar.

Once the annuloplasty segments have been deployed within the left atrium of the patient and positioned upon the annulus of the mitral valve, anchoring structures are sequentially advanced along respective guide wires, through the channels, and are
20 subsequently implanted within the annulus in order to anchor the segments to the annulus. The control wires are then replaced by a tensile suture. Using real-time monitoring, tactile feedback and optionally in combination with fluoroscopic imaging, the suture is then pulled. Consequently, the leaflets are drawn toward one another in accordance with the level of dilation of the preoperative mitral valve. Thus, generally
25 the normal structural configuration is returned to the leaflets, effecting a reduction in mitral valve prolapse and regurgitation.

In some embodiments of the present invention, the system comprises a multilumen catheter shaped to provide a primary lumen and a secondary lumen. Typically, the multilumen catheter is configured to advance the segments through an
30 advancement catheter and into the left atrium. In some embodiments, the multilumen catheter is disposed proximally to the ring segments and is configured to push the segments through the advancement catheter. For some applications, the annuloplasty ring segments are advanced through the primary lumen of the multilumen catheter.

Typically, the multilumen catheter, the two ring segments, the control wires, and the plurality of guide wires coupled thereto, are preloaded into a catheter prior to the percutaneous advancement of the catheter into the left atrium of the patient.

5 There is therefore provided, in accordance with an embodiment of the present invention, apparatus for repairing a valve of a body of a patient, the valve including an annulus and at least first and second leaflets, including:

at least a first discrete segment and a second discrete segment of an annuloplasty structure, each segment being shaped to provide a respective lateral wall, each lateral wall being shaped to define at least one lumen of the respective segment;
10 and

at least a first and a second control wire, each control wire configured for sliding advancement through both the first and second segments:

the first control wire is configured to control a relative disposition of a first end of the first segment and a first end of the second segment, and
15 the second control wire is configured to control a relative disposition of a second end of the first segment and a second end of the second segment.

In an embodiment, the first and second segments are configured for transcatheter advancement into a left atrium of a patient.

20 In an embodiment, the first and second segments are configured for simultaneous advancement toward a left atrium of a patient.

In an embodiment, for each lateral wall of each segment, the lateral wall has a first and a second portion, and the segment is shaped to provide a channel extending from the first portion to the second portion.

25 In an embodiment, the apparatus includes a bar configured to be disposed within the channel.

In an embodiment, the bar is disposed within the channel substantially perpendicular to an axis of the channel.

In an embodiment, the apparatus includes a flexible longitudinal guide member configured to be removably coupled to the bar.

30 In an embodiment, the apparatus includes an anchoring structure, and while the guide member is disposed within the body of the patient, the anchoring structure is

configured to be advanced via the guide member, through the channel, and subsequently anchored to the annulus of the patient.

In an embodiment, the anchoring structure includes a pointed distal tip.

5 In an embodiment, while the guide member is disposed within the body of the patient, the anchoring structure is configured to be advanced along the guide member from a site outside the body of the patient.

In an embodiment, while the guide member is disposed within the body of the patient, the guide member is configured to be decoupled from the bar subsequent to the anchoring of the anchoring structure to the annulus.

10 In an embodiment, the anchoring structure includes a helical element at a distal end thereof, the helical element shaped to provide a proximal end of the helical element and a distal end of the helical element.

In an embodiment, the apparatus includes an advancement tube having a distal tip thereof, at least a portion of the proximal end of the helical element is configured
15 to be coupled to the distal tip of the advancement tube.

In an embodiment, the helical element is shaped to define a first number of proximal rotational subunits and a second number of distal rotational subunits, and the proximal rotational subunits are wrapped around the distal tip of the advancement tube.

20 In an embodiment, the proximal rotational subunits are coupled to the distal tip of the advancement tube by a first frictional force.

In an embodiment, the second number is greater than the first number.

In an embodiment, the advancement tube is configured to be rotated and, in response to the rotation, the distal rotational subunits are configured to be implanted
25 within the annulus of the patient.

In an embodiment, at least a portion of the distal tip is shaped to define a protrusion disposed adjacent to the proximal end of the helical element, the protrusion being configured to apply a circumferentially-directed force to the proximal end of the helical element as the advancement tube is rotated.

30 In an embodiment, during the rotation of the advancement tube:

the proximal rotational subunits are configured to slide distally along the distal tip of the advancement tube, and

in response to the sliding, a portion of the first number of proximal rotational subunits remains wrapped around the distal tip of the advancement tube.

- 5 In an embodiment, a number of proximal rotational subunits in the portion is less than the first number of proximal rotational subunits.

In an embodiment, the portion of the proximal rotational subunits is coupled to the distal tip of the advancement tube by a second frictional force, the second frictional force being weaker than the first frictional force.

- 10 In an embodiment, the second frictional force being weaker than the first frictional force facilitates decoupling of the distal tip of the advancement tube from the helical element.

In an embodiment:

- 15 the helical element is shaped to define at least two adjacent distal rotational subunits and at least two adjacent proximal rotational subunits, and

a distance between the two adjacent distal rotational subunits is greater than a distance between the two adjacent proximal rotational subunits.

- 20 In an embodiment, the distance between the distal rotational subunits enables the distal rotational subunits to be corkscrewed around the bar and subsequently into the annulus of the patient.

In an embodiment, the distance between the proximal rotational subunits restricts the proximal rotational subunits from being corkscrewed around the bar and into the annulus of the patient.

- 25 In an embodiment, the first and second segments are configured to be advanced toward a left atrium of the patient in a generally straight configuration and subsequently are made to assume a curved configuration.

In an embodiment, the first and second control wires are configured to pull the first and second segments into curved configurations.

- 30 In an embodiment, the first and second segments include a shape-memory alloy, the alloy being configured to assume a curved configuration once the segments have been advanced into the left atrium of the patient.

In an embodiment, the apparatus includes at least first and second flexible longitudinal guide members, the first and second guide members configured to be removably coupled to the first and second segments, respectively, each guide member being configured to facilitate anchoring of the respective segment to the annulus of the patient.

In an embodiment, the apparatus includes respective at least first and second anchoring structures, the first and second anchoring structures configured to be disposed at respective distal ends of the first and second guide members, respectively, the anchoring structures being configured to be screwed into the annulus of the patient in response to a rotational force applied to a respective proximal end of the respective guide members.

In an embodiment, each of the anchoring structures includes a pointed distal tip.

In an embodiment, the first and second control wires are configured to control a relative disposition of the first and second segments.

In an embodiment, the first and second control wires are configured to separate the first and second segments.

In an embodiment, the first and second control wires are configured to facilitate positioning of the first and second segments along the annulus.

In an embodiment, the first and second segments are configured to be advanced toward a left atrium of the patient in a generally straight configuration thereof, and the first and second control wires are configured to pull the first and second segments into a curved configuration.

In an embodiment, the first and second segments are configured to be advanced toward an atrium of a heart of the patient in a generally straight configuration, the straight configuration defining a longitudinal axis of the respective first and second segments,

at least a portion of the first and second segments is shaped to define one or more compressible units, and

the compressible units are configured to be compressed in parallel with the longitudinal axis of the respective segments.

In an embodiment, the compressible units are configured to be compressed in response to an application of a pulling force to the first and second control wires.

5 In an embodiment, the first control wire is configured to compress the first segment at least in part in response to an application of a pulling force to at least a portion of the first control wire, and the second control wire is configured to compress the second segment at least in part in response to an application of a pulling force to at least a portion of the second control wire.

10 In an embodiment, the apparatus includes first and second adjustment wires, coupled to the first and second control wires, respectively, the first adjustment wire is coupled to the first control wire at a first junction between the first and second segments, and the second adjustment wire is coupled to the second control wire at a second junction between the first and second segments.

In an embodiment, the adjustment wires are configured to facilitate aligning of the first and second segments with the annulus by separating the segments.

15 In an embodiment, the adjustment wires are configured to facilitate aligning of the first and second segments with the annulus by elevating portions of the first and second segments.

There is further provided, in accordance with an embodiment of the present invention apparatus for repairing a valve of a body of a patient, the valve including an annulus and at least first and second leaflets, including:

20

an annuloplasty structure,

shaped to provide one or more channels, each channel extending from a respective first portion of a lateral wall of the annuloplasty structure to a respective second portion of the lateral wall of the annuloplasty structure, and

25 including one or more bars, each bar configured to be disposed within a respective one of the channels; and

one or more flexible longitudinal guide members, each guide member configured to be removably coupled to a respective one of the bars.

30 In an embodiment, each guide member is removably coupled to the respective bar by being looped around the respective bar.

In an embodiment, the annuloplasty structure includes an annuloplasty ring.

In an embodiment, the annuloplasty structure includes a partial annuloplasty ring.

In an embodiment, the structure and the one or more guide members are configured to be transcatheterally advanced into a left atrium of the patient.

5 In an embodiment, the structure and the one or more guide members are configured to be simultaneously advanced toward a left atrium of the patient.

In an embodiment, the annuloplasty structure includes two or more segments of an annuloplasty ring.

10 In an embodiment, each bar is disposed within a respective one of the channels substantially perpendicular to an axis of the channel.

In an embodiment, the structure includes a shape-memory alloy.

In an embodiment, the structure is configured to be advanced toward a left atrium of the patient in a generally straight configuration and subsequently to be made to assume a curved configuration.

15 In an embodiment, the apparatus includes at least one control wire, and the control wire is configured to pull the structure into the curved configuration.

In an embodiment, the structure includes a shape-memory alloy, the alloy being configured to assume a curved configuration once the structure has been advanced into the left atrium of the patient.

20 In an embodiment, the apparatus includes at least one control wire in communication with the structure configured to adjust a disposition of the structure.

In an embodiment, the lateral wall of the annuloplasty structure is shaped to define at least one lumen of the structure.

25 In an embodiment, the at least one control wire is configured for sliding advancement through the at least one lumen, and to control from within the lumen a conformation of the structure.

In an embodiment,
the structure is configured to be advanced toward a left atrium of the patient in a generally straight configuration, the straight configuration defining a longitudinal
30 axis thereof,

at least a portion of the structure is shaped to define one or more compressible units, and

the compressible units are configured to be compressed in parallel with the longitudinal axis.

5 In an embodiment, the compressible units are configured to be compressed in response to an application of a pulling force to the at least one control wire.

In an embodiment, the structure includes a first and a second segment, the first and second segments each shaped to provide a respective lateral wall, each lateral wall being shaped to define at least one respective lumen of the respective segment.

10 In an embodiment, the apparatus includes at least one adjustment wire coupled to the at least one control wire, and the at least one adjustment wire is configured to be coupled to the at least one control wire at a junction between the first and second segments.

In an embodiment, the at least one adjustment wire is configured to facilitate
15 aligning of the first and second segments with the annulus by separating the segments.

In an embodiment, the at least one adjustment wire is configured to facilitate aligning of the first and second segments with the annulus by elevating portions of at least one of the segments.

In an embodiment, the control wire is configured for sliding advancement
20 through the at least one lumen of each of the first and second segments.

In an embodiment, the at least one control wire includes a first and a second control wire.

In an embodiment:

the first and second segments are each shaped to provide respective first and
25 second lumens, and

the first control wire is configured for sliding advancement through each of the first lumens, and the second control wire is configured for sliding advancement through each of the second lumens.

In an embodiment, the first and second control wires are configured to control
30 a relative disposition of the first and second segments.

In an embodiment, the first and second control wires are configured to separate portions of the first and second segments.

In an embodiment, the first and second control wires are configured to facilitate positioning of the first and second segments along the annulus.

5 In an embodiment, the first and second segments are configured to be advanced toward a left atrium of the patient in a generally straight configuration thereof, and the first and second control wires are configured to pull the first and second segments into a curved configuration.

10 In an embodiment,
the first and second segments are configured to be advanced toward a left atrium of the patient in a generally straight configuration, the straight configuration defining a longitudinal axis of the respective first and second segments,
at least a portion of each of the first and second segments is shaped to define one or more compressible units, and
15 the compressible units are configured to be compressed in parallel with the longitudinal axis of the respective segments.

In an embodiment, the compressible units are configured to be compressed in response to an application of a pulling force to the first and second control wires.

20 In an embodiment:
the first control wire is configured to compress the first segment at least in part in response to an application of a pulling force to at least a portion of the first control wire, and
the second control wire is configured to compress the second segment at least in part in response to an application of a pulling force to at least a portion of the
25 second control wire.

In an embodiment, the apparatus includes one or more anchoring structures, each anchoring structure configured to be advanced through a respective one of the channels and subsequently anchored to the annulus of the patient.

30 In an embodiment, the anchoring structure is shaped to define a pointed distal tip.

In an embodiment, while the guide member is disposed within the body of the patient, each anchoring structure is configured to be advanced along a respective one of the guide members from a site outside the body of the patient.

In an embodiment, the guide member is configured to be decoupled from the bar subsequent to the anchoring of the anchoring structure to the annulus.

In an embodiment, each of the anchoring structures includes a helical element at a distal end thereof.

In an embodiment:

the helical element is shaped to define at least two adjacent distal rotational subunits and at least two adjacent proximal rotational subunits, and

a distance between the two adjacent distal rotational subunits is greater than a distance between the two adjacent proximal rotational subunits.

In an embodiment, the distance between the distal rotational subunits enables the distal rotational subunits to be corkscrewed around the bar and subsequently into the annulus of the patient.

In an embodiment, the distance between the proximal rotational subunits restricts the proximal rotational subunits from being corkscrewed fully around the bar and into the annulus of the patient.

There is yet further provided, in accordance with an embodiment of the present invention apparatus for repairing a valve of a body of a patient, the valve including an annulus and at least first and second leaflets, including:

an annuloplasty structure including a bar; and

an anchoring structure including a helical element, the helical element shaped to define at least two adjacent distal rotational subunits and at least two adjacent proximal rotational subunits, a distance between the two adjacent distal rotational subunits is greater than a distance between the two adjacent proximal rotational subunits, and:

the distance between the distal rotational subunits enables the distal rotational subunits to be corkscrewed around the bar and subsequently into tissue of a patient, and

the distance between the proximal rotational subunits restricts the proximal rotational subunits from being corkscrewed into tissue of the patient.

In an embodiment, the annuloplasty structure includes an annuloplasty ring.

5 In an embodiment, the annuloplasty structure includes a partial annuloplasty ring.

In an embodiment, the annuloplasty structure includes two or more segments of an annuloplasty ring.

10 In an embodiment, the apparatus includes a flexible longitudinal guide member reversibly coupled to the structure, and configured to facilitate anchoring of the annuloplasty structure to the annulus of the patient.

In an embodiment,

the annuloplasty structure is shaped to provide a lateral wall having at least first and second portions, and shaped to provide at least one channel,

15 the at least one channel extends from the first portion of the lateral wall of the structure to the second portion of the lateral wall of the structure,

the bar is disposed within the at least one channel substantially perpendicular to an axis of the channel, and

the guide member is reversibly coupled to the bar.

20 In an embodiment, the anchoring structure is disposed at a distal end of the guide member.

In an embodiment, the anchoring structure is configured to be screwed into the annulus in response to a rotational force applied to a proximal end of the guide member.

25 In an embodiment, the apparatus includes a hollow tube configured to be reversibly coupled to the helical element, and to push the anchoring structure toward the annuloplasty structure.

In an embodiment, the hollow tube is configured to be advanced around the guide member while the guide member is disposed within the body of the patient.

30 In an embodiment, the helical element is disposed around the hollow tube, the hollow tube is configured to be rotated at a proximal portion thereof, and the

anchoring structure is corkscrewed into the annulus of the patient in response to the rotation of the tube.

In an embodiment, a diameter of the bar is greater than the distance between the proximal rotational subunits, and during an attempt to corkscrew the proximal rotational subunits therearound:

the bar restricts the proximal rotational subunits from being corkscrewed into tissue of the patient by applying a counterforce to a torque applied by the rotation of the tube, and

the proximal rotational subunits are configured to expand radially in response to the counterforce applied by the bar.

In an embodiment, the helical element is configured to be detached from the hollow tube in response to the radial expansion of the proximal rotational subunits.

There is additionally provided, in accordance with an embodiment of the present invention, a method for performing an annuloplasty on a valve of a body of a patient the valve including an annulus and at least first and second leaflets, including:

deploying an annuloplasty structure in an atrium of a heart of the patient, the structure including one or more bars and one or more respective flexible longitudinal guide members, each guide member reversibly coupled to a respective one of the bars;

positioning the annuloplasty structure along the annulus of the valve of the patient;

advancing one or more respective anchoring structures, each anchoring structure each anchoring structure being passed along a respective one of the flexible longitudinal guide members while the one or more guide members are disposed within the body of the patient;

advancing at least a portion of each anchoring structure beyond the respective bar and into tissue of the patient; and

decoupling each guide member from the respective bar.

In an embodiment, deploying the annuloplasty structure includes placing the annuloplasty structure in the atrium during an open heart procedure.

In an embodiment, deploying the annuloplasty structure includes deploying at least one segment of an annuloplasty ring.

In an embodiment, deploying the annuloplasty structure includes deploying an annuloplasty ring.

In an embodiment, deploying the annuloplasty structure includes deploying a partial annuloplasty ring.

5 In an embodiment, the method includes advancing the annuloplasty structure to the atrium transcatheterally.

In an embodiment, the method includes performing, during a single transcatheter advancement, the steps of: (a) deploying the annuloplasty structure, (b) positioning the annuloplasty structure, (c) advancing the one or more respective
10 anchoring structures, (d) advancing the at least a portion of each anchoring structure, and (e) decoupling each guide member.

In an embodiment, positioning the annuloplasty structure includes adjusting a configuration of the annuloplasty structure with respect to a configuration of the annulus of the patient.

15 In an embodiment, the annuloplasty structure is generally ring-shaped following the deployment, thereby defining a radius characteristic thereof, and adjusting the configuration of the structure includes reducing the radius by compressing at least a portion of the structure.

In an embodiment, compressing includes applying a pulling force to a control
20 wire disposed within a lumen of the structure.

In an embodiment, deploying the structure includes deploying two segments of the annuloplasty ring.

In an embodiment, the method includes drawing together the first and second segments.

25 In an embodiment, positioning the structure along the annulus of the patient includes positioning the first and second segments along the annulus.

In an embodiment, positioning the first and second segments includes positioning the first segment on the annulus along a junction between a base of a first leaflet and the annulus, and positioning the second segment on the annulus along a
30 junction between a base of a second leaflet and the annulus.

In an embodiment, positioning the first and second segments includes adjusting a relative disposition of the first and second segments with respect to a configuration of the annulus of the patient.

5 In an embodiment, adjusting the disposition of the first and second segments includes elevating at least a portion of the first segment and at least a portion of the second segment.

In an embodiment, adjusting the first and second segments includes adjusting the first segment independently of the adjusting of the second segment.

10 In an embodiment, the annuloplasty structure is configured to assume a generally straight configuration following the deployment, the straight configuration defining a longitudinal axis of the structure, and adjusting the disposition of the first and second segments includes adjusting a disposition of the first and second segments by compressing in parallel with the longitudinal axis of the structure at least a portion of the first segment and at least a portion of the second segment.

15 In an embodiment, compressing includes applying a pulling force to at least one control wire disposed within a lumen of each of the first and second segments.

There is also provided, in accordance with an embodiment of the present invention, apparatus for repairing a valve of a body of a patient, the valve including an annulus and at least first and second leaflets, including:

20 an annuloplasty structure; and
a flexible longitudinal guide member removably coupled to the structure:
the guide member is configured to facilitate anchoring of the annuloplasty structure to the annulus of the patient, and
the guide member is configured to be advanced toward the annulus
25 simultaneously with the annuloplasty structure.

In an embodiment, the annuloplasty structure includes an annuloplasty ring.

In an embodiment, the annuloplasty structure includes a partial annuloplasty ring.

30 In an embodiment, the annuloplasty structure includes at least first and second segments of an annuloplasty ring.

In an embodiment, the apparatus includes an anchoring structure configured to anchor the structure to the annulus via the guide member.

In an embodiment, the anchoring structure includes a pointed distal tip.

5 In an embodiment, the anchoring structure is disposed at a distal end of the guide member, and is configured to be screwed into the annulus in response to a rotational force applied to a proximal end of the guide member.

In an embodiment, the annuloplasty structure is shaped to define a lateral wall having first and second portions, and to provide a channel extending from the first portion of the lateral wall to the second portion of the lateral wall of the structure.

10 In an embodiment, the anchoring structure is configured to be advanced through the channel and subsequently anchored to the annulus of the patient while the one or more guide members are disposed within the body of the patient.

In an embodiment, the apparatus includes a bar configured to be disposed within the channel.

15 In an embodiment, the bar is disposed within the channel substantially perpendicular to an axis of the channel.

In an embodiment, the guide member is configured to be removably coupled to the bar.

20 In an embodiment, the anchoring structure is configured to be advanced along the guide member from a site outside the body of the patient while the guide member is disposed within the body of the patient.

In an embodiment, the guide member is configured to be decoupled from the bar subsequent to the anchoring of the anchoring structure to the annulus.

25 In an embodiment, the anchoring structure includes a helical element at a distal end thereof, the helical element being configured to be corkscrewed at least in part into the annulus of the patient.

In an embodiment, the helical element is shaped to define at least two adjacent distal rotational subunits and at least two adjacent proximal rotational subunits, and a distance between the two adjacent distal rotational subunits is greater than a distance
30 between the two adjacent proximal rotational subunits.

In an embodiment, the distance between the distal rotational subunits enables the distal rotational subunits to be corkscrewed around the bar and subsequently into the annulus of the patient.

In an embodiment, the distance between the proximal rotational subunits
5 restricts the proximal rotational subunits from being corkscrewed around the bar and into the annulus of the patient.

The present invention will be more fully understood from the following detailed description of embodiments thereof, taken together with the drawings, in which:

10 **BRIEF DESCRIPTION OF THE DRAWINGS**

Figs. 1A-J are schematic illustrations of transcatheter advancement and deploying of a system for repairing an annulus of the patient, in accordance with an embodiment of the present invention;

15 Figs. 2A-F are schematic illustrations of the deployment of two annuloplasty ring segments of the system toward the annulus of the patient, in accordance with an embodiment of the present invention;

Figs. 3A-B, 4A-E, and 5A-B are schematic illustrations of anchoring apparatus configured to anchor the two annuloplasty ring segments to the annulus of the patient, in accordance with an embodiment of the present invention; and

20 Figs. 5C-D are schematic illustrations of the drawing together and locking of the two segments of the annuloplasty ring to the annulus of the patient, in accordance with an embodiment of the present invention.

DETAILED DESCRIPTION OF THE EMBODIMENTS

Reference is now made to Figs. 1A-F, which are schematic illustrations of a
25 system 400 for repairing a mitral valve 30, being advanced into a left atrium of a patient, in accordance with an embodiment of the present invention. Typically, a catheter 404 (Fig. 1B) is advanced into the left atrium of the patient using a percutaneous endovascular approach typically combined with continuous monitoring by electromagnetic and/or sound waves, e.g., fluoroscopy, transesophageal echo,
30 and/or echocardiography, to maintain real-time orientation of a distal tip of the

catheter within the heart of the patient. Typically, catheter 404 is transseptally advanced into the left atrium.

Catheter 404 typically comprises a 13 F catheter, although another size may be appropriate for a given patient. In some embodiments, catheter 404 is advanced
5 through vasculature of the patient and into the right atrium using a suitable point of origin typically determined for a given patient. For example:

(1) Catheter 404 is introduced into the femoral vein of the patient, through the superior vena cava, into the right atrium of the heart, transseptally through the fossa ovalis, and finally into the left atrium;

10 (2) Catheter 404 is introduced into the basilic vein, through the subclavian vein to the superior vena cava, into the right atrium, transseptally through the fossa ovalis, and finally into the left atrium; or

(3) Catheter 404 is introduced into the external jugular vein, through the subclavian vein to the superior vena cava, into the right atrium, transseptally through
15 the fossa ovalis, and finally into the left atrium.

In some embodiments, catheter 404 is advanced through an inferior vena cava
22 of the patient (as shown) and into the right atrium using a suitable point of origin typically determined for a given patient.

Fig. 1A shows a guide wire 402 being advanced into the right atrium of the
20 patient. Advancement of wire 402 typically precedes advancement of catheter 404 into the right atrium of the patient. Wire 402 comprises a semi-rigid wire which provides a guide for the subsequent advancement of catheter 404 therealong and into the right atrium of the patient, as shown in Fig. 1B. Once catheter 404 has entered the right atrium, guide wire 402 is retracted and extracted from within the body of the
25 patient (Fig. 1C). In Fig. 1D, catheter 404 is pushed distally until it reaches the interatrial septum of heart 20 of the patient.

(In this context, in the specification and in the claims, "proximal" means closer to the orifice through which catheter 404 is originally placed into the vasculature of the patient, and "distal" means further from this orifice.)

30 As shown in Fig. 1E, a resilient needle 406 is advanced through catheter 404 and into heart 20 of the patient. In order to advance catheter 404 transseptally into the

left atrium, needle 406 first punctures the septum of heart 20 such that an opening is created which facilitates passage of catheter 404 therethrough and into the left atrium. Subsequently, a dilator (not shown) is advanced along needle 406 and toward the septum of heart 20. Typically, the dilator is shaped to define a hollow shaft for
5 passage along needle 406, the hollow shaft being shaped to define a tapered distal end. This tapered distal end is first advanced through the hole created by needle 406. The hole is enlarged when the gradually increasing diameter of the distal end of the dilator is pushed through the hole in the septum. The advancement of catheter 404 through the septum and into the left atrium is followed by the extraction of the dilator
10 from within catheter 404 (Fig. 1F).

Fig. 1G is a schematic illustration of a first segment 430 and a second segment 440 of an annuloplasty structure 408 being advanced along catheter 404, in accordance with an embodiment of the present invention. Segments 430 and 440 are configured to be chronically implanted within heart 20 along an annulus 40 of mitral
15 valve 30. Typically, segments 430 and 440 comprise a biocompatible material, e.g., nitinol, titanium, silicone, polytetrafluoroethylene (PTFE), and/or polyester graft material. Additionally, segments 430 and 440 comprise accordion-like, compressible subunits 450 which facilitate bending of the segments into a suitable configuration and compressing of the segments when they are later drawn toward one another.

20 In some embodiments of the present invention, segments 430 and 440 comprise coils made of stainless steel, e.g., type 304 or type 316. Suitable coil shapes include round wire coils or flat wire coils.

Prior to advancing segments 430 and 440 into the left atrium of the patient, segments 430 and 440 are loaded into an advancement catheter 410 in a substantially
25 linear configuration, as shown in Fig. 1G. The linear configuration defines a longitudinal axis of segments 430 and 440 of structure 408. Segments 430 and 440 are typically advanced into the left atrium of the patient during a single transcatheter advancement.

During advancement of segment 430 within advancement catheter 410,
30 segment 430 has a length L1 between about 10 mm and about 50 mm, e.g., 20 mm. Length L1 of segment 430 typically corresponds with a portion of annulus 40 at the junction between annulus 40 and the base of the anteromedial leaflet of valve 30.

Similarly, second segment 440 is designated to be anchored to annulus 40 at the base of the posterolateral leaflet, and thus is sized in accordance therewith. For example, segment 440 may have a length L2 of between about 20 mm and about 80 mm, e.g., 40 mm. The respective lengths of segments 430 and 440 enable the segments to
5 dynamically support the mitral valve in accordance with the relative motion of the anteromedial and posterolateral leaflets. Typically, segments 430 and 440 each have a diameter L3 of between about 1 mm and about 5 mm, typically between about 2.5 mm and about 3.5 mm.

Typically, segments 430 and 440 are shaped to define a lateral wall 462 that
10 has at least one flexible hollow lumen configured for sliding advancement of at least one control wire therethrough. As shown, a first control wire 480 and a second control wire 490 are disposed within both the first and second segments 430 and 440. Typically, wires 480 and 490 function to position and adjust a relative disposition and configuration of segments 430 and 440 with respect to a configuration of annulus 40
15 of valve 30. Additionally, the structural and spatial configurations of each segment are controlled independently by a respective one of the first and second control wires 480 and 490. Such functions of wires 480 and 490 are described hereinbelow. As such, a diameter of control wires 480 and 490 (e.g., between about 0.2 mm and about 0.4 mm, typically, between 0.25 mm and 0.3 mm) provides the wires with the strength
20 to control structure 408. Typically, control wires 480 and 490 comprise a resilient material capable of providing a pulling force to segments 430 and 440, e.g., nitinol or Teflon. In some embodiments, control wires 430 and 440 are Teflon-coated.

In some embodiments, first and second control tubes are disposed within both the first and second segments. Typically, the first and second control tubes are
25 configured to function similarly to control wires 480 and 490 described herein.

Typically, lateral wall 462 of segments 430 and 440 is shaped to provide a first portion 464 and a second portion 466 generally at opposite sites of the segment when viewed in cross-section (e.g., at 12 o'clock and 6 o'clock). First and second segments 430 and 440 of annuloplasty structure 408 each comprise at least one
30 channel 460. Channel 460 is configured to extend from first portion 464, through the given segment, to second portion 466. A respective flexible and longitudinal guide member 470 is partially disposed within each channel 460 and is used to facilitate anchoring of annuloplasty structure 408, as described hereinbelow.

Typically, guide member 470 is configured to facilitate advancement therealong of a respective anchoring structure (described hereinbelow). The anchoring structure is typically advanced along guide member 470, through channel 460, and is ultimately anchored into annulus 40 of mitral valve 30, thereby anchoring the segment to annulus 40. Typically, guide member 470 comprises a flexible metal wire, e.g., nitinol or stainless steel. In some embodiments, guide member 470 comprises a suture comprising an artificial fiber, e.g., nylon, polypropylene, Kevlar, Teflon, or polyester. Typically, each guide member 470 has a diameter of between about 0.05 mm and about 0.2 mm, e.g., 0.1 mm.

Prior to advancing segments 430 and 440 into the left atrium of the patient, advancement catheter 410 is preloaded with segments 430 and 440, with control wires 480 and 490, with guide members 470, and with a multilumen catheter 420 which is disposed proximally to segments 430 and 440. Thus, segments 430 and 440 are simultaneously conveyed toward heart 20, during a single transcatheter advancement. Typically, advancement catheter 410 comprises a 12 F catheter, although other sizes may be appropriate depending on the size of catheter 404.

Figs. 1H and 1I show deployment of first segment 430 of the segmented annuloplasty ring, in accordance with an embodiment of the present invention. Segments 430 and 440 are in a linear configuration within advancement catheter 410 when catheter 410 is advanced within catheter 404 and initially enters the left atrium. As shown in Fig. 1H, a distal end of catheter 410 emerges from within catheter 404. Segment 430 maintains its linear configuration as it is initially pushed from within catheter 410.

As shown by way of illustration and not limitation, each guide member 470 is looped around a bar disposed within each channel 460. The purpose of this bar is described hereinbelow.

Typically, first and second segments 430 and 440 of structure 408 are ultimately made to assume a somewhat round configuration that resembles an annuloplasty ring in structure and function.

As shown in Fig. 1I, control wires 480 and 490 are tightly pulled proximally, applying a force to segment 430 and compressing segment 430 so that it is made to assume a curved configuration. The curved configuration is thus achieved as

compressible subunits 450 are compressed in response to the pulling of control wires 480 and 490. Typically, compressible subunits 450 are compressed generally in parallel with the longitudinal axis of segment 430. Such a curved configuration minimizes the possibility for segment 430 to prematurely contact walls of heart 20:
5 (1) during deployment of system 400 within the left atrium, and (2) prior to positioning segments 430 and 440 along annulus 40.

It is to be noted that in some embodiments, segments 430 and 440 of annuloplasty structure 408 comprise a shape-memory alloy, e.g., nitinol. In these embodiments, segments 430 and 440 are introduced within catheter 410 in a straight
10 configuration, and are each biased to assume a generally semi-circular configuration once expanded from within catheter 410. Annuloplasty structure 408 thus assumes a somewhat round configuration typically independently of the application of a proximal force to control wires 430 and 440. In such an embodiment, control wires 430 and 440 are used instead to expand the segments by separating at least a part of
15 segment 430 from at least a part of segment 440.

Reference is now made to Fig. 1J, which is a schematic illustration of system 400 comprising annuloplasty structure 408 and multilumen catheter 420, in accordance with an embodiment of the present invention. As shown, each control wire 480 and 490 is coupled to a respective adjustment wire 482 and 492. Adjustment
20 wires 482 and 492 are configured to contribute to adjusting a relative disposition of segments 430 and 440 once inside the left atrium of heart 20. The functions of wires 482 and 492 are described in more detail hereinbelow.

Typically, multilumen catheter 420 is shaped to define a primary lumen 426 and secondary lumens 422 and 424. The flexible and longitudinal guide members 470
25 are disposed within primary lumen 426 and are exposed outside the body of the patient proximally to catheter 404. Since, in some embodiments, a respective anchoring structure is advanced along each of guide members 470, primary lumen 426 typically has a diameter D1 of between about 1.0 mm to about 3.0 mm (e.g., 1.6 mm). The diameter D1 of lumen 426 allows passage therethrough of at least one
30 anchoring structure at a given time.

First and second portions of control wire 490 and a portion of adjustment wire 482 are disposed within secondary lumen 422 (as shown), while first and second

portions of control wire 480 and a portion of adjustment wire 492 are disposed within secondary lumen 424 (as shown). Multilumen catheter 420 separates and isolates control wire 480 from control wire 490 and separates and isolates adjustment wire 482 from adjustment wire 492, thereby enabling the physician to distinguish between each of control wires 480 and 490 and between adjustment wires 482 and 492. Thus, catheter 420 helps facilitate independent control by the physician of each of the wires which ultimately determine the relative positioning of structure 408 within the left atrium of heart 20.

Reference is now made to Figs. 2A and 2B, which are schematic illustrations of first segment 430 of structure 408 being advanced from within catheter 410, as described hereinabove with reference to Figs. 1H and 1I, in accordance with an embodiment of the present invention.

Reference is now made to Fig. 2C, which is a schematic illustration of the deployment and expansion of segments 430 and 440, in accordance with an embodiment of the present invention. Control wires 480 and 490 are shown disposed within at least one hollow lumen of both first and second segments 430 and 440 of annuloplasty structure 480, thereby coupling the segments. In some embodiments, each of segments 430 and 440 is shaped to provide a first lumen configured for sliding advancement therethrough of wire 480, and a second lumen configured for sliding advancement of wire 490 (configuration not shown). First and second portions of control wire 480 emerge from within segments 430 and 440 at respective first ends 432 and 442 of segments 430 and 440. The first and second portions of control wire 480 are disposed within secondary lumen 424 such that first and second ends of wire 480 are exposed and controllable from outside the body of the patient. Similarly, first and second portions of control wire 490 emerge from within segments 430 and 440 at respective second ends 434 and 444 of segment 430 and 440. The first and second portions of control wire 490 are disposed within secondary lumen 422, such that first and second ends of wire 490 are exposed and controllable from outside the body of the patient.

In some embodiments, multilumen catheter 420 is shaped to provide secondary lumens 423 and 425, as shown. Typically, lumens 423 and 425 are provided for passage of supplementary instruments, e.g., for suction and/or irrigation, therethrough and into the left atrium of the patient.

Following the deployment, segments 430 and 440 are expanded by being separated in accordance with the shape of the dilated annulus. Adjustment wire 482 extends from secondary lumen 422 and is coupled at a distal end thereof to control wire 480. Typically, adjustment wire 482 is coupled to a portion of wire 480 that is disposed at a junction between respective second ends 434 and 444 of segments 430 and 440. Similarly, adjustment wire 492 extends from secondary lumen 424 and is coupled at a distal end thereof to control wire 490. Typically, adjustment wire 492 is coupled to a portion of control wire 490 that is disposed at a junction between respective first ends 432 and 442 of segments 430 and 440. Typically, adjustment wires 482 and 492 are irreversibly coupled, e.g. knotted or otherwise fixed, to control wires 480 and 490, respectively. In some embodiments, adjustment wires 482 and 492 are looped around control wires 480 and 490, respectively.

The separating of segments 430 and 440 occurs when the physician pushes control wires 480 and 490 while pushing adjustment wires 482 and 492. Thus, adjustment wires 482 and 492 provide an auxiliary pushing force which helps expand segments 430 and 440. Such pushing of the control wires feeds greater portions of control wires 480 and 490 into segments 430 and 440. The relaxed configuration of control wires 480 and 490 is shown in Fig. 2C, while the taut configuration thereof is shown in Fig. 2B. Typically, segments 430 and 440 expand annularly as increasing lengths of control wires 480 and 490 are pushed and fed into segments 430 and 440.

In some embodiments of the present invention, adjustment wires 482 and 492 are pulled to elevate portions of segments 430 and 440, such that the segments conform to the shape of annulus 40. For example, pulling adjustment wire 482 elevates the portion of control wire 480 which is disposed between segments 430 and 440. In response to the pulling, second ends 434 and 444 of segments 430 and 440, respectively, are elevated.

Control wires 480 and 490 enable the physician to control a relative disposition of second ends 434 and 444 and first ends 432 and 442 of segments 430 and 440, respectively. For example, distal pushing of the first and second ends of control wire 480 distances second ends 434 and 444 of segments 430 and 440, respectively. Similarly, distal pushing of the first and second ends of control wire 490 distances first ends 432 and 442 of segments 430 and 440, respectively. It is to be noted that the use of two discrete control wires allows for independent control of the

distance that separates first ends 432 and 442 and the distance that separates second ends 434 and 444 of segments 430 and 440.

5 Additionally, pulling on respective ends of control wires 480 and 490 shapes segments 430 and 440 in accordance with the curved structural conformation of annulus 40 at a given site destined for anchoring of a respective one of the segments thereto. For example, pulling on a first end of control wire 490 and on a first end of control wire 480 curves segment 430 by drawing together second end 432 and first end 434, respectively, of segment 430. Thus, segment 430 is compressed at least in part, and is made to assume a shape according to the curvature of the annulus at the
10 base of the anteromedial leaflet.

Reference is now made to Fig. 2D, which is a schematic illustration of the deployment and expansion of segments 430 and 440 as described hereinabove with reference to Fig. 2C, with the exception that structure 408 is optionally rotated as appropriate about an axis of annulus 40, in accordance with an embodiment of the
15 present invention. Guided by echocardiography, the physician assesses the relative disposition of segments 430 and 440 with respect to annulus 40 of heart 20. Multilumen catheter 420 is configured to be rotatable 360 degrees about a longitudinal axis thereof. By rotating multilumen catheter 420, the segments are positioned properly with respect to the annulus. That is, segment 440 is positioned
20 above a portion of annulus 40 at the base of the posterolateral leaflet, while segment 430 is positioned above a portion of annulus 40 at the base of the anteromedial leaflet.

Fig. 2E shows catheter 410 comprising a steering wire 500, in accordance with an embodiment of the present invention. Typically, a distal end of steering wire 500 is coupled to a distal end of catheter 410. A proximal end of wire 500 is disposed at a
25 site outside the body of the patient, enabling the physician to steer the distal end of catheter 410. Following the deployment and expansion of annuloplasty structure 408, multilumen catheter 420 is retracted slightly within advancement catheter 410. Retracting multilumen catheter 420 frees the lumen of the distal end of catheter 410, thereby restoring flexibility to the distal end of catheter 410 and enabling proper
30 steering thereof. Structure 408 is pushed toward annulus 40 by pushing on both catheter 410 and on wires 480 and 490. Additionally, the structure is properly aligned with annulus 40 by steering and/or rotating the distal tip of catheter 410.

Fig. 2F shows system 400 following the aligning of segments 430 and 440 with annulus 40, in accordance with an embodiment of the present invention. Segment 440 is aligned against the base of posterolateral leaflet 32 at the annulus, and segment 430 is aligned against the base of anteromedial leaflet 34 at the annulus. Segments 430 and 440 are shown prior to anchoring thereof to annulus 40. Multilumen catheter 420 is shown in a slightly retracted state within catheter 410.

Reference is now made to Figs. 3A and 3B, which are schematic illustrations of system 400 comprising an anchoring system 600, in accordance with an embodiment of the present invention. Once advancement catheter 410 has positioned segments 430 and 440 in their proper orientation with respect to annulus 40, catheter 410 is retracted slightly within catheter 404 and a distal end of multilumen catheter 420 is exposed. At a site proximal to catheter 404, and outside the body of the patient, the physician slides a first anchoring system 600 around both ends of a first flexible and longitudinal guide member 470. Anchoring system 600 is advanced through primary lumen 426 of multilumen catheter 420. Anchoring system 600 is advanced along guide member 470 and subsequently inserted, in part, into channel 460, as shown in Fig. 3B.

Reference is now made to Figs. 4A-E, which are schematic illustrations of anchoring system 600, in accordance with an embodiment of the present invention. Fig. 4A shows a bar 710 disposed within channel 460. Typically, bar 710 is disposed perpendicularly to an axis of channel 460, and at the base of the channel. It is to be noted that bar 710 is disposed parallel to the longitudinal axis of segment 440 (or segment 430) by way of illustration and not limitation. For example, bar 710 may be disposed perpendicularly to the axis of segment 440. Guide member 470 is disposed within channel 460 and is reversibly coupled to structure 408 via bar 710. Typically, guide member 470 is looped around bar 710 prior to the advancement of structure 408 into the body of the patient. When structure 408 is disposed within heart 20, both ends of guide member 470 are exposed outside the body of the patient, thus enabling the physician to slide anchoring system 600 around both ends of member 470 and therealong toward annulus 40 of heart 20.

Fig. 4B shows anchoring system 600 comprising an outer tube 610 housing an advancement tube 620, which is reversibly coupled to an anchoring structure 740. Typically, anchoring structure 740 comprises a helical element whose proximal end is

tightly wrapped around a distal end of advancement tube 620. Outer tube 610 typically prevents radial expansion of anchoring structure 740 within primary lumen 426 of multilumen catheter 420 as element 740 is advanced therein. Anchoring system 600 is advanced within channel 460, as shown in Fig. 4C.

5 Reference is now made to Fig. 4D. Anchoring of anchoring structure 740 begins when the physician rotates advancement tube 620 about a longitudinal axis thereof. Such rotation corkscrews a distal portion of the helical element around and beyond bar 710 and subsequently into annulus 40 of the patient.

 Reference is made to Figs. 4A and 4B. Typically, channel 460 has a diameter
10 D2, e.g., between about 0.8 mm and 1.2 mm, typically 1.0 mm. Diameter D2 is thus sized in order to enable passage of anchoring structure 740 through channel 460. Typically, anchoring structure 740 has a diameter D3 of between about 0.5 mm and 1.5 mm, e.g., 1 mm. Typically, each coil of the coiled, helical element has a diameter D4 of between about 0.05 mm and 0.5 mm, e.g., 0.2 mm.

15 Reference is again made to Fig. 4B. Typically, the helical element is shaped to define at least two adjacent distal rotational subunits 720 and at least two adjacent proximal rotational subunits 730. A distance Di1 (e.g., between about 0.3 mm and about 0.6 mm) between adjacent distal rotational subunits 720 is typically greater than
20 a distance Di2 (e.g., between about 0 mm and about 0.4 mm) between adjacent proximal rotational subunits 730. Typically a diameter of bar 710 is less than distance Di1 and greater than distance Di2. Distance Di1 enables distal rotational subunits 720 to be corkscrewed around bar 710 and subsequently into annulus 40 of the patient. Distance Di2 is typically less than a diameter of bar 710, and therefore restricts proximal rotational subunits 730 from being corkscrewed fully around bar 710 and
25 into annulus 40.

 During an attempt to corkscrew proximal rotational subunits 730 around bar 710, bar 710 restricts the rotation of subunits 730 therearound and applies a counterforce to a torque applied by rotation of tube 620. The counterforce applied by bar 710 expands proximal subunits 730 radially such that subunits 730 are no longer
30 wrapped tightly around the distal end of tube 620. Following the expansion of subunits 730, anchoring structure 740 is released from tube 620, typically by pulling on tube 620 while continuing to apply a rotational, helix-expanding force to proximal

subunits 730. Tube 620 is then pulled proximally along guide member 470 and extracted from within the body of the patient, as shown in Fig. 4E. During the removal of tube 620 from heart 20, guide member 470 typically remains within system 400, although it is optionally removed at the same time as tube 620.

5 In some embodiments of the present invention, a few rotational subunits of the helical element are wrapped around a distal end of tube 620, while the remaining rotational subunits extend distally from the distal end of tube 620. Typically, a smaller number of rotational subunits are wrapped around tube 620 than the number of rotational subunits that extend distally from the distal end of tube 620 and are not
10 wrapped around the distal end of tube 620. As shown by way of illustration and not limitation, three rotational subunits are wrapped around the distal end of tube 620, while four rotational subunits are disposed distally to the distal end of tube 620. The rotational subunits wrapped around the distal end of tube 620 generally provide enough frictional force to maintain their position around the distal end of tube 620.

15 A protrusion (not shown) is typically disposed along the distal end of tube 620 adjacent to the proximal-most tip of the helical element of anchoring structure 740. During initial implantation of the anchoring structure within annulus 40 of the patient (i.e., as tube 620 is rotated), the protrusion applies a circumferentially-directed pushing force to the proximal-most tip of the helical element. By pushing on the
20 proximal-most tip of the helical element, the protrusion typically adds to the frictional force described above, in order to rotate anchoring structure 740. One or both of these forces enable a distal end of structure 740 to puncture annulus 40. As anchoring structure 740 is advanced into tissue of annulus 40, the proximal end of anchoring structure 740 slides distally along the distal end of tube 620 and away from the
25 protrusion.

 Following implantation within annulus 40 of distal rotational subunits 720, the distal end of tube 620 is impeded by bar 710. The physician continues to rotate tube 620 such that the proximal-most tip of anchoring structure 740 continues to slide distally from the protrusion while the entire anchoring structure 740 continues to be
30 advanced distally within tissue of annulus 40. During the continued rotation of tube 620, fewer rotational subunits are wrapped around the distal end of tube 620, thereby reducing friction between anchoring structure 740 and the distal end of tube 620. After a sufficient number of rotations, the minimal friction between structure 740 and

the distal end of tube 620 enables the physician to pull on tube 620 in order to detach tube 620 from anchoring structure 740.

It is to be understood that use of a helical anchoring structure 740 is described herein by way of illustration and not limitation, and that the scope of the present invention includes the use of other apparatus for anchoring annuloplasty structure 408 to annulus 40. For example, anchoring structure 740 may comprise a screw, harpoon, barb, or any other anchoring structure known in the art. In some embodiments, anchoring structure 740 comprises a wire configured to penetrate annulus 40 in a generally straight configuration and to subsequently assume a curved configuration once inside tissue of annulus 40.

Reference is now made to Figs. 5A-B, which are schematic illustrations of anchoring system 600, which anchors segments 430 and 440 to annulus 40 of heart 20, in accordance with an embodiment of the present invention. Fig. 5A shows segment 440 being anchored, via anchoring system 600, to annulus 40 at the base of posterolateral leaflet 32. A respective anchoring system 600 is sequentially advanced along each guide member 470 until both segments 430 and 440 are anchored to annulus 40, and tubes 620 and guide members 470 are withdrawn.

As shown, the helical element of anchoring structure 740 comprises a pointed distal tip 750 configured to puncture tissue of annulus 40 in order to enable screwing of structure 740 within annulus 40 of the patient. In some embodiments, distal tip 750 comprises a barb or anchoring structure 740 comprises a plurality of barbs, configured to provide a lock between structure 740 and annulus 40.

Following the anchoring of each structure 740 within annulus 40, each guide member 470 is decoupled from the respective bar 710. For embodiments in which guide member 470 is looped around bar 710, guide member 470 is decoupled from bar 710 when the physician pulls on a first end of guide member 470 from a site outside the body of the patient. Guide member 470 slides around bar 710 until it is extracted from within the body of the patient.

In some embodiments, a first end of guide member 470 comprises a material configured to dissolve when exposed within heart 20 of the patient. In such an embodiment, guide member 470 is typically not looped around bar 710, rather, it is coupled at its first end to bar 710 while a second end thereof is disposed outside the

body of the patient. Following anchoring of structure 740 to annulus 40 as described hereinabove, the first end of guide member 470 dissolves, thereby decoupling guide member 470 from bar 710. Guide member 470 is then pulled from its second end until the first end is extracted from within the body of the patient.

5 In some embodiments, a first end of guide member 470 is coupled to one of the segments, prior to placement in the patient's body, by, for example, passing through channel 460 and being attached to an external surface of the segment. Alternatively, guide member 470 comprises a "T"-shaped anchor at a distal end of guide member 470, which passes through channel 460 and inhibits proximal motion
10 of the "T"-shaped anchor through the channel. In such an embodiment, guide member 470 is typically not looped around bar 710. Typically, a second end of guide member 470 is disposed outside the body of the patient. Following anchoring of structure 740 to annulus 40 as described hereinabove, the physician pulls on the second end of guide member 470 in order to tear the guide member at a pre-weakened point on the
15 guide member, typically slightly proximal to the segment. Guide member 470 is then extracted from within the body of the patient while the distal-most portion of guide member 470 that is attached to the external surface of the segment, or the "T"-shaped anchor, remains disposed within structure 408.

Reference is now made to Fig. 5C, which is a schematic illustration of system
20 400, comprising a tensile suture 800 configured for sliding advancement through segments 430 and 440, in accordance with an embodiment of the present invention. One of control wires 480 or 490, e.g., control wire 480, is extracted from within segments 430 and 440 when the physician pulls on a first end of wire 480. Subsequently, the physician replaces control wire 490 with tensile suture 800 by (a)
25 tying a first end of suture 800 to a first end of wire 490, and then (b) pulling on a second end of wire 490. The physician pulls wire 490 until the first end of suture 800 has replaced control wire 490 in segments 430 and 440, e.g., until suture 800 is once again exposed outside the body of the patient. As shown in Fig. 5C, a portion of suture 800 remains disposed within both segments 430 and 440. Tensile suture 800
30 comprises a flexible material, e.g., nitinol, Kevlar, titanium, or polytetrafluoroethylene (PTFE), and is configured to reside chronically within segments 430 and 440. For example, suture 800 may comprise a braided polyester suture (e.g., Ticron). Additionally, suture 800 is configured to withstand cardiac

pressures and constant motion of segments 430 and 440 that result from the motion of annulus 40. As such, suture 800 typically has a relatively thick diameter of between about 0.1 mm and about 1.0 mm, typically between about 0.3 mm and about 0.6 mm.

5 In some embodiments, two tensile sutures 800 reside chronically within segments 430 and 440. In such an embodiment, a first tensile suture replaces control wire 480, and a second tensile suture replaces control wire 490. Control wires 480 and 490 are replaced as described hereinabove.

10 In any embodiment, using tactile feedback and optionally in combination with fluoroscopic imaging, first and second ends of suture(s) 800 are pulled to an extent that is based on (a) the level of dilation of the preoperative mitral valve, and/or (b) real-time monitoring of regurgitation minimization.

Fig. 5C shows a lock 820 being advanced around first and second portions of suture 800, in accordance with an embodiment of the present invention. Lock 820 secures together segments 430 and 440 of annuloplasty structure 408, thereby
15 defining its final configuration within annulus 40 of mitral valve 30. The excess portions of tensile suture 800 are clipped proximally to lock 820 and are extracted from the body via catheter 404. Following clipping, first and second ends of suture 800 remain accessible for future tightening together of segments 430 and 440 upon need therefor. In some embodiments, the first and second ends of suture 800 are
20 located using fluoroscopy or any other method described herein.

Fig. 5D shows annuloplasty structure 408 in a closed state, in accordance with an embodiment of the present invention. By reducing a circumference of annulus 40, leaflets 32 and 34 are lifted and/or drawn toward one another to prevent recurring dilation of mitral valve 30, restore leaflet coaptation, and reduce mitral regurgitation.

25 It is to be noted that in an embodiment of the present invention, guide members 470 comprise a screw at a distal end thereof. Guide member 470 in this embodiment is suitable for conveying torque, such that by rotating the proximal end of the guide member from outside the body of the patient, the screw at the distal end is screwed into the annulus. Following anchoring of the screw to the annulus of the
30 patient, the guide member is clipped proximally to the screw and is extracted from within the body of the patient. In such an embodiment, guide member 470 is

configured to anchor structure 408 to annulus 40 independently of bar 710 described hereinabove.

It is to be noted that the scope of the present invention is not limited to minimally-invasive procedures (e.g., transcatheter procedures such as percutaneous or intercostal penetration procedures), and includes applications in which system 400 is applied in invasive procedures such as open heart surgery.

It is to be further noted that system 400 may be used to treat valves other than mitral valve 30. For example, system 400 may be used to treat an aortic valve of the patient.

The scope of the present invention includes embodiments described in one or more of the following:

- US Provisional Patent Application 60/873,075 to Gross et al., entitled, "Mitral valve closure techniques," filed December 5, 2006;
- US Provisional Patent Application 60/902,146 to Gross et al., entitled, "Mitral valve closure techniques," filed on February 16, 2007;
- a US provisional patent application to Gross et al., entitled, "Segmented ring placement," filed October 29, 2007; and
- a US regular application to Gross et al., entitled, "Segmented ring placement," filed on even date herewith.

All of these applications are incorporated herein by reference. Techniques described herein can be practiced in combination with techniques described in one or more of these applications.

For some applications, techniques described herein are practiced in combination with techniques described in one or more of the references cited in the Background section and Cross-References section of the present patent application. All references cited herein, including patents, patent applications, and articles, are incorporated herein by reference.

It will be appreciated by persons skilled in the art that the present invention is not limited to what has been particularly shown and described hereinabove. Rather, the scope of the present invention includes both combinations and subcombinations of

the various features described hereinabove, as well as variations and modifications thereof that are not in the prior art, which would occur to persons skilled in the art upon reading the foregoing description.

CLAIMS

1. Apparatus for repairing a valve of a body of a patient, the valve including an annulus and at least first and second leaflets, comprising:
 - at least a first discrete segment and a second discrete segment of an annuloplasty structure, each segment being shaped to provide a respective lateral wall, each lateral wall being shaped to define at least one lumen of the respective segment; and
 - at least a first and a second control wire, each control wire configured for sliding advancement through both the first and second segments, wherein:
 - the first control wire is configured to control a relative disposition of a first end of the first segment and a first end of the second segment, and
 - the second control wire is configured to control a relative disposition of a second end of the first segment and a second end of the second segment.
2. The apparatus according to claim 1, wherein the first and second segments are configured for transcatheter advancement into a left atrium of a patient.
3. The apparatus according to claim 1, wherein the first and second segments are configured for simultaneous advancement toward a left atrium of a patient.
4. The apparatus according to any one of claims 1-3, wherein for each lateral wall of each segment, the lateral wall has a first and a second portion, and the segment is shaped to provide a channel extending from the first portion to the second portion.
5. The apparatus according to claim 4, further comprising a bar configured to be disposed within the channel.
6. The apparatus according to claim 5, wherein the bar is disposed within the channel substantially perpendicular to an axis of the channel.
7. The apparatus according to claim 5, further comprising a flexible longitudinal guide member configured to be removably coupled to the bar.
8. The apparatus according to claim 7, further comprising an anchoring structure, wherein, while the guide member is disposed within the body of the patient, the anchoring structure is configured to be advanced via the guide member, through the channel, and subsequently anchored to the annulus of the patient.

9. The apparatus according to claim 8, wherein the anchoring structure comprises a pointed distal tip.
10. The apparatus according to claim 8, wherein, while the guide member is disposed within the body of the patient, the anchoring structure is configured to be advanced along the guide member from a site outside the body of the patient.
11. The apparatus according to claim 10, wherein, while the guide member is disposed within the body of the patient, the guide member is configured to be decoupled from the bar subsequent to the anchoring of the anchoring structure to the annulus.
12. The apparatus according to claim 8, wherein the anchoring structure comprises a helical element at a distal end thereof, the helical element shaped to provide a proximal end of the helical element and a distal end of the helical element.
13. The apparatus according to claim 12, further comprising an advancement tube having a distal tip thereof, wherein at least a portion of the proximal end of the helical element is configured to be coupled to the distal tip of the advancement tube.
14. The apparatus according to claim 13, wherein the helical element is shaped to define a first number of proximal rotational subunits and a second number of distal rotational subunits, and wherein the proximal rotational subunits are wrapped around the distal tip of the advancement tube.
15. The apparatus according to claim 14, wherein the proximal rotational subunits are coupled to the distal tip of the advancement tube by a first frictional force.
16. The apparatus according to claim 15, wherein the second number is greater than the first number.
17. The apparatus according to claim 16, wherein the advancement tube is configured to be rotated and, in response to the rotation, the distal rotational subunits are configured to be implanted within the annulus of the patient.
18. The apparatus according to claim 17, wherein at least a portion of the distal tip is shaped to define a protrusion disposed adjacent to the proximal end of the helical element, the protrusion being configured to apply a circumferentially-directed force to the proximal end of the helical element as the advancement tube is rotated.

19. The apparatus according to claim 17, wherein during the rotation of the advancement tube:
the proximal rotational subunits are configured to slide distally along the distal tip of the advancement tube, and
5 in response to the sliding, a portion of the first number of proximal rotational subunits remains wrapped around the distal tip of the advancement tube.
20. The apparatus according to claim 19, wherein a number of proximal rotational subunits in the portion is less than the first number of proximal rotational subunits.
21. The apparatus according to claim 20, wherein the portion of the proximal rotational subunits is coupled to the distal tip of the advancement tube by a second frictional force, the second frictional force being weaker than the first frictional force.
22. The apparatus according to claim 21, wherein the second frictional force being weaker than the first frictional force facilitates decoupling of the distal tip of the advancement tube from the helical element.
- 15 23. The apparatus according to claim 12, wherein:
the helical element is shaped to define at least two adjacent distal rotational subunits and at least two adjacent proximal rotational subunits, and
a distance between the two adjacent distal rotational subunits is greater than a distance between the two adjacent proximal rotational subunits.
- 20 24. The apparatus according to claim 23, wherein the distance between the distal rotational subunits enables the distal rotational subunits to be corkscrewed around the bar and subsequently into the annulus of the patient.
- 25 25. The apparatus according to claim 23, wherein the distance between the proximal rotational subunits restricts the proximal rotational subunits from being corkscrewed around the bar and into the annulus of the patient.
26. The apparatus according to any one of claims 1-3, wherein the first and second segments are configured to be advanced toward a left atrium of the patient in a generally straight configuration and subsequently are made to assume a curved configuration.
- 30 27. The apparatus according to claim 26, wherein the first and second control wires are configured to pull the first and second segments into curved configurations.

28. The apparatus according to claim 26, wherein the first and second segments comprise a shape-memory alloy, the alloy being configured to assume a curved configuration once the segments have been advanced into the left atrium of the patient.
- 5 29. The apparatus according to any one of claims 1-3, further comprising at least first and second flexible longitudinal guide members, the first and second guide members configured to be removably coupled to the first and second segments, respectively, each guide member being configured to facilitate anchoring of the respective segment to the annulus of the patient.
- 10 30. The apparatus according to claim 29, further comprising respective at least first and second anchoring structures, the first and second anchoring structures configured to be disposed at respective distal ends of the first and second guide members, respectively, the anchoring structures being configured to be screwed into the annulus of the patient in response to a rotational force applied to a respective
15 proximal end of the respective guide members.
31. The apparatus according to claim 30, wherein each of the anchoring structures comprises a pointed distal tip.
32. The apparatus according to any one of claims 1-3, wherein the first and second control wires are configured to control a relative disposition of the first and second
20 segments.
33. The apparatus according to claim 32, wherein the first and second control wires are configured to separate the first and second segments.
34. The apparatus according to claim 32, wherein the first and second control wires are configured to facilitate positioning of the first and second segments along
25 the annulus.
35. The apparatus according to claim 32, wherein the first and second segments are configured to be advanced toward a left atrium of the patient in a generally straight configuration thereof, and wherein the first and second control wires are configured to pull the first and second segments into a curved configuration.
- 30 36. The apparatus according to claim 32,

wherein the first and second segments are configured to be advanced toward an atrium of a heart of the patient in a generally straight configuration, the straight configuration defining a longitudinal axis of the respective first and second segments;

5 wherein at least a portion of the first and second segments is shaped to define one or more compressible units, and

wherein the compressible units are configured to be compressed in parallel with the longitudinal axis of the respective segments.

37. The apparatus according to claim 36, wherein the compressible units are configured to be compressed in response to an application of a pulling force to the
10 first and second control wires.

38. The apparatus according to claim 36, wherein the first control wire is configured to compress the first segment at least in part in response to an application of a pulling force to at least a portion of the first control wire, and wherein the second control wire is configured to compress the second segment at least in part in response
15 to an application of a pulling force to at least a portion of the second control wire.

39. The apparatus according to any one of claims 1-3, further comprising first and second adjustment wires, coupled to the first and second control wires, respectively, wherein the first adjustment wire is coupled to the first control wire at a first junction between the first and second segments, and wherein the second adjustment wire is
20 coupled to the second control wire at a second junction between the first and second segments.

40. The apparatus according to claim 39, wherein the adjustment wires are configured to facilitate aligning of the first and second segments with the annulus by separating the segments.

25 41. The apparatus according to claim 39, wherein the adjustment wires are configured to facilitate aligning of the first and second segments with the annulus by elevating portions of the first and second segments.

42. Apparatus for repairing a valve of a body of a patient, the valve including an annulus and at least first and second leaflets, comprising:
30 an annuloplasty structure,

- shaped to provide one or more channels, each channel extending from a respective first portion of a lateral wall of the annuloplasty structure to a respective second portion of the lateral wall of the annuloplasty structure, and comprising one or more bars, each bar configured to be disposed within a respective one of the channels; and one or more flexible longitudinal guide members, each guide member configured to be removably coupled to a respective one of the bars.
43. The apparatus according to claim 42, wherein each guide member is removably coupled to the respective bar by being looped around the respective bar.
44. The apparatus according to claim 42, wherein the annuloplasty structure comprises an annuloplasty ring.
45. The apparatus according to claim 42, wherein the annuloplasty structure comprises a partial annuloplasty ring.
46. The apparatus according to claim 42, wherein the structure and the one or more guide members are configured to be transcatheterally advanced into a left atrium of the patient.
47. The apparatus according to claim 42, wherein the structure and the one or more guide members are configured to be simultaneously advanced toward a left atrium of the patient.
48. The apparatus according to claim 42, wherein the annuloplasty structure comprises two or more segments of an annuloplasty ring.
49. The apparatus according to claim 42, wherein each bar is disposed within a respective one of the channels substantially perpendicular to an axis of the channel.
50. The apparatus according to claim 42, wherein the structure comprises a shape-memory alloy.
51. The apparatus according to any one of claims 42-50, wherein the structure is configured to be advanced toward a left atrium of the patient in a generally straight configuration and subsequently to be made to assume a curved configuration.
52. The apparatus according to claim 51, further comprising at least one control wire, wherein the control wire is configured to pull the structure into the curved configuration.

53. The apparatus according to claim 51, wherein the structure comprises a shape-memory alloy, the alloy being configured to assume a curved configuration once the structure has been advanced into the left atrium of the patient.

54. The apparatus according to any one of claims 42-50, further comprising at least one control wire in communication with the structure configured to adjust a disposition of the structure.

55. The apparatus according to claim 54, wherein the lateral wall of the annuloplasty structure is shaped to define at least one lumen of the structure.

56. The apparatus according to claim 55, wherein the at least one control wire is configured for sliding advancement through the at least one lumen, and to control from within the lumen a conformation of the structure.

57. The apparatus according to claim 56,
wherein the structure is configured to be advanced toward a left atrium of the patient in a generally straight configuration, the straight configuration defining a longitudinal axis thereof,

wherein at least a portion of the structure is shaped to define one or more compressible units, and

wherein the compressible units are configured to be compressed in parallel with the longitudinal axis.

58. The apparatus according to claim 57, wherein the compressible units are configured to be compressed in response to an application of a pulling force to the at least one control wire.

59. The apparatus according to claim 54, wherein the structure comprises a first and a second segment, the first and second segments each shaped to provide a respective lateral wall, each lateral wall being shaped to define at least one respective lumen of the respective segment.

60. The apparatus according to claim 59, further comprising at least one adjustment wire coupled to the at least one control wire, wherein the at least one adjustment wire is configured to be coupled to the at least one control wire at a junction between the first and second segments.

61. The apparatus according to claim 60, wherein the at least one adjustment wire is configured to facilitate aligning of the first and second segments with the annulus by separating the segments.
62. The apparatus according to claim 60, wherein the at least one adjustment wire is configured to facilitate aligning of the first and second segments with the annulus by elevating portions of at least one of the segments.
63. The apparatus according to claim 59, wherein the control wire is configured for sliding advancement through the at least one lumen of each of the first and second segments.
64. The apparatus according to claim 63, wherein the at least one control wire comprises a first and a second control wire.
65. The apparatus according to claim 64, wherein:
the first and second segments are each shaped to provide respective first and second lumens, and
the first control wire is configured for sliding advancement through each of the first lumens, and the second control wire is configured for sliding advancement through each of the second lumens.
66. The apparatus according to claim 64, wherein the first and second control wires are configured to control a relative disposition of the first and second segments.
67. The apparatus according to claim 66, wherein the first and second control wires are configured to separate portions of the first and second segments.
68. The apparatus according to claim 66, wherein the first and second control wires are configured to facilitate positioning of the first and second segments along the annulus.
69. The apparatus according to claim 66, wherein the first and second segments are configured to be advanced toward a left atrium of the patient in a generally straight configuration thereof, and wherein the first and second control wires are configured to pull the first and second segments into a curved configuration.
70. The apparatus according to claim 66,

wherein the first and second segments are configured to be advanced toward a left atrium of the patient in a generally straight configuration, the straight configuration defining a longitudinal axis of the respective first and second segments,

wherein at least a portion of each of the first and second segments is shaped to
5 define one or more compressible units, and

wherein the compressible units are configured to be compressed in parallel with the longitudinal axis of the respective segments.

71. The apparatus according to claim 70, wherein the compressible units are configured to be compressed in response to an application of a pulling force to the
10 first and second control wires.

72. The apparatus according to claim 70, wherein:

the first control wire is configured to compress the first segment at least in part in response to an application of a pulling force to at least a portion of the first control wire, and

15 the second control wire is configured to compress the second segment at least in part in response to an application of a pulling force to at least a portion of the second control wire.

73. The apparatus according to any one of claims 42-50, further comprising one or more anchoring structures, each anchoring structure configured to be advanced
20 through a respective one of the channels and subsequently anchored to the annulus of the patient.

74. The apparatus according to claim 73, wherein the anchoring structure is shaped to define a pointed distal tip.

75. The apparatus according to claim 73, wherein while the guide member is
25 disposed within the body of the patient, each anchoring structure is configured to be advanced along a respective one of the guide members from a site outside the body of the patient.

76. The apparatus according to claim 75, wherein the guide member is configured to be decoupled from the bar subsequent to the anchoring of the anchoring structure to
30 the annulus.

77. The apparatus according to claim 73, wherein each of the anchoring structures comprises a helical element at a distal end thereof.

78. The apparatus according to claim 77, wherein:
the helical element is shaped to define at least two adjacent distal rotational subunits and at least two adjacent proximal rotational subunits, and
a distance between the two adjacent distal rotational subunits is greater than a
5 distance between the two adjacent proximal rotational subunits.
79. The apparatus according to claim 78, wherein the distance between the distal rotational subunits enables the distal rotational subunits to be corkscrewed around the bar and subsequently into the annulus of the patient.
80. The apparatus according to claim 78, wherein the distance between the
10 proximal rotational subunits restricts the proximal rotational subunits from being corkscrewed fully around the bar and into the annulus of the patient.
81. Apparatus for repairing a valve of a body of a patient, the valve including an annulus and at least first and second leaflets, comprising:
an annuloplasty structure comprising a bar; and
15 an anchoring structure comprising a helical element, the helical element shaped to define at least two adjacent distal rotational subunits and at least two adjacent proximal rotational subunits, wherein a distance between the two adjacent distal rotational subunits is greater than a distance between the two adjacent proximal rotational subunits, and wherein:
20 the distance between the distal rotational subunits enables the distal rotational subunits to be corkscrewed around the bar and subsequently into tissue of a patient, and
the distance between the proximal rotational subunits restricts the proximal rotational subunits from being corkscrewed into tissue of the patient.
- 25 82. The apparatus according to claim 81, wherein the annuloplasty structure comprises an annuloplasty ring.
83. The apparatus according to claim 81, wherein the annuloplasty structure comprises a partial annuloplasty ring.
84. The apparatus according to claim 81, wherein the annuloplasty structure
30 comprises two or more segments of an annuloplasty ring.

85. The apparatus according to any one of claims 81-84, further comprising a flexible longitudinal guide member reversibly coupled to the structure, and configured to facilitate anchoring of the annuloplasty structure to the annulus of the patient.
86. The apparatus according to claim 85,
5 wherein the annuloplasty structure is shaped to provide a lateral wall having at least first and second portions, and shaped to provide at least one channel,
wherein the at least one channel extends from the first portion of the lateral wall of the structure to the second portion of the lateral wall of the structure,
wherein the bar is disposed within the at least one channel substantially
10 perpendicular to an axis of the channel, and
wherein the guide member is reversibly coupled to the bar.
87. The apparatus according to claim 85, wherein the anchoring structure is disposed at a distal end of the guide member.
88. The apparatus according to claim 87, wherein the anchoring structure is
15 configured to be screwed into the annulus in response to a rotational force applied to a proximal end of the guide member.
89. The apparatus according to claim 85, further comprising a hollow tube configured to be reversibly coupled to the helical element, and to push the anchoring structure toward the annuloplasty structure.
- 20 90. The apparatus according to claim 89, wherein the hollow tube is configured to be advanced around the guide member while the guide member is disposed within the body of the patient.
91. The apparatus according to claim 89, wherein the helical element is disposed around the hollow tube, wherein the hollow tube is configured to be rotated at a
25 proximal portion thereof, and wherein the anchoring structure is corkscrewed into the annulus of the patient in response to the rotation of the tube.
92. The apparatus according to claim 91, wherein a diameter of the bar is greater than the distance between the proximal rotational subunits, and wherein during an attempt to corkscrew the proximal rotational subunits therearound:

the bar restricts the proximal rotational subunits from being corkscrewed into tissue of the patient by applying a counterforce to a torque applied by the rotation of the tube, and

the proximal rotational subunits are configured to expand radially in response to the counterforce applied by the bar.

93. The apparatus according to claim 92, wherein the helical element is configured to be detached from the hollow tube in response to the radial expansion of the proximal rotational subunits.

94. A method for performing an annuloplasty on a valve of a body of a patient the valve including an annulus and at least first and second leaflets, comprising:

deploying an annuloplasty structure in an atrium of a heart of the patient, the structure including one or more bars and one or more respective flexible longitudinal guide members, each guide member reversibly coupled to a respective one of the bars; positioning the annuloplasty structure along the annulus of the valve of the patient;

advancing one or more respective anchoring structures, each anchoring structure each anchoring structure being passed along a respective one of the flexible longitudinal guide members while the one or more guide members are disposed within the body of the patient;

advancing at least a portion of each anchoring structure beyond the respective bar and into tissue of the patient; and

decoupling each guide member from the respective bar.

95. The method according to claim 94, wherein deploying the annuloplasty structure comprises placing the annuloplasty structure in the atrium during an open heart procedure.

96. The method according to claim 94, wherein deploying the annuloplasty structure comprises deploying at least one segment of an annuloplasty ring.

97. The method according to claim 94, wherein deploying the annuloplasty structure comprises deploying an annuloplasty ring.

98. The method according to claim 94, wherein deploying the annuloplasty structure comprises deploying a partial annuloplasty ring.

99. The method according to any one of claims 94-98, further comprising advancing the annuloplasty structure to the atrium transcatheterally.
100. The method according to claim 99, wherein the method comprises performing, during a single transcatheter advancement, the steps of: (a) deploying the annuloplasty structure, (b) positioning the annuloplasty structure, (c) advancing the one or more
5 respective anchoring structures, (d) advancing the at least a portion of each anchoring structure, and (e) decoupling each guide member.
101. The method according to any one of claims 94-98, wherein positioning the annuloplasty structure comprises adjusting a configuration of the annuloplasty structure with respect to a configuration of the annulus of the patient.
10
102. The method according to claim 101, wherein the annuloplasty structure is generally ring-shaped following the deployment, thereby defining a radius characteristic thereof, and wherein adjusting the configuration of the structure comprises reducing the radius by compressing at least a portion of the structure.
103. The method according to claim 102, wherein compressing comprises applying a pulling force to a control wire disposed within a lumen of the structure.
15
104. The method according to any one of claims 94-98, wherein deploying the structure comprises deploying two segments of the annuloplasty ring.
105. The method according to claim 104, further comprising drawing together the first and second segments.
20
106. The method according to claim 104, wherein positioning the structure along the annulus of the patient comprises positioning the first and second segments along the annulus.
107. The method according to claim 106, wherein positioning the first and second segments comprises positioning the first segment on the annulus along a junction
25 between a base of a first leaflet and the annulus, and positioning the second segment on the annulus along a junction between a base of a second leaflet and the annulus.
108. The method according to claim 106, wherein positioning the first and second segments comprises adjusting a relative disposition of the first and second segments with respect to a configuration of the annulus of the patient.
30

109. The method according to claim 108, wherein adjusting the disposition of the first and second segments comprises elevating at least a portion of the first segment and at least a portion of the second segment.

5 110. The method according to claim 108, wherein adjusting the first and second segments comprises adjusting the first segment independently of the adjusting of the second segment.

111. The method according to claim 108, wherein the annuloplasty structure is configured to assume a generally straight configuration following the deployment, the straight configuration defining a longitudinal axis of the structure, and wherein
10 adjusting the disposition of the first and second segments comprises adjusting a disposition of the first and second segments by compressing in parallel with the longitudinal axis of the structure at least a portion of the first segment and at least a portion of the second segment.

112. The apparatus according to claim 111, wherein compressing comprises
15 applying a pulling force to at least one control wire disposed within a lumen of each of the first and second segments.

113. Apparatus for repairing a valve of a body of a patient, the valve including an annulus and at least first and second leaflets, comprising:

an annuloplasty structure; and
20 a flexible longitudinal guide member removably coupled to the structure, wherein:

the guide member is configured to facilitate anchoring of the annuloplasty structure to the annulus of the patient, and

25 the guide member is configured to be advanced toward the annulus simultaneously with the annuloplasty structure.

114. The apparatus according to claim 113, wherein the annuloplasty structure comprises an annuloplasty ring.

115. The apparatus according to claim 113, wherein the annuloplasty structure comprises a partial annuloplasty ring.

30 116. The apparatus according to claim 113, wherein the annuloplasty structure comprises at least first and second segments of an annuloplasty ring.

117. The apparatus according to any one of claims 113-116, further comprising an anchoring structure configured to anchor the structure to the annulus via the guide member.
118. The apparatus according to claim 117, wherein the anchoring structure
5 comprises a pointed distal tip.
119. The apparatus according to claim 117, wherein of the anchoring structure is disposed at a distal end of the guide member, and is configured to be screwed into the annulus in response to a rotational force applied to a proximal end of the guide member.
- 10 120. The apparatus according to claim 117, wherein the annuloplasty structure is shaped to define a lateral wall having first and second portions, and to provide a channel extending from the first portion of the lateral wall to the second portion of the lateral wall of the structure.
121. The apparatus according to claim 120, wherein the anchoring structure is
15 configured to be advanced through the channel and subsequently anchored to the annulus of the patient while the guide member is disposed within the body of the patient.
122. The apparatus according to claim 120, further comprising a bar configured to be disposed within the channel.
- 20 123. The apparatus according to claim 122, wherein the bar is disposed within the channel substantially perpendicular to an axis of the channel.
124. The apparatus according to claim 122, wherein the guide member is configured to be removably coupled to the bar.
125. The apparatus according to claim 124, wherein the anchoring structure is
25 configured to be advanced along the guide member from a site outside the body of the patient while the guide member is disposed within the body of the patient.
126. The apparatus according to claim 125, wherein the guide member is configured to be decoupled from the bar subsequent to the anchoring of the anchoring structure to the annulus.

127. The apparatus according to claim 117, wherein the anchoring structure comprises a helical element at a distal end thereof, the helical element being configured to be corkscrewed at least in part into the annulus of the patient.

5 128. The apparatus according to claim 127, wherein the helical element is shaped to define at least two adjacent distal rotational subunits and at least two adjacent proximal rotational subunits, and wherein a distance between the two adjacent distal rotational subunits is greater than a distance between the two adjacent proximal rotational subunits.

10 129. The apparatus according to claim 128, wherein the distance between the distal rotational subunits enables the distal rotational subunits to be corkscrewed around the bar and subsequently into the annulus of the patient.

130. The apparatus according to claim 128, wherein the distance between the proximal rotational subunits restricts the proximal rotational subunits from being corkscrewed around the bar and into the annulus of the patient.

15

1/18

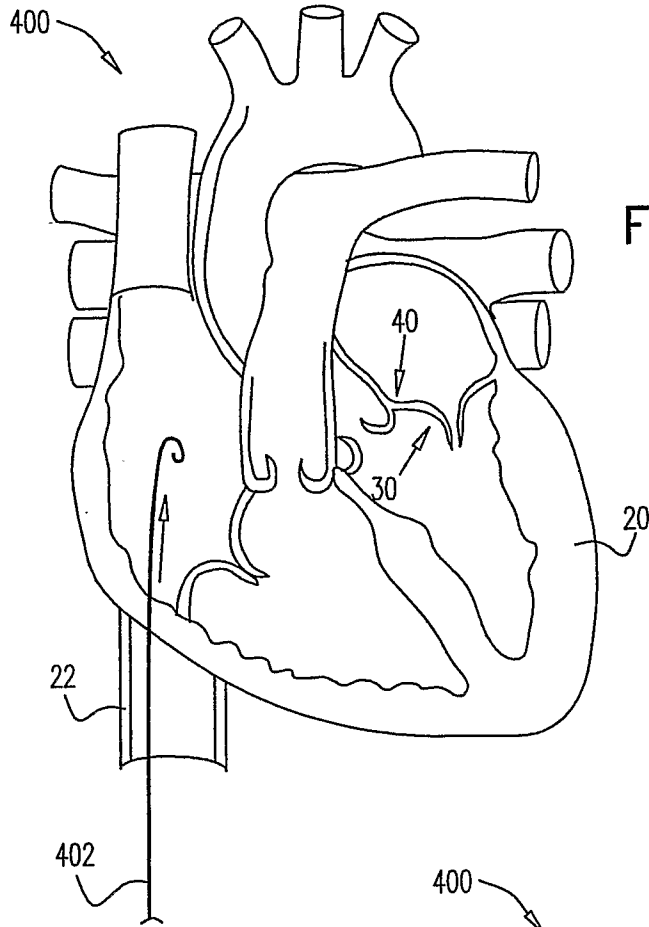
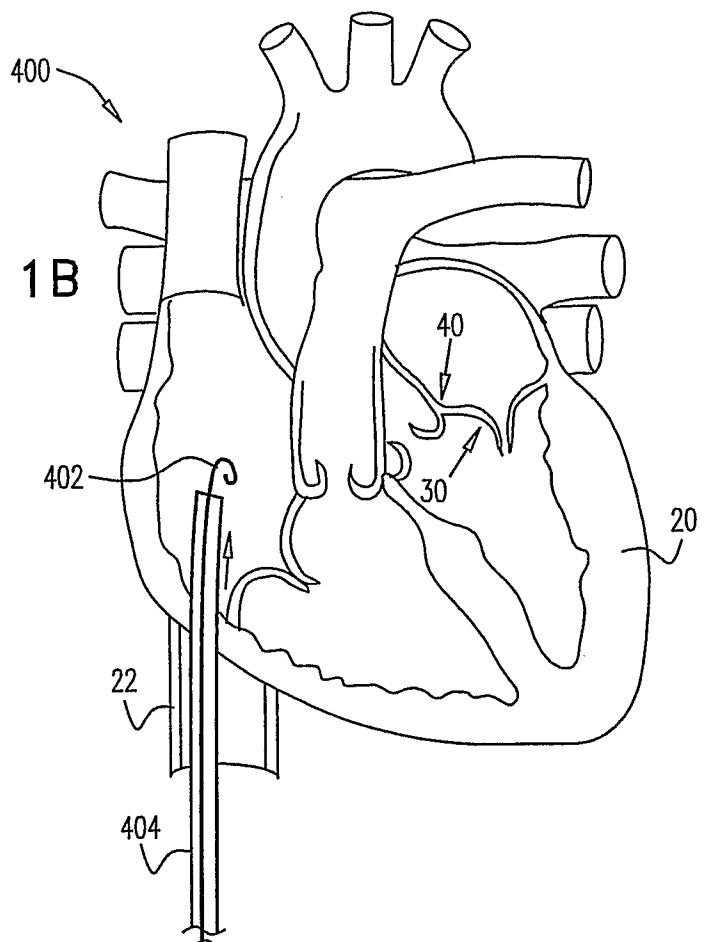
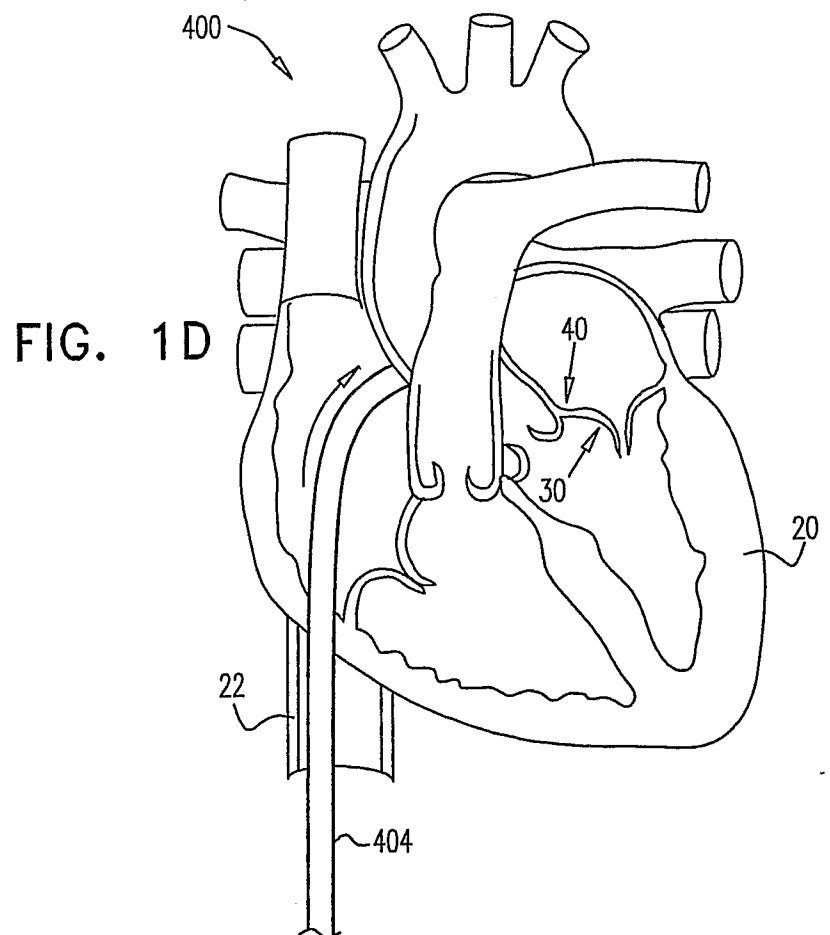
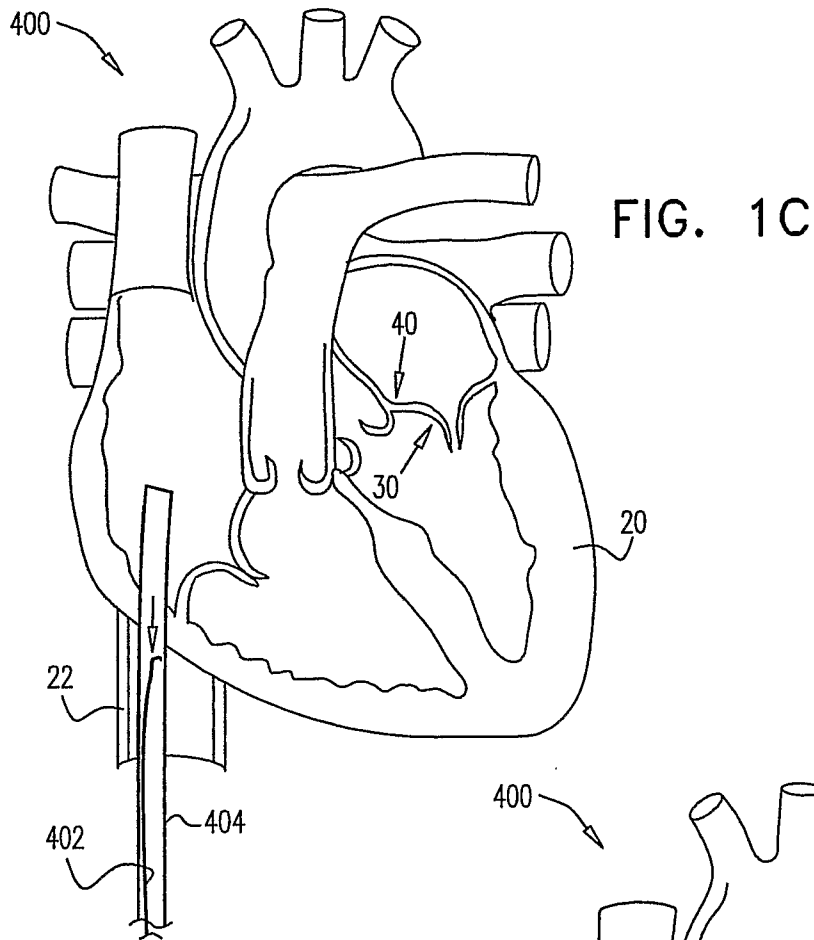

FIG. 1A

FIG. 1B



2/18



3/18

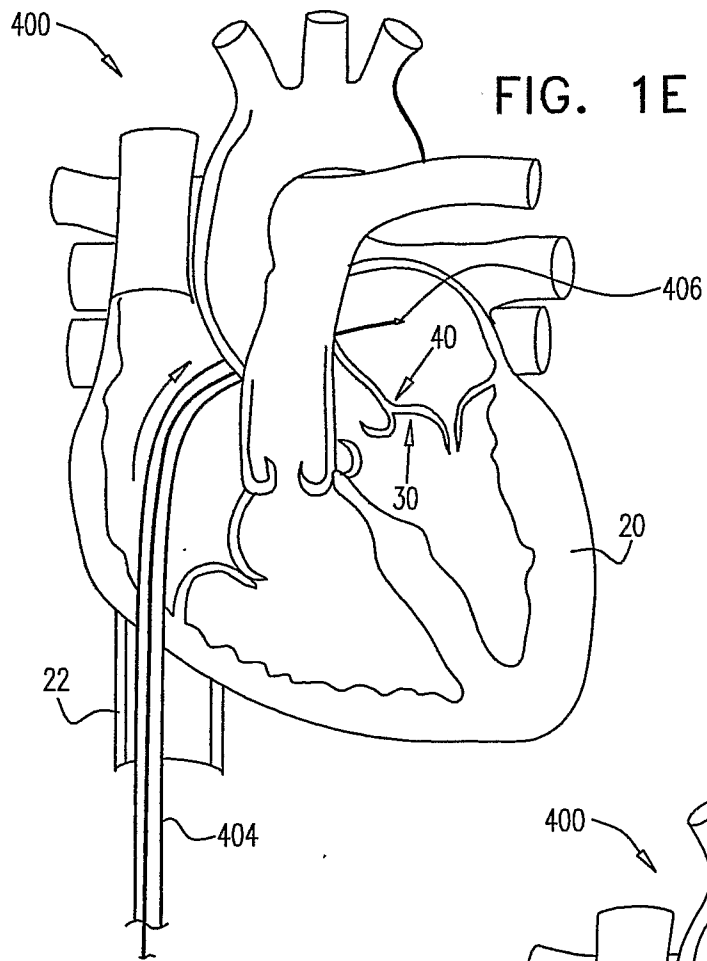
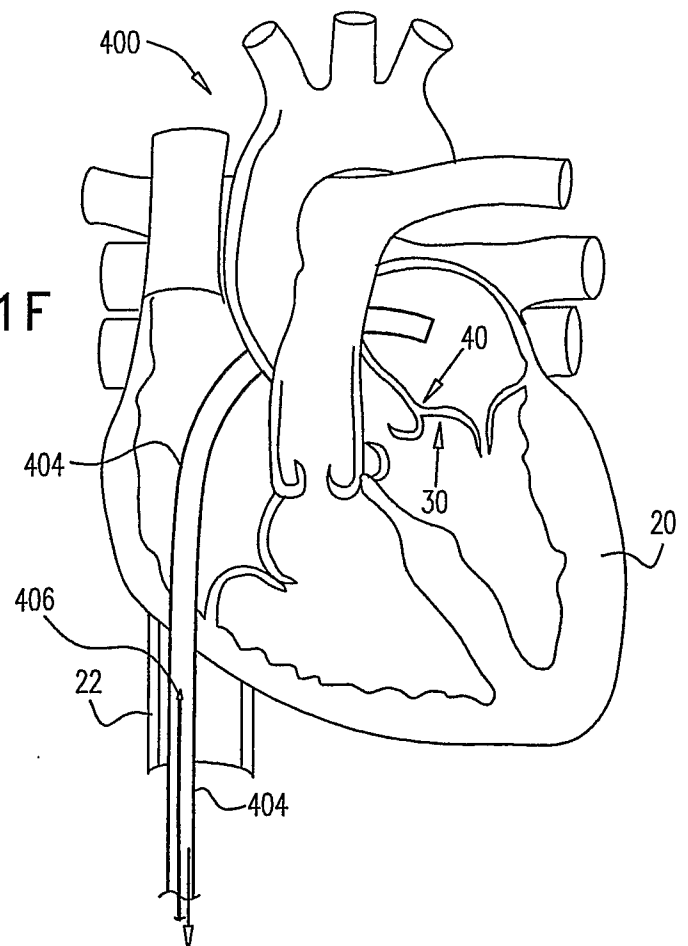
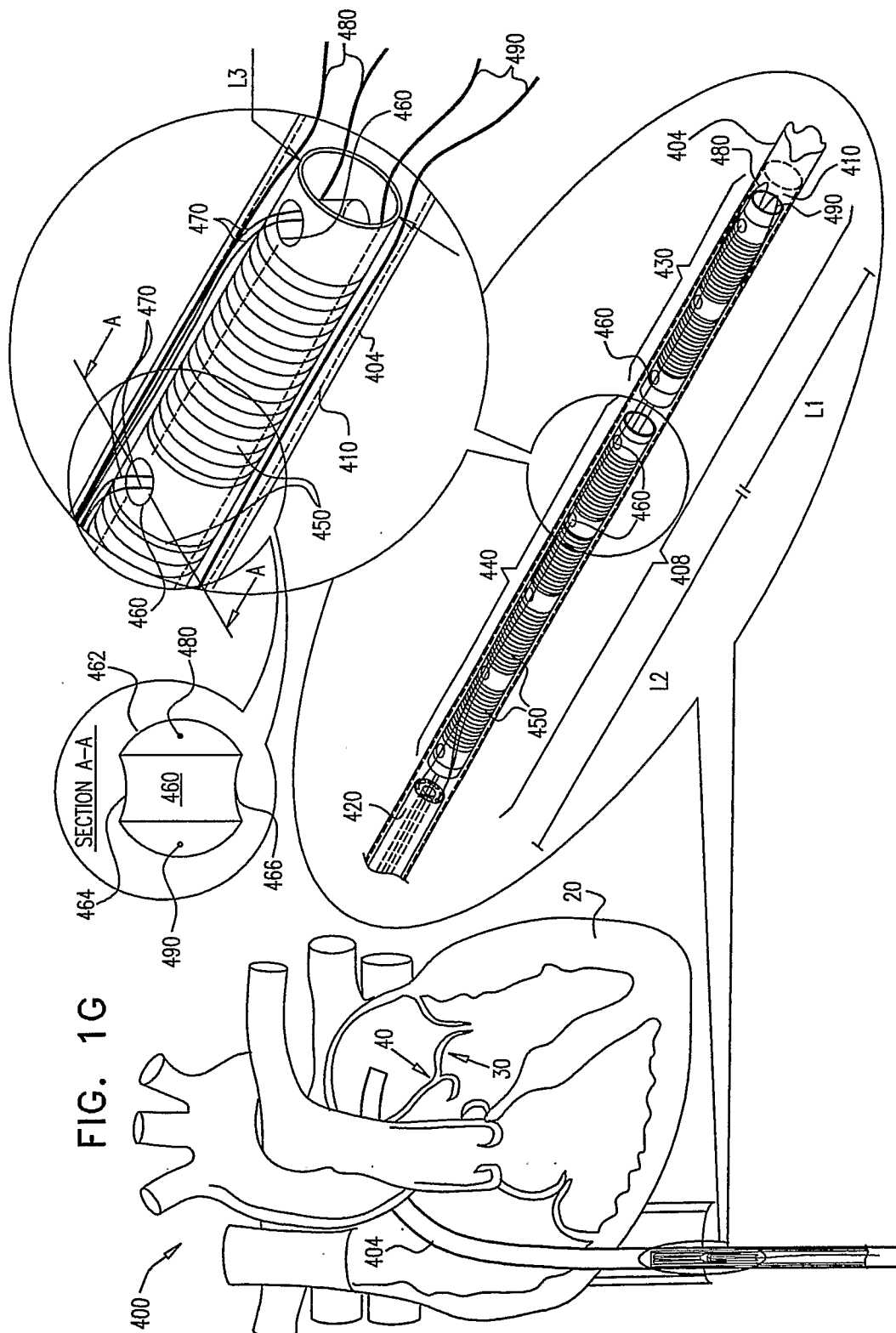

FIG. 1F



4/18



5/18

FIG. 1H

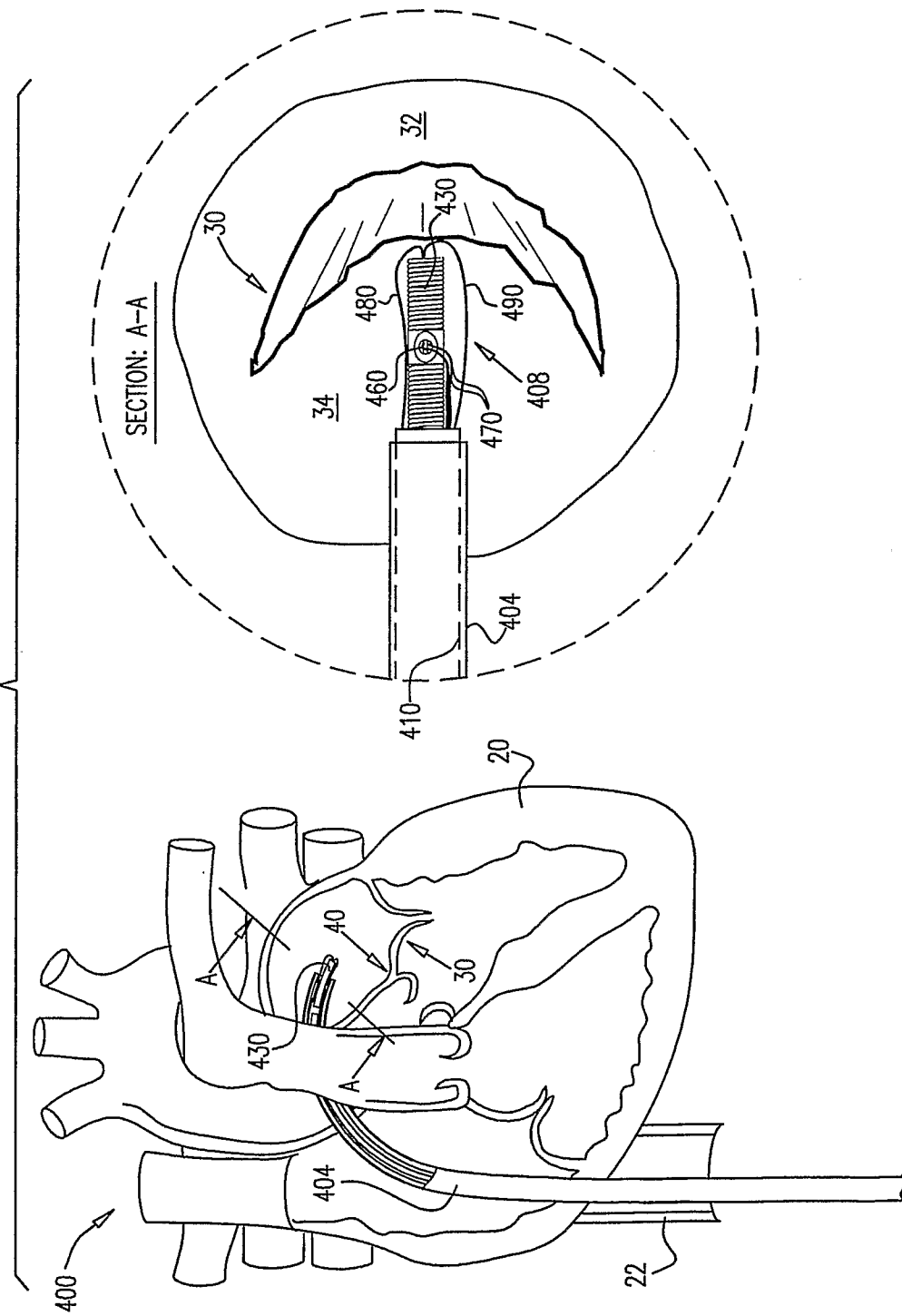

6/18

FIG. 11

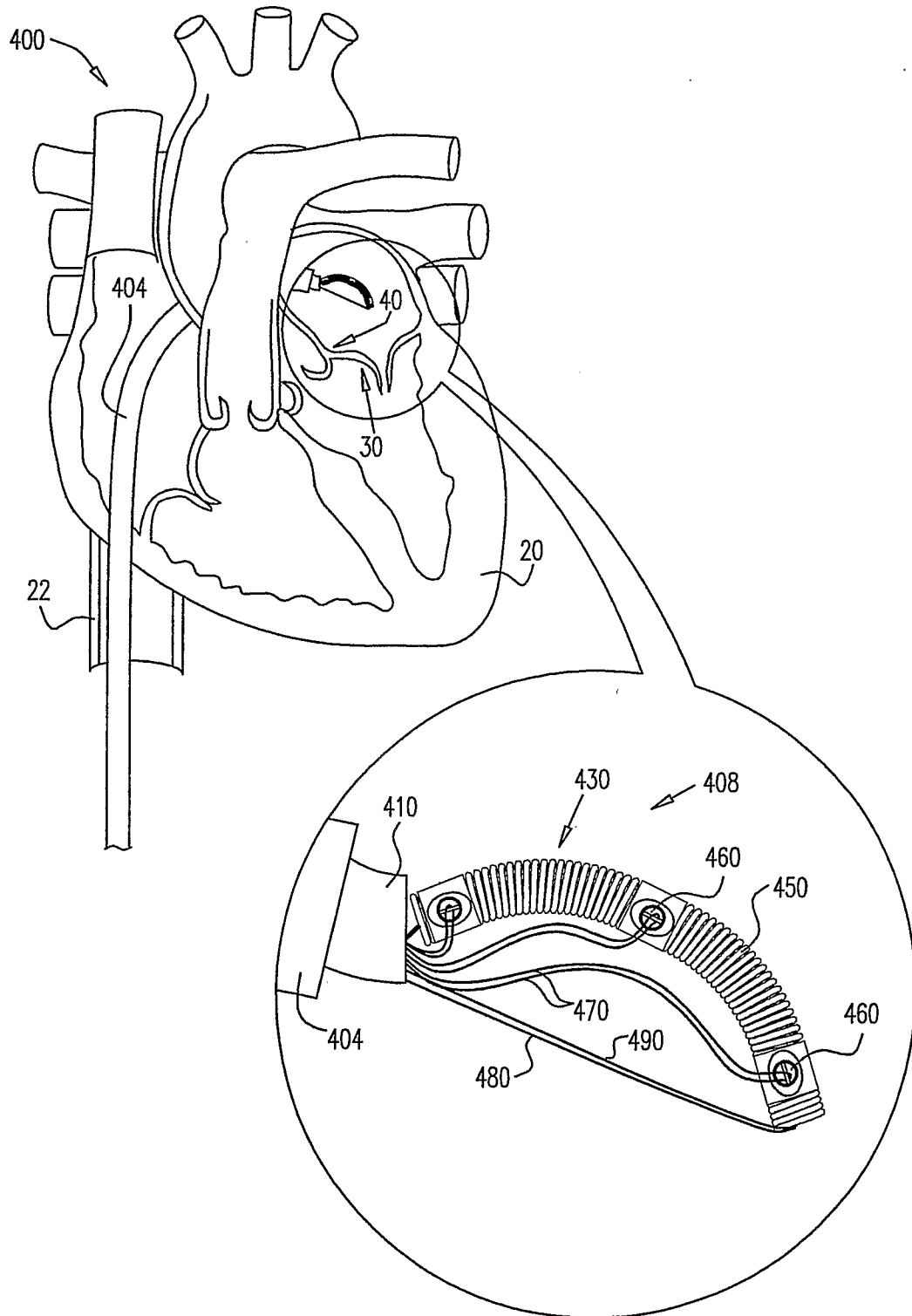
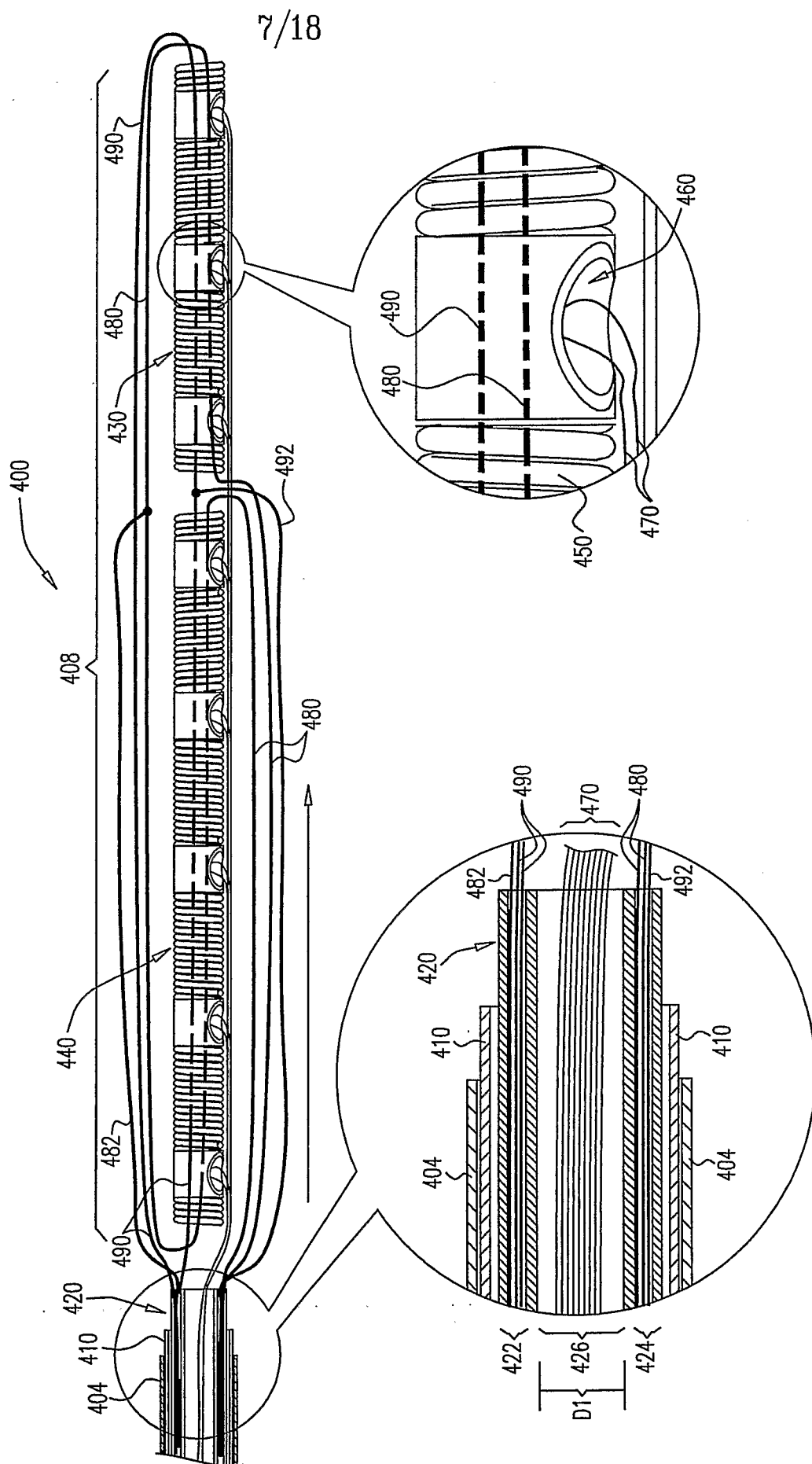
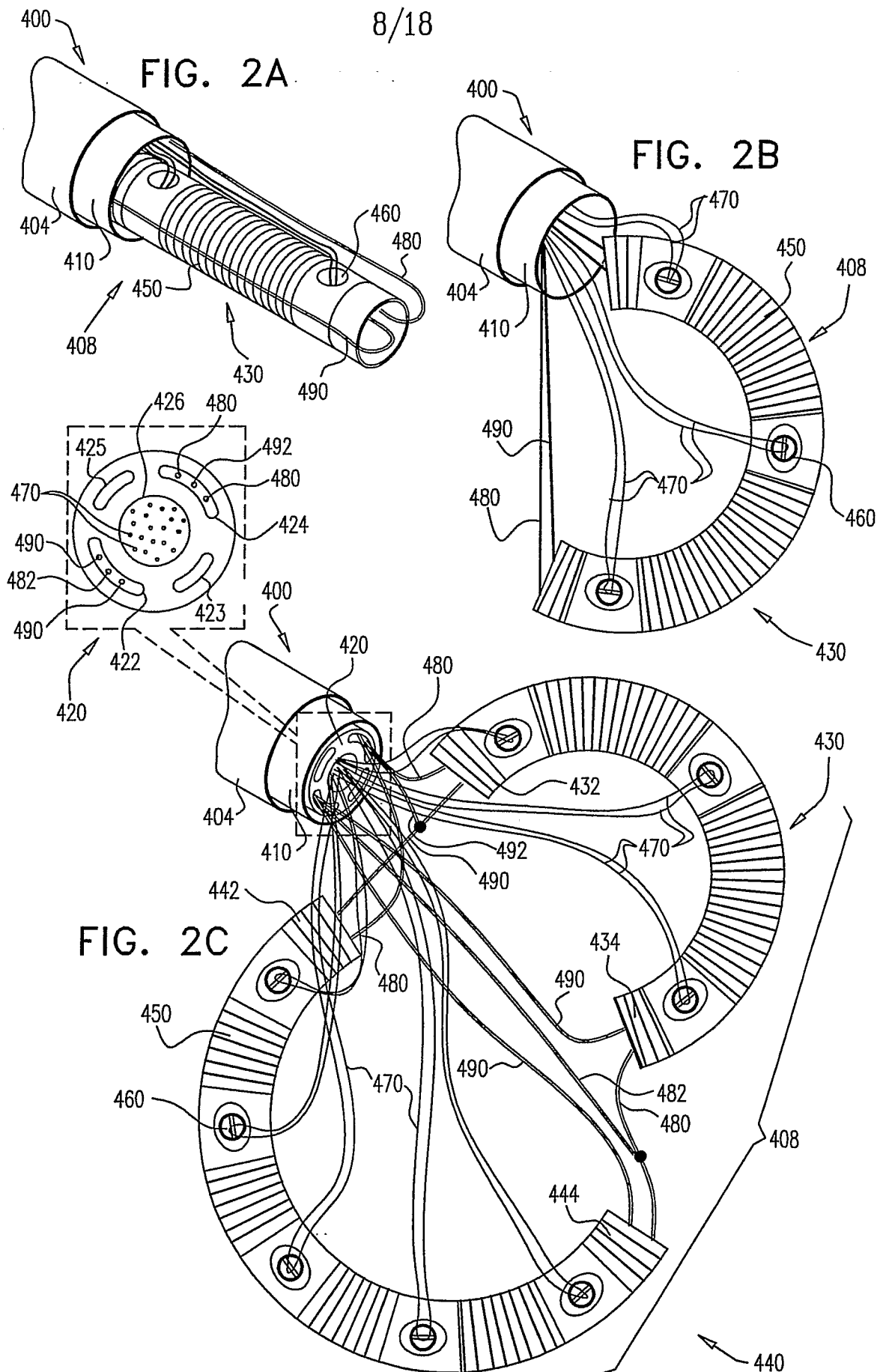
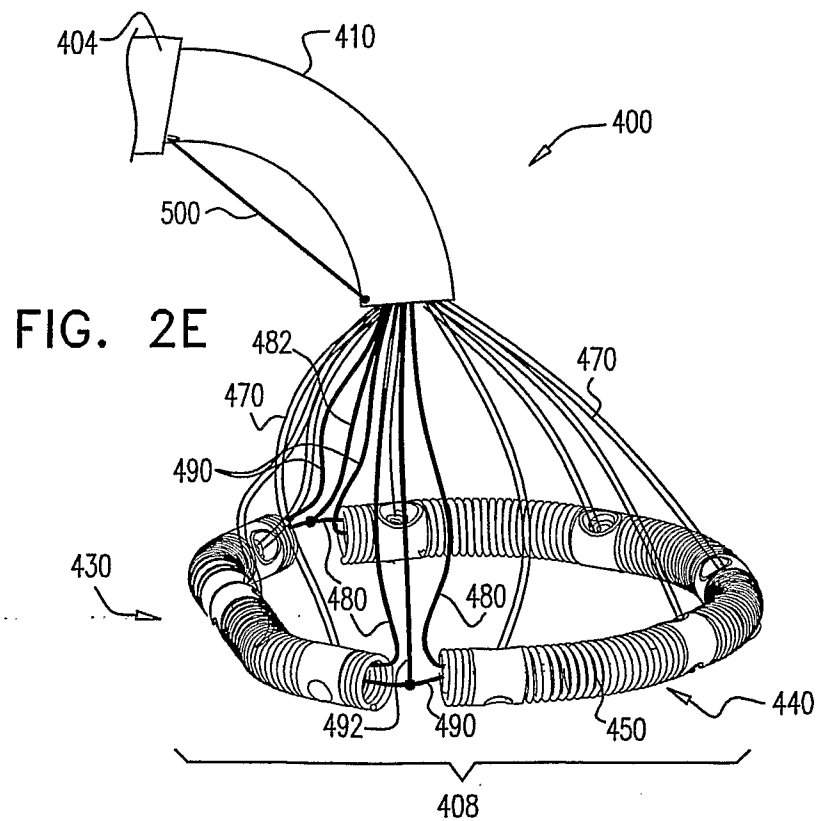
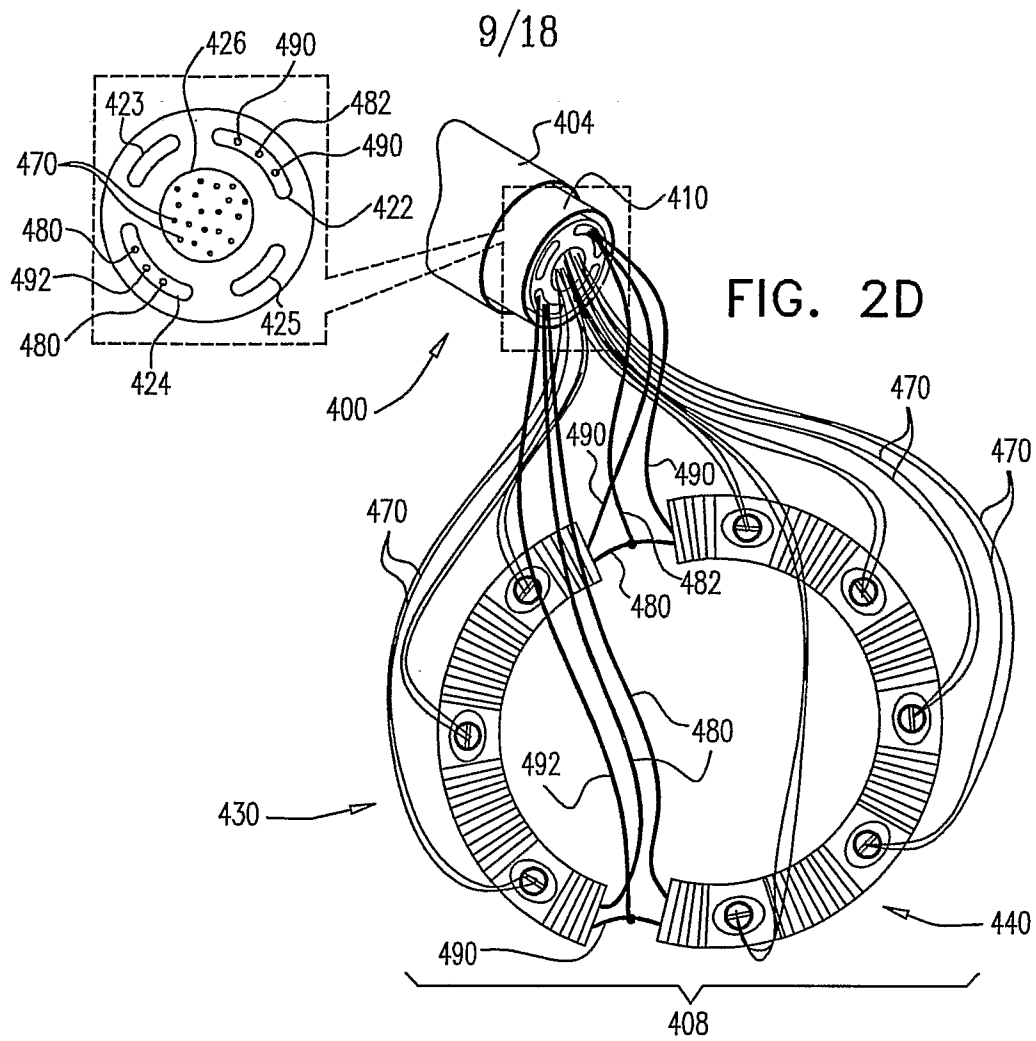

FIG. 1J







10/18

FIG. 2F

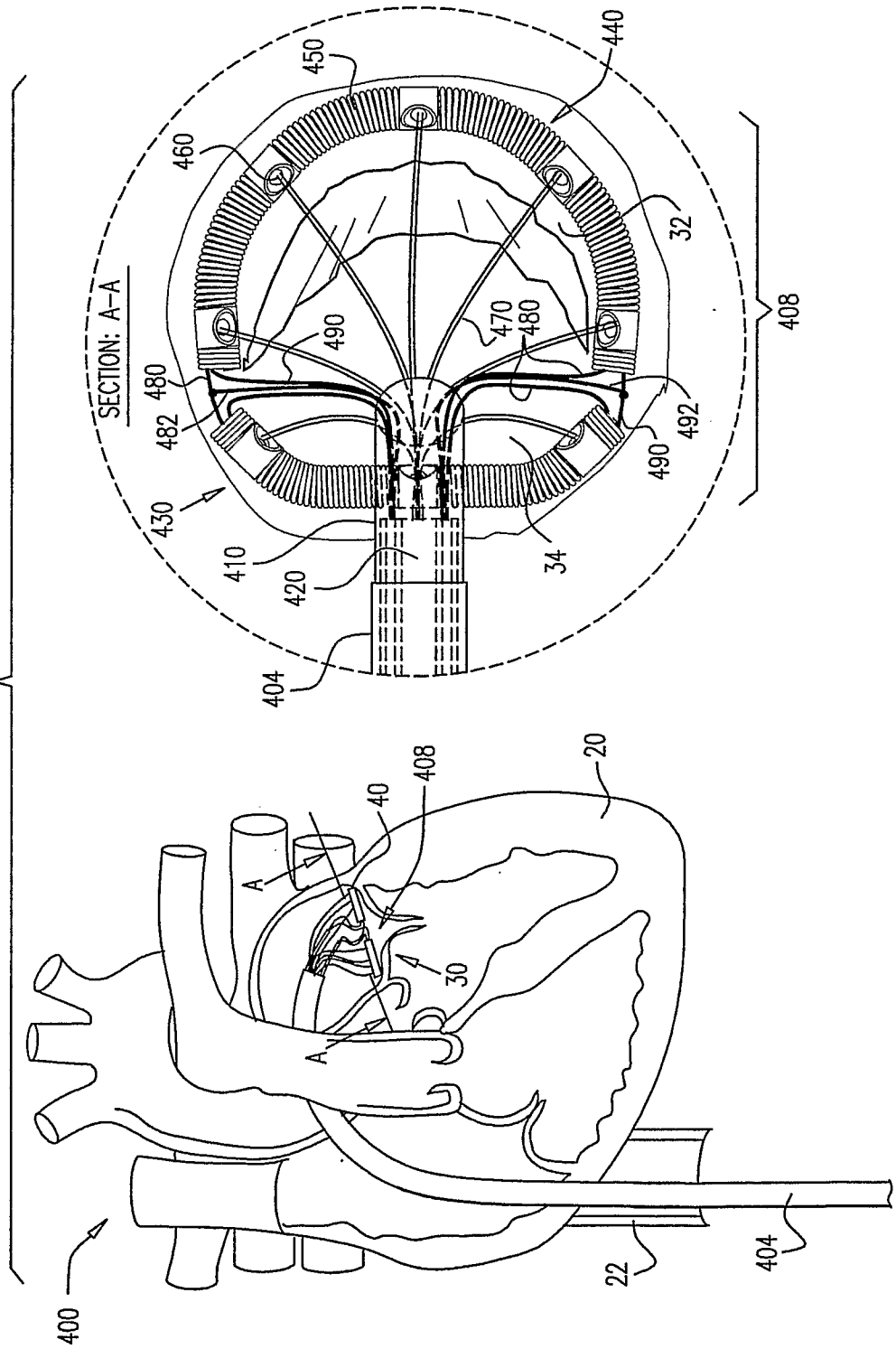
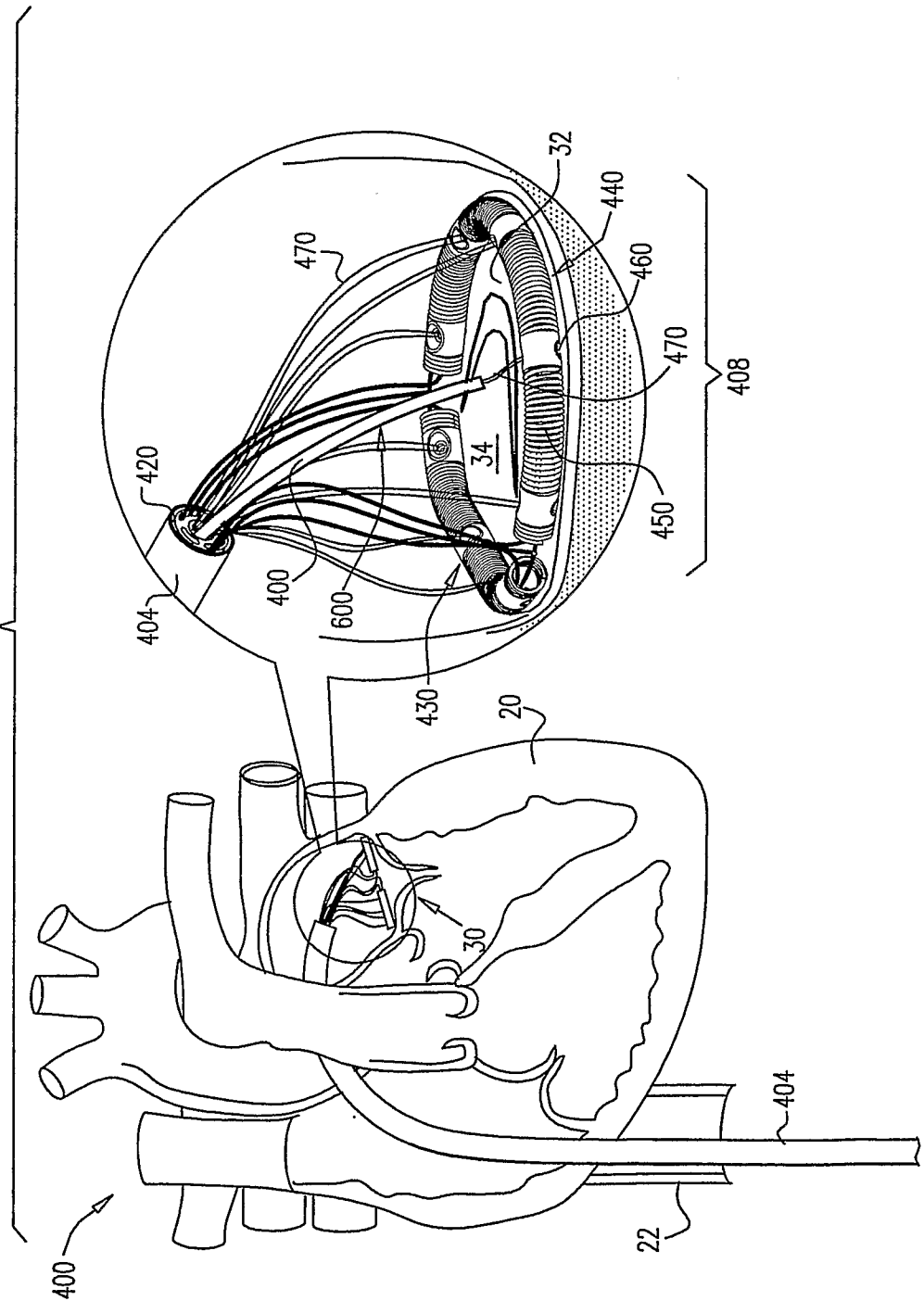
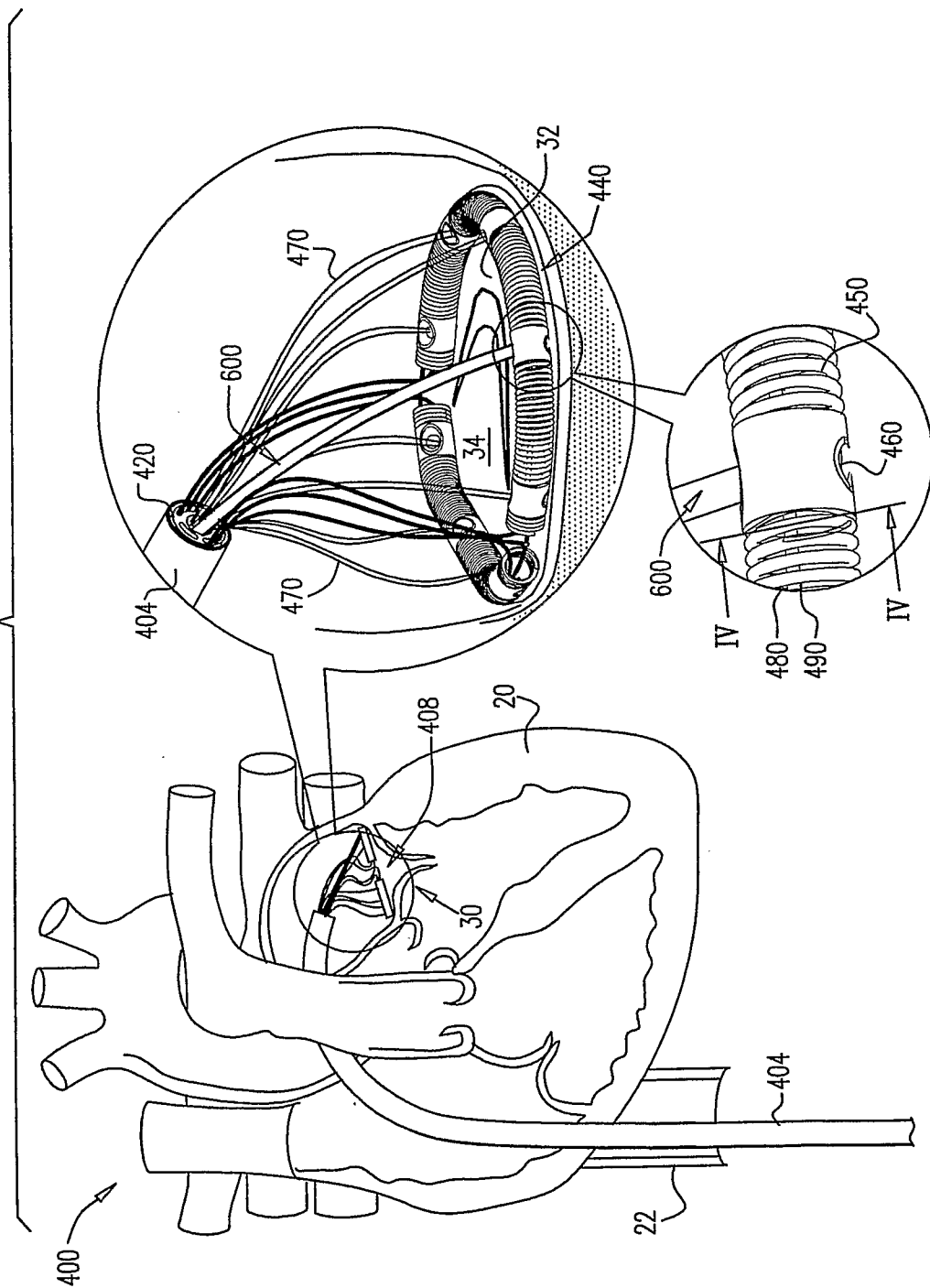

FIG. 3A



12/18

FIG. 3B



13/18

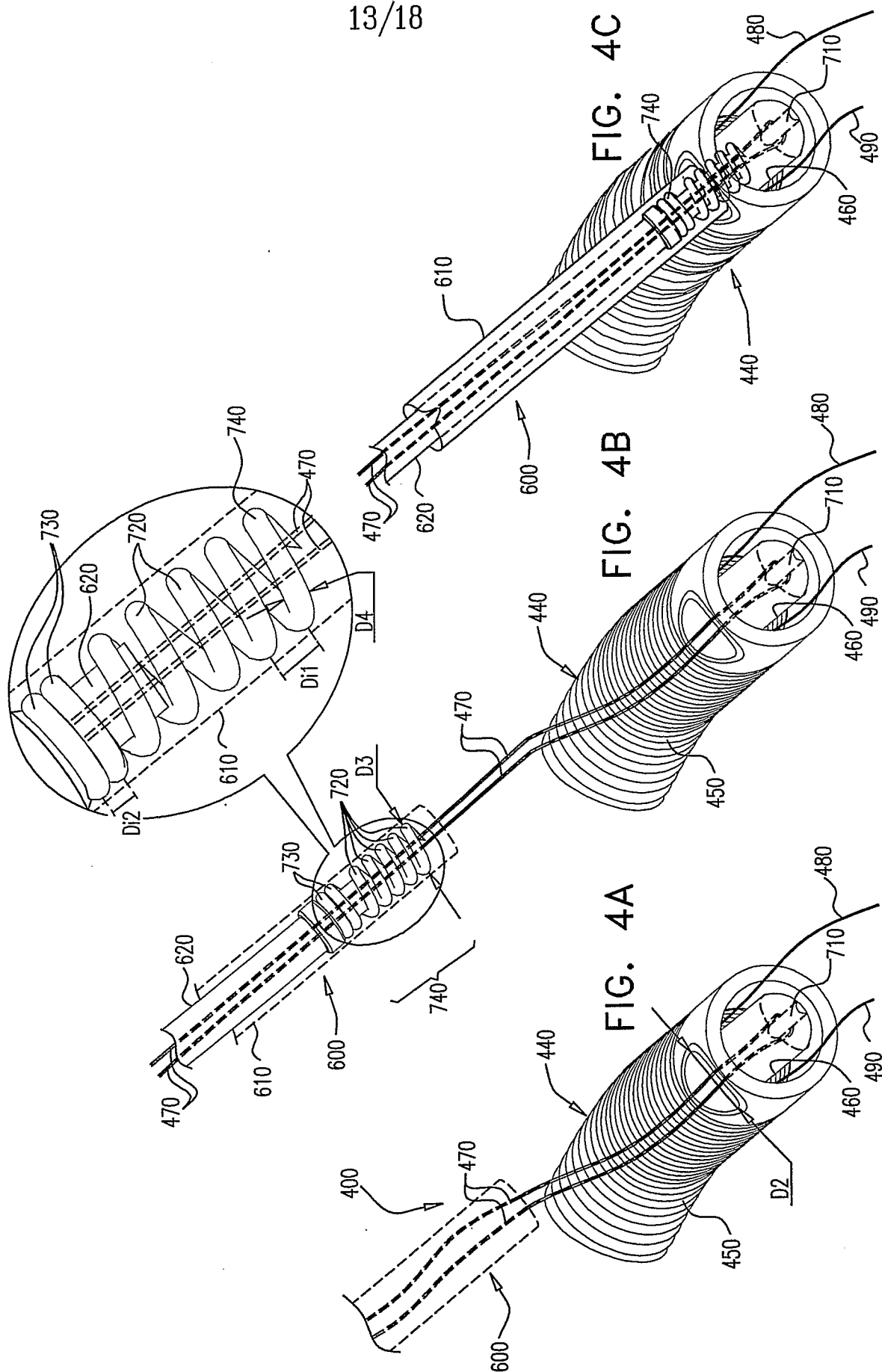

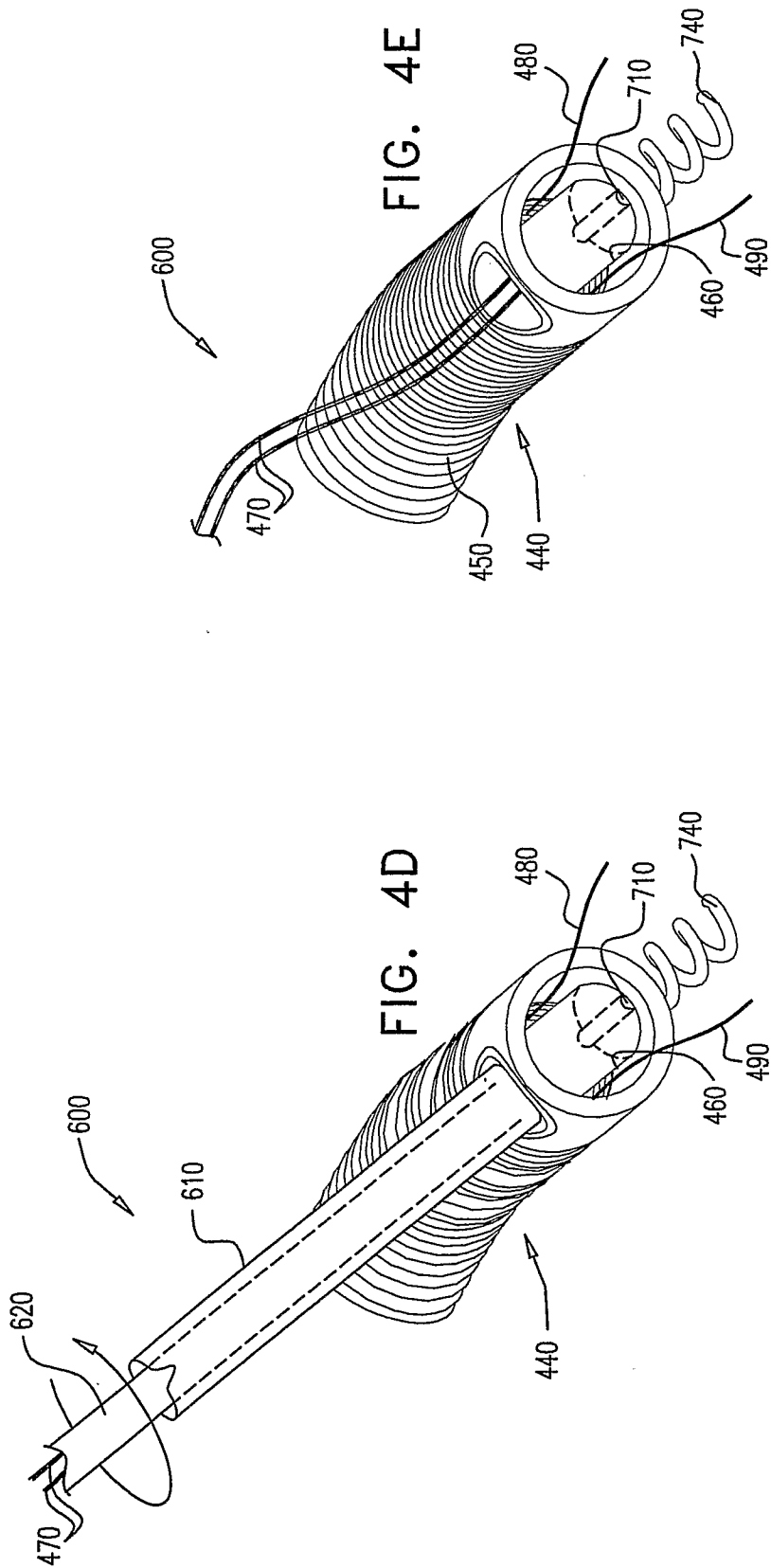

15/18

FIG. 5A

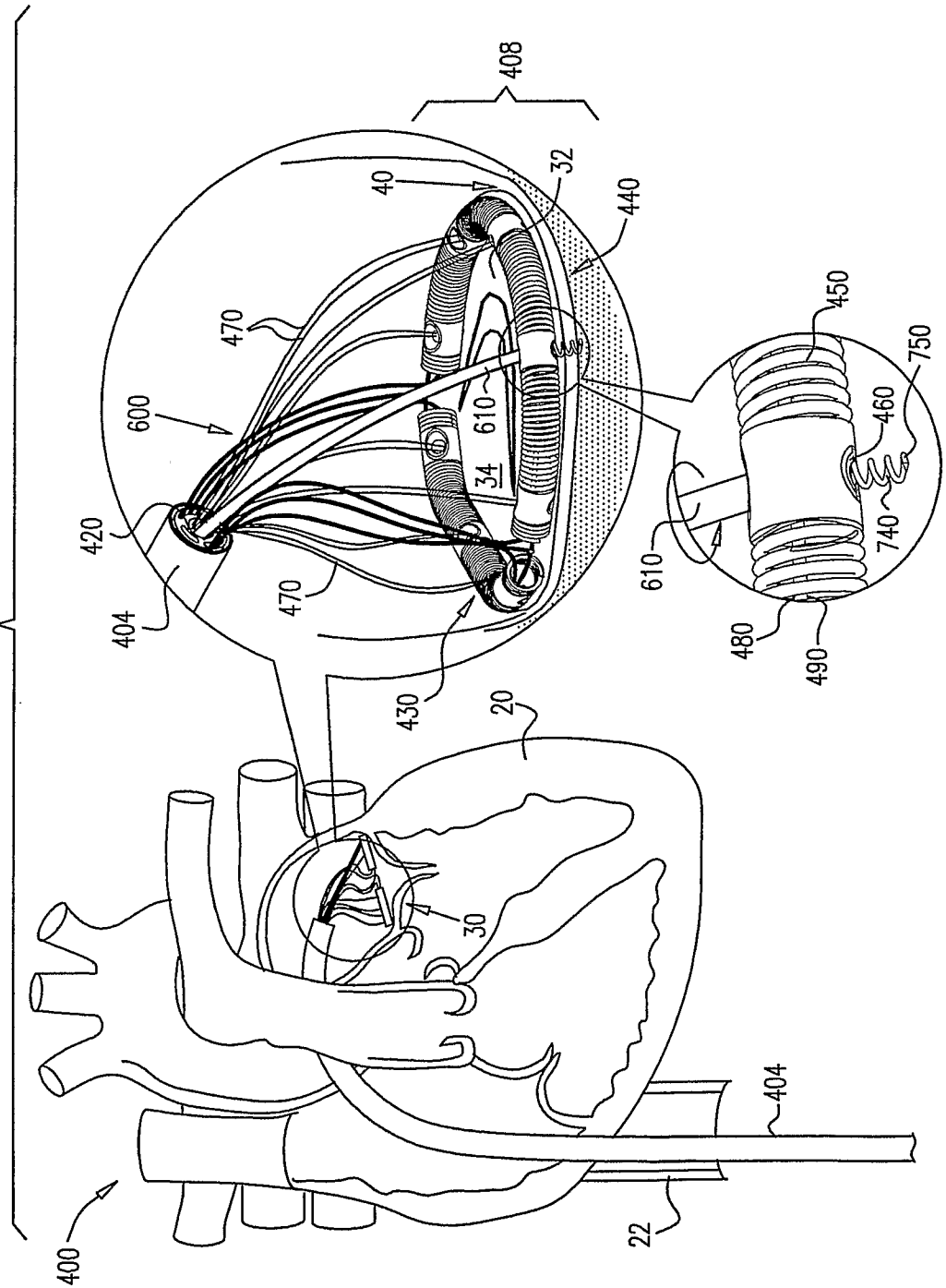

16/18

FIG. 5B

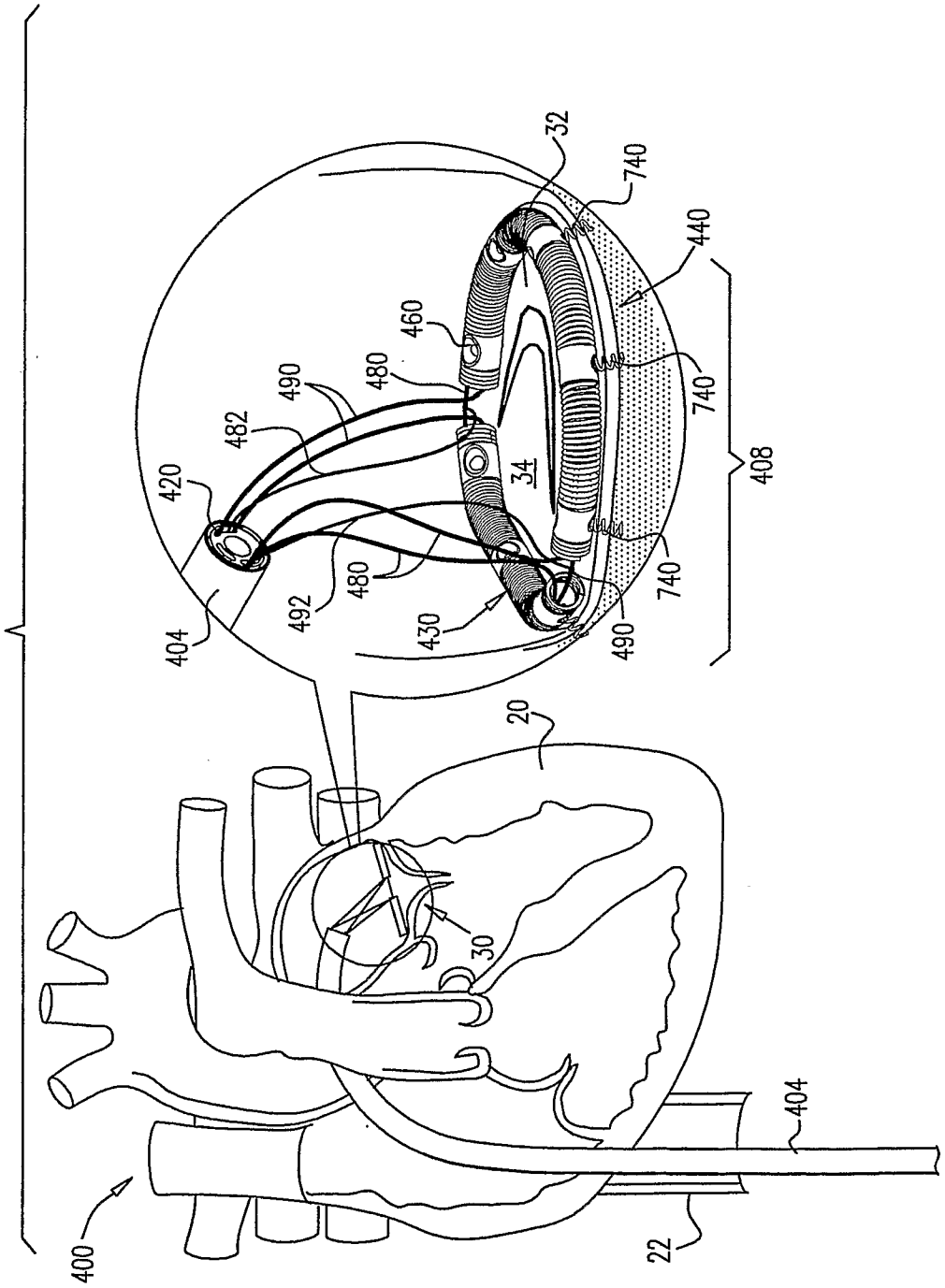
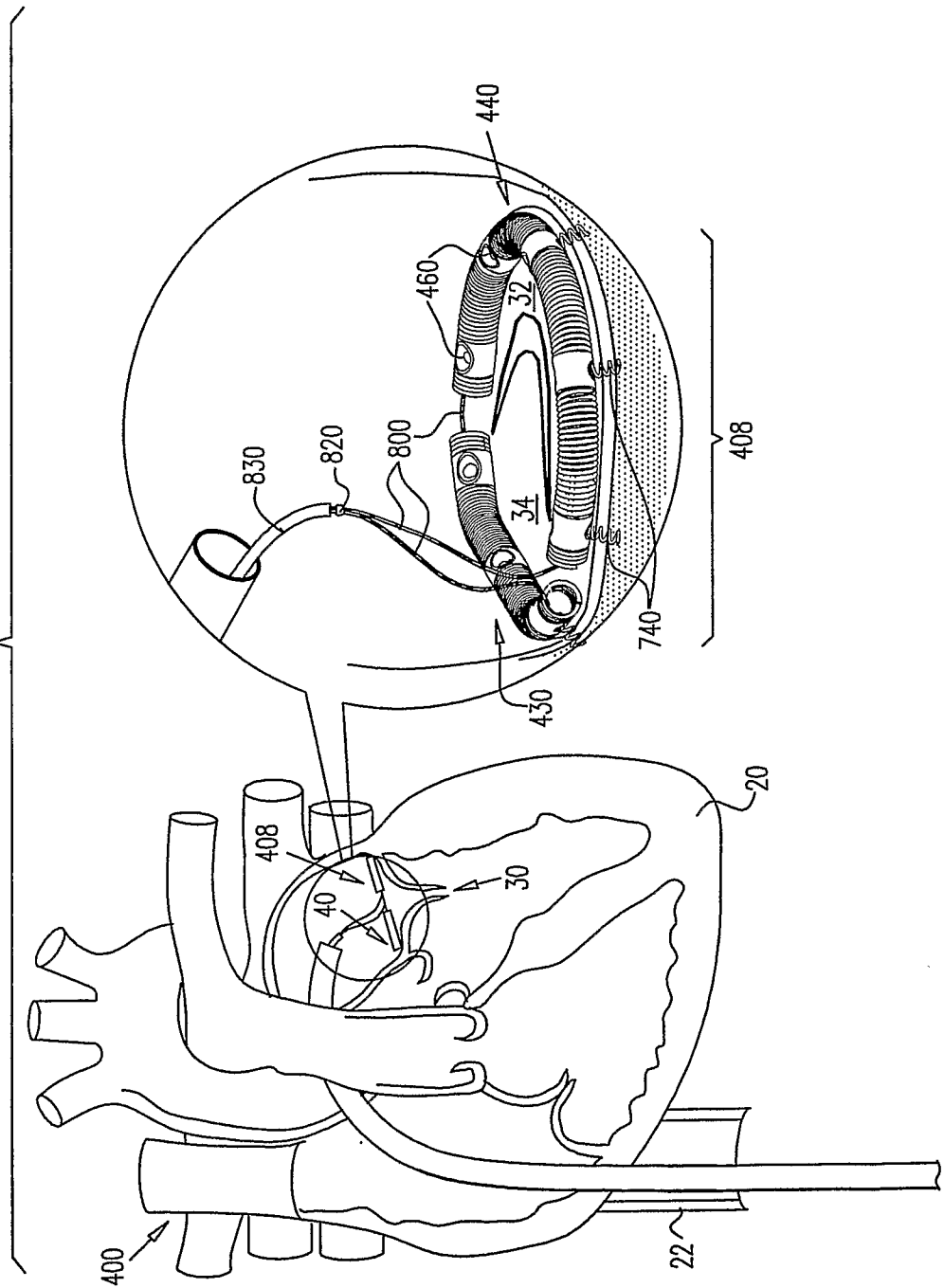

FIG. 5C



18/18

FIG. 5D

