



(12) **DEMANDE DE BREVET CANADIEN  
CANADIAN PATENT APPLICATION**

(13) **A1**

(86) Date de dépôt PCT/PCT Filing Date: 2003/06/02  
(87) Date publication PCT/PCT Publication Date: 2003/12/11  
(85) Entrée phase nationale/National Entry: 2004/11/29  
(86) N° demande PCT/PCT Application No.: GB 2003/002406  
(87) N° publication PCT/PCT Publication No.: 2003/102398  
(30) Priorité/Priority: 2002/05/31 (0212733.0) GB

(51) Cl.Int.<sup>7</sup>/Int.Cl.<sup>7</sup> F02B 75/22, F01B 1/12, F02M 35/10

(71) Demandeur/Applicant:  
MAN B & W DIESEL LTD., GB

(72) Inventeur/Inventor:  
MCCULLAGH, DAVID GERARD, GB

(74) Agent: FETHERSTONHAUGH & CO.

(54) Titre : MOTEUR A COMBUSTION INTERNE  
(54) Title: INTERNAL-COMBUSTION ENGINE

(57) **Abrégé/Abstract:**

An internal-combustion engine has cylinders 21 arranged preferably in a V-formation with corresponding cylinder heads (27) including connectors for the supply and discharge of fluids. The cylinders are mounted in a crankcase (41) and are supplied with air for combustion by a cast air manifold (51) running the length of the engine, the air manifold being located adjacent to the row of cylinders, preferably in the V. To reduce the amount of pipework the manifold has shaped connectors for at least one of the fluids, in particular the air intake (33) and the water coolant (55), these connectors connecting directly to the relevant connectors on the cylinder head and being pressed against them by the pressure in the manifold.



(12) INTERNATIONAL APPLICATION PUBLISHED UNDER THE PATENT COOPERATION TREATY (PCT)

(19) World Intellectual Property Organization  
International Bureau



(43) International Publication Date  
11 December 2003 (11.12.2003)

PCT  
(10) International Publication Number  
**WO 03/102398 A1**

(51) International Patent Classification<sup>7</sup>: **F02B 75/22**,  
F02M 35/10, F01B 1/12

(21) International Application Number: PCT/GB03/02406

(22) International Filing Date: 2 June 2003 (02.06.2003)

(25) Filing Language: English

(26) Publication Language: English

(30) Priority Data:  
0212733.0 31 May 2002 (31.05.2002) GB

(71) Applicant (*for all designated States except US*): **MAN B & W DIESEL LTD.** [GB/GB]; Bramhall Moor Lane, Hazel Grove, Stockport, Cheshire SK7 5AQ (GB).

(72) Inventor; and

(75) Inventor/Applicant (*for US only*): **MCCULLAGH, David, Gerard** [GB/GB]; 22 Beresford Street, Warrington WA1 3SA (GB).

(74) Agent: **GIBBS, Christopher, Stephen**; Haseltine Lake, Imperial House, 15-19 Kingsway, London WC2B 6UD (GB).

(81) Designated States (*national*): AE, AG, AL, AM, AT, AU, AZ, BA, BB, BG, BR, BY, BZ, CA, CH, CN, CO, CR, CU, CZ, DE, DK, DM, DZ, EC, EE, ES, FI, GB, GD, GE, GH, GM, HR, HU, ID, IL, IN, IS, JP, KE, KG, KP, KR, KZ, LC, LK, LR, LS, LT, LU, LV, MA, MD, MG, MK, MN, MW, MX, MZ, NI, NO, NZ, OM, PH, PL, PT, RO, RU, SC, SD, SE, SG, SK, SL, TJ, TM, TN, TR, TT, TZ, UA, UG, US, UZ, VC, VN, YU, ZA, ZM, ZW.

(84) Designated States (*regional*): ARIPO patent (GH, GM, KE, LS, MW, MZ, SD, SL, SZ, TZ, UG, ZM, ZW), Eurasian patent (AM, AZ, BY, KG, KZ, MD, RU, TJ, TM), European patent (AT, BE, BG, CH, CY, CZ, DE, DK, EE, ES, FI, FR, GB, GR, HU, IE, IT, LU, MC, NL, PT, RO, SE, SI, SK, TR), OAPI patent (BF, BJ, CF, CG, CI, CM, GA, GN, GQ, GW, ML, MR, NE, SN, TD, TG).

**Published:**  
— with international search report

*For two-letter codes and other abbreviations, refer to the "Guidance Notes on Codes and Abbreviations" appearing at the beginning of each regular issue of the PCT Gazette.*

(54) Title: INTERNAL-COMBUSTION ENGINE

(57) **Abstract:** An internal-combustion engine has cylinders 21 arranged preferably in a V-formation with corresponding cylinder heads (27) including connectors for the supply and discharge of fluids. The cylinders are mounted in a crankcase (41) and are supplied with air for combustion by a cast air manifold (51) running the length of the engine, the air manifold being located adjacent to the row of cylinders, preferably in the V. To reduce the amount of pipework the manifold has shaped connectors for at least one of the fluids, in particular the air intake (33) and the water coolant (55), these connectors connecting directly to the relevant connectors on the cylinder head and being pressed against them by the pressure in the manifold.

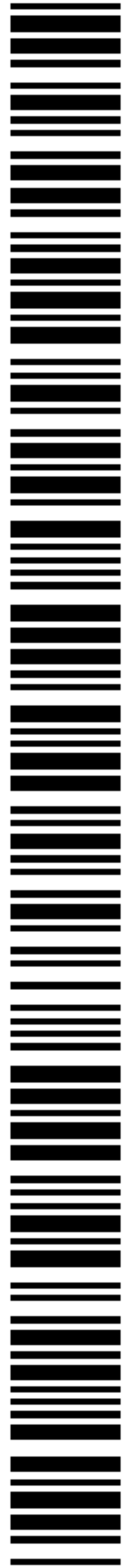

**WO 03/102398 A1**

## INTERNAL-COMBUSTION ENGINE

## BACKGROUND

The present invention relates to internal-  
5 combustion engines, in particular large engines such as  
are used in fast boats such as ferries or generally for  
industrial power generation.

Manufacturers of engines are of course always trying  
to increase the specific power output of their engines.  
10 One way of doing this is by reducing the weight of the  
engine. Another important characteristic is the ease of  
maintenance of such engines, which is partly dependent  
upon the ease of access to the internal components.  
Also, of course, reducing the cost of manufacture is a  
15 constant requirement. The present invention aims to make  
improvements in all these areas.

For background on the layout of engines one can  
consult the following documents. US 3809032 (G O Morris)  
describes a manifold for with separate passages for a  
20 multiple-barrel carburettor. US 4,267,812 (Ford) shows a  
manifold system providing an integral mounting of an EGR  
cooler/carburettor. US 4,458,491 (MTU) has an exhaust  
manifold system within the V of a V-engine. US 6,032,634  
(Hitachi) shows a multi-part engine air manifold system  
25 located on the engine, where two design options are  
provided for an optimised air charging system as well as  
providing cooling for the engine control unit. The  
manifold system includes a longitudinal partition wall  
and mounts other engine components such as the injectors.  
30 JP 10-030445A (Nissan) shows an intake manifold with an  
integral supercharger, mounted on top of the engine. EP  
0162272 A1 (KHD) shows an enclosed assembly containing  
lubricant and fuel pipes. EP 0644326 A1 (Hitachi) is an  
air duct with integral air filter/throttle valve and a  
35 plurality of suction pipes. Described in EP 1069301 A2  
(DDC) is a wedge-shaped cylinder head with integral air  
manifold mounted on top of and spanning the cylinder  
heads. Finally GB 2174454 A (Rover) shows an air



induction system with variable plenum length. The design allows ease of manufacturing by plastic mouldings and metal pressing.

## 5 SUMMARY OF THE INVENTION

According to the invention there is provided an internal-combustion engine having cylinders arranged in a row with corresponding cylinder heads including connectors for the supply and discharge of fluids, the  
10 cylinders being mounted in a casing and being supplied with air for combustion by an air manifold running the length of the engine, in which the air manifold is located adjacent to the row of cylinders, and has shaped connectors for at least one of the fluids, these  
15 connectors connecting directly to the relevant connectors on the cylinder head.

This arrangement does away with at least some of the piping between the air manifold and the cylinders that is a feature of prior-art engines. The connecting parts of  
20 air manifold and cylinder head abut each other directly, but a good seal can nevertheless be achieved because (in contrast to the engines described above) the pressure in the air manifold during operation of the engine presses outwards and seals the connection.

For pressure within the air manifold to improve the seal of the connectors on the manifold abutting against the cylinder heads there must be a support opposite the cylinders against which the air manifold can bear. For an in-line engine a special support can be designed, but  
30 the invention is particularly advantageous for V-engines because the manifold can simply be located within the V, between the rows of cylinders, in use bearing outwardly against them on both sides. Preferably it rests directly on the crankcase, and the connectors are designed to have  
35 substantially vertical planes of abutment.

The fluid or fluids in question can be combustion fluids, such as the air directed towards the inlet valves in the cylinder head, or heat-exchange fluids, in

particular the water used for cooling the cylinders.  
Advantageously both such possibilities are made use of,  
so that the air manifold has no external pipes along its  
length (though it will generally have pipes at the end  
5 for supply and discharge).

It is possible to achieve further integration if  
further channels, not necessarily communicating directly  
with the cylinder heads and being for instance for oil  
and/or water, are integrated into the manifold,  
10 preferably on its underside, i.e. adjacent to the casing,  
in other words the crankcase. Moreover, in the part  
between the rows of cylinders and directly under the air  
manifold the crankcase may itself contain passages for  
water, one over the other, the upper or outer one of  
15 which is sealed directly by the air manifold, i.e. the  
wall of the manifold also forms part of the wall of the  
passage. This reduces the number of parts of the engine.  
Furthermore the intercooler for a turbocharger  
arrangement can be mounted directly on top of the air  
20 manifold. This does away with the support brackets that  
would otherwise be needed, saving weight and space. The  
air manifold is preferably cast, so as to be able to  
achieve the necessary shape, and may for instance be of  
aluminium. With the intercooler supported along its  
25 entire length on the manifold the strength of aluminium  
is entirely adequate.

For a better understanding of the invention an  
embodiment will now be described with reference to the  
30 accompanying drawings, in which:

- Figure 1 shows a perspective view of a complete  
engine, representing an embodiment of the  
invention;  
35 Figure 2 shows a cross-section through the engine  
perpendicular to the axis; and  
Figure 3 shows a perspective view of the engine with  
the cylinder heads removed showing the air



manifold; and

Figure 4 shows the air manifold itself.

**Figure 1** shows a V12 engine which can be used, for instance, in fast cross-channel ferries. The cylinder head 27 on one side can be seen, as can the intercooler 61 on top of the engine and next to it on either side the exhaust heat shields 73. All the drives are at one end of the engine, and in the Figure the lubricating oil pump 85, sea water pump 89 and fresh water pumps 91 can be seen. Also visible is a damper 87 and the twin air filters 93 leading into the turbochargers which in turn lead via twin emergency shut-off valves 97 into the intercooler 61.

**Figure 2** shows a cross-section through this engine. The engine is of a modular design and can be produced in varying configurations - currently as a twelve-, sixteen- or twenty-cylinder engine - with a minimal stock of parts such as air manifold, cylinder head. The section is taken through a crank 3 of the crank shaft 1 to which is connected a two-piece dowelled angle split connecting rod 5 leading to the gudgeon pin 7 at the small end. The gudgeon pin is connected in the usual way to a piston 11 which in its crown 13 has a central chamber 14 surrounded by an annular chamber 15. To form the chambers the piston is made in two parts split by a plane perpendicular to its axis by a proprietary process.

The piston 11 slides in cylinders 21 having at their upper ends, i.e. at the ends away from the crank shaft, a thicker portion 23 surrounded by a sleeve or water jacket 25 defining the chamber for cooling of the cylinder. On top of each cylinder is a cast cylinder head 27 with two pairs of valves 29 mounted in the usual way. The cylinder head is cast in iron and has an exhaust outlet 31 and an air inlet 33. The cylinders are mounted in a V formation in a cast crankcase 41, being sealed to it approximately at the bottom end of their thicker portions 23. The crankcase contains at least one

passage, here two cast passages 43 and 45, for water running axially to the engine, located generally in the V between the lower ends of the cylinder liners 21. The upper passage 45 is the hot feed to the cylinder heads, and the lower passage 43 is the cold return.

An air manifold 51, likewise made of cast aluminium and having a generally rectangular section with side-walls 52, runs the length of the engine and is mounted approximately between the cylinder heads 27 of the two banks of cylinders. The manifold 51 has a central passage running along its length and off this passage along each side in the sidewalls 52 has air terminals or connectors 59 that abut the ends of the air passages 33 of the cylinder heads. The plane of their abutment is substantially vertical, i.e. perpendicular to the axis of the V. Likewise the manifold 51 has, near the top of the sidewalls, integral cast passages 55 for hot water that communicate with a chamber surrounding the exhaust passages 31 in the cylinder heads. In use the pressure in the manifold pushes the sidewalls 52, with the connecting terminals, outwards against the corresponding terminals on the cylinder heads, reinforcing the sealing effect.

The air manifold 51 also has twin axial water and oil passages 53 in its bottom section, the lower walls of which act to seal the upper water passage 45 in the crank casing. The water passage in the air manifold supplies cold water to a second intercooler, if present.

On top of the air manifold 51 is mounted the intercooler 61 which is a two-stage intercooler with integral air intake passage, surrounded by a single casing which has a waist so that it forms a figure of eight in section, the upper part being the air passage and the lower part enclosing the heat exchanger pipes 63. A line can also be seen which notionally splits the intercooler into two stages: the pipes above this line are connected to the hot (c. 80°C) water from the passages 55, and the pipes below are connected to the



cold (c. 40°C) supply. The air spreads axially along the air passage and then down between the pipes and into the manifold. Next to the intercooler on either side are the exhaust manifolds 71 connected to the exhaust passages 31  
5 of the cylinder heads, again directly. The exhaust manifolds are protected by covers 73, which as can be seen are in two parts.

Figures 1 and 2 also shows the cam shafts 101, the fuel pump 105, the sump 83, twin bearing caps 85 and cast  
10 mounting feet 81 for mounting the engine in a frame, such as a ship's frame, the lubricating oil cooler 74, an intercooler water diverting valve 57, a duplex lubricating oil filter 76, a fuel pump and tappet cover 77, crankcase doors 79, a lubricating oil pump 84  
15 and a lubricating oil filler 86. For a twelve-cylinder ferry engine the bore is 280mm, the stroke is 330mm and the power output may be about 5.4 MW at a speed of about 1000r/min. However the invention is not limited to ships' engines.

20 **Figure 3** shows a 16-cylinder version of the engine in perspective, with the cylinder heads 27 removed so that the air manifold box 51 is visible. The cast air connections 59, a pair for each cylinder, are visible. In the 16-cylinder version (as for the 20-cylinder) two  
25 intercoolers 61 are used, the cold water supply to the second being by way of one of the lower passages 53 in the manifold. The manifold 51 is shown on its own in **Figure 4**, the seals between sections also being shown in a partially exploded view that reveals the hot-water  
30 passages 55. These Figures also show the modular nature of the engine and manifold, the cross-section of the manifold being essentially uniform, with passages running only axially within it along its length.



CLAIMS:

1. An internal-combustion engine having cylinders (21) arranged in a row with corresponding cylinder heads (27) including connectors for the supply and discharge of fluids, the cylinders being mounted in a casing (41) and being supplied with air for combustion by an air manifold (51) running the length of the engine, in which the air manifold is located adjacent to the row of cylinders, and has sidewalls (52) with shaped connectors (59) for at least one of the fluids, these connectors connecting directly via a parting plane that is substantially vertical to the relevant connectors on the cylinder head and in use being pressed against them by the pressure in the manifold.
2. An engine according to claim 1, in which the fluid or fluids include combustion fluids, such as the air directed towards the inlet valves in the cylinder head, or heat-exchange fluids, in particular water used for cooling the cylinders, or both.
3. An engine according to claim 1 or 2, in which the air manifold has no external pipes along its length, and contains passages for the fluids that run essentially along its entire length.
4. An engine according to any preceding claim, in which further channels (53), not communicating directly with the cylinder heads and being for instance for oil and/or water, are integrated into the air manifold.
5. An engine according to any preceding claim, in which, in the part adjacent to the row of cylinders and directly under the air manifold, the engine crankcase itself contains passages (43, 45) for water, the upper one of which is sealed directly by the air manifold.

6. An engine according to any preceding claim, in which the engine is a V-engine and the manifold is located within the V, between the rows of cylinders, in use bearing outwardly against them on both sides.

5

7. An engine according to any preceding claim, further comprising an intercooler (61) for a turbocharger arrangement, mounted directly on top of the air manifold.

10 8. An engine according to any preceding claim, in which the air manifold is cast, for instance of aluminium, and has a generally rectangular cross-section.

15 9. An engine according to any preceding claim, in which the air manifold is of modular design, being adapted to be fitted to further such manifolds, end to end.

20 10. An internal-combustion engine having cylinders (21) arranged in a row with corresponding cylinder heads (27) including connectors for the supply and discharge of fluids, the cylinders being mounted in a casing (41) and being supplied with air for combustion by an air manifold (51) running the length of the engine, in which the air manifold is located adjacent to the row of  
25 cylinders, and has shaped connectors (59) for at least one of the fluids, these connectors connecting directly to the relevant connectors on the cylinder head, and further channels (53), not communicating directly with the cylinder heads and being for instance for oil and/or  
30 water, integrated into and running the length of the air manifold.

11. A water craft having an engine according to any preceding claim.

35



Figure 1

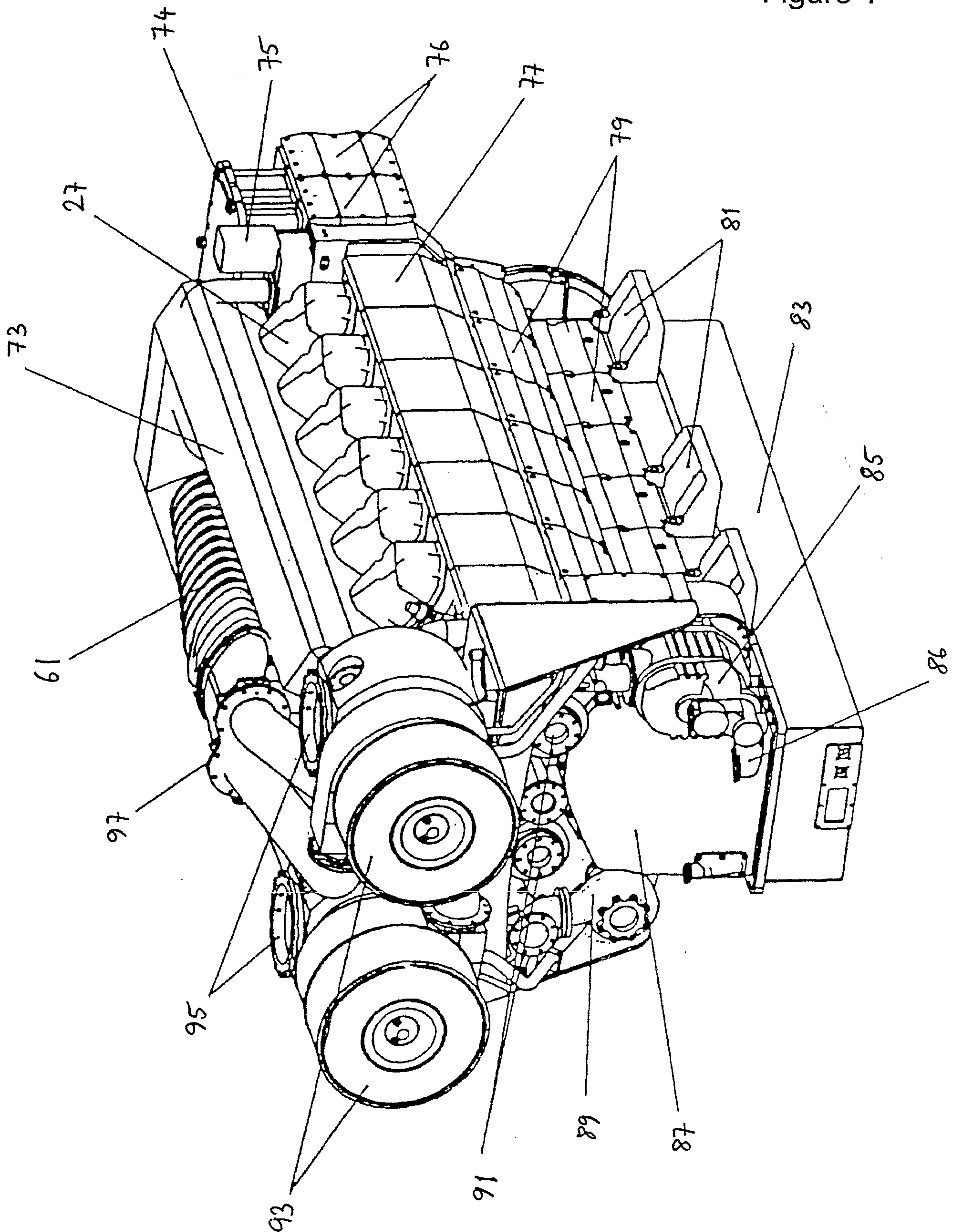



2/4

Figure 2

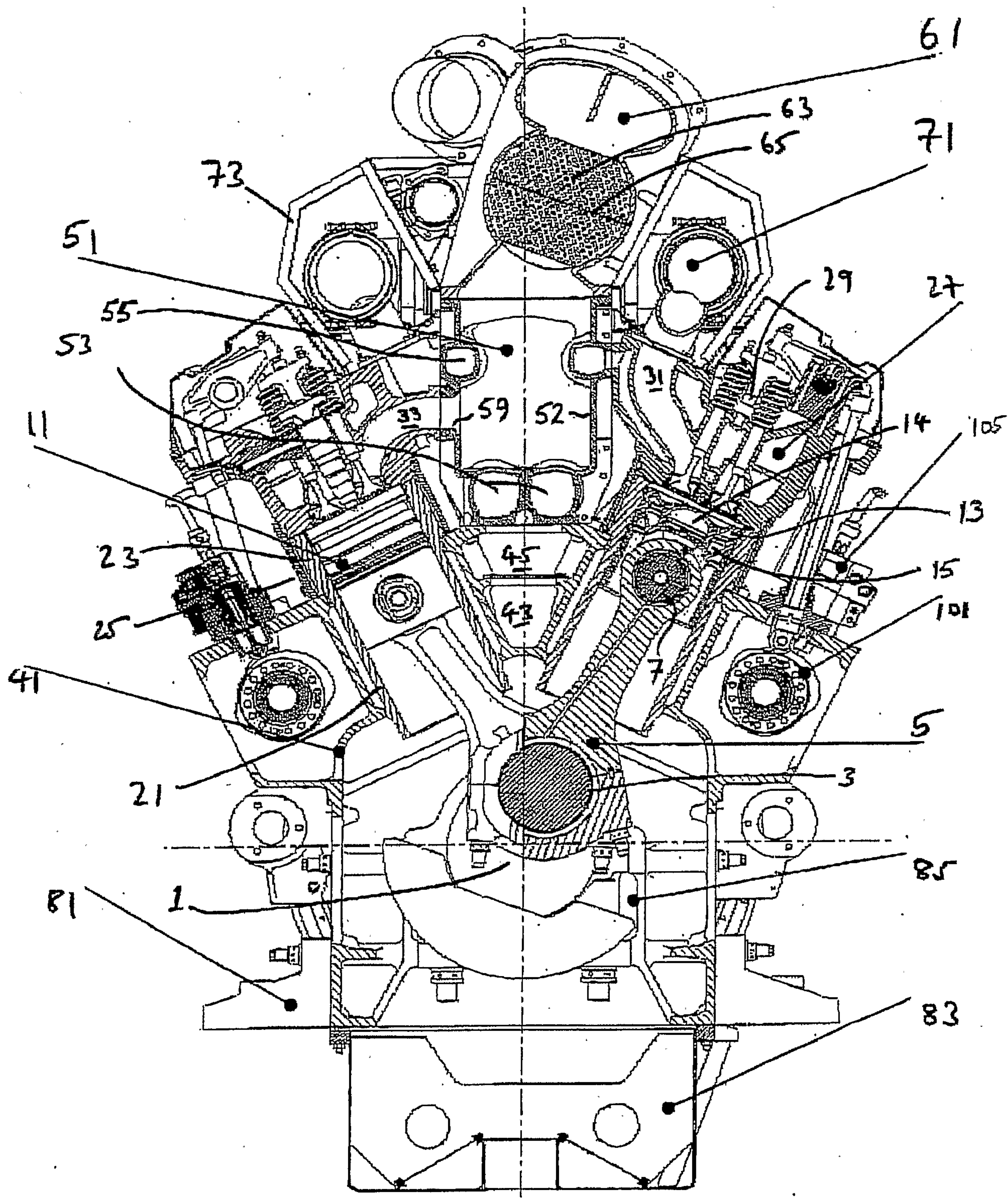

Empf.zeit:23/07/2004 17:42

Empf.nr.:628 P.001

AMENDED SHEET



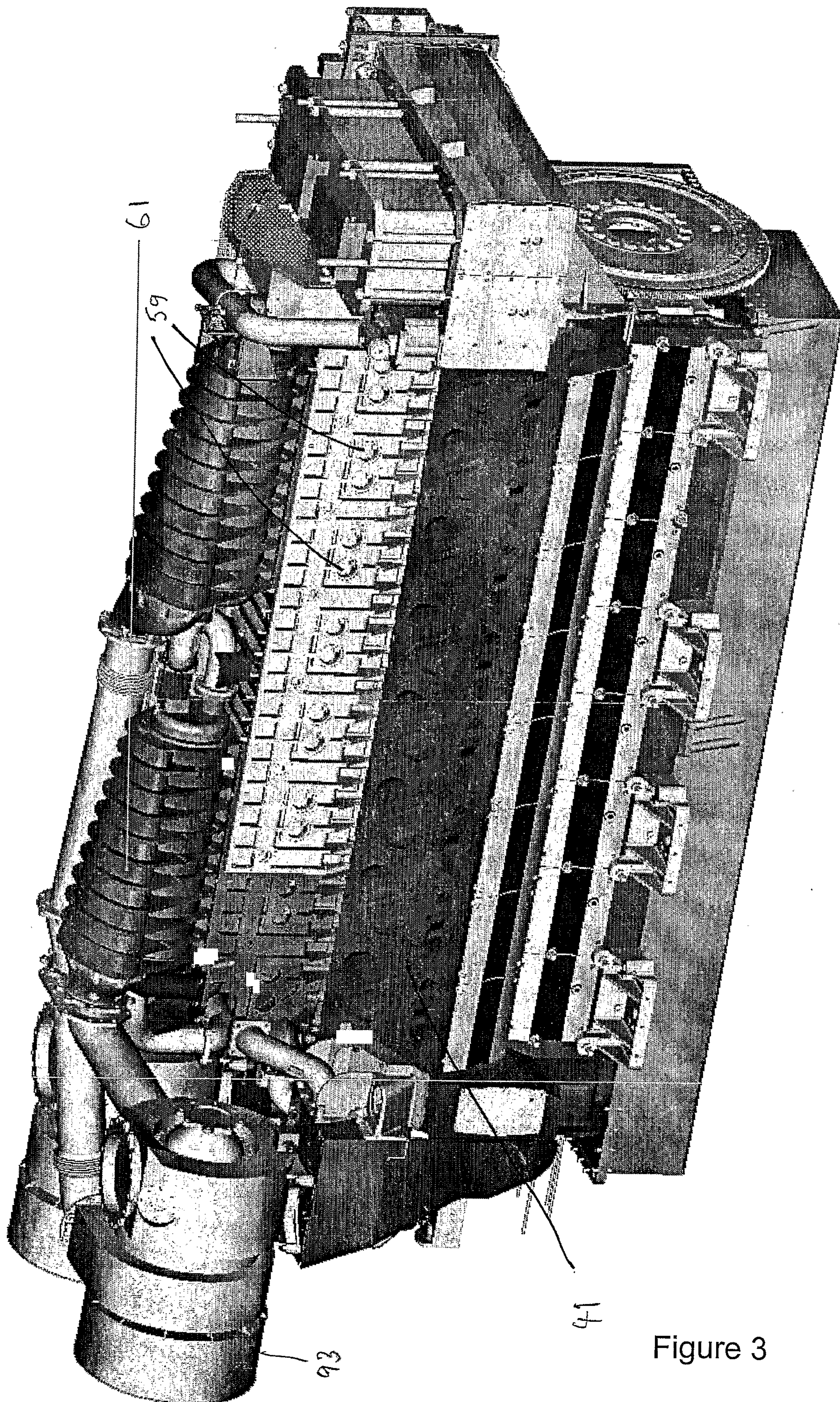

Figure 3



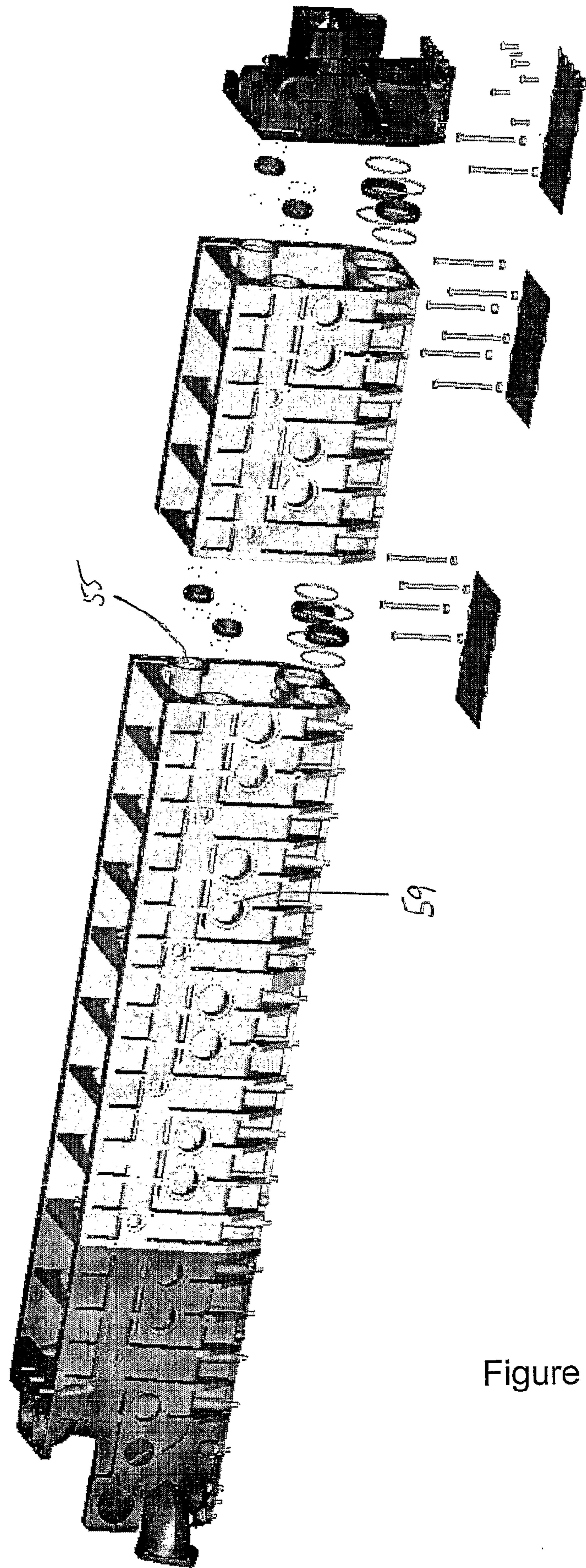

Figure 4