

(19) World Intellectual Property
Organization
International Bureau



(43) International Publication Date
29 December 2005 (29.12.2005)

PCT

(10) International Publication Number
WO 2005/123553 A1

- (51) International Patent Classification⁷: **B65G 47/84**, 21/20
- (21) International Application Number: PCT/GB2005/002447
- (22) International Filing Date: 21 June 2005 (21.06.2005)
- (25) Filing Language: English
- (26) Publication Language: English
- (30) Priority Data:

0413853.3	21 June 2004 (21.06.2004)	GB
0414211.3	24 June 2004 (24.06.2004)	GB
- (71) Applicant (for all designated States except US): **DIAGEO PLC** [GB/GB]; Edinburgh Park, 5 Lochside Way, Edinburgh EH12 9DT (GB).
- (72) Inventor; and
- (75) Inventor/Applicant (for US only): **ROBERTSON, John** [GB/GB]; 12 Wellesley Crescent, Blackwood, Cumbernauld, Glasgow G68 9PH (GB).
- (74) Agents: **MCLEISH, Nicholas, Alistair** et al.; Boulton Wade Tennant, Verulam Gardens, 70 Gray's Inn Road, London WC1X 8BT (GB).
- (81) Designated States (unless otherwise indicated, for every kind of national protection available): AE, AG, AL, AM, AT, AU, AZ, BA, BB, BG, BR, BW, BY, BZ, CA, CH, CN, CO, CR, CU, CZ, DE, DK, DM, DZ, EC, EE, EG, ES, FI, GB, GD, GE, GH, GM, HR, HU, ID, IL, IN, IS, JP, KE, KG, KM, KP, KR, KZ, LC, LK, LR, LS, LT, LU, LV, MA, MD, MG, MK, MN, MW, MX, MZ, NA, NG, NI, NO, NZ, OM, PG, PH, PL, PT, RO, RU, SC, SD, SE, SG, SK, SL, SM, SY, TJ, TM, TN, TR, TT, TZ, UA, UG, US, UZ, VC, VN, YU, ZA, ZM, ZW.
- (84) Designated States (unless otherwise indicated, for every kind of regional protection available): ARIPO (BW, GH, GM, KE, LS, MW, MZ, NA, SD, SL, SZ, TZ, UG, ZM, ZW), Eurasian (AM, AZ, BY, KG, KZ, MD, RU, TJ, TM), European (AT, BE, BG, CH, CY, CZ, DE, DK, EE, ES, FI, FR, GB, GR, HU, IE, IS, IT, LT, LU, MC, NL, PL, PT, RO, SE, SI, SK, TR), OAPI (BF, BJ, CF, CG, CI, CM, GA, GN, GQ, GW, ML, MR, NE, SN, TD, TG).

[Continued on next page]

(54) Title: AUTOMATED HANDLING LINE GUIDE RAIL ASSEMBLY

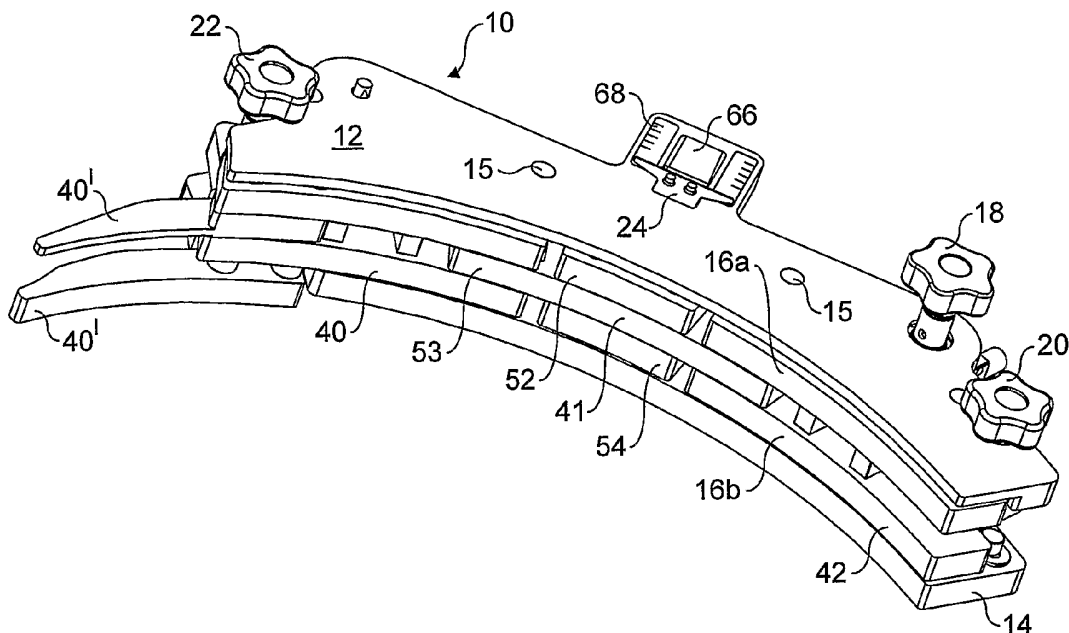

(57) Abstract: The present invention relates to an automated handling line guide rail assembly (10) for use on an automated handling line where containers are being processed. A typical application of the present invention will be on a bottling line where containers are conveyed between various machines to be presented to and taken from the various machines by a star wheel and guide rail (16, 17) assembly. Advantageously, the present invention provides an automated handling line guide rail assembly that defines the perimeter of the container's path with a guide rail that is movable radially to define the perimeter at different radii but still centred on substantially the same spot.

WO 2005/123553 A1



Published:

— *with international search report*

For two-letter codes and other abbreviations, refer to the "Guidance Notes on Codes and Abbreviations" appearing at the beginning of each regular issue of the PCT Gazette.

- 1 -

AUTOMATED HANDLING LINE GUIDE RAIL ASSEMBLY

5 The present invention relates to an automated handling
line guide rail assembly for use on an automated handling
line where containers are being processed. In particular,
the present invention relates to an adjustable guide rail
assembly whose position may be altered to define arcs of
10 varying radii.

A typical application of the present invention will be
on a bottling line where a container such as a bottle may
first be rinsed, then filled, capped and labelled. Each of
these processes is generally performed by a separate machine
15 at different locations along the automated handling line.
The containers are conveyed between the various machines
along generally rectilinear paths and are presented to and
taken from the various machines along arcuate paths where
the spacing between containers is regulated to match the
20 required spacing of the processing machine by using a star
wheel and guide rail assembly.

Such a star wheel and guide rail assembly combination
is described in our co-pending British Patent Application
No. GB0322492.0. Essentially, a guide rail assembly defines
25 the outer limit of an arcuate path along which the bottles
are conveyed by the star wheel. A guide rail assembly
generally comprises upper and lower guide rails that support
a container at two heights. As the name suggests, a star
wheel is a rotating wheel of a generally star shape, the
30 star shape being defined by a plurality of recesses that
receive a container to be processed. In our co-pending
application, the recesses are defined by the periphery of a

- 2 -

pair of top and bottom plates and by pairs of opposed
fingers that contact the containers. In operation, the star
wheel rotates such that the first bottle presented to the
star wheel is received within a recess and is contacted by
5 the fingers. The container is then conveyed along a path
defined by the star wheel and the guide rail that runs
around and is spaced from the centre line of the path to be
fed upon exit to a processing machine. As will be
appreciated, the spacing of the recesses in the star wheel
10 determine the spacing with which containers are passed to
the machine.

Any particular automated handling line is likely to
process containers having a variety of different shapes and
sizes. Traditionally, different shapes and sizes of
15 containers have necessitated a range of different star
wheels and guide rail assemblies having shapes and sizes to
correspond to the particular containers that may be
processed. A change of container required a time-consuming
change in star wheels and guide rail assemblies. An
20 improvement on this arrangement is disclosed in our co-
pending patent application, referenced above. In that
application, both the star wheel and the guide rail assembly
are adjustable. The fingers of the star wheel rotate to
allow larger containers to be received and the guide rail
25 may also be moved closer to and further away from the star
wheel.

Generally, when containers are conveyed along an
automated handling line, the exact path they must follow is
dictated by the centre point of the container. The reason
30 for this is best illustrated by considering a filling
machine that must pour liquid down the neck of a bottle.
Clearly, the centre of the neck should be in the same

- 3 -

position regardless of the size of the bottle. Accordingly,
it is desirable for both the star wheel and the guide rail
assembly to be adjustable such that different sizes of
bottles can be conveyed along the handling line with their
5 centres passing along the required path between star wheel
and guide rail assembly.

An example of an adjustable guide rail assembly is
provided by EP-A1-0,412,059 where half of the star wheel is
enclosed by a two-part guide rail, each part subtending
10 approximately 90°. The two halves are connected at their
adjacent ends to a plate via a pair of vertical pins about
which the guide rails can rotate. The plate and thus the
proximal ends of each half of the guide rails can be driven
radially towards the centre of the star wheel. The distal
15 ends of each half of the guide rail are provided with angled
slots that receive a further vertical pin. Thus, when the
plate is driven radially, the proximal ends move radially
but the distal ends move inwardly with substantially equal
radial and tangential components. This tangential component
20 of movement is undesirable as it moves the centre point of
the semi-circle subtended guide rail away from the centre
point of the star wheel so that they can be aligned
concentrically in only a single position.

Against this background, and from a first aspect, the
25 present invention resides in an automated handling line
comprising a guide rail that defines the perimeter of a path
of a container when conveyed along part of an automated
handling line, the path and hence the perimeter being
arcuate about a centre and positioned at a radius from the
30 centre, wherein the guide rail is movable radially to define
the perimeter at a plurality of different radii from
substantially the same centre.

- 4 -

Such an arrangement is clearly beneficial as it may be used in combination with a star wheel such that only a single path is traced by the rotating star wheel and the static guide rail assembly, no matter how they are set (e.g. to accommodate differently sized containers). This is in contrast to the prior art arrangement described above that does not allow concentric adjustment.

Preferably, the guide rail comprises at least two segments, a first segment being driveable in a substantially radial direction and a second segment being connected to the first segment by a link such that the second segment follows movement of the first segment. The use of a segmented guide rail is useful as it allows more flexibility over a single piece guide rail. Optionally, the second segment is constrained to move radially by guide means. However, a segmented guide rail may otherwise suffer from the weakness that it is difficult to maintain its shape whilst being moved if it were not for the guide means employed in this invention. By employing a link and guide means, only one of the segments need be driven as the remaining segment is forced to follow by the link and this path is also constrained by the guide means to ensure the shape of the guide rail as a whole is preserved. The guide means may comprise a post received within a slot, the slot being elongated radially. This arrangement allows radial movement of the guide rail.

Optionally, the first segment is constrained to move radially by further guide means. The further guide means may comprise a post received within a slot, the slot being elongated radially. This helps further to constrain motion of the guide rail to the radial direction.

- 5 -

Preferably, the first and second segments are arranged in superposition to overlap and are provided with a slideable link between overlapping portions to allow relative circumferential movement between the first and second segments as the segments move radially inwardly and outwardly. This is advantageous as it allows the shape of the perimeter to be preserved when the guide rail is moved. For example, if a guide rail defining part of a circle is moved inwardly, the circumference it subtends should also decrease: as the separation between segments may decrease with this arrangement, the overall length of the guide rail decreases.

The slideable link comprises a post received within an elongate slot, the slot being optionally elongated in a circumferential direction.

Optionally, the first segment is connected to an actuator arranged to drive the first segment radially. The actuator may comprise a thumb wheel mounted on a shaft. The actuator may comprise a rack and pinion, the pinion being provided on the shaft and the rack being aligned in the radial direction. Alternatively, the actuator may comprise a cam arrangement.

Optionally, the guide rail assembly may further comprise a clamping mechanism operable to clamp the guide rail in position. The clamping mechanism may comprise a thumb wheel provided on a shaft with co-operating screw threads. The shaft may correspond to the post of the guide means or the further guide means.

The guide rail assembly may optionally further comprise a position indicator and a scale, wherein one of the position indicator or scale is fastened to the guide rail to

- 6 -

move therewith and the other is fixed in position. This provides a simple indication of where the guide rail is set.

Optionally, the guide rail assembly further comprises a third segment, the third segment being connected to the second segment by a second link. Provision of further segments allows better preservation of the shape of the guide rail. The first and third segments may be driven by respective actuators that are coupled such that driving one actuator drives the other actuator.

Optionally, the actuators are driven by shafts coupled such that rotation of one shaft causes rotation of the other shaft. Preferably, sprockets connected by a chain are mounted on the shafts.

Preferably, the guide rail assembly further comprises a second guide rail like the guide rail of any preceding claim. This provides more stable support of a container. The second guide rail may be moveable independently of the first guide rail, or the second guide rail may be connected to the first guide rail so that they move in unison.

From a second aspect, the present invention resides in a method of adjusting an automated handling line guide rail assembly comprising a guide rail that defines the perimeter of a path of a container when conveyed along part of an automated handling line, the path and hence the perimeter being arcuate about a centre and positioned at a radius from the centre, the method comprising moving the guide rail radially to define the perimeter at a different radius from substantially the same centre.

In order that the invention can be more readily understood, reference will now be made by way of example only, to the accompanying drawings in which:

- 7 -

Figure 1 is a plan view of an automated handling line guide rail assembly according to the present invention;

Figure 2 is an isometric view of the guide rail assembly of Figure 1 from above and in front;

5 Figure 3 is an isometric view of the guide rail assembly of Figure 1 from above and behind;

Figure 4 is a plan view of the guide rail assembly of Figure 1, with the top plate removed;

10 Figure 5 is an isometric view of the guide rail assembly of Figure 1 from above and in front, with the top plate removed;

Figure 6 is an isometric view of the guide rail assembly of Figure 1 from above and behind, with the top plate removed; and

15 Figure 7 is an isometric view of the guide rail assembly of Figure 1 from above and in front, with various parts removed to show other features of the invention.

An automated handling line guide rail assembly 10 defining a generally arcuate path corresponding to the arc 20 of a circle of approximately 100° is shown in Figures 1 to 7. The guide rail assembly 10 comprises a generally flat, elongate structure bounded by a top plate 12 and a bottom plate 14 separated by posts 15. The guide rail assembly 10 also comprises a pair of guide rails 16, 17 defining the 25 front arcuate surface. The guide rails 16, 17 correspond in size and shape and are positioned one 16 above the other 17. Three thumb wheels 18, 20, 22 and a position indicator 24 sit proud of the top plate 12.

30 As can best be seen from Figure 3, one of the thumb wheels 18 is mounted on a shaft that extends through the top plate 12 to enter an actuator box 26. Also mounted on the shaft beneath the thumb wheel 18 is a drive sprocket 28 that

- 8 -

is used to drive a chain 30, as best seen in Figures 5 and 6. The other end of the chain 30 passes around a driven sprocket 32 that is mounted on a shaft that is connected to a second actuator box 34, identical to the first actuator
5 box 24. The actuator boxes 26, 34 are provided with a rack and pinion gearing. The pinions are provided on the bottoms of the shafts also mounting the sprockets 28, 32, and the pinions are provided as rods 35 that are connected to yokes 38. The yokes 38 are in turn connected to the guide rails
10 16, 17, as best seen in Figure 7. Accordingly, rotating the thumb wheel 18 causes the guide rails 16, 17 to be driven in and out by the rack and pinion gearing of the actuator boxes 26, 34.

The other thumb wheels 20, 22 provide a clamp that is
15 used to secure the guide rails 16, 17 in position. Both thumb wheels 20, 22 are provided on a shaft with a screw thread that, when tightened, clamps together the top 12 and bottom 14 plates thereby firmly sandwiching the components therebetween to lock the guide rails 16, 17 in position.

20 As can best be seen from Figure 5, the guide rails 16, 17 are divided into various parts that make up top 16 and bottom 17 guide rails, and left 40, centre 41 and right 42 segments. While the right segment 42 comprises only a single element for each of the top 16 and bottom 17 guide
25 rails, the left segment 40 comprises a corresponding element that is joined via pins 43 to a lower finger 40'. These fingers 40' are positioned to mesh with fingers of a star wheel positioned at the same level as guide rails 16, 17.

Both guide rails 16, 17 move in unison in this
30 embodiment by virtue of various pins that extend therebetween. For example, pins 44 protrude through apertures provided in the yokes 38 to be received in holes

- 9 -

provided in the top 16 and bottom 17 guide rails. Other pins 46, pass through top 16 and bottom 17 guide rails and provide a link between adjacent segments. However, in other contemplated embodiments, the top 16 and bottom 17 guide rails may be moved independently, i.e. each of the top 16 and bottom 17 guide rails has its own dedicated pair of actuator boxes 26, 34, and thumb wheel 18 and drive chain 30.

As can be seen most clearly from Figure 4, the left segment 40 is connected to the yoke 38 of actuator box 34 and the right segment 42 is connected to the yoke 38 of actuator box 26. Accordingly, left 40 and right 42 segments are driven to move in the direction of movement of the rods 36 of actuator boxes 26, 34. The motion of the left 40 and right 42 segments is further constrained by a series of guide members that comprise posts 48 passing through apertures of a corresponding width but with an elongate length provided in enlarged lobes 50 of the left 40 and right segments. The posts are in fact provided by the shafts upon which the clamping thumb wheels 20, 22 are mounted, hence reducing the total parts count of the guide rail assembly 10. The rods 36 of the actuator boxes 26, 34 and the apertures provided in the lobes 50 are elongate in the radial direction of the arc that the guide rails 16, 17 provide. Thus, the left 40 and right 42 segments are constrained to move radially in and out. Common gearing of the sprockets 28, 32 that co-operate with the drive chain 30 ensures that the left 40 and right 42 segments move radially at the same rate.

The middle segment 41 comprises a three tier element: the top 52 and bottom 54 tiers comprise plates at the heights of the top 16 and bottom 17 guide rails adjacent the

- 10 -

left 40 and right 42 segments, whereas the middle tier comprises a longer plate that extends at each side into the gap separating the top 16 and bottom 17 guide rail portions 53 of the left 40 and right 42 segments. Middle tier 53 includes a tab 56 at its rear that has a pair of slots 58. These slots 58 are also elongate in the radial direction and receive a pair of pins 60. Hence, the middle segment 41 is also constrained to move radially in and out.

The middle tier 53 also comprises a second pair of slots 62 at its ends that receive the pins 46 that fasten the top 16 and bottom 17 guide rails together. The slots 62 are elongate with a width corresponding to the pins 46 and a greater length that extends in a generally circumferential direction. Thus, the pins 46 provide a link between the left 40, middle 41 and right 42 segments such that rotating the thumb wheel 18 drives all three segments 40, 41, 42 to move radially. Specifically, while left 40 and right 42 segments are driven by the actuator boxes 26 and 34, the pins 46 making contact with the edges of apertures 62 urge the middle segment 41 to follow the left 40 and right 42 segments. Moreover, as the segments 40, 41, 42 are being driven radially, their separation must either increase or decrease as the circumference of the arc they subtend changes. For example, when being driven inwardly, the segments 40, 41, 42 will move together to define a smaller circumference as the outer limit of the path. The slots 62 provided in the middle tier 53 of the middle segment 41 allow the segments 40, 41, 42 to move inwardly towards each other thereby preventing jamming of the mechanism. As will be appreciated, the pins 46 merely slide along the slots 62 thereby allowing separation to vary.

- 11 -

Thus, as the guide rails 16, 17 are moved, the outer limit of the path the container will follow changes relative to the centre path and, moreover, the circumference of the outer path also changes to match the change in radius. This change in circumference is provided by the expandable gaps
5 between the left 40 and middle 41 segments, and the middle 41 and right 42 segments that allow the guide rails 16, 17 as a whole to expand and contract as they are moved radially.

10 As described previously, a position indicator 24 is provided on top of the guide rail assembly 10. This position indicator 24 comprises a flat plate with a straight edge that is mounted from an upright 64 that is in turn fastened to the back of the tab 56 of the middle tier 53 of
15 the middle segment 41. The upright 64 projects through an aperture 66 provided in the top plate 12 thereby allowing the position indicator 24 to move with the middle segment 41. The position indicator 24 is mounted with the edges of its straight edge above a pair of scales 68 provided on the
20 top plate 12 to allow the position of the guide rails 16, 17 to be determined.

A skilled person would appreciate that the above embodiment may be varied in many different respects without departing from the scope of the present invention.

25 Although the above embodiment has a guide rail assembly that defines an arcuate path, other shapes are clearly also possible. For example, elliptical shapes can easily be achieved, as can other serpentine paths. One possibility is an S-shaped path where some segments 40, 41, 42 of the guide
30 rails 16, 17 will move closer together while the separation of other segments will increase.

- 12 -

While the above embodiment has a pair of guide rails to support a container at different heights, any other number of guide rails 16, 17 may be used. For example, a single guide rail may be appropriate, particularly if it is of a greater height. Alternatively, three, four or even more
5 guide rails may be used, particularly for tall containers or containers of varying widths. As mentioned above, the guide rails 16, 17 may either be fixed together to move in unison or each guide rail may be independently adjustable.

10 Whilst the above embodiment employs triple-segmented guide rails 16, 17, clearly any number of segments may be chosen for any particular purpose. Clearly, the more segments the better in that the invariance in the shape of the guide rails 16, 17 as they move. This is because each
15 individual segment 40, 41, 42 has a fixed radius of curvature (chosen to be a maximum value for the required paths) and it is the expandable gaps between the segments 40, 41, 42 that allows the overall shape to be maintained. However, the more segments, the greater the complexity of
20 the guide rail assembly 10 so there will always be a trade-off in this respect. However many segments are chosen, the number of segments provided with a dedicated actuator box 26, 34 may also be freely chosen. More actuator boxes could be provided, such as in a five segment guide rail wherein
25 the first, third and fifth segments are directly driven and the second and fourth segments merely follow. Of course, only one segment need be driven and all remaining segments could follow.

The above embodiment uses actuator boxes that employ a
30 rack and pinion system but other means that provide rotation to linear movement could be equally employable, such as a cam mechanism. For example, an eccentrically mounted roller

- 13 -

may be employed that is used to push the guide rail segments radially in and out. Moreover, a rotational actuator such as a thumb wheel need not be provided. Other rotational actuators may be used or even linear actuators, such as
5 slide members, may be used.

CLAIMS

1. An automated handling line guide rail assembly comprising a guide rail that defines the perimeter of a path
5 of a container when conveyed along part of an automated handling line, the path and hence the perimeter being arcuate about a centre and positioned at a radius from the centre, wherein the guide rail is movable radially to define the perimeter at a plurality of different radii from
10 substantially the same centre.
2. The guide rail assembly of claim 1, wherein the guide rail comprises at least two segments, a first segment being driveable in a substantially radial direction and a second
15 segment being connected to the first segment by a link such that the second segment follows movement of the first segment.
3. The guide rail assembly of claim 2, wherein the second
20 segment is constrained to move radially by guide means.
4. The guide rail of claim 3, wherein the guide means comprises a post received within a slot, the slot being elongated radially.
25
5. The guide rail assembly of claim 3 or claim 4, wherein the first segment is constrained to move radially by further guide means.
- 30 6. The guide rail assembly of claim 5, wherein the further guide means comprises a post received within a slot, the slot being elongated radially.

- 15 -

7. The guide rail assembly of any of claims 2 to 6, wherein the first and second segments are arranged in superposition to overlap and are provided with a slideable link between overlapping portions to allow relative circumferential movement between the first and second segments as the segments move radially inwardly and outwardly.
- 5
- 10 8. The guide rail assembly of claim 7, wherein the slideable link comprises a post received within an elongate slot.
9. The guide rail assembly of claim 8, wherein the slot is elongated in a circumferential direction.
- 15
10. The guide rail assembly of any of claims 2 to 9, wherein the first segment is connected to an actuator arranged to drive the first segment radially.
- 20
11. The guide rail assembly of claim 10, wherein the actuator comprises a thumb wheel mounted on a shaft.
12. The guide rail assembly of claim 11, wherein the actuator comprises a rack and pinion, the pinion being provided on the shaft and the rack being aligned in the radial direction.
- 25
13. The guide rail assembly of any preceding claim, further comprising a clamping mechanism operable to clamp the guide rail in position.
- 30

- 16 -

14. The guide rail assembly of claim 13 when dependent upon claim 4 or claim 6, wherein the clamping mechanism comprises a thumb wheel provided on a shaft, and the shaft corresponds to the post of the guide means or the further guide means.

5

15. The guide rail assembly of any preceding claim, further comprising a position indicator and a scale, wherein one of the position indicator or scale is fastened to the guide rail to move therewith and the other is fixed in position.

10

16. The guide rail assembly of claims 2 to 15, further comprising a third segment, the third segment being connected to the second segment by a second link.

15 17. The guide rail assembly of claim 16, wherein the third segment is constrained to move radially by guide means.

18. The guide rail assembly of claim 17, wherein the guide means constraining movement of the third segment comprise a post received within a slot, the slot being elongated radially.

19. The guide rail assembly of any of claims 16 to 18, wherein the second and third segments are arranged in superposition to overlap and are provided with a slideable link between overlapping portions to allow relative circumferential movement between the second and third segments as the segments move radially inwardly and outwardly.

30

- 17 -

20. The guide rail assembly of claim 19, wherein the slideable link between second and third segments comprises a post received within an elongate slot.
- 5 21. The guide rail assembly of claim 20, wherein the slot is elongated in a circumferential direction.
22. The guide rail assembly of any of claims 16 to 21, wherein the third segment is connected to an actuator
10 arranged to drive the third segment radially.
23. The guide rail assembly of any of claims 16 to 22, wherein the first and third segments are driven by respective actuators that are coupled such that driving one
15 actuator drives the other actuator.
24. The guide rail assembly of claim 23, wherein the actuators are driven by shafts coupled such that rotation of one shaft causes rotation of the other shaft.
20
25. The guide rail assembly of claim 24, wherein sprockets connected by a chain are mounted on the shafts.
26. The guide rail assembly of any preceding claim, further
25 comprising a second guide rail like the guide rail of any preceding claim.
27. The guide rail assembly of claim 26, wherein the second
30 guide rail is moveable independently of the first guide rail.

- 18 -

28. The guide rail assembly of claim 26, wherein the second guide rail is connected to the first guide rail so that they move in unison.

5 29. The guide rail assembly of claim 28 when dependent upon claim 8, wherein the first and second guide rails are connected by the post that is received within the elongate slot of the slideable link.

10 30. A method of adjusting an automated handling line guide rail assembly comprising a guide rail that defines the perimeter of a path of a container when conveyed along part of an automated handling line, the path and hence the perimeter being arcuate about a centre and positioned at a
15 radius from the centre, the method comprising moving the guide rail radially to define the perimeter at a different radius from substantially the same centre.

31. An automated handling line guide rail assembly
20 substantially as hereinbefore described with reference to any of the accompanying Figures.

32. A method of adjusting an automated handling line guide rail assembly substantially as hereinbefore described with
25 reference to any of the accompanying Figures.

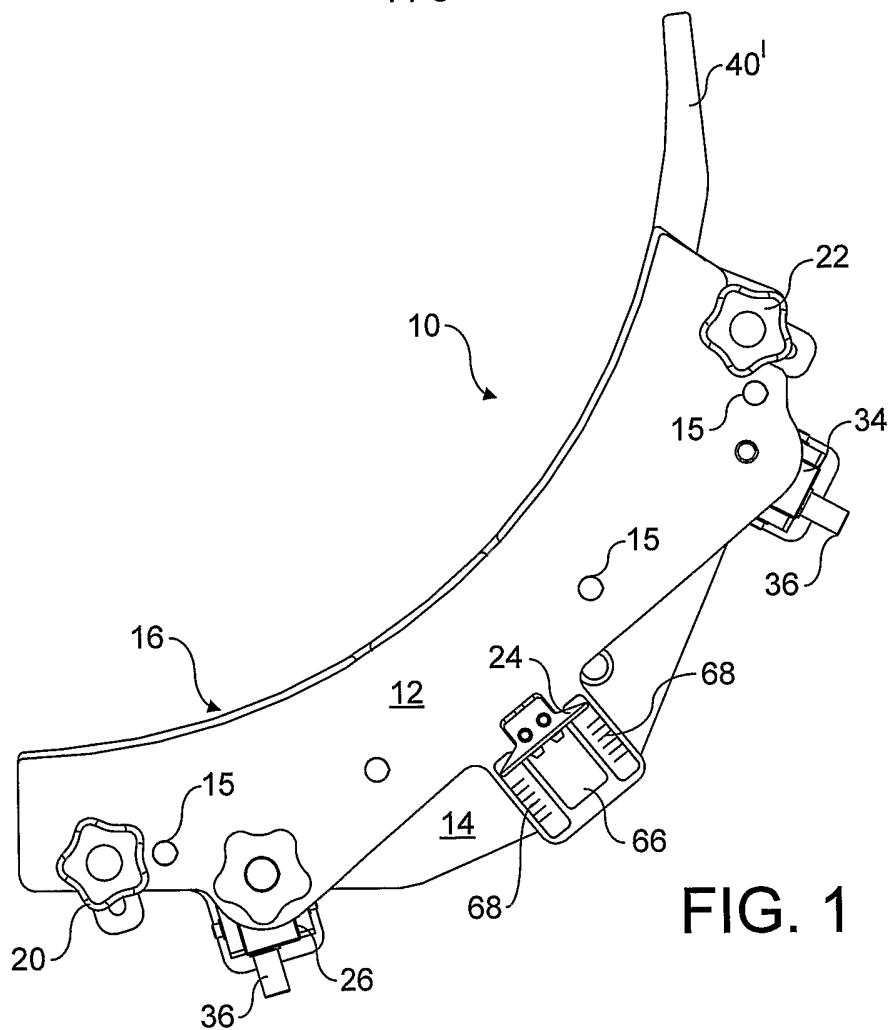

FIG. 1

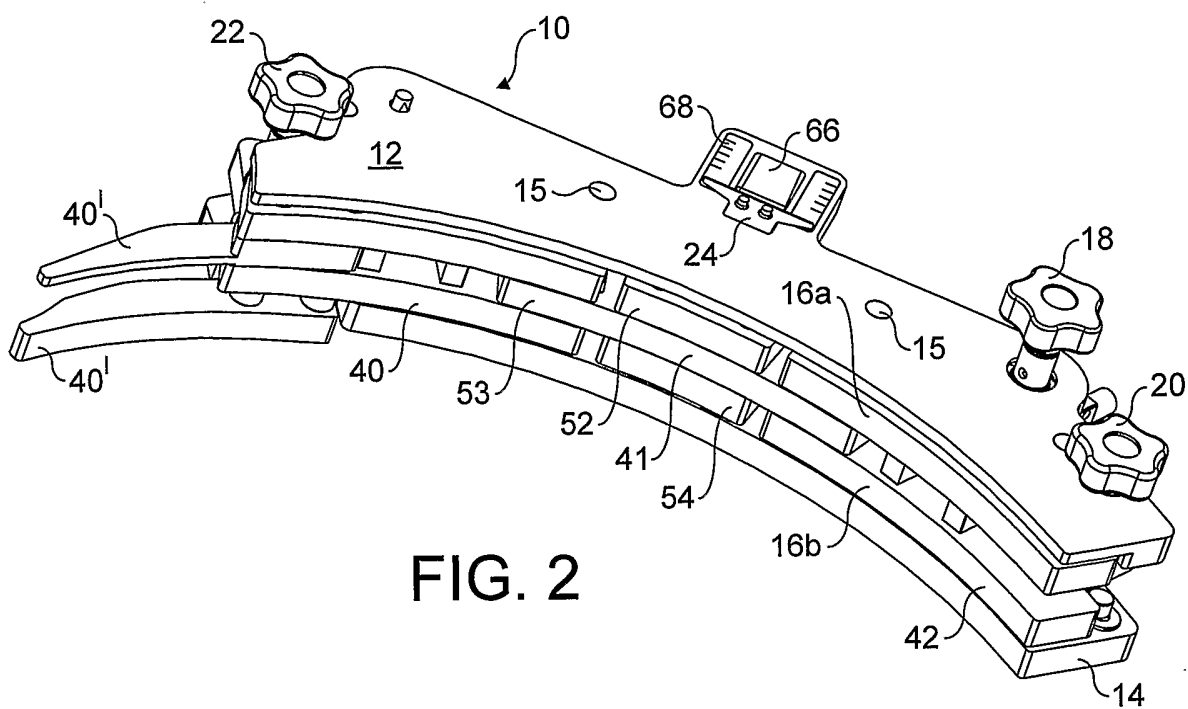

FIG. 2

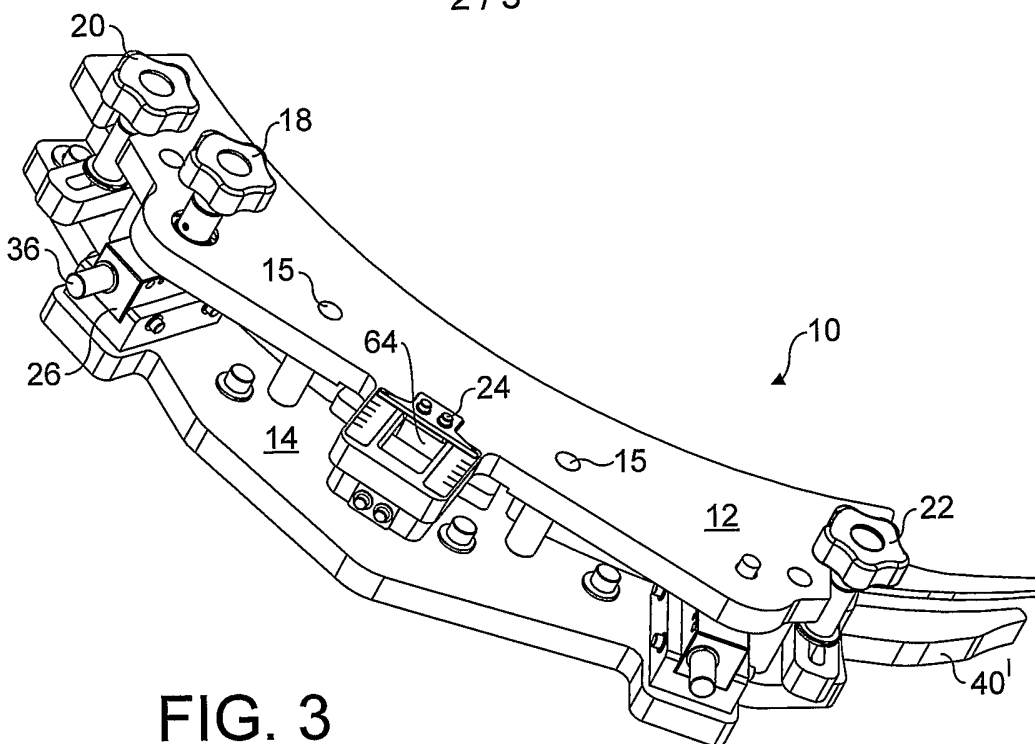

FIG. 3

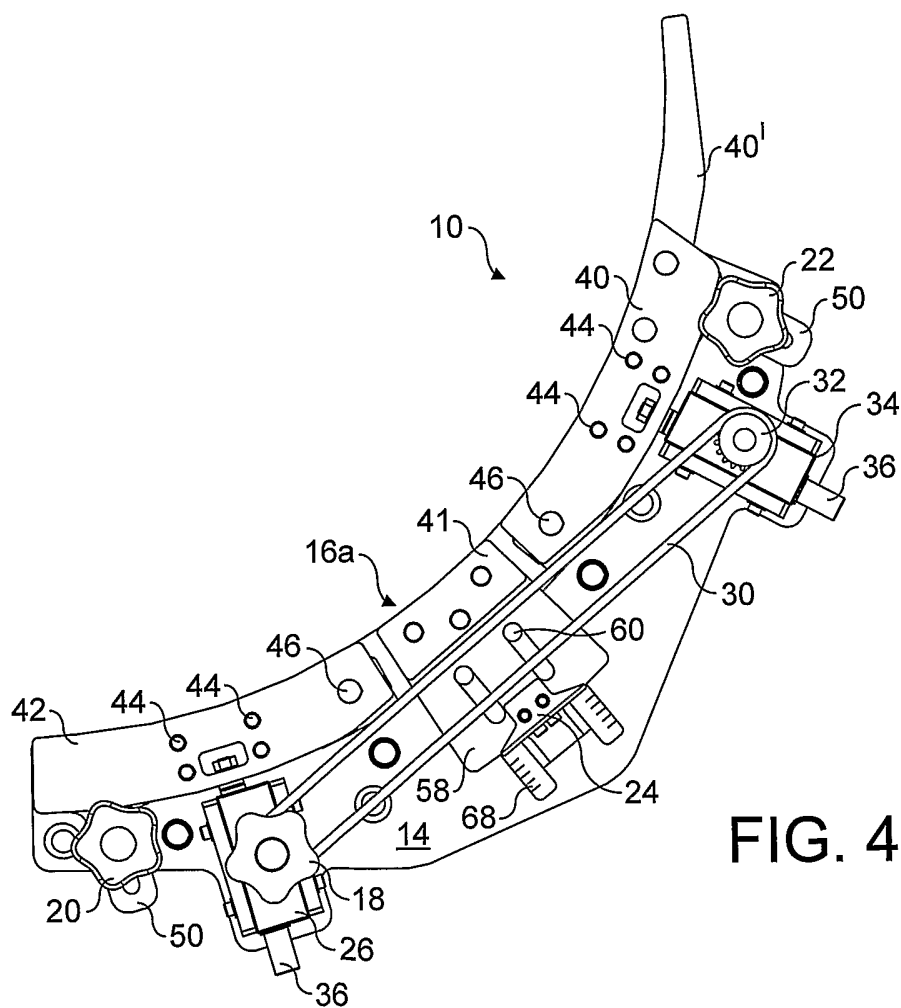

FIG. 4

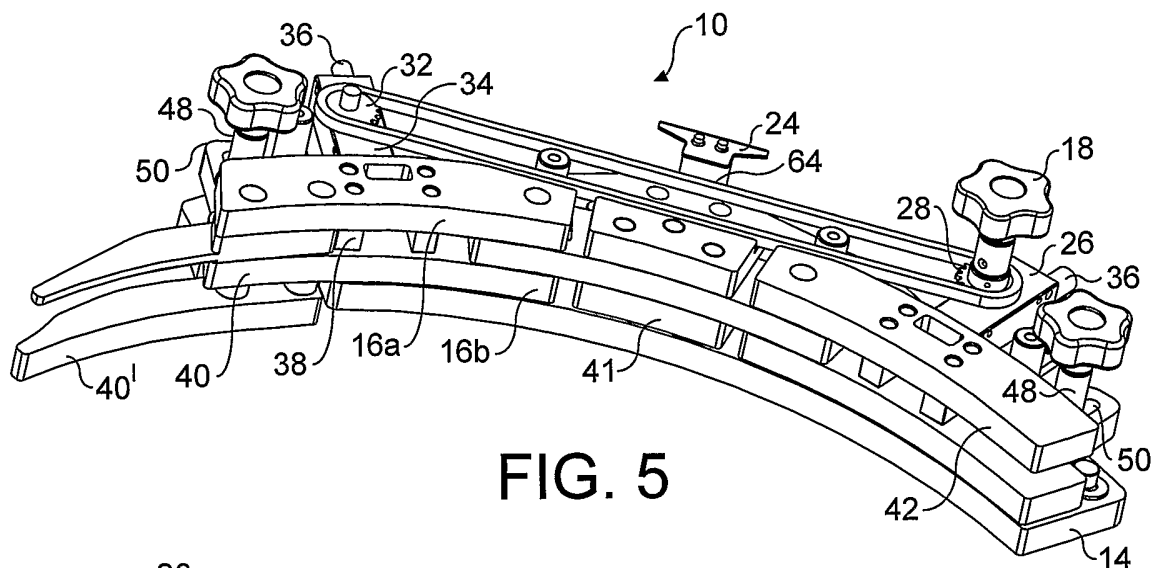

FIG. 5

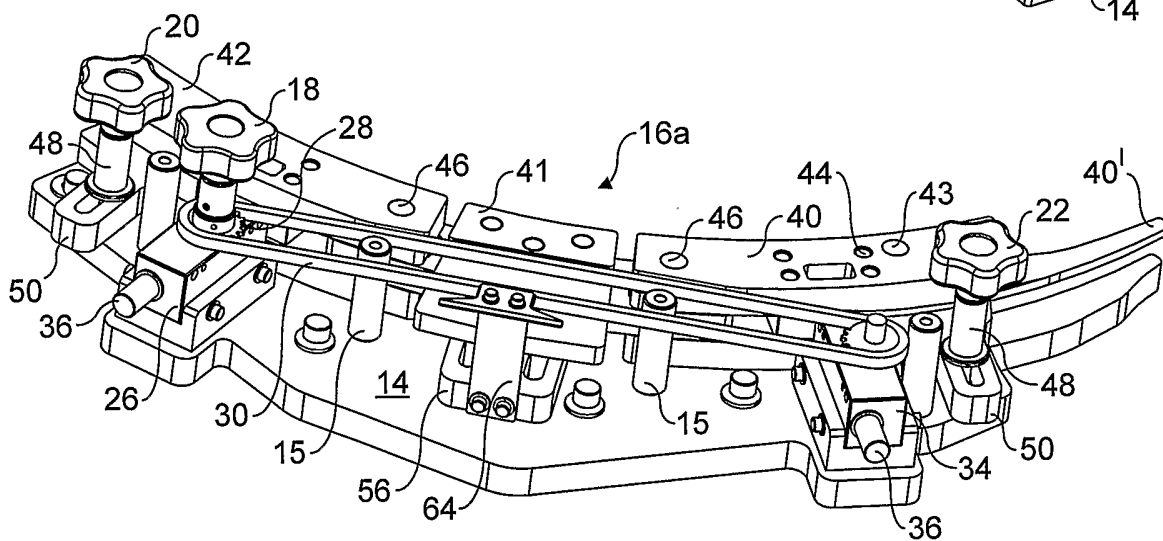

FIG. 6

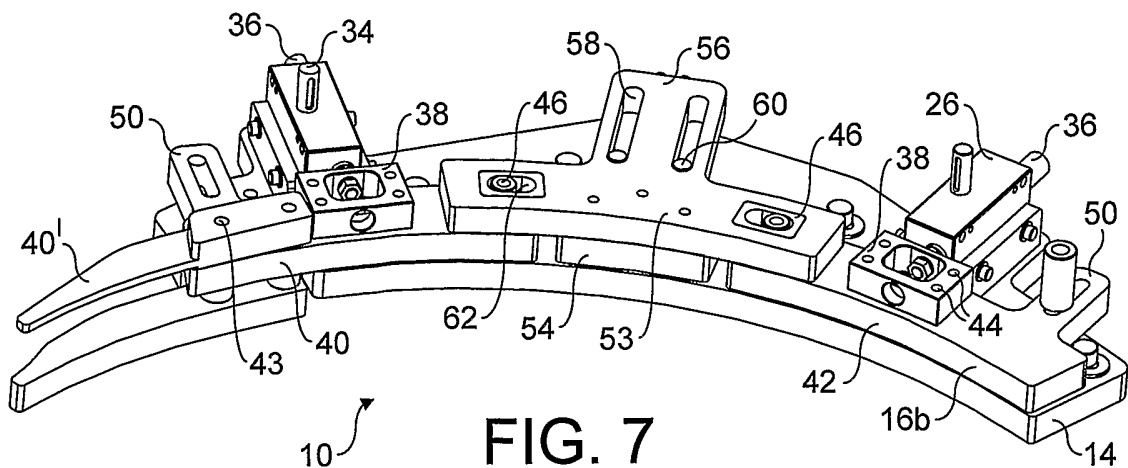

FIG. 7

INTERNATIONAL SEARCH REPORT

International Application No.
PCT/GB2005/002447

A. CLASSIFICATION OF SUBJECT MATTER IPC 7 B65G47/84 B65G21/20		
According to International Patent Classification (IPC) or to both national classification and IPC		
B. FIELDS SEARCHED		
Minimum documentation searched (classification system followed by classification symbols) IPC 7 B65G		
Documentation searched other than minimum documentation to the extent that such documents are included in the fields searched		
Electronic data base consulted during the international search (name of data base and, where practical, search terms used) EPO-Internal, WPI Data, PAJ		
C. DOCUMENTS CONSIDERED TO BE RELEVANT		
Category °	Citation of document, with indication, where appropriate, of the relevant passages	Relevant to claim No.
X Y X Y	EP 0 412 059 A (SARCOMI S.P.A) 6 February 1991 (1991-02-06) cited in the application column 2, line 31 - column 3, line 8 figures 1-3 ----- US 5 291 988 A (LEONARD ET AL) 8 March 1994 (1994-03-08) column 2, line 12 - line 64 figures 1-6 ----- -/--	1-3, 5, 7, 10, 11, 26-28, 30 4-6, 12, 13, 19 1, 2, 16, 22, 30 13, 17-19, 22-24
<input checked="" type="checkbox"/> Further documents are listed in the continuation of box C. <input checked="" type="checkbox"/> Patent family members are listed in annex.		
° Special categories of cited documents :		
A document defining the general state of the art which is not considered to be of particular relevance *E* earlier document but published on or after the international filing date *L* document which may throw doubts on priority claim(s) or which is cited to establish the publication date of another citation or other special reason (as specified) *O* document referring to an oral disclosure, use, exhibition or other means *P* document published prior to the international filing date but later than the priority date claimed	*T* later document published after the international filing date or priority date and not in conflict with the application but cited to understand the principle or theory underlying the invention *X* document of particular relevance; the claimed invention cannot be considered novel or cannot be considered to involve an inventive step when the document is taken alone *Y* document of particular relevance; the claimed invention cannot be considered to involve an inventive step when the document is combined with one or more other such documents, such combination being obvious to a person skilled in the art. *&* document member of the same patent family	
Date of the actual completion of the international search <p style="text-align: center;">16 September 2005</p>	Date of mailing of the international search report <p style="text-align: center;">05/10/2005</p>	
Name and mailing address of the ISA European Patent Office, P.B. 5818 Patentlaan 2 NL - 2280 HV Rijswijk Tel. (+31-70) 340-2040, Tx. 31 651 epo nl, Fax: (+31-70) 340-3016	Authorized officer <p style="text-align: center;">Papatheofrastou, M</p>	

INTERNATIONAL SEARCH REPORT

International Application No
PCT/GB2005/002447

C.(Continuation) DOCUMENTS CONSIDERED TO BE RELEVANT		
Category °	Citation of document, with indication, where appropriate, of the relevant passages	Relevant to claim No.
X	CH 431 377 A (EMHART ZURICH S. A) 28 February 1967 (1967-02-28)	1, 30
Y	column 3, line 11 - line 24 figure 1	4-6, 17, 18, 22-24
X	US 6 378 695 B1 (RINNE RHETT L) 30 April 2002 (2002-04-30)	1, 30
Y	the whole document	12

I

INTERNATIONAL SEARCH REPORT

International application No.
PCT/GB2005/002447

Box II Observations where certain claims were found unsearchable (Continuation of item 2 of first sheet)

This International Search Report has not been established in respect of certain claims under Article 17(2)(a) for the following reasons:

1. Claims Nos.:
because they relate to subject matter not required to be searched by this Authority, namely:

2. Claims Nos.: 31, 32
because they relate to parts of the International Application that do not comply with the prescribed requirements to such an extent that no meaningful International Search can be carried out, specifically:
see FURTHER INFORMATION sheet PCT/ISA/210

3. Claims Nos.:
because they are dependent claims and are not drafted in accordance with the second and third sentences of Rule 6.4(a).

Box III Observations where unity of invention is lacking (Continuation of item 3 of first sheet)

This International Searching Authority found multiple inventions in this international application, as follows:

1. As all required additional search fees were timely paid by the applicant, this International Search Report covers all searchable claims.

2. As all searchable claims could be searched without effort justifying an additional fee, this Authority did not invite payment of any additional fee.

3. As only some of the required additional search fees were timely paid by the applicant, this International Search Report covers only those claims for which fees were paid, specifically claims Nos.:

4. No required additional search fees were timely paid by the applicant. Consequently, this International Search Report is restricted to the invention first mentioned in the claims; it is covered by claims Nos.:

Remark on Protest

- The additional search fees were accompanied by the applicant's protest.
- No protest accompanied the payment of additional search fees.

FURTHER INFORMATION CONTINUED FROM PCT/ISA/ 210

Continuation of Box II.2

Claims Nos.: 31,32

The claims 31,32 are rely on reference to the drawings contrary to Rule 6.2 (a) PCT.

The applicant's attention is drawn to the fact that claims relating to inventions in respect of which no international search report has been established need not be the subject of an international preliminary examination (Rule 66.1(e) PCT). The applicant is advised that the EPO policy when acting as an International Preliminary Examining Authority is normally not to carry out a preliminary examination on matter which has not been searched. This is the case irrespective of whether or not the claims are amended following receipt of the search report or during any Chapter II procedure. If the application proceeds into the regional phase before the EPO, the applicant is reminded that a search may be carried out during examination before the EPO (see EPO Guideline C-VI, 8.5), should the problems which led to the Article 17(2) declaration be overcome.

INTERNATIONAL SEARCH REPORT

Information on patent family members

International Application No PCT/GB2005/002447

Patent document cited in search report	Publication date	Publication date	Patent family member(s)	Publication date
EP 0412059	A	06-02-1991	BR 9003765 A DE 69006797 D1 IT 1234736 B US 5082105 A	03-09-1991 31-03-1994 26-05-1992 21-01-1992
US 5291988	A	08-03-1994	NONE	
CH 431377	A	28-02-1967	DE 1940484 U	08-06-1966
US 6378695	B1	30-04-2002	NONE	