

(19) World Intellectual Property Organization  
International Bureau



(43) International Publication Date  
2 February 2006 (02.02.2006)

PCT

(10) International Publication Number  
WO 2006/011793 A1

- (51) International Patent Classification<sup>7</sup>: **B65D 85/60**, 75/10, 75/16, 75/58, B65B 25/00
- (21) International Application Number: PCT/NL2005/000547
- (22) International Filing Date: 26 July 2005 (26.07.2005)
- (25) Filing Language: Dutch
- (26) Publication Language: English
- (30) Priority Data:  
1026721 26 July 2004 (26.07.2004) NL  
1028314 17 February 2005 (17.02.2005) NL
- (71) Applicant (for all designated States except US): **CFS WEERT B.V.** [NL/NL]; De Fuus 8, NL-6006 RV Weert (NL).
- (72) Inventor; and
- (75) Inventor/Applicant (for US only): **NEIJNENS, Henricus, Petrus, Maria** [NL/NL]; Strikkenhof 38, NL-6081 HA Haelen (NL).
- (74) Agents: **FERGUSON, Alexander** et al.; c/o Octrooibureau Vriesendorp & Gaade B.V., P.O. Box 266, NL-2501 AW The Hague (NL).
- (81) Designated States (unless otherwise indicated, for every kind of national protection available): AE, AG, AL, AM, AT, AU, AZ, BA, BB, BG, BR, BW, BY, BZ, CA, CH, CN, CO, CR, CU, CZ, DE, DK, DM, DZ, EC, EE, EG, ES, FI, GB, GD, GE, GH, GM, HR, HU, ID, IL, IN, IS, JP, KE, KG, KM, KP, KR, KZ, LC, LK, LR, LS, LT, LU, LV, MA, MD, MG, MK, MN, MW, MX, MZ, NA, NG, NI, NO, NZ, OM, PG, PH, PL, PT, RO, RU, SC, SD, SE, SG, SK, SL, SM, SY, TJ, TM, TN, TR, TT, TZ, UA, UG, US, UZ, VC, VN, YU, ZA, ZM, ZW.
- (84) Designated States (unless otherwise indicated, for every kind of regional protection available): ARIPO (BW, GH, GM, KE, LS, MW, MZ, NA, SD, SL, SZ, TZ, UG, ZM, ZW), Eurasian (AM, AZ, BY, KG, KZ, MD, RU, TJ, TM), European (AT, BE, BG, CH, CY, CZ, DE, DK, EE, ES, FI, FR, GB, GR, HU, IE, IS, IT, LT, LU, LV, MC, NL, PL, PT,

[Continued on next page]

(54) Title: LOLLIPOP AND DEVICE FOR THE MANUFACTURING THEREOF

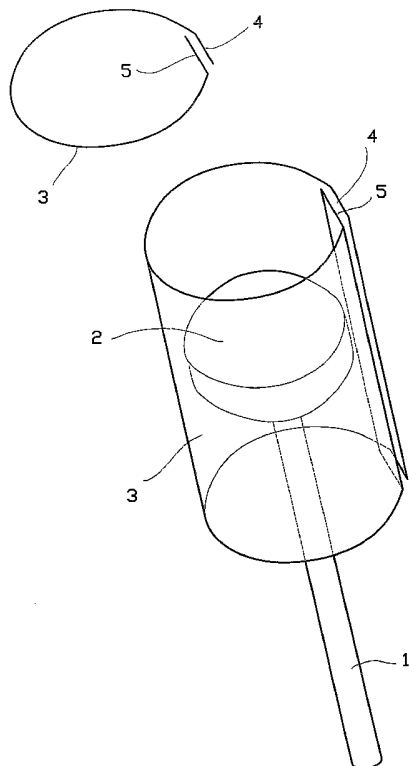

(57) Abstract: Lollipop having a head (2) and a stick (1), wherein the lollipop head is packaged in a packaging sheet (3), such as a foil sheet, wherein the packaging sheet forms a seal seam with edges (4, 5) that are joined together and wherein the sheet is sealed on both sides of the head, considered in longitudinal direction, and is twisted at at least one of the longitudinal ends. The seal seam extends over the full distance between both ends.

WO 2006/011793 A1



RO, SE, SI, SK, TR), OAPI (BF, BJ, CF, CG, CI, CM, GA, GN, GQ, GW, ML, MR, NE, SN, TD, TG).

**Declaration under Rule 4.17:**

— *as to applicant's entitlement to apply for and be granted a patent (Rule 4.17(ii)) for the following designations AE, AG, AL, AM, AT, AU, AZ, BA, BB, BG, BR, BW, BY, BZ, CA, CH, CN, CO, CR, CU, CZ, DE, DK, DM, DZ, EC, EE, EG, ES, FI, GB, GD, GE, GH, GM, HR, HU, ID, IL, IN, IS, JP, KE, KG, KM, KP, KR, KZ, LC, LK, LR, LS, LT, LU, LV, MA, MD, MG, MK, MN, MW, MX, MZ, NA, NG, NI, NO, NZ, OM, PG, PH, PL, PT, RO, RU, SC, SD, SE, SG, SK, SL, SM, SY, TJ, TM, TN, TR, TT, TZ, UA, UG, UZ, VC, VN, YU, ZA, ZM, ZW, ARIPO patent (BW, GH, GM, KE,*

*LS, MW, MZ, NA, SD, SL, SZ, TZ, UG, ZM, ZW), Eurasian patent (AM, AZ, BY, KG, KZ, MD, RU, TJ, TM), European patent (AT, BE, BG, CH, CY, CZ, DE, DK, EE, ES, FI, FR, GB, GR, HU, IE, IS, IT, LT, LU, LV, MC, NL, PL, PT, RO, SE, SI, SK, TR), OAPI patent (BF, BJ, CF, CG, CI, CM, GA, GN, GQ, GW, ML, MR, NE, SN, TD, TG)*

**Published:**

— *with international search report*

*For two-letter codes and other abbreviations, refer to the "Guidance Notes on Codes and Abbreviations" appearing at the beginning of each regular issue of the PCT Gazette.*

## Lollipop and device for the manufacturing thereof

The invention relates to a lollipop, particularly so-called (double-) twist wrap lollipops. The invention furthermore relates to a method for making such lollipops. The invention furthermore relates to a device for making such lollipops.

5

It is known to package lollipops in a foil sheet that is placed around the lollipop head and then twisted around the stick and sealed at that location. Such packagings can also be made with a twisted end at the side of the lollipop head that faces away from the stick, which results  
10 in a so-called double-twist wrap lollipop.

In case of the known double-twist wrap lollipops a sheet is folded around the head, in order to form a sleeve that is parallel to the stick. The longitudinal edges are brought into overlap with each other, after  
15 which the protruding ends of the sleeve are twisted.

An objection to this known packaging is that the overlap forms a passage for air and moisture towards the lollipop material, particularly the sugary mass of the lollipop head. In this way the quality of the  
20 lollipop head is affected, resulting in the lollipops being perishable in certain areas in the world.

It is an object of the invention to improve on this.

It is a further object of the invention to provide a lollipop that is easy to open, despite a sealed packaging.

5

From one aspect the invention provides a lollipop having a head and a stick, wherein the lollipop head is packaged in a packaging sheet, such as a foil sheet, wherein the packaging sheet forms a seal seam with edges that are joined together and wherein the sheet is sealed on both  
10 sides of the head, considered in longitudinal direction, and is twisted at at least one of the longitudinal ends.

In the lollipop according to the invention the head has been sealed from the ambience by the seal seam(s) and the at least one twisted area. In  
15 this way the quality, texture and taste of the lollipop mass is preserved. Due to the integrity of the packaging when the seal seam has been formed the lollipop head can, if necessary, be engaged for enhancing the twisting, without an opening in the packaging being created.

20 Preferably the seal seam extends between both ends, so that the seal seam is in one plane with the stick.

The seal seam may extend over the full distance between both ends, which results in an optimal sealing. The exact location (considered in  
25 stick direction) of the twisted area(s) is of less importance in that case.

Preferably the seal seam forms a strip that can be engaged on both sides by the fingers of a hand, which may enhance the opening of the packaging. Opening is further enhanced if the seal seam is provided  
30 with a local discontinuity or weakening, where tearing the packaging open can be initiated. The twisted areas need not be touched in that case.

In one embodiment the sheet is made of synthetic material, such as polypropylene, having a layer of sealable material. Said layer preferably is sealable, such as by heat and/or pressure (such as for instance a cold seal).

In one embodiment the sheet is twisted and sealed at both opposite ends, in order to form a so-called twist-wrap lollipop.

10 In one embodiment the packaging sheet is sealed at the location of the transition from the head to the stick. Preferably the packaging sheet is then twisted at the location of the transition from the head to the stick.

Preferably the packaging sheet is twisted at the longitudinal end facing away from the stick.

From a further aspect the invention provides in a more generally described lollipop, which lollipop comprises a head enveloped by a sheet-shaped packaging, wherein the packaging is twisted and sealed around the stick and behind the head, wherein the sheet is provided with a weakening or discontinuity for opening the packaging by tearing the sheet.

From a further aspect the invention provides a method for packaging a lollipop in a sheet of packaging material, such as a foil sheet, wherein the packaging sheet is placed around the lollipop in order to form a sleeve parallel to the stick, wherein the longitudinal edges of the sleeve are sealed together and at least one of the sections of the sleeve protruding towards the opposite sides of the head is twisted and both protruding sections are sealed.

Preferably prior to sealing the longitudinal edges are placed with their inner surfaces against each other.

Alternatively prior to sealing the longitudinal edges are placed with their inner surfaces and outer surfaces, respectively, against each other. The foil can then be provided with a sealable layer at the outer surface or at the inner surface.

Preferably the sealed longitudinal edges form a strip, which strip is laid against the sleeve.

The longitudinal edges and/or twisted areas can be sealed by hot air.

As indicated above the sealed longitudinal edges can be – or are - provided with a discontinuity or weakening.

From a further aspect the invention provides a device for packaging lollipops provided with a stick and a head, comprising means for holding the lollipops, means for supplying packaging material in the form of sheets, such as foil sheets, and means for placing the packaging sheet in question around the lollipop, wherein the packaging sheet is bent about a longitudinal centre line that is substantially parallel to the stick, furthermore provided with means for bringing the opposite longitudinal edge areas of the packaging sheet against each other, and means for sealing both longitudinal edge areas together while forming a foil tube, wherein the device furthermore comprises first and/or second means for twisting one or both foil tube sections protruding from the longitudinal sides of the lollipop head. With such a device a double-twisted and sealed lollipop packaging can be efficiently achieved.

The sealing of the packaging can be optimised if the sealing means have a length corresponding with at least almost the length of the longitudinal edge areas of the packaging sheet.

- 5 In one embodiment the sealing means are adapted for heat sealing.

In a further embodiment the first and second twisting means are rotatable in the same direction.

- 10 The first twisting means preferably are positioned for twisting the foil section in question around the stick.

- In one embodiment the means for placing the packaging sheet around the lollipop are adapted for placing the longitudinal edge areas with  
15 their inner sides against each other.

In a simple and fast-working embodiment the sealing means are part of the means for placing the packaging sheet around the lollipop.

- 20 Preferably the means for placing the packaging sheet around the lollipop and/or the sealing means are provided with cooperating means, such as a blade and an anvil, for forming a weakening or recess in both longitudinal edge areas.

- 25 From a further aspect the invention provides a device for packaging lollipops provided with a stick and a head, comprising means for holding the lollipops, means for supplying packaging material in the form of sheets, such as foil sheets, and means for placing the packaging sheet in question around the lollipop, wherein the packaging sheet is bent  
30 about a longitudinal centre line that is substantially parallel to the stick, furthermore provided with means for clamping the lollipops on the head with the foil in between, wherein the device furthermore comprises first

and/or second means for twisting one or both foil tube sections protruding from the longitudinal sides of the lollipop head, during continued clamping of the lollipop head.

5 Preferably the device is furthermore provided with means for bringing opposite longitudinal edge areas of the packaging sheet against each other, and means for sealing both longitudinal edge areas together, while forming a foil tube, prior to twisting.

10 The invention will be elucidated on the basis of an exemplary embodiment shown in the attached drawings, in which:

Figure 1 shows a double-twist wrap lollipop according to the state of the art, at a moment during manufacturing;

15

Figure 2 shows a double-twist wrap lollipop according to the invention at the same stage as figure 1;

20

Figure 3 shows the double-twist wrap lollipop of figure 2 at a next stage;

Figure 4A shows a double-twist wrap lollipop according to the invention, ready;

25

Figure 4B shows an alternative embodiment of a lollipop according to the invention;

Figure 5 shows a schematic view in perspective of a part of a packaging device for making lollipops according to figures 2-4A;

30

Figures 5A and 5B show a schematic view of a transfer station in the device of figure 5;

Figures 6A and 6B show a schematic view, transverse to the lollipop stick and in its extension, respectively, at a first packaging stage;

- 5 Figures 7A and 7B show a schematic view, transverse to the lollipop stick and in its extension, respectively, at a second packaging stage;

Figures 8A and 8B show a schematic view, transverse to the lollipop stick and in its extension, respectively, at a third packaging stage;

10

Figures 8C, 8D and 8E show an end view and side view of a sealing arm and a detail of the sealing surface of said sealing arm, respectively, in the packaging device of figure 5;

- 15 Figures 9A and 9B show a schematic view, transverse to the lollipop stick and in its extension, respectively, at a fourth packaging stage; and

Figures 10A and 10B show a schematic view, transverse to the lollipop stick and in its extension, respectively, at a fifth packaging stage.

20

The lollipop shown in figure 1 comprises a stick 1 and a lollipop head 2, which, at a packaging stage, are enveloped by a foil sheet 3, of which, as shown at the top section of figure 1, the edges 4 and 5 have been placed over each other for forming a sleeve, which further down the process is twisted above the head 2 and below the head 2 around the stick 1. The edges 4 and 5 that overlap each other may shift with respect to each other. After the packaging has been completed a passage may have been formed between the edges 4 and 5 through which air and moisture may get to the lollipop head 2, which adversely affects the quality of the lollipop.

25

30

In one suggestion according to the invention, shown in figures 2-4, the foil sheet 13, for instance made of polypropylene provided with a heat sealable layer, is transformed into an actual sleeve, without slit, wherein the edges 14 and 15 under the influence of heat, for instance by hot blow air, are sealed into an airtight and moisture proof seal edge 20. The seal edge 20 may be provided with a weakened area, particularly a notch 16, for initiating a tearing opening movement of the enveloping of the lollipop.

10 As can be seen in figure 3 the seal edge 20 is subsequently folded to lie flat against the sleeve-shaped packaging formed by sheet 13.

In the condition of figure 3 the foil sleeve closed in circumferential direction can be twisted at both longitudinal ends of the lollipop head 2 in the manner known per se, and be sealed as well, again for instance using hot blow air. Thus the sealed twisted areas 19 and 21 are formed (figure 4A), wherein at the free end a wing 22 is integrally formed. The head 2 is then enveloped by foil section 18, wherein the flat, turned seal edge 20 is accessible to a finger of the user, who is able to lift said edge, subsequently tear it open at the location of weakening 16 to subsequently take the lollipop out of the packaging.

The weakening or discontinuity may under certain circumstances also be formed by a tearing strip.

25

The lollipop according to figure 4A with the discussed packaging may preserve its quality for a long time, also in areas where with the packagings that have been common up until now the quality of the lollipops deteriorates very quickly.

30

The same applies to the lollipop shown in figure 4B, in which only one end section of the foil sleeve has been twisted. The head 2' is

enveloped by foil section 18', and provided with longitudinal seal 20' with weakening 16'. Below the head 2' the foil tube is twisted (21'), yet above the head 2' the foil tube is untwisted in fan-shaped, flat flaring section 19', yet transversely sealed at the location of seam 22'.

5

The (part of) packaging device 100 shown in figure 5 comprises a schematically shown supply device 30 for a web of packaging foil 130, which is unrolled from a supply roll 102 and driven in the direction S and cut into pieces of foil sheet 13 by means of blades 103. The cut  
10 off foil sheets 13 are intermittently discharged to a series of lollipops supplied in direction B in conveyance clamps 32a,b, as known per se from the applicant's commercially available machine TwistWrapper 300. Each lollipop including a foil sheet 13 is consecutively received in a wheel 40, driven in the direction C about a horizontal centre line. The  
15 transfer is schematically shown in figures 5A and 5B. Transfer device 70 moving up and down, takes the lollipops from the conveyance clamps 32a,b opened at that location wherein the lollipop head is supported on support members 73a,b and the stick on support member 71b, which support members with the member 71a are attached to  
20 support plate 72 of the transfer device 70. Between the support members 73a,b there is room for engagement of the head by clamping members 62a,b that are attached to wheel 40.

As is also schematically shown in figure 6B the lollipops in supply B are  
25 held clamped on the sticks by pairs of clamping jaws 32a, 32b. The second wheel 40 is provided with a series of lollipop holders 60, that circulate along with the second wheel 40 in the direction C.

In the second wheel 40 a number of stations can be distinguished in  
30 the circulation, namely station I, where the lollipops including foil sheets are accommodated, station or track II where the foil sheet 13 is placed around the lollipop head and sealed longitudinally, station III

where twisting takes place and station IV where the packaged and twisted lollipop is discharged in the direction D to a discharge station 110.

5 The lollipop holders 60 arranged on the disc 40 have a number of lollipop head clamping arms 42a, 42b, provided with clamping members 62a,b and furthermore hingingly driven (in a manner not shown) in the wheel 40, in order to be brought in and out of clamping engagement of the head of a lollipop.

10

The lollipop holders 60 furthermore comprise sealing arms 43a, 43b, which, as can be seen in figure 7B, are hingingly attached on the second wheel 40 at the location of hinges 44a, 44b, and are L-shaped with sealing rods 45a, 45b, in which heating elements 46a, 46b have  
15 been arranged. On sealing rod 45b (see figure 8E) a blade 65 has been provided that is able to cuttingly cooperate with an anvil 66 on sealing rod 46a. The blade 65 does not extend over the full height of the sealing rod 46a, but ends at a distance from the edge of the sealing rod that is situated at the lollipop side. As is also indicated in figure 8D a  
20 heating wire 64 extends to heating element 46b for actuating it. The wire 64 extends to hinge 44b, in order to be connected there to further electric wires that are not further shown.

As further shown in figures 9A and 10A two pairs of twisting arms  
25 47a, 47b and 48a, 48b are positioned at the location of station III, which arms are rotatably attached in manner that is not shown at the location of hinges 49a, 49b and 51a, 51b in order to be rotated in the directions G and H. The twisting arms 47a, 47b and 48a, 48b are provided with teeth 50a, 50b and 52a, 52b near their hinge end for  
30 cooperation with a drive rack (not further shown) in order to be able to carry out the said rotation.

At their other ends the twisting arms 47a, 47b and 48a, 48b are provided with foil engagement surfaces 53a, 53b and 54a, 54b. The twisting arms 47a, 47b are provided with an opening 63a,b to offer room to the sealing arms 43a, 43b, also see figure 8C.

5

In the partial track I the treatment shown in figures 6A and 6B takes place. The stick of the lollipop is still clamped by the clamping arms 32a, 32b of the supplier. The clamping arms 42a, 42b of the second wheel 60 rotate inwards, and with the clamping members 62a,b start clamping the lollipop on the head, with the foil sheet 13 in between. Then the clamping arms 32a, 32b of the supplier are released. The lollipop is then only held on the wheel 40.

Immediately subsequent, while rotating in direction C, in partial track II, the sealing arms 43a, 43b are rotated towards each other in the direction E. The sealing rods 45a, 45b with the heating elements 46a, 46b contact the pending foil sheet areas 13a, 13b and bring them towards each other, as can be seen in figure 7B.

This movement is continued until the foil sheet areas 13a, 13b touch each other and the sealing rods 45a, 45b of the sealing arms 43a, 43b extend just below the head 2 of the lollipop. The sealing arms 43a, 43b here also function as (part of the) means for placing the foil sheet fully around the lollipop.

25

In addition or subsequently the heating elements 46a, 46b are activated and the foil areas 13a, 13b are sealed together, see figure 8B.

Then a foil tube 13 closed by sealing is achieved, which fully surrounds the lollipop head 2 in partial area Y (see figures 8A, 9A), and protruding therefrom in longitudinal direction of the tube in foil tube edge areas X and Z.

30

Subsequently the sealing arms 43a, 43b can be moved apart in the direction E (see figure 9B), and the lollipop holders 60 arrive at twisting station III. At that location the wheel 40 is held still and the twisting arms 47a, 47b and 48a, 48b are rotated in the direction G and H in order to fixedly clamp the respective foil tube sections X and Z between the twisting surfaces 53a, 53b and 54a, 54b. The stick, however, remains clamped at all times between the clamping arms 42a, 42b, on the head, including the foil.

10

Subsequently the twisting arms 47a,b and 48a,b are rotated in the directions I and J, as schematically shown in figure 10A, about a centre line coinciding with the centre line of the stick. The clamping arms 42a, 42b here do not rotate any longer, so that the foil tube 13 is rotated, wherein the foil tube section X is twisted around the stick and the foil tube section Z is twisted into a fan-shaped knot. During twisting the twisting arms 47a,b and 48a,b will be moved slightly towards the lollipop head in the manner known per se (TwistWrapper 300).

20 Because of the twisted ends and the sealing seal continuing therein the lollipop head 2 will be fully closed off from the ambience.

After the twisting arms 47a, 47b and 48a, 48b have been removed from the lollipop including foil and have at least been slightly rotated back again the wheel 40 is rotated further and the packaged lollipop is discharged in station IV in direction D to a discharge station 110, after the clamping arms 42a, 42b have been opened.

25

## Claims

1. Lollipop having a head and a stick, wherein the lollipop head is packaged in a packaging sheet, such as a foil sheet, wherein the packaging sheet forms a seal seam with edges that are joined together and wherein the sheet is sealed on both sides of the head, considered  
5 in longitudinal direction, and is twisted at at least one of the longitudinal ends.
2. Lollipop according to claim 1, wherein a seal seam extends between both ends, preferably over the full distance between both ends.  
10
3. Lollipop according to claim 1 or 2, wherein the seal seam forms a strip that can be engaged on both sides by the fingers of a hand.
4. Lollipop according to claim 1, 2 or 3, wherein the seal seam is  
15 provided with a local discontinuity or weakening, such as a notch.
5. Lollipop according to any one of the claims 1-4, wherein the sheet is made of synthetic material, such as polypropylene, having a layer of sealable material.  
20
6. Lollipop according to claim 5, wherein the layer is sealable, such as by heat or pressure, particular cold seal.
7. Lollipop according to any one of the preceding claims, wherein the  
25 packaging sheet is sealed at the location of the transition from the head to the stick.

8. Lollipop according to claim 7, wherein the packaging sheet is twisted at the location of the transition from the head to the stick of the head.

5 9. Lollipop according to any one of the preceding claims, wherein the packaging sheet is twisted at the longitudinal end facing away from the stick.

10 10. Lollipop having a head enveloped by a sheet-shaped packaging, wherein the packaging is twisted and sealed around the stick and behind the head, wherein the sheet is provided with a weakening or discontinuity for opening the packaging by tearing the sheet.

15 11. Method for packaging a lollipop in a sheet of packaging material, such as a foil sheet, wherein the packaging sheet is wrapped around the lollipop in order to form a sleeve parallel to the stick, wherein the longitudinal edges of the sleeve are sealed together and at least one of the sections of the sleeve protruding towards the opposite sides of the head is twisted and both protruding sections are sealed.

20

12. Method according to claim 11, wherein prior to sealing the longitudinal edges are placed with their inner surfaces against each other.

25 13. Method according to claim 11, wherein prior to sealing the longitudinal edges are placed with their inner surfaces and outer surfaces, respectively, against each other.

30 14. Method according to claim 11, 12 or 13, wherein the sealed longitudinal edges form a strip, which strip is laid against the sleeve.

15. Method according to any one of the claims 11-14, wherein the longitudinal edges are sealed by hot air.

16. Method according to any one of the claims 11-15, wherein the  
5 twisted areas are sealed by hot air.

17. Method according to any one of the claims 11-16, wherein the sealed longitudinal edges are provided with a discontinuity or weakening.

10

18. Lollipop having a head and a stick, wherein the lollipop head is packaged in a packaging sheet, such as a foil sheet, wherein the packaging sheet with opposite edges forms a seal seam, and wherein the sheet at the location of the transition from the head to the stick and  
15 at the opposite side of the head is twisted and sealed.

19. Device for packaging lollipops provided with a stick and a head, comprising means for holding the lollipops, means for supplying packaging material in the form of sheets, such as foil sheets, and  
20 means for placing the packaging sheet in question around the lollipop, wherein the packaging sheet is bent about a longitudinal centre line that is substantially parallel to the stick, furthermore provided with means for bringing the opposite longitudinal edge areas of the packaging sheet against each other, and means for sealing both longitudinal edge areas  
25 together while forming a foil tube, wherein the device furthermore comprises first and/or second means for twisting one or both foil tube sections protruding from the longitudinal sides of the lollipop head.

20. Device according to claim 19, wherein the sealing means have a  
30 length corresponding with at least almost the length of the longitudinal edge areas of the packaging sheet.

21. Device according to claim 19 or 20, wherein the sealing means are adapted for heat sealing.

22. Device according to claim 19, 21 or 22, wherein the first and  
5 second twisting means are rotatable in the same direction.

23. Device according to any one of the claims 19-22, wherein the first twisting means are positioned for twisting the foil section in question around the stick.

10

24. Device according to any one of the claims 19-23, wherein the means for placing the packaging sheet around the lollipop are adapted for placing the longitudinal edge areas with their inner sides against each other.

15

25. Device according to any one of the claims 19-24, wherein the sealing means are part of the means for placing the packaging sheet around the lollipop.

20 26. Device according to any one of the claims 19-25, wherein the means for placing the packaging sheet around the lollipop and/or the sealing means are provided with cooperating means, such as a blade and an anvil, for forming a weakening or recess in both longitudinal edge areas.

25

27. Device for packaging lollipops provided with a stick and a head, comprising means for holding the lollipops, means for supplying packaging material in the form of sheets, such as foil sheets, and means for placing the packaging sheet in question around the lollipop,  
30 wherein the packaging sheet is bent about a longitudinal centre line that is substantially parallel to the stick, furthermore provided with means for clamping the lollipops on the head with the foil in between, wherein

the device furthermore comprises first and second means for twisting one or both foil tube sections protruding from the longitudinal sides of the lollipop head, during continued clamping of the lollipop head.

- 5 28. Device according to claim 27, furthermore provided with means for bringing opposite longitudinal edge areas of the packaging sheet against each other, and means for sealing both longitudinal edge areas together, while forming a foil tube, prior to twisting.
- 10 29. Lollipop provided with one or more of the characterising measures described in the attached description and/or shown in the attached drawings.
- 15 30. Method comprising one or more of the characterising steps described in the attached description and/or shown in the attached drawings.
- 20 31. Device provided with one or more of the characterising measures described in the attached description and/or shown in the attached drawings.

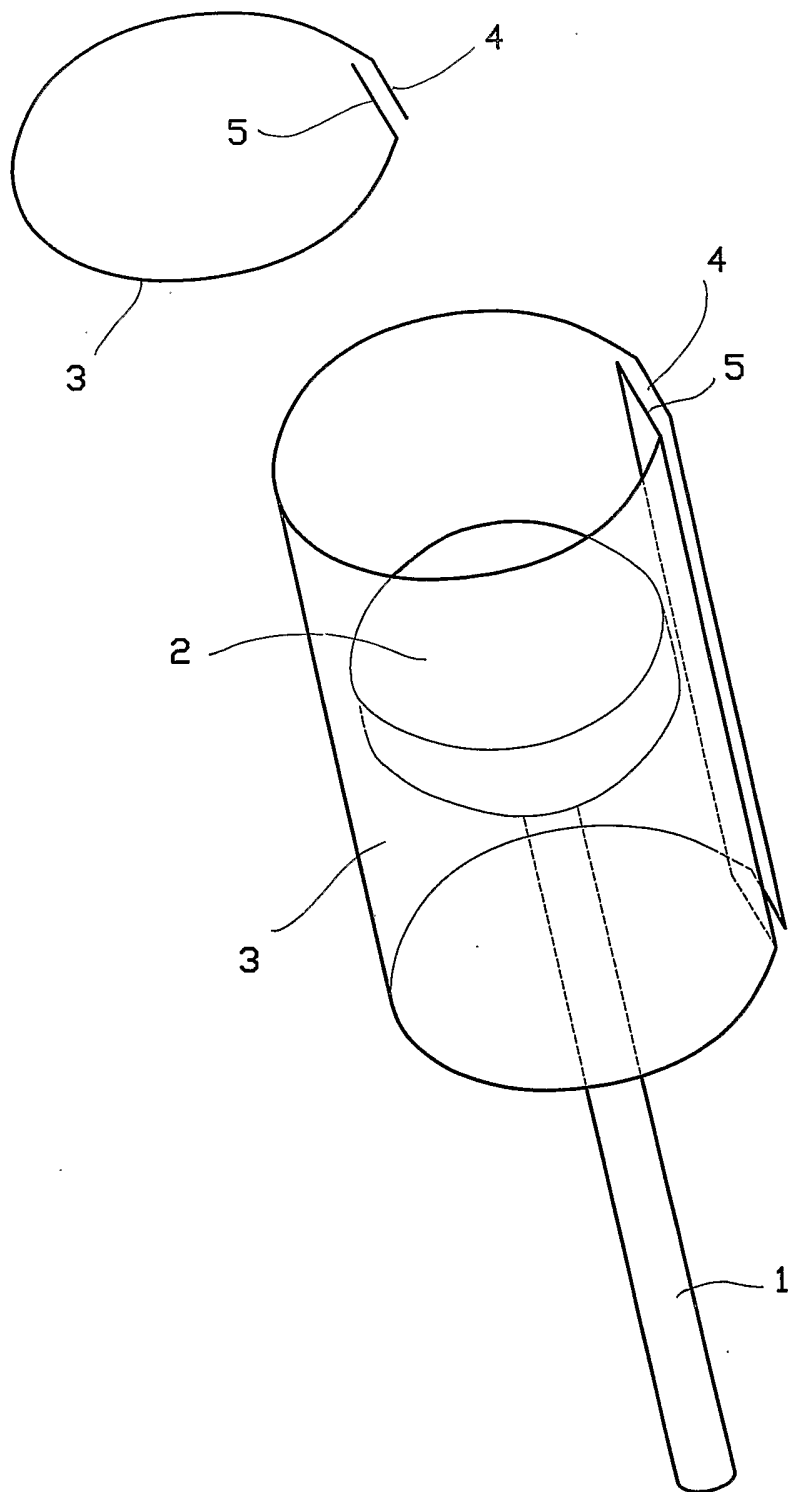

FIG. 1

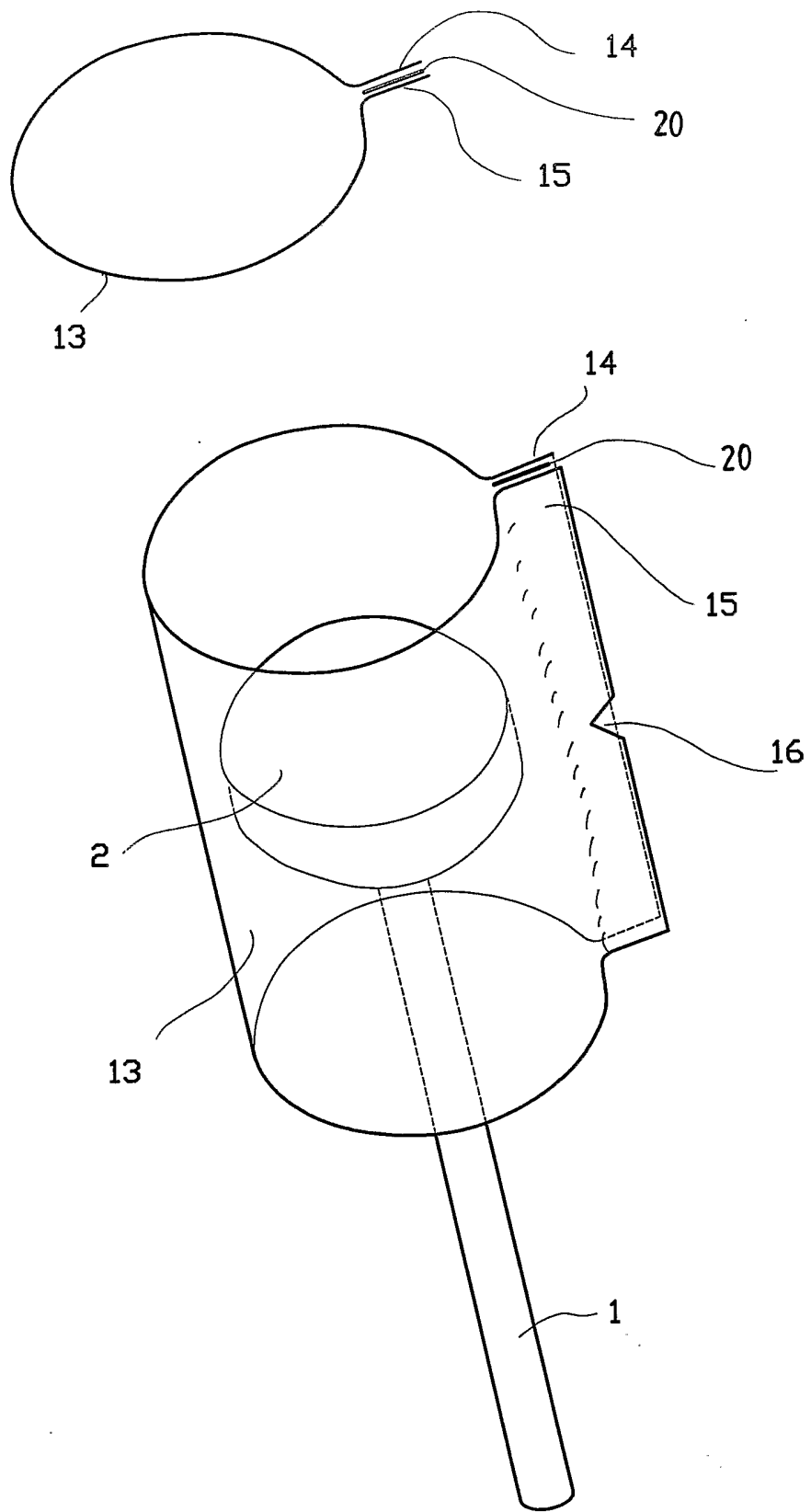

FIG. 2

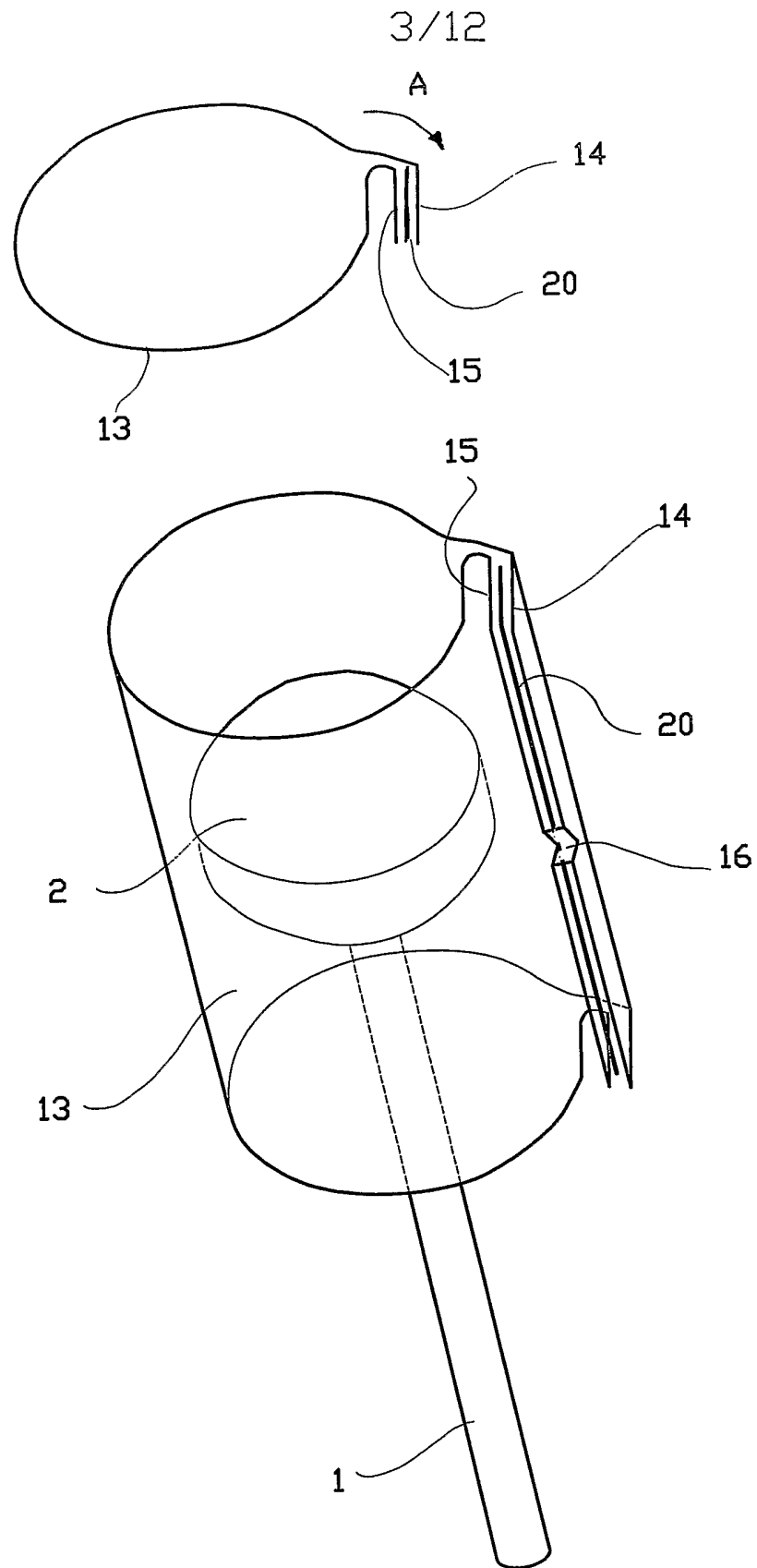

FIG. 3

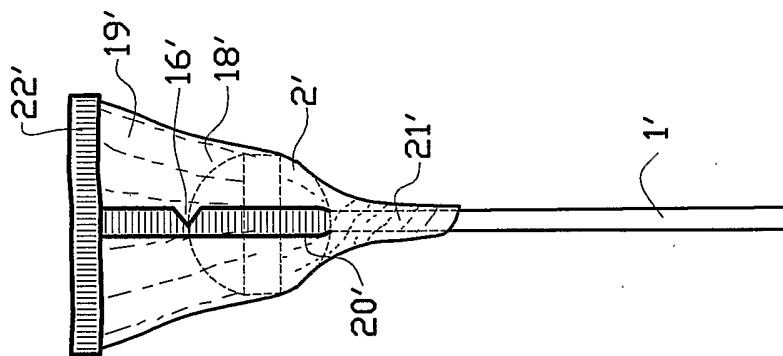

FIG. 4B

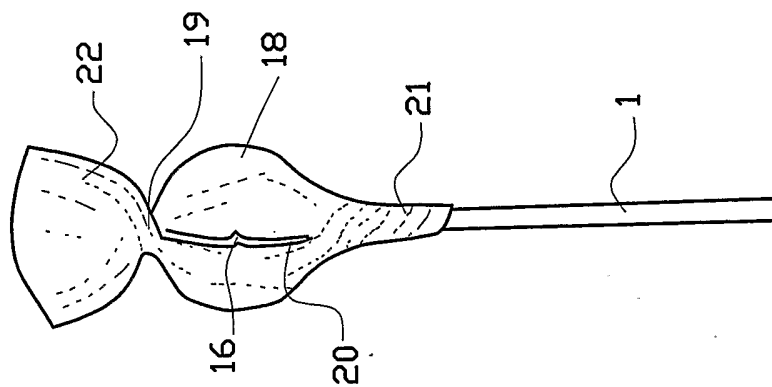

FIG. 4A

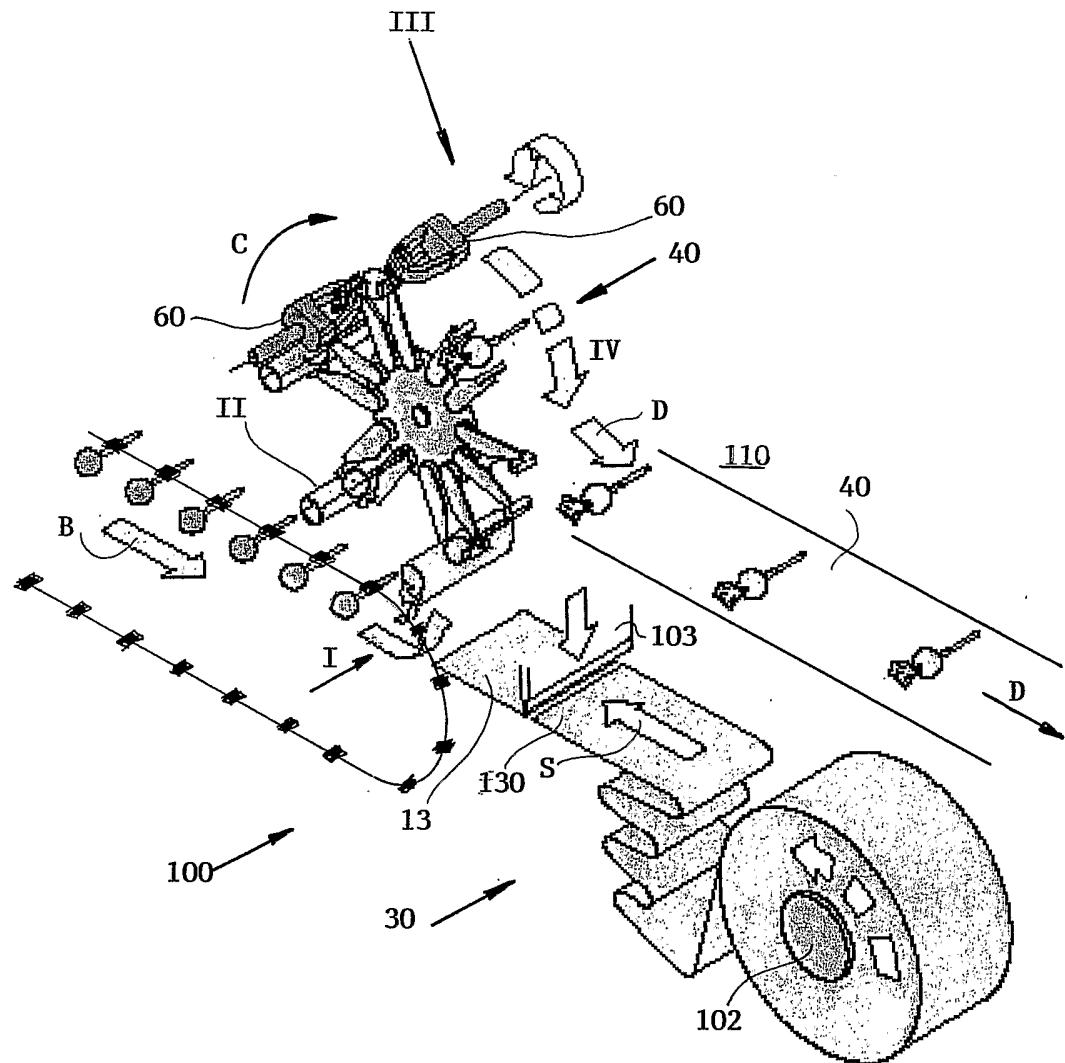

FIG. 5

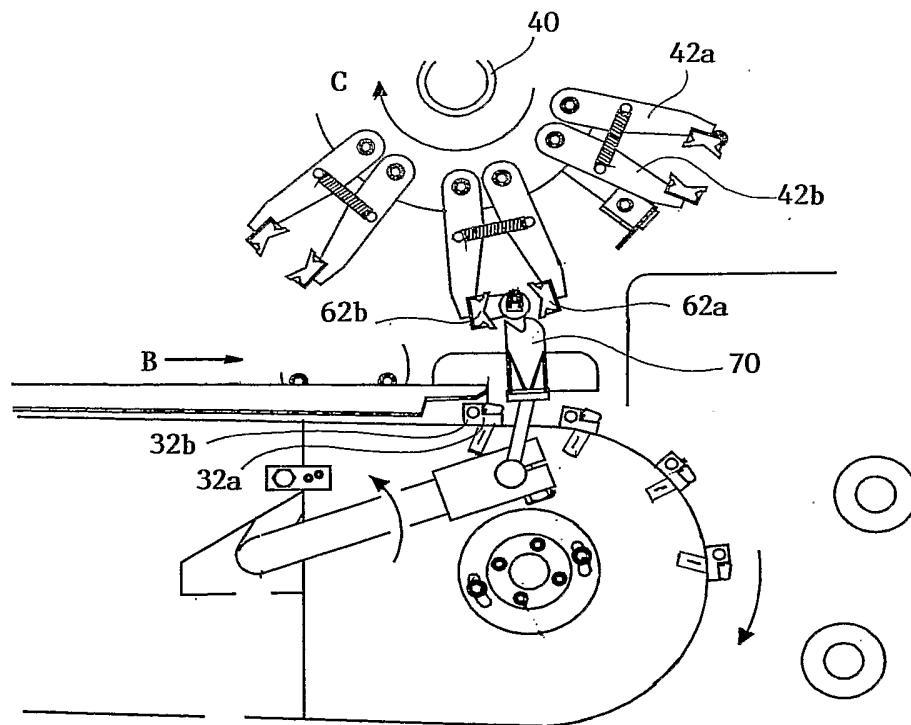

FIG. 5A

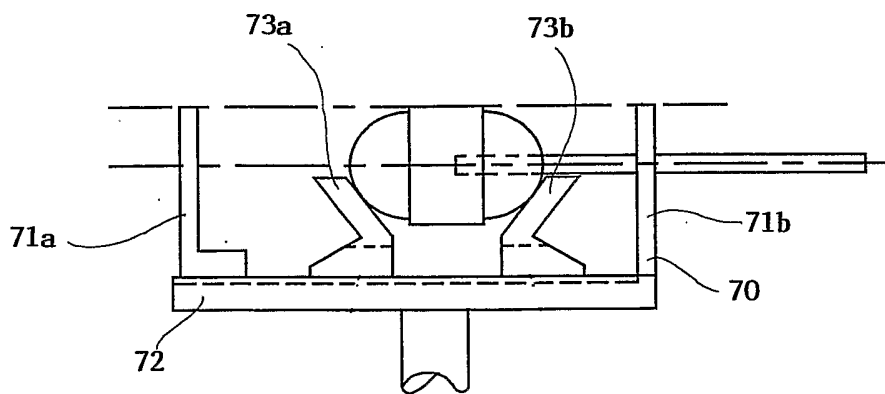

FIG. 5B

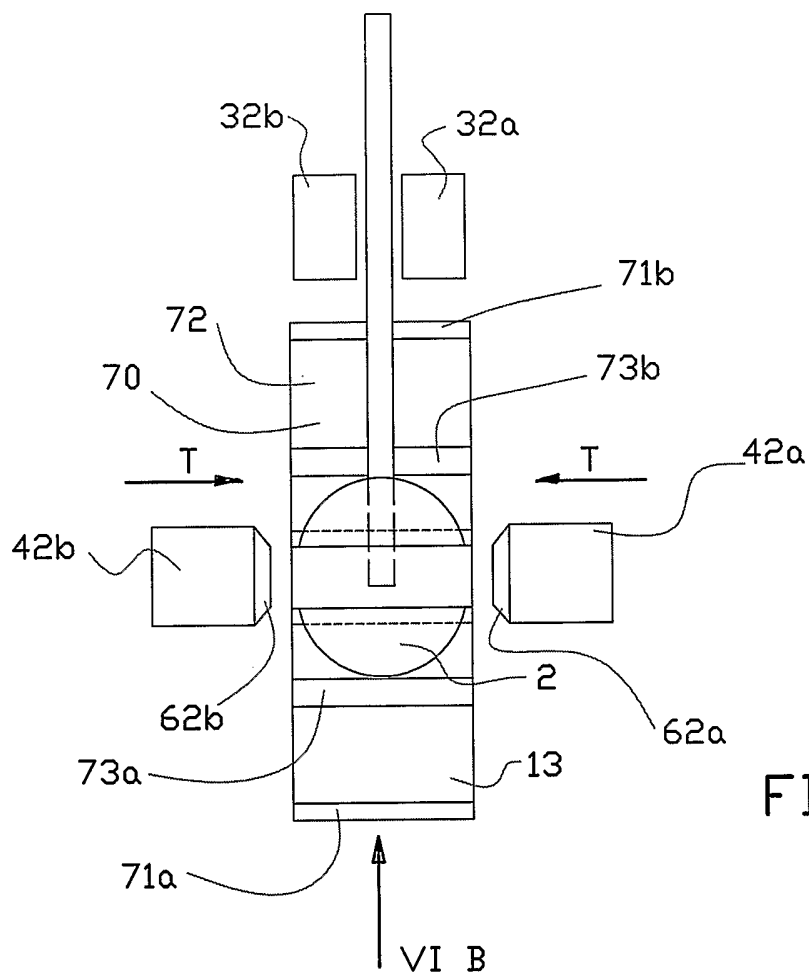

FIG. 6A

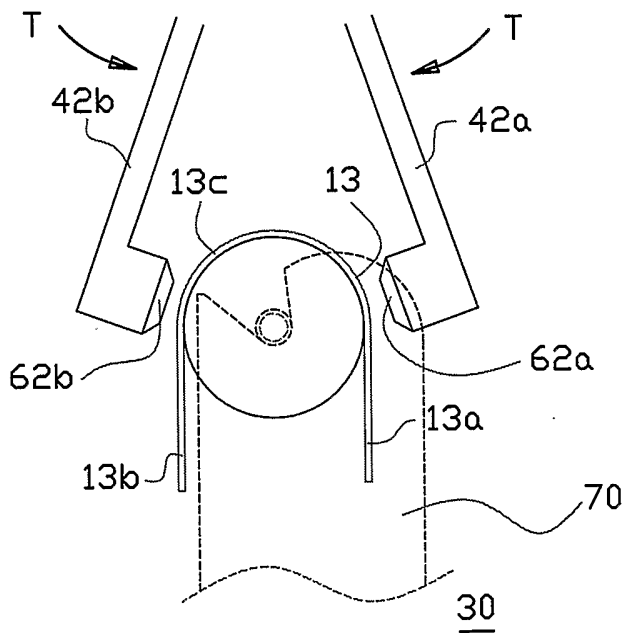

FIG. 6B

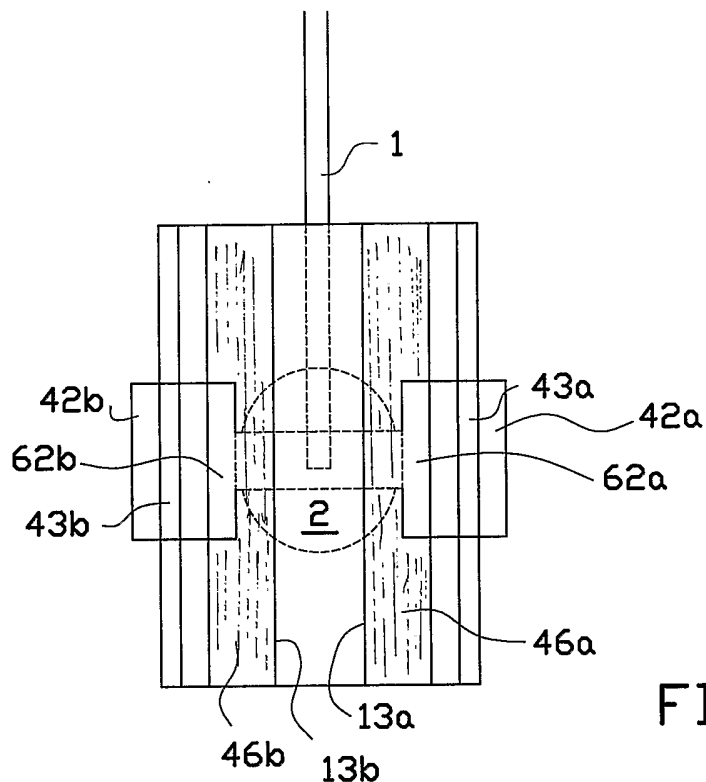

FIG. 7A

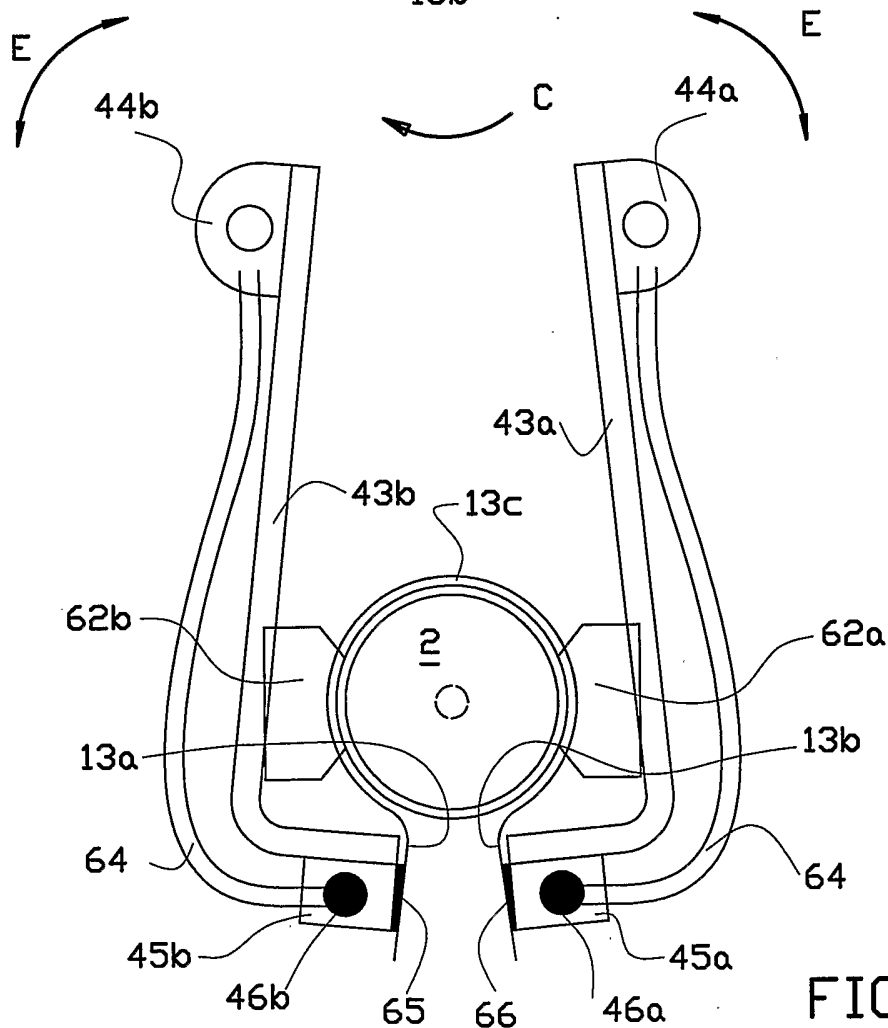

FIG. 7B

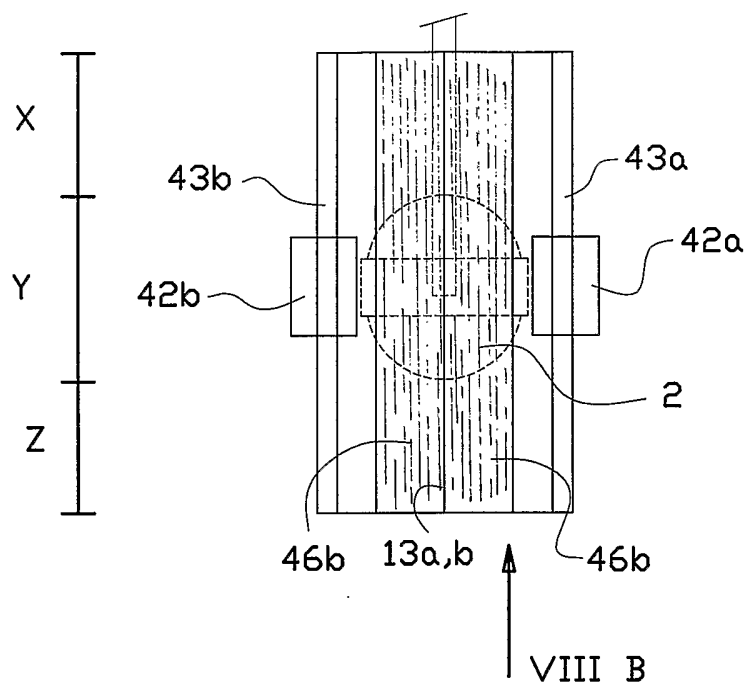

FIG. 8A

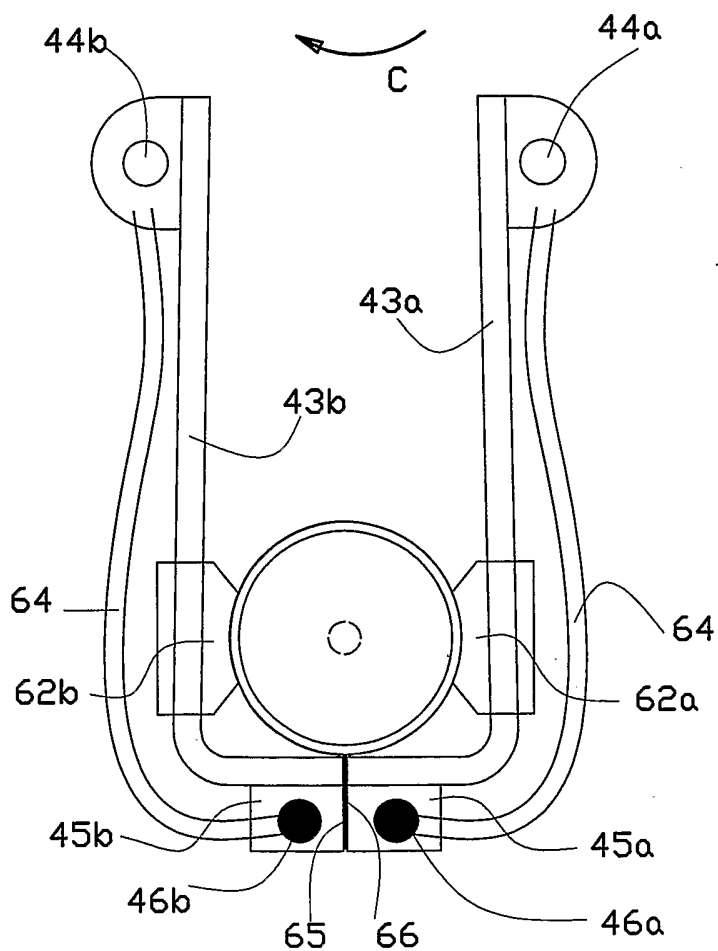

FIG. 8B



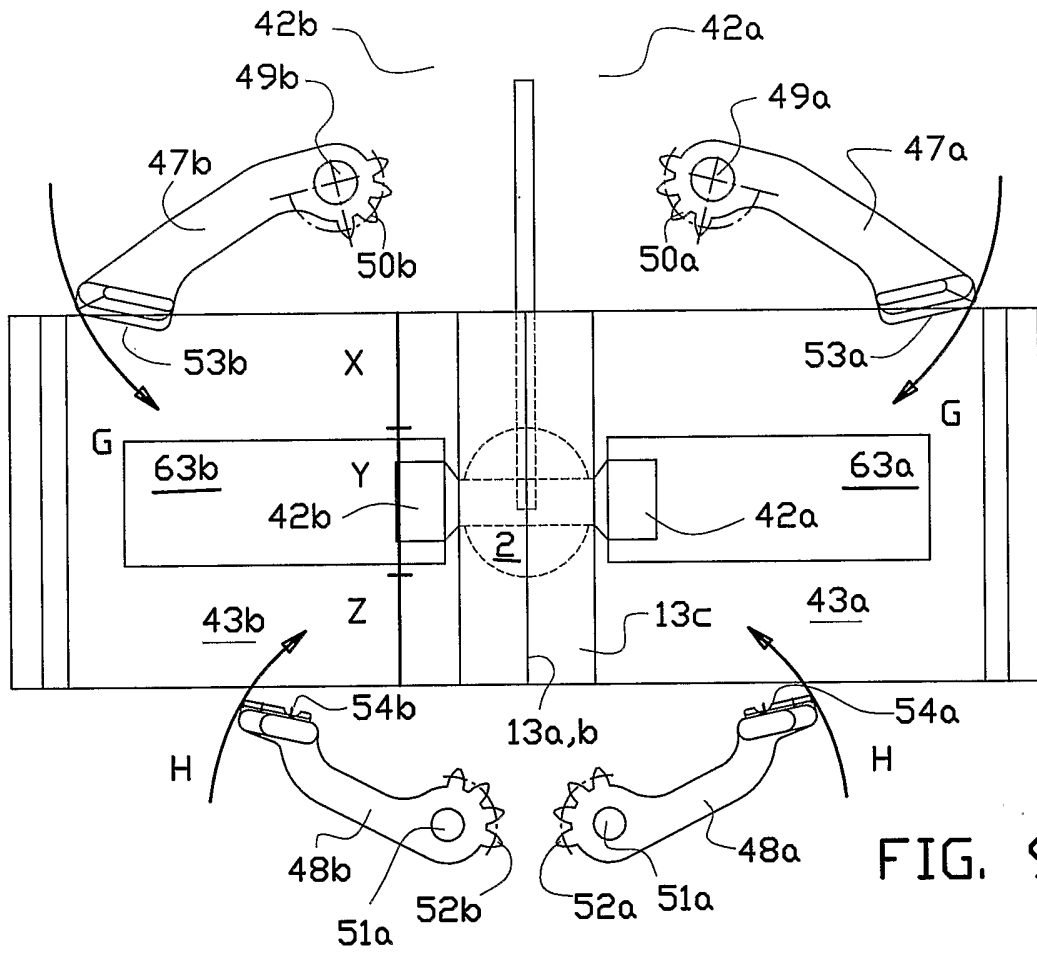

FIG. 9A

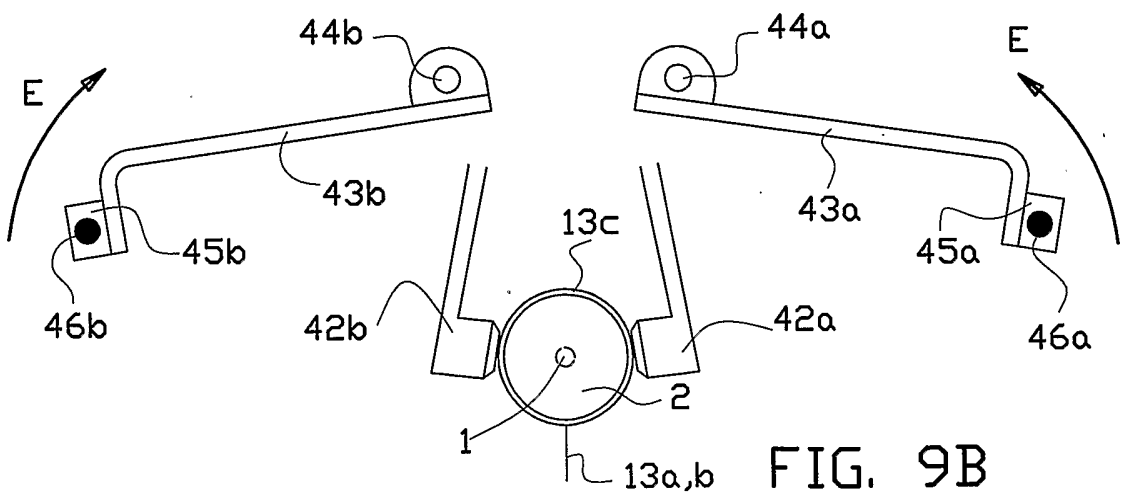
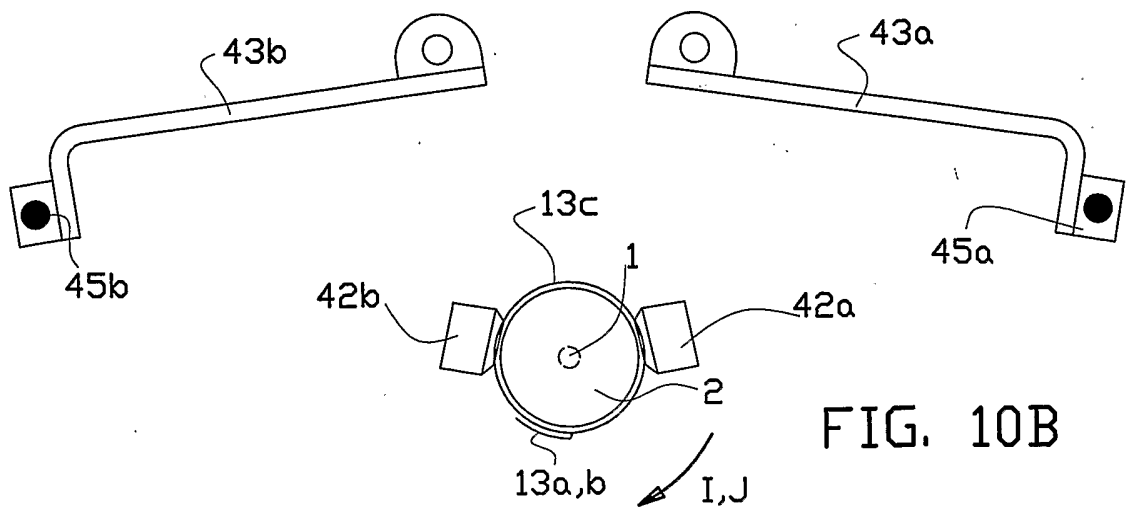
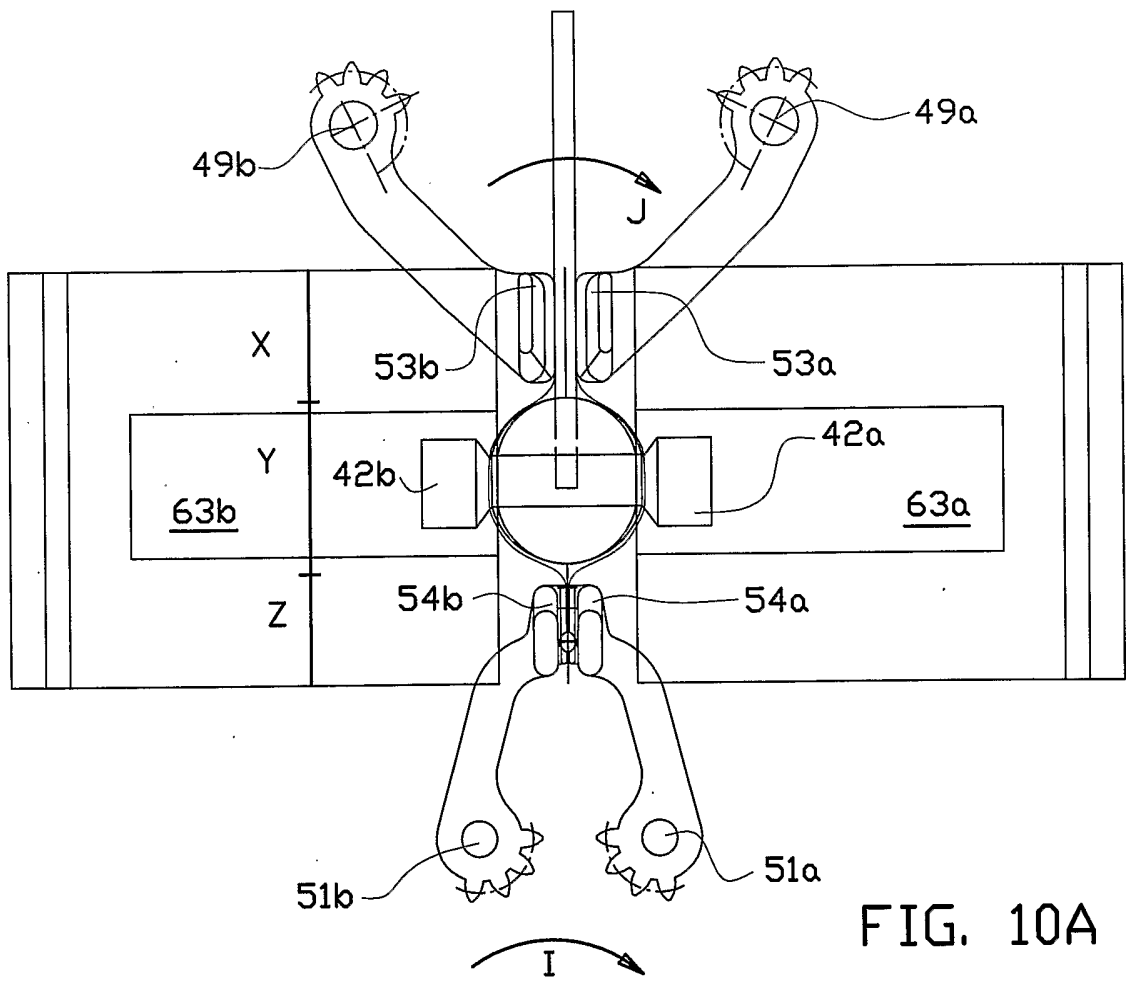

FIG. 9B



# INTERNATIONAL SEARCH REPORT

International Application No  
PCT/NL2005/000547

**A. CLASSIFICATION OF SUBJECT MATTER**  
IPC 7 B65D85/60 B65D75/10 B65D75/16 B65D75/58 B65B25/00

According to International Patent Classification (IPC) or to both national classification and IPC

**B. FIELDS SEARCHED**

Minimum documentation searched (classification system followed by classification symbols)  
IPC 7 B65D B65B

Documentation searched other than minimum documentation to the extent that such documents are included in the fields searched

Electronic data base consulted during the international search (name of data base and, where practical, search terms used)

EPO-Internal

**C. DOCUMENTS CONSIDERED TO BE RELEVANT**

Category °	Citation of document, with indication, where appropriate, of the relevant passages	Relevant to claim No.
X	GB 1 062 155 A (ROSE BROTHERS) 15 March 1967 (1967-03-15)	1,2,5, 7-9,11, 13,16, 18-20, 22,23, 27,28
Y	the whole document	3,4,6, 10,12, 14,15, 17,21, 24-26

Further documents are listed in the continuation of box C.

Patent family members are listed in annex.

° Special categories of cited documents :

- "A" document defining the general state of the art which is not considered to be of particular relevance
- "E" earlier document but published on or after the international filing date
- "L" document which may throw doubts on priority claim(s) or which is cited to establish the publication date of another citation or other special reason (as specified)
- "O" document referring to an oral disclosure, use, exhibition or other means
- "P" document published prior to the international filing date but later than the priority date claimed

- "T" later document published after the international filing date or priority date and not in conflict with the application but cited to understand the principle or theory underlying the invention
- "X" document of particular relevance; the claimed invention cannot be considered novel or cannot be considered to involve an inventive step when the document is taken alone
- "Y" document of particular relevance; the claimed invention cannot be considered to involve an inventive step when the document is combined with one or more other such documents, such combination being obvious to a person skilled in the art.
- "&" document member of the same patent family

Date of the actual completion of the international search

31 October 2005

Date of mailing of the international search report

11/11/2005

Name and mailing address of the ISA

European Patent Office, P.B. 5818 Patentlaan 2  
NL - 2280 HV Rijswijk  
Tel. (+31-70) 340-2040, Tx. 31 651 epo nl,  
Fax: (+31-70) 340-3016

Authorized officer

SERRANO GALARRAGA, J

INTERNATIONAL SEARCH REPORT

International Application No  
PCT/NL2005/000547

C.(Continuation) DOCUMENTS CONSIDERED TO BE RELEVANT		
Category °	Citation of document, with indication, where appropriate, of the relevant passages	Relevant to claim No.
Y	<p>WO 03/106267 A (A.C.M.A. S.P.A.) 24 December 2003 (2003-12-24)</p> <p>page 2, line 4 - line 30 page 7, line 10 - page 13, line 6; figures 1-7</p>	<p>3,4,6, 10,12, 14,15, 17,21, 24-26</p>
X	<p>US 6 374 583 B1 (DAELMANS) 23 April 2002 (2002-04-23)</p> <p>column 1, line 29 - line 44 column 4, line 7 - column 5, line 35; figures 1-6</p>	<p>1-3,5,6, 8,9, 11-13,15</p>
X	<p>US 5 935 686 A (DAELMANS) 10 August 1999 (1999-08-10)</p> <p>column 1, line 13 - line 45 column 6, line 5 - column 7, line 12; figures 5-11</p>	<p>1-3,5,6, 8,9,11, 15</p>
A	<p>US 5 241 807 A (QUICK ET AL) 7 September 1993 (1993-09-07) column 2, line 61 - column 3, line 17</p>	<p>19,27</p>
A	<p>EP 1 188 672 A (MARS) 20 March 2002 (2002-03-20)</p>	
A	<p>GB 684 363 A (ROSE BROTHERS) 17 December 1952 (1952-12-17)</p>	
A	<p>EP 1 080 877 A (ALUSUISSE) 7 March 2001 (2001-03-07)</p>	
A	<p>EP 0 018 701 A (AQUARIUS, COENRARDUS HUBERTUS) 12 November 1980 (1980-11-12)</p>	

# INTERNATIONAL SEARCH REPORT

International application No.  
PCT/NL2005/000547

## Box II Observations where certain claims were found unsearchable (Continuation of item 2 of first sheet)

This International Search Report has not been established in respect of certain claims under Article 17(2)(a) for the following reasons:

1.  Claims Nos.:  
because they relate to subject matter not required to be searched by this Authority, namely:
  
2.  Claims Nos.: 29-31  
because they relate to parts of the International Application that do not comply with the prescribed requirements to such an extent that no meaningful International Search can be carried out, specifically:  
see FURTHER INFORMATION sheet PCT/ISA/210
  
3.  Claims Nos.:  
because they are dependent claims and are not drafted in accordance with the second and third sentences of Rule 6.4(a).

## Box III Observations where unity of invention is lacking (Continuation of item 3 of first sheet)

This International Searching Authority found multiple inventions in this international application, as follows:

1.  As all required additional search fees were timely paid by the applicant, this International Search Report covers all searchable claims.
  
2.  As all searchable claims could be searched without effort justifying an additional fee, this Authority did not invite payment of any additional fee.
  
3.  As only some of the required additional search fees were timely paid by the applicant, this International Search Report covers only those claims for which fees were paid, specifically claims Nos.:
  
4.  No required additional search fees were timely paid by the applicant. Consequently, this International Search Report is restricted to the invention first mentioned in the claims; it is covered by claims Nos.:

### Remark on Protest

- The additional search fees were accompanied by the applicant's protest.
- No protest accompanied the payment of additional search fees.

## FURTHER INFORMATION CONTINUED FROM PCT/ISA/ 210

Continuation of Box II.2

Claims Nos.: 29-31

Rule 6.2a (PCT)

The applicant's attention is drawn to the fact that claims relating to inventions in respect of which no international search report has been established need not be the subject of an international preliminary examination (Rule 66.1(e) PCT). The applicant is advised that the EPO policy when acting as an International Preliminary Examining Authority is normally not to carry out a preliminary examination on matter which has not been searched. This is the case irrespective of whether or not the claims are amended following receipt of the search report or during any Chapter II procedure. If the application proceeds into the regional phase before the EPO, the applicant is reminded that a search may be carried out during examination before the EPO (see EPO Guideline C-VI, 8.5), should the problems which led to the Article 17(2) declaration be overcome.

# INTERNATIONAL SEARCH REPORT

Information on patent family members

International Application No

PCT/NL2005/000547

Patent document cited in search report	Publication date	Patent family member(s)	Publication date
GB 1062155	A	15-03-1967	NONE
WO 03106267	A	24-12-2003	AU 2003239269 A1 31-12-2003 BR 0311406 A 29-03-2005 EP 1515892 A1 23-03-2005 IT B020020390 A1 18-12-2003 US 2005155329 A1 21-07-2005
US 6374583	B1	23-04-2002	AP 1143 A 05-05-2003 AU 726474 B2 09-11-2000 AU 4705597 A 05-05-1998 BG 63495 B1 29-03-2002 BG 103313 A 30-11-1999 BR 9712218 A 31-08-1999 CA 2267792 A1 16-04-1998 CN 1237138 A 01-12-1999 CZ 9901216 A3 16-08-2000 DE 837010 T1 22-10-1998 EE 9900141 A 15-12-1999 WO 9815470 A1 16-04-1998 EP 0837010 A1 22-04-1998 ES 2116249 T1 16-07-1998 HK 1023325 A1 02-07-2004 HU 9904644 A2 28-05-2000 ID 18083 A 26-02-1998 IL 129340 A 26-08-2001 JP 2001501562 T 06-02-2001 KR 2000048989 A 25-07-2000 NO 991639 A 07-04-1999 NZ 335664 A 23-06-2000 OA 11111 A 04-04-2003 PL 332580 A1 27-09-1999 RU 2179946 C2 27-02-2002 SK 45099 A3 13-03-2000 TR 9900787 T2 23-08-1999 ZA 9708774 A 17-04-1998
US 5935686	A	10-08-1999	AT 190287 T 15-03-2000 AU 704044 B2 15-04-1999 AU 7288396 A 28-07-1997 BE 1009877 A3 07-10-1997 BR 9608171 A 09-02-1999 CA 2227735 A1 10-07-1997 CN 1189137 A 29-07-1998 CZ 289226 B6 12-12-2001 CZ 9800055 A3 16-06-1999 DE 69607044 D1 13-04-2000 DE 69607044 T2 12-10-2000 DK 929467 T3 31-07-2000 EE 9700307 A 15-06-1998 WO 9724273 A1 10-07-1997 EP 0929467 A1 21-07-1999 ES 2143234 T3 01-05-2000 GR 3033520 T3 29-09-2000 HK 1017872 A1 08-03-2002 HU 9900140 A2 28-04-1999 JP 2001515436 T 18-09-2001 NO 975926 A 10-02-1998

# INTERNATIONAL SEARCH REPORT

Information on patent family members

International Application No

PCT/NL2005/000547

Patent document cited in search report	A	Publication date	Patent family member(s)	Publication date
US 5935686	A		NZ 320186 A PL 323588 A1 PT 929467 T RU 2136560 C1 SK 9898 A3 TR 9701724 T1 ZA 9610893 A	28-10-1998 14-04-1998 30-06-2000 10-09-1999 06-05-1998 21-05-1998 27-06-1997
US 5241807	A	07-09-1993	NONE	
EP 1188672	A	20-03-2002	AU 9440301 A CA 2422757 A1 CN 1458896 A DE 60107591 D1 JP 2004509021 T WO 0222445 A1 US 2004037927 A1	26-03-2002 21-03-2002 26-11-2003 05-01-2005 25-03-2004 21-03-2002 26-02-2004
GB 684363	A	17-12-1952	NONE	
EP 1080877	A	07-03-2001	ES 1046645 U1 IT MI991864 A1 MX PA00003653 A	16-01-2001 05-03-2001 08-03-2002
EP 0018701	A	12-11-1980	NL 7905691 A	11-11-1980