

12 **EUROPEAN PATENT APPLICATION**

21 Application number: 86201683.9

51 Int. Cl.4: **H04M 1/02**

22 Date of filing: 30.09.86

30 Priority: 09.10.85 GB 8524843

43 Date of publication of application:
15.04.87 Bulletin 87/16

64 Designated Contracting States:
BE DE FR GB IT SE

71 Applicant: **PHILIPS ELECTRONIC AND ASSOCIATED INDUSTRIES LIMITED**
Arundel Great Court 8 Arundel Street
London WC2R 3DT(GB) GB
Applicant: **N.V. Philips' Gloeilampenfabrieken**
Groenewoudseweg 1
NL-5621 BA Eindhoven(NL) BEDEFRITSE

72 Inventor: **Coatman, Michael Charles**
c/o TMC LTD. Swinson Road
Malmesbury Wiltshire(GB)

74 Representative: **Andrews, Arthur Stanley et al**
Phillips Electronic and Associated Industries
Limited Patent Department Mullard House
Torrington Place
London WC1E 7HD(GB)

64 **Telephone Instrument.**

67 A telephone instrument has a housing constructed from a first section (1) and a second section (2), the first (1) and second (2) section being connected together to form a housing. The second section (2) comprises three identical first sub-sections (4,5,6) which are substantially rectangular in plan. The number of first sub-sections is dependent on the dimensions of the first section (1) which is formed in one piece. The first sub-sections (4,5,6) comprise a first part defining a regular array of apertures (22, Figure 2) suitable for locating an array of pushbuttons (8). The array of apertures (22) extends across the full width of the rectangle so that when two or more sub-sections are butted together a continuous regular array of apertures extends across the arrangement of first sub-sections. A cover plate (9) covers locations in which no pushbutton is provided, the cover plate being located by the apertures (22).

The first sub-sections also comprise a second part defining a single aperture (14) which extends over a major portion of the second part. A further sub-assembly (11) is mounted in the aperture (14) in the second part of one or more first sub-sections.

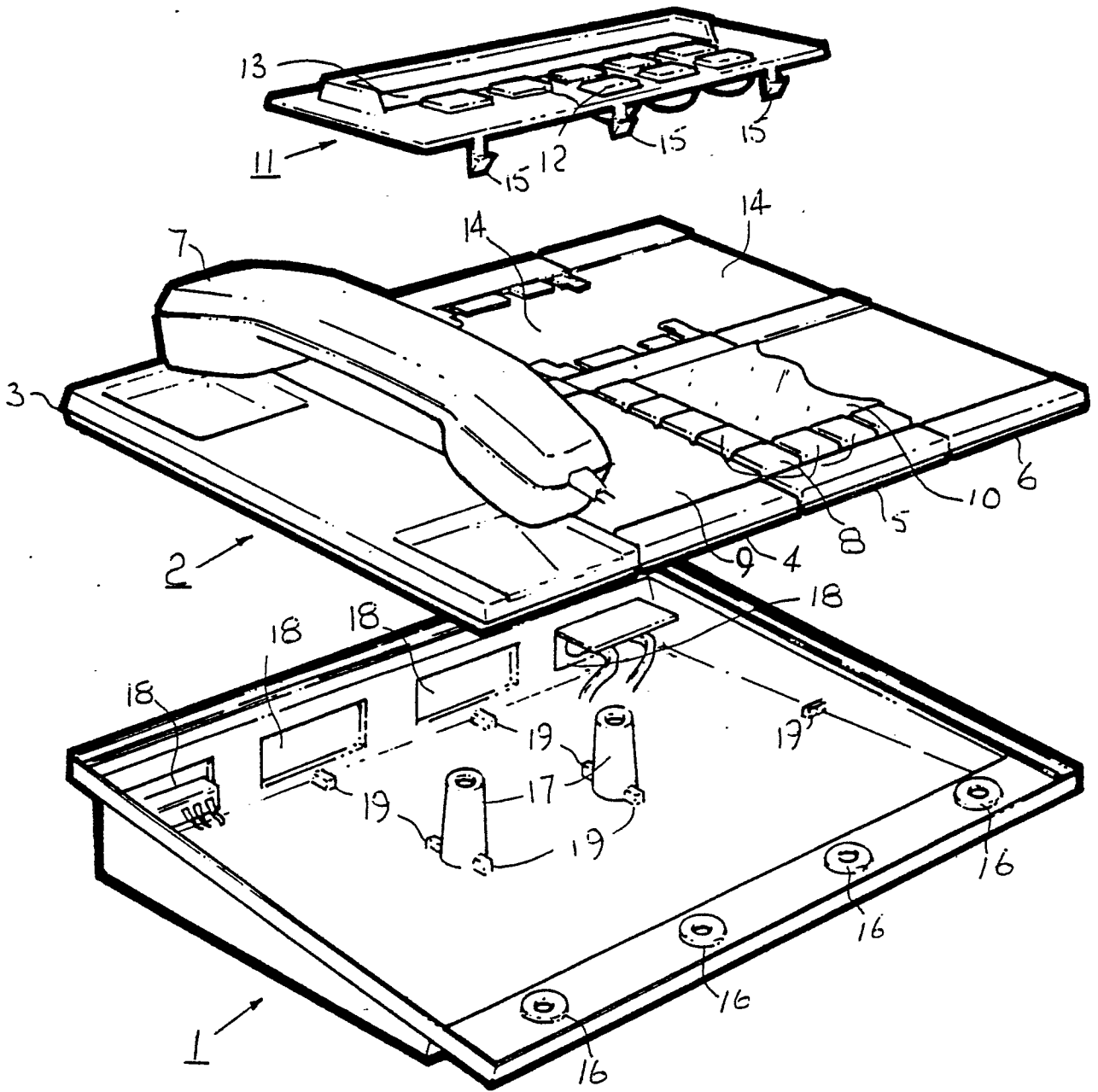

FIG. 1.

TELEPHONE INSTRUMENT

The invention relates to a telephone instrument having a housing constructed from a first section and a second section, the first and second sections being connected together to form a housing. The invention also relates to a sub-section for use in a telephone instrument.

Telephone instruments are commonly constructed from a base section and a top section (base and top referring to a table top rather than wall mounted instrument). Typically the base section has items such as a tone caller mounted within it and the top section carries push buttons and perhaps a visual display and supports the handset.

There is a trend towards adding further facilities to telephone instruments, such as visual displays, repertory diallers, loudspeaking or "hands free" operation, and data transmission. Thus a family of instruments which may have a selection of these facilities may be required. This brings the problem of how to allow for the different facilities to be provided in the most economic fashion. Clearly the different instruments will require different sized housings, dependent on the number and type of facilities provided. Since the housings of the instruments are normally plastics mouldings a variety of different mouldings are required. This greatly increases the tooling costs for a range of instruments, particularly since the various options offered tends to reduce the quantity of any individual instrument type required.

It is an object of the invention to enable the provision of a range of telephone instruments without unduly increasing the number of different mouldings required to form their housings.

The invention provides a telephone instrument as set forth in the opening paragraph characterised in that the second section comprises a plurality of identical moulded sub-sections, the number of sub-sections being dependent on the dimensions of the first section which is formed as a single moulding.

This enables the use of a reduced number of different mouldings with a consequent reduction in tooling costs. The first section is typically a base section of the telephone instrument and is less complex in form than the second section. Hence although a different base moulding is required for each size of instrument the tooling required is not so expensive.

The sub-sections may comprise a first part defining a matrix of apertures suitable for locating a regular array of pushbuttons and a second part defining a single aperture which extends over a major portion of the second part.

An array of pushbuttons may be located in the apertures of the first part, the buttons of the pushbuttons being so dimensioned that adjacent buttons cover the area between adjacent apertures with only a clearance sufficient to allow individual pushbuttons to be operated.

This enables the top face of the instrument to present an appearance showing a complete block of buttons and if a pushbutton is not required in any position the appearance can be maintained merely by mounting a dummy button in that position.

A cover plate may cover locations in which no pushbutton is provided, the cover plate being located by the apertures.

Where a block of pushbuttons are not required a cover plate can be located by the apertures to give a finished decorative appearance to the telephone instrument.

The sub-sections may be mounted on a single printed circuit board. The printed circuit board provides, for example conductive tracks for a rubber mat keypad, key decoding circuitry and driving circuits for display devices. The sub-sections may be snap fitted on the printed circuit board by means of barbs on the sub-section engaging with apertures provided in the printed circuit board. This provides a structure which is sufficiently rigid for assembly and maintenance operations. In the embodiments described hereinafter further printed circuit boards for telephone and/or data facilities may be located in the base section.

A further sub-assembly may be mounted in the aperture in the second part of one or more sub-sections, which sub-assembly may be a snap fit in the aperture(s). The sub-assembly may carry further pushbuttons and/or one or more display devices.

The second section may comprise a further sub-section formed to locate a telephone handset. Such a sub-section may be used on a whole range of telephone instruments since most telephone instruments require a handset.

The sub-sections may be connected to the first section by means of screws to enable the two sections to be easily separated for maintenance.

The invention further provides a sub-section for a telephone instrument comprising a first part defining a matrix of apertures suitable for locating an array of pushbuttons and a second part defining a single aperture which extends over a major portion of the second part.

The invention still further provides a telephone instrument including a sub-section as set forth in the preceding paragraph.

Embodiments of the invention will now be described, by way of example, with reference to the accompanying drawings, in which:-

Figure 1 shows an exploded, perspective view of a telephone instrument according to the invention,

Figure 2 shows a plan view of a sub-section for a telephone instrument according to the invention,

Figure 3 is a cross-sectional elevation of the sub-section shown in Figure 2 the section being taken on line A-A,

Figure 4 is a plan view of an embodiment of a telephone instruments similar to that shown in Figure 1,

Figure 5 is a plan view of a further embodiment of a telephone instrument according to the invention, and

Figure 6 shows a handset sub-section suitable for use in a telephone instrument as shown in Figures 1, 4 or 5.

Figure 1 shows an exploded perspective view of a telephone instrument according to the invention, the telephone instrument having a housing comprising a first section 1 in the form of a base section and a second section 2 in the form of a top section. The top section 2 is constructed from four sub-sections 3,4,5 and 6, sub-sections 4,5 and 6 being identical to each other and sub-section 3 being designed to locate a handset 7. The sub-sections 4,5 and 6 are shown in greater detail in Figures 2 and 3 and will be further described hereinafter. Depending on the facilities to be provided by the telephone instrument a greater or lesser number of the sub-sections 4, 5 and 6 are provided while only one sub-section 3 per instrument is used. It is, alternatively, possible to dispense with the sub-section 3 and mount the handset 7 on a hook switch projecting from the side of the base section 1.

The sub-sections 4, 5 and 6 carry a selected arrangement of pushbuttons 8, and plates 9 and 10 which may be blank or may be provided with legends. A further sub-assembly 11 carrying pushbuttons 12 and a display device 13 is mountable into apertures 14 in the sub-sections 4,5 and 6 by means of bars 15.

The rear of the base section 1 is provided with a plurality of cut outs 18 through which cable entry may be effected. The cut outs may mount plugs and sockets or be covered by blanking plates depending on cable entry requirements. Telephone and data circuits and components may be mounted on printed circuit boards located by projections 19.

Figure 2 shows a plan view of a sub-section 20 suitable for use as the sub-sections 4,5 and 6 of Figure 1. The sub-section 20 comprises a first part 21 defining a matrix of apertures 22 for locating an

array of pushbuttons 23. In this instance the matrix of apertures 22 comprises four columns and five rows. These numbers are arbitrary and may be changed depending on the application. As shown in Figure 2 the pushbuttons 23 are arranged to have a minimum spacing so that there is merely sufficient clearance between them to allow independent operation. When pushbuttons are not required in every position in the matrix of apertures cover plates 25, 26 are fitted to mask the apertures 22 and provide a finished surface to the top of the telephone instrument. The cover plates may be blank or may carry legends which may be produced in any convenient fashion, for example printing or engraving.

The first part 21 and a second part 31 are separated by a bar 26 and two further bars 27 and 28 are formed at each end of the sub-section and define the extents of the first part 21 and second part 31. The first part 21 is also provided with a number of display devices 30 which are located next to pushbuttons adjacent to the bars 26 and 27.

The second part 31 of the sub-section 20 defines an aperture 32 which extends over a major portion of the second part 31. The aperture 32 is provided with four projections 33 for co-operation with spring barbs to locate a cover plate or additional sub-assembly in the aperture 32.

Figure 3 is a cross-sectional view of the sub-section on line A-A of Figure 2. The sub-section 20 is mounted on a printed circuit board 40 by means of barbs 41 which project through co-operating apertures (not shown) in the printed circuit board 40. The pushbutton tops 23 are located in the apertures 22 by means of plugs 42 which are a friction fit within the hollow stem 43 of the pushbutton tops 23 and which engage against shoulders 44 of the apertures 22 to prevent the pushbutton tops 23 being displaced from the apertures. The printed circuit board 40 is shown broken in the region of the plug 42 merely to enable the fitting of the pushbuttons to be clearly indicated and in practice the printed circuit board extends continuously. The plug 42 is biased against the shoulder 44 by means of an elastomeric dome 45 which includes a conductive pill which short circuits tracks on the printed circuit board when the pushbutton is depressed. Only one dome is shown for reasons of clarity but all operative pushbuttons are provided with such domes. The cover plate 24 is located by means of bars 45 which engage behind the shoulders 44 of appropriate apertures 22. The cover plate 25 is, of course, located in the same manner.

The display devices 30 comprise a surface mounted light emitting diode 46 and a light guide 47, for example a perspex rod, which is in contact with the light emitting surface of the diode 46 at one end and whose other end provides the visual display at the top surface of the instrument.

The sub-section 20 is attached to the first or base section 1 by means of screws passing through bosses 16 and pillars 17 (Figure 1) in the base section into threaded inserts (not shown) located in the bars 26 and 27 of the sub-sections 20. Various additional or alternative methods of connecting the base and top sections would be readily apparent to those skilled in the art. For example horizontally extending lugs could be formed on the bar 28 which engage in slots provided in the rear of the base section. Alternatively adhesives could be used, particularly with simple instruments where a replacement rather than repair philosophy was employed.

Figure 4 shows a plan view of a telephone instrument similar to that shown in Figure 1. The telephone instrument shown in Figure 4 comprises a handset 107 mounted in a handset sub-section 103 and three identical sub-sections 104, 105 and 106 which carry a plurality of pushbuttons 108, a cover plate 110 having spaces 120 for writing addresses for repertory dialling or call transfer and indicator devices 121 for indicating the address operated by a pushbutton depression or of a received call, a blank cover plate 122, and a further sub-assembly 111 carrying further pushbuttons 112 and a display unit 113.

Figure 5 shows a plan view of a telephone instrument having fewer facilities than that shown in Figure 4. The instrument shown in Figure 5 comprises a handset section 203 carrying a handset 207 and two identical sub-sections 204 and 205. The first sub-section 4 carries an array of pushbuttons 208 while the second sub-section carries a number of pushbuttons 208, a cover plate 210 which has spaces for addresses 220 and indicators 221 and a plain spacer 222.

Figure 6 shows a plan view of a handset sub-section suitable for use in the telephone instruments shown in Figures 1, 4 and 5. The handset sub-section 303 comprises a rectangular plate 304 provided with two recesses 305 and 306. The recesses 305 and 306 are spaced and dimensioned to receive the mouth and ear pieces of the telephone handset. The instruments shown are designed for desk top mounting and the handset is kept in position by gravity. However, if wall mounting was desired with the handset lying substantially vertically rather than horizontally this could be achieved by appropriate design of the shape of the

mouth or ear piece and the recesses. The recess 305 is provided with an aperture 307 through which the hook switch projects so that it can be operated by replacing the handset on the sub-section.

A basic telephone can be provided by using a handset sub-section 303 and a sub-section 20 as shown in Figure 2. In this case only ten pushbuttons are required, though there is space for more and some additional facilities may be offered, for example for plan sets. The aperture 32 may then be covered by a plain cover plate which may carry a label holder for indicating the telephone number or any other information. An alternative arrangement providing a basic telephone instrument could use a sub-section 20 to form the complete top section with the handset being carried on a cradle or platform projecting from the side of the base unit.

Clearly many alternative arrangements using the sub-section shown in Figures 2 and 3 can be constructed, the layout of the cover plates and pushbuttons being variable to give a desired aesthetic effect and to provide access to the facilities provided. Thus by using a sub-section provided with a regular array of apertures for locating pushbuttons and by arranging the buttons of adjacent pushbuttons to cover the area between the adjacent apertures a finished appearance can be given to a telephone instrument while allowing many different options to be offered using the same top sub-section. Clearly where single isolated pushbuttons are not required for a particular instrument the cover plate for that location could be constructed to have the same appearance as a pushbutton top.

Claims

1. A telephone instrument having a housing constructed from a first injection moulded plastics section and a second injection moulded plastics section, the first and second section being connected together to form a housing, characterised in that the second section comprises a plurality of identical sub-sections, the number of sub-sections being dependent on the dimensions of the first section which is formed in one piece.

2. A telephone instrument as claimed in Claim 1, characterised in that the sub-sections comprise a first part defining a matrix of apertures suitable for locating an array of pushbuttons and a second part defining a single aperture which extends over a major portion of the second part.

3. A telephone instrument as claimed in Claim 2, characterised in that an array of pushbuttons is located in the apertures of the first part, the heads of the pushbuttons being so dimensioned that adja-

cent pushbutton heads cover the area between adjacent apertures with only a clearance sufficient to allow individual pushbuttons to be operated.

4. A telephone instrument as claimed in Claim 2 or Claim 3, characterised in that a cover plate covers locations in which no pushbutton is provided, the cover plate being located by the apertures.

5. A telephone instrument as claimed in any preceding claim, characterised in that the sub-sections are mounted on a single printed circuit board.

6. A telephone instrument as claimed in any preceding claim when dependent on Claim 2, characterised in that a further sub-assembly is mounted in the aperture in the second part of one or more sub-sections.

7. A telephone instrument as claimed in Claim 6, characterised in that the sub-assembly is a snap fit in the aperture(s).

8. A telephone instrument as claimed in any preceding claim, characterised in that the second section additionally comprises a sub-section formed to locate a telephone handset.

9. A telephone instrument as claimed in any preceding claim, characterised in that the sub-sections are connected to the first section by means of screws.

10. A sub-section for a telephone instrument characterised in that the sub-section comprises a first part defining a matrix of apertures suitable for locating an array of pushbuttons and a second part defining a single aperture which extends over a major portion of the second part.

11. A telephone instrument including a sub-section as claimed in Claim 10.

5

10

15

20

25

30

35

40

45

50

55

5

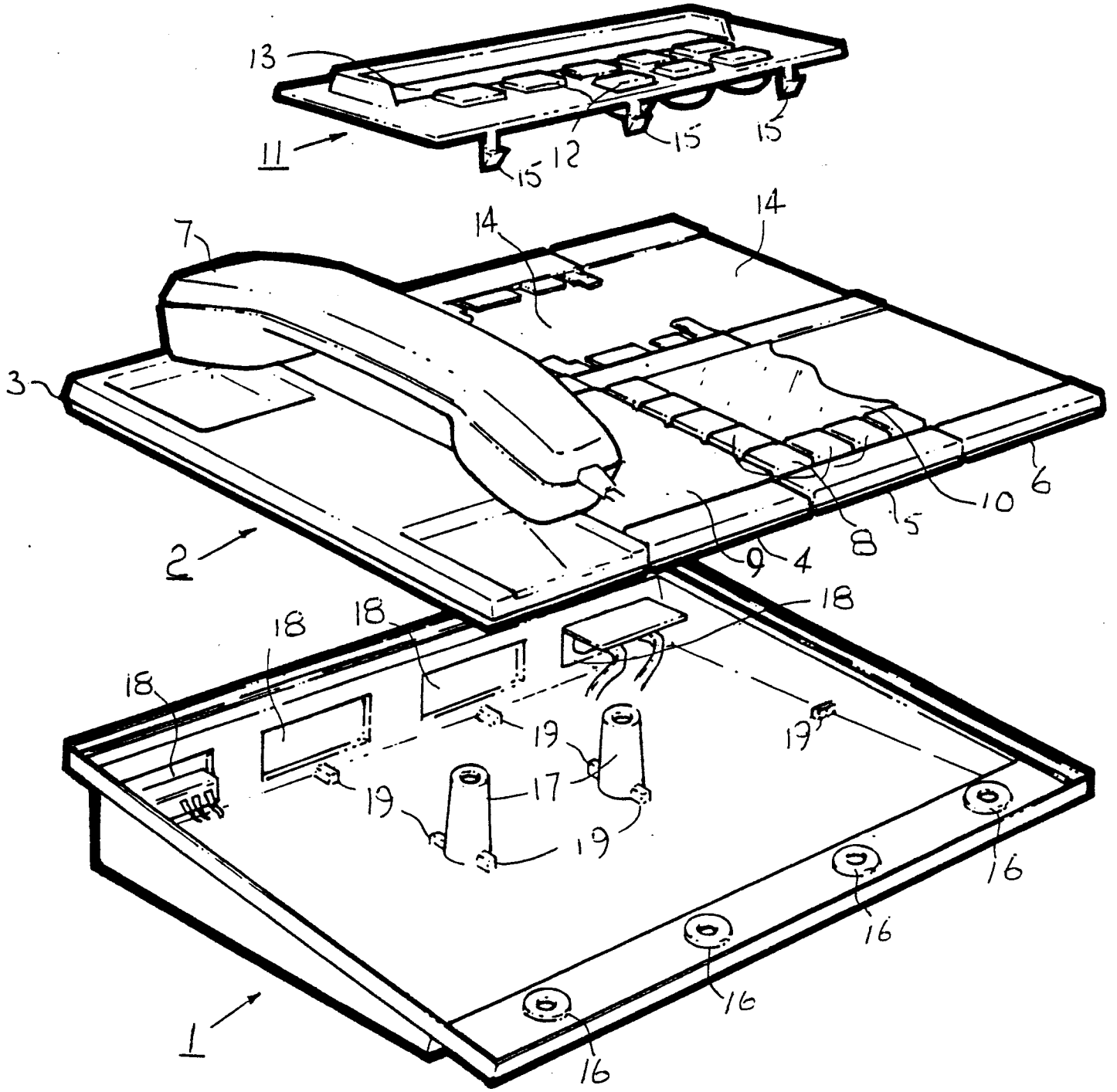

FIG. 1.

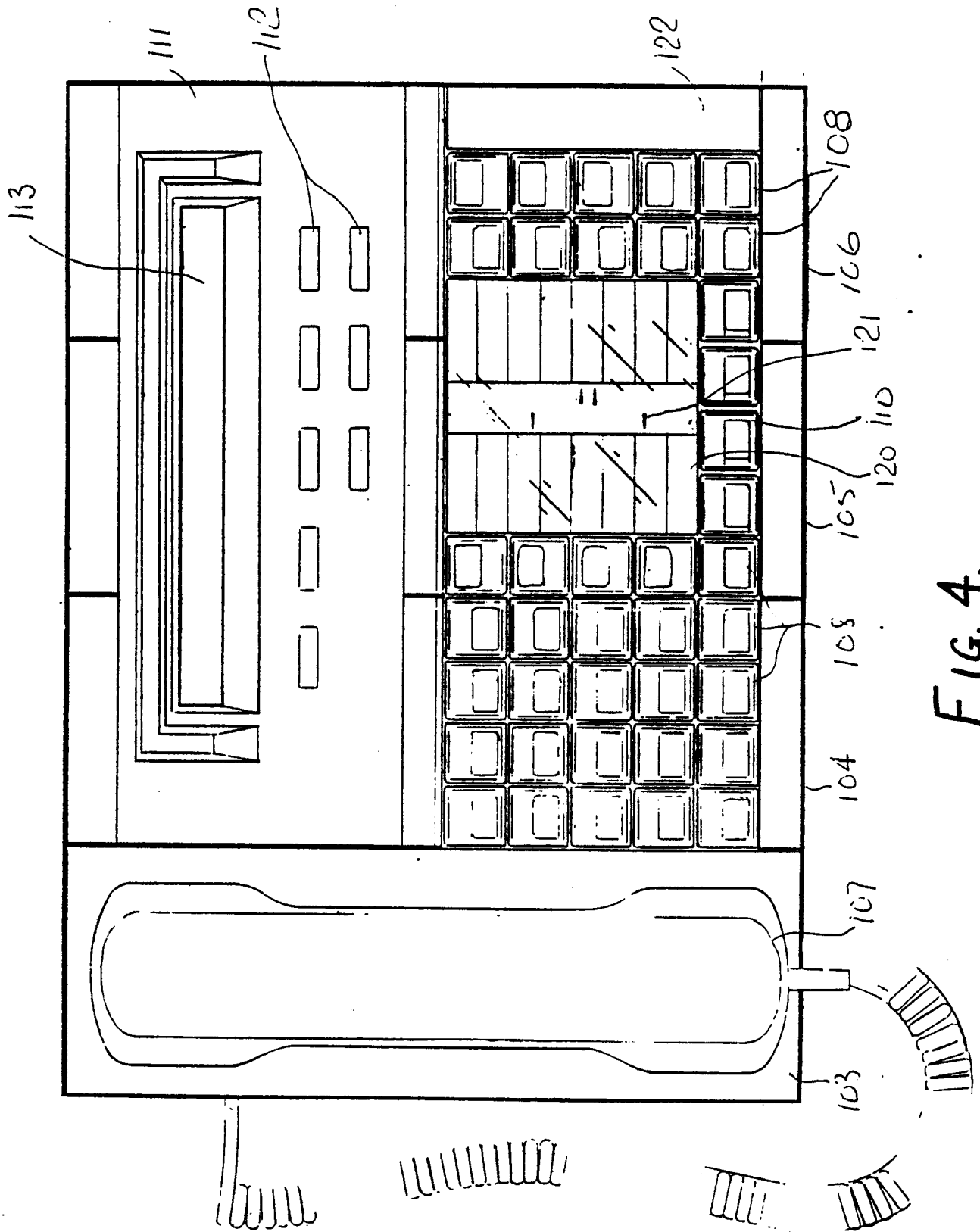

FIG. 4.

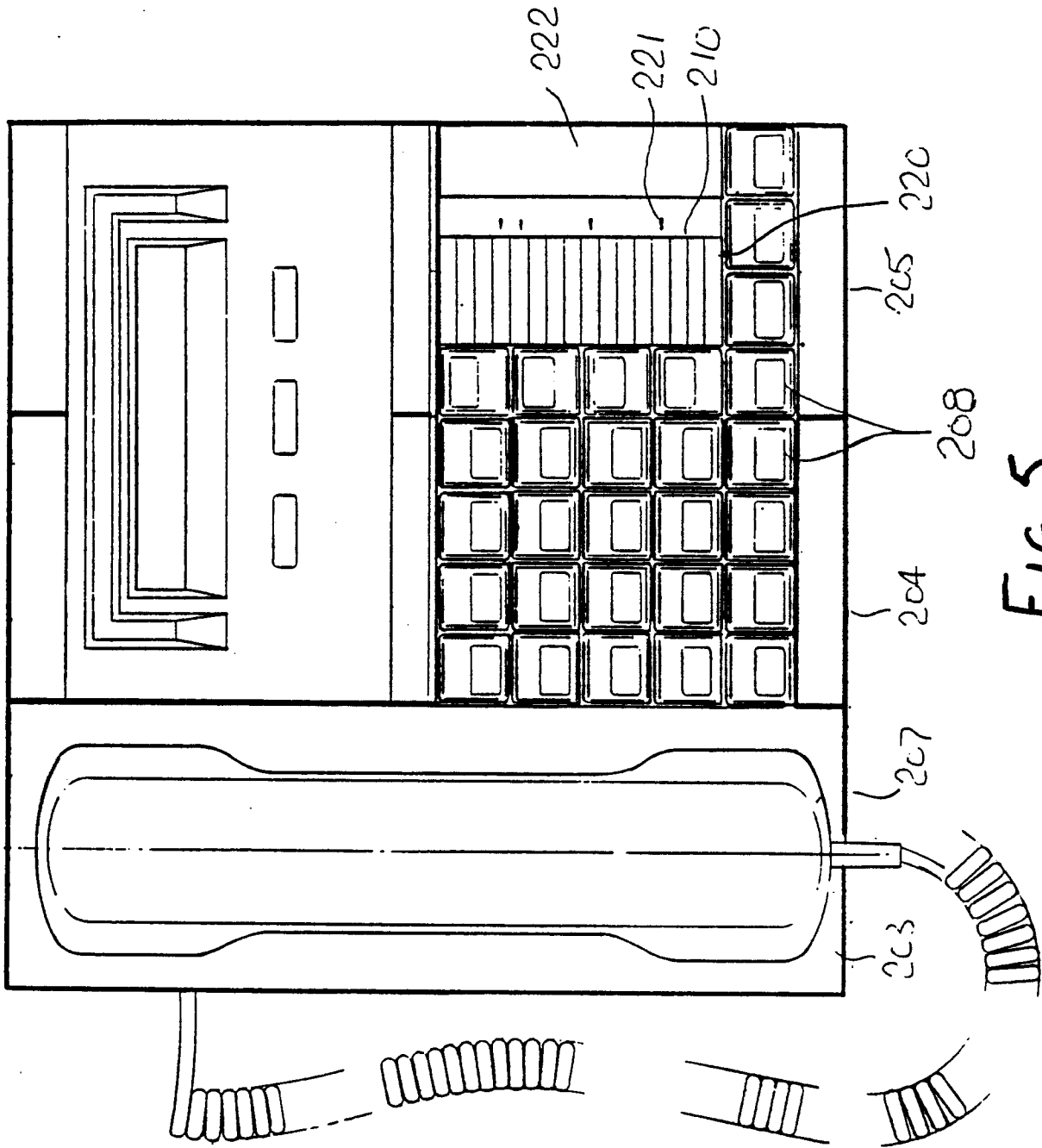

FIG. 5.

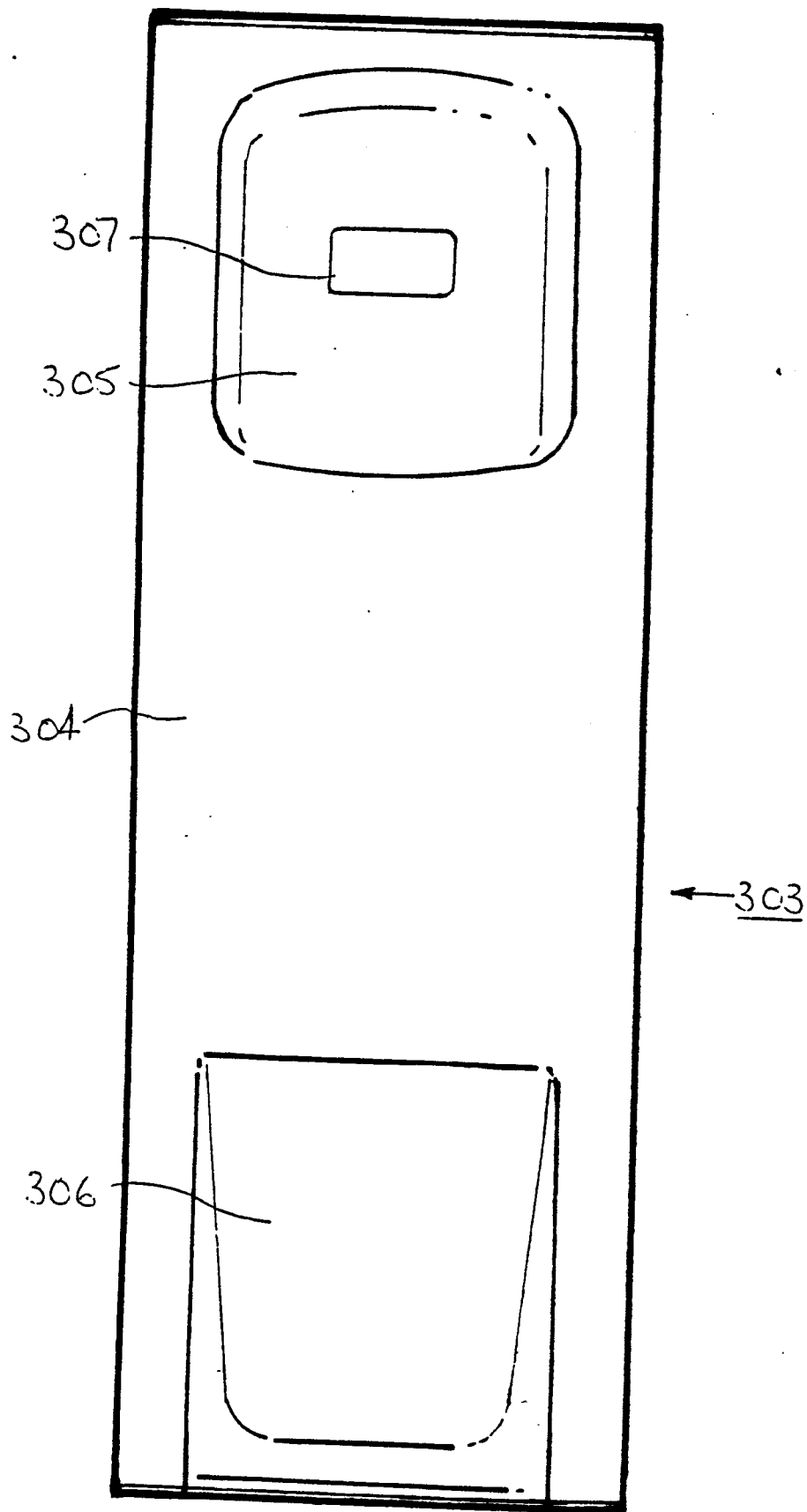

FIG. 6.