

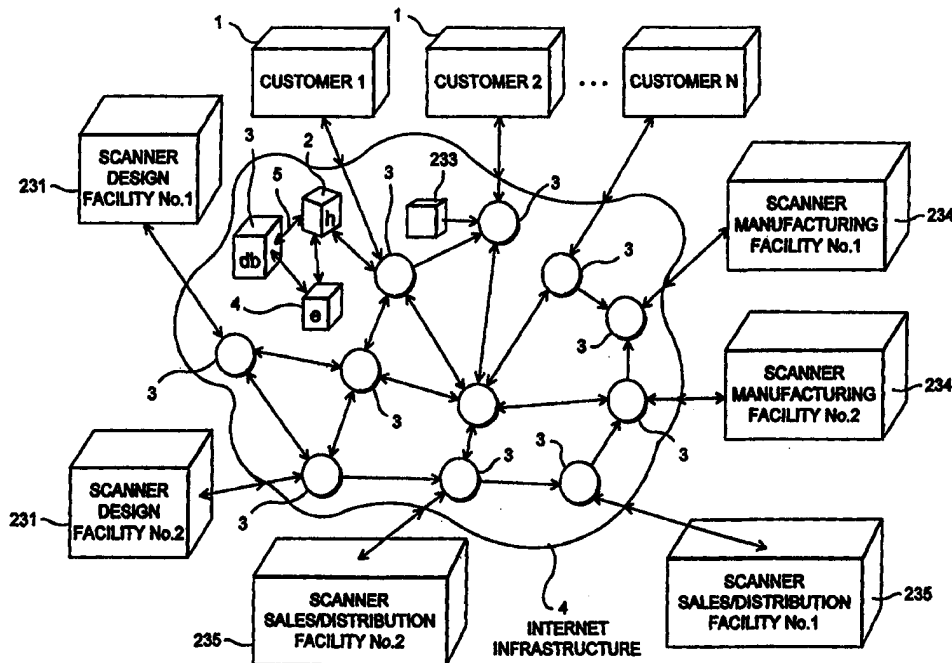

<p>(51) International Patent Classification ⁶ : G06K 7/10, 19/06</p>	<p>A1</p>	<p>(11) International Publication Number: WO 98/52144 (43) International Publication Date: 19 November 1998 (19.11.98)</p>
<p>(21) International Application Number: PCT/US98/09692 (22) International Filing Date: 12 May 1998 (12.05.98) (30) Priority Data: 08/854,832 12 May 1997 (12.05.97) US (71) Applicant (for all designated States except US): METRO-LOGIC INSTRUMENTS, INC. [US/US]; 90 Coles Road, Blackwood, NJ 08012 (US). (72) Inventors; and (75) Inventors/Applicants (for US only): KNOWLES, C., Harry [US/US]; 425 East Linden Street, Morristown, NJ 08057 (US). DICKSON, Leroy [US/US]; Unit B, 16035 Caputo Drive, Morgan Hill, CA 95037 (US). AMUNDSEN, Thomas [US/US]; 620 Glen Court, Turnersville, NJ 08012 (US). GROOT, John [US/US]; 265 Arbor Valley Drive, San Jose, CA 95119 (US). CARULLO, Thomas, J. [US/US]; 5 Ridgemount Drive, Marlton, NJ 08053 (US). (74) Agent: PERKOWSKI, Thomas, J.; Thomas J. Perkowski, P.C., Soundview Plaza, 1266 East Main Street, Stamford, CT 06902 (US).</p>	<p>(81) Designated States: AL, AM, AT, AU, AZ, BB, BG, BR, BY, CA, CH, CN, CZ, DE, DK, EE, ES, FI, GB, GE, HU, IS, JP, KE, KG, KP, KR, KZ, LK, LR, LS, LT, LU, LV, MD, MG, MK, MN, MW, MX, NO, NZ, PL, PT, RO, RU, SD, SE, SG, SI, SK, TJ, TM, TR, TT, UA, UG, US, UZ, VN, ARIPO patent (GH, GM, KE, LS, MW, SD, SZ, UG, ZW), Eurasian patent (AM, AZ, BY, KG, KZ, MD, RU, TJ, TM), European patent (AT, BE, CH, CY, DE, DK, ES, FI, FR, GB, GR, IE, IT, LU, MC, NL, PT, SE), OAPI patent (BF, BJ, CF, CG, CI, CM, GA, GN, ML, MR, NE, SN, TD, TG).</p> <p>Published <i>With international search report. Before the expiration of the time limit for amending the claims and to be republished in the event of the receipt of amendments.</i></p>	

(54) Title: WEB-ENABLED SYSTEM AND METHOD FOR DESIGNING AND MANUFACTURING LASER SCANNERS



(57) Abstract
An Internet enabled method and system (1) for designing, and manufacturing laser scanners of modular design and construction (231) using globally based information networks (3), such as the Internet, supporting the World Wide Web (WWW).

FOR THE PURPOSES OF INFORMATION ONLY

Codes used to identify States party to the PCT on the front pages of pamphlets publishing international applications under the PCT.

AL	Albania	ES	Spain	LS	Lesotho	SI	Slovenia
AM	Armenia	FI	Finland	LT	Lithuania	SK	Slovakia
AT	Austria	FR	France	LU	Luxembourg	SN	Senegal
AU	Australia	GA	Gabon	LV	Latvia	SZ	Swaziland
AZ	Azerbaijan	GB	United Kingdom	MC	Monaco	TD	Chad
BA	Bosnia and Herzegovina	GE	Georgia	MD	Republic of Moldova	TG	Togo
BB	Barbados	GH	Ghana	MG	Madagascar	TJ	Tajikistan
BE	Belgium	GN	Guinea	MK	The former Yugoslav Republic of Macedonia	TM	Turkmenistan
BF	Burkina Faso	GR	Greece			TR	Turkey
BG	Bulgaria	HU	Hungary	ML	Mali	TT	Trinidad and Tobago
BJ	Benin	IE	Ireland	MN	Mongolia	UA	Ukraine
BR	Brazil	IL	Israel	MR	Mauritania	UG	Uganda
BY	Belarus	IS	Iceland	MW	Malawi	US	United States of America
CA	Canada	IT	Italy	MX	Mexico	UZ	Uzbekistan
CF	Central African Republic	JP	Japan	NE	Niger	VN	Viet Nam
CG	Congo	KE	Kenya	NL	Netherlands	YU	Yugoslavia
CH	Switzerland	KG	Kyrgyzstan	NO	Norway	ZW	Zimbabwe
CI	Côte d'Ivoire	KP	Democratic People's Republic of Korea	NZ	New Zealand		
CM	Cameroon			PL	Poland		
CN	China	KR	Republic of Korea	PT	Portugal		
CU	Cuba	KZ	Kazakstan	RO	Romania		
CZ	Czech Republic	LC	Saint Lucia	RU	Russian Federation		
DE	Germany	LI	Liechtenstein	SD	Sudan		
DK	Denmark	LK	Sri Lanka	SE	Sweden		
EE	Estonia	LR	Liberia	SG	Singapore		

5

WEB-ENABLED SYSTEM AND METHOD FOR DESIGNING AND
MANUFACTURING LASER SCANNERS

BACKGROUND OF THE INVENTION

10

Field of Invention

15

The present invention relates generally to laser scanners of modular design and construction, and more particularly to a novel method and system for designing and manufacturing the same using globally-based information networks, such as the Internet, supporting the World Wide Web (WWW).

Brief Description of the Prior Art

20

Laser bar code scanners are used in many fields of endeavor for diverse purposes, namely: data entry; automatic product/object detection; information retrieval; and the like.

25

Typically, laser bar code scanning systems are acquired by end-users only after the scanning requirements of their applications have been determined. In most instances, bar code scanning requirements are specified by: the resolution of the smallest bar code expected to be scanned; the speed at which bar codes are expected to move within the scanning field (or volume); the depth of the scanning field (or volume) required by the application; and the dimensions of the scanning field (or volume) required by the application.

Once the scanning requirements have been specified for the application at hand, the end-user can then either: (1) find a manufacturer which sells a laser scanning system that satisfies the specified scanning requirements; or (2) find a manufacturer willing to custom manufacture a laser scanning system that satisfies the specified scanning requirements and in quantities required by the end-user.

While such methods of laser scanner procurement have been adopted by virtually all end-users, such methods suffer from a number of shortcomings and drawbacks.

In particular, the first method of scanner procurement typically results in the end-user acquiring a laser scanning system that is non-optimally matched to the end-user specified scanning requirements in terms of both cost and performance.

The second method of scanner procurement is typically available to only those end-users who are in a position to purchase large quantities of a particular scanner design. Consequently, for end-users having small purchase order requirements, the first method of scanner procurement is typically the only method available to such customers.

Thus, there is a great need in the laser scanning art for an improved method and system of designing, constructing and delivering custom-configured laser scanning systems to end-users, while avoiding the shortcomings and drawbacks of prior art systems and methodologies.

DISCLOSURE OF THE INVENTION

Accordingly, a primary object of the present invention is to provide an improved method and system of designing, constructing and

delivering custom-configured laser scanning systems to end-users, while avoiding the shortcomings and drawbacks of prior art systems and methodologies.

5 A further object of the present invention is to provide a novel method for designing and manufacturing laser scanners using end-user specified scanning requirements and modularized subcomponents and subassemblies.

10 A further object of the present invention is to provide a novel system for designing and manufacturing laser scanners using end-user specified scanning requirements and modularized subcomponents and subassemblies.

A further object of the present invention is to provide a Internet (i.e. Web) enabled system for designing, manufacturing and delivering custom-designed laser scanners of modularized design and construction.

15 A further object of the present invention is to provide such a Web-enabled system, wherein end-users desiring to purchase a laser scanning system for a particular application (1) transmit their end-user scanning requirements to a Scanner Design/Manufacturing Website, during an interactive procedure using a conventional Web browser
20 program, and in response thereto, the system (2) assigns a unique customer request number to the input scanner requirements, (3) computes a price quotation (based thereon), and thereafter (4) transmits the same back to an e-mail address specified by the end-user (customer).

25 A further object of the present invention is to provide such a Web-enabled system, wherein an electronic commerce server, supporting secured credit-card transactions and the like, enables (1) the manufacturer to confirm the user-specified scanning system on which a

particular quote was transmitted, (2) the customer (e.g. end-user, value-added reseller, etc.) to electronically place a purchase order on the particular system, and thereafter (3) the customer to track the progress of the ordered system during its various stages of manufacture (via a Web-site) maintained by the manufacturer.

A further object of the present invention is to provide such a Web-enabled system, wherein end-user scanning requirements are satisfied by a holographic laser scanning system design comprising modularized subcomponents and subassemblies.

A further object of the present invention is to provide a novel holographic laser scanning system comprised of modularized subcomponents and subassemblies custom manufactured and/or configured using the globally-extensive system of the present invention.

These and other objects of the present invention will become apparent hereinafter and in the Claims to Invention.

BRIEF DESCRIPTION OF THE DRAWINGS

In order to more fully understand the objects of the present invention, the following Detailed Description of the Best Mode Embodiments of the Present Invention should be read in conjunction with the accompanying Figure Drawings in which:

Fig. 1 is a schematic representation illustrating the high-level operations carried out by the Web-enabled system and method of laser scanner design, manufacture and delivery in accordance with the principles of the present invention;

Fig. 2 is a schematic representation of the Web-enabled system for designing, manufacturing and delivering custom-built laser scanners in

accordance with the principles of the present invention;

Fig. 3 is a method of designing, manufacturing and delivering custom-built laser scanners in accordance with the principles of the present invention;

5 Fig. 4 is a perspective, partially cut-away view of an illustrative embodiment of a holographic scanning system constructed in accordance with the principles of the present invention, shown with its housing and the light detector support structure removed from its optical bench in order to reveal the modular design thereof exhibited by its holographic scanning disc, beam folding mirrors, laser beam production modules,
10 analog/digital signal processing boards, and other structures otherwise hidden by the housing and the light detector support structure of the system;

Fig. 5 is an exploded schematic diagram of an exemplary
15 embodiment of a modularized holographic laser scanning system designed and being constructed according to the principles of the present invention;

Fig. 6 is a high level flow chart illustrating the stages of designing and manufacturing modularized holographic laser scanners according to
20 the principles of the present invention;

Fig. 7 is a more detailed schematic diagram of a Web-enabled (computer-integrated) system for designing and manufacturing modularized holographic laser scanning systems according to the principles of the present invention;

25 Fig. 8 is a schematic representation of a tree-type information structure used to display which modules and subcomponents have been selected from Inventory Library or the Design Library of the Web-enabled system during the design of the modularized holographic laser

scanners according to the principles of the present invention; and

Fig. 9 is a schematic representation of an information display structure used to display information models of modules and subcomponents from the Inventory Library and the Design Library of the system during the design of the modularized holographic laser scanners according to the principles of the present invention.

DETAILED DESCRIPTION OF THE BEST MODE EMBODIMENTS OF THE PRESENT INVENTION

Referring to the figures in the accompanying Drawings, the method and system for designing and manufacturing laser scanning systems of modular design and construction will be described in great detail.

As shown in Fig. 1, the system of the preferred embodiment is implemented over a globally-based information network, such as the Internet supporting the World Wide Web using hypertext transmission protocol (HTTP) and the hypertext markup language (HTML) well known in the art. The infrastructure of the Internet, HTTP, HTML, Web clients and Web servers are described in detail in the following International Applications: International Application No. PCT/US97/21975, entitled "SYSTEM AND METHOD FOR ACCESSING INTERNET-BASED INFORMATION RESOURCES BY SCANNING JAVA-APPLET ENCODED BAR CODE SYMBOLS," filed November 24, 1997; International Application No. PCT/US97/21443, entitled "SYSTEM AND METHOD FOR CARRYING OUT INFORMATION-RELATED TRANSACTIONS USING WEB DOCUMENTS EMBODYING TRANSACTION-ENABLING APPLETS AUTOMATICALLY LAUNCHED AND EXECUTED TO READING URL-ENCODED SYMBOLS," filed November 24, 1997; and International Application No.:

PCT/US97/21970, entitled "BAR CODE SYMBOL DRIVEN SYSTEMS FOR ACCESSING INFORMATION RESOURCES ON THE INTERNET" filed November 24, 1997, each being incorporated herein by reference.

As indicated in Figs. 1 and 2, the end-user (e.g. customer),
5 considering the purchase of a laser scanning system, with a particular application in mind, uses a Web-enabled client computer system 1 in order to visit the Manufacturer's Web-site which is designed to support the specification, purchase, manufacture and delivery of custom-built laser scanners in accordance with the method of the present invention.
10 The manufacturer's Web-site can be hosted upon any suitable Internet (i.e. HTTP) Server 2 running HTTP, with a TCP/IP link to an Internet Service Provider (ISP) 3 connected to the infrastructure of the Internet 4. As shown in Fig. 2, a back-end Database System 3 and an Electronic Commerce Server 4 are interfaced with the Internet Server 2 by way of
15 a high-speed local area network (LAN), situated behind a secure firewall constructed in a manner known in the art. As will be explained in greater detail hereinafter, the function of the Database Server 3 is to support the automated generation of complete models (i.e. optical, engineering, 3-D graphical, cost, production and like models) for
20 modularized laser-based scanning systems in response to scanning requirements provided to the Manufacturer's Web site by end-users (e.g. prospective customers). The function of the Electronic Commerce Server 4 is to support secured credit-card transactions and the like for the purchase of a designed laser scanning system on which a particular
25 quote was computed and transmitted by the Database Server 3.

In accordance with the principles of the present invention, the Manufacturer's Web site should include a collection of HTML Forms, and one or more CGI scripts, particularly designed to cooperate with the

back-end (web-enabled) Database System 3 and Web-enabled client systems 1 remotely situated anywhere in the world having Internet access. Preferrably, the back-end Database System 3 is constructed/programmed to support the automated generation of a complete model of laser scanning systems capable of satisfying the specified scanning requirements of a wide range of end-users.

As indicated at Block A in Fig. 3, the first step of the method of the present invention involves the end-user (e.g. prospective customer) using a client computer system 1 to access the Manufacturer's Website and to provide a specification of the end-user's scanning requirements, e.g.: the resolution of the smallest bar code element expected to be scanned; the speed at which bar codes are expected to move within the scanning field (or volume); the depth of the scanning field (or volume) required by the application; the dimensions of the scanning field (or volume) required by the application, etc. These parameters, as well as the e-mail address of the customer making the scanner design inquiry, are provided to the Database System 3 by way of HTML forms that are generated by CGI scripts running on the Web Server 2.

At indicated at Block B in Fig. 3, the second step of the method involves the Database System 3 using the information contained in these HTML forms, as well as the models and information contained therewithin, to generate a complete model of a laser scanner which will satisfy the end-user scanning requirements provided to the Database System. Preferably, the scanner design process is completely automated by the Database System 3 and its automated design and testing procedures and therefore requires little or no input on part of optical engineers, in that all know-how, models, design procedures and the like are embodied with the scanner design programs running on

Database System 3. Depending on various factors, design process could
takes minutes or hours. It is understood, however, that one or more HSD
workstations 231, as shown in Fig. 7, can be used to carry out scanner
designs that are not automatable within Database System 3. Models of
5 scanners, subcomponents, modules and subassemblies generated on
workstations 231 during scanner design processes can be transferred to
Database Management System (DBMS2) 232 for use within Database
System 3, shown in Fig. 2. This aspect of the method hereof will be
described in greater detail hereinafter.

10 Typically, Database System 3 will automatically carry out one or
more scanner performance procedures on each scanner model generated
in order to test whether the generated scanner design meets the
scanning requirements set by the end-user. When it has determined
that such scanning requirements are met by a particular design
15 (sometimes requiring several reiterations), the Database System 3 then
uses cost models, bill of material (BOM) lists, assembly schedules and
the like, to arrive at a cost for a given quantity of the designed laser
scanner product, as indicated at Block C in Fig. 3. Thereafter, the price
quote along with its terms and conditions is transmitted to the e-mail
20 address of the prospective customer who placed the Scanner Design
Request. Each Scanner Design generated by the Database System 3 in
response to a particular Scanner Design Request is assigned a unique
Design Identification Number (DIN) so that future reference can be
accurately made thereto by the Manufacturer and prospective customer
25 alike. Optionally, the Manufacturer can provide the prospective
customer with an access code enabling the prospective customer to view
a complete 3-D computer-graphic simulation of the designed laser
scanning system, generated from the Manufacturer's Web site and

viewer by the prospective customer using a conventional browser program (e.g. Netscape Navigator or Microsoft Internet Explorer). The scanner simulation may be realized using Virtual Reality Modelling Language (VRML) or other suitable graphical display techniques particularly adapted for use over the Internet. Alternatively, scanner simulations can be recorded on CD ROM discs which can be sent to the prospective customer for analysis prior to purchase.

As indicated at Block D in Fig. 3, if satisfied with the delivered laser scanner design in the form of a computer-based model, the prospective customer (located anywhere in the world) may purchase the corresponding laser scanning system in accordance with the terms and conditions of the transmitted quote. This purchase can be carried out electronically by way of a secured electronic transaction supported by Electronic Commerce Server 4, shown in Fig. 2. All documentation relating to the purchase and delivery of the laser scanner order is carried out electronically using Web-enabled electronic data interchange (EDI) between the parties involved in the purchase transaction.

As indicated at Block E in Fig. 3, after the purchase order has been made, the customer may then track the progress of the laser scanning system order during the various stages of its manufacture. Such tracking can be carried out by way of HTML forms displayed from the Manufacturer's Web site. For example, each purchaser can be provided with a tracking number that can be entered into a suitable HTML form displayed on a client system 1, requesting status information acquired by the manufacturing system 234 and supplied to Database System 3 or other server. The HTML form is sent to the Database System 3 (or other server) via a CGI in order to access up-to-date information on the status of the order (as well as portions thereof). The

obtained information is then displayed by the browser of the customer seeking such status information.

As indicated at Block F in Fig. 3, when manufactured, tested and packaged, the laser scanners are shipped to the location specified by the customer, and during shipping, may also be tracked either by way of the Manufacturer's Website or by way of its shipping agent responsible for the delivery of the finished scanner product.

The process of acquiring user-specified scanning requirements, automatic/semi-automatic generation of laser scanner designs (i.e. models), electronic purchase of scanner product, tracking and the like can be realized using various technologies, including Javascript, well known in the Internet and Web arts.

In the illustrative embodiments, custom-design/built laser scanning systems are realized using holographic laser scanning mechanisms and high-speed scan data processors as taught in Applicant's International Application No. PCT/US96/20525, published under the Patent Cooperation Treaty as International Publication No. WO 97/22945, hereby incorporated herein by reference in its entirety. It is understood, however, that other non-holographic enabling technologies based on light reflection and/or refraction made be used to practice the present invention with acceptable results.

One of the advantages of using holographic scanning technology to produce customized laser scanners is that one can easily generate 3-D scanning volumes and scanning patterns particularly tailored to a wide range of customer needs. Notably, the holographic laser scanner of modular construction shown in Fig. 4, and detailed in Applicant's International Application No. PCT/US96/20525, can be used to meet the needs of a wide class of customers quickly and in a highly cost-effective

manner. Custom-designed (and built) laser scanners can be designed from this, as well as from other basic configurations, using the highly flexible scanner design method disclosed in International Application No. PCT/US96/20525). From this basic architecture, holographic laser scanners of modular design and construction having diverse scanning characteristics, matched to the end-user scanning requirements, can be rapidly designed and manufactured for shipment.

In Fig. 5, an exemplary holographic laser scanner of modular construction 200 is shown comprising a number (i.e. six) of predesigned (preassembled) modules, namely: an optical-bench/housing module M1 comprising, as subcomponents, an optical bench 201, a wrap-around case 202 and a housing cover 203 with output scanning window 204, speaker 205 and LEDs 206 and 207; a holographic scanning-disc/photodetector module M2 comprising, as subcomponents, a holographic laser scanning disc 208, a scanning motor 209, photodetector/signal processing boards 210A through 210E, and a motor/board mounting assembly 211; a plurality of scanning station modules M3 comprising, as subcomponents, a laser beam production module 212A through 212E (for scan data channels A through E, respectively), base plate therefor 213A through 213E, output beam folding mirror 214A through 214E and adjustable support bracket 215A through 215E, and parabolic light collection mirror 216A through 216E, for mounting onto optical bench 201, adjacent to the corresponding base plate using a pair of screws of light fasteners; a digital signal processing and I/O module M4 comprising, as subcomponents, a CPU motherboard 217 with power supply, five CPUs for decode processing, I/O circuitry and the like.

In the illustrative embodiment, optical-bench 201 has a first set of

preformed holes 218 for receiving the ends of support posts 219 associated with the motor/board mounting assembly 211, and a second set of preformed holes 220 for jointly mounting base plate 213 and adjustable support bracket 215. The size and dimensions of the optical bench will typically be selected to accommodate a holographic scanning disc having a maximum diameter (e.g., 8.66 inches). In such embodiments, scanning discs of smaller diameter (e.g., 6.0 inches or smaller) could be accommodated on such an optical bench, although the rationale for doing so, when a smaller size optical bench is available, is not certain. The size and dimensions of support bracket 215 are designed so that any one of a variety of output beam folding mirrors 214 can be mounted thereto using adhesive or the like in order to meet the specifications and performance characteristics of the holographic laser scanner under design. Optionally, optical bench 201 can have several sets of preformed mounting holes so that a different number of scanning-disc/photodetector modules M2 can be easily mounted to the optical bench, in order to provide the scanner designer with the option of designing various types of scanners having different number of output scan data channels, while using the same optical bench.

In the illustrative embodiment, a wrap-around case 202 can be made of metal, plastic or fiberglass and be available in a variety of heights (e.g., 4.0 inches, 5.0 inches, etc.) depending on the design at hand. The housing cover 203 is generally matched with the optical bench, and is designed to be used with a variety of cases of different height, as described above.

In some design applications, the holographic laser scanning disc 208 can be treated as a modularized component which is predesigned, premanufactured and available out of inventory for use in the design

and construction of any particular scanner. In such instances, a number of predesigned/premanufactured scanning discs can be stored in inventory and used to construct various types of holographic scanner designs. While the laser beam scanning and light collection properties of each such inventoried scanning disc will remain substantially the same in each scanner in which it is employed, the resulting scanning volume and scanning pattern can be changed from design to design by using different modules and subcomponents, as will be explained in greater detail hereinafter.

It is also understood that in many applications, it will be desirable or necessary to custom design the holographic scanning disc using the fixed and variable parameters associated with the selected modules, subcomponents (e.g. preconstructed "master" HOE-based scanning elements), and end-user design specifications. In such instances, the disc design methods and procedures described hereinabove can be used to design scanning systems having minimized height dimensions, omnidirectional scanning volumes, and the like.

By taking into account design parameters such as the minimum bar width to be read, the effective width of the scan pattern, the scan-line overlap, the overall depth of field, the maximum and minimum reading distances, the speed of the items passing through the scan region, etc., one can design a family of laser scanners based on a minimum number of holographic master scanning elements. By selecting the proper combination of these scanning elements, one can create a wide variety of scanners with a broad range of capabilities. Trade-offs can be made between depth of field and scan pattern repetition rate, for example; or between resolution and scan pattern repetition rate; or between scan pattern width and scan pattern repetition rate, etc. The

trade-offs would be made to optimize the scanner for a particular customer's application.

Ideally, any combination of holographic facets with any combination of facet parameters is attainable using the design method of the present invention. For purposes of illustration, a suitable disc design method for producing an "XXBar" scan pattern using six scanning stations (i.e. VLDs) would involve first considering the broadest possible range of scanner requirements that must be satisfied or that one desires to satisfy. Thereafter, a number of holographic master facets (HOEs) are designed that will satisfy all of these requirements when used in the proper combinations. The number of facets required will, on the whole, be relatively small. While the 20 or so basic master holograms will be created using facet focal lengths, diffraction angles and areas established by the requirements of the scan pattern, the facet areas and the mirror angles and configurations in each individual scanner must be determined from the application requirements, using facet focal lengths and diffraction angles that are already established.

These master facets can be placed in a web, or in a master-facet source housing, in order to produce a master scanning disc for any particular design. The web is a circular array of apertures in which the master holograms are placed. The web is rotated so that each individual master hologram is placed at the proper location on the copy disk just prior to exposure. The master-facet source housing can be constructed as a large open container having individual cells containing the master facet holograms. A mechanical picking device can be used to select from the housing, the facet to be exposed at any particular time during the disc manufacture process. This facet would be placed by the picking element at the proper exposure position over the unexposed copy disk

just prior to exposure.

The web approach is simpler and would be the preferred method when the number of master facets is reasonably small, 24 or less. The housing/picker approach is more complex but may be preferable when
5 the number of master elements is much larger than 24. In both methods, the computer selects each individual master facet for each exposure of each facet on the copy disk. The selection is based on the particular design selected for the customer's application.

No matter which method is used, some means must be provided for
10 varying the size and shape of the facet on the copy disk. Therefore, some mechanism must be created to provide a variable mask for the copy exposure process.

Depending upon the design requirements, different scanning
motors 209 (having different rotational speeds--RPMs--) can be
15 selected for use in designing different types of holographic laser scanners. Photodetector/signal processing boards 210 (having different bandwidth characteristics, different analog signal processing thresholds, different signal gain constants, different SNR levels, etc.) can also be selected for use in designing different types of holographic laser
20 scanners. The motor/board mounting assembly 211 attached to the optical bench selected (e.g., 8.66 or 6.00 inch scanning disc) like the casing 202 and housing cover 203.

In general, the adjustable support bracket 215 and base plate 214
upon which the laser beam production module is mounted, can be
25 realized as a universal bracket subassembly that is utilizable in a very broad range of scanner designs, independent of the diameter of the scanning discs employed. It is understood, however, that it will be desirable to design, make and inventory many different laser beam

production module designs for use in different kinds of holographic scanning systems under design. Such laser beam production modules can be designed to produce stigmatic laser beams having different aspect ratios, and focal distances for use in different scanner designs in order to meet the operational and performance characteristics thereof, including, for example: the resolution of the smallest bar code element expected to be scanned; the speed at which bar codes are expected to move within the scanning field (or volume); the depth of the scanning field (or volume) required by the application (e.g. scanning distance); the dimensions of the scanning field (or volume) required by the application (i.e. scanning volume characteristics); scanning beam aspect ratio; scanning beam polarization-state; specified code symbol resolution at a specified scanning distance(s); bar code substrate characteristics and print quality characteristics; and the like.

Preferably, the parabolic mirror 216 associated with each scanning station module M3 is directly mounted to the optical bench by a pair of screws of like fasteners. This component will be designed to satisfy the light collection requirements of the widest holographic facet on the largest diameter scanning disc able to be accommodated by the selected housing, and while utilizing the minimum amount of space possible therebeneath. Once designed and manufactured, the focal length of the parabolic mirror will be fixed, determining where the corresponding photodetector board must be positioned above the scanning disc. While it is possible to design, make and inventory a number of parabolic mirrors having different light collection surface areas and focal lengths, it may be desirable in many applications to stock a single parabolic mirror design. In such a case, the parabolic mirror subcomponent will be matched to the motor/board mounting assembly 211 and the

support posts 219 which depend therefrom.

From the point of design flexibility, it would be desirable to use a single output mirror design having the largest possible width and height dimensions. However, this approach certainly has its drawbacks. Thus,
5 in many instances, it will make sense to elect an output mirror having different height and width characteristics for use in a particular scanner design. By doing so, the scanner designer will be able to minimize manufacturing costs and overall scanner weight, while increasing the total available volume within the scanner housing for the internal
10 mounting of auxiliary components.

An important feature of the mirror support bracket 215 is that it is provided within a hinge or like mechanism that allows the plane of the mirror to be adjusted with respect to the optical bench. As shown in Fig. 5, the adjustable mirror support bracket allows the scanner design
15 parameter ϕ to be a variable in the custom disc design process of the present invention. In geometrical terms, this support bracket assembly allows the output mirrors to be reconfigured (e.g., tilted) in any given system design so as to achieve 3-D scanning pattern and light collection characteristics required by the scanning system specified by the end
20 user.

Preferably, a number of different digital signal processing and decode boards 217 would be designed, manufactured and inventoried in order to satisfy the scanner design requirements for a wide range of applications. Certain boards would support three CPUs, while other
25 boards support five or more CPUs. Some boards could be provided with special decoding algorithms, I/O interfaces, low-speed scanner input options, and the like.

In accordance with another aspect of the present invention, these

basic modules and subcomponents are used in conjunction with the computer-integrated design and manufacturing system shown in Fig. 6 in order to efficiently design and inexpensively manufacture a wide range of holographic laser scanners having performance characteristics uniquely tailored to the needs of particular end-users.

As shown in Fig. 6, the system of the present invention is realized as a network of computer systems comprising: a first database management system (BDBMS1) 230 for storing and managing information model relating to the inventory of modules, submodules (subcomponents) available within the system; one or more holographic scanner design (HSD) computer workstations 231 for designing holographic laser scanners, subsystems and subcomponents thereof according to the principles of the present invention; a second database management system (DBMS2) 232 for storing and managing information models (e.g., 2-D, 3-D geometrical models, geometrical optics models, analytical models, etc.) about modules and subcomponent designs obtained from the HSD workstations; a network information server (computer system) 233 for storing and serving the database information models (comprises of information files of various sorts) maintained by DMS1 and DBMS2 so that other computer systems within network can access such models whenever needed; and a system 234 for manufacturing holographic laser scanners using the designs and models stored in the network information server 233. Holographic laser scanners manufactured using the CIM system hereof are then sold and distributed using a sales, marketing and distribution system 235 of the manufacturer's choice. Each of these computer-based systems can be located at different locations throughout the world, and thus could be interconnected by way of a wide area network (WAN) such as the

Internet. If the systems are located in close proximity, then they could be interconnected by a local area network (LAN), depending on the needs of the manufacturer. In the illustrative embodiment, each of the computer systems in the network supports the Windows NT Operating System (OS) by MicroSoft Corporation, of Redmond, California, and the network protocol TCP/IP.

Notably, information files maintained with database systems 232 and 230 that are required for scanner design generation (at the Manufacturer's Web site) are made available to Database System 3 shown in Fig. 2, by way of network server 233 shown in Figs. 2 and 7. In the illustrative embodiment, network server 233 is realized as an ftp server and is connected to an ISP 3 for Web-enablement and selected information file sharing over the Internet using, for example, file transfer protocol (ftp).

The relational database management systems DBMS1 and DBMS2 can be realized using a commercially available relational database system development program such as, for example, 4D Version 6.0 from ACI US, Inc., AccessTM from MicroSoft, Corporation, SQL from Sybase, Inc., etc. The function of DBMS1 is to maintain an "Inventory Library" that tracks and manages the inventory of manufactured modules and subcomponents that have been either placed into inventory or removed therefrom to satisfy production requirements. Bar code indexing/tracking techniques can be used to carry out this subsystem in a manner well known in the part inventory management art. The function of DBMS2 is to store and manage module and subcomponent designs that have been previously designed in connection with other holographic scanner designs that may or may not have ever been manufactured.

The HSD workstations 231 can be realized in the manner described in great detail hereinabove. In connection therewith, it should be noted that HSD workstations used in the design of the mechanical components of the holographic scanners will have 3-D CAD modelling tools (e.g., AUTOCAD) well known in the art.

The manufacturing system 234 will typically include CNC machine tools, robots, pick-and place machines, assembly fixtures, assembly lines, and the like. While structures, elements and processes are generally well known in the art, they will expectedly vary from embodiment to embodiment of the system hereof. Notwithstanding this fact, the subsystems thereof will be generally configured in accordance with the requirements of the designs provided by the HSD workstations described above.

In Fig. 6, a generalized method of designing and manufacturing holographic laser scanners using the Web-enabled CIM system of the present invention is illustrated. As indicated at Block A thereof, the first stage of the method involves using DBMS1 to create a relational database model (i.e. DBM1) for constructed laser scanner modules and subcomponents available in inventory. The second stage of the method involves using DBMS2 to create a relational database model (i.e. DBM2) for laser scanner modules and subcomponent designs that have been previously created during the design of other holographic laser scanners. Notably, DBM2 provides the Design Library with geometrical models, geometrical-optical models, and/or analytical models of modules and subcomponents of holographic laser scanners of modular construction. The third stage of the method involves maintaining mirror images of the relational database models DBM1 and DBM2 on the Information Network Server 233. By doing so, each HSD workstation

and manufacturing workstation and computer system within the manufacturing system is provided access to the information stored therein over the global information network, as needed or desired.

As indicated at Block D, the next stage of the method involves
5 designing a holographic laser scanner on one or more HSD workstations using inventory and design information stored on the Information Network Server. In this alternative embodiment of the design process of the present invention, each HSD work station is preferably provided with several computer-software "tools" that facilitate the design of
10 holographic laser scanners of modular construction, namely: an Inventory Display Tool (e.g., client program) for displaying which modules and subcomponents are available in the Inventory Library, in what quantities, at what cost, etc.; a Design Display Tool (e.g., client program) for displaying which module designs and subcomponent
15 designs have been previously created and are available for downloading from the Information Network Server; and a Module/Subcomponent Selection Tool (e.g., client program) for selecting which modules and subcomponents in Inventory Library (DBM1) or from the Design Library (DBM2) will be used in designing a holographic laser scanner of modular
20 construction.

When the Database System 3 (or scanner designer) uses the Module/Subcomponent Selection Tool, a Holographic Scanner Design Tree Structure as shown in Fig. 7 is analyzed by Database System 3 (or
25 displayed on the graphical user interface (GUI) of the HSD workstation for analysis by the scanner designer). Underlying this graphical tree structure is an information structure (e.g., relational database model) that stores the various information files associated with each of the modules and submodules (I.e., subcomponents) of the "modularized"

holographic laser scanner under design. This structure can be viewed as a "System Model" for the holographic scanner under design. While each holographic laser scanner will have generally the same system architecture, the particular modules and subcomponent structure thereof can and will vary from scanner design to scanner design. The subcomponent structure of a given design will depend on which modules and subcomponents selected during the design process. The Database System 3 (or scanner designer) can access the Network Information Server 233 and use the Inventory Display Tool to determine which particular modules and submodules (subcomponents) are in the manufacturer's inventory, what the present cost of their manufacture is, their availability, etc. The Database System 3 (or holographic scanner designer) can access the Network Information Server 233 and use the Design Display Tool to determine which particular modules and subcomponents have been previously designed during previous scanner design projects, that may be useful in the present design.

When the Design Display Tool is launched from Database System 3 (or HSD workstation 231), information models of the modules and subcomponents in the DBM2 can be reviewed and analyzed. An exemplary display screen is set forth in Fig. 8. In this display screen, the modules of a previous scanner design ("Design A") are indicated by M1A, M, M3A and M4A. The subcomponents of module M1A are indicated by M1A1, M1A2, M1A3, and M1A4. The subcomponents of module M are indicated by M1, M2, M3, M4, and M5. The subcomponents of module M3A are indicated by M3A1, M3A2, M3A3, and M4A4. While not shown in this display screen, each subcomponent contains detailed information about its design, specifications and

performance characteristics which can be readily displayed by simply clicking on the display cell associated with the subcomponent.

Understandably, the graphical user interface of this design tool (i.e., program) will vary from embodiment to embodiment of the present invention.

Based on the specifications and expected cost of the module designs displayed using the Design Disciple Tool, the Database System 3 (or scanner designer) can determine which designs are best suited for use in the present scanner design project. When the Database System 3 (or scanner designer) finds a certain module or subcomponent satisfactory to the design requirements, then the module or subcomponent can be selected as follows: (1) employing the Design Display Tool (or its functional equivalent) to select the module or subcomponent design from the Design Library (e.g., by "clicking on" the graphical icon thereof); (2) constructing/generating the Holographic Scanner Design Tree Structure; (3) "dragging" the selected icon of the module or subcomponent design over to the Holographic Scanner Design Tree Structure; and (4) "dropping" it onto the module or subcomponent location of the Tree Structure where the selection is to be achieved.

Each time such a drag and drop operation is carried out (manually by scanner designer, or in an automated manner by Database System 3), the diverse information files associated with the selected module or subcomponent are automatically transferred from the Internet Network Server 233 to the information structure underlying the Holographic Scanner Design Tree Structure (stored in either the HSD workstation or Database System 3, as the case may be).

When the Inventory Display Tool is launched, information models of the modules and subcomponents in the DBM1 can be reviewed.

Preferably, to provide a unified approach to the scanner design process, the display screen shown in Fig. 8 is also used to display inventoried modules and subcomponents. However, to distinguish between module and subcomponent designs in the Design Library from manufactured modules and subcomponents in Inventory Library, graphical indications (or color coding techniques) should be employed to make clear what modules and subcomponents are in the Inventory Library and what modules and subcomponents are only in the Display Library (and not manufactured). Alternative techniques for displaying such models will occur to those skilled in the art upon having the benefit of the present disclosure.

Based on specifications, availability, and actual cost figures for the modules and subcomponents displayed using the Inventory Display Tool, the scanner designer can determine which designs are best suited for use in the present scanner design project, in a manner described hereinabove. When the designer finds a certain module or subcomponent satisfactory to the design requirements, then module or subcomponent selection can occur as follows: (1) employ the Inventory Display Tool (or its functional equivalent) to select the module or subcomponent design from Inventory database system DBMS1 (e.g., by "clicking on" on the graphical icon thereof); (2) generate the Holographic Scanner Design Tree Structure; (3) "drag" the selected icon of the module or subcomponent design over to the Holographic Scanner Design Tree Structure; and (4) "drop" it onto the module or subcomponent location of the Tree Structure where the selection is to be achieved. Each time such a drag and drop operation is carried out (manually by scanner designer, or in an automated manner by Database System 3), the diverse information files associated with the selected module or subcomponent

are automatically transferred from the Internet Network Server to the information structure underlying the Holographic Scanner Design Tree Structure (stored in either in the HSD workstation or Database System 3 as the case may be).

5 Using the Design and Inventory Display Tools, in conjunction with the Holographic Scanner Design Tree Structure of the present invention, a basic model for the holographic laser scanner under design can be arrived at with minimum effort. Notably, however, not all of the subcomponents can be selected during this stage of design if one desires
10 to optimize the scanner design in the various ways described in International Application No. PCT/US96/20525. In such cases where optimization is desired, it will be necessary to defer the selection of particular subcomponents (e.g., the housing casing which determines the height of the scanner; the beam folding mirrors which also determine
15 the height of the scanner housing; etc.) until the design process is completed. The basic model would have a number of fixed scanner parameters set by the selection of the particular modules and subcomponents. Other parameters will be set by the designer based on Heuristics and experience. The variables in the system design can be
20 determined by employing the geometrical and analytical modelling techniques hereinbefore described to arrive at optimized values for such system variables. Once these parameters have been determined, the designer can go back to the Information Network Server 233 and select subcomponents that satisfy the optimized parameters. Thereafter
25 the Database System 3 (or scanner designer) can update the Holographic Scanner Design Tree Structure (i.e., scanner system model) and thus, the model of the scanner under design. At the end of the design process, a complete set of construction parameters will have been generated for

use in manufacturing "optimized" holographic scanning discs in a manner described hereinabove.

As indicated at Block E, after the holographic scanner design has been finalized, the information models comprising the same can be used to update the Design Library (DBM2) as required, thereby increasing the design capabilities of the system.

At Block F, the modules and subcomponents (e.g., scanning disc) are manufactured according to the finalized holographic scanner design. Then based on production activity, the module and subcomponent Inventory Library (DBM1) is periodically updated to track the status of the manufacturer's inventory.

As indicated at Block G, the finalized holographic laser scanner design is assembled, its parameters configured, and its performance tested as described hereinabove.

In the design process described above, the holographic scanning disc was considered a subcomponent characterized by having several variables that are determined by application of the design procedures of the present invention. It might be desirable, however in some applications, to predesign and inventory a number of scanning disc designs for selection during the design process, much like the parabolic light collection mirror, subcomponent M3A3, in the display screen of Fig. 8. In other embodiments, it will be preferable to custom design the HoEs on the holographic scanning disc, in order to exploit the advantages of the various design optimization procedures disclosed herein. However, even in such embodiments, the size of the scanning disc plates (e.g., 8.66 or 6.00 inches in diameter) will be a subcomponent that the designer will necessarily select during the preliminary design stage of the design process for modularized holographic scanners using the Inventory and

Design Library databases described above.

In other embodiments, it will be preferable to custom design the entire holographic scanning system in order to meet the specifications and requirements of a particular end user.

5 While the various embodiments of the laser scanner hereof have been described in connection with linear (1-D) and 2-D code symbol scanning applications, it should be clear, however, that the scanning apparatus and methods of the present invention are equally suited for scanning alphanumeric characters (e.g., textual information) in optical
10 character recognition (OCR) applications, as well as for scanning graphical images in graphical scanning arts.

 Several modifications to the illustrative embodiments have been described above. It is understood, however, that various other
15 modifications to the illustrative embodiment of the present invention will readily occur to persons with ordinary skill in the art. All such modifications and variations are deemed to be within the scope and spirit of the present invention as defined by the accompanying Claims to
Invention.

CLAIMS TO INVENTION:

- 5 1. An Internet-enabled method for designing and manufacturing laser
scanners using end-user specified scanning requirements and
modularized subcomponents and subassemblies.
- 10 2. An Internet-enabled system for designing and manufacturing a laser
scanners using end-user specified scanning requirements and
modularized subcomponents and subassemblies.
3. An Internet-enabled system for designing and purchasing a laser
scanning system comprising:
an Internet information server programmed for hosting a Website
15 capable of supporting an interactive procedure; and
client computer system, including using a Web browser program,
for enabling a prospective customer to transmit end-user scanning
requirements of a particular application to said Website during said
interactive procedure.
- 20 4. The Internet-enabled System of claim 3, which further comprises:
means for assigning a unique customer request number to end-
user scanning requirements;
means for computing a price quotation (based thereon); and
25 means for transmitting said price quotation to said end-user or
prospective customer of said laser scanning system.
5. The Internet-enabled system of claim 3, which further comprises:

an electronic commerce server, for supporting secured electronic commerce transactions and enabling said prospective customer to electronically transmitt a purchase order on said designed laser scanning system.

5

6. The Internet-enabled system of claim 5, which further comprises:

means enabling said customer to track the progress of said ordered laser scanning system during its various stages of manufacture (via a Web-site) maintained by said manufacturer.

10

7. The Internet-enabled system of claim 3, wherein said end-user scanning requirements are satisfied by a holographic laser scanning system design comprising models of modularized subcomponents and subassemblies.

15

8. An Internet-enabled method for designing and purchasing a laser scanning system, comprising the steps:

(a) hosting on an programmed Internet information server, a Website capable of supporting an interactive procedure; and

20

(b) using a client computer system having a Web browser program, to enable a prospective customer to transmit end-user scanning requirements of a particular application to said Website during said interactive procedure.

25

9. The Internet-enabled method of claim 8, which further comprises:

assigning a unique customer request number to end-user scanning requirements;

computing a price quotation (based thereon); and

transmitting said price quotation to said end-user or prospective customer of said laser scanning system.

5 10. The Internet-enabled method of claim 8, which further comprises:
using an electronic commerce server, for supporting secured electronic commerce transactions and enabling said prospective customer to electronically transmitt a purchase order on said designed laser scanning system.

10 11. The Internet-enabled method of claim 10, which further comprises:
enabling said customer to track the progress of said ordered laser scanning system during its various stages of manufacture (via a Website) maintained by said manufacturer.

15 12. The Internet-enabled method of claim 10, wherein said end-user scanning requirements are satisfied by a holographic laser scanning system design comprising models of modularized subcomponents and subassemblies.

20 13. A method of manufacturing a holographic laser scanning system comprises of modularized subcomponents and subassemblies, custom manufactured and/or configured using the Internet.

25 14. An Internet-based information serving system comprising:
an Internet information server hosting a Website including a plurality of HTML forms for supporting the specification, purchase, manufacture and delivery of custom-built laser scanning systems.

15. The Internet-based information serving system of claim 14, which further comprises:

5 a database system for supporting the generation of a model for a modularized laser-based scanning system designed in response to scanning requirements provided by an end-user.

16. The Internet-based information serving system of claim 14, which further comprises:

10 an electronic commerce server for supporting secured credit-card transactions for the purchasing of a designed laser scanning system on which a particular quote was computed and transmitted to said end-user.

17. A method of designing a laser scanning system comprising the steps:

15 (a) using a client computer system to access a manufacturer's Website and providing thereto a specification of the end-user's scanning requirements; and

(b) using said specification to generate a model of a laser scanning system which satisfies said end-user scanning requirements.

20 18. The method of claim 17, which further comprises:

(c) computing a price quote for a given quantity of said designed laser scanning system, and transmitting said price quote along with its terms and conditions to the prospective customer.

25 19. The method of claim 17, which further comprises:

providing said prospective customer with an access code enabling

the prospective customer to view a complete 3-D computer-graphic simulation of the designed laser scanning system, generated from the Manufacturer's Internet site and viewer by the prospective customer using a conventional browser program.

5

20. The method of claim 20, which further comprises:

providing said prospective customer with a CD ROM disc whereon is recorded a computer-graphic simulation of the scanner.

10

21. The method of claim 18, which further comprises:

purchasing said designed laser scanning system using an electronic commerce transaction.

15

22. A system for designing a laser scanning system comprising the steps:

an Internet information server for hosting a Website; and
a client computer system for accessing said Website and providing thereto a specification of the end-user's scanning requirements;

20

wherein said Internet information server uses said specification to generate a model of a laser scanning system which satisfies said end-user scanning requirements.

23. The system of claim 22, which further comprises:

25

means for computing a price quote for a given quantity of said designed laser scanning system, and transmitting said price quote along with its terms and conditions to the prospective customer.

24. The system of claim 22, which further comprises:

means for providing said prospective customer with an access code enabling the prospective customer to view a complete 3-D computer-graphic simulation of the designed laser scanning system, generated from the Manufacturer's Internet site and viewer by the prospective customer using a conventional browser program.

25. The system of claim 22, which further comprises:

means for providing said prospective customer with a CD ROM disc whereon is recorded a computer-graphic simulation of the scanner.

26. The system of claim 22, which further comprises:

means for purchasing said designed laser scanning system using an electronic commerce transaction.

27. A holographic laser scanner of modular construction comprising:

an optical-bench/housing module including as subcomponents, an optical bench, a wrap-around case and a housing cover with output scanning window;

a holographic scanning-disc/photodetector module including as subcomponents, a holographic laser scanning disc, a scanning motor, one or more photodetector/signal processing boards, and a motor/board mounting assembly;

a plurality of scanning station modules each including, as subcomponents, a laser beam production module, a base plate for mounting said laser beam production module, an output beam folding mirror and an adjustable support bracket; and

a digital signal processing and I/O module including, as subcomponents, a CPU motherboard with one or more CPUs, and an I/O

circuitry.

28. The holographic laser scanner of claim 27, wherein said optical-bench has a first set of preformed holes for receiving the ends of support posts associated with said motor/board mounting assembly, and a second set of preformed holes for jointly mounting said base plate and said adjustable support bracket.

29. The holographic laser scanner of claim 27, wherein said housing cover is generally matched with said optical bench, and is designed to be used with a variety of wrap-around cases of different heights.

30. The holographic laser scanner of claim 27, wherein said adjustable support bracket allows the tilt angle of said output beam folding mirror to be adjusted over a range of angles to achieve a desired laser scanning pattern.

31. A system for designing and manufacturing holographic laser scanners of modular construction, comprising:

a first database management system for storing and managing information models relating to the inventory of the modules and subcomponents of modularized holographic laser scanners;

a holographic scanner design computer (HSD) work station for designing holographic laser scanners of modular construction, and producing information models for the modules and subcomponents thereof;

a second database management system for storing and managing

subcomponents obtained from said HSD work stations;

a manufacturing system for manufacturing said holographic laser scanners of modular construction; and

an information server for storing and serving the information models maintained by said first and second database management systems so that said HSD work station and said manufacturing system can access such information models as needed.

32. A method of designing and manufacturing holographic laser scanners comprising the steps of:

(a) creating a first relational database model for constructed modules and subcomponents of holographic laser scanners available in inventory;

(b) creating a second relational database model for modules and subcomponent designs that have been previously created during the design of other holographic laser scanners;

(c) storing said first and second relational database models in an information server;

(d) designing a holographic laser scanner using inventory and design information stored in the information server;

(e) updating said second relational database model using the information obtained during step (d);

(f) manufacturing modules and subcomponents using the information contained during step (d)

(g) updating said inventory; and

(h) constructing a holographic laser scanner according the information obtained during step (d).

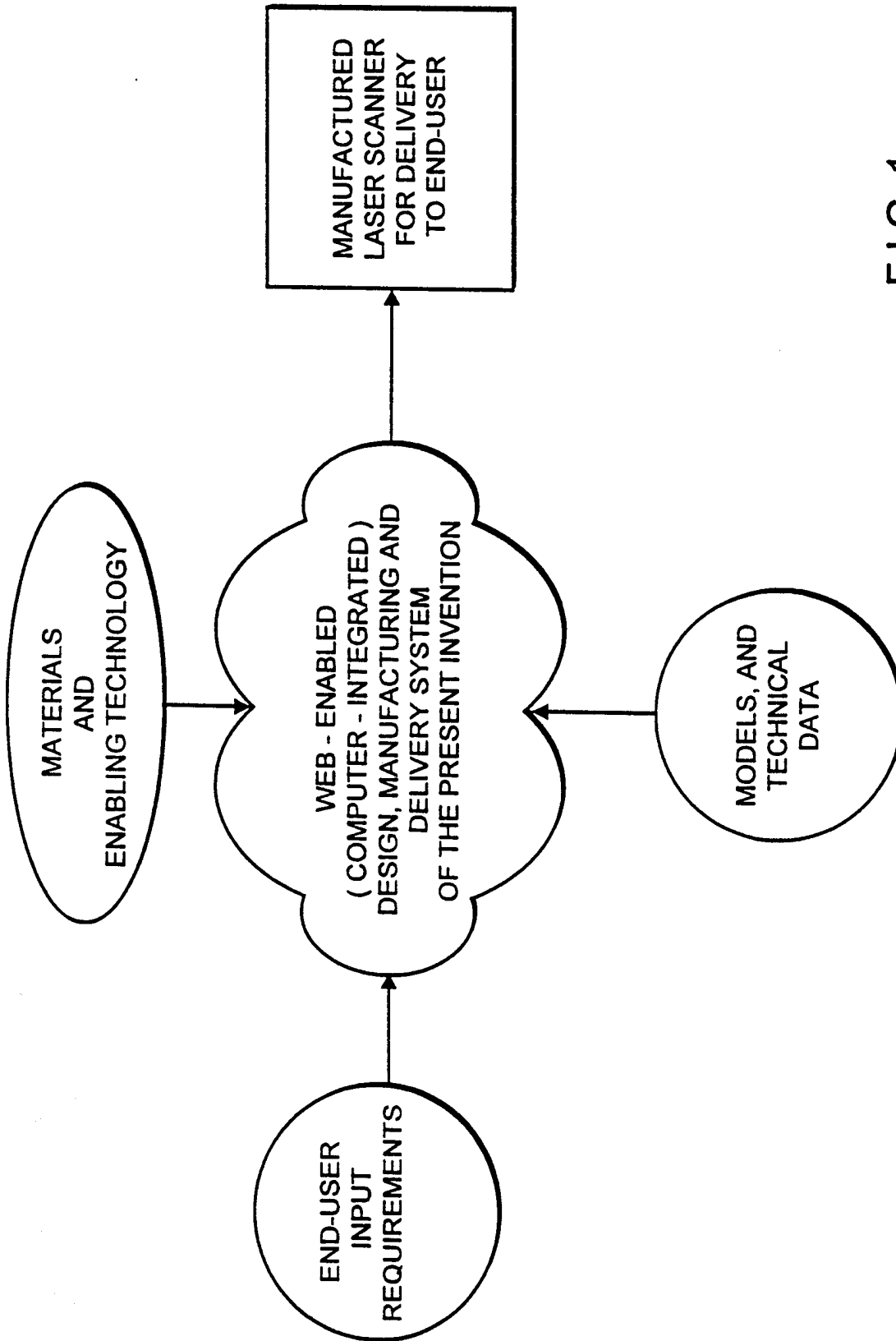

FIG.1

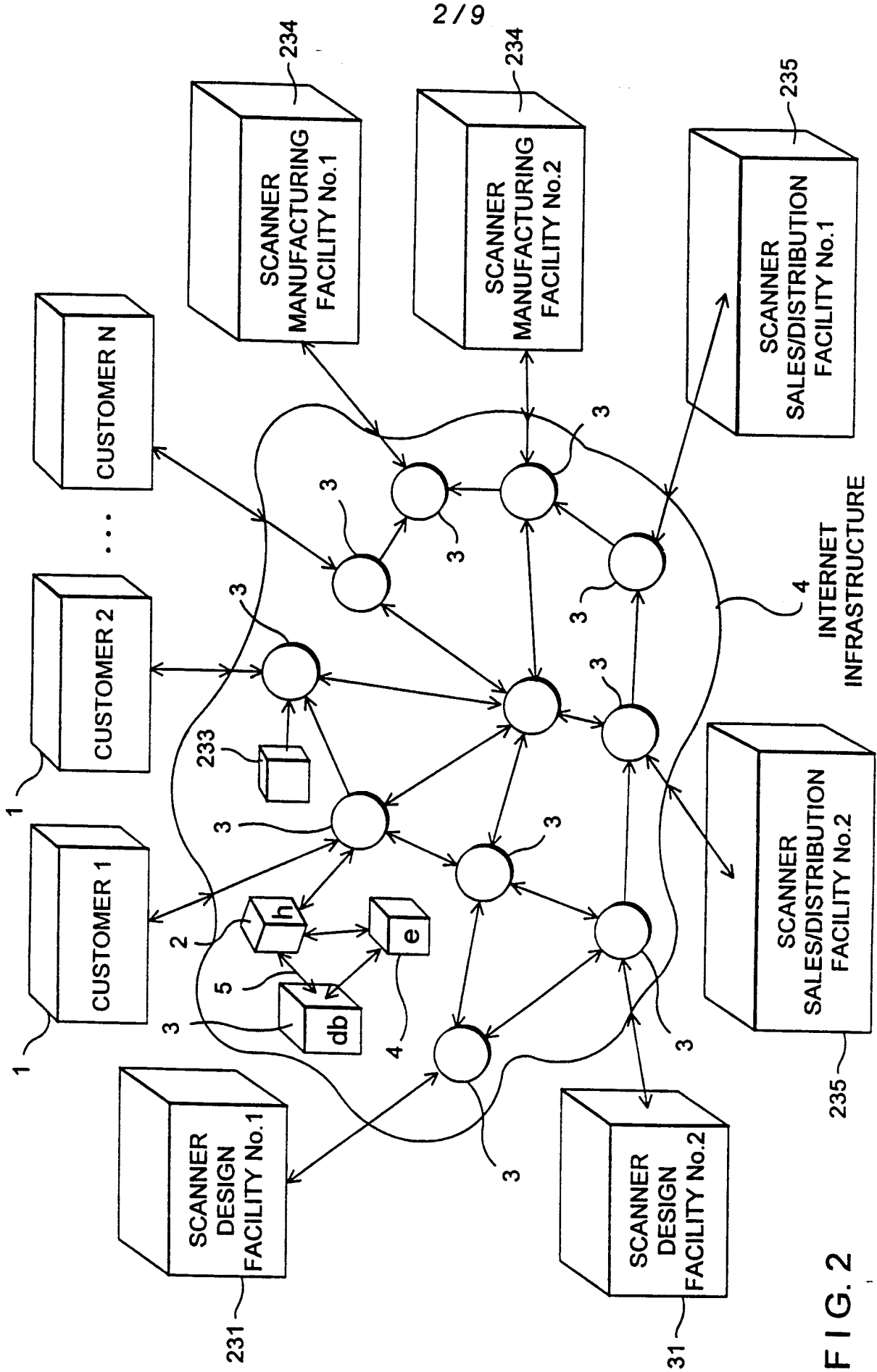

FIG. 2

3 / 9

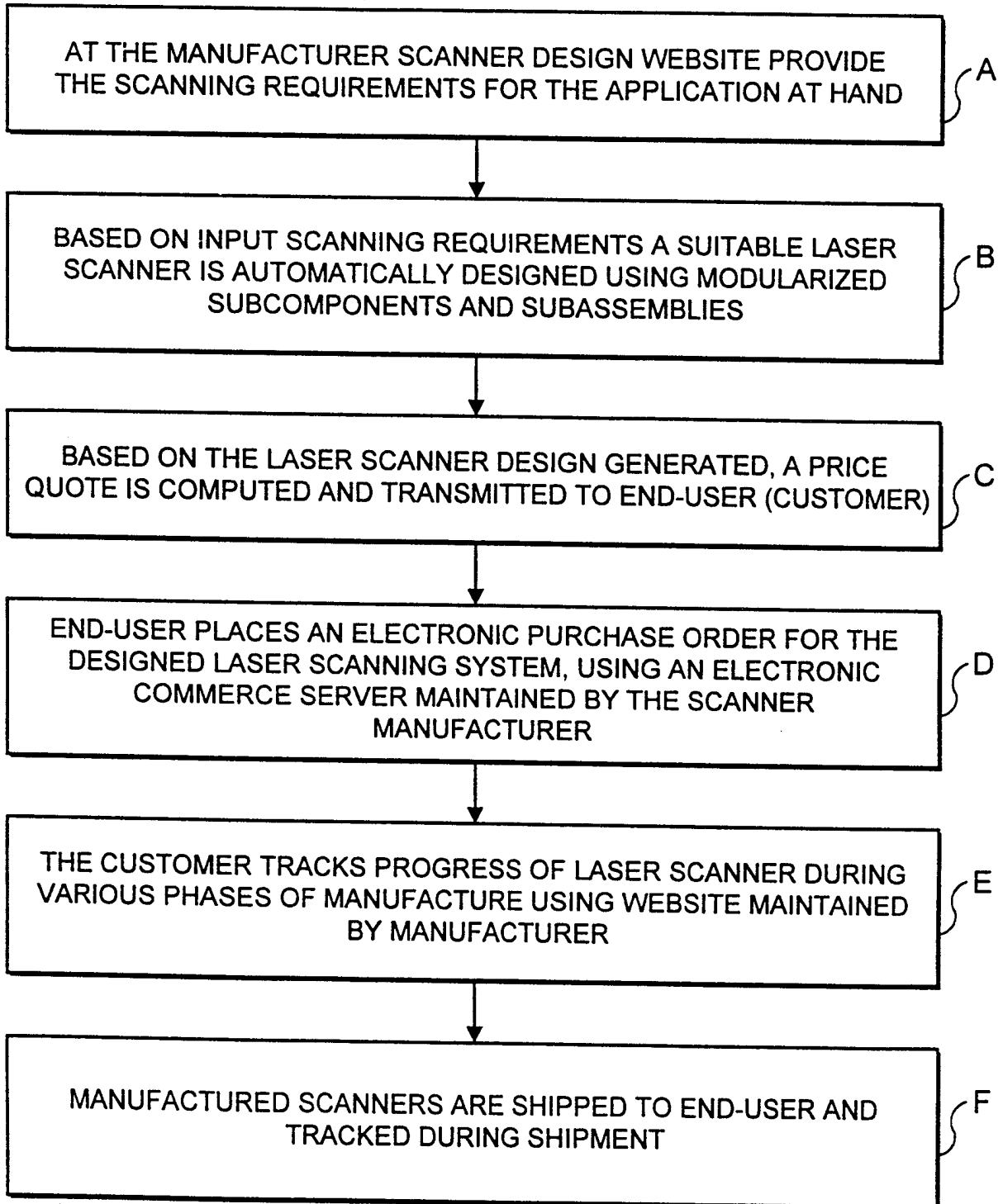

FIG. 3

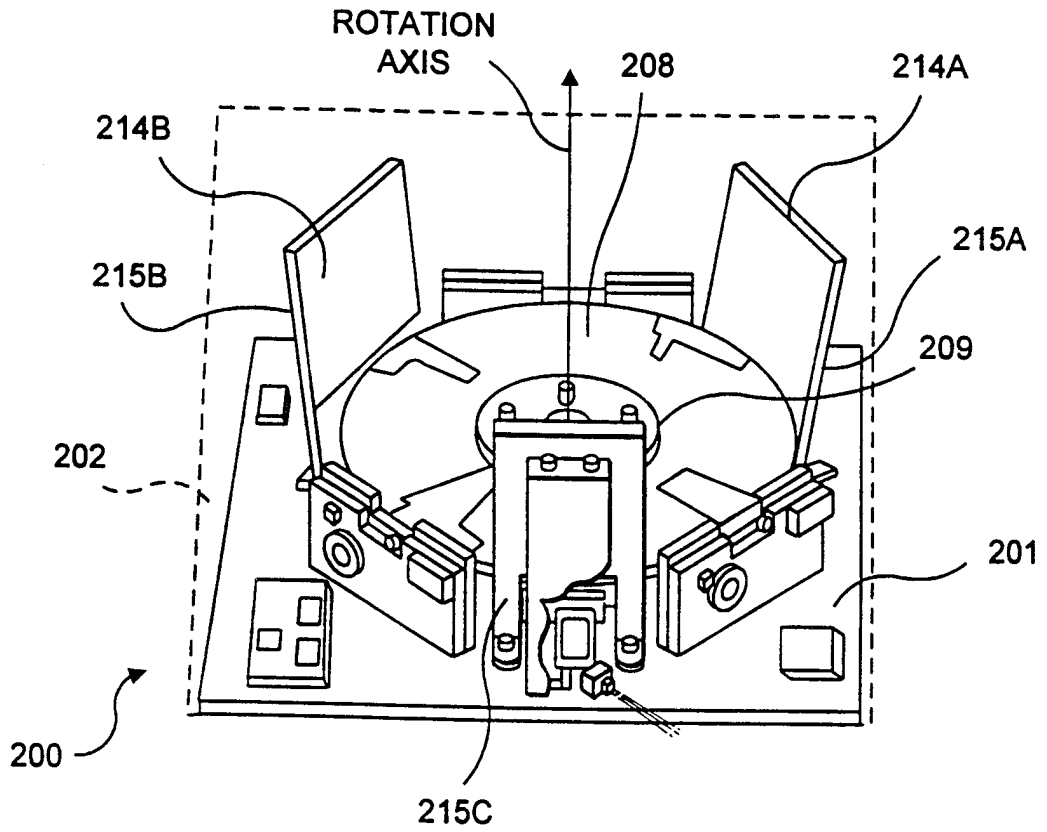

FIG. 4

5/9

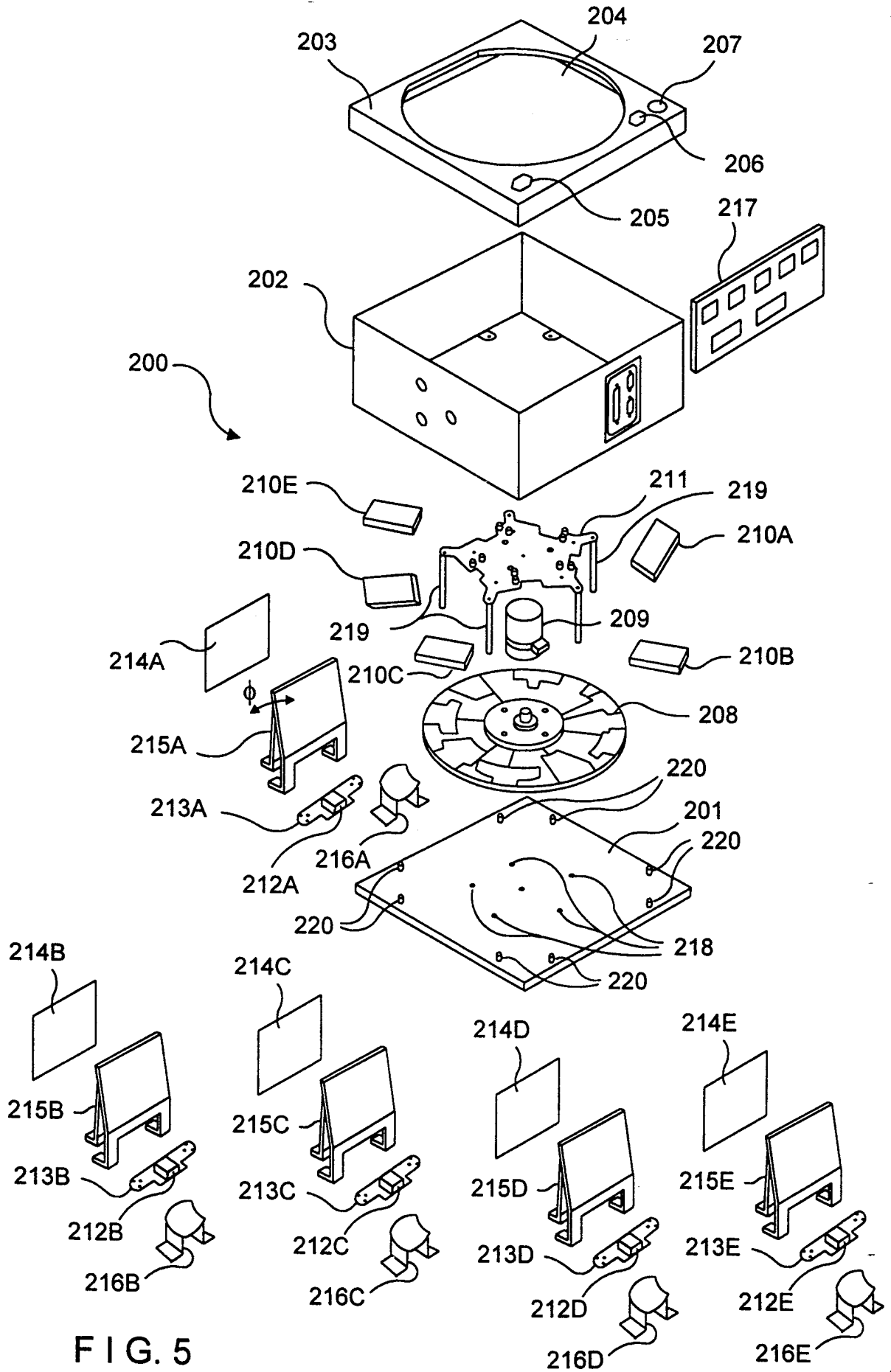

FIG. 5

6/9

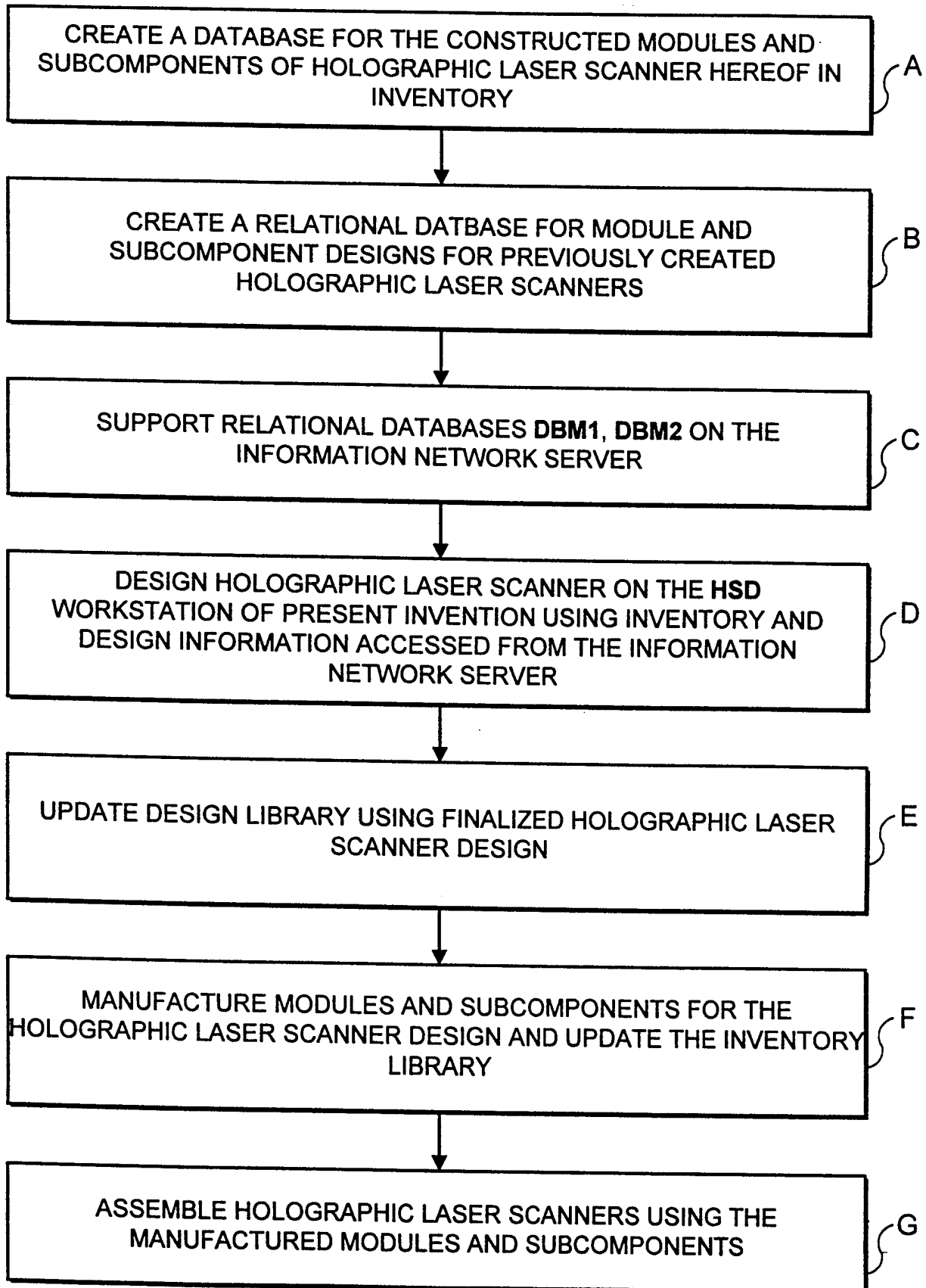

FIG. 6

SUBSTITUTE SHEET (RULE 26)

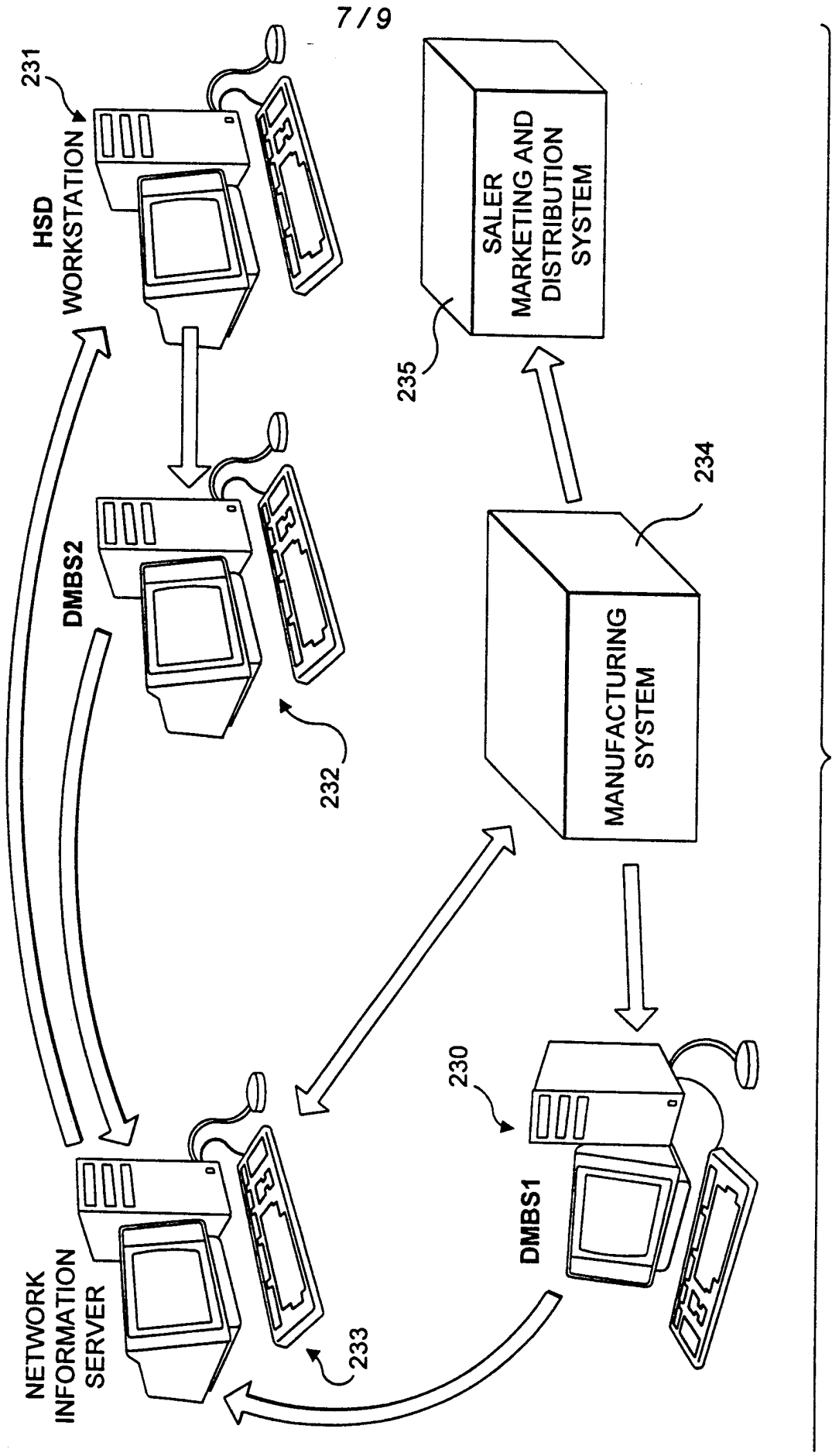

FIG. 7

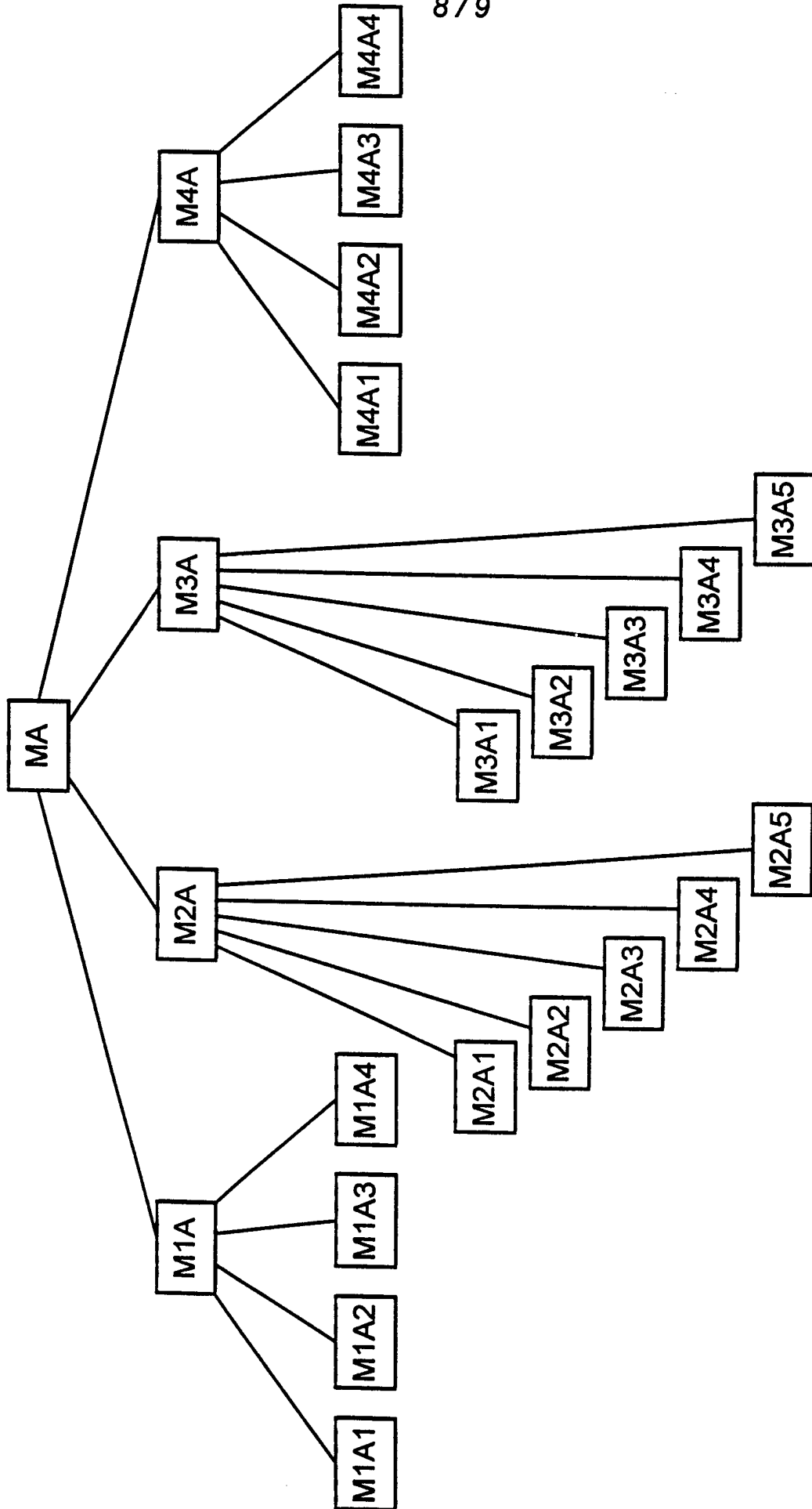

FIG. 8

MODULES AND SUBCOMPONENTS FOR HOLOGRAPHIC LASER SCANNER DESIGN "A"				
MODULES	M1A OPTICAL BENCH / HOUSING MODULE	M2A HOLOGRAPHIC SCANNING DISC/ PHOTODETECTOR MODULE	M3A SCANNING STATION MODULE	M4A CPU BOARD/ POWER SUPPLY MODULE
SUBCOMPONENTS	M1A1 OPTICAL BENCH	M2A1 SCANNING DISC PLATES (8.6")	M3A1 SCANNING STATION SUPPORT FIXTURE	M4A1 CPU MOTHER-BOARD
	M1A2 HOUSING COVER	M2A2 SCANNER MOTOR	M3A2 BEAM FOLDING MIRROR	M4A2 POWER SUPPLY MODULE
	M1A3 HOUSING SIDE WALLS	M2A3 MOTOR SUPPORT FIXTURE	M3A3 PARABOLIC LIGHT COLLECTING MIRROR	M4A3 WIRE HARNESSSES
		M2A4 PHOTODETECTOR BOARDS (3)	M3A4 LASER BEAM PRODUCTION MODULE	
		M2A5 PHOTODETECTOR COVER PLATE	M3A5 ANALOG SIGNAL PROCESSING BOARD	

FIG. 9

INTERNATIONAL SEARCH REPORT

International application No.
PCT/US98/09692

A. CLASSIFICATION OF SUBJECT MATTER IPC(6) : G06K 07/10, 19/06 US CL : 235/ 462, 472, 454, 375, 469, 470, 494 According to International Patent Classification (IPC) or to both national classification and IPC		
B. FIELDS SEARCHED Minimum documentation searched (classification system followed by classification symbols) U.S. : 235/ 462, 472, 454, 375, 469, 470, 494 Documentation searched other than minimum documentation to the extent that such documents are included in the fields searched NONE Electronic data base consulted during the international search (name of data base and, where practicable, search terms used) NONE		
C. DOCUMENTS CONSIDERED TO BE RELEVANT		
Category*	Citation of document, with indication, where appropriate, of the relevant passages	Relevant to claim No.
Y	US 5,763,863 A (Grosfeld et al.) 09 June 1998 (09/06/98), the entire reference	1-32
Y	US 5,581,067 A (Grosfeld et al) 03 December 1996 (03/12/96), the entire reference	1-32
Y	US 4,675,531 A (Clark et al.) 23 June 1987 (23/06/87), the entire reference	1-32
<input type="checkbox"/> Further documents are listed in the continuation of Box C. <input type="checkbox"/> See patent family annex.		
* "A" "E" "L" "O" "P"	Special categories of cited documents: document defining the general state of the art which is not considered to be of particular relevance earlier document published on or after the international filing date document which may throw doubts on priority claim(s) or which is cited to establish the publication date of another citation or other special reason (as specified) document referring to an oral disclosure, use, exhibition or other means document published prior to the international filing date but later than the priority date claimed	"T" "X" "Y" "&" later document published after the international filing date or priority date and not in conflict with the application but cited to understand the principle or theory underlying the invention document of particular relevance; the claimed invention cannot be considered novel or cannot be considered to involve an inventive step when the document is taken alone document of particular relevance; the claimed invention cannot be considered to involve an inventive step when the document is combined with one or more other such documents, such combination being obvious to a person skilled in the art document member of the same patent family
Date of the actual completion of the international search	Date of mailing of the international search report	
24 JUNE 1998	<div style="font-size: 2em; font-weight: bold; margin: 0;">08 SEP 1998</div>	
Name and mailing address of the ISA/US Commissioner of Patents and Trademarks Box PCT Washington, D.C. 20231 Facsimile No. (703) 305-3230	Authorized officer for THIEN LE <i>Mary C. Kelly</i> Telephone No. (703) 305-3500	