



(51) International Patent Classification:
A61B 18/14 (2006.01)

(21) International Application Number:
PCT/US2016/025849

(22) International Filing Date:
4 April 2016 (04.04.2016)

(25) Filing Language: English

(26) Publication Language: English

(71) Applicant: GYRUS ACMI, INC., D.B.A. OLYMPUS SURGICAL TECHNOLOGIES AMERICA [US/US]; 136 Turnpike Road, Southborough, MA 01772 (US).

(72) Inventors; and

(71) Applicants : BLUS, Theodore, C. [US/US]; 923 Monterey Ct. N., Shoreview, MN 55126 (US). LIM, Jyue, Boon [US/US]; 558 Continental Dr., New Brighton, MN 55112 (US). BATCHELOR, Kester, J. [GB/US]; 2933 Cambridge Lane, Mound, MN 55364 (US).

(74) Agent: CARD, John, M.; Vivacqua Law, PLLC, 3101 East Eisenhower Parkway, Suite 1, Ann Arbor, MI 48108 (US).

(81) Designated States (unless otherwise indicated, for every kind of national protection available): AE, AG, AL, AM, AO, AT, AU, AZ, BA, BB, BG, BH, BN, BR, BW, BY, BZ, CA, CH, CL, CN, CO, CR, CU, CZ, DE, DK, DM, DO, DZ, EC, EE, EG, ES, FI, GB, GD, GE, GH, GM, GT, HN, HR, HU, ID, IL, IN, IR, IS, JP, KE, KG, KN, KP, KR, KZ, LA, LC, LK, LR, LS, LU, LY, MA, MD, ME, MG, MK, MN, MW, MX, MY, MZ, NA, NG, NI, NO, NZ, OM, PA, PE, PG, PH, PL, PT, QA, RO, RS, RU, RW, SA, SC, SD, SE, SG, SK, SL, SM, ST, SV, SY, TH, TJ, TM, TN, TR, TT, TZ, UA, UG, US, UZ, VC, VN, ZA, ZM, ZW.

(84) Designated States (unless otherwise indicated, for every kind of regional protection available): ARIPO (BW, GH, GM, KE, LR, LS, MW, MZ, NA, RW, SD, SL, ST, SZ, TZ, UG, ZM, ZW), Eurasian (AM, AZ, BY, KG, KZ, RU, TJ, TM), European (AL, AT, BE, BG, CH, CY, CZ, DE, DK, EE, ES, FI, FR, GB, GR, HR, HU, IE, IS, IT, LT, LU, LV, MC, MK, MT, NL, NO, PL, PT, RO, RS, SE, SI, SK, SM, TR), OAPI (BF, BJ, CF, CG, CI, CM, GA, GN, GQ, GW, KM, ML, MR, NE, SN, TD, TG).

Published:

— with international search report (Art. 21(3))

WO 2017/176240 A1

(54) Title: AN ELECTROSURGICAL ILLUMINATING INSTRUMENT

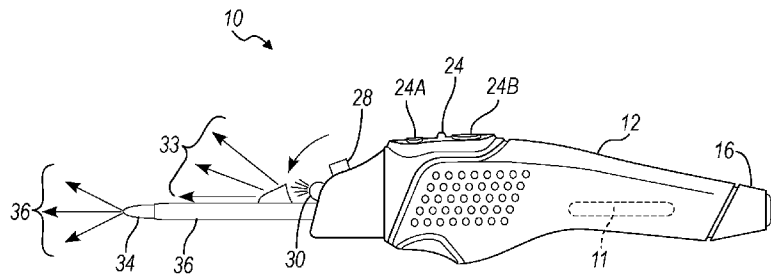

FIG. 2

(57) Abstract: An electrosurgical instrument includes a light source, a first conductor, a second conductor, an insulation material positioned between the first conductor and the second conductor, and a light pipe that carries light from the light source to the insulation material.

AN ELECTROSURGICAL ILLUMINATING INSTRUMENT

FIELD

[0001] The present disclosure relates to an electrosurgical instrument. More specifically, the present disclosure relates to an electrosurgical illuminating instrument.

BACKGROUND

[0002] The statements in this section merely provide background information related to the present disclosure and may or may not constitute prior art.

[0003] Electrosurgical illuminating instruments have become widely employed by medical professionals in recent years. A number of electrosurgical illuminating instruments have been developed whereby an active electrode is attached to an insulated handle and a high frequency current is applied thereto. Accordingly, electrosurgical illuminating instruments are used by medical professionals in various types of surgical procedures. A common surgical procedure involves cauterizing a patient's tissue. Typically, cauterizing is employed to sterilize and cut tissue as well as to kill certain tissue that has been infected with disease such as cancer and the like. To accurately perform the surgical procedure, the medical professional needs to be able to illuminate and view the local tissue area to be cauterized. Thus, it is imperative that adequate lighting be provided to the affected regions during the surgical procedure. Overhead surgery room lighting, however, is rarely sufficient. Accordingly, various types of supplemental lighting equipment have been developed that suits different medical illumination requirements, for example, the incorporation of a lighting source to a surgical instrument.

[0004] Most existing surgical light sources involve fiber optic cable or bundles that are permanently attached to a particular surgical instrument with one end of the fiber optic cable or bundle connected to a source of illumination.

These types of surgical instrument lights are disclosed in U.S. Pat. Nos. 6,585,727; 5,376,087; and 4,688,569. Such instruments, however, are cumbersome to manufacture and to use in a surgery room setting.

[0005] Accordingly, there is need for a surgical instrument that incorporates an effective light source.

SUMMARY

[0006] The present invention provides an electrosurgical illuminating instrument.

[0007] Accordingly, pursuant to one aspect of the present invention, an electrosurgical instrument includes a light source, a first conductor, a second conductor, an insulation material positioned between the first conductor and the second conductor, and a light pipe that carries light from the light source to the insulation material.

[0008] Accordingly, pursuant to another aspect of the present invention, an electrosurgical instrument includes a light source, a first conductor, a second conductor, and an insulation material positioned between the first conductor and the second conductor, the insulation material being a light pipe that carries light from the light source.

[0009] The above aspects of the present invention can be further characterized by one or any combination of the features described herein, such as: the insulation material is translucent, transparent or both translucent and transparent; a portion of the insulation material is opaque; a handpiece, the light source being positioned in the handpiece; an extension with a proximal end and a distal end, the proximal end of the extension being connected to the handpiece, the first conductor and the second conductor being positioned at the distal end of the extension; the first conductor, the second conductor and the insulation material are configured to illuminate a surgical site; the insulation material has an exterior surface that transmits the incident light; the surface that transmits the incident light is located at the distal ends of the first and second conductors, the lateral sides of the first and second conductors, or both the distal ends and the

lateral sides of the first and second conductors; the first conductor, the second conductor and the insulation material are configured to display an instrument state of the electrosurgical instrument; the electrosurgical instrument is capable of delivering a therapy current between the first conductor and the second conductor; the insulation material has a frosted surface to diffuse the light; at least of a portion of the insulation material is an indicator that displays an instrument state of the electrosurgical instrument; the insulation material is made from a material selected from a group consisting of ceramic, silicon rubber, glass, and titanium dioxide; the light source is an LED; and the first conductor is a first electrode and the second conductor is a second electrode.

[0010] Accordingly, pursuant to another aspect of the present invention, an electrosurgical instrument includes a handpiece, a surgical end, a light source positioned in the handpiece, and a light pipe with a proximal end and distal end. The proximal end of the light pipe selectively engages optically with the light source to transmit light to the distal end of the light pipe such that light is transmitted to the surgical end which converts from wide illumination to tip illumination of a surgical site.

[0011] This aspect of the present invention can be further characterized by one or any combination of the features described herein, such as: the surgical end includes a first electrode, a second electrode, and an insulation layer positioned between the first electrode and the second electrode; the light pipe transmits light from the light source to the insulation layer; the insulation material is translucent, transparent or both translucent and transparent; a portion of the insulation material is opaque; the first conductor, the second conductor, and the insulation material are configured to display an instrument state of the electrosurgical instrument; the insulation material has a frosted surface to diffuse the light; the insulation material is made from a material selected from a group consisting of ceramic, silicon rubber, glass, and titanium dioxide; the light source is an LED.

[0012] Accordingly, pursuant to yet another aspect of the present invention, an electrosurgical instrument includes a handpiece, a light source

positioned in the handpiece, a surgical end with a first electrode, a second electrode, and an insulation material positioned between the first electrode and the second electrode; and a light pipe that carries light from the light source to the insulation material.

[0013] This aspect of the present invention can be further characterized by one or any combination of the features described herein, such as: the light pipe has a proximal end and distal end, the proximal end of the light pipe selectively engaging optically with the light source to transmit light to the distal end of the light pipe such that light is transmitted to the surgical end which converts from wide illumination to tip illumination of a surgical site; the insulation material is translucent, transparent or both translucent and transparent; a portion of the insulation material is opaque; an extension with a proximal end and a distal end, the proximal end of the extension being connected to the handpiece, the first electrode and the second electrode being positioned at the distal end of the extension; the first electrode, the second electrode and the insulation material are configured to illuminate a surgical site; the first electrode, the second electrode and the insulation material are configured to display an instrument state of the electrosurgical instrument; the insulation material has a frosted surface to diffuse the light; the insulation material is made from a material selected from a group consisting of ceramic, silicon rubber, glass, and titanium dioxide; and the light source is an LED.

[0014] Further features, advantages, and areas of applicability will become apparent from the description provided herein. It should be understood that the description and specific examples are intended for purposes of illustration only and are not intended to limit the scope of the present disclosure.

DRAWINGS

[0015] The drawings described herein are for illustration purposes only and are not intended to limit the scope of the present disclosure in any way. The components in the figures are not necessarily to scale, emphasis instead being placed upon illustrating the principles of the invention. In the drawings:

[0016] FIG. 1 is a perspective view of an electrosurgical illuminating instrument in accordance with the principles of the present invention;

[0017] FIG. 2 is a side view of the electrosurgical illuminating instrument; and

[0018] FIG. 3 is a close-up view of a distal end of the electrosurgical illuminating instrument.

DETAILED DESCRIPTION

[0019] The following description is merely exemplary in nature and is not intended to limit the present disclosure, application, or uses.

[0020] With reference to FIG. 1, an electrosurgical illuminating instrument embodying the principles of the present invention is illustrated therein and designated at 10. The electrosurgical illuminating instrument 10 is self-powered by one or more batteries 11 or receives electrical energy from an electrical energy source 20, or is powered by both the batteries 11 and the electrical energy source 20. The proximal end 16 of the electrosurgical illuminating instrument 10 includes a connector 17 that connects the electrosurgical illuminating instrument 10 to the energy source 20 with a lead 18.

[0021] The electrosurgical illuminating instrument 10 includes a main body 12, a light pipe 26, a light source 30, and a directing light cover 32. The light source 30 can be any suitable light source, such as, for example, one or more LEDs. If more than one LED is employed, the LEDs can be multicolored. In various arrangements, the light pipe 26 is a bundle of fiber optics.

[0022] The electrosurgical illuminating instrument 10 further includes a switch 24 that turns the electrosurgical illuminating instrument 10 on and off. For example, in a particular arrangement the switch includes a first switch 24a that turns the light source 30 on and off and a second switch 24b that activates the energy source 20 to deliver RF electrical energy to a distal end 34 of the electrosurgical illuminating instrument 10. In particular arrangements, the one or more batteries 11 provides electrical energy to the light source 30 and the energy

source 20 provides RF electrical energy to the distal end 34 to treat tissue in proximity of the distal end 34.

[0023] The electrosurgical illuminating instrument 10 also includes a button 28 that toggles the electrosurgical illuminating instrument 10 from wide illumination of the surgical site to narrow illumination of the site from the distal end 34 of the electrosurgical illuminating instrument 10. More specifically, when the button 28 is in the wide illumination position, the light source 30 is uncovered by the light cover 32 to provide wide illumination of the surgical site as indicated by the arrows 33, and when the button 28 is in the narrow illumination position, the light source 30 rotates downward towards the light cover 32 such that the light cover 32 directs light from the light source 30 to the distal end 34 through the light pipe 26 to provide localized illumination (as indicated by the arrows 36) at the surgical site. Accordingly, a medical professional is able to illuminate and view local tissue to be treated to accurately perform a surgical procedure with the electrosurgical illuminating instrument 10. Further, the electrosurgical illuminating instrument 10 meets the strict waterproofing and sanitizing requirements of a surgery room.

[0024] Referring now to FIG. 3, the distal end 34 of the electrosurgical illuminating instrument 10 is shown in greater detail. As described above the distal end 34 receives light from the light pipe 26. Hence, the distal end 34 can be a second light pipe that optically communicates with the light pipe 26 or an extension of the light pipe 26. The distal end 34 of the electrosurgical illuminating instrument 10 includes a first conductor 36, a second conductor 38, and an insulation material 40, 42 positioned between the first conductor 36 and 38. In some arrangements, the insulation material 40, 42 can be a single piece of insulation material or in other arrangements the insulation material 40, 42 can include a portion separated by a spacer 44.

[0025] In various arrangements, the insulation material 40, 42 is translucent, whereas in other arrangements the insulation material 40, 42 is transparent. In particular arrangements, the insulation material includes a transparent portion and a translucent portion. Some portion or portions of the

insulation material 40, 42 may be opaque so that light is not transmitted from the opaque portions. All or a portion of the insulation material 40, 42 may be frosted to diffuse the light.

[0026] The insulation material can be made from any suitable material, such as, for example, ceramic, silicone rubber, glass, or titanium dioxide, or any combination of these materials.

[0027] The first conductor 36 and the second conductor 38 can operate as bipolar electrodes of the electrosurgical illumination instrument 10. In such arrangements, the first and second conductors receive RF electrical energy from, for example, the energy source 20 such that a voltage potential is generated between the first conductor 36 and the second conductor 38, which causes a current to pass from one conductor to the other through tissue being treated by the electrosurgical illuminating instrument 10. This current heats the tissue to coagulate or cauterize the tissue depending on the amount of RF energy supplied to the conductors 36 and 38.

[0028] In some arrangements, a portion of the insulation material 40, 42 acts as an indicator to provide visual feedback to the medical profession about the instrument state of the electrosurgical illuminating instrument 10. For example, the color of the light can change from one color to another color after a particular procedure (such as coagulation or cauterization of tissue) is completed. In particular arrangements, the light source 30 is configured to blink, for example, at different frequencies, to indicate various instrument states of the electrosurgical illuminating instrument 10.

[0029] The description of the invention is merely exemplary in nature and variations that do not depart from the gist of the invention are intended to be within the scope of the invention. Such variations are not to be regarded as a departure from the spirit and scope of the invention.

CLAIMS

What is claimed is:

1. An electrosurgical instrument comprising:
a light source;
a first conductor;
a second conductor;
an insulation material positioned between the first conductor and the second conductor; and
a light pipe that carries light from the light source to the insulation material.
2. An electrosurgical instrument comprising:
a light source;
a first conductor;
a second conductor; and
an insulation material positioned between the first conductor and the second conductor, the insulation material being a light pipe that carries light from the light source.
3. The electrosurgical instrument of claim 1 or 2 wherein the insulation material is translucent, transparent or both translucent and transparent.
4. The electrosurgical instrument of claim 3 wherein a portion of the insulation material is opaque.
5. The electrosurgical instrument of claim 1 or 2 further comprising a handpiece, the light source being positioned in the handpiece.
6. The electrosurgical instrument of claim 5 further comprising an extension with a proximal end and a distal end, the proximal end of the extension being

connected to the handpiece, the first conductor and the second conductor being positioned at the distal end of the extension.

7. The electrosurgical instrument of claim 6 wherein the first conductor, the second conductor and the insulation material are configured to illuminate a surgical site.

8. The electrosurgical instrument of claim 7 wherein the insulation material has an exterior surface that transmits the incident light.

9 The electrosurgical instrument of claim 8 wherein the surface that transmits the incident light is located at the distal ends of the first and second conductors, the lateral sides of the first and second conductors, or both the distal ends and the lateral sides of the first and second conductors.

10. The electrosurgical instrument of claim 6 wherein the first conductor, the second conductor and the insulation material are configured to display a instrument state of the electrosurgical instrument.

11. The electrosurgical instrument of claim 1 or 2 wherein the electrosurgical instrument is capable of delivering a therapy current between the first conductor and the second conductor.

12. The electrosurgical instrument of claim 1 or 2 wherein the insulation material has a frosted surface to diffuse the light.

13. The electrosurgical instrument of claim 12 wherein at least of a portion of the insulation material is an indicator that displays an instrument state of the electrosurgical instrument.

14. The electrosurgical instrument of claim 1 or 2 wherein the insulation material is made from a material selected from a group consisting of ceramic, silicon rubber, glass, and titanium dioxide.
15. The electrosurgical instrument of claim 1 or 2 wherein the light source is an LED.
16. The electrosurgical instrument of claim 1 or 2 wherein the first conductor is a first electrode and the second conductor is a second electrode.
17. An electrosurgical instrument comprising:
 - a handpiece;
 - a surgical end;
 - a light source positioned in the handpiece; and
 - a light pipe with a proximal end and distal end, the proximal end of the light pipe selectively engaging optically with the light source to transmit light to the distal end of the light pipe such that light is transmitted to the surgical end which converts from wide illumination to tip illumination of a surgical site.
18. The electrosurgical instrument of claim 17 wherein the surgical end includes a first electrode, a second electrode, and an insulation layer positioned between the first electrode and the second electrode.
19. The electrosurgical instrument of claim 18 wherein the light pipe transmits light from the light source to the insulation layer.
20. The electrosurgical instrument of claim 17 wherein the insulation material is translucent, transparent or both translucent and transparent.
21. The electrosurgical instrument of claim 17 wherein a portion of the insulation material is opaque.

22. The electrosurgical instrument of claim 17 wherein the first conductor, the second conductor, and the insulation material are configured to display an instrument state of the electrosurgical instrument.
23. The electrosurgical instrument of claim 17 wherein the insulation material has a frosted surface to diffuse the light.
24. The electrosurgical instrument of claim 17 wherein the insulation material is made from a material selected from a group consisting of ceramic, silicon rubber, glass, and titanium dioxide.
25. The electrosurgical instrument of claim 17 wherein the light source is an LED.
26. An electrosurgical instrument comprising:
a handpiece;
a light source positioned in the handpiece;
a surgical end with a first electrode, a second electrode, and an insulation material positioned between the first electrode and the second electrode; and
a light pipe that carries light from the light source to the insulation material.
27. The electrosurgical instrument of claim 26 wherein the light pipe has a proximal end and distal end, the proximal end of the light pipe selectively engaging optically with the light source to transmit light to the distal end of the light pipe such that light is transmitted to the surgical end which converts from wide illumination to tip illumination of a surgical site.
28. The electrosurgical instrument of claim 26 wherein the insulation material is translucent, transparent or both translucent and transparent.

29. The electrosurgical instrument of claim 26 wherein a portion of the insulation material is opaque.

30. The electrosurgical instrument of claim 26 further comprising an extension with a proximal end and a distal end, the proximal end of the extension being connected to the handpiece, the first electrode and the second electrode being positioned at the distal end of the extension.

31. The electrosurgical instrument of claim 26 wherein the first electrode, the second electrode and the insulation material are configured to illuminate a surgical site.

32. The electrosurgical instrument of claim 26 wherein the first electrode, the second electrode and the insulation material are configured to display an instrument state of the electrosurgical instrument.

33. The electrosurgical instrument of claim 26 wherein the insulation material has a frosted surface to diffuse the light.

34. The electrosurgical instrument of claim 26 wherein the insulation material is made from a material selected from a group consisting of ceramic, silicon rubber, glass, and titanium dioxide.

35. The electrosurgical instrument of claim 26 wherein the light source is an LED.

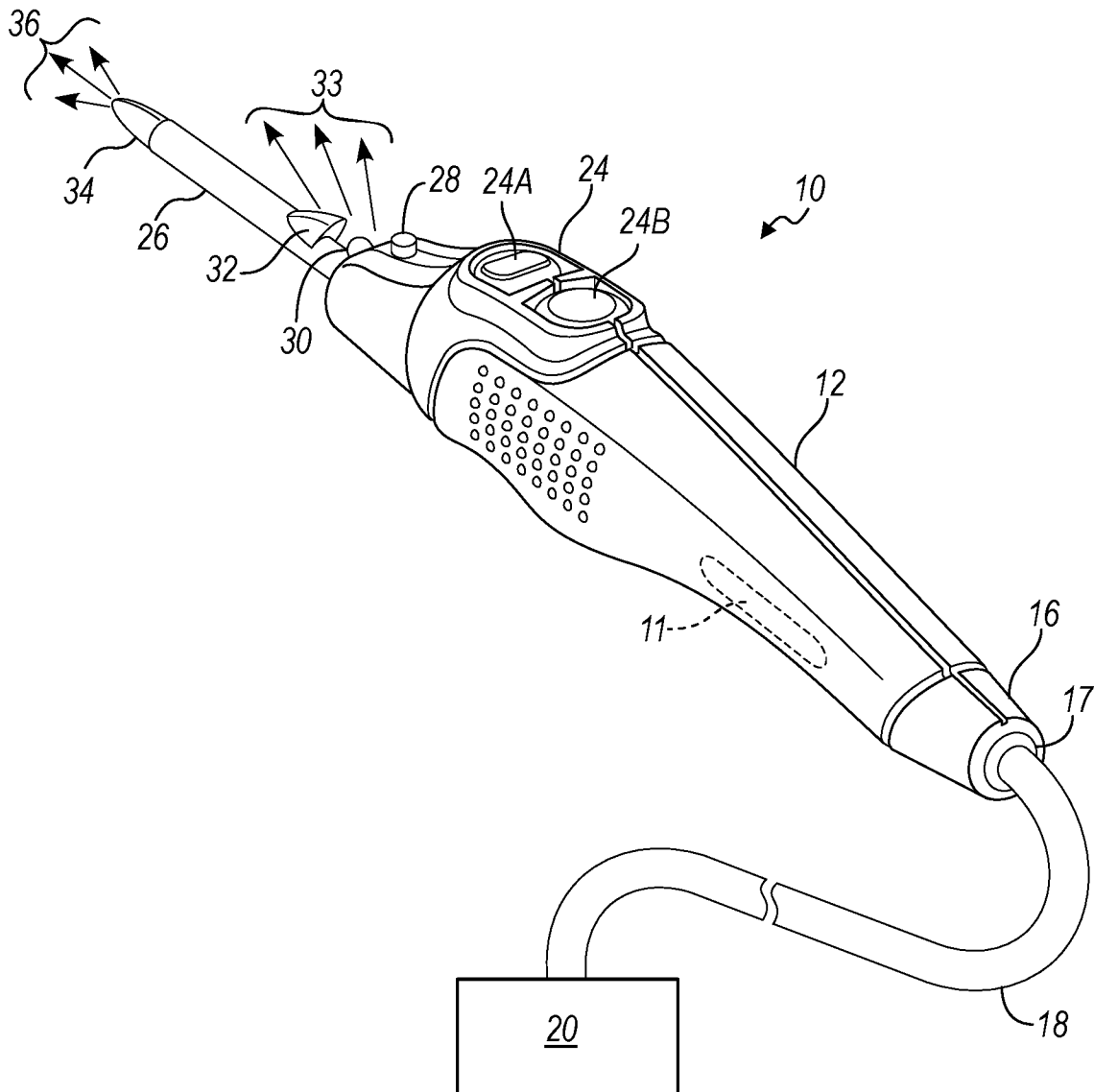

FIG. 1

2/2

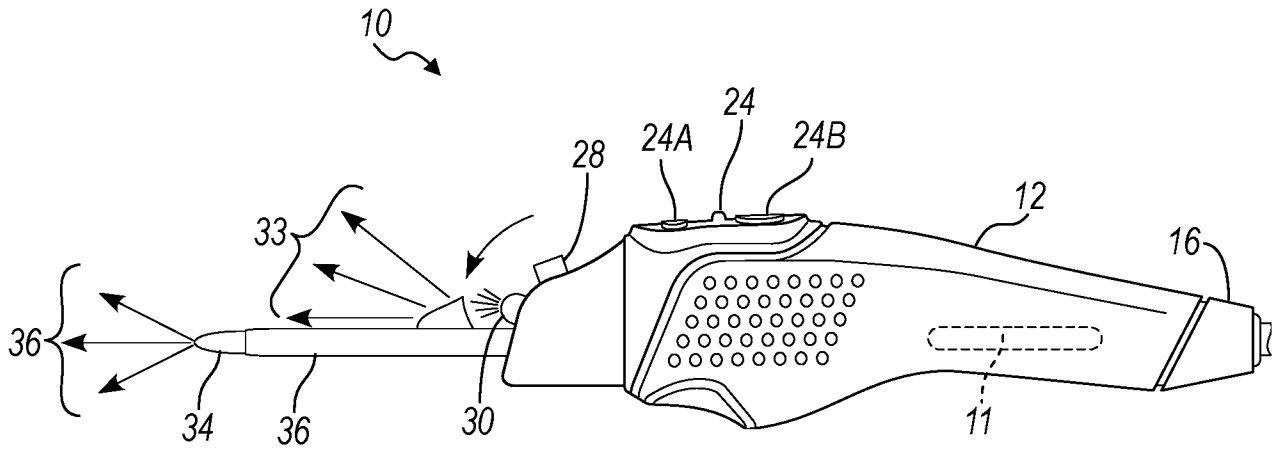

FIG. 2

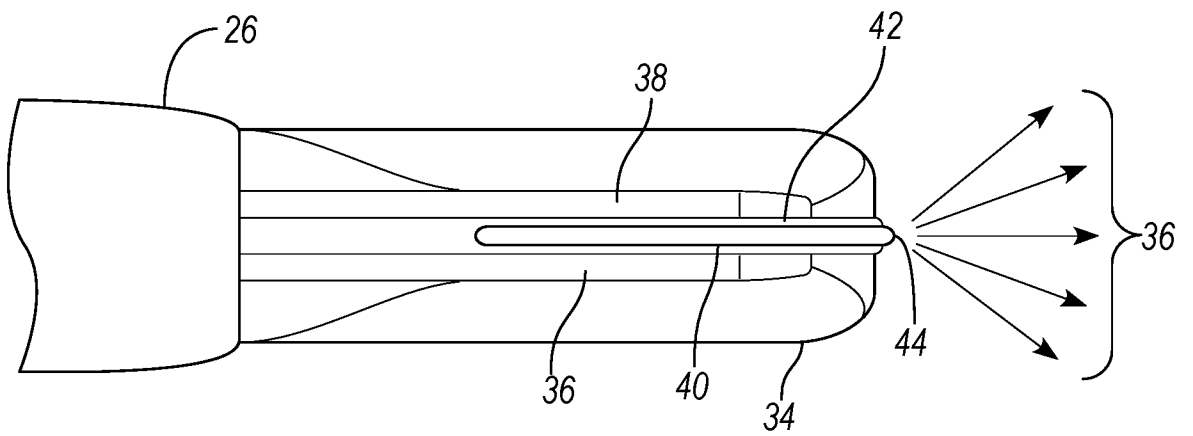

FIG. 3

INTERNATIONAL SEARCH REPORT

International application No
PCT/US2016/025849

A. CLASSIFICATION OF SUBJECT MATTER
INV. A61B18/14
ADD.

According to International Patent Classification (IPC) or to both national classification and IPC

B. FIELDS SEARCHED
Minimum documentation searched (classification system followed by classification symbols)
A61B

Documentation searched other than minimum documentation to the extent that such documents are included in the fields searched

Electronic data base consulted during the international search (name of data base and, where practicable, search terms used)
EPO-Internal, WPI Data

C. DOCUMENTS CONSIDERED TO BE RELEVANT

Category*	Citation of document, with indication, where appropriate, of the relevant passages	Relevant to claim No.
X Y	WO 2009/005850 A1 (TYCO HEALTHCARE [US]; FLOUME TIMMY [GB]; SYMS RICHARD R A [GB]; HANNA) 8 January 2009 (2009-01-08) abstract; figures 1-3 page 12, line 4 - page 14, line 5 page 17, line 7 - page 19, line 8 -----	1-12, 14-31, 33-35 13,32
X Y	US 5 376 087 A (HABER TERRY M [US] ET AL) 27 December 1994 (1994-12-27) cited in the application abstract; figures 1-4 column 2, line 64 - column 3, line 16 column 4, line 25 - column 5, line 2 ----- -/--	1-12, 14-31, 33-35 13,32

Further documents are listed in the continuation of Box C. See patent family annex.

* Special categories of cited documents :

"A" document defining the general state of the art which is not considered to be of particular relevance	"T" later document published after the international filing date or priority date and not in conflict with the application but cited to understand the principle or theory underlying the invention
"E" earlier application or patent but published on or after the international filing date	"X" document of particular relevance; the claimed invention cannot be considered novel or cannot be considered to involve an inventive step when the document is taken alone
"L" document which may throw doubts on priority claim(s) or which is cited to establish the publication date of another citation or other special reason (as specified)	"Y" document of particular relevance; the claimed invention cannot be considered to involve an inventive step when the document is combined with one or more other such documents, such combination being obvious to a person skilled in the art
"O" document referring to an oral disclosure, use, exhibition or other means	"&" document member of the same patent family
"P" document published prior to the international filing date but later than the priority date claimed	

Date of the actual completion of the international search 13 December 2016	Date of mailing of the international search report 21/12/2016
---	--

Name and mailing address of the ISA/ European Patent Office, P.B. 5818 Patentlaan 2 NL - 2280 HV Rijswijk Tel. (+31-70) 340-2040, Fax: (+31-70) 340-3016	Authorized officer Lahorte, Philippe
--	---

INTERNATIONAL SEARCH REPORT

International application No PCT/US2016/025849

C(Continuation). DOCUMENTS CONSIDERED TO BE RELEVANT		
Category*	Citation of document, with indication, where appropriate, of the relevant passages	Relevant to claim No.
X	<p>WO 2008/014465 A2 (JNJ TECHNOLOGY HOLDINGS LLC [US]; JANSSEN WILLIAM MICHAEL [US]; NEWMAN) 31 January 2008 (2008-01-31) abstract; figures 1-3D, 4, 6 paragraphs [0137], [0142] - [0148], [0163]</p> <p align="center">-----</p>	1-12, 14-31, 33-35
Y	<p>US 2008/312649 A1 (GUERRA PAUL [US] ET AL) 18 December 2008 (2008-12-18) abstract; figures 1-4 paragraphs [0009] - [0011], [0025] - [0028]</p> <p align="center">-----</p>	13,32
A	<p>US 2010/312241 A1 (ERICKSON JR JERRY MARTIN [US]) 9 December 2010 (2010-12-09) the whole document</p> <p align="center">-----</p>	1-35
A	<p>US 2010/145333 A1 (DETHIER DAVID [US] ET AL) 10 June 2010 (2010-06-10) the whole document</p> <p align="center">-----</p>	1-35
A	<p>US 2016/045247 A1 (HEIM WARREN P [US] ET AL) 18 February 2016 (2016-02-18) abstract; figures 3, 6-7, 17 paragraphs [0008] - [0014], [0092] - [0109]</p> <p align="center">-----</p>	1-35

INTERNATIONAL SEARCH REPORT

Information on patent family members

International application No

PCT/US2016/025849

Patent document cited in search report	Publication date	Patent family member(s)	Publication date
WO 2009005850	A1	08-01-2009	
		AU 2008271014 A1	08-01-2009
		CA 2691582 A1	08-01-2009
		EP 2162076 A1	17-03-2010
		JP 5336481 B2	06-11-2013
		JP 2010532213 A	07-10-2010
		US 2010217258 A1	26-08-2010
		WO 2009005850 A1	08-01-2009

US 5376087	A	27-12-1994	NONE

WO 2008014465	A2	31-01-2008	
		CN 101516286 A	26-08-2009
		EP 2068740 A2	17-06-2009
		KR 20090071546 A	01-07-2009
		KR 20150043515 A	22-04-2015
		WO 2008014465 A2	31-01-2008

US 2008312649	A1	18-12-2008	NONE

US 2010312241	A1	09-12-2010	NONE

US 2010145333	A1	10-06-2010	
		US 2010145333 A1	10-06-2010
		US 2012316553 A1	13-12-2012

US 2016045247	A1	18-02-2016	
		US 2016045247 A1	18-02-2016
		WO 2016025251 A1	18-02-2016
