



- (51) International Patent Classification:
A61B 19/00 (2006.01)
- (21) International Application Number:
PCT/US2015/020884
- (22) International Filing Date:
17 March 2015 (17.03.2015)
- (25) Filing Language: English
- (26) Publication Language: English
- (30) Priority Data:
- | | | |
|------------|------------------------------|----|
| 61/954,571 | 17 March 2014 (17.03.2014) | US |
| 61/954,557 | 17 March 2014 (17.03.2014) | US |
| 61/954,497 | 17 March 2014 (17.03.2014) | US |
| 61/954,502 | 17 March 2014 (17.03.2014) | US |
| 61/954,595 | 17 March 2014 (17.03.2014) | US |
| 62/019,318 | 30 June 2014 (30.06.2014) | US |
| 62/103,991 | 15 January 2015 (15.01.2015) | US |
| 62/104,306 | 16 January 2015 (16.01.2015) | US |
- (71) Applicant: INTUITIVE SURGICAL OPERATIONS, INC. [US/US]; 1020 Kifer Road, Sunnyvale, California 94086 (US).
- (72) Inventors: DACHS II, Gregory W.; 312 Almaden Way, San Mateo, California 94403 (US). SCHENA, Bruce Michael; 414 Pope Street, Menlo Park, California 94025 (US). CHAGHAJERDI, Amir; 1154 Quail Creek Cir, San Jose, California 95120 (US). SMABY, Niels; 4230 Ruthelma Ave, Palo Alto, California 94306 (US).
- (74) Agents: ALLENBY, Christopher B. et al.; Intuitive Surgical Operations, Inc., 1020 Kifer Road, Sunnyvale, California 94086 (US).
- (81) Designated States (*unless otherwise indicated, for every kind of national protection available*): AE, AG, AL, AM, AO, AT, AU, AZ, BA, BB, BG, BH, BN, BR, BW, BY, BZ, CA, CH, CL, CN, CO, CR, CU, CZ, DE, DK, DM, DO, DZ, EC, EE, EG, ES, FI, GB, GD, GE, GH, GM, GT, HN, HR, HU, ID, IL, IN, IR, IS, JP, KE, KG, KN, KP, KR, KZ, LA, LC, LK, LR, LS, LU, LY, MA, MD, ME, MG, MK, MN, MW, MX, MY, MZ, NA, NG, NI, NO, NZ, OM,

[Continued on next page]

(54) Title: COUPLER TO TRANSFER MOTION TO SURGICAL INSTRUMENT FROM SERVO ACTUATOR

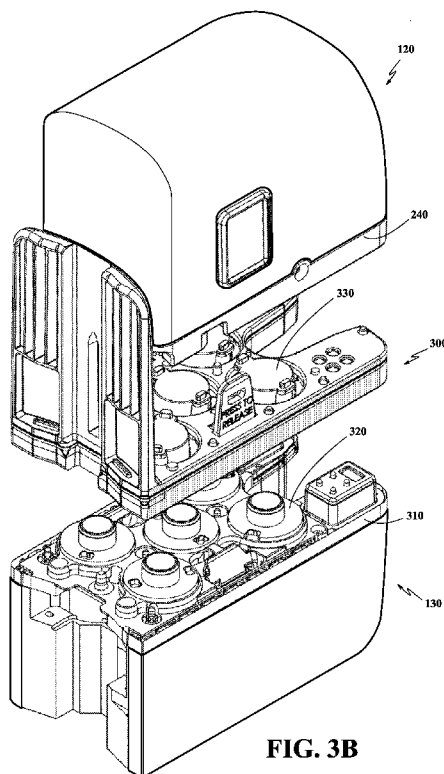

FIG. 3B

(57) Abstract: A sterile adapter for coupling a surgical instrument and a surgical instrument manipulator includes a bottom component and a coupling component. The bottom component includes a bottom component opening with a bottom lip having a locking mechanism. The coupling component is rotatably coupled to the bottom component. The coupling component includes an engagement feature that engages the surgical instrument manipulator. The coupling component further includes a locking mechanism opening that engages the locking mechanism when the engagement feature has not engaged the surgical instrument manipulator. The coupling component may include a retention tab that is aligned with the keyway to insert the coupling component into the bottom component opening and then misaligned with the keyway to retain the coupling component in the bottom component opening. A ramp may be provided on a leading edge of a pocket to facilitate engaging the coupling component with the surgical instrument manipulator.



PA, PE, PG, PH, PL, PT, QA, RO, RS, RU, RW, SA, SC, SD, SE, SG, SK, SL, SM, ST, SV, SY, TH, TJ, TM, TN, TR, TT, TZ, UA, UG, US, UZ, VC, VN, ZA, ZM, ZW.

SI, SK, SM, TR), OAPI (BF, BJ, CF, CG, CI, CM, GA, GN, GQ, GW, KM, ML, MR, NE, SN, TD, TG).

(84) Designated States (*unless otherwise indicated, for every kind of regional protection available*): ARIPO (BW, GH, GM, KE, LR, LS, MW, MZ, NA, RW, SD, SL, ST, SZ, TZ, UG, ZM, ZW), Eurasian (AM, AZ, BY, KG, KZ, RU, TJ, TM), European (AL, AT, BE, BG, CH, CY, CZ, DE, DK, EE, ES, FI, FR, GB, GR, HR, HU, IE, IS, IT, LT, LU, LV, MC, MK, MT, NL, NO, PL, PT, RO, RS, SE,

Declarations under Rule 4.17:

— *of inventorship (Rule 4.17(iv))*

Published:

— *with international search report (Art. 21(3))*

COUPLER TO TRANSFER MOTION TO SURGICAL INSTRUMENT
FROM TELEOPERATED ACTUATOR

[0001] This application claims a right of priority to the following earlier filed applications:

5 United States 61/954,497 17 March 2014 (17-03-2014)
 United States 61/954,502 17 March 2014 (17-03-2014)
 United States 61/954,557 17 March 2014 (17-03-2014)
 United States 61/954,571 17 March 2014 (17-03-2014)
10 United States 61/954,595 17 March 2014 (17-03-2014)
 United States 62/019,318 30 June 2014 (30-06-2014)
 United States 62/103,991 15 January 2015 (15-01-2015)
 United States 62/104,306 16 January 2015 (16-01-2015)

Each of these applications is specifically incorporated herein by reference
15 to the greatest extent permitted.

Field

[0002] Embodiments of the invention relate to the field of field of mechanical couplers; and more specifically, to a mechanical coupler for transferring motion from a teleoperated actuator to an attached surgical instrument.

20 Background

[0003] Minimally invasive medical techniques have been used to reduce the amount of extraneous tissue which may be damaged during diagnostic or surgical procedures, thereby reducing patient recovery time, discomfort, and deleterious side effects. Traditional forms of minimally invasive surgery
25 include endoscopy. One of the more common forms of endoscopy is laparoscopy, which is minimally invasive inspection or surgery within the abdominal cavity. In traditional laparoscopic surgery, a patient's abdominal cavity is insufflated with gas, and cannula sleeves are passed through small (approximately 12 mm) incisions in the musculature of the patient's
30 abdomen to provide entry ports through which laparoscopic surgical instruments can be passed in a sealed fashion.

[0004] The laparoscopic surgical instruments generally include a laparoscope for viewing the surgical field and surgical instruments having

end effectors. Typical surgical end effectors include clamps, graspers, scissors, staplers, and needle holders, for example. The surgical instruments are similar to those used in conventional (open) surgery, except that the working end or end effector of each surgical instrument is separated from its handle by an approximately 30 cm. long extension tube, for example, so as to permit the operator to introduce the end effector to the surgical site and to control movement of the end effector relative to the surgical site from outside a patient's body.

5
10
15
[0005] In order to provide improved control of the working tools, it may be desirable to control the surgical instrument with teleoperated actuators. The surgeon may operate controls on a console to indirectly manipulate the instrument that is connected to the teleoperated actuators. The surgical instrument is detachably coupled to the teleoperated actuators so that the surgical instrument can be separately sterilized and selected for use as needed instrument for the surgical procedure to be performed. The surgical instrument may be changed during the course of a surgery.

20
[0006] Performing surgery with teleoperated surgical instruments creates new challenges. One challenge is the need to maintain the region adjacent the patient in a sterile condition. However, the motors, sensors, encoders and electrical connections that are necessary to control the surgical instruments typically cannot be sterilized using conventional methods, e.g., steam, heat and pressure or chemicals, because they would be damaged or destroyed in the sterilization process.

25
30
[0007] Another challenge with teleoperated surgery systems is that a surgeon will typically employ several different surgical instruments during a procedure. A number of different surgical instruments will typically be introduced through the same trocar sleeve during the operation to limit the number of incisions required. Thus, there are a limited number of instrument holders available, often fewer than the number of surgical instruments used during a procedure. Therefore the surgical instruments may be attached and detached from the same instrument holder a number of times during an operation. A number of connections are required between the surgical instrument and the teleoperated actuator and its

controller. Connections are required to transmit the actuator forces, electrical signals, and data. This makes the attachment of the surgical instrument to the teleoperated actuator and its controller complex.

5 **[0008]** Still another challenge with teleoperated surgery systems is that an operating room is not an ideal environment for preparing precision mechanical assemblies.

10 **[0009]** It would be desirable to provide an easier and more effective way to engage and disengage a surgical instrument and a teleoperated actuator drive while preventing contamination of the teleoperated actuator and allowing quick and reliable attachment of a succession of surgical instruments that maintains a sterile area around the surgical instrument.

15 **[0010]** It would be desirable to provide an easier and more effective way to engage and disengage a surgical instrument and a teleoperated actuator drive while preventing contamination of the teleoperated actuator and allowing quick and reliable attachment of a succession of surgical instruments that maintains a sterile area around the surgical instrument.

SUMMARY

20 **[0011]** A sterile adapter for coupling a surgical instrument and a surgical instrument manipulator includes a bottom component and a coupling component. The bottom component includes a bottom component opening with a bottom lip having a locking mechanism. The coupling component is rotatably coupled to the bottom component. The coupling component includes an engagement feature that engages the surgical instrument manipulator. The coupling component further includes a locking
25 mechanism opening that engages the locking mechanism when the engagement feature has not engaged the surgical instrument manipulator. The coupling component may include a retention tab that is aligned with the keyway to insert the coupling component into the bottom component opening and then misaligned with the keyway to retain the coupling
30 component in the bottom component opening. A ramp may be provided on a leading edge of a pocket to facilitate engaging the coupling component with the surgical instrument manipulator.

[0012] Other features and advantages of the present invention will be apparent from the accompanying drawings and from the detailed description that follows below.

BRIEF DESCRIPTION OF THE DRAWINGS

5 **[0013]** The invention may best be understood by referring to the following description and accompanying drawings that are used to illustrate embodiments of the invention by way of example and not limitation. In the drawings, in which like reference numerals indicate similar elements:

[0014] FIG. 1 is a view of an illustrative patient-side portion of a teleoperated surgical system.
10

[0015] FIG. 2 is a side view of a surgical instrument for use with a teleoperated actuator.

[0016] FIG. 3A is an illustration of an exemplary embodiment of a coupling of a surgical instrument, a carriage of a surgical instrument manipulator, and an instrument sterile adapter (ISA).
15

[0017] FIG. 3B is an illustration of an exemplary embodiment of the coupler system of FIG. 3A.

[0018] FIG. 4 is an illustration of an exemplary embodiment of an assembled ISA.

20 **[0019]** FIG. 5 is an illustration of an ISA bottom component and a plurality of ISA couplers.

[0020] FIG. 6 is an illustration of an exemplary embodiment of an ISA coupler.

[0021] FIG. 7 is an illustration of a plurality of ISA couplers coupled with the ISA bottom component.
25

[0022] FIG. 8 is an illustration of an exemplary embodiment of an ISA top component having one ISA coupler placed in a top component opening.

[0023] FIG. 9 is illustration of a cut-away ISA top component coupled to the ISA bottom component without the ISA couplers.

30 **[0024]** FIG. 10 is an illustration of an exemplary embodiment of a top component of the ISA coupled to a bottom component of the ISA without an ISA coupler.

[0025] FIG. 11 is an illustration of an exemplary embodiment of the underside of an ISA.

[0026] FIG. 12 is an illustration of an exemplary embodiment of an instrument carriage.

5 **[0027]** FIG. 13A is an illustration of an exemplary embodiment of an ISA bottom component having a locking mechanism illustrated as a boss.

[0028] FIG. 13B is an enlarged illustration of the boss locking mechanism illustrated in a portion of Figure 13A.

[0029] FIG. 13C is an illustration of an exemplary embodiment of an ISA
10 bottom component having a locking mechanism illustrated as a ratchet.

[0030] FIG. 13D is an enlarged illustration of the ratchet locking mechanism illustrated in a portion of Figure 13C

[0031] FIG. 16A is an illustration of an exemplary embodiment of an ISA bottom engagement feature approaching a carriage engagement feature
15 without an entry ramp.

[0032] FIG. 16B is an illustration of the exemplary embodiment of Figure 14A showing a failed attempt at coupling the ISA bottom engagement feature with the carriage engagement feature.

[0033] FIG. 17A is an illustration of an exemplary embodiment of an ISA
20 bottom engagement feature approaching a carriage engagement feature that includes an entry ramp.

[0034] FIG. 17B is an illustration of the exemplary embodiment of Figure 15A showing the ISA bottom engagement feature approaching the carriage engagement feature and using the entry ramp to begin mating with the
25 carriage engagement feature.

[0035] FIG. 18A is an illustration of an exemplary embodiment of an ISA bottom engagement feature that includes an entry ramp approaching a carriage engagement feature.

[0036] FIG. 18B is an illustration of the exemplary embodiment of Figure
30 16A showing the ISA bottom engagement feature approaching the carriage engagement feature and using the entry ramp to begin mating with the carriage engagement feature.

DESCRIPTION OF EMBODIMENTS

[0037] In the following description, numerous specific details are set forth.

However, it is understood that embodiments of the invention may be practiced without these specific details. In other instances, well-known
5 circuits, structures, and techniques have not been shown in detail in order not to obscure the understanding of this description.

[0038] In the following description, reference is made to the accompanying drawings, which illustrate several embodiments of the present invention. It is understood that other embodiments may be utilized, and mechanical
10 compositional, structural, electrical, and operational changes may be made without departing from the spirit and scope of the present disclosure. The following detailed description is not to be taken in a limiting sense, and the scope of the embodiments of the present invention is defined only by the claims of the issued patent.

[0039] The terminology used herein is for the purpose of describing
15 particular embodiments only and is not intended to be limiting of the invention. Spatially relative terms, such as "beneath", "below", "lower", "above", "upper", and the like may be used herein for ease of description to describe one element's or feature's relationship to another element(s) or
20 feature(s) as illustrated in the figures. It will be understood that the spatially relative terms are intended to encompass different orientations of the device in use or operation in addition to the orientation depicted in the figures. For example, if the device in the figures is turned over, elements described as "below" or "beneath" other elements or features would then
25 be oriented "above" the other elements or features. Thus, the exemplary term "below" can encompass both an orientation of above and below. The device may be otherwise oriented (e.g., rotated 90 degrees or at other orientations) and the spatially relative descriptors used herein interpreted accordingly.

[0040] As used herein, the singular forms "a", "an", and "the" are intended to
30 include the plural forms as well, unless the context indicates otherwise. It will be further understood that the terms "comprises" and/or "comprising" specify the presence of stated features, steps, operations, elements, and/or

components, but do not preclude the presence or addition of one or more other features, steps, operations, elements, components, and/or groups thereof.

[0041] The term "object" generally refers to a component or group of components. For example, an object may refer to either a pocket or a boss of a disk within the specification or claims. Throughout the specification and claims, the terms "object," "component," "portion," "part" and "piece" are used interchangeably.

[0042] The terms "instrument" and "surgical instrument" are used herein to describe a medical device configured to be inserted into a patient's body and used to carry out surgical or diagnostic procedures. The instrument includes an end effector. The end effector may be a surgical tool associated with one or more surgical tasks, such as a forceps, a needle driver, a shears, a bipolar cauterizer, a tissue stabilizer or retractor, a clip applier, an anastomosis device, an imaging device (e.g., an endoscope or ultrasound probe), and the like. Some instruments used with embodiments of the invention further provide an articulated support (sometimes referred to as a "wrist") for the surgical tool so that the position and orientation of the surgical tool can be manipulated with one or more mechanical degrees of freedom in relation to the instrument's shaft. Further, many surgical end effectors include a functional mechanical degree of freedom, such as jaws that open or close, or a knife that translates along a path. Surgical instruments may also contain stored (e.g., on a semiconductor memory inside the instrument) information that may be permanent or may be updatable by the surgical system. Accordingly, the system may provide for either one-way or two-way information communication between the instrument and one or more system components.

[0043] The term "pocket" may be construed broadly as a recess of a workspace which is configured such that a boss is able to mate with the pocket. Such a mating process occurs when a boss of the appropriate shape and size is inserted into the pocket.

[0044] The term "boss" may be construed broadly as an extending or protruding feature on a workspace. A boss may be configured as any

shape or size. One use of a boss is to participate in a mating process with a pocket through insertion of the boss into the pocket. Throughout the specification, the terms “boss” and “protrusion” are used interchangeably.

5 [0045] The term “engagement feature” may be construed broadly as a “pocket” or a “boss” or any piece used to engage two or more objects.

[0046] The term “mating” may be construed broadly as any event in which two or more objects are connected in a manner allowing the mated objects to operate in conjunction with one another. It should be noted that mating does not require a direct connection (e.g., direct physical or electrical
10 connection) but that a multiplicity of objects or components may be used to mate two or more objects. For example, objects A and B may be mated through the use of object C. As another example, objects D and E may mate when object D, a protrusion, is received into the recess of object E, a pocket. Throughout the specification and claims, the terms “mate,”
15 “couple,” “connect” or “engage” are used interchangeably.

[0047] In addition, the term “detachably coupled” or “detachably mated” may be construed to mean a coupling or mating event between two or more objects that is not permanent. This means that objects that are detachably coupled may be uncoupled and separated such that they no longer operate
20 in conjunction.

[0048] The term “backlash” may be construed as the clearance or gap between two mated components. For instance, when a boss is inserted into a pocket, the protrusion of the boss is inherently smaller than opening of the pocket. The difference between the size of the protrusion and the size
25 of the opening is the amount of backlash between the boss and the pocket.

[0049] Lastly, the terms “or” and “and/or” as used herein are to be interpreted as inclusive or meaning any one or any combination. Therefore, “A, B or C” or “A, B and/or C” mean “any of the following: A; B; C; A and B; A and C; B and C; A, B and C.” An exception to this definition will occur
30 only when a combination of elements, functions, steps or acts are in some way inherently mutually exclusive.

Overview of a Functional Teleoperated Surgical System

[0050] FIG. 1 is a view of an illustrative patient-side portion 100 of a teleoperated surgical system, in accordance with embodiments of the present invention. The patient-side portion 100 includes support
5 assemblies 110 and one or more surgical instrument manipulators 112 at the end of each support assembly. The support assemblies optionally include one or more unpowered, lockable setup joints that are used to position the surgical instrument manipulator(s) 112 with reference to the patient for surgery. As depicted, the patient-side portion 100 rests on the
10 floor. In other embodiments the patient-side portion may be mounted to a wall, to the ceiling, to the operating table 126, which also supports the patient's body 122, or to other operating room equipment. Further, while the patient-side portion 100 is shown as including four surgical instrument manipulators 112, more or fewer surgical instrument manipulators 112 may
15 be used. Still further, the patient-side portion 100 may consist of a single assembly as shown, or it may include two or more separate assemblies, each optionally mounted in various possible ways.

[0051] Each surgical instrument manipulator 112 supports one or more surgical instruments 120 that operate at a surgical site within the patient's
20 body 122. Each surgical instrument manipulator 112 may be provided in a variety of forms that allow the associated surgical instrument to move with one or more mechanical degrees of freedom (e.g., all six Cartesian degrees of freedom, five or fewer Cartesian degrees of freedom, etc.). Typically, mechanical or control constraints restrict each surgical
25 instrument manipulator 112 to move its associated surgical instrument around a center of motion on the surgical instrument that stays stationary with reference to the patient, and this center of motion is typically located to be at the position where the surgical instrument enters the body.

[0052] A functional teleoperated surgical system will generally include a
30 vision system portion (not shown) that enables the operator to view the surgical site from outside the patient's body 122. The vision system typically includes a surgical instrument that has a video-image-capture function 128 (a "camera instrument") and one or more video displays for

displaying the captured images. In some surgical system configurations, the camera instrument 128 includes optics that transfer the images from the distal end of the camera instrument 128 to one or more imaging sensors (e.g., CCD or CMOS sensors) outside of the patient's body 122.

5 Alternatively, the imaging sensor(s) may be positioned at the distal end of the camera instrument 128, and the signals produced by the sensor(s) may be transmitted along a lead or wirelessly for processing and display on the video display. An illustrative video display is the stereoscopic display on the surgeon's console in surgical systems commercialized by Intuitive Surgical,
10 Inc., Sunnyvale, California.

[0053] A functional teleoperated surgical system will further include a control system portion (not shown) for controlling the movement of the surgical instruments 120 while the instruments are inside the patient. The control system portion may be at a single location in the surgical system, or it may
15 be distributed at two or more locations in the system (e.g., control system portion components may be in the system's patient-side portion 100, in a dedicated system control console, or in a separate equipment rack). The teleoperated master/slave control may be done in a variety of ways, depending on the degree of control desired, the size of the surgical
20 assembly being controlled, and other factors. In some embodiments, the control system portion includes one or more manually-operated input devices, such as a joystick, exoskeletal glove, a powered and gravity-compensated manipulator, or the like. These input devices control teleoperated motors which, in turn, control the movement of the surgical
25 instrument.

[0054] The forces generated by the teleoperated motors are transferred via drivetrain mechanisms, which transmit the forces from the teleoperated motors to the surgical instrument 120. In some telesurgical embodiments, the input devices that control the manipulator(s) may be provided at a
30 location remote from the patient, either inside or outside the room in which the patient is placed. The input signals from the input devices are then transmitted to the control system portion. Persons familiar with telemanipulative, teleoperative, and telepresence surgery will know of such

systems and their components, such as the da Vinci® Surgical System commercialized by Intuitive Surgical, Inc. and the Zeus® Surgical System originally manufactured by Computer Motion, Inc., and various illustrative components of such systems.

5 **[0055]** As shown, both the surgical instrument 120 and an optional entry guide 124 (e.g., a cannula in the patient's abdomen) are removably coupled to the distal end of a manipulator 112, with the surgical instrument 120 inserted through the entry guide 124. Teleoperated actuators in the manipulator 112 move the surgical instrument 120 as a whole. The
10 manipulator 112 further includes an instrument carriage 130. The surgical instrument 120 is detachably connected to the carriage 130. The teleoperated actuators housed in the carriage 130 provide a number of controller motions which the surgical instrument 120 translates into a variety of movements of the end effector on the surgical instrument. Thus
15 the teleoperated actuators in the carriage 130 move only one or more components of the surgical instrument 120 rather than the instrument as a whole. Inputs to control either the instrument as a whole or the instrument's components are such that the input provided by a surgeon to the control system portion (a "master" command) is translated into a corresponding
20 action by the surgical instrument (a "slave" response).

[0056] FIG. 2 is a side view of an illustrative embodiment of the surgical instrument 120, comprising a distal portion 250 and a proximal control mechanism 240 coupled by an elongate tube 210. The distal portion 250 of the surgical instrument 120 may provide any of a variety of surgical tools,
25 such as the forceps 254 shown, a needle driver, a cautery device, a cutting tool, an imaging device (e.g., an endoscope or ultrasound probe), or a combined device that includes a combination of two or more various tools and imaging devices. In the embodiment shown, the surgical tool 254 is coupled to the elongate tube 210 by a "wrist" 252 that allows the orientation
30 of the surgical tool to be manipulated with reference to the instrument tube 210.

[0057] Surgical instruments that are used with the invention may control their end effectors (surgical tools) with a plurality of rods and/or flexible

cables. Rods, which may be in the form of tubes, may be combined with cables to provide a "push/pull" control of the end effector with the cables providing flexible sections as required. A typical elongate tube 210 for a surgical instrument 120 is small, perhaps five to eight millimeters in diameter, roughly the diameter of a large soda straw. The diminutive scale of the mechanisms in the surgical instrument 120 creates unique mechanical conditions and issues with the construction of these mechanisms that are unlike those found in similar mechanisms constructed at a larger scale, because forces and strengths of materials do not scale at the same rate as the size of the mechanisms. The cables must fit within the elongate tube 210 and be able to bend as they pass through the wrist joint 252.

[0058] In order to provide a sterile operation area while using a functional teleoperated surgical system, it is preferred that a barrier be placed between the non-sterile system and the sterile surgical field. Therefore, a sterile component, such as an instrument sterile adapter (ISA), is placed between the surgical instrument 120 and the teleoperated surgical instrument manipulator 130. The placement of an instrument sterile adapter between the surgical instrument 120 and the surgical instrument manipulator 130 includes the benefit of ensuring a sterile coupling point for the surgical instrument 120 and the surgical instrument manipulator 130. This permits removal of surgical instruments from the surgical instrument manipulator 130 and exchange with other surgical instruments during the course of a surgery.

[0059] FIG. 3A shows a portion of an exemplary embodiment of a proximal control mechanism 240 of a surgical instrument 120, a carriage 310 of a teleoperated surgical instrument manipulator 130, and an instrument sterile adapter (ISA) 300 in a coupled condition.

[0060] FIG. 3B shows an exploded view of the coupler system of FIG. 3A. In one embodiment, the first stage of the coupling process includes the ISA 300 coupling with the carriage 130. Carriage drivers 320 on the carriage 130 are rotated to engage the corresponding ISA couplers 330. The surgical instrument 120 is coupled with the ISA 300. The ISA couplers 330

are rotated by the carriage drivers 320 to engage corresponding instrument drivers (not shown).

Instrument Sterile Adapter Disk Assembly

[0061] The instrument sterile adapter (ISA) is assembled from a plurality of components, including, among others, a top component, a bottom component and one or more couplers. A coupler is positioned through an opening in the bottom component, and then the top component is joined with the bottom component.

[0062] There is a need for a mechanism that allows the top component to couple with the bottom component and ensure that couplers will not become dislodged while still allowing the couplers to rotate freely.

[0063] FIG. 4 shows an exemplary embodiment of an assembled ISA 300. The ISA 300 includes an ISA top component 410, an ISA bottom component 420, and a plurality of ISA couplers 330. The embodiment of FIG. 4 illustrates the ISA 300 including five ISA couplers 330. The number of ISA couplers 330 is not limited to five, but may be more than or less than five.

[0064] Referring to FIG. 5, a view of an ISA bottom component 420 and a plurality of ISA couplers 330 is shown. The ISA bottom component 420 includes a plurality of bottom component openings 530. Each coupler 330 is associated with a corresponding opening 530. Each bottom component opening 530 is partially surrounded by a bottom lip 540, and each bottom lip 540 includes one or more keyways 550.

[0065] Referring to FIG. 6, an exemplary embodiment of an ISA coupler 330 is shown. The ISA coupler 330 includes two ISA bottom engagement features 610, two ISA top engagement features 600 (one is hidden from view), two ISA locking mechanism openings 640, two retention tabs 630, and an ISA coupler lip 620. It should be noted that the number of engagement features, retention tabs, and locking mechanism openings are variable. In addition, various configurations of the top and bottom engagement features 600, 610 may be used. For example, the bottom engagement feature 610 could be a recessed feature rather than a projecting feature as shown.

[0066] Referring again to Figure 5, each ISA coupler 330 is positioned in a corresponding bottom component opening 530. The ISA coupler 330 is rotated to align the retention tabs 630 with the keyways 550 to allow the ISA coupler to be inserted into the corresponding bottom component opening 530. The ISA coupler lip 620 is larger than the bottom component opening 530 and limits the distance the ISA coupler 330 can be inserted into the bottom component opening. The ISA coupler 330 is then rotated to unalign the retention tabs 630 with the keyways 550 so as to retain the ISA coupler in the corresponding bottom component opening 530.

[0067] Referring to FIG. 7, an illustration of a plurality of ISA couplers 330 coupled with the ISA bottom component 420 is shown.

[0068] Referring to FIG. 8, one exemplary embodiment of the ISA top component 410 is illustrated. In FIG. 8, the ISA top component 410 of the ISA 300 includes five top component openings 810, through which five ISA couplers 330 pass. Furthermore, each top component opening 810 includes two keyway fillers 820. The number of keyway fillers 820 included in each top component opening 810 may be varied but should correspond with the number of keyways 550 included in each bottom component opening 530 of the ISA bottom component 420.

[0069] FIG. 9 illustrates the ISA top component 410 coupled to the ISA bottom component 420. The ISA couplers 330 are not shown to allow the bottom lip 540 and keyway 550 features of the bottom component to be seen. Furthermore, FIG. 9 illustrates the ISA top component 410 cut along line 9—9 in Figure 8 and the forward half of the ISA top component removed. After the ISA couplers 330 are inserted into the corresponding bottom component openings 530, the ISA top component 410 is then placed on top of the ISA bottom component 420 such that the ISA couplers 330 pass through the corresponding top component openings 810 in the ISA top component 410.

[0070] The keyway fillers 820 of the ISA top component 410 align with the keyways 550 of the ISA bottom component 420. When the ISA top component 410 is assembled with the ISA bottom component 420, the alignment of the keyway fillers 820 and the keyways 550 locks the ISA

couplers 330 between the ISA bottom component 420 and the ISA top component 410. The illustration of FIG. 9 shows that the keyway filler 820 of the top component 410 and the bottom lip 540 of the bottom component 420 create a complete lip when the top component 410 and then bottom component 420 are coupled.

[0071] FIG. 10 illustrates an exemplary embodiment of the ISA top component 410 coupled to the bottom component 700 without the ISA coupler 330 in two of the openings 870. The ISA coupler 330 is not shown in FIG. 10 in order to illustrate how the keyway filler 820 aligns with the keyway 550 to create a solid lip preventing the ISA coupler 330 from dislodging. As is seen in FIG. 10, the keyway filler 820 is configured to be the counterpart to the keyway 550. Of course, other shapes may be used for the keyways 550 and the keyway fillers 820.

Instrument Sterile Adapter Engagement

[0072] Referring to **FIG. 11**, an exemplary illustration of the underside of the ISA 300 is shown. In the embodiment, the ISA 300 is shown to include five ISA couplers 330. However, the number of ISA couplers 330 is not limited to five; other embodiments may contain more than or less than five. Furthermore, the placement of the ISA couplers 330 is not limited to that as illustrated in **FIG. 11**, and ISA couplers may be arranged in various patterns.

[0073] As discussed above, **FIG. 6** shows an exemplary embodiment of an ISA coupler 330. In the embodiment shown, the ISA coupler 330 includes two ISA bottom engagement features 610, two ISA top engagement features 600, two ISA locking mechanism openings 640, two retention tabs 630, and an ISA coupler lip 620. The portion of the ISA coupler 330 that includes the ISA bottom engagement features 610 projects through the bottom component opening 530. The portion of the ISA coupler 330 that includes the ISA top engagement features 600 projects through the top component opening 810. It should be noted that there may be a different number of engagement features, retention tabs, and locking mechanism openings than the number of any or all such features shown in the

drawings. Any or all of the features shown in the exemplary embodiment of Figure 6 may be placed in different positions than those shown.

[0074] Referring to **FIG. 12**, an exemplary illustration of the carriage 310 is shown. In the exemplary embodiment of **FIG. 12**, the carriage 310 is shown to have five carriage drivers 320. Each carriage driver 320 is driven in a rotational manner by a motor (not shown). The number of carriage drivers 320 and motors can be varied depending on various factors such as, among other things, the size of the support assembly 110 and the size of the teleoperated surgical instrument manipulator 130.

10 [0075] In the embodiment illustrated in **FIG. 12**, each carriage driver 320 is shown to have two carriage engagement features 1220. The carriage 310 of the surgical instrument manipulator 130 couples with the ISA 300 through an engagement process between the carriage engagement features 1220 of the carriage driver 320 and the ISA bottom engagement features 610 of the ISA coupler 330, which will be described below. Of course, the number of carriage engagement features 1220 and ISA bottom engagement features 610 is not limited to two. In other embodiments, the number may be more than or less than two.

[0076] Each carriage driver 320 contains a spring-loaded mechanism such that when a force is applied to the carriage driver 320 (e.g., from projecting engagement features on a corresponding driven element), the carriage driver 320 recedes slightly into the carriage 310. When the carriage engagement features 1220 and ISA bottom engagement features 610 are in misalignment at the time the ISA 300 and the surgical instrument manipulator 130 attempt to engage, the spring-loaded mechanism provides the necessary force to couple the ISA bottom engagement features 610 with the carriage engagement features 1220 when they come into alignment as the carriage drivers 320 rotate.

[0077] However, the addition of an ISA 300 between the coupling of the surgical instrument 120 and the surgical instrument manipulator 130 creates a need for a way to ensure that the instrument sterile adapter properly engages with both the surgical instrument 120 and the surgical instrument manipulator 130.

[0078] If the ISA bottom engagement features 610 (Figure 11) and the carriage engagement features 1220 are not initially in alignment when an attempt to couple the ISA 300 and the carriage 310 is made, the ISA bottom engagement features 610 will come into contact with the carriage drivers 320. To correct the misalignment, the carriage drivers 320 rotate in order to align the ISA bottom engagement features 610 and the carriage engagement features 1220. However, due to friction that is created when the ISA bottom engagement features 610 come into contact with the carriage driver disk 320, the ISA couplers 330 may rotate as the carriage drivers 320 turn. It is necessary to ensure that the ISA bottom engagement features 610 engage the carriage engagement features 1220 so that a surgical instrument attached to the ISA 300 can be properly controlled.

[0079] In order to ensure that the friction caused by the ISA bottom engagement features 610 coming in contact with the carriage disks 320 does not prevent a proper engagement between the ISA bottom engagement features 610 and the carriage engagement features 1220, a locking mechanism may be implemented within the ISA 300.

[0080] The locking mechanism implemented within the ISA 300 is a mechanism that restricts the ability of each ISA coupler 330 to rotate, at least during the engagement process with the carriage 310 of the surgical instrument manipulator 130. Therefore, if the ISA bottom engagement features 610 and the carriage engagement features 1220 are not aligned when an attempt to couple the ISA 300 with the surgical instrument manipulator 130 is made, and if the locking mechanism restricts the ability of the ISA couplers 330 to rotate, the carriage drivers 320 will be able to rotate and align the carriage engagement features 1220 with the ISA bottom engagement features 610. When the carriage engagement features 1220 come into alignment with the ISA bottom engagement features 610, the pressure created by the spring-loaded mechanism of the carriage drivers 320 causes the ISA bottom engagement features 610 to be inserted into the corresponding carriage engagement features 1220, therefore producing a proper engagement event.

[0081] FIG. 13A illustrates an embodiment of an ISA bottom component 420. As discussed above, the ISA bottom component 420 includes a plurality of bottom component openings 530. Furthermore, each bottom component opening 530 is partially surrounded by a bottom lip 540, and
5 each bottom lip 540 includes one or more keyways 550 and one or more locking mechanisms 1310.

[0082] Prior to any coupling with the carriage 310 or the surgical instrument 120, the ISA coupler 330 does not sit flush against the bottom lip 540 or the locking mechanism(s) 1310 and is free to rotate completely in either
10 direction. However, when an attempt to couple the carriage 310 with the ISA 300 is made, the carriage drivers 320 push the ISA couplers 330 against the bottom lip 540 or the locking mechanism(s) 1310. When the ISA coupler 330 is pushed up toward the bottom lip 540, one of two situations occur: (1) the ISA coupler lip 620 comes in contact with the
15 locking mechanism(s) 1310 or (2) the ISA locking mechanism opening 640 and the locking mechanism 1310 are in alignment and the ISA coupler lip 620 is pushed flush against the bottom lip 540.

[0083] As seen in the detail shown in FIG. 13B, the locking mechanism 1310 is illustrated as a boss. When the ISA locking mechanism opening 640 is aligned with the ISA locking mechanism 1310, the ISA coupler 330 is
20 pushed flush against the bottom lip 540. However, when the ISA locking mechanism opening 640 and the locking mechanism 1310 are not aligned, the ISA coupler rotates with the carriage drivers 310 against the bottom lip 540 until the ISA locking mechanism opening(s) 640 and the locking
25 mechanism(s) 1310 are aligned. When the locking mechanism opening(s) 610 and the locking mechanism(s) 1310 are aligned, the ISA coupler lip 620 is pushed flush against the bottom lip 540. When the ISA coupler lip 620 is pushed flush against the bottom lip 540 and the locking mechanism 1310 is embodied as a boss, the ISA coupler 330 is prevented from rotating
30 in either direction.

[0084] However, if the ISA bottom engagement features 610 and the carriage engagement features 1220 are not initially aligned at the time the carriage drivers 320 come in contact with the ISA couplers 330, the friction

between the ISA couplers 330 and carriage drivers 320 will cause the ISA couplers 330 to rotate with the carriage drivers 320. Once the ISA couplers 330 rotate such that the ISA locking mechanism opening(s) 640 are aligned with the locking mechanism(s) 1310, the ISA coupler lip 620 will be pushed
5 flush against the bottom lip 540. The torque from the motors is more powerful than the friction created by the force of the spring-loaded mechanisms in the carriage drivers 320 so the carriage drivers 320 continue to rotate as the ISA couplers remain stationary. As the carriage drivers 320 rotate, it will bring the carriage engagement features 1220 into
10 alignment with the ISA bottom engagement features 610. When the carriage engagement features 1220 and the ISA bottom engagement features 610 are in alignment, the pressure from the spring-loaded mechanism of the carriage 310 will cause the carriage engagement features 1220 and the ISA bottom engagement features 610 to engage.

15 **[0085]** In the embodiment shown in **FIG. 13C**, the locking mechanism 1320 is illustrated as a ratchet. **FIG. 13D** is a detail drawing of a portion of Figure 13C that shows the ratchet locking mechanism. When the ISA locking mechanism opening(s) 640 and the locking mechanism(s) 1320 are not aligned, due to the friction created by the spring-loaded mechanism of the
20 carriage drivers 320, the ISA couplers 330 rotate with the carriage drivers 310 until the ISA locking mechanism opening(s) 640 and the locking mechanism(s) 1320 are aligned. When the locking mechanism 1320 is embodied as a ratchet, the ISA coupler lip 620 slides along in the slip direction of the ratchet until it hits a ratchet wall. When the ISA coupler 330
25 has slid along the slip and hit the ratchet wall, the ISA coupler lip 620 sits flush against the bottom lip 540. When the ISA coupler lip 620 is pushed flush against the bottom lip 540 and the locking mechanism 1320 is embodied as a ratchet, the ISA coupler 330 is prevented from rotating in the direction against the ratchet wall.

30 **[0086]** When the locking mechanism 1320 is embodied as a ratchet, the motors that drive the carriage drivers 320 are configured to rotate the carriage drivers 320, and consequently the ISA couplers 330, in the direction against the ratchet. If the ISA bottom engagement features 610

- and the carriage engagement features 1220 are not initially aligned at the time the carriage drivers 320 come in contact with the ISA couplers 330, the friction between the ISA couplers 330 and carriage drivers 320 will cause the ISA couplers 330 to rotate with the carriage drivers 320. The torque from the motors is more powerful than the friction created by the force of the spring-loaded mechanisms in the carriage drivers 320 so once the ISA coupler lip 620 rotates to hit the ratchet wall, the carriage drivers 320 continue to rotate as the ISA couplers remain stationary. As the carriage drivers 320 rotate, it will bring the carriage engagement features 1220 into alignment with the ISA bottom engagement features 610. When the carriage engagement features 1220 and the ISA bottom engagement features 610 are in alignment, the pressure from the spring-loaded mechanism of the carriage 310 will cause the carriage engagement features 1220 and the ISA bottom engagement features 610 to engage.
- 15 **[0087]** When the locking mechanism 1320 is embodied as a ratchet, once the ISA coupler 330 is properly engaged with the carriage drivers 320, it is possible to rotate the ISA coupler 330 in the direction opposite that in which the ISA coupler lip 620 rotates to hit the ratchet wall. This allows the ISA coupler 330 to be rotated to a desired position prior to engaging a surgical instrument manipulator 130 with the ISA 300.
- 20 **[0088]** Thereafter, in both embodiments illustrated in **Figs 13A-B**, once the ISA coupler 330 is properly engaged with the carriage drivers 320, it is preferable for the ISA coupler 330 to be permitted to rotate freely in either direction. As the instrument drivers 710 of the instrument 120 attempt to couple with the ISA couplers 330, the instrument drivers 710 place pressure on the ISA couplers 330. This in turn presses the ISA coupler lip 620 below the depth of the locking mechanism 1310 or 1320, and allows the ISA coupler 330 to avoid the locking mechanism 1310 or 1320 and rotate freely in either direction.
- 25 **[0089]** Furthermore, it is not necessary for the pockets to be located on the carriage drivers 320 and the bosses to be located on the ISA couplers 330 as shown in the figures provided. Instead, one embodiment may have the carriage drivers 320 including bosses and the ISA couplers 330 including
- 30

pockets. In another embodiment, the locking mechanism may be formed on the ISA top component 410 and extend into the ISA bottom component 420.

[0090] In one embodiment, the teleoperated surgical instrument manipulator 130 includes a software module that enables the surgical instrument manipulator 130 to detect when a proper engagement between the ISA 300 and the surgical instrument manipulator 130 (through the ISA couplers 330 and the carriage drivers 310) has occurred. A proper engagement event may be detected by the software module through the analysis of the amount of torque applied to the motors of the carriage 310. When a proper engagement has occurred, the ISA bottom engagement features 610 have coupled with the carriage engagement features 1220 and the motors are attempting to drive the ISA couplers 330 against restriction of the locking mechanism. In this case, the software module detects an increased torque on each motor. The detection of this increased torque indicates a proper engagement and the absence of the increased torque indicates that the ISA bottom engagement features 610 have not successfully coupled with the carriage engagement features 1220.

[0091] The software module may communicate the absence or completion of a proper engagement to surgical personnel. This communication may occur in numerous ways. Examples of possible ways a proper engagement may be communicated are, among other things, flashing a light on the surgical instrument manipulator 130 or changing a light of a first color on the surgical instrument manipulator 112 to a second color (such as red to green).

High Speed Disk Engagement

[0092] As discussed above, the addition of an instrument sterile adapter (ISA) between the coupling of the surgical instrument 120 and the surgical instrument manipulator 130 creates a need for a way to ensure that the ISA properly engages with both the surgical instrument 120 and the surgical instrument manipulator 130.

[0093] FIG. 14 shows an embodiment of the ISA 300 and the surgical instrument manipulator 130 with the ISA and the surgical instrument

manipulator rotated away from each other to show the surfaces that engage each other. As previously discussed, the surgical instrument manipulator 130 includes one or more carriage drivers 320 that provide rotary motion to drive a surgical instrument. The ISA includes a like number of ISA couplers 330 that transfer the rotary motion from the carriage drivers 320 to the surgical instrument. In the embodiment shown, each carriage driver 320 includes two carriage engagement features 1220 in form of pockets. The corresponding ISA coupler 330 includes a like number of ISA bottom engagement features 610 in the form of bosses. Each ISA engagement feature 610 mates with a corresponding carriage engagement feature 1220 to provide a positive connection between the carriage driver 320 and the ISA coupler 330. In other embodiments different numbers of engagement features may be used. In other embodiments the carriage engagement features may be in form of bosses and the ISA bottom engagement features may be in the form of pockets. In still other embodiments the carriage engagement features may include both pockets and bosses and the ISA bottom engagement features may be in the form of bosses and pockets as necessary to mate with the corresponding carriage engagement features.

[0094] FIG. 15 shows an embodiment of the ISA 300 and a surgical instrument 120 with the ISA and the surgical instrument rotated away from each other to show the surfaces that engage each other. As previously discussed, the ISA couplers 330 engage corresponding instrument drivers 1500 to transfer the rotary motion from the carriage drivers 320 (Fig. 14) to the surgical instrument 120. In the embodiment shown, each instrument driver 1500 includes two instrument engagement features 1520 in form of pockets. The corresponding ISA coupler 330 includes a like number of ISA top engagement features 600 in the form of bosses. Each ISA engagement feature 600 mates with a corresponding instrument engagement feature 1520 to provide a positive connection between the ISA coupler 330 and the instrument driver 1500. In other embodiments different numbers of engagement features may be used. In other embodiments the instrument engagement features may be in form of bosses and the ISA top

engagement features may be in the form of pockets. In still other embodiments the instrument engagement features may include both pockets and bosses and the ISA top engagement features may be in the form of bosses and pockets as necessary to mate with the corresponding instrument engagement features.

[0095] One solution presented above discusses implementing a locking mechanism in the ISA 300 which restricts ability of the ISA couplers 330 to rotate during the engagement process, thereby ensuring that the friction caused by the ISA bottom engagement features 610 coming into contact with the carriage disks 320 did not prevent a proper engagement between the ISA bottom engagement features 610 and the carriage engagement features 1220.

[0096] However, even if the locking mechanism is implemented in the ISA 300, it may take several rotations of the carriage drivers to ensure a successful engagement of the ISA engagement features 600, 610 with the corresponding carriage and instrument engagement features 1220, 1520.

First Embodiment

[0097] In a first embodiment, the motors may be limited as to the rotational speed of the carriage drivers 320. By limiting the rotational speed of the carriage drivers 320, it can be ensured that the spring-loaded mechanism of the carriage drivers 320 will be sufficiently strong to engage the ISA bottom engagement features 610 with the carriage engagement features 1220. Likewise the limited rotational speed of the carriage drivers 320 allows the spring-loaded mechanism of the instrument drivers 1520 to reliably engage the ISA top engagement features 600. In some embodiments only the carriage drivers provide a spring-loaded mechanism that cause engagement of both the carriage engagement features with the ISA bottom engagement features and the ISA top engagement features with the instrument engagement features.

[0098] In one embodiment, a limitation of the rotational speed of the motors that drive the carriage drivers 320 may be controlled by a software module. In a second embodiment, the rotational speed of the motor may be limited by the applied voltage, current, and/or frequency of the current. The

appropriate rotational speed of the carriage drivers 320 may be established by an analysis of the geometry and physics associated with the ISA couplers 330, the carriage and instrument drivers 320, 1520, and the associated spring-loaded mechanisms.

5 **Second Embodiment**

[0099] In some embodiments, the engagement feature configured as a pocket may be configured with an entry ramp to increase the ease of the process of mating with the engagement feature configured as a boss.

[00100] For ease of explanation, the engagement features to couple the carriage 310 and the ISA 300 will be described. However, it should be understood that these features may also be used to couple the instrument 120 and the ISA 300. In the embodiments discussed below, it will be assumed that the engagement feature of the carriage 310 is configured as a pocket and the engagement figure of the ISA 300 is configured as a boss. However, in another embodiment, the engagement feature of the carriage 310 may be configured as a boss and the engagement feature of the ISA 300 may be configured as a pocket.

[00101] Referring to FIG. 16A, an exemplary illustration of an ISA bottom boss 610 approaching a carriage pocket 1220 without an entry ramp is illustrated. It is seen in FIG. 16A that carriage pocket wall 1600 is at a 90-degree angle 1621 in relation to the surface 1210 of the carriage disk 320. The ISA bottom boss 610 will insert into the carriage pocket 1220 only when the two engagement features are in direct alignment. The size of the protrusion of the ISA bottom boss 610 will correspond almost exactly to size of the opening of the carriage pocket 1220 to decrease the backlash that may arise during rotation of the carriage drivers 320 and the ISA couplers 330 after a successful proper engagement. Therefore, it is difficult for the ISA bottom boss 610 to be inserted into the carriage pocket 1220, especially when the carriage drivers 320 are rotating at a high speed.

[00102] Referring to FIG. 16B, an exemplary illustration of a failed attempt at coupling the ISA bottom boss 610 with the carriage pocket 1220 is illustrated. As is seen in FIG. 16B, the ISA bottom boss 610 may bypass

the carriage pocket 1220, resulting in a failed attempt to couple the two engagement features.

[00103] Referring to FIG. 17A, an exemplary illustration of an ISA bottom boss 610 approaching a carriage pocket 1221 including an entry ramp 1720 is illustrated. It is seen in FIG. 17A that a wall of the carriage pocket 1221 includes an entry ramp 1720 and a straight portion 1700. The entry ramp 1720 is seen to form an obtuse angle of more than 90 degrees in relation to the surface 1210 of the carriage disk 320 that supports the ISA bottom boss 610 before it engages the carriage pocket 1221. When the ISA bottom boss 610 approaches the carriage pocket 1221, the entry ramp 1720 allows the ISA bottom boss 610 to begin insertion into the carriage pocket 1221 before the leading ISA boss wall 1770 reaches the trailing pocket wall 1750.

[00104] Referring to FIG. 17B, an exemplary illustration of an ISA bottom boss 610 approaching a carriage pocket 1221 and using the entry ramp 1720 to begin insertion into the carriage pocket 1221 is shown. When the ISA bottom boss 610 begins sliding down the entry ramp 1720, the ISA boss 1760 begins to enter carriage pocket 1221. As the ISA coupler 330 continues to rotate, the leading ISA boss wall 1770 comes in contact with the trailing pocket wall 1750 and the ISA bottom boss 610 is prevented from bypassing the carriage pocket 1221. The spring-loaded mechanism of the carriage driver 320 is then able to propel the insertion of the ISA bottom boss 610 into the carriage pocket 1221. As suggested by Figure 17B, if the carriage driver 320 contains a spring-loaded mechanism, the carriage driver 320 will rise from the carriage to cause the ISA bottom boss 610 to enter the carriage pocket 1221.

[00105] The angle 1721 of entry ramp 1720 in relation to the surface 1210 of the carriage disk 320 shown is only one exemplary embodiment. The angle of the entry ramp may be more than or less than the angle 1721 shown. However, the entry ramp 1720 will always form an obtuse angle with the surface 1210 of the carriage disk 320. It will be appreciated that the entry ramp 1720 should be configured so that the straight portion 1700 of the wall of the carriage pocket 1221 provides an adequate bearing surface to

support the ISA bottom boss 610 when driven against the straight portion of the wall. At a minimum, the straight portion 1700 of the wall needs to be sufficiently high to prevent the ISA coupler 330 from disengaging from the carriage driver 320 when driven in the reverse direction from the direction
5 for engagement.

[00106] Referring to FIG. 18A, an exemplary illustration of an ISA bottom boss 1810 that includes an entry ramp 1820 approaching a carriage pocket 1220 is illustrated. It is seen in FIG. 18A that a trailing ISA boss wall 1840 wall includes an entry ramp 1820 that forms an obtuse angle of more than
10 90 degrees in relation to the lower surface 1830 of the ISA bottom boss 1810, the lower surface supporting the ISA coupler 330 on the surface 1210 of the carriage disk 320 before it engages the carriage pocket 1221.

[00107] Referring to FIG. 18B, an exemplary illustration of the ISA bottom boss 1810 approaching the carriage pocket 1220 and using the entry ramp 1820 to begin insertion into the carriage pocket 1220. When the ISA bottom
15 boss 1810 approaches the carriage pocket 1220, the entry ramp 1820 allows the ISA bottom boss 1810 to begin insertion into the carriage pocket 1220 before the leading ISA boss wall 1870 reaches the trailing pocket wall 1850. As the ISA coupler 330 continues to rotate, the leading ISA boss wall 1870 comes in contact with the trailing pocket wall 1850 and the ISA
20 bottom boss 1810 is prevented from bypassing the carriage pocket 1220. The spring-loaded mechanism of the carriage driver 320 is then able to propel the insertion of the ISA bottom boss 610 into the carriage pocket 1220. As suggested by Figure 17B, if the carriage driver 320 contains a
25 spring-loaded mechanism, the carriage driver 320 will rise from the carriage to cause the ISA bottom boss 1810 to enter the carriage pocket 1220.

[00108] The angle of the entry ramp 1820 in relation to the lower surface 1830 of the ISA bottom boss 1810 shown is only one exemplary embodiment. The angle of the entry ramp may be more than or less than
30 the angle shown. However, the entry ramp 1820 will always form an obtuse angle with the lower surface 1830 of the ISA bottom boss 1810. It will be appreciated that the entry ramp 1820 should be configured so that the straight portion of the trailing ISA boss wall 1840 wall provides an adequate

bearing surface to support the ISA bottom boss 610 when driven against the straight portion of the wall. At a minimum, the straight portion of the trailing ISA boss wall 1840 needs to be sufficiently high to prevent the ISA coupler 330 from disengaging from the carriage driver 320 when driven in
5 the reverse direction from the direction for engagement

[00109] While certain exemplary embodiments have been described and shown in the accompanying drawings, it is to be understood that such embodiments are merely illustrative of and not restrictive on the broad invention, and that this invention is not limited to the specific constructions
10 and arrangements shown and described, since various other modifications may occur to those of ordinary skill in the art. The description is thus to be regarded as illustrative instead of limiting.

CLAIMS

What is claimed is:

1. A sterile adapter for coupling a surgical instrument and a surgical instrument manipulator, the sterile adapter comprising:
5 a bottom component including a bottom component opening with a bottom lip having a locking mechanism; and
a coupling component rotatably coupled to the bottom component, the coupling component including an engagement feature that engages the surgical instrument manipulator, the coupling
10 component further including a locking mechanism opening that engages the locking mechanism when the engagement feature has not engaged the surgical instrument manipulator.
2. The sterile adapter of claim 1, wherein the locking mechanism is configured as a boss.
- 15 3. The sterile adapter of claim 1, wherein the locking mechanism is configured as a ratchet and permits the coupling component to rotate in only one direction when the locking mechanism opening engages the locking mechanism.
4. The sterile adapter of claim 1, wherein the bottom lip includes a plurality
20 of locking mechanisms.
5. The sterile adapter of claim 4, wherein the coupling component includes a plurality of locking mechanism openings.
6. The sterile adapter of claim 5, wherein a number of locking mechanisms comprising the plurality of locking mechanisms corresponds to a number
25 of locking mechanism openings comprising the plurality of locking mechanism openings.
7. The sterile adapter of claim 1, wherein the bottom lip further has a keyway, and the coupling component further has a retention tab and a coupler lip, the retention tab aligning with the keyway to allow the

coupling component to pass through the bottom component opening, the retention tab and the coupler lip engaging the bottom lip to retain the coupling component in the bottom component opening when the retention tab and the keyway are not aligned.

5 8. The sterile adapter of claim 1, wherein the engagement feature includes an entry ramp.

9. A method for coupling a sterile adapter and a surgical instrument manipulator, the method comprising:
coupling the sterile adapter to the surgical instrument manipulator such
10 that an engagement feature on a rotatable coupling component of the sterile adapter does not engage a rotatable carriage driver on the surgical instrument manipulator which causes a locking mechanism opening on the rotatable coupling component to engage a locking mechanism on the sterile adapter that prevents
15 the rotatable coupling component from rotating; and
rotating the rotatable carriage driver on the surgical instrument manipulator to cause the rotatable coupling component on the sterile adapter to engage the rotatable carriage driver.

10. The method of claim 9, further comprising rotating the rotatable carriage driver on the surgical instrument manipulator to cause the rotatable coupling component on the sterile adapter to engage the locking mechanism on the sterile adapter.
20

11. The method of claim 9, wherein the locking mechanism permits the rotatable coupling component to rotate in only a first direction when the locking mechanism opening engages the locking mechanism, and the method further comprises rotating the rotatable carriage driver on the surgical instrument manipulator in a second direction opposite the first direction.
25

12. The method of claim 9, wherein the carriage driver further includes a carriage pocket having an entry ramp, and the method further comprises
30

rotating the carriage driver in a first direction leading with the entry ramp to cause an engagement feature on the rotatable coupling component to slide down the entry ramp and enter the carriage pocket.

13. A sterile adapter for coupling a surgical instrument and a surgical
5 instrument manipulator, the sterile adapter comprising:
means for coupling rotary motion from the surgical instrument
manipulator to the surgical instrument through the sterile adapter;
and
means for preventing rotation of the means for coupling rotary motion
10 when the means for coupling rotary motion is not positively
engaged with the surgical instrument manipulator.
14. The sterile adapter of claim 13, wherein the means for preventing
rotation of the means for coupling rotary motion prevents rotation in only
one direction of rotation.
- 15 15. The sterile adapter of claim 13, wherein the means for coupling rotary
motion includes a ramp means for encouraging positive engagement of
the means for coupling rotary motion.

1/12

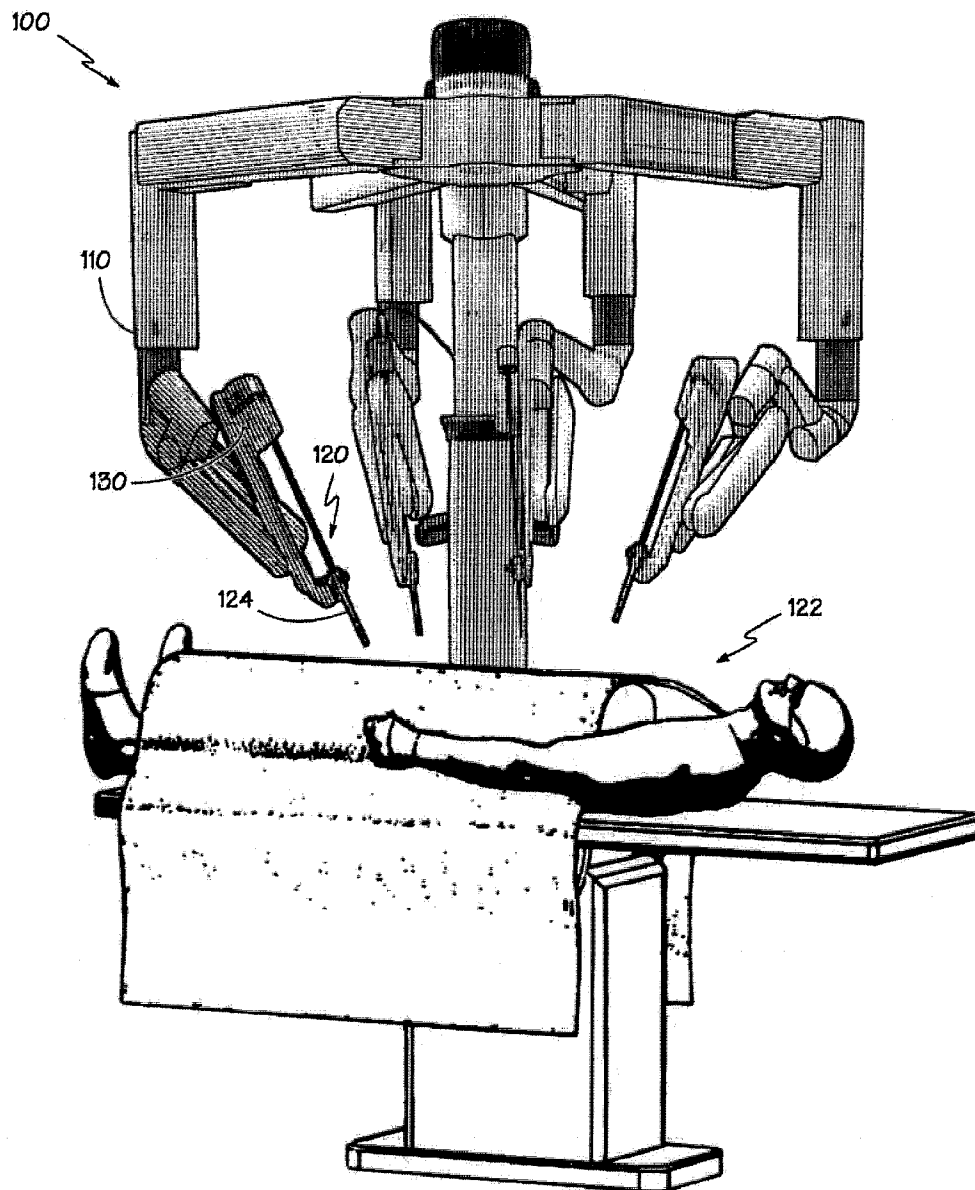

FIG. 1

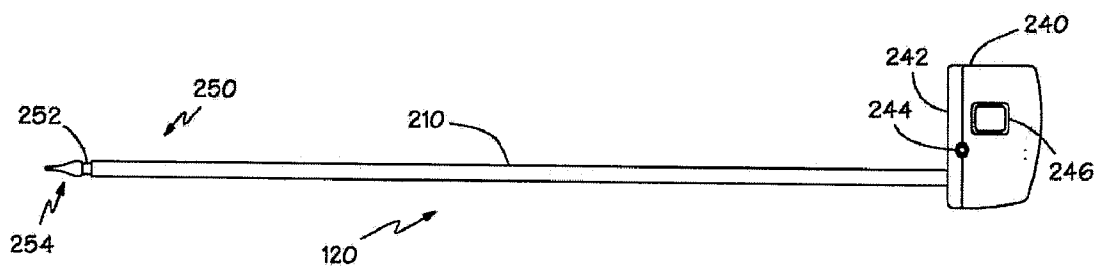

FIG. 2

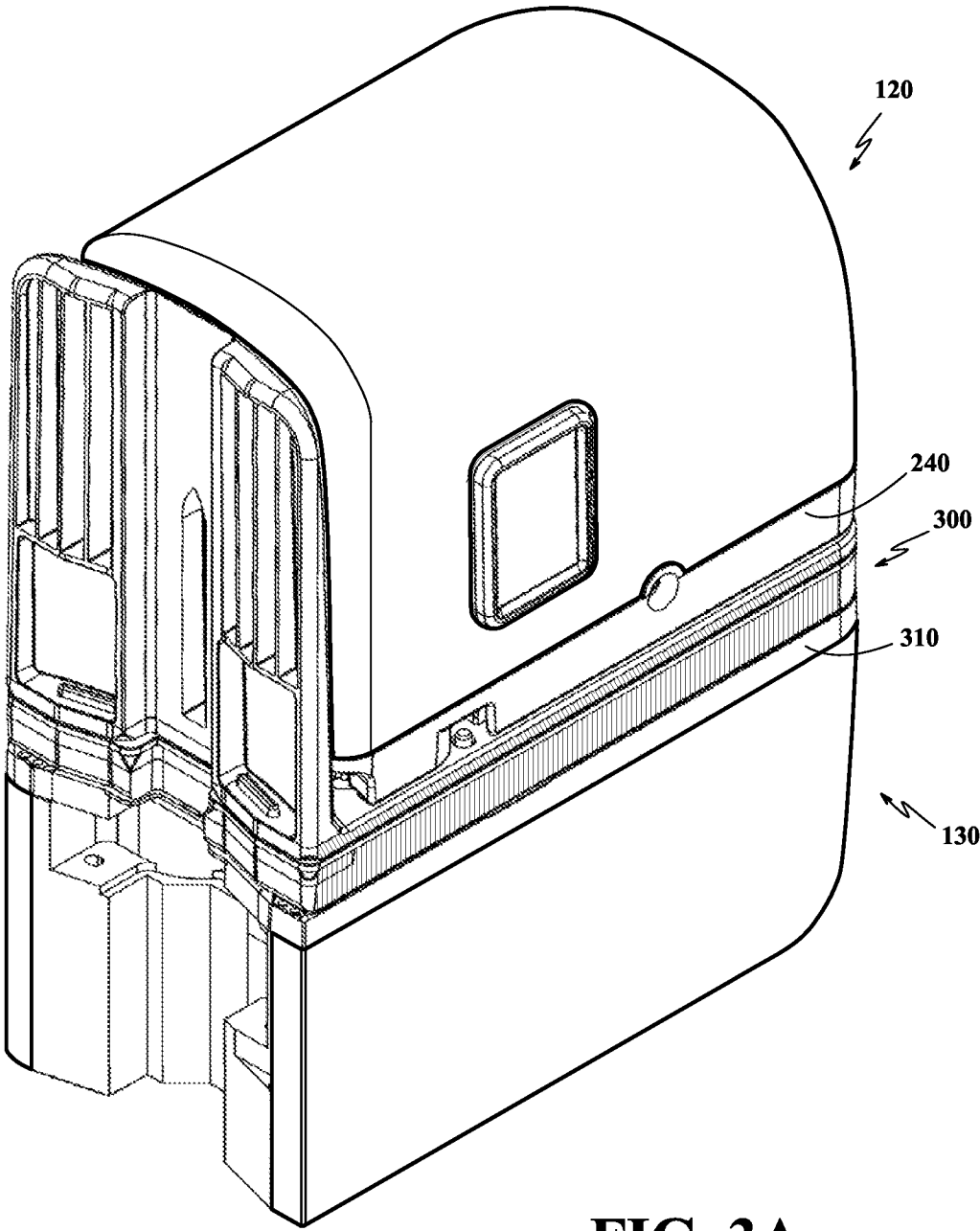

FIG. 3A

3/12

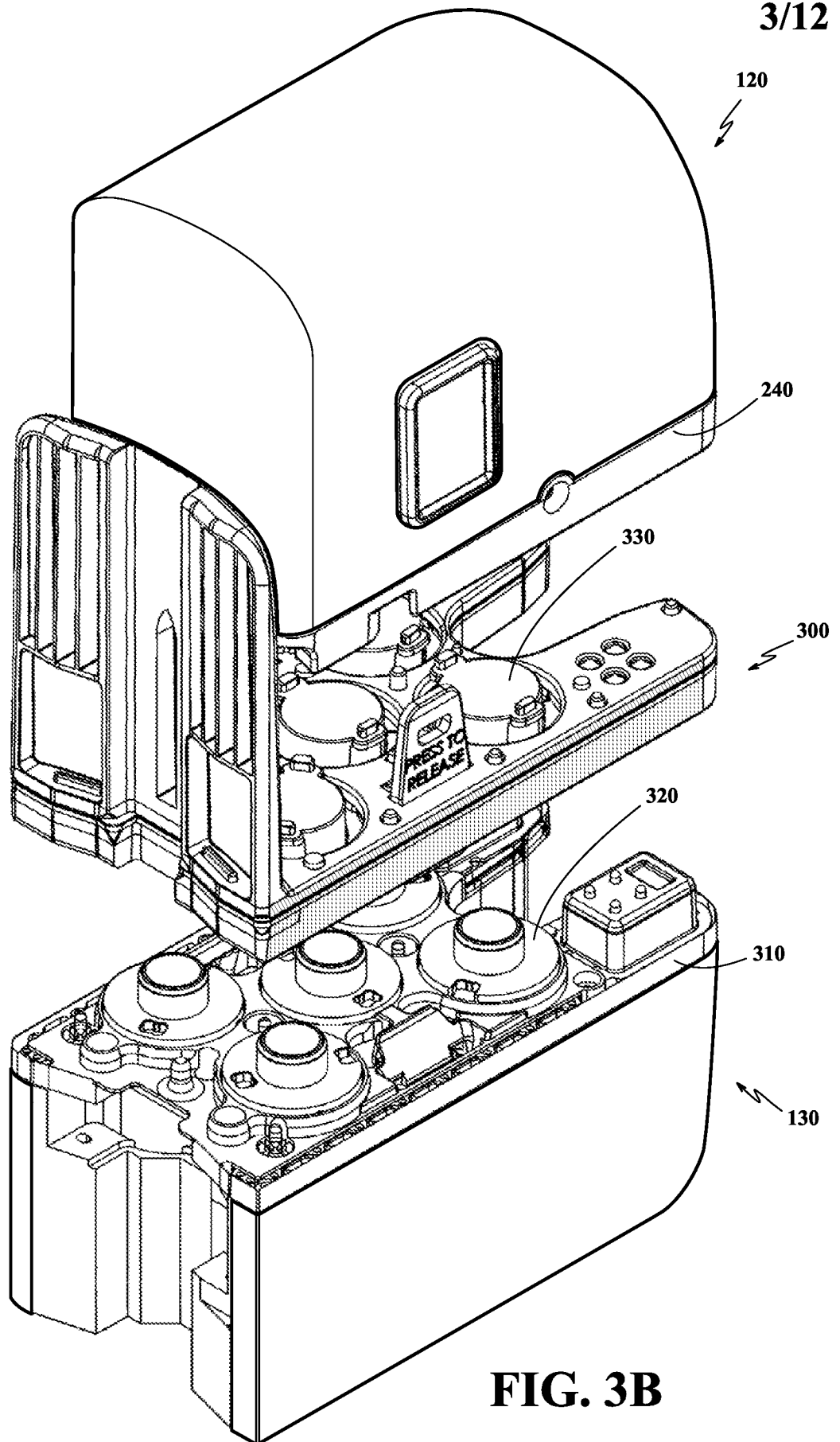

FIG. 3B

4/12

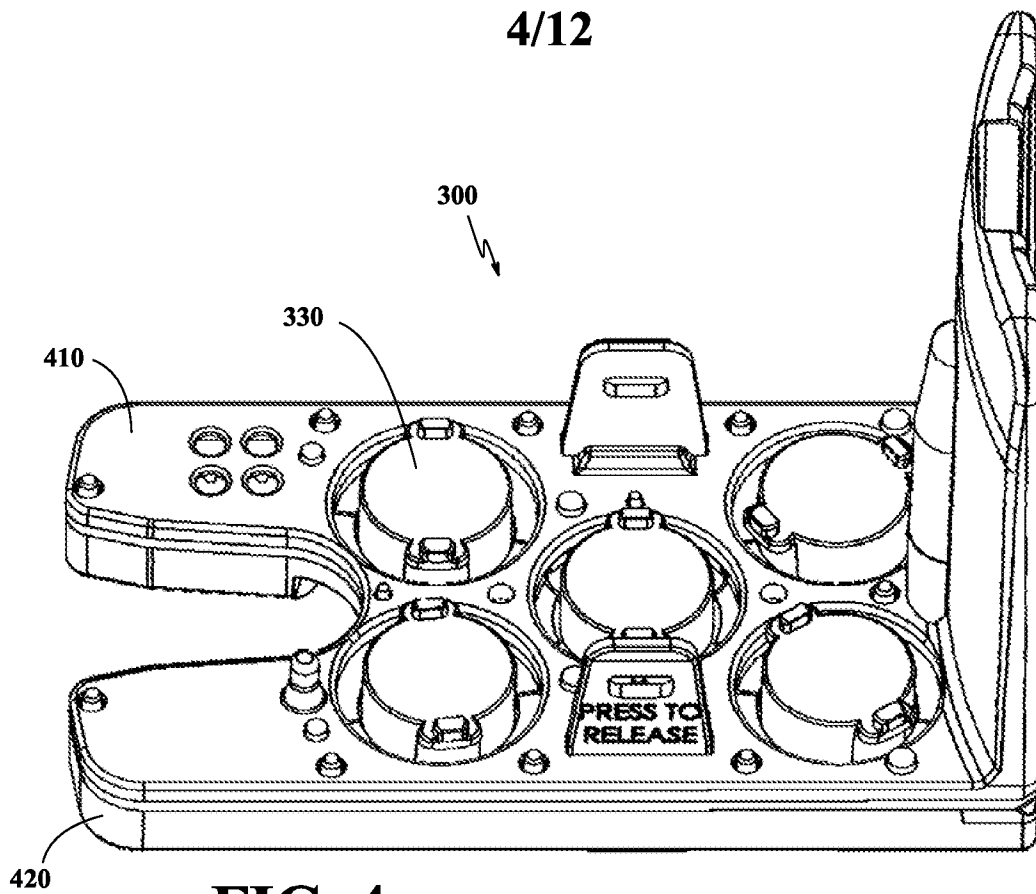

FIG. 4

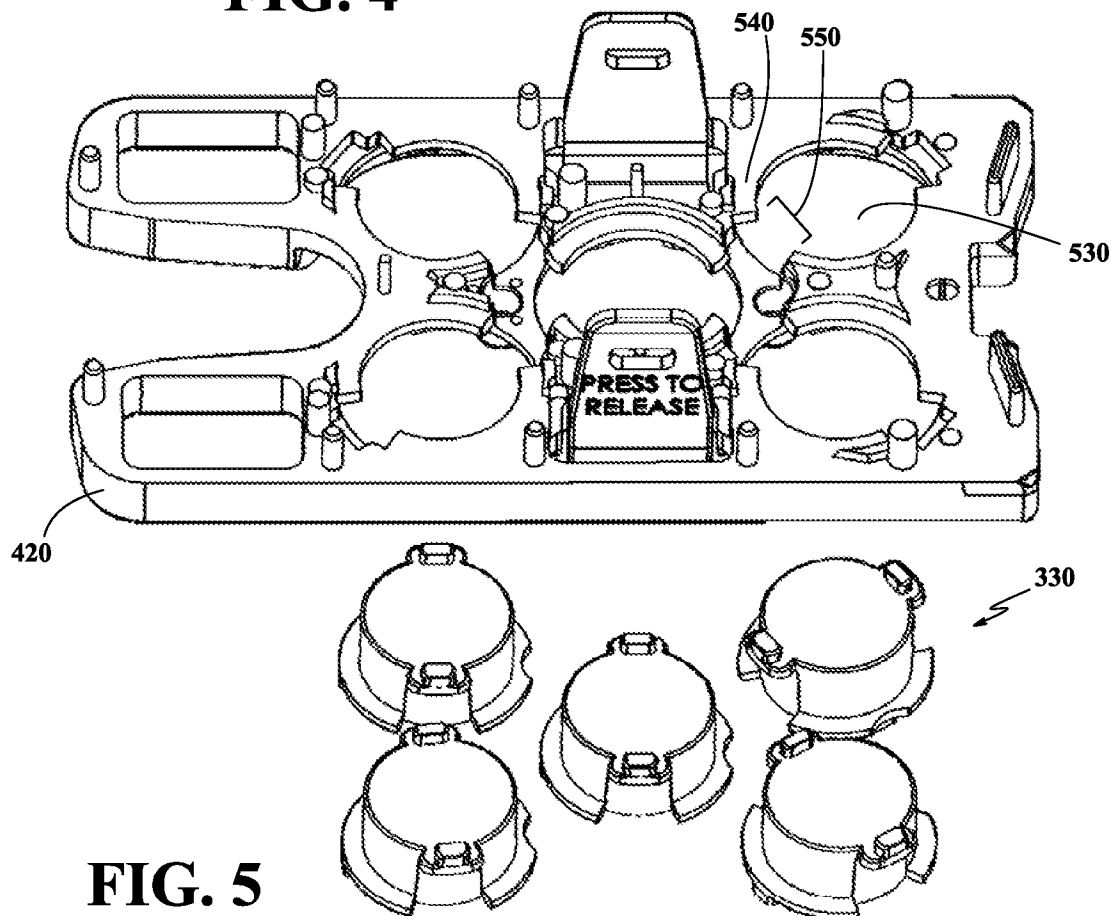

FIG. 5

5/12

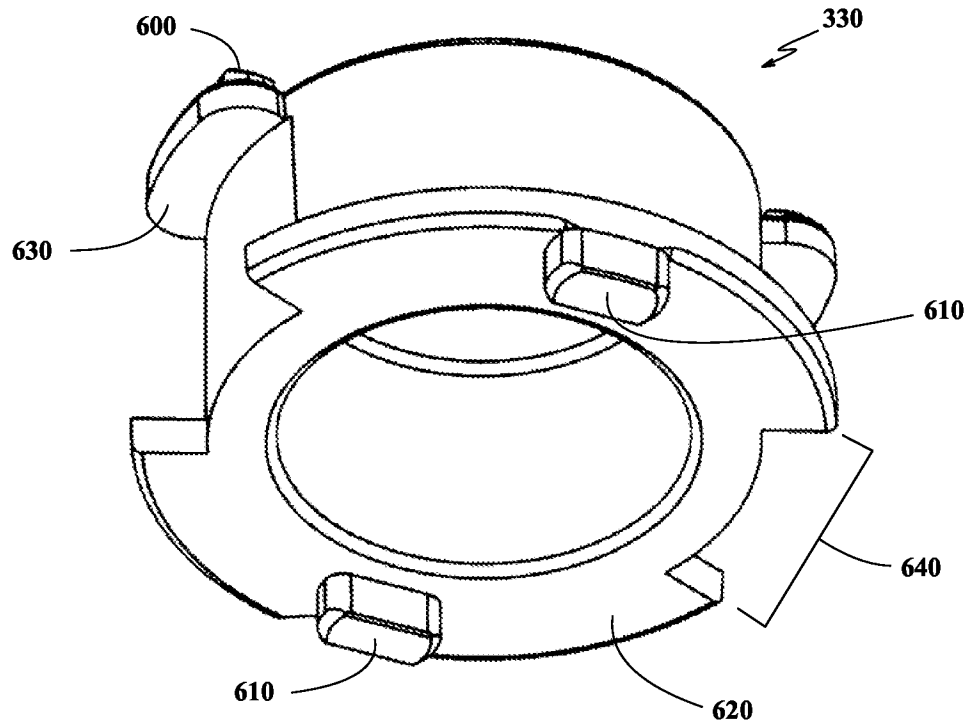

FIG. 6

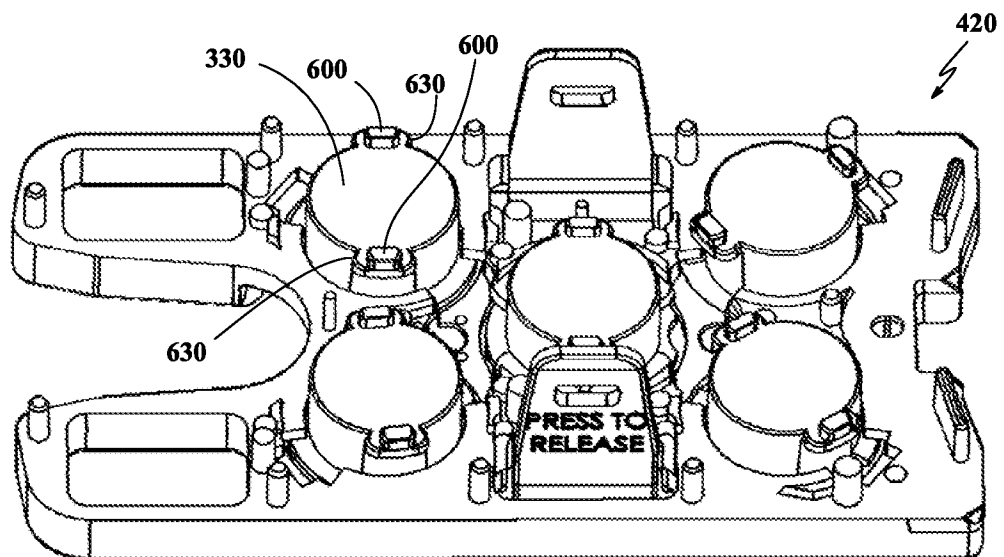

FIG. 7

6/12

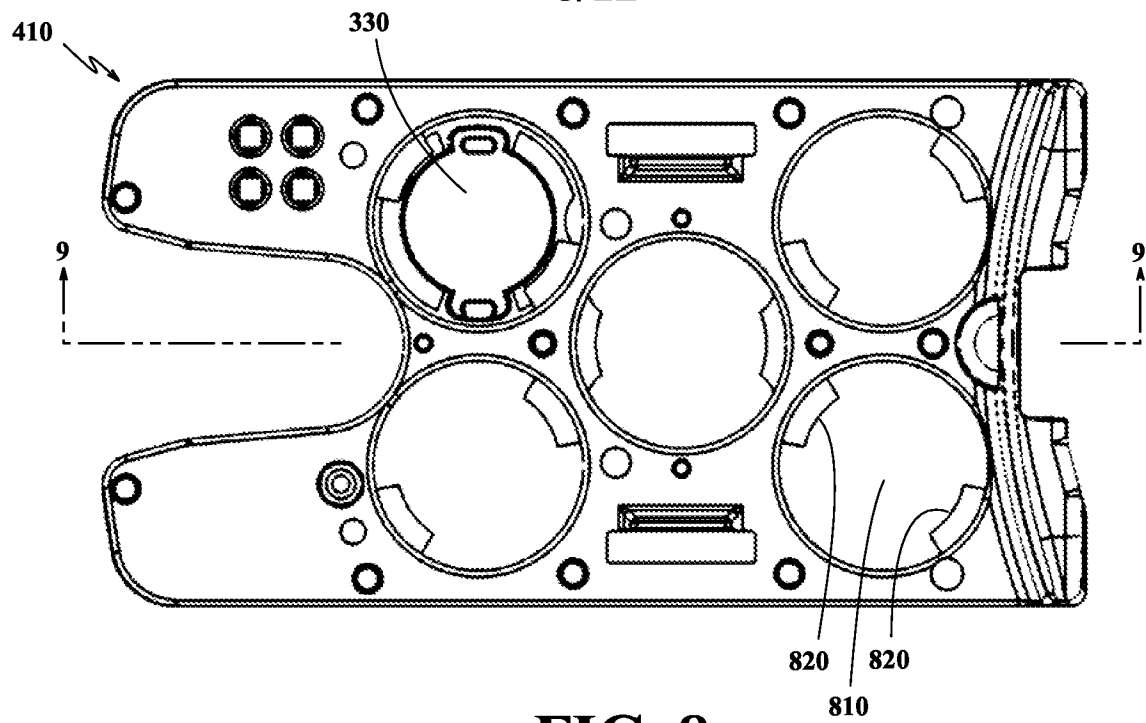

FIG. 8

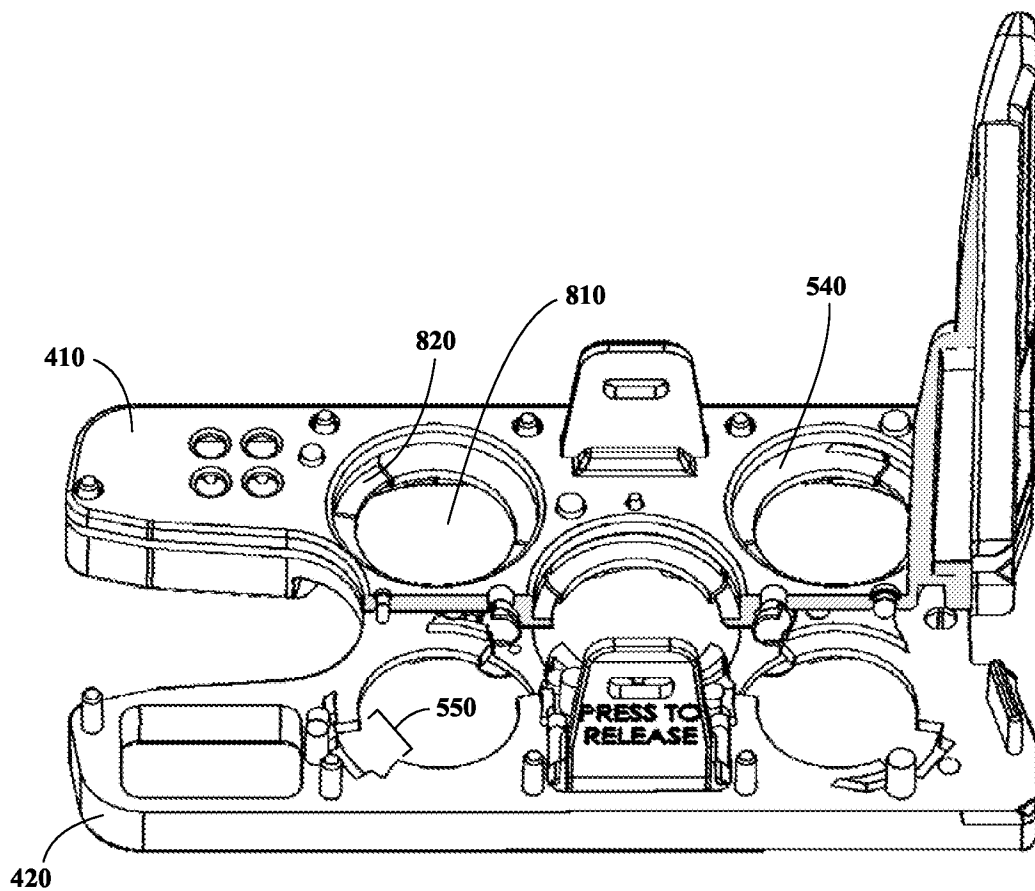

FIG. 9

7/12

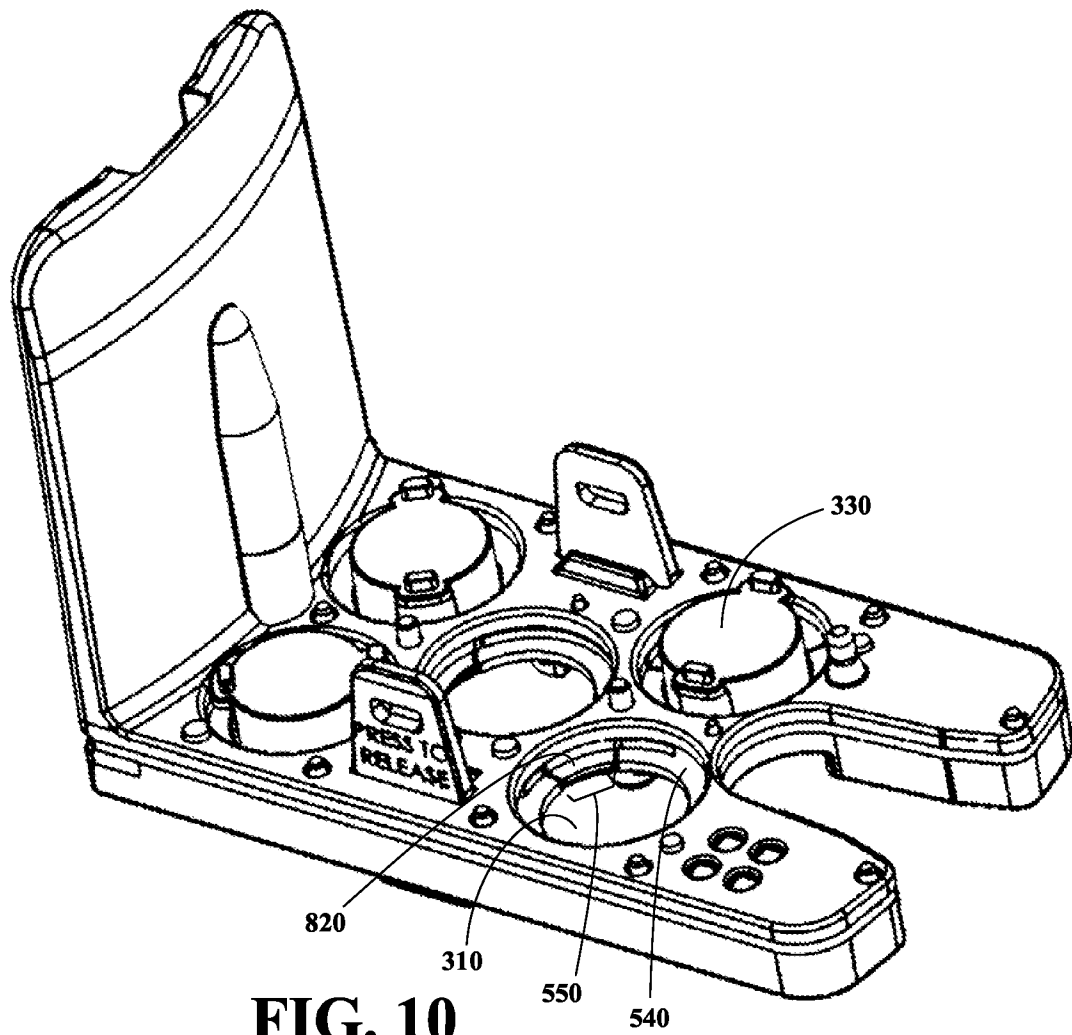

FIG. 10

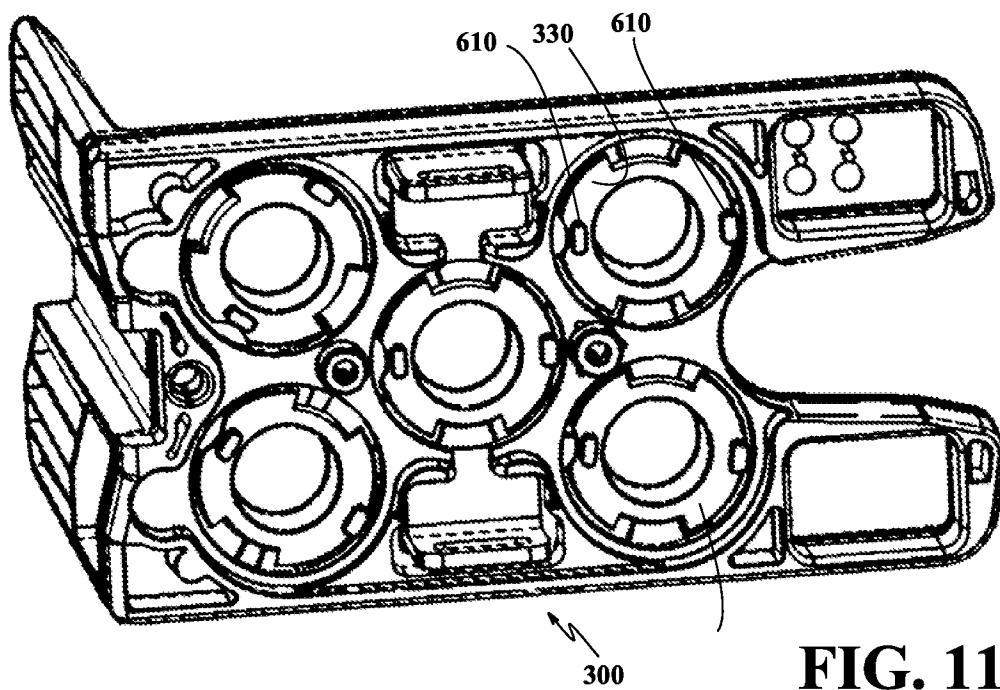

FIG. 11

8/12

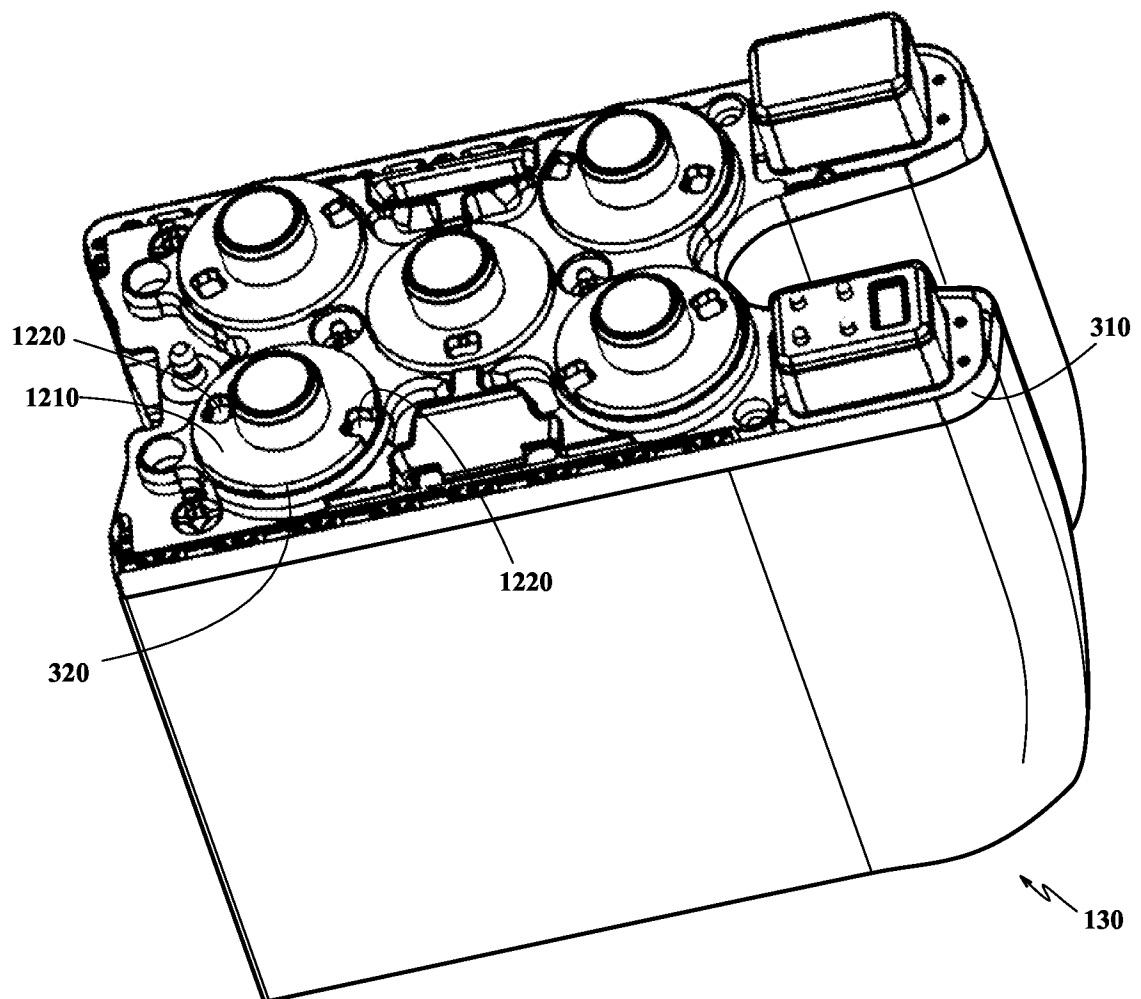

FIG. 12

9/12

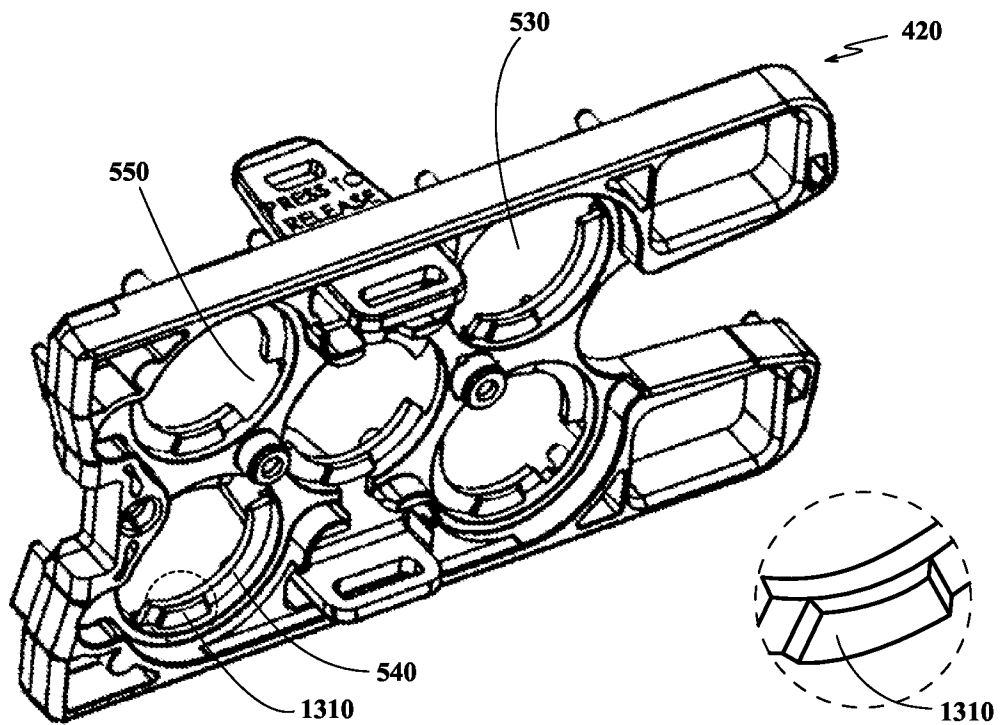

FIG. 13A FIG. 13B

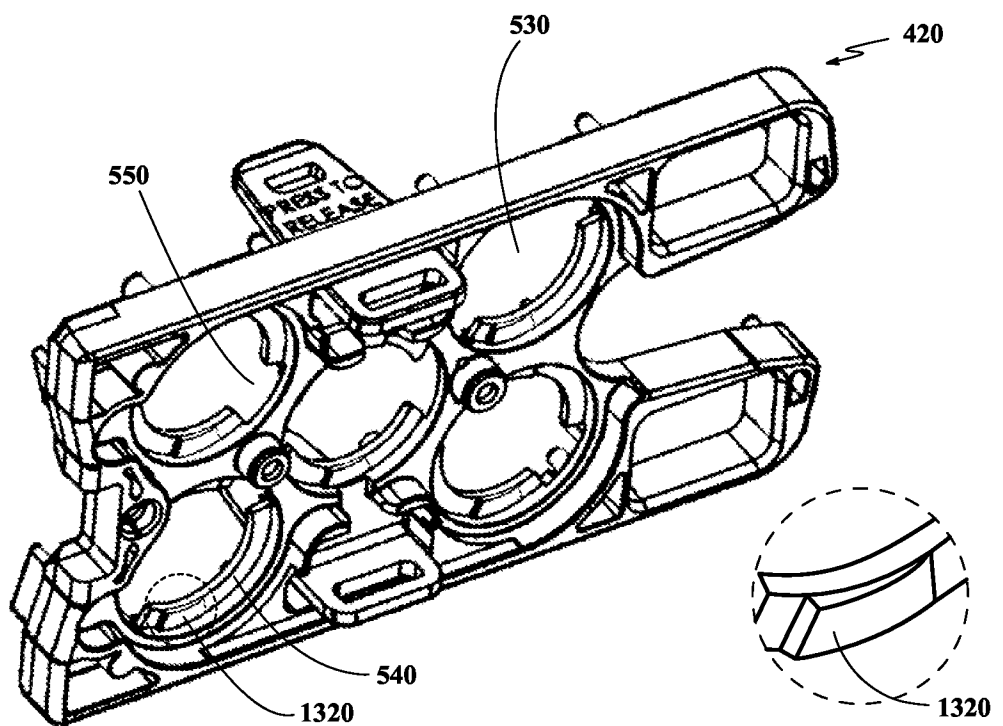

FIG. 13C FIG. 13D

10/12

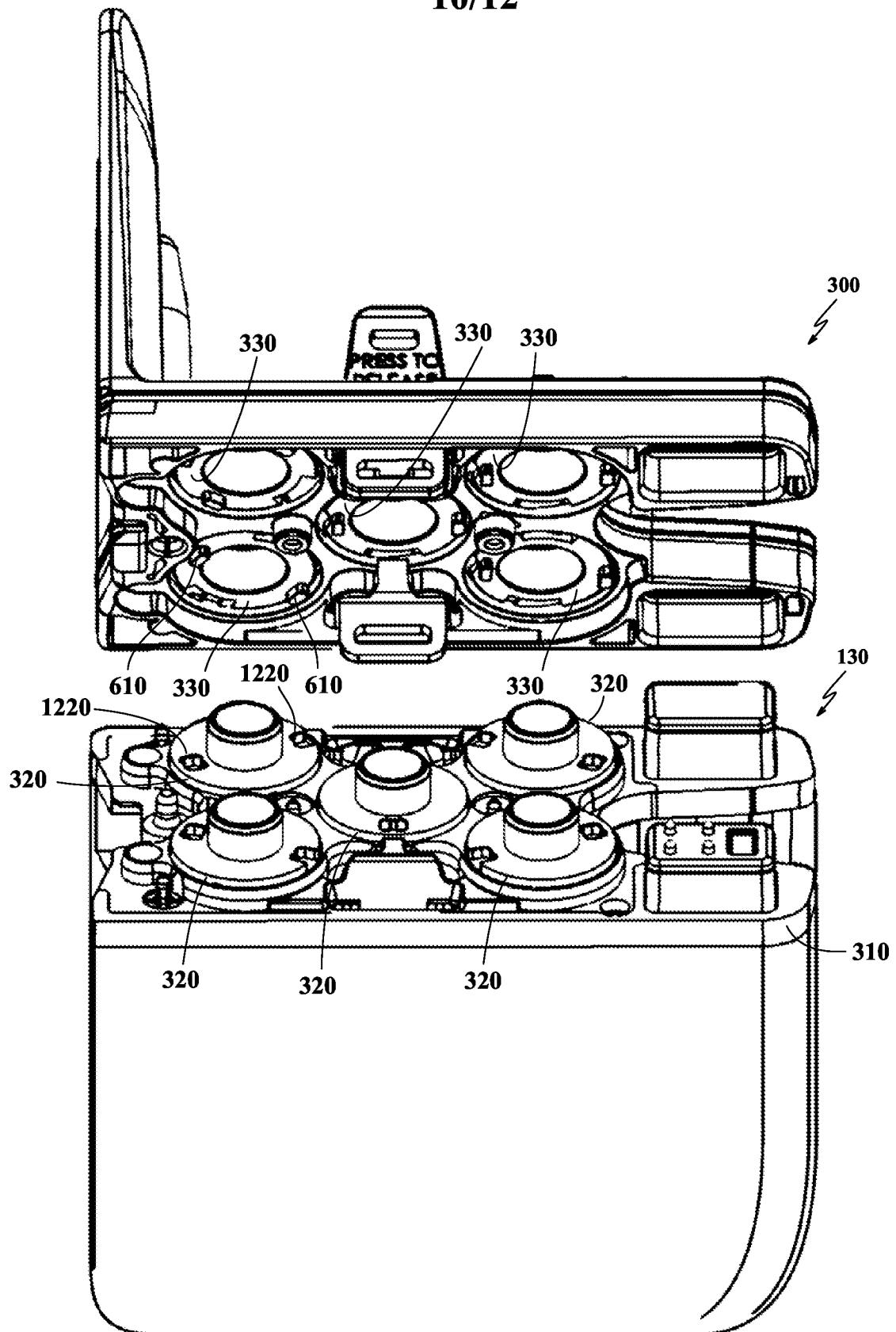

FIG. 14

11/12

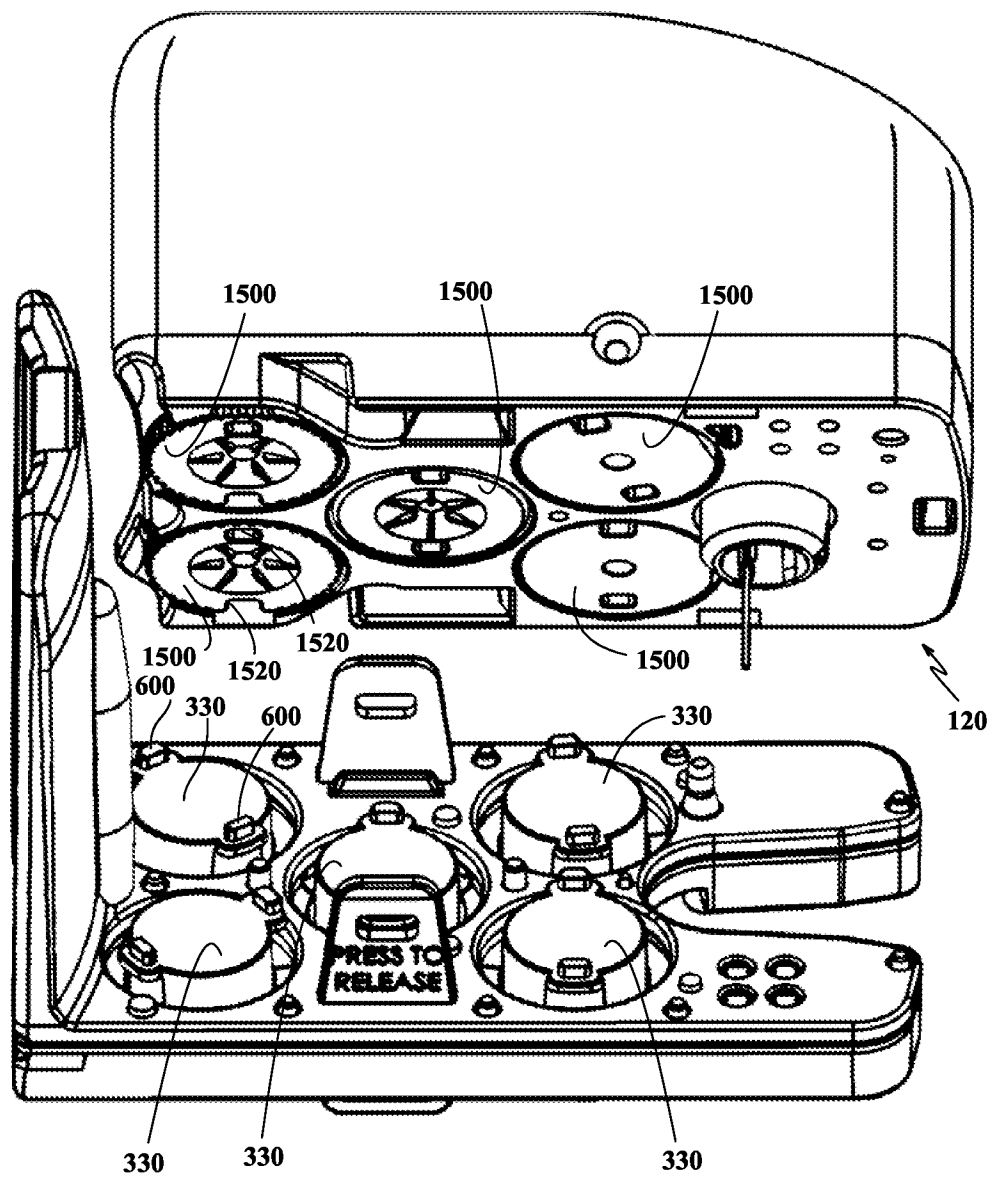

FIG. 15

300

12/12

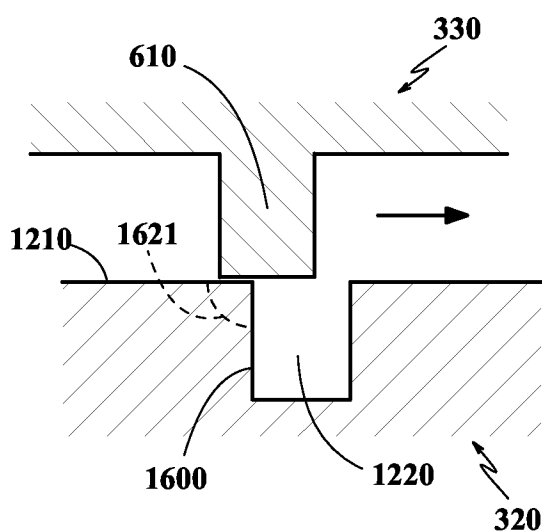

FIG. 16A

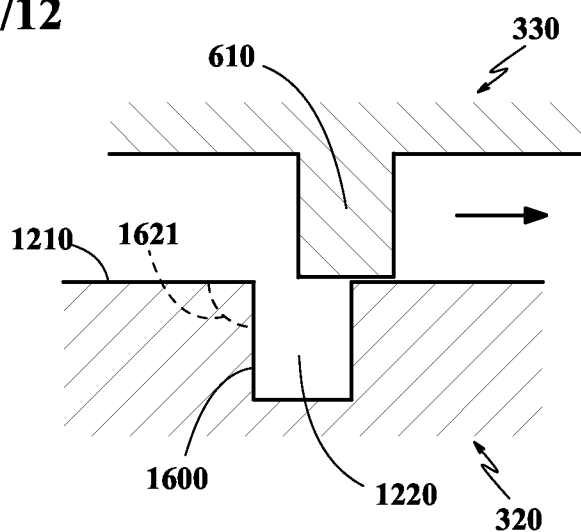

FIG. 16B

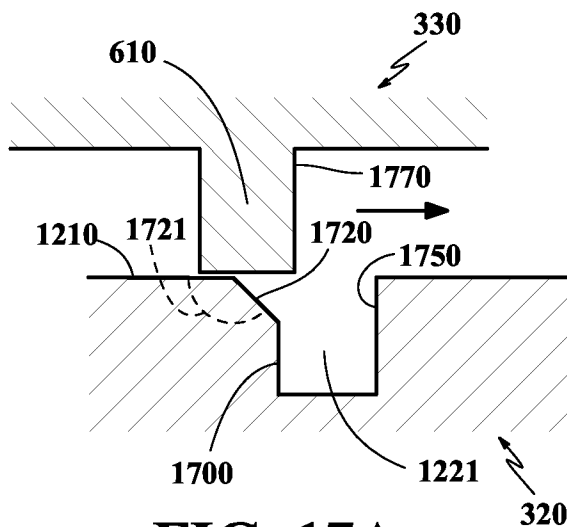

FIG. 17A

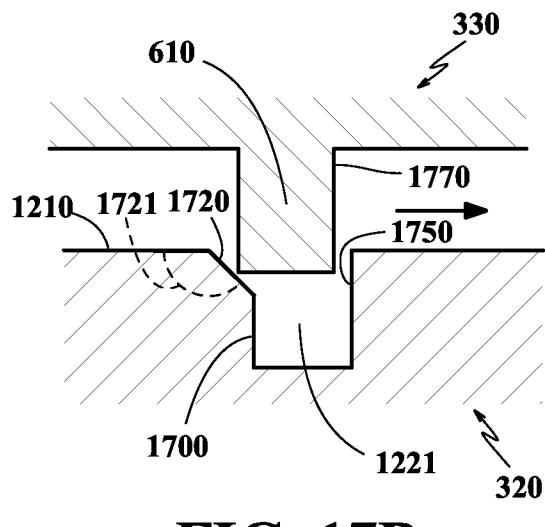

FIG. 17B

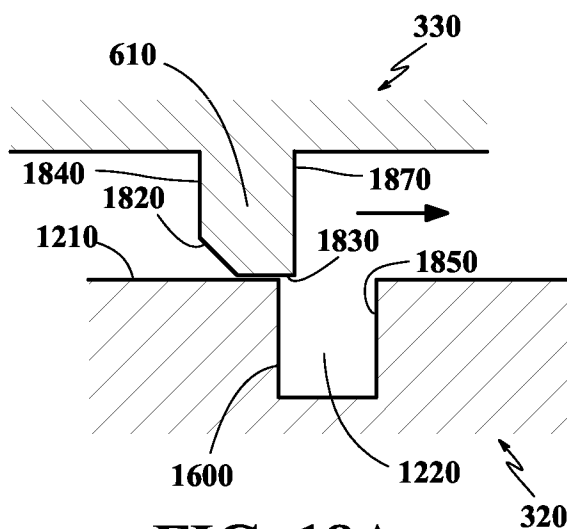

FIG. 18A

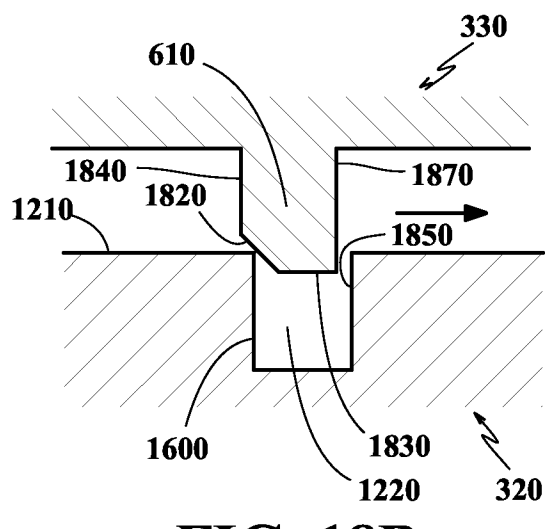

FIG. 18B

INTERNATIONAL SEARCH REPORT

International application No.
PCT/US2015/020884**A. CLASSIFICATION OF SUBJECT MATTER****A61B 19/00(2006.01)i**

According to International Patent Classification (IPC) or to both national classification and IPC

B. FIELDS SEARCHED

Minimum documentation searched (classification system followed by classification symbols)

A61B 19/00; A61B 19/08; A61B 19/10

Documentation searched other than minimum documentation to the extent that such documents are included in the fields searched

Korean utility models and applications for utility models

Japanese utility models and applications for utility models

Electronic data base consulted during the international search (name of data base and, where practicable, search terms used)

eKOMPASS(KIPO internal) & Keywords: sterile adaptor, bottom component opening, bottom lip, locking mechanism, coupling component, engagement feature, locking mechanism opening**C. DOCUMENTS CONSIDERED TO BE RELEVANT**

Category*	Citation of document, with indication, where appropriate, of the relevant passages	Relevant to claim No.
X	US 2012-0239060 A1 (ORBAN, III, JOSEPH P.) 20 September 2012 See paragraphs [0082], [0083], [0096]-[0109], [0120]-[0124], [0126]-[0133]; and figures 9A, 9B, 12A-17F, 27A-30, 32A-37B.	1-15
A	US 2011-0295270 A1 (GIORDANO et al.) 1 December 2011 See paragraphs [0223]-[0226]; and figures 26-31.	1-15
A	US 2014-0069437 A1 (REIS et al.) 13 March 2014 See paragraphs [0047]-[0065]; and figures 2-6D.	1-15
A	US 2010-0170519 A1 (ROMO et al.) 8 July 2010 See paragraphs [0034]-[0052]; and figures 1-10B.	1-15
A	US 8506555 B2 (RUIZ MORALES, EMILIO) 13 August 2013 See abstract; column 9, line 13-column 16, line 24; column 17, line 27-column 22, line 14; and figures 1-18.	1-15



Further documents are listed in the continuation of Box C.



See patent family annex.

* Special categories of cited documents:

"A" document defining the general state of the art which is not considered to be of particular relevance

"E" earlier application or patent but published on or after the international filing date

"L" document which may throw doubts on priority claim(s) or which is cited to establish the publication date of another citation or other special reason (as specified)

"O" document referring to an oral disclosure, use, exhibition or other means

"P" document published prior to the international filing date but later than the priority date claimed

"T" later document published after the international filing date or priority date and not in conflict with the application but cited to understand the principle or theory underlying the invention

"X" document of particular relevance; the claimed invention cannot be considered novel or cannot be considered to involve an inventive step when the document is taken alone

"Y" document of particular relevance; the claimed invention cannot be considered to involve an inventive step when the document is combined with one or more other such documents, such combination being obvious to a person skilled in the art

"&" document member of the same patent family

Date of the actual completion of the international search

11 June 2015 (11.06.2015)

Date of mailing of the international search report

12 June 2015 (12.06.2015)

Name and mailing address of the ISA/KR

International Application Division
Korean Intellectual Property Office
189 Cheongsu-ro, Seo-gu, Daejeon Metropolitan City, 302-701,
Republic of Korea

Facsimile No. +82-42-472-7140

Authorized officer

CHANG, Bong Ho

Telephone No. +82-42-481-3353



INTERNATIONAL SEARCH REPORT

Information on patent family members

International application No.

PCT/US2015/020884

Patent document cited in search report	Publication date	Patent family member(s)	Publication date
US 2012-0239060 A1	20/09/2012	US 2008-0140088 A1 US 8206406 B2 US 8998930 B2 WO 2009-061915 A2 WO 2009-061915 A3	12/06/2008 26/06/2012 07/04/2015 14/05/2009 23/07/2009
US 2011-0295270 A1	01/12/2011	CN 103702624 A EP 2713899 A1 US 2012-0211546 A1 US 2014-0171966 A1 US 2014-0291378 A1 US 2015-0083781 A1 US 2015-0090760 A1 US 2015-0090761 A1 US 2015-0090762 A1 US 8479969 B2 US 8684253 B2 WO 2012-166476 A1 WO 2012-166476 A8	02/04/2014 09/04/2014 23/08/2012 19/06/2014 02/10/2014 26/03/2015 02/04/2015 02/04/2015 02/04/2015 09/07/2013 01/04/2014 06/12/2012 12/12/2013
US 2014-0069437 A1	13/03/2014	US 2010-0175701 A1 US 8602031 B2 WO 2010-081050 A1	15/07/2010 10/12/2013 15/07/2010
US 2010-0170519 A1	08/07/2010	US 8720448 B2	13/05/2014
US 8506555 B2	13/08/2013	AT 507942 T BR PI0707443 A2 CA 2635136 A1 CA 2635136 C CN 101443162 A CN 101443162 B DK 1979136 T3 EP 1815950 A1 EP 1979136 A1 EP 1979136 B1 ES 2365359 T3 JP 05130228 B2 JP 2009-525098 A KR 10-1375206 B1 KR 10-2008-0100212 A MX 2008010058 A PT 1979136 E RU 2008135241 A RU 2412800 C2 US 2009-0024142 A1 WO 2007-088208 A1	15/05/2011 03/05/2011 09/08/2007 16/09/2014 27/05/2009 07/09/2011 27/06/2011 08/08/2007 15/10/2008 04/05/2011 30/09/2011 30/01/2013 09/07/2009 17/03/2014 14/11/2008 12/11/2008 21/07/2011 10/03/2010 27/02/2011 22/01/2009 09/08/2007