



(12) **EUROPEAN PATENT SPECIFICATION**

(45) Date of publication and mention  
of the grant of the patent:  
**27.12.2006 Bulletin 2006/52**

(51) Int Cl.:  
**A44B 21/00** (2006.01) **A41H 37/10** (2006.01)  
**B25C 5/11** (2006.01) **B65C 7/00** (2006.01)  
**B65D 85/24** (2006.01) **G09F 3/08** (2006.01)  
**G09F 3/14** (2006.01) **B29C 45/26** (2006.01)

(21) Application number: **00916055.7**

(86) International application number:  
**PCT/US2000/005649**

(22) Date of filing: **02.03.2000**

(87) International publication number:  
**WO 2000/051792 (08.09.2000 Gazette 2000/36)**

(54) **FASTENER DISPENSING TOOL FOR PLASTIC FASTENERS**

AUSGABEVORRICHTUNG FÜR KUNSTSTOFF-BEFESTIGUNGSELEMENTE

OUTIL DISTRIBUTEUR D'AGRAFES EN MATIERE PLASTIQUE

(84) Designated Contracting States:  
**DE FR GB IT**

• **GRENDOL, Clark, L.**  
**Sturbridge, MA 01566 (US)**

(30) Priority: **02.03.1999 US 122557 P**  
**13.01.2000 US 483181**  
**13.01.2000 US 483180**

(74) Representative: **Schubert, Klemens**  
**Neue Promenade 5**  
**10178 Berlin-Mitte (DE)**

(43) Date of publication of application:  
**15.05.2002 Bulletin 2002/20**

(56) References cited:

<b>AU-B- 243 745</b>	<b>US-A- 3 103 666</b>
<b>US-A- 3 325 853</b>	<b>US-A- 3 494 004</b>
<b>US-A- 3 733 657</b>	<b>US-A- 4 039 078</b>
<b>US-A- 4 417 656</b>	<b>US-A- 4 456 123</b>
<b>US-A- 4 456 161</b>	<b>US-A- 4 533 076</b>
<b>US-A- 4 534 464</b>	<b>US-A- 4 586 609</b>
<b>US-A- 4 660 718</b>	<b>US-A- 4 901 854</b>
<b>US-A- 5 024 365</b>	<b>US-A- 5 205 458</b>
<b>US-A- 5 321 872</b>	<b>US-A- 5 405 070</b>
<b>US-A- 5 463 799</b>	<b>US-A- 5 593 033</b>
<b>US-A- 5 683 025</b>	<b>US-A- 5 772 073</b>
<b>US-A- 5 810 238</b>	<b>US-A- 6 026 544</b>

(73) Proprietor: **AVERY DENNISON CORPORATION**  
**Pasadena, CA 91103 (US)**

(72) Inventors:

- **RAYMOND, Jeffrey, A.**  
**Leominster, MA 01453 (US)**
- **DAVIGNON, Paul, A.**  
**Uxbridge, MA 01569 (US)**
- **DESCHENES, Charles, L.**  
**North Attleboro, MA 02760 (US)**
- **COOPER, William, J.**  
**Woonsocket, RI 02895 (US)**

Note: Within nine months from the publication of the mention of the grant of the European patent, any person may give notice to the European Patent Office of opposition to the European patent granted. Notice of opposition shall be filed in a written reasoned statement. It shall not be deemed to have been filed until the opposition fee has been paid. (Art. 99(1) European Patent Convention).

## Description

### BACKGROUND OF THE INVENTION

**[0001]** The present invention relates generally to the fastening of objects using plastic fasteners and relates more particularly to a novel fastener dispensing tool.

**[0002]** Certain articles of clothing, most notably men's dress shirts, are often packaged and sold in a folded condition so as to minimize any wrinkling of the article and so as to present the article in an otherwise flattering manner. Typically, the article is maintained in a folded condition by means of one or more straight metal pins, each of said straight metal pins typically comprising an elongated shaft terminating at one end in a sharp tip designed to penetrate the article and at the other end in a rounded head designed not to penetrate the article. Typically in use, the article is folded, and a plurality of said pins are used to maintain the article in its folded condition by securing the article to itself at a plurality of different locations. Often, in the case of men's dress shirts, one or more of said pins are additionally used to secure the shirt to a piece of cardboard or to a similar backing material. The act of using straight metal pins to maintain an article of clothing in a folded condition is typically referred to in the art as "shirt-pinning."

**[0003]** Although straight metal pins have achieved widespread use in maintaining articles of clothing in a folded condition, certain shortcomings are associated therewith. One such shortcoming is that no suitable tool exists for dispensing such pins into an article of clothing; consequently, the pins must be inserted manually. As can readily be appreciated, the repeated insertion of such pins into articles of clothing, over time, can become both physically and mentally taxing. Another shortcoming associated with the use of straight metal pins is that the pins, as noted above, have sharp ends, which can cause injury both to the person who must insert the pin into the article and to the person (i.e., consumer) who must remove the pin from the article. Moreover, once the pins are removed from the article, they must be disposed of properly to avoid injury to others. Still another shortcoming associated with the use of straight metal pins is that such pins, when inserted, may cause damage to the article, either by snagging and tearing the article or by creating a conspicuous insertion hole in the article. Still yet another shortcoming associated with the use of straight metal pins is that such pins, once inserted into an article of clothing, can be difficult to access and manipulate in such a way as to enable their removal.

**[0004]** Plastic fasteners of the type comprising an elongated flexible filament having a first enlargement at one end thereof and a second enlargement at the opposite end thereof are well-known and have been widely used in the attachment of merchandise tags to articles of commerce, in the coupling or re-coupling of buttons to garments, in the binding of a shoe upper during the process of shoe-lasting, and in various packaging applications.

In one common type of plastic fastener (see, for example, Fig. 1 of U.S. Patent No. 5,321,872), the first enlargement has the shape of a first transverse bar and the second enlargement has the shape of a paddle or the shape of a second transverse bar, the first transverse bar and the paddle (or second transverse bar) extending in planes parallel to one another. In another common type of plastic fastener (see, for example, U.S. Patent No. 3,494,004), the first enlargement has the shape of a transverse bar and the second enlargement has the shape of a knob or pin head. In still another common type of plastic fastener (see, for example, U.S. Patent No. 4,240,183), the first enlargement has the shape of a transverse bar or the shape of a plug and the second enlargement has the shape of a socket, said socket being adapted to receive said transverse bar or said plug.

**[0005]** Plastic fasteners of the various types described above are typically molded as parts of a unitary fastener clip. An example of such a fastener clip is disclosed in U.S. Patent No. 3,733,657). The clip of the aforementioned '657 patent includes a plurality of fasteners, each of said fasteners comprising a flexible filament having a first transverse bar (or "cross-bar") at one end thereof and a paddle or a second transverse bar (or "cross-bar") at the opposite end thereof, the transverse bar and the paddle (or second transverse bar) of each fastener extending in planes parallel to one another. The fasteners are arranged relative to one another so that the respective transverse bars are spaced apart and oriented side-by-side and parallel to one another and so that the respective paddles (or second transverse bars) are spaced apart and oriented side-by-side and parallel to one another. The clip of the foregoing '657 patent also includes a runner bar, said runner bar extending perpendicularly relative to the respective transverse bars and being connected to each of the transverse bars by a severable connector. The clip of said '657 patent further includes a severable member interconnecting each pair of adjacent paddles (or second transverse bars).

**[0006]** Several commercial embodiments of the aforementioned fastener clip have been sold by the present assignee, Avery Dennison Corporation, as DENNISON® SWIFTACH® fastener clips. DENNISON® SWIFTACH® fastener clips comprising fasteners of the type having a cross-bar at one end of a flexible filament and a paddle at the opposite end of the flexible filament are generally made of polypropylene or nylon and are typically used to attach merchandise tags and the like to articles of clothing. The filaments of such fasteners are typically at least about 12.5 mm in length. DENNISON® SWIFTACH® fastener clips comprising fasteners of the type having a first cross-bar at one end of a flexible filament and a second cross-bar at the opposite end of the flexible filament are made of nylon and are used to attach merchandise tags and the like to a wide variety of articles of commerce. In addition, such fasteners are used in shoe-lasting applications and in packaging applications, where the high tensile strength afforded by the use of nylon in the fas-

tener is desirable. The filaments of such fasteners are typically at least about 6.35 mm in length.

**[0007]** As far as the present inventors are aware, the above-described fastener clip, exemplified by the family of DENNISON® SWIFTACH® fastener clips, has not been used to maintain an article of clothing, such as a dress shirt, in a folded condition.

**[0008]** A second type of fastener clip (or "fastener stock") is disclosed in U.S. Patent No. 4,039,078, inventor Bone, issued August 2, 1977. In said patent, the fastener stock comprises two undivided elongated and continuous plastic side members having a plurality of plastic cross links coupled to and between each of said side members, each of the links being preferably spaced equidistantly apart from each other. The fastener stock is designed to be separated or divided, e.g., by cutting, severing, rupturing or shearing the side members, to provide a plurality of fasteners, each of said fasteners preferably having a substantially H shape.

**[0009]** A commercial embodiment of the aforementioned fastener stock has been sold by the present assignee, Avery Dennison Corporation, as DENNISON® PLASTIC STAPLE™ fasteners. PLASTIC STAPLE™ fasteners are typically made of polyurethane and are often used to attach tags, at two distinct points, to pants and similar clothing articles. It is the understanding of the present inventors that, for a limited time in the past, a third party used PLASTIC STAPLE™ fasteners to "pin" shirts, albeit not dress shirts or other shirts of a fine material, so as to maintain the shirts in a folded condition. It is the understanding of the present inventors that the aforementioned securing was achieved using a dual needle fastener dispensing tool of the type disclosed in U.S. Patent No. 4,533,076 and was performed by folding the shirt, inserting both needles of the tool entirely through the folded-over article and then dispensing both cross-bars through the needles and the folded article so that both cross-bars were positioned on one side of the article, with the filament connecting the two cross-bars extending over to the opposite side of the article. It is further believed by the present inventors that the aforementioned use of such fasteners to "pin" shirts was discontinued because PLASTIC STAPLE™ fasteners did not have sufficient tensile strength to maintain the shirt in its folded condition (PLASTIC STAPLE™ fasteners typically having a tensile strength of about 594.308-635.026g (1.2-1.4 pounds)).

**[0010]** Tools (often referred to as "tagging guns") for dispensing individual fasteners from multi-fastener clips of the two different types described above are known, examples of such tools including the Dennison® Mark II™ SWIFTACH® tool, as well as those tools disclosed in U.S. Patent Nos. 5,772,073, 5,683,025, 5,024,365, 4,533,076, 4,456,161, 4,121,487, and 4,456,123.

**[0011]** Other patents that may be of interest include U.S. Patent No. 3,103,666, inventor Bone, issued September 17, 1963; U.S. Patent No. 5,593,033, inventor Kunreuther, issued January 14, 1995; U.S. Patent No. 5,463,799, inventor Graham issued November 7, 1995;

U.S. Patent No. 5,321,872, inventor Merser, issued June 21, 1994; U.S. Patent No. 3,733,657, inventor Lankton, issued May 22, 1973, U.S. Patent No. 4,660,718, inventor Kato et al., issued April 28, 1987; and U.S. Reissue Patent No. 32,332, inventor Kato, re-issued January 20, 1987.

**[0012]** The US 3,103,666 discloses a bar-lock tag for fasten a tag to a fabric, and an apparatus for applying such attachments. The apparatus includes a hollow needle elongately slotted along one side, and a plunger for driving the bar of an attachment through the needle with its filament projecting through the slot.

**[0013]** A system for attaching price tags to garments and for other joining applications using plastic fasteners dispensed through hollow, slotted needles is disclosed in the US 4,456,123. The system comprises a new method and tool for dispensing fasteners supplied in long lengths, together with improved fastener stock adapted for use therewith and for molding in continuous lengths.

**[0014]** A cluster type tag pin assembly having a multiplicity of tag pins adapted for use in securing price tags or the like to sold goods is disclosed in the US 4,417,656. The tag pin assembly includes a large number of tag pins each having a head portion, a cross bar and a filament portion through which the cross bar is connected to the head portion. Each side surface of the cross bar of each tag pin is formed at the central portion thereof with an expanded portion, and expanded portions of each adjacent cross bars are mutually joined.

**[0015]** Further the US 4,660,718 discloses a fastener assembly comprising a number of fasteners each comprising a head, a crossbar and a filament interconnecting the head and the crossbar, each adjacent crossbars being interconnected through a connecting element in a manner of not undergoing a change in their relative positions, the number of crossbars in the fastener assembly being arranged in the form of a sheet as a whole.

**[0016]** A system is described in the US 4,456,161 for attaching price tags to garments and for other joining applications using plastic fasteners dispensed through hollow, slotted needles. The system comprises a new method and tool for dispensing fasteners supplied in long lengths, together with improved fastener stock adapted for the use therewith and for molding in continuous lengths.

**[0017]** A plastic fastener for clothing and a method for its use is described by C. Deschenes, W. Cooper and C. Grendol in the WO 00/14702.

**[0018]** A tag dispensing and attaching apparatus is disclosed by D. Duchin in the US-patent 4,610,384.

**[0019]** A pistol-shaped tag fastening device having a grip, in which a trigger lever is pivotally mounted on a pin mounted on the inside of the grip is disclosed in the US-patent 5,501,002.

**[0020]** A loop pin attaching device for tag hanging is described in the US 5,738,265, with a drive lever which is selectively moveable between a first, unactivated and a second, activated position.

**[0021]** The US 4,536,933 discloses a method of connecting ends of a fastener of the type having a filament portion of a predetermined length, a tubular socket portion connected to one end of the filament portion and a pin portion connected to the other end of the filament portion, as well as a device suitable for carrying out this method.

**[0022]** Further, a button attaching device for attaching a button to a layer of material is described in the US 5,788,138.

### **SUMMARY OF THE INVENTION**

**[0023]** It is an object of the present invention to provide a fastener dispensing tool, said fastener dispensing tool comprising (a) a casing, said casing being shaped to receive, entirely within said casing, a clip of fasteners, each of said fasteners in said clip comprising a flexible filament having a first enlarged portion at a first end thereof and a second enlarged portion at a second end thereof; (b) a hollow, slotted needle coupled to said casing, said hollow, slotted needle being adapted to receive the first enlarged portion of a fastener; (c) wherein said feed track terminates behind said hollow, slotted needle in a direction substantially perpendicular to the longitudinal axis of said hollow, slotted needle; and (d) an ejector rod disposed within said casing and insertable into said hollow, slotted needle for ejecting from said hollow, slotted needle an enlarged portion of a fastener disposed therein.

**[0024]** Additional objects, features, aspects and advantages of the present invention will be set forth, in part, in the description which follows and, in part, will be obvious from the description or may be learned by practice of the invention. In the description, reference is made to the accompanying drawings which form a part thereof and in which is shown by way of illustration specific embodiments for practicing the invention. These embodiments will be described in sufficient detail to enable those skilled in the art to practice the invention, and it is to be understood that other embodiments may be utilized. The following detailed description is, therefore, not to be taken in a limiting sense, and the scope of the present invention is best defined by the appended claims.

### **BRIEF DESCRIPTION OF THE DRAWINGS**

**[0025]** The accompanying drawings, which are hereby incorporated into and constitute a part of this specification, illustrate preferred embodiments of the invention and, together with the description, serve to explain the principles of the invention. In the drawings wherein like reference numerals represent like parts:

Figs. 1(a) through 1(c) are side, top and front views, respectively, of one embodiment of a plastic fastener well-suited for maintaining a dress shirt in a folded condition in accordance with the teachings of the present invention;

Figs. 2(a) and 2(b) are partially-exploded perspective and partially-exploded side views, respectively, of one embodiment of a fastener clip constructed in accordance with the teachings of the present invention, the fastener clip including a plurality of the plastic fasteners shown in Figs. 1(a) through 1(c);

Figs. 3(a) through 3(c) are side, top and front views, respectively, of an individual fastener of the clip of Fig. 2, together with its associated connectors;

Figs. 4(a) through 4(c) are left side, front right top perspective and front views, respectively, of one embodiment of a fastener dispensing tool constructed according to the teachings of the present invention, the fastener dispensing tool being well-suited for use in dispensing individual fasteners from the clip of Fig. 2;

Fig. 5 is a rear, left, top, perspective view of the fastener dispensing tool of Figs. 4(a) through 4(c), with the left half of the casing not being shown;

Figs. 6(a) through 6(d) are front right bottom perspective, front left top perspective, enlarged left side and enlarged front views, respectively, of the right half of the casing of the tool shown in Figs. 4(a) through 4(c);

Figs. 7(a) through 7(d) are front left bottom perspective, front right top perspective, enlarged right side and enlarged front views, respectively, of the left half of the casing of the tool shown in Figs. 4(a) through 4(c);

Figs. 8(a) through 8(d) are front right top perspective, bottom, section and right views, respectively, of the cover of the tool shown in Figs. 4(a) through 4(c);

Figs. 9(a) through 9(d) are rear right top perspective right side rear and top perspective views, respectively, of the anvil of the tool shown in Figs. 4(a) through 4(c);

Figs. 10(a) through 10(c) are rear left top perspective, front right top perspective and right side views, respectively, of the needle shown in Fig. 5;

Figs. 11(a) through 11(f) are front left top perspective, front right top perspective, rear right bottom perspective, top, front and section views, respectively, of the needle carrier shown in Fig. 5;

Fig. 12 is an enlarged perspective view of the locking pin shown in Fig. 5;

Fig. 13 is a left rear bottom perspective view of the tool shown in Fig. 5, with the left half of the casing, the needle carrier, the trigger and certain additional components not being shown for clarity;

Figs. 14(a) and 14(b) are front bottom left perspective and right side views, respectively, of the ejector rod carrier shown in Fig. 5;

Fig. 15 is a rear top right perspective view of the ejector clip shown in Fig. 5;

Fig. 16 is a rear top right perspective view of the linking member shown in Fig. 5;

Figs. 17(a) through 17(c) are front bottom right perspective, rear top left perspective and right side

views, respectively, of the feed guide shown in Fig. 5; Figs. 18(a) and 18(b) are front bottom right perspective and front views, respectively, of the feed clip shown in Fig. 13;

Fig. 19 is a front top right perspective view of the pawl shown in Fig. 13; and

Fig. 20 is a front bottom left perspective view of the feed sliding member shown in Fig. 13.

#### **DETAILED DESCRIPTION OF PREFERRED EMBODIMENTS**

**[0026]** Referring now to Figs. 1(a) through 1(c), there are shown side top and front views, respectively, of one embodiment of a plastic fastener well-suited for maintaining a dress shirt in a folded condition, said plastic fastener being constructed according to the teachings of the present invention and being represented generally by reference numeral 11. (It is to be understood that, although fastener 11 is particularly well-suited for maintaining a dress shirt or the like in a folded condition, it is not limited in its utility thereto and may be used in a variety of different applications including, but not limited to fixing together pairs of socks, coupling together sheets of paper, fixing dress shirts to cardboard supports fixing doll clothing to cardboard supports, etc.)

**[0027]** Fastener 11, which is a unitary structure preferably made by molding, comprises a flexible filament 13. When molded, filament 13 has a length  $l_1$  of about 1.65 mm and a diameter  $d_1$  of about 0.4 mm; filament 13 is thereafter stretched in the conventional manner to a length of approximately 4.3 mm and a diameter of approximately 0.2 mm. It should be noted that, even though, in the present embodiment, filament 13 has a generally cylindrical shape, filament 13 need not be cylindrically shaped and may take a variety of shapes, including those specified in commonly-assigned co-pending U.S. Patent Application Serial No. 09/416,784.

**[0028]** Fastener 11 also comprises a first cross-bar 15 and a second cross-bar 17, cross-bar 15 being disposed at a first end of filament 13, cross-bar 17 being disposed at a second end of filament 13, cross-bars 15 and 17 being parallel to one another. Each of cross-bars 15 and 17 has a length  $l_2$  of approximately 1.78 mm, a width  $w_1$  of approximately 0.55 mm and a height  $h_1$  of approximately 0.55 mm. It should be noted that, even though, in the present embodiment, cross-bars 15 and 17 are shaped so as to have flat inner surfaces 15-1 and 17-1, respectively, proximate to filament 13 and convex outer surfaces 15-2 and 17-2, respectively, distal to filament 13, cross-bars 15 and 17 need not be so shaped. In fact, cross-bars 15 and 17 may take a variety of forms, including those of the enlarged ends described in U.S. Patent Application Serial No. 09/416,784.

**[0029]** Fastener 11 is preferably made of a polyurethane that gives filament 13 a tensile strength of about 2 pounds. However, it is to be noted that said polyurethane is not the only type of material of which fastener

11 may be made and that other plastic materials (or combinations of materials) capable of providing filament 13 with a tensile strength in the range of about 907.18-1814.36g (2-4 pounds) (or whatever tensile strength is desirable based upon the particular use to which fastener 11 is put) are also suitable for purposes of the present invention. It is to be noted that, because filament 13 is made of a polyurethane, it has a certain degree of elasticity - a property which may be desirable in certain applications.

**[0030]** Referring now to Figs. 2(a) and 2(b), there are shown partially-exploded perspective and partially-exploded side views, respectively, of one embodiment of a fastener clip constructed according to the teachings of the present invention, the fastener clip being represented generally by reference numeral 31.

**[0031]** Clip 31, which is a unitary structure preferably made by molding, comprises a plurality of fasteners 11-1 through 11-3, fasteners 11 being arranged in a parallel, side-by-side, spaced orientation. Although only three fasteners 11 are shown in clip 31, it is to be understood that the number of fasteners 11 in clip 31 is illustrative only (In fact, in a preferred embodiment, clip 31 comprises one hundred twenty-five fasteners 11.)

**[0032]** Clip 31 also includes a first plurality of severable connector posts 33-1 and 33-2 and a second plurality of severable connector posts 35-1 and 35-2, connector posts 33 connecting the mutually-opposing sides of adjacent cross-bars 15 at their approximate midpoints and extending in a substantially perpendicular direction relative to the longitudinal axes of cross-bars 15, connector posts 35 connecting the mutually-opposing sides of adjacent cross-bars 17 at their approximate midpoints and extending in a substantially perpendicular direction relative to the longitudinal axes of cross-bars 17. (Side, top and front views of an individual fastener 11, together with its associated connector posts 33 and 35, are shown in Figs. 3(a) through 3(c), respectively.) In the present embodiment, connector posts 33 and 35 have a length of approximately 0.25 mm.

**[0033]** Connector posts 33 and 35 are strong enough to maintain the connection between adjacent fasteners 11 in clip 31 prior to the dispensing of individual fasteners 11 from clip 31 and, yet, are weak enough to be severed by the conventional severing action of a fastener dispensing tool. At the same time, connector posts 33 and 35 have a certain degree of flexibility; consequently, because of the arrangement of posts 33 and 35 relative to cross-bars 15 and 17, respectively, adjacent fasteners 11 in clip 31 are permitted to pivot relative to one another, thereby enabling clip 31 to be bent into an arcuate shape.

**[0034]** As seen best in Fig. 2(b), posts 33 and 35 preferably have a conical or tapered transverse cross-section that decreases in diameter from the fastener about to be dispensed (e.g., fastener 11-1) to the next fastener in the clip 31 (e.g., fastener 11-2) so that very little or nothing of the severed posts 33 and 35 that once connected the fastener about to be dispensed to the fastener previously

attached to it remain on the about-to-be-dispensed fastener. In this manner, as will be seen below, the fastener about to be dispensed by the tool (e.g., fastener 11-1) is able to sit substantially flush within a tool used to dispense the fastener. It should be understood, however, that the above embodiment is merely a preferred embodiment and that posts 33 and 35 need not be conical or tapered and, instead, may take a variety of shapes.

**[0035]** Clip 31 further includes an extra pair of cross-bars 37 and 39, cross-bars 37 and 39 being identical to cross-bars 15 and 17, respectively, except for the fact that cross-bars 37 and 39 are not disposed at the ends of a flexible filament. Cross-bars 37 and 39 are arranged in a parallel, side-by-side, spaced orientation from cross-bars 15 and 17, respectively, of the last fastener 11 of clip 31 (in the present embodiment, fastener 11-3) and are severably connected thereto by connector posts 33-3 and 35-3, respectively. Connector post 33-3 is identical to connector posts 33-1 and 33-2, and connector post 35-3 is identical to connector posts 35-1 and 35-2. Cross-bars 37 and 39 serve to keep the last fastener of clip 31 properly oriented while it is being dispensed using the fastener dispensing tool described below.

**[0036]** As can be seen in Figs. 2(a) and 2(b), clip 31 does not include a runner bar. This may be advantageous since the runner bar of a fastener clip typically has no use once the fasteners originally attached thereto have been dispensed therefrom. As a result, the detached runner bar typically represents economically and environmentally undesirable waste material. In addition, severed connectors previously used to connect fasteners to a runner bar and still remaining on the runner bar after the fasteners have been detached therefrom often have an acute end which may undesirably snag on and damage merchandise when fasteners from the fastener clip are dispensed into such merchandise with a conventional fastener dispensing tool.

**[0037]** Clip 31 may be made by injection molding, preferably using polyurethane or a similar material. According to a preferred embodiment, clip 31 is made by forming a fastener clip analogous to clip 31 but further comprising a runner bar severably connected to each of cross-bars 15 (see, for example, fastener clip 11 of U.S.S.N. 09/464,022) and then by severing said runner bar from each of cross-bars 15 and removing the remnants of any connectors connecting said runner bar to cross-bars 15.

**[0038]** It should be noted that, notwithstanding the above-noted generalized shortcomings of runner bar-containing fastener clips, the aforementioned runner bar-containing analog to clip 31 could be substituted for runner bar-less clip 31 and used with an appropriately dimensioned version of a conventional fastener dispensing tool of the type adapted for use with runner bar-containing clips (an example of such a tool being an appropriately dimensioned Dennison® Mark II™ SWIFTACH® tool).

**[0039]** Referring now to Figs. 4(a) through 4(c) and to Fig. 5, there are shown various views of a fastener dispensing tool that is particularly well-suited for use in dis-

5 dispensing individual fasteners from clip 31, said fastener dispensing tool being constructed according to the teachings of the present invention and being represented generally by reference numeral 51 (Fasteners dispensed by tool 51 may be used to maintain a dress shirt or the like in a folded condition or may be used in other fastening applications.)

**[0040]** Tool 51 includes a hollow, gun-shaped casing 53, casing 53 comprising a right half 55 (which is shown separately in Figs. 6(a) through 6(d)) and a left half 57 (which is shown separately in Figs. 7(a) through 7(d)). Halves 55 and 57, which may be fabricated from any convenient durable material, such as molded plastic, are joined together by a plurality of screws 58 and jointly define a handle portion 59 and a barrel portion 61. As seen best in Fig. 4(b), right half 55 and left half 57 also jointly define an opening 62 located at the front end of barrel portion 61, the purpose of opening 62 to be discussed below.

**[0041]** Referring now to Figs. 6(a) and 7(a), an oval-shaped recess 63-1 is provided on the outer surface of the barrel portion of right half 55, and a corresponding oval-shaped recess 63-2 is provided on the outer surface of the barrel portion of left half 57. Recesses 63-1 and 63-2 are adapted to receive complementary-shaped inserts 64-1 and 64-2, respectively, inserts 64-1 and 64-2 being shown disposed in their respective recesses in Figs. 4(a) through 4(c). Inserts 64-1 and 64-2 may bear a logo or the like and/or may have a rubberized or gripping outer surface to prevent tool 51 from sliding across a table when placed thereon.

**[0042]** Referring back to Figs. 6(a) and 7(a), a window 65-1 is provided in the barrel portion of right half 55, and a matching window 65-2 is provided in the barrel portion of left half 57. Windows 65-1 and 65-2 permit a user to monitor the status of a fastener clip 31 disposed inside casing 53. In addition, windows 65-1 and 65-2 provide an opening through which cross-bars 37 and 39 of a clip 31 may exit casing 53 once a clip 31 has been completely spent.

**[0043]** An arrow 67-1 is formed on right half 55 towards the front of its barrel portion, and a matching arrow 67-2 is formed on left half 57 towards the front of its barrel portion. Arrows 67-1 and 67-2 are aligned with opening 62 and are designed to aid a user in aligning tool 51 with an object to be fastened, such as a dress-shirt.

**[0044]** Referring back to Figs. 4(a) through 4(c) and to Fig. 5, tool 51 further comprises a door 69 (shown separately in Figs. 8(a) through 8(d)). Door 69, which also may be made from molded plastic or the like, is pivotally mounted at its front end on a screw 70 secured to halves 55 and 57. When door 69 is closed, it substantially covers an opening formed between recesses 55-1 and 57-1 located along the top edges of halves 55 and 57, respectively (recesses 55-1 and 57-1 seen best in Figs. 6(d) and 7(d), respectively). For reasons to be revealed below, the rear end 69-1 of door 69 is angled upwardly to permit limited access to the interior of casing 53 through

an opening 68 even when door 69 is in a closed position. When door 69 is pivoted away from the top of casing 53, the interior of barrel portion 61 (and in particular the feed track to be described below of casing 53) can be accessed.

**[0045]** As seen best in Fig. 5, a ring 71, which is preferably made of rubber or the like, is rotatably mounted on a pin 72 fixed to door 69. Ring 71 is adapted to engage the filament portions of a clip 31 disposed within tool 51 in such a way as to permit manual advancement of a clip 31 through the feed track of tool 51 merely by turning ring 71 from the exterior of casing 53.

**[0046]** Tool 51 further comprises an anvil 73 (shown separately in Figs. 9(a) through 9(d)). Anvil 73, which is preferably made of molded plastic or the like, includes a rear portion 73-1 and a front portion 73-2. Rear portion 73-1 is disposed within barrel portion 61 of casing 53 and is secured to halves 55 and 57 by screw 70 (anvil 73 sharing screw 70 with door 69). Hooked front portion 73-2 extends upwardly from the top of casing 53 and then loops downwardly in front of tool 51 spaced a short distance from opening 62. Front portion 73-2 is provided with an opening 75, which is aligned with opening 62 and which is appropriately spaced from tool 51 so as to receive the tip of the needle of tool 51. Front portion 73-2 is also provided with an outer slot 77 which is preferably dimensioned depthwise to extend beyond the tip of the needle in its forwardmost position and is preferably dimensioned widthwise to prevent a user from inserting his fingers thereinto. In this manner, anvil 73 not only serves as a support for the fastening operation to be performed by tool 51 but also serves to protect a user from injury caused by accidental needle sticks. As a further safety measure, the spacing between opening 62 of tool and opening 75 of anvil 73 is preferably sufficiently small (e.g., 0,635-0,762 cm (0.25-0.3 inch)) to prevent a user from inserting his fingers therebetween.

**[0047]** As can readily be appreciated, because anvil 73 is secured to casing 53 by screw 70, anvil 73 can easily be replaced if damaged. Also, anvil 73 can readily be replaced with an anvil having a different sized loop if one wishes to vary the point of attachment of the fastener dispensed by tool 51 into an object (i.e., generally speaking, the higher the loop, the lower the point of attachment of the fastener into the object).

**[0048]** As seen best in Fig. 5, tool 51 also includes a triggering mechanism whose purpose will become apparent below. In the present embodiment, said triggering mechanism includes a trigger 81. Trigger 81, which may be made of molded plastic or another similarly suitable material, is pivotally attached to casing 53 by a pin 83 and extends partially through an opening 84 formed in handle portion 59 of casing 53 so that it may be digitally manipulated for movement towards and away from, respectively, the rear wall of handle portion 59. A coiled spring 85, which is attached at one end to the inside rear wall of handle portion 59 and which is attached at its opposite end to the inside of trigger 81, biases trigger 81

away from the rear wall of handle portion 59.

**[0049]** The triggering mechanism of tool 51 additionally includes a lever 87 and a float link 89, both of which may be made of molded plastic or another suitable material. Lever 87 is disposed within casing 53 and is pivotally mounted at a first end 87-1 on a pin 88, pin 88 being fixed to trigger 81. Float link 89 is pivotally mounted at one end on a pin 90 mounted inside handle portion 59 and is pivotally mounted at its opposite end on a pin 91 fixed to an intermediate portion of lever 87.

**[0050]** Tool 51 further includes a needle assembly. In the present embodiment, said needle assembly comprises a needle 93. As seen best in Figs. 10(a) through 10(c), needle 93 comprises a stem portion 95 and a base portion 97. Stem portion 95, which may be made from stamped and rolled metal, is a generally cylindrical member terminating at one end in a sharp tip 95-1 designed for insertion through a garment or like object. Stem portion 95 also has a slotted bore 95-2 extending substantially longitudinally thereacross. Base portion 97 may be made of a plastic that has been insert-molded onto that end of stem portion 95 that is distal to tip 95-1. (Alternatively, stem portion 95 and base portion 97 may be a unitary structure made of metal or another suitable material.) Base portion 97 is provided with a slotted longitudinal bore 97-1 that is aligned with bore 95-2 of stem portion 95 and is also provided with a scallop-shaped recess 99 on its outer surface whose purpose will be described below. The bores of stem portion 95 and base portion 97 are appropriately dimensioned so that cross-bar 15 of a fastener 11 may be inserted thereinto from the rear of base portion 97, traverse the length of needle 93 through bore 95-2 and then exit needle 93 via tip 95-1. The slots of stem portion 95 and base portion 97 are appropriately dimensioned to permit the filament 13 of fastener 11 to extend therethrough while its associated cross-bar 15 is disposed within needle 93, said slots being oriented in tool 51 so as to face towards half 55 of casing 53.

**[0051]** Referring back to Fig. 5, the needle assembly of tool 51 further comprises a needle carrier 101 (shown separately in Figs. 11(a) through 11(f)), needle carrier 101 being slidably mounted in a slot 102 defined at least in part by matching sets of longitudinally extending ribs 104-1/104-2 and 106-1/106-2 integrally formed on right half 55 and left half 57, respectively, of casing 53 (ribs 106-1 and 106-2 being visible in Figs. 7(b) and 7(c)). One end of a spring 108 is attached to a post 110 formed on needle carrier 101, the opposite end of spring 108 being attached to a post 112 mounted in casing 53. In this manner, needle carrier 101 is normally biased rearwardly in barrel portion 61. Needle carrier 101, which may be made of molded plastic or another suitable material, is provided at its front end with a sleeve 107, sleeve 107 being aligned with opening 62 for reasons to become apparent below. Base portion 97 of needle 93 is disposed within sleeve 107 and is lockably secured therewithin by a locking pin 109.

**[0052]** Referring now to Fig. 12, locking pin 109 can be seen to be a generally cylindrical member having a slotted head 111 (manipulable with a screwdriver or the like) at one end thereof, a longitudinally-extending slot 113 at the opposite end thereof and a scallop-shaped recess 115 on its outer surface at about its midpoint. Recess 115 on pin 109 is appropriately dimensioned to receive base portion 97 of needle 93, and recess 99 of base portion 97 is appropriately dimensioned to receive pin 109.

**[0053]** Locking pin 109 is disposed in a bore 117 formed in carrier 101, bore 117 being shown in Figs. 11(a) through 11(d) and in Fig. 11(f). As seen best in Fig. 11(f), bore 117 and sleeve 107 are oriented relative to one another so that, when pin 109 is rotationally positioned so that recess 115 faces away from needle 93, needle 93 is engaged by pin 109 and, therefore, is locked into sleeve 107 whereas, when pin 109 is rotationally positioned so that recess 115 faces towards needle 93, needle 93 is not engaged by pin 109 and, therefore, is free to be removed from sleeve 107. As can be seen in Fig. 5, slotted head 111 of locking pin 109 is accessible (for use in locking and unlocking needle 93) through an opening 119 formed in the bottom of barrel portion 61.

**[0054]** Referring now to Figs. 5 and 13, tool 51 further includes a mechanism for loading fasteners, one at a time, into needle 93 and for ejecting loaded fasteners from needle 93. In the present embodiment, said loading/ejecting mechanism comprises an ejector rod carrier 141, an ejector rod 143 and an ejector clip 145. Ejector rod carrier 141 (shown separately in Figs. 14(a) and 14(b)), which may be made of molded plastic or another suitable material, is slidably mounted on the underside of needle carrier 101. Ejector rod carrier 141 is coupled to lever 87 by means of a pin 147 that is fixed to ejector rod carrier 141, lever 87 being pivotally mounted on pin 147. In this manner, when trigger 81 is squeezed, ejector rod carrier 141 is moved forwardly across barrel portion 61; conversely, when trigger 81 is released, ejector rod carrier 141 is moved rearwardly across barrel portion 61. For reasons to be discussed below, the top of carrier 141 is shaped to include a first recessed portion 149-1 at its front end and a second recessed portion 149-2 proximate to its rear end.

**[0055]** Ejector rod 143 is preferably conventional in shape and composition. The rear end of ejector rod 143 is mounted in the front end of carrier 141, the front end of ejector rod 143 extending forwardly away from carrier 141 and being aligned with bore 97-1 of needle 93. In this manner, when trigger 81 is squeezed, ejector rod carrier 141 and ejector rod 143 together move forwardly through barrel portion 61 until the front end of ejector rod 143 is inserted completely through needle 93. Because, as will hereinafter be described, the cross-bar 15 of the lead fastener 11 of a fastener clip 31 loaded in tool 51 is positioned behind bore 97-1 of needle 93, as the front end of ejector rod 143 moves forwardly through barrel portion 61, it pushes said cross-bar into and through nee-

dle 93, in the process severing the connector 33 between said cross-bar and its adjacent cross-bar 15

**[0056]** Ejector clip 145, which is shown separately in Fig. 15, is preferably a unitary structure made of stamped stainless steel or the like. Clip 145, which is positioned between the right side of ejector carrier 141 and the inner right side of needle carrier 101, is shaped to include a front portion 151-1 and a rear portion 151-2. Front portion 151-1 is provided with a tip 152, tip 152 being aligned with cross-bar 17 of the lead fastener 11. Rear portion 151-2 is provided with an elongated slot 153 through which pin 147 extends. As can be seen best in Fig. 15, the rear end 153-1 of slot 153 is angled upwardly. In this manner, as ejector rod carrier 141 begins its forward movement through barrel portion 61 and as the front end of ejector rod 143 pushes cross-bar 15 of the lead fastener into needle 93, pin 147 begins to move forwardly through slot 153 from rear end 153-1, causing clip 145 to be moved forwardly a short distance and causing tip 152 of clip 145 to engage cross-bar 17 of the lead fastener and to push it forwardly until the connector 35 connecting cross-bar 17 to the remainder of the clip 31 breaks. As carrier 141 continues to move forwardly, pin 147 moves through the straight front end 153-2 of slot, causing clip 145 to remain stationary while carrier 141 moves forwardly. Later, as carrier 141 makes its rearward movement through barrel portion 61 (as trigger 81 is released), pin 147 moves rearwardly through slot 153, and clip 145 is restored to its original position.

**[0057]** Referring back to Figs 5 and 13, tool 51 further comprises a mechanism for coupling and decoupling ejector rod carrier 141 to and from needle carrier 101. In the present embodiment, said mechanism comprises a linking member 161 (shown separately in Fig. 16). Linking member 161, which may be made of molded plastic or a similarly suitable material, is seated in a slot 142 (shown best in Figs. 11(a) and 11(b)) formed in needle carrier 101 and is pivotally mounted at one end 161-1 to needle carrier 101 by a pin 163.

**[0058]** As seen best in Fig. 13, the front end 161-2 of linking member 161 is enlarged and, prior to actuation of trigger 81, is disposed over the recessed portion 149-1 of carrier 141. When trigger 81 is first squeezed, carrier 141 moves forwardly; however, because of recessed portion 149-1, carrier 141 does not initially engage the enlarged front end 161-2 of linking member 161. As a result, linking member 161 and, in turn, needle carrier 101 are not initially coupled to carrier 141 and do not initially move forwardly with carrier 141. During the aforementioned part of the trigger stroke, ejector rod 143 severs the lead cross-bar 15 from its adjacent cross-bar 15 and feeds the lead cross-bar 15 into needle 93.

**[0059]** Continued squeezing of trigger 81 causes that portion of carrier 141 located immediately behind recessed portion 149-1 to pivot front end 161-2 of linking member 161 up against rib 104-1, thereby causing linking member 161 and, in turn, needle carrier 101 to be coupled to carrier 141. Thus, once coupled together, carrier 101,

linking member 161 and carrier 141 begin to move forwardly together through slot 102. During this part of the trigger stroke, needle 93 and ejector rod 143 move together, with tip 95-1 of needle 93 passing through opening 62 of casing 53 and through opening 75 of anvil 73.

**[0060]** Further continued squeezing of trigger 81 causes linking member 161 and carrier 141 to be decoupled as front end 161-2 of linking member 161 arrives at and is forced through an opening 165 formed in rib 104-1 (a corresponding opening being provided in rib 106-1) while carrier 141 continues to move forwardly through barrel portion 61. During this part of the trigger stroke, ejector rod 143 continues to move forwardly through the now-stationary needle 93.

**[0061]** Still further continued squeezing of trigger 81 causes ejector carrier 141 to slide across the now-stationary enlarged end 161-2 of member 161 until enlarged end 161-2 drops down into recessed portion 149-2 of carrier 141. During this part of the trigger stroke, ejector rod 143 completes its forward progress through needle 93.

**[0062]** When trigger 81 is initially released, carrier 141 and member 161 move rearwardly together (with enlarged end 161-2 disposed in recessed portion 149-2 and pressed up against rib 104-1) until member 161 is fully withdrawn and enlarged end 161-2 is aligned with an opening 166 in rib 104-1 (a corresponding opening being provided in rib 106-1). During this part of the trigger stroke, ejector rod 143 and needle 93 move rearwardly together, with needle 93 being completely withdrawn into casing 53 through opening 62. The primary reason for having needle 93 and ejector rod 143 simultaneously withdraw at the beginning of the trigger release, instead of simply reversing the sequence of events that took place during the squeezing of trigger 81 (which would involve having ejector rod 143 first retract partially while needle 93 is kept stationary), is to prevent the cross-bar 15 that is being dispensed through needle 93 from toggling back into the needle 93 after retraction of ejector rod 143. This undesired outcome is prevented in the present arrangement by having needle 93 and ejector rod 143 retract together until needle 93 has fully retracted.

**[0063]** Continued release of trigger 81 causes carrier 141 to slide rearwardly across the now-stationary enlarged end 161-2 until carrier 141 is fully withdrawn and enlarged end 161-2 is returned to its starting position over recessed portion 149-1. During this part of the trigger stroke, ejector rod 143 fully retracts.

**[0064]** Tool 51 further comprises a feed track 171 along which a fastener clip 31 may be advanced through tool 51 to a position where individual fasteners can be loaded into and dispensed from needle 93. Feed track 171, which extends from the rear of opening 68 to just behind bore 97-1 of needle 93, is defined, in part, by a matching pair of arcuate ribs 173-1 and 173-2 formed interiorly along the barrel portion of halves 55 and 57, respectively, and is defined, in part, by a feed guide 175 (shown separately in Figs. 17(a) through 17(c)) station-

arily mounted in barrel portion 61 just behind needle 93. Feed track 171 is appropriately dimensioned so that the entirety of a clip analogous to clip 31 but comprising one hundred twenty-five fasteners 11 can be completely contained within tool 51. As can readily be appreciated, even longer fastener clips (e.g., clips having several hundred fasteners 11) can be disposed in feed track 171, with the rear end of such clips extending out through opening 68 of tool 51.

**[0065]** Referring now to Figs. 17(a) through 17(c), feed guide 175, which is preferably a unitary structure made of molded plastic or the like, is shaped to include a front portion 177-1, a rear portion 177-2 and an intermediate portion 177-3. Front portion 177-1 is provided with a slotted bore 179, which is aligned with bore 97-1 of needle 93 and which is also aligned with ejector rod 143, and is also provided with a slot 180, which is aligned with tip 152 of clip 145. In addition, the front surface of front portion 177-1 is shaped to include a recessed area 181, which is adapted to receive the rear of base portion 97 of needle 93 as needle 93 is moved back and forth by needle carrier 101. Furthermore, the rear surface of front portion 177-1 is shaped to include a guide rib 183, guide rib 183 being positioned in feed track 171 and being appropriately dimensioned to keep cross-bars 15 and 17 properly aligned on opposite sides thereof as a clip 31 travels downwardly through feed track 171. A downwardly and outwardly angled bump 183-1 is provided on rib 183, bump 183-1 being positioned on rib 183 and appropriately dimensioned so that the filament 15 of the lead fastener 11 slides thereacross as said fastener moves into position to be dispensed but, once drawn past bump 183-1, cannot easily be pulled back thereover. In this manner, bump 183-1 acts as an anti-back to prevent a clip 31 from moving backwards in feed track 171 during the as yet to be described feeding operation of the clip.

**[0066]** The top surface of intermediate portion 177-3 constitutes the front end of feed track 171 and functions as a stage on which the lead fastener 11 of clip 31 is situated prior to being dispensed by tool 51.

**[0067]** A pair of transverse openings 185-1 and 185-2 are provided in rear portion 177-2 of guide 175, opening 185-1 being positioned so that it is aligned both with ejector rod 143 and with bore 179, opening 185-2 being positioned so that it is aligned with tip 152 of clip 145 and with slot 180.

**[0068]** As cross-bar 15 of the lead fastener 11 is pushed by ejector rod 143 through opening 179, the severable connector 33 connecting said cross-bar 15 to its adjacent cross-bar 15 is severed. Likewise as cross-bar 17 of the lead fastener 11 is pushed by ejector clip 145 through slot 180, the severable connector 35 connecting said cross-bar 17 to its adjacent cross-bar 17 is severed. As noted above, one advantage to having connectors 33 and 35 taper in the manner described above is that, once connectors 33 and 35 between the lead fastener and its adjacent fastener have been severed and the lead fastener has been dispensed, the cross-bars 15 and 17 of

the adjacent fastener are capable of sitting substantially flush on top of the top surface of portion 177-3. As also noted above, cross-bars 37 and 39 ensure that cross-bars 15 and 17 of the last fastener 11 of clip 31 remain properly aligned with bore 179 and slot 180, respectively.

**[0069]** Referring back now to Fig. 13, tool 51 further comprises a feed clip 187, clip 187 being mounted on guide 175 for use in maintaining the alignment of cross-bar 15 of the lead fastener 11 with bore 179 while said cross-bar 15 is seated on top of portion 177-3 of guide 175. As seen best in Figs. 18(a) and 18(b), clip 187 is a unitary structure, preferably made of molded plastic, comprising a main portion 189-1 and an arm 189-2. Main portion 189-1 is provided with a pair of mounting posts 190-1 and 190-2 insertable into a pair of corresponding openings 191-1 and 191-2 formed in guide 175. Arm 189-2, which is biased away from main portion 189-1, is shaped to include a finger 192 adapted to engage cross-bar 15 of the lead fastener 11.

**[0070]** Referring back now to Fig. 13, tool 51 further comprises a mechanism for feeding or advancing a clip 31 through feed track 171 at a rate of one fastener per trigger stroke. In the present embodiment, said feeding or advancing mechanism comprises a pawl 193 made of molded plastic or a similarly suitable material. Pawl 193, which is shaped to include a pair of fingers 194-1 and 194-2 (see Fig. 19) engageable with the filament portion 15 of a clip 31 seated in guide 175, is rotatably mounted on guide 175 by a pin 195. In addition, pawl 193 is mechanically coupled by a wire hook 197 to a feed sliding member 199 (shown separately in Fig. 20) slidably mounted in a slot defined by ribs 203-1/203-2 and 205-1/205-2 on halves 55 and 57, respectively, of casing 53 (ribs 205-1 and 205-2 being shown in Figs. 7(b) and 7(c)). A rear post 207 is formed at the rear end of member 199, and a front post 209 is formed proximate to the front end of member 199. Posts 207 and 209 are appropriately positioned on member 199 so that, when trigger 81 is nearly completely squeezed, lever 87 contacts post 209 and moves member 199 forwardly a short distance. This causes pawl 193 to rotate away from the fasteners positioned in guide 175. Then, when trigger 81 is released, lever 87 contacts post 207 and moves member 199 rearwardly a short distance. This causes pawl 193 to rotate towards the fasteners positioned in guide 175, whereby fingers 194-1 and 194-2 engage the filament portion of the clip and pull the clip down to advance it by one fastener.

**[0071]** To prepare tool 51 for use, clip 31 (or more preferably a fastener clip analogous to clip 31 but comprising on the order of one hundred twenty-five fasteners 11) is loaded into tool 51. This is typically done by opening door 69, inserting the clip into feed track 171 (i.e., by orienting the clip relative to ribs 173-1 and 173-2 so that the respective filaments 15 are disposed on top of and across ribs 173-1 and 173-2 and so that the respective cross-bars 15 and 17 are positioned off to the sides of and perpendicular to ribs 173-1 and 173-2), closing door 69,

and advancing the clip through feed track 171 using wheel 71. With tool 51 thus loaded, a fastener 11 may be inserted into a desired article first by placing the article between opening 62 in casing 53 and opening 75 in anvil 73 (arrows 67-1 and 67-2 optionally being used to locate openings 62 and 75) and then by squeezing and releasing trigger 81 in the manner described above.

**[0072]** The embodiments of the present invention recited herein are intended to be merely exemplary and those skilled in the art will be able to make numerous variations and modifications to it without departing from the spirit of the present invention.

## 15 Claims

1. A hand-held fastener dispensing tool (51) for dispensing a fastener of the type comprising a flexible filament (13) having an enlargement at one end thereof, said fastener dispensing tool (51) comprising:

(a) a casing (53) said casing (53) being provided with a needle (93) opening;

(b) a hollow, slotted needle (93), said hollow, slotted needle (93) being slidably movable back and forth between a retracted position disposed entirely within said casing (53) and an extended position extending through said needle (93) opening, said hollow, slotted needle (93) being adapted to receive the enlargement of said fastener (11);

(c) an ejector rod (143) said ejector rod (143) being slidably movable back and forth through said hollow, slotted needle (93) to eject the enlargement disposed therein; and

(d) an anvil (73) fixed relative to said casing (53) and extending in front of said needle (93) opening, said anvil (73) being positioned so that said hollow, slotted needle (93), when in said extended position, does not extend therebeyond.

2. The hand-held fastener dispensing tool (51) as claimed in claim 1 wherein said casing (53) is gun-shaped and comprises a barrel portion (61) and a handle portion (59).

3. The hand-held fastener dispensing tool (51) as claimed in claim 2 wherein said handle portion (59) is provided with a trigger opening (87), said fastener dispensing tool (51) further comprising a trigger (81), said trigger (81) being pivotally mounted in said casing (53) and extending partially through said trigger opening (87) for digital actuation thereof, said trigger (81) being coupled to said hollow, slotted needle (93) and also being coupled to said ejector rod (143).

4. The hand-held fastener dispensing tool (51) as

- claimed in claim 3 further comprising an ejector rod carrier (141) disposed in said barrel portion (61) of said casing (53), said ejector rod (143) being mounted on said ejector rod carrier (141), said ejector rod carrier (141) being connected to said trigger (81) in such a way that said ejector rod carrier is caused to slide back and forth through said barrel portion (61) as said trigger (81) is operated.
- 5
5. The hand-held fastener dispensing tool (51) as claimed in claim 4 further comprising a needle carrier (101) disposed in said barrel portion (61) of said casing (53), said hollow, slotted needle (93) being mounted on said needle carrier (101), said hand-held fastener dispensing tool (51) further comprising a linkage coupled to said needle carrier (101) and selectively engageable with said ejector rod carrier (141) for coupling and decoupling said needle carrier (101) to and from said ejector rod carrier (141) so that said needle carrier (101) is caused to slide back and forth in said barrel portion (61) only during a portion of the movement of said ejector rod carrier (141).
- 10
6. The hand-held fastener dispensing (51) tool as claimed in claim 5 further comprising a lever (87) disposed within said casing, (53) said lever (87) being pivotally mounted at a first end on a first pin (91), said first pin (91) being fixed to said trigger (91), said lever (87) being pivotally mounted at a second end on a second pin (147) said second pin (147) being fixed to said ejector rod carrier (141).
- 15
7. The hand-held fastener dispensing tool (51) as claimed in claim 5 further comprising a feed track (171) disposed within said barrel portion (61) of said casing (53), said feed track (171) being shaped to receive, entirely within said barrel portion (61), a clip of fasteners (11), each of said fasteners (11) comprising a flexible filament (13), a first enlargement at one end of the flexible filament and a second enlargement at the other end of the flexible filament (13).
- 20
8. The hand-held fastener dispensing tool (51) as claimed in claim 7 wherein said feed track (171) is defined in part by a feed guide (175) disposed within said casing (53) and in part by a rib formed on the interior of said casing (53).
- 25
9. The hand-held fastener dispensing tool (51) as claimed in claim 1 wherein said anvil (73) comprises a front portion (73-2) and a rear portion (73-1), said rear portion (73-2) being secured to said casing (53), said front portion (73-2) being looped and extending in front of said opening (62) in said casing (53).
- 30
10. The hand-held fastener dispensing tool (51) as claimed in claim 9 wherein said front portion (73-2) of said anvil (73) is provided with an anvil opening (75) said anvil opening (75) being aligned with said opening (62) in said casing (53), said front portion of said anvil (73) also being provided with a slotted outer surface.
- 35
11. The hand-held fastener dispensing tool (51) as claimed in claim 10 wherein said anvil opening (75) and said opening (62) in said casing (53) are spaced apart by a distance of approximately 0,635-0,762 cm (0.25-0.3 inch).
- 40
12. The hand-held fastener dispensing tool (51) as claimed in claim 9 wherein said rear portion (73-1) of said anvil (73) is removably secured to said casing (53) by a screw (70).
- 45
13. The fastener dispensing tool (51) as claimed in claim 6 wherein said needle (93) is removably coupled to said needle carrier (101) by a locking pin (109).
- 50
14. The fastener dispensing tool (51) as claimed in claim 13 wherein said barrel portion (61) of said casing (53) is provided with an opening for accessing said locking pin (109).
- 55
15. The fastener dispensing tool (51) as claimed in claims 1 to 14, wherein said casing (53), is gun-shaped and includes a handle portion (59) and a barrel portion (61), said fastener dispensing tool (51) further comprising a needle carrier (101), an ejector rod carrier (141), a linking member and a triggering mechanism, said needle carrier (101) being slidably mounted in said barrel portion (61), said hollow, slotted needle (93) being coupled to said needle carrier (101), said ejector rod carrier (141) being slidably mounted in said barrel portion (61), said ejector rod (143) being coupled to said ejector rod carrier (141), said linking member being coupled to said needle carrier (101) and selectively engageable with said ejector rod carrier (141) for coupling and decoupling said needle carrier (101) to and from said ejector rod carrier (141) so that said needle carrier (101) is caused to slide back and forth in said barrel portion (61) only during a portion of the movement of said ejector rod carrier (141), said triggering mechanism comprising a trigger (81), said trigger (81) being pivotally mounted in said casing (53) and extending partially through said handle portion (59) thereof for manual actuation, said triggering mechanism further comprising a lever (87) disposed within said casing (53), said lever (87) being pivotally mounted at a first end on a first pin (91), said first pin (91) being fixed to said trigger (81), said lever (87) being pivotally mounted at a second end on a second pin (147), said second pin (147) being fixed to said ejector rod carrier (141).

16. The fastener dispensing tool (51) as claimed in claim 15 further comprising an anvil (73), said anvil (73) being coupled to said casing (53).
17. The fastener dispensing tool (51) as claimed in claim 15 wherein said anvil (73) is removably coupled to said casing (53).
18. The fastener dispensing tool (51) as claimed in claim 15 wherein said fastener dispensing tool (51) is adapted for dispensing individual fasteners (11) from a fastener clip (31) the individual fasteners (11) comprising a flexible filament (13) having a first enlargement at a first end thereof and a second enlargement at a second end thereof, adjacent first enlargements of said fastener clip (31) being connected by a first connector post (35), adjacent second enlargement of said fastener clip (31) being connected by a second connector post (35), said first enlargements of said clip (31) being dispensed through said hollow, slotted needle (93), said fastener dispensing tool (51) further comprising an ejector clip (145) coupled to said ejector rod carrier (141) for severing the second connector post (35) between adjacent second enlargements.
19. The fastener dispensing tool (51) as claimed in claims 1 to 11 further comprising a feed guide (175) said feed guide (175) being stationarily mounted in said casing (53) behind said hollow, slotted needle (93), said feed guide (175) defining a front portion of a feed track (171) and comprising a stage at the end of said feed track (171) off of which an individual fastener (11) from a fastener clip (31) is loaded into said hollow, slotted needle (93) by said ejector rod (143).
20. The fastener dispensing tool (51) as claimed in claim 15 wherein said feed guide (175) further comprises a projection engageable with the filament portion of a fastener clip (31) for use in preventing said fastener clip (31) from moving rearwardly in said feed track (171).
21. The fastener dispensing tool (51) as claimed in claim 15 wherein said feed guide (175) is provided with a recessed portion having a slotted bore (179), said recessed portion being adapted to removably receive said hollow, slotted needle (93).
22. The fastener dispensing tool (51) as claimed in claim 15 wherein said casing is interiorly shaped to define a rear portion (177-2) of a feed track (171), said rear portion (177-2) being aligned with said front portion (177-1) of said feed track (171).
23. The fastener dispensing tool (51) as claimed in claim 22 wherein said feed track (171) is shaped to receive entirely within said casing (53) a plurality of fasteners (11).
24. The fastener dispensing tool (51) as claimed in claim 23 further comprising a door (69) pivotally mounted on said casing (53), said door (69) providing access to said feed track (171).
25. The fastener dispensing tool (51) as claimed in claim 24 further comprising a wheel rotatably mounted in said door (69), said wheel being adapted to engage a fastener clip (31) disposed in said feed track (171).
26. The fastener dispensing tool (51) as claimed in claim 15 wherein said casing (53) is provided with a pair of windows (65) for use in monitoring a fastener clip (31) disposed in said feed track (171).
27. The fastener dispensing tool (51) as claimed in claim 15 further comprising a triggering mechanism mounted in said casing (53), a mechanism coupling said triggering mechanism to movement of said hollow, slotted needle (93) and a mechanism coupling said triggering mechanism to movement of said ejector rod (143).
28. The fastener dispensing tool (51) as claimed in claim 27 further comprising a mechanism for advancing a fastener clip (31) through said feed track (171) at a rate of one fastener (11) per trigger stroke.
29. The fastener dispensing tool (51) as claimed in claims 1 to 19 wherein said ejector rod (143) is slidably movable back and forth between a withdrawn position disposed behind said hollow, slotted needle (93) and an advanced position extending through said hollow, slotted needle (93), said fastener dispensing tool further comprising a trigger (81) mechanically coupled to said casing (53), first coupling means, coupling said trigger (81) to said hollow, slotted needle (93) for moving said hollow, slotted needle (93) from said retracted position to said extended position and then back to said retracted position during a trigger stroke, and second coupling means, coupling said trigger (81) to said ejector rod (143), for moving said ejector rod (143) from said withdrawn position to said advanced position and then back to said withdrawn position during a trigger stroke wherein said first coupling means and said second coupling means are designed so that said ejector rod (143) withdraws from said advanced position together with said hollow, slotted needle (93) as said hollow, slotted needle (93) moves from said extended position to said retracted position.
30. The fastener dispensing tool (51) as claimed in claim

1 to 29 wherein said casing (53) is shaped to receive, entirely within said casing (53), a clip (31) of fasteners (11), each of said fasteners (11) in said clip (31) comprising a flexible filament (13) having a first enlarged portion at a first end thereof and a second enlarged portion at a second end thereof.

31. The fastener dispensing tool (51) as claimed in claim 30 wherein said casing (53) is shaped to receive entirely therewithin a clip (31) of approximately one hundred twenty-five fasteners (11).
32. The fastener dispensing tool (51) as claimed in claim 30 wherein said feed track (171) terminates behind said hollow, slotted needle (93) in a direction substantially perpendicular to the longitudinal axis of said hollow, slotted needle (93).
33. The fastener dispensing tool (51) as claimed in claim 32 wherein said casing (53) is shaped to receive entirely therewithin a clip of approximately one hundred twenty-five fasteners (11).

#### Patentansprüche

1. Tragbare Befestigungselement-Ausgabevorrichtung (51) zur Ausgabe eines Befestigungselements des Typs, der einen flexiblen Faden (13) umfasst, welcher eine Verlängerung an seinem einen Ende besitzt, wobei die Befestigungselement-Ausgabevorrichtung (51) umfasst:

(a) ein Gehäuse (53), wobei das genannte Gehäuse (53) ausgestattet ist mit einer Öffnung für eine Nadel (93);

(b) einer hohlen, geschlitzten Nadel (93), wobei die genannte hohle, geschlitzte Nadel (93) verschiebbar rückwärts und vorwärts zwischen einer zurückgezogenen Position, die vollständig innerhalb des genannten Gehäuses (53) angeordnet ist, und einer ausgefahrenen Position, die sie sich durch die genannte Öffnung für die Nadel (93) erstreckt, bewegbar ist, wobei die genannte hohle, geschlitzte Nadel (93) angepasst ist, um die Verlängerung des genannten Befestigungselements (11) aufzunehmen;

(c) eine Auswurfstange (143), wobei die genannte Auswurfstange (143) verschiebbar rückwärts und vorwärts durch die genannte hohle, geschlitzte Nadel (93) bewegbar ist, um die darin untergebrachte Verlängerung auszuwerfen; und

(d) ein Amboss (73), das relativ zu dem genannten Gehäuse (53) fixiert ist und sich vor der genannten Öffnung für die Nadel (93) erstreckt, wobei der genannte Amboss (73) so positioniert ist, dass sich die genannte hohle, geschlitzte

Nadel (93), wenn sie sich in der genannten ausgefahrenen Position befindet, nicht darüber hinaus erstreckt.

2. Tragbare Befestigungselement-Ausgabevorrichtung (51), wie in Anspruch 1 beansprucht, worin das genannte Gehäuse (53) revolverförmig ist und einen Lauf-Teil (61) und einen Griff-Teil (59) umfasst.
3. Tragbare Befestigungselement-Ausgabevorrichtung (51), wie in Anspruch 2 beansprucht, worin der genannte Griff-Teil (59) mit einer Auslöseröffnung (87) ausgestattet ist, wobei die genannte Befestigungselement-Ausgabevorrichtung (51) weiterhin einen Auslöser (81) umfasst, wobei der genannte Auslöser (81) drehbar in dem genannten Gehäuse (53) befestigt ist und sich teilweise durch die genannte Auslöseröffnung (87) für seine digitale Betätigung erstreckt, der genannte Auslöser (81) an die genannte hohle, geschlitzte Nadel (93) gekoppelt ist und auch an die genannte Auswurfstange (143) gekoppelt ist.
4. Tragbare Befestigungselement-Ausgabevorrichtung (51), wie in Anspruch 3 beansprucht, die weiterhin einen Auswurfstangen-Träger (141) umfasst, der in dem genannten Lauf-Teil (61) des genannten Gehäuses (53) angeordnet ist, wobei die genannte Auswurfstange (143) auf dem genannten Auswurfstangen-Träger (141) befestigt ist, der genannte Auswurfstangen-Träger (141) mit dem genannten Auslöser (81) derart verbunden ist, dass bewirkt wird, dass sich der genannte Auswurfstangen-Träger rückwärts und vorwärts durch den genannten Lauf-Teil (61) bewegt, wenn der Auslöser (81) betätigt wird.
5. Tragbare Befestigungselement-Ausgabevorrichtung (51), wie in Anspruch 4 beansprucht, weiterhin einen Nadelträger (101) umfassend, der in dem genannten Lauf-Teil (61) des genannten Gehäuses (53) angeordnet ist, wobei die genannte hohle, geschlitzte Nadel (93) auf dem genannten Nadelträger (101) befestigt ist, die genannte tragbare Befestigungselement-Ausgabevorrichtung (51) weiterhin eine Verbindung umfasst, die an den genannten Nadelträger (101) gekoppelt ist und selektiv verbindbar ist mit dem genannten Auswurfstangen-Träger (141) zur Kopplung und Entkopplung des genannten Nadelträgers (101) an und von dem genannten Auswurfstangen-Träger (141), so dass bewirkt wird, dass sich der genannte Nadelträger (101) rückwärts und vorwärts in dem genannten Lauf-Teil (61) nur während eines Teils der Bewegung des genannten Auswurfstangen-Trägers (141) bewegt.
6. Tragbare Befestigungselement-Ausgabevorrichtung (51), wie in Anspruch 5 beansprucht, die wei-

- terhin einen Hebel (87) umfasst, der innerhalb des genannten Gehäuses (53) angeordnet ist, wobei der genannte Hebel (87) drehbar befestigt ist an einem ersten Ende eines ersten Stifts (91), der genannte erste Stift (91) an dem genannten Auslöser (81) fixiert ist, wobei der genannte Hebel (87) drehbar befestigt ist an einem zweiten Ende an einem zweiten Stift (147), wobei der zweite Stift (147) an dem genannten Auswurfstangen-Träger (141) fixiert ist.
7. Tragbare Befestigungselement-Ausgabevorrichtung (51), wie in Anspruch 5 beansprucht, weiterhin eine Beschickungsbahn (171) umfassend, die innerhalb des LaufTeils (61) des genannten Gehäuses (53) angeordnet ist, wobei die genannte Beschickungsbahn (171) geformt ist, um, vollständig innerhalb dem genannten Lauf-Teil (61), eine Klammer von Befestigungselementen (11) aufzunehmen, wobei jedes der genannten Befestigungselemente (11) einen flexiblen Faden (13), ein erste Verlängerung an einem Ende des flexiblen Fadens und eine zweite Verlängerung an dem anderen Ende des flexiblen Fadens (13) umfasst.
8. Tragbare Befestigungselement-Ausgabevorrichtung (51), wie in Anspruch 7 beansprucht, worin die genannte Beschickungsbahn (171) teilweise definiert ist durch eine Beschickungsführung (175), die innerhalb des genannten Gehäuses (53) angeordnet ist, und teilweise durch eine Rippe, die im Innenbereich des genannten Gehäuses (53) ausgebildet ist.
9. Tragbare Befestigungselement-Ausgabevorrichtung (51), wie in Anspruch 1 beansprucht, worin der genannte Amboss (73) einen Vorderteil (73-2) und einen Rückteil (73-1) umfasst, der genannte Rückteil (73-1) an dem genannten Gehäuse (53) gesichert ist, der genannte Vorderteil (73-2) gebogen ist und sich vor der genannten Öffnung (62) in dem genannten Gehäuse (53) erstreckt.
10. Tragbare Befestigungselement-Ausgabevorrichtung (51), wie in Anspruch 9 beansprucht, worin der genannte Vorderteil (73-2) des genannten Ambosses (73) mit einer Amboss-Öffnung (75) versehen ist, wobei die genannte Amboss-Öffnung (75) mit der genannten Öffnung (62) in dem genannten Gehäuse (53) fluchtet, wobei der genannte Vorderteil des genannten Ambosses (73) auch mit einer geschlitzten äußeren Oberfläche versehen ist.
11. Tragbare Befestigungselement-Ausgabevorrichtung (51), wie in Anspruch 10 beansprucht, worin die genannte Amboss-Öffnung (75) und die genannte Öffnung (62) in dem genannten Gehäuse (53) mit einer Distanz von ungefähr 0,635 - 0,762 cm (0,25 - 0,3 Inch) voneinander beabstandet sind.
12. Tragbare Befestigungselement-Ausgabevorrichtung (51), wie in Anspruch 9 beansprucht, worin der genannte Rückteil (73-1) des genannten Ambosses (73) mittels einer Schraube (70) entfernbar gesichert ist an dem genannten Gehäuse (53).
13. Befestigungselement-Ausgabevorrichtung (51), wie in Anspruch 6 beansprucht, worin die genannte Nadel (93) mittels eines Arretierstifts (109) entfernbar gekoppelt ist an den genannten Nadelträger (101).
14. Befestigungselement-Ausgabevorrichtung (51), wie in Anspruch 13 beansprucht, worin der genannte Lauf-Teil (61) des genannten Gehäuses (53) mit einer Öffnung versehen ist, um den Arretierstift (109) zugänglich zu machen.
15. Befestigungselement-Ausgabevorrichtung (51), wie in den Ansprüchen 1 bis 14 beansprucht, worin das genannte Gehäuse (53) revolverförmig ist und einen Griff-Teil (59) und einen Lauf-Teil (61) einschließt, die genannte Befestigungselement-Ausgabevorrichtung (51) weiterhin einen Nadelträger (101), einen Auswurfstangen-Träger (141), ein Verbindungselement und einen Auslösermechanismus umfasst, wobei der genannte Nadelträger (101) verschiebbar in dem genannten Lauf-Teil (61) befestigt ist, die genannte hohle, geschlitzte Nadel (93) an den genannten Nadelträger (101) gekoppelt ist, der genannte Auswurfstangen-Träger (141) verschiebbar in dem genannten Lauf-Teil (61) befestigt ist, die genannte Auswurfstange (143) an den genannten Auswurfstangen-Träger (141) gekoppelt ist, das genannte Verbindungselement an den genannten Nadelträger (101) gekoppelt ist und selektiv verbindbar ist mit dem genannten Auswurfstangen-Träger (141) zur Kopplung und Entkopplung des genannten Nadelträgers (101) vom genannten Auswurfstangen-Träger (141), so dass bewirkt wird, dass der genannte Nadelträger (101) nur während eines Teils der Bewegung des genannten Auswurfstangen-Trägers (141) in dem genannten Lauf-Teil (61) zurück und vorwärts rutscht, wobei der Auslösermechanismus einen Auslöser (81) umfasst, der genannte Auslöser (81) in dem genannten Gehäuse (53) drehbar befestigt ist und sich teilweise durch dessen genannten Griff-Teil (59), zur manuellen Betätigung, erstreckt, wobei der genannte Auslösemechanismus weiterhin einen Hebel (87) umfasst, der innerhalb des genannten Gehäuses (53) angeordnet ist, der genannte Hebel (87) drehbar befestigt ist an einem ersten Ende eines ersten Stifts (91), wobei der genannte erste Stift (91) an dem genannten Auslöser (81) fixiert ist, der genannte Hebel (87) drehbar befestigt ist an einem zweiten Ende eines zweiten Stifts (147), wobei der genannte zweite Stift (147) an dem genannten Auswurfstangen-Träger (141) fixiert ist.

16. Befestigungselement-Ausgabevorrichtung (51), wie in Anspruch 15 beansprucht, weiterhin einen Amboss (73) umfassend, wobei der Amboss (73) an das genannte Gehäuse (53) gekoppelt ist.
17. Befestigungselement-Ausgabevorrichtung (51), wie in Anspruch 15 beansprucht, worin der genannte Amboss (73) entfernbar an das genannte Gehäuse (53) gekoppelt ist.
18. Befestigungselement-Ausgabevorrichtung (51), wie in Anspruch 15 beansprucht, worin die genannte Befestigungselement-Ausgabevorrichtung (51) angepasst ist für die Ausgabe einzelner Befestigungselemente (11) aus einer Befestigungselement-Klammer (31), die einzelnen Befestigungselemente (11) einen flexiblen Faden (13) umfassen, der eine erste Verlängerung an einem ersten Ende davon und eine zweite Verlängerung an einem zweiten Ende davon besitzt, wobei benachbarte erste Verlängerungen der genannten Befestigungselement-Klammer (31) verbunden sind durch einen ersten Verbindungssteg (35), die benachbarte zweite Verlängerung der genannten Befestigungselement-Klammer (31) verbunden ist durch einen zweiten Verbindungssteg (35), die genannten ersten Verlängerungen der genannten Klammer (31) ausgegeben werden durch die genannte hohle, geschlitzte Nadel (93), wobei die genannte Befestigungselement-Ausgabevorrichtung (51) weiterhin eine Auswurfklammer (145) umfasst, die an den genannten Auswurfstangen-Träger (141) gekoppelt ist, um den zweiten Verbindungssteg (35) zwischen benachbarten zweiten Verlängerungen zu trennen.
19. Befestigungselement-Ausgabevorrichtung (51), wie in den Ansprüchen 1 bis 11 beansprucht, weiterhin eine Beschickungsführung (175) umfassend, wobei die genannte Beschickungsführung (175) feststehend in dem genannten Gehäuse (53) hinter der genannten hohlen, geschlitzten Nadel (93) befestigt ist, die genannte Beschickungsführung (175) einen Vorderteil einer Beschickungsbahn (171) definiert und eine Stufe am Ende der genannten Beschickungsbahn (171) umfasst, von welcher entfernt ein einzelnes Befestigungselement (11) aus einer Befestigungselement-Klammer (31) in die genannte hohle, geschlitzte Nadel (93) mittels der genannten Auswurfstange (143) geladen wird.
20. Befestigungselement-Ausgabevorrichtung (51), wie in Anspruch 15 beansprucht, worin die genannte Beschickungsführung (175) weiterhin einen Vorsprung umfasst, der mit dem Fadenteil einer Befestigungselement-Klammer (31) verbindbar ist, verwendbar um zu verhindern, dass sich die genannte Befestigungselement-Klammer (31) rückwärts in die genannte Beschickungsbahn (171) bewegt.
21. Befestigungselement-Ausgabevorrichtung (51), wie in Anspruch 15 beansprucht, worin die genannte Beschickungsführung (175) mit einem vertieften Teil versehen ist, der eine geschlitzte Bohrung (179) besitzt, wobei der genannte vertiefte Teil angepasst ist, um entfernbar die genannte hohle, geschlitzte Nadel (93) aufzunehmen.
22. Befestigungselement-Ausgabevorrichtung (51), wie in Anspruch 15 beansprucht, worin das genannte Gehäuse innen geformt ist, um einen Rückteil (177-2) einer Beschickungsbahn (171) zu definieren, wobei der genannte Rückteil (177-2) mit dem genannten Vorderteil (177-1) der genannten Beschickungsbahn (171) fluchtet.
23. Befestigungselement-Ausgabevorrichtung (51), wie in Anspruch 22 beansprucht, worin die genannte Beschickungsbahn (171) geformt ist, um vollständig innerhalb des genannten Gehäuses (53) eine Vielzahl von Befestigungselementen (11) aufzunehmen.
24. Befestigungselement-Ausgabevorrichtung (51), wie in Anspruch 23 beansprucht, weiterhin eine Tür (69) umfassend, die drehbar an dem genannten Gehäuse (53) befestigt ist, wobei die genannte Tür (69) einen Zugriff auf die genannte Beschickungsbahn (171) bereitstellt.
25. Befestigungselement-Ausgabevorrichtung (51), wie in Anspruch 24 beansprucht, weiterhin ein Rad umfassend, das rotierbar in der genannten Tür (69) befestigt ist, wobei das genannte Rad angepasst ist, um eine Befestigungselement-Klammer (31) einzurasten, die in der genannten Beschickungsbahn (171) angeordnet ist.
26. Befestigungselement-Ausgabevorrichtung (51), wie in Anspruch 15 beansprucht, worin das genannte Gehäuse (53) mit einem Paar Fenster (65) ausgestattet ist, zur Verwendung bei der Beobachtung einer Befestigungselement-Klammer (31), die in der genannten Beschickungsbahn (171) angeordnet ist.
27. Befestigungselement-Ausgabevorrichtung (51), wie in Anspruch 15 beansprucht, weiterhin umfassend einen Auslösemechanismus, der in dem genannten Gehäuse (53) angebracht ist, einen Mechanismus, der den genannten Auslösemechanismus zur Bewegung der genannten hohlen, geschlitzten Nadel (93) koppelt, und einen Mechanismus, der den genannten Auslösemechanismus zur Bewegung der genannten Auswurfstange (143) koppelt.
28. Befestigungselement-Ausgabevorrichtung (51), wie in Anspruch 27 beansprucht, weiterhin einen Mechanismus umfassend zum Verschieben einer Befestigungselement-Klammer (31) durch die genannte

Beschickungsbahn (171) mit einer Rate von einem Befestigungselement (11) pro Auslöserzug.

29. Befestigungselement-Ausgabevorrichtung (51), wie in den Ansprüchen 1 bis 19 beansprucht, worin die genannte Auswurfstange (143) verschiebbar rückwärts und vorwärts bewegbar ist zwischen einer zurückgezogenen Position, die hinter der genannten hohlen, geschlitzten Nadel (93) angeordnet ist, und einer vorgerückten Position, die sich durch die genannte hohle, geschlitzte Nadel (93) erstreckt, die genannte Befestigungselement-Ausgabevorrichtung weiterhin umfassend einen Auslöser (81), der mechanisch an das genannte Gehäuse (53) gekoppelt ist, erste Kopplungsmittel, welche den genannten Auslöser (81) an die genannte hohle, geschlitzte Nadel (93) koppeln, zur Bewegung der genannten hohlen, geschlitzten Nadel (93) von der genannten zurückgezogenen Position zu der genannten vorgerückten Position, und dann zurück zu der genannten zurückgezogenen Position, während eines Auslöserzugs, und zweite Kopplungsmittel, welche den genannten Auslöser (81) an die genannte Auswurfstange (143) koppeln, zur Bewegung der genannten Auswurfstange (143) von der genannten zurückgezogenen Position zu der genannten vorgerückten Position, und dann zurück zu der genannten zurückgezogenen Position, während eines Auslöserzugs, worin die genannten ersten Kopplungsmittel und die genannten zweiten Kopplungsmittel so gestaltet sind, dass die genannte Auswurfstange (143) sich von der genannten vorgerückten Position zusammen mit der genannten hohlen, geschlitzten Nadel (93) zurückzieht, wenn sich die genannte hohle, geschlitzte Nadel (93) von der genannten vorgerückten Position zu der genannten zurückgezogenen Position bewegt.
30. Befestigungselement-Ausgabevorrichtung (51), wie in den Ansprüchen 1 bis 29 beansprucht, worin das genannte Gehäuse (53) gestaltet ist, um vollständig innerhalb des genannten Gehäuses (53) eine Klammer (31) von Befestigungselementen (11) aufzunehmen, wobei jedes der Befestigungselemente (11) in der genannten Klammer (31) einen flexiblen Faden (13) umfasst, der einen ersten verlängerten Teil an einem ersten Ende davon und einen zweiten verlängerten Teil an einem zweiten Ende davon besitzt.
31. Befestigungselement-Ausgabevorrichtung (51), wie in Anspruch 30 beansprucht, worin das genannte Gehäuse (53) geformt ist, um vollständig darin eine Klammer (31) mit ungefähr einhundertfünfundzwanzig Befestigungselementen (11) aufzunehmen.
32. Befestigungselement-Ausgabevorrichtung (51), wie

in Anspruch 30 beansprucht, worin die genannte Beschickungsbahn (171) hinter der genannten hohlen, geschlitzten Nadel (93) in einer Richtung abschließt, die im Wesentlichen lotrecht auf die longitudinale Achse der genannten hohlen, geschlitzten Nadel (93) ist.

33. Befestigungselement-Ausgabevorrichtung (51), wie in Anspruch 32 beansprucht, worin das genannte Gehäuse (53) geformt ist, um darin vollständig eine Klammer mit ungefähr einhundertfünfundzwanzig Befestigungselementen (11) aufzunehmen.

## 15 Revendications

1. Outil distributeur d'agrafes (51) tenu à la main, pour distribuer une agrafe du type comprenant un filament flexible (13) élargi à une extrémité, ledit outil distributeur d'agrafes (51) comprenant:
- (a) un boîtier (53), ledit boîtier (53) étant pourvu d'une ouverture d'aiguille (93) ;
  - (b) une aiguille creuse fendue (93), ladite aiguille creuse fendue (93) pouvant coulisser d'avant en arrière entre une position rétractée disposée entièrement à l'intérieur dudit boîtier (53) et une position déployée s'étendant à travers ladite ouverture d'aiguille (93), ladite aiguille creuse fendue (93) étant prévue pour recevoir l'élargissement de ladite agrafe (11) ;
  - (c) une tige éjectrice (143), ladite tige éjectrice (143) pouvant coulisser d'avant en arrière à travers ladite aiguille creuse fendue (93) pour éjecter l'élargissement disposé dedans ; et
  - (d) une enclume (73) fixée par rapport audit boîtier (53) et s'étendant devant ladite ouverture d'aiguille (93), ladite enclume (73) étant positionnée de telle sorte que ladite aiguille creuse fendue (93), dans ladite position déployée, ne s'étende pas plus loin.
2. Outil distributeur d'agrafes (51) tenu à la main selon la revendication 1, dans lequel ledit boîtier (53) a une forme de pistolet et comprend une portion de barillet (61) et une portion de crosse (59).
3. Outil distributeur d'agrafes (51) tenu à la main selon la revendication 2, dans lequel ladite portion de crosse (59) est pourvue d'une ouverture de gâchette (87), ledit outil distributeur d'agrafes (51) comprenant en outre une gâchette (81), ladite gâchette (81) étant montée à pivotement dans ledit boîtier (53) et s'étendant partiellement à travers ladite ouverture de gâchette (87) en vue de son actionnement digital, ladite gâchette (81) étant couplée à ladite aiguille creuse fendue (93) et étant également couplée à ladite tige éjectrice (143).

4. Outil distributeur d'agrafes (51) tenu à la main selon la revendication 3, comprenant en outre un support de tige éjectrice (141), disposé dans ladite portion de barillet (61) dudit boîtier (53), ladite tige éjectrice (143) étant montée sur ledit support de tige éjectrice (141), ledit support de tige éjectrice (141) étant connecté à ladite gâchette (81) de telle manière que ledit support de tige éjectrice soit coulissé d'avant en arrière à travers ladite portion de barillet (61) à mesure que ladite gâchette (81) est actionnée. 5
5. Outil distributeur d'agrafes (51) tenu à la main selon la revendication 4, comprenant en outre un support d'aiguille (101) disposé dans ladite portion de barillet (61) dudit boîtier (53), ladite aiguille creuse fendue (93) étant montée sur ledit support d'aiguille (101), ledit outil distributeur d'agrafes (51) tenu à la main comprenant en outre une tringle couplée audit support d'aiguille (101) et pouvant s'engager de manière sélective avec ledit support de tige éjectrice (141) pour coupler et désaccoupler ledit support d'aiguille (101) avec ledit support de tige éjectrice (141) de sorte que ledit support d'aiguille (101) soit coulissé d'avant en arrière dans ladite portion de barillet (61) uniquement pendant une portion du mouvement dudit support de tige éjectrice (141). 10 15 20 25
6. Outil distributeur d'agrafes (51) tenu à la main selon la revendication 5, comprenant en outre un levier (87) disposé dans ledit boîtier (53), ledit levier (87) étant monté à pivotement au niveau d'une première extrémité sur une première goupille (91), ladite première goupille (91) étant fixée à ladite gâchette (81), ledit levier (87) étant monté à pivotement au niveau d'une deuxième extrémité sur une deuxième goupille (147), ladite deuxième goupille (147) étant fixée audit support de tige éjectrice (141). 30 35
7. Outil distributeur d'agrafes (51) tenu à la main selon la revendication 5, comprenant en outre une piste d'alimentation (171) disposée dans ladite portion de barillet (61) dudit boîtier (53), ladite piste d'alimentation (171) étant formée de manière à recevoir, entièrement dans ladite portion de barillet (61), un groupe d'agrafes (31), chacune desdites agrafes (11) comprenant un filament flexible (13), un premier élargissement à une extrémité du filament flexible et un deuxième élargissement à l'autre extrémité du filament flexible (13). 40 45 50
8. Outil distributeur d'agrafes (51) tenu à la main selon la revendication 7, dans lequel ladite piste d'alimentation (171) est définie en partie par un guide d'alimentation (175) disposé dans ledit boîtier (53) et en partie par une nervure formée sur l'intérieur dudit boîtier (53). 55
9. Outil distributeur d'agrafes (51) tenu à la main selon la revendication 1, dans lequel ladite enclume (73) comprend une portion avant (73-2) et une portion arrière (73-1), ladite portion arrière (73-1) étant fixée audit boîtier (53), ladite portion avant (73-2) étant enroulée et s'étendant devant ladite ouverture (62) dans ledit boîtier (53).
10. Outil distributeur d'agrafes (51) tenu à la main selon la revendication 9, dans lequel ladite portion avant (73-2) de ladite enclume (73) est pourvue d'une ouverture d'enclume (75), ladite ouverture d'enclume (75) étant alignée avec ladite ouverture (62) dans ledit boîtier (53), ladite portion avant de ladite enclume (73) étant également pourvue d'une surface extérieure fendue. 10 15 20 25
11. Outil distributeur d'agrafes (51) tenu à la main selon la revendication 10, dans lequel ladite ouverture d'enclume (75) et ladite ouverture (62) dans ledit boîtier (53) sont espacées l'une de l'autre d'une distance d'environ 0,625 à 0,762 cm (0,25 à 0,3 pouce). 30 35
12. Outil distributeur d'agrafes (51) tenu à la main selon la revendication 9, dans lequel ladite portion arrière (73-1) de ladite enclume (73) est fixée de manière amovible audit boîtier (53), par une vis (70). 40 45
13. Outil distributeur d'agrafes (51) selon la revendication 6, dans lequel ladite aiguille (93) est couplée de manière amovible audit support d'aiguille (101) par une goupille de verrouillage (109). 50
14. Outil distributeur d'agrafes (51) selon la revendication 13, dans lequel ladite portion de barillet (61) dudit boîtier (53) est pourvue d'une ouverture pour accéder à ladite goupille de verrouillage (109). 55
15. Outil distributeur d'agrafes (51) selon l'une quelconque des revendications 1 à 14, dans lequel ledit boîtier (53) est en forme de pistolet et comporte une portion de crosse (59) et une portion de barillet (61), ledit outil distributeur d'agrafes (51) comprenant en outre un support d'aiguille (101), un support de tige éjectrice (141), un organe de liaison et un mécanisme de déclenchement, ledit support d'aiguille (101) étant monté à coulissement dans ladite portion de barillet (61), ladite aiguille creuse fendue (93) étant couplée audit support d'aiguille (101), ledit support de tige éjectrice (141) étant monté à coulissement dans ladite portion de barillet (61), ladite tige éjectrice (143) étant couplée audit support de tige éjectrice (141), ledit organe de liaison étant couplé audit support d'aiguille (101) et pouvant s'engager de manière sélective dans ledit support de tige éjectrice (141) pour coupler et désaccoupler ledit support d'aiguille (101) avec ledit support de tige éjectrice (141) de sorte que ledit support d'aiguille (101) coulisse d'avant en arrière dans ladite portion de barillet (61) 50 55

- uniquement pendant une portion du mouvement dudit support de tige éjectrice (141), ledit mécanisme de déclenchement comprenant une gâchette (81), ladite gâchette (81) étant montée à pivotement dans ledit boîtier (53) et s'étendant en partie à travers sa dite portion de crosse (59) en vue d'un actionnement manuel, ledit mécanisme de déclenchement comprenant en outre un levier (87) disposé dans ledit boîtier (53), ledit levier (87) étant monté à pivotement au niveau d'une première extrémité sur une première goupille (91), ladite première goupille (91) étant fixée à ladite gâchette (81), ledit levier (87) étant monté à pivotement au niveau d'une deuxième extrémité sur une deuxième goupille (147), ladite deuxième goupille (147) étant fixée audit support de tige éjectrice (141).
16. Outil distributeur d'agrafes (51) selon la revendication 15, comprenant en outre une enclume (73), ladite enclume (73) étant couplée audit boîtier (53).
17. Outil distributeur d'agrafes (51) selon la revendication 15, dans lequel ladite enclume (73) est couplée de manière amovible audit boîtier (53).
18. Outil distributeur d'agrafes (51) selon la revendication 15, dans lequel ledit outil distributeur d'agrafes (51) est prévu pour distribuer des agrafes individuelles (11) d'un groupe d'agrafes (31), les agrafes individuelles (11) comprenant un filament flexible (13) ayant un premier élargissement au niveau d'une première extrémité et un deuxième élargissement au niveau d'une deuxième extrémité, des premiers élargissements adjacents dudit groupe d'agrafes (31) étant connectés par une première broche de connexion (35), des deuxièmes élargissements adjacents dudit groupe d'agrafes (31) étant connectés par une deuxième broche de connexion (35), lesdits premiers élargissements dudit groupe (31) étant distribués à travers ladite aiguille creuse fendue (93), ledit outil distributeur d'agrafes (51) comprenant en outre un groupe éjecteur (145) couplé audit support de tige éjectrice (141) pour sectionner la deuxième broche de connexion (35) entre des deuxièmes élargissements adjacents.
19. Outil distributeur d'agrafes (51) selon l'une quelconque des revendications 1 à 11, comprenant en outre un guide d'alimentation (175), ledit guide d'alimentation (175) étant monté de manière stationnaire dans ledit boîtier (53) derrière ladite aiguille creuse fendue (93), ledit guide d'alimentation (175) définissant une position avant d'une piste d'alimentation (171) et comprenant un étage à l'extrémité de ladite piste d'alimentation (171) depuis lequel une agrafe individuelle (11) d'un groupe d'agrafes (31) est chargée dans ladite aiguille creuse fendue (93) par ladite tige éjectrice (143).
20. Outil distributeur d'agrafes (51) selon la revendication 15, dans lequel ledit guide d'alimentation (175) comprend en outre une saillie pouvant s'engager avec la portion de filament d'un groupe d'agrafes (31) pour empêcher ledit groupe d'agrafes (31) de se déplacer vers l'arrière dans ladite piste d'alimentation (171).
21. Outil distributeur d'agrafes (51) selon la revendication 15, dans lequel ledit guide d'alimentation (175) est pourvu d'une portion en retrait ayant un alésage fendu (179), ladite portion en retrait étant prévue pour recevoir de manière amovible ladite aiguille creuse fendue (93).
22. Outil distributeur d'agrafes (51) selon la revendication 15, dans lequel ledit boîtier est formé à l'intérieur de manière à définir une portion arrière (177-2) d'une piste d'alimentation (171), ladite portion arrière (177-2) étant alignée avec ladite portion avant (177-1) de ladite piste d'alimentation (171).
23. Outil distributeur d'agrafes (51) selon la revendication 22, dans lequel ladite piste d'alimentation (171) est formée de manière à recevoir entièrement dans ledit boîtier (53) une pluralité d'agrafes (11).
24. Outil distributeur d'agrafes (51) selon la revendication 23, comprenant en outre une porte (69) montée à pivotement sur ledit boîtier (53), ladite porte (69) permettant l'accès à ladite piste d'alimentation (171).
25. Outil distributeur d'agrafes (51) selon la revendication 24, comprenant en outre une roue montée à rotation dans ladite porte (69), ladite roue étant prévue pour engager un groupe d'agrafes (31) disposé dans ladite piste d'alimentation (171).
26. Outil distributeur d'agrafes (51) selon la revendication 15, dans lequel ledit boîtier (53) est pourvu d'une paire de fenêtres (65) permettant de contrôler un groupe d'agrafes (31) disposé dans ladite piste d'alimentation (171).
27. Outil distributeur d'agrafes (51) selon la revendication 15, comprenant en outre un mécanisme de déclenchement monté dans ledit boîtier (53), un mécanisme couplant ledit mécanisme de déclenchement au mouvement de ladite aiguille creuse fendue (93) et un mécanisme couplant ledit mécanisme de déclenchement au mouvement de ladite tige éjectrice (143).
28. Outil distributeur d'agrafes (51) selon la revendication 27, comprenant en outre un mécanisme pour faire avancer un groupe d'agrafes (31) à travers ladite piste d'alimentation (171) à une vitesse d'une agrafe (11) par actionnement de la gâchette.

29. Outil distributeur d'agrafes (51) selon l'une quelconque des revendications 1 à 19, dans lequel ladite tige éjectrice (143) peut coulisser d'avant en arrière entre une position rentrée disposée derrière ladite aiguille creuse fendue (93) et une position avancée s'étendant à travers ladite aiguille creuse fendue (93), ledit outil distributeur d'agrafes (51) comprenant en outre une gâchette (81) couplée mécaniquement audit boîtier (53),  
un premier moyen d'accouplement, couplant ladite gâchette (81) à ladite aiguille creuse fendue (93) pour déplacer ladite aiguille creuse fendue (93) de ladite position rentrée dans ladite position étendue puis la ramener dans ladite position rentrée au cours d'une course de la gâchette, et  
un deuxième moyen d'accouplement couplant ladite gâchette (81) à ladite tige éjectrice (143) pour déplacer ladite tige éjectrice (143) de ladite position rentrée dans ladite position avancée puis la ramener dans ladite position rentrée au cours d'une course de la gâchette,  
ledit premier moyen d'accouplement et ledit deuxième moyen d'accouplement étant conçus de telle sorte que ladite tige éjectrice (143) se rétracte de ladite position avancée conjointement avec ladite aiguille creuse fendue (93) à mesure que ladite aiguille creuse fendue (93) se déplace de ladite position étendue dans ladite position rentrée.
30. Outil distributeur d'agrafes (51) selon la revendication 25, dans lequel le boîtier (53) est formé pour recevoir, entièrement à l'intérieur dudit boîtier (53), un groupe (31) d'agrafes (11), chacune desdites agrafes (11) dans ledit groupe (31) comprenant un filament flexible (13) ayant une première portion élargie au niveau d'une première extrémité et une deuxième portion élargie au niveau d'une deuxième extrémité.
31. Outil distributeur d'agrafes (51) selon la revendication 30, dans lequel ledit boîtier (53) est formé pour recevoir, entièrement à l'intérieur de celui-ci, un groupe (31) d'environ cent-vingt-cinq agrafes (11).
32. Outil distributeur d'agrafes (51) selon la revendication 30, dans lequel ladite piste d'alimentation (171) se termine derrière ladite aiguille creuse fendue (93) dans une direction substantiellement perpendiculaire à l'axe longitudinal de ladite aiguille creuse fendue (13).
33. Outil distributeur d'agrafes (51) selon la revendication 32, dans lequel ledit boîtier (53) est formé pour recevoir entièrement à l'intérieur de celui-ci, un groupe d'environ cent-vingt-cinq agrafes (11).

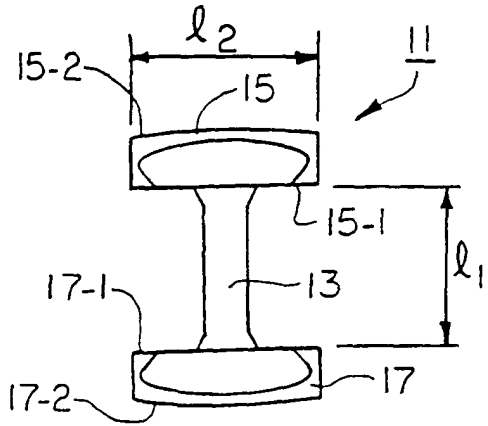

FIG. 1(a)

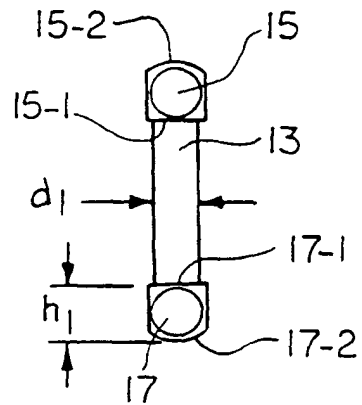

FIG. 1(c)

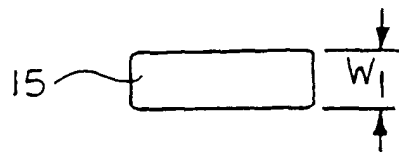

FIG. 1(b)

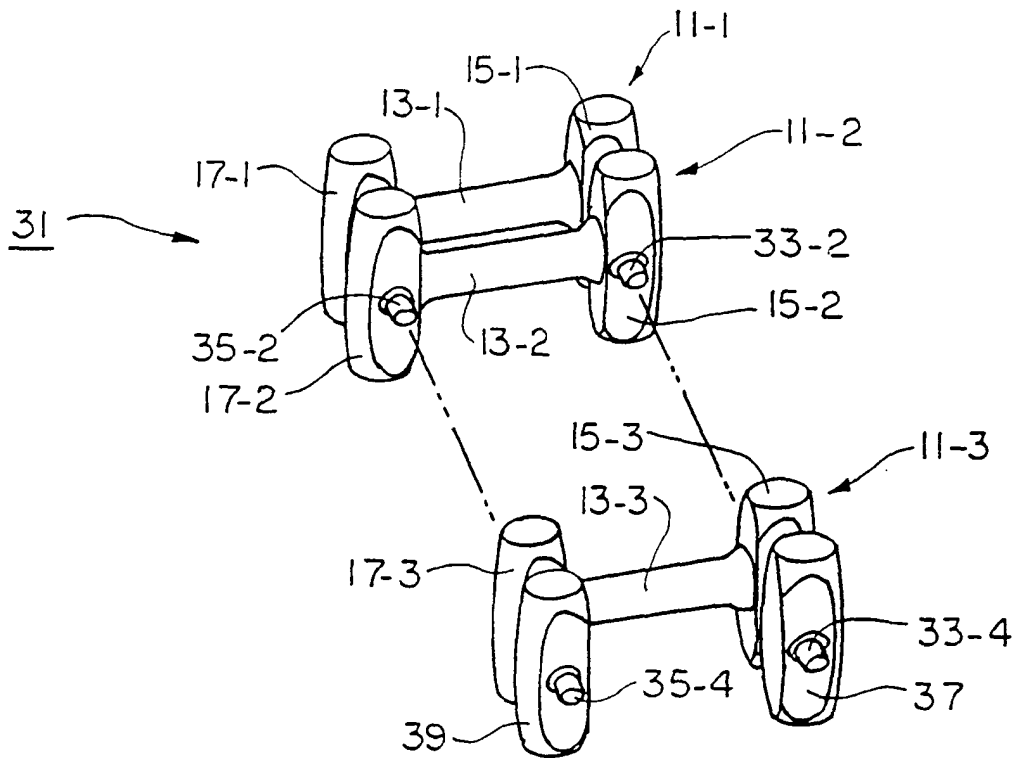

FIG. 2(a)

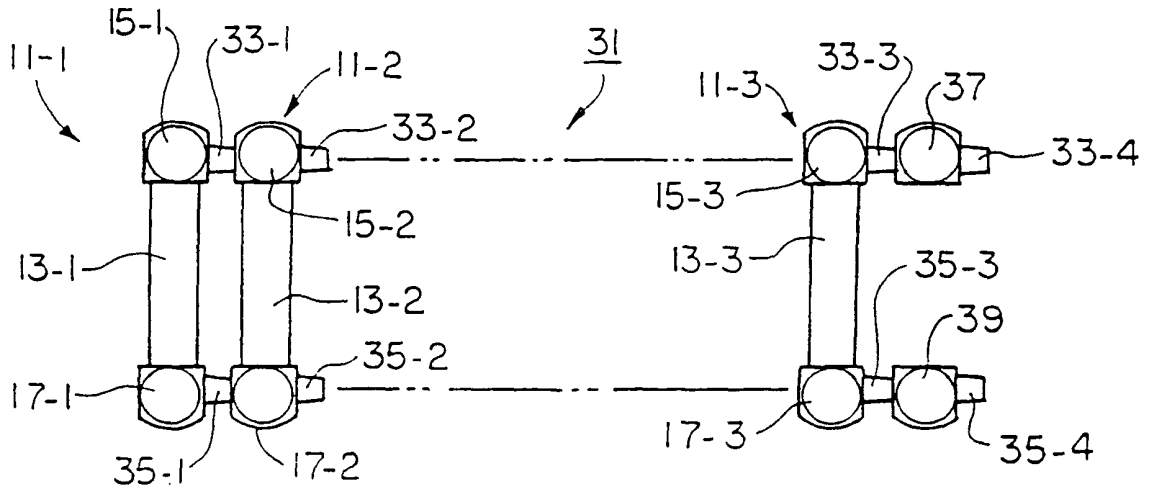

FIG. 2(b)

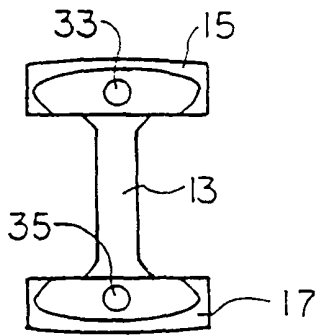

FIG. 3(a)

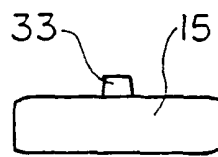

FIG. 3(b)

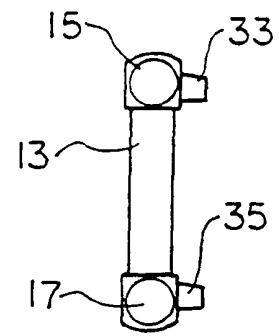

FIG. 3(c)

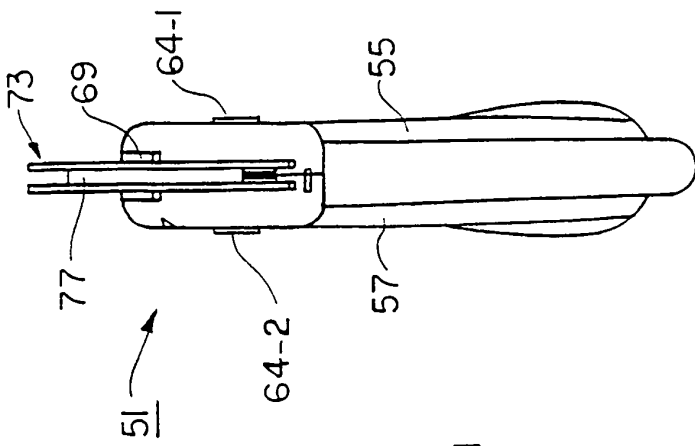

FIG. 4(c)

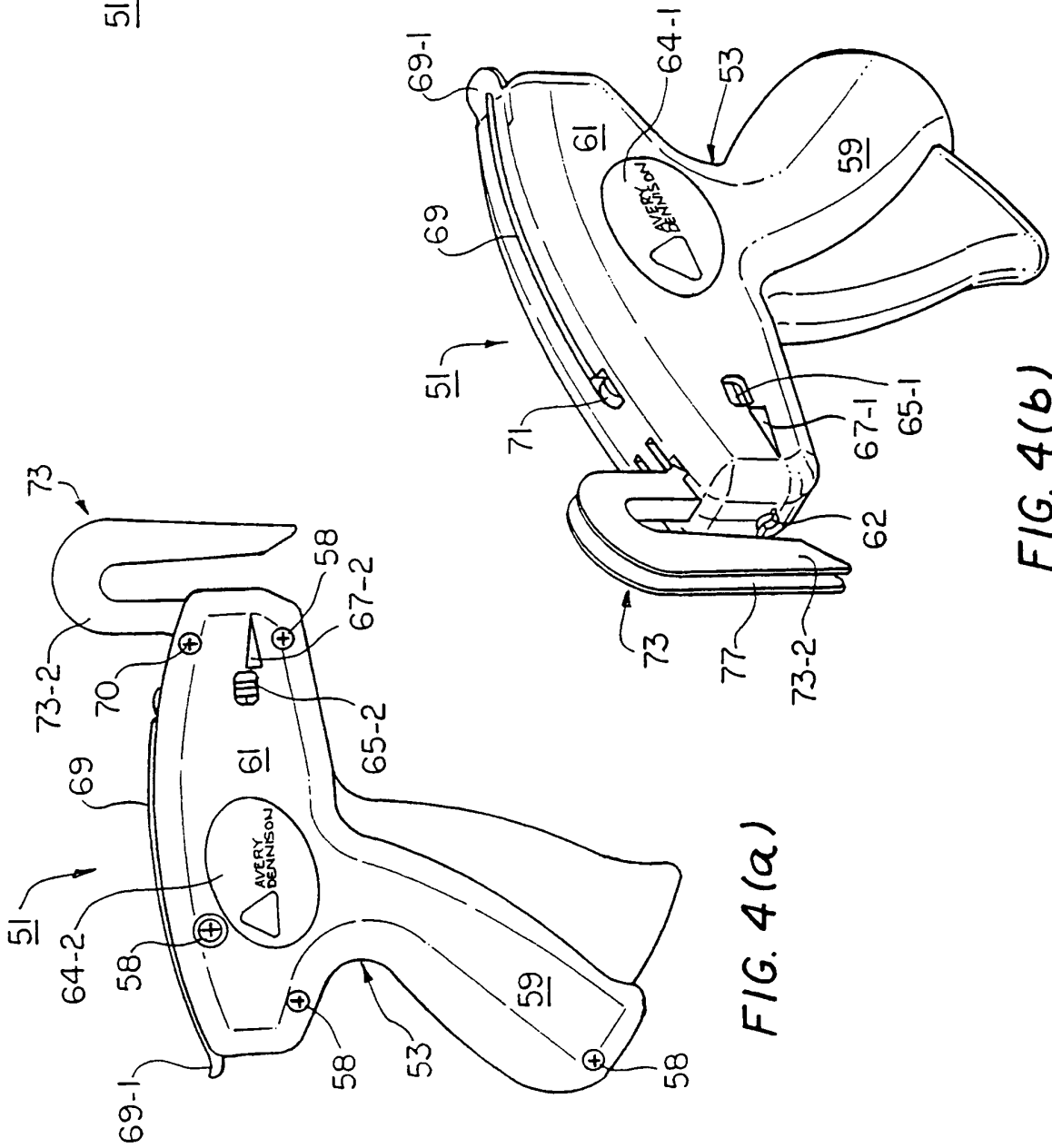

FIG. 4(a)

FIG. 4(b)

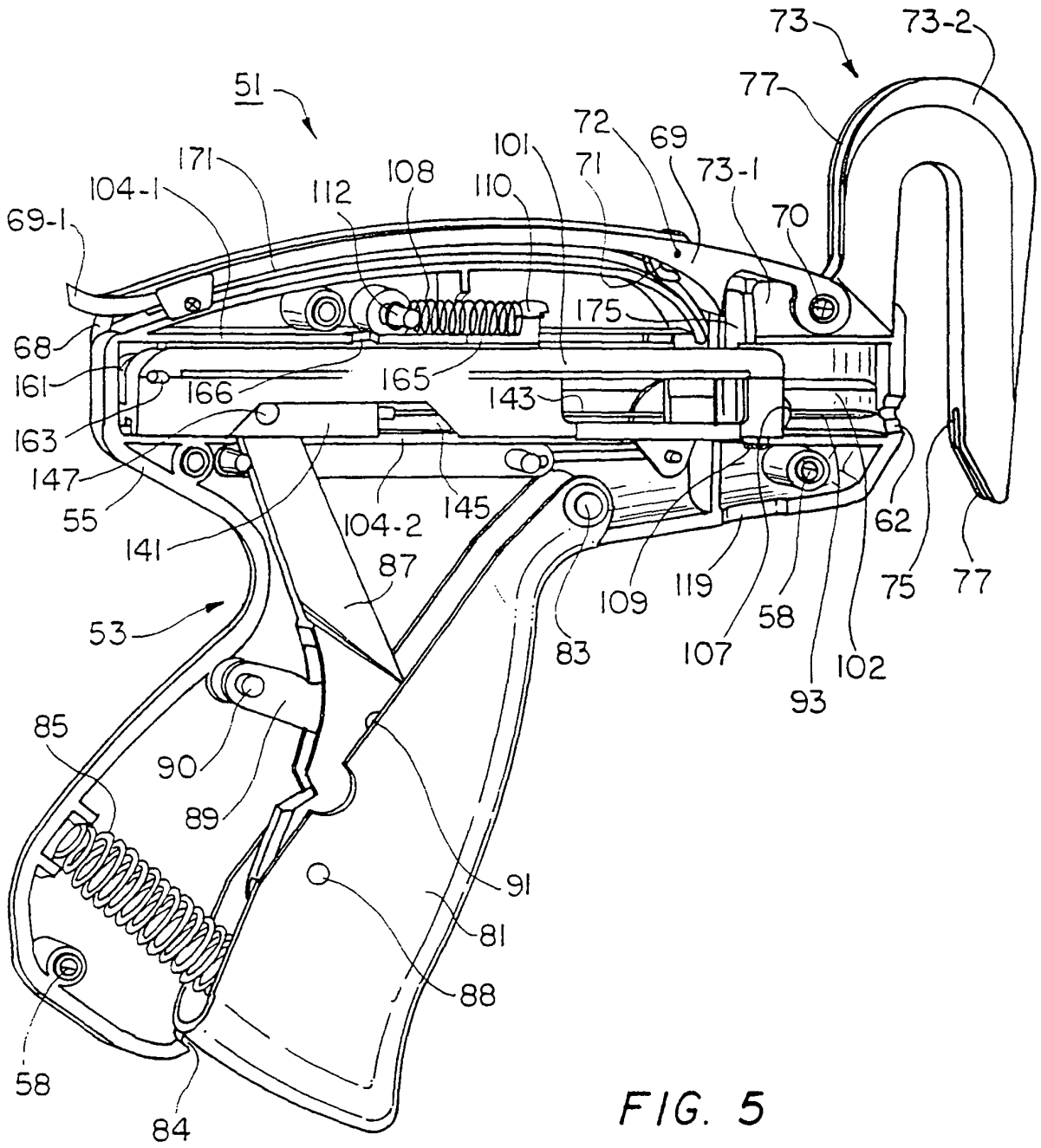
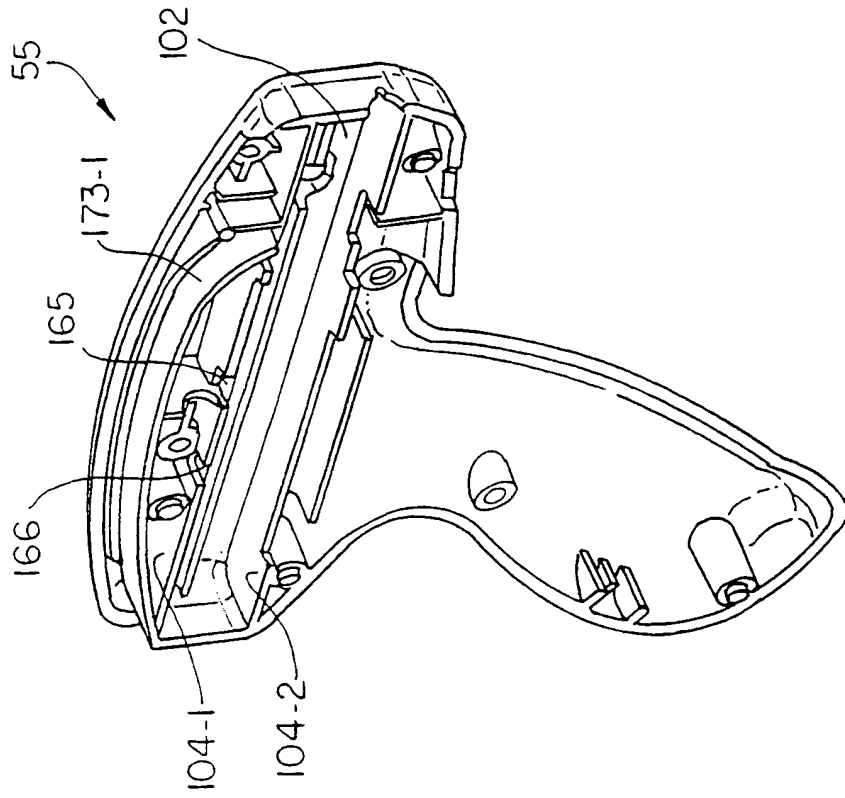
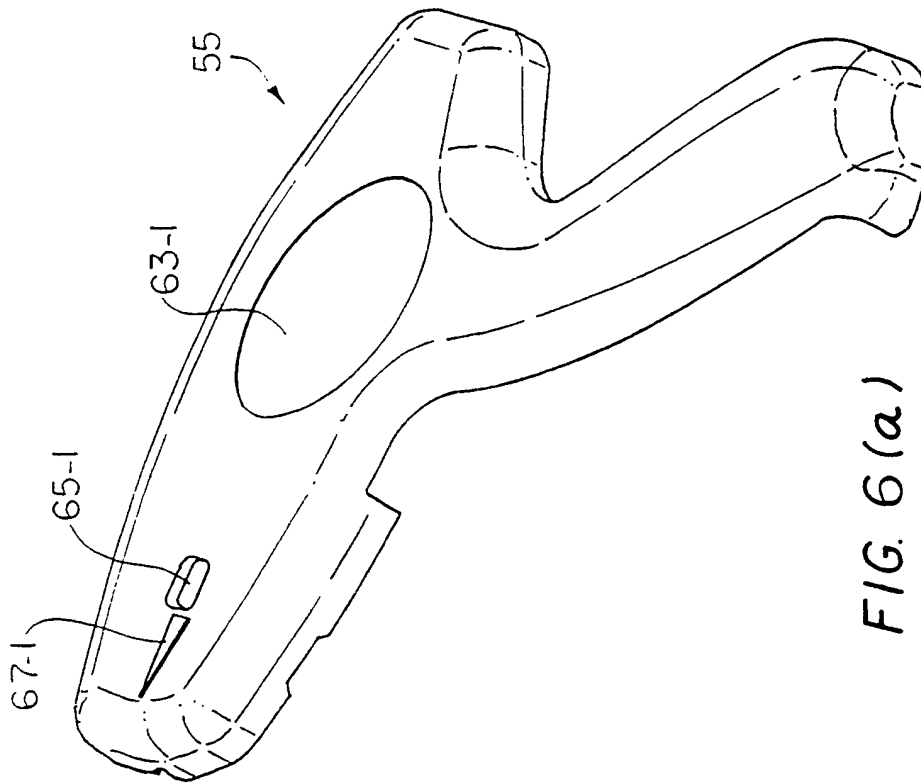

FIG. 5



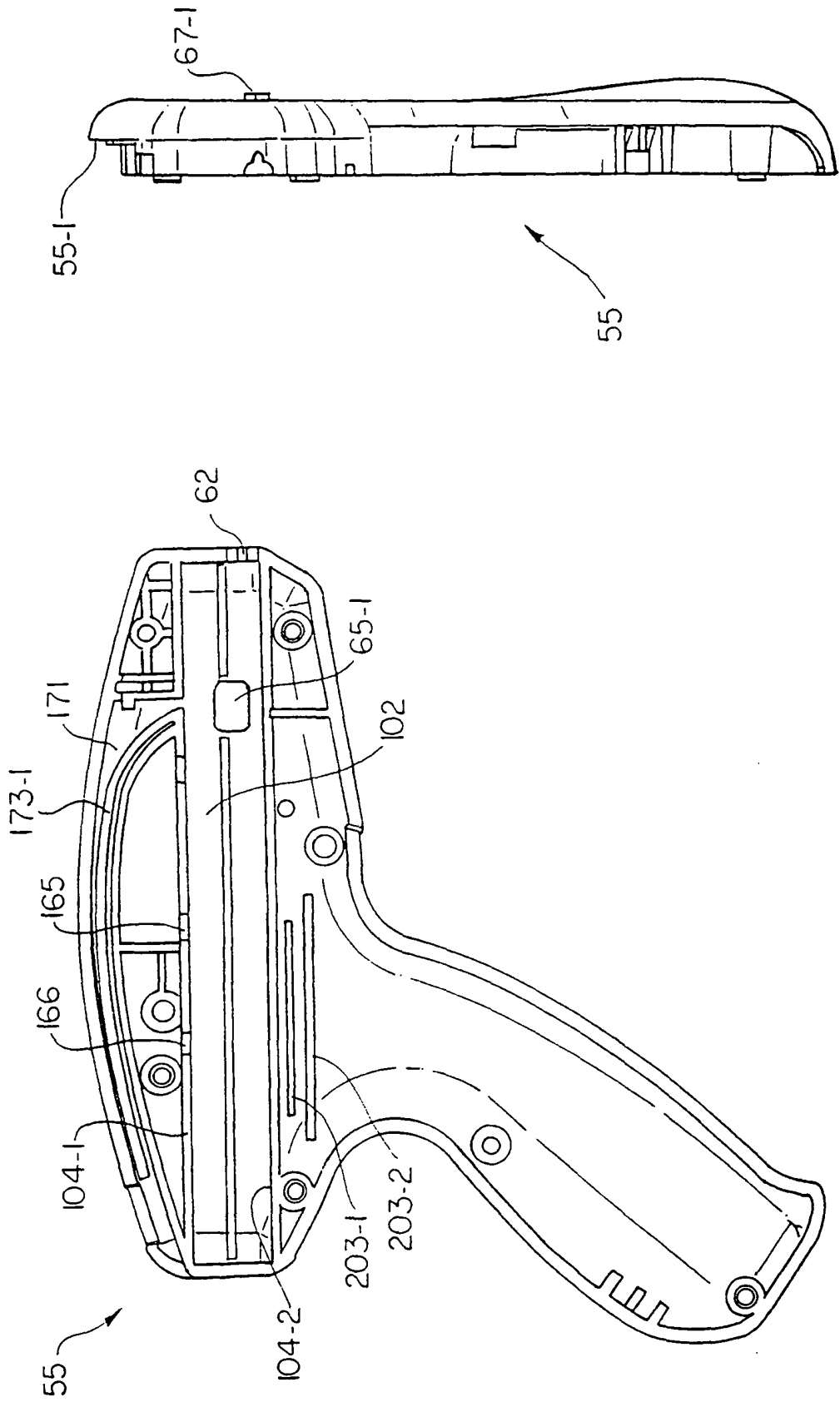

FIG. 6(c)

FIG. 6(d)

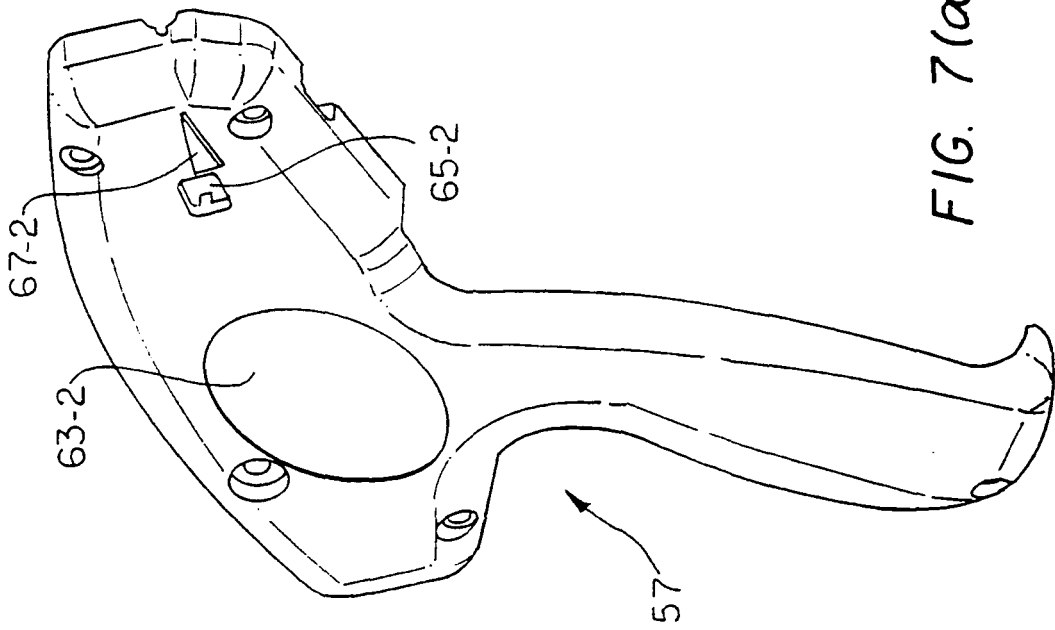

FIG. 7(a)

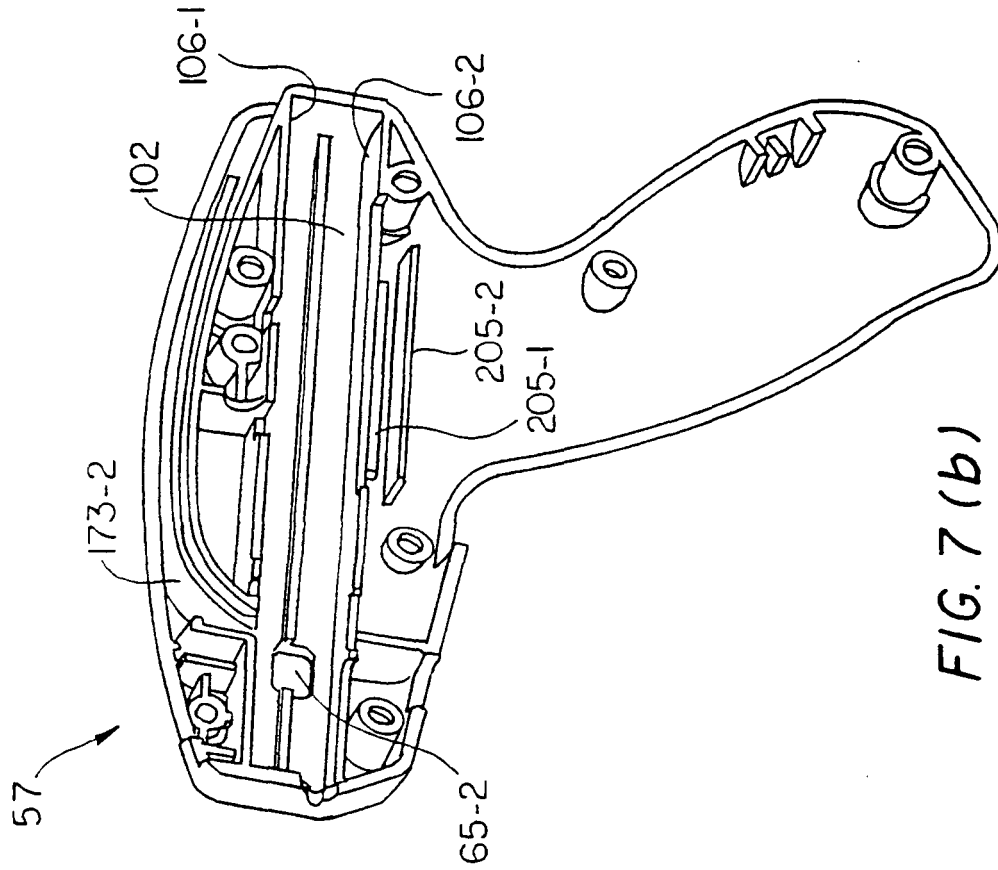

FIG. 7(b)

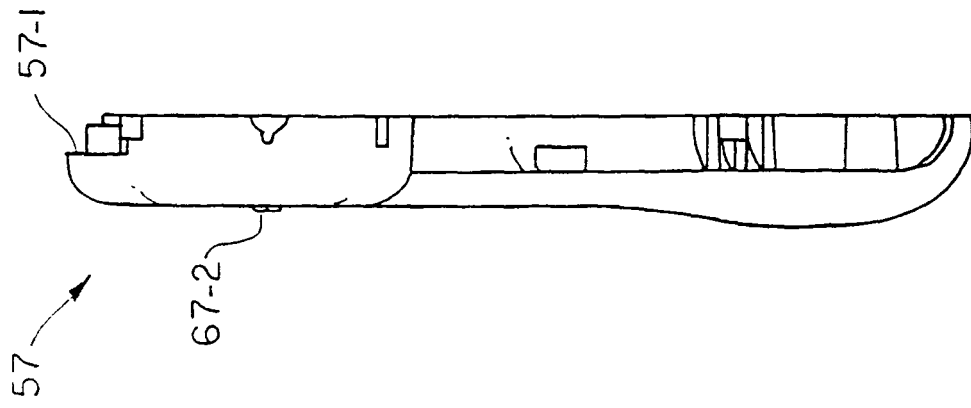

FIG. 7(d)

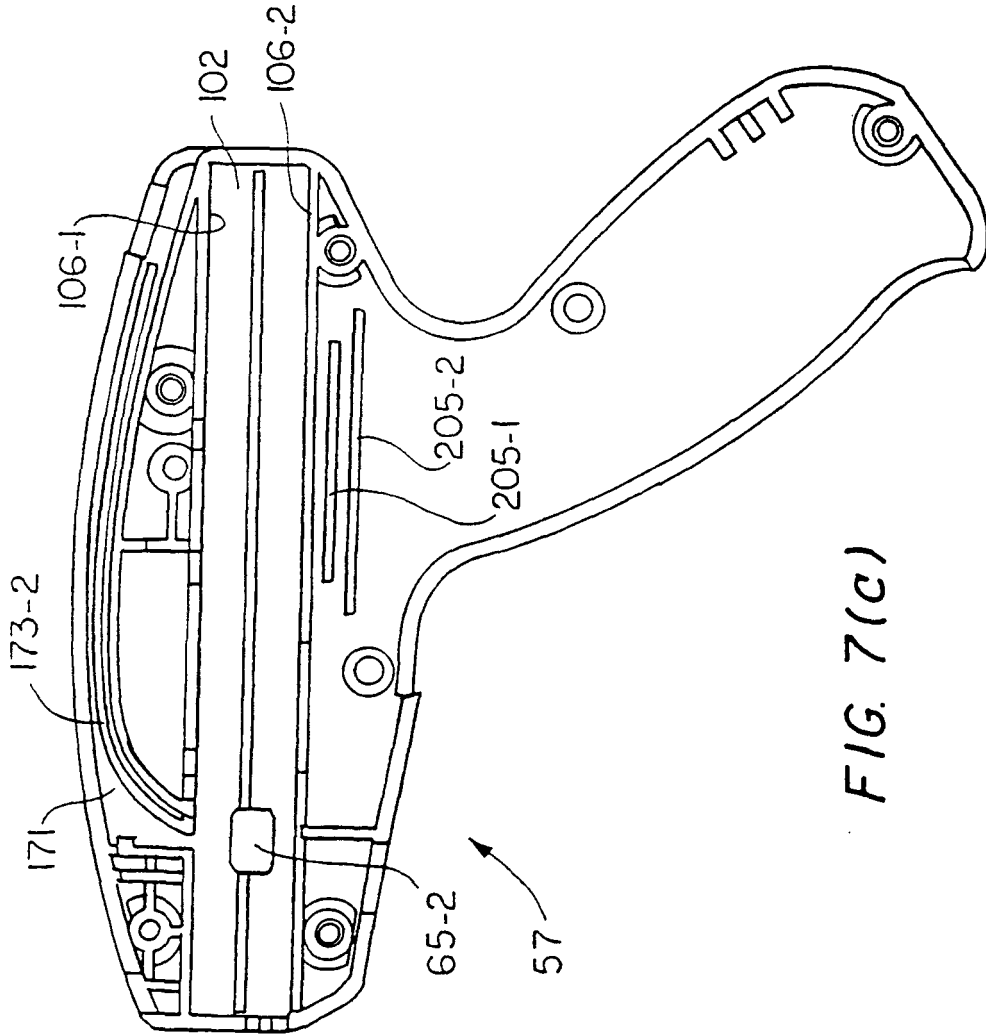

FIG. 7(c)

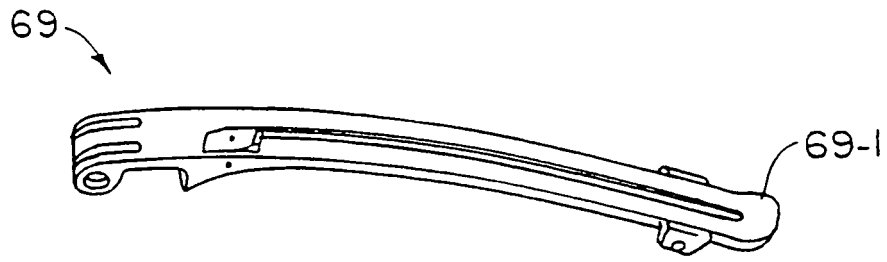

FIG. 8(a)

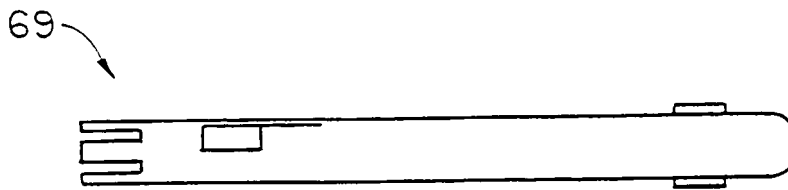

FIG. 8(b)

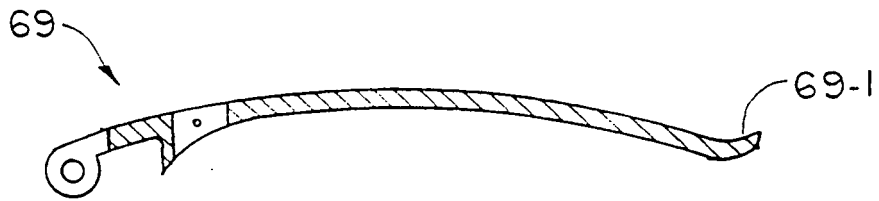

FIG. 8(c)



FIG. 8(d)

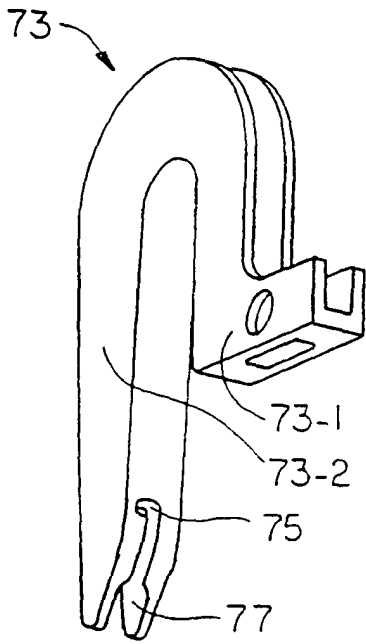

FIG. 9(a)

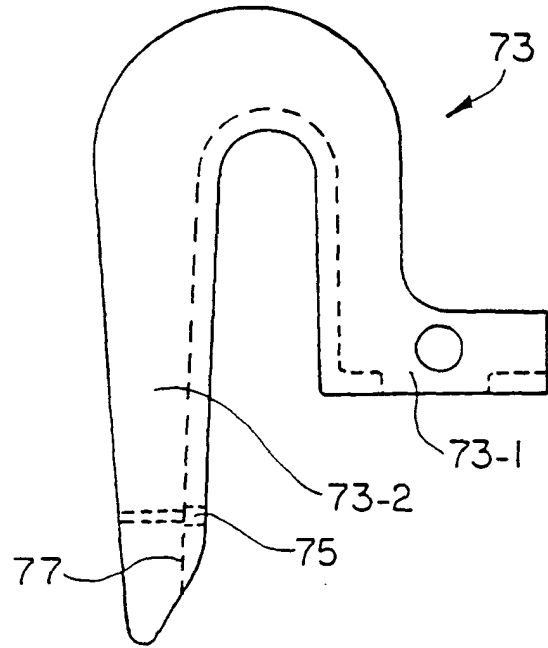

FIG. 9(b)

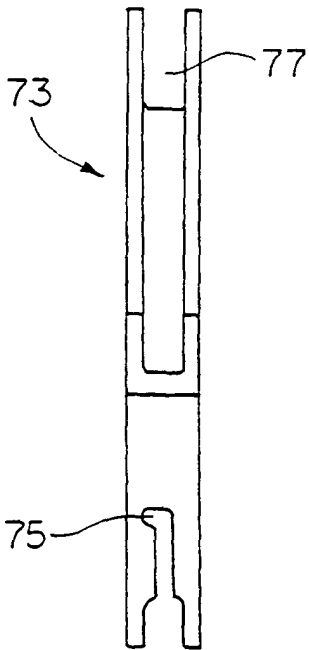

FIG. 9(c)

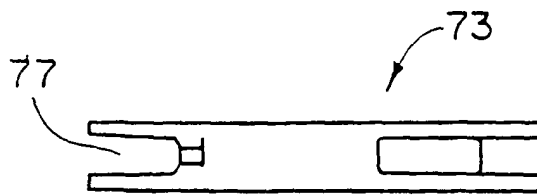

FIG. 9(d)

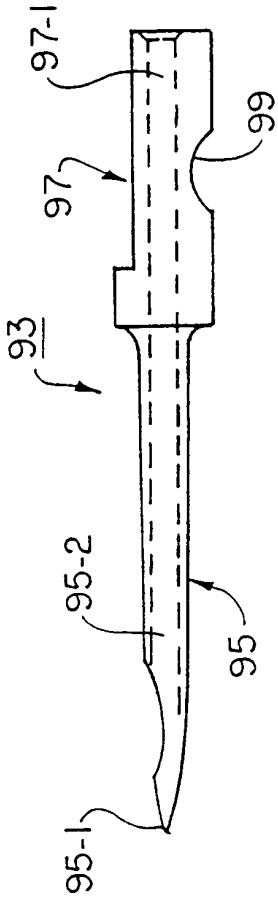

FIG. 10(c)

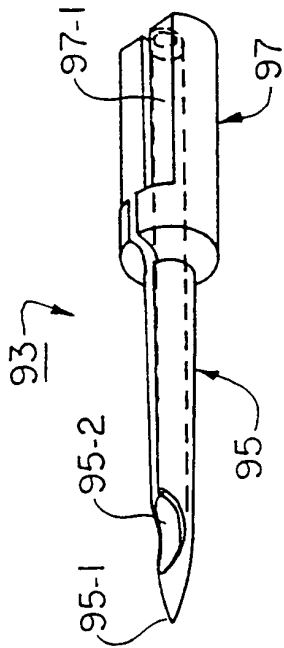

FIG. 10(a)

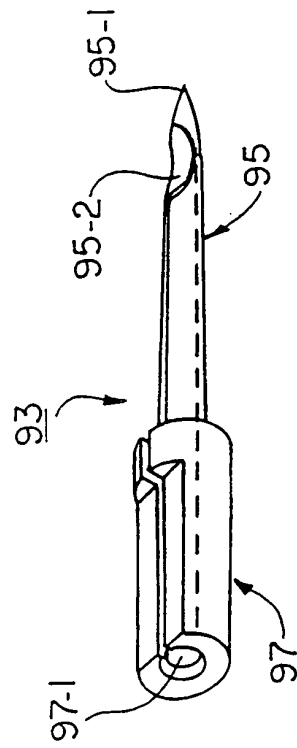

FIG. 10(b)

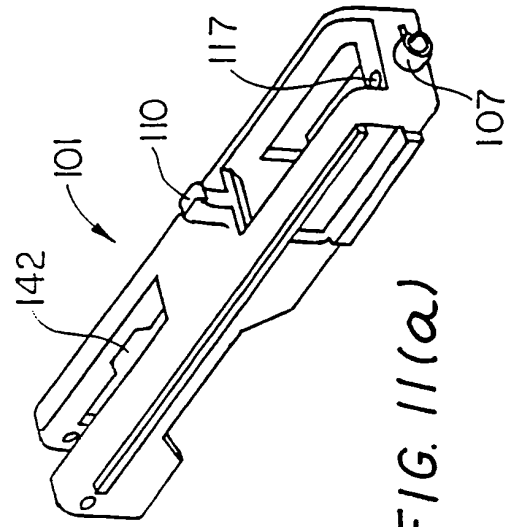

FIG. 11(a)

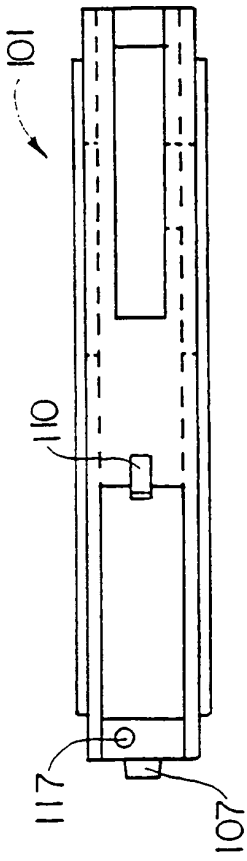

FIG. 11(d)

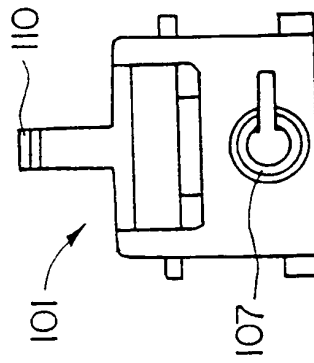

FIG. 11(e)

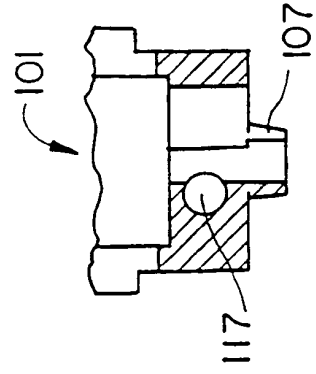

FIG. 11(f)

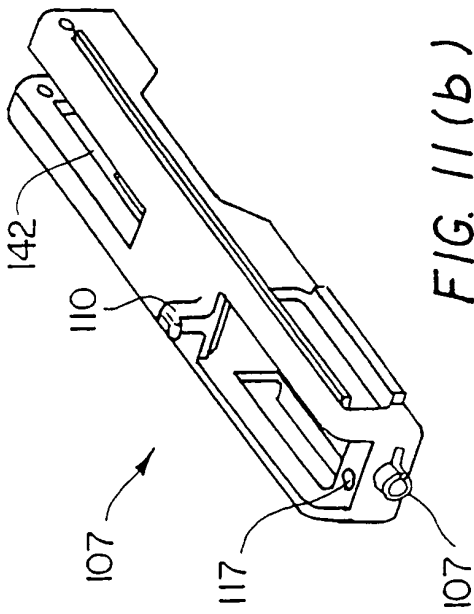

FIG. 11(b)

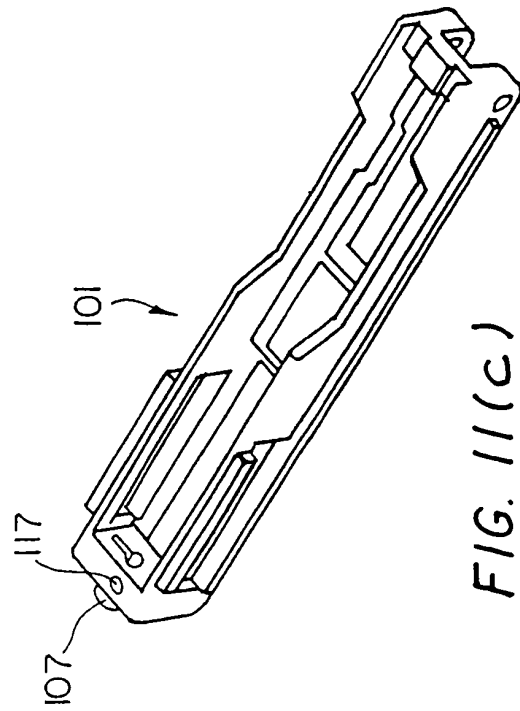

FIG. 11(c)

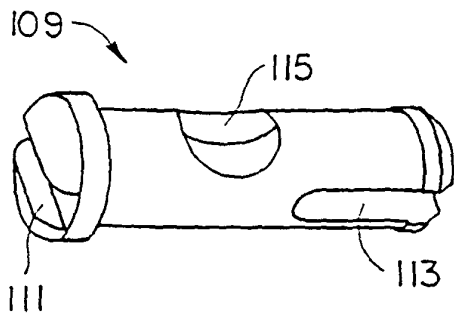

FIG. 12

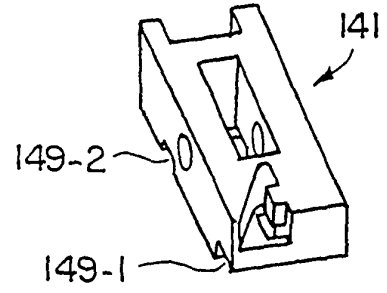

FIG. 14(a)

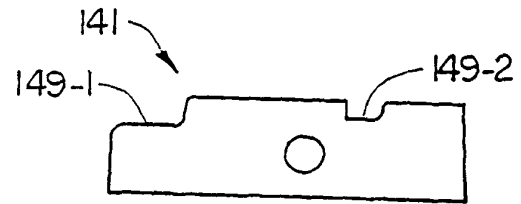

FIG. 14(b)

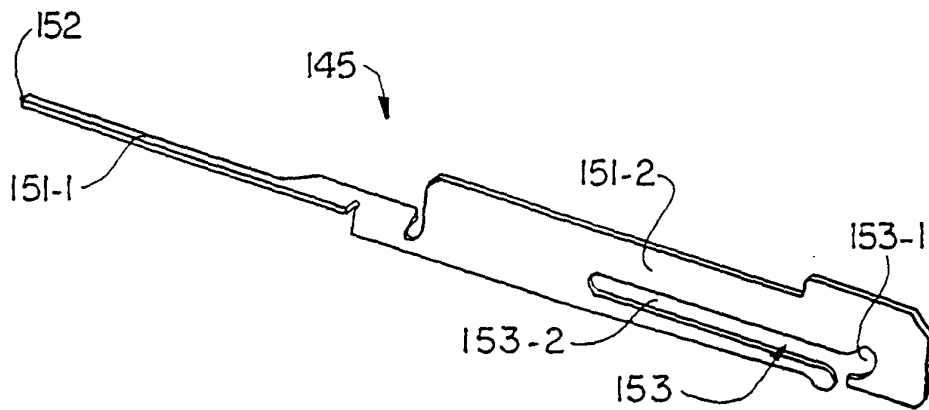

FIG. 15

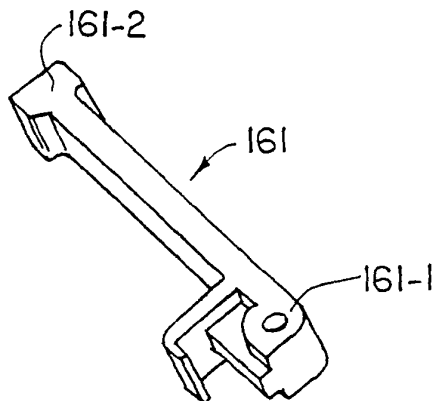

FIG. 16

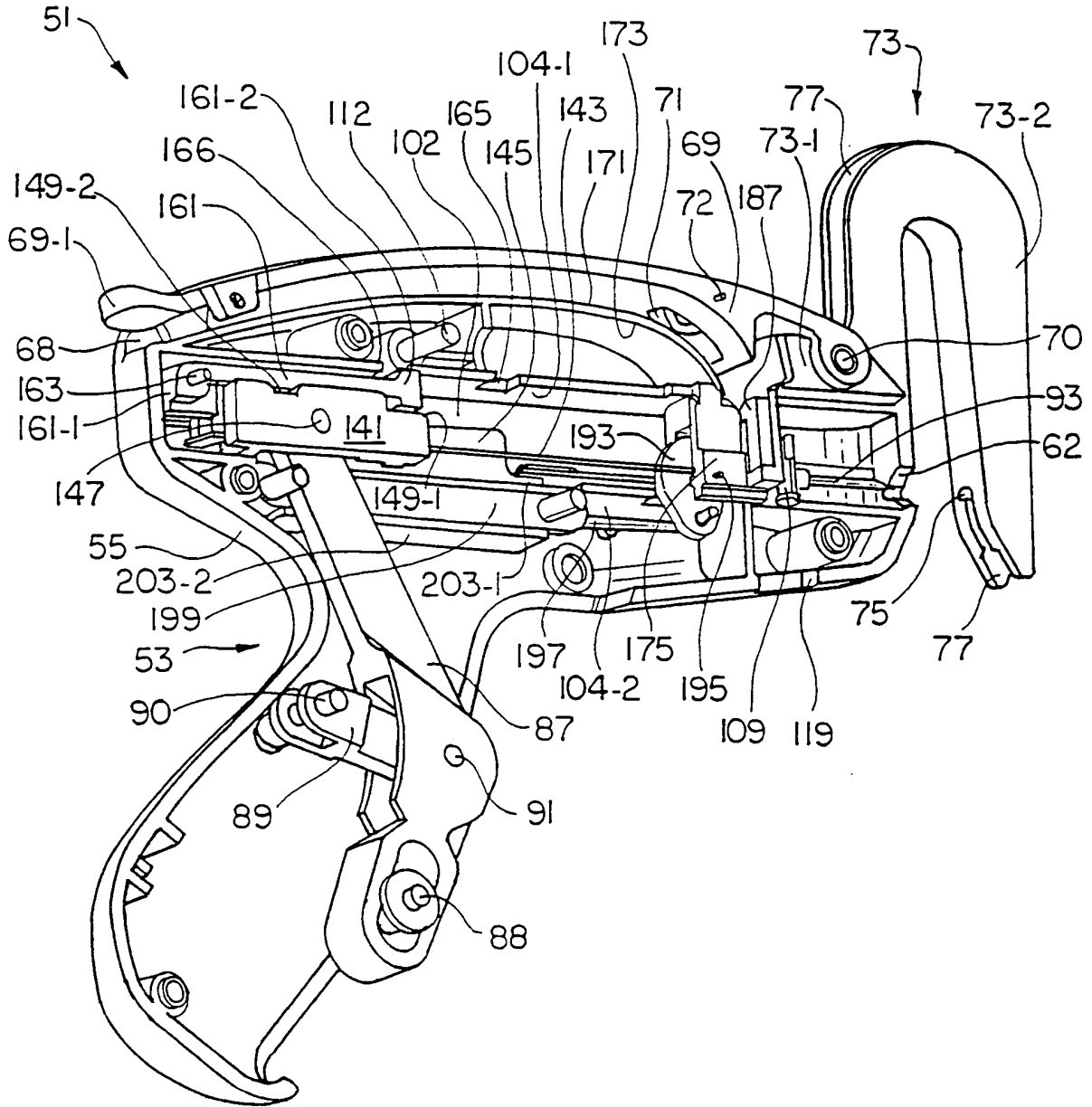

FIG. 13

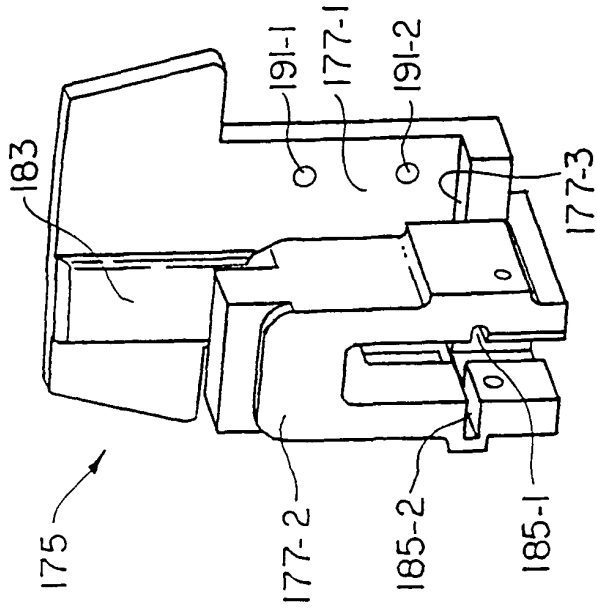

FIG. 17(a)

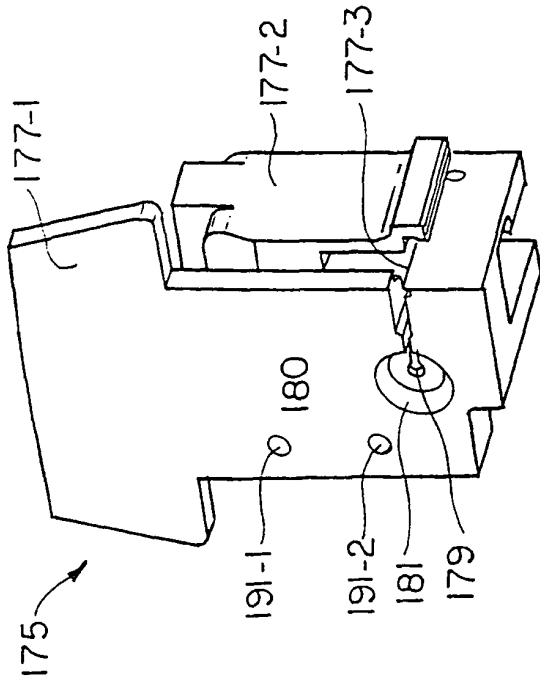

FIG. 17(b)

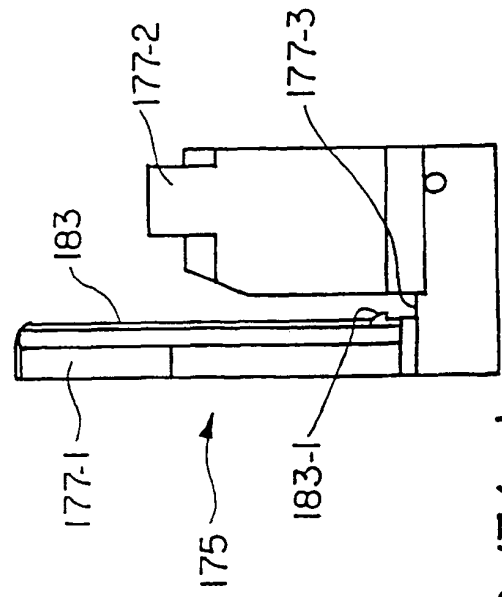

FIG. 17(c)

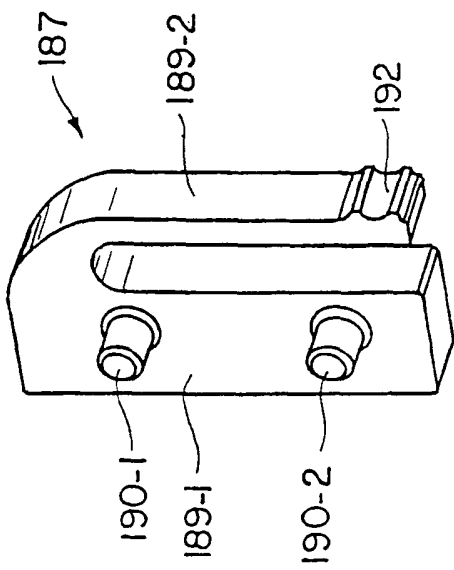

FIG. 18 (a)

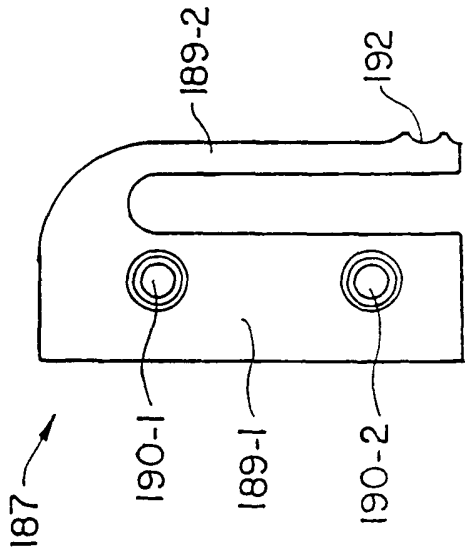

FIG. 18 (b)

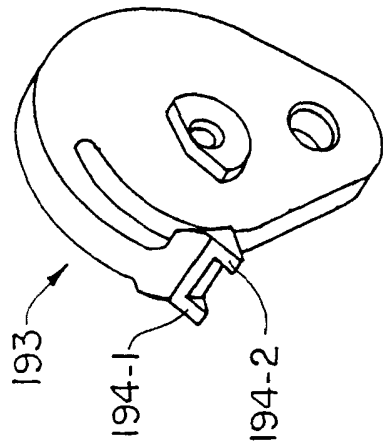

FIG. 19

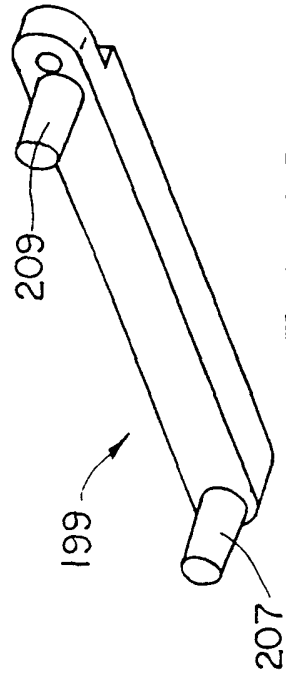

FIG. 20