



(22) **Date de dépôt/Filing Date:** 2017/03/10

(41) **Mise à la disp. pub./Open to Public Insp.:** 2017/09/11

(45) **Date de délivrance/Issue Date:** 2018/08/21

(30) **Priorité/Priority:** 2016/03/11 (US62/306,965)

(51) **Cl.Int./Int.Cl. H02B 11/12** (2006.01)

(72) **Inventeurs/Inventors:**

MECCA, FLORENT, CA;
GADEN, CEDRIC, CA;
BOZONAT, JEAN, CA

(73) **Propriétaire/Owner:**

9088-5625 QUEBEC INC., CA

(74) **Agent:** NORTON ROSE FULBRIGHT CANADA
LLP/S.E.N.C.R.L., S.R.L.

(54) **Titre : SYSTEME DE POSITIONNEMENT DE DISJONCTEURS ET METHODE DE CONNEXION ET DECONNEXION ASSOCIEE**
(54) **Title: CIRCUIT BREAKER POSITIONING SYSTEM AND METHOD FOR CONNECTION AND DISCONNECTION THEREOF**

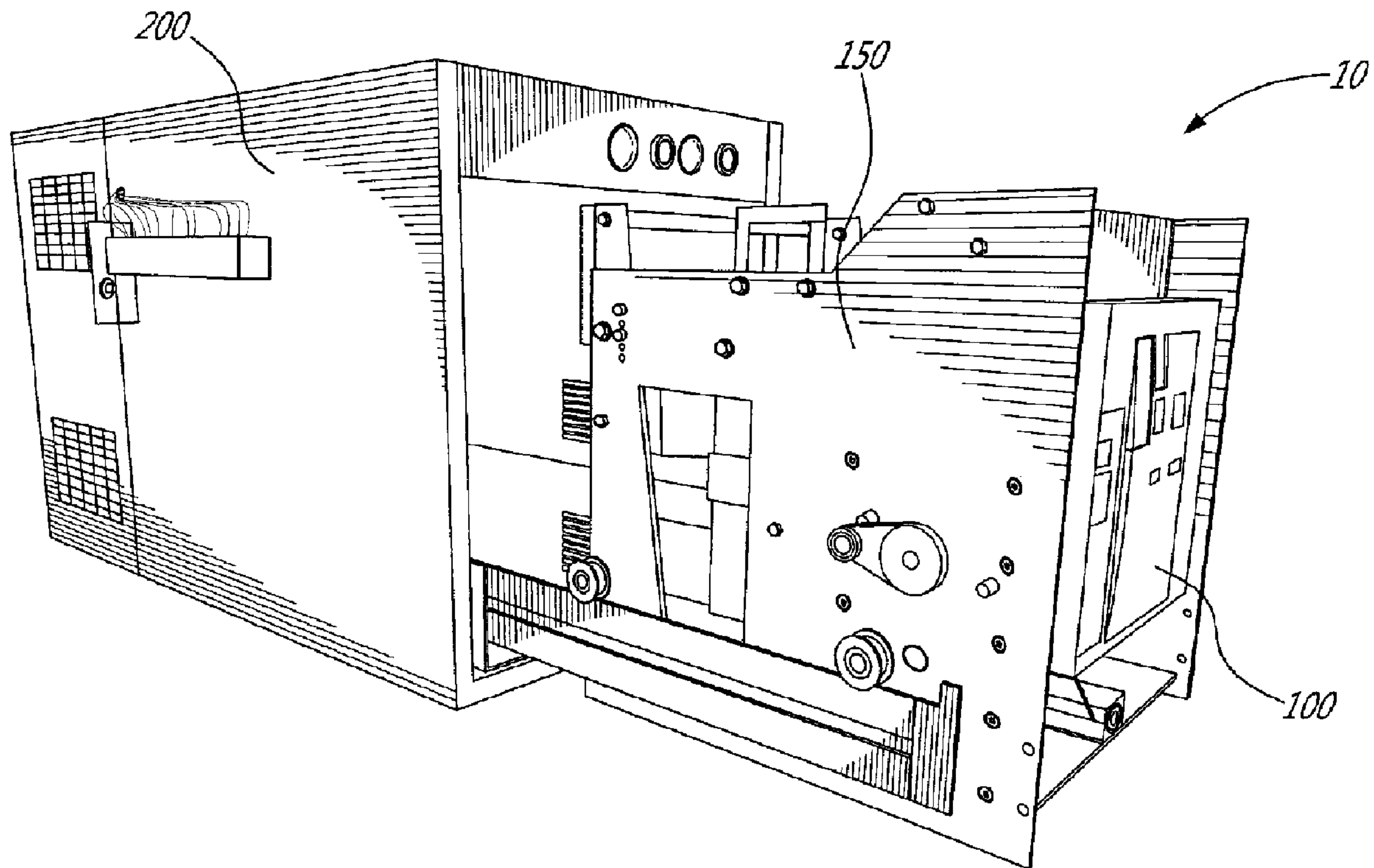

(57) **Abrégé/Abstract:**

The present disclosure relates to a circuit breaker positioning system and method including a circuit breaker casing and circuit breaker cell for connecting and disconnecting a circuit breaker to an external electrical circuit. The circuit breaker positioning system includes a motion system for receiving a rotational force from an external source and translating the rotational force into a displacement of the casing relative to the cell.

55684807-1US

ABSTRACT

The present disclosure relates to a circuit breaker positioning system and method including a circuit breaker casing and circuit breaker cell for connecting and disconnecting a circuit breaker to an external electrical circuit. The circuit
5 breaker positioning system includes a motion system for receiving a rotational force from an external source and translating the rotational force into a displacement of the casing relative to the cell.

55684807-1CA

CIRCUIT BREAKER POSITIONING SYSTEM AND METHOD FOR
CONNECTION AND DISCONNECTION THEREOF

TECHNICAL FIELD

The present disclosure relates generally to circuit breakers, and more
5 specifically to systems for connecting and disconnecting circuit breakers.

BACKGROUND OF THE ART

Commercial- and industrial-type low-voltage circuit breakers may come
in a variety of shapes and sizes, and connecting and disconnecting such circuit
breakers in an external circuit may require more than simply actuating a switch
10 or button. Indeed, in some cases circuit breakers may need to be physically
displaced with respect to connectors in order to be properly and fully connected
or disconnected from the external circuit. This may be done by having movable
connectors which can extend or retract, or by displacing the whole circuit
breaker, to name a few possibilities.

15 In cases where the circuit breaker as a whole is displaced to effect
connection or disconnection, this may be accomplished through manual labor or
by way of a motorized system. While motorized systems may be simpler and
less time consuming to operate, there is an inherent risk of damaging or
destroying connectors of both the circuit breaker and the external circuit if the
20 motorized system displaces the circuit breaker too quickly, or if too great a force
is applied. As such, there is a need for a circuit breaker positioning system
which provides greater control for the connecting and disconnecting of a circuit
breaker to an external circuit

SUMMARY

25 The present disclosure relates to a circuit breaker positioning system
including a circuit breaker casing and circuit breaker cell for connecting and
disconnecting a circuit breaker to an external electrical circuit. The circuit
breaker position system includes a motion system for receiving a rotational
force from an external source and translating the rotational force into a

55684807-1CA

displacement of the casing relative to the cell.

According to a broad aspect, there is provided a circuit breaker positioning system configured for inserting a circuit breaker into a cell, the cell having two or more cell outer walls defining a first aperture and a plurality of
5 connectors linked to an external circuit. The positioning system comprises a casing. The casing comprises two or more casing outer walls defining a second aperture for receiving the circuit breaker, the casing outer walls spaced to be received within the first aperture between the cell outer walls, and a support configured for supporting the circuit breaker within the casing. The position
10 system also comprises a motion system for displacing the casing relative to the cell inside the first aperture between a position P_A where the circuit breaker is disconnected from the external circuit and a position P_B where the circuit breaker is connected to the external circuit via the connectors in the cell. The motion system comprises a gear system having a first end and a second end, a
15 first member in cooperating engagement with the first end of the gear system, and a second member in cooperating engagement with the second end of the gear system, the first member responsive to an external force to rotate about a first axis and engage the gear system to rotate the second member about a second axis, wherein rotation of the second member causes a displacement of
20 the casing and circuit breaker relative to the cell.

According to another broad aspect, there is provided a method for connecting and disconnecting a circuit breaker to an external circuit via a plurality of connectors disposed inside a first aperture defined by a cell having two or more outer cell walls. The method comprises supporting the circuit
25 breaker in a casing, the casing having two or more casing outer walls defining a second aperture for receiving the circuit breaker, applying a rotational force to a first member of a motion system, and translating the rotational force into a displacement of the casing relative to the cell by engaging a gear system via the first member, the gear system in cooperating engagement with a second
30 member, engagement of the gear system causing rotation of the second member, rotation of the second member causing the circuit breaker to move between a position P_A where the circuit breaker is disconnected from the

55684807-1CA

external circuit and a position P_B where the circuit breaker is connected to the external circuit via the connectors in the cell.

BRIEF DESCRIPTION OF THE DRAWINGS

Further features and advantages of the present invention will become
5 apparent from the following detailed description, taken in combination with the appended drawings, in which:

Figure 1 is a perspective view of a circuit breaker with a casing outside a breaker cell.

Figure 2A is an inside perspective view of the breaker cell.

10 Figure 2B is an inside rear view of the breaker cell, showing power and control contacts.

Figure 3A is an inside view of the breaker casing with a motion system.

Figure 3B is a side view of the breaker casing with wheels, a rotating arm, and stoppers.

15 Figure 3C is a side view of the breaker casing with the rotating arm and stoppers.

Figure 4 is a rear-inside view of the breaker cell with the circuit breaker partially inserted.

20 Figure 5 is a front view of the breaker cell with the circuit breaker partially inserted.

Figure 6A-C are stop-motion perspective views of the circuit breaker and breaker casing as the motion system is being driven.

It will be noted that throughout the appended drawings, like features are identified by like reference numerals.

25

55684807-1CA

DETAILED DESCRIPTION

Circuit breakers are widely used in multiple applications for protecting sensitive or valuable circuit components from overloading or short circuits. A circuit breaker is an electrical switch which operates automatically when circuit conditions exceed known safe values or limits. The circuit breaker may comprise any suitable displays and controls required for operation: this may include status indicators, on/off switches, reset buttons, and the like. The circuit breaker may also comprise a plurality of connectors, as will be described herein. While circuit breakers may come in a variety of shapes and sizes, the present disclosure will be illustrated by way of circuit breakers which are substantially box-shaped. Other shapes may also apply.

Actuation of the circuit breaker causes an open-circuit before any sensitive or valuable circuit components are affected, thereby protecting them from the excessive current or voltage from the power source. Circuit breakers used in commercial or industrial applications may only be useable for a given "lifecycle" and may wear down over time. Additionally, in some cases a circuit breaker which trips may need certain components replaced or repaired in order for it to be functional again. Therefore, it may be desirable to have access to the circuit breaker for removing it from the external circuit and/or for replacing the circuit breaker in the external circuit with a new, fully functional circuit breaker.

There is described herein a circuit breaker positioning system to displace the circuit breaker from a first position P_A , where the circuit breaker is disconnected from the external circuit, to a second position P_B , where the circuit breaker is connected to the external circuit, and vice-versa. The circuit breaker may be displaced translationally, for example, or in any other suitable way.

With reference to Figure 1, a circuit breaker positioning system 10 for moving a circuit breaker 100 within a cell 200 is illustrated and comprises a circuit breaker casing 150 and a motion system (illustrated only in part in Figure 1A). The casing 150 has at least two casing outer walls defining a first aperture for receiving the circuit breaker 100, and the cell 200 has at least two cell outer walls defining a second aperture. The casing 150 also has a first support for

55684807-1CA

supporting the circuit breaker 100 within the casing 150, and a second support for supporting the casing 150 within the cell 200 in the second aperture. The first aperture is sized to allow the casing 150 to move relative to the cell 200, and the at least two casing outer walls are parallel to the at least two cell outer walls, defining a space therebetween. The circuit breaker 100 and the casing 150 may be displaced within the cell 200 from the position P_A , where the circuit breaker 100 is disconnected from the external circuit, to the position P_B , where the circuit breaker 100 is connected to the external circuit. The circuit breaker 100 and the casing 150 may also be displaced within the cell 200 from the position P_B to the position P_A to disconnect the circuit breaker 100 from the external circuit.

The distance between the position P_A and the position P_B may be any suitable distance greater than an isolation distance, which is defined as a distance between two electrical contacts sufficient to prevent an electric discharge, such as arcing, to take place between the two electrical contacts. In some embodiments, the isolation distance may be a few centimeters, such as 5 to 10 cm, or any other suitable distance. The circuit breaker positioning system comprises a motion system, for providing relative motion of the casing 150 with respect to the cell 200. The motion system translates a relatively large displacement of a first member at a first end of the motion system resulting from a force applied to the first member, into a relatively small displacement of the casing 150. Displacement of the casing 150 is effected by a second member at a second end of the motion system, which is itself displaced as a result of the force applied to the first member. The second member is engaged with both the cell 200 and the casing 150 in order to move the casing 150 relative to the cell 200.

The motion system also scales the torque produced at the second end of the motion system compared to the torque produced at the first end of the motion system when the force is applied to the first member. The torque experienced by the second member, and by extension the casing 150 and the cell 200, is thus smaller than the torque experienced by the first member. The motion system may comprise a gear system with a plurality of gears having

55684807-1CA

sizes selected to appropriately scale the torque produced at the first end of the motion system to the torque produced at the second end of the motion system for effecting suitable motion of the circuit breaker 100 within the cell 200. Displacement of the circuit breaker 100 between positions P_A and P_B using the
5 circuit breaker positioning system 10 allows for more precise control of the displacement of the circuit breaker 100.

In Figure 1, the circuit breaker 100 is shown as having the casing 150 attached thereto, and being substantially fully outside the aperture defined by the cell 200. In some embodiments, the casing 150 may be affixed to the circuit
10 breaker 100, and both the circuit breaker 100 and the casing 150 may be inserted into the cell 200 together. Other insertion methods, such as first affixing the casing 150 to the cell 200 and inserting the circuit breaker 100 thereafter, are also considered. The casing 150 and cell 200 as illustrated in Figure 1 are for example purposes. Other suitable casings 150 and cells 200 are also
15 considered for embodiments where the circuit breaker 100 is shaped differently. The casing 150 may be fitted to the circuit breaker 100 such that the casing 150 may wrap around at least a portion of the sides of the circuit breaker 100: the casing may be affixed to the circuit breaker 100 directly, or may simply rest against the circuit breaker 100.

20 With reference to Figure 2A-B, the cell 200 may be generally box-shaped and may comprise a number of walls, including the two cell outer walls defining the first aperture in which the casing 150 (and attached circuit breaker 100) is inserted. The cell 200 may also comprise a back wall and a bottom wall. In some embodiments, the cell 200 may also include a top wall and/or a front wall.
25 Any number of these walls may be moveable with respect to the others: for example, in an embodiment, the cell 200 may have a movable front and/or top wall for allowing insertion of the circuit breaker 100 and the casing 150. In another embodiment, the cell 200 may have at least one movable side wall and a movable front wall for allowing insertion of the circuit breaker 100 and the
30 casing 150. Other combinations and embodiments are also considered. The particular dimensioning of the cell 200 may provide a space between the side walls of the cell and the sides or side walls of the casing 150. In some

55684807-1CA

embodiments, the cell 200 may be one of a group of cells 200 stacked or otherwise arranged in a grid-like configuration.

The cell 200 may comprise at least one socket 210 disposed substantially against a respective side wall of the cell 200. The at least one
5 socket 210 may be claw-shaped, such that two vertical projections of differing heights define a recess therebetween, or may take on any other suitable shape. Each of the at least one socket 210 may be attached or otherwise affixed to a respective side rail 230, which may in turn be affixed to a respective side wall of the cell 200, to the bottom wall of the cell 200, or to any other suitable wall of
10 the cell 200. The cell 200 may further comprise a transverse rail 220 disposed between the at least one side rail 230 and being positioned substantially orthogonal thereto.

Thus, in a particular embodiment, the cell 200 may comprise a pair of substantially opposite side walls, and each may have a respective side rail 230
15 to which a respective socket 210 may be affixed. The transverse rail 220 may be disposed between the two side rails 230 in substantially orthogonal fashion thereto.

With reference to Figure 2B, the cell 200 may additionally comprise a plurality of power connectors 240 for supplying power to the circuit breaker 100
20 and a plurality of control connectors 250 for establishing communication links between the circuit breaker 100 and the external circuit. The connectors 240, 250 may be positioned along the back wall of the cell 200, or along any other suitable wall of the cell 200. While Figure 2B shows the connectors 240, 250 as being male connectors, it should be noted that other embodiments of the cell
25 200 may feature female connectors 240, 250, or any suitable combination of male and female connectors 240, 250. Additionally, the particular orientation and setup of the connectors 240, 250 may vary from one embodiment of the cell 200 to another. The connectors 240, 250 may be any suitable kind of connector, including post connectors, plug or socket connectors, blade connectors, ring or
30 spade terminal connectors, or any other suitable type of connector. In some embodiments, the connectors 240, 250 may be keyed connectors.

55684807-1CA

With reference to Figure 3A, there is illustrated an example embodiment of the motion system 300. The motion system has a first portion mounted inside the casing and a second portion mounted in the space defined between the at least two casing outer walls and the at least two cell outer walls. The first portion comprises a gear system and a first member in cooperating engagement with the gear system. The second portion comprises a second member in cooperating engagement with the gear system. The first member is rotatable about a first axis and engages the gear system to rotate the second member about a second axis, wherein rotation of the second member displaces the casing relative to the cell inside the first aperture. In the embodiment illustrated, the first member comprises first and second drive shafts 310, 320. A knob or socket 308 attached to the first drive shaft 310 may be disposed for receiving a force from an external source. The first drive shaft 310 may be held within a holder 312 (which may be affixed to the bottom wall of the casing 150). The first drive shaft may be free to rotate both clockwise and counterclockwise within the holder 312. The first drive shaft 310 may also include an endless screw portion 314 disposed thereon which may rotate with the first drive shaft 310. The endless screw portion 314 may comprise any suitable number of threads having any suitable lead and pitch.

The second drive shaft 320 may be disposed orthogonally to the first drive shaft 310, and may extend from one side wall of the casing 150 to the other side wall. The second drive shaft 320 may comprise a gear portion 322, which may be configured for mating with the endless screw portion 314 of the first drive shaft 310, which may cause torque from the first drive shaft 310 to be transferred to the second drive shaft 320.

Though the motion system 300 is described as having two drive shafts 310, 320, other embodiments may make use of more drive shafts, as may be suitable to a particular embodiment. The drive shafts 310, 320, as well as the holder 312, may be of any suitable length and may be made of any suitable material, including steel, iron, aluminum, titanium, and the like. In some embodiments, a single drive shaft may be used.

55684807-1CA

The first portion of the motion system 300 may further comprise a gear system 330 comprising at least one gear. Each gear of the gear system 300 may be disposed along a respective casing outer wall, and at least one of the gears may be mechanically coupled to the second drive shaft 320. Thus, the torque of the second drive shaft 320 may be transferred to the gear system 330. Additionally, at least one gear of the gear system 330 may be mechanically coupled to a respective second member of the motion system, which may be disposed on a respective casing outer wall. A corresponding gear system 330 and second member may be disposed on opposing faces of a casing outer wall, and may be mechanically coupled through the casing outer wall in any suitable fashion, such as through an axle 332.

In the embodiment shown in Figure 3A, the gear system 330 comprises three gears: a first gear mechanically coupled to the second drive shaft 320, a second gear mechanically coupled to a respective second member through the axle 332, and a third gear disposed therebetween. It should be noted that the gear system 330 may include any suitable number of gears, including any number of gears required for both adjusting the torque and/or rotational speed of the rotating arm 170 and for setting a desired relationship between a direction of rotation of the external source and a direction of rotation of the rotating arm 170. Additionally, while the gear system 330 shown in Figure 3A has three gears with substantially aligned respective axes of rotation, in other embodiments the gears of the gear system 330 may be disposed in any suitable fashion. Put differently, the gear system 330 may comprise any suitable number of gears, of any suitable size, positioned in any suitable fashion, for scaling the torque applied by the external force to a torque suitable for causing motion of the second member for displacing the casing 150 within the cell 200, and for scaling the substantially larger torque experienced by the first member to a substantially smaller torque, namely that experienced by the second member.

The motion system 300 may, as described hereinabove, translate or scale the torque applied to the first member, or more specifically the first drive shaft 310, to a smaller torque, which is applied to the second member. This scaling may be accomplished by the gear system 330, as well as by the

55684807-1CA

interconnection between the first drive shaft 310 and the second drive shaft 320, as variations in the pitch and lead of the endless screw portion 314 and the gear portion 322, as well as the respective radii of the first and second drive shafts 310, 320, may also effect a scaling of the torque. Additionally, the motion system 330 may translate a substantially larger displacement effected by an external source into a substantially smaller displacement, namely the displacement of the second member, described in greater detail hereinbelow.

Additionally, while the present disclosure discusses the use of an endless screw portion 314 on the first drive shaft 310 coupled to a gear portion 322 on the second drive shaft 320, other embodiments of the motion system may use a converse system, whereby the first drive shaft 310 comprises a gear portion and the second drive shaft 320 comprises an endless screw portion. Still further embodiments may transfer the torque from the first drive shaft 310 to the second drive shaft 320 by other means, such as via bevel gears, or any other suitable mechanical system.

With reference to Figure 3B, the circuit breaker casing 150 may be configured for being affixed to the circuit breaker 100, as discussed hereinabove. The casing 150 may comprise the pair of casing outer walls defining the second aperture for receiving the circuit breaker 100. The casing outer walls may be linked in any suitable way, including by a front wall portion, a bottom wall portion, a rear wall portion, or any combination thereof, which may combine to provide a base for supporting the circuit breaker 100 within the casing 150 when inserted into the second aperture. Alternatively, or in addition, the casing 150 may be affixed to the circuit breaker 100 in any suitable fashion, which may also provide support for the circuit breaker 100 within the casing 150.

The casing 150 further comprises the second support for supporting the casing 150 within the cell 200 in the first aperture, which may comprise at least one wheel 160 disposed on the side wall of the casing 150 and being configured for rolling along the side rail 230 of the cell 200. This allows the casing 150 and the circuit breaker 100 to be rolled along the side rails 230 for

55684807-1CA

displacing the casing 150 and the circuit breaker 100 relative to the cell 200. The at least one wheel 160 may be any suitable wheel of any suitable size and made of any suitable material. Additionally, while Figure 3B shows two wheels 160 being disposed asymmetrically along the side walls of the casing 150, in
5 alternative embodiments the casing 150 may comprise any suitable number of wheels 160 disposed in any suitable fashion.

With additional reference to Figure 3C, the casing 150 may further support the second member of the motion system 300, which may be at least one rotating arm 170, though other implementations of the second member are
10 also considered. The rotating arm 170 may be disposed along a respective casing outer wall in the space between the casing outer wall and the cell outer wall. In some embodiments, only one such rotating arm 170 may be provided, whereas in other embodiments each casing outer wall may have a respective rotating arm 170. The motion system 300 may comprise an equal number of
15 gear systems 330 as of rotating arms 170. The rotating arm 170 may have any suitable shape and size. In the embodiment illustrated in Figure 3C, the rotating arm 170 is pear-shaped with a knob 172 disposed at a distal end of the rotating arm 170, though other shapes and configurations are also considered. The knob 172 may be a projection extending from a surface of the rotating arm 170
20 and may be circular, or may be square, triangular, or any other suitable shape. The rotating arm 170 may rotate about an axis 171, which may be located in a central portion of the rotating arm 170, or in any other suitable location.

The casing 150 may also comprise at least one pair of stoppers 174 disposed on a respective side wall of the casing 150. The casing 150 may
25 comprise as many pairs of stoppers 174 as the number of rotating arms 170. Thus, in an embodiment where each side wall of the casing 150 comprises a respective rotating arm 170, each side wall may further comprise a respective pair of stoppers 174. The stoppers 174 may be projections disposed to contact with the rotating arm 170 so as to limit the rotational movement of the rotating
30 arm 170 to a given arc, or to a position along an arc. The stoppers 174 thus confine the movement of the rotating arm 170 to a given arc determined by the positioning of the stoppers 174.

55684807-1CA

The rotating arm 170 may travel from a first position, where the rotating arm 170 is in contact with a first stopper 174 along an arc to a second position, where the rotating arm 170 is in contact with a second stopper 174 different from the first stopper 174. In some embodiments, the arc travelled by the rotating arm 170 may be 180°; in other embodiments, the arc travelled may be more than 180°, or less than 180°. The stoppers 174 may thus be disposed to allow the rotating arm 170 to travel any suitable arc distance.

With reference to Figure 4, an inside view of cell 200 with the circuit breaker 100 partially inserted is shown. In this particular embodiment, with the circuit breaker 100 partially inserted, a rear portion of the circuit breaker 100 is visible. The circuit breaker 100 may comprise a plurality of breaker connectors 110 disposed on the rear portion of the circuit breaker 100 which allow the circuit breaker 100 to connect to an external circuit. The particular configuration and design of the breaker connectors 110 may vary: while Figure 4 shows the breaker connectors 240 as being female connectors, it should be noted that other embodiments of the circuit breaker 100 may feature female breaker connectors 110, or any suitable combination of male and female breaker connectors 110. Additionally, the particular orientation and setup of the breaker connectors 110 may vary from one embodiment of the circuit breaker 100 to another. The breaker connectors 110 may be any suitable kind of connector, including post connectors, plug or socket connectors, blade connectors, ring or spade terminal connectors, or any other suitable type of connector. In some embodiments, the breaker connectors 110 may be keyed connectors. Generally speaking, the cell connectors 240 and the breaker connectors 110 should be complementary, allowing for the circuit breaker 100 to be connected into an external circuit by contacting the breaker connectors 110 with the cell connectors 240.

As stated hereinabove, the circuit breaker 100 may be any suitable circuit breaker, and may be rated for any suitable voltages, currents, and power requirements.

With reference to Figure 5, the circuit breaker positioning system 10 is

55684807-1CA

configured for receiving a rotational force from an external source. For example, the first drive shaft 310 may be configured for receiving a rotational force from an external source 400, which may be any suitable source of rotational force, including a drill as pictured in Figure 5. Of course, in other embodiments the external source may be another source of rotational force, including a crank, lever, or other simple machine which may be powered by manual labor, or any suitable motorized source. The external source 400 may provide the rotational force as either a clockwise or counterclockwise rotation. Clockwise rotation may be for connecting the circuit breaker 100 to the external circuit, and counterclockwise rotation may be for disconnecting the circuit breaker 100, or vice-versa.

Figures 6A-C are stop-motion illustrations of the circuit breaker positioning system 10 as the motion system 300 is being driven by the external force 400. For the purposes of illustration, the circuit breaker 100 and the casing 150 are not fully inserted into the cell 200 – this allows for the motion of the rotating arm 170 to be visible as the external source 400 applies the rotational force to the first drive shaft 310.

In Figure 6A, the rotating arm 710 is at a first position 17_1 and the knob 172 of the rotating arm 170 is located at a position proximate a first stopper 174. Were the circuit breaker 100 and the casing 150 inserted in the cell 200, the circuit breaker 100 may be at the position P_A , i.e. disconnected from the external circuit.

In Figure 6B, as the force is applied by the external source 400, the rotating arm 170 rotates along an arc to a second position 17_2 , with the position of the knob 172 being between the first and second stoppers 174 – here, the circuit breaker may be in a test position P_T between positions P_A and P_B . At position P_T , a first subset of the breaker connectors 110 is in contact with the control connectors 250 and a second subset of the breaker connectors 110 is not yet in contact with the power connectors 240. When the circuit breaker 100 is in the position P_T , the control connectors 250 and the first subset of the breaker connectors 110 may be configured for exchanging information, such as

55684807-1CA

information on the type and rating of the circuit breaker 100, an identifier of the external circuit, and the like. Additionally, a position indicator (not pictured) on the cell 200 may be configured for tracking the position of the circuit breaker 100, and may indicate that the circuit breaker 100 is in the position P_T once the control connectors 250 and the first subset of the breaker connectors 110 are connected. The position indicator may be an indicator light, a screen, a mechanical indicator, or any other suitable visible or audible indicator.

In Figure 6C, as further force is applied by the external source 400, the rotating arm 170 rotates further along the arc to a third position 17_3 , where the knob 172 is located proximate the second stopper 174. Were the circuit breaker 100 and the casing 150 inserted in the cell 200, the circuit breaker 100 may be at the position P_B . In the position P_B , the first subset of the breaker connectors 110 is in contact with the control connectors 250, and the second subset of the breaker connectors 110 is in contact with the power connectors 240. In the position P_B , the circuit breaker 100 is connected to the external circuit.

In some embodiments, the position indicator may also be configured for indicating whether the circuit breaker 100 is in the position P_A and/or the position P_B . The position indicator may, for example, interpret no connection between the breaker connectors 110 and the connectors 240, 250, as the circuit breaker being in position P_A , and may further interpret both subsets of the breaker connectors 110 being connected to the connectors 240, 250, respectively, as the circuit breaker 100 being in position P_B . In some embodiments, the circuit breaker positioning system 10 may also include a safety mechanism. The safety mechanism may be configured for triggering the circuit breaker 100 to enter an open state responsive to the application of a force by the external source 400 to move the circuit breaker 100 from the position P_B . For example, the safety mechanism may be a mechanical or electrical component which is only active when the circuit breaker is in the position P_B . Upon detecting a force applied by the external source 400, the safety mechanism may automatically trigger the circuit breaker 100 to enter an open state.

55684807-1CA

When the circuit breaker 100 and casing 150 are fully inserted into the cell 200, the knob 172 may be positioned within the socket 210 of the cell 200. The socket 210 may be configured for receiving the knob 172 in the recessed portion thereof, thereby substantially imprisoning the knob 172 therein. When
5 the circuit breaker 100 and casing 150 are so positioned, movement of the rotating arm 170 caused by the rotational force applied by the external source 400 may cause the circuit breaker 100 and casing 150 to effect a translational motion within the cell 200 for connecting or disconnecting the circuit breaker
10 100 from the external circuit. The rotational force may cause the rotating arm 170 to push against one of the projections of the socket 210 which in turn may cause the circuit breaker 100 and casing 150 to move in a direction substantially opposite the force applied by the rotating arm on the socket 210. In this way, the rotational force applied by the external source 400 may cause the circuit breaker 100 to connect to or disconnect from the external circuit.

15 The above description is meant to be exemplary only, and one skilled in the relevant arts will recognize that changes may be made to the embodiments described without departing from the scope of the invention disclosed. For example, the blocks and/or operations in the flowcharts and drawings described herein are for purposes of example only. There may be many variations to
20 these blocks and/or operations without departing from the teachings of the present disclosure. For instance, the blocks may be performed in a differing order, or blocks may be added, deleted, or modified. The structure illustrated is thus provided for efficiency of teaching the present embodiment. The present disclosure may be embodied in other specific forms without departing from the
25 subject matter of the claims. Also, one skilled in the relevant arts will appreciate that while the systems and methods disclosed and shown herein may comprise a specific number of elements/components, the systems and methods may be modified to include additional or fewer of such elements/components. The present disclosure is also intended to cover and embrace all suitable changes in
30 technology. Modifications which fall within the scope of the present invention will be apparent to those skilled in the art, in light of a review of this disclosure, and such modifications are intended to fall within the appended claims.

55684807-1CA

CLAIMS:

1. A circuit breaker positioning system configured for inserting a circuit breaker into a cell, the cell having at least two cell outer walls defining a first aperture and a plurality of connectors linked to an external circuit, the positioning system
5 comprising:
 a casing comprising:
 at least two casing outer walls defining a second aperture for receiving the circuit breaker, the at least two casing outer walls spaced to be received within the first aperture between the at least two cell outer
10 walls; and
 a first support configured for supporting the circuit breaker within the casing; and
 a motion system for displacing the casing relative to the cell inside the first aperture between a position P_A where the circuit breaker is disconnected
15 from the external circuit and a position P_B where the circuit breaker is connected to the external circuit via the connectors in the cell, the motion system comprising:
 a gear system having a first end and a second end;
 a first member in cooperating engagement with the first end of the
20 gear system; and
 a second member in cooperating engagement with the second end of the gear system, the first member responsive to an external force to rotate about a first axis and engage the gear system to rotate the second member about a second axis, wherein rotation of the second
25 member causes a displacement of the casing and circuit breaker relative to the cell.
2. The system of claim 1, wherein the casing comprises a second support configured for supporting the casing within the cell.
- 30 3. The system of claim 2, wherein the second support comprises at least one wheel disposed on each one of the at least two casing side walls and configured for rolling along a side rail of the cell.

55684807-1CA

4. The system of any one of claims 1 to 3, wherein the first member comprises:
a first drive shaft held within a holder and free to rotate both clockwise and counterclockwise within the holder;
a second drive shaft disposed orthogonally to the first drive shaft, the
5 second drive shaft mechanically coupled to the first end of the gear system; and
an endless screw portion and a gear portion matingly engaged and disposed on the first drive shaft and the second drive shaft, for translating a torque applied to the first drive shaft towards the second drive shaft.
- 10 5. The system of any one of claims 1 to 4, wherein the gear system comprises at least three cooperating gears of increasing size, a smallest one of the gears at the first end of the gear system and a largest one of the gears at the second end of the gear system.
- 15 6. The system of any one of claims 1 to 5, wherein the second member comprises a rotating arm having a first end mechanically coupled to the second end of the gear system and a second end engaged with the casing.
- 20 7. The system of claim 6, wherein the rotating arm is disposed on a first side of one of the at least two casing outer walls, and the gear system is disposed on a second and opposite side of the one of the at least two casing outer walls, the first side facing one of the at least two cell outer walls.
8. The system of claims 6 or 7, wherein the second member further comprises a pair of stoppers to confine movement of the rotating arm along a displacement path.
- 25 9. The system of any one of claims 1 to 8, further comprising a safety mechanism configured for triggering the circuit breaker to enter an open state in response to displacement of the circuit breaker from the position P_B .
- 30 10. The system of any one of claims 1 to 9, wherein the second member engages at least one of the at least two cell outer walls and rotational movement of the second member effects a translational motion of the casing and circuit breaker within the cell.

55684807-1CA

11. A method for connecting and disconnecting a circuit breaker to an external circuit via a plurality of connectors disposed inside a first aperture defined by a cell having at least two outer cell walls, the method comprising:
- supporting the circuit breaker in a casing, the casing having at least two
 - 5 casing outer walls defining a second aperture for receiving the circuit breaker;
 - applying a rotational force to a first member of a motion system; and
 - translating the rotational force into a displacement of the casing relative to the cell by engaging a gear system via the first member, the gear system in cooperating engagement with a second member, engagement of the gear
 - 10 system causing rotation of the second member, rotation of the second member causing the circuit breaker to move between a position P_A where the circuit breaker is disconnected from the external circuit and a position P_B where the circuit breaker is connected to the external circuit via the connectors in the cell.
12. The method of claim 11, wherein translating the rotational force into a displacement of the casing relative to the cell comprises applying a translational movement of the casing and circuit breaker within the cell in response to rotational movement of the second member.
13. The method of claim 12, wherein applying the translational movement comprises rolling the casing and circuit breaker along side rails of the cell.
14. The method of any one of claims 11 to 13, wherein the second member is at a first position when the circuit breaker is at position P_A and at a second position
- 25 when the circuit breaker is at position P_B .
15. The method of claim 14, wherein a pair of stoppers confine movement of the rotating arm along a displacement path between the first position and the second position.
- 30 16. The method of any one of claims 11 to 15, wherein a position P_T between positions P_A and P_B corresponds to a test position, where a first subset of the

55684807-1CA

plurality of connectors are in contact with the circuit breaker and a second subset of the plurality of connectors are not in contact with the circuit breaker.

17. The method of any one of claims 11 to 16, wherein a position indicator
5 tracks the displacement of the circuit breaker between positions P_A and P_B and displays a corresponding position.

18. The method of any one of claims 11 to 17, wherein supporting the circuit
breaker in the casing comprises affixing the circuit breaker to the casing and
10 inserting the circuit breaker and the casing together into the cell.

19. The method of any one of claims 11 to 18, wherein the first member
comprises:

a first drive shaft held within a holder and free to rotate both clockwise
15 and counterclockwise within the holder;

a second drive shaft disposed orthogonally to the first drive shaft, the
second drive shaft mechanically coupled to the gear system; and

an endless screw portion and a gear portion matingly engaged and
disposed on the first drive shaft and the second drive shaft, for translating a
20 torque applied to the first drive shaft towards the second drive shaft.

20. The method of any one of claims 11 to 19, wherein the gear system
comprises at least three cooperating gears of increasing size, a smallest one of
the gears mechanically coupled to the first member and a largest one of the
25 gears mechanically coupled to the second member.

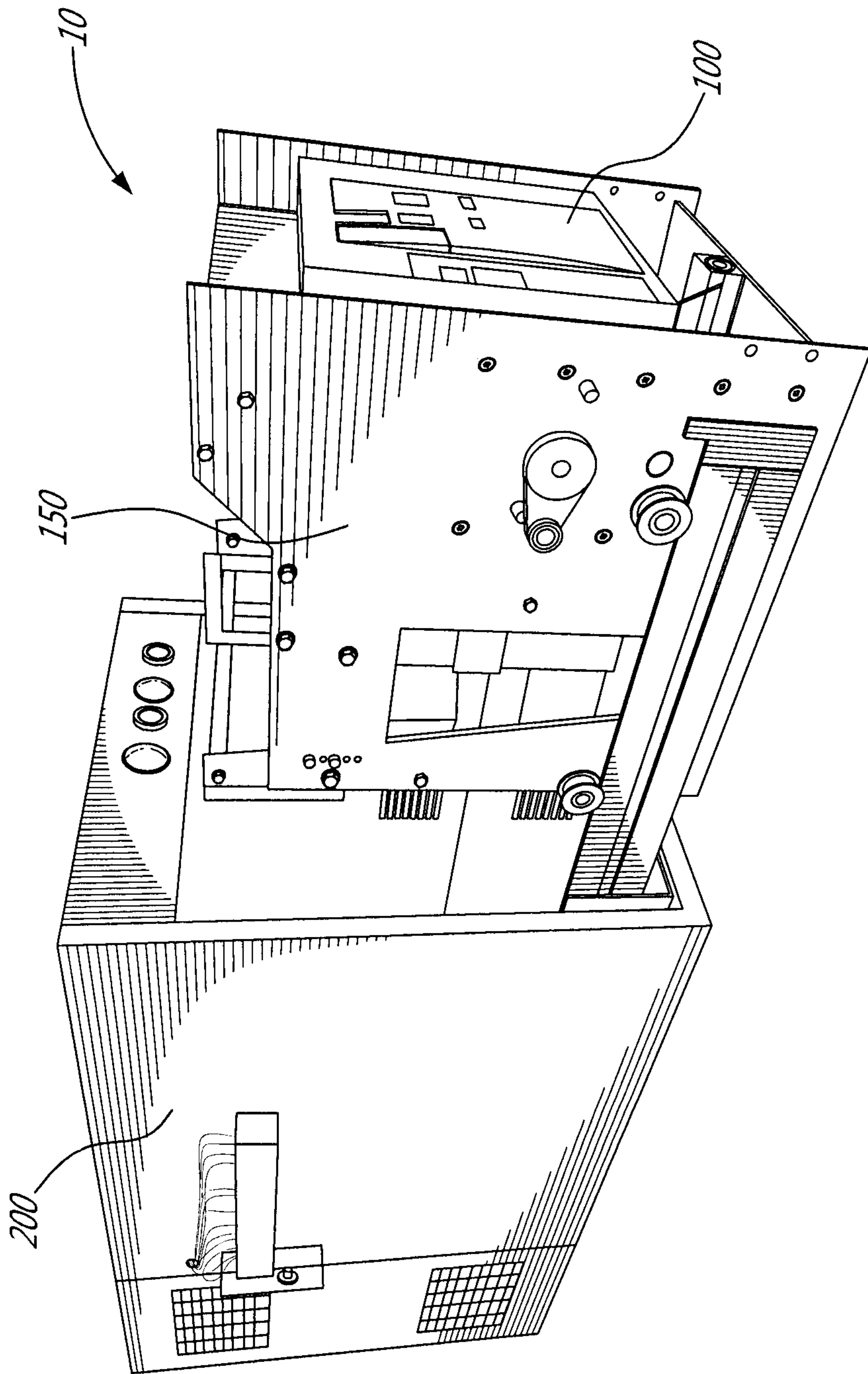

FIG. 1

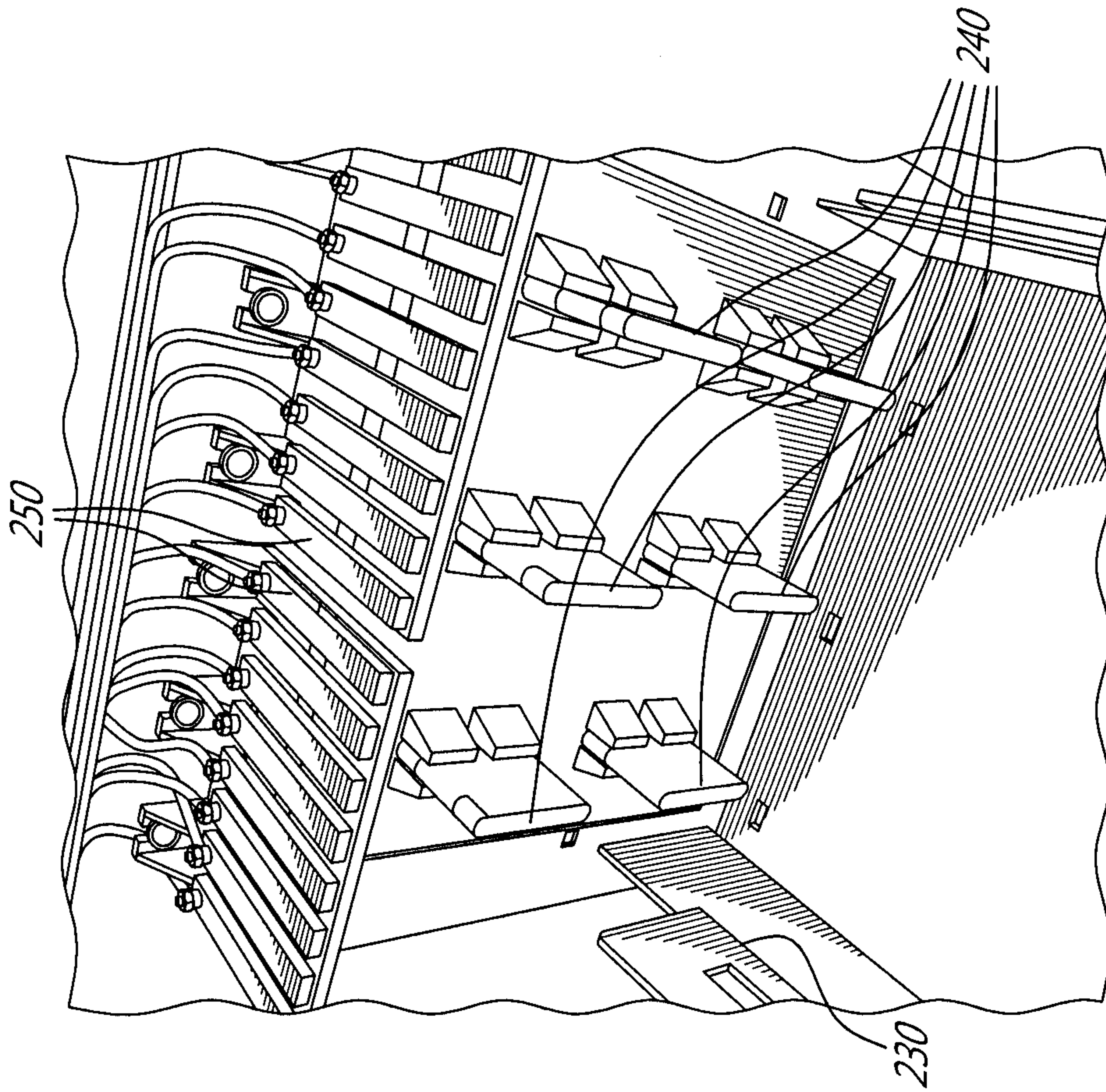

FIG. 2B

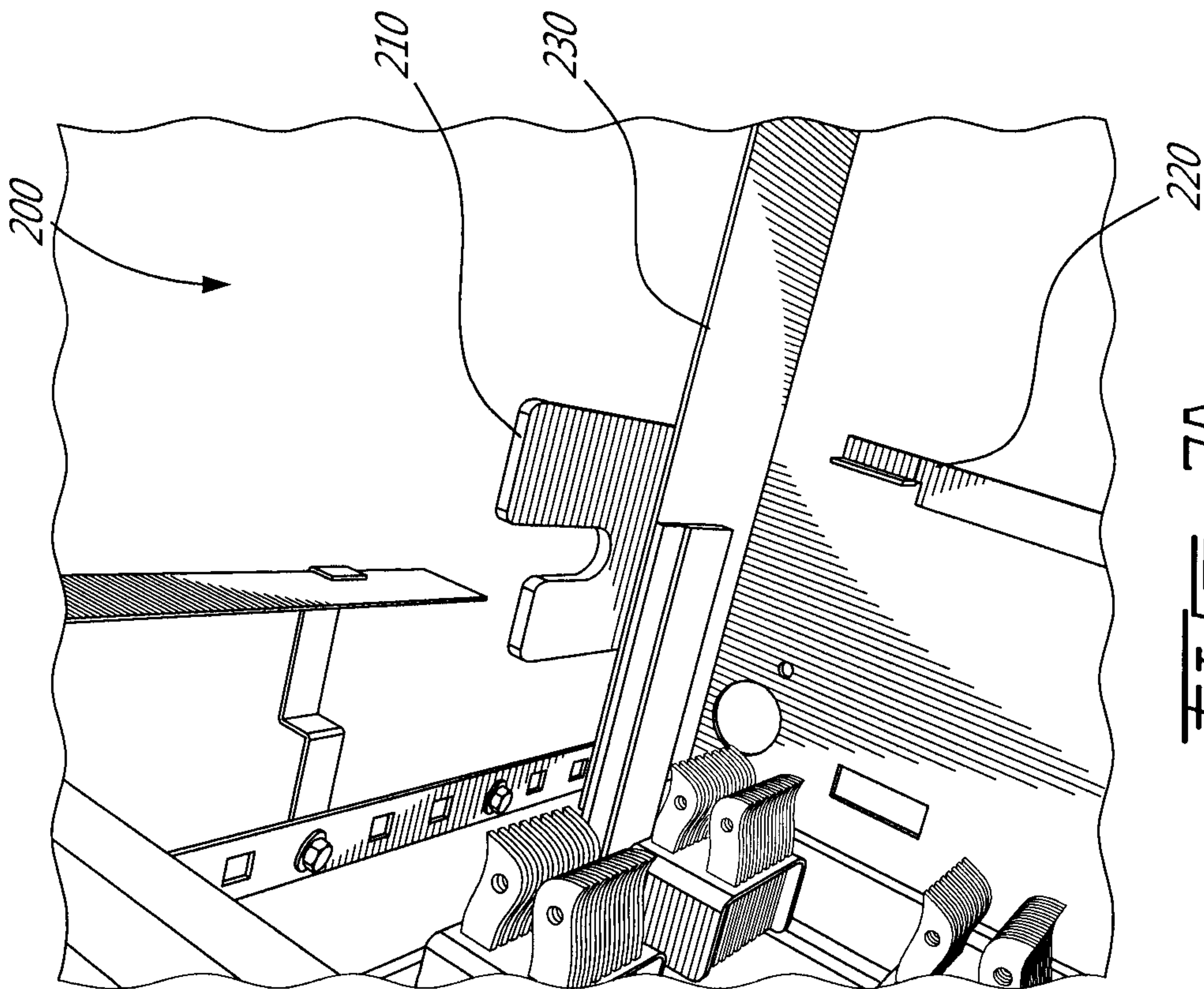

FIG. 2A

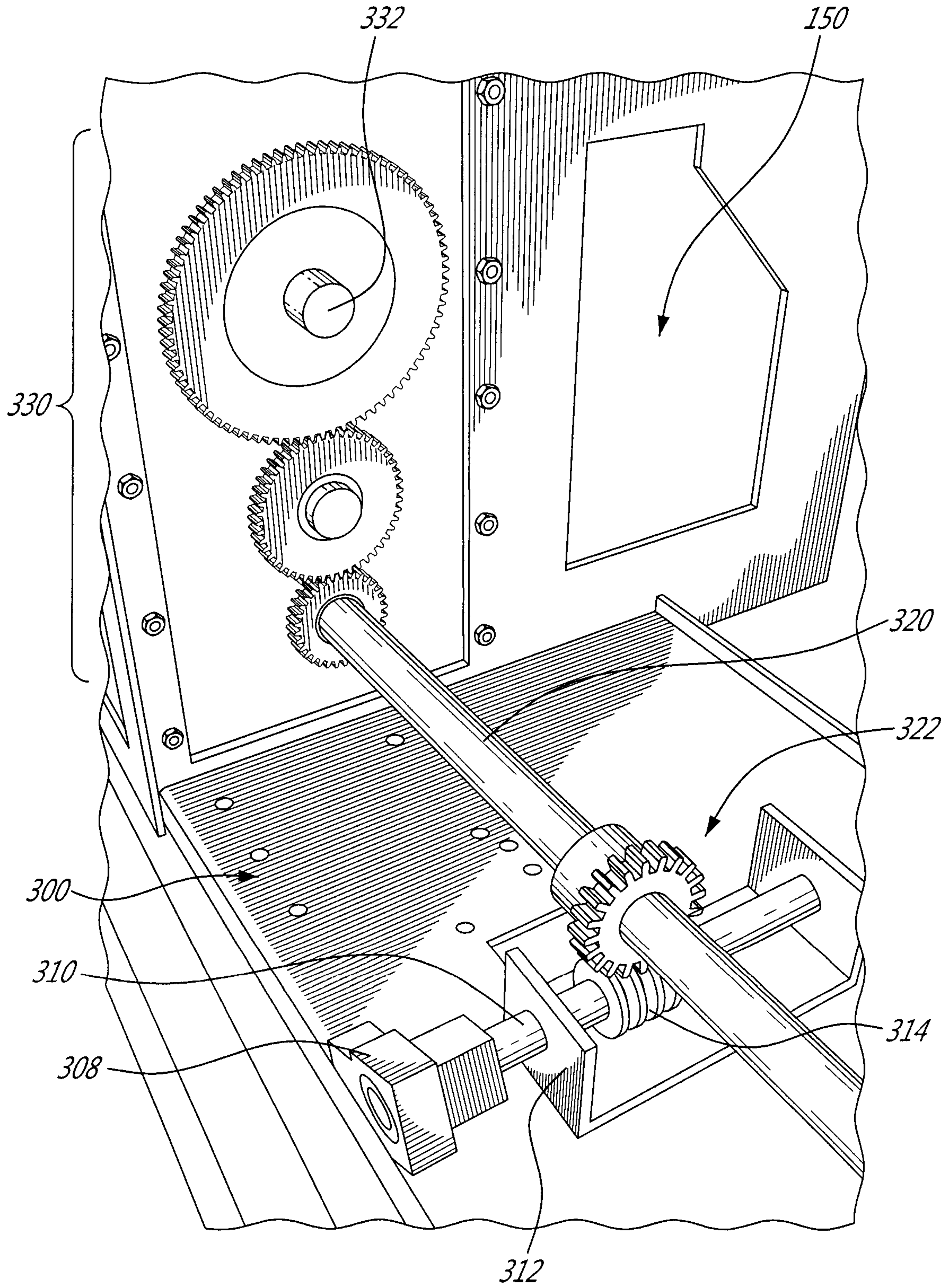
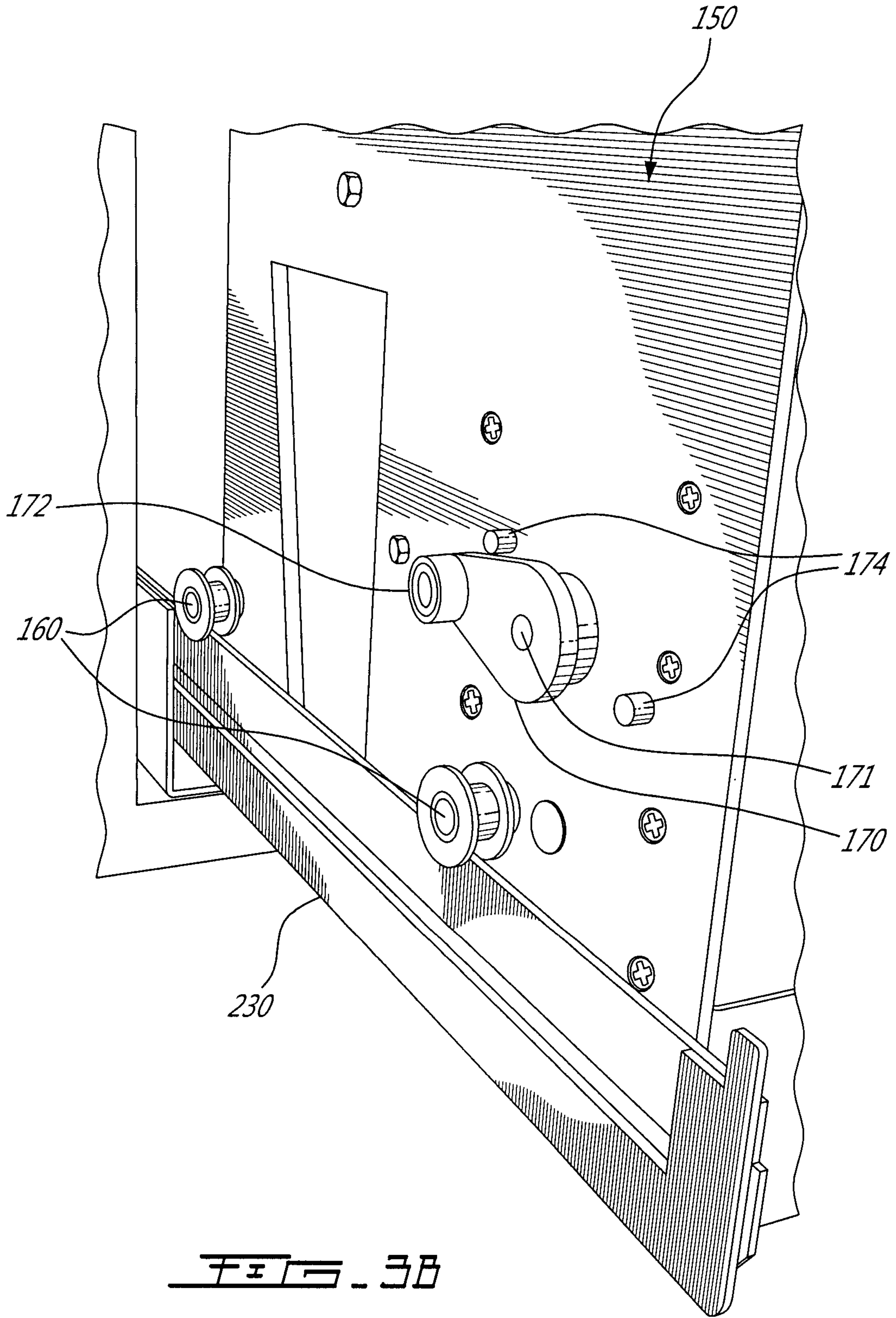

FIG. 3A



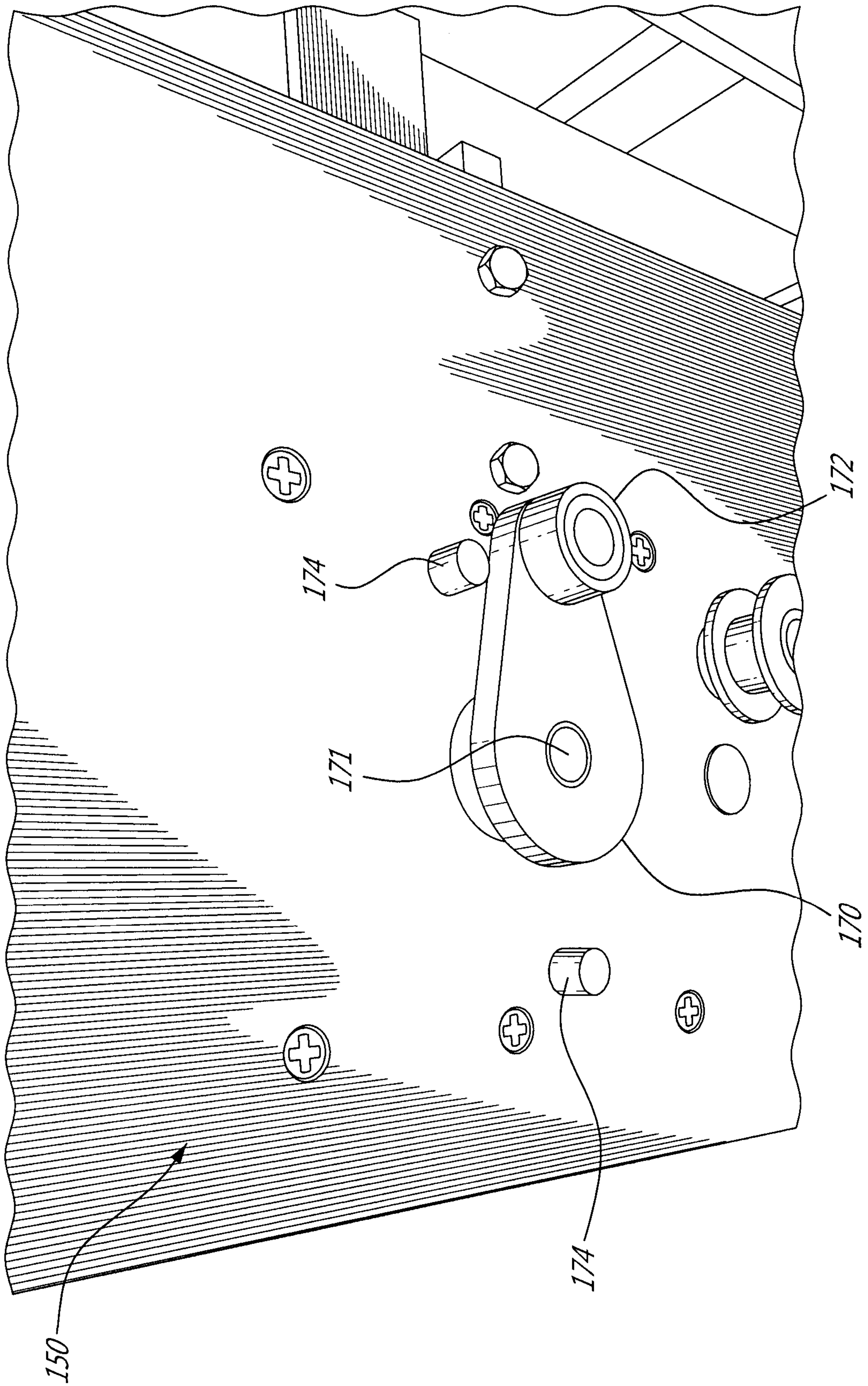

FIG. 3C

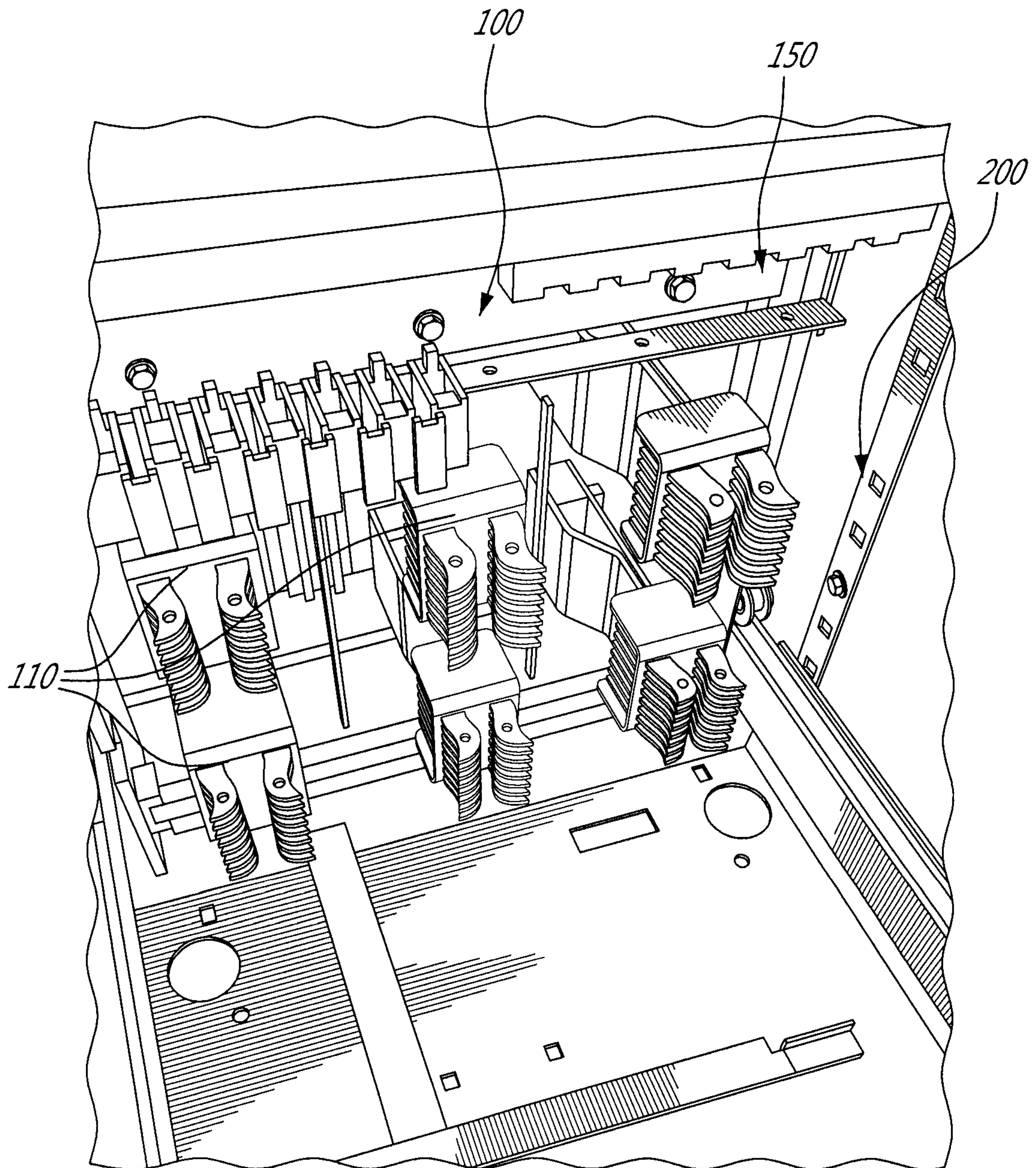

FIG. 4

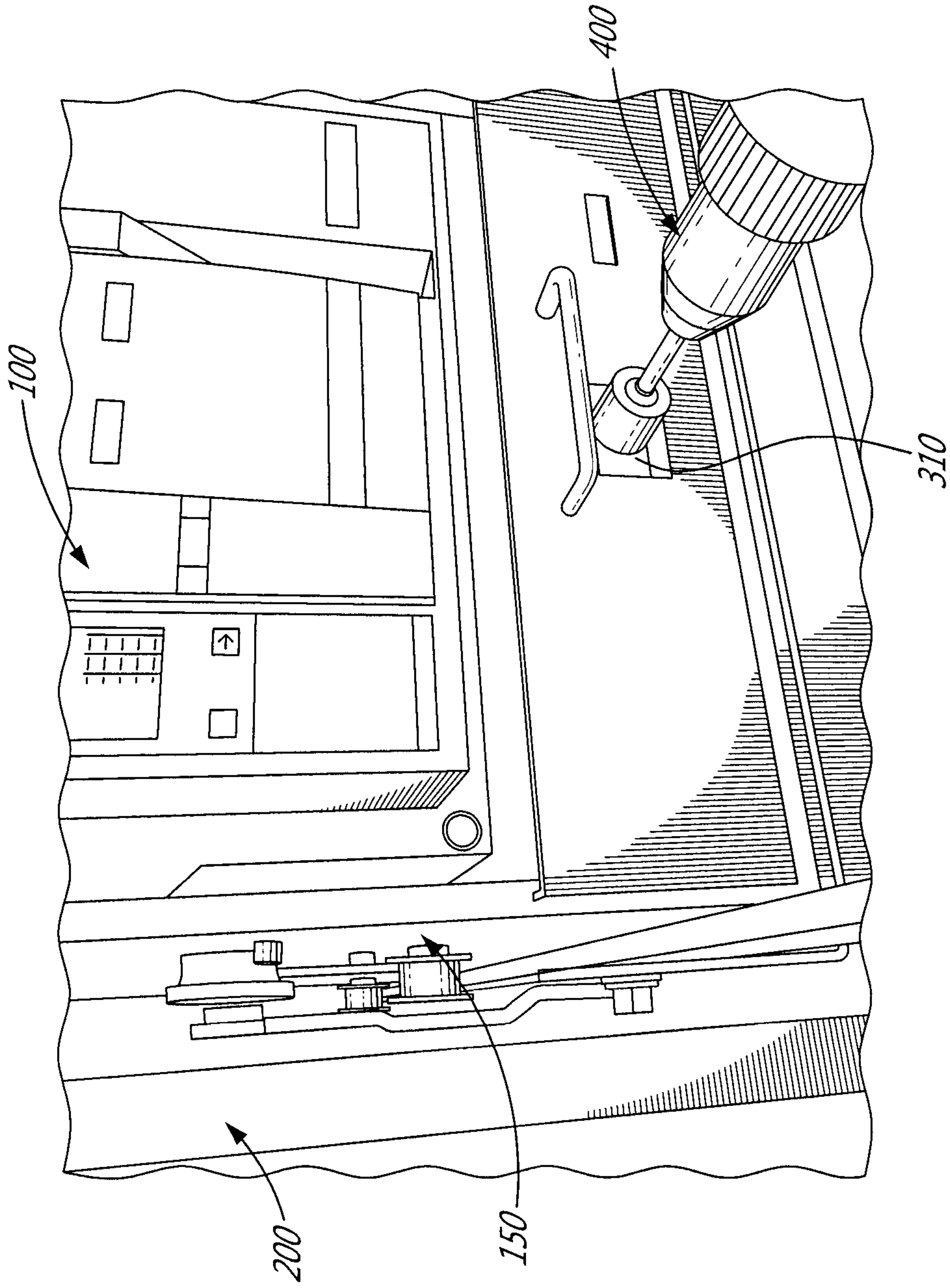

FIG. 5

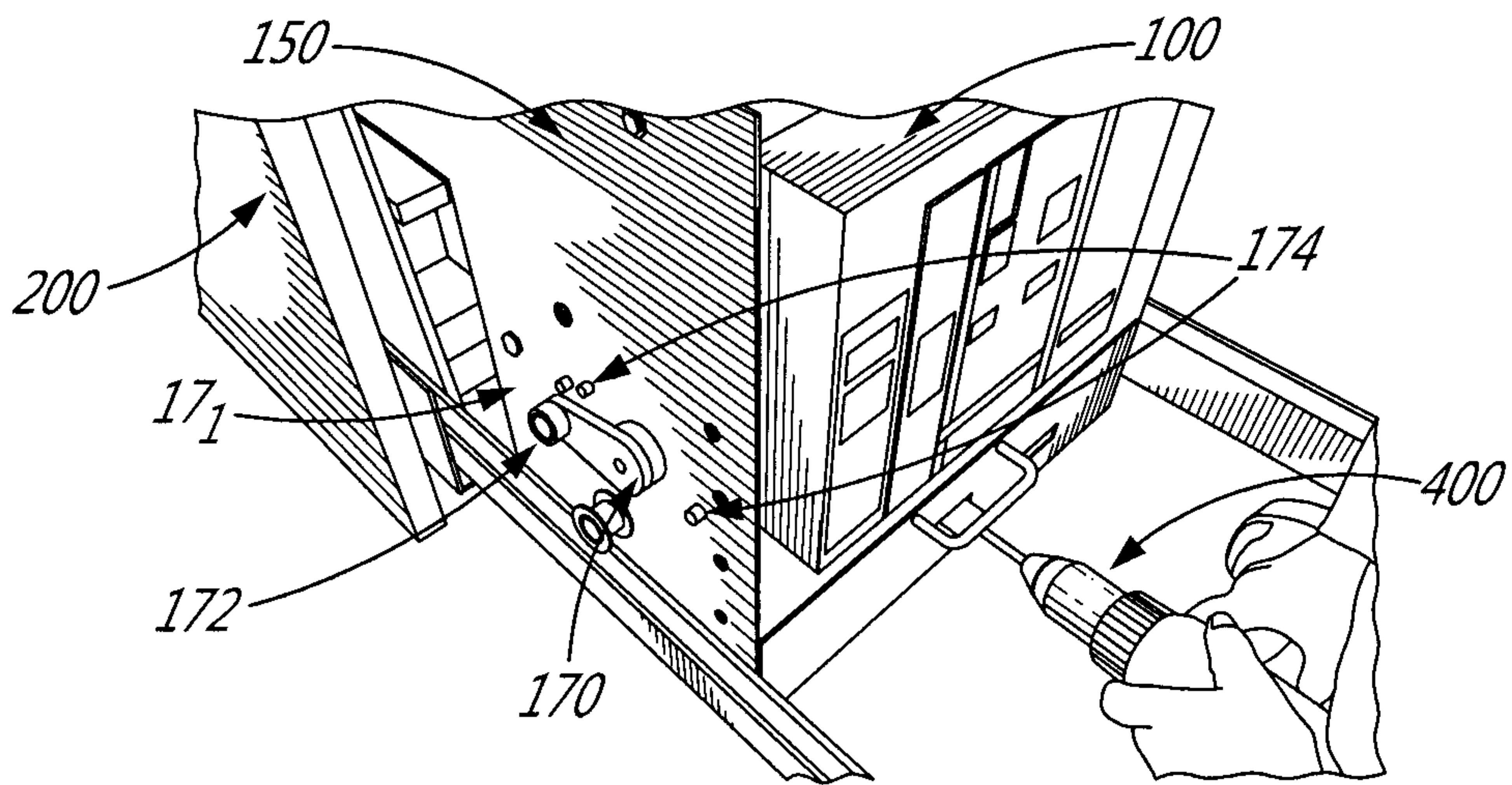

FIG. 6A

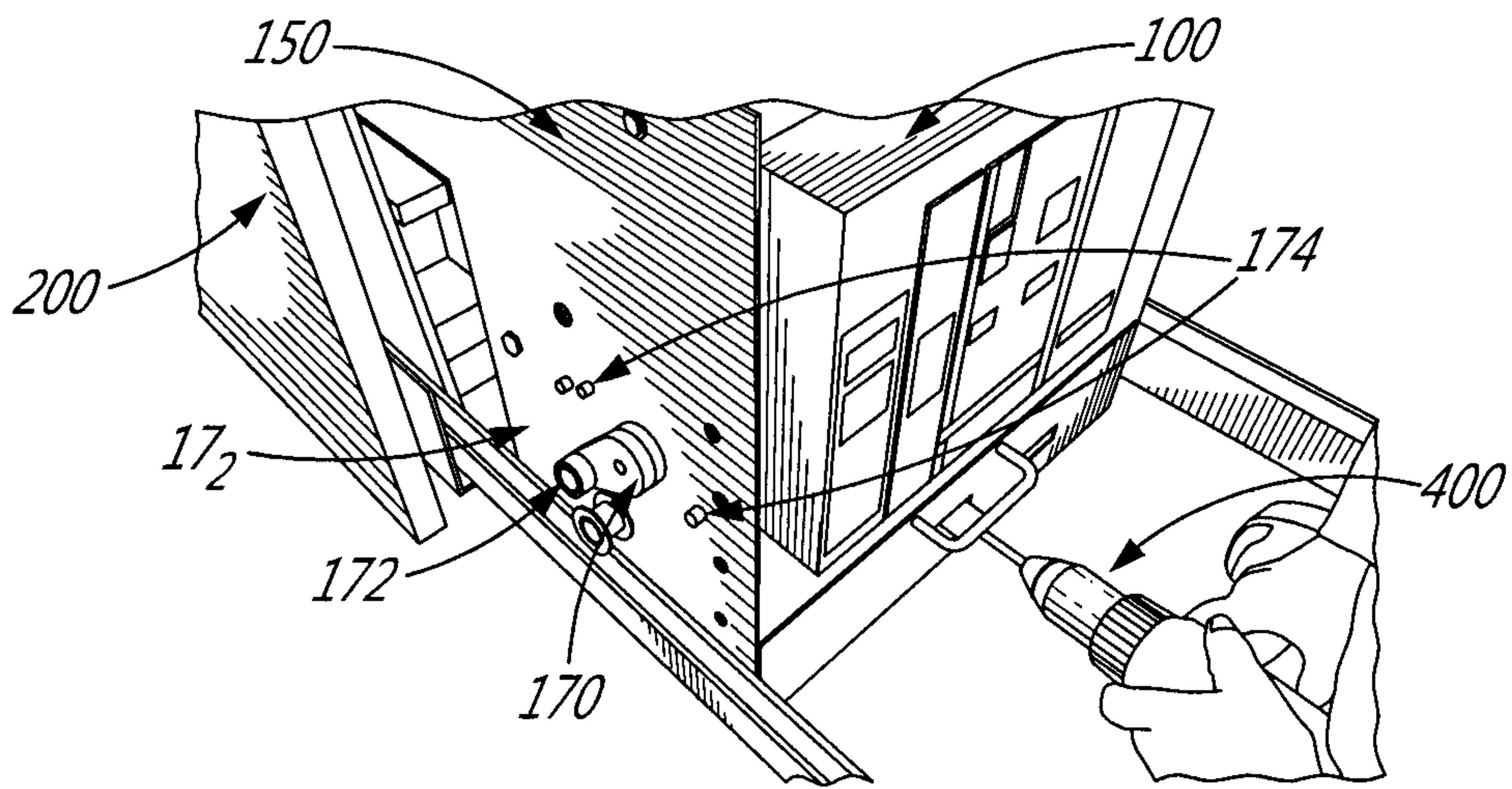

FIG. 6B

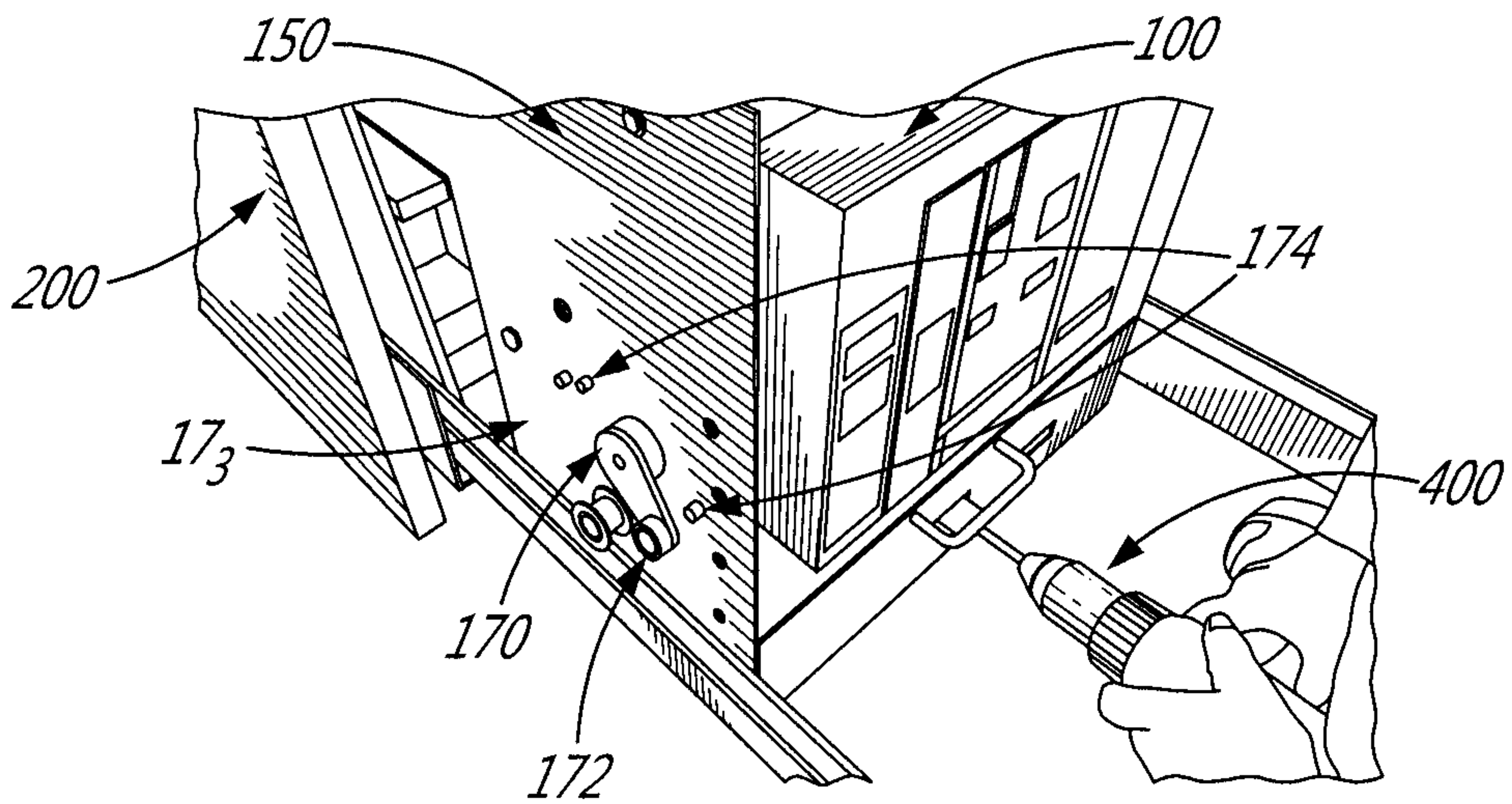

FIG. 6C

