

(19) World Intellectual Property Organization  
International Bureau



(43) International Publication Date  
22 June 2006 (22.06.2006)

PCT

(10) International Publication Number  
**WO 2006/065619 A1**

- (51) International Patent Classification:  
**G06K 7/10** (2006.01)
- (21) International Application Number:  
PCT/US2005/044452
- (22) International Filing Date:  
8 December 2005 (08.12.2005)
- (25) Filing Language: English
- (26) Publication Language: English
- (30) Priority Data:  
11/014,478 16 December 2004 (16.12.2004) US
- (71) Applicant (for all designated States except US):  
**COGNEX TECHNOLOGY AND INVESTMENT CORPORATION** [US/US]; 1001 Rengstorff Avenue, Mountain View, CA 94043 (US).
- (72) Inventor; and
- (75) Inventor/Applicant (for US only): **NUNNINK, Laurens** [NL/NL]; Vinkedelstraat 3, NL-6369 BT Simpelveld (NL).
- (74) Agents: **LOGINOV, William, A.** et al.; Cesari and McKenna, LLP, 88 Black Falcon Avenue, Boston, MA 02210 (US).

- (81) Designated States (unless otherwise indicated, for every kind of national protection available): AE, AG, AL, AM, AT, AU, AZ, BA, BB, BG, BR, BW, BY, BZ, CA, CH, CN, CO, CR, CU, CZ, DE, DK, DM, DZ, EC, EE, EG, ES, FI, GB, GD, GE, GH, GM, HR, HU, ID, IL, IN, IS, JP, KE, KG, KM, KN, KP, KR, KZ, LC, LK, LR, LS, LT, LU, LV, LY, MA, MD, MG, MK, MN, MW, MX, MZ, NA, NG, NI, NO, NZ, OM, PG, PH, PL, PT, RO, RU, SC, SD, SE, SG, SK, SL, SM, SY, TJ, TM, TN, TR, TT, TZ, UA, UG, US, UZ, VC, VN, YU, ZA, ZM, ZW.
- (84) Designated States (unless otherwise indicated, for every kind of regional protection available): ARIPO (BW, GH, GM, KE, LS, MW, MZ, NA, SD, SL, SZ, TZ, UG, ZM, ZW), Eurasian (AM, AZ, BY, KG, KZ, MD, RU, TJ, TM), European (AT, BE, BG, CH, CY, CZ, DE, DK, EE, ES, FI, FR, GB, GR, HU, IE, IS, IT, LT, LU, LV, MC, NL, PL, PT, RO, SE, SI, SK, TR), OAPI (BF, BJ, CF, CG, CI, CM, GA, GN, GQ, GW, ML, MR, NE, SN, TD, TG).

**Published:**  
— with international search report

For two-letter codes and other abbreviations, refer to the "Guidance Notes on Codes and Abbreviations" appearing at the beginning of each regular issue of the PCT Gazette.

(54) Title: HAND HELD SYMBOLOGY READER ILLUMINATION DIFFUSER

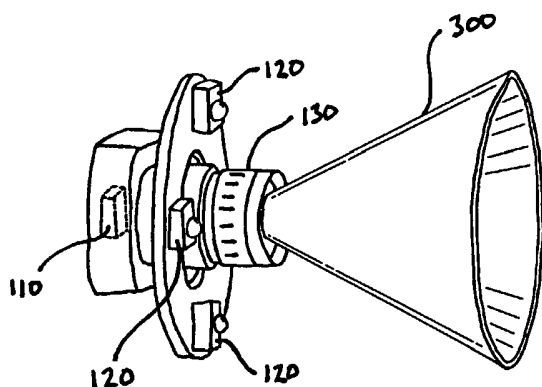

(57) Abstract: A hand held industrial identification symbol reader projects diffuse illumination onto a region of interest to produce high contrast images of symbols. The diffuse illumination is particularly well suited for producing images of symbols that are marked directly on objects. The diffuse illumination is created through the use of an optically translucent diffuser having a generally tapered shape that distributes diffuse illumination throughout the field of view of the reader. The diffuse illumination can be supplemented with dark field illumination using selectively actuated illumination sources.



WO 2006/065619 A1

# HAND HELD SYMBOLOGY READER ILLUMINATION DIFFUSER

## BACKGROUND OF THE INVENTION

### *Field of the Invention*

This invention relates to illumination for image acquisition devices, and more particularly, to illumination for image acquisition devices used for reading industrial identification codes.

### *Description of Related Art*

Machine vision systems use image acquisition devices that include camera sensors to deliver information on a viewed subject. The system then interprets this information according to a variety of algorithms to perform a programmed decision-making and/or identification function. For an image to be most effectively acquired by a sensor in the visible, and near visible light range, the subject should be properly illuminated.

In the example of identification symbol scanning using an image sensor, good lighting is highly desirable. Identification symbol scanning entails the aiming of an image acquisition sensor (CMOS camera, CCD, etc.) at a location on an object that contains a bar code, data matrix, or other identification symbol, and retrieval of an image of that symbol. The identification symbol contains a set of predetermined patterns that represent an ordered group of characters or symbols from which an attached data processor (for example a microcomputer) can derive useful information about the object (e.g. its serial number, type, model, price, etc.). Identification symbols are available in a variety of shapes and sizes. Two of the most commonly employed symbol types are the so-called one-dimensional barcode, consisting a line of vertical stripes of varying width and spacing, and the so-called two-dimensional barcode consisting of a two-dimensional array of dots or rectangles.

In reading identification symbols or other subjects of interest the type of illumination employed is of particular concern. Where barcodes and other viewed subjects are printed on a flat surface with contrasting ink or paint, a diffuse, high-angle "bright field" illumination may best highlight these features for the sensor. By high-angle it is meant,

generally, light that strikes the subject nearly perpendicularly (normal) or at an angle that is typically no less than about 45 degrees from perpendicular (normal) to the surface of the item being scanned. Such illumination is subject to substantial reflection back toward the sensor. By way of example, barcodes and other subjects requiring mainly bright field illumination may be present on a printed label adhered to an item or container, or on a printed field in a relatively smooth area of item or container.

Conversely, where a barcode or other subject is formed on a more-irregular surface or is created by etching or peening a pattern directly on the surface, the use of highly reflective bright field illumination may be inappropriate. A peened/etched surface has two-dimensional properties that tend to scatter bright field illumination, thereby obscuring the acquired image. Where a viewed subject has such decidedly two-dimensional surface texture, it may be best illuminated with dark field illumination. This is an illumination with a characteristic low angle (approximately 45 degrees or less, for example) with respect to the surface of the subject (i.e. an angle of more than approximately 45 degrees with respect to normal). Using such low-angle, dark field illumination, two-dimensional surface texture is contrasted more effectively (with indents appearing as bright spots and the surroundings as shadow) for better image acquisition.

To take full advantage of the versatility of a camera image sensor, it is desirable to provide both bright field and dark field illumination for selective or simultaneous illumination of a subject. However, dark field illumination must be presented close to a subject to attain the low incidence angle thereto. Conversely, bright field illumination is better produced at a relative distance to ensure full area illumination.

In the situation where a barcode or other subject is formed on a specular surface, non-directional totally diffuse bright field illumination is preferred. This type of illumination, like that naturally produced on a cloudy day must surround the object upon which the barcode is placed. In typical machine vision applications, non-directional totally diffuse illumination is difficult and costly to provide, usually by way of surrounding a workpiece with a light tent.

## SUMMARY OF THE INVENTION

In one aspect the present invention provides diffuse illumination in a hand held reader to produce high contrast images of symbols and barcodes. A tapered translucent

diffuser is disposed between the imager and the region of interest with illumination behind the diffuser directed toward the region of interest. The tapered diffuser converts bright field illumination into totally diffused non-directional illumination. The narrow end of the tapered diffuser surrounds the lens at a position near to the lens of the reader. The wide end of the tapered diffuser surrounds the field of view near the region of interest. Accordingly, the field of view is flooded with diffuse illumination.

In another aspect of the invention, diffuse illumination is produced in addition to low angle dark field illumination. In this aspect of the invention, a passive light pipe that produces low angle dark field illumination is positioned around the diffuser. Alternatively, an active light pipe surrounds the diffuser, with dark field illuminators directly projecting illumination at a low angle with respect to the region of interest. The reader can be configured to selectively actuate either the diffuse illumination from the tapered diffuser, or exclusive dark field illumination from the dark field light pipes, or a combination of both diffuse illumination and dark field illumination.

In yet another aspect of the invention, in addition to the tapered diffuser that surrounds the lens at the narrow end of the diffuser, diffused illumination directed to a semi-transparent mirror positioned in front of the lens and aligned so that a portion of the light reflecting from the region of interest is projected into the lens, while a portion of the diffuse illumination is reflected onto the region of interest. In this aspect of the invention, uniform diffuse illumination can be projected onto the region of interest without producing a reflection of the lens in the image.

Other objects and advantages of the present invention will become apparent from the following detailed description, the accompanying drawings, and the appended claims.

## **BRIEF DESCRIPTION OF THE SEVERAL VIEWS OF THE DRAWINGS**

The present invention is further described in the detailed description which follows, by reference to the noted drawings by way of non-limiting illustrative embodiments, in which like reference numerals represent similar part throughout the several views of the drawings, and wherein:

FIG. 1 is a perspective view of a handheld scanning system and an object having a symbol thereon;

FIG. 2 is a schematic cross sectional view of an image formation system according to the prior art;

5 FIG. 3 is a perspective view of a representative object having a two-dimensional symbol marked thereon, according to the background art;

FIG. 4 is an image of a two dimensional symbol on a specular cylindrical object acquired using an image formation system according to the prior art;

10 FIG. 5 is a schematic cross sectional view of an image formation system according to an illustrative embodiment of the present invention;

FIG. 6 is a perspective view of an illustrative embodiment of an image formation system according to the present invention;

FIG. 7 is an image of a two dimensional symbol on a specular cylindrical object acquired using an image formation system according to the present invention;

15 FIG. 8 is a schematic cross section of an illustrative embodiment of the present invention;

FIG. 9 is a schematic cross section of an illustrative embodiment of the present invention;

20 FIG. 10 is a schematic cross section of an illustrative embodiment of the present invention;

FIG. 11 is an exploded perspective view of an image formation system according to an illustrative embodiment of the present invention;

FIG. 12 is a schematic cross section of an illustrative embodiment of the present invention;

25 FIG. 13 is a schematic cross section of an illustrative embodiment of the present invention;

FIG. 14 is a perspective view of an illustrative embodiment of the present invention with the diffuser according to the invention adapted with a cylindrical shape; and

FIG. 15 is a perspective view of an illustrative embodiment of the present invention with selective quadrant diffuse illumination.

## DETAILED DESCRIPTION OF THE INVENTION

FIG. 1 shows a scanning system 101 adapted for handheld operation. An exemplary handheld scanning appliance or handpiece 102 is provided. It includes a grip section 104 and a body section 106. An image formation system 151, shown in phantom and described herein, can be controlled and can direct image data to an onboard embedded processor 109. This processor can include a scanning software application 113 by which lighting is controlled, images are acquired and image data is interpreted into usable information (for example, alphanumeric strings derived from the barcode images). The decoded information can be directed via a cable 111 to a PC or other data storage device 112 having (for example) a display 114, keyboard 116 and mouse 118, where it can be stored and further manipulated using an appropriate application 121. Alternatively, the cable 111 can be directly connected to an interface in the scanning appliance and an appropriate interface in the computer 112. In this case the computer-based application 121 performs various image interpretation and lighting control functions as needed. The precise arrangement of the handheld scanning appliance with respect to an embedded processor, computer or other processor is highly variable. For example, a wireless interconnect can be provided in which no cable 111 is present. Likewise, the depicted microcomputer can be substituted with another processing device, including an onboard processor or a miniaturized processing unit such as a personal digital assistant or other small-scale computing device.

The scanning application 113 can be adapted to respond to inputs from the scanning appliance 102. For example, when the operator toggles a trigger 122 on the hand held scanning appliance 102, an internal camera image sensor (110, shown and described further below) acquires an image of a region of interest 131 on an object 105. The exemplary region of interest includes a two-dimensional symbol 195 that can be used to identify the object 105. Identification and other processing functions are carried out by the scanning application 113, based upon image data transmitted from the hand held scanning appliance 102 to the processor 109. A visual indicator 141 can be illuminated by signals from the processor 109 to indicate a successful read and decode of the symbol 195.

FIG. 2 depicts an image formation system 151 typically used in a hand held scanning appliance 102. FIG. 2 shows a cross sectional view of a prior art imaging system 100 for reading marks or symbols on an object 105. The imaging system 100 has an imager 110 that is one of a variety of types of photosensitive imaging sensors, such as a CMOS or CCD device. A lens 130 disposed in front of the imager 110 is configured to direct illumination onto the imager 110. The imager 110 and lens 130 together form an optical axis 140 that defines the center of a field of view, which is bound by the polyhedral volume defined as lines 150 in FIG. 2.

At a given focus setting, a sharply focused image of the surface of an object 105 will be projected by the lens 130 onto the imager 110 when the object is positioned at an appropriate distance from the imaging system 100. Optical properties of the system will affect the range of distance from which the object 105 can be positioned in front of the system 100 while projecting an image of the object 105 onto the imager 110 that exhibits features of sufficient sharpness and contrast so as to be perceived as a focused image. The range upon which a focused image can be formed on the imager 110 is called the depth of field 125.

Illuminators 120 are shown in the system 100 for directing illumination towards the object 105. Typically, a diffuser 180 is disposed in front of the illuminators 120 to diffuse the illumination so that a uniform distribution of illumination can be spread over the surface of the object. Without the diffuser 180, the illumination from the illuminators 120 will appear as areas of high intensity illumination surrounded by areas of low intensity illumination. As shown in FIG. 2, the field of view of an image of a cylindrical object 105 is the portion of the surface of the object from point B 135 to point A 145.

Although the entire field of view is illuminated, only a portion of the reflective surface (from point P 175 to point Q 165) will reflect light into the imaging system 100. This results from the maximum angle of illumination, depicted as lines 155 in FIG. 2, that can be reflected into the imaging system 100, depicted as lines 160 in FIG. 2, being significantly less than the field of view. The image of a cylindrical object using the prior art imaging system 100 will depict a brightly illuminated band over the area defined by lines through points P and Q.

FIG. 3 depicts a two-dimensional data matrix symbol 195 etched on the surface of a cylindrical object, e.g., a drill bit 190. Presenting the exemplary drill bit 190 to the imaging system 100 will produce an image of the symbol 195 as shown in FIG. 4. A

brightly illuminated band can be observed between the regions defined as lines P 175 and Q 165. The illumination that strikes the remaining portion of the object does not reflect into the optics of the imaging system 100, and therefore, the image is too dark to produce a clear representation of the data matrix symbol so that decoding algorithms  
5 can be applied to decode the symbol.

FIG. 5 depicts an improved imaging system 200 according to the present invention that can be used as an image formation system 151 in a hand held scanning appliance 102. The improved system 200 has an imager 110 that is one of a variety of types of photosensitive imaging sensors, such as a CMOS or CCD device. A lens 130  
10 disposed in front of the imager 110 is configured to direct illumination onto the imager 110. The imager 110 and lens 130 together form an optical axis 140 that defines the center of a field of view, which is bound by the polyhedral area defined as lines 150 in FIG. 4

At a given focus setting, a sharply focused image of the surface of the object 105 will be projected by the lens 130 onto the imager 110 when the object is positioned at an  
15 appropriate distance from the improved system 200. Optical properties of the system will affect the range of distance from which the object 105 can be positioned in front of the improved system 200 while projecting an image of the object 105 onto the imager 110 that exhibits features of sufficient sharpness and contrast so as to be perceived as a focused image. The range upon which a focused image can be formed on the imager 110  
20 is called the depth of field 125.

Illuminators 120 are shown in the improved system 200 for directing illumination towards the object 105. Optionally, a diffuser 180 can be used to diffuse the bright field illumination. In an illustrative embodiment of the present invention, a conical diffuser 300  
25 is disposed between the lens 130 and the object 105. One skilled in the art will appreciate that while the illustrative embodiment describes a conical shaped diffuser 300, other embodiments can be employed with alternative shapes without departing from the scope of the invention. For example, parabolic, cylindrical, and hemispherical shaped diffusers can be used as a diffuser 300.

FIG. 6 depicts a perspective view of the basic elements of the illustrative em-  
30 bodiment of the present invention. The conical diffuser 300 is constructed from a translucent plastic material, such as polymethyl methacrylate (PMMA) with a roughened surface to achieve the optical property of translucency. In an embodiment of the invention, the optical properties of the diffuser 300 has translucency like that of ordinary white pa-



per, in that illumination will cause the surface of the diffuser to appear bright. The conical diffuser 300 can be molded with a rough mold surface, or sandblasted to roughen the normally clear material to be translucent. The diffuser 300 is configured so that a first distal end, the narrow opening, of the diffuser surrounds the opening of the lens 130 and aligned with the imager 110 (shown in phantom). The illuminators 120 are distributed around the lens 130 so that an even distribution of illumination can be projected.

Referring back to FIG. 5, the entire field of view is illuminated with diffuse illumination since the second distal end of the diffuser 300 surrounds the field of view near the object 105. The maximum angle of illumination from the diffuser 300, shown as line 310 strikes the object 105 within the region defined as the field of view between point A 145 and point B 135, reflecting toward the lens 130 and the imager 110 as lines 150. Illumination from the diffuser that strikes the object outside of that region is outside the field of view, and therefore, not captured by the imager 110.

Presenting the exemplary drill bit 190 (FIG. 3) to the improved imaging system 200, an image of the data matrix symbol 195 will be formed like that shown in FIG. 7. The entire data matrix symbol 195 is visible, since the region defined as the field of view between point A 145 and point B 135 receive diffuse illumination, and therefore, decoding algorithms operating on the image can readily extract the encoded information.

FIG. 8 shows another implementation of the diffuser 300 with a passive light pipe 800, shown in cross section relative to the lens 130, to provide diffuse illumination in combination with, or in the alternative to dark field illumination. Dark field illumination 810 is directed into the light pipe 800 that is internally reflected at a chamfered portion 815 to be directed at the object 105 at a low angle. Further information regarding the design and implementation of passive light pipes with selectively actuated illumination to provide dark field illumination can be found in commonly assigned US Patent Application Serial No. 10/693,626, incorporated herein by reference. Bright field illumination 820 is converted into totally diffuse illumination by the diffuser 300, to project diffuse illumination on the object 105 within the field of view, depicted as the region defined by lines 150. Optionally, the diffuser 300 can be removably attached to the hand held scanning appliance 102 so that a user can operate the hand held scanning appliance using non-diffuse bright field illumination. The removability of the diffuser 300 can be achieved by incorporating snap-fit clearances and/or features in the diffuser and light pipe that permit removable assembly (not shown).

When dark field illumination is exclusively applied to the object 105 in the embodiment of the invention according to FIG. 8, scattered illumination may reflect from the object 105 and then from the diffuser 300 to unintentionally cause diffuse illumination on the object 105. This condition may be undesirable for reading certain parts that are best imaged with low angle dark field illumination, such as peened data matrix marks on a highly specular surface.

FIG. 9 shows an alternate embodiment of the implementation of the diffuser 300 with a passive light pipe 800, shown in cross section relative to the lens 130, to provide selectively exclusive dark field illumination or diffuse illumination. In this embodiment, a color specific dark field illumination 835 is projected into the light pipe 800. The diffuser 300 is fabricated with a material 840 having a color characteristic different from the color of the color specific dark field illumination 835, and illuminated with color specific bright field illumination 825 that matches the color characteristic of the material 840. In this embodiment, when the color specific dark field illumination is exclusively actuated, the low angle dark field illumination is projected onto the object 105, and any scattered illumination reflecting from the object 105 and then the diffuser 300 will not be converted into totally diffuse illumination.

In an illustrative embodiment according to FIG. 9, the color specific dark field illumination 835 is red, and the color specific bright field illumination is blue, with the material 840 having a blue color. In this embodiment, if only low angle dark field illumination is desired, the red dark field illumination 835 is turned on, with the blue bright field illumination turned off. The low angle red illumination striking the object, if scattered to reflect off the blue colored material 840 of the diffuser 300, will not appear bright in an image, and therefore not contribute to the illumination of the object with totally diffuse illumination. Conversely, if the blue bright field illumination 825 is turned on, the blue colored material 840 of the diffuser will transmit and diffuse the illumination to provide totally diffuse illumination of the object 105 within the field of view, depicted as the region defined by lines 150. One skilled in the art will appreciate that alternative color characteristics, such as red/infrared can be employed according to the illustrative embodiment of FIG. 9.

FIG. 10 shows another illustrative embodiment of the implementation of the diffuser 300 with a passive light pipe 800, shown in cross section relative to the lens 130, to provide selectively exclusive dark field illumination or diffuse illumination. In this illustrative embodiment, dark field illumination 810 is projected into the light pipe 800 to pro-

duce low angle dark field illumination while the bright field illumination 820 is turned off. A light absorbing foil 860, such as a neutral density filter material is applied to the interior surface of the diffuser 300. Low angle dark field illumination that reflects off the object 105 is absorbed by the foil filter 860 so that totally diffuse illumination is not reflected  
5 back onto the object. If diffuse illumination is desired, either instead of dark field illumination, or in combination with dark field illumination, the bright field illumination 820 is turned on. The intensity of the bright field illumination 820 would need to be increased to compensate for the absorption of such illumination by the foil filter 820. With the bright field illumination actuated, totally diffuse illumination will transmit from the diffuser 300,  
10 through the foil filter 860, and onto the object within the field of view, depicted as the region defined by lines 150.

FIG. 11 depicts another illustrative embodiment of the implementation of the diffuser 300 as an image formation system 151 in a hand held scanning appliance 102. In the illustrative embodiment according to FIG. 11, the diffuser 300 is inserted into an active light pipe 870. The active light pipe 870 provides low angle dark field illumination  
15 from a ring of dark field illuminators 875, as disclosed in the commonly assigned International Patent Application WO02/075637, incorporated herein by reference. The dark field illuminators 875 are held in place with a threaded collar 880, and flexible sleeve 890. Bright field illuminators 120 project bright field illumination that is diffused by an optional  
20 diffuser 180, that is diffused over the entire field of view by the diffuser 300. A transparent window 895 protects the lens 130 and other internal components from the operating environment.

In the illustrative embodiment according to FIG. 11, the conical diffuser 300 can be positioned to diffuse the dark field illumination from the dark field illuminators 875, or  
25 optionally constructed to permit illumination from the dark field illuminators 875 to project onto the object at low angle without being diffused. This optional configuration can be achieved by inserting the conical diffuser 300 further into the active light pipe 870 toward the lens 130 to expose the dark field illuminators 875, or by constructing the conical diffuser 300 to have a transparent optical property at the distal end where it is disposed in  
30 front of the dark field illuminators 875. When the hand held scanning appliance having an image formation system 151 according to the illustrative embodiment according to FIG. 11 is operated, the user can configure or select exclusive dark field illumination or exclusive diffuse illumination, or a combination of both modes of illumination thereof.

In the illustrative embodiment according to FIG. 11, the conical diffuser 300 can be optionally removed from the image formation system 151 so that the hand held scanning appliance 102 can be operated without diffuse illumination. This condition may be desired if high intensity non-diffuse bright field illumination, or if exclusive dark field illumination is required. The removable aspect of the diffuser 300 can be achieved by unscrewing the threaded collar 880 to remove the diffuser 300, and re-threading the collar 880 without the diffuser in place.

FIG. 12 shows a schematic representation of the effect of illuminating an object 105 having a highly specular surface 910 according to the present invention. The resulting image 920 will exhibit features 925 associated with a reflection of the lens 130. Though the field of view 930, as defined as the region bound by lines 150, will be illuminated with totally diffuse illumination from the diffuser 300, the image 920 will exhibit a darkened region of features 925 that is a reflection of light not emanating from the diffuser 300.

FIG. 13 shows an illustrative embodiment of the invention that further improves the uniform distribution of diffuse illumination over the field of view according to the present invention. Bright field illumination 820 is converted into totally diffuse illumination by the diffuser 300, to project diffuse illumination on the object 105 within the field of view, depicted as the region defined by lines 150. A semi-reflecting mirror 950 is disposed in front of the lens 130, and behind the diffuser at an appropriate angle so that the image of the field of view is projected into the lens 130. A second bright field illumination source 935 is directed toward the semi-reflecting mirror 950, with a second diffuser 940 disposed between the second illumination source 935 and the semi-reflecting mirror 950. The second diffuser 940 is composed of the same material as the diffuser 300, with the same translucent optical properties. One skilled in the art will appreciate that a single diffuser can be fabricated or molded that can provide the functionality of both the diffuser 300 and the second diffuser 940. The intensity of the second illumination source 935 may require an increased level during operation since a portion of the illumination 935 will not be reflected onto the object 105, but rather through the semi-reflecting mirror into the body of the hand held scanning appliance 102. By adjusting the intensity level of the second illumination 935, an even distribution of diffuse illumination can be achieved over the entire field of view 930.

FIG. 14 shows an illustrative embodiment of the invention that provides a cylindrical shape 990 in the diffuser 300 so that an object 105 having an extended length can be presented to the improved imaging system 200. The cylindrical shape 990 of the diffuser provides relief so that the diffuser 300 can increase an area of diffuse illumination pattern on a reflective cylindrical object. Further, the cylindrical shape 990 provides an aiming assistance to the user.

FIG. 15 shows a plurality of selectively actuated illuminators 985 that can provide selective illumination of the diffuser 300. In this illustrative embodiment, the North illuminator 996 can be actuated with the South illuminator 998 while the East illuminator 994 and the West illuminator 992 are not actuated. Conversely, the East illuminator 994 and the West illuminator 992 can be actuated while the North illuminator 996 and the South illuminator 998 are not actuated. Selective quadrant illumination according to this illustrative embodiment permits an adjustment, or compensation, of the uniformity of the illumination that is converted into totally diffuse illumination by the diffuser 300, on an axis parallel with the axis of a specular object 105.

While the invention has been described with reference to certain illustrated embodiments, the words which have been used herein are words of description rather than words of limitation. Changes may be made, within the purview of the appended claims, without departing from the scope and spirit of the invention and its aspects. Although the invention has been described herein with reference to particular structures, acts and materials, the invention is not to be limited to the particulars disclosed, but rather extends to all equivalent structures, acts, and materials, such as are within the scope of the appended claims.

What is claimed is:

## CLAIMS

- 1       1. An apparatus for imaging a symbol on an object, the apparatus comprising:  
2           a hand held portable imaging system having an imager;  
3           a lens disposed between the imager and a region of interest, the region of interest  
4 being the intended position of the symbol on the object, the lens and imager defining a  
5 field of view and an optical axis;  
6           an illuminator adjacent to the lens, directing illumination towards the region of in-  
7 terest; and  
8           a tapered translucent diffuser concentrically aligned with the optical axis, having a  
9 first distal end surrounding the field of view proximate to the lens, and a second distal  
10 end surrounding the field of view proximate to the region of interest.
- 1       2. The apparatus according to claim 1 wherein the tapered translucent diffuser is  
2 composed of polymethyl methacrylate.
- 1       3. The apparatus according to claim 2 wherein the tapered translucent diffuser is fab-  
2 ricated in an injection molding process.
- 1       4. The apparatus according to claim 1 wherein the tapered translucent diffuser has a  
2 conical shape.
- 1       5. The apparatus according to claim 1 wherein the tapered translucent diffuser has a  
2 cylindrical shape.
- 1       6. The apparatus according to claim 1 further comprising:  
2           a dark field illuminating light pipe concentrically aligned with the optical axis and  
3 surrounding the tapered translucent diffuser; and  
4           a dark field illuminator directing illumination into the dark field illuminating light  
5 pipe.

1 7. The apparatus according to claim 6 wherein the tapered translucent diffuser is re-  
2 movably attached.

1 8. The apparatus according to claim 6 wherein the tapered translucent diffuser has a  
2 first color characteristic, the illuminator emits illumination having a color characteristic  
3 similar to the first color characteristic, and the dark field illuminator emits illumination  
4 having a second color characteristic.

1 9. The apparatus according to claim 8 wherein the first color characteristic is blue,  
2 and the second color characteristic is red.

1 10. The apparatus according to claim 8 wherein at least one color characteristic is in-  
2 fared.

1 11. The apparatus according to claim 6 further comprising:  
2 a light absorbing filter applied to the diffuser and disposed between the diffuser and the  
3 region of interest.

1 12. The apparatus according to claim 1 wherein the illuminator further comprises a  
2 plurality of selectively actuated illuminators.

1 13. The apparatus according to claim 12 wherein the plurality of selectively actuated  
2 illuminators have a north-south and east-west selective actuation.

1 14. An apparatus for imaging a symbol on an object, the apparatus comprising:  
2 a hand held portable imaging system having an imager;  
3 a lens disposed between the imager and a region of interest, the region of interest  
4 being the intended position of the symbol on the object, the lens and imager defining a  
5 field of view and an optical axis;

6 an illuminator adjacent to the lens, directing illumination towards the region of in-  
7 terest;

8 a dark field illuminating light pipe having a first distal end surrounding the lens  
9 and the illuminator, and a second distal end surrounding the field of view proximate to  
10 the region of interest, the second distal end configured to emit a dark field illumination  
11 toward the object at a low angle; and

12 a tapered translucent diffuser concentrically aligned with the optical axis and dis-  
13 posed within the dark field illuminating light pipe, the diffuser having a first distal end  
14 surrounding the field of view proximate to the lens, and a second distal end surrounding  
15 the field of view proximate to the object.

1 15. The apparatus according to claim 14 wherein the tapered translucent diffuser does  
2 not diffuse the dark field illumination.

1 16. The apparatus according to claim 15 wherein the tapered translucent diffuser has a  
2 transparent optical property where it is disposed before the dark field illumination.

1 17. The apparatus according to claim 14 wherein the tapered diffuser is removable.

1 18. The apparatus according to claim 14 and further comprising a plurality of dark  
2 field illuminators at the second distal end of the dark field illuminating light pipe config-  
3 ured to provide the dark field illumination.

1 19. An apparatus for imaging a symbol on an object, the apparatus comprising:  
2 a hand-held portable imaging system having an imager;  
3 a lens disposed between the imager and a region of interest, the region of interest  
4 being the intended position of the symbol on the object, the lens and imager defining a  
5 field of view and an optical axis;  
6 a first illuminator adjacent to the lens, directing illumination towards the region of  
7 interest;



8 a semi-reflecting mirror disposed in front of the lens aligned with the optical axis  
9 configured to direct at least a portion of illumination reflected from the region of interest  
10 into the lens;

11 a second illuminator directing illumination at the semi-reflecting mirror so that at  
12 least a portion of the illumination from the second illuminator is directed towards the re-  
13 gion of interest;

14 a first diffuser disposed between the second illuminator and the semi-reflecting  
15 mirror; and

16 a tapered translucent diffuser concentrically aligned with the optical axis, having a  
17 first distal end surrounding the field of view proximate to the lens, and a second distal  
18 end surrounding the field of view proximate to the region of interest.

1 20. The apparatus according to claim 19 wherein the first illuminator has a first inten-  
2 sity, and the second illuminator has a second intensity, so as to configure the apparatus to  
3 produce a uniform distribution of illumination over the field of view at the region of in-  
4 terest.

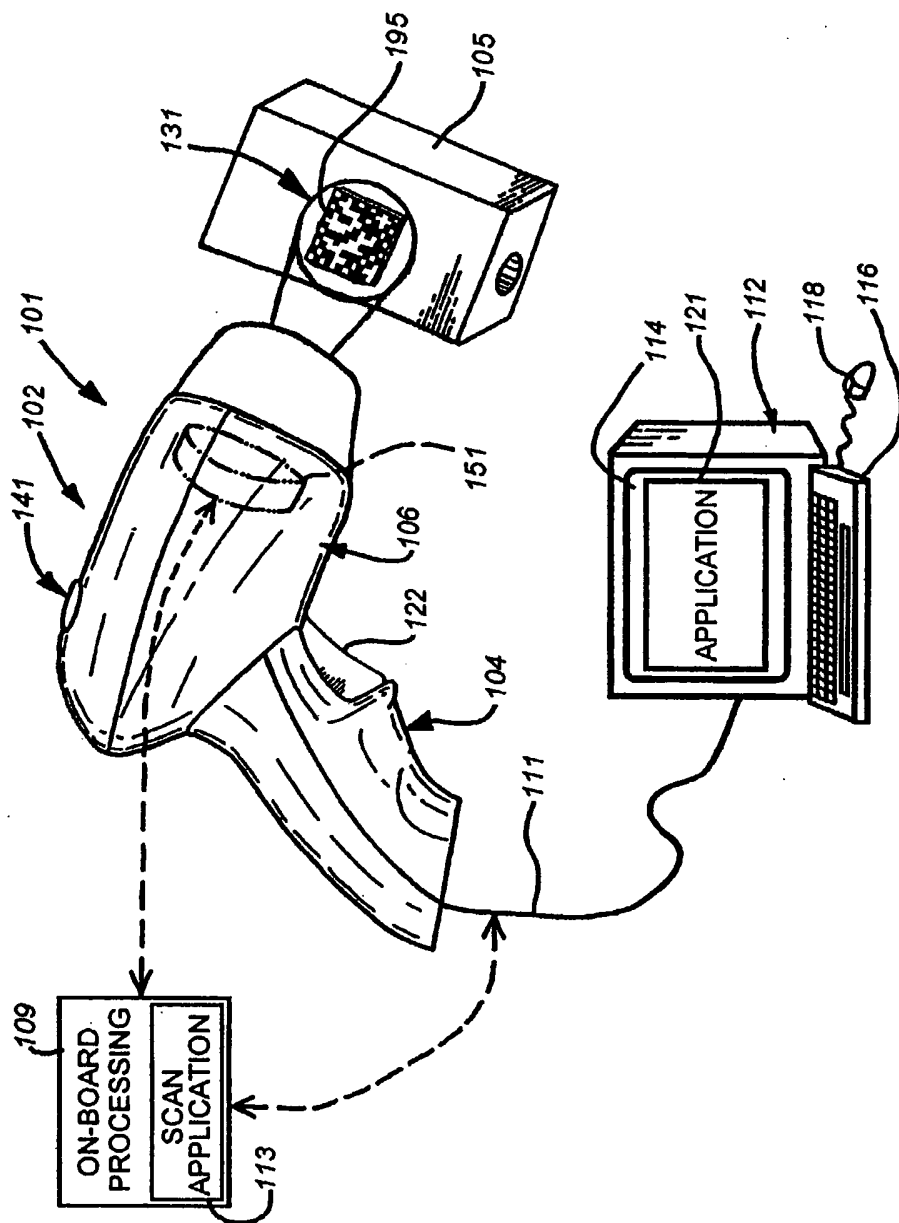

FIG 1  
Background Art

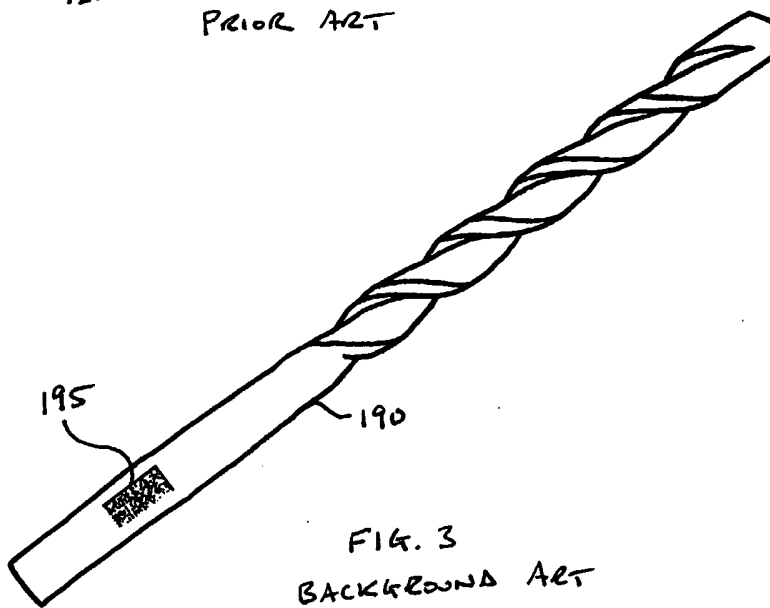
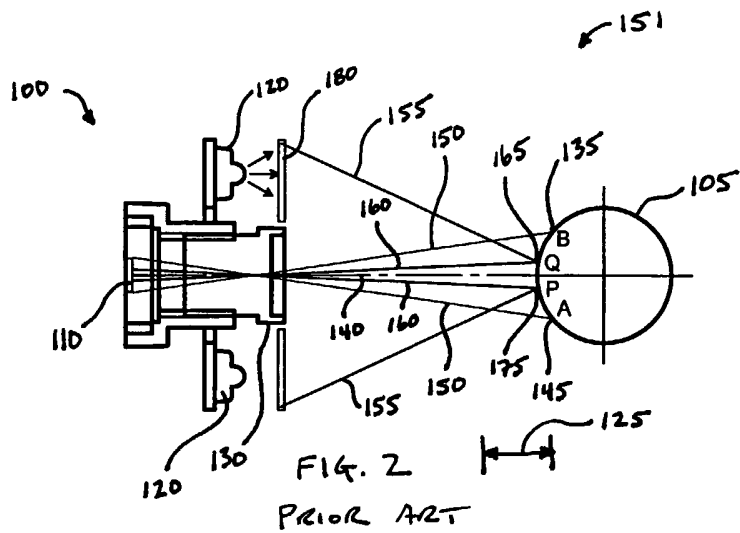
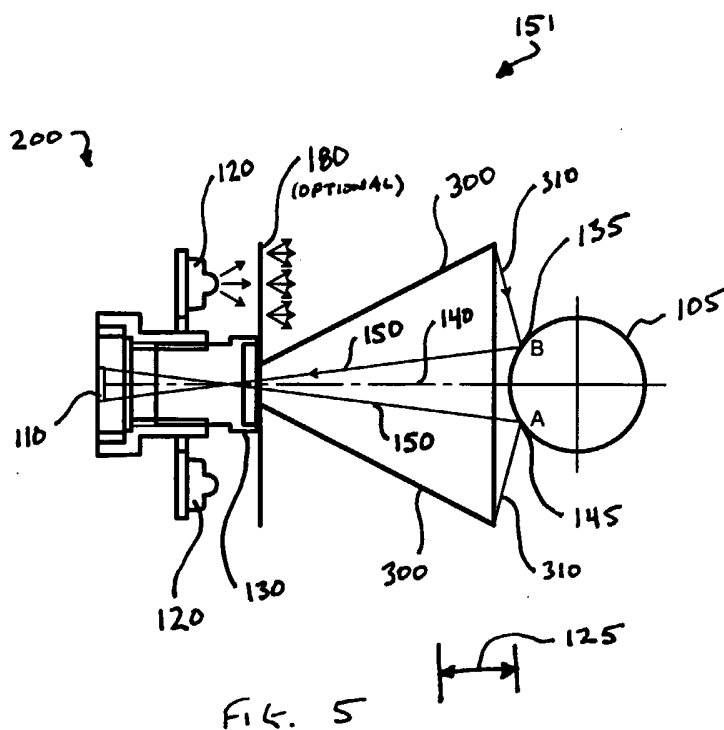



FIG. 4  
BACKGROUND ART



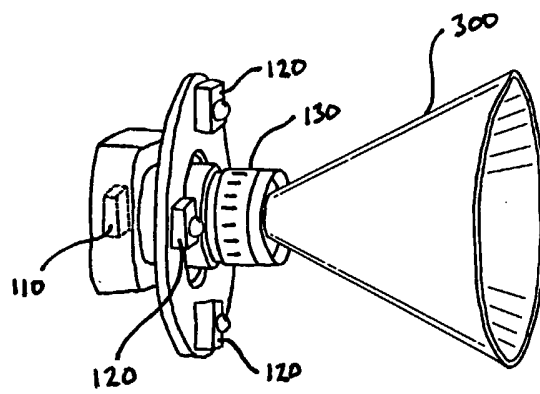

FIG. 6

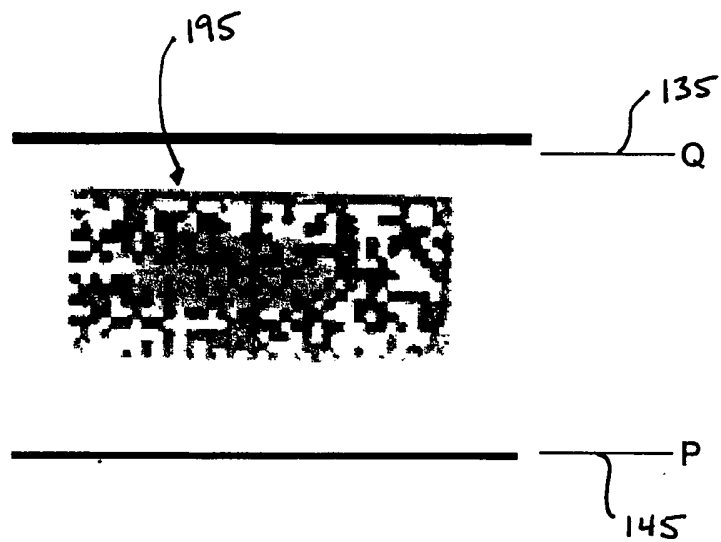

FIG. 7

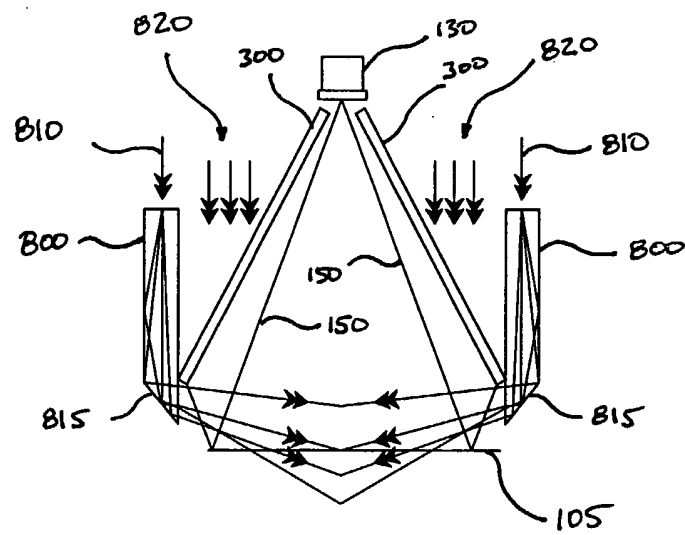

FIG. 8



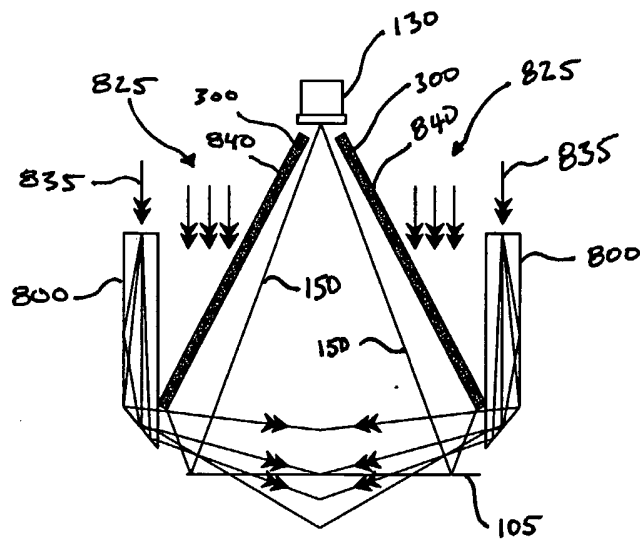

FIG. 9

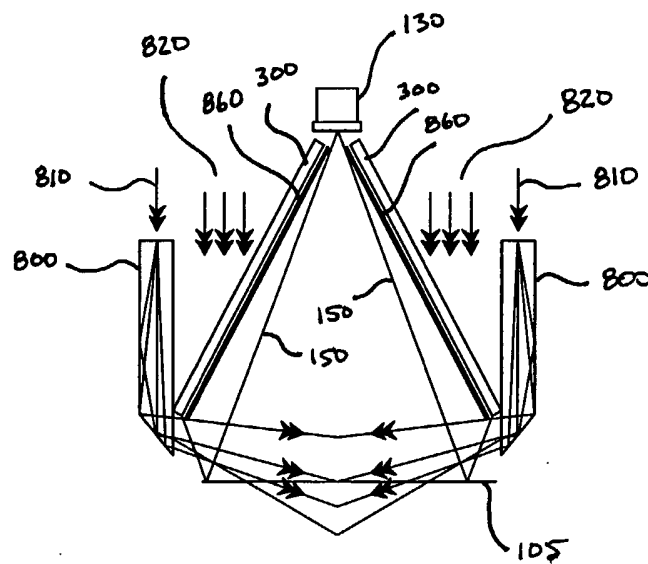

FIG. 10

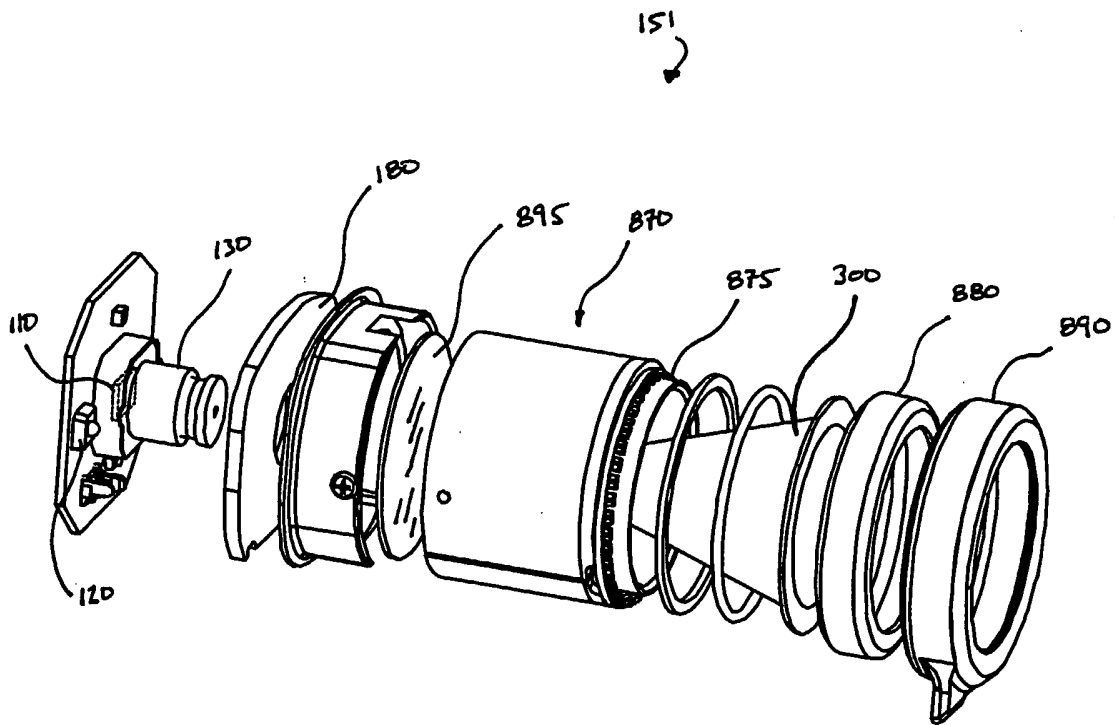

Fig. 11

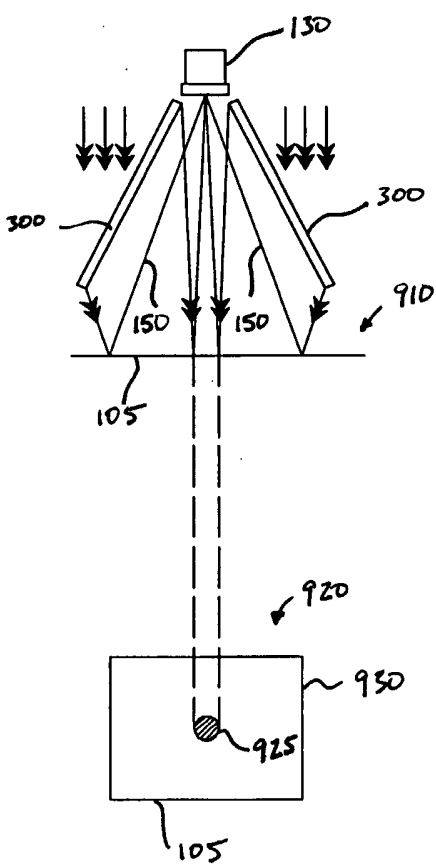

FIG. 12

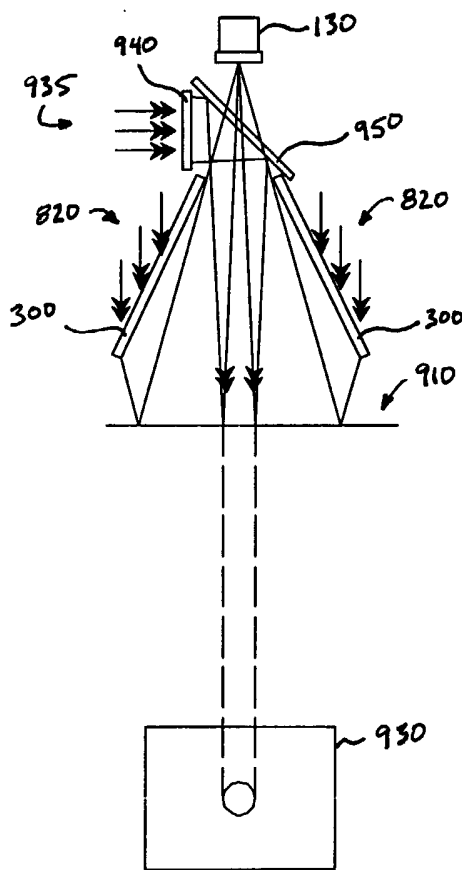

FIG. 13

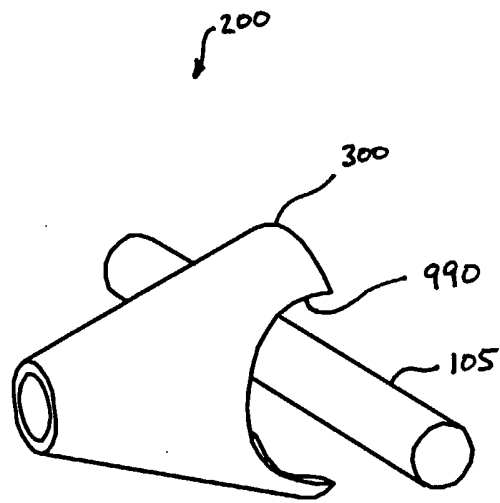

FIG. 14

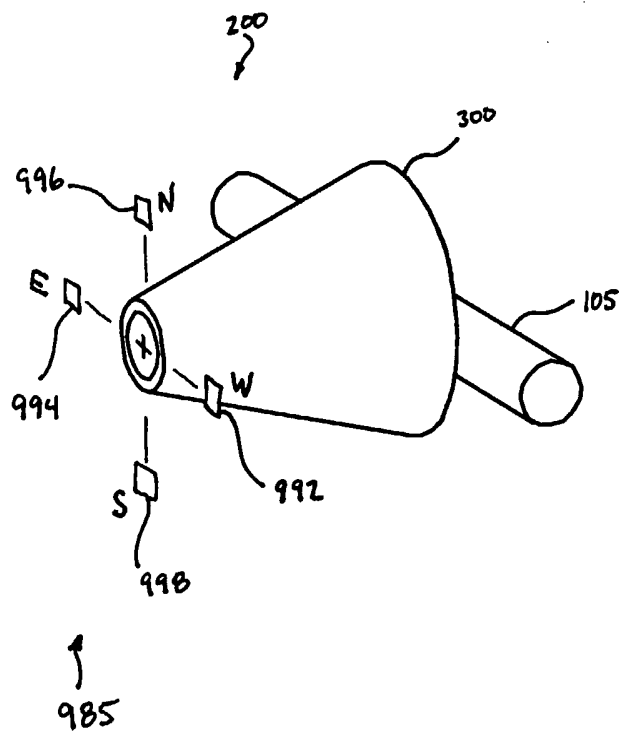

FIG. 15

**INTERNATIONAL SEARCH REPORT**

International application No  
/US2005/044452

**A. CLASSIFICATION OF SUBJECT MATTER**  
G06K7/10

According to International Patent Classification (IPC) or to both national classification and IPC

**B. FIELDS SEARCHED**

Minimum documentation searched (classification system followed by classification symbols)  
G06K

Documentation searched other than minimum documentation to the extent that such documents are included in the fields searched

Electronic data base consulted during the international search (name of data base and, where practical, search terms used)  
EPO-Internal, WPI Data, PAJ

<b>C. DOCUMENTS CONSIDERED TO BE RELEVANT</b>		
Category*	Citation of document, with indication, where appropriate, of the relevant passages	Relevant to claim No.
A	US 6 065 678 A (LI ET AL) 23 May 2000 (2000-05-23) page 4, line 1 - page 10, line 29; figures 1-3	1, 14, 19
A	WO 99/49347 A (AUTO IMAGE ID, INC) 30 September 1999 (1999-09-30) page 4, line 1 - page 10, line 29; figures 1-3	1, 14, 19

Further documents are listed in the continuation of Box C.

See patent family annex.

\* Special categories of cited documents :

- \*A\* document defining the general state of the art which is not considered to be of particular relevance
- \*E\* earlier document but published on or after the international filing date
- \*L\* document which may throw doubts on priority claim(s) or which is cited to establish the publication date of another citation or other special reason (as specified)
- \*O\* document referring to an oral disclosure, use, exhibition or other means
- \*P\* document published prior to the international filing date but later than the priority date claimed

- \*T\* later document published after the international filing date or priority date and not in conflict with the application but cited to understand the principle or theory underlying the invention
- \*X\* document of particular relevance; the claimed invention cannot be considered novel or cannot be considered to involve an inventive step when the document is taken alone
- \*Y\* document of particular relevance; the claimed invention cannot be considered to involve an inventive step when the document is combined with one or more other such documents, such combination being obvious to a person skilled in the art.
- \*&\* document member of the same patent family

Date of the actual completion of the international search  13 March 2006	Date of mailing of the international search report  20/03/2006
Name and mailing address of the ISA/ European Patent Office, P.B. 5818 Patentlaan 2 NL - 2280 HV Rijswijk Tel. (+31-70) 340-2040, Tx. 31 651 epo nl, Fax: (+31-70) 340-3016	Authorized officer  Schmidt, R

# INTERNATIONAL SEARCH REPORT

Information on patent family members

International application No

/US2005/044452

Patent document cited in search report	Publication date	Patent family member(s)	Publication date
US 6065678	A	US 5859418 A	12-01-1999
WO 9949347	A	AU 3090199 A	18-10-1999
		CA 2324626 A1	30-09-1999
		EP 1064580 A1	03-01-2001
		JP 2002507779 T	12-03-2002
		MX PA00009228 A	03-12-2004
		NO 20004706 A	27-10-2000