

(19)



(11)

**EP 3 519 302 B1**

(12)

**EUROPEAN PATENT SPECIFICATION**

(45) Date of publication and mention of the grant of the patent:  
**12.07.2023 Bulletin 2023/28**

(21) Application number: **17857299.6**

(22) Date of filing: **27.09.2017**

(51) International Patent Classification (IPC):  
**B65B 9/02** <sup>(2006.01)</sup>      **G07F 11/16** <sup>(2006.01)</sup>  
**G07F 11/44** <sup>(2006.01)</sup>      **G07F 11/60** <sup>(2006.01)</sup>  
**G07F 9/10** <sup>(2006.01)</sup>

(52) Cooperative Patent Classification (CPC):  
**B65B 9/02; G07F 9/10; G07F 11/165; G07F 11/44; G07F 11/60; G07F 17/0092; B65B 2039/009**

(86) International application number:  
**PCT/US2017/053593**

(87) International publication number:  
**WO 2018/064095 (05.04.2018 Gazette 2018/14)**

(54) **PHARMACY PACKAGING SYSTEM**

ARZNEIMITTELVERPACKUNGSSYSTEM

SYSTÈME D'EMBALLAGE DE PHARMACIE

(84) Designated Contracting States:  
**AL AT BE BG CH CY CZ DE DK EE ES FI FR GB GR HR HU IE IS IT LI LT LU LV MC MK MT NL NO PL PT RO RS SE SI SK SM TR**

(30) Priority: **27.09.2016 US 201615277500**

(43) Date of publication of application:  
**07.08.2019 Bulletin 2019/32**

(73) Proprietor: **RxSafe, LLC**  
**San Marcos, CA 90269 (US)**

(72) Inventor: **HOLMES, William, K.**  
**San Diego**  
**CA 92131 (US)**

(74) Representative: **Barker Brettell LLP**  
**100 Hagley Road**  
**Edgbaston**  
**Birmingham B16 8QQ (GB)**

(56) References cited:  
**EP-A1- 0 947 425**      **JP-A- 2006 321 516**  
**US-A- 2 960 808**      **US-A- 3 439 469**  
**US-A- 3 552 087**      **US-A- 5 029 430**  
**US-A1- 2013 318 931**      **US-A1- 2017 015 445**  
**US-B1- 6 478 041**

**EP 3 519 302 B1**

Note: Within nine months of the publication of the mention of the grant of the European patent in the European Patent Bulletin, any person may give notice to the European Patent Office of opposition to that patent, in accordance with the Implementing Regulations. Notice of opposition shall not be deemed to have been filed until the opposition fee has been paid. (Art. 99(1) European Patent Convention).

**Description**

## FIELD OF THE INVENTION

**[0001]** The present invention relates to a unit and method for packaging pharmaceuticals. A prior art unit is shown in document US 2013/318931.

## SUMMARY

**[0002]** In one non-claimed example, the disclosure provides a system for storing and packaging pharmaceuticals. The system includes a frame configured to store canisters that contain pharmaceuticals and a canister-moving assembly coupled to the frame. The canister-moving assembly is operable to move relative to the frame to retrieve the canisters from the frame. The system also includes a dispensing area positioned adjacent the frame to receive the canisters from the canister-moving assembly. The dispensing area is operable to selectively operate the canisters. The system further includes packaging equipment in communication with the dispensing area. The packaging equipment includes a feed stock roll for forming pouches. The packaging equipment is operable to fill the pouches with pharmaceuticals that are dispensed from the canisters in the dispensing area. The system also includes a control system coupled to the canister-moving assembly and the packaging equipment to control operation of the canister-moving assembly and the packaging equipment.

**[0003]** In another non-claimed example, the disclosure provides a system for storing and retrieving pharmaceuticals. The system includes a storage unit having a frame configured to store canisters that contain pharmaceuticals and a canister-moving assembly coupled to the frame. The canister-moving assembly is operable to move relative to the frame to retrieve the canisters from the frame. The system also includes a packaging unit having a dispensing area positioned adjacent the frame of the storage unit to receive the canisters from the canister-moving assembly. The dispensing area is operable to selectively operate the canisters. The packaging unit also has packaging equipment operable to package pharmaceuticals that are dispensed from the canisters in the dispensing area and a manifold extending from the dispensing area to direct pharmaceuticals that are dispensed from the canisters toward the packaging equipment.

**[0004]** In an embodiment, the invention provides a packaging unit for packaging pharmaceuticals into a pouch. The packaging unit includes packaging equipment operable to form the pouch, a track configured to direct the pharmaceuticals toward the packaging equipment, and a receptacle coupled to the track upstream of the packaging equipment to receive the pharmaceuticals from the track. The receptacle includes a valve mechanism that is movable relative to the track to push the pharmaceuticals into the pouch.

**[0005]** In still another embodiment, the invention provides a method of packaging pharmaceuticals into a pouch using a packaging unit. The packaging unit includes packaging equipment, a track configured to direct the pharmaceuticals toward the packaging equipment, and a receptacle coupled to the track upstream of the packaging equipment. The receptacle includes a valve mechanism. The method includes forming the pouch with the packaging equipment, directing the pharmaceuticals along the track toward the packaging equipment while the valve mechanism is in a raised position, receiving the pharmaceuticals from the track in the pouch, and lowering the valve mechanism to push the pharmaceuticals into the pouch.

**[0006]** Other aspects of the invention will become apparent by consideration of the detailed description and accompanying drawings.

## BRIEF DESCRIPTION OF THE DRAWINGS

**[0007]**

Fig. 1 is a perspective view of a pharmacy packaging system according to one embodiment

Fig. 2 is another perspective view of the pharmacy packaging system shown in Fig. 1.

Fig. 3 is a perspective view of a storage unit of the pharmacy packaging system shown in Fig. 1.

Fig. 4 is a perspective view of an automatic packaging unit of the pharmacy packaging system shown in Fig. 1.

Fig. 5 is a perspective view of a pharmacy packaging system according to another embodiment.

Fig. 6 is a side view of the pharmacy packaging system shown in Fig. 5.

Fig. 7 is a top view of the pharmacy packaging system shown in Fig. 5.

Fig. 8 is a front view of the pharmacy packaging system shown in Fig. 5.

Fig. 9 is a front perspective view of the pharmacy packaging system shown in Fig. 5.

Fig. 10 illustrates another embodiment of a packaging unit for use with the packaging system shown in Fig. 5.

Figs. 11 and 12 illustrate a portion of the packaging unit of Fig. 10 including a motor base and a manifold.

Figs. 13-15 illustrate another portion of the packaging unit of Fig. 10 including the manifold, a receptacle, and a valve mechanism.

Fig. 16 illustrates a pouch with pharmaceuticals packaged inside.

Fig. 17 illustrates a portion of another packaging unit for use in the pharmacy packaging system, the packaging unit including a valve mechanism in a first position.

Fig. 18 illustrates the portion of the packaging unit of Fig. 17 with the valve mechanism in a second position.

Fig. 19 illustrates a series of pouches formed using the packaging unit of Fig. 10.

#### DETAILED DESCRIPTION

**[0008]** Before any embodiments of the invention are explained in detail, it is to be understood that the invention is not limited in its application to the details of construction and the arrangement of components set forth in the following description or illustrated in the following drawings. The invention is capable of other embodiments and of being practiced or of being carried out in various ways within the scope of the independent claims.

**[0009]** Figs. 1 and 2 illustrate an example pharmacy packaging system 10. The illustrated system 10 is a self-contained system that stores, retrieves, and packages pharmaceuticals (e.g., pills, drugs, narcotics, or other medications). Pharmaceuticals may also include nutraceuticals and other types of substances. The system 10 securely stores all of the pharmaceuticals required by a facility in an organized manner. In addition, the system 10 allows a user to retrieve different combinations of those pharmaceuticals through an automated process. In some embodiments, the system 10 can be placed in a facility (e.g., a closed-door pharmacy) that supplies packaged pharmaceuticals to multiple locations. In other embodiments, the system 10 can be placed in a consumer pharmacy or in other locations where a variety of different pharmaceuticals are distributed directly to multiple patients on a regular basis, such as in a nursing home, a hospital, a correctional facility, a home residence, or the like.

**[0010]** In the illustrated embodiment, the system 10 includes a storage unit 14 and two automatic packaging units 18. The storage unit 14 stores a plurality of canisters 22, or containers or cassettes, containing a variety of pharmaceuticals. The packaging units 18 package pharmaceuticals from those canisters 22 into pouches for distribution to patients. In some embodiments, the system 10 may include fewer or more packaging units 18. Additionally or alternatively, the packaging units 18 may be positioned on both sides of the storage unit 14. For example, the system 10 may include four packaging units 18, with two units 18 positioned on each side of the storage unit 14. Such an arrangement allows multiple, independent packaging units 18 to access the same pharmaceutical array.

**[0011]** As shown in Fig. 3, the storage unit 14 includes a frame 26 and a gantry assembly 30. The frame 26 includes a plurality of shelves or other supports for storing the canisters 22 in an array of rows and columns. Each canister 22 is uniformly shaped and sized and may contain pharmaceuticals of the same or different type compared to other canisters 22. In some embodiments, the frame 26 may be, for example, about 427 cm (fourteen feet) wide by 183 cm (six feet) tall by 122 cm (four feet) deep and may store up to 1000 individual canisters 22. In other embodiments, the frame 26 may be larger or

smaller for storing fewer or more canisters 22, as needed by a particular facility.

**[0012]** The gantry assembly 30 is coupled to the frame 26 for retrieving canisters 22 from within the frame 26.

5 The gantry assembly 30 is a canister-moving assembly that is operable to move the canisters 22 within the frame 26. The illustrated gantry assembly 30 is similar to the gantry assembly disclosed in U.S. Patent Application No. 12/870,045, filed August 27, 2010 and published as U.S. Patent Application Publication No. 2011/0054668. The gantry assembly 30 includes a track 34 and a robotic head 38 that is operable to move along the track 34 to retrieve the canisters 22. The track 34 is movable horizontally within the frame 26 to align the robotic head 38 with a specific column of canisters 22. The robotic head 38, or carriage assembly, is movable vertically along the track 34 to align with a specific row of canisters 22. When the robotic head 38 is aligned with the desired canister 22, the head 38 grabs the canister 22 and carries the canister 22 to one of the automatic packaging units 18, as further described below. The robotic head 38 can also retrieve a canister 22 from the packaging unit 18 and return the canister 22 to the proper column and row within the frame 26. In some embodiments, the canisters 22 may not be assigned the same location. In these embodiments, the robotic head 38 may retrieve a canister 22 from the packaging unit 18 and return the canister 22 to a random location. The packaging unit 18 may then store the new location of the canister 22. In some embodiments, a return location of the canister 22 may be determined based on, for example, the frequency of use the canister 22, the size of the canister 22, or the like.

**[0013]** Fig. 4 illustrates one of the automatic packaging units 18. The packaging unit 18 includes a cabinet 42, a dispensing area 46, and a control system 50. The illustrated cabinet 42 may be about 61 cm (two feet) deep such that the entire system 10 is about 183 cm (six feet) deep with a packaging unit 18 on each side of the frame 26. The cabinet 42 contains equipment for packaging pharmaceuticals into pouches. In the illustrated embodiment, the packaging equipment includes a feed stock roll 54 and a take-up roll 58 that are positioned within the cabinet 42. The feed stock roll 54 unrolls the pouches, which are then filled with pharmaceuticals from the canisters 22A in the dispensing area 46. The pouch is run along a track underneath all of the active canisters 22A and filled with the requested number and type of pharmaceuticals from the appropriate canisters 22A. Such an arrangement reduces the possibility of cross-contamination between the canisters 22A and, thereby, the pharmaceuticals. Once a pouch is filled, the pouch is discharged from the cabinet 42 through an outlet 62. In the illustrated embodiment, the outlet 62 drops the filled pouches into a tote 66 so the pouches can be retrieved by a user. In other non-claimed examples, the packaging equipment may be configured to package the pharmaceuticals into blister packs, pharmacy vials, or other suitable containers.

**[0014]** In some embodiments, the packaging units 18 may include rollers, castors, or other types of wheels. The wheels allow a user to roll the packaging units 18 toward and away from the storage unit 14 in a modular fashion. Such an arrangement provides redundancy by allowing each of the units 18 to quickly and easily be replaced. In addition, the packaging units 18 may be interchanged if pharmaceuticals need to be packaged in a different size and/or type of packaging container.

**[0015]** The illustrated dispensing area 46 is positioned on top of the cabinet 42 adjacent the frame 26 of the storage unit 14. The dispensing area 46 temporarily stores a series of active canisters 22A that are used to fill the pouches within the cabinet 42. In the illustrated embodiment, the dispensing area 46 stores up to twenty active canisters 22A at a time. Such an arrangement allows a pouch to be filled with twenty different types of pharmaceuticals. In other embodiments, the dispensing area 46 may store fewer or more active canisters 22A. The illustrated dispensing area 46 includes motors and sensors that are temporarily connected to each of the active canisters 22A. For example, one motor and one sensor may electrically connect to each active canister 22A to selectively open and close the canister 22A and to monitor the amount (e.g., number, volume, etc.) of pharmaceuticals being dispensed from the canister 22A. In particular, the motor of the dispensing area 46 rotates a rotor within the corresponding canister 22A to selectively dispense pharmaceuticals out of the canister 22A. In some embodiments, selectively operating the canister 22A includes rotating a base of the canister 22A to dispense a pharmaceutical through an opening. When operated, the canisters 22A drop pharmaceuticals into the pouches. In the illustrated embodiment, the pharmaceuticals are dispensed from the canisters 22A via gravity. In other embodiments, the packaging equipment may generate a vacuum to draw the pharmaceuticals out of the canisters 22A. Metering devices may also be coupled to each active canister 22A to help control the amount of pharmaceuticals being dispensed.

**[0016]** In some embodiments, the automatic packaging unit 18 may include an inspection device that inspects the pharmaceuticals before they are packaged in the pouches. After the pharmaceuticals come out of the active canisters 22A, the pharmaceuticals may be temporarily collected in an intermediate catch basin. A sensor (e.g., a camera, etc.) may inspect the pharmaceuticals in the basin based on, for example, color, shape, infrared images, shape recognition, or pill imprints. The sensor may alternatively inspect the pharmaceuticals with spectrography, magnetic resonance, or the like. Once the pharmaceuticals are verified, the pharmaceuticals can be released from the basin into the corresponding pouch. Inspection of the pharmaceuticals may be entirely automated or may involve a person (e.g., a remote operator who views images of the pharmaceuticals).

**[0017]** The control system 50 is electrically coupled to the packaging equipment and the gantry assembly 30 to

control operation of the packaging system 10. In particular, the control system 50 coordinates movement of the gantry assembly 30 to move the canisters 22 between the storage unit 14 and the packaging unit 18, controls operation of the feed stock roll 54 to release a pouch, and controls when the active canisters 22A positioned in the dispensing area 46 are operated. The illustrated control system 50 includes a monitor 70 mounted to a shelf 74 that extends from the cabinet 42. The control system 50 may also include a processor, a memory, and an input device (e.g., a keyboard) that allows a user to interface with the system 50. In some embodiments, the monitor 70 may include a touch screen.

**[0018]** Referring back to Figs. 1 and 2, during operation, a user interacts with the packaging system 10 through the control systems 50 on the packaging units 18. The user may input the name of a patient and/or a particular combination of pharmaceuticals needed. Once the necessary data is inputted, the gantry assembly 30 moves relative to the frame 26 to retrieve the proper canisters 22 from the storage unit 14 and carry the canisters 22 to the dispensing area 46. In the illustrated embodiment, the robotic head 38 of the gantry assembly 30 carries one canister 22 at a time, but alternates between carrying a canister 22 to the dispensing area 46 and removing a canister 22 from the dispensing area 46, thereby limiting excess movements of the gantry assembly 30. In some embodiments, the packaging system 10 may include more than one robotic head 38 or more than one gantry assembly 30. In these embodiments, multiple canisters 22 may be carried at a time between the storage unit 14 and the dispensing area 46. In some embodiments, a user interacts with the packaging system 10 via a remote device (e.g., a tablet, smart phone, laptop, or client computer) that enables the user to remotely control or otherwise interact with the packaging system 10.

**[0019]** After the proper canisters 22 are positioned in the dispensing area, the packaging equipment within the cabinet 42 fills a pouch with the desired pharmaceuticals. For example, a strip of pouches may be filled with a week's supply of assorted pharmaceuticals for a particular patient. By connecting two packaging units 18 to the storage unit 14, a user (or multiple users) can simultaneously input data and fill two strips of pouches with pharmaceuticals for different patients. In some embodiments, the packaging equipment may include a printer to print a patient's name, the date, the amount and type of pharmaceuticals contained within, a bar code, or other indicia on the pouches. Once a pouch is filled and labeled, the pouch is dropped into the corresponding tote 66.

**[0020]** As the pouches are being filled, the control system 50 tracks and monitors the amount and types of pharmaceuticals within the system 10. For example, the control system 50 can verify that a user is authorized to retrieve certain pharmaceuticals, that a patient has a prescription for a particular pharmaceutical, and the quantity of pharmaceuticals remaining in each canister 22. The control system 50 can also track where a particular can-

ister of pharmaceuticals is positioned within the system 10 (i.e., whether the canister 22 is currently stored in the storage unit 14 or one of the dispensing areas 46, and in which row and column of the frame 26 the canister 22 belongs).

**[0021]** In some embodiments, the filling of orders can be optimized by the control system 50. For example, a user can input all of the orders that need to be filled by the system 10 in a given day. The control system 10 can then determine in which order to process those orders to minimize the number of times the canisters 22 move between the storage unit 14 and the dispensing areas 46 of the packaging units 18. In other embodiments, the control system 50 may optimize the orders such that all of the orders for a particular patient or facility are filled consecutively. In further embodiments, the user may program the control system 50 so that a particular order is filled immediately and/or the orders are filled in the order in which they were requested.

**[0022]** In still further embodiments, the control system 50 can be programmed to fill a spool of pouches with the same drug or other pharmaceutical. For example, the control system 50 can fill a series of 50 to 500 pouches with an individual drug or narcotic for pharmacies, nursing homes, hospitals, or other facilities to keep as stock drugs in emergency drug kits.

**[0023]** As shown in Figs. 1 and 2, the packaging system 10 also includes two refill areas 78 positioned above the dispensing areas 46 of the packaging units 18. In other embodiments, the system 10 may only include a single refill area and/or the refill areas 78 may be positioned in different locations relative to the packaging units 18. The refill areas 78 may be manually stocked with canisters 22 by a user. When one of the canisters 22 stored within the storage unit 14 is depleted, the gantry assembly 30 can remove the empty canister, place that canister in the refill area 78, and grab a replacement canister from the refill area 78. The gantry assembly 30 can then position the replacement canister in the proper row and column within the frame 26. In some embodiments, the control system 50 can alert a user when a particular canister 22 is empty or near empty so that the user can place a suitable replacement canister 22 within the refill area 78 and input information notifying the system 50 of the replacement canister 22.

**[0024]** The illustrated packaging system 10 increases the speed at which pouches of pharmaceuticals can be filled at an on-site facility and reduces the possibility of errors when filling those pouches. In the illustrated embodiment, the system 10 can achieve a throughput of up to sixty pouches per minute, including verification, for each automatic packaging unit 18 included in the system 10. The automated system 10 also avoids cross-contamination caused by mixing pharmaceuticals between pouches through a common pathway. In some embodiments, the packaging equipment generates vacuum to remove dust and clean the pathways. In other embodiments, the packing system may use designate certain

pathways to certain pharmaceuticals to reduce or eliminate cross-contamination.

**[0025]** In some embodiments, the automatic packaging units 18 may operate separately from the storage unit 14. In such embodiments, each packaging unit 18 may be a standalone packaging system for use in smaller pharmacies or other low-volume facilities. In addition, the dispensing areas 46 of the packaging units 18 may be manually loaded, as needed, to fill specific pharmaceutical orders.

**[0026]** Figs. 5-9 illustrate an example pharmacy packaging system 110. Similar to the packaging system 10 discussed above with reference to Figs. 1-4, the illustrated packaging system 110 includes a storage unit 114 and multiple automatic packaging units 118. As shown in Fig. 7, the packaging system 110 includes four packaging units 118, with two units 118 positioned adjacent each side of the storage unit 114 to access canisters 122. In other embodiments, the packaging system 110 may include fewer or more packaging units 118.

**[0027]** Referring back to Figs. 5 and 6, the storage unit 114 includes a frame 126 and a gantry assembly 130. The frame 126 includes a plurality of shelves for storing the canisters 122 in an array of rows and columns. In some embodiments, panels may be coupled to and extend across the frame 126 to enclose the frame 126 such that the canisters 122 are secured within the system 110. The illustrated canisters 122 are non-motorized canisters suitable for storing pharmaceuticals. The gantry assembly 130, or canister-moving assembly, is similar to the gantry assembly 30 discussed above and can move along the frame 126 to retrieve the canisters 122. In the illustrated embodiment, the gantry assembly 130 is positioned between two arrays, or stacks, of canisters 122 such that the gantry assembly 130 can access the canisters 122 on both sides of the storage unit 114.

**[0028]** Each packaging unit 114 includes a motor base 134 positioned adjacent the frame 126 of the storage unit 114 and a manifold 138 coupled to and extending from the motor base 134. The motor bases 134 are offset from the other shelves of the frame 126 and include ledges 142 for supporting active canisters 122A. The illustrated motor bases 134 are only offset from the other shelves a relatively short distance to reduce the range of horizontal movement required by the gantry assembly 130 to place canisters 122 on or remove canisters 122 from the ledges 142. In the illustrated embodiment, each motor base 134 supports up to twenty active canisters 122A at a time in a single, horizontal row. In other embodiments, each motor base 134 may support fewer or more active canisters 122A and/or the motor bases 134 may be configured to support the active canisters 122A in multiple rows (e.g., two rows of ten, three rows of seven, etc.). Each motor base 134 includes one or more motors operable to operate the active canisters 122A to dispense the pharmaceuticals stored within the canisters 122A. The motor bases 134 thereby provide dispensing areas for the active canisters 122A.

**[0029]** As shown in Fig. 5, the motor bases 134 define openings 146, or inlets, in the ledge 142 that correspond to the active canisters 122A. The motor bases 134 also include a switch 150 adjacent each opening 146. When a canister 122A is positioned on the ledge 142, the canister 122A communicates with the opening 146 and activates the switch 150. The switch 150 indicates to the motor base 134 that a canister is currently positioned on the ledge 142. The motors in the motor base 134 can then operate the canister 122A (e.g., by rotating a disk on the bottom of the canister 122A) to dispense pharmaceuticals into the opening 146. In some embodiments, an infrared beam may detect when pharmaceuticals pass through each of the openings 146. The pharmaceuticals travel through the motor base 134 and are ejected through an outlet 154 formed in a face of the motor base 134. The outlets 154 dispense the pharmaceuticals from the motor base 134 into the corresponding manifold 138.

**[0030]** The manifold 138 directs pharmaceuticals from the motor base 134 toward packaging equipment of the corresponding packaging unit 118. The motor bases 134 are positioned generally above the packaging equipment such that pharmaceuticals slide down the manifold 138 toward the packaging equipment. In the illustrated embodiment, the manifolds 138 are funnels or chutes that are generally triangular and may be formed of, for example, stainless steel. In some embodiments, each manifold 138 may include a cover to inhibit pharmaceuticals from bouncing out of the manifold 138. In such embodiments, the cover may be formed of, for example, clear plastic to help visually monitor operation of the system 110. In addition, the cover may be easily liftable or otherwise separable from the manifold 138 to facilitate cleaning the manifold 138. In some embodiments, each manifold 138 may include discrete tracks (e.g., raceways or pathways) to direct pharmaceuticals from the corresponding outlets 154 in the motor base 134 toward the packaging equipment.

**[0031]** The packaging equipment of the automatic packaging units 118 collect the pharmaceuticals from the manifolds 138 and package the pharmaceuticals into pouches. In the illustrated embodiment, each packaging unit 118 includes a receptacle 158 that communicates with the corresponding manifold 138. The receptacle 158 collects all of the desired pharmaceuticals from the different active canisters 122A before delivering the pharmaceuticals in a single group to the packaging equipment. A camera 162 is coupled to the receptacle 158 to take photographs of the pharmaceuticals as the pharmaceuticals pass into the packaging equipment. In some embodiments, multiple cameras may be coupled to the receptacle 158 to take photographs of the pharmaceuticals from different reference angles. The photographs can be checked by a computer and/or a pharmacist remotely or on-site to verify that the correct pharmaceuticals are being packaged.

**[0032]** In other embodiments, a camera (or other sensor) may be positioned at each outlet 154 in the motor

base 134. In such embodiments, the camera can look at a pill from its origin and determine whether the correct pharmaceutical is being dispensed by comparing an image of the pharmaceutical to a stored image of the expected pharmaceutical. For example, the camera can compare a pill's color, contour, shape, size, and/or inscription to the color, contour, shape, size, and/or inscription of a known pill.

**[0033]** In the illustrated embodiment, the packaging equipment of each packaging unit 118 includes two feed stock rolls 166, 170 and a take-up roll 174. After the pharmaceuticals pass through the receptacle 158, the pharmaceuticals are sandwiched between two strips of material (e.g., plastic) from the feed stock rolls 166, 170. The strips of material are then heat sealed together to form a pouch for the pharmaceuticals. In some embodiments, such as the embodiment shown in Figs. 10-15 and described below, each receptacle 158 may include a shutter or valve mechanism that temporarily stops the pharmaceuticals before they are captured in a pouch. Once formed, the pouches are wrapped around the take-up roll 174 to create a single spool of pouches. In some embodiments, a camera (or other sensor) may be positioned upstream of the take-up roll 174 to verify, for example, that the correct number of pharmaceuticals are packaged within each pouch. The spool may correspond to pharmaceuticals requested by a particular patient or a particular facility. In other embodiments, the pouches may be cut and separated as they are filled, rather than spooled onto the take-up roll 174 continuously.

**[0034]** In some embodiments, the packaging units 118 may include equipment for packaging pharmaceuticals in a blister pack or card, rather than a pouch. Alternatively, the packaging units 118 may include equipment for packaging pharmaceuticals in a pharmacy vial. In such embodiments, the feed stock rolls 166, 170 and the take-up roll 174 may be removed and replaced with other suitable packaging equipment. Furthermore, the packaging system 110 may include a variety of different packaging units 118 to package the pharmaceuticals into a combination of pouches, blister cards, and/or pharmacy vials. In some embodiments, pharmaceuticals may be packaged into different types of packaging containers at the same time by using the packaging units 118 having different types of packaging equipment.

**[0035]** In some embodiments, each packaging unit 118 may include a printer to print a patient's name, the date, the amount and type of pharmaceuticals contained within, a bar code, and/or other indicia on the pouches as the pouches are formed. The printer may be, for example, a thermal printer. In other embodiments, the printer may include an ink ribbon or an inkjet. In addition, each packaging unit 118 may include a bar code scanner or vision system to monitor and check the pouches as they are spooled onto the take-up roll 174 or cut.

**[0036]** In some embodiments, the packaging units 118 may include rollers, castors, or other types of wheels. The wheels allow a user to roll the packaging units 118

toward and away from the storage unit 114 in a modular fashion. In the illustrated embodiment, the packaging units 118 can be easily connected to the storage unit 114 by aligning the motor bases 134 with designated areas of the frame 126. When the units 114, 118 are connected, a single control system can communicate with the storage unit 114 to control operation of the gantry assembly 130 and with the packaging units 118 to control operation of the packaging equipment. Such an arrangement allows the packaging units 118 to be quickly exchanged to package pharmaceuticals in different types and/or sizes of pouches or for maintenance.

**[0037]** The illustrated packaging system 110 includes a control system that functions in a similar manner to the control system 50 discussed above. A user can interact with the packaging system 110 through the control system to input patient information, facility information, and/or the pharmaceuticals needed. The control system can control movement of the gantry assembly 130 to move canisters 122 from the shelves of the storage unit 114 to one of the motor bases 134. In addition, the control system can control operation of the motor bases 134 to selectively operate the active canisters 122A. Furthermore, the control system may optimize orders by minimizing movement of the gantry assembly 130 and canisters 122 or by filling all the orders for a particular patient or facility consecutively.

**[0038]** As shown in Figs. 8 and 9, the packaging system 110 also includes a refill unit 178 coupled to the storage unit 114. The refill unit 178 includes an input port 182 and an output port 186. When a canister 122 is empty, the gantry assembly 130 can move the canister 122 to the output port 186. The control system may notify a user that a canister is in the output port 186 with an audible noise, email, or other alert. The user can then remove the canister 122 from the output port 186, fill the canister 122 with suitable pharmaceuticals, and return the filled canister 122 to the system through the input port 182. The illustrated input port 182 includes an internal scale 190 that weighs the filled canister 122 to determine how many pharmaceuticals were added to the canister 122. The scale 190 may be internal to the packaging system 110 to inhibit tampering, air flow, and the like from disturbing the canisters 122 while being weighed. In some embodiments, the refill unit 178 may also include bar code scanners that automatically scan the canister 122 as it is removed from and returned to the system 110. Such an arrangement limits the number of canisters being removed from the system 110 at a time to reduce the possibility of refilling error. In addition, such an arrangement allows a user to easily access any of the canisters 122 within the system 110 without having to use a ladder or stool to reach the top row of canisters. In some embodiments, the canisters 122 also include RFID tags which can be read at each port 182, 186, as well as the filling stations, to help track the canisters 122 within the packaging system 110.

**[0039]** In other embodiments, a particular area (e.g., a

portion of some rows and/or columns) within the storage unit 114 may be designated as the refill area. In such embodiments, the gantry assembly 130 may move empty canisters 122 to this area for refilling by a user. When a filled canister is placed in the refill area, a user may interact with the control system to notify the system 110 of the location of the filled canister and the type/number of pharmaceuticals contained therein. The gantry assembly 130 may carry the canister from the refill area to its proper location within the storage unit 114.

**[0040]** In some embodiments, one motor base 134, one manifold 138, and one packaging unit 118 may operate together as a standalone packaging system. Such a system has a relatively small footprint for use in lower volume pharmacies or facilities. In these embodiments, a user may manually place and remove canisters 122 on the motor base 134, as needed, to package pharmaceuticals using the packaging unit 118. In addition, the motor base 134 may be moved relatively lower and/or divided into multiple rows to facilitate access by a user.

**[0041]** Figs. 10-15 illustrate another embodiment of a packaging unit 218 for use with the packaging system 110. Similar to the packaging unit 118 discussed above, the illustrated packaging unit 218 includes a motor base 222, a manifold 226, a receptacle 230, two feed stock rolls 234, 238, and a take-up roll 242.

**[0042]** As shown in Figs. 10-12, the manifold 226 includes a plurality of discrete tracks 246 corresponding to each of the canisters 122 mounted on the motor base 222. The illustrated tracks 246 are independent channels that together form the manifold 226. The tracks 246 isolate the pharmaceuticals from each other as the pharmaceuticals slide down the manifold to the receptacle.

**[0043]** As shown in Figs. 11 and 12, cameras 250 are mounted to the motor base 222 adjacent outlets in the base 222. Each camera 250 is associated with one of the canisters 122 supported on the base 222. The cameras 250 are operable to determine whether the proper number and/or type of pharmaceuticals are being dispensed from the canisters 122. The cameras 250 capture images of pharmaceuticals exiting the motor base 222 and compare features (e.g., color, contour, size, shape, inscription, etc.) of the pharmaceuticals to stored images of known pharmaceuticals. In some embodiments, recognition software may be employed to automatically compare the images captured by the cameras 250 to stored images. In other embodiments, the captured images may be transmitted to a remotely-located pharmacist or technician who analyzes the images and verifies that the correct number and type of pharmaceuticals were dispensed. In further embodiments, the cameras 250 may be infrared sensors that only detect whether an object (e.g., a pill) drops through the motor base 22, rather than identifying the particular type of pharmaceutical.

**[0044]** As shown in Figs. 13-15, the receptacle 230 receives the pharmaceuticals from each of the tracks 246 in the manifold 226. In the illustrated embodiment, the receptacle 230 includes a shutter or valve mechanism

254 that temporarily stops the pharmaceuticals before the pharmaceuticals are collected in a pouch by the feed stock rolls 234, 238. The illustrated shutter mechanism 254 includes a plunger or pushrod 258 that is movable between a first or lowered position (Fig. 14) and a second or raised position (Fig. 15). When in the lowered position, the plunger 258 blocks the pharmaceuticals from traveling out of the manifold 226. When in the raised position, the plunger 258 is moved out of the way to allow the pharmaceuticals to pass toward the packaging equipment (e.g., the feed stock rolls 234, 238). In some embodiments, the shutter mechanism 254 may include a solenoid or other suitable actuator to raise and lower the plunger 258.

**[0045]** In operation, the plunger 258 is initially in the lowered position (Fig. 14) to temporarily stop the pharmaceuticals. The plunger 258 remains in this position until all the requested pharmaceuticals are gathered in the receptacle 230. If an excess or incorrect pharmaceutical is dispensed from the canisters 122 (which may be determined by the cameras 250), a gust of air, deflector, or trapdoor may be employed to remove that pharmaceutical from the receptacle 230 or from the manifold 226 before the pharmaceutical reaches the receptacle 230. In some embodiments, detecting whether an excess or incorrect pharmaceutical may include inspecting a pharmaceutical when the pharmaceutical is in flight (e.g., dropping from the motor base 222 into the manifold 226) as it is released from a canister 122. The cameras 250 mounted on the motor base 222 may be used to identify each dispensed pharmaceutical, for example, by reading an inscription on the pill. The cameras 250 may be high-speed camera and may include prisms and/or mirrors to capture an all-around image of a dispensed pharmaceutical. The control system may then process the image captured by the high-speed camera 250 to determine whether a correct or intact pharmaceutical was dispensed from the canisters 122. Once the proper pharmaceuticals are within the receptacle 230, the plunger 258 is actuated to the raised position (Fig. 15) such that the pharmaceuticals can be packaged in a pouch. The plunger 258 is then re-actuated to the lowered position to help push the pharmaceuticals into the pouch and await the next batch of pharmaceuticals.

**[0046]** Fig. 16 illustrates a pouch 300 containing different pharmaceuticals 304 therein. The illustrated pouch 300 is an example of a pouch that may be formed using the packaging equipment of the packaging units 18, 118, 218 described above. The pouch 300 is a clear plastic (e.g., cellophane) bag having three closed edges 308 and an open edge 312. A heat seal 316 extends across the pouch 300 adjacent the open edge 312 to seal the pouch 300. In some embodiments, all four edges 308, 312 of the pouch 300 may be closed via heat seals. Additionally or alternatively, the pouch 300 may be composed of an opaque and/or non-plastic material. For example, one or both sides of the material may be opaque or colored (e.g., amber colored). As discussed above,

identification indicia 320 (e.g., a patient's name, a barcode, types of pharmaceuticals, etc.) are printed on the pouch 300 using, for example, a thermal printer, an inkjet printer, a thermal transfer ribbon, or the like. In other embodiments, the identification indicia 320 may be printed on a label that is coupled to the pouch 300 with adhesives. In further embodiments, the pouch 300 may include a header area and/or a footer area without medication, but that provides space to print or apply the indicia 320. In some embodiments, the packaging unit 218 may dispense empty (i.e., non-filled) pouches including certain information for a patient. The information may include, for example, instructions on how or when to take the pharmaceuticals, reminders to get new batch of pharmaceuticals, or the like.

**[0047]** Referring back to Fig. 10, the packaging unit 218 also includes a visual inspection system 324. The illustrated visual inspection system 324 is mounted to the packaging equipment, rather than the motor base 222. The visual inspection system 324 includes a camera or other suitable sensor. The camera looks at the contents of each pouch 300 after the pouches 300 are filled. The camera also looks at the indicia 320 (e.g., a barcode) printed on each pouch 300. The system 324 can then compare the detected pouch contents to the expected pouch contents to verify whether the pouch 300 was filled correctly. This arrangement allows the packaging unit 218 to inspect the pouches 300 in real time. The packaging unit 218 can make corrections, stop operation, and/or notify a user if errors are detected. In the illustrated embodiment, the visual inspection system 324 is located on one side of the packaging strip. In this arrangement, the visual inspection system 324 can infer the indicia 320 on the pouch 300 by knowing what was printed and tracking the location of the packaging strip. Alternatively, if the pouch 300 is made of clear material, the camera of the visual inspection system 324 can look through the pouch 300 to read the indicia. In such embodiments, the visual inspection system 324 may include a processor with software or firmware that reverses and interprets the indicia 320. In other embodiments, the visual inspection system 324 may include two cameras located on both sides of the packaging strip (e.g., one camera to verify the contents of the pouch 300, and one camera to read the indicia 320). In further embodiments, a mirror may be mounted to the packaging equipment so that the camera of the visual inspection system 324 can see around and on both sides of the packaging strip.

**[0048]** The visual inspection system 324 may be used in conjunction with or independently of the cameras 250 on the motor base 222. As noted above, the cameras 250 view the pharmaceuticals as the pharmaceuticals are released by the motor base 222. Since the pharmaceuticals are released in a controlled manner (e.g., without many other pharmaceuticals around) and the cameras 250 are not looking through other materials (e.g., the plastic packaging of the pouch 300), the cameras 250 can accurately view and determine the inscriptions on

the pharmaceuticals (rather than simply relying on shape, color, etc.). The cameras 250 thereby identify each pharmaceutical as the pharmaceuticals are released into the manifold 226. The visual inspection system 324 communicates with the cameras 250 to determine which pharmaceuticals are expected in the pouch 300. The system 324 then verifies that all of the pharmaceuticals reached the pouch 300.

**[0049]** Figs. 17 and 18 illustrate a portion of another packaging unit 400 for use with the packaging system 110. The packaging unit 400 is similar to the packaging unit 218 discussed above. Reference is hereby made to the description of the packaging unit 218 above for description of features and elements of the packaging unit 400 not specifically discussed below.

**[0050]** In the illustrated embodiment, the packaging unit 400 includes a receptacle 404 to control pharmaceuticals (e.g., pills P) as the pharmaceuticals are packaged into a pouch (e.g., the pouch 300 shown in Fig. 16). The receptacle 404 receives pharmaceuticals from one or more tracks (e.g., the tracks 246 of the manifold 226 shown in Fig. 10) and directs the pharmaceuticals toward packaging equipment. As explained above, the packaging equipment can include two feed stock rolls and a take-up roll (e.g., the rolls 234, 238, 242 shown in Fig. 10) to form a pouch. In other embodiments, the packaging equipment can include a single feed stock roll. The receptacle 404 is located upstream of the packaging equipment to receive the pharmaceuticals from the track before the pharmaceuticals reach the packaging equipment.

**[0051]** The illustrated receptacle 404 includes a collection area 408 and a valve mechanism 412. The collection area 408 communicates with the track to receive pharmaceuticals. The valve mechanism 412 blocks the pharmaceuticals before the pharmaceuticals reach the packaging equipment. In the illustrated embodiment, the valve mechanism 412 includes a plunger or injector 416. The plunger 416 is movable relative to the track and the collection area 408 between a first or lowered position (Fig. 17) and a second or raised position (Fig. 18). When in the lowered position, the plunger 416 blocks the pharmaceuticals from moving out of the collection area 408 toward the packaging equipment. When in the raised position, the plunger 416 is moved out of the way to allow the pharmaceuticals to pass toward the packaging equipment. In the illustrated embodiment, the plunger 416 slides linearly between the lowered and raised positions. In some embodiments, the valve mechanism 412 may include a solenoid or other suitable actuator to raise and lower the plunger 416.

**[0052]** The illustrated receptacle 404 also includes a flapper 420. The flapper 420 is located downstream of the collection area 408. The flapper 420 helps manage material 432 being released by the feed stock rolls of the packaging equipment to form pouches. In particular, the flapper 420 extends into a path 424 between the collection area 408 and the packaging equipment and engages

the material 432 to inhibit the material 432 from being torn or from binding. In addition, the flapper 420 helps hold edges of the material 432 close to each other for sealing. In the illustrated embodiment, the flapper 420 is pivotable relative to the path 424 about a pivot shaft 428. In other embodiments, the flapper 420 may move linearly relative to the path 424. In some embodiments, the flapper 420 may be biased by, for example, a spring, into the path 424.

**[0053]** In some embodiments, the flapper 420 may also selectively block the path 424 between the collection area 408 and the packaging equipment. When the plunger 416 is in the raised position (Fig. 18), the illustrated flapper 420 extends into the path 424 between the receptacle 404 and the packaging equipment. In this position, the pharmaceuticals are held above a pouch before the pharmaceuticals are loaded into the pouch. When the plunger 416 is in the lowered position (Fig. 17), the flapper 420 is moved out of the path 424, allowing the plunger 416 to extend through the path 424. If a pharmaceutical was being held on the flapper 420 before the plunger 416 moved to the lowered position, the pharmaceutical is also forced by the plunger 416 into the pouch formed by the packaging equipment. When the plunger 416 is moved back to the raised position, the leading edge of the flapper 420 pushes the two halves of the pouch (i.e., the two strips of material 432) flat against each other.

**[0054]** In other embodiments, the flapper 420 may include a carve-out or recess along its leading edge. The carve-out may generally match the shape and contour of the plunger 416. The carve-out provides a hole for pharmaceuticals to move into a pouch without being blocked by the flapper 420. In such embodiments, the flapper 420 does not pinch the two sides of the pouch tight against each other along an entire edge, but only pushes the two side edges of the pouch close together so the upper edge of the pouch can be closed.

**[0055]** In some embodiments, the plunger 416 is held between the material 432 as the pouch is being formed. More particularly, the pouch is formed by sealing (e.g., heat sealing) the two strips of material 432 along three edges (e.g., the bottom edge and the two side edges). This sealing process can be performed in a single step using a U-shaped sealing mechanism. Before the two strips of material 432 are sealed together, the plunger 416 is positioned between the strips of material 432. The sealing mechanism then creates the seal around the plunger 416. By creating the seal around the plunger 416, the two strips of material 432 are connected together, but do not lie flat against each other. When the plunger 416 is moved to the raised position (Fig. 18), the plunger 416 moves out from between the two strips of material 432, and the pouch is left open at the top. As further explained below, the plunger 416 can be moved back to the lowered position (Fig. 17) to help push the pharmaceuticals into the pouch. The two strips of material 432 can then be advanced so that the plunger 416 is between upstream sections of the material 432. When the next

pouch is ready to be formed, the U-shaped sealing mechanism can again seal the two strips of material 432 along three edges. The bottom seal of this pouch becomes the top seal of the previous pouch. A cutting mechanism can then create, at generally the same time and stroke, a line of serrations through the bottom/top seal between pouches to facilitate later separating the pouches. Alternatively, the cutting mechanism can cut apart the pouches at the seal as the pouches are completed.

**[0056]** Fig. 19 illustrates part of a series or strip of pouches 434 created using the packaging unit 400. The pouches 434 that are sealed along all four edges with heat seals 435. Serrations 437 are formed in the heat seals 435 between the pouches 434 to facilitate separating the pouches 434. As shown in Fig. 19, the pouches can be different lengths to accommodate, for example, different amounts of pharmaceuticals.

**[0057]** Referring back to Figs. 17 and 18, in operation, the valve mechanism 412 physically pushes pharmaceuticals into a pouch to load the pouch, rather than relying on gravity for the pharmaceuticals to fall into the pouch. In particular, the plunger 416 of the valve mechanism 412 is initially in the lowered position (Fig. 17) as the receptacle 404 receives pharmaceuticals from the track. While in the lowered position, the plunger 416 blocks pharmaceuticals from traveling to the packaging equipment so that all of the pharmaceuticals are first collected in the collection area 408. Blocking the pharmaceuticals with the valve mechanism 412 allows the pharmaceuticals to settle together toward the bottom of the collection area 408 while the previous pouch is still being sealed. The valve mechanism 412 inhibits the pharmaceuticals from going into the wrong pouch. The valve mechanism 412, thereby, increases the accuracy and speed of the packaging unit 400 and provides error prevention. The valve mechanism 412 also inhibits the pharmaceuticals from being crushed or damaged in the sealing area of the pouches by the sealing mechanism. Additionally, the pouch is advanced at generally the same speed as the valve mechanism 412 to inhibit the valve mechanism from damaging the pharmaceuticals or the pouch.

**[0058]** During this time, each feed stock roll of the packaging equipment releases material 432 to form a pouch. The material 432 from each feed stock roll forms half of the pouch. The two halves are secured together along three sides or edges (e.g., the bottom and the two sides) to close the sides and form the pouch. In the illustrated embodiment, the sides of the pouch are closed by, for example, heat sealing. Because the pouches are made on-demand from feed stock rolls, the pouches can be made variable in length (e.g., longer or shorter), as shown in Fig. 19, depending on the amount of pharmaceuticals being packaged. For example, pouches are made having lengths between about 2.54 cm and about 8.26 cm (1 inch and about 3 ¼ inches), although other lengths of pouches are also possible. The length of the pouch may be determined automatically by the packaging equipment based on the amount of pharmaceuticals expected

to be loaded into the pouch, and the area needed to print indicia and other information on the pouch. The amount of material needed to form a particular pouch can be identified on the material 432 by an indexing mark (e.g., a black line) drawn on the material 432. Once the packaging equipment sees this mark, the feed stock rolls stop releasing material 432. In embodiments where the packaging equipment only includes a single feed stock roll, the material 432 from the single roll may be folded along one side or edge to close the edge. In either embodiment, the material 432 may be pre-printed with indicia regarding the pharmaceuticals and patient. After the pouch is initially formed, one of the heat sealing elements is moved away from the material 432. This action causes the pouch to open along its upper, unclosed edge.

**[0059]** The illustrated plunger 416 also helps form and shape the pouch. When the plunger 416 is in the lowered position, the plunger 416 is located between the two strips of material 432 that form the pouches. The material 432 can be closed (e.g., heat sealed) along three edges (e.g., the bottom and two sides) to form the initial shape of the pouch. In the illustrated embodiment, the plunger 416 includes a substantially curved outer surface 436 on one side and a substantially flat outer surface 440 on the opposite side. The curved outer surface 436 shapes one of the strips of material 432 in an arch relative to the other strip of material 432. This arrangement causes the arched strip of material 432 to not lie flat against the other strip of material 432, making it easier for pharmaceuticals to fill the pouch. In addition, when the plunger 416 is removed from the pouch, a hole or gap is left between upper edges of the material 432, allowing the pharmaceuticals to more easily move into the pouch.

**[0060]** In some embodiments, once the pouch is formed around the plunger 416, the plunger 416 moves to the raised position (Fig. 18). The pharmaceuticals are then released from the respective canisters 122. The pharmaceuticals fall through the manifold 226 and into the pouch due to gravity. The plunger 416 moves to a second position at the top of the pouch where the opening is formed to help push the pharmaceuticals into the pouch. The plunger 416 then moves to the lowered position (Fig. 17) and the material 432 is advanced by the packaging equipment at generally the same speed that the plunger 416 moves. When the plunger 416 is in the lowered position (Fig. 17), the top of the pouch is sealed along with the sides of a new pouch as described below.

**[0061]** In other embodiments, once all of the required pharmaceuticals are collected in the collection area 408 and the pouch is formed, the plunger 416 moves to the raised position (Fig. 18). The pharmaceuticals then fall out of the collection area 408 toward the flapper 420, which in some embodiments blocks the path 424 to the packaging equipment. The plunger 416 then moves back to the lowered position (Fig. 17) to help push the pharmaceuticals into the pouch. The material 432 is advanced by the packaging equipment at generally the same speed that the plunger 416 moves so the plunger 416 does not

crush or damage the pharmaceuticals, particularly if the pouch is being filled with many pharmaceuticals (e.g., 15-20 pills, or more). Instead, the plunger 416 pushes the pharmaceuticals to move the pharmaceuticals past and out of the way of the sealing mechanism so the sealing mechanism can make the top seal in the pouch. In some embodiments, the plunger 416 may also actuate a cam-type mechanism that moves the flapper 420 slightly ahead of movement of the plunger 416. By helping push the pharmaceuticals into the pouch with the plunger 416, more pharmaceuticals can be loaded into the pouch more reliably. For example, in some embodiments, the plunger 416 may be used to move 10-40 pharmaceuticals into a single pouch. Such volume of pharmaceutical loading into a pouch may not be attainable by relying on gravity alone. In addition, such an arrangement allows more pharmaceuticals to be loaded into a single pouch than conventional devices, which reduces the possibility of confusing a patient by providing all of the pharmaceuticals in a single pouch (rather than multiple pouches each containing a small number of pills).

**[0062]** As the pharmaceuticals are loaded into the pouch by the plunger 416, the material 432 is advanced to begin forming the next pouch around the plunger 416. The flapper 420 is pivoted toward the plunger 416 to help hold edges of the material 432 together. Once the material 432 is sufficiently advanced by the feed stock rolls, a fourth side or edge (e.g., the top) of the pouch is closed by the sealing mechanism. Similar to the other sides, the fourth side of the pouch may be closed by, for example, heat sealing. As noted above, the seal forming the fourth (or top) side of the pouch may also form the bottom seal of the next pouch. This process is continued to create a series of discrete pouches, as shown in Fig. 19.

**[0063]** The receptacle 404 of the packaging unit 400 facilitates loading pharmaceuticals into pouches more accurately, faster, and at a higher capacity than packaging units which rely on gravity feed. As such, the pouches can be filled more reliably.

**[0064]** In some embodiments, the packaging unit 400 may further include a secondary staging area located upstream of the collection area 408 of the receptacle 404. The secondary staging area may include a valve mechanism or flapper that temporarily stops pharmaceuticals to create a delay as the pharmaceuticals travel from the track to the receptacle 404. As such, if the packaging unit 400 determines (via a sensor or camera) that an improper pharmaceutical was dispensed, the second staging area can remove the unwanted pharmaceutical before the pharmaceutical reaches the collection area. In some embodiments, the secondary staging area may remove the unwanted pharmaceutical by pushing the pharmaceutical away with the valve mechanism. In other embodiments, the secondary staging area may remove the unwanted pharmaceutical with a focused gust of air. If the pharmaceutical is verified as being correct, the valve mechanism 412 can open to allow the pharmaceutical to pass into the collection area 408 of the receptacle 404.

**[0065]** Various features and advantages of the invention are set forth in the following claims.

## 5 Claims

1. A packaging unit (118, 218, 400) for packaging pharmaceuticals into a pouch, the packaging unit comprising:

10

packaging equipment operable to form the pouch;

a track (246) configured to direct the pharmaceuticals toward the packaging equipment; and a receptacle (158, 230, 404) coupled to the track upstream of the packaging equipment to receive the pharmaceuticals from the track, the receptacle including a valve mechanism (254, 412) that is movable relative to the track to push the pharmaceuticals into the pouch, **characterised in that** the receptacle further includes a flapper (420), wherein the flapper pushes a first side of the pouch toward a second side of the pouch.

15

20

25

2. The packaging unit of claim 1, wherein the valve mechanism includes a plunger (416) configured to push the pharmaceuticals into the pouch.

30

3. The packaging unit of claim 2, wherein the plunger (416) is movable between a first position to form the pouch around the plunger, a second position to allow the pharmaceuticals to move past the valve mechanism (254, 412) toward the packaging equipment, and a third position to push the pharmaceuticals into the pouch.

35

4. The packaging unit of claim 3, wherein in the third position, a lower edge of the plunger (416) is adjacent a top portion of the pouch where an opening of the pouch is formed.

40

5. The packaging unit of claim 3, wherein the pouch is formed from two strips of material, and wherein the plunger (416) is configured to be positioned between the two strips of material while in the first position.

45

6. The packaging unit of claim 5, wherein:-

(i) the plunger includes a curved outer surface (436); or

(ii) the packaging equipment is configured to connect together edges of the two strips of material while the plunger is positioned between the two strips of material.

50

7. The packaging unit of claim 3, wherein when the plunger (416) is configured to move from the third position to the first position, and wherein the pack-

55

- aging unit is configured to advance the pouch at generally the same speed as the plunger.
8. The packaging unit of claim 2, wherein the plunger (416) is configured to slide linearly to push the pharmaceuticals into the pouch. 5
9. The packaging unit of claim 1, wherein the packaging equipment includes a feed stock roll, the feed stock roll having material that forms the pouch. 10
10. The packaging unit of claim 9, wherein the packaging equipment is configured to close the material along three sides to form the pouch before the pharmaceuticals are pushed into the pouch by the valve mechanism, and wherein the packaging equipment is configured to close the material along a fourth side after the pharmaceuticals are pushed into the pouch. 15
11. A method of packaging pharmaceuticals into a pouch using a packaging unit (118, 218, 400), the packaging unit including packaging equipment, a track (246) configured to direct the pharmaceuticals toward the packaging equipment, and a receptacle (158, 230, 404) coupled to the track upstream of the packaging equipment, the receptacle including a valve mechanism (254, 214) and a flapper (420), the method comprising: 20
- forming the pouch with the packaging equipment; 30
- pushing, using the flapper, a first side of the pouch toward a second side of the pouch;
- directing the pharmaceuticals along the track toward the packaging equipment while the valve mechanism is in a raised position; 35
- receiving the pharmaceuticals from the track in the pouch; and lowering the valve mechanism to push the pharmaceuticals into the pouch. 40
12. The method of claim 11, wherein the valve mechanism includes a plunger (416), and wherein forcing the pharmaceuticals into the pouch includes pushing the pharmaceuticals into the pouch with the plunger. 45
13. The method of claim 12, wherein forming the pouch includes forming the pouch around the plunger (416), and further comprising raising the plunger out of the pouch such that an opening is created for the pharmaceuticals to pass into the pouch. 50
14. The method of claim 13, further comprising moving the plunger (416) between a first position to form the pouch around the plunger, a second position to allow the pharmaceuticals to move past the valve mechanism toward the pouch, and a third position to push the pharmaceuticals into the pouch. 55

15. The method of claim 11, wherein the packaging equipment includes a feed stock roll, the feed stock roll having material that forms the pouch, the method further comprising:

closing the material along three sides to form the pouch before the pharmaceuticals are pushed into the pouch by the valve mechanism; and

closing the material along a fourth side after the pharmaceuticals are pushed into the pouch.

### Patentansprüche

1. Verpackungseinheit (118, 218, 400) zum Verpacken von Arzneimitteln in einen Beutel, wobei die Verpackungseinheit Folgendes umfasst:
- eine Verpackungsausstattung, die betreibbar ist, um den Beutel zu bilden;
- eine Bahn (246), die dazu konfiguriert ist, die Arzneimittel zu der Verpackungsausstattung zu leiten; und
- eine Aufnahme (158, 230, 404), die mit der Bahn stromaufwärts der Verpackungsausstattung gekoppelt ist, um die Arzneimittel von der Bahn aufzunehmen, wobei die Aufnahme einen Ventilmechanismus (254, 412) beinhaltet, der relativ zu der Bahn bewegbar ist, um die Arzneimittel in den Beutel zu drücken, **dadurch gekennzeichnet, dass** die Aufnahme ferner eine Klappe (420) beinhaltet, wobei die Klappe eine erste Seite des Beutels gegen eine zweite Seite des Beutels drückt.
2. Verpackungseinheit nach Anspruch 1, wobei der Ventilmechanismus einen Stößel (416) beinhaltet, der dazu konfiguriert ist, die Arzneimittel in den Beutel zu drücken. 40
3. Verpackungseinheit nach Anspruch 2, wobei der Stößel (416) zwischen einer ersten Position, um den Beutel um den Stößel zu bilden, einer zweiten Position, um es zu ermöglichen, dass sich die Arzneimittel durch den Ventilmechanismus (254, 412) zu der Verpackungsausstattung bewegen, und einer dritten Position, um die Arzneimittel in den Beutel zu drücken, bewegbar ist. 45
4. Verpackungseinheit nach Anspruch 3, wobei in der dritten Position eine untere Kante des Stößels (416) angrenzend an einen oberen Abschnitt des Beutels ist, wo eine Öffnung des Beutels gebildet ist. 50
5. Verpackungseinheit nach Anspruch 3, wobei der Beutel aus zwei Streifen von Material gebildet ist und wobei der Stößel (416) dazu konfiguriert ist, zwi-

- schen den zweite Streifen von Material positioniert zu sein, während er sich in der ersten Position befindet.
6. Verpackungseinheit nach Anspruch 5, wobei
- (i) der Stößel eine gebogene äußere Oberfläche (436) beinhaltet; oder
- (ii) die Verpackungsausstattung dazu konfiguriert ist, Kanten der zwei Streifen von Material miteinander zu verbinden, während der Stößel zwischen den zwei Streifen von Material positioniert ist.
7. Verpackungseinheit nach Anspruch 3, wobei wenn der Stößel (416) dazu konfiguriert ist, sich von der dritten Position auf die erste Position zu bewegen, und wobei die Verpackungseinheit dazu konfiguriert ist, den Beutel mit im Allgemeinen der gleichen Geschwindigkeit vorzurücken wie den Stößel.
8. Verpackungseinheit nach Anspruch 2, wobei der Stößel (416) dazu konfiguriert ist, linear zu gleiten, um die Arzneimittel in den Beutel zu drücken.
9. Verpackungseinheit nach Anspruch 1, wobei die Verpackungsausstattung eine Vorratsrolle beinhaltet, wobei die Vorratsrolle ein Material aufweist, das den Beutel bildet.
10. Verpackungseinheit nach Anspruch 9, wobei die Verpackungsausstattung dazu konfiguriert ist, das Material entlang drei Seiten zu verschließen, um den Beutel zu bilden, bevor die Arzneimittel durch den Ventilmechanismus in den Beutel gedrückt werden, und wobei die Verpackungsausstattung dazu konfiguriert ist, das Material entlang einer vierten Seite zu verschließen, nachdem die Arzneimittel in den Beutel gedrückt wurden.
11. Verfahren zum Verpacken von Arzneimitteln in einen Beutel unter Verwendung einer Verpackungseinheit (118, 218, 400), wobei die Verpackungseinheit eine Verpackungsausstattung, eine Bahn (246), die dazu konfiguriert ist, die Arzneimittel zu der Verpackungsausstattung zu leiten, und eine Aufnahme (158, 230, 404), die mit der Bahn stromaufwärts der Verpackungsausstattung gekoppelt ist, beinhaltet, wobei die Aufnahme einen Ventilmechanismus (254, 214) und eine Klappe (420) beinhaltet, wobei das Verfahren Folgendes umfasst:
- Bilden des Beutels mit der Verpackungsausstattung;
- Drücken, unter Verwendung der Klappe, einer ersten Seite des Beutels zu einer zweiten Seite des Beutels;
- Leiten der Arzneimittel entlang der Bahn zu der
- Verpackungsausstattung, während sich der Ventilmechanismus in einer angehobenen Position befindet;
- Aufnehmen der Arzneimittel von der Bahn in den Beutel; und
- Absenken des Ventilmechanismus, um die Arzneimittel in den Beutel zu drücken.
12. Verfahren nach Anspruch 11, wobei der Ventilmechanismus einen Stößel (416) beinhaltet und wobei ein Treiben der Arzneimittel in den Beutel Drücken der Arzneimittel in den Beutel mit dem Stößel beinhaltet.
13. Verfahren nach Anspruch 12, wobei das Bilden des Beutels Bilden des Beutels um den Stößel (416) beinhaltet, und ferner umfassend Anheben des Stößels aus dem Beutel, so dass eine Öffnung geschaffen wird, durch die die Arzneimittel in den Beutel gelangen können.
14. Verfahren nach Anspruch 13, ferner umfassend Bewegen des Stößels (416) zwischen einer ersten Position, um den Beutel um den Stößel zu bilden, einer zweiten Position, um es zu ermöglichen, dass sich die Arzneimittel durch den Ventilmechanismus zu dem Beutel bewegen, und einer dritten Position, um die Arzneimittel in den Beutel zu drücken.
15. Verfahren nach Anspruch 11, wobei die Verpackungsausstattung eine Vorratsrolle beinhaltet, wobei die Vorratsrolle Material aufweist, das den Beutel bildet, wobei das Verfahren ferner Folgendes umfasst:
- Verschließen des Materials entlang drei Seiten, um den Beutel zu bilden, bevor die Arzneimittel durch den Ventilmechanismus in den Beutel gedrückt werden; und
- Verschließen des Materials entlang einer vierten Seite, nachdem die Arzneimittel in den Beutel gedrückt wurden.
- Revendications**
1. Unité d'emballage (118, 218, 400) pour emballer des produits pharmaceutiques dans une poche, l'unité d'emballage comprenant :
- un équipement d'emballage pouvant fonctionner pour former la poche ;
- un rail (246) configurée pour diriger les produits pharmaceutiques vers l'équipement d'emballage ; et
- un réceptacle (158, 230, 404) couplé au rail en amont de l'équipement d'emballage pour rece-

- voir les produits pharmaceutiques depuis le rail, le réceptacle comportant un mécanisme de soupape (254, 412) qui est mobile par rapport au rail pour pousser les produits pharmaceutiques dans la poche,
- caractérisée en ce que** le réceptacle comporte en outre un clapet (420), dans laquelle le clapet pousse un premier côté de la poche vers un second côté de la poche.
2. Unité d'emballage selon la revendication 1, dans laquelle le mécanisme de soupape comporte un piston (416) configuré pour pousser les produits pharmaceutiques dans la poche.
  3. Unité d'emballage selon la revendication 2, dans laquelle le piston (416) est mobile entre une première position pour former la poche autour du piston, une deuxième position pour permettre aux produits pharmaceutiques de passer devant le mécanisme de soupape (254, 412) vers l'équipement d'emballage, et une troisième position pour pousser les produits pharmaceutiques dans la poche.
  4. Unité d'emballage selon la revendication 3, dans laquelle, dans la troisième position, un bord inférieur du piston (416) est adjacent à une partie supérieure de la poche où une ouverture de la poche est formée.
  5. Unité d'emballage selon la revendication 3, dans laquelle la poche est formée de deux bandes de matériau, et dans laquelle le piston (416) est configuré pour être positionné entre les deux bandes de matériau lorsqu'il est dans la première position.
  6. Unité d'emballage selon la revendication 5, dans laquelle :
    - (i) le piston comporte une surface externe incurvée (436) ; ou
    - (ii) l'équipement d'emballage est configuré pour connecter ensemble des bords des deux bandes de matériau tandis que le piston est positionné entre les deux bandes de matériau.
  7. Unité d'emballage selon la revendication 3, dans laquelle le piston (416) est configuré pour se déplacer de la troisième position à la première position, et dans laquelle l'unité d'emballage est configurée pour faire avancer la poche généralement à la même vitesse que le piston.
  8. Unité d'emballage selon la revendication 2, dans laquelle le piston (416) est configuré pour coulisser linéairement pour pousser les produits pharmaceutiques dans la poche.
  9. Unité d'emballage selon la revendication 1, dans laquelle l'équipement d'emballage comporte un rouleau de matière première, le rouleau de matière première ayant un matériau qui forme la poche.
  10. Unité d'emballage selon la revendication 9, dans laquelle l'équipement d'emballage est configuré pour fermer le matériau le long de trois côtés pour former la poche avant que les produits pharmaceutiques ne soient poussés dans la poche par le mécanisme de soupape, et dans laquelle l'équipement d'emballage est configuré pour fermer le matériau le long d'un quatrième côté après que les produits pharmaceutiques ont été poussés dans la poche.
  11. Procédé d'emballage de produits pharmaceutiques dans une poche à l'aide d'une unité d'emballage (118, 218, 400), l'unité d'emballage comportant un équipement d'emballage, un rail (246) configuré pour diriger les produits pharmaceutiques vers l'équipement d'emballage, et un réceptacle (158, 230, 404) couplé au rail en amont de l'équipement d'emballage, le réceptacle comportant un mécanisme de soupape (254, 214) et un clapet (420), le procédé comprenant :
    - la formation de la poche avec l'équipement d'emballage ;
    - le fait de pousser, à l'aide du clapet, un premier côté de la poche vers un second côté de la poche ;
    - la direction des produits pharmaceutiques le long du rail vers l'équipement d'emballage tandis que le mécanisme de soupape est dans une position relevée ;
    - la réception des produits pharmaceutiques depuis le rail dans la poche ; et
    - l'abaissement du mécanisme de soupape pour pousser les produits pharmaceutiques dans la poche.
  12. Procédé selon la revendication 11, dans lequel le mécanisme de soupape comporte un piston (416), et dans lequel le fait de forcer les produits pharmaceutiques dans la poche comporte le fait de pousser les produits pharmaceutiques dans la poche avec le piston.
  13. Procédé selon la revendication 12, dans lequel la formation de la poche comporte la formation de la poche autour du piston (416), et comprenant en outre l'élévation du piston hors de la poche de sorte qu'une ouverture est créée pour que les produits pharmaceutiques passent dans la poche.
  14. Procédé selon la revendication 13, comprenant en outre le déplacement du piston (416) entre une première position pour former la poche autour du piston, une deuxième position pour permettre aux produits

pharmaceutiques de passer devant le mécanisme de soupape vers la poche et une troisième position pour pousser les produits pharmaceutiques dans la poche.

5

15. Procédé selon la revendication 11, dans lequel l'équipement d'emballage comporte un rouleau de matière première, le rouleau de matière première ayant un matériau qui forme la poche, le procédé comprenant en outre :

10

la fermeture du matériau le long de trois côtés pour former la poche avant que les produits pharmaceutiques ne soient poussés dans la poche par le mécanisme de soupape ; et la fermeture du matériau le long d'un quatrième côté après que les produits pharmaceutiques ont été poussés dans la poche.

15

20

25

30

35

40

45

50

55

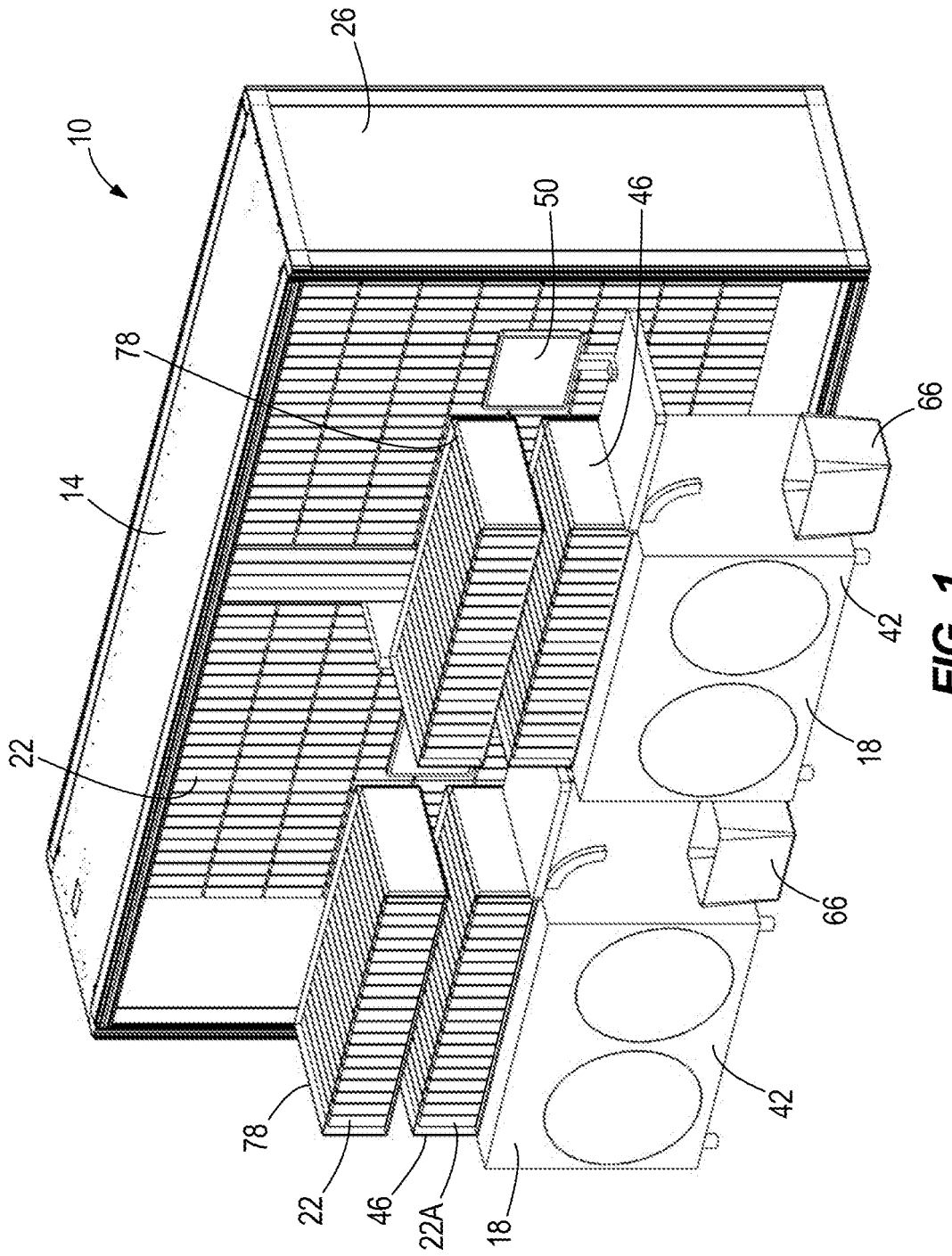

**FIG. 1**

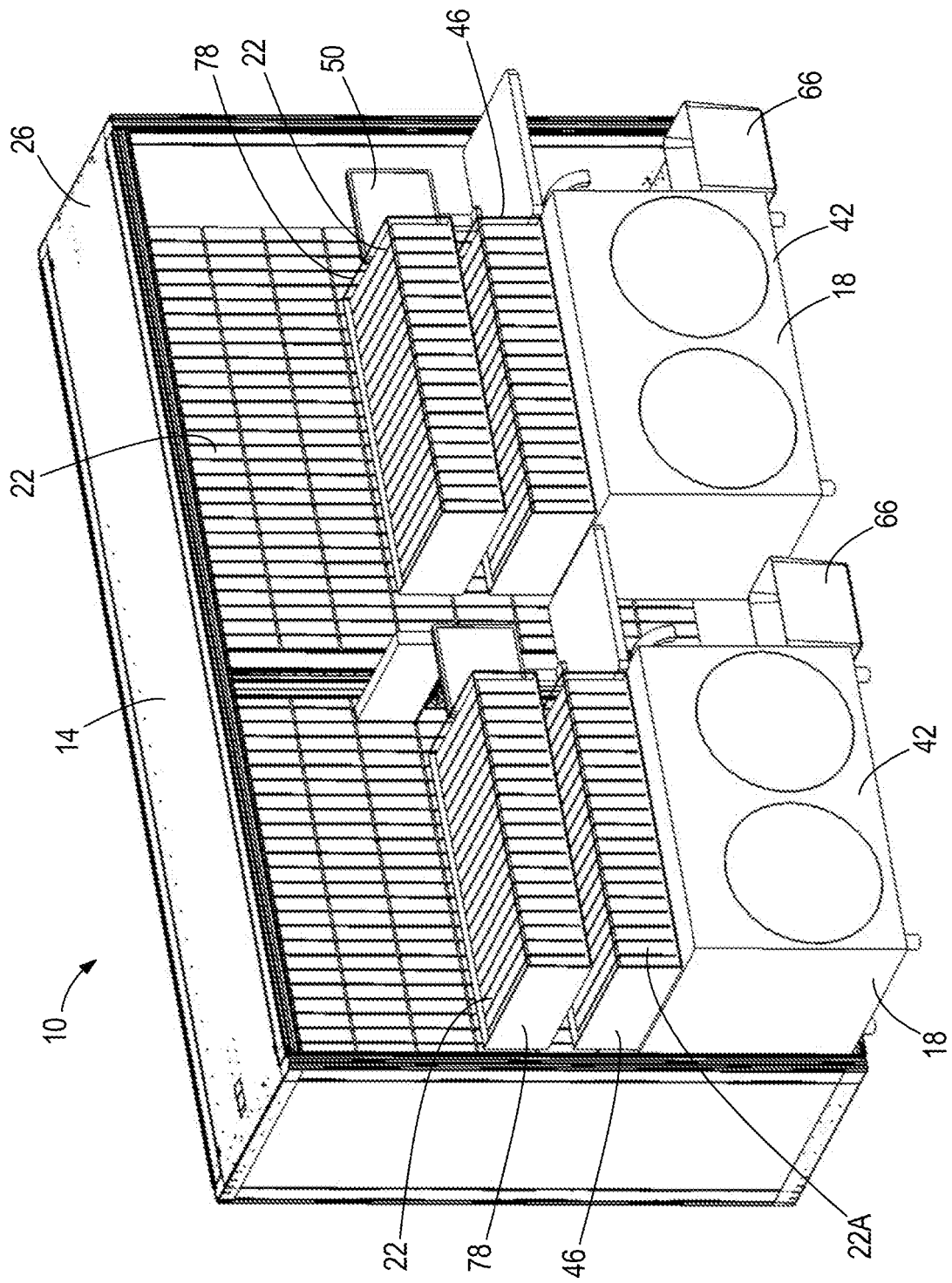

**FIG. 2**

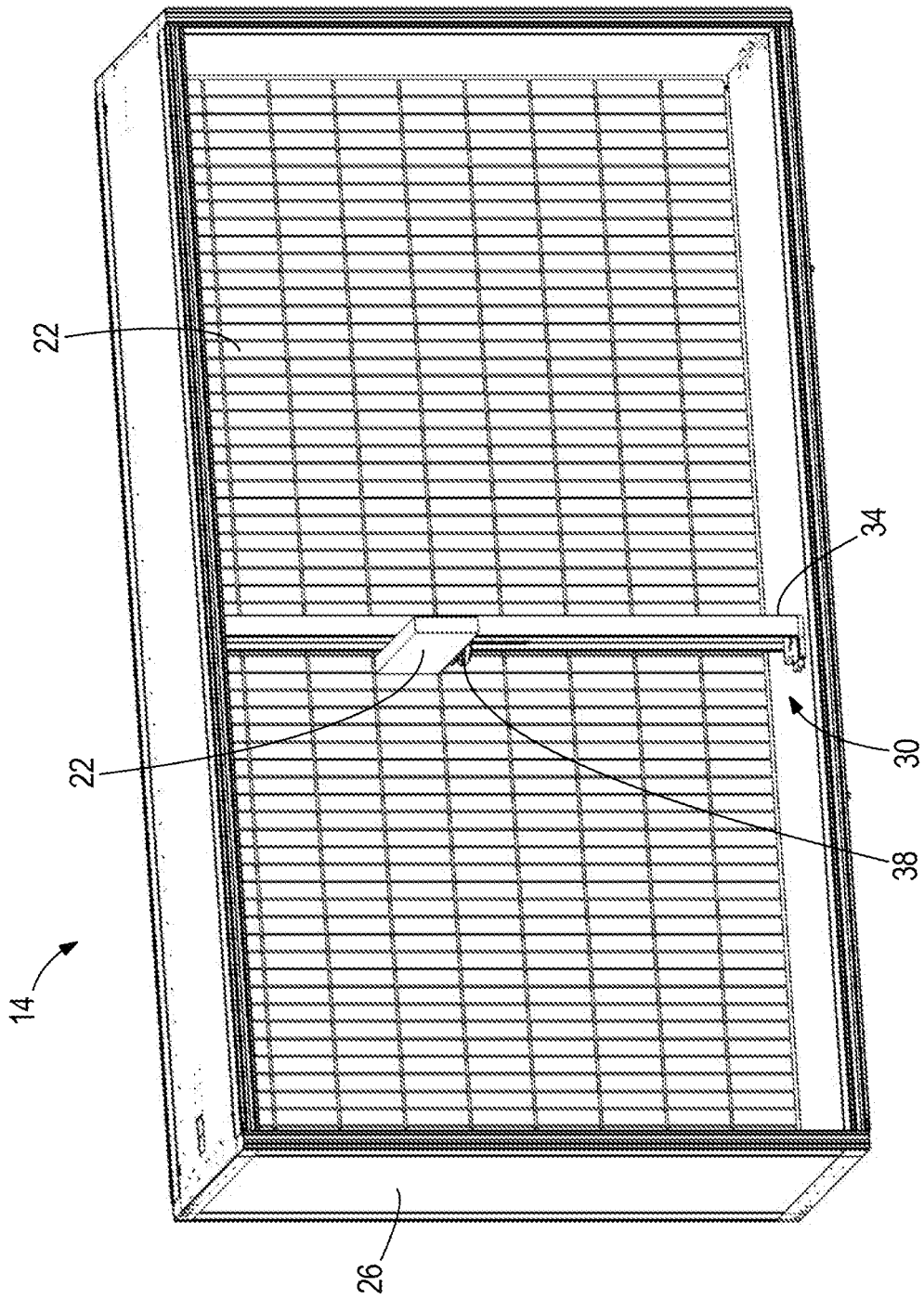

**FIG. 3**

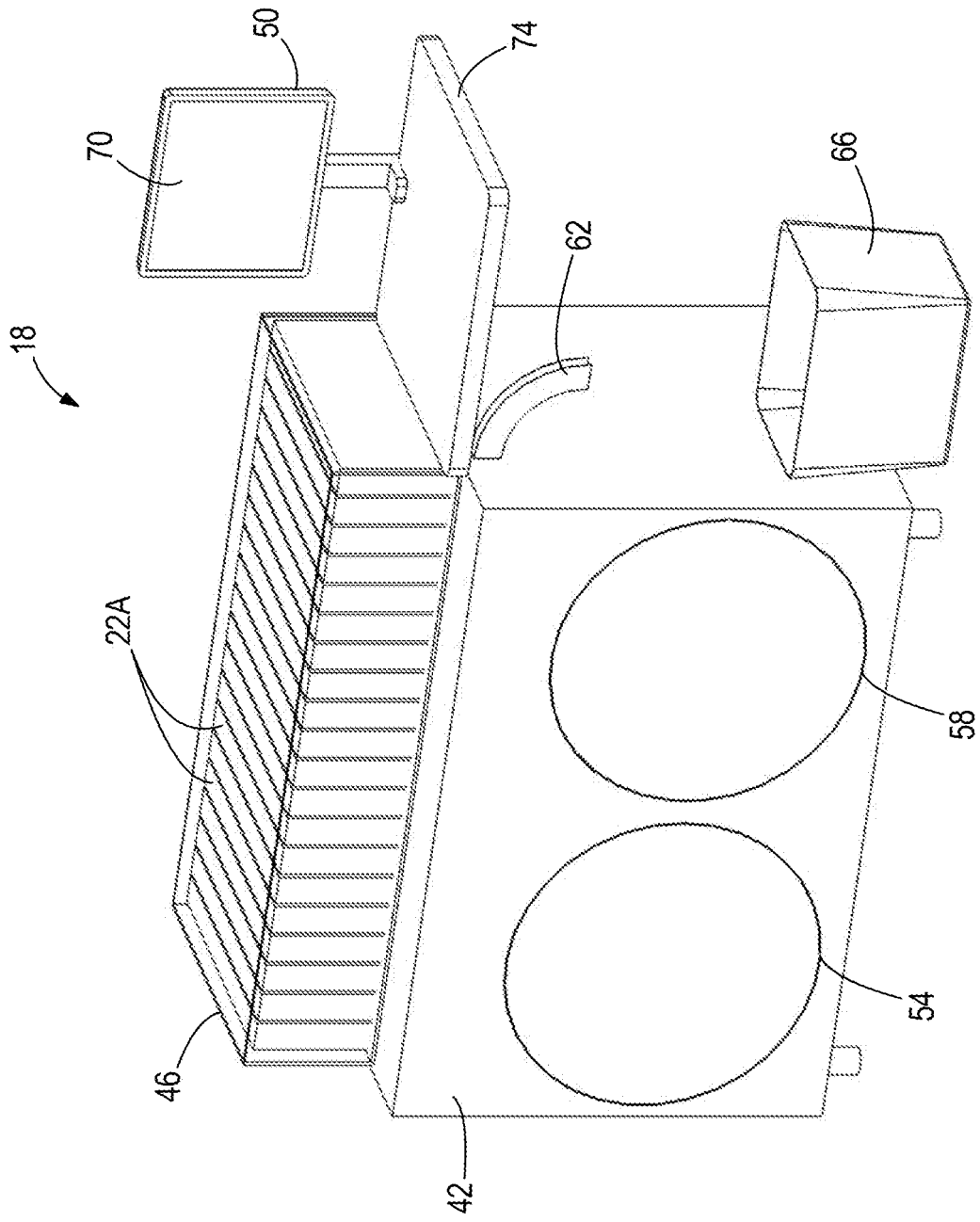

**FIG. 4**

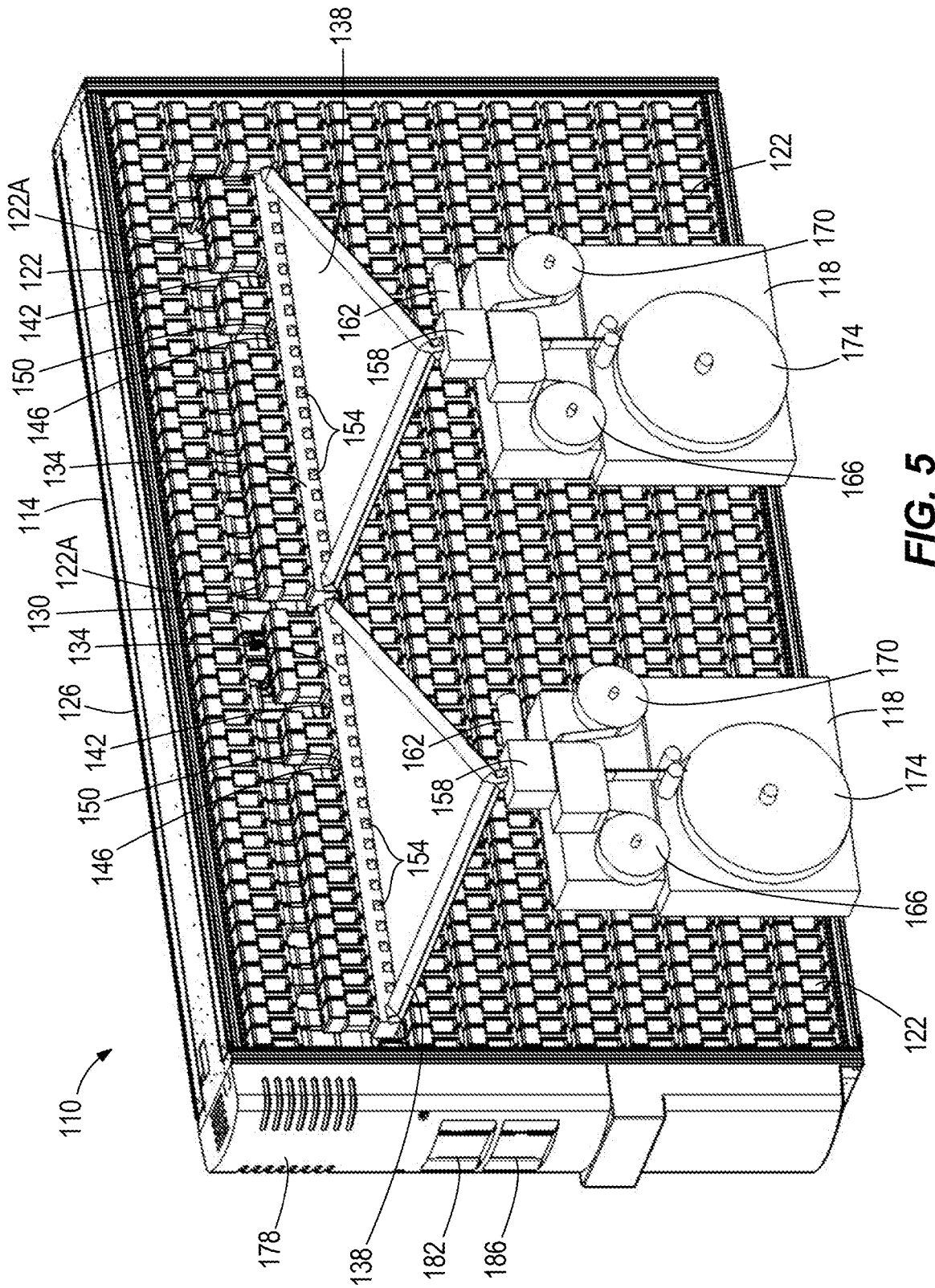

**FIG. 5**

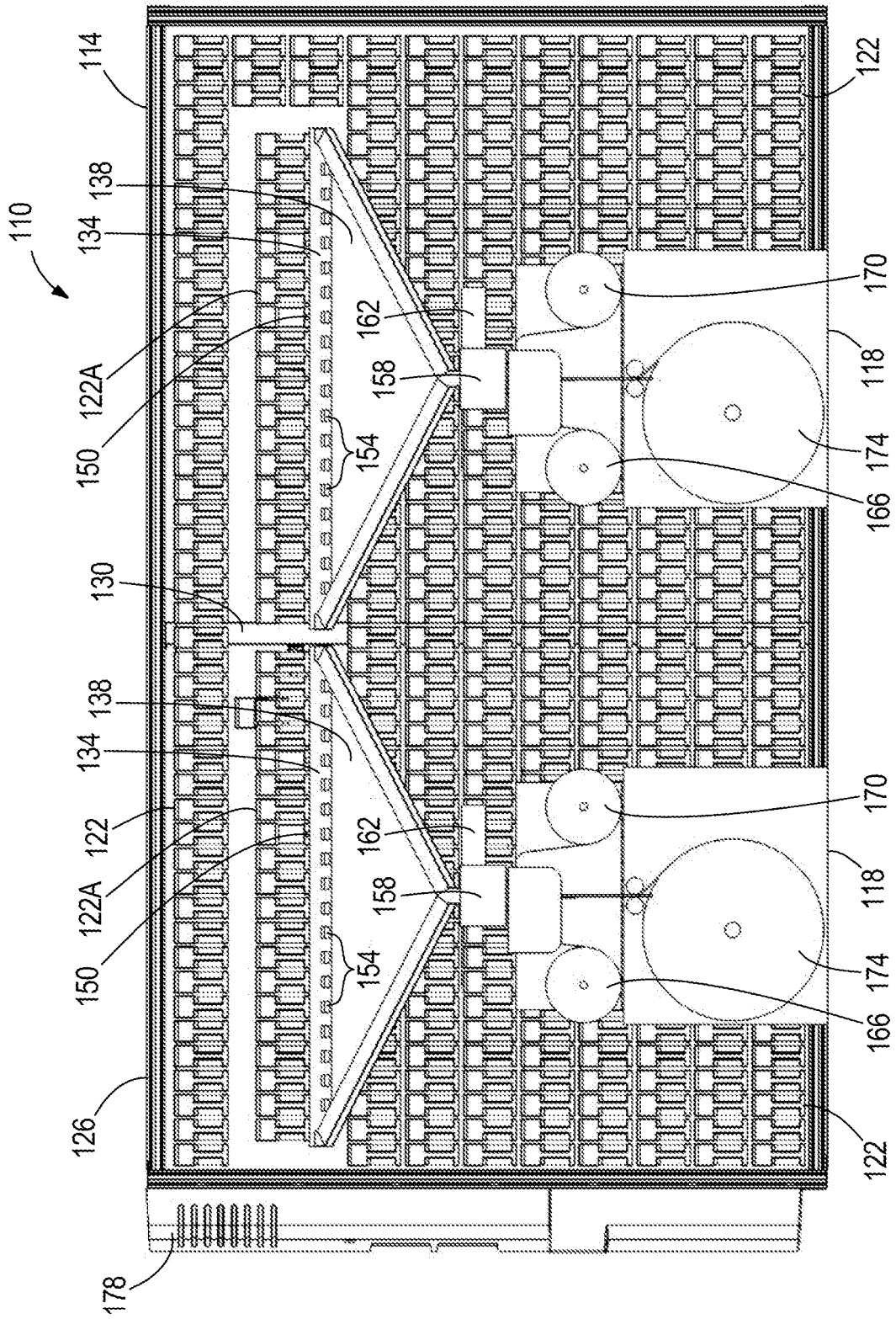

**FIG. 6**

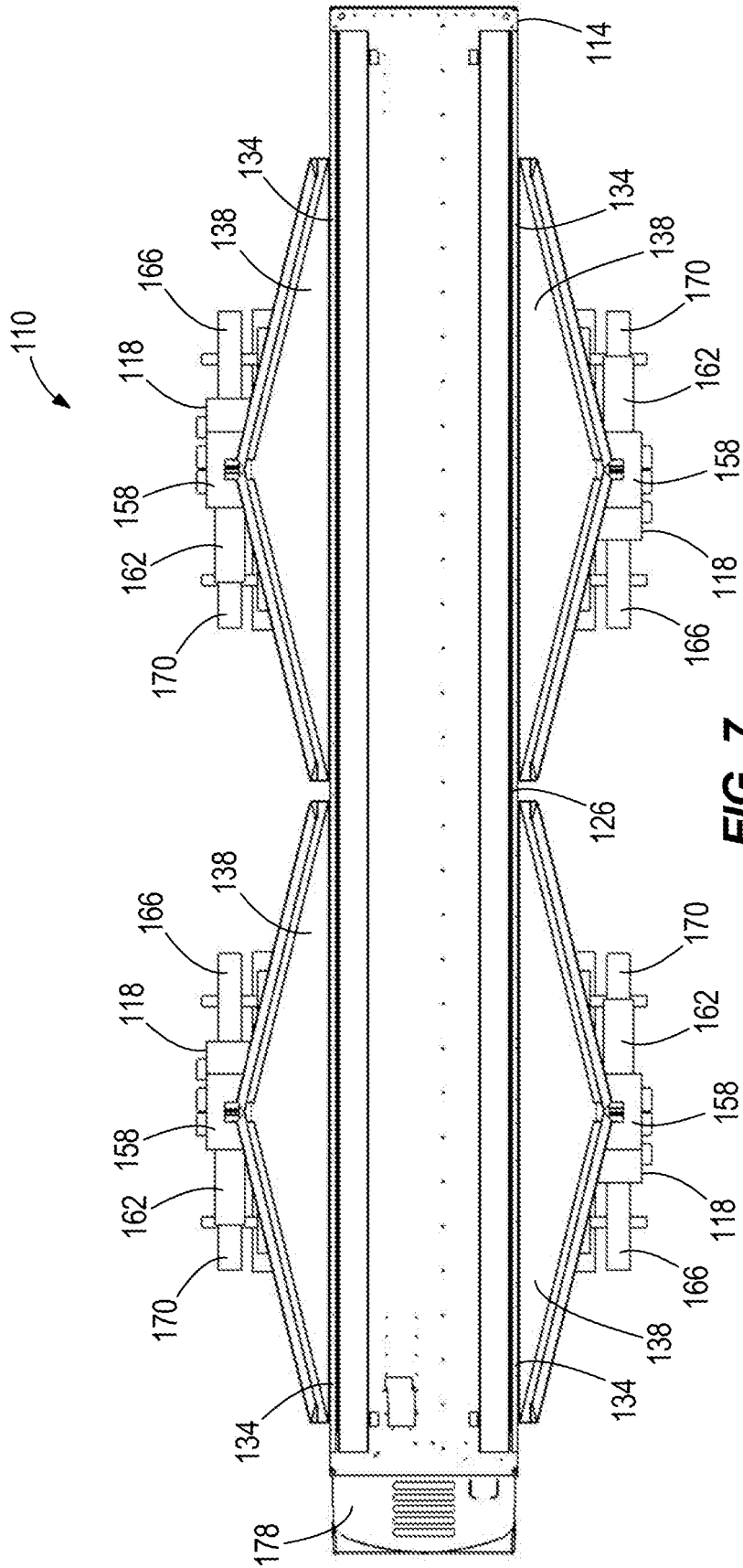

**FIG. 7**

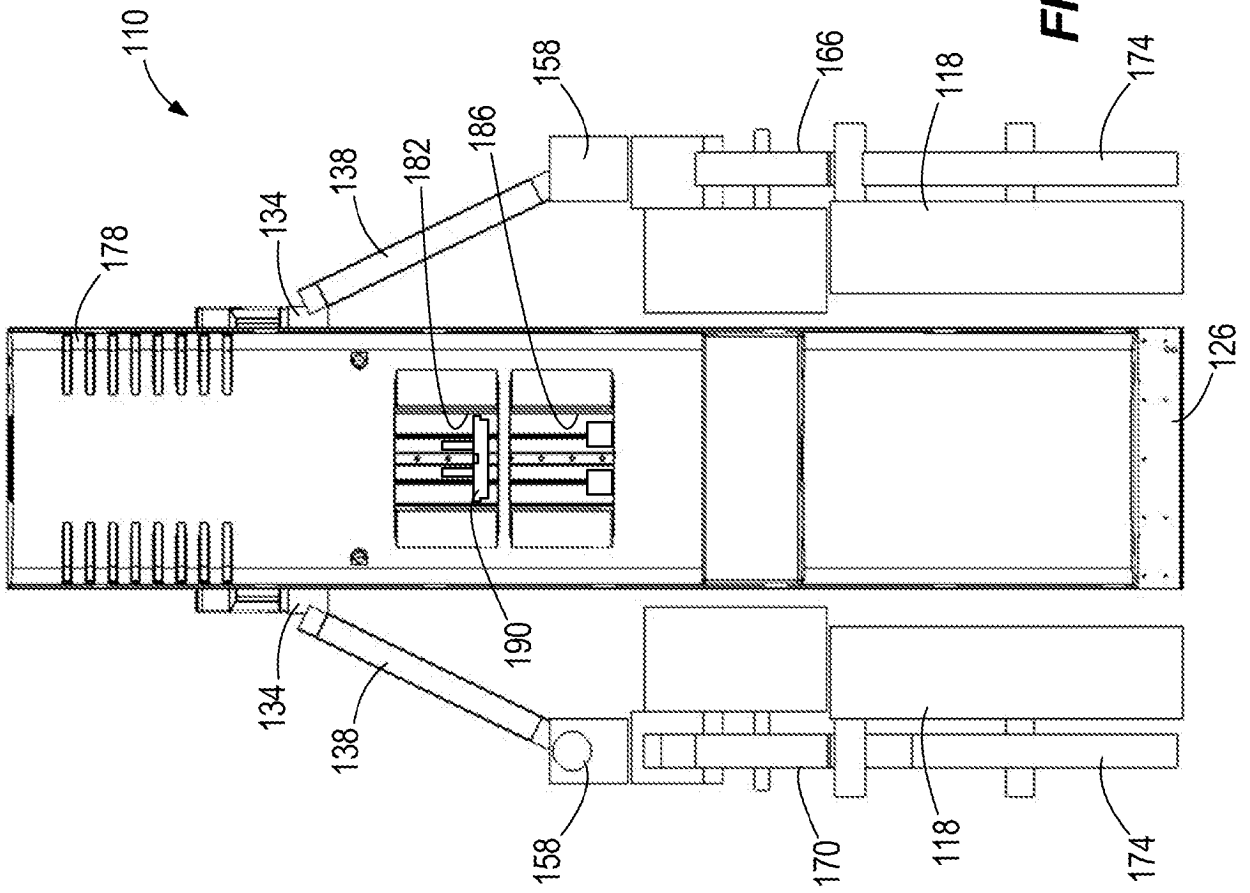

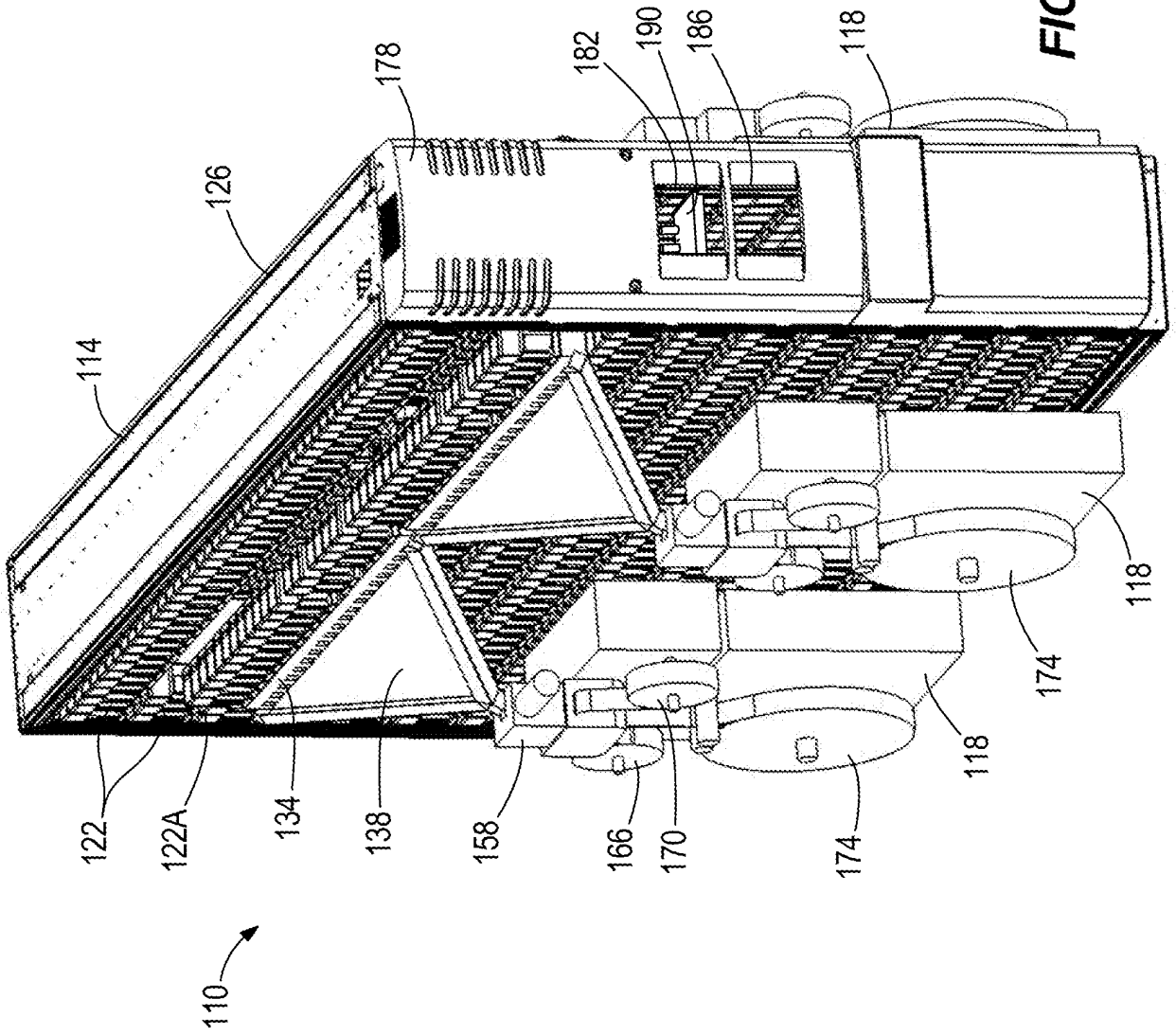
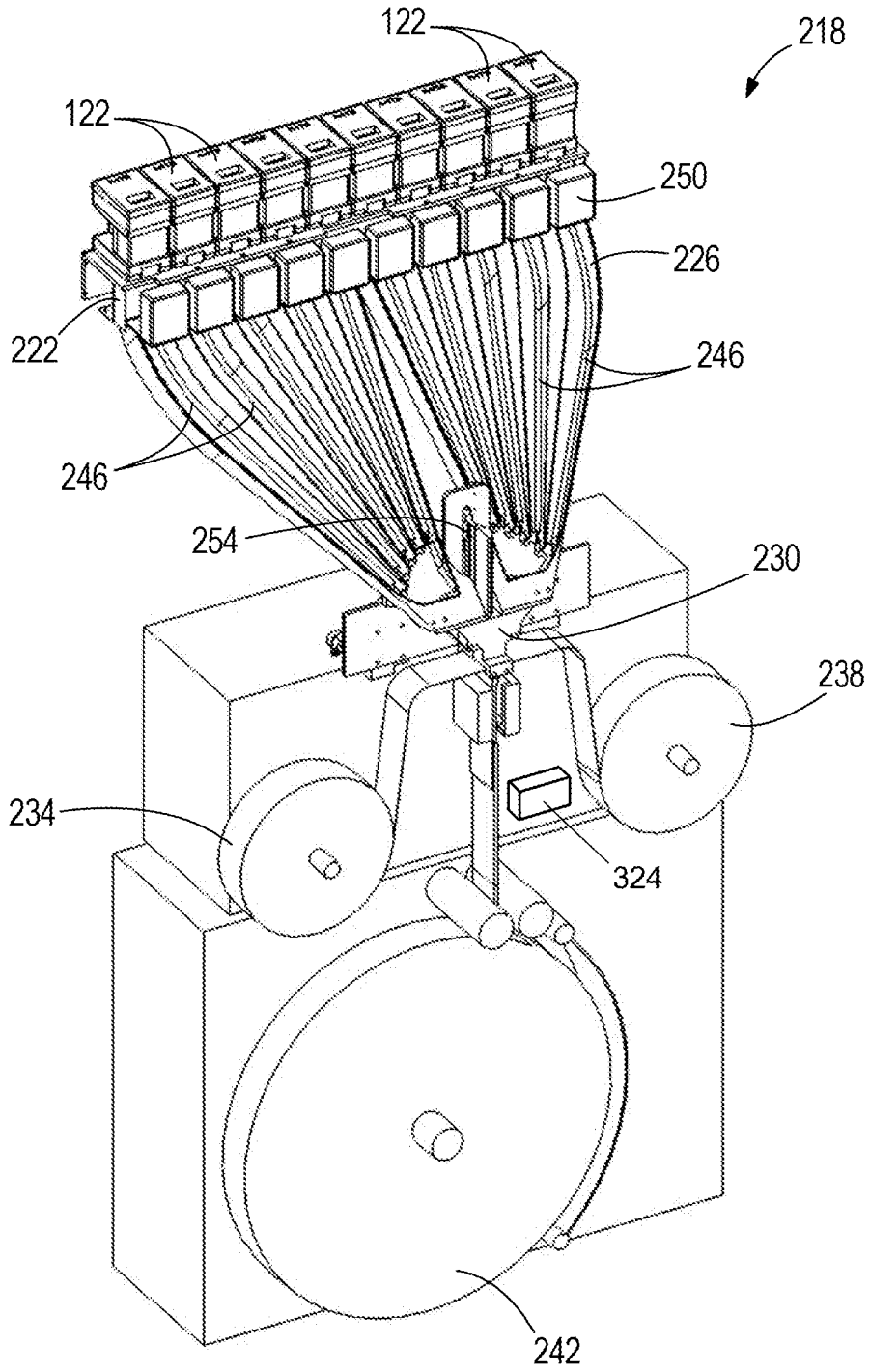
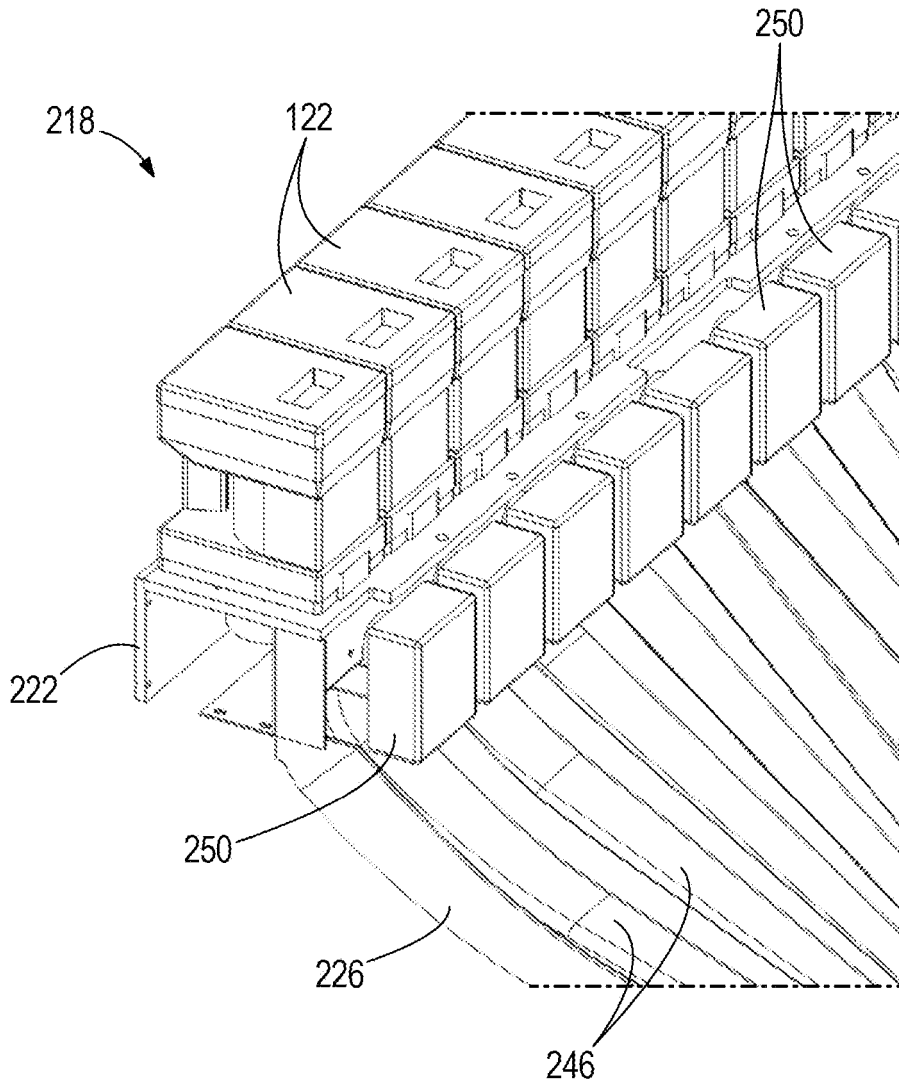

FIG. 9



**FIG. 10**



**FIG. 11**

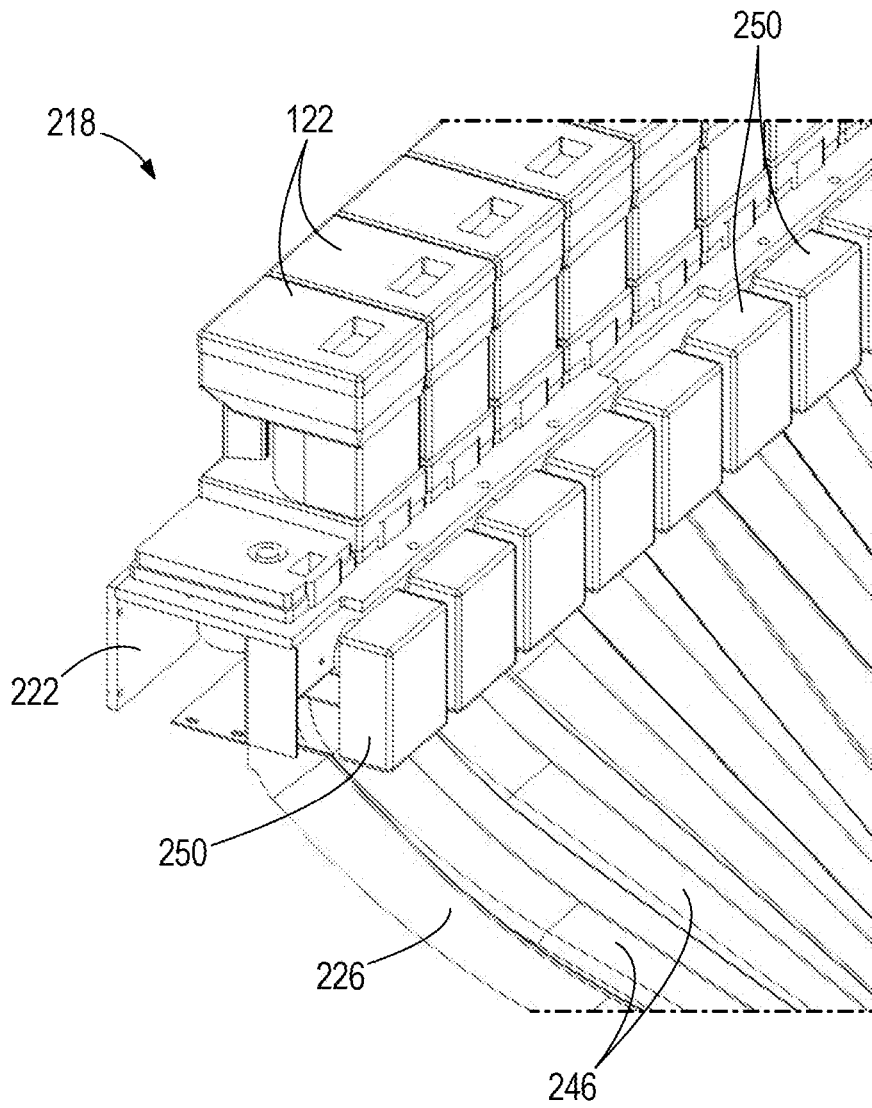

**FIG. 12**

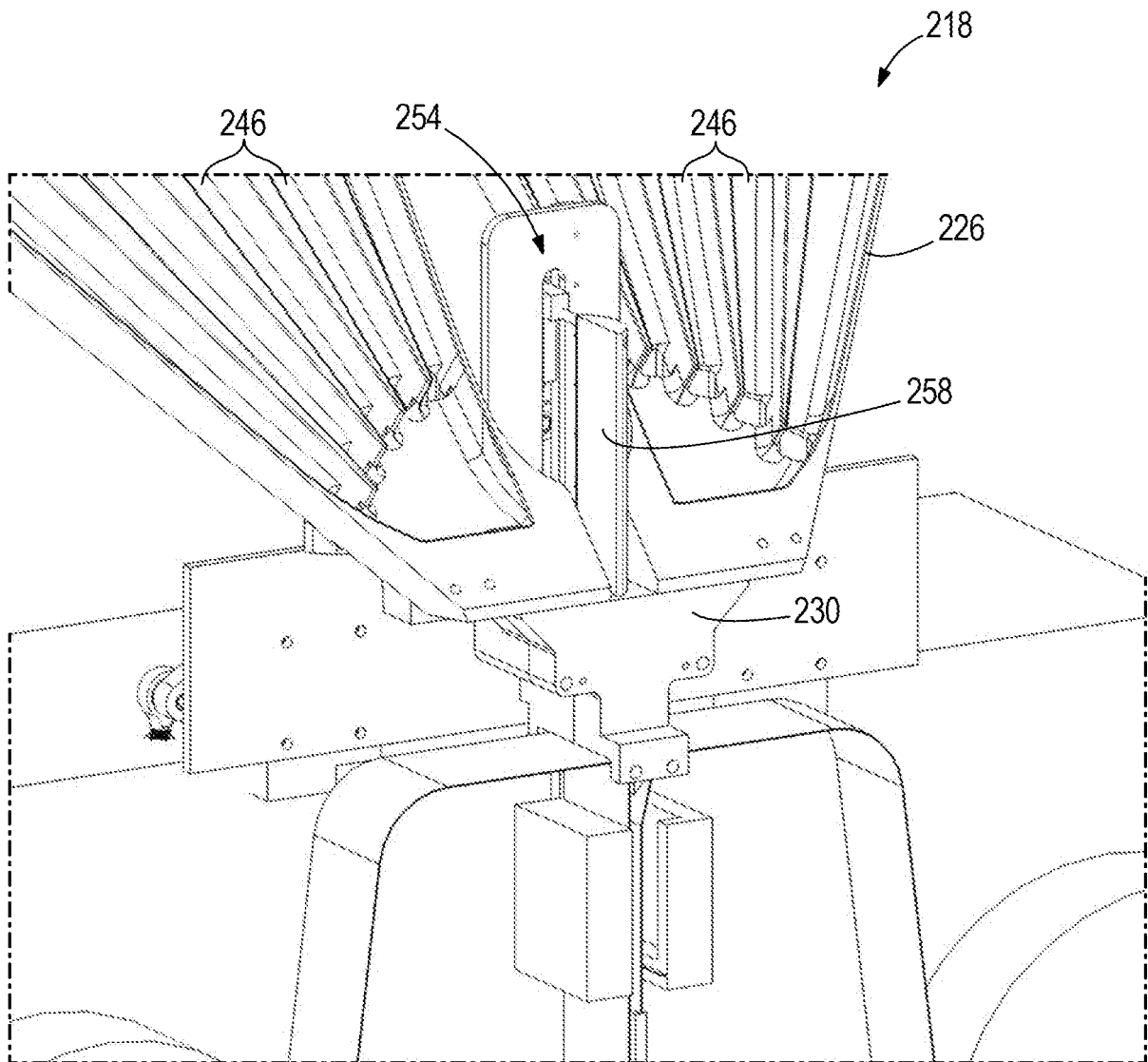

**FIG. 13**

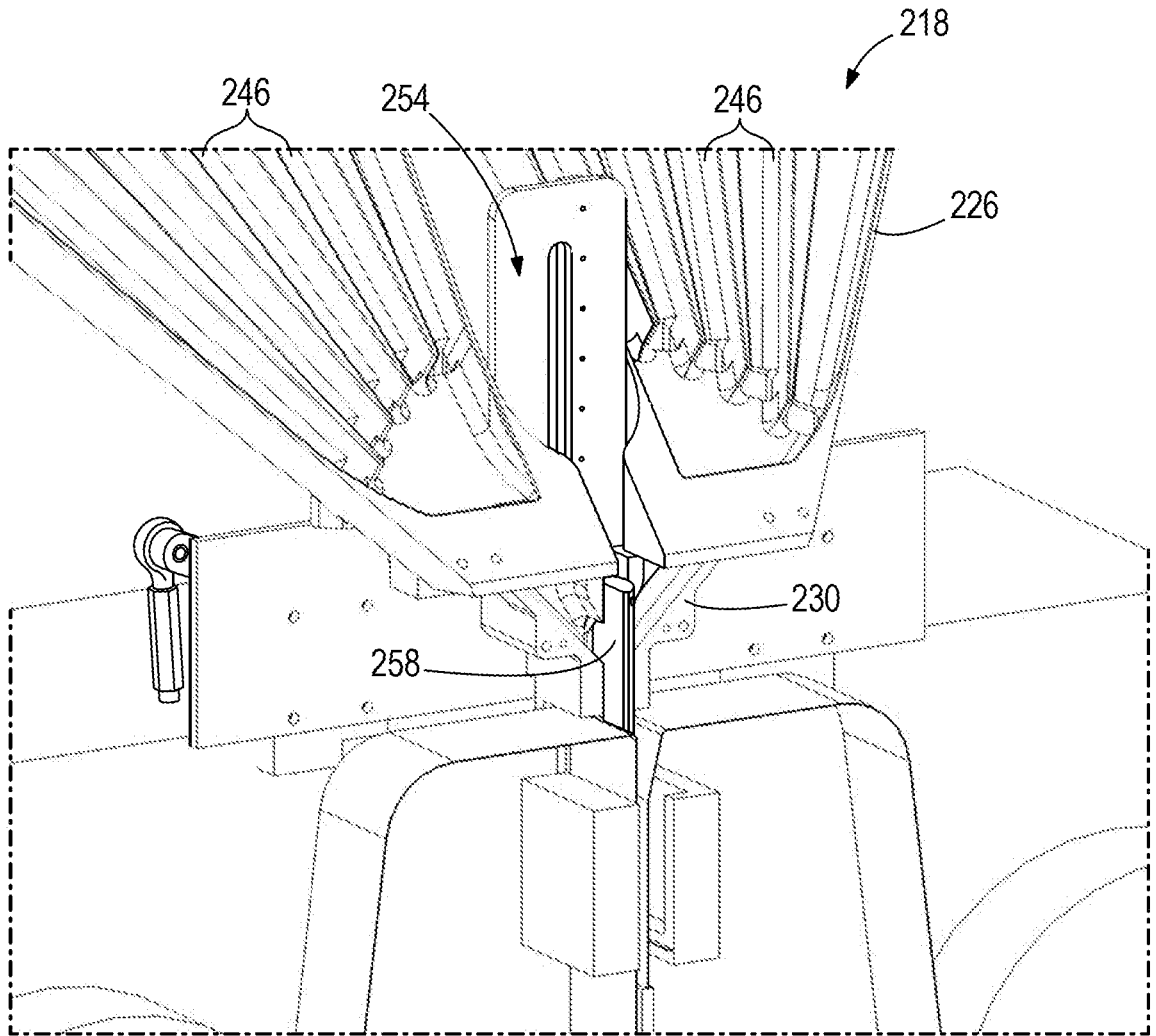

**FIG. 14**

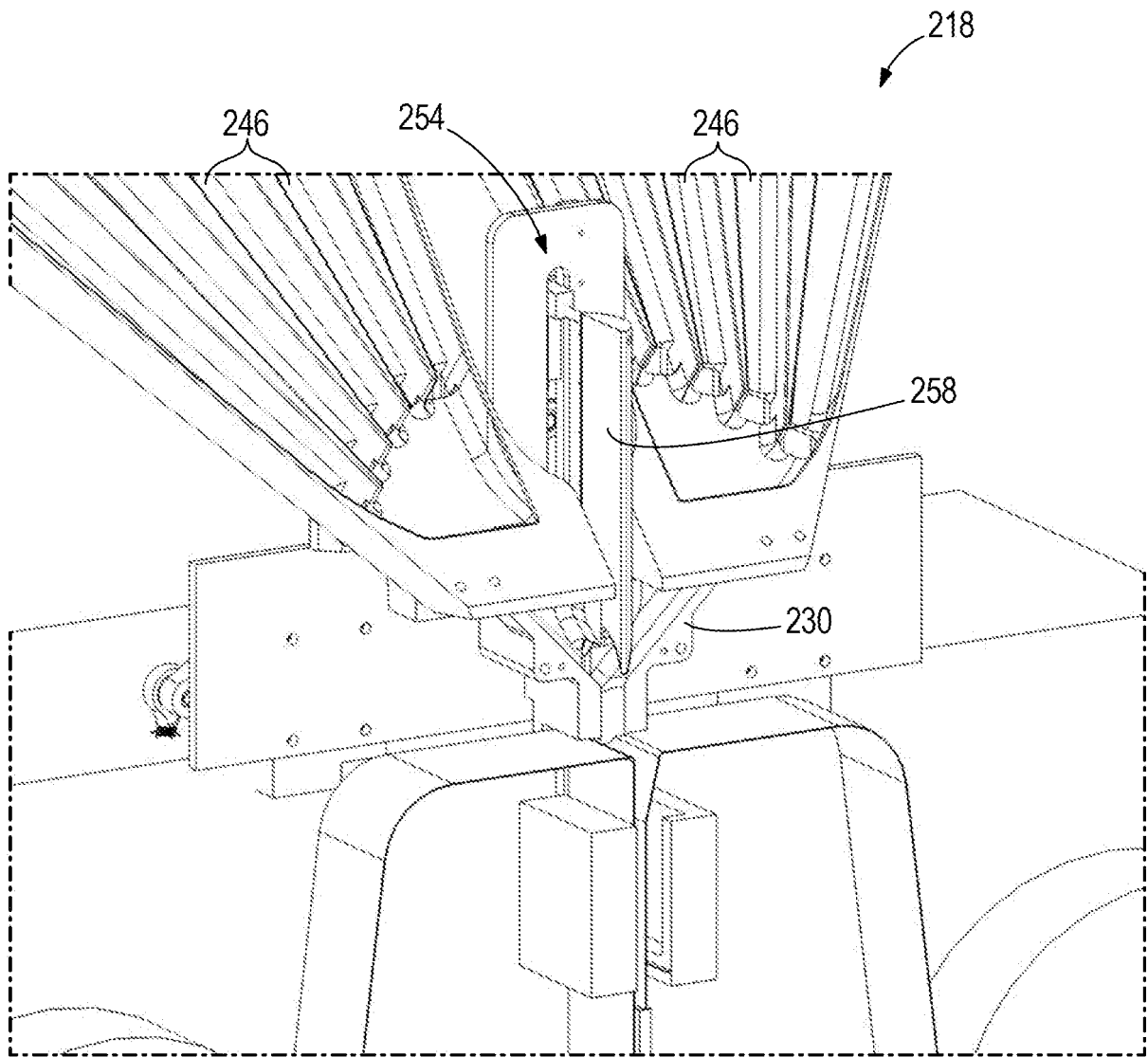

**FIG. 15**

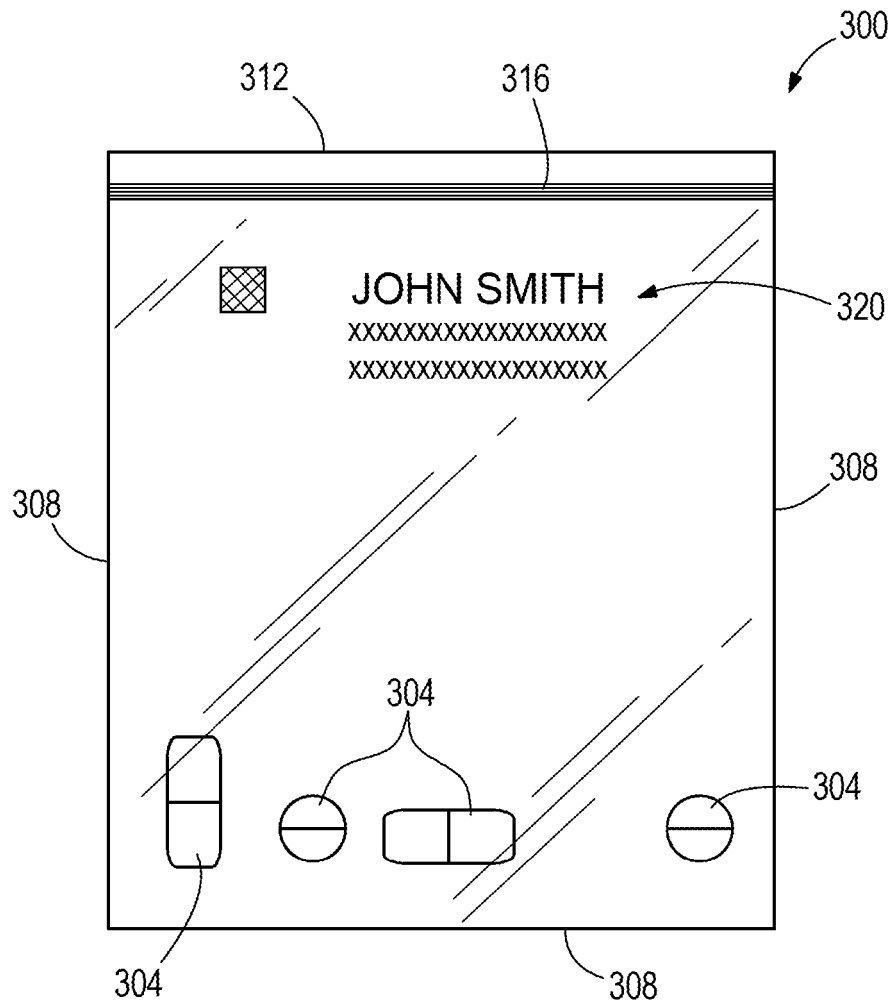

**FIG. 16**

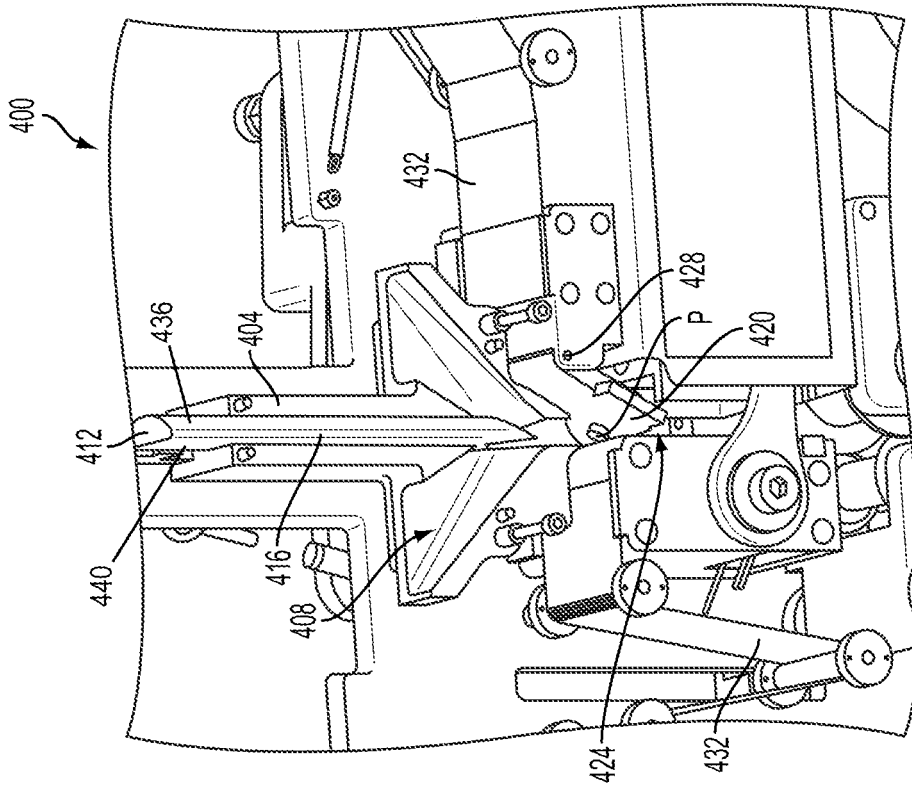

FIG. 18

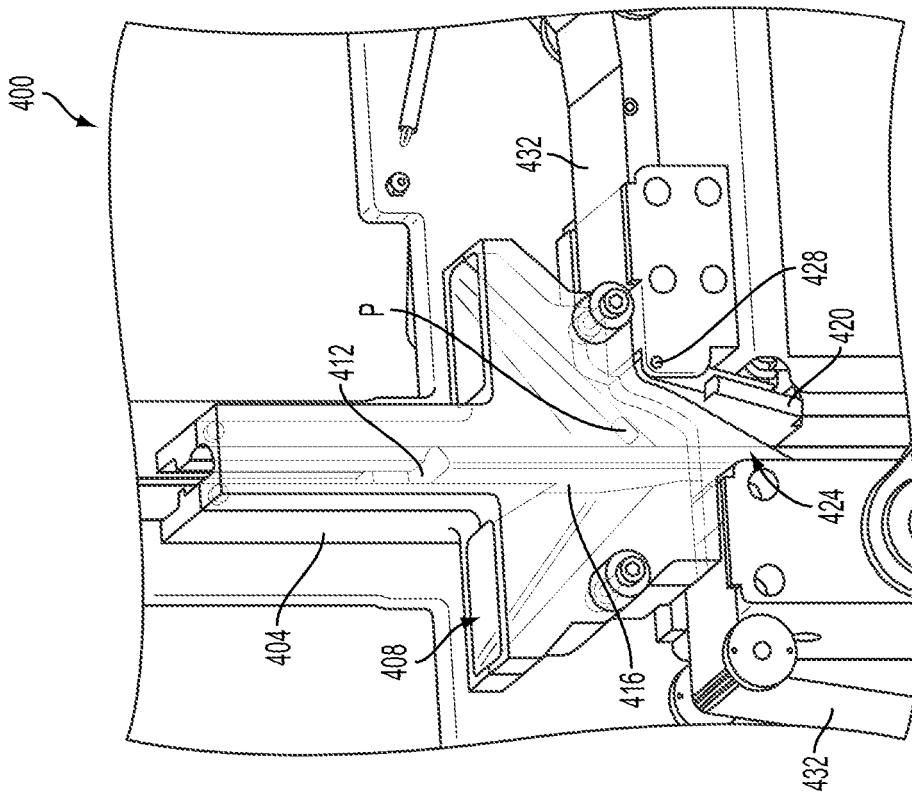

FIG. 17

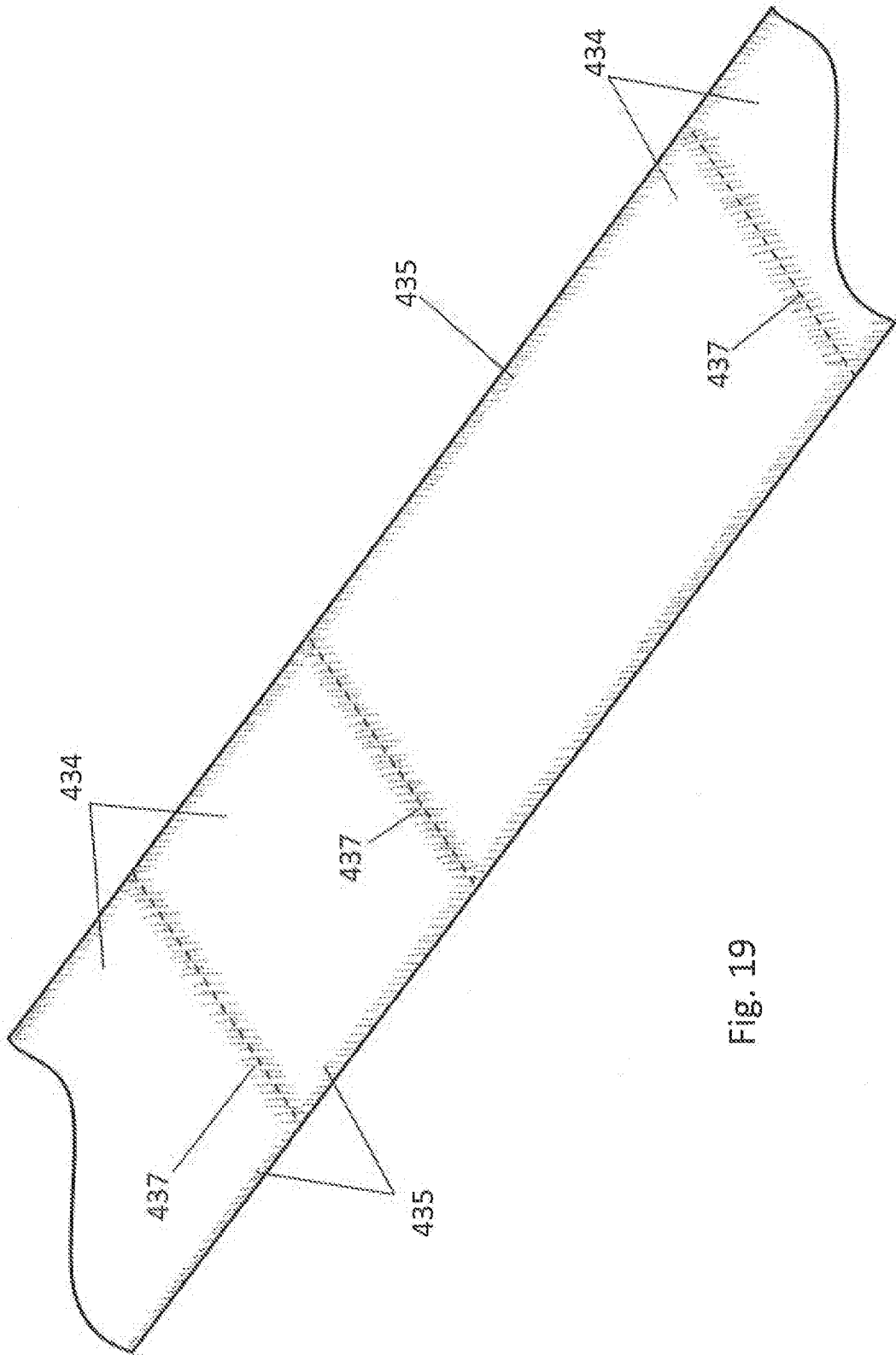

Fig. 19

**REFERENCES CITED IN THE DESCRIPTION**

*This list of references cited by the applicant is for the reader's convenience only. It does not form part of the European patent document. Even though great care has been taken in compiling the references, errors or omissions cannot be excluded and the EPO disclaims all liability in this regard.*

**Patent documents cited in the description**

- US 2013318931 A [0001]
- US 87004510 [0012]
- US 20110054668 [0012]