

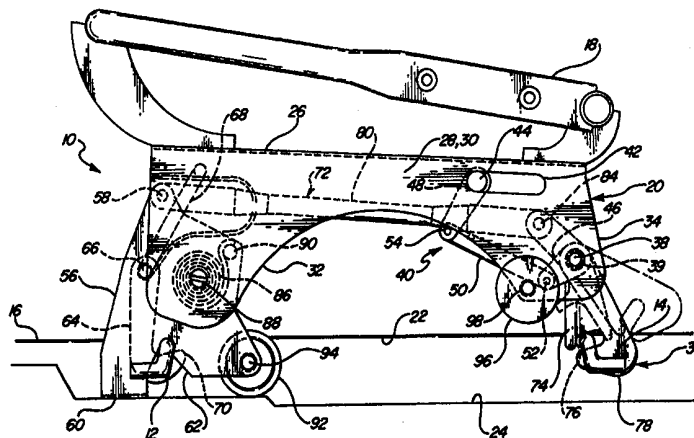

## INTERNATIONAL APPLICATION PUBLISHED UNDER THE PATENT COOPERATION TREATY (PCT)

(51) International Patent Classification <sup>6</sup> : <b>B60N 2/00</b>	<b>A1</b>	(11) International Publication Number: <b>WO 99/59836</b> (43) International Publication Date: 25 November 1999 (25.11.99)
<p>(21) International Application Number: PCT/CA99/00506</p> <p>(22) International Filing Date: 13 May 1999 (13.05.99)</p> <p>(30) Priority Data: 60/085,732 15 May 1998 (15.05.98) US</p> <p>(71) Applicant (for all designated States except US): MAGNA INTERIOR SYSTEMS INC. [CA/CA]; 337 Magna Drive, Aurora, Ontario L4G 7K1 (CA).</p> <p>(72) Inventors; and (75) Inventors/Applicants (for US only): NICOLA, Kirk, M. [US/US]; 18184 Buckingham Avenue, Beverly Hills, MI 48025 (US). WITTMAN, Frank [US/US]; 9297 Holiday Drive, Whitmore Lake, MI 48189 (US).</p> <p>(74) Agent: IMAI, Jeffrey, T.; Magna International Inc., 337 Magna Drive, Aurora, Ontario L4G 7K1 (CA).</p>	<p>(81) Designated States: AE, AL, AM, AT, AU, AZ, BA, BB, BG, BR, BY, CA, CH, CN, CU, CZ, DE, DK, EE, ES, FI, GB, GD, GE, GH, GM, HR, HU, ID, IL, IN, IS, JP, KE, KG, KP, KR, KZ, LC, LK, LR, LS, LT, LU, LV, MD, MG, MK, MN, MW, MX, NO, NZ, PL, PT, RO, RU, SD, SE, SG, SI, SK, SL, TJ, TM, TR, TT, UA, UG, US, UZ, VN, YU, ZA, ZW, ARIPO patent (GH, GM, KE, LS, MW, SD, SL, SZ, UG, ZW), Eurasian patent (AM, AZ, BY, KG, KZ, MD, RU, TJ, TM), European patent (AT, BE, CH, CY, DE, DK, ES, FI, FR, GB, GR, IE, IT, LU, MC, NL, PT, SE), OAPI patent (BF, BJ, CF, CG, CI, CM, GA, GN, GW, ML, MR, NE, SN, TD, TG).</p> <p><b>Published</b> <i>With international search report.</i> <i>Before the expiration of the time limit for amending the claims and to be republished in the event of the receipt of amendments.</i></p>	

(54) Title: FOLD AND TUMBLE SEAT SUPPORT ASSEMBLY



## (57) Abstract

A fold and tumble seat support assembly (10) for removably securing a vehicle seat to a pair of front and rear strikers (12, 14) on the floor (16) of a vehicle. The seat support assembly includes a riser (20) having a pair of forward (32) and rearward (34) legs. A rear latch (36) is pivotally connected to each of the rearward legs (34) and operable by a first linkage mechanism (40) to latch and unlatch with the rear strikers (14). A front latch (64) is pivotally connected to each of the forward legs (32) and operable by a front latch handle (68) to latch and unlatch with the front strikers. A rear support leg (74) supports the rearward legs (34) of the riser above the vehicle floor (16). A foot bracket (56) is pivotally connected to each of the forward legs (32) for supporting the riser (20) above the vehicle floor (16) between both a generally horizontal use position and a forwardly pivoted tumbled position. A second linkage mechanism (72) is connected between the foot brackets (56) and the rear support legs (74) for automatically retracting the rear support legs (74) against the riser (20) in response to pivotal movement of the seat about the foot bracket (56) from the use position to the tumbled position. A pair of front (92) and rear (96) wheels are connected to the foot brackets (56) and rearward legs (74), respectively, for providing rolling support of the seat when removed from the vehicle in a roll-away position.

**FOR THE PURPOSES OF INFORMATION ONLY**

Codes used to identify States party to the PCT on the front pages of pamphlets publishing international applications under the PCT.

AL	Albania	ES	Spain	LS	Lesotho	SI	Slovenia
AM	Armenia	FI	Finland	LT	Lithuania	SK	Slovakia
AT	Austria	FR	France	LU	Luxembourg	SN	Senegal
AU	Australia	GA	Gabon	LV	Latvia	SZ	Swaziland
AZ	Azerbaijan	GB	United Kingdom	MC	Monaco	TD	Chad
BA	Bosnia and Herzegovina	GE	Georgia	MD	Republic of Moldova	TG	Togo
BB	Barbados	GH	Ghana	MG	Madagascar	TJ	Tajikistan
BE	Belgium	GN	Guinea	MK	The former Yugoslav Republic of Macedonia	TM	Turkmenistan
BF	Burkina Faso	GR	Greece	ML	Mali	TR	Turkey
BG	Bulgaria	HU	Hungary	MN	Mongolia	TT	Trinidad and Tobago
BJ	Benin	IE	Ireland	MR	Mauritania	UA	Ukraine
BR	Brazil	IL	Israel	MW	Malawi	UG	Uganda
BY	Belarus	IS	Iceland	MX	Mexico	US	United States of America
CA	Canada	IT	Italy	NE	Niger	UZ	Uzbekistan
CF	Central African Republic	JP	Japan	NL	Netherlands	VN	Viet Nam
CG	Congo	KE	Kenya	NO	Norway	YU	Yugoslavia
CH	Switzerland	KG	Kyrgyzstan	NZ	New Zealand	ZW	Zimbabwe
CI	Côte d'Ivoire	KP	Democratic People's Republic of Korea	PL	Poland		
CM	Cameroon	KR	Republic of Korea	PT	Portugal		
CN	China	KZ	Kazakstan	RO	Romania		
CU	Cuba	LC	Saint Lucia	RU	Russian Federation		
CZ	Czech Republic	LI	Liechtenstein	SD	Sudan		
DE	Germany	LK	Sri Lanka	SE	Sweden		
DK	Denmark	LR	Liberia	SG	Singapore		
EE	Estonia						

## FOLD AND TUMBLE SEAT SUPPORT ASSEMBLY

### 1. Field of Invention

The subject invention relates to a fold and tumble seat support assembly for removably  
5 securing a vehicle seat to the floor of a vehicle.

### 2. Background of Invention

Automotive vehicle rear seats often include a seat support assembly for removably  
supporting the seat to the floor of a vehicle. The seat support assemblies often also provide for  
10 pivoting of the seat between a use position for supporting an occupant on the seat and a  
forwardly pivoted position or tumbled position. These seat support assemblies are often referred  
to as fold and tumble seat mechanisms. The seat back portion of the seat can fold onto the seat  
cushion and then the entire seat can tumble forward from the use position to the tumbled  
position. These mechanisms provide an ingress/egress path for a passenger to or from behind  
15 the seat, and provide quick additional cargo room by folding the seat back flat to the seat  
cushion prior to rotating or pivoting forwardly to the tumbled position.

One type of fold and tumble seat mechanism utilizes four floor strikers to attach the seat  
to the floor. The seat rotates forward, when the rear latch mechanisms are released from the two  
20 rear strikers, by pivoting on the front two strikers. Once the two rear latches are released, the  
seat rotates forward by an applied force supplied by a spring loaded leg which is attached to the  
seat mechanism base or riser at one end and acts against the floor at the other end. The leg end  
acting against the floor contains a wheel that rolls on the floor as the seat mechanism rotates  
forward. The rear latch areas of the mechanism may or may not be designed to tuck into the seat  
25 mechanism as the seat tilts forward. Once the seat rotates to its full forward position, the front  
two latches can be released to remove the seat from the vehicle. The seat back may or may not  
need to be folded flat to the seat cushion prior to intended seat removal. There is minimal, if  
any, under-seat storage intended due to the chosen design.

30 Another type of fold and tumble seat mechanism utilizes six floor strikers to attach the  
seat to the floor. There are two strikers for each front latch mechanism and one striker for each  
rear latch mechanism. The seat rotates forward, when the rear latch mechanisms are released  
from the two rear strikers, by pivoting on the front two latch legs of the seat mechanism which

are latched to the front strikers. Once the two rear latches are released, the seat rotates forward by an applied force supplied by a spring load between the front latch legs and the riser. The rear latch areas of the mechanism are designed to tuck into the seat mechanism, by a link connected from the front latch leg to the rear latch leg, as the seat tilts forward. Once the seat rotates to its  
5 full forward position, the front two latches can be released to remove the seat from the vehicle. The seat back may or may not need to be folded flat to the seat cushion prior to intended seat removal. Again, there is minimal, if any, under-seat storage intended due to the chosen design.

There are several inadequacies of each of the aforementioned designs. Neither design  
10 provides any under-seat storage and when the seats are removed from the vehicle and placed on the ground, the latch mechanisms support the seat weight which could damage the mechanism or the surface its resting upon.

The first type of fold and tumble mechanism uses the roller leg to supply the load to  
15 rotate the seat. This makes the reinstallation of the seat to the vehicle more difficult for the customer. Additionally, the roller can create a wear pattern on the floor. Finally, debris on the floor can interfere with the intended function of the roller leg.

The second type of fold and tumble mechanism uses six strikers to mount the seat, which  
20 is an added cost to the vehicle. Latching and unlatching the seat from the front strikers is more difficult for the passenger because the front latch mechanisms hook on one of the front strikers and latch to the other. Additionally, visibility for performing this process is poor, creating some of the difficulty.

25

### SUMMARY OF THE INVENTION

A seat support assembly for removable securing a vehicle seat to a pair of front and rear strikers on the floor of a vehicle comprises a riser having a forward leg and a rearward leg for supporting the seat above the vehicle floor. A rear latch is pivotally coupled to the rearward leg of the riser for releasably securing the seat to the rear striker. A first linkage mechanism extends  
30 between the riser and the rear latch for moving the rear latch between a latched position for engaging the rear striker and an unlatched position for disengaging from the rear striker. A foot bracket is pivotally coupled to the forward leg of the riser for supporting the seat above the vehicle floor between a generally horizontal use position with the rear latch in the latched

position and a tumbled position with the riser pivoted forwardly about the foot bracket with the rear latch in the unlatched position. A rear support leg is pivotally coupled to the rearward leg of the riser and pivotal between a support position for supporting the seat above the vehicle floor and stowed position retracted against the riser. A front latch is pivotally coupled to the foot  
5 bracket for releasably securing the seat to the front strikers. Finally, a second linkage mechanism is coupled between the foot bracket and the rear support leg for automatically retracting the rear support leg from the support position to the stowed position, while the first linkage mechanism automatically pivots the rear latch from an extended position for movement between said latched and unlatched positions and a retracted position folded against the riser, in response to pivotal  
10 movement of the riser about the foot bracket from the use position to the tumbled position.

### **BRIEF DESCRIPTION OF THE DRAWINGS**

Other advantages of the present invention will be readily appreciated as the same becomes better understood by reference to the following detailed description when considered  
15 in connection with the accompanying drawings wherein:

Figure 1 is a front elevational view of the fold and tumble seat support assembly of the present invention;

Figure 2 is a side elevational view of the seat support assembly of Figure 1, illustrated in a use and latched position;

20 Figure 3 is a side elevational view of the seat support assembly of Figure 1, illustrated in a tumbled position; and

Figure 4 is a side elevational view of the seat support assembly of Figure 1, illustrated in a roll-away condition.

### **DETAILED DESCRIPTION OF THE DRAWINGS**

25 Referring to Figure 1, a fold and tumble seat support assembly of the present invention is generally shown at 10. The seat support assembly 10 removably secures a vehicle seat to a pair of front and rear strikers 12,14 on the floor 16 of a vehicle. The seat includes a seat cushion frame 18 and a seat back mounted to the top of a riser 20 for supporting the seat above the  
30 vehicle floor 16 in a manner well known in the art. The riser 20 has a generally inverted U-shaped configuration, when viewed from the front or rear of the seat support assembly 10. The riser 20 has front and rear latches, as will be discussed in greater detail herein below, which releasably connect the seat support assembly 10 to the floor 16 of the vehicle. The floor 16 has

a channel 22 having a recessed sub-floor 24 in which the strikers 12,14 are mounted. The use of strikers mounted in channels is more fully described in United States Patent No. 5,372,398, the entire contents of which are incorporated herein by way of reference.

5           The riser 20 includes an upper platform 26 for supporting the seat cushion frame 18 which extends between first 28 and second 30 sides on each side thereof which significantly space the upper platform 26 above the vehicle floor 16 providing under-seat storage. The sides 28,30 are generally the same on each side of the riser 20 and thus only one side need be described. Each side 28,30 comprises a forward leg 32 and rearward leg 34. A rear latch 36 is  
10 pivotally connected at pin 38 to the rearward leg 34 of the riser 20 for releasably securing the seat to the rear striker 14. A first linkage mechanism 40 extends between the riser 20 and the rear latch 36 for moving the rear latch 36 between a latched position for engaging the rear striker 14, as shown in Figure 2, and an unlatched position for disengaging the rear striker 14, as shown in phantom in Figure 2. The first linkage mechanism 40 includes a rear latch handle 42 pivotally  
15 secured by pin 44 to the side 28,30 of the riser 20 and coupled to the rear latch 36 for moving the rear latch 36 between the latched and unlatched position. The first link mechanism 40 further includes a fixed link 46 fixedly secured to the rear latch 36 for rotation therewith, a first link 48 fixedly secured to the rear latch handle 42, and a second link 50 having opposite ends pivotally connected at pins 52, 54 between the fixed link 46 and the first link 48, respectively.  
20 The links 46,48,50 transfer pivotal movement of the rear latch handle 42 to pivotal movement of the rear latch 36 during movement between the latched and unlatched positions. A coil spring 39 is secured between the pin 38 and latch 36 to continuously bias the latch 36 in the clockwise or latching direction engaging the rear striker 14.

25           A foot bracket 56 is pivotally connected at pin 88 to the forward leg 32 for supporting the seat above the vehicle floor 16 between a generally horizontal use position with the rear latch 36 in the latched position, as shown in Figure 2, and a tumbled position with the riser 20 pivoted forwardly about the foot bracket 56 with the rear latch 36 in the unlatched position, as shown in Figure 3. The foot bracket 56 has generally triangular configuration with the pivot at pin 88  
30 slightly offset from the center thereof. A forward lower corner of the foot bracket 56 has a pad 60 for contacting the sub-floor 24. The foot bracket 56 further includes an open notch 62 adjacent the pad 60 for receiving the front striker 12.

A front latch 64 is pivotally connected at pin 66 to the foot bracket 56 for releasably securing the seat to the front striker 12. A front latch handle 68 is fixedly secured to the front latch 64 for moving, or pivoting, the latch 64 between a latched position for engaging the front striker 12 when the riser 20 is in each of the use and tumbled positions, as shown in Figures 2 and 3, and an unlatched position for disengaging the front striker 12 and removing the seat from the vehicle floor in a roll-away position as shown in Figure 4. The front latch handle 68 is a wire or tubular member which interconnects both the front latches 64 for ganged operation. The front latch 64 includes a J-shaped hook portion 70 for closing the open notch 62 of the foot bracket 56, capturing the front striker 12 therein and securing the riser 20 to the front striker 12 in the latched position.

A rear support leg 74 is pivotally connected to the rearward leg 34 of the riser 20 and pivotal between a support position for supporting the seat above the vehicle floor, as shown in Figure 2, and a stowed position retracted against the riser 20, as shown in Figures 3 and 4. More specifically, the rear support leg 74 is pivotally connected to both the rearward leg 34 and the rear latch 36 by the pin 38 for engaging the rear striker 14 and supporting the riser 20 on the vehicle floor 16 in the use position. The rear support leg 74 includes an open notch 76 for receiving the rear striker 14 and supporting the riser 20 above the vehicle floor 16. The rear latch 36 includes a J-shaped hook portion 78 for closing the open notch 76, capturing the rear striker 14, and securing the riser 20 to the rear striker 14 in the latched position.

A second linkage mechanism 72 is coupled between the foot bracket 56 and the rear support leg 74 for automatically retracting the rear support leg 74 from the support position to the stowed position, while the first linkage mechanism 40 automatically pivots the rear latch 36 from an extended position for movement between the latched and unlatched positions, as shown in Figure 2, and a retracted position folded against the riser 20, as shown in Figures 3 and 4, in response to pivotal movement of the riser 20 about the foot bracket 56 from the use position to the tumbled position.

The second linkage mechanism 72 includes a longitudinally extending link rod 80 having a first end pivotally connected at the pin 58 on the foot bracket 56 and a second end pivotally connected at pin 84 to the rear support leg 74 for automatically retracting the rear support leg 74 against the riser 20 in response to the pivotal movement of the riser 20 about the foot bracket

56 from the use position to the tumbled position. A spiral spring 86 is fixedly secured between the foot bracket 56 by pin 88 and the forward leg 32 of the riser 20 by pin 90 for continuously biasing the riser 20 toward the tumbled position.

5 A front wheel 92 is rotatably attached by axle 94 to the rearward corner of the foot bracket 56 for further supporting the riser 20 in each of the use and tumbled positions and for movably supporting the forward leg 32 when the seat is removed from the vehicle floor 16 in the roll-away position. That is, in the use position and the tumbled position, both the pad 60 of the foot bracket 56 and the front wheel 92 contact the sub-floor 24 to support the riser 20.

10

A rear wheel 96 is rotatably attached by axle 98 to the rearward leg 34. The rear wheel 96 is spaced above the vehicle floor 16 when the rear latch 36 is in the extended position and extends below the rear latch 36 in the retracted position for movably supporting the rearward leg 34 of the riser 20 when the seat is removed from the vehicle floor 16 in the roll-away  
15 position. The rear wheel 96 is also spaced above the vehicle floor 16 when the rear support leg 74 is in the support position and extends below the leg 74 in the stowed position.

In operation, to move the seat from the use position to the tumbled position, the user simply rotates the rear latch handle 42 in the counterclockwise direction. The first linkage  
20 mechanism 40 transfers the rotational movement of the handle 42 to rotation of the rear latch 36 to release the hook portion 78 from the rear striker 14. The continuously biasing force of the spiral spring 86 will urge the seat to pivot forwardly to the tumbled position. Obviously, depending on the strength of the spring 86, some user assistance may be necessary for the seat to fully tumble. The seat will rotate about the pin 88 of the foot bracket 56. Since the foot  
25 bracket 56 is stationary, the link rod 80 of the second linkage mechanism 72 will automatically force the rear support leg 74 to retract from the support position to the stowed position. Also, the coil spring 39 of the first linkage mechanism 40 will automatically force the rear latch 36 to rotate about the pin 38 to the retracted position against the riser 20 as shown in Figure 3. More specifically, as the rear support leg 74 is forced to rotate to the retracted position, the coil spring  
30 39 forces the rear latch 36 to rotate with the leg 74 to the retracted position. The retraction of both the rear support leg 74 and the rear latch 36 optimizes ingress and egress, as well as storage, behind the seat in the tumbled position. The rear latch handle 42 maintains its orientation with respect to the riser 20 via the first linkage mechanism 40 having pivot pins



52,54 connecting the second link 50 between the first link 48 and the fixed link 46. When the seat is rotated back from the tumbled position to the use position, the rear support leg 74 automatically returns to its extended position for support against the rear striker 14 and simultaneously forces the rear latch 36 to return to its extended position for automatic  
5 engagement with the rear striker 14.

In the tumbled position, the seat may also be completely unlatched from the vehicle floor 16 and removed from the vehicle. In the tumbled position, the front latch handle 68 is pivoted to disengage the front latch 64 from the front striker 12. When the entire seat is removed and  
10 lowered to a generally horizontal position, the front wheels 92 support the forward legs 32 and the rear wheels 96 support the rearward legs 34 to provide rolling movement of the seat in the roll-away position. The rear support leg 74 and the rear latch 36 are retained in the stowed and retracted positions, respectively, against the riser 20 to expose the rear wheels 96 and prevent  
15 contact of all the wheel 92,96 with the support floor of the seat or damage thereto by the weight of the seat. Thus, the entire seat can be rolled away for easy removal and storage.

The invention has been described in an illustrative manner, and it is to be understood that the terminology used is intended to be in the nature of words of description rather than of  
limitation.

20

Many modification and variations of the present invention are possible in light of the above teachings. Therefore, it is to be understood that within the scope of the appended claims, the invention may be practiced otherwise than as specifically described.

What is claimed is:

1. A seat support assembly for removably securing a vehicle seat to a pair of front and rear strikers on the floor of a vehicle, said support assembly comprising:
  - a riser for supporting the seat above the vehicle floor, said riser having a forward leg and  
5 a rearward leg;
  - a rear latch pivotally coupled to said rearward leg of said riser for releasably securing the seat to the rear striker;
  - a first linkage mechanism extending between said riser and said rear latch for moving said rear latch between a latched position for engaging the rear striker and an unlatched position  
10 for disengaging from the rear striker;
  - a foot bracket pivotally coupled to said forward leg of said riser for supporting the seat above the vehicle floor between a generally horizontal use position with said rear latch in said latched position and a tumbled position with said riser pivoted forwardly about said foot bracket with said rear latch in said unlatched position;
  - 15 a rear support leg pivotally coupled to said rearward leg of said riser and pivotal between a support position for supporting the seat above the vehicle floor and stowed position retracted against said riser;
  - a front latch pivotally coupled to said foot bracket for releasably securing the seat to the front strikers;
  - 20 and a second linkage mechanism coupled between said foot bracket and said rear support leg for automatically retracting said rear support leg from said support position to said stowed position, while said first linkage mechanism automatically pivots said rear latch from an extended position for movement between said latched and unlatched positions and a retracted position folded against said riser, in response to pivotal movement of said riser about said foot  
25 bracket from said use position to said tumbled position.
2. A seat support assembly as set forth in claim 1 further including a spring connected between said foot bracket and said riser for continuously biasing said riser toward said tumbled position.
- 30 3. A seat support assembly as set forth in claim 2 further including a front latch handle for moving said front latch between a latched position for engaging the front striker when said riser is in each of said use and tumbled positions and an unlatched position for disengaging the front

striker and removing the seat from the vehicle floor.

4. A seat support assembly as set forth in claim 3 further including a front wheel rotatably attached to said foot bracket for supporting said riser in said use and tumbled position and for  
5 movably supporting said forward leg of said riser when the seat is removed from the vehicle floor.

5. A seat support assembly as set forth in claim 4 further including a rear wheel rotatably attached to said rearward leg of said riser wherein said rear wheel is spaced above the vehicle  
10 floor when said rear latch is in said extended position and extends below said rear latch in said retracted position for movably supporting said rearward leg of said riser when the seat is removed from the vehicle floor.

6. A seat support assembly as set forth in claim 5 wherein said rear wheel is spaced above  
15 the vehicle floor when said rear support leg is in said support position and extends below said rear support leg in said stowed position for movably supporting said rearward leg of said riser when the seat is removed from the vehicle floor.

7. A seat support assembly as set forth in claim 6 wherein said rear support leg includes a  
20 first portion pivotally coupled to said rearward leg of said riser and said rear latch and an open notch for engaging the rear striker and supporting said riser on the vehicle floor in said use position.

8. A seat support assembly as set forth in claim 7 wherein said second linkage mechanism  
25 includes a link rod pivotally coupled between said foot bracket and said rear support leg for automatically retracting said rear support leg and said rear latch against said riser and above said rear wheel in response to said pivotal movement of said riser about said foot bracket from said use position to said tumbled position.

30 9. A seat support assembly as set forth in claim 8 wherein said first linkage mechanism includes a rear latch handle secured to said riser and coupled to said rear latch for moving said rear latch between said latched and unlatched positions.

10. A seat support assembly as set forth in claim 9 wherein said first linkage mechanism includes a fixed link fixedly secured to said rear latch and pivotally connected to said rearward leg of said riser, a first link fixedly secured to said rear latch handle, and a second link having opposite ends pivotally connected between said fixed link and said first link for transferring  
5 pivotal movement of said rear latch handle to pivotal movement of said rear latch during movement between said latched and unlatched positions.

11. A seat support assembly as set forth in claim 10 wherein said first linkage mechanism includes a spring coupled between said rearward leg and said rear latch for retracting said rear  
10 latch from said extended position to said retracted position.

12. A seat support assembly as set forth in claim 11 wherein said foot bracket includes an open notch for receiving the front striker and said front latch includes a hook for closing said open notch and securing said riser to the front striker in said latched position.  
15

13. A seat support assembly as set forth in claim 12 wherein said rear latch includes a hook for closing said open notch on said rear support leg and securing said riser to the rear striker in said latched position.

20 14. A seat support assembly as set forth in claim 13 wherein said riser is generally U-shaped and includes an upper platform for supporting the seat and extending between first and second sides wherein each of said sides form forward and rearward legs of said riser.

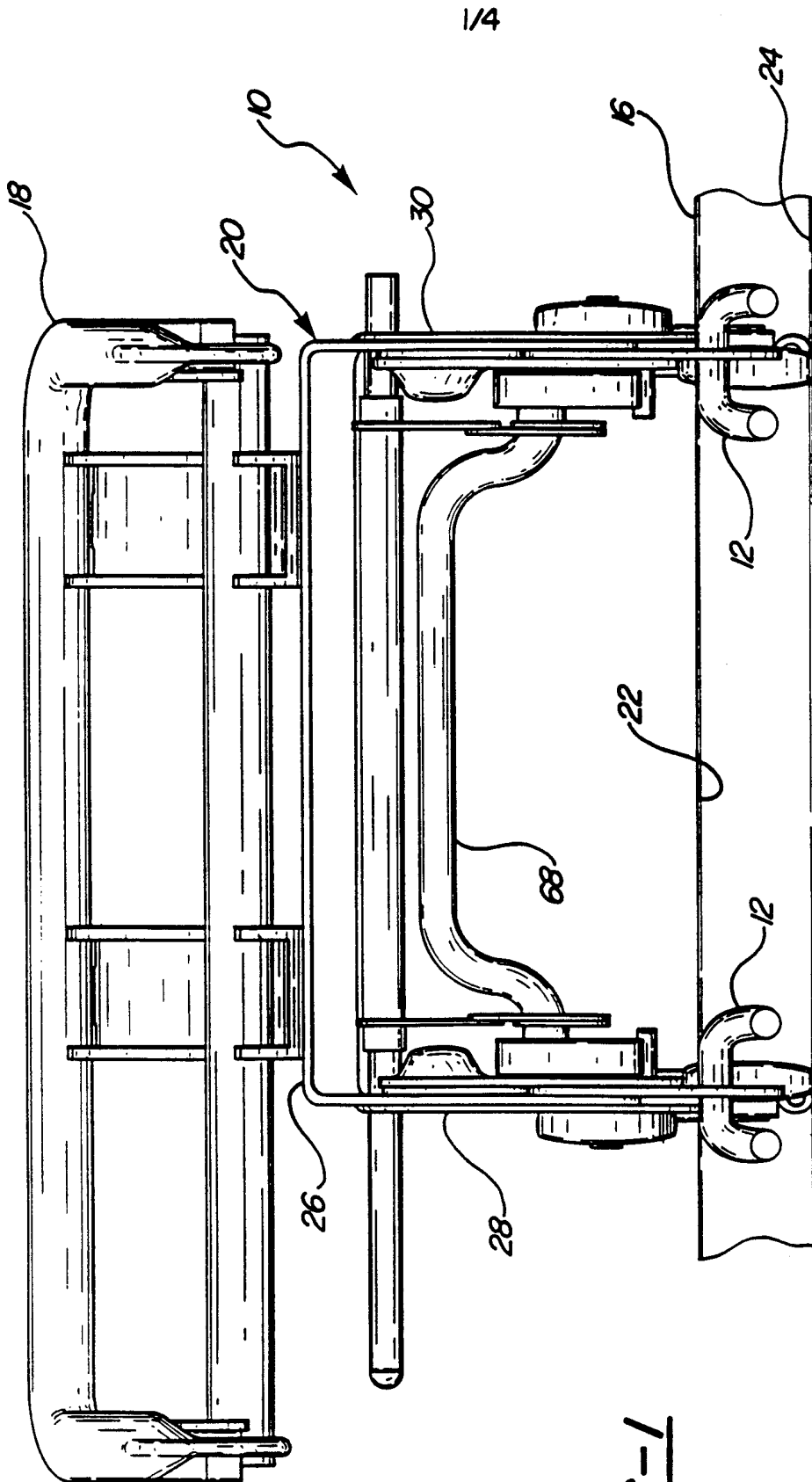

**FIG-1**

FIG-2

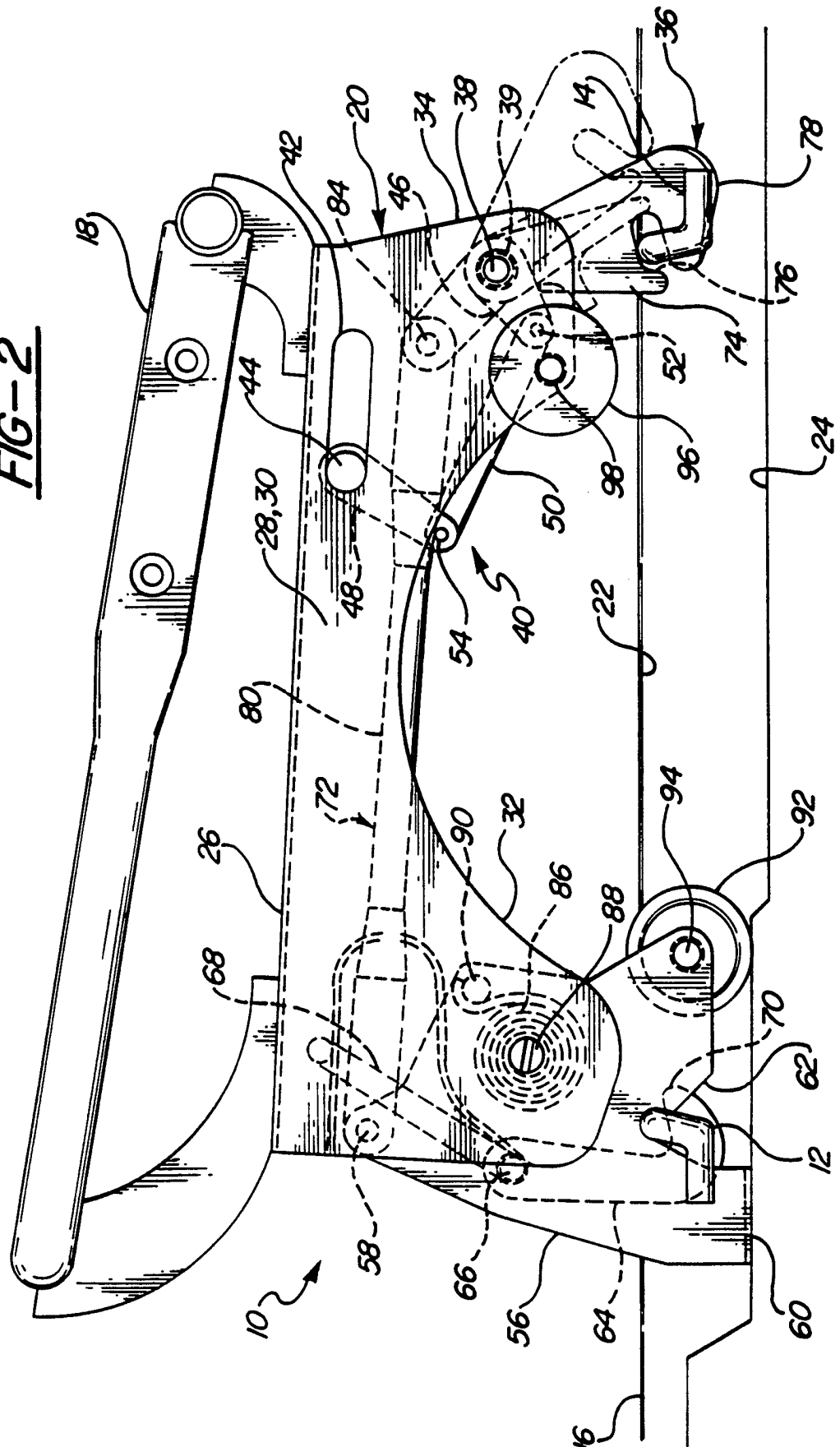
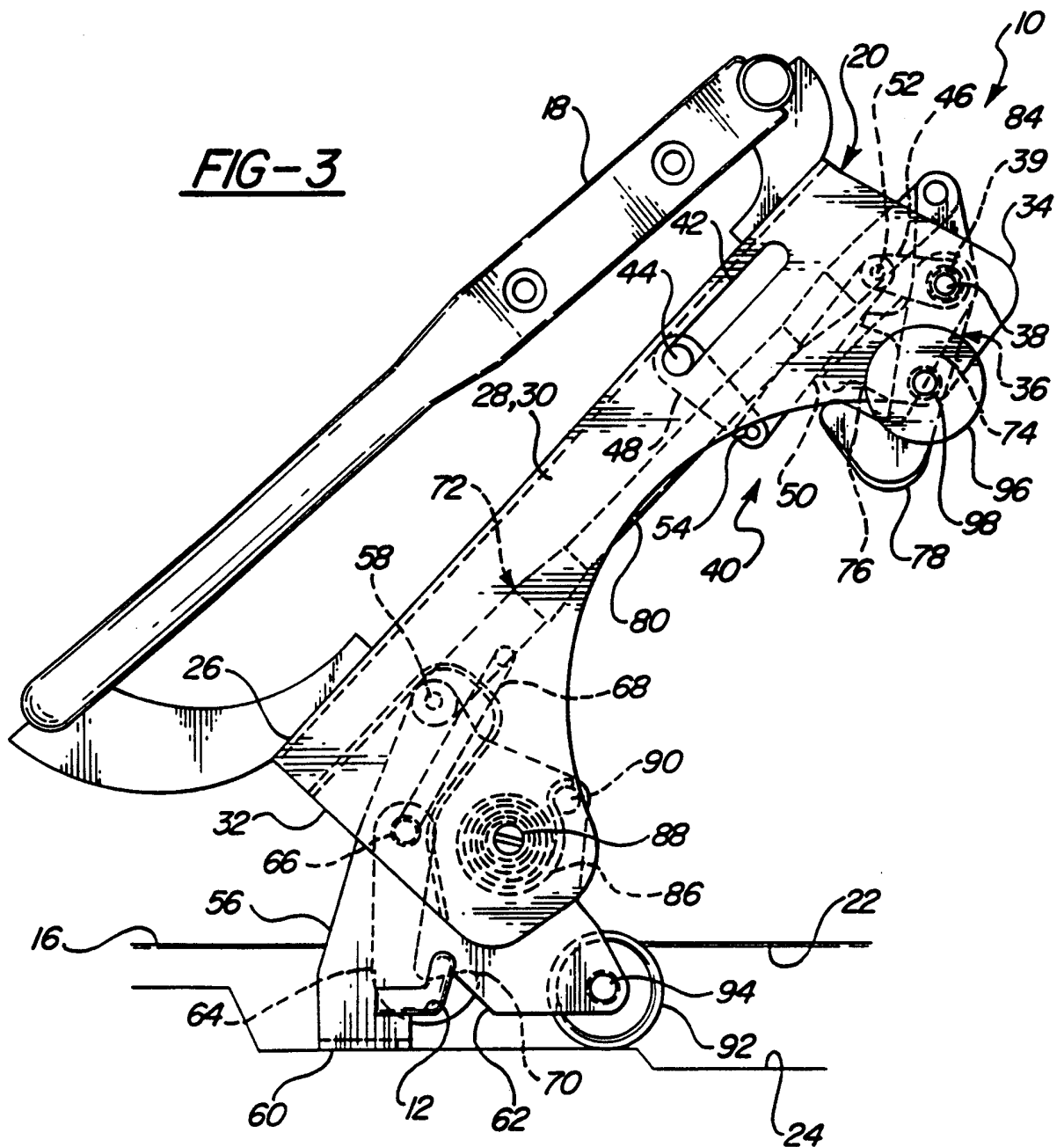
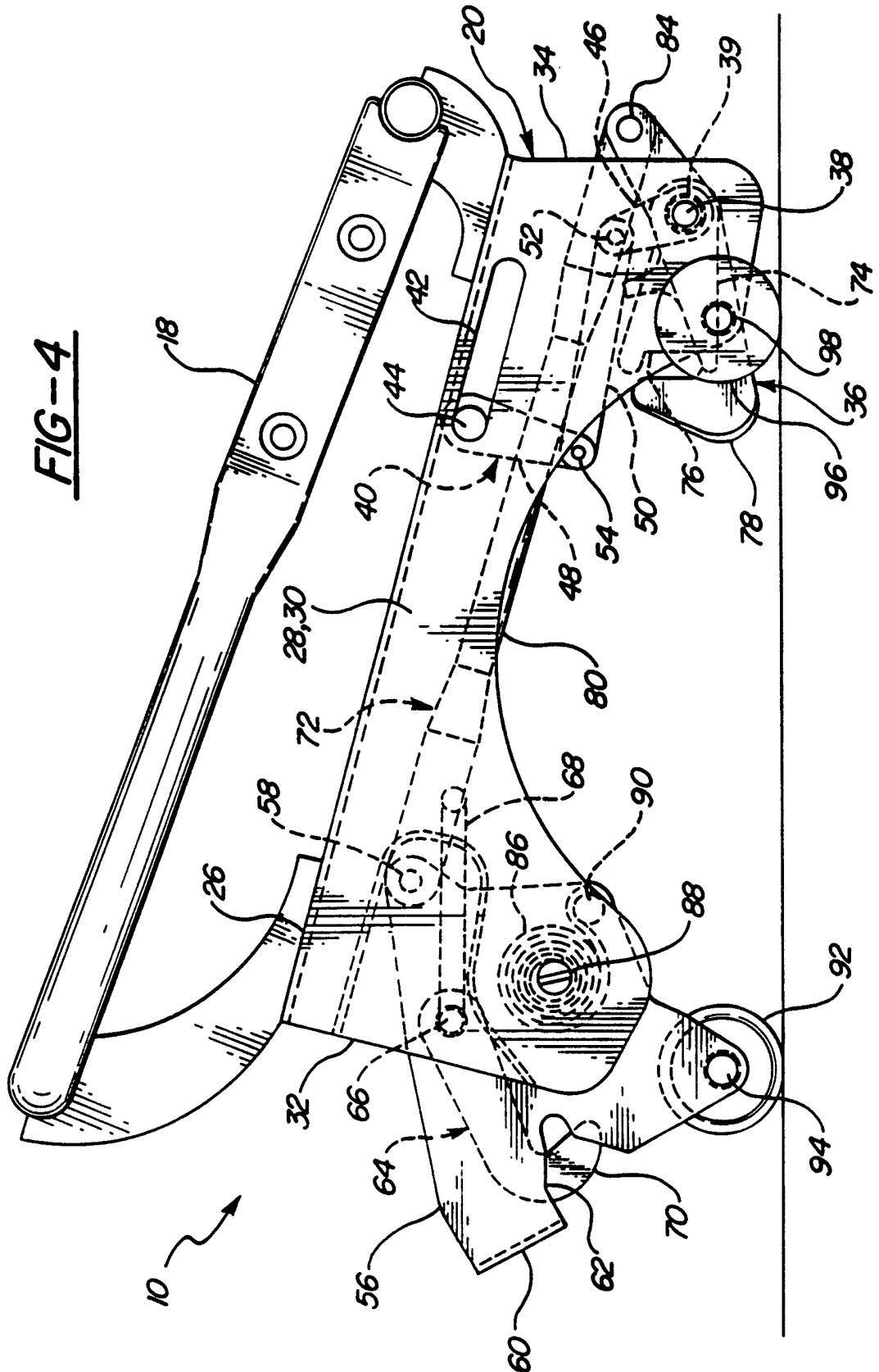

FIG-3



**FIG-4**





**INTERNATIONAL SEARCH REPORT**

International Application No

PCT/CA 99/00506

**A. CLASSIFICATION OF SUBJECT MATTER**  
IPC 6 B60N2/00

According to International Patent Classification (IPC) or to both national classification and IPC

**B. FIELDS SEARCHED**

Minimum documentation searched (classification system followed by classification symbols)

IPC 6 B60N

Documentation searched other than minimum documentation to the extent that such documents are included in the fields searched

Electronic data base consulted during the international search (name of data base and, where practical, search terms used)

**C. DOCUMENTS CONSIDERED TO BE RELEVANT**

Category *	Citation of document, with indication, where appropriate, of the relevant passages	Relevant to claim No.
A	US 5 238 285 A (CARL J. HOLDAMPF ET AL.) 24 August 1993 (1993-08-24) column 3, line 28 - column 6, line 16; figures 1-6 ---	1-14
A	US 5 372 398 A (RICARDO Z. ANEIROS ET AL.) 13 December 1994 (1994-12-13) cited in the application abstract; figures 1-3,6 ---	1-14
A	WO 97 36765 A (BERTRAND FAURE COMPONENTS LTD.) 9 October 1997 (1997-10-09) page 22, line 19 - page 24, line 23; claim 1; figures 5-12 ---	1-14
	-/--	

Further documents are listed in the continuation of box C.

Patent family members are listed in annex.

\* Special categories of cited documents :

- "A" document defining the general state of the art which is not considered to be of particular relevance
- "E" earlier document but published on or after the international filing date
- "L" document which may throw doubts on priority claim(s) or which is cited to establish the publication date of another citation or other special reason (as specified)
- "O" document referring to an oral disclosure, use, exhibition or other means
- "P" document published prior to the international filing date but later than the priority date claimed

- "T" later document published after the international filing date or priority date and not in conflict with the application but cited to understand the principle or theory underlying the invention
- "X" document of particular relevance; the claimed invention cannot be considered novel or cannot be considered to involve an inventive step when the document is taken alone
- "Y" document of particular relevance; the claimed invention cannot be considered to involve an inventive step when the document is combined with one or more other such documents, such combination being obvious to a person skilled in the art.
- "&" document member of the same patent family

Date of the actual completion of the international search

1 September 1999

Date of mailing of the international search report

17/09/1999

Name and mailing address of the ISA

European Patent Office, P.B. 5818 Patentlaan 2  
NL - 2280 HV Rijswijk  
Tel. (+31-70) 340-2040, Tx. 31 651 epo nl,  
Fax: (+31-70) 340-3016

Authorized officer

Cuny, J-M

## INTERNATIONAL SEARCH REPORT

International Application No

PCT/CA 99/00506

C.(Continuation) DOCUMENTS CONSIDERED TO BE RELEVANT		
Category *	Citation of document, with indication, where appropriate, of the relevant passages	Relevant to claim No.
A	US 5 498 051 A (KARL G. SPONSLER ET AL.) 12 March 1996 (1996-03-12)  abstract; figures 1-4 -----	1-3, 9-11,13, 14
A	FR 2 556 946 A (SABLE, SOCIÉTÉ ANONYME) 28 June 1985 (1985-06-28) abstract; claims 1-17; figure 1 -----	1,3,9, 11,13,14

# INTERNATIONAL SEARCH REPORT

Information on patent family members

International Application No

PCT/CA 99/00506

Patent document cited in search report	A	Publication date	Patent family member(s)	Publication date
US 5238285	A	24-08-1993	NONE	
US 5372398	A	13-12-1994	AT 162477 T AU 672667 B AU 5793794 A CA 2120394 A CN 1095023 A DE 69408007 D DE 69408007 T EP 0618102 A ES 2111246 T JP 7117533 A	15-02-1998 10-10-1996 06-10-1994 03-10-1994 16-11-1994 26-02-1998 20-05-1998 05-10-1994 01-03-1998 09-05-1995
WO 9736765	A	09-10-1997	CA 2198674 A EP 0889798 A	29-09-1997 13-01-1999
US 5498051	A	12-03-1996	NONE	
FR 2556946	A	28-06-1985	US 4700989 A	20-10-1987