



(11) (21) (C) **2,180,799**  
(22) 1996/07/09  
(43) 1997/01/22  
(45) 2001/03/27

(72) Dufresne, Christopher, FR

(72) Bonneval, Georges, FR

(72) Emin, Jean, FR

(72) Golabek, Robert S., Jr., US

(73) BECTON, DICKINSON AND COMPANY, US

(51) Int.Cl.<sup>6</sup> G01N 33/49, B01L 3/14

(30) 1995/07/21 (95111546.8) EP

(54) **TUBE A ESSAI POUR DETERMINER LE TAUX DE  
SEDIMENTATION DES ERYTHROCYTES ET SURFACTIF  
EMPLOYE A CETTE FIN**

(54) **TEST TUBE FOR DETERMINING THE ERYTHROCYTE  
SEDIMENTATION RATE AND A SURFACTANT FOR USE  
THEREIN**

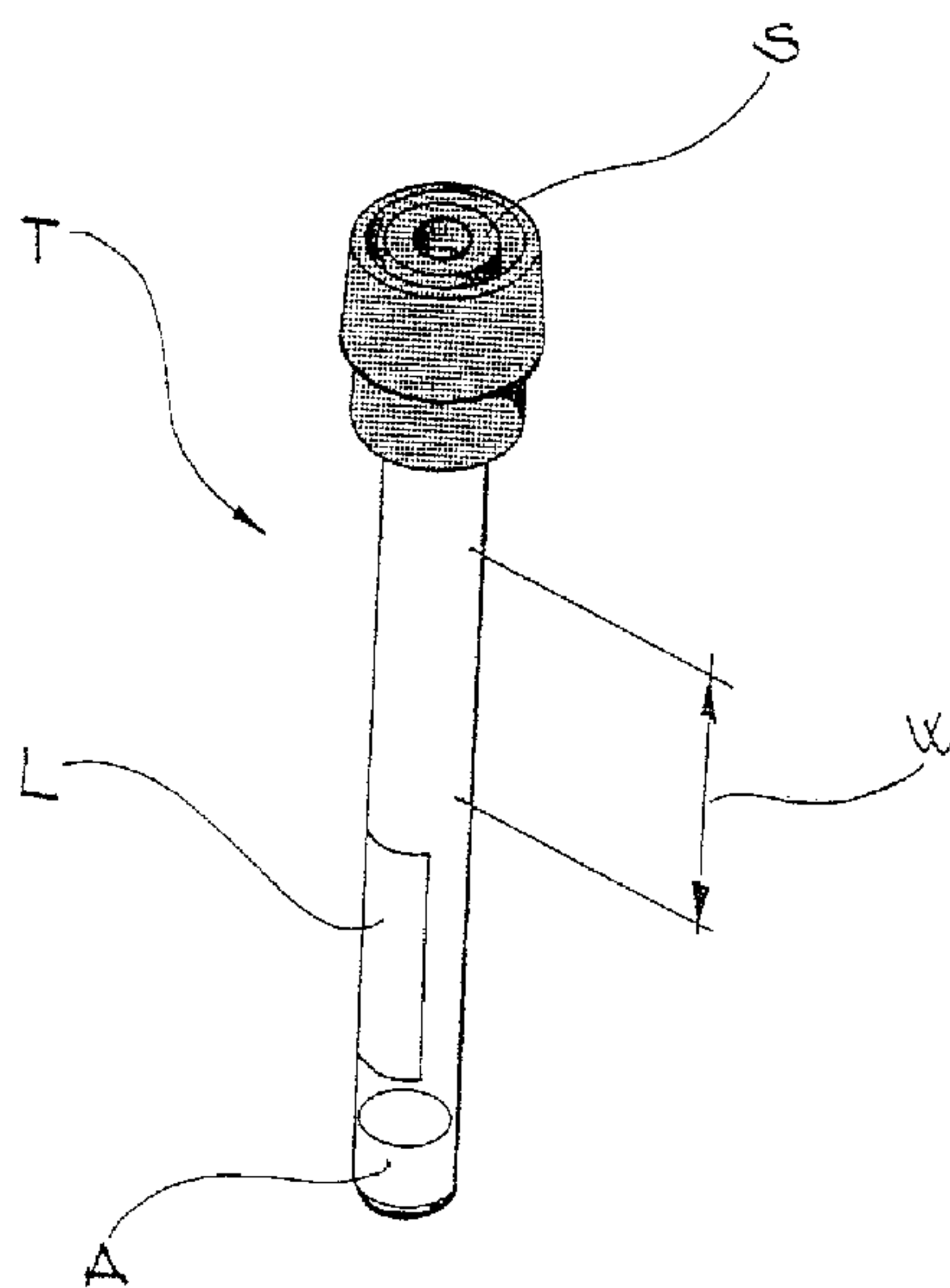

(57) In an improved method for measuring the erythrocyte sedimentation rate (ESR) a pre-evacuated test tube (T) is used to collect a blood specimen. The tube (T) is made of a material such as glass or plastics and contains an anticoagulant agent. In order to facilitate mixing of the blood sample a surfactant such as an organo-silicone fluid is provided in the tube (T) as an additive.



ABSTRACT

A test tube for determining the erythrocyte sedimentation rate and a surfactant for use therein

In an improved method for measuring the erythrocyte sedimentation rate (ESR) a pre-evacuated test tube (T) is used to collect a blood specimen. The tube (T) is made of a material such as glass or plastics and contains an anticoagulant agent. In order to facilitate mixing of the blood sample a surfactant such as an organo-silicone fluid is provided in the tube (T) as an additive.

(Fig.1)

A test tube for determining the erythrocyte sedimentation rate and a surfactant for use therein

The present invention relates generally to determining the erythrocyte sedimentation rate (ESR) in a blood sample. The standard laboratory method heretofore used for measuring ESR is the so-called Westergren method. A general review of that method is provided in "ICSH recommendations for measurement of erythrocyte sedimentation rate" published in Journal of Clinical Pathology 1993; 46: 198-203.

Essentially, the Westergren method provides for a sample of blood to be collected in a test tube (pipette) to form a 200 mm blood column in the presence of an anti-coagulant. After mixing the specimen briefly, the test tube is loaded into a device or an instrument including sensors such as an optical sensor to record the location of the blood/air meniscus at an initial time. After a period of 60 or 120 minutes, the operator or the sensor then identifies and measures the location of the cell/plasma interface. The distance in millimetres from initial blood/air meniscus and the final cell/plasma interface gives the typical Westergren output value for the test which is expressed in units of mm/hr.

A basic disadvantage of the conventional Westergren method lies in the considerable length of the test tube (typically in excess of 200 mm) which makes it unsuitable for use in collecting blood directly. Consequently, blood for the test has to be taken either by using a syringe or a pre-evacuated tube and the blood thus collected must then be transferred to the Westergren test tube. In addition to being impractical, such a procedure exposes the operator to the danger of contacting the blood during the transfer process.

Systems dispensing with such a drawback and carrying out ESR determination using tubes significantly shorter than the standard 200 mm Westergren pipette are already available.

Exemplary of such prior art is, for instance, the ESR measuring system sold under the trademark SEDISCAN by the assignee of the present application. A SEDISCAN instrument is adapted for use in connection with tubes (sold under the trademark SEDITAINER - both SEDISCAN and SEDITAINER being registered trademarks of Becton Dickinson and Company) essentially comprised of 5 ml draw tube of 120 mm length and 10.25 mm outer diameter containing liquid sodium citrate/citric acid at 4:1 ratio. Using the above tube, the SEDISCAN instrument provides an extrapolated Westergren value after 30 minutes which compares well to actual 60 and 120 minutes Westergren values. However, it is necessary to examine nearly the entire tube length (about 70-80 mm of the blood column height of 100 mm) in order to predict the ESR. The tube is held vertically.

Another system using "short" tubes is sold under the trade name VESMATIC by the Italian company Dienes Diagnostica Senese S.r.l.. The tube for use in this latter system has a rectangular shape overall and a triangular shape of the tube bottom. Again, nearly the entire tube length must be scanned which leads to using an additional plastics outer sleeve to apply patient bar code or identification labels. The outer sleeve and the patient identification data must be removed from the tube before this is placed in the instrument for carrying out the test. Consequently, there is an actual danger that, due to the high number of tubes tested concurrently in a laboratory, a diagnostic result may be incorrectly assigned to the wrong patient due to a mistake in association of the clinical result for a tube with the patient identification contained on the removed outer sleeve.

So, it is practically a mandatory requirement for any test tube for proper use in ESR measuring test to carry patient identification data which must not and cannot be removed at any time, while carrying out the test.

Also, there is a growing trend in the field of ESR determination to provide reading of the test final values in a significantly shorter time than the standard 60 minutes of the Westergren method. Finally, the quantity of blood required for the test (and

consequently the quantity of blood to be taken from the patient) is to be made as small as possible.

The present invention basically aims at providing a solution which jointly overcomes the drawbacks of the prior art solutions, i.e. by providing an ESR determination procedure, where:

- "short" tubes are used, preferably adapted for direct blood collection;
- patient identification data, once applied onto the tube, cannot be removed from it, thereby making it impossible to dis-associate the specimen from the patient identification;
- reliable ESR values are provided in a term much shorter than the standard 60 or 120 minutes of the Westergren; and
- the quantity of blood to be taken from the patient is minimised.

A method and apparatus which permit reliable ESR values to be provided in a short term (e.g. 20 minutes or less) will be described in the following which constitute the subject matter of a European Patent application filed on an even date by the same Applicant of the present application.

Specifically, the invention relates to a test tube constituting an improvement over the prior art as exemplified by the SEDITAINER® test tube referred to in the foregoing.

Essentially, the underlying problem of the invention is providing an improved test tube by means of which the results obtained by the captioned new method and apparatus may be optimized. According to the present invention, that problem is solved by means of a test tube having the features set forth in the claims. The invention also relates to a surfactant for use in such an improved test tube.

In the presently preferred embodiment of the invention, a pre-evacuated test tube is used to collect the specimen which is made of such a material as glass or plastics



and which contains an anticoagulant. The tube is then put into a rack and loaded into an instrument which mixes the specimen briefly. The instrument then uses optical sensors to record the location of the blood/air meniscus at an initial time. At subsequent time intervals thereafter for periods up to 30 minutes, typically 20 minutes or less, the optical sensors then identify and measure the location of the cell/plasma interface. These measured values are then converted by a given relationship, e.g. an algorithm, to the values which would be obtained using the classical Westergren method (200 mm blood column height and blood to citrate ratio of 4:1).

When a small bore evacuated blood collection tube containing an anticoagulant is used several requirements should be preferably satisfied in order for the tube to function in a most satisfactory way. These requirements are as follows:

- the anticoagulant must be rapidly mixed with the blood sample at the time of draw to insure a full anticoagulation effect;
- the tube must contain a thoroughly homogeneous suspension of erythrocytes prior to setting up the ESR test in order to obtain optimal results;
- the additive/anticoagulant must not interfere with the haematology parameters of blood.

In the invention, in order to satisfy the first two requirements, a surfactant is added to the tube to promote rapid mixing of the contents by reducing the surface tension of the blood sample to the glass tube. This allows for adequate anticoagulation of the blood specimen during draw. In addition, the amount of mixing (i.e. agitation or stirring) required to insure a homogeneous suspension of erythrocytes during ESR set up is reduced because the tube mixes faster which in turn causes more turbulence within the tube thereby stirring the specimen.

Generally there is an exponential relationship between mixing time and concentration of surfactant, and at approximately 1% by weight the fastest mixing time was found to be achieved.

A similar exponential relationship was found to exist between mixing time and diameter of the glass tube. Due to the use of the surfactant a 6mm inside diameter, 8 mm outside diameter tube was found to mix almost as fast as an 8 mm inside diameter 10 mm outside diameter tube without the use of the surfactant.

Briefly stated the key physical property that the surfactant must exhibit is the lowering of the surface tension of whole blood to the glass tube. The surfactant must also not interfere with the haematology properties of human blood. For example, the surfactant must not effect the alpha-globulin interaction with erythrocytes as this is a key factor in erythrocyte sedimentation rate testing (ESR).

The surfactant must also preferably be:

- irradiation stable, thereby allowing Cobalt 60 sterilization of the tube;
- chemically stable e.g. in a buffered Tri-sodium citrate anticoagulant;
- temperature stable over the desired range of use, as well as during the transit of the product from the plant of the customer.

For example, some surfactants were found to become irreversibly cloudy in the citrate anticoagulant when heated above 50°C. This is perceived as a fungal/bacterial growth in the tube, and is unacceptable.

Desirably, the surfactant is a nonionic surfactant. An example of such a surfactant is an organosilicone. Preferably, the organosilicone is a polyalkyleneoxide modified polydimethylsiloxane. Polyalkyleneoxide modified polydimethyl siloxanes are found to be stable with irradiation, do not cause the blood to haemolysis and increases the rate of mixing of the blood sample.

In a thoroughly unexpected manner, the solution of the invention was found to be suitable for satisfactory and reliable use also in a "manual" ESR determination procedure, wherein the test tube is held vertically during the standard 60-120 minute period and reading is accomplished simply by eye against a reference scale.

The invention will now be described, purely by way of example, with reference to annexed drawings, wherein:

- fig.1 shows a test tube according to the invention,
- figs.2 and 3 show diagrammatically the typical arrangement of device of the invention, and
- figs.4 to 7 show the correlation between the results of the method of the invention and the results which would be obtained using the classical Westergren method.

In fig.1 an exemplary tube according to the invention is generally designated T. Such a tube T - intended to define a cavity for forming a column of blood whose ESR is to be determined - has a tubular, preferably cylindrical wall with an outside diameter of not less than about 7 mm and not more than about 9 mm. The length of the tube T (roughly corresponding to the height of the blood column formed therein which is preferably not less than about 75 mm, but not more than about 105 mm) is preferably about 80 mm. The inside diameter is preferably not less than about 5 mm and not more than about 7 mm and still preferably about 6 mm.

Irrespective of the specific embodiment, the inner diameter of the tube T must be sufficiently large to allow the blood specimen used for the test to mix adequately immediately after collecting to ensure complete anticoagulation is achieved. Subsequently, immediately before initiating the measurement of the ESR, the specimen must be uniformly and completely mixed to re-suspend blood cells.

The inner diameter and tube length should also be sufficiently small to minimise the volume of the blood required from the patient for the test, since excessive blood lost by patients is considered detrimental to their health. This is particularly the case for paediatric patients who have small blood volumes and geriatric patients who have diminished capacity to regenerate blood cells. In the configuration described, blood requirements would be typically less than 2 mls which is considered sufficiently small to have little impact on patient health.



The outer diameter and tube wall thickness must be sufficiently large to add sufficient strength and rigidity to ensure the tube does not break or bend during handling and subsequent testing. However, they should be sufficiently small to ensure the tube is easy to cut, form and glaze as in the case of a glass tube or injection moulded as in the case of a plastics tube. Excess material leads to higher manufacturing cost and an overly thick tube wall could reduce the ability of an optical viewing device to see through the wall when attempting to identifying the meniscus and the interface.

Optical imaging devices, such as a LCDs, linear CCDs and video cameras, are preferably used in connection with a visibly transparent tube wall (at least insofar as the "window" of the tube actually observed is concerned), e.g. made of glass or transparent plastics. Alternative embodiments can however be envisaged, wherein non-optical/sensors and/or visibly opaque, non-transparent tube walls are used. Exemplary of such alternative embodiments are imaging devices operating outside the visible range (e.g. infrared radiation) or devices operating with other kinds of radiation or based on other physical phenomena (e.g. capacitive sensors and the like).

Optical devices are however preferred due to the current availability of devices adapted for use within the framework of the invention. Exemplary of such devices are, in addition to the one used in the assignee's SEDISCAN<sup>R</sup> system, those sold under the trade names Sony CCB-M25/CE (CCD) and Sony PSB9151A (power board) [Sony, Kanafawa, Japan] and Computak 6mm 1:1-2 1/2" C (Lens from Japan).

The open end of the tube T is preferably sealed by a stopper S having vacuum and moisture barrier properties suitable to maintain the additive contents and blood drawing capability for periods in excess of two weeks and preferably for periods in excess of one year.

The tube T according to the invention may be packaged and sold as a stand-alone, disposable, product comprised of the tube body proper (made of glass or plastics, for instance) pre-evacuated and sealed by the stopper S and also including a quantity of additive A. Primarily, the additive is intended to act as an anti-coagulating agent/mixing aid.

Preferably, the additive is a mixture of tri-sodium citrate ( $\text{Na}_3$ ) and citric acid mixed in an aqueous solution to achieve a molarity of 0.105 M-0.135 M. Sufficient solution (e.g. 0.46 cc - referring to the preferred dimensions of the tube T referred to in the foregoing) is dispensed into the tube T during manufacturing in order to ensure a blood to additive ratio upon specimen collection of 4:1. However, when using liquid citrate solutions, blood to additive ratio starting at about 2:1 and below and up to about 10:1 and above are possible; the mathematical algorithm which converts the observed rate of cell settling to the classical Westergren value is adapted accordingly. Likewise, alternative anticoagulants such as EDTA, Heparin and its analogues or potassium and sodium oxalate can be used in a variety of forms, such as liquid, freeze dried, powder or spray coatings. Each may be equally effective in anticoagulating the specimen without haemolysis and with an appropriate mathematical algorithm will allow conversion of the observed value to the Westergren value. Non-liquid, e.g. dry additives are usually preferred in the case of plastics tubes due to the well-known tendency of plastic tube to lose moisture.

Also, to further enhance and facilitate mixing of the specimen in the tube irrespective of the dimensions thereof, a component which reduces the surface tension of the blood is added to the tube as a coating or combined with the anticoagulant in its liquid or dry form. Desirably, the surfactant is a nonionic surfactant. An example of such a surfactant is an organosilicone. Preferably, the organosilicone is a polyalkyleneoxide modified polydimethyl-siloxane. Polyalkyleneoxide modified polydimethyl siloxanes are found to be stable with irradiation, do not cause the blood haemolysis and increases the rate of mixing the specimen to provide a well anticoagulated and homogeneous specimen without cell aggregation or clotting.

The fastest mixing time was found to be achieved at approximately 1% concentration by weight.

Fig.2 and 3 show a rack 1 adapted for receiving one or, preferably, a plurality of tubes T, a light source 2, such as a fluorescence light arranged on one side of the rack 1 to create background illumination, as well as an optical imaging device such as a video camera 3, arranged on the other side of the rack 1 and adapted for viewing, as better described in the following, the tube or the tubes T against the background illumination created by the source 2.

The location of the cell/plasma interface (schematically designated I in fig.2) is thus detected as a contrasted image (dark/clear, black/white) against said background illumination.

In the preferred embodiment shown in fig.2, the rack 1 is essentially comprised of a C-shaped frame having opposite lower 4 and upper 5 arms adapted for securely receiving the lower and upper ends of the tube or tubes T. The two horizontal arms 4, 5 are connected by an upright arm 6 which is rigidly fixed to one of the arms (for instance upper arm 5) and is hinged at 7 to the other (in the present instance lower) arm 4. This arrangement permits the rack 1 to be opened to insert the or each tube T into respective cavities 8 provided in the lower arm 4 and then securely locked to their final position for carrying out the test by bringing the rack 1 to its closed position with the upper arm 5 (having respective cavities or a cutout on the lower side thereof - not visible in the drawing) to engage the upper ends of the tube or tubes T (closed by the stopper S). The rack 1 is then locked to its closed position by means of a lock mechanism controlled by a thumb-actuated slider 9.

According to an arrangement well-known per se, the camera 3 has associated therewith drive means (such as a motor-driven toothed belt 3a) which cause it to undergo a traverse movement (as shown by the double-pointed arrow of fig. 3) along the tube or tubes T. The motor moves the camera to view each rack (three such racks



are provided in a linear array in the currently preferred embodiment of the invention). The motor does not move the camera during the period when the camera is viewing a specific rack. The camera sees a 2-dimensional picture of the rack and thus can see the entire aspect of each tube in a rack. After reading one rack, the camera is moved by the motor to view the next rack. Also, associated with the rack 1 is a rotary mounting fixture including a rotary platform or drum D carrying supporting formations which enable the rack 1 to be safely retained on the mounting fixture as this is rotated about a horizontal axis XR under the action of motor means (not shown). Thus, the rack 1 and the tube or tubes T located therein to be vertically rotated about an axis XR to achieve thorough mixing of the specimen immediately before initiating the optical reading. The rack 1 also allows the tube or tubes T to be optically observed from the side starting immediately above the blood/ air meniscus and continuing downward over a distance defining a window W as explained in detail in the following.

Even though preferred at present, the rack arrangement described in the foregoing is not - per se - critical to the invention. Other arrangements, such as the one currently used in the SEDISCAN<sup>R</sup> system, can be used. This also applies to the nature of the imaging device embodied by the video camera 3. As an alternative to LCDs, linear CCD arrays and other devices (including non-optical devices) may be used.

Also, the arrangement for causing the camera 3 to move along the rack array, as well as the rotary mounting fixture for the racks 1, are conventional in the art and do not require to be described in further detail.

The foregoing also applies - in general terms - to the computer-controlled arrangement adopted for processing the output signal from the camera 3 and the possibility of using a manual scanner 10 for identifying each and every tube T as it is loaded into the respective rack 1. The manual scanner 10 enables each patient's identification data (usually in the form of a bar code) to be read from a label L



applied around the lower portion of each tube T when collecting the blood samples. Both the output signal (which is usually converted to a digital format) as well the signal from the manual scanner 10 are fed to a data processing unit, such as a personal computer 11. As an alternative to a programmed general purpose computers, a dedicated computer or processor can be used. Suitable programming (according to well-known criteria which are not required to be described here) enables each tube T to be safely identified as such, prior to loading into the instrument, while the respective camera reading 3, converted to a standard Westergren value, can be outputted as a visual display on a screen and/or a hard copy printout or communicated electronically to the host computer managing patient data in the laboratory. For a general review of the general principles of operation of such a processing unit, reference may be made to the User's Guide to the SEDIS© software available with Becton Dickinson Vacutainer Systems and Cell Science Product Europe for use with the SEDISCAN<sup>R</sup> measuring system. Further details concerning the algorithm adopted for converting the camera reading 3 to standard of Westergren values are provided in the following.

When a plurality of tubes (such as fifteen tubes) T are tested simultaneously in a rack, these are preferably arranged in the rack in an array including two parallel rows, as shown in fig.2, with the tubes T in the adjacent rows suitably staggered or offset in order to make sure that all the tubes T in the two-row array can be inspected by the camera 3 moving along a line parallel to the two rows.

Preferably, the locations of the tubes in each rack 1 are such that all the tubes in the rack can be inspected simultaneously by the camera 3 positioned at a given point with respect of the rack 1. That point is preferably chosen to correspond to a central positioning of the camera 3 with respect to the length of the rack.

As the tubes in each rack 1 can be viewed simultaneously by the camera 3 from a single location, the camera 3 needs to be stopped only once for each rack, without any scanning movement being required. In the presently preferred embodiment of

the invention, three racks are arranged to be tested simultaneously, and the movement of the camera 3 along the guide 3a is thus stopped three times. Suitable controls may however be provided in order to prevent the camera from stopping at any location where, for any reasons, no rack, a rack containing no tubes or a rack containing only empty tubes are arranged.

From fig.3 it will be appreciated that, in the preferred embodiment of the invention, the tubes T are held inclined at an angle  $\alpha$  with respect to the vertical.

As the classic Westergren method specifies that the specimen be examined after remaining vertically upright for 60 or 120 minutes, the clinician or laboratorian must wait this long before providing a diagnostic result for the patient. This inevitably results in inefficiencies and high costs in the health care environment, where it is the primary goal of the health care to provide to deliver care as rapidly and cost effectively as possible.

It was found that the ESR is artificially accelerated if the tube T is inclined from the classical vertical position. This fact was already recognised in the past as witnessed e.g. from textbooks such as "Clinical Haematology, 5th edition" 1961 (Wintrobe) or "Todd-Stanford clinical diagnosis by lab methods" 14 edition, 1969 (Davidsohn & Henry).

While the underlying mechanism is not thoroughly clear, it is felt that, by keeping the tube T inclined with respect to the vertical position, the blood cells descend along the tube wall and accelerate more rapidly than the classic vertical position, while the plasma ascends.

In the arrangement shown in fig.3, this result can be easily achieved simply by stopping the rotary motion of the mounting fixture carrying the rack 1 at the end of the mixing stage at a position which leaves the tube(s) T oriented approximately 20° from the vertical position.

For that purpose reference indicia (such as a notch or an optical mark 12) can be provided on the rotary fixture carrying the racks 1. Such indicia are detected by respective sensors 12a (of known type), acting as angular position sensing means, in order to stop the rotary motion of the fixture at the desired angular position. An inclination angle of about  $20^\circ$  was experimentally found to represent an optimal choice. While in principle significantly different inclinations can be used, it was found that lower angles will not accelerate the sedimentation rate as much and have been seen to result in poorer reproducibility of the measurement. Higher angles offer slight improvements in the rate of sedimentation, but create distortion for the optical viewing device (e.g. the camera 3) in sensing the specimen, particularly in the area of the blood/air meniscus defining the top of the blood column which changes shape from a circle to an ellipse in a cylindrical tube the more inclined the tube becomes. This may result in a poor establishment of the zero or base line from which the ESR measurement is based.

In the classic Westergren method, a 200 mm long tube is scanned after 60 or 120 minutes. Depending upon such variables as patients' health, sex, age and haematocrit, it may be necessary to scan the tube for the cell/plasma interface as far down as 150 mm below the meniscus. Because the rate at which the cells fall is very slow, particularly in the vertical position, the operator must wait at least 60 minutes before he or she can be certain that the rate of a cell falling has effectively reached zero. The size, cost and complexity of an instrument to accurately search for and locate the cell/plasma interface is increased by having to examine such a long distance as 150 mm.

As opposed thereto, in the arrangement of the invention a much smaller length or "window" W of the tube T containing the specimen is scanned.

In the solution of the invention for prospected use in the exemplary automated ESR determination apparatus disclosed in the foregoing a short blood collection tube (about 80 mm to about 110 mm about 80 mm being the presently preferred



value) is used whereby a blood column may be formed therein having a height of not less than about 75 mm and not more than about 105 mm. The tube is preferably inclined at approximately  $20^{\circ}$  to accelerate the rate at which the cells fall, making it possible to read significant displacements in the cell/plasma interface sooner than 60 minutes (preferably about 20 minutes or less). In addition, the optical viewing device is sized or adjusted only to read a short length (30-40 mm or less contrary to 70-80 mm of the SEDISCAN<sup>R</sup> system) of the tube T located at the top thereof, "at the top" meaning a length or window W which encompasses the blood/air meniscus in the tube T upon starting the test or has its upper margin lower than the blood air/meniscus and located in proximity thereto.

It will be appreciated that, in the exemplary embodiment of the invention shown, displacements in the cell/plasma interface are simply read or viewed by the camera 3a without any vertical scanning movement along the test tubes being required.

In a thoroughly unexpected manner, it was found that by restricting the distance the cells have fallen to said reduced length W and at said periods, the observed values are representative - with a high degree of reliability and repeatability - of the desired ESR values. Consequently, by transforming the observed values, final values can be found which closely match the classic Westergren values.

Preferably, if the cell/plasma interface remains in the viewed length W for the entire test period (20 minutes or less), the final observed value are used for conversion to the classic Westergren value. Also preferably, if the cells have fallen at such a rapid rate, that the interface is outside of the length W before the end of the total test period the previous observed reading which fell within the viewed length W is used for conversion to the classic Westergren value. Thus, by observing only a small portion of the tube below the blood/air meniscus and converting the observed value to a classic Westergren value in far less than 60-120 minutes, the invention provides a solution for giving thoroughly reliable results to the patient in a much faster period than in the past.



As indicated in the foregoing, attempts were already made in the past of using shorter test tubes (i.e. shorter blood columns) and/or providing results in a shorter time than the standard 60-120 minutes of the Westergren method. None the less, these past methods require the whole blood column, or a substantial portion thereof (about 70-80%), to be scanned in order to obtain reliable results.

Contrary to any reasonable expectation, the solution of the invention provides for cell falling being monitored only over a reduced length or window of the blood column in the tube while providing thoroughly reliable results even if the overall period the cell falling phenomenon is observed is reduced to 20 minutes or less.

Another less apparent, but extremely important advantage of the solution of the invention, is that because the window W is only a portion of the entire tube length (see especially fig.1) the remaining tube length can be used to apply patient identification labels L to ensure the diagnostic result is properly matched by the laboratorian to the correct patient. This is particularly important as the use of bar code style positive patient identification labels L adapted for reading by manual scanners, such as scanner 10, has increased rapidly in an effort by hospitals to improve quality of care while increasing laboratory efficiency and throughput. These labels L are typically a 30-50 mm long (in the axial direction of the tube T). When these labels L are applied to "short" blood collection tubes T intended for ESR determination, they would cover such a large area of the tube T that is not possible to observe the meniscus or the interface in order to make the ESR measurement. As a result, these labels cannot be used or must be removed or the specimen must be transferred over to another tube T or pipette in order to make the ESR determination, or require (as is the case of the Diesse VESMATIC system referred to in the introductory portion of the description) to provide for an additional plastic outer sleeve to apply patient bar code or identification labels. This increases the opportunity for error, takes time, costs more money and/or exposes the laboratorian to a blood specimen unnecessarily.

Consequently, the present invention provides the significant advantage of being able to apply typical labels L onto the exterior of a primary tube for an ESR determination in an area (the lower portion of the tube T shown in fig.1) which does not obstruct the measurement. This is essentially due to the fact that - according to the invention - only a minor portion ("minor" meaning about 50% or less, typically about 30% or less) of the blood column within the tube T is actually used for determination. The remaining lower portion of the blood column, while playing a role in the overall cell falling phenomena, can be covered by the label L as it will not be used for determination purposes.

In order to provide the clinician with an estimate of the classic Westergren value when using a short tube length and observing only a small portion of the tube and when providing a reading in 20 minutes or less, it is necessary to utilise a mathematical algorithm to establish the relation of the observed reading to the Westergren value. Such an algorithm was constructed using extensive experimental data. The resulting system was then examined by comparing actual 60 and 120 minutes Westergren values versus extrapolated Westergren values as predicted by the mathematical algorithm.

Specifically, to establish the relationship, specimens from a large population of patients (n=101) admitted for hospitalization or seeking medical care were analysed by both the Westergren reference method and by the system. The sedimentation rate expressed in mm/hr for the Westergren reference method was collected using the standard glass pipette at the specified time intervals of 60 and 120 minutes after initiation of the test. Meanwhile, in parallel, using the instrument and tube previously described, the initial blood meniscus height in the tube at time 0 was determined. Subsequently, the location of the cell/plasma interface was observed via the camera system and measured by the instrument. This data was collected at intervals of about 10, 15 and 20 minutes after the initial time.

Using a linear regression analysis, this data was first analyzed graphically by

plotting the observed value at each time interval versus the reference method value and determining the correlation. An example of this data may be seen in figure 4. This shows that the correlation is reasonable ( $R^2=0.7088$ ) as the flow data is actually non-linear. It was also confirmed that all of the observed cell/plasma meniscus had fallen less than about 38 mm from the initial starting blood column height of approximately 82 mm (46%). From this it was confirmed that in the system of the invention the sedimentation rate of the cells is such that it is possible to predict the Westergren value in 20 minutes or less. From this it was also confirmed that rather than observing a substantial length of the tube (i.e. 75% of the blood column height), that the blood/cell meniscus need only be observed at the 10, 15 and 20 minute time intervals within only approximately the upper 50% of the blood column height for nearly all the blood specimens. Therefore, it was not necessary to use the lower portion of the tube for observation.

To further enhance the quality of the correlation achieved by observing only a limited portion of the blood column height at time intervals no later than 20 minutes after start of the test, non-linear polynomial algorithms were then chosen. In addition, it was learned that the correlation can be further enhanced by using two sets of such algorithms depending upon the initial column height of the tube. Tubes which were properly filled, in our case at greater than about 80 mm are analyzed using one algorithm to predict the Westergren value while tubes filled less than about 80 mm are analyzed using a second algorithm to predict the Westergren value. An example of this data may be seen in figure 5. Using a multiple part non-linear algorithm described in Tables 1 and 2, the observed data was converted and it was demonstrated that the correlation was improved ( $R^2=0.7536$ ) and that the flow of data now follows the regression more closely.

To further enhance the quality of the correlation, clinical investigations were expanded to cover a population of 339 patients at multiple sites. The resulting algorithm is defined in Tables 1 and 2.



Table 1

Algorithm for predicting the 60 minute Westergren value when blood column height is greater than 80 mm.

- \* If cell/plasma meniscus (i.e. interface) has fallen <35mm at 20 minute reading interval:

$$\text{Predicted value (mm/hr)} = (0.652194*A) + (0.045525*A^2) - (0.06051*C^2)$$

- \* If cell/plasma meniscus has fallen >35mm at 20 minute reading interval but <35mm at 15 minute reading interval

$$\text{Predicted value (mm/hr)} = (3.229994*B) - (0.0758*C^2)$$

- \* If cell/plasma meniscus has fallen >35mm at 15 minute reading interval but <35mm at 10 minute reading interval

$$\text{Predicted value (mm/hr)} = (5.634304*A) - (0.07907*C^2)$$

Algorithm for predicting the 60 minute Westergren value when blood column height is less than 80 mm.

- \* If cell/plasma meniscus has fallen <30mm at 20 minute reading interval:

$$\text{Predicted value (mm/hr)} = (0.652194*A) + (0.045525*A^2) - (0.06051*C^2)$$

- \* If cell/plasma meniscus has fallen >30mm at 20 minute reading interval but <30mm at 15 minute reading interval:

$$\text{Predicted value (mm/hr)} = (3.578074*B) - (2.1702*C^2)$$

- \* If cell/plasma meniscus has fallen >30mm at 15 minute reading interval but <30mm at 10 minute reading interval

$$\text{Predicted value (mm/hr)} = (5.509347*C) - (0.08674*C^2)$$

Where:

A = observed reading at 20 minute interval

B = observed reading at 15 minute interval

C = observed reading at 10 minute interval

Table 2

Algorithm for predicting the 120 minute Westergren value when blood column



height is greater than 80 mm.

- \* If cell/plasma meniscus has fallen <35mm at 20 minute reading interval:  
**Predicted value (mm/hr) =  $(5.53835364 \cdot A) + (0.021903042 \cdot A^2) - (4.105250868 \cdot B^2)$**
- \* If cell/plasma meniscus has fallen >35mm at 20 minute reading interval but <35mm at 15 minute reading interval  
**Predicted value (mm/hr) =  $(4.625610738 \cdot B) - (0.072863681 \cdot C^2)$**
- \* If cell/plasma meniscus has fallen >35mm at 15 minute reading interval but <35mm at 10 minute reading interval  
**Predicted value (mm/hr) =  $(9.295466293 \cdot C) - (0.162433073 \cdot C^2)$**

Algorithm for predicting the 60 minute Westergren value when blood column height is less than 80 mm.

- \* If cell/plasma meniscus has fallen <30mm at 20 minute reading interval:  
**Predicted value (mm/hr) =  $(5.53835364 \cdot A) + (0.021903042 \cdot A^2) - (4.105250868 \cdot B^2)$**
- \* If cell/plasma meniscus has fallen >30mm at 20 minute reading interval but <30mm at 15 minute reading interval:  
**Predicted value (mm/hr) =  $(5.527322594 \cdot B) - (2.740388301 \cdot C^2)$**
- \* If cell/plasma meniscus has fallen >30mm at 15 minute reading interval but <30mm at 10 minute reading interval  
**Predicted value (mm/hr) =  $(9.660137741 \cdot C) - (0.183986082 \cdot C^2)$**

Where:

A = observed reading at 20 minute interval

B = observed reading at 15 minute interval

C = observed reading at 10 minute interval

The correlation results achieved between the predicted value and the Westergren reference method may be seen in figures 6 and 7 ( $R^2=0.93$  for 60 minute Westergren value and  $R^2=0.94$  for 120 minute Westergren value).

It will be easily appreciated that the various parameters considered in the foregoing (i.e. the 80 mm blood column height, the 35 mm distance fallen, the 10, 15, and 20 minute reading intervals), while constituting preferred choices at present,

do not represent absolute imperative values. For that reason the wording "about" was resorted to in the annexed claims in respect of those parameters in order to make it clear that any possible minor changes, with respect to any of those parameters will not invalidate the expected results.

Also, it is entirely possible to develop alternatives to the algorithm presented herein that may be equally as effective. For example, the reading intervals can be chosen to be more frequent or less frequent than the 10, 15 and 20 minute intervals described here. Consequently, the preferred coefficients disclosed in Tables 1 and 2 may vary accordingly. The system described here provides predictions after 20 minutes for the Westergren value classically obtained using the reference method after 60 and 120 minutes. The new system clearly offers significant advantage to the user by providing diagnostic values faster to the clinicians. By shortening the reading cycle further through the development of alternative algorithms in the manner described herein or in similar manners, it would further add advantage for the clinician.

It is also entirely possible to develop algorithms with mathematical corrections for environmental factors encountered during the test. Such factors may include the laboratory temperature as it is well established that increasing temperatures can accelerate the sedimentation rate.

It is also possible to develop algorithms with mathematical correction for patient factors affecting the blood specimen. Such factors may include the patient haematocrit as it is well established that decreasing haematocrit can accelerate the sedimentation rate.

It is also possible to develop algorithms to achieve the desired correlation if one were to use specimen collection tubes of geometries and volumes or with additives other than described herein. For example: alternative surfactant; alternative citrate anticoagulant to blood ratios; alternative anticoagulants such as EDTA, heparin or

hirudin; alternative tube diameters, shapes or lengths. Changes to any of these factors is likely to make the algorithms described herein less optimal. However, using the method described herein or similar methods, new algorithms can easily be developed, without undue experimentation being required, the key point being the recognition that the values obtained according to the invention are representative - with a high degree of reliability and repeatability - of the desired ESR values. Consequently, the values obtained can be converted, through a given relationship (as the algorithms disclosed in the foregoing) to the classic Westergren values.

Also, it will be easily appreciated that any conversion algorithm as those disclosed and/or referred to in the foregoing may be easily stored and implemented (in a thoroughly known manner) in a computer such as the computer designated 11 in figure 3.

As indicated, even though the test tube of the invention was devised for preferred use in a fully automated ESR determination method and apparatus, thoroughly satisfactory and reliable use was also experimented with in a "manual" version of the ESR determination method wherein reading is accomplished by eye and requires a stand (not shown) to hold the tube vertically during a 60-120 minute reading period. On the stand is a scale read by eye in the logarithmic format which converts the observed value directly to that anticipated by the Westergren method.

The test tube for use in this manual version is similar in all regards to the test tube for use in the automated ESR determination procedure described in the foregoing except that a tube wall length of about 110-120 mm, preferably about 120 mm, to yield a blood column height of nominally about 100 mm was found to be preferable. The resulting blood draw value is about 2.3 mls. The additive type, surfactant and other tube geometries are otherwise the same. As the tube is read preferably as much as 75% of the tube length, correspondingly shorter patient identification data labels are usually applied at the bottom end of the tube.



**THE EMBODIMENTS OF THE INVENTION IN WHICH AN EXCLUSIVE  
PROPERTY OR PRIVILEGE IS CLAIMED ARE DEFINED AS FOLLOWS:**

1. A test tube (T) for determining the erythrocyte sedimentation rate (ESR) in a blood sample, wherein said test tube includes a tubular wall defining a cavity for forming therein a column of said blood, said blood column having a given height at an initial time, whereby the location of the cell/plasma interface (I) with respect to the height of said blood column at at least one subsequent time interval is indicative of the ESR of the said blood sample, a quantity of an anticoagulation agent for the blood forming said column being provided in said cavity, characterised in that:

- said tubular wall has a length of not less than 80 mm and not more than 120 mm and an inside diameter not less than 5 mm and not more than 7 mm, and

- a quantity of a surfactant is provided in said cavity for mixing to the blood forming said column, said surfactant being stable under test conditions, being capable of lowering the surface tension of whole blood, and not interfering with the haematology properties of human blood.

2. The test tube of claim 1, characterised in that said tubular wall has a length of 80 mm and an inside diameter of 6 mm.

3. The test tube of claim 1, characterized in that said tubular wall has a length of 120 mm and an inside diameter of 6 mm.

4. The tube of any of claims 1 to 3, characterised in that said tubular wall has an outside diameter of not less than 7 mm and not more than 9 mm.



-23-

5. The test tube of claim 4, characterised in that said tubular wall has an outside diameter of 8 mm.

5 6. The test tube of any of claims 1 to 5, characterised in that said tubular wall includes an upper portion defining a length (W) for measuring the location of said cell/plasma interface (I); said test tube having associated therewith an identification label (L) for applying onto the remaining lower part of said tubular wall.

10 7. The test tube of claim 6 characterised in that said upper portion (W) is 30-40 mm.

8. The test tube of any of claims 1 to 7, characterised in that said anti-coagulation agent includes tri-sodium citrate.

15 9. The test tube of any of claims 1 to 8, characterised in that said anti-coagulation agent includes citric acid.

20 10. The test tube of claim 8 or claim 9, characterised in that said anti-coagulation agent is a mixture of tri-sodium citrate and citric acid.

11. The test tube of any of claims 8 or 10, characterised in that said anti-coagulation agent is mixed in an aqueous solution to achieve a molarity of 0.105 M-0.135 M.

25 12. The test tube according to any of claims 8 or 10, characterised in that said anticoagulation agent is present in a quantity to give, in use, a blood to anti-coagulation agent ratio between 2:1 and 10:1.

30 13. The test tube according to any of claims 8 or 10, characterised in that said anticoagulation agent is present in a quantity to give, in use, a blood to anti-coagulation agent ratio of 4:1.

14. The test tube of claim 1, characterised in that said anticoagulation agent includes an anticoagulant selected from the group consisting of EDTA, hirudin, potassium and sodium oxalate and mixtures thereof.

5

15. The test tube of any of claims 1 to 14, characterized in that said quantity of surfactant is approximately 1% by weight of the quantity of blood forming said blood column.

10

16. The test tube of any of claims 1 to 15, characterised in that said surfactant is non-ionic.

17. The test tube of claim 1 or claim 15, characterised in that said surfactant is an organosilicone fluid.

15

18. The test tube of claim 17, characterized in that said surfactant is poly-alkyleneoxide modified polydimethylsiloxane.

20

19. Use of a surfactant as an additive in a blood column for determining the erythrocyte sedimentation rate (ESR) of a blood sample forming said column, said surfactant being stable under test conditions, being capable of lowering the surface tension of whole blood, and not interfering with the haematology properties of human blood.

25

20. The use of claim 19, characterized in that said surfactant is approximately 1% by weight of the blood forming said column.

21. The use of any of claims 19 or 20, characterized in that said surfactant is non-ionic.

30

-25-

22. The use of claim 19 or claim 21, characterized in that said surfactant is an organosilicone fluid.

23. The use of claim 22, characterised in that said surfactant is polyalkyleneoxide modified polydimethylsiloxane.

**fig. 1**

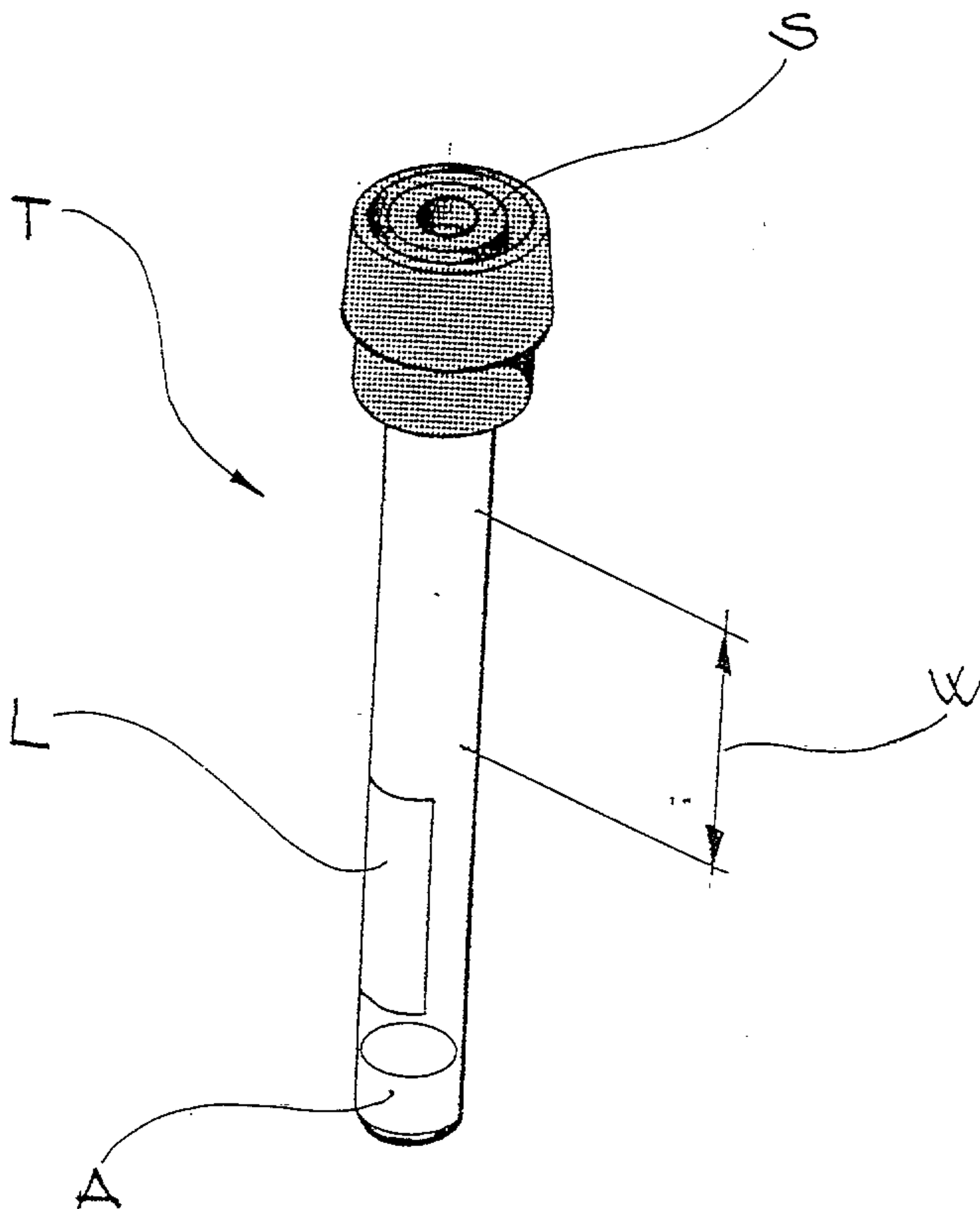

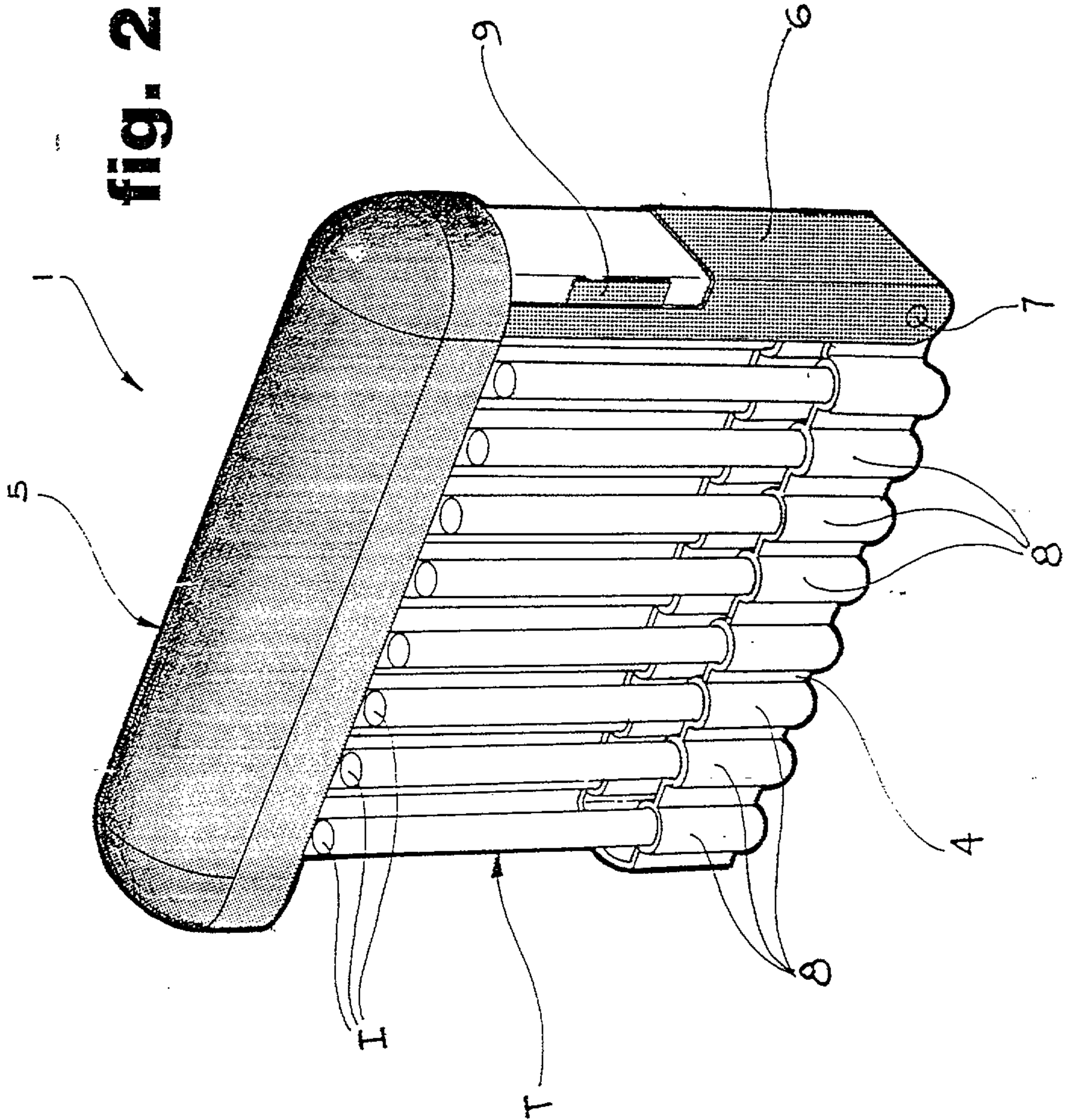

**fig. 2**

2180799

3/7

XP

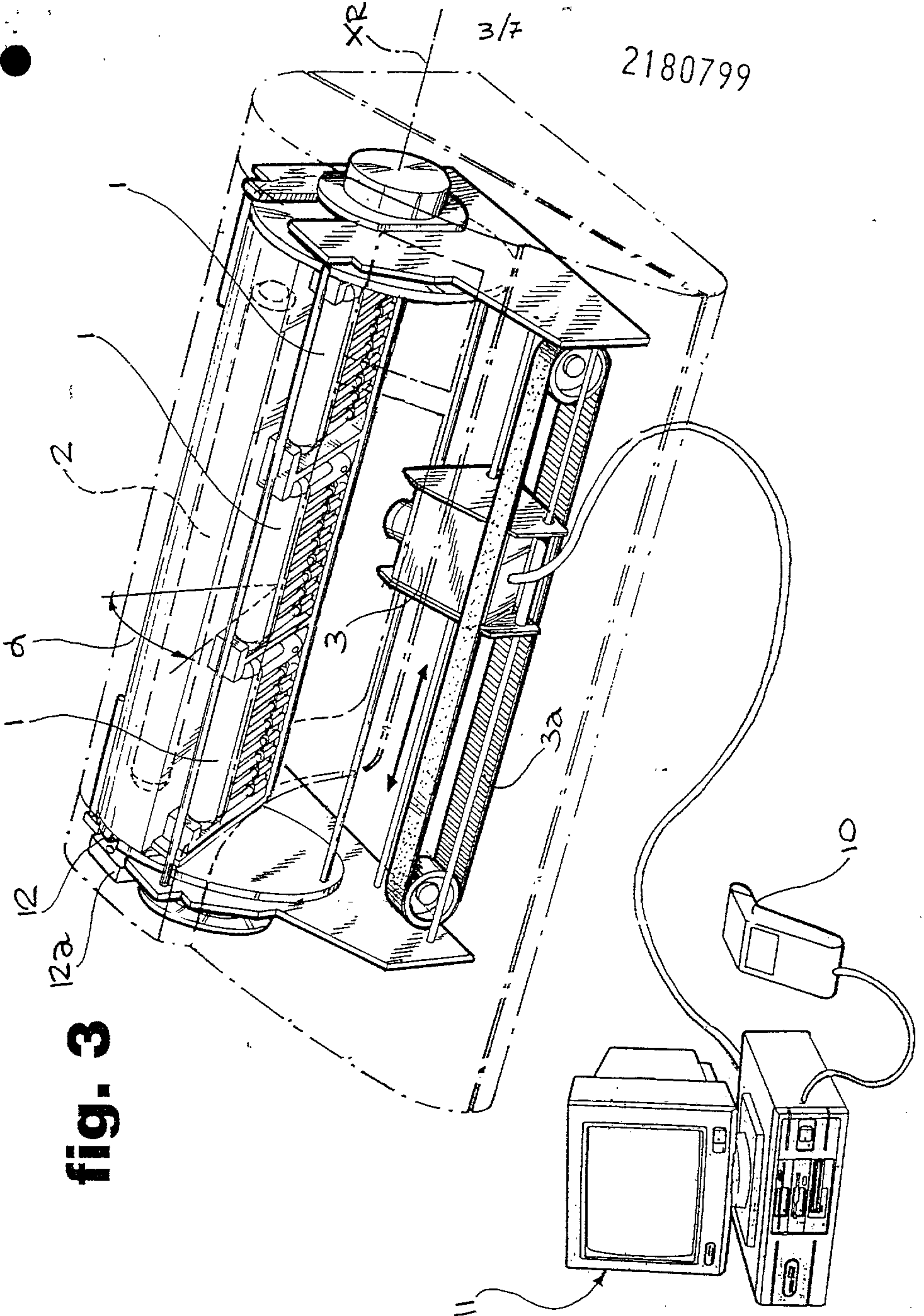
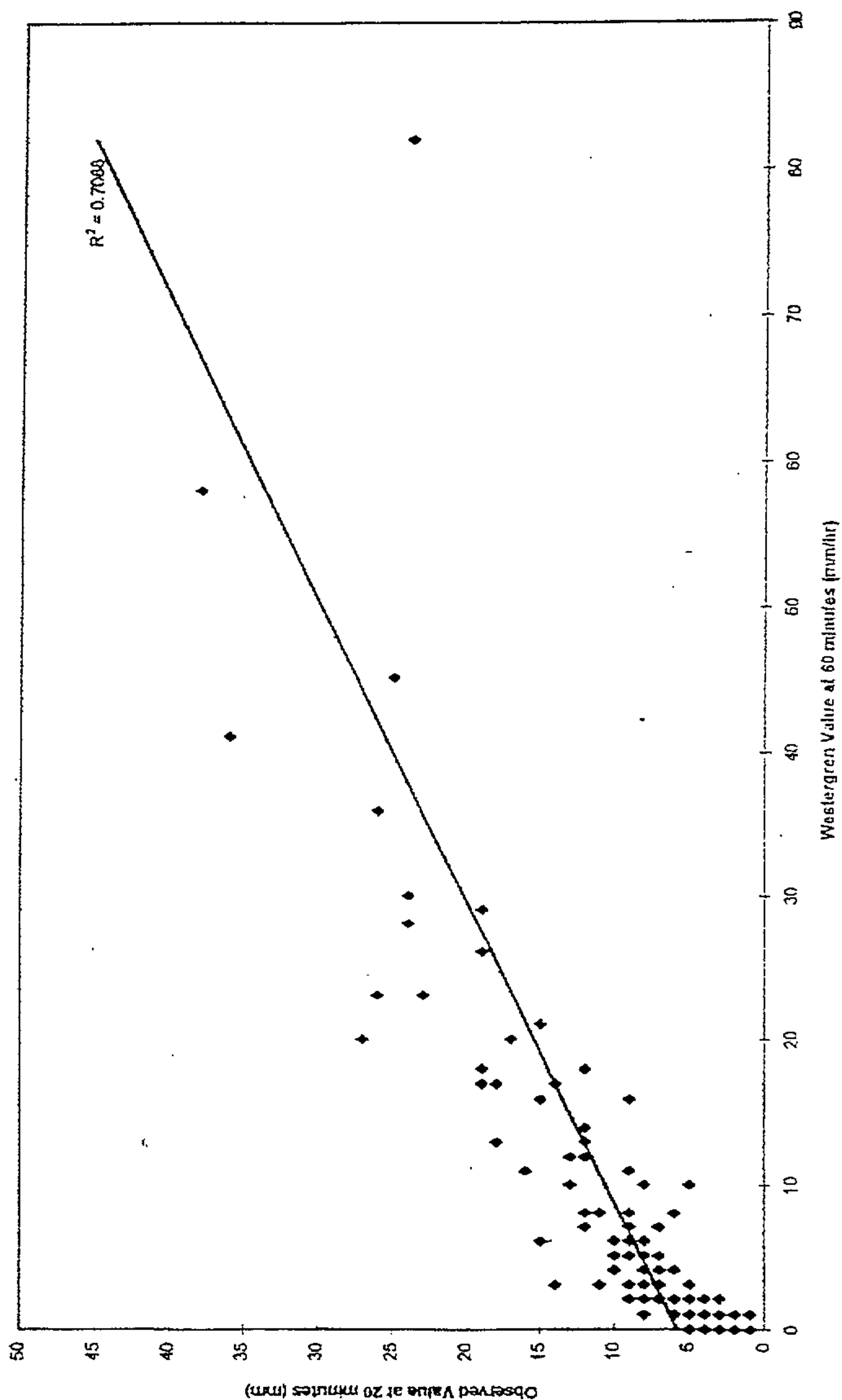
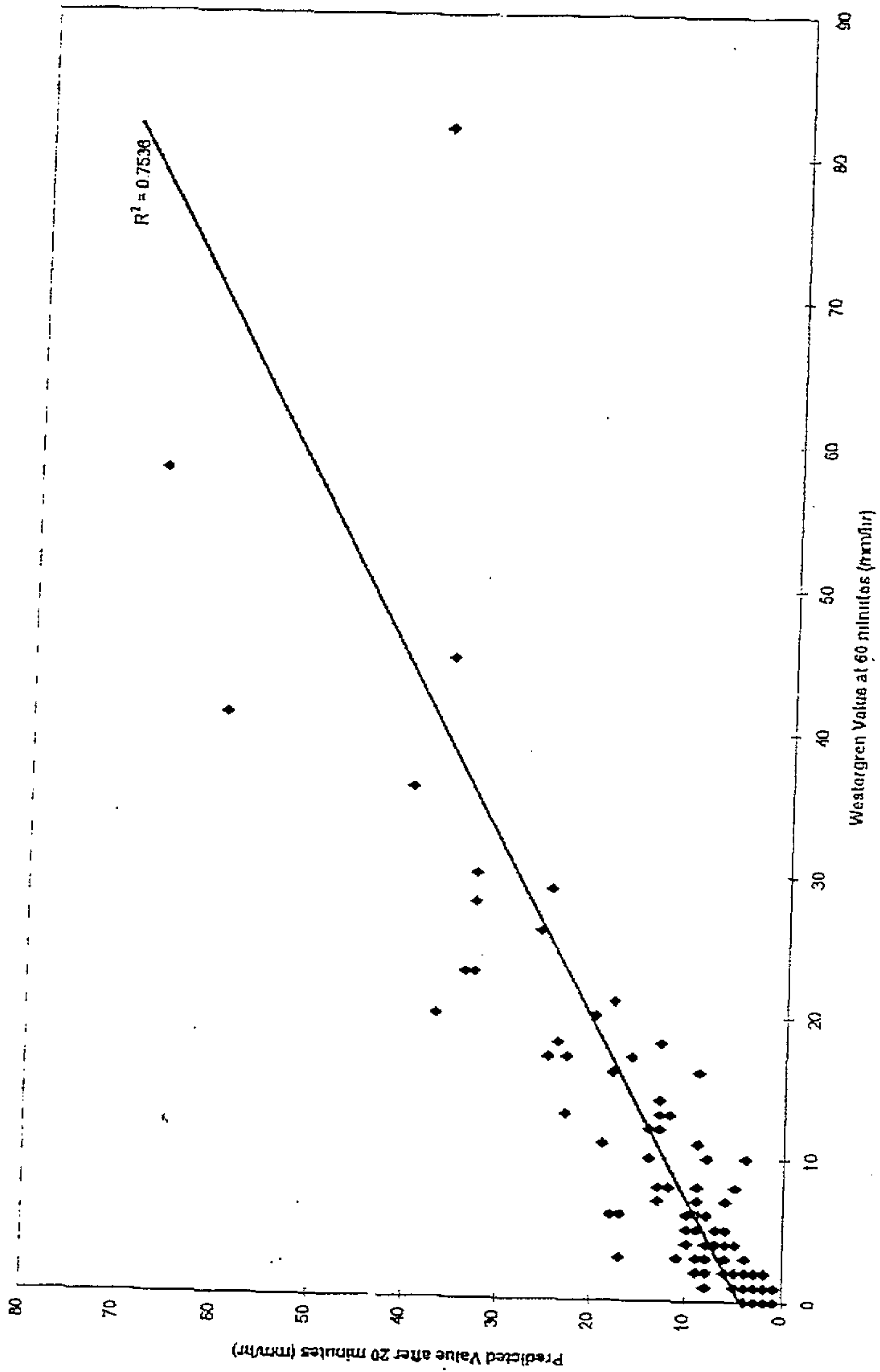

fig. 3

fig. 4



**fig. 5**



**fig. 6**

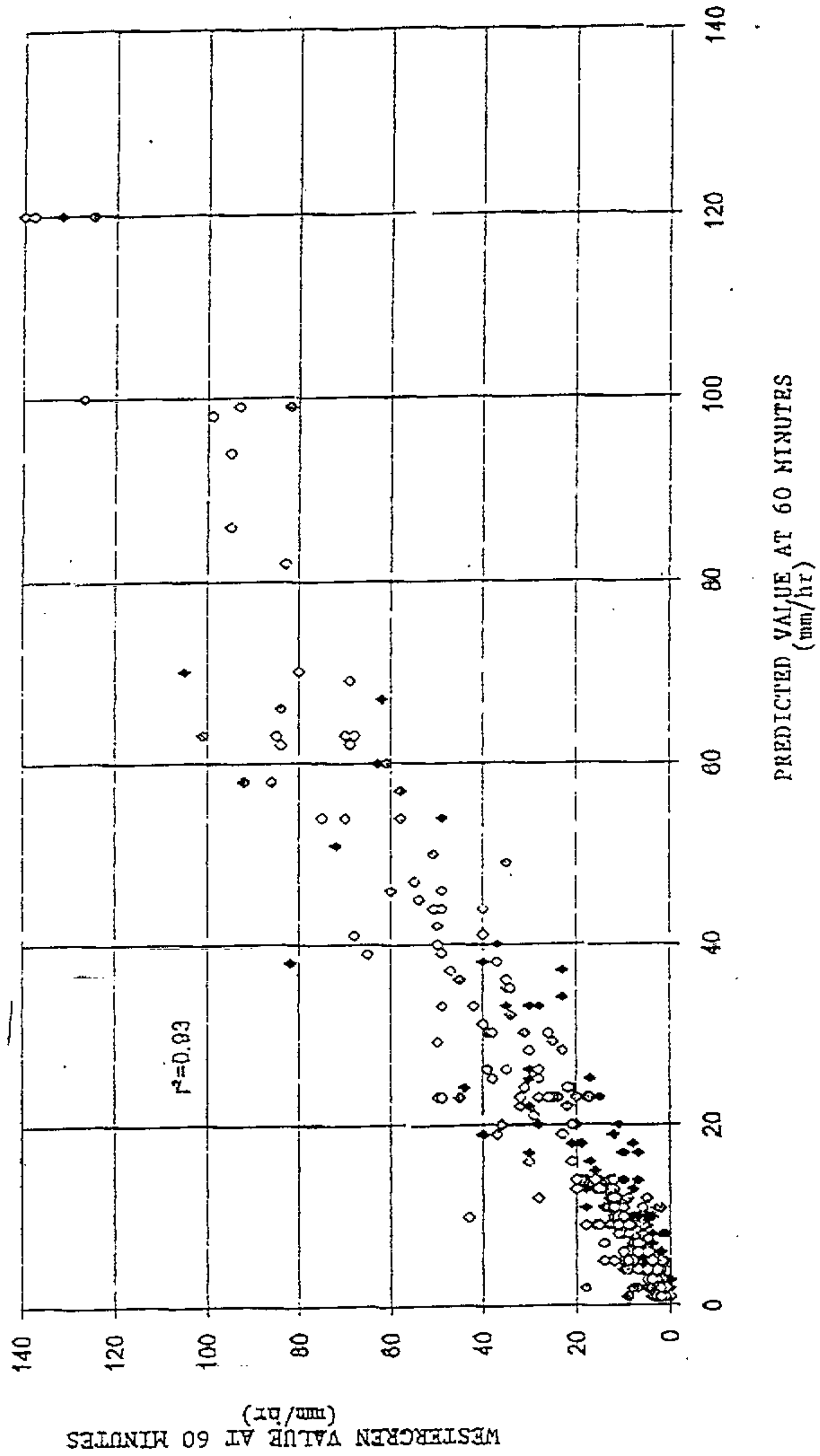

6/7

2180799

fig. 7

