

(19) **DANMARK**

(10) **DK/EP 3284267 T3**



(12) **Oversættelse af
europæisk patentskrift**

Patent- og
Varemærkestyrelsen

-
- (51) Int.Cl.: **H 04 R 1/02 (2006.01)** **H 04 R 1/40 (2006.01)**
- (45) Oversættelsen bekendtgjort den: **2019-09-16**
- (80) Dato for Den Europæiske Patentmyndigheds bekendtgørelse om meddelelse af patentet: **2019-06-05**
- (86) Europæisk ansøgning nr.: **16717332.7**
- (86) Europæisk indleveringsdag: **2016-04-13**
- (87) Den europæiske ansøgnings publiceringsdag: **2018-02-21**
- (86) International ansøgning nr.: **EP2016058105**
- (87) Internationalt publikationsnr.: **WO2016166150**
- (30) Prioritet: **2015-04-14 NL 2014636**
- (84) Designerede stater: **AL AT BE BG CH CY CZ DE DK EE ES FI FR GB GR HR HU IE IS IT LI LT LU LV MC MK MT NL NO PL PT RO RS SE SI SK SM TR**
- (73) Patenthaver: **Alcons Audio B.V., De Corantijn 69, 1689 AN Zwaag, Holland**
- (72) Opfinder: **DE HAAN, Philip Derek Eduard, De Corantijn 69, 1689 AN Zwaag, Holland**
GROEN, Boudewijn, De Corantijn 69, 1689 AN Zwaag, Holland
- (74) Fuldmægtig i Danmark: **Chas. Hude A/S, H.C. Andersens Boulevard 33, 1780 København V, Danmark**
- (54) Benævnelse: **Ophængning af en række højttalere**
- (56) Fremdragne publikationer:
WO-A1-2011/005093
US-A1- 2004 213 425
US-A1- 2007 000 719
US-A1- 2012 093 347
US-A1- 2013 240 288

DESCRIPTION

[0001] The present invention relates to a loudspeaker array, comprising at least two loudspeaker housings, wherein each two adjacent loudspeakers housings are coupled to each other by coupling means; wherein said coupling means comprises a hinge connecting the front sides of said adjacent loudspeaker housings; wherein said coupling means are designed to couple said adjacent loudspeakers in such a manner that the loudspeaker housings will extend at a predetermined angle relative to each other in a hoisted position, and provided with means for setting the predetermined angle when the loudspeaker housings are in a non-hoisted position; and wherein the coupling means are further designed for coupling the loudspeaker housings in such a manner that said loudspeaker housings, upon being moved from the non-hoisted position to the hoisted position, are be moved to a position wherein the loudspeaker housings are forced to extend at said predetermined angle. Such a coupling system is known, for example from U.S. patent US 7,261,180.

[0002] A drawback of the known system is the fact that the angle between two loudspeaker housings must be set with the loudspeaker housings in a hoisted position, so that forces caused by gravity are exerted on the loudspeaker housings. Said forces may also lead to accidents, for example in that a person's fingers can get jammed between two loudspeaker housings upon setting the aforesaid angle.

[0003] Systems are known for use in a fly mode suspension system wherein the angle between the speakers can be set in advance in a non-hoisted position and wherein the angle is achieved by hoisting the array from a horizontal position such that the back sides of the speakers are pushed against each other, and then let gravity pull the back sides of the speakers away from each other towards the set angle, such as described in US 2007/0000719 A1, WO 2011/005093 A1. Also systems are known for use in a compression mode suspension system wherein the angle between the speakers can be set in advance in a non-hoisted position and wherein a tensioning cable is used to pull the back sides of the speakers towards each other towards the set angle, such as described in US 2013/0240288 A1.

[0004] It is an object of the invention to provide a coupling system for coupling loudspeaker housings, which is more flexible in use, and/or which is reliable and/or efficient, and/or wherein an angle between two loudspeaker housings can be set in a simple and/or efficient manner and/or correctly and/or quickly, and/or wherein the risk of accidents is reduced, and/or provides other advantages.

[0005] According to a first aspect of the invention a loudspeaker array is provided which is suitable for use in both a compression suspension mode and a flying suspension mode, comprising at least two loudspeaker housings, wherein each two adjacent loudspeakers housings are coupled to each other by coupling means; wherein said coupling means comprises a hinge connecting the front sides of said adjacent loudspeaker housings; wherein said coupling means are designed to couple said adjacent loudspeaker housings in such a

manner that the loudspeaker housings will extend at a predetermined angle relative to each other in a hoisted position, and provided with means for setting the predetermined angle when the loudspeaker housings are in a non-hoisted position; wherein the coupling means are further designed for coupling the loudspeaker housings in such a manner that said loudspeaker housings, upon being moved from the non-hoisted position to the hoisted position, are moved to a position wherein the loudspeaker housings are forced to extend at said predetermined angle; wherein said coupling means comprise a pivotable connection bar which at one end is pivotably connected to a back side of one of said adjacent loudspeaker housings, and a stationary connection frame mounted on a back side of the other one of said adjacent loudspeaker housings and to which the other end of said connection bar can be coupled by means of a connection member; wherein one of said connection frame and bar is provided with a plurality of holders which are arranged to hold said connection member, and arranged such that a selection of each one of said holders by rotating said connection bar for holding said connection member and coupling said connection bar to said connection frame determines a different said predetermined angle; and wherein the other one of said connection frame and bar is provided with a fly mode pulling connection member stop and a compression mode pushing connection member stop which each are arranged to receive and block movement of said connection member in two opposite directions, one being a fly mode direction and one being a compression mode direction, such that blocking the movement of said connection member in the fly mode direction causes the back sides of said loudspeaker housings to exert a pulling force on each other while maintaining said predetermined angle and blocking the movement of said connection member in the compression mode direction causes the back side of said loudspeaker housings to exert a pushing force on each other while maintaining said predetermined angle.

[0006] Preferably the designated connection member locations of said fly mode connection member stop and said compression mode connection member stop are located at the same distance from the pivot point of said pivotable connection bar. Preferably said connection member stops are formed by the ends of slots wherein said connection member can move. Preferably said slots extend in the fly mode and compression mode directions respectively, each of said directions extending through the pivot point of said pivotable connection bar. Preferably said plurality of holders for holding said connection member extends in an array in a direction which is substantially perpendicular to the fly mode and compression mode directions.

[0007] Preferably said loudspeaker array is provided with a tension cable, one end of which is attached to the back side of the lower loudspeaker in said loudspeaker array, and one end of which is attached near the upper side of said loudspeaker array, and means for tensioning said cable in order to move said connection members in the compression mode direction towards the compression mode connection member stops.

[0008] Preferably said loudspeaker array is designed such that when the upper loudspeaker of said loudspeaker array is hoisted gravity forces said loudspeakers to move such that said connection members move in the fly mode direction towards the fly mode connection member stops. Preferably said plurality of holders is provided in the stationary connection frame and the

connection member is provided in the pivotable connection bar. Preferably said connection member is a pin. Preferably said holder is a pin hole in which a pin can be inserted.

[0009] Preferably said connection frame or bar which is provided with said holders for said connection member is provided with a support surface extending in a segment of a circle, the centre of said circle being the pivot point of said pivotable connection bar when said loudspeaker array is in the non-hoisted position; wherein the other one of said connection frame and bar is provided with a removable support member which is arranged to push against and be movable along said support surface when said connection bar is rotated in order to hold said loudspeaker array standing upright in the non-hoisted position, which removable support member can be removed when the loudspeaker array is hoisted in order to allow a tension cable, one end of which is attached to the back side of the lower loudspeaker in said loudspeaker array, and one end of which is attached near the upper side of said loudspeaker array, and means for tensioning said cable, to move said connection members in the compression mode direction towards the compression mode connection member stops.

[0010] Preferably said connection frame or bar which is provided with said holders for said connection member is provided with a second support surface extending in a segment of a circle, the centre of said circle being the pivot point of said pivotable connection bar when said loudspeaker array is in the non-hoisted, stretched position; wherein the other one of said connection frame and bar is provided with a second support member which is arranged to push against and be movable along said support surface in order to hold said loudspeaker array in a stretched position when the loudspeaker array is hoisted.

[0011] According to a second aspect of the invention a loudspeaker array is provided, which is suitable for use in a compression suspension mode, comprising at least two loudspeaker housings, wherein each two adjacent loudspeakers housings are coupled to each other by coupling means; wherein said coupling means comprises a hinge connecting the front sides of said adjacent loudspeaker housings; wherein said coupling means are designed to couple said adjacent loudspeakers in such a manner that the loudspeaker housings will extend at a predetermined angle relative to each other in a hoisted position, and provided with means for setting the predetermined angle when the loudspeaker housings are in a non-hoisted position; wherein the coupling means are further designed for coupling the loudspeaker housings in such a manner that said loudspeaker housings, upon being moved from the non-hoisted position to the hoisted position, are moved to a position wherein the loudspeaker housings are forced to extend at said predetermined angle; wherein said coupling means comprise a pivotable connection bar which at one end is pivotably connected to a back side of one of said adjacent loudspeakers, and a stationary connection frame mounted on a back side of the other one of said adjacent loudspeakers and to which the other end of said connection bar can be coupled by means of a connection member; wherein one of said connection frame and bar is provided with a plurality of holders which are arranged to hold said connection member, and arranged such that a selection of each one of said holders by rotating said connection bar for holding said connection member and coupling said connection bar to said connection frame determines a different said predetermined angle; and wherein the other one of said connection

frame and bar is provided with a compression mode pushing connection member stop which is arranged to receive and block movement of said connection member in a compression mode direction, such that blocking the movement of said connection member in the compression mode direction causes the back side of said loudspeaker housings to exert a pushing force on each other while maintaining said predetermined angle.

[0012] Preferably said connection frame or bar which is provided with said holders for said connection member is provided with a support surface extending in a segment of a circle, the centre of said circle being the pivot point of said pivotable connection bar when said loudspeaker array is in the non-hoisted, stretched position; wherein the other one of said connection frame and bar is provided with a removable support member which is arranged to push against and be movable along said support surface when said connection bar is rotated in order to hold said loudspeaker array standing upright in the non-hoisted, stretched position, which removable support member can be removed when the loudspeaker array is hoisted in order to allow a tension cable, one end of which is attached to the back side of the lower loudspeaker in said loudspeaker array, and one end of which is attached near the upper side of said loudspeaker array, and means for tensioning said cable, to move said connection members in the compression mode direction towards the compression mode connection member stops.

[0013] Preferably said connection frame or bar which is provided with said holders for said connection member is provided with a second support surface extending in a segment of a circle, the centre of said circle being the pivot point of said pivotable connection bar when said loudspeaker array is in the non-hoisted, stretched position; wherein the other one of said connection frame and bar is provided with a second support member which is arranged to push against and be movable along said support surface in order to hold said loudspeaker array in a stretched position when the loudspeaker array is hoisted.

[0014] Preferably said connection member stops are formed by the ends of slots wherein said connection member can move. Preferably said slot extends in the compression mode direction, extending through the pivot point of said pivotable connection bar. Preferably said plurality of holders for holding said connection member extends in an array in a direction which is substantially perpendicular to the compression mode direction. Preferably said plurality of holders is provided in the stationary connection frame and the connection member is provided in the pivotable connection bar. Preferably said connection member and/or support member(s) is/are a pin. Preferably said holder is a pin hole in which a pin can be inserted.

[0015] According to a further preferred embodiment of the second aspect of the invention, the loudspeaker array is suitable for use in both a compression suspension mode and a flying suspension mode, wherein the other one of said connection frame and bar is provided with a fly mode pulling connection member stop which is arranged to receive and block movement of said connection member in a fly mode direction being opposite to said compression mode direction, such that blocking the movement of said connection member in the fly mode direction causes the back sides of said loudspeaker housings to exert a pulling force on each

other while maintaining said predetermined angle.

[0016] Preferably the designated connection member locations of said fly mode connection member stop and said compression mode connection member stop are located at the same distance from the pivot point of said pivotable connection bar.

[0017] Preferably said loudspeaker array is designed such that when the upper loudspeaker of said loudspeaker array is hoisted gravity forces said loudspeakers to move such that said connection members move in the fly mode direction towards the fly mode connection member stops.

[0018] The invention will now be explained in more detail with reference to the preferred embodiment as shown in the figures, in which:

Figure 1 is a perspective view of a hoisted loudspeaker array;

Figure 2 is a perspective view of the back side of two adjacent speakers of the loudspeaker array of figure 1;

Figure 3 is a detail of the perspective view of the back side of the two adjacent speakers of the loudspeaker array of figure 2;

Figure 4 is a perspective view of the pivotable connection bar used in the loudspeaker array of figure 1;

Figure 5A, 5B, 5C are side views of the loudspeaker array being hoisted in flying mode at different stages; and

Figure 6A, 6B, 6C are side views of the loudspeaker array being hoisted in compression mode at different stages.

[0019] Figure 1 shows an array of loudspeaker housings 2, which comprises at least one loudspeaker. In said row, respective loudspeaker housings 2 are disposed vertically below or above next loudspeaker housings 2, with the uppermost loudspeaker housing being suspended from a chain 100, for example. As figure 1 shows, the loudspeaker housing 2 is higher at the front side than at the rear side. When a block-shaped loudspeaker housing is used, this shape can be realised by mounting a spacer at the front side. The loudspeaker housings 2 extend vertically at an angle 3 relative to each other, which angle 3 is determined and preset in advance. In the case of large distances, a high sound pressure is important, so that the sound can be clearly heard from a large distance by an audience. To achieve this, the angle 3 between two loudspeaker housings 2 is preferably small, so that the two loudspeakers in the housings will optimally interact. In the case of smaller distances, on the other hand, the sound pressure must be lower, so that a larger angle between two loudspeaker housings 2 is desired, with the maximum angle preferably ranging between 0° and 15°, or between 0° and

6°, depending on the size of the sound system. The presence of said angles 3 appears from figure 1, in that the row 1 exhibits a curvature from the top downwards, in the direction of the stage 4.

[0020] Figure 1 furthermore shows the loudspeaker array in the so-called "flying mode". When the loudspeaker housings 2 are being hoisted in flying mode, a so-called dolly 5, which comprises a plate provided with wheels and which extends against the front side of a loudspeaker 2 in use, is removed from successive loudspeaker housings 2, preferably at man height. When the loudspeaker housings 2 are being lowered, said dollies 5 are, on the contrary, connected to the front side of respective loudspeaker housings 2, so that the loudspeaker housings 2 can rest on the dollies 5. As appears from figure 1, the loudspeaker housings 2 only extend at the predetermined angle 3 in the hoisted condition, with the loudspeaker housings 2 assuming the angular position under the influence of gravity through the use of a coupling system while being hoisted. The working of the coupling mechanism in the flying mode will be explained in more detail with reference to figures 5A-C. The loudspeaker housings 2 can also be hoisted in the so-called "compression mode", which will be explained in more detail with reference to figures 6A-C.

[0021] Figure 2 shows two adjacent loudspeaker housings 2. The front sides of two adjacent loudspeaker housings 2 are mutually connected by hinges 5. A space 13 is provided in the centre of the loudspeaker housing 2, in which space a coupling system is mounted. The space 13 is a through recess which extends from the upper surface to the lower surface of the loudspeaker housing 2, parallel to the lateral surfaces. The coupling system comprises coupling means 11 for coupling to loudspeaker housings 2 together and for setting the angle 3 between the two loudspeaker housings 2. The coupling system is shown in detail in figure 3.

[0022] The coupling means 11 comprise a stationary connection frame 6, a pivotable connection bar 7 and a first connection pin 8 for connecting the outer end of the connection bar 7 of one loudspeaker to the connection frame 6 of the adjacent loudspeaker, in this case the lower adjacent lower adjacent loudspeaker.

[0023] The stationary connection frame 6 is mounted on the back side of the loudspeaker housings. The pivotable connection bar 7 is at one end pivotably connected to said frame 6 near the lower end thereof by means of a second connection pin 9. The other end of the pivotable connection bar 7 is provided with a handle 25 for easy operation.

[0024] The pivotable connection bar 7 is provided with two slots 14A, 14B, which both extend in the direction of the pivot point of the bar 7. The lower end of slot 14 A and the upper end of slot 14 B form stops against which the first connection pin 8 can rest in the final hoisted condition of the loudspeaker array, in order to maintain the desired angle 3 between the loudspeakers. Because the locations of the two stops in the slots 14A, 14B are located at the same distance from the pivot point 9 of the pivotable connection bar 7, a hole 15 corresponds to the same angle 3 between the loudspeakers in both the fly mode and the compression mode of operation.

[0025] The connection frame 6 is provided with a plurality of holes 15 which are arranged to hold the first connection pin 8. The holes 15 extend in an arcuate array in a direction which is substantially perpendicular to the slots 14A, 14B. Each hole 15 is located at a different distance from the pivot point 9 of the connection bar 7, in order to cause different angles 3 between the adjacent loudspeakers. While the loudspeaker array is extending in a straight line in the non-hoisted condition, rotating the connection bar 7 and coupling the connection bar 7 to the connection frame 6 by inserting the pin 8 through one of said holes 15 and either the slot 14A (in fly mode) or slot 14B (in compression mode) determines the angle 3 between the speaker housings 2 in the final hoisted condition. When the loudspeaker array is then hoisted the pin 8 will move in the respective slot 14A, 14B to the stop position, either by gravity in the fly mode as shown in figures 5A-C or by pulling a tension cable 16 in the compression mode as shown in figures 6A-C.

[0026] According to Figures 5A-C when the upper loudspeaker housing 2 is hoisted from a horizontally extending position as shown in figure 5A such that the back sides of the speakers are first pushed against each other as shown in figure 5B, at which point the second pin 9 of the connection bar 7 can be connected to the connection frame 6 to form the hingeable connection, while the correct hole 15 of the connection frame 6 is chosen to be connected to the slot 14A at the other end of the connection bar 7, and thereafter upon further hoisting gravity forces the back sides of the loudspeaker housings to move away relative to each other such that the first connection pins 8 move towards the lower stops in slots 14A, as shown in figure 5C.

[0027] According to Figures 6A-C the loudspeaker array is provided with a tension cable 16, one end of which is attached to the back side of the lower loudspeaker housing 2 in the loudspeaker array, and one end of which is attached near the upper side of said loudspeaker array to the hoist frame 17. The hoist frame 17 comprises means for tensioning the cable 16, which forces the back sides of the loudspeaker housings to move towards each other such that the first connection pins 8 move towards the upper stops in slots 14B.

[0028] In the compression mode the loudspeaker array is normally standing on the floor in a vertical pile before it is hoisted. In order to be able to set the angle 3 between each pair of adjacent loudspeaker housings 2 by rotating the connection bar 7 and coupling the connection bar 7 to the connection frame 6 by inserting the pin 8 through one of said holes 15 and slot 14B, the connection frame 6 is provided with a first support surface 18 extending in a segment of a circle, the centre of said circle being the pivot point 9 of the pivotable connection bar 7 when the loudspeaker array is in the non-hoisted, stretched position. The first support surface 18 is facing towards the pivot point of the connection bar 7. The connection bar 7 is provided with a hole with removable support pin 19 which is arranged to be pushed against and be movable along the support surface 18 when the connection bar 7 is rotated to select the desired hole 15 in the connection frame 6. In that manner the loudspeaker array is kept standing upright in the non-hoisted, stretched position while the support pin 19 is not removed, as shown in figure 6A. The support pin 19 can be removed when the loudspeaker array is

being hoisted at the hoisting stage as shown in figure 6B, in order to allow the tension cable 16 to move the back sides of the loudspeaker housings 2 towards each other and thereby move the first connection pins 8 towards the upper stops in slots 14B, as shown in figure 6 C.

[0029] The connection frame 6 is furthermore provided with a second support surface 20, also extending in a segment of a circle, the centre of said circle also being the pivot point of the pivotable connection bar 7 when the loudspeaker array is in the non-hoisted, stretched position. The second support surface 20 is facing away from the pivot point of the connection bar 7. The connection bar 7 is provided with a second support pin 21 which is arranged to push against and be movable along said support surface 20 in order to hold said loudspeaker array in the stretched position when the loudspeaker array is hoisted, before the cable 16 is tensioned, as can be seen in figure 6B.

[0030] The invention has thus been described by means of a preferred embodiment. It is to be understood, however, that this disclosure is merely illustrative. Various details of the structure and function were presented, but changes made therein, to the full extent extended by the general meaning of the terms in which the appended claims are expressed, are understood to be within the principle of the present invention. The description and drawings shall be used to interpret the claims. The claims should not be interpreted as meaning that the extent of the protection sought is to be understood as that defined by the strict, literal meaning of the wording used in the claims, the description and drawings being employed only for the purpose of resolving an ambiguity found in the claims. For the purpose of determining the extent of protection sought by the claims, due account shall be taken of any element which is equivalent to an element specified therein.

REFERENCES CITED IN THE DESCRIPTION

This list of references cited by the applicant is for the reader's convenience only. It does not form part of the European patent document. Even though great care has been taken in compiling the references, errors or omissions cannot be excluded and the EPO disclaims all liability in this regard.

Patent documents cited in the description

- [US7261180B \[0001\]](#)
- [US20070000719A1 \[0003\]](#)
- [WO2011005093A1 \[0003\]](#)
- [US20130240288A1 \[0003\]](#)

Patentkrav

1. Række af højttalere, og som er egnet til brug både ved en "sammentrykt" ophængning og ved en "fri" ophængning, og som omfatter mindst to højttalerhuse
- 5 (2), hvor hver af de to ved siden af hinanden anbragte højttalerhuse (2) er koblet til hinanden ved hjælp af koblingsorganer (11);
- og hvor koblingsorganerne (11) omfatter et hængsel, som forbinder forsiderne af de ved siden af hinanden anbragte højttalerhuse (2);
- hvor koblingsorganerne (11) er udformet til at kunne sammenkoble højttalerhu-
- 10 sene (2) på en sådan måde, at højttalerhusene (2) i en ophejst stilling danner en i forvejen bestemt vinkel med hinanden og er forsynet med organer til indstilling af en i forvejen bestemt vinkel, når højttalerhusene (2) befinder sig i en ikke-vejst stilling;
- hvor koblingsorganerne (11) yderligere er således udformet, at de kan sammen-
- 15 koble højttalerhusene (2), så at højttalerhusene (2), efter at sidstnævnte er flyttet fra ikke-vejst stilling til vejst stilling - kan flyttes til en stilling, hvor højttalerhusene (2) er tvunget til at danne nævnte, i forvejen bestemte vinkel;
- hvor koblingsorganerne (11) omfatter en vippelig forbindelsesstang (7), som ved den ene ende er vippeligt forbundet med bagsiden af en af de nævnte, ved siden
- 20 af hinanden anbragte højttalerhuse (2) og en stationær forbindelsesramme (6), som er monteret på bagsiden af det andet af de ved siden af hinanden anbragte højttalerhuse, og hvortil den anden ende af forbindelsesstangen (7) kan kobles ved hjælp af en forbindelsesdel (8); og
- hvor enten forbindelsesrammen (6) eller -stangen (7) er forsynet med en antal
- 25 holdeorganer (15), som er således anbragt, at de kan holde forbindelsesdelen (8) og er således indrettet, at et valg af hver enkelt af de nævnte holdeorganer (15) ved at dreje forbindelsesstangen (7) til fastholdelse af forbindelsesdelen (8) og koble forbindelsesstangen (7) til forbindelsesrammen (6) - vil fastlægge en forskellig, i forvejen bestemt vinkel;
- 30 **kendetegnet ved**, at den anden af nævnte forbindelsesramme (6) eller -stang (7) er forsynet med et "på flyvende måde virkende" trækforbindelsesdel-stoporgan og et "ved tryk virkende"-skubbeforbindelsesdel-stoporgan, som hver er indrettet til at opfange og blokere bevægelse af forbindelsesdelen (8) i to modsatte

retninger, og hvor den ene er en "på flyvende måde"-indretning og den anden er en "ved tryk virkende måde"-indretning, så at blokering af bevægelsen af forbindelsesdelen (8) i "flyvemåde"-retningen får bagsiderne af de nævnte højttalerhuse (2) til at udøve en trækraft på hinanden, medens opretholdelse af nævnte
5 i forvejen bestemte vinkel og blokering af bevægelsen af forbindelsesdelen (8) i "trykmåde"-retningen får bagsiden af højttalerhusene (2) til at udøve en trykkraft på hinanden, medens den nævnte i forvejen bestemte vinkel opretholdes.

2. Række af højttalere ifølge krav 1, hvor de særligt udformede forbindelsesdel-
10 steder på nævnte "flyvemåde"-forbindelsesdel-stoporgan og nævnte "trykmåde"-forbindelsesdel-stoporgan er anbragt i samme afstand fra vippepunktet for den vippelige forbindelsesstang (7).

3. Række af højttalere ifølge krav 1 eller 2, hvor forbindelsesdel-stoporganerne
15 (5) er tildannet ved hjælp af ender af slidser (14A, 14B), hvori forbindelsesdelen (8) kan bevæges, og hvor de nævnte slidser (14A, 14B) strækker sig i henholdsvis "flyvemåde"-retningen og "trykmåde"-retningen, idet hver af de nævnte retninger "går igennem" vippepunktet for den vippelige forbindelsesstang (7).

20 4. Række af højttalere ifølge ethvert af kravene 1 til 3, hvor det nævnte antal holdeorganer (15) til fastholdelse af forbindelsesdelen (8) strækker sig i en række i retning, som er i hovedsagen vinkelret på retningerne for "flyvemåden" og "trykmåden".

25 5. Række af højttalere ifølge ethvert af kravene 1 til 4, hvor nævnte række af højttalere er forsynet med et spændingskabel (16), hvis ene ende er fastgjort til bagsiden af det nedre højttalerhus (2) i rækken af højttalere, og hvor den ene ende er tilsluttet nær den øvre side af rækken af højttalere, og organer til spænding af kablet (16) med henblik på at kunne bevæge nævnte forbindelsesdel (8)
30 i "trykmåde"-retningen hen mod "trykmåde"-forbindelsesdel-stoporganerne.

6. Række af højttalere ifølge ethvert af kravene 1 til 5, og hvor rækken af højttalere er således udformet, at når det øvre højttalerhus (2) i rækken af højttalere

er hejst, så vil tyngdekræfterne tvinge rækken af højttalerhuse (2) til at bevæge sig, således at forbindelsesdelene (8) vil bevæge sig i "flyvemåde"-retningen hen mod "flyvemåde"-forbindelsesdel-stoporganerne.

5 7. Række af højttalere ifølge ethvert af kravene 1 til 6, hvor forbindelsesrammen (6) eller -stangen (7), som er forsynet med holdeorganer (15) til nævnte forbindelsesdel (8) er forsynet med en bæreflade (18), som strækker sig i et cirkelsegment, hvor centrum for cirklen udgør vippepunktet for nævnte vippelige forbindelsesstang (7), når rækken af højttalere befinder sig i ikke-hejst stilling, hvor
10 rækken er strakt;

hvor den anden af nævnte forbindelsesramme (6) eller -stang (7) er forsynet med en bortfjernelig bæredel (19), som er således anbragt, at den kan skubbes mod og være bevægelig langs bærefladen (18), når forbindelsesstangen (7) er drejet for at holde nævnte række af højttalere stående opret i ikke-hejst stilling, hvor
15 rækken er strakt, hvilken bortfjernelig bæredel (19) kan fjernes, når rækken af højttalere er hejst for at tillade tilstedeværelsen af et spændekabel (16), hvis ene ende er fastgjort på bagsiden af det nedre højttalerhus (2) i nævnte række af højttalere, og hvis ene ende er fastgjort nær den øvre ende af rækken af højttalere, og organer til spænding af det nævnte kabel (16) med henblik på at bevæge
20 nævnte forbindelsesdel (8) i "trykmåde"-retningen hen mod "kompressionsmåde"-forbindelsesdel-stoporganerne.

8. Række af højttalere ifølge ethvert af kravene 1 til 7, hvor nævnte forbindelsesramme (6) eller -stang (7), som er forsynet med de nævnte holdeorganer (15)
25 for nævnte forbindelsesdel (8), er forsynet med en anden bæreflade (20), som strækker sig i et cirkelsegment, hvor centrum i cirklen udgør vippepunkt for nævnte vippelige forbindelsesstang (7), når rækken af højttalere befinder sig i ikke-hejst stilling, idet rækken er strakt;

hvor den anden ende af nævnte forbindelsesramme (7) eller -stang (7) er forsynet
30 med en anden bæredel (21), som er indrettet til at kunne skubbe mod og være bevægelig langs nævnte bæreflade (20), så at rækken af højttalere holdes i strakt stilling, når denne række af højttalere er hejst.

9. Række af højttalere, som er egnet til anvendelse ved en "trykophængningsmåde", og som omfatter mindst to højttalerhuse (2), hvor hver to ved siden af hinanden anbragte højttalerhuse (2) er koblet til hinanden ved hjælp af koblingsorganer (11);
- 5 hvor koblingsorganerne (11) omfatter et hængsel (5), som forbinder forsiderne af de nævnte, ved siden af hinanden anbragte, højttalerhuse (2);
- hvor koblingsorganerne (11) er således udformet, at de kan sammenkoble de ved siden af hinanden anbragte højttalerhuse (2) på en sådan måde, at højttalerhusene (2) vil strække sig, således at de danner en i forvejen bestemt vinkel med
- 10 hinanden i hejst stilling, og være forsynet med organer til indstilling af den i forvejen bestemte vinkel, når højttalerhusene (2) befinder sig i en ikke-hejst stilling; hvor koblingsorganerne (11) er yderligere udformet til at kunne sammenkoble højttalerhusene (2) på en sådan måde, at højttalerhusene (2) - efter at de er blevet bevæget fra ikke-hejst stilling til hejst stilling - kan bevæges til en stilling, hvor
- 15 disse højttalerhuse (2) tvinges til at strække sig ved nævnte, i forvejen bestemte vinkel;
- hvor koblingsorganerne (11) omfatter en vippelig forbindelsesstang (7), som ved den ene ende er vippeligt forbundet med bagsiden af et af de nævnte, ved siden af hinanden anbragte højttalerhuse (2), og en stationær forbindelsesramme (6),
- 20 som er monteret på en bagside af det andet af de nævnte ved siden af hinanden anbragte højttalerhuse (2), og hvortil den anden ende af nævnte forbindelsesstang (7) kan kobles ved hjælp af forbindelsesdelen (8);
- hvor den ene af nævnte forbindelsesramme (6) eller -stang (7) er forsynet med et antal holdeorganer (15), som er indrettet til at holde forbindelsesstangen (8) og således indrettet, at et valg af hver af de nævnte holdeorganer (15) ved at
- 25 dreje forbindelsesstangen (7) for at holde nævnte forbindelsesdel (8) og sammenkoble forbindelsesstangen (7) med forbindelsesrammen (6) - vil fastlægge en anden, i forvejen bestemt vinkel; og
- hvor den anden af nævnte forbindelsesramme (6) eller -stang (7) er forsynet med
- 30 et "trykmåde"-skubbeforbindelses-stoporgan, som er indrettet til at kunne optage og blokere bevægelse af nævnte forbindelsesdel (8) i "trykmåde"-retningen, så at blokering af bevægelsen af nævnte forbindelsesdel (8) i "trykmåde"-retningen

vil medføre, at bagsiden af højttalerhusene (2) vil udøve en trykkraft på hinanden, medens de opretholder nævnte, i forvejen bestemte vinkel.

10. Række af højttalere ifølge krav 9, hvor nævnte forbindelsesramme (6) eller
5 -stang (7), som er forsynet med de nævnte holdeorganer (15) for nævnte forbindelsesdel (8), er forsynet med en bæreflade (18), som strækker sig i et cirkelsegment, hvor centrum for cirklen er vippepunktet for nævnte vippelige forbindelsesstang (7), når rækken af højttalere befinder sig i ikke-vejst stilling, hvor rækken er strakt;
- 10 hvor den anden af nævnte forbindelsesramme (6) eller -stang (7) er forsynet med en bevægelig bæredel (19), som er således indrettet, at den kan skubbe mod og være bevægelig langs nævnte bæreflade (18), når forbindelsesstangen (7) drejes for at holde rækken af højttalere stående opret i ikke-vejst stilling, hvor rækken er strakt - hvilken bortfjernelig bæredel (19) kan fjernes, når rækken af højttalere
15 er vejst for at tillade brugen af et spændingskabel (16), hvis ene ende er fastgjort til bagsiden af det nedre højttalerhus (2) i nævnte række af højttalere, og hvor den ene ende af kablet er fastgjort nær den øvre side af rækken af højttalere og organer til spænding af kablet (16), så at forbindelsesdelene (8) kan bevæges i "trykmåde"-retningen mod "trykmåde"-forbindelsesdel-stoporganerne.
- 20
11. Række af højttalere ifølge krav 9 eller 10, hvor forbindelsesrammen (6) eller -stangen (7), som er forsynet med de nævnte holdeorganer (15) til forbindelsesdelen (8), er forsynet med en anden bæreflade (20), som strækker sig i et cirkelsegment, hvor centrum for cirklen er vippepunkt for nævnte vippelige forbindelsesstang (7), når nævnte række af højttalere befinder sig i den ikke-vejste stilling,
25 hvor rækken er strakt;
- hvor den anden af nævnte forbindelsesramme (6) eller -stang (7) er forsynet med en anden bæredel (21), som er indrettet til at skubbe mod og være bevægelig langs nævnte bæreflade (20), så at rækken af højttalere holdes i en strakt stilling,
30 når rækken af højttalere hejses.

12. Række af højttalere ifølge ethvert af kravene 1 til 11, hvor nævnte antal holdeorganer (15) er tilvejebragt på den stationære forbindelsesramme (6), og at forbindelsesdelen (8) er tilvejebragt i den vippelige forbindelsesstang (7).

5 13. Række af højttalere ifølge ethvert af kravene 1 til 12, hvor forbindelsesdelen (8) og/eller bæredelen(e) (19, 21) udgøres af en tap.

14. Række af højttalere ifølge ethvert af kravene 1 til 13, hvor holdeorganet (15) er et taphul, hvori en tap (8) kan indskydes.

10

15. Række af højttalere ifølge ethvert af kravene 9 til 11, og som er egnet til både en "trykunderstøtningsmåde" og en "flyvende understøtningsmåde", og hvor den anden af nævnte forbindelsesramme (6) eller -stang (7) er forsynet med et "flyvemåde"-trækforbindelsesdel-stoporgan, som er indrettet til at kunne rumme og blokere bevægelse af forbindelsesdelen (8) i en "flyvemåde"-retning, som er modsat nævnte "kompressionsmåde"-retning, så at en blokering af bevægelsen af den nævnte forbindelsesdel (8) i "flyvemåde"-retningen vil få bagsiderne af højttalerhusene (2) til at udøve en trækraft på hinanden, medens nævnte, i forvejen bestemte vinkel opretholdes, og hvor de "opløste" forbindelsesdel-steder vedrørende nævnte "flyvemåde"-forbindelsesdel-stoporgan og nævnte "kompressionsmåde"-forbindelsesdel-stoporgan er placeret i samme afstand fra vippepunktet for nævnte vippelige forbindelsesstang (7), og hvor rækken af højttalere er således udformet, at når det øvre højttalerhus (2) i rækken af højttalere hejses, vil tyngdekraften tvinge højttalerhusene (2) til at bevæge sig, så at forbindelsesdelene (8) vil bevæge sig i "flyvemåde"-retningen hen mod "flyvemåde"-forbindelsesdel-stoporganerne.

15

20

25

DRAWINGS

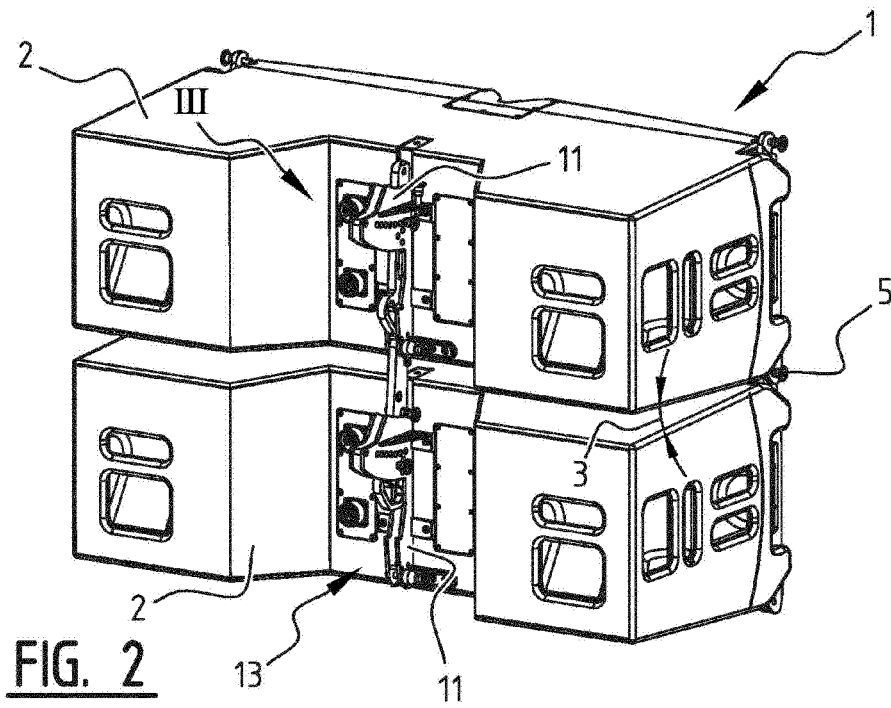
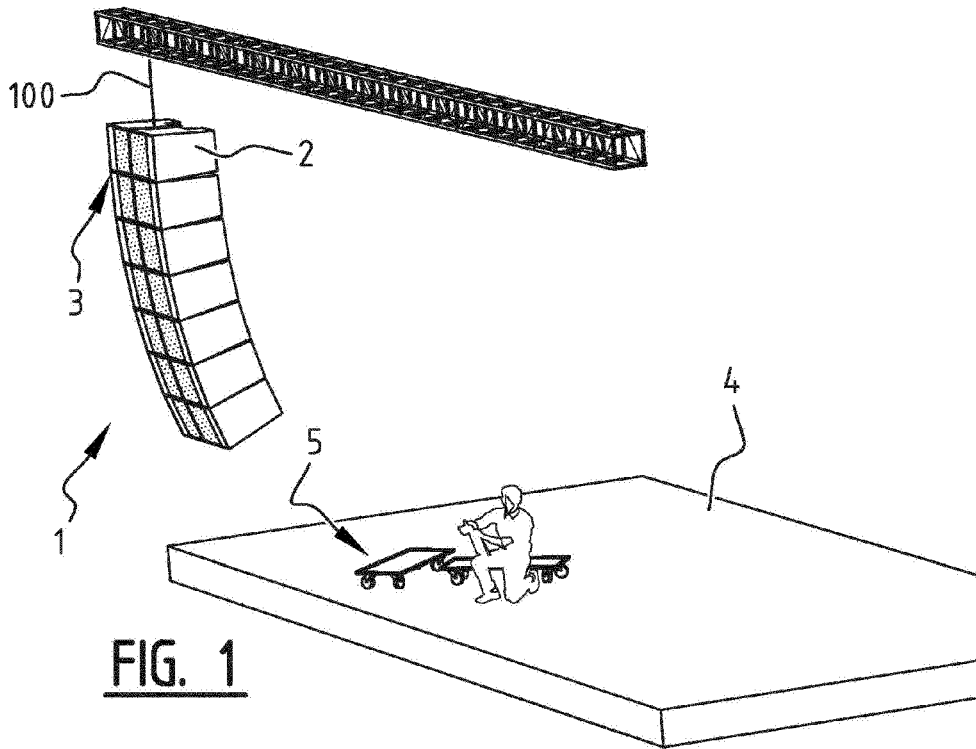

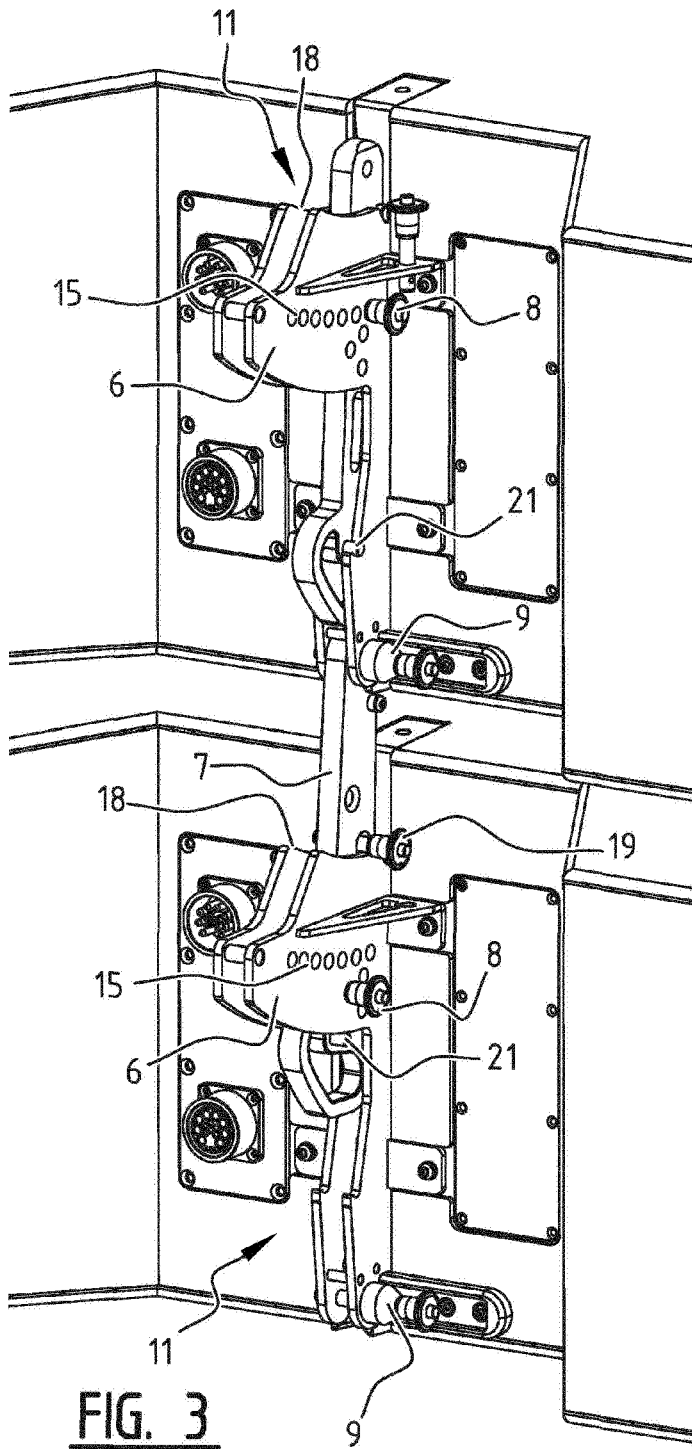

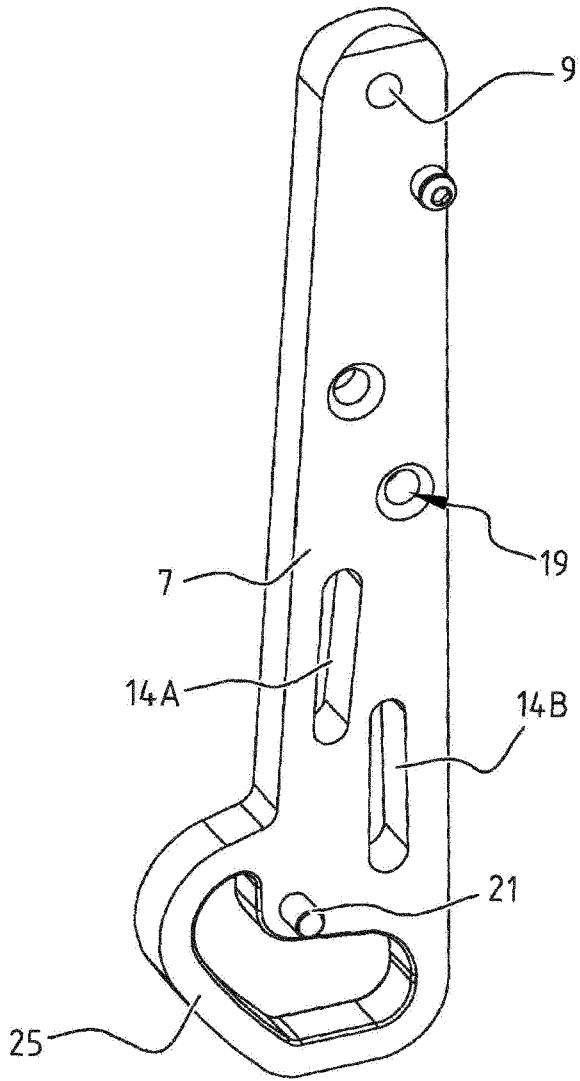

FIG. 4

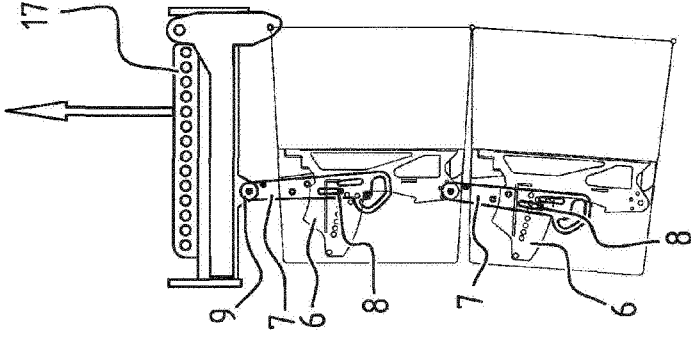

FIG. 5C

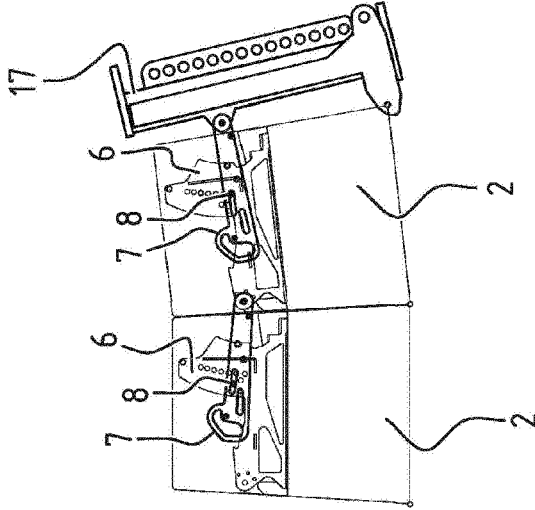

FIG. 5B

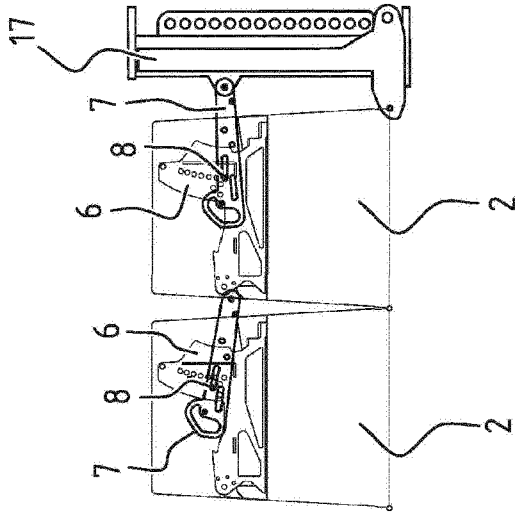

FIG. 5A

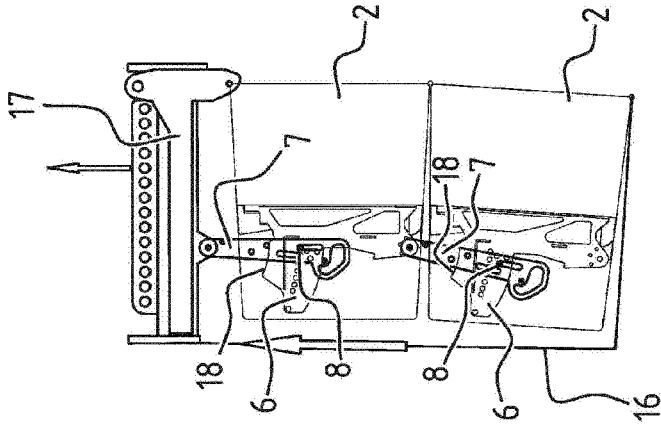

FIG. 6C

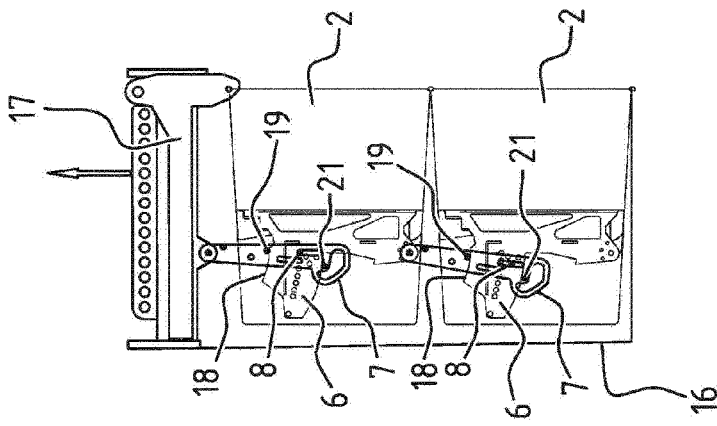

FIG. 6B

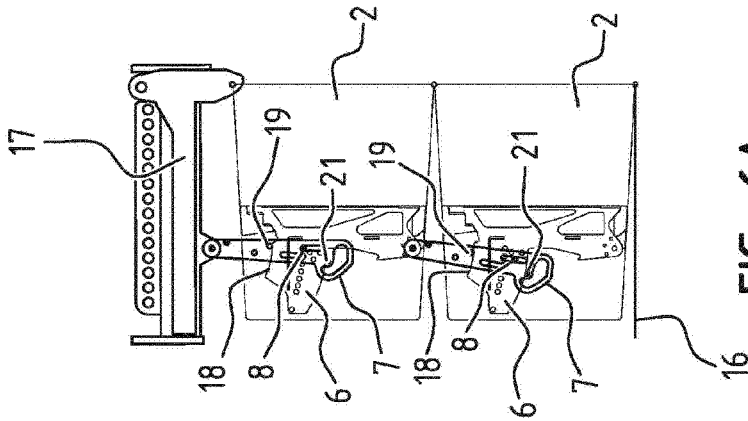

FIG. 6A