



- (51) International Patent Classification:  
A61B 17/32 (2006.01) A61B 18/14 (2006.01)  
A61B 17/28 (2006.01)
- (21) International Application Number:  
PCT/US2017/062023
- (22) International Filing Date:  
16 November 2017 (16.11.2017)
- (25) Filing Language: English
- (26) Publication Language: English
- (30) Priority Data:  
62/422,698 16 November 2016 (16.11.2016) US  
62/508,720 19 May 2017 (19.05.2017) US  
62/519,482 14 June 2017 (14.06.2017) US  
15/798,835 31 October 2017 (31.10.2017) US
- (71) Applicant: ETHICON LLC [US/US]; #475 Street C, Suite 401, Los Frailes Industrial Park, Guaynabo, 00969 (PR).
- (72) Inventors: ASHER, Ryan M.; 4545 Creek Road, Cincinnati, Ohio 45242 (US). BOUDREAUX, Chad P.; 4545 Creek Road, Cincinnati, Ohio 45242 (US). DENZINGER, Kristen G.; 4545 Creek Road, Cincinnati, Ohio 45242 (US). NOTT, Cameron; 4545 Creek Road, Cincinnati, Ohio 45242 (US). WIENER, Eitan T.; 4545 Creek Road, Cincinnati, Ohio 45242 (US).
- (74) Agent: SHIRTZ, Joseph F. et al.; JOHNSON & JOHNSON, One Johnson & Johnson Plaza, New Brunswick, New Jersey 08933 (US).
- (81) Designated States (unless otherwise indicated, for every kind of national protection available): AE, AG, AL, AM, AO, AT, AU, AZ, BA, BB, BG, BH, BN, BR, BW, BY, BZ, CA, CH, CL, CN, CO, CR, CU, CZ, DE, DJ, DK, DM, DO,

(54) Title: SURGICAL INSTRUMENT WITH SPOT COAGULATION CONTROL AND ALGORITHM

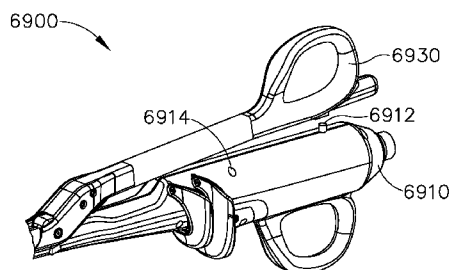

Fig.24

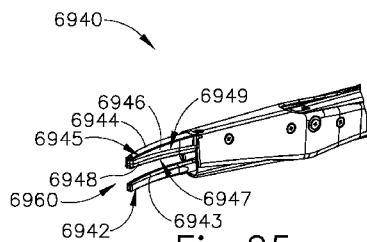

Fig.25

(57) Abstract: A surgical instrument includes an end effector that has an ultrasonic blade (6942) and a clamp arm (6944) that is movable relative to the ultrasonic blade from an opened position toward a closed position. The ultrasonic blade and the clamp arm are able to receive tissue in the opened position, and the clamp arm is able to clamp tissue against the ultrasonic blade in the closed position. There is a first electrode (6946) connected with the clamp arm, and a second electrode (6943) associated with the ultrasonic blade. The electrodes are able to apply bipolar radiofrequency (RF) energy to tissue captured in the end effector. The instrument further has a first button (6912) for activating the ultrasonic blade to provide a cutting and sealing mode at the end effector. There is also a second button (6914) for activating the electrodes to provide a spot coagulation mode at the end effector.



DZ, EC, EE, EG, ES, FI, GB, GD, GE, GH, GM, GT, HN, HR, HU, ID, IL, IN, IR, IS, JO, JP, KE, KG, KH, KN, KP, KR, KW, KZ, LA, LC, LK, LR, LS, LU, LY, MA, MD, ME, MG, MK, MN, MW, MX, MY, MZ, NA, NG, NI, NO, NZ, OM, PA, PE, PG, PH, PL, PT, QA, RO, RS, RU, RW, SA, SC, SD, SE, SG, SK, SL, SM, ST, SV, SY, TH, TJ, TM, TN, TR, TT, TZ, UA, UG, US, UZ, VC, VN, ZA, ZM, ZW.

**(84) Designated States** (*unless otherwise indicated, for every kind of regional protection available*): ARIPO (BW, GH, GM, KE, LR, LS, MW, MZ, NA, RW, SD, SL, ST, SZ, TZ, UG, ZM, ZW), Eurasian (AM, AZ, BY, KG, KZ, RU, TJ, TM), European (AL, AT, BE, BG, CH, CY, CZ, DE, DK, EE, ES, FI, FR, GB, GR, HR, HU, IE, IS, IT, LT, LU, LV, MC, MK, MT, NL, NO, PL, PT, RO, RS, SE, SI, SK, SM, TR), OAPI (BF, BJ, CF, CG, CI, CM, GA, GN, GQ, GW, KM, ML, MR, NE, SN, TD, TG).

**Published:**

— *with international search report (Art. 21(3))*

## SURGICAL INSTRUMENT WITH SPOT COAGULATION CONTROL AND ALGORITHM

## PRIORITY

**[0001]** This application claims priority to: (1) U.S. Provisional Patent Application Serial No. 62/422,698, filed November 16, 2016, entitled “Ultrasonic Surgical Shears with Contained Compound Lever Clamp Arm Actuator,” the disclosure of which is incorporated by reference herein; (2) U.S. Provisional Patent Application Serial No. 62/508,720, filed May 19, 2017, entitled “Ultrasonic and Electrosurgical Instrument with Replaceable End Effector Features,” the disclosure of which is incorporated by reference herein; and (3) U.S. Provisional Patent Application Serial No. 62/519,482, filed June 14, 2017, entitled “Ultrasonic and Electrosurgical Instrument with Removable Features,” the disclosure of which is incorporated by reference herein.

## BACKGROUND

**[0002]** A variety of surgical instruments include an end effector having a blade element that vibrates at ultrasonic frequencies to cut and/or seal tissue (e.g., by denaturing proteins in tissue cells). These instruments include piezoelectric elements that convert electrical power into ultrasonic vibrations, which are communicated along an acoustic waveguide to the blade element. The precision of cutting and coagulation may be controlled by the surgeon’s technique and adjusting the power level, blade edge, tissue traction and blade pressure.

**[0003]** Examples of ultrasonic surgical instruments include the HARMONIC ACE® Ultrasonic Shears, the HARMONIC WAVE® Ultrasonic Shears, the HARMONIC FOCUS® Ultrasonic Shears, and the HARMONIC SYNERGY® Ultrasonic Blades, all by Ethicon Endo-Surgery, Inc. of Cincinnati, Ohio. Further examples of such devices and related concepts are disclosed in U.S. Pat. No. 5,322,055, entitled “Clamp Coagulator/Cutting System for Ultrasonic Surgical Instruments,” issued June 21, 1994, the disclosure of which is incorporated by reference herein; U.S. Pat. No. 5,873,873, entitled “Ultrasonic Clamp Coagulator Apparatus Having Improved Clamp Mechanism,” issued February 23, 1999, the disclosure of which is incorporated by reference herein; U.S. Pat.

No. 5,980,510, entitled “Ultrasonic Clamp Coagulator Apparatus Having Improved Clamp Arm Pivot Mount,” filed October 10, 1997, the disclosure of which is incorporated by reference herein; U.S. Pat. No. 6,325,811, entitled “Blades with Functional Balance Asymmetries for use with Ultrasonic Surgical Instruments,” issued December 4, 2001, the disclosure of which is incorporated by reference herein; U.S. Pat. No. 6,773,444, entitled “Blades with Functional Balance Asymmetries for Use with Ultrasonic Surgical Instruments,” issued August 10, 2004, the disclosure of which is incorporated by reference herein; and U.S. Pat. No. 6,783,524, entitled “Robotic Surgical Tool with Ultrasound Cauterizing and Cutting Instrument,” issued August 31, 2004, the disclosure of which is incorporated by reference herein.

**[0004]** Still further examples of ultrasonic surgical instruments are disclosed in U.S. Pub. No. 2006/0079874, entitled “Tissue Pad for Use with an Ultrasonic Surgical Instrument,” published April 13, 2006, the disclosure of which is incorporated by reference herein; U.S. Pub. No. 2007/0191713, entitled “Ultrasonic Device for Cutting and Coagulating,” published August 16, 2007, the disclosure of which is incorporated by reference herein; U.S. Pub. No. 2007/0282333, entitled “Ultrasonic Waveguide and Blade,” published December 6, 2007, the disclosure of which is incorporated by reference herein; U.S. Pub. No. 2008/0200940, entitled “Ultrasonic Device for Cutting and Coagulating,” published August 21, 2008, the disclosure of which is incorporated by reference herein; U.S. Pat. No. 8,623,027, entitled “Ergonomic Surgical Instruments,” issued January 7, 2014, the disclosure of which is incorporated by reference herein; U.S. Pat. No. 9,023,071, entitled “Ultrasonic Device for Fingertip Control,” issued May 5, 2015, the disclosure of which is incorporated by reference herein; and U.S. Pat. No. 8,461,744, entitled “Rotating Transducer Mount for Ultrasonic Surgical Instruments,” issued June 11, 2013, the disclosure of which is incorporated by reference herein; and U.S. Pat. No. 8,591,536, entitled “Ultrasonic Surgical Instrument Blades,” issued November 26, 2013, the disclosure of which is incorporated by reference herein.

**[0005]** Some of ultrasonic surgical instruments may include a cordless transducer such as that disclosed in U.S. Pat. No. 9,381,058, entitled “Recharge System for Medical Devices,” issued July 5, 2016, the disclosure of which is incorporated by reference herein; U.S. Pub.

No. 2012/0116265, entitled “Surgical Instrument with Charging Devices,” published May 10, 2012, the disclosure of which is incorporated by reference herein; and/or U.S. Pat. App. No. 61/410,603, filed November 5, 2010, entitled “Energy-Based Surgical Instruments,” the disclosure of which is incorporated by reference herein.

**[0006]** Additionally, some ultrasonic surgical instruments may include an articulating shaft section. Examples of such ultrasonic surgical instruments are disclosed in U.S. Pat. No. 9,393,037, entitled “Surgical Instruments with Articulating Shafts,” issued July 19, 2016, the disclosure of which is incorporated by reference herein; and U.S. Pat. No. 9,095,367, entitled “Flexible Harmonic Waveguides/Blades for Surgical Instruments,” issued August 4, 2015 the disclosure of which is incorporated by reference herein.

**[0007]** While several surgical instruments and systems have been made and used, it is believed that no one prior to the inventors has made or used the invention described in the appended claims.

#### BRIEF DESCRIPTION OF THE DRAWINGS

**[0008]** While the specification concludes with claims which particularly point out and distinctly claim this technology, it is believed this technology will be better understood from the following description of certain examples taken in conjunction with the accompanying drawings, in which like reference numerals identify the same elements and in which:

**[0009]** FIG. 1A depicts a perspective view of a first exemplary surgical instrument, with an end effector of the instrument in an open configuration;

**[00010]** FIG. 1B depicts a perspective view of the instrument of FIG. 1A, with the end effector in a closed configuration;

**[00011]** FIG. 2 depicts an exploded perspective view of the instrument of FIG. 1A;

**[00012]** FIG. 3 depicts a perspective view of a first modular assembly of the instrument of FIG. 1A;

**[00013]** FIG. 4 depicts a perspective view of the first modular assembly of FIG. 3, with

selected portions purposefully omitted for clarity;

- [00014] FIG. 5 depicts a perspective view of a shaft assembly and a blade assembly of the first modular assembly of FIG. 3;
- [00015] FIG. 6 depicts a cross-sectional perspective view of the shaft assembly and blade assembly of FIG. 5;
- [00016] FIG. 7 depicts a perspective view of a coupling member of the instrument of FIG. 1A;
- [00017] FIG. 8 depicts a perspective view of a second modular assembly of the instrument of FIG. 1A;
- [00018] FIG. 9 depicts an exploded perspective view of the second modular assembly of FIG. 8;
- [00019] FIG. 10 depicts an exploded perspective view of a clamp arm assembly and a clamp pad assembly of the second modular assembly of FIG. 8;
- [00020] FIG. 11 depicts a perspective view of the clamp arm assembly of FIG. 10;
- [00021] FIG. 12 depicts a cross-sectional side view of the clamp arm assembly of FIG. 10, taken along line 12-12 of FIG. 11;
- [00022] FIG. 13A depicts a perspective view of the second modular assembly of FIG. 8 aligned with the shaft assembly of FIG. 5 in order to couple the modular assemblies together;
- [00023] FIG. 13B depicts a perspective view of the second modular assembly of FIG. 8 inserted over the shaft assembly of FIG. 5;
- [00024] FIG. 13C depicts a perspective view of the second modular assembly of FIG. 8 coupled with the shaft assembly of FIG. 5 via the coupling member of FIG. 7;
- [00025] FIG. 14A depicts a cross-sectional side view of the second modular assembly of FIG. 8 partially inserted over the shaft assembly of FIG. 5, taken along line 14-14 of FIG. 13B;

- [00026]** FIG. 14B depicts a cross-sectional side view of the second modular assembly of FIG. 8 further inserted over the shaft assembly of FIG. 5, taken along line 14-14 of FIG. 13B;
- [00027]** FIG. 14C depicts a cross-sectional side view of the second modular assembly of FIG. 8 inserted over the shaft assembly of FIG. 5 while the coupling member of FIG. 7 is rotated toward a configuration to couple the shaft assembly with the second modular assembly, taken along line 14-14 of FIG. 13B;
- [00028]** FIG. 14D depicts a cross-sectional side view of the coupling member of FIG. 7 connecting the second modular assembly of FIG. 8 and the shaft assembly of FIG. 5, taken along line 14-14 of FIG. 13B;
- [00029]** FIG. 15A depicts a cross-sectional front view of the second modular assembly of FIG. 8 inserted over the shaft assembly of FIG. 5, taken along line 15A-15A of FIG. 14B;
- [00030]** FIG. 15B depicts of cross-sectional front view of the second modular assembly of FIG. 8 inserted over the shaft assembly of FIG. 5 while the coupling member of FIG. 7 is rotated toward a configuration to couple the shaft assembly with the second modular assembly, taken along line 15B-15B of FIG. 14C;
- [00031]** FIG. 15C depicts a cross-sectional front view of the coupling member of FIG. 7 connecting the second modular assembly of FIG. 8 and the shaft assembly of FIG. 5, taken along line 15C-15C of FIG. 14D;
- [00032]** FIG. 16A depicts a cross-sectional side view of the second modular assembly of FIG. 8 coupled with the shaft assembly of FIG. 5, where the end effector is in an open configuration;
- [00033]** FIG. 16B depicts a cross-sectional side view of the second modular assembly of FIG. 8 coupled with the shaft assembly of FIG. 5, where the end effector is in a closed configuration;
- [00034]** FIG. 17 depicts a perspective view of a second exemplary surgical instrument, with an end effector of the instrument in an open configuration;

- [00035] FIG. 18 depicts a partially exploded perspective view of the instrument of FIG. 17;
- [00036] FIG. 19 depicts a partial perspective view of the distal end of a clamp arm actuator of the instrument of FIG. 17;
- [00037] FIG. 20 depicts a perspective view of a shaft assembly and ultrasonic blade of the instrument of FIG. 17;
- [00038] FIG. 21 depicts a perspective view of a removable clamp arm assembly of the instrument of FIG. 17;
- [00039] FIG. 22 depicts an exploded perspective view of the clamp arm assembly of FIG. 21;
- [00040] FIG. 23 depicts a partial perspective view of a proximal end of a clamp arm body of the clamp arm assembly of FIG. 22;
- [00041] FIG. 24 depicts a partial perspective view of a third exemplary surgical instrument including an exemplary handle body, with the handle body including a deactivation button;
- [00042] FIG. 25 depicts a partial perspective view of the surgical instrument of FIG. 24, with an exemplary end effector in an open position and including a clamp arm and an ultrasonic blade, the clamp arm including two poles and the ultrasonic blade including one pole;
- [00043] FIG. 26 depicts a partial perspective view of the handle body of FIG. 24, with the button engaged by a clamp arm actuator;
- [00044] FIG. 27 depicts a partial perspective view of the end effector of FIG. 25, with the end effector in an intermediate position;
- [00045] FIG. 28 depicts a partial perspective view of the clamp arm of FIG. 25, with the two poles positioned therein and separately spaced;
- [00046] FIG. 29 depicts a partial perspective view of the clamp arm of FIG. 25; and
- [00047] FIG. 30 depicts a diagrammatical view of a method of coagulation.

**[00048]** The drawings are not intended to be limiting in any way, and it is contemplated that various embodiments of the technology may be carried out in a variety of other ways, including those not necessarily depicted in the drawings. The accompanying drawings incorporated in and forming a part of the specification illustrate several aspects of the present technology, and together with the description serve to explain the principles of the technology; it being understood, however, that this technology is not limited to the precise arrangements shown.

#### DETAILED DESCRIPTION

**[00049]** The following description of certain examples of the technology should not be used to limit its scope. Other examples, features, aspects, embodiments, and advantages of the technology will become apparent to those skilled in the art from the following description, which is by way of illustration, one of the best modes contemplated for carrying out the technology. As will be realized, the technology described herein is capable of other different and obvious aspects, all without departing from the technology. Accordingly, the drawings and descriptions should be regarded as illustrative in nature and not restrictive.

**[00050]** It is further understood that any one or more of the teachings, expressions, embodiments, examples, etc. described herein may be combined with any one or more of the other teachings, expressions, embodiments, examples, etc. that are described herein. The following-described teachings, expressions, embodiments, examples, etc. should therefore not be viewed in isolation relative to each other. Various suitable ways in which the teachings herein may be combined will be readily apparent to those of ordinary skill in the art in view of the teachings herein. Such modifications and variations are intended to be included within the scope of the claims.

**[00051]** For clarity of disclosure, the terms “proximal” and “distal” are defined herein relative to a human or robotic operator of the surgical instrument. The term “proximal” refers the position of an element closer to the human or robotic operator of the surgical instrument and further away from the surgical end effector of the surgical instrument. The term “distal” refers to the position of an element closer to the surgical end effector of the surgical instrument and further away from the human or robotic operator of the surgical

instrument. In addition, the terms "upper," "lower," "lateral," "transverse," "bottom," and "top" are relative terms to provide additional clarity to the figure descriptions provided below. The terms "upper," "lower," "lateral," "transverse," "bottom," and "top" are thus not intended to unnecessarily limit the invention described herein.

**[00052]** I. First Exemplary Ultrasonic Surgical Instrument for Open Surgical Procedures

**[00053]** FIGS. 1A-2 and FIGS. 13A-13C illustrate a first exemplary ultrasonic surgical instrument (10). At least part of instrument (10) may be constructed and operable in accordance with at least some of the teachings of U.S. Pat. No. 5,322,055; U.S. Pat. No. 5,873,873; U.S. Pat. No. 5,980,510; U.S. Pat. No. 6,325,811; U.S. Pat. No. 6,773,444; U.S. Pat. No. 6,783,524; U.S. Pub. No. 2006/0079874; U.S. Pub. No. 2007/0191713; U.S. Pub. No. 2007/0282333; U.S. Pub. No. 2008/0200940; U.S. Pat. No. 8,623,027; U.S. Pat. No. 9,023,071; U.S. Pat. No. 8,461,744; U.S. Pat. No. 9,381,058; U.S. Pub. No. 2012/0116265; U.S. Pat. No. 9,393,037; U.S. Pat. No. 9,095,367; U.S. Pat. App. No. 61/410,603; and/or U.S. Pub. No. 2015/0080924. The disclosures of each of the foregoing patents, publications, and applications are incorporated by reference herein. In addition, or in the alternative, at least part of instrument (10) may be constructed and operable in accordance with at least some of the teachings of U.S. Pub. No. 2017/0105755, entitled "Surgical Instrument with Dual Mode End Effector and Compound Lever with Detents," published April 20, 2017, the disclosure of which is incorporated by reference herein; and/or U.S. Pat. App. No. 62/363,411, entitled "Surgical Instrument with Dual Mode End Effector," filed July 18, 2016, the disclosure of which is incorporated by reference herein.

**[00054]** As described in greater detail below, instrument (10) is operable to cut tissue and seal or weld tissue (e.g., a blood vessel, etc.) substantially simultaneously. It should also be understood that instrument (10) may have various structural and functional similarities with the HARMONIC ACE® Ultrasonic Shears, the HARMONIC WAVE® Ultrasonic Shears, the HARMONIC FOCUS® Ultrasonic Shears, and/or the HARMONIC SYNERGY® Ultrasonic Blades. Furthermore, instrument (10) may have various structural and functional similarities with the devices taught in any of the other references that are cited and incorporated by reference herein.

**[00055]** Instrument (10) in the present example includes a first modular assembly (100), a second modular assembly (200), and a coupling member (300). As will be described in greater detail below, coupling member (300) may selectively attach first modular assembly (100) with second modular assembly (200) in order to form instrument (10) with an end effector (12). As best seen in FIGS. 1A-1B, end effector (12) comprises an ultrasonic blade (150) and a clamp pad (222) of a clamp pad assembly (220).

**[00056]** Additionally, as will be described in greater detail below, selected portions of second modular assembly (200) may actuate relative to first modular assembly (100), when properly attached with each other, in order to actuate end effector (12) from an open configuration (FIGS. 1A and 16A), to a closed configuration (FIGS. 1B and 16B). The ability to selectively attach and detach second modular assembly (200) with first modular assembly (100) may provide additional benefits of reusability of either modular assembly (100, 200). For instance, different kinds of first modular assemblies (100) may be used with second modular assembly (200) to provide different kinds of surgical instruments. Similarly, different kinds of second modular assemblies (200) may be used with first modular assembly (100) to provide different kinds of surgical instruments. Additionally, moving components of second modular assembly (200) may be housed within static components of second modular assembly (200), which may provide additional advantages, some of which are described below while others will be apparent to one having ordinary skill in the art in view of the teachings herein.

**[00057]** First modular assembly (100) includes a handle assembly (110), a shaft assembly (130) extending distally from handle assembly (110), and an ultrasonic blade (150) extending distally from shaft assembly (130). Handle assembly (110) includes a body (112), a finger grip ring (124), a pair of buttons (126) distal to finger grip ring (124), and an ultrasonic transducer assembly (30) housed within body (112).

**[00058]** Shaft assembly (130) includes a proximal outer sheath (132) extending distally from body (112), a tube (138) extending distally from proximal outer sheath (132), and a waveguide (140) extending within and through both proximal outer sheath (132) and tube (138). Proximal outer sheath (132) includes a pair of protrusions (136). Additionally, proximal outer sheath (132) defines a pair of recesses (134). As will be described in greater

detail below, recesses (134) are dimensioned to mate with a portion of distal outer sheath (230) while protrusions (136) are configured to pivotally couple proximal outer sheath (132) with coupling member (300). Both recesses (134) and protrusions (136) may help couple first modular assembly (100) with coupling member (300).

**[00059]** Proximal outer sheath (132) may be fixed relative to body (112), while tube (138) may be fixed relative to proximal outer sheath (132). As will be described in greater detail below, waveguide (140) may attach to transducer assembly (30) and be supported by portions proximal outer sheath (132) and tube (138). Ultrasonic blade (150) may be unitarily connected to waveguide (140), and also extend distally from waveguide (140). As will be described in greater detail below, waveguide (140) is operable to connect to ultrasonic transducer assembly (30) in order to provide acoustic communication between ultrasonic blade (150) and transducer assembly (30).

**[00060]** Referring to FIG. 4, ultrasonic transducer assembly (30) is housed within body (112) of handle assembly (110). As seen in FIGS. 1A-1B, transducer assembly (30) is coupled with a generator (5) via a plug (11). Transducer assembly (30) receives electrical power from generator (5) and converts that power into ultrasonic vibrations through piezoelectric principles. Generator (5) may include a power source and control module that is configured to provide a power profile to transducer assembly (30) that is particularly suited for the generation of ultrasonic vibrations through transducer assembly (30). Generator (5) may also be configured to provide a power profile that enables end effector (12) to apply RF electrosurgical energy to tissue.

**[00061]** By way of example only, generator (5) may comprise a GEN 300 sold by Ethicon Endo-Surgery, Inc. of Cincinnati, Ohio. In addition or in the alternative, generator (not shown) may be constructed in accordance with at least some of the teachings of U.S. Pat. No. 8,986,302, entitled "Surgical Generator for Ultrasonic and Electrosurgical Devices," issued March 24, 2015, the disclosure of which is incorporated by reference herein. It should also be understood that at least some of the functionality of generator (5) may be integrated into handle assembly (110), and that handle assembly (110) may even include a battery or other on-board power source such that plug (11) is omitted. Still other suitable forms that generator (5) may take, as well as various features and operabilities that

generator (5) may provide, will be apparent to those of ordinary skill in the art in view of the teachings herein.

**[00062]** Ultrasonic vibrations that are generated by transducer assembly (30) are communicated along acoustic waveguide (140) when properly coupled. Waveguide (140) is mechanically and acoustically coupled with transducer assembly (30). Waveguide (140) extends through shaft assembly (130) to reach ultrasonic blade (150). Waveguide (140) may be secured to proximal outer sheath (132) and/or body (112) via a pin (135) extending through waveguide (140) and proximal outer sheath (132). Pin (135) may help ensure waveguide (140) remains longitudinally and rotationally fixed relative to the rest of shaft assembly (130) when waveguide (140) is in a deactivated state (i.e. not vibrating ultrasonically).

**[00063]** Additionally, waveguide (140) may be supported by tube (138) via seals (142) located between an interior of tube (138) and an exterior of waveguide (140). Seals (142) may also prevent unwanted matter and fluid from entering portions of tube (138) housing waveguide (140). Pin (135) and seals (142) are located at positions along the length of waveguide (140) corresponding to nodes associated with resonant ultrasonic vibrations communicated through waveguide (140). Therefore, contact between waveguide (140) and pin (135), as well as contact between waveguide (140) and seals (142) may not affect ultrasonic vibrations communicated through waveguide (154).

**[00064]** When ultrasonic blade (150) is in an activated state (i.e., vibrating ultrasonically), ultrasonic blade (150) is operable to effectively cut through and seal tissue, particularly when the tissue is being clamped between clamp pad (222) and ultrasonic blade (150). It should be understood that waveguide (140) may be configured to amplify mechanical vibrations transmitted through waveguide (140). Furthermore, waveguide (140) may include features operable to control the gain of the longitudinal vibrations along waveguide (140) and/or features to tune waveguide (140) to the resonant frequency of the system.

**[00065]** In the present example, the distal end of ultrasonic blade (150) is located at a position corresponding to an anti-node associated with resonant ultrasonic vibrations communicated through waveguide (140), in order to tune the acoustic assembly to a

preferred resonant frequency  $f_0$  when the acoustic assembly is not loaded by tissue. When transducer assembly (30) is energized, the distal end of ultrasonic blade (150) is configured to move longitudinally in the range of, for example, approximately 10 to 500 microns peak-to-peak, and in some instances in the range of about 20 to about 200 microns at a predetermined vibratory frequency  $f_0$  of, for example, 55.5 kHz. When transducer assembly (30) of the present example is activated, these mechanical oscillations are transmitted through the waveguide to (140) reach ultrasonic blade (150), thereby providing oscillation of ultrasonic blade (150) at the resonant ultrasonic frequency. Thus, when tissue is secured between ultrasonic blade (150) and clamp pad (222), the ultrasonic oscillation of ultrasonic blade (150) may simultaneously sever the tissue and denature the proteins in adjacent tissue cells, thereby providing a coagulative effect with relatively little thermal spread.

**[00066]** In some versions, an electrical current may also be provided through ultrasonic blade (150) and/or clamp pad (222) to also seal the tissue. It should therefore be understood that instrument (10) may also be configured to provide radiofrequency (RF) energy to a surgical site via end effector (12). By way of example only, an operator may rely mainly on the use of ultrasonic energy from blade (150) to sever tissue that is captured between ultrasonic blade (150) and clamp pad (222). The operator may further rely on the use of RF energy from end effector (12) to seal the severed tissue. Of course, it will be understood that the ultrasonic energy from blade (150) may seal tissue to some degree, such that the RF energy from end effector (12) may supplement the sealing that would already be provided from the ultrasonic energy. It will also be understood that there may be instances where the operator may wish to simply use end effector (12) to only apply RF energy to tissue, without also applying ultrasonic energy to tissue. As will be appreciated from the description herein, some versions of instrument (10) are capable of providing all of the above noted kinds of functionality. Various ways in which instrument (10) may be configured and operable to provide both ultrasonic and RF electrosurgical modes of operation are described in various references cited herein; while other ways in which instrument (10) may be configured and operable to provide both ultrasonic and RF electrosurgical modes of operation will be apparent to those of ordinary skill in the art in view of the teachings herein.

**[00067]** An operator may activate buttons (126) to selectively activate transducer assembly (30) to thereby activate ultrasonic blade (150). In the present example, two buttons (126) are provided. In some versions, one button (126) is provided for activating ultrasonic blade (150) at a first power profile (e.g., a first frequency and/or first amplitude) and another button (126) is provided for activating ultrasonic blade (150) at a second power profile (e.g., a second frequency and/or second amplitude). In some other versions, one button (126) is provided for activating ultrasonic blade (150) with ultrasonic energy, and the other button (126) is provided for activating end effector (12) with RF energy. In some other versions, one button (126) is operable to activate ultrasonic blade (150) with ultrasonic energy while simultaneously activating end effector (12) with RF energy; while the other button (126) is only operable to activate ultrasonic blade (150) with ultrasonic energy. In some other versions, at least one button (126) is operable to initially activate ultrasonic blade (150) with ultrasonic energy, then based on one or more other conditions (e.g., time, measured impedance, etc.) while button (126) remains activated, eventually activating end effector (12) with RF energy while still activating ultrasonic blade (150) with ultrasonic energy. In some other versions, at least one button (126) is operable to initially activate ultrasonic blade (150) with ultrasonic energy, then based on one or more other conditions (e.g., time, measured impedance, etc.) while button (126) remains activated, eventually activating end effector (12) with RF energy while ceasing activation of ultrasonic blade (150) with ultrasonic energy. In some other versions, at least one button (126) is operable to initially activate end effector (12) with RF energy, then based on one or more other conditions (e.g., time, measured impedance, etc.) while button (126) remains activated, eventually activating ultrasonic blade (150) with ultrasonic energy while ceasing activation of end effector (12) with RF energy.

**[00068]** It should be understood that any other suitable number of buttons and/or otherwise selectable power levels and/or power modalities may be provided. For instance, a foot pedal may be provided to selectively activate transducer assembly (30).

**[00069]** Buttons (126) of the present example are positioned such that an operator may readily fully operate instrument (10) with a single hand. For instance, when first and second modular assemblies (100, 200) are coupled, the operator may position their thumb

in thumb grip ring (214), position their ring finger in finger grip ring (124), position their middle finger about body (112), and manipulate buttons (126) using their index finger. Of course, any other suitable techniques may be used to grip and operate instrument (10); and buttons (126) may be located at any other suitable positions.

**[00070]** As mentioned above, and as will be described below, coupling member (300) is configured to selectively couple first modular assembly (100) with second modular assembly (200). As best seen in FIG. 7, coupling member (300) comprises a body (302), a pair of resilient arms (304) extending from body (302), and a pair of grips (305) extending from body (302). Resilient arms (304) each define a respective pivot bore (306) and locking assembly (308). Resilient arms (304) are spaced apart from each other in order to receive proximal outer sheath (132) and to snap-fit pivot bores (306) with respective protrusions (136). Therefore, as shown between FIGS. 13B-13C and 14B-14C, coupling member (300) is configured to pivotally connect with proximal outer sheath (132) via pivot bores (306) and protrusions (136). While in the current example, coupling member (300) and proximal outer sheath (132) are pivotally coupled via snap-fitting, any other type of suitable connection may be used as would be apparent to one having ordinary skill in the art in view of the teachings herein. For example, protrusions (136) may be extendable relative to proximal outer sheath (132) in order to pivotally couple with pivot bore (306) of coupling member (300). Grips (305) may be positioned on body (302) such that an operator may easily rotate coupling member (300) relative to outer sheath (132) via grips (305).

**[00071]** Each locking assembly (308) includes an interior contact wall (310) facing toward each other and a coupling recess (312). As will be described in greater detail below, locking assembly (308) is configured to rotate about pivot bore (306) and protrusions (136) in order to selectively couple with portions of second modular assembly (200).

**[00072]** While coupling member (300) in the current example is used to connect first modular assembly (100) with second modular assembly (200), it should be understood that coupling member (300) may be incorporated into any suitable type of modular assembly that would be apparent to one having ordinary skill in the art in view of the teachings herein. For example, coupling assembly (300) may be modified to couple different

modular clamp arm assemblies with first modular assembly (100) where the different modular clamp arm assemblies include clamp arm assemblies such as those taught in U.S. Pub. No. 2017/0105788, entitled “Surgical Instrument with Dual Mode End Effector and Modular Clamp Arm Assembly,” published April 20, 2017, the disclosure of which is incorporated by reference herein. Thus, one modular clamp arm assembly that may be coupled with first modular assembly (100) may provide pivotal motion of a clamp arm at one side of ultrasonic blade (150) while the other modular clamp arm assembly that may be coupled with first modular assembly (100) may provide pivotal motion of a clamp arm at the other side of ultrasonic blade (150). Other suitable kinds of clamp arm assemblies that may be used to provide different kinds of second modular assemblies (200) will be apparent to those of ordinary skill in the art in view of the teachings herein.

**[00073]** Second modular assembly (200) includes a clamp arm assembly (210), a clamp pad assembly (220), and a distal outer sheath (230). As will be described in greater detail below, distal outer sheath (230) is configured to couple with both coupling member (300) and proximal outer sheath (132) in order to selectively couple first modular assembly (100) with second modular assembly (200). In other words, when properly coupled, proximal outer sheath (132) and distal outer sheath (230) may be fixed relative to one another. As will also be described in greater detail below, clamp arm assembly (210) and clamp pad assembly (220) are both pivotally coupled with distal outer sheath (230). Additionally, clamp arm assembly (210) and clamp pad assembly (220) are dimensioned to mesh with each other such that rotation of one assembly (210, 220) relative to distal outer sheath (230) causes rotation of the other assembly (210, 220) relative to distal outer sheath (230). In other words, clamp arm assembly (210) and clamp pad assembly (220) are capable of rotating each other relative to distal outer sheath (230).

**[00074]** Distal outer sheath (230) includes a U-shaped body (232) extending from a distal face (235) and terminating in a pair of proximally presented projections (234). Proximally presented projections (234) each include a lateral protrusion (238) extending away from U-shaped body (232). U-shaped body (232) defines a longitudinal pathway (236) and a plurality of bores (240). U-shaped body (232) and longitudinal pathway (236) are dimensioned to receive tube (138) and to rotationally house a portion of clamp arm

assembly (210) and clamp pad assembly (220). In particular, as best shown between FIGS. 13A-13B, U-shaped body (232) may be inserted over ultrasonic blade (150) and tube (138) such that tube (138) will rest under clamp arm assembly (210) and clamp pad assembly (220). Tube (138) may protect waveguide (140) such that clamp arm assembly (210) and clamp pad assembly (220) do not contact adjacent portions of waveguide (140).

**[00075]** As shown between FIGS. 13A-13B and between FIGS. 14A-14B, proximally presented projections (234) are configured to be inserted into recesses (134) defined by proximal outer sheath (132). When proximally presented projections (234) are inserted into recesses (134), distal outer sheath (230) may not rotate relative to proximal outer sheath (132) about a longitudinal axis defined by tube (138). Therefore, proximally presented projections (234) may mate with recesses (134) in order to rotationally fix distal outer sheath (230) relative to proximal outer sheath (132).

**[00076]** As shown between FIGS. 13B-13C, between FIGS 14B- 14D, and between FIGS. 15A-15C, once distal outer sheath (230) is rotationally fixed relative to proximal outer sheath (132), an operator may rotate coupling member (300) such that locking assembly (308) snap-fits with lateral protrusions (238). In particular, an operator may rotate coupling member (300) about protrusion (136) such that lateral protrusions (238) cam against contact walls (310) of resilient arms (304). As a result, as best seen in FIG. 15B, contact between contact walls (310) and lateral protrusions (238) flex resilient arms (304) outwardly away from proximally presented projections (234). An operator may further rotate coupling member (300) about protrusions (136) such that lateral protrusions (238) no longer abut against contact wall (310), as shown in FIGS. 13C, 14C, and 15C. The resilient nature of resilient arms (304) allows resilient arms (304) to return to a relaxed position such that lateral protrusions (238) rest within coupling recess (312) of locking assembly (308). With locking assembly (308) of coupling member (300) fully attached, and shown in FIGS. 13C, 14D, and 15C, distal outer sheath (230) is longitudinally fixed relative to proximal outer sheath (132), thereby coupling first modular assembly (100) with second modular assembly (200).

**[00077]** If an operator wishes to decouple first modular assembly (100) with second modular assembly (200), an operator may grasp grips (305) to rotate coupling member

(300) in the opposite direction about protrusions (136) in order to flex resilient arms (304) to pop out lateral protrusions (238) from coupling recess (312).

**[00078]** As mentioned above, clamp arm assembly (210) and clamp pad assembly (220) are both pivotally coupled with distal outer sheath (230) such that rotation of one assembly (210, 220) relative to distal outer sheath (230) causes rotation of the other assembly (210, 220) relative to distal outer sheath (230).

**[00079]** Clamp arm assembly (210) includes an elongated arm (212), a thumb grip ring (214), a camming protrusion (216), and a pivot coupling (218). Thumb grip ring (214) and elongated arm (212) together provide a scissor grip type configuration in combination with body (112) and finger grip ring (124). Pivot coupling (218) pivotally couples clamp arm assembly (210) with distal outer sheath (230) via pins (202). As will be described in greater detail below, camming protrusion (216) interacts with clamp pad assembly (220) in order to rotate clamp pad assembly (220) in response to rotation of clamp arm assembly (210).

**[00080]** Clamp pad assembly (220) includes a clamp pad (222) facing ultrasonic blade (150), a pair of tissue stops (223) located adjacent to ultrasonic blade (150) and proximal to clamp pad (222), an arm (224) defining both a camming recess (226) and a spring recess (221), a pivot coupling (228), and a leaf spring (225) housed within spring recess (221). In some versions, clamp pad assembly (220) further includes one or more electrodes that is/are operable to apply RF electrosurgical energy to tissue. Various references herein provide examples of how a clamp pad assembly may incorporate one or more electrodes that is/are operable to apply RF electrosurgical energy to tissue, while other examples of how clamp pad assembly (220) may incorporate one or more electrodes that is/are operable to apply RF electrosurgical energy to tissue will be apparent to those of ordinary skill in the art in view of the teachings herein.

**[00081]** In the current example, tissue stops (223) longitudinally align with distal face (235) when end effector (12) is in the closed position. Tissue stops (223) and distal face (235) may cooperate to consistently and simply prevent tissue from inadvertently reaching a proximal position within end effector (12) where ultrasonic energy from blade (150) may not adequately sever or seal the tissue. In providing such prevention, tissue stop (223) may

eliminate the need for an operator to visualize proximal region of end effector (12) in order to determine whether the tissue has reached an undesirably proximal position within end effector (12).

**[00082]** Camming protrusion (216) is dimensioned to rotate within camming recess (226) while also contacting camming recess (226). Camming protrusion (216) and camming recess (226) are positioned within distal outer sheath (230) such that both are located between pivot couplings (218, 228) while clamp arm assembly (210) and clamp pad assembly (220) are pivotally coupled to distal outer sheath (230). Therefore, as shown between FIGS. 1A-1B and 16A-16B, when an operator rotates elongated arm (212) about pivot coupling (218) toward distal outer sheath (230), camming protrusion (216) rotates away from distal outer sheath (230) about pivot coupling (218). Because camming protrusion (216) is housed within camming recess (226), upward movement of camming protrusion (216) about pivot coupling (218) causes upward movement of camming recess (226) about pivot coupling (228). Upward movement of camming recess (226) about pivot coupling (228) rotates arm (224) such that clamp pad (222) rotates toward ultrasonic blade (150). Therefore, closure of elongated arm (212) of clamp arm assembly (210) toward handle assembly (110) leads to closure of clamp pad (222) toward ultrasonic blade (150). It should therefore be understood that when first modular assembly (100) and second modular assembly (200) are connected, an operator may squeeze thumb grip ring (214) toward body (112) to thereby clamp tissue between clamp pad assembly (220) and ultrasonic blade (150) to compress tissue against ultrasonic blade (150). When ultrasonic blade (150) is activated during such compression, clamp pad assembly (220) and ultrasonic blade (150) cooperate to transect and/or seal the compressed tissue.

**[00083]** As mentioned above, leaf spring (225) is housed within spring recess (221). As best seen in FIGS. 16A-16B, leaf spring (225) is dimensioned such that a portion of leaf spring (225) extends out of spring recess (221) to make contact against tube (138) in order to provide electrical continuity between the one or more RF electrodes of end effector (12) and the source of electrical power. It should be understood that leaf spring (225) maintains this electrical continuity throughout the range of motion of clamp pad assembly (220). It should also be understood that any other suitable kinds of features may be used to provide

electrical continuity between the one or more RF electrodes of end effector (12) and the source of electrical power.

**[00084]** In some versions, one or more resilient members are used to bias clamp pad assembly (220) toward the open position shown in FIGS. 1A and 16A. Of course, any other suitable kind of resilient member may be used as would be apparent to one having ordinary skill in the art in view of the teachings herein, such as a torsion spring. Alternatively, clamp pad assembly (220) need not necessarily be biased toward the open position.

**[00085]** Pivot couplings (218, 228) of clamp arm assembly (210) and clamp pad assembly (220) being located within longitudinal pathway (236) of distal outer sheath (230) may provide certain desirable advantages as compared to clamp arm assembly (210) and clamp pad assembly (220) pivotally coupling with an exterior of distal outer sheath (230). For instance, there may be a reduced chance of inadvertently pinching tissue due to rotation of clamp arm assembly (210) and clamp pad assembly (220) with pivot couplings (218, 228) being housed within U-shaped body (232). In other words, U-shaped body (232) may protect tissue from being inadvertently pinched by rotation of clamp arm assembly (210) and clamp pad assembly (220) relative to distal outer sheath (230). Additionally, the width of second modular assembly (200) may be reduced due to pivot couplings (218, 228) being housed within longitudinal pathway (236) of distal outer sheath (230). It may also be easier to fabricate desired components due to the simplified shapes of clamp arm assembly (210) and clamp pad assembly (220). A reduction of tolerance stack may also be an advantage to storing pivot couplings (218, 228) within the interior of distal outer sheath (230).

**[00086]** The foregoing components and operabilities of instrument (10) are merely illustrative. Instrument (10) may be configured in numerous other ways as will be apparent to those of ordinary skill in the art in view of the teachings herein. By way of example only, at least part of instrument (10) may be constructed and/or operable in accordance with at least some of the teachings of any of the following, the disclosures of which are all incorporated by reference herein: U.S. Pat. No. 5,322,055; U.S. Pat. No. 5,873,873; U.S. Pat. No. 5,980,510; U.S. Pat. No. 6,325,811; U.S. Pat. No. 6,783,524; U.S. Pub. No. 2006/0079874; U.S. Pub. No. 2007/0191713; U.S. Pub. No. 2007/0282333; U.S. Pub. No.

2008/0200940; U.S. Pat. No. 9,023,071; U.S. Pat. No. 8,461,744; U.S. Pat. No. 9,381,058; U.S. Pub. No. 2012/0116265; U.S. Pat. No. 9,393,037; U.S. Pat. No. 9,095,367; and/or U.S. Pub. No. 2015/0080925, entitled "Alignment Features for Ultrasonic Surgical Instrument," published March 19, 2015, the disclosure of which is incorporated by reference herein.

**[00087]** II. Second Exemplary Ultrasonic Surgical Instrument for Open Surgical Procedures

**[00088]** FIGS. 17-18 show a second exemplary ultrasonic surgical instrument (301). Except as otherwise described below, instrument (301) of this example may be constructed and operable just like instrument (10) described above. Certain details of instrument (301) will therefore be omitted from the following description, it being understood that such details are already provided above in the description of instrument (10).

**[00089]** Instrument (301) of the present example comprises a handle assembly (311), a clamp arm actuator (320), a shaft assembly (330), and a clamp arm assembly (400). Handle assembly (311) of this example is configured and operable just like handle assembly (110) described above, such that details of handle assembly (311) will not be reiterated here.

**[00090]** Clamp arm actuator (320) is pivotably coupled with shaft assembly (330). In the present example, clamp arm actuator (320) is not removable from shaft assembly (330). Clamp arm actuator (320) of the present example comprises a shaft (322). A thumb ring (324) is positioned at the proximal end of shaft (322). As best seen in FIGS. 18-19, pair of projections (326) extend distally from shaft (322). Projections (326) are laterally spaced apart from each other and extend parallel to each other. As best seen in FIG. 19, the distal end of each projection (326) includes a camming protrusion (328). Camming protrusions (328) are configured to cooperate with clamp arm assembly (400), in a manner similar to camming protrusions (216), as will be described below. As also best seen in FIG. 19, projections (326) also define a pair of pin openings (327), which are configured to receive pin (338). Pin (338) provides a pivotable coupling between clamp arm actuator (320) and shaft assembly (330).

**[00091]** Shaft assembly (330) extends distally from handle assembly (311) and is

substantially identical to shaft assembly (130) described above except for the differences described below. An ultrasonic blade (350), which is identical to ultrasonic blade (150) described above, is positioned at the distal end of shaft assembly (130). As best seen in FIG. 20, shaft assembly (330) defines an opening (332) that is configured to receive pin (338) to thereby provide a pivotable coupling between clamp arm actuator (320) and shaft assembly (330). As also shown in FIG. 20, shaft assembly (330) includes a ramped latch protrusion (334), which is configured to engage clamp arm assembly (400) as will be described in greater detail below.

**[00092]** As shown in FIGS. 21-22, clamp arm assembly (400) of the present example comprises a pair of shrouds (402, 404) partially encompassing a clamp arm body (430), which is pivotally coupled with a stationary body (410). Each shroud includes a distally presented tissue stop edge (408). Stationary body (410) also includes a pair of distally presented tissue stop edges (418). Edges (408, 418) are configured to cooperate to consistently and restrict proximal positioning of tissue like tissue stops (223) and distal face (235) described above. Shroud (404) of the present example also includes a distally projecting shield member (406).

**[00093]** Stationary body (410) of the present example further includes a pin opening (411) and a proximally projecting latch member (412). Latch member (412) defines a latch opening (414) and a ramp (416). Latch member (412) is configured to cooperate with latch protrusion (334) of shaft assembly (330) to selectively secure clamp arm assembly (400) to shaft assembly (330). In particular, when clamp arm assembly (400) is initially provided separately from shaft assembly (330), an operator may align clamp arm assembly (400) with shaft assembly (330) along a common axis, and then insert blade (350) and the remaining distal portion of shaft assembly (330) into clamp arm assembly (400). Ramp (416) will eventually engage latch protrusion (334), which will provide a camming action that causes latch member (412) to deflect away from the longitudinal axis. As the operator continues to insert shaft assembly (330) through clamp arm assembly (400), latch protrusion (334) eventually reaches latch opening (414), at which point latch member (412) resiliently returns to a straight, non-deflected state. At this stage, latch protrusion (334) is disposed in latch opening (414) and thereby secures clamp arm assembly (400) to shaft

assembly (330). When the operator wishes to remove clamp arm assembly (400) from shaft assembly (330), the operator may simply engage ramp (416) and thereby urge latch member (412) to a deflected state where latch member (412) can clear latch protrusion (334); then pull clamp arm assembly (400) away from shaft assembly (330). Other suitable structures and techniques that may be used to secure clamp arm assembly (400) to shaft assembly (330), and to remove clamp arm assembly (400) from shaft assembly (330), will be apparent to those of ordinary skill in the art in view of the teachings herein.

**[00094]** Clamp arm body (430) of the present example comprises a clamp pad (432) and a pair of proximal projections (434). Clamp pad (432) is positioned and configured to compress tissue against ultrasonic blade (350) when clamp arm assembly (400) is secured to shaft assembly (330). Shield member (406) of shroud (404) is configured to extend over the exterior of the distal end of clamp arm body (430), without covering clamp pad (432). Shield member (406) thus enables clamp pad (432) to contact tissue directly. Projections (438) each comprise a respective proximally presented recess (436) and a pair of pin openings (438). A pin (440) is positioned in pin openings (411, 438) to thereby pivotally couple clamp arm body (430) with stationary body (410). Shrouds (402, 404) are fixedly secured to clamp arm body (430) such that shrouds (402, 404) pivot with clamp arm body (430) relative to stationary body (410).

**[00095]** As shown in FIG. 23, recesses (436) have a generally U-shaped configuration. Recesses (436) are configured to receive camming protrusions (328) of clamp arm actuator (320). In other words, when shaft assembly (330) is inserted into clamp arm assembly (400) as described above, camming protrusions (328) will enter recesses (436) when latch member (412) reaches the point at which latch member (412) secures clamp arm assembly (400) to shaft assembly (330). When the operator removes clamp arm assembly (400) from shaft assembly (330), camming protrusions (328) may freely exit recesses (436), as clamp arm actuator (320) remains secured to shaft assembly (330). As best seen in FIG. 17, shrouds (402, 404) are configured to cover the interfaces between recesses (436) and camming protrusions (328). It should be understood that the relationship between recesses (436) and camming protrusions (328) is substantially identical to the relationship between camming protrusion (216) and camming recess (226) described above. Thus, recesses

(436) and camming protrusions (328) provide a pivoting coupling between clamp arm body (430) and clamp arm actuator (320).

**[00096]** As noted above, clamp arm actuator (320) is pivotally coupled with shaft assembly (330) via pin (338); and clamp arm body (430) is pivotally coupled with stationary body (410) via pin (440); while stationary body (410) is fixedly secured to shaft assembly (330). The pivoting interface between recesses (436) and camming protrusions (328) is longitudinally positioned between the longitudinal positions of pins (338, 440). It should therefore be understood that clamp arm actuator (320) and clamp arm body (430) cooperate to provide a compound lever assembly. When an operator pivots thumb ring (324) toward handle assembly (311), the compound lever action provides corresponding pivotal movement of clamp pad (432) toward ultrasonic blade (350).

**[00097]** In the present example, a resilient beam (313) is secured to clamp arm actuator (320) and slidably bears against shaft assembly (330), such that resilient beam (313) resiliently urges clamp arm actuator (320) away from handle assembly (311). Thus, when an operator relaxes their grip on thumb ring (324), resilient beam (313) will urge thumb ring (324) away from handle assembly (311), thereby urging clamp pad (432) away from ultrasonic blade (350). Of course, any other suitable components and arrangements may be used to provide a resilient bias to clamp arm actuator (320). Alternatively, such resilient bias may simply be omitted.

**[00098]** III. Exemplary Surgical Instrument with Spot Coagulation Mode

**[00099]** In some instances, it may be beneficial for an ultrasonic surgical instrument to provide the operator with a custom mode of operation, specifically a spot coagulation mode. Improving the ability of ultrasonic surgical instruments, such as surgical instrument (10, 301) discussed above, to form a predetermined gap at end effector (12) may be desirable when providing ultrasonic and/or RF energy to a patient's tissue, such as performing a spot coagulation on a patient's tissue. Exemplary instruments and features directed to forming a predetermined gap at end effector (12) are described in U.S. Pat. App. No. [ATTORNEY DOCKET NO. END8130USNP2.0652948], entitled "Surgical Instrument with Selectively Actuated Gap-Setting Features for End Effector," filed on even

date herewith, the disclosure of which is incorporated by reference herein. Various suitable ways in which the teachings herein may be combined with the teachings of U.S. Pat. App. No. [ATTORNEY DOCKET NO. END8130USNP2.0652948] will be apparent to those of ordinary skill in the art in view of the teachings herein.

**[000100]** Referring now to the figures, FIG. 24 shows a third exemplary surgical instrument (6900) operable to transition between a cut/seal mode to a spot coagulation mode. As seen in FIG. 25, an end effector (6940) of surgical instrument (6900) comprises an ultrasonic blade (6942) and a clamp arm (6944). Clamp arm (6944) includes a top pad (6945) and a bottom pad (6947), where top pad (6945) includes a first pole (6946) and bottom pad includes a second pole (6948). First pole (6946) is a vessel sealing electrode, or a negative electrode more commonly referred to as a cathode. Ultrasonic blade (6942) is operatively connected to a transducer (not shown) in surgical instrument (6900). Second pole (6948) is a radio frequency (RF) electrode, or a positive electrode more commonly referred to as an anode. As best seen in FIG. 28, top pad (6945) and bottom pad (6947) are spaced apart within clamp arm (6944) by a gap (6949). In some versions, an electrically insulating material could define gap (6949) or be located in place of gap (6949) where gap (6949) is otherwise a void space between top pad (6945) and bottom pad (6947). Ultrasonic blade (6942) includes a third pole (6943), as seen in FIG. 25. Third pole (6943), similar to second pole (6948), is a radio frequency (RF) electrode, or a positive electrode more commonly referred to as an anode. In some versions, third pole (6943) is in the form of an electrode surface or other surface that is applied to or otherwise integrated into the material forming ultrasonic blade (6942). In some other versions, the entirety of ultrasonic blade (6942) serves as third pole (6943).

**[000101]** Second pole (6948) of clamp arm (6944) is positioned to proximally face third pole (6943) of ultrasonic blade (6942). Gap (6949) is configured to separate first pole (6946) from second pole (6948) at a predetermined transverse distance. Another gap (6960) is formed between second pole (6948) and third pole (6943) of ultrasonic blade (6942).

**[000102]** In the present example, as seen in FIG. 24, handle body (6910) includes a first button (6912) and a second button (6914). First button (6912) transversely extends from handle body (6910) towards clamp arm actuator (6930) and is configured to activate the

cut/seal mode of surgical instrument (6900). First button (6912) becomes actuated as clamp arm actuator (6930) moves toward handle body (6910) and engages against first button (6912), as seen in FIG. 26. In this instance, ultrasonic blade (6942) is configured to close against clamp arm (6944) to the closed position, as shown in FIG. 27.

**[000103]** Second button (6914) is configured to activate the spot coagulation mode of surgical instrument (6900). With second button (6914) actuated by an operator, spot coagulation mode is initiated and is configured to operate an algorithm to activate poles (6946, 6948) of clamp arm (6944) and third pole (6943) of ultrasonic blade (6942). Spot coagulation mode is configured to maintain a predetermined gap (6960) at end effector (6940) with clamp arm actuator (6930) moved relative to handle body (6910) to at least a predetermined degree. In other words, spot coagulation mode is configured to maintain predetermined gap (6960) irrespective of the relative position of clamp arm actuator (6930) to handle body (6910) so long as the predetermined minimum degree of movement by clamp arm actuator (6930) towards handle body (6910) is satisfied. Therefore, with second button (6914) activated and first button (6912) not engaged, spot coagulation mode is configured to deactivate with clamp arm actuator (6930) not moved relative to handle body (6910) at least to the predetermined minimum degree.

**[000104]** Spot coagulation mode is further configured to remain active until second button (6914) is actuated, or until clamp arm actuator (6930) engages first button (6912) with clamp arm actuator (6930) moved relative to handle body (6910) to the closed configuration. Furthermore, spot coagulation mode is configured to deactivate with clamp arm actuator (6930) substantially moved towards handle body (6910) but without engaging first button (6912). In this instance, the algorithm of spot coagulation mode perceives end effector (6940) to be in the closed position, due to the insignificant space positioned between ultrasonic blade (6942) and clamp arm (6944), and is thereby configured to deactivate the spot coagulation mode.

**[000105]** IV. Coagulation Algorithm

**[000106]** As shown in FIG. 30, a method (9400) is provided to enable a continuous activation for spot coagulation utilizing simultaneous activation of advanced bipolar (RF) and

ultrasonic energies. Spot coagulation presents a challenge in that the device must continuously activate the underlying energy both in air and in tissue and in some environments, advanced bipolar (RF) energy may short circuit when activated in air due to the high impedance detected.

**[000107]** In this dual energy method (9400), the advanced bipolar (RF) modality creates a strong sealing of the tissue, while the ultrasonic activation reduces the amount of sticking by balancing the thermal effect on both the blade and the clamp pad/arm, such as ultrasonic blade (150) and clamp pad (222) of instrument (10).

**[000108]** In general, method (9400) is directed to lowering one or both of the ultrasonic and RF energy between tissue contact to a low energy level, without completely halting the energy as many energy generating elements cannot support quickly stopping and starting the generated energy. Upon detection of a tissue contact, the low energy level is increased to a working energy level to perform the spot coagulation. Upon release of the tissue contact, the working energy level is decreased to the low energy level and the cycle repeats. Rather than completely halting the RF and/or ultrasonic energy between tissue contacts, the low energy level is provided between tissue contacts to prevent a transition from no energy to a working energy level, which may produce a significant amount of blood spatter.

**[000109]** Method (9400) begins with a step (9402), whereby a surgeon activates a spot coagulation device. Thereafter, step (9402) moves to a step (9404). In step (9404), the device outputs a low RF pulse to interrogate tissue as well as a sub-therapeutic ultrasonic activation to maintain lock. In some versions of method (9400), sub-therapeutic is associated with a low enough amplitude to prevent a shut-down of the instrument being used to provide the energy and/or lower than a standard amplitude for the energy in the given environment. By providing a sub-therapeutic level of energy between tissue contacts, a transition from no energy to the working energy level is prevented, as a transition from no energy to the working energy may produce a significant amount of blood spatter. In some versions of method (9400), maintaining lock is associated with maintaining a particular resonant frequency in an acoustic drivetrain to prevent a generator of the energy from shutting down. The locking is directed to staying as close as possible to a zero phase angle between a current and a voltage of the energy in order to minimize

impedance.

**[000110]** Thereafter, step (9404) moves to a step (9406). In step (9406), the impedance of the RF pulse is checked or collected. If the impedance of the RF pulse is above a particular set threshold, step (9406) moves to a step (9408). If the impedance of the RF pulse is below the particular threshold, step (9406) moves to a step (9410). In the illustrated example, the threshold is set to 4000 ohms. This threshold is selected to indicate when the device's jaws are in air or one jaw is touching tissue, while the other jaw is not. If the device's jaws are in air or one jaw is touching tissue, the impedance of the RF pulse will be above the threshold. If step (9406) determines that the RF pulse is above the threshold, step (9406) moves to step (9408) and step (9408) returns to step (9404) to complete a loop of impedance checking using a low RF pulse within method (9400).

**[000111]** If step (9406) determines that the measured impedance of the RF pulse is below the threshold, step (9406) proceeds to step (9410). Step (9410) recognizes that because the measured impedance is below the threshold, there is tissue contact between the device's jaws. Step (9410) thereafter proceeds to a step (9412), where both the RF energy and the ultrasonic energy is changed to compensate for the tissue contact between the device's jaws. In some versions of step (9412), compound load curve tables are activated for use in updating the RF energy. In other versions of step (9412), ultrasonic energy is activated with an intermediate power level between a lower power level and a higher level, such as a power level "2" between a lower power level of "1" and a higher power level of "5." In other versions, both compound load curves and intermediate power level are activated simultaneously to update their reflective energies.

**[000112]** After the RF and/or ultrasonic energies are updated to compensate for the tissue contact between the device's jaws, step (9412) returns to step (9406) to continue checking the RF impedance in a loop of steps (9406, 9410, 9412). If the impedance changes, step (9406) will proceed to step (9408) and ultimately adjust the RF pulse in step (9404) to reflect the change in impedance.

**[000113]** A spot coagulation instrument similar to instrument (10) of FIG. 1A may be provided and configured to perform one or more steps of method (9400). Some versions

of the spot coagulation instrument may be provided with a closure switch and a feedback feature. The feedback feature may be configured to provide feedback to the user when the closure switch is depressed and the impedance is above the threshold. Alternatively, the feedback feature may be configured to provide feedback to the user when the closure switch is depressed and the impedance is below the threshold. This feedback may be in the form of an audible feedback such as an audible tone, a visual feedback such as a light, or a tactile feedback such as a vibration of one or more portions of the spot coagulation instrument.

**[000114]** V. Exemplary Combinations

**[000115]** The following examples relate to various non-exhaustive ways in which the teachings herein may be combined or applied. It should be understood that the following examples are not intended to restrict the coverage of any claims that may be presented at any time in this application or in subsequent filings of this application. No disclaimer is intended. The following examples are being provided for nothing more than merely illustrative purposes. It is contemplated that the various teachings herein may be arranged and applied in numerous other ways. It is also contemplated that some variations may omit certain features referred to in the below examples. Therefore, none of the aspects or features referred to below should be deemed critical unless otherwise explicitly indicated as such at a later date by the inventors or by a successor in interest to the inventors. If any claims are presented in this application or in subsequent filings related to this application that include additional features beyond those referred to below, those additional features shall not be presumed to have been added for any reason relating to patentability.

**[000116]** Example 1

**[000117]** A surgical instrument, comprising: (a) an end effector, including: (i) an ultrasonic blade, (ii) a clamp arm configured to move relative to the ultrasonic blade from an opened position toward a closed position, wherein the ultrasonic blade and the clamp arm are configured to receive tissue in the opened position, wherein the clamp arm is configured to clamp tissue against the ultrasonic blade in the closed position, (iii) a first electrode operably connected with the clamp arm, (iv) a second electrode associated with the ultrasonic blade, wherein the electrodes are operable to apply bipolar radiofrequency (RF)

energy to tissue captured in the end effector; (b) a clamp arm actuator operatively connected to the clamp arm and configured to selectively direct the clamp arm respectively from the opened position toward the closed position; (c) a first button operable to activate the ultrasonic blade to thereby provide a cutting and sealing mode at the end effector; and (d) a second button operable to activate the electrodes to thereby provide a spot coagulation mode at the end effector.

**[000118]** Example 2

**[000119]** The surgical instrument of Example 1, further comprising a shaft assembly projecting proximally from the end effector and including an acoustic waveguide operatively connected to the ultrasonic blade, wherein the acoustic waveguide is configured to connect to an ultrasonic transducer.

**[000120]** Example 3

**[000121]** The surgical instrument of Example 2, further comprising a body projecting proximally from the shaft assembly.

**[000122]** Example 4

**[000123]** The surgical instrument of Example 3, wherein the first and second buttons are located on the body.

**[000124]** Example 5

**[000125]** The surgical instrument of Example 3, wherein the first button is located on the body, wherein the first button transversely extends from the body toward the clamp arm actuator.

**[000126]** Example 6

**[000127]** The surgical instrument of any of Example 3 through Example 5, wherein the first button is configured to be actuated as the clamp arm actuator moves toward the body and engages against the first button.

**[000128]** Example 7

**[000129]** The surgical instrument of any of Example 3 through Example 6, wherein the clamp arm actuator has a proximal end, wherein the body has a proximal end, wherein the proximal end of the actuator is movable toward the proximal end of the body to thereby urge the clamp arm toward the closed position, wherein the first button is located at the proximal end of the body, wherein the first button is configured to be actuated by the proximal end of the clamp arm actuator.

**[000130]** Example 8

**[000131]** The surgical instrument of any of Example 1 through Example 7, wherein the second button is located distally relative to the first button.

**[000132]** Example 9

**[000133]** The surgical instrument of any of Example 1 through Example 8, wherein the clamp arm comprises a top pad and a bottom pad, wherein the bottom pad is located between the top pad and the ultrasonic blade.

**[000134]** Example 10

**[000135]** The surgical instrument of Example 9, wherein the top pad and the bottom pad are spaced apart within the clamp arm.

**[000136]** Example 11

**[000137]** The surgical instrument of any of Example 9 through Example 10, wherein the first electrode is included with the top pad.

**[000138]** Example 12

**[000139]** The surgical instrument of any of Example 9 through Example 11, further comprising a third electrode included with the bottom pad, wherein the third electrode has opposite polarity of the first electrode.

**[000140]** Example 13

**[000141]** The surgical instrument of Example 12, wherein the third electrode is a radio frequency (RF) electrode.

[000142] Example 14

[000143] The surgical instrument of any of Example 1 through Example 12, wherein the ultrasonic blade defines the second electrode.

[000144] Example 15

[000145] The surgical instrument of any of Example 1 through Example 11, wherein the clamp arm further comprises a third electrode positioned to proximally face the second electrode of the ultrasonic blade.

[000146] Example 16

[000147] The surgical instrument of any of Example 1 through Example 15, wherein the second button is on the body extending towards the clamp arm actuator.

[000148] Example 17

[000149] A surgical instrument, comprising: (a) an end effector, including: (i) an ultrasonic blade providing a first electrode, and (ii) a clamp arm configured to move relative to the ultrasonic blade from an opened position toward an intermediate position and a closed position, wherein the ultrasonic blade and the clamp arm are configured to receive tissue in the opened position, wherein the clamp arm is configured to clamp tissue against the ultrasonic blade in the closed position, wherein the clamp arm is offset from the ultrasonic blade to define a predetermined gap in the intermediate position between the opened position and the closed position, wherein the clamp arm includes a second electrode and a third electrode configured to be separately spaced to bias the clamp arm and the ultrasonic blade to the intermediate position, wherein the first and second electrodes have poles opposite of the third electrode, wherein the second electrode is positioned within the clamp arm actuator proximal to the ultrasonic blade relative to the third electrode; (b) a shaft assembly projecting proximally from the end effector and including an acoustic waveguide operatively connected to the ultrasonic blade, wherein the acoustic waveguide is configured to connect to an ultrasonic transducer; (c) a body projecting proximally from the shaft assembly; (d) a clamp arm actuator operatively connected to the clamp arm and configured to selectively move relative to the body from an opened configuration to a

closed configuration to thereby direct the clamp arm respectively from the opened position toward the intermediate position and the closed position; (e) a first button operable to activate the first, second and third electrodes; and (f) a second button configured to deactivate the first, second and third electrodes when the clamp arm actuator is in the closed configuration.

**[000150]** Example 18

**[000151]** A method of performing coagulation using a surgical instrument, the method comprising: (a) delivering an ultrasonic energy to an end effector at a first ultrasonic intensity; (b) delivering a radiofrequency (RF) energy to the end effector at a first RF intensity; (c) detecting a contact of the end effector with a tissue; and (d) in response to detecting the contact of the end effector with the tissue, changing one or both of the first ultrasonic intensity to a second ultrasonic intensity or the first RF intensity to a second RF intensity.

**[000152]** Example 19

**[000153]** The method of Example 18, further comprising: (a) detecting a release of the end effector from the tissue; and (b) upon detecting the release of the end effector from the tissue, changing one or both of the second ultrasonic intensity to the first ultrasonic intensity or the second RF intensity to the first RF intensity.

**[000154]** Example 20

**[000155]** The method of any of Example 18 through Example 19, wherein the act of detecting a contact of the end effector with a tissue comprises comparing a threshold impedance value for an RF pulse with an observed impedance value for the RF pulse, wherein the contact of the end effector with the tissue exists when the observed impedance value for the RF pulse is below the threshold impedance value for the RF pulse.

**[000156]** Example 21

**[000157]** The method of Example 20, wherein the threshold impedance value is set to 4000 ohms.

**[000158]** VI. Miscellaneous

**[000159]** While various examples herein describe two or more modular components being releasably coupled together, it should be understood that some variations may eliminate such modularity and releasable couplings. For instance, some versions of instrument (10) may provide first modular assembly (100) and second modular assembly (200) as a single combined unit that does not permit second modular assembly (200) to be removed from first modular assembly (100). In some such versions, coupling member (300) would either be omitted (with some other feature being used to provide permanent coupling between first modular assembly (100) and second modular assembly (200)); or coupling member (300) may be modified such that coupling member (300) may not be manipulated to decouple second modular assembly (200) from first modular assembly (100). Similarly, some versions of instrument (301) may prevent clamp arm assembly (400) from being removed from shaft assembly (330). For instance, latch member (412) may be omitted and clamp arm assembly (400) may be permanently coupled with shaft assembly (330).

**[000160]** It should be understood that the various teachings herein may be readily combined with the various teachings of U.S. Pub. No. 2017/0105754, entitled “Surgical Instrument with Dual Mode End Effector and Side-Loaded Clamp Arm Assembly,” published on April 20, 2017, the disclosure of which is incorporated by reference herein. Various suitable ways in which the teachings herein may be combined with the teachings of U.S. Pub. No. 2017/0105754 will be apparent to those of ordinary skill in the art.

**[000161]** It should be understood that the various teachings herein may be readily combined with the various teachings of U.S. Pub. No. 2017/0105755, entitled “Surgical Instrument with Dual Mode End Effector and Compound Lever with Detents,” published April 20, 2017, the disclosure of which is incorporated by reference herein. Various suitable ways in which the teachings herein may be combined with the teachings of U.S. Pub. No. 2017/0105755 will be apparent to those of ordinary skill in the art.

**[000162]** It should be understood that the various teachings herein may be readily combined with the various teachings of U.S. Pub. No. 2017/0105788, entitled “Surgical Instrument with Dual Mode End Effector and Modular Clamp Arm Assembly,” published April 20,

2017, the disclosure of which is incorporated by reference herein. Various suitable ways in which the teachings herein may be combined with the teachings of U.S. Pub. No. 2017/0105788 will be apparent to those of ordinary skill in the art.

**[000163]** The various instruments described above may be used in a variety of kinds of surgical procedures. By way of example only, the instruments described above may be used to perform liver resection, colorectal surgical procedures, gynecological surgical procedures, and/or various other kinds of surgical procedures. Various other kinds of procedures and ways in which the instruments described above may be used will be apparent to those of ordinary skill in the art in view of the teachings herein.

**[000164]** It should be understood that any of the versions of instruments described herein may include various other features in addition to or in lieu of those described above. By way of example only, any of the instruments described herein may also include one or more of the various features disclosed in any of the various references that are incorporated by reference herein. It should also be understood that the teachings herein may be readily applied to any of the instruments described in any of the other references cited herein, such that the teachings herein may be readily combined with the teachings of any of the references cited herein in numerous ways. Other types of instruments into which the teachings herein may be incorporated will be apparent to those of ordinary skill in the art.

**[000165]** In addition to the foregoing, the teachings herein may be readily combined with the teachings of U.S. Pat. App. No. [ATTORNEY DOCKET NO. END8130USNP.0652942], entitled "Surgical Instrument with Removable Clamp Arm Assembly," filed on even date herewith, the disclosure of which is incorporated by reference herein. Various suitable ways in which the teachings herein may be combined with the teachings of U.S. Pat. App. No. [ATTORNEY DOCKET NO. END8130USNP.0652942] will be apparent to those of ordinary skill in the art in view of the teachings herein.

**[000166]** In addition to the foregoing, the teachings herein may be readily combined with the teachings of U.S. Pat. App. No. [ATTORNEY DOCKET NO. END8130USNP1.0652944], entitled "Surgical Instrument with Removable End Effector Components," filed on even date herewith, the disclosure of which is incorporated by reference herein. Various suitable

ways in which the teachings herein may be combined with the teachings of U.S. Pat. App. No. [ATTORNEY DOCKET NO. END8130USNP1.0652944] will be apparent to those of ordinary skill in the art in view of the teachings herein.

**[000167]** In addition to the foregoing, the teachings herein may be readily combined with the teachings of U.S. Pat. App. No. [ATTORNEY DOCKET NO. END8130USNP2.0652948], entitled “Surgical Instrument with Selectively Actuated Gap-Setting Features for End Effector,” filed on even date herewith, the disclosure of which is incorporated by reference herein. Various suitable ways in which the teachings herein may be combined with the teachings of U.S. Pat. App. No. [ATTORNEY DOCKET NO. END8130USNP2.0652948] will be apparent to those of ordinary skill in the art in view of the teachings herein.

**[000168]** In addition to the foregoing, the teachings herein may be readily combined with the teachings of U.S. Pat. App. No. [ATTORNEY DOCKET NO. END8130USNP4.0652946], entitled “Surgical Instrument with Removable Portion to Facilitate Cleaning,” filed on even date herewith, the disclosure of which is incorporated by reference herein. Various suitable ways in which the teachings herein may be combined with the teachings of U.S. Pat. App. No. [ATTORNEY DOCKET NO. END8130USNP4.0652946] will be apparent to those of ordinary skill in the art in view of the teachings herein.

**[000169]** It should also be understood that any ranges of values referred to herein should be read to include the upper and lower boundaries of such ranges. For instance, a range expressed as ranging “between approximately 1.0 inches and approximately 1.5 inches” should be read to include approximately 1.0 inches and approximately 1.5 inches, in addition to including the values between those upper and lower boundaries.

**[000170]** It should be appreciated that any patent, publication, or other disclosure material, in whole or in part, that is said to be incorporated by reference herein is incorporated herein only to the extent that the incorporated material does not conflict with existing definitions, statements, or other disclosure material set forth in this disclosure. As such, and to the extent necessary, the disclosure as explicitly set forth herein supersedes any conflicting material incorporated herein by reference. Any material, or portion thereof, that is said to be incorporated by reference herein, but which conflicts with existing definitions,

statements, or other disclosure material set forth herein will only be incorporated to the extent that no conflict arises between that incorporated material and the existing disclosure material.

**[000171]** Versions of the devices described above may have application in conventional medical treatments and procedures conducted by a medical professional, as well as application in robotic-assisted medical treatments and procedures. By way of example only, various teachings herein may be readily incorporated into a robotic surgical system such as the DAVINCI™ system by Intuitive Surgical, Inc., of Sunnyvale, California. Similarly, those of ordinary skill in the art will recognize that various teachings herein may be readily combined with various teachings of U.S. Pat. No. 6,783,524, entitled “Robotic Surgical Tool with Ultrasound Cauterizing and Cutting Instrument,” published August 31, 2004, the disclosure of which is incorporated by reference herein.

**[000172]** Versions described above may be designed to be disposed of after a single use, or they can be designed to be used multiple times. Versions may, in either or both cases, be reconditioned for reuse after at least one use. Reconditioning may include any combination of the steps of disassembly of the device, followed by cleaning or replacement of particular pieces, and subsequent reassembly. In particular, some versions of the device may be disassembled, and any number of the particular pieces or parts of the device may be selectively replaced or removed in any combination. Upon cleaning and/or replacement of particular parts, some versions of the device may be reassembled for subsequent use either at a reconditioning facility, or by an operator immediately prior to a procedure. Those skilled in the art will appreciate that reconditioning of a device may utilize a variety of techniques for disassembly, cleaning/replacement, and reassembly. Use of such techniques, and the resulting reconditioned device, are all within the scope of the present application.

**[000173]** By way of example only, versions described herein may be sterilized before and/or after a procedure. In one sterilization technique, the device is placed in a closed and sealed container, such as a plastic or TYVEK bag. The container and device may then be placed in a field of radiation that can penetrate the container, such as gamma radiation, x-rays, or high-energy electrons. The radiation may kill bacteria on the device and in the container.

The sterilized device may then be stored in the sterile container for later use. A device may also be sterilized using any other technique known in the art, including but not limited to beta or gamma radiation, ethylene oxide, or steam.

**[000174]** Having shown and described various embodiments of the present invention, further adaptations of the methods and systems described herein may be accomplished by appropriate modifications by one of ordinary skill in the art without departing from the scope of the present invention. Several of such potential modifications have been mentioned, and others will be apparent to those skilled in the art. For instance, the examples, embodiments, geometrics, materials, dimensions, ratios, steps, and the like discussed above are illustrative and are not required. Accordingly, the scope of the present invention should be considered in terms of the following claims and is understood not to be limited to the details of structure and operation shown and described in the specification and drawings.

I/We claim:

1. A surgical instrument, comprising:
  - (a) an end effector, including:
    - (i) an ultrasonic blade,
    - (ii) a clamp arm configured to move relative to the ultrasonic blade from an opened position toward a closed position, wherein the ultrasonic blade and the clamp arm are configured to receive tissue in the opened position, wherein the clamp arm is configured to clamp tissue against the ultrasonic blade in the closed position,
      - (iii) a first electrode operably connected with the clamp arm, and
      - (iv) a second electrode associated with the ultrasonic blade, wherein the electrodes are operable to apply bipolar radiofrequency (RF) energy to tissue captured in the end effector;
    - (b) a clamp arm actuator operatively connected to the clamp arm and configured to selectively direct the clamp arm respectively from the opened position toward the closed position;
    - (c) a first button operable to activate the ultrasonic blade to thereby provide a cutting and sealing mode at the end effector; and
    - (d) a second button operable to activate the electrodes to thereby provide a spot coagulation mode at the end effector.
  2. The surgical instrument of claim 1, further comprising a shaft assembly projecting proximally from the end effector and including an acoustic waveguide operatively connected to the ultrasonic blade, wherein the acoustic waveguide is configured to connect to an ultrasonic transducer.
  3. The surgical instrument of claim 2, further comprising a body projecting proximally from the shaft assembly.
  4. The surgical instrument of claim 3, wherein the first and second buttons are

located on the body.

5. The surgical instrument of claim 3, wherein the first button is located on the body, wherein the first button transversely extends from the body toward the clamp arm actuator.

6. The surgical instrument of claim 5, wherein the first button is configured to be actuated as the clamp arm actuator moves toward the body and engages against the first button.

7. The surgical instrument of claim 6, wherein the clamp arm actuator has a proximal end, wherein the body has a proximal end, wherein the proximal end of the actuator is movable toward the proximal end of the body to thereby urge the clamp arm toward the closed position, wherein the first button is located at the proximal end of the body, wherein the first button is configured to be actuated by the proximal end of the clamp arm actuator.

8. The surgical instrument of claim 3, wherein the second button is located distally relative to the first button.

9. The surgical instrument of claim 1, wherein the clamp arm comprises a top pad and a bottom pad, wherein the bottom pad is located between the top pad and the ultrasonic blade.

10. The surgical instrument of claim 9, wherein the top pad and the bottom pad are spaced apart within the clamp arm.

11. The surgical instrument of claim 10, wherein the first electrode is included with the top pad.

12. The surgical instrument of claim 11, further comprising a third electrode included with the bottom pad, wherein the third electrode has opposite polarity of the first electrode.

13. The surgical instrument of claim 12, wherein the third electrode is a radio

frequency (RF) electrode.

14. The surgical instrument of claim 1, wherein the ultrasonic blade defines the second electrode.

15. The surgical instrument of claim 1, the clamp arm further comprising a third electrode positioned to proximally face the second electrode of the ultrasonic blade.

16. A surgical instrument, comprising:

(a) an end effector, including:

(i) an ultrasonic blade providing a first electrode, and

(ii) a clamp arm configured to move relative to the ultrasonic blade

from an opened position toward an intermediate position and a closed position, wherein the ultrasonic blade and the clamp arm are configured to receive tissue in the opened position, wherein the clamp arm is configured to clamp tissue against the ultrasonic blade in the closed position, wherein the clamp arm is offset from the ultrasonic blade to define a predetermined gap in the intermediate position between the opened position and the closed position, wherein the clamp arm includes a second electrode and a third electrode configured to be separately spaced to bias the clamp arm and the ultrasonic blade to the intermediate position, wherein the first and second electrodes have poles opposite of the third electrode, wherein the second electrode is positioned within the clamp arm actuator proximal to the ultrasonic blade relative to the third electrode;

(b) a shaft assembly projecting proximally from the end effector and including an acoustic waveguide operatively connected to the ultrasonic blade, wherein the acoustic waveguide is configured to connect to an ultrasonic transducer;

(c) a body projecting proximally from the shaft assembly;

(d) a clamp arm actuator operatively connected to the clamp arm and configured to selectively move relative to the body from an opened configuration to a closed configuration to thereby direct the clamp arm respectively from the opened position toward the intermediate position and the closed position;

- (e) a first button operable to activate the first, second and third electrodes; and
- (f) a second button configured to deactivate the first, second and third electrodes when the clamp arm actuator is in the closed configuration.

17. A method of performing coagulation using a surgical instrument, the method comprising:

- (a) delivering an ultrasonic energy to an end effector at a first ultrasonic intensity;
- (b) delivering a radiofrequency (RF) energy to the end effector at a first RF intensity;
- (c) detecting a contact of the end effector with a tissue; and
- (d) in response to detecting the contact of the end effector with the tissue, changing one or both of the first ultrasonic intensity to a second ultrasonic intensity or the first RF intensity to a second RF intensity.

18. The method of claim 17, further comprising:

- (a) detecting a release of the end effector from the tissue; and
- (b) upon detecting the release of the end effector from the tissue, changing one or both of the second ultrasonic intensity to the first ultrasonic intensity or the second RF intensity to the first RF intensity.

19. The method of claim 18, wherein the act of detecting a contact of the end effector with a tissue comprises comparing a threshold impedance value for an RF pulse with an observed impedance value for the RF pulse, wherein the contact of the end effector with the tissue exists when the observed impedance value for the RF pulse is below the threshold impedance value for the RF pulse.

20. The method of claim 19, wherein the threshold impedance value is set to 4000 ohms.

1/35

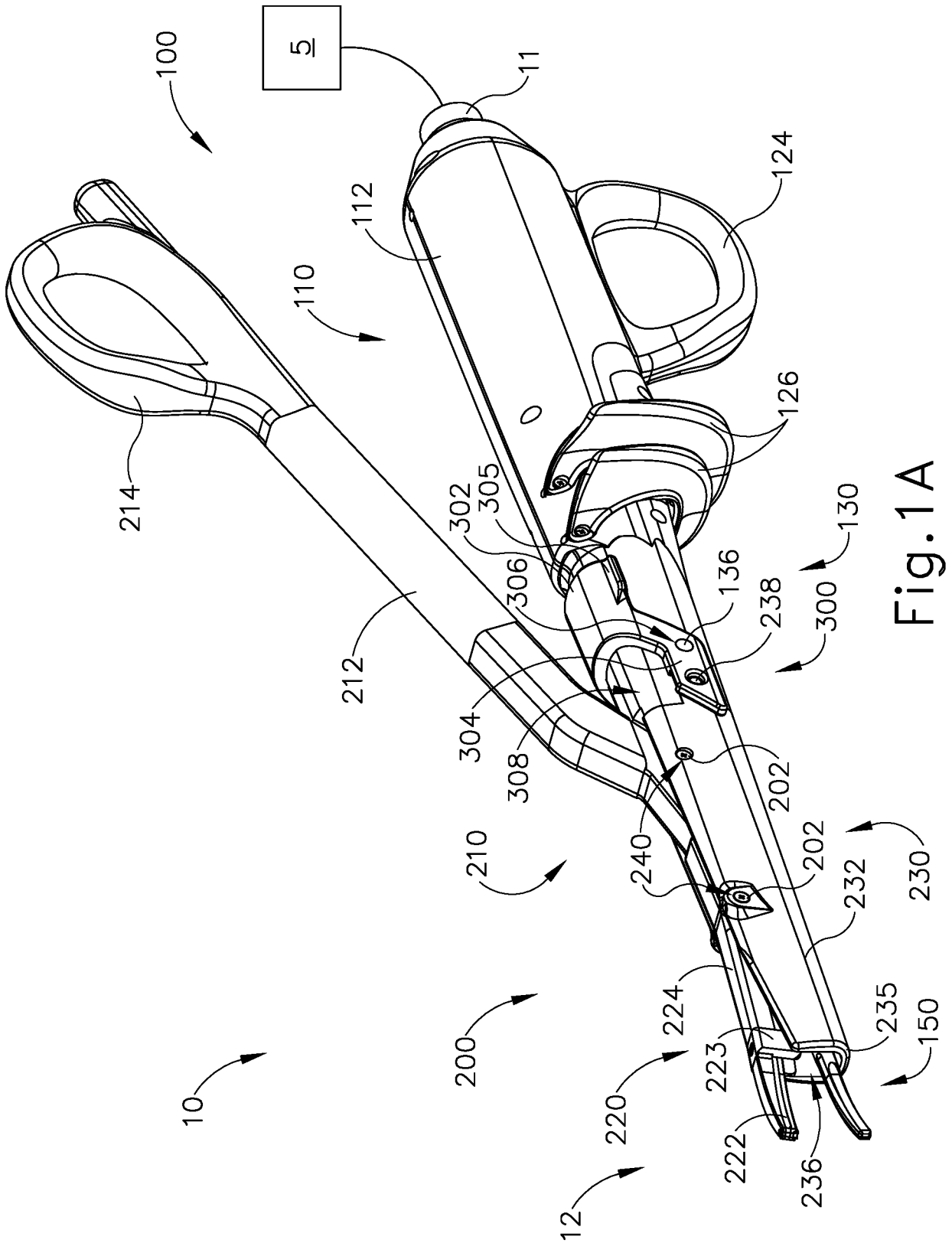

Fig. 1A

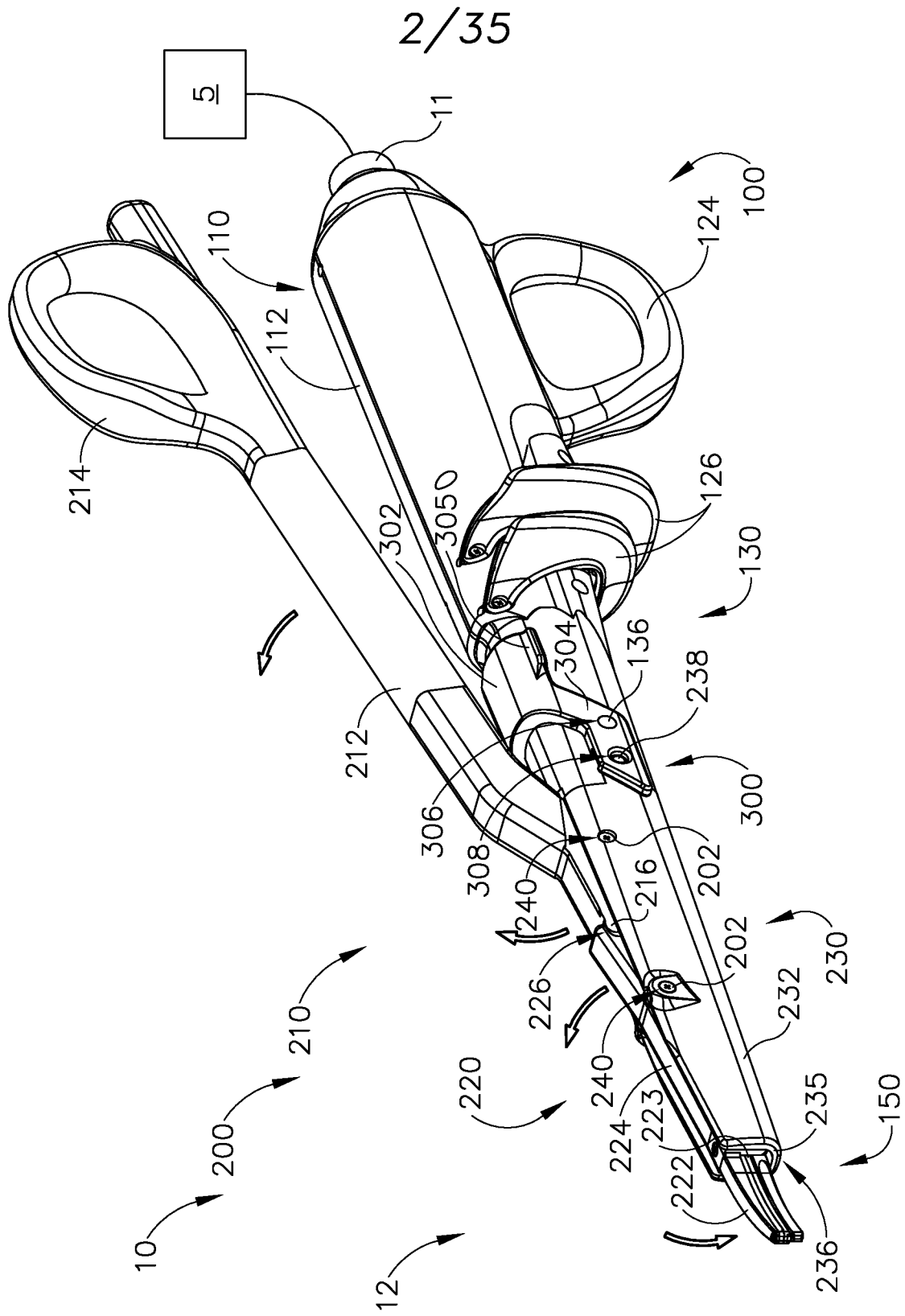

Fig.1B

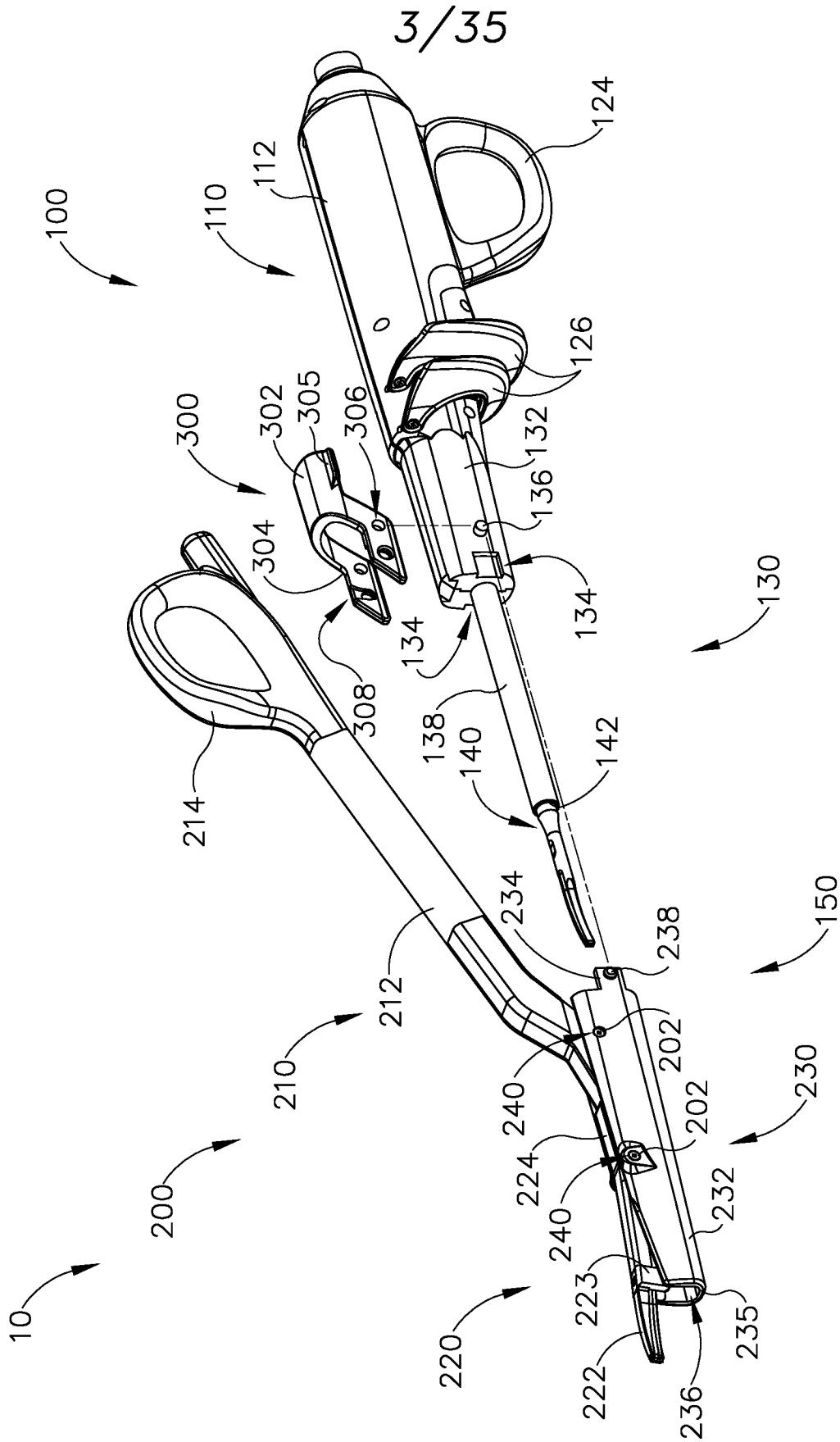

Fig. 2

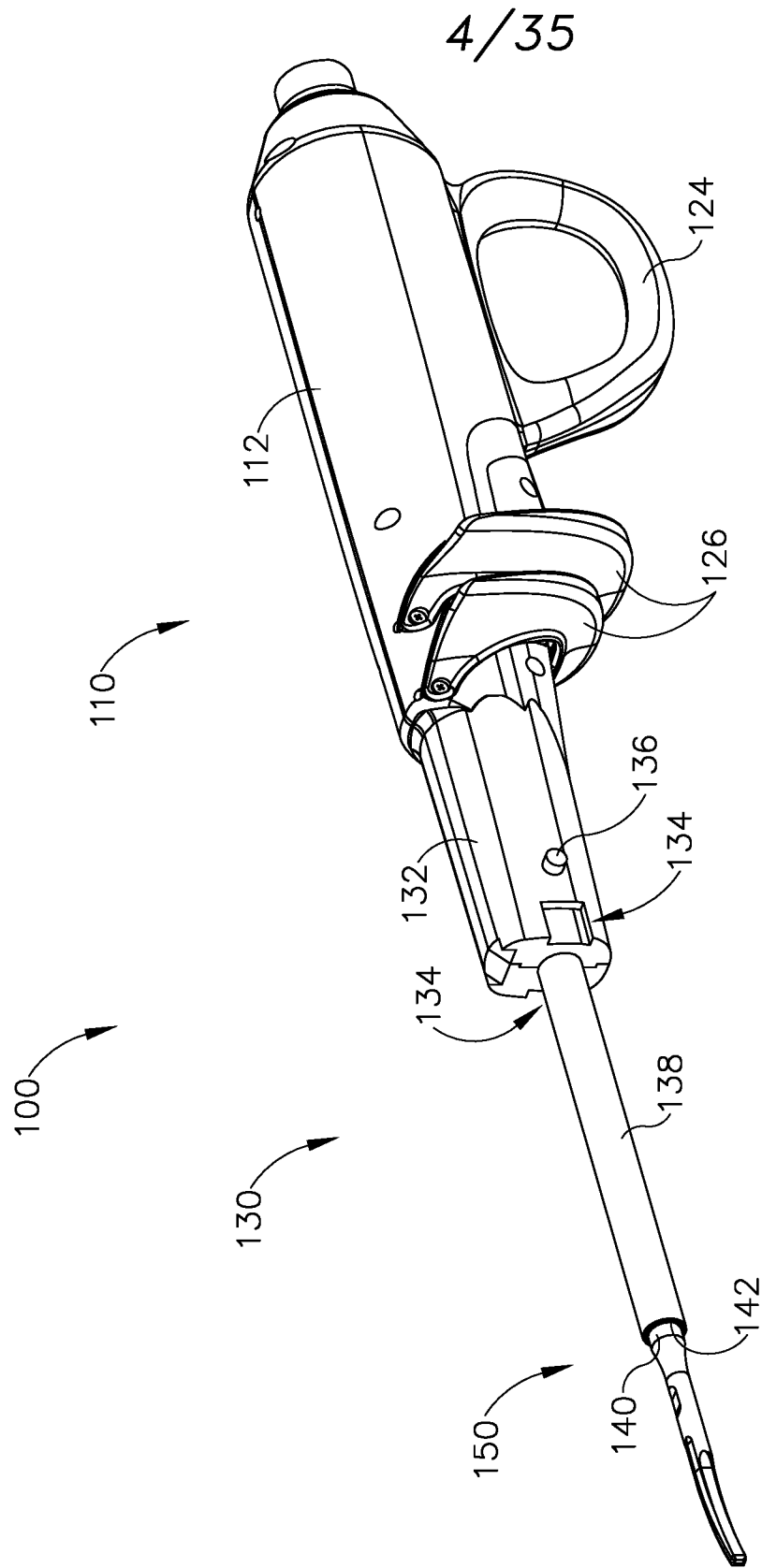

Fig. 3

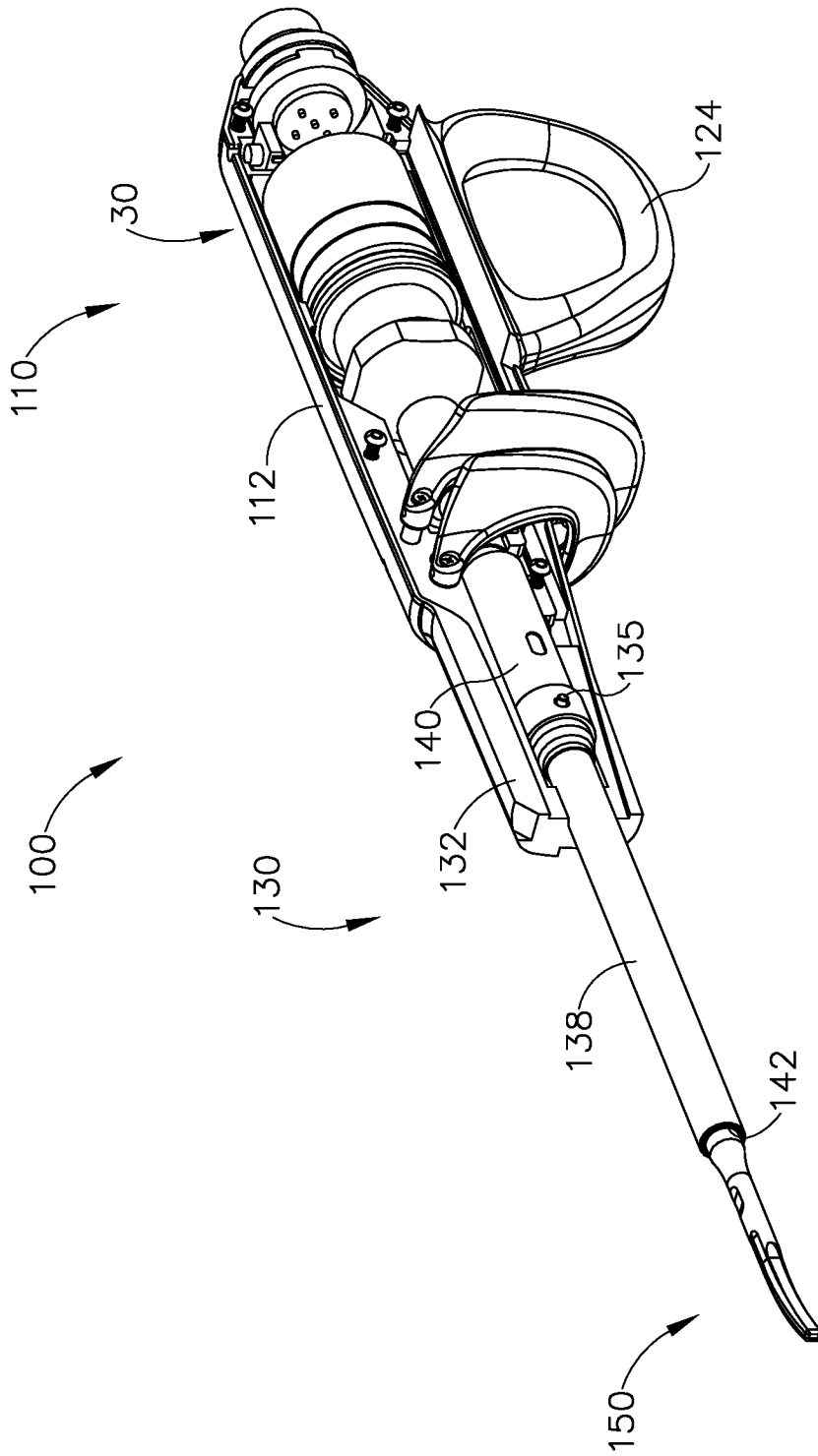

Fig. 4

6/35

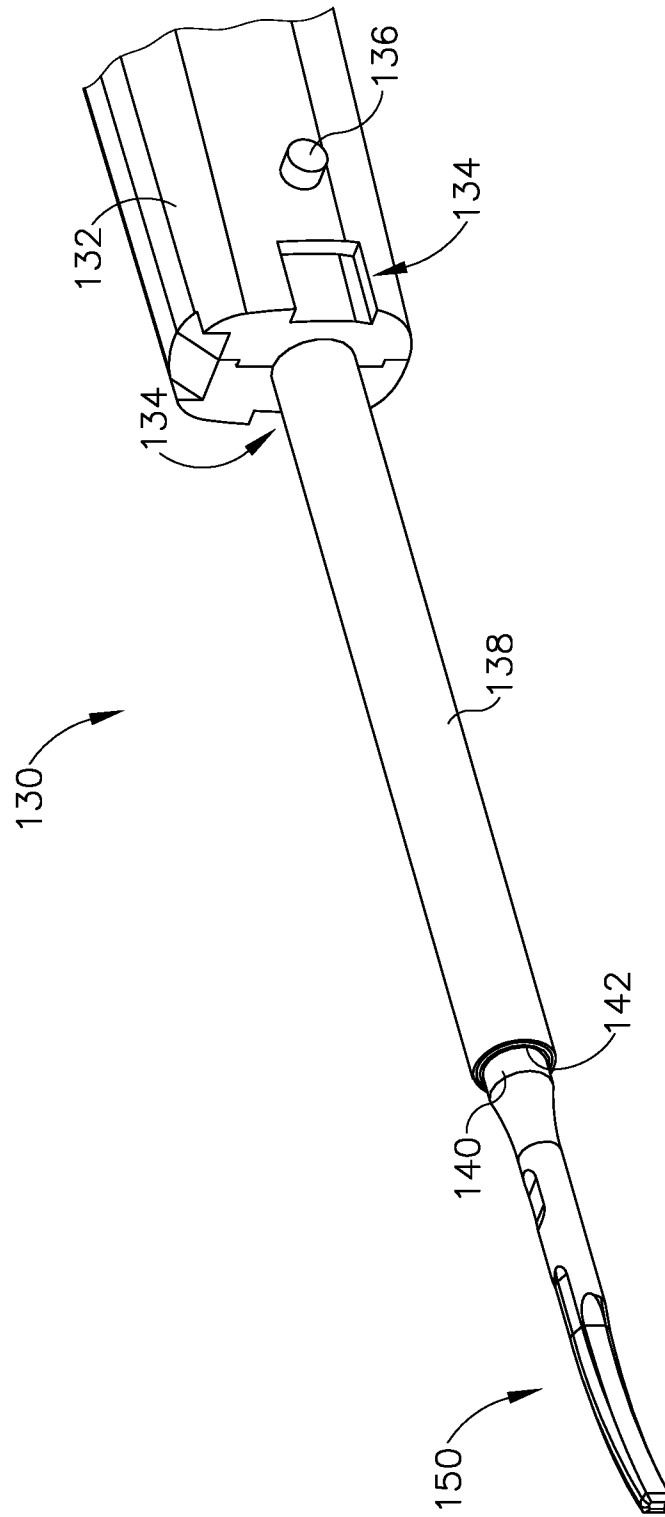

Fig.5

7/35

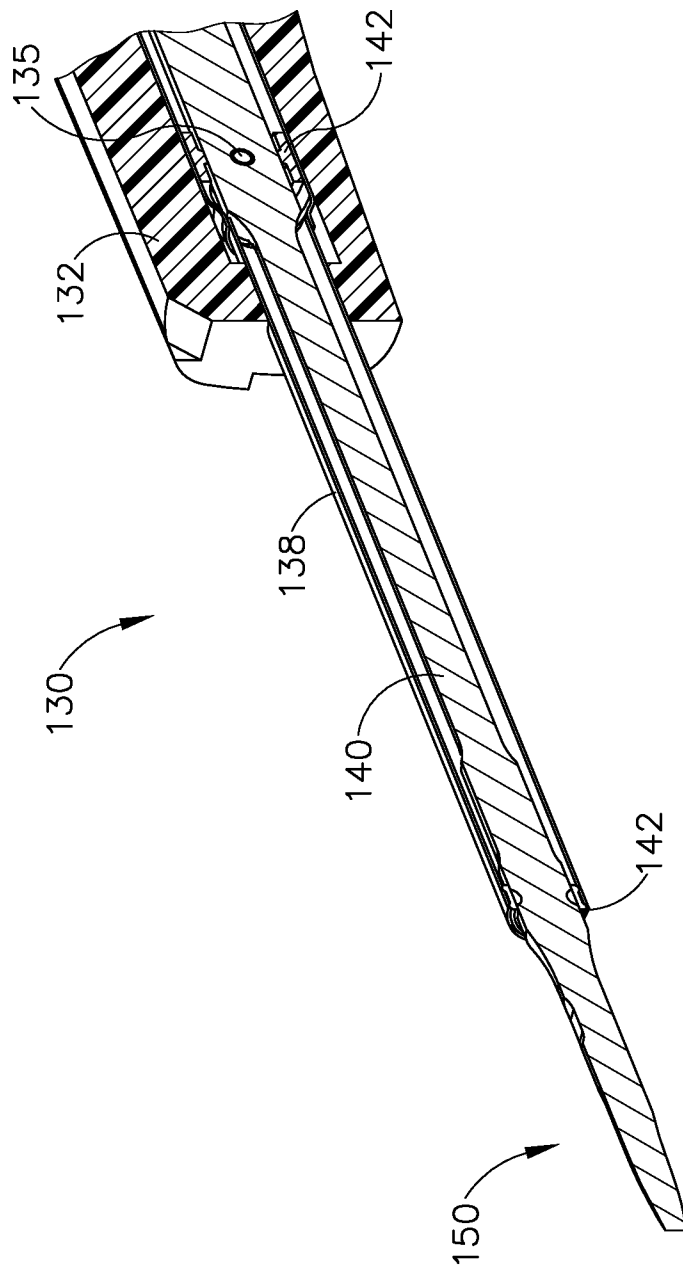

Fig. 6

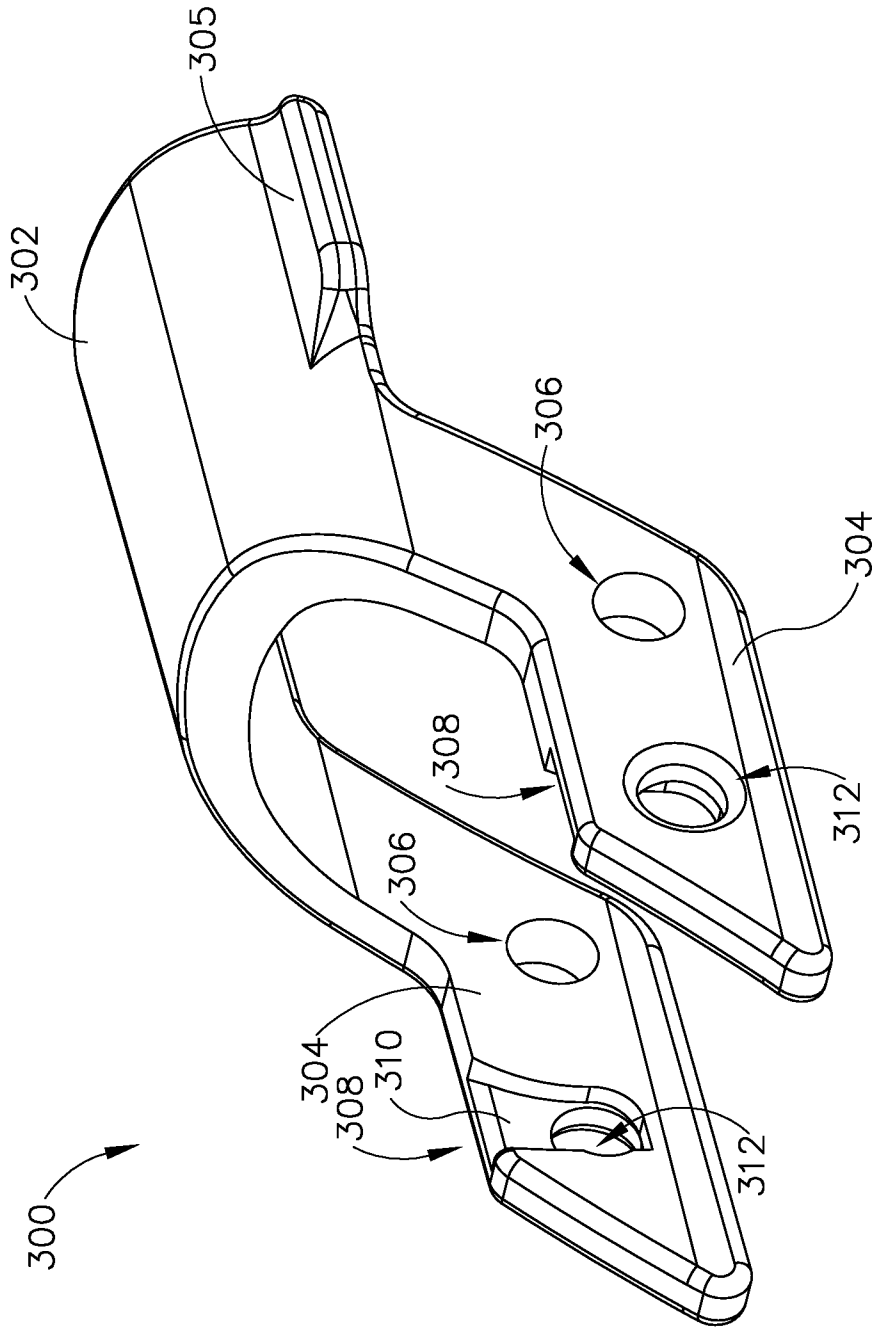

Fig.7

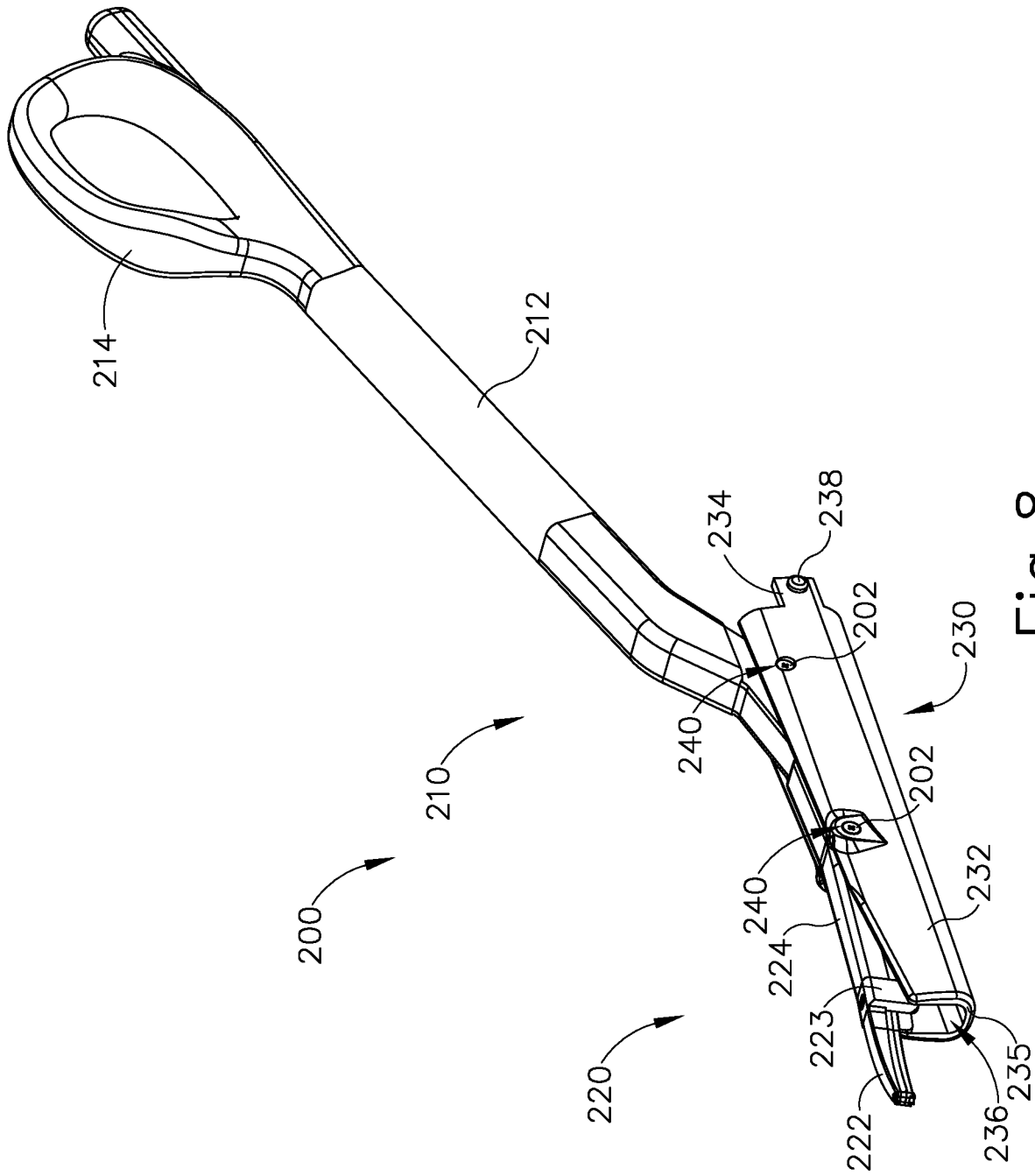

Fig. 8



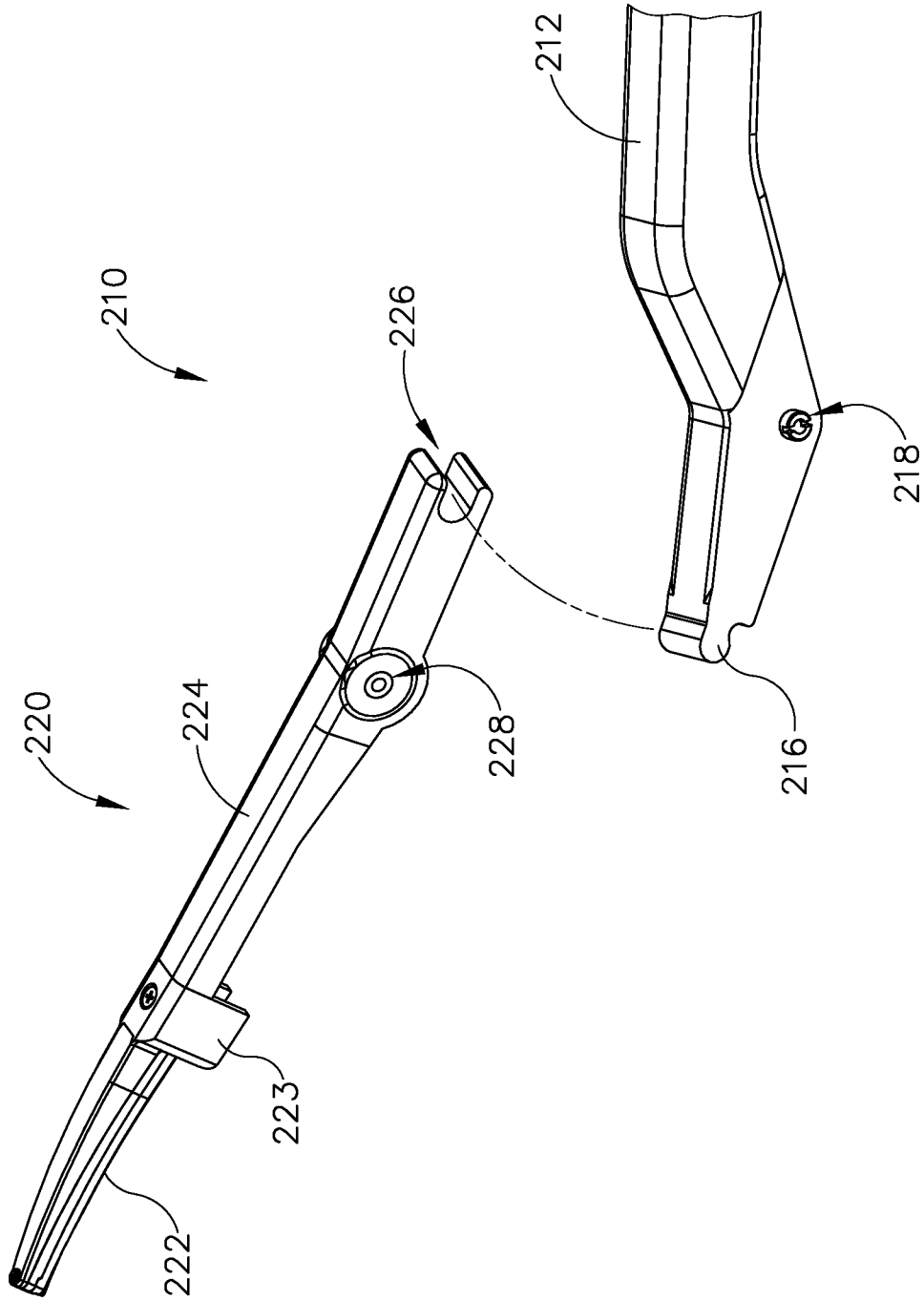

Fig. 10

12/35

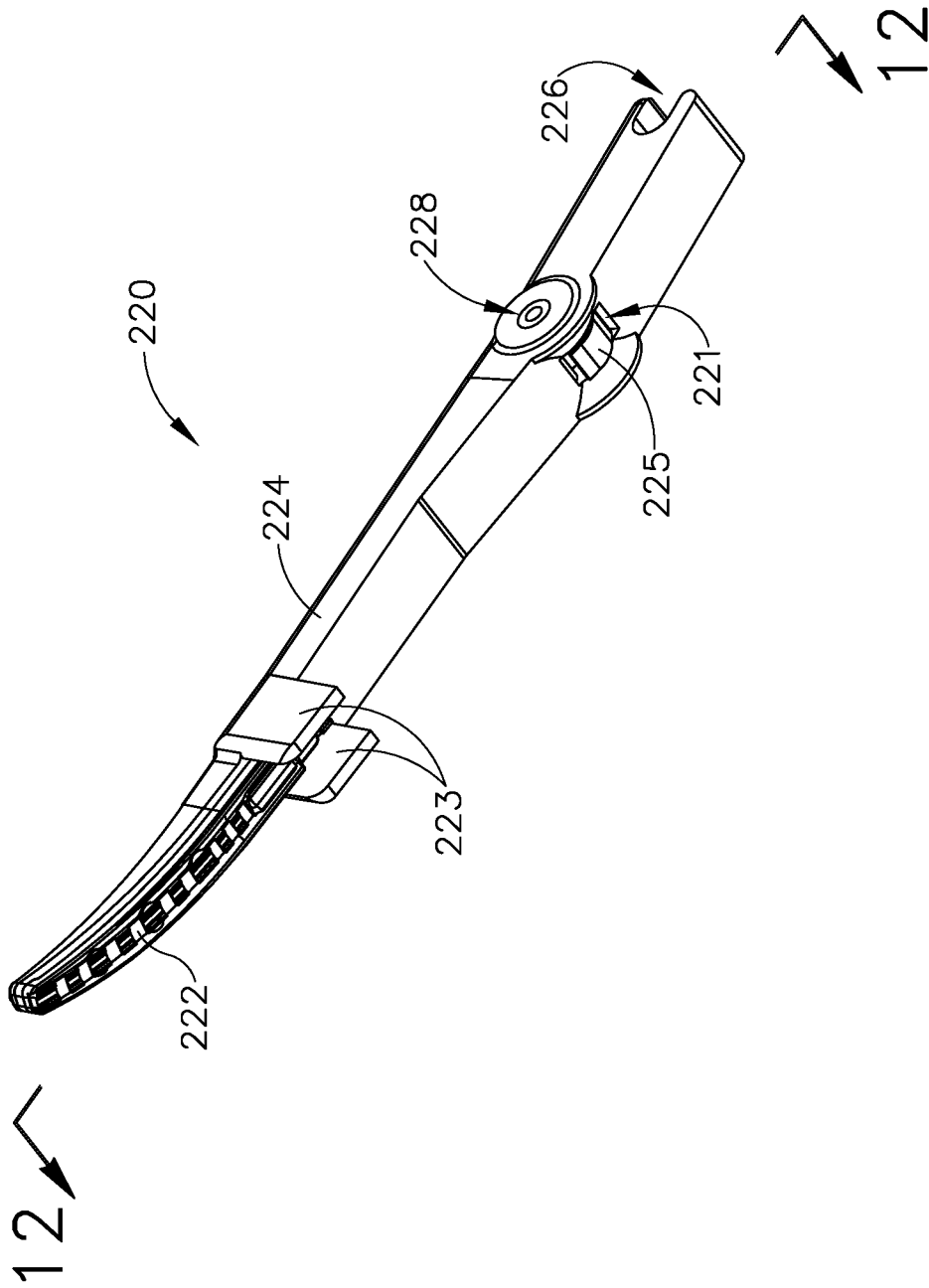

Fig. 11

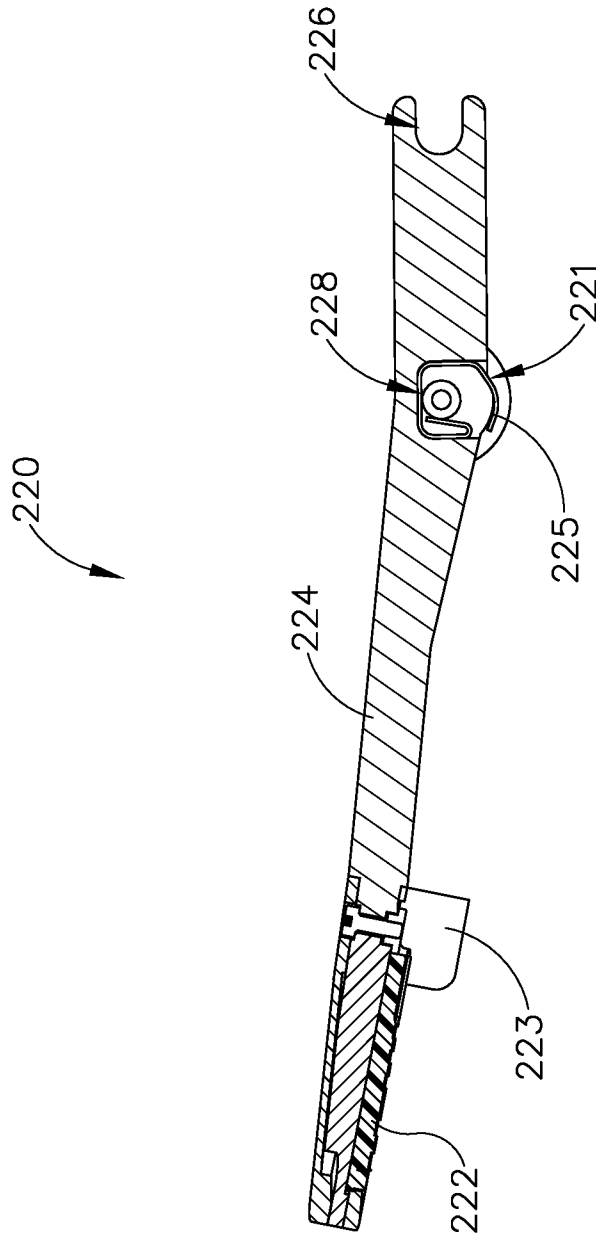

Fig.12

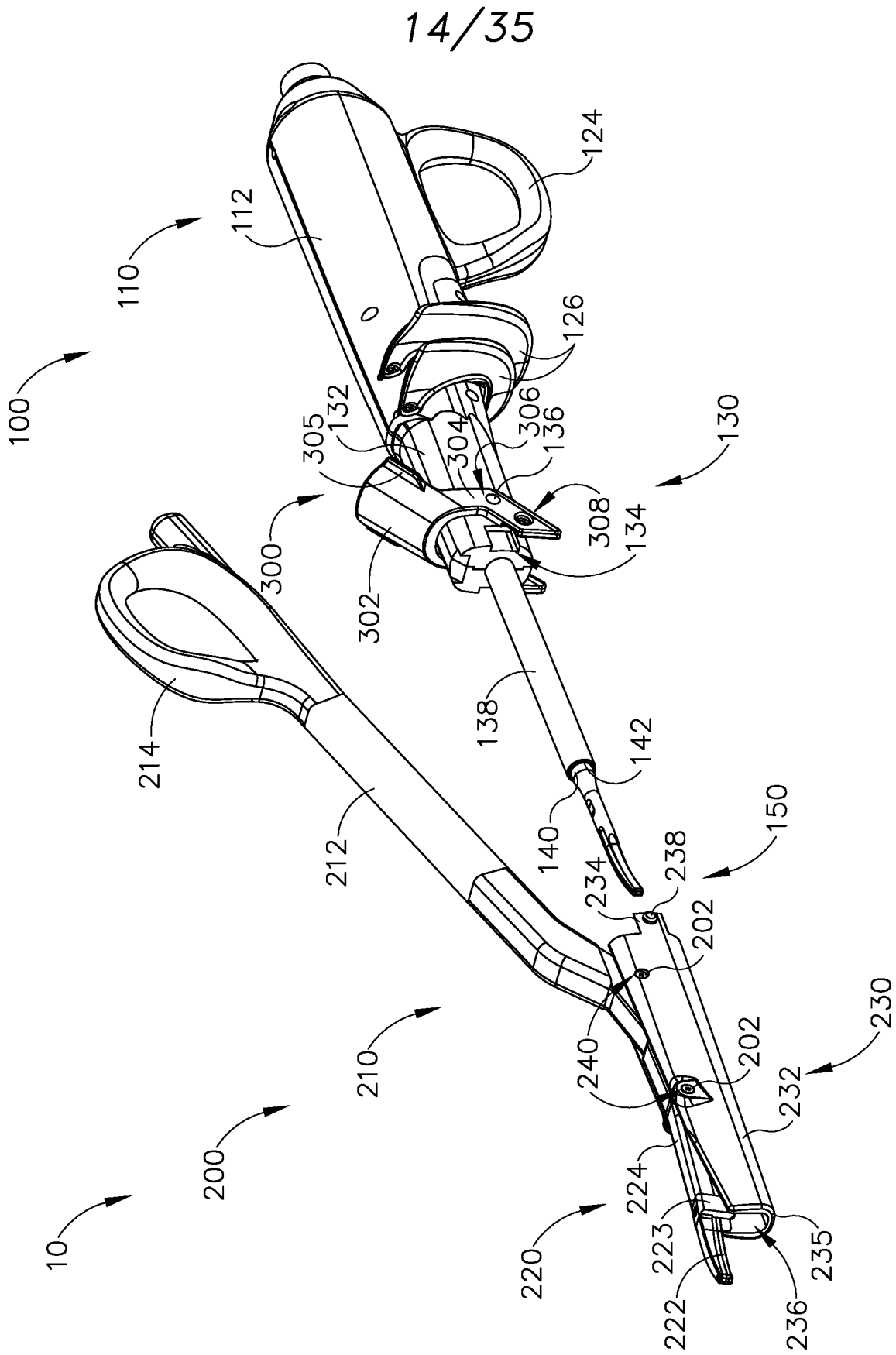

Fig. 13A

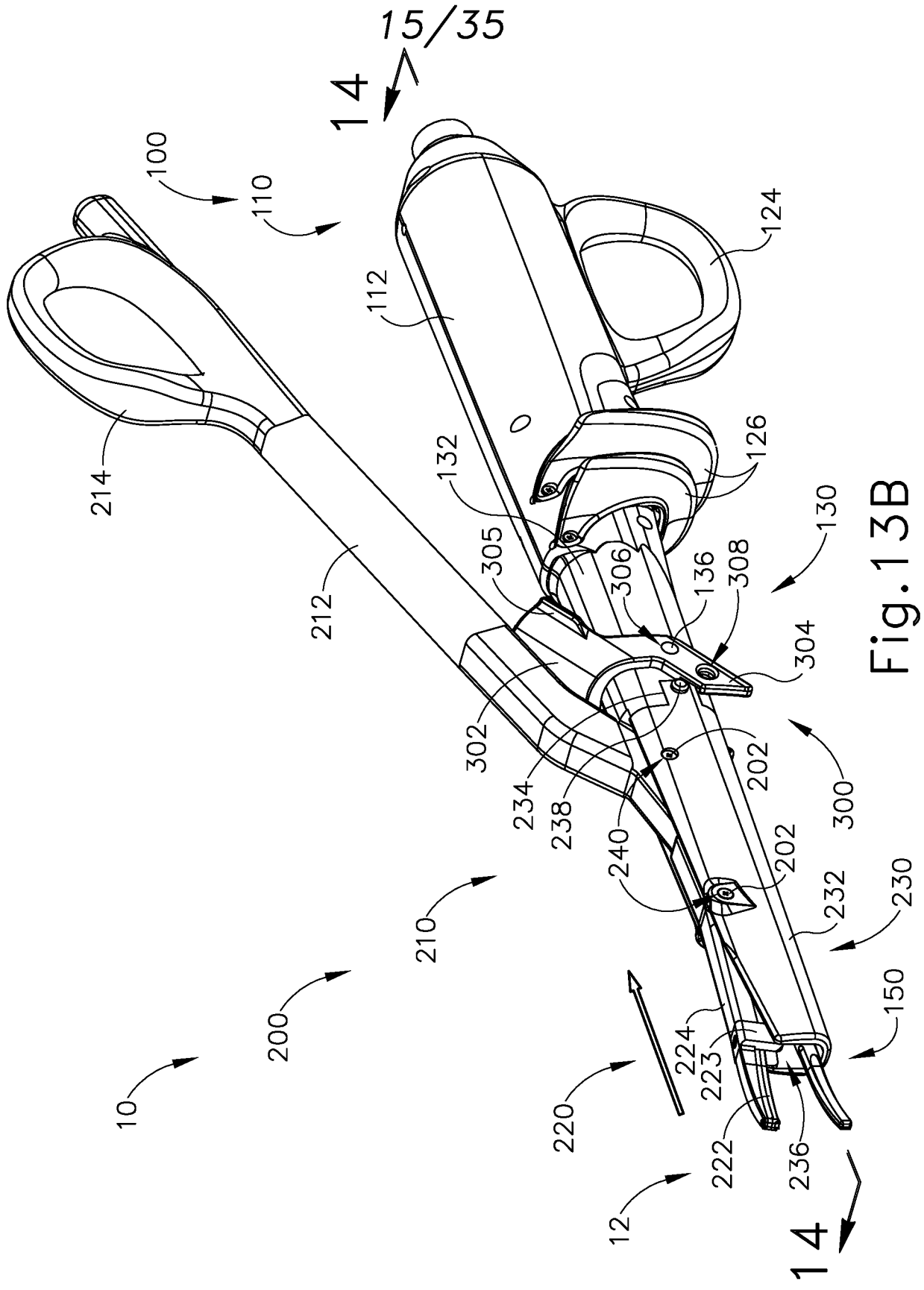

Fig. 13B

16/35

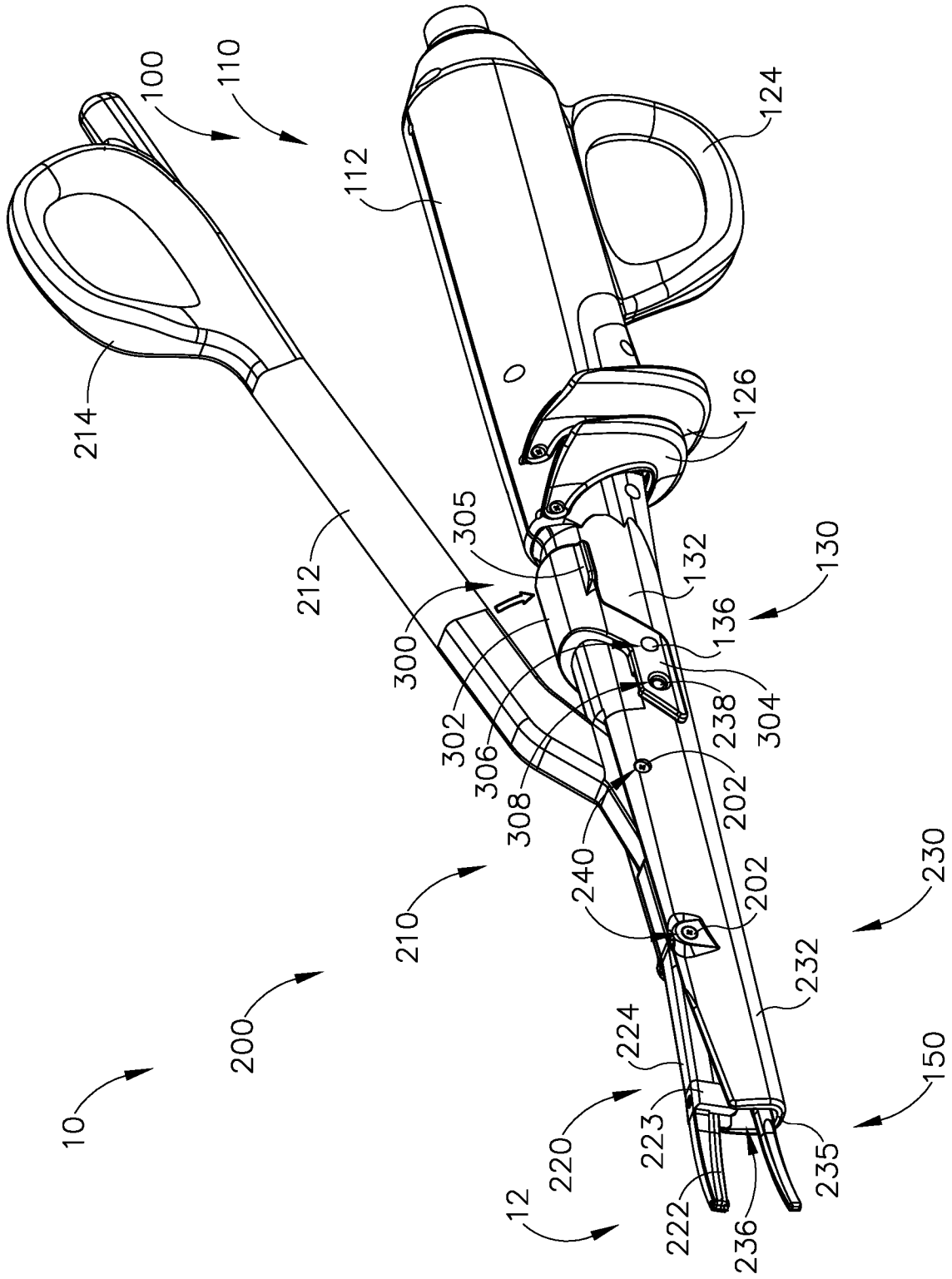

Fig. 13C



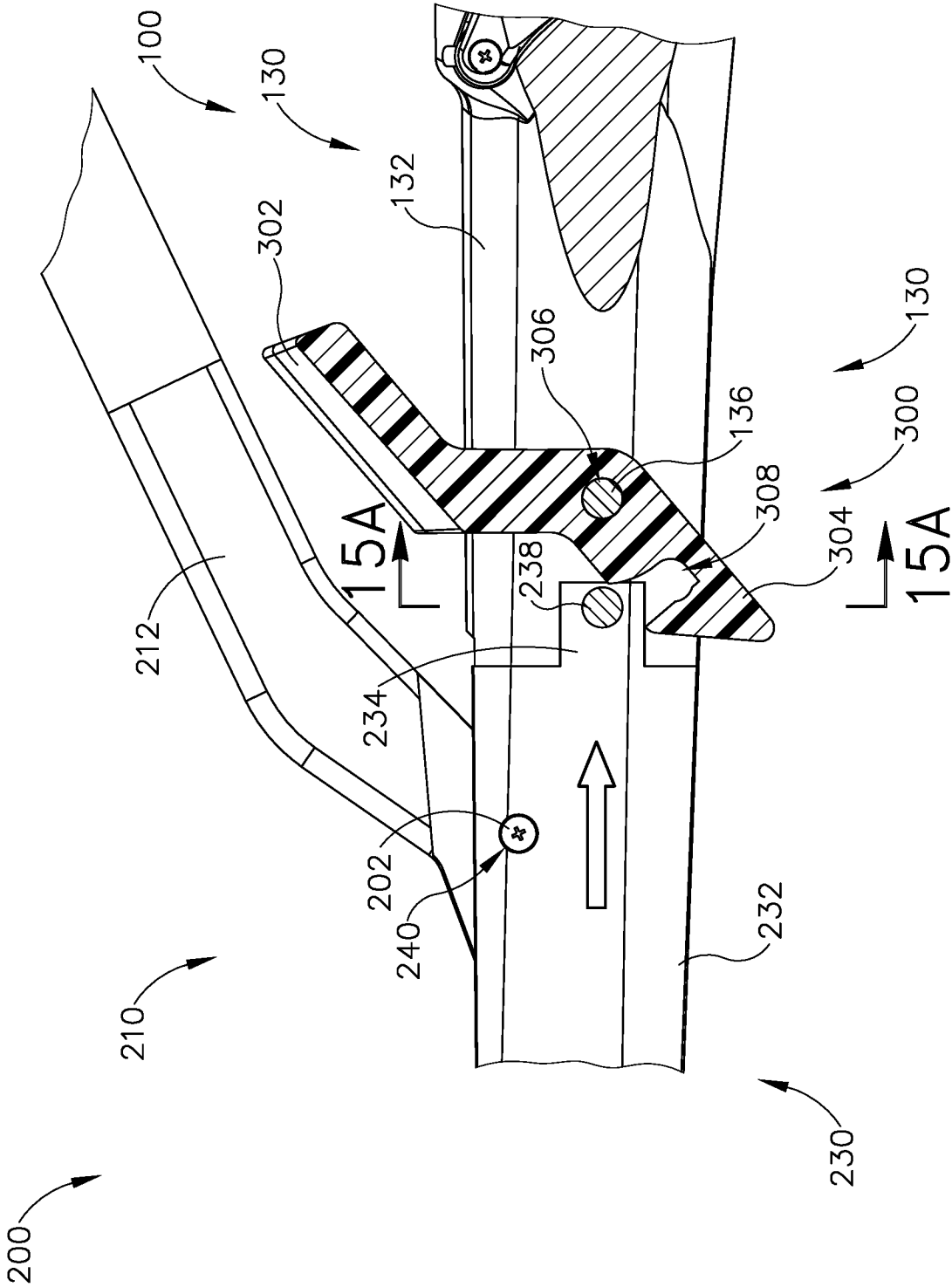

Fig. 14B





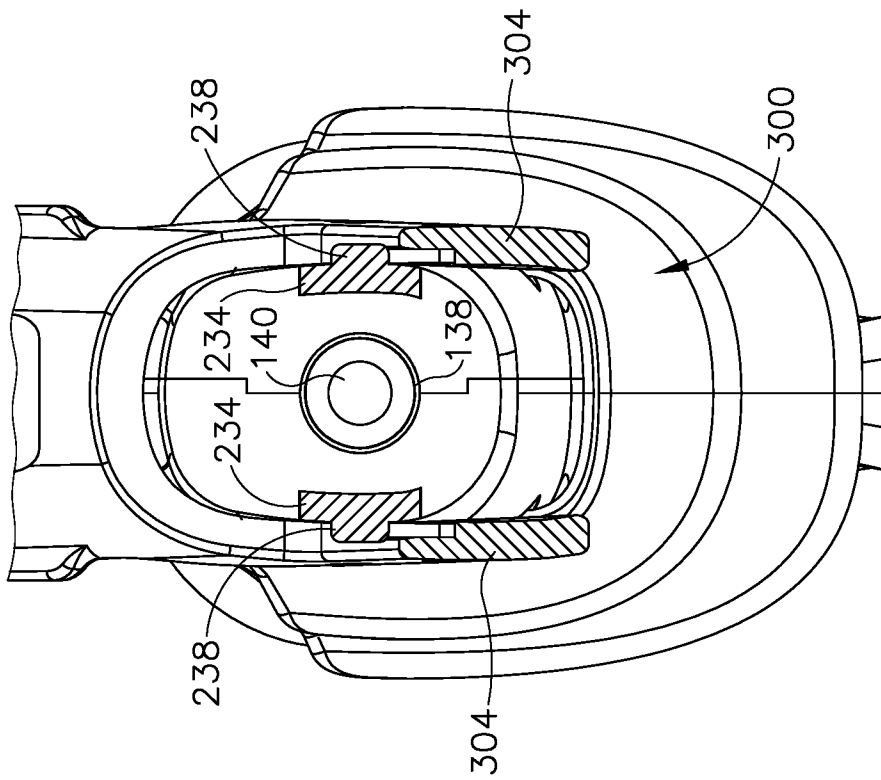

Fig. 15A

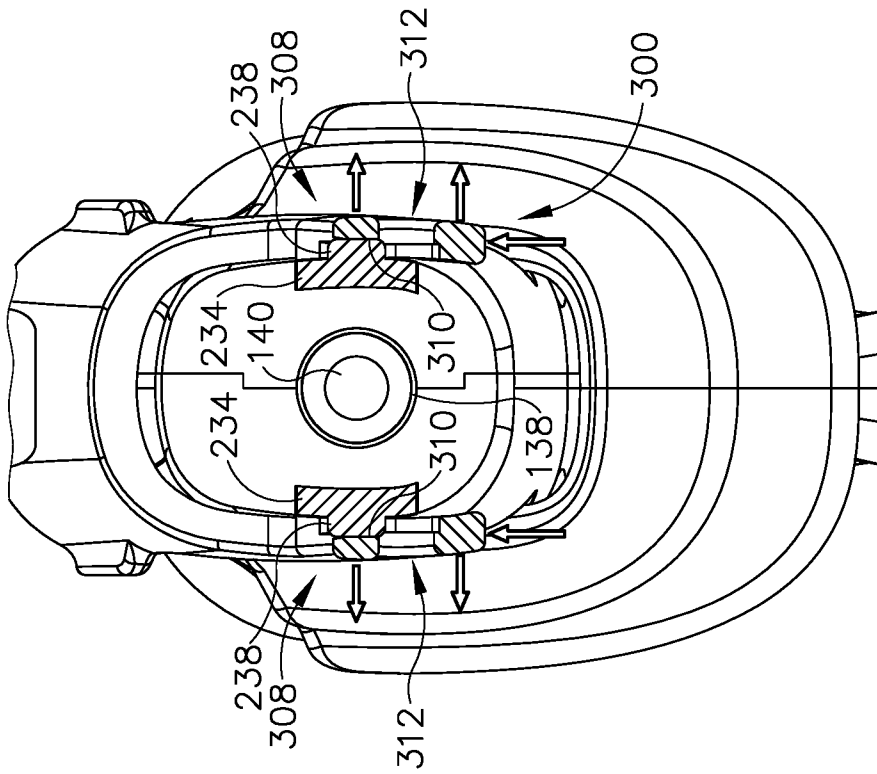

Fig. 15B

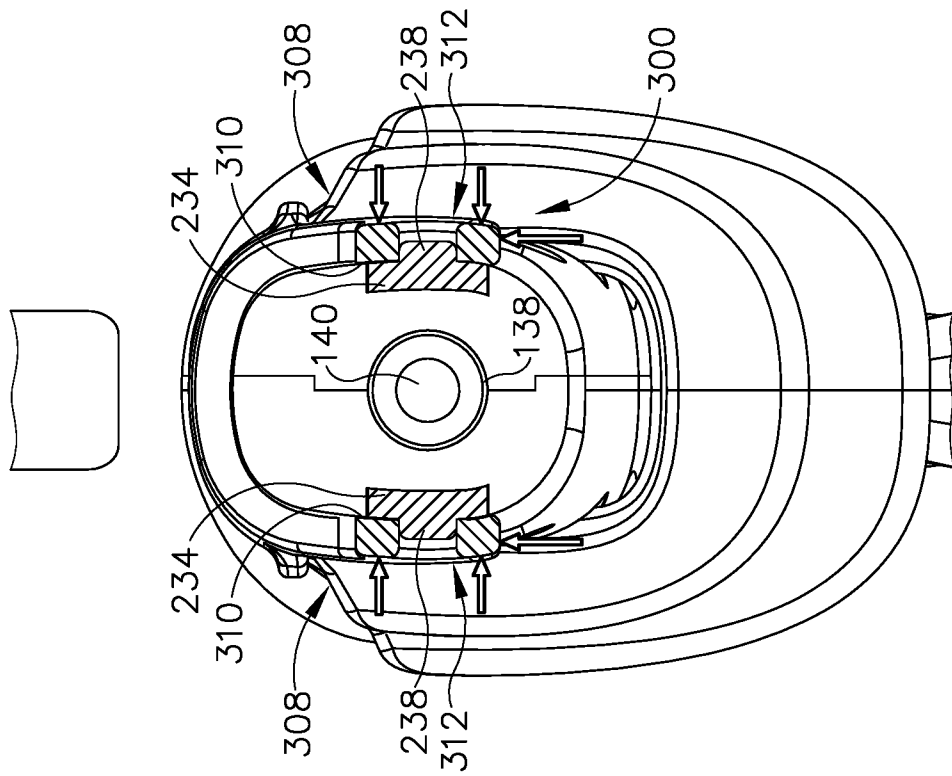

Fig. 15C

24/35

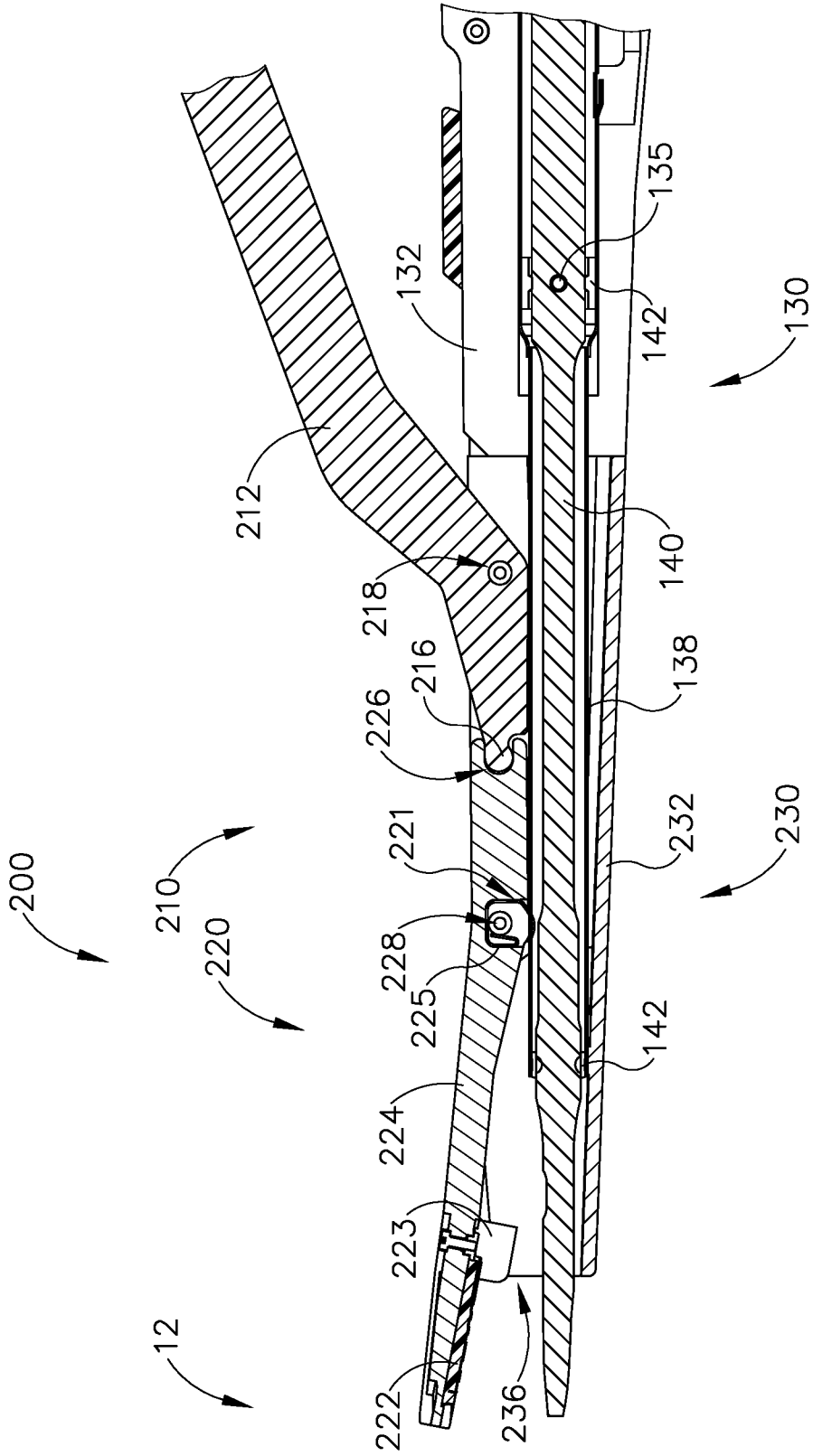

Fig. 16A

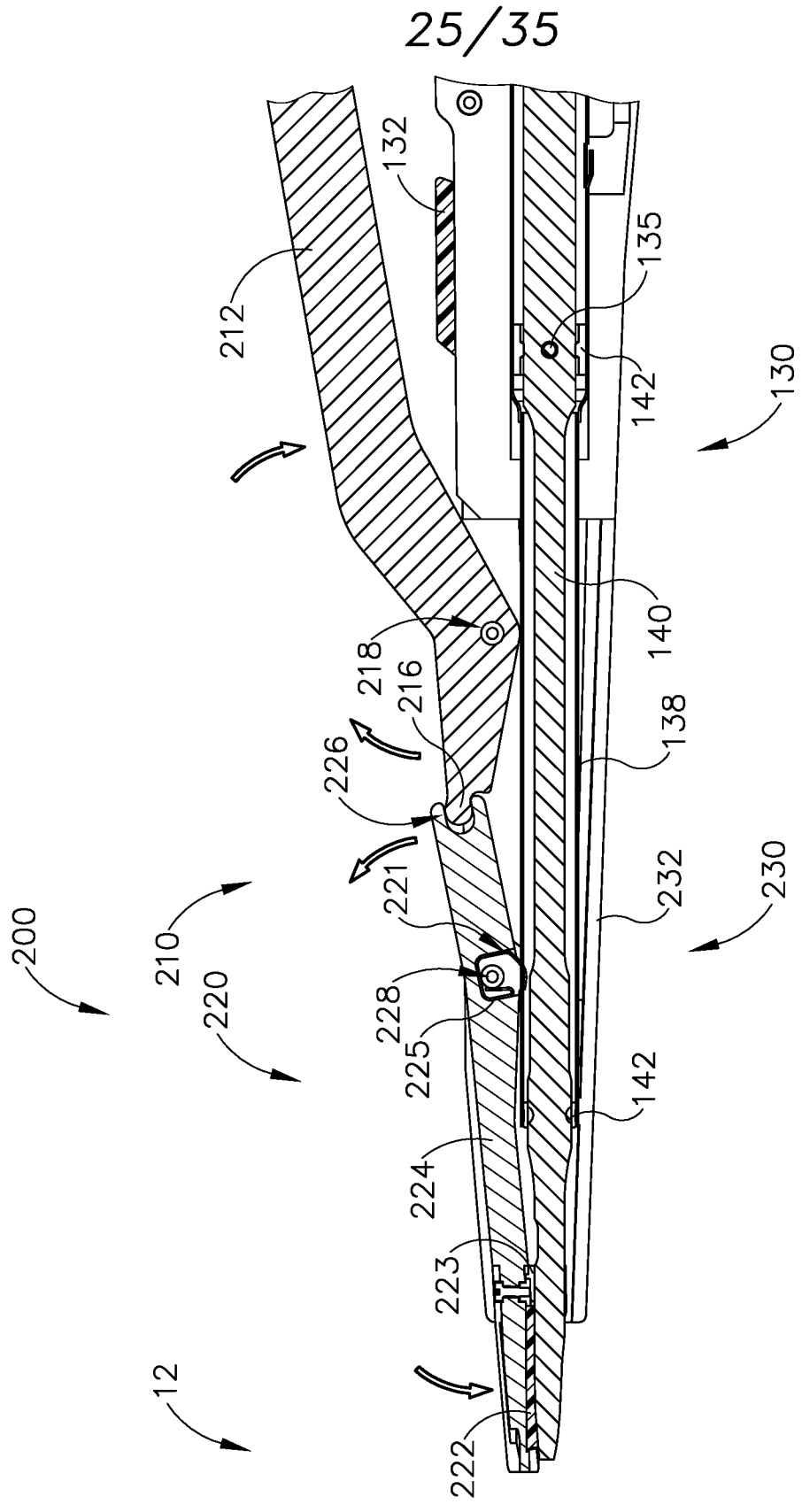

Fig. 16B

26/35

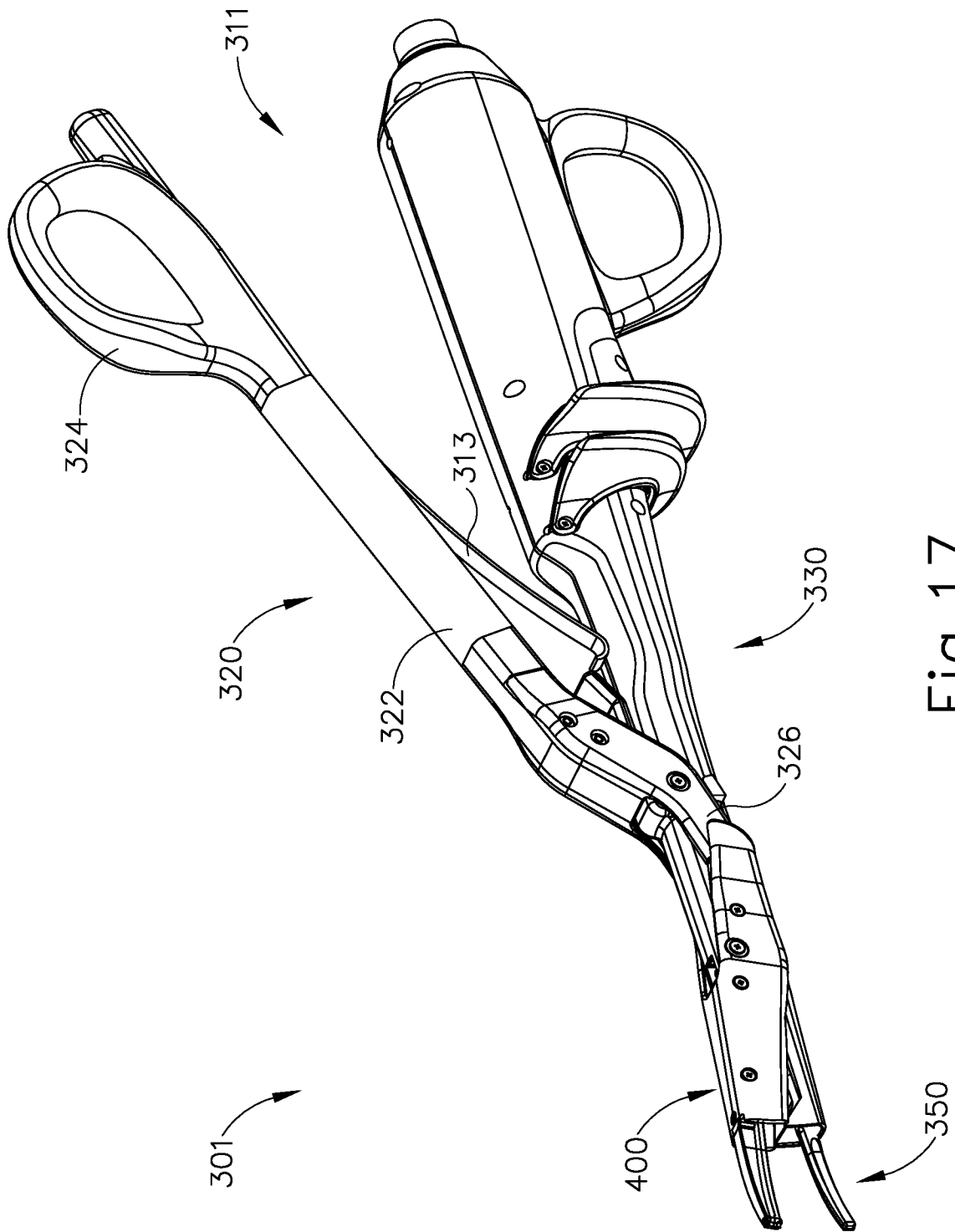

Fig.17

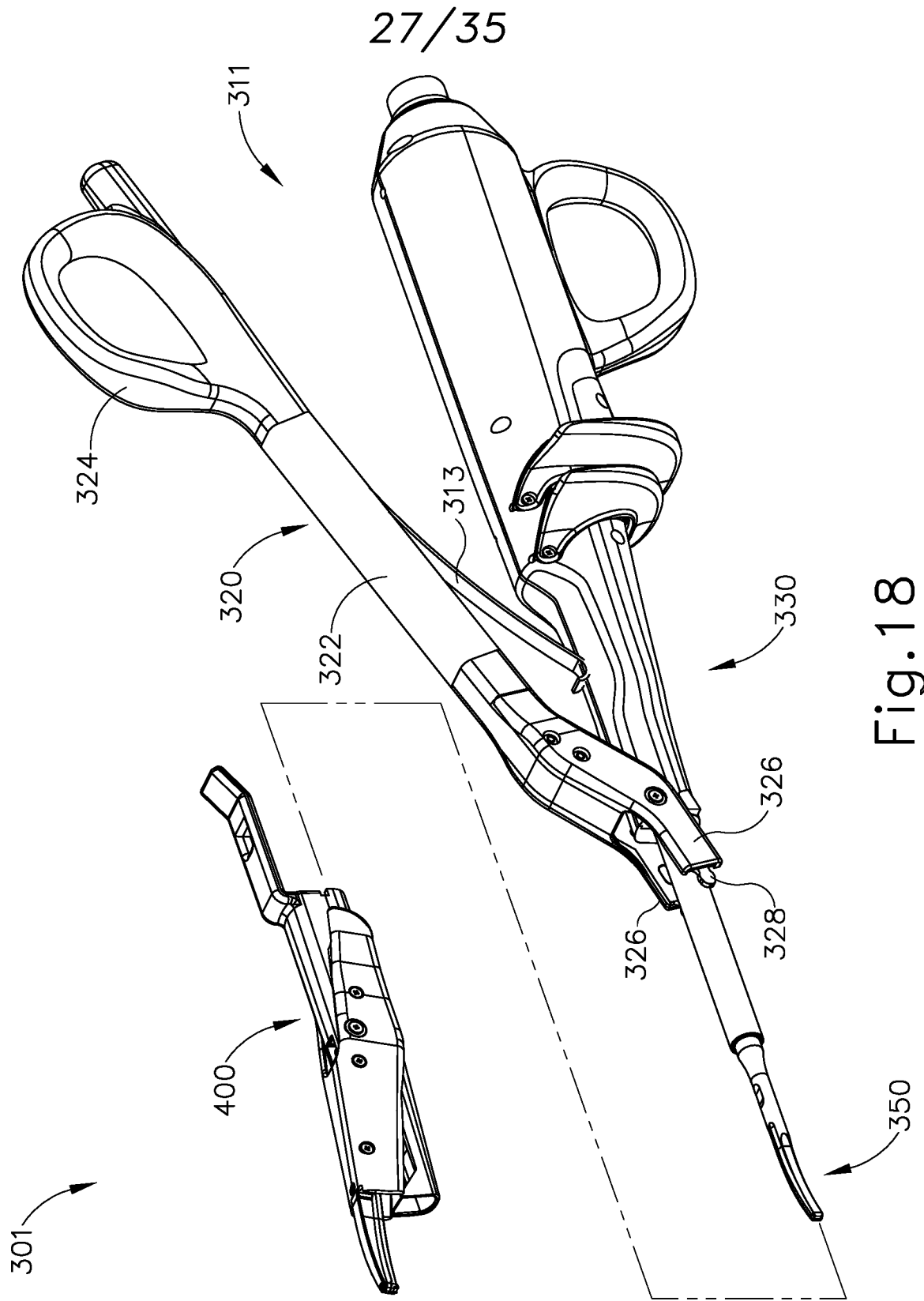

Fig. 18

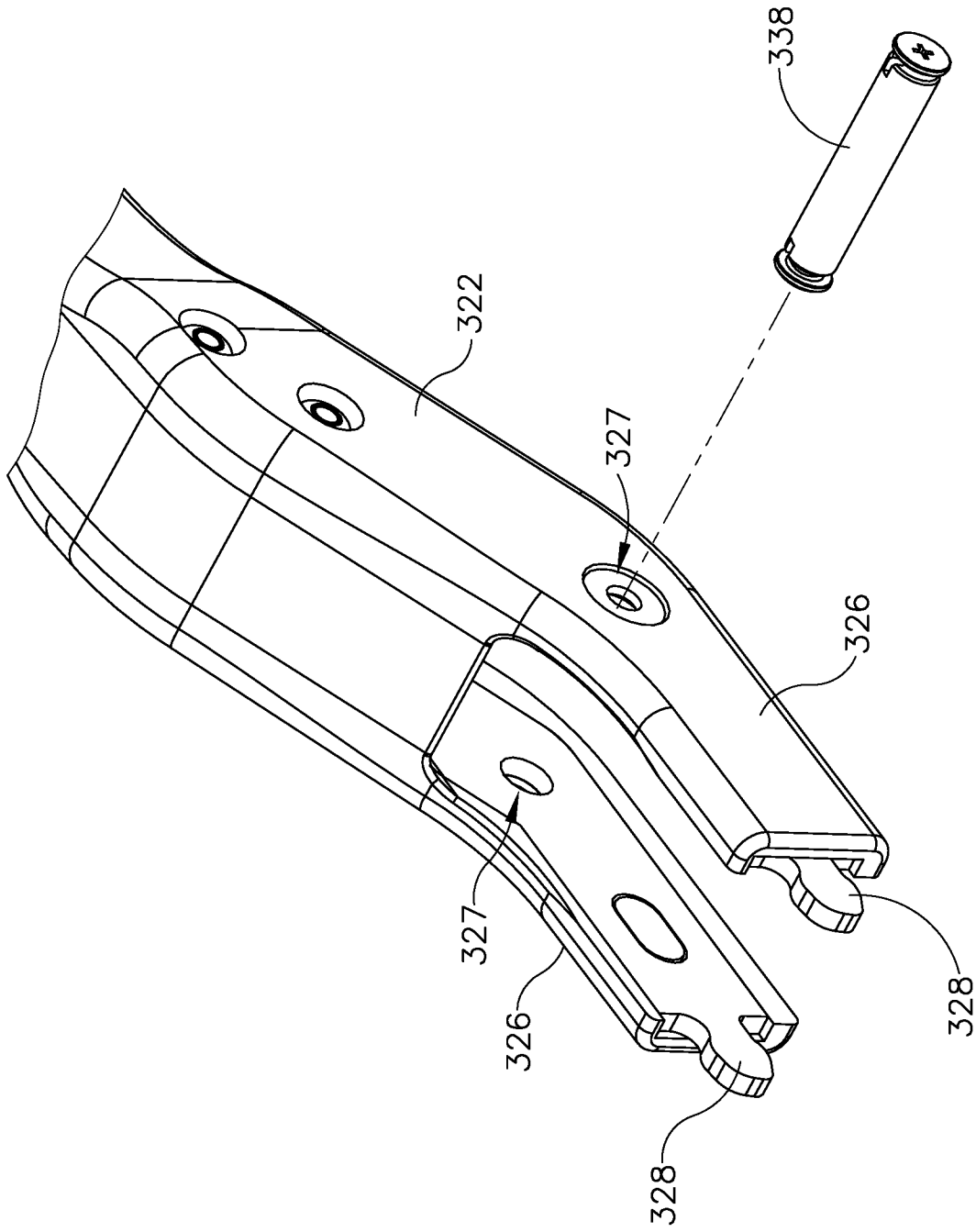

Fig. 19

29/35

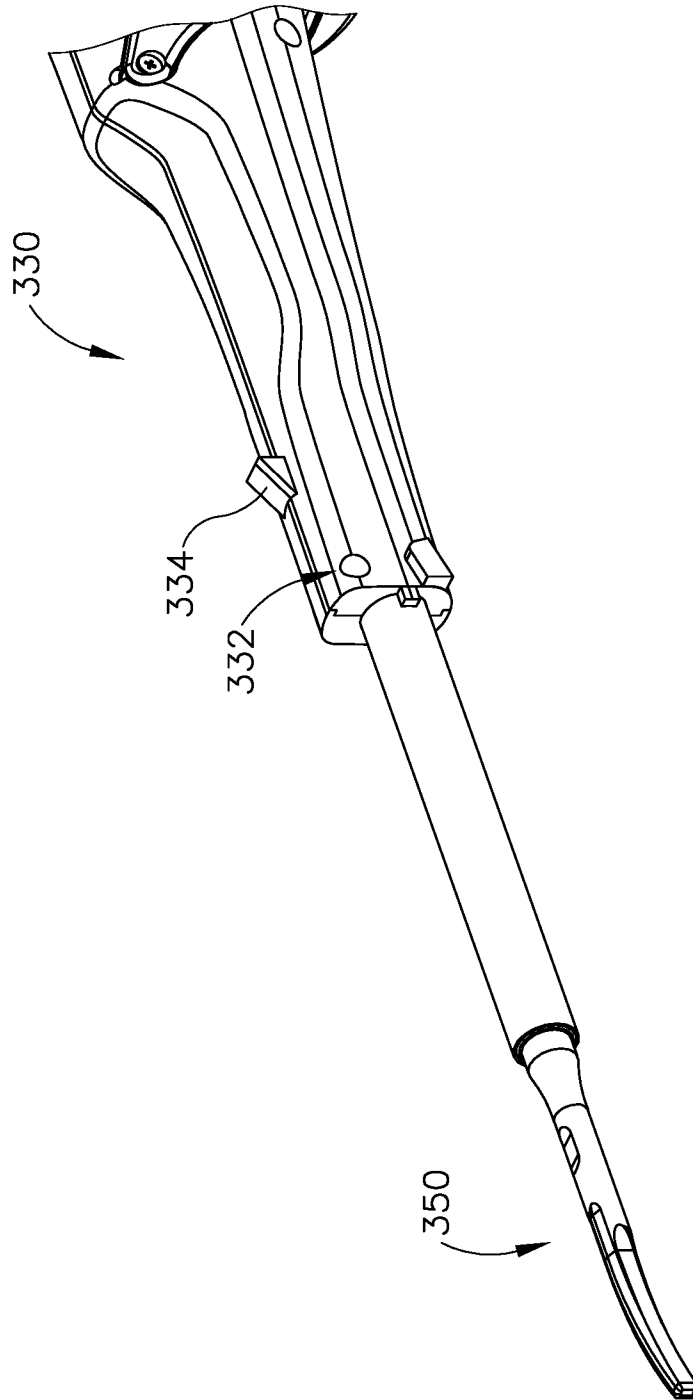

Fig. 20

30/35

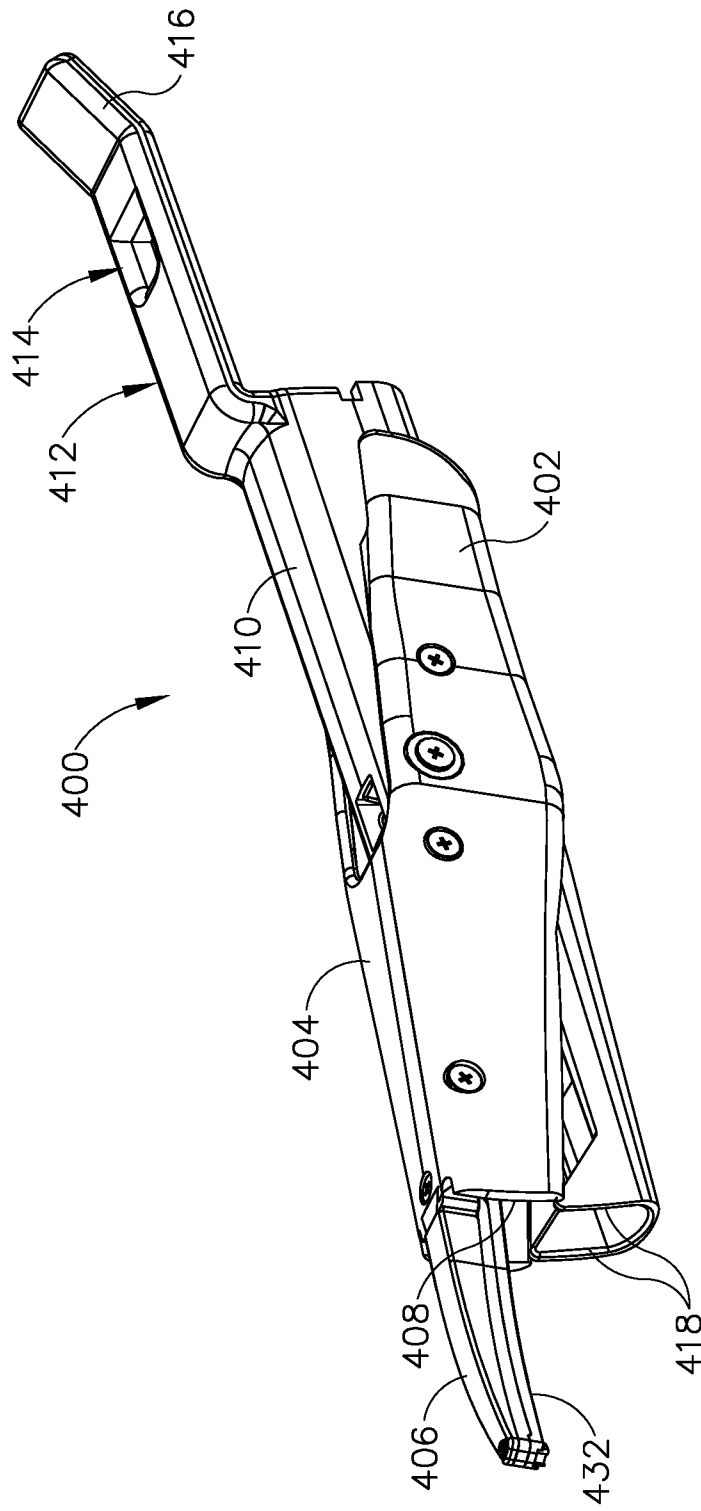

Fig. 21

31/35

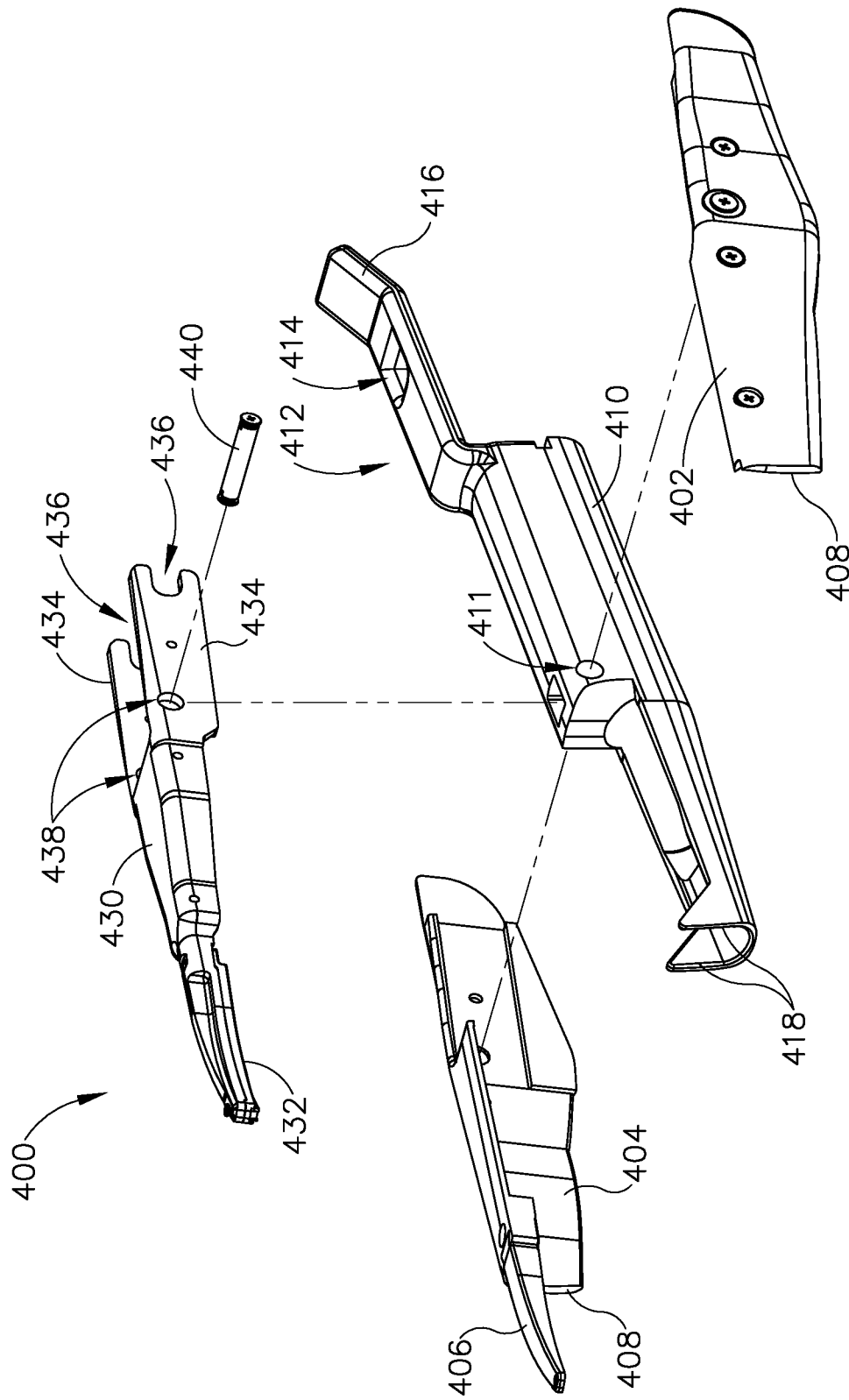

Fig. 22

32/35

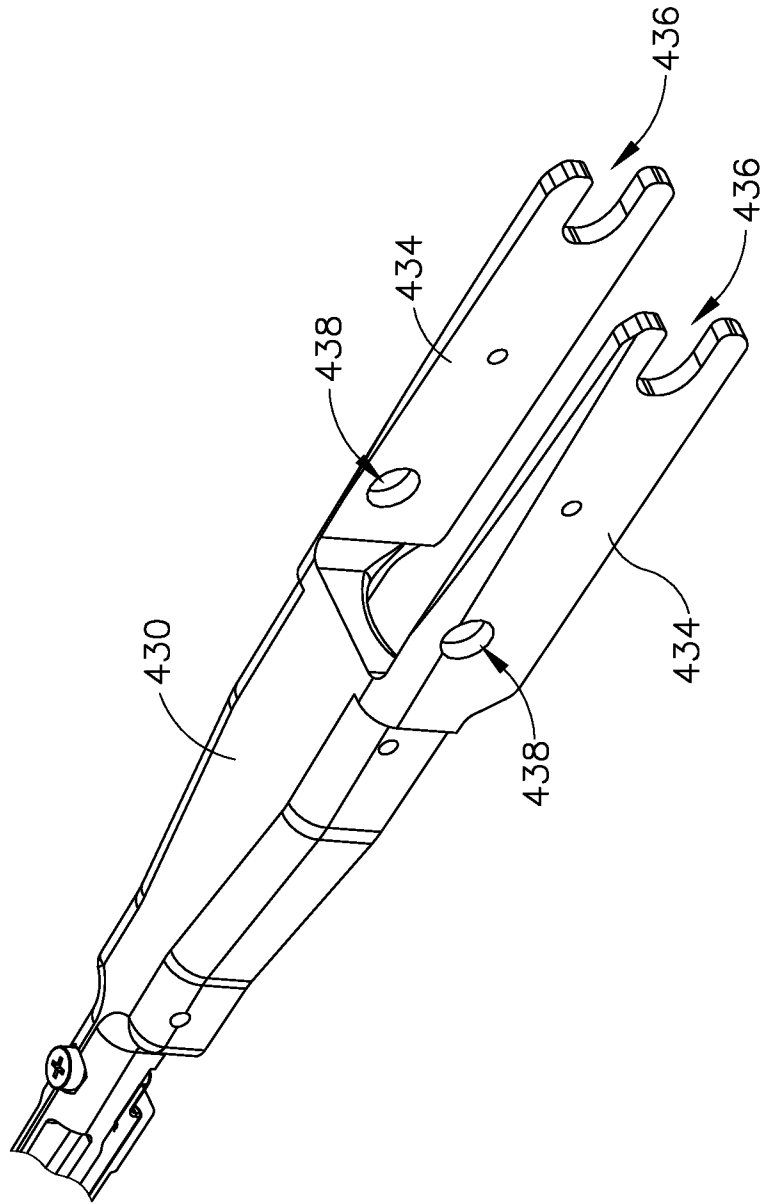

Fig. 23

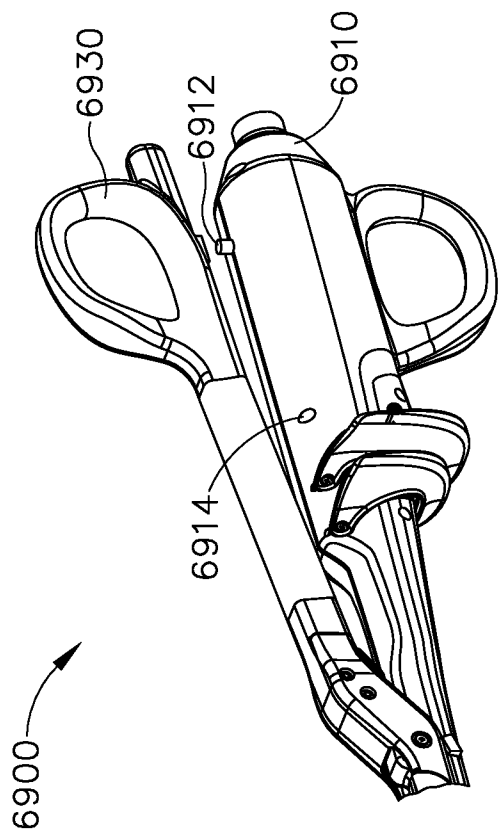

Fig. 24

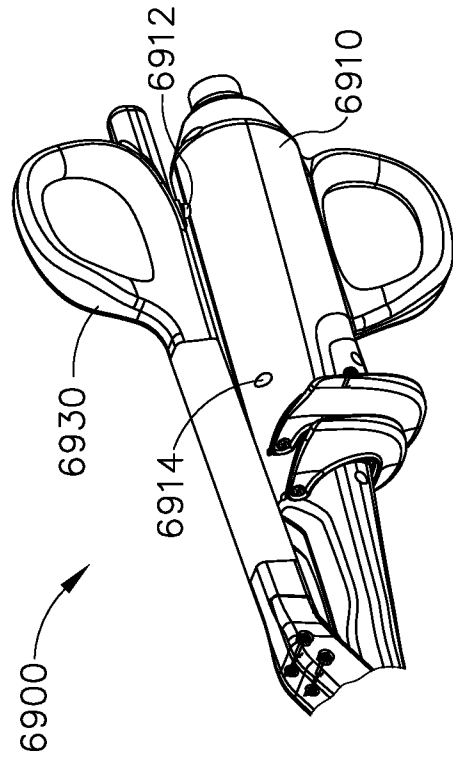

Fig. 26

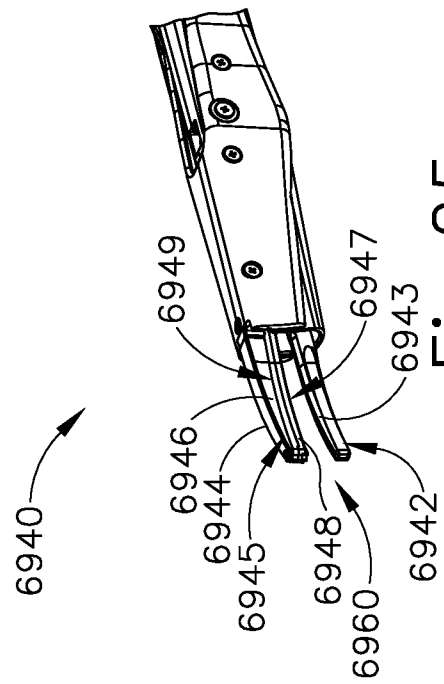

Fig. 25

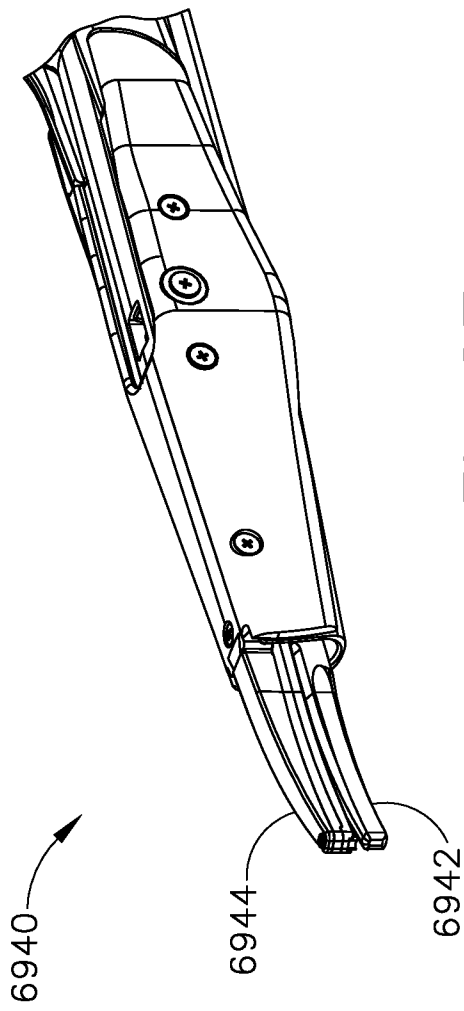

Fig. 27

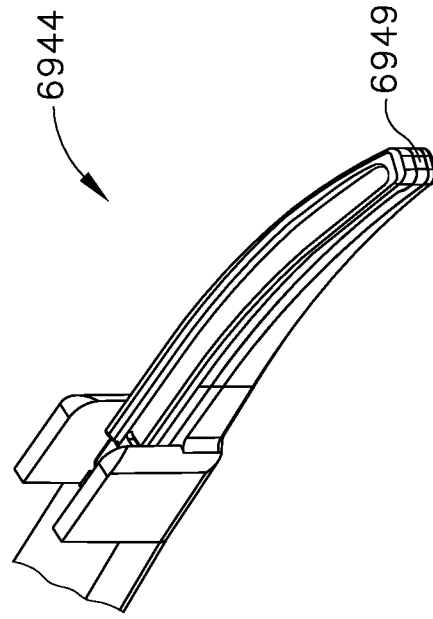

Fig. 29

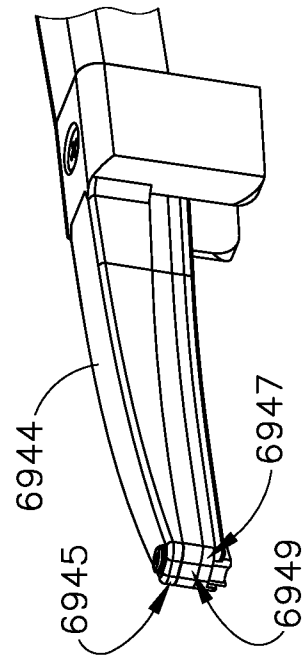

Fig. 28

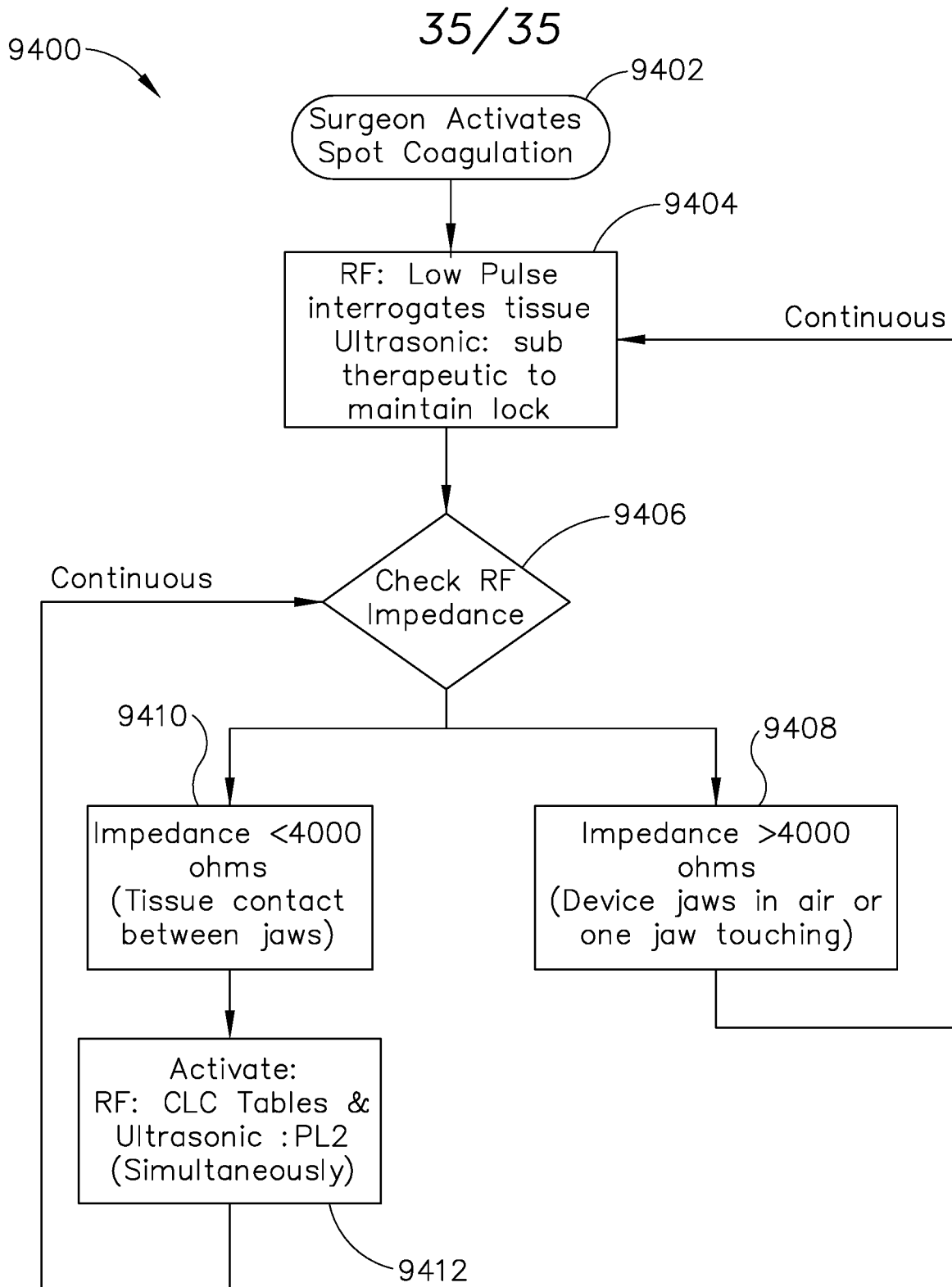

Fig.30

# INTERNATIONAL SEARCH REPORT

International application No.  
PCT/US2017/062023

## Box No. II Observations where certain claims were found unsearchable (Continuation of item 2 of first sheet)

This international search report has not been established in respect of certain claims under Article 17(2)(a) for the following reasons:

1.  Claims Nos.: 17-20  
because they relate to subject matter not required to be searched by this Authority, namely:  
Rule 39.1(iv) PCT - Method for treatment of the human or animal body by surgery
2.  Claims Nos.:  
because they relate to parts of the international application that do not comply with the prescribed requirements to such an extent that no meaningful international search can be carried out, specifically:
3.  Claims Nos.:  
because they are dependent claims and are not drafted in accordance with the second and third sentences of Rule 6.4(a).

## Box No. III Observations where unity of invention is lacking (Continuation of item 3 of first sheet)

This International Searching Authority found multiple inventions in this international application, as follows:

1.  As all required additional search fees were timely paid by the applicant, this international search report covers all searchable claims.
2.  As all searchable claims could be searched without effort justifying an additional fees, this Authority did not invite payment of additional fees.
3.  As only some of the required additional search fees were timely paid by the applicant, this international search report covers only those claims for which fees were paid, specifically claims Nos.:
4.  No required additional search fees were timely paid by the applicant. Consequently, this international search report is restricted to the invention first mentioned in the claims; it is covered by claims Nos.:

### Remark on Protest

- The additional search fees were accompanied by the applicant's protest and, where applicable, the payment of a protest fee.
- The additional search fees were accompanied by the applicant's protest but the applicable protest fee was not paid within the time limit specified in the invitation.
- No protest accompanied the payment of additional search fees.

INTERNATIONAL SEARCH REPORT

International application No  
PCT/US2017/062023

A. CLASSIFICATION OF SUBJECT MATTER  
INV. A61B17/32 A61B17/28 A61B18/14  
ADD.  
According to International Patent Classification (IPC) or to both national classification and IPC

B. FIELDS SEARCHED  
Minimum documentation searched (classification system followed by classification symbols)  
A61B

Documentation searched other than minimum documentation to the extent that such documents are included in the fields searched

Electronic data base consulted during the international search (name of data base and, where practicable, search terms used)  
EPO-Internal, WPI Data

C. DOCUMENTS CONSIDERED TO BE RELEVANT

Category*	Citation of document, with indication, where appropriate, of the relevant passages	Relevant to claim No.
X	US 2015/141981 A1 (PRICE DANIEL W [US] ET AL) 21 May 2015 (2015-05-21)	1-8,14
Y	paragraph [0034] - paragraph [0038]; figures 2, 4, 6 paragraph [0048] - paragraph [0049]	9-13,15, 16
Y	US 2014/163541 A1 (SHELTON IV FREDERICK E [US] ET AL) 12 June 2014 (2014-06-12) paragraph [0077] - paragraph [0081]; figures 4, 6	9-13,15, 16
X	US 2014/135804 A1 (WEISENBURGH II WILLIAM B [US] ET AL) 15 May 2014 (2014-05-15) paragraph [0309] - paragraph [0312]; figures 77, 114a-115i paragraph [0320] - paragraph [0322]	1
	----- -/--	

Further documents are listed in the continuation of Box C.

See patent family annex.

\* Special categories of cited documents :

"A" document defining the general state of the art which is not considered to be of particular relevance

"E" earlier application or patent but published on or after the international filing date

"L" document which may throw doubts on priority claim(s) or which is cited to establish the publication date of another citation or other special reason (as specified)

"O" document referring to an oral disclosure, use, exhibition or other means

"P" document published prior to the international filing date but later than the priority date claimed

"T" later document published after the international filing date or priority date and not in conflict with the application but cited to understand the principle or theory underlying the invention

"X" document of particular relevance; the claimed invention cannot be considered novel or cannot be considered to involve an inventive step when the document is taken alone

"Y" document of particular relevance; the claimed invention cannot be considered to involve an inventive step when the document is combined with one or more other such documents, such combination being obvious to a person skilled in the art

"&" document member of the same patent family

Date of the actual completion of the international search  23 January 2018	Date of mailing of the international search report  01/02/2018
--	--

Name and mailing address of the ISA/ European Patent Office, P.B. 5818 Patentlaan 2 NL - 2280 HV Rijswijk Tel. (+31-70) 340-2040, Fax: (+31-70) 340-3016	Authorized officer  Moers, Roelof
--	---

# INTERNATIONAL SEARCH REPORT

International application No  
PCT/US2017/062023

C(Continuation). DOCUMENTS CONSIDERED TO BE RELEVANT		
Category*	Citation of document, with indication, where appropriate, of the relevant passages	Relevant to claim No.
A	US 2012/203143 A1 (SANAI HIDEO [JP] ET AL) 9 August 2012 (2012-08-09) abstract; figures 1-8 -----	1,12,16

# INTERNATIONAL SEARCH REPORT

Information on patent family members

International application No

PCT/US2017/062023

Patent document cited in search report	Publication date	Patent family member(s)	Publication date	
US 2015141981	A1	21-05-2015	CN 105764435 A	13-07-2016
			EP 3071129 A1	28-09-2016
			JP 2016537129 A	01-12-2016
			US 2015141981 A1	21-05-2015
			WO 2015077119 A1	28-05-2015
-----				
US 2014163541	A1	12-06-2014	US 2014163541 A1	12-06-2014
			US 2017112567 A1	27-04-2017
			US 2017202610 A1	20-07-2017
-----				
US 2014135804	A1	15-05-2014	AU 2013344626 A1	07-05-2015
			CA 2891662 A1	22-05-2014
			CN 104780855 A	15-07-2015
			EP 2919676 A2	23-09-2015
			JP 2016501072 A	18-01-2016
			KR 20150085532 A	23-07-2015
			RU 2015122618 A	10-01-2017
			US 2014135804 A1	15-05-2014
			US 2015157356 A1	11-06-2015
			US 2015164533 A1	18-06-2015
			US 2015164534 A1	18-06-2015
			US 2015164535 A1	18-06-2015
			US 2015164536 A1	18-06-2015
			US 2015164537 A1	18-06-2015
			US 2015164538 A1	18-06-2015
WO 2014078548 A2	22-05-2014			
-----				
US 2012203143	A1	09-08-2012	NONE	
-----				