



- (51) International Patent Classification:  
G01N 35/02 (2006.01) G01N 21/13 (2006.01)
- (21) International Application Number:  
PCT/US2012/063002
- (22) International Filing Date:  
1 November 2012 (01.11.2012)
- (25) Filing Language: English
- (26) Publication Language: English
- (30) Priority Data:  
61/554,195 1 November 2011 (01.11.2011) US
- (71) Applicants: SAUDI ARABIAN OIL COMPANY [SA/SA]; 1 Eastern Avenue, Dhahran, 31311 (SA). ARAMCO SERVICES COMPANY [US/US]; 9009 West Loop South, Houston, TX 77210-4535 (US).
- (72) Inventors: HEGAZI, Ezzat; P.o. Box 14000, Saudi Aramco, Dhahran, 31311 (SA). STAMM, Christoph; Zurich University Of Applied Sciences, School Of Engineering, Technikumstrasse 9, CH-8401 Winterthur (CH). ENGEL, Peter; Zurich University Of Applied Sciences, School Of

Engineering, Technikumstrasse 9, CH-8401 Winterthur (CH). FELLMANN, Benjammin; Tossfeldstrasse 13, CH-8401 Winterthur (CH). SAUTTER, Hanspeter; Tossfeldstrasse 13, CH-8401 Winterthur (CH).

- (74) Agent: RHEBERGEN, Constance, Gall; Bracewell & Guliani LLP, P.o. Box 61389, Houston, TX 77208-1389 (US).
- (81) Designated States (unless otherwise indicated, for every kind of national protection available): AE, AG, AL, AM, AO, AT, AU, AZ, BA, BB, BG, BH, BN, BR, BW, BY, BZ, CA, CH, CL, CN, CO, CR, CU, CZ, DE, DK, DM, DO, DZ, EC, EE, EG, ES, FI, GB, GD, GE, GH, GM, GT, HN, HR, HU, ID, IL, IN, IS, JP, KE, KG, KM, KN, KP, KR, KZ, LA, LC, LK, LR, LS, LT, LU, LY, MA, MD, ME, MG, MK, MN, MW, MX, MY, MZ, NA, NG, NI, NO, NZ, OM, PA, PE, PG, PH, PL, PT, QA, RO, RS, RU, RW, SC, SD, SE, SG, SK, SL, SM, ST, SV, SY, TH, TJ, TM, TN, TR, TT, TZ, UA, UG, US, UZ, VC, VN, ZA, ZM, ZW.
- (84) Designated States (unless otherwise indicated, for every kind of regional protection available): ARIPO (BW, GH,

[Continued on next page]

(54) Title: MULTI-CUVETTE AUTOSAMPLER FOR PHOTO-OPTICAL MEASUREMENTS

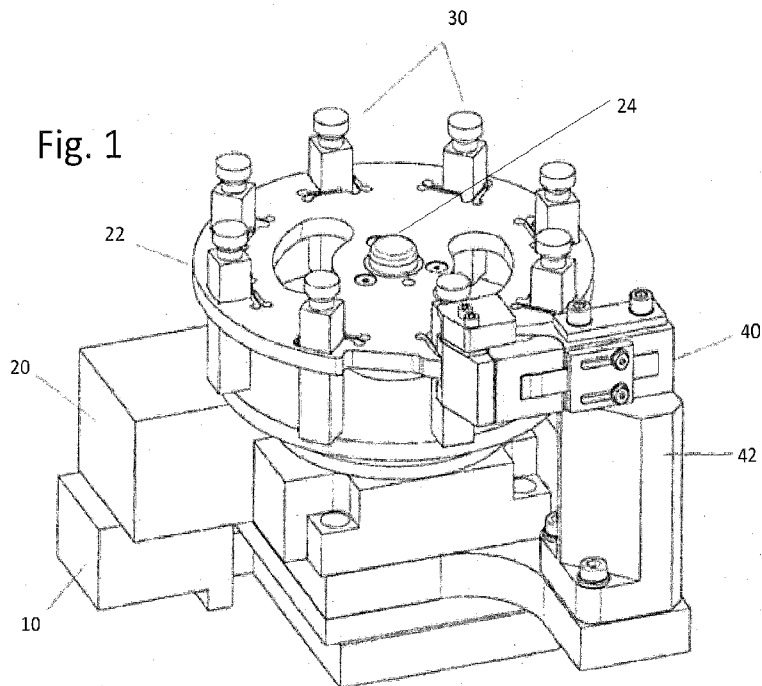

[Continued on next page]

WO 2013/067143 A1

GM, KE, LR, LS, MW, MZ, NA, RW, SD, SL, SZ, TZ, UG, ZM, ZW), Eurasian (AM, AZ, BY, KG, KZ, RU, TJ, TM), European (AL, AT, BE, BG, CH, CY, CZ, DE, DK, EE, ES, FI, FR, GB, GR, HR, HU, IE, IS, IT, LT, LU, LV, MC, MK, MT, NL, NO, PL, PT, RO, RS, SE, SI, SK, SM, TR), OAPI (BF, BJ, CF, CG, CI, CM, GA, GN, GQ, GW, ML, MR, NE, SN, TD, TG).

**Published:**

- *with international search report (Art. 21(3))*
- *before the expiration of the time limit for amending the claims and to be republished in the event of receipt of amendments (Rule 48.2(h))*

---

**(57) Abstract:** A motorized multi-cuvette rotatable carousel positions cuvettes around a stationary axis. A rotatable cuvette holder plate positions cuvettes in the carousel. The cuvette holder plate has spring tensioning elements that hold cuvettes in a precise position within the cuvette holder plate. A cuvette positioning arm is attached to the rotatable carousel assembly. The positioning arm geometrically positions the cuvette for depth-resolved laser-induced fluorescence testing.

**PCT PATENT APPLICATION****MULTI-CUVETTE AUTOSAMPLER FOR PHOTO-OPTICAL MEASUREMENTS**

Inventors: Ezzat Hegazi (Canada)  
Christoph Stamm (Switzerland)  
Peter Engel (Switzerland)  
Benjamin Fellman (Switzerland)  
Hanspeter Sautter (Switzerland)

Assignee: Saudi Arabian Oil Company

**BACKGROUND OF THE INVENTION****Field of the Invention**

[0001] The present invention relates to photo-optical measurement of cuvette contained samples, and more particularly to precise positioning of cuvettes in a multi-cuvette system, the samples undergoing depth-resolved laser-induced fluorescence testing.

**Description of the Related Art**

[0002] Depth-resolved laser-induced fluorescence measurement has seen use measuring concentrations of fuel mixtures. Measurements involve illuminating a sample with a laser and measuring the fluorescent emissions of the sample. Such an apparatus is often set up for the testing of individual samples. Industry usage of such a technique often requires the ability to quickly test many samples in an efficient manner. While the previous apparatus and methods provide excellent results, it would be advantageous to accurately illuminate multiple samples in a time efficient manner.

[0003] There exist a number of systems for handling of biological or other samples for multi-sample testing. These systems often have specific biological purposes and the level of precision in the handling of samples can vary greatly between systems. Further, there exist many auto sampling systems carrying multiple sample containers. These systems often suffer from accuracy and repeatability issues as they do not address the considerations of the precise positioning of individual sample containers for repeatable position testing of multiple samples. It

would be advantageous to develop a system that ensures precise positioning and therefore establishes repeatability of testing multiple samples.

[0004] Other auto sampling systems consist of multi-sample containers or multi-sample cards that carry the individual samples in a plurality of sample test sites within one container. These systems may employ fluorescence or other testing where the multiple samples in the sample containers may be illuminated and tested simultaneously. These multi-sample based container management systems lack elements that provide a precise geometric location of the sample being tested. It would be advantageous to provide a system that addresses the precise geometric location of the sample.

[0005] Many multiple sample testing systems exist. Often the systems have similar limitations to the systems described above, such as: a system useful for testing only one sample at a time; a multi-sample system that does not have elements providing for the precise geometric location of a sample within the testing apparatus; and a multi-sample system that does not provide for geometric positioning of a sample beyond the apparatus conveying the sample. The present invention seeks to improve upon the described systems by addressing these issues as well as others.

#### SUMMARY OF THE INVENTION

[0006] The current invention provides a cuvette positioning system that is efficient and accurate for performing depth-resolved laser-induced fluorescence measurements on cuvette-contained industrial fluid samples. Fluid samples can include gas, liquid, or combination gas and liquid cuvette-contained samples. This cuvette positioning system can additionally be applied to other sample types, can use other light sources and can be used for other photo-optical measurements such as absorption, transmission and interferometry.

[0007] In one embodiment of the invention, the cuvette positioning system provides an apparatus for positioning cuvettes into precise geometrical positions within a photo-optical measuring station. The apparatus comprises a rotatable carousel assembly for carrying multiple cuvettes in a loose-fitting manner and a separate positioning arm assembly for locking the cuvettes, individually, in the same precise orientation and location with respect to a precisely positioned slit for use in comparative photo-optical measurements. The apparatus additionally comprises a linear stage that permits the whole rotatable carousel assembly and the positioning arm assembly

to be moved along a linear axis in relation to the fixed slit. The apparatus makes it possible to perform absolute and comparative photo-optical measurements on multiple samples in different selectable depths, the depths being sufficiently precise for photo-optical measurements such as depth-resolved laser-induced fluorescence measurements.

### **Brief Description of the Drawings**

[0008] So that the manner in which the above-recited features, aspects and advantages of the invention, as well as others that will become apparent, are attained and can be understood in detail, more particular description of the invention briefly summarized above may be had by reference to the embodiments thereof that are illustrated in the drawings that form a part of this specification. It is noted, however, that the appended drawings illustrate only preferred embodiments of the invention that are, therefore, not to be considered limiting of the invention's scope, for the invention may admit to other equally effective embodiments.

[0009] FIG. 1 is a schematic view of the cuvette positioning system showing the carousel carrying multiple cuvettes, the translational stage and the positioning arm in accordance with an embodiment of the present invention.

[0010] FIG. 2a and FIG. 2b are top view diagrams showing the linear movement of the cuvette positioning system, the direction of light from the excitation source and the corresponding fluorescence emissions through the stationary slit in accordance with an embodiment of the present invention.

[0011] FIG. 3 is an exploded schematic view of the motorized rotation stage assembly without the cuvette positioning arm in accordance with an embodiment of the present invention.

[0012] FIG. 4 is a rear schematic view of the cuvette positioning arm and cuvette positioning arm post in accordance with an embodiment of the present invention.

[0013] FIG. 5 is a front schematic view of the cuvette positioning arm in accordance with an embodiment of the present invention.

[0014] FIG. 6 is a rear schematic view of the cuvette positioning arm in accordance with an embodiment of the present invention.

[0015] FIG. 7 is a schematic view showing the fitment of a cuvette as positioned in the carousel and held by the cuvette positioning arm in accordance with an embodiment of the present invention.

[0016] FIG. 8 is a schematic top view showing a cuvette as positioned in the carousel and held by the cuvette positioning arm in accordance with an embodiment of the present invention.

### DETAILED DESCRIPTION

[0017] Figure 1 illustrates an embodiment of a cuvette positioning system. The cuvette positioning system has motorized translation stage 10 which provides for linear movement of the entire cuvette positioning system. Motorized rotation stage assembly 20 is attached to motorized translation stage 10. Motorized rotation stage assembly 20 uses a motor to position cuvettes 30 around central shaft 24. In this embodiment, cuvettes 30 have a square shape. An individual cuvette 30 is held in precise geometric orientation by cuvette positioning arm 40. Cuvette positioning arm 40 is connected to cuvette positioning arm post 42. Cuvette positioning arm post 42 is further connected to motorized rotation stage assembly 20.

[0018] Figures 2a and 2b illustrate an embodiment of the cuvette positioning system, showing two positions within the linear movement of the system. In this embodiment, motorized translation stage shown by 10a and 10b has positioned cuvette 30a and 30b in two different linear locations. Cuvette 30a and 30b demonstrates the cuvette being fluoresced by excitation light source 66a and 66b. Excitation light source 66a and 66b generates excitation light beam 62a and 62b, which illuminates the sample in the cuvette 30a and 30b and causes fluorescence emissions 64a and 64b. Fluorescence emissions 64a and 64b are measured as they come out of stationary slit 60a and 60b. Motorized rotation stage assembly is moved linearly by motorized translation stage 10a and 10b in relation to stationary slit 60a and 60b to allow fluorescence emissions measurements to be taken at varying depths of the cuvette 30 contained sample.

[0019] Figure 3 illustrates an exploded view of the motorized rotation stage assembly with translation stage 10 and without the cuvette positioning arm. Translation stage 10 connects to translation stage platform 12 that provides linear movement substantially along one axis with respect to the light source as described in Figure 2 above. The motorized rotation stage assembly includes the carousel rotation parts and the cuvette positioning arm assembly, which are both attached to motorized rotation stage assembly connection plate 28. Motorized rotation stage

assembly connection plate 28 is further attached to motorized translation stage 10. The carousel rotation parts begin with motorized rotation stage base 26, which houses the motor that rotates the carousel through connected motorized rotation stage top plate 29. Motorized rotation stage top plate 29 attaches to carousel support plate 25 having positioning bolt 27 for alignment with cuvette support plate 23 having connection part 21 that connects to cuvette holder plate 22. Cuvette support plate 23 positioned to rest against each cuvettes lower wall and provide vertical support to the cuvettes. Central shaft 24 goes through the center of the carousel and serves as a central axis about which the carousel revolves. Positioning bolt 27 serves the dual function of allowing the carousel to fit in a predetermined orientation and of providing the means for anchoring the carousel to the rotation stage during rotation. The carousel rotation is driven by a motor in motorized rotation stage base 26 that connects to and is capable of turning the carousel in both directions. The rotation of the carousel allows the carousel contained cuvettes, as shown in Figure 1, to rotate into a precise position set up to be illuminated by a fixed position light source, as shown in Figure 2.

[0020] Figure 4 illustrates another embodiment of the cuvette positioning arm assembly. The cuvette positioning arm assembly consists of cuvette positioning arm 40 connected to cuvette positioning arm post 42. The cuvette positioning arm assembly bolts to motorized rotation stage assembly connection plate 28 as illustrated in Figure 1. This connection allows the cuvette positioning arm assembly to move together with the carousel using the linear stage. Continuing with Figure 4, cuvette positioning arm 40 has numerous components to aid in the precise positioning of cuvettes. Lip spring 48 is held in place by lip spring holder plate 43. Lip spring 48 allows positioning lip 44 to pivot away from and then back towards the carousel when the cuvette in the carousel slides in front of positioning lip 44 on its way to being locked in the accurate position for measurement. Lip spring 48 achieves this movement by applying tension against positioning lip 44 so that when a cuvette in the carousel slides in front of positioning lip 44, positioning lip 44 is under greater tension from lip spring 48 such that positioning lip 44 moves back towards the carousel as the cuvette slides past positioning lip 44. Cuvette spacer plate 45 sits between cuvette positioning arm 40 and cuvette end stop 46. Cuvette end stop 46 prevents the active cuvette in the testing position of the carousel from moving upwards once locked into place by cuvette positioning arm 40. Cuvette spacer plate 45 advantageously allows for cuvettes of varying heights to be used in the system. Cuvette arm holder plate 47 serves to attach cuvette positioning arm 40 to cuvette positioning arm post 42.

[0021] Figure 5 illustrates a front view of the positioning arm assembly described in Figure 4. Positioning arm 40 is shown without the cuvette spacer plate, cuvette end stop and cuvette arm holder plate that were described and shown in Figure 4. A front view shows the unique shape of positioning lip 44 that allows for the accurate positioning of an individual cuvette. The positioning lip 44 has two tongues 41 on a front side of the positioning lip 44 and a rounded edge on a lateral side of the positioning lip 44. The positioning piece is attached to the bulk of the positioning arm in a manner that leaves the two tongues 41 protruding at the front of the positioning lip 44. The two tongues 41 act as a vertical border which aligns one of the four sidewalls of the cuvette. The rounded edge of the positioning lip 44 acts as a hinge about which the positioning lip rotates when it becomes pivoted away from the carousel.

[0022] Figure 6 illustrates a rear view of the positioning arm assembly described in Figure 4. Positioning arm 40 is shown without the cuvette spacer plate, cuvette end stop and cuvette arm holder plate. A rear view shows the unique shape of positioning lip 44. Lip holder plate 43 holds lip spring 48 in place which provides tension against positioning lip 44.

[0023] Figure 7 illustrates a front view of the cuvette positioning arm assembly holding the active cuvette in the testing position of the carousel in a precise geometric position for measurement. Cuvette 30 is held in place by the cuvette positioning arm assembly as described previously. Cuvette end stop 46 prevents upward movement of the cuvette, helping maintain the precise geometric position the cuvette positioning arm seeks to achieve. Cuvette positioning lip 44 is held by cuvette positioning arm 40 and tensioned by the lip spring, not shown, against cuvette 30. The particular shape of positioning lip 44 determines the precise geometric position of the cuvette in relation to the incoming excitation light beam. Cuvette holder plate 22 has flexible springs 39 that allow for the varying positions that would be imposed by a cuvette positioning lip having a different tongue shape. Flexible springs 39 can be rectangular in shape, sit flush with cuvette holder plate 22, engage with the sides of the cuvette sitting in cuvette holder plate 22 and serve to bias the position of cuvettes to a substantially perpendicular position in relation to cuvette holder plate 22. Over time, flexible springs 39 of cuvette holder plate 22 may weaken and allow more movement of individual cuvettes within cuvette holder plate 22. In regard to the potential added movement of individual cuvettes within the carousel, precise geometric positioning can still be achieved for cuvettes undergoing measurement as described in regard to Figure 4 by the cuvette positioning arm assembly.

[0024] Figure 8 illustrates a top view of the embodiment described in Figure 7 above. Cuvette 30 is held in place by the cuvette positioning arm assembly as described previously. Cuvette end stop 46 prevents upward movement of cuvette 30. Cuvette positioning lip 44 is held by cuvette positioning arm 40 and tensioned by lip spring 48 against cuvette 30.

[0025] The operation of an embodiment of the cuvette positioning system proceeds as follows in regard to the positioning arm assembly as described in Figures 1-8: the carousel carrying the cuvettes rotates clockwise to switch next in line cuvette into the measurement position. As the individual cuvette to be measured reaches and presses on the protruding tongues 41 of the described positioning lip 44, it causes the positioning lip 44 to pivot away from the carousel allowing the cuvette to pass over the protruding tongues 41. After the new cuvette crosses to the lateral side of the tongues 41, the carousel is made to rotate counterclockwise at a small angle until one side of the cuvette touches and slightly presses on the tongues 41 from the lateral side. The unique design of the positioning lip 44 constrains the cuvette from pivoting backward when the tongues 41 are pressed from the lateral side, this causes the cuvette to be cornered parallel to the tongues 41. The way the cuvette is cornered against the lateral side of the tongues 41 provides the sought optically precise orientation of the cuvette for measurement. In an embodiment the portion of the tongues 41 that contact the cuvettes may be substantially parallel to carousel central shaft 24 such that the cuvettes are cornered substantially parallel to central shaft 24. In another embodiment the portion of the tongues 41 that contact the cuvettes may be angled or each tongue can be offset from each other such that the cuvettes are cornered at a precise angle in relation to the carousel central shaft 24. When the cuvette is in the measurement position depth-resolved laser induced fluorescence or other photo-optical measurements may be performed to the cuvette contained sample. The cuvette can be transparent such that the laser can enter the cuvette and cause fluorescence emissions to emit off of the sample and out of the transparent cuvette towards measuring devices. In an embodiment these emissions can be measured through a substantially stationary slit as described in Figure 2 or by other techniques.

[0026] In addition to depth-resolved laser-induced fluorescence measurements, the described embodiment could also be adapted for other photo-optical measurements such as absorption, transmission and interferometry.

[0027] While the invention has been described in conjunction with specific embodiments thereof, it is evident that many alternatives, modifications, and variations will be apparent to

those skilled in the art in light of the foregoing description. Accordingly, it is intended to embrace all such alternatives, modifications, and variations as fall within the spirit and broad scope of the appended claims. The present invention may suitably comprise, consist or consist essentially of the elements disclosed and may be practiced in the absence of an element not disclosed. Furthermore, language referring to order, such as first and second, should be understood in an exemplary sense and not in a limiting sense. For example, it can be recognized by those skilled in the art that certain steps can be combined into a single step.

[0028] The singular forms "a", "an" and "the" include plural referents, unless the context clearly dictates otherwise.

[0029] Optional or optionally means that the subsequently described event or circumstances may or may not occur. The description includes instances where the event or circumstance occurs and instances where it does not occur.

[0030] Ranges may be expressed herein as from about one particular value, and/or to about another particular value. When such a range is expressed, it is to be understood that another embodiment is from the one particular value and/or to the other particular value, along with all combinations within said range.

## CLAIMS

What is claimed is:

1. A cuvette positioning system characterized by:

a motorized rotation stage assembly having a rotatable carousel assembly and a positioning arm assembly, the motorized rotation stage assembly having a motorized translation stage to linearly position the motorized rotation stage assembly in relation to an excitation light source;

the rotatable carousel assembly having a plurality of cuvettes around a central shaft, each cuvette of the plurality of cuvettes having a lower wall, an upper wall, a plurality of sidewalls, an opening, and a cavity;

the plurality of cuvettes positioned in a cuvette holder plate within the carousel assembly, the cuvette holder plate having a plurality of flexible spring tension arms set against the plurality of sidewalls of the plurality of cuvettes, the plurality of spring tension arms biasing the sidewalls of each of the plurality of cuvettes towards a position substantially parallel with the central shaft, thereby preparing the position of each cuvette of the plurality of cuvettes such that when the rotatable carousel assembly rotates an individual cuvette of the plurality of cuvettes to a testing location, the cuvette positioning arm assembly can engage the individual cuvette;

the cuvette positioning arm assembly having a cuvette positioning arm connected to a cuvette positioning arm post, the cuvette positioning arm aligning an individual cuvette of the plurality of cuvettes in a particular measurement position such that the plurality of cuvette sidewalls are at a particular measurement angle, thereby setting the position of the individual cuvette in the testing location such that the particular position of the individual cuvette is repeatable for each individual cuvette of the plurality of cuvettes when the each individual cuvette is placed into the testing location by the rotatable carousel assembly.

2. The system of claim 1, further characterized by:

a cuvette support plate connected to the motorized rotation stage assembly and positioned to rest against the lower wall of each of the plurality of cuvettes, thereby supporting the lower wall of each cuvette in the motorized rotation stage assembly and maintaining the vertical position of each cuvette of the plurality of cuvettes within the cuvette holder plate.

3. The system of claim 1, further characterized by:

a cuvette positioning lip connected to the cuvette positioning arm wherein the cuvette positioning lip has a plurality of tongues.

4. The system of any of Claims 1-3, further characterized by:

a lip spring having a lip spring holder plate connected to the cuvette positioning arm, the lip spring holder plate pressing against the cuvette positioning arm.

5. The system of any of Claims 1-3, wherein the lip spring presses the tongues of the cuvette positioning lip against the cuvette positioned by the cuvette positioning arm assembly, thereby causing the cuvette to be cornered against the tongues in a particular position.

6. The system of any of Claims 1-3, further characterized by:

a cuvette end stop connected to the cuvette positioning arm assembly positioned to prevent upward movement of the cuvette positioned by the cuvette positioning arm assembly.

7. The system of any of the preceding claims, wherein the excitation light source is characterized by a laser.

8. A cuvette positioning apparatus characterized by:

a rotatable carousel assembly having a plurality of cuvettes around a motorized central shaft;

the plurality of cuvettes positioned in a cuvette holder plate such that a plurality of cuvette walls of each of the plurality of cuvettes contact the cuvette holder plate, the cuvette holder plate connected to the motorized central shaft, thereby allowing the cuvette holder plate to rotate each of the cuvettes of the plurality of cuvettes around the motorized central shaft and into a testing position;

a cuvette positioning arm assembly having a cuvette positioning arm connected to a cuvette positioning arm post located adjacent the testing position, the cuvette positioning arm aligning an individual cuvette of the plurality of cuvettes in a particular measurement position that is repeatable for each individual cuvette in the plurality of cuvettes when the each individual cuvette is rotated into the testing position.

9. The system of claim 8, further characterized by:

an excitation light source positioned to fluoresce a cuvette positioned by the cuvette positioning arm in the testing position.

10. The system of claim 8, further characterized by:

a cuvette support plate connected to the rotatable carousel assembly and positioned against a lower side of each of the plurality of cuvettes to thereby support the cuvettes within the carousel assembly.

11. The system of claim 8, further characterized by:

a lip spring and a lip spring holder plate connected to the cuvette positioning arm.

12. The system of any of Claims 8-11, further characterized by:

a cuvette positioning lip connected to the cuvette positioning arm wherein the cuvette positioning lip has a plurality of tongues, the tongues aligning an individual cuvette when the cuvette is being held by the cuvette positioning arm assembly.

13. The system of any of Claims 8-12, wherein the lip spring presses the tongues of the cuvette positioning lip against the cuvette positioned by the cuvette positioning arm assembly, thereby causing the cuvette to be cornered against the tongues.

14. The system of any of Claims 8-12, further characterized by:

a cuvette end stop connected to the cuvette positioning arm assembly positioned to prevent upward movement of the cuvette positioned by the cuvette positioning arm assembly.

15. The system of any of Claims 8-14, wherein the excitation light source comprises a laser.

16. A method of positioning cuvettes characterized by:

positioning a plurality of cuvettes around a central shaft of a rotatable carousel assembly, the plurality of cuvettes positioned in a cuvette holder plate within the carousel, wherein the cuvette holder plate has flexible spring tension arms positioned against the sides of the plurality of cuvettes;

rotating the rotatable carousel assembly clockwise until a side of an individual cuvette of the plurality of cuvettes presses against a plurality of tongues of a cuvette positioning arm assembly such that the side of the individual cuvette passes over the plurality of tongues; and

rotating the rotatable carousel assembly counterclockwise at a small angle until one side of an individual cuvette of the plurality of cuvettes touches and slightly presses on a plurality of tongues of the cuvette positioning arm assembly causing the individual cuvette to be cornered against the tongues thereby precisely positioning the individual cuvette such that the same position can be substantially repeated for each of the individual cuvettes.

17. The method according to claim 16, further characterized by:

fluorescing with an excitation light source, the individual cuvette of the plurality of cuvettes cornered against the tongues by the cuvette positioning arm assembly, thereby causing fluorescence emissions to project from a sample contained in the individual cuvette through a stationary slit positioned adjacent the individual cuvette.

18. The method according to any of Claims 16-17, further characterized by:

linearly positioning, by a motorized translation stage assembly, the rotatable carousel assembly and the positioning arm assembly in relation to the excitation light source.

19. The method according to any of Claims 16-17, further characterized by:

continuing to rotate the rotatable carousel assembly clockwise at a small angle until one side of an individual cuvette of the plurality of cuvettes further presses on the plurality of tongues of the cuvette positioning arm assembly causing the tension of the spring tension arms of the cuvette holder plate to be partially overcome, thereby causing the spring tension arms to flex such that the individual cuvette is rigidly held against the tongues of the cuvette positioning arm.

20. The method according to any of Claims 16-19, wherein the excitation light source is characterized by a laser.

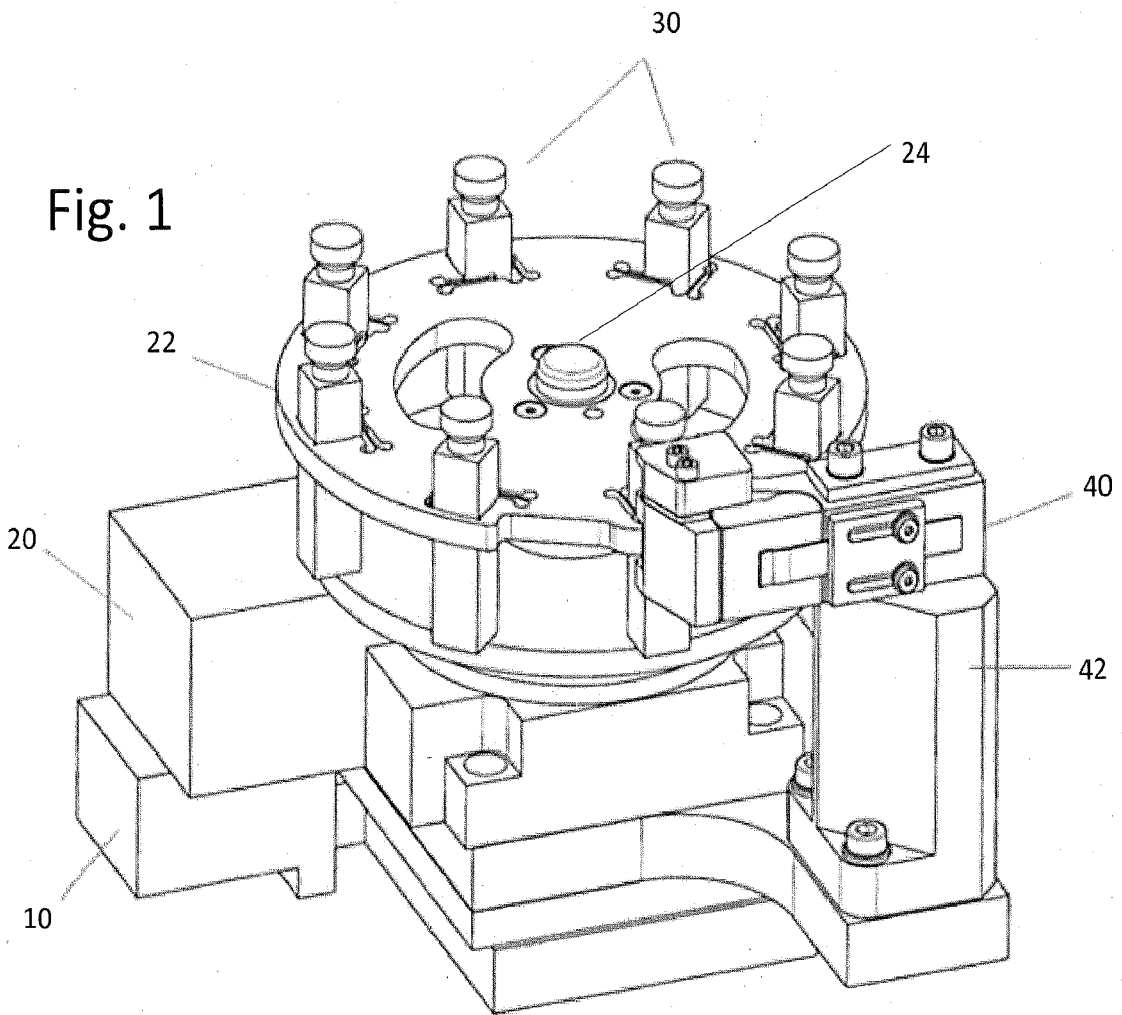

Fig. 2a

Fig. 2b

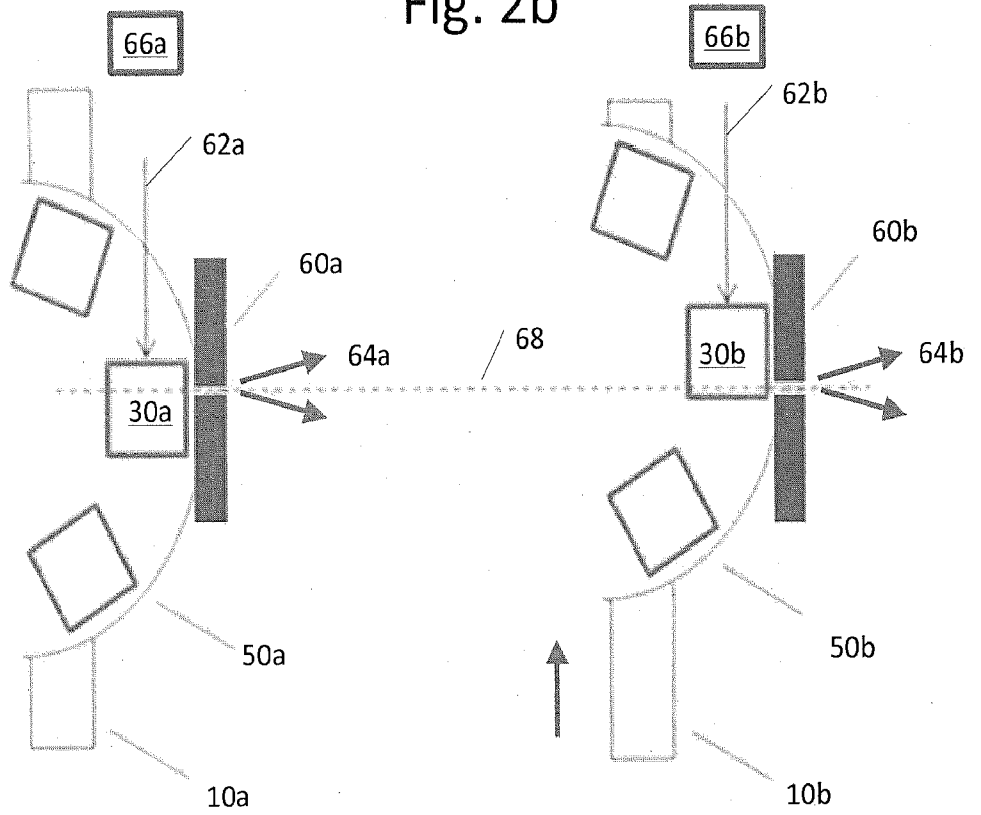

Fig. 3

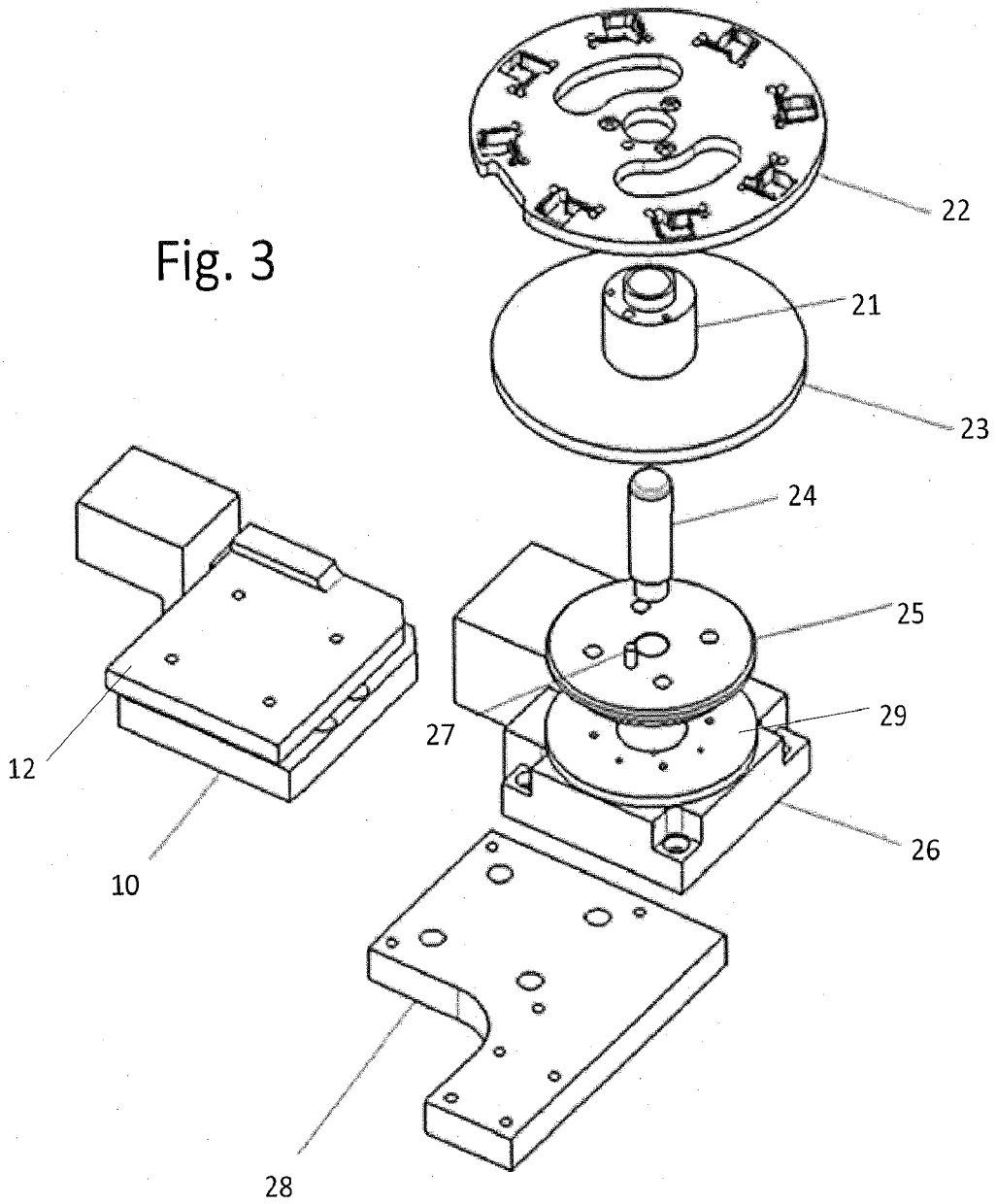

Fig. 4

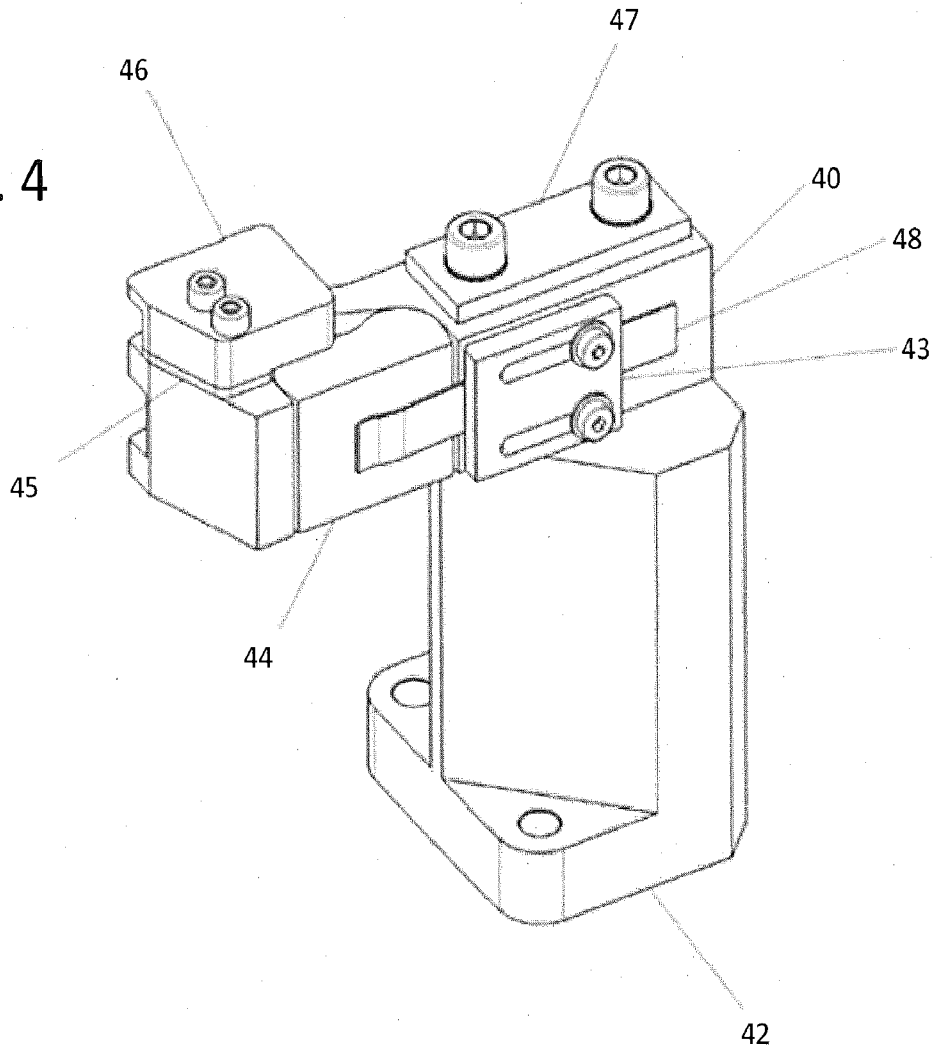

Fig. 5

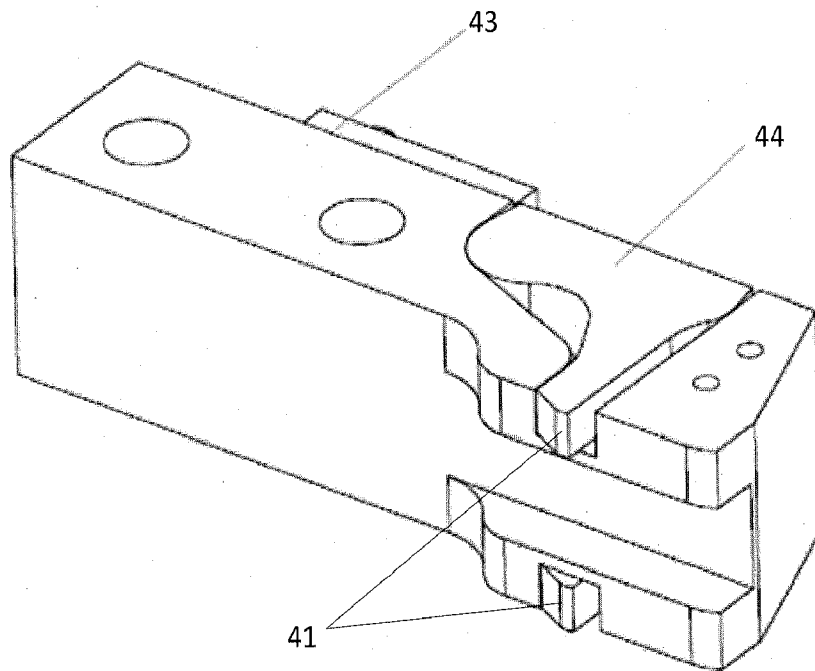
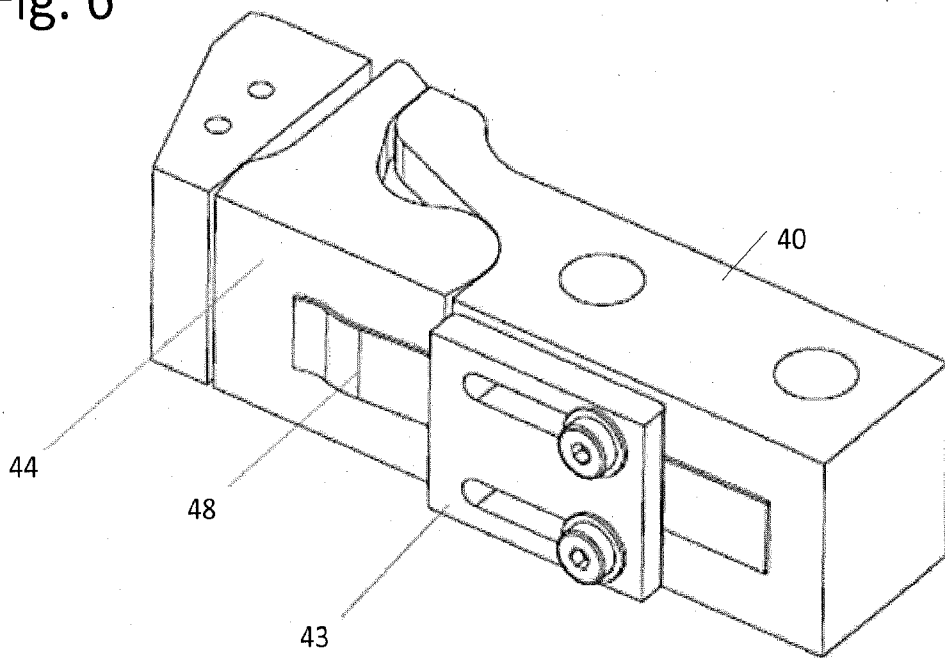

Fig. 6



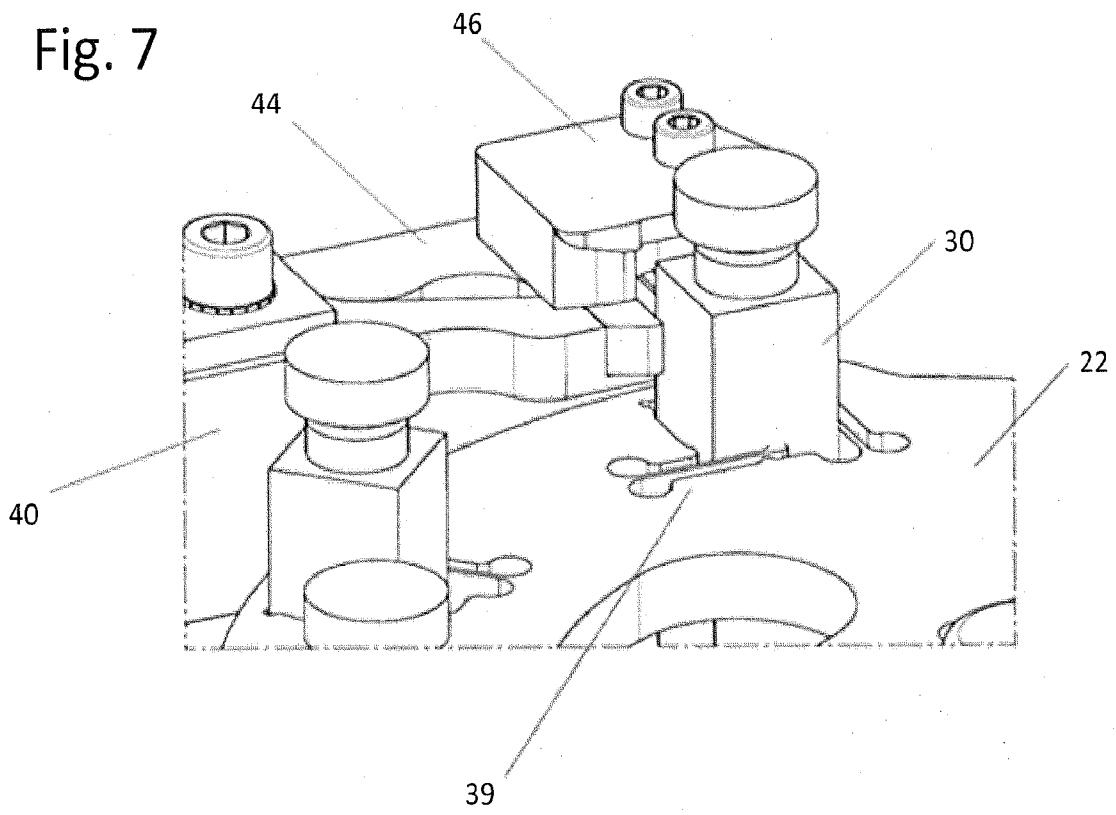
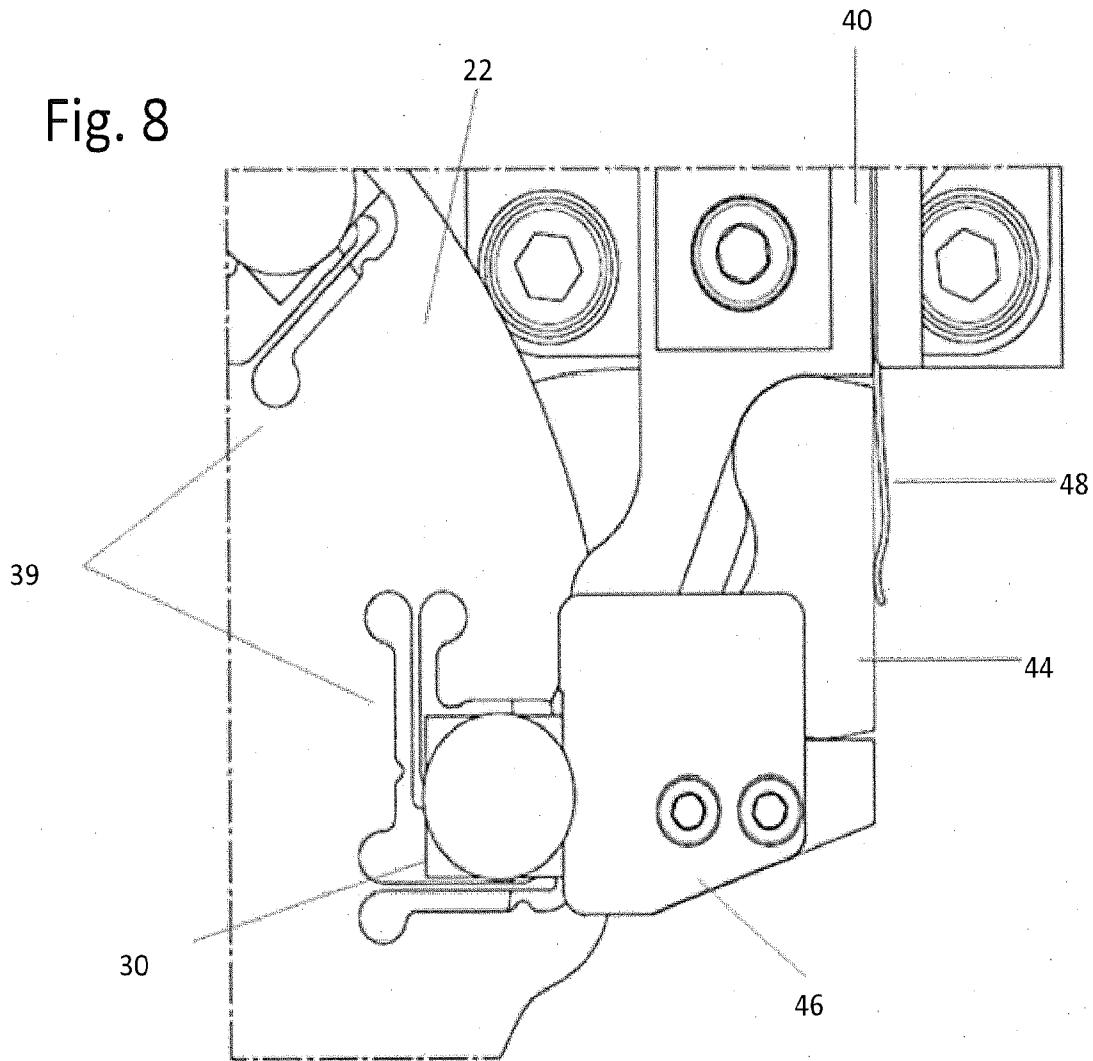

Fig. 8



INTERNATIONAL SEARCH REPORT

International application No  
PCT/US2012/063002

A. CLASSIFICATION OF SUBJECT MATTER  
INV. G01N35/02 G01N21/13  
ADD.  
According to International Patent Classification (IPC) or to both national classification and IPC

B. FIELDS SEARCHED  
Minimum documentation searched (classification system followed by classification symbols)  
G01N

Documentation searched other than minimum documentation to the extent that such documents are included in the fields searched

Electronic data base consulted during the international search (name of data base and, where practicable, search terms used)  
EPO-Internal, WPI Data

C. DOCUMENTS CONSIDERED TO BE RELEVANT

Category*	Citation of document, with indication, where appropriate, of the relevant passages	Relevant to claim No.
X	US 6 106 781 A (ROSENBERG BURKARD [CH]) 22 August 2000 (2000-08-22) the whole document	8
X	US 3 748 044 A (LISTON M) 24 July 1973 (1973-07-24)	1,2, 6-10,14, 15
A	abstract figures 5-7 column 8, line 15 - column 9, line 67	3-5, 11-13, 16-20
A	US 3 623 381 A (LAB CHOAY) 30 November 1971 (1971-11-30) claims	1-20
	----- -/--	

Further documents are listed in the continuation of Box C.

See patent family annex.

\* Special categories of cited documents :

"A" document defining the general state of the art which is not considered to be of particular relevance

"E" earlier application or patent but published on or after the international filing date

"L" document which may throw doubts on priority claim(s) or which is cited to establish the publication date of another citation or other special reason (as specified)

"O" document referring to an oral disclosure, use, exhibition or other means

"P" document published prior to the international filing date but later than the priority date claimed

"T" later document published after the international filing date or priority date and not in conflict with the application but cited to understand the principle or theory underlying the invention

"X" document of particular relevance; the claimed invention cannot be considered novel or cannot be considered to involve an inventive step when the document is taken alone

"Y" document of particular relevance; the claimed invention cannot be considered to involve an inventive step when the document is combined with one or more other such documents, such combination being obvious to a person skilled in the art

"&" document member of the same patent family

Date of the actual completion of the international search  15 February 2013	Date of mailing of the international search report  26/02/2013
---	--

Name and mailing address of the ISA/ European Patent Office, P.B. 5818 Patentlaan 2 NL - 2280 HV Rijswijk Tel. (+31-70) 340-2040, Fax: (+31-70) 340-3016	Authorized officer  Ruchaud, Nicolas
--	--

## INTERNATIONAL SEARCH REPORT

International application No  
PCT/US2012/063002

C(Continuation). DOCUMENTS CONSIDERED TO BE RELEVANT		
Category*	Citation of document, with indication, where appropriate, of the relevant passages	Relevant to claim No.
A	EP 1 227 313 A2 (FUJI PHOTO FILM CO LTD [JP]; FUJI PHOTO OPTICAL CO LTD [JP]) 31 July 2002 (2002-07-31) the whole document	1-20
A	----- WO 2006/102348 A1 (BAYER HEALTHCARE LLC [US]; ZHONG WEIPING [US]) 28 September 2006 (2006-09-28) abstract figures -----	1-20

# INTERNATIONAL SEARCH REPORT

Information on patent family members

International application No

PCT/US2012/063002

Patent document cited in search report	Publication date	Patent family member(s)	Publication date	
US 6106781	A	22-08-2000	CA 2092026 A1	07-10-1993
			DE 59300704 D1	09-11-1995
			DK 0564906 T3	27-12-1995
			EP 0564906 A1	13-10-1993
			ES 2078772 T3	16-12-1995
			GR 3018540 T3	31-03-1996
			JP 2674937 B2	12-11-1997
			JP 6043175 A	18-02-1994
			US 6106781 A	22-08-2000
			-----	
US 3748044	A	24-07-1973	NONE	
-----				
US 3623381	A	30-11-1971	BE 743049 A	14-05-1970
			CH 511171 A	15-08-1971
			DE 1962119 A1	18-06-1970
			FR 1599279 A	15-07-1970
			FR 2154991 A6	18-05-1973
			GB 1292296 A	11-10-1972
			NL 6918869 A	18-06-1970
			US 3623381 A	30-11-1971
-----				
EP 1227313	A2	31-07-2002	EP 1227313 A2	31-07-2002
			US 2002127706 A1	12-09-2002
			US 2010195107 A1	05-08-2010
-----				
WO 2006102348	A1	28-09-2006	EP 1866642 A1	19-12-2007
			US 2008164164 A1	10-07-2008
			WO 2006102348 A1	28-09-2006
-----				