

(21) Application No: 1615236.5
(22) Date of Filing: 24.03.2015
Date Lodged: 08.09.2016
(30) Priority Data:
(31) 20140415 (32) 31.03.2014 (33) US
(86) International Application Data:
PCT/NO2015/050052 En 24.03.2015
(87) International Publication Data:
WO2015/152729 En 08.10.2015

(51) INT CL:
E21B 17/02 (2006.01) E21B 17/046 (2006.01)
E21B 19/16 (2006.01)
(56) Documents Cited:
US 1054812 A US 20040207202 A1
US 20030062169 A1
(58) Field of Search:
INT CL E21B
Other: EPODOC

(71) Applicant(s):
Wellpartner AS
(Incorporated in Norway)
Energiveien 22, 4056 Tananger, Norway
(72) Inventor(s):
Haaken Christopher Heide
Kenneth Skinnes
(74) Agent and/or Address for Service:
Håmsø Patentbyrå ANS
P.O.Box 171, N-4302, Sandnes, Norway

(54) Title of the Invention: **A coupling apparatus for connecting two drill pipe sections and a method of using same**
Abstract Title: **A coupling apparatus for connecting two drill pipe sections and a method of using same**

(57) A coupling apparatus (1) and a method for connecting two drill-pipe sections in a string (100) of drill-pipe sections joined together by tool joints, the coupling apparatus (1) comprising : - a first pipe (10) with a first end portion (12) and a second end portion (14), the first end portion (12) being provided with a tool joint (16) for connection to a drill-pipe section; - a second pipe (20) with a first end portion (22) and a second end portion (24), the first end portion (22) being provided with a tool joint (26) for connection to a drill-pipe section; each of the second end portions (14, 24) of the pipes (10, 20) further being provided with a flange (18, 28) provided with at least two spaced-apart bores (30) which are each arranged to receive a bolt (32) so that the flanges (18, 28) and the bolts (32) form a flange connection configured to hold the first pipe (10) and the second pipe (20) fixed against axial movement relative to each other, each of the first pipe (10) and the second pipe (20) being provided with a mutual engagement means (34) configured to resist relative rotation thereof; and the bolts (32) are configured to rupture on a predetermined axial load.

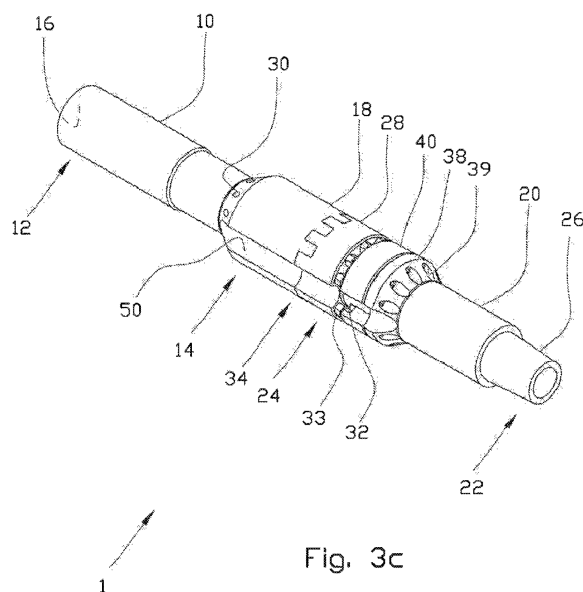

Fig. 3c