

(19) World Intellectual Property Organization
International Bureau



(43) International Publication Date
21 August 2003 (21.08.2003)

PCT

(10) International Publication Number
WO 03/069882 A1

(51) International Patent Classification⁷: H04M 11/00,
1/21, B41J 3/36, 2/125, H04Q 7/32, H04B 7/26

Kia [AU/AU]; Silverbrook Research Pty Ltd, 393 Darling Street, Balmain, New South Wales 2041 (AU).

(21) International Application Number: PCT/AU03/00169

(74) Agent: SILVERBROOK, Kia; Silverbrook Research Pty Ltd, 393 Darling Street, Balmain, New South Wales 2041 (AU).

(22) International Filing Date: 12 February 2003 (12.02.2003)

(25) Filing Language: English

(81) Designated States (national): AE, AG, AL, AM, AT, AU, AZ, BA, BB, BG, BR, BY, BZ, CA, CH, CN, CO, CR, CU, CZ, DE, DK, DM, DZ, EC, EE, ES, FI, GB, GD, GE, GH, GM, HR, HU, ID, IL, IN, IS, JP, KE, KG, KP, KR, KZ, LC, LK, LR, LS, LT, LU, LV, MA, MD, MG, MK, MN, MW, MX, MZ, NO, NZ, OM, PH, PL, PT, RO, RU, SC, SD, SE, SG, SK, SL, TJ, TM, TN, TR, TT, TZ, UA, UG, US, UZ, VC, VN, YU, ZA, ZM, ZW.

(26) Publication Language: English

(30) Priority Data:
PS 0491 13 February 2002 (13.02.2002) AU

(71) Applicant (for all designated States except US): SILVERBROOK RESEARCH PTY. LTD. [AU/AU]; 393 Darling Street, Balmain, New South Wales 2041 (AU).

(84) Designated States (regional): ARIPO patent (GH, GM, KE, LS, MW, MZ, SD, SL, SZ, TZ, UG, ZM, ZW), Eurasian patent (AM, AZ, BY, KG, KZ, MD, RU, TJ, TM), European patent (AT, BE, BG, CH, CY, CZ, DE, DK, EE,

(72) Inventor; and

(75) Inventor/Applicant (for US only): SILVERBROOK,

[Continued on next page]

(54) Title: MOBILE PHONE WITH SWIPE PRINTER

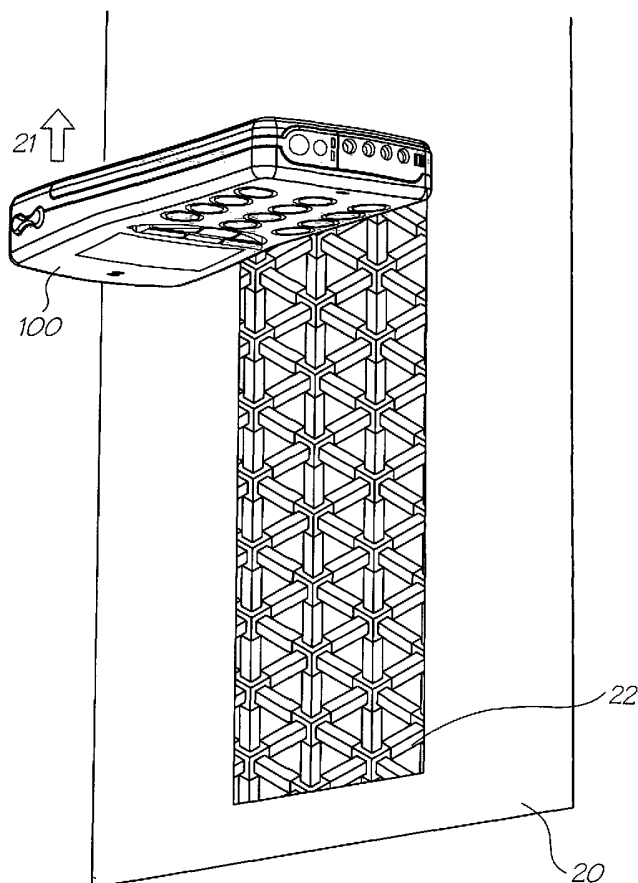

(57) Abstract: A mobile telecommunications device, such as a mobile telephone, includes an internal printer for printing on print media external to the device. A speed sensor measures the speed at which a user moves the device relative to the print media and controls the rate of ink ejection accordingly. The device may print images displayed on a display screen of the device or may print image data received through a wireless telecommunications network.



WO 03/069882 A1



ES, FI, FR, GB, GR, HU, IE, IT, LU, MC, NL, PT, SE, SI, SK, TR), OAPI patent (BF, BJ, CF, CG, CI, CM, GA, GN, GQ, GW, ML, MR, NE, SN, TD, TG).

For two-letter codes and other abbreviations, refer to the "Guidance Notes on Codes and Abbreviations" appearing at the beginning of each regular issue of the PCT Gazette.

Published:

— *with international search report*

MOBILE PHONE WITH SWIPE PRINTER

FIELD OF THE INVENTION

This invention relates to mobile telecommunications devices, in particular mobile telephones, and peripheral devices giving current mobile telephones greater functionality. Specifically, the present invention relates to mobile telephones having an internal colour printer.

BACKGROUND

In recent years, the commercially successful models of mobile telephones have been the ones which have been the most compact. The desire for small size has prevented other devices, most notably printers, from being incorporated into the housings of mobile telephones.

Prior art printers incorporate a supply of print media into the printer and employ a print media feed mechanism to transport the print media past the printhead(s) to effect printing onto the print media. It is essential during a printing operation to synchronise the speed of the print media with the printing rate of the printhead(s) to ensure a faithful reproduction of the image being printed. Heretofore, the synchronisation of the print media with the printhead(s) has been relatively simple to accomplish because the print media feed mechanism, including the supply of print media, forms an integral part of the printer. The speed of the print media is therefore known and fixed, as is the speed at which the printhead(s) and print controller operate, with synchronisation between these features being accomplished using simple mechanical features such as gears, stepper motors and the like.

Such features however, in particular the need to have a supply of print media accommodated within the printer, have made these printers larger and heavier than they otherwise need be. Even in more compact printers employing a monolithic page-width drop-on-demand printhead arrangement of the type described in the above mentioned co-pending applications, where the printhead is fixed, there is still a need to have a supply of print media and a print media drive mechanism integral to the printer to ensure proper synchronisation between ink ejection and the motion of the print media. Up until now these requirements have limited the minimum possible printer size and have precluded the possibility of a printer being incorporated into a device such as a compact mobile telephone.

CO-PENDING APPLICATIONS

Various methods, systems and apparatus relating to the present invention are disclosed in the following co-pending applications filed by the applicant or assignee of the present invention simultaneously with the present application:

AP39	AP43	AP44	AP46	AP47	AP48
AP49	AP50	AP51	AP52	AP53	AP55
AP58	AP60	AP61	AP62	AP63	AP64
AP65	AP66	AP67	AP68	AP69	AP70
AP71	AP77	AP78	AP79		

The disclosures of these co-pending applications are incorporated herein by cross-reference. Each application is temporarily identified by its file reference. This will be replaced by the corresponding PCT Application Number when available.

RELATED PATENT APPLICATIONS AND PATENTS

	US6,227,652	US6,213,588	US6,213,589	US6,231,163
	US6,247,795	US6,394,581	US6,244,691	US6,257,704
5	US6,416,168	US6,220,694	US6,257,705	US6,247,794
	US6,234,610	US6,247,793	US6,264,306	US6,241,342
	US6,247,792	US6,264,307	US6,254,220	US6,234,611
	US6,302,528	US6,283,582	US6,239,821	US6,338,547
	US6,247,796	US09/113,122	US6,390,603	US6,362,843
10	US6,293,653	US6,312,107	US6,227,653	US6,234,609
	US6,238,040	US6,188,415	US6,227,654	US6,209,989
	US6,247,791	US6,336,710	US6,217,153	US6,416,167
	US6,243,113	US6,283,581	US6,247,790	US6,260,953
	US6,267,469	US6,273,544	US6,309,048	US6,420,196
15	US6,443,558	US09/422,892	US6,378,989	US09/425,420
	US09/422,893	US09/609,140	US6,409,323	US6,281,912
	US09/575,113	US6,318,920	US6,488,422	US09/693,644
	US6,457,810	US6,485,135	US09/112,763	US6,331,946
	US6,246,970	US6,442,525	US09/505,951	US09/505,147
20	US09/505,952	US09/575,108	US09/575,109	US09/575,110
	US09/607,985	US6,398,332	US6,394,573	US09/606,999
	US6,238,044	US6,425,661	US6,390,605	US6,322,195
	US09/504,221	US6,480,089	US6,460,778	US6,305,788
	US6,426,014	US6,364,453	US6,457,795	US09/556,219
25	US09/556,218	US6,315,399	US6,338,548	US09/575,190
	US6,328,431	US6,328,425	US09/575,127	US6,383,833
	US6,464,332	US6,390,591	US09/575,152	US6,328,417
	US6,322,194	US09/575,177	US09/575,175	US6,417,757
	US09/608,780	US6,428,139	US09/607,498	US09/693,079
30	US09/693,135	US6,428,142	US09/692,813	US09/693,319
	US09/693,311	US6,439,908	US09/693,735	PCT/AU98/00550
	PCT/AU00/00516	PCT/AU00/00517	PCT/AU00/00511	PCT/AU00/00754
	PCT/AU00/00755	PCT/AU00/00756	PCT/AU00/00757	PCT/AU00/00095
	PCT/AU00/00172	PCT/AU00/00338	PCT/AU00/00339	PCT/AU00/00340
35	PCT/AU00/00341	PCT/AU00/00581	PCT/AU00/00580	PCT/AU00/00582
	PCT/AU00/00587	PCT/AU00/00588	PCT/AU00/00589	PCT/AU00/00583
	PCT/AU00/00593	PCT/AU00/00590	PCT/AU00/00591	PCT/AU00/00592
	PCT/AU00/00584	PCT/AU00/00585	PCT/AU00/00586	PCT/AU00/00749
	PCT/AU00/00750	PCT/AU00/00751	PCT/AU00/00752	PCT/AU01/01332
40	PCT/AU01/01318	PCT/AU00/01513	PCT/AU00/01514	PCT/AU00/01515

	PCT/AU00/01516	PCT/AU00/01517	PCT/AU00/01512	PCT/AU01/00502
	PCT/AU02/01120	PCT/AU00/00333	PCT/AU01/00141	PCT/AU01/00139
	PCT/AU01/00140	PCT/AU00/00753	PCT/AU01/01321	PCT/AU01/01322
	PCT/AU01/01323	PCT/AU00/00594	PCT/AU00/00595	PCT/AU00/00596
5	PCT/AU00/00597	PCT/AU00/00598	PCT/AU00/00741	PCT/AU00/00742

SUMMARY OF THE INVENTION

According to one aspect of the present invention there is provided a mobile telecommunications device comprising a casing, a display, circuitry for wireless telecommunications housed within the casing and a printer housed within the casing, the printer comprising:

10 a printhead arrangement adapted to effect printing onto print media as the printer is moved relative to the print media, the printhead arrangement including a plurality of ink ejection nozzles;

an ink supply adapted to store ink and to supply the ink to the printhead arrangement;

a speed sensor adapted to measure the speed at which the printhead arrangement is moved relative to the print media and to generate speed data; and

15 a print controller adapted to:

(a) receive image data from an image source;

(b) convert the image data into a plurality of drop ejection control signals;

(c) receive the speed data from the speed sensor; and

20 (d) operate the ink ejection nozzles in the printhead arrangement in accordance with the drop ejection control signals at a rate determined using the speed data, to thereby effect printing of the image data onto the print media.

Preferably, the speed sensor comprises:

25 an optical encoder wheel adapted to be in contact with the print media and to rotate as the device is moved relative to the print media, the optical encoder wheel having a series of circumferentially spaced markings thereon; and

an optical sensor adapted to:

(a) detect the markings as the markings pass the optical sensor during rotation of the optical encoder wheel; and

(b) generate the speed data from the detected markings.

30 Preferably, the ink supply is removable from the printer.

Preferably, the device further comprises a capping arrangement moveable between a capped position in which the capping arrangement substantially obstructs the ejection of ink from the ink ejection nozzles and

an un-capped position in which the capping arrangement does not substantially obstruct the ejection of ink from the ink ejection nozzles.

Preferably, the device further comprises a capping actuator disposed on the device so as to be operable by a user as the user moves the printhead arrangement relative to the print media.

5 Preferably, the device further comprises a biasing member adapted to bias the capping arrangement towards the capped position.

Preferably, the print controller receives the image data from the image source via the circuitry for wireless telecommunications. More preferably, the image data is received at the circuitry for wireless telecommunications from a wireless telecommunications network.

10 Preferably, the device further comprises a memory adapted to store the image data.

Preferably, the image to be printed is displayed on the device display.

Preferably, the printer further comprises a replaceable ink cartridge.

Preferably, the device further comprises one or more ink inlets through which the ink supply may be replenished.

15 Preferably, the device further comprises a digital camera including a lens and CCD array, and wherein image data captured by the CCD array is displayed on the display of the telecommunications device.

Preferably, the printer is adapted to print images captured by the digital camera.

BRIEF DESCRIPTION OF THE DRAWINGS

20 The invention will now be described by way of example only with reference to preferred embodiments and to the accompanying drawings in which:-

Figure 1 shows a perspective view of a mobile telecommunications device with an in-built printer in use, printing an image onto a page of print media;

Figure 2 is an exploded perspective view of a printer used in the mobile telecommunications device;

Figure 3 is a top perspective view of the printer;

25 Figure 4 is an underside perspective of the printer;

Figure 5 is a front perspective view of a mobile telephone having an internal printer;

Figure 6 is a rear perspective of the mobile telephone;

Figure 7 is an exploded perspective view of the mobile telephone;

Figure 8 is a rear elevational view of a mobile telephone with an in-built digital camera;

30 Figure 9 is a side elevational view of the mobile telephone of Figure 5;

Figure 10 is a rear elevational view of the mobile telephone of Figure 5;

Figure 11 is a plan view of the mobile telephone of Figure 5; and

Figure 12 is a transverse cross-section of the mobile telephone of Figure 5.

DESCRIPTION OF PREFERRED EMBODIMENTS

5 Referring to Figure 1, a mobile telecommunications device according to the present invention is shown generally at 100. The telecommunications device 100 is a mobile telephone having an internal printer and is depicted in Figure 1 as moving, under the guidance of a user (not shown), across a page 20 of print media in the direction of the arrow 21 to print an image 22 on the page 20.

10 With reference to Figures 5 and 6, the mobile telephone 100 includes standard features such as a keypad 101, navigation keys 102, display screen 103, volume buttons 104, speaker 105 and microphone 106. The telephone also includes charging contacts 107, power socket 108 and hands free jack 109. A printer unit 10 is received through an opening in the side of the telephone casing.

15 An exploded view of the telephone 100 is illustrated in Figure 7. Assembled views are shown in Figures 8 to 11. With reference to these figures, the telephone includes an upper moulding 301, base moulding 302 and cover moulding 303. The upper moulding 301 has a first series of apertures 306 that receive keypad and navigation keys from an elastomeric keypad 308. A second aperture 309 receives a lens moulding 310.

20 A rigid printed circuit board (PCB) 312 is held firmly between the upper moulding 301 and base moulding 302. As is known, the PCB 312 contains the majority of the telephone circuitry, in particular a speaker 313, colour LCD display 314 and an aerial 315. A SIM card 316 containing ID codes and command circuitry as is known in the art is received in an internal aperture 319 in the base moulding 302 and electrically communicates with the PCB 312 in a known manner.

25 The base moulding 302 has a recess 321 in its upper surface that receives the PCB 312 and aerial 315. A cut-away section is provided in the lower portion of the base moulding 302 to receive a standard mobile telephone battery 322 and the printer unit 10, further details of which are described below.

The base moulding 302 further includes charging contact apertures 323, power socket aperture 324 and hands free jack aperture 325.

30 The cover moulding 303 removably fits with the base moulding 302 to provide an access to the battery 322 and SIM card 316.

Details of the printer unit 10 will now be described with reference to Figures 2 to 4. Although Figures 2 to 4 depict a stand-alone swipe printer, having a slightly different shape from the printer depicted in Figure 7, those skilled in the art will appreciate that many of the features of the two printers are common and need not be described with specific reference to this mobile telecommunications device version of the printer.

An exploded view of the printer 10 is shown in Figure 2. The printer 10 includes a lower moulding 11, upper moulding 12 and removable end cap 13 each of which may be formed of any suitable plastics, metal or similar material.

5 The upper and lower mouldings each include media slides 14 formed at each end of the mouldings on the bottom surface thereof. The slides 14 protrude from the bottom surface of the mouldings and serve to elevate the printer as the printer traverses the print media resulting in minimal friction between the printhead and print media and preventing contact between the printer and freshly printed ink which could otherwise disturb the printed image.

10 When joined, the upper and lower mouldings reveal an ink ejection slot through which ink is ejected during printing. A capping device 50, preferably of metal is received in a recess 17 formed in the upper moulding 12. The capping device 50, moves from a position in which a capping arm 52 of the capper 50 blocks the ink ejection slot 15 to a position where ink ejection is unrestricted.

15 Internally, the printer 10 includes a printhead module 30 in which is disposed a plurality of ink distribution channels leading to an array of ink ejection nozzles 31 aligned with the ink ejection slot 15 formed between the upper and lower mouldings 12, 11. An ink supply cartridge 32 stores coloured inks, preferably in four colours namely cyan, magenta, yellow and black, to provide for full colour printing. Alternatively, or in addition, infra-red ink may be provided. The ink cartridge 32 supplies ink to the ink distribution channels of the printhead module 30 through an ink connector 33.

20 Any one of a number of known printhead modules and ink supply systems may be suitable for use with the present invention and thus further description of such features is omitted here. Details of printhead modules and ink supply systems suitable for use with the invention can be found in the above-mentioned co-pending applications of the present applicant.

25 A print controller 36 includes a microprocessor that converts image data stored in microprocessor memory into a sequence of electrical "drop ejection" signals. The signals are communicated to the printhead module 30 in a known manner during a print operation to cause selective ejection of ink from the ink ejection nozzles 31.

The print control microprocessor 36 communicates with the circuitry of the PCB 312 to receive print instructions and digital image data.

30 When the printer unit 10 is properly engaged in the mobile telephone 100, power contacts of the printer unit (not shown) connect with the power supply circuits of the mobile telephone.

As illustrated in Figure 3, the end cap 13 is removable from the printer 10 to reveal an aperture 47 through which the ink cartridge may be replaced.

35 To perform printing, a user commands the printer using the navigation keys 102 and actuates the capper 50, in a manner described below, to expose the printhead chip 30 (Figure 4) to the print media. The print media may be any suitable textile for receiving the type of ink stored in the printer and may include *inter alia* paper, cardboard, wood, fabric and plastics. The telephone 100 may include a control button depressed

by the user to initiate printing (that is, to commence the ejection of ink from the printhead under the control of the print control microprocessor.) Alternatively, actuation of the capper 16 may be detected as a signal that the user is ready for the printing to commence. The user then traverses the print media 20 with the telephone 100 as illustrated in Figure 1.

5 To control the printing rate, the printer 10 includes an optical encoder wheel 39 (Figure 2) attached to the printhead module 30 at one end thereof. The optical encoder wheel 39 is received in slots 41a, 41b formed in the upper and lower mouldings respectively and extends from the mouldings to the point where the rim of the wheel 39 is level with the media slides 14 (see Figure 4). Circumferentially spaced markings on the optical encoder wheel 39 are read by an optical sensor on the microprocessor 36 as the wheel 39 rotates in
10 contact with the print media.

The optical sensor includes a light source, such as an LED, and a photo-detector that produces an electrical response dependent upon the amount of light incident upon the detector. The light reflection characteristics of the encoder wheel 39 vary between the marked and un-marked areas and thus as the markings rotate past the detector, a change in the detector response occurs. The frequency at which the
15 detector response changes provides a measurement of the speed at which the encoder wheel is rotating and therefore the speed at which the telephone is moving relative to the print media.

The detector response is communicated to the print control microprocessor 36 which uses the signal to calculate the speed at which the printhead module is being moved across the print media. The print controller then synchronises the rate at which the drop ejection control signals are passed to the ink ejection
20 nozzles with the measured speed of the printer. The printer 10 is therefore able to ensure appropriate print dot spacing of successive lines of print and thus create a faithful reproduction of the printed image even though the printer does not control the speed at which the print media moves relative to the printhead.

Furthermore, if the number of markings on the encoder wheel 39 is high enough, the microprocessor 36 is able to quickly adapt to the variations in the speed at which a user may move the printer across the print
25 media thereby achieving a higher quality image.

An idler wheel 44 is attached to the opposite end of the printhead module 30 to allow stability and directional control of the printer. A shaft may connect the idler wheel 44 with the encoder wheel 39 to synchronise the rotation speeds of each wheel.

The optical encoder wheel 39 and/or idler wheel 44 may have a speed limiter such as a friction clutch
30 that prevents a user from moving the printer along the print media at a rate faster than the maximum rate of operation of the printhead module 30. Furthermore, either or both wheels may have a system such as a ratchet for preventing the printer from being moved in a direction opposite to the direction of printing.

In the embodiment shown, digital image data may be provided to the microprocessor 36 from an external image source via a wireless telecommunications network and received via the antenna 315 and PCB
35 312.

Alternatively, the digital image data may be received from an external device such as a computer using an infra-red (IR) signal transmitted through an IR window formed in the casing of the mobile telephone. In such an embodiment an IR receiver electrically connected to the microprocessor 36 receives the data which is then stored in the processor memory. In alternative embodiments (not shown), the microprocessor may communicate through any other suitable connection for example, hard wire connections to other electronic devices (such as computers, scanners, copiers, digital cameras), wireless telecommunications (such as WAP) or through a plug and socket connection or data port. Other information, for example print control instructions, may also be provided to the printer from external devices using the above systems. In a further embodiment, the microprocessor may have its own graphics generating capabilities.

10 For example, as depicted in Figure 8, the mobile telephone 100 may have an in-built camera module. In this embodiment, a lens 401 is formed in the base moulding 302. Light passing through the lens 401 is incident on a CCD array. The CCD array communicates a digital image to the print control microprocessor for printing. Camera operation keys are incorporated into the keypad 102 of the telephone.

15 In the embodiment described herein, the printer unit 10 includes a replaceable ink cartridge. As an alternative, the mobile telephone 100 may be provided with an integral ink reservoir that is re-charged with ink from an ink charging stand using an ink charging system, further details of which are provided in the present applicant's co-pending applications (Attorney Docket numbers AP52 and AP53) cross-referenced above. An ink charging system of the type referred to above utilises ink inlets 327 of the print unit 10 as seen in Figures 5 and 7. By using an ink charging system of the type referred to, the printer unit 10 need not be as readily removable as would otherwise be necessary because removal of the printer unit 10 will only be required for maintenance of the printhead.

20 Figure 12 is a transverse cross section of the mobile telephone 100 of Figure 5. In this figure, there is shown a capping mechanism 50 of the type described in the present applicant's co-pending application (Attorney Docket No AP44) cross-referenced above. The capping mechanism is mounted on the printer unit 10 in a manner that allows movement of a capping arm 52 from a position in which the capping arm 52 obstructs the ejection of ink from the printhead chip 30 to a position as illustrated where ejection of ink from the printhead chip 30 is uninhibited.

25 Actuation of the capping mechanism 50 to its uncapped position can occur in any suitable manner, including but not limited to those examples described in the applicant's co-pending application (Attorney Docket No AP44) cross-referenced above. For example, actuation of the capper may occur using a friction clutch operating in conjunction with the encoder wheel 39, a solenoid actuator, or a finger-operated actuator exposed through the casing of the mobile telephone 100.

30 The configuration of the printhead module and ink reservoir within the telephone casing may be varied to suit the particular model and styling of the telephone. The embodiments described previously utilise a side-edge printhead with an integral recharging ink reservoir.

35 Alternative embodiments include configurations where the printhead is exposed through a bottom or top edge of the telephone casing and has either integral or replaceable ink cartridges as required.

While the invention has been described with particular reference to mobile telephones, it will be apparent to the person skilled in the art that the invention is suitable for application in many other portable electronic devices, including but not limited to, Wireless Internet Access Devices (WIADs) in particular Wireless Application Protocol (WAP) terminals, pagers, Personal Digital Assistants (PDAs) and the like.

5 While particular embodiments of this invention have been described, it will be evident to those skilled in the art that the present invention may be embodied in other specific forms without departing from the essential characteristics thereof. The present embodiments and examples are therefore to be considered in all respects as illustrative and not restrictive, the scope of the invention being indicated by the appended claims rather than the foregoing description, and all changes which come within the meaning and range of
10 equivalency of the claims are therefore intended to be embraced therein.

WE CLAIM:

1. A mobile telecommunications device comprising a casing, a display, circuitry for wireless telecommunications housed within the casing and a printer housed within the casing, the printer comprising:

5 a printhead arrangement adapted to effect printing onto print media as the printer is moved relative to the print media, the printhead arrangement including a plurality of ink ejection nozzles;

an ink supply adapted to store ink and to supply the ink to the printhead arrangement;

a speed sensor adapted to measure the speed at which the printhead arrangement is moved relative to the print media and to generate speed data; and

a print controller adapted to:

10 (a) receive image data from an image source;

(b) convert the image data into a plurality of drop ejection control signals;

(c) receive the speed data from the speed sensor; and

15 (d) operate the ink ejection nozzles in the printhead arrangement in accordance with the drop ejection control signals at a rate determined using the speed data, to thereby effect printing of the image data onto the print media.

2. The device of claim 1 wherein the speed sensor comprises:

an optical encoder wheel adapted to be in contact with the print media and to rotate as the device is moved relative to the print media, the optical encoder wheel having a series of circumferentially spaced markings thereon; and

20 an optical sensor adapted to:

(a) detect the markings as the markings pass the optical sensor during rotation of the optical encoder wheel; and

(b) generate the speed data from the detected markings.

25 3. The device of claim 1 wherein the ink supply is removable from the printer.

4. The device of claim 1 further comprising a capping arrangement moveable between a capped position in which the capping arrangement substantially obstructs the ejection of ink from the ink ejection nozzles and an un-capped position in which the capping arrangement does not substantially obstruct the
30 ejection of ink from the ink ejection nozzles.

5. The device of claim 4 further comprising a capping actuator disposed on the device so as to be operable by a user as the user moves the printhead arrangement relative to the print media.
6. The device of claim 4 further comprising a biasing member adapted to bias the capping arrangement
5 towards the capped position.
7. The device of claim 1 wherein the print controller receives the image data from the image source via the circuitry for wireless telecommunications.
- 10 8. The device of claim 7 wherein the image data is received at the circuitry for wireless telecommunications from a wireless telecommunications network.
9. The device of claim 1 further comprising a memory adapted to store the image data.
- 15 10. The device of claim 1 wherein the image to be printed is displayed on the device display.
11. The device of claim 1 wherein the printer further comprises a replaceable ink cartridge.
12. The device of claim 1 further comprising one or more ink inlets through which the ink supply may be
20 replenished.
13. The device of claim 1 further comprising a digital camera including a lens and CCD array, and wherein image data captured by the CCD array is displayed on the display of the telecommunications device.
- 25 14. The device of claim 13 wherein the printer is adapted to print images captured by the digital camera.

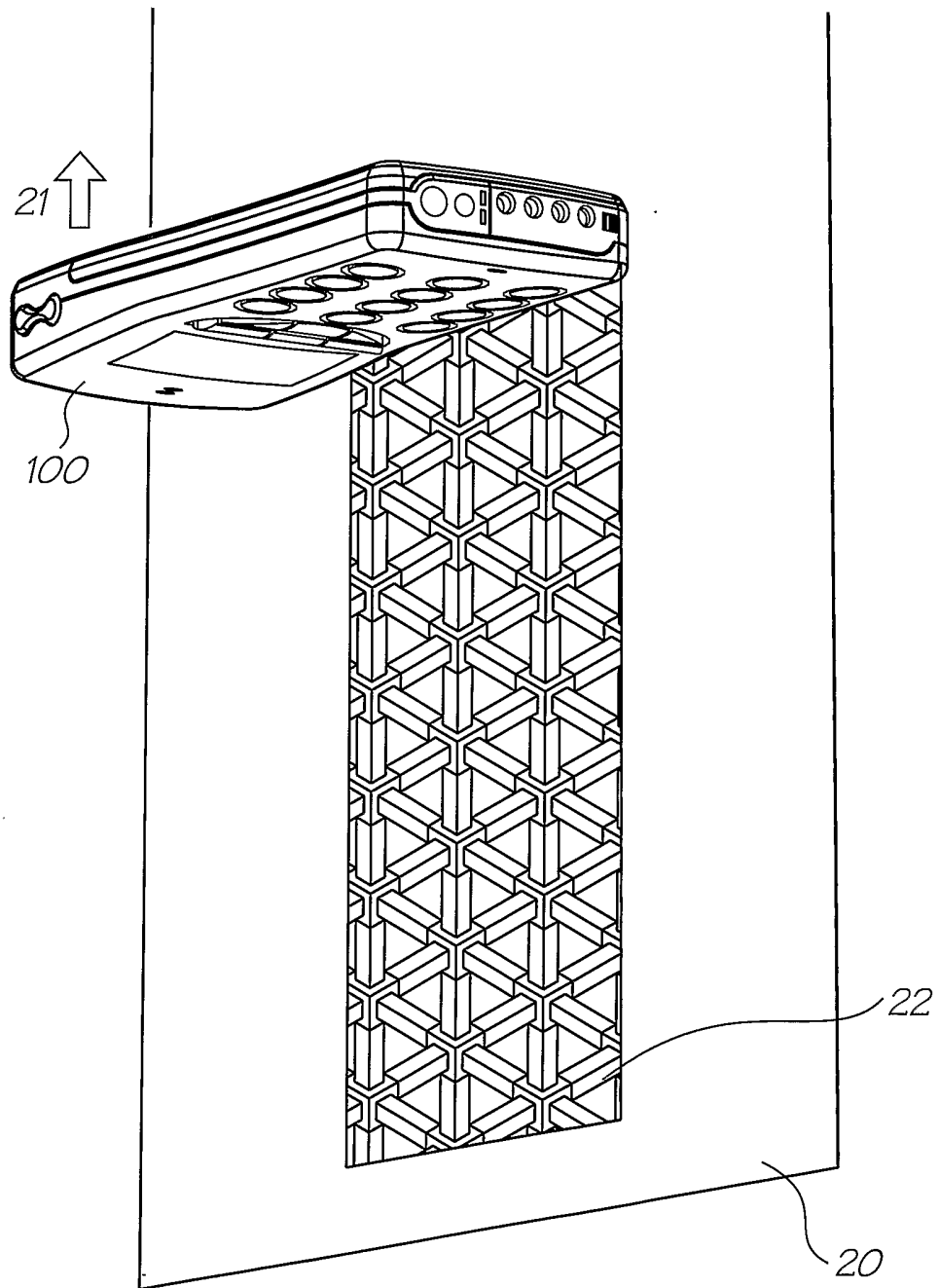

FIG. 1

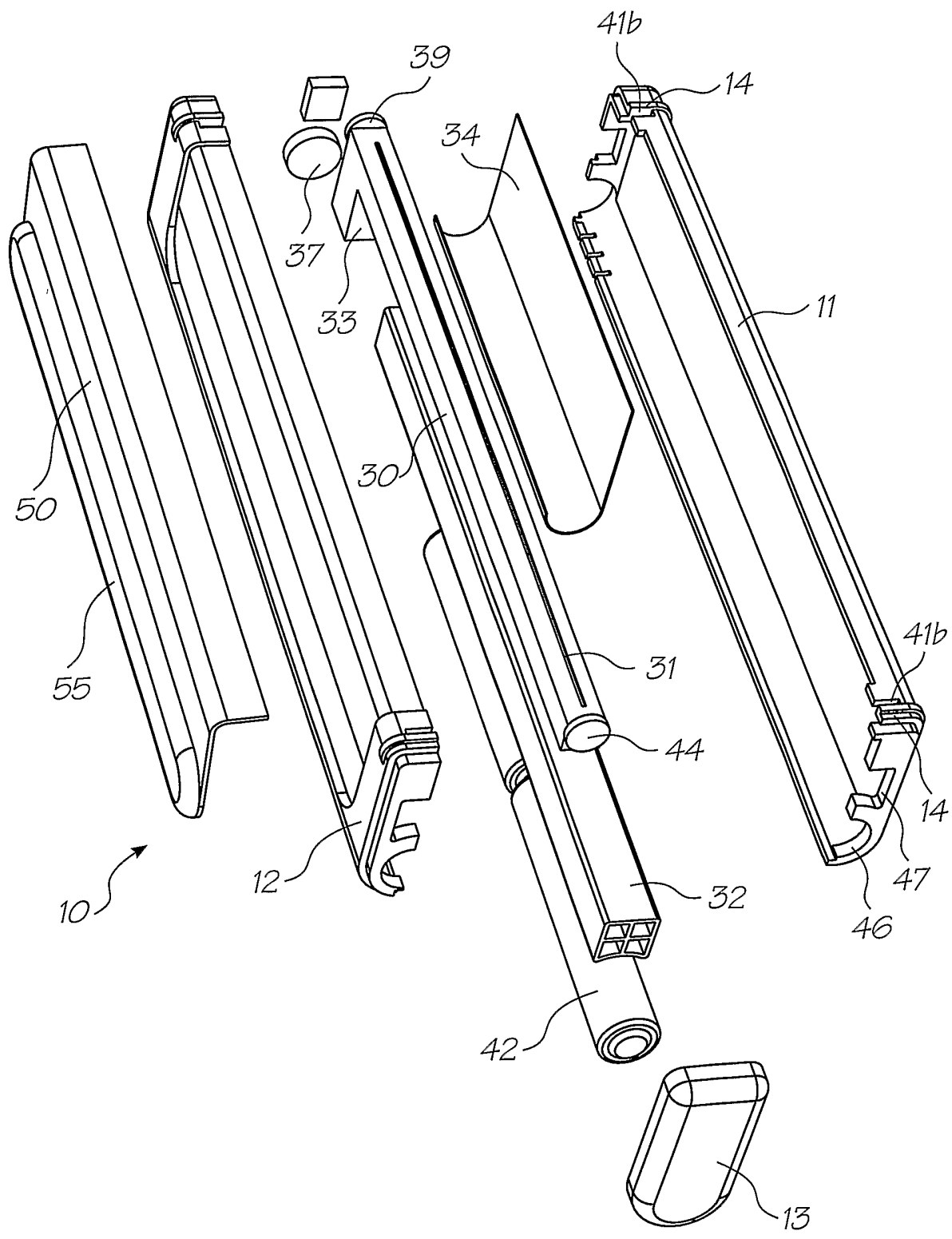

FIG. 2

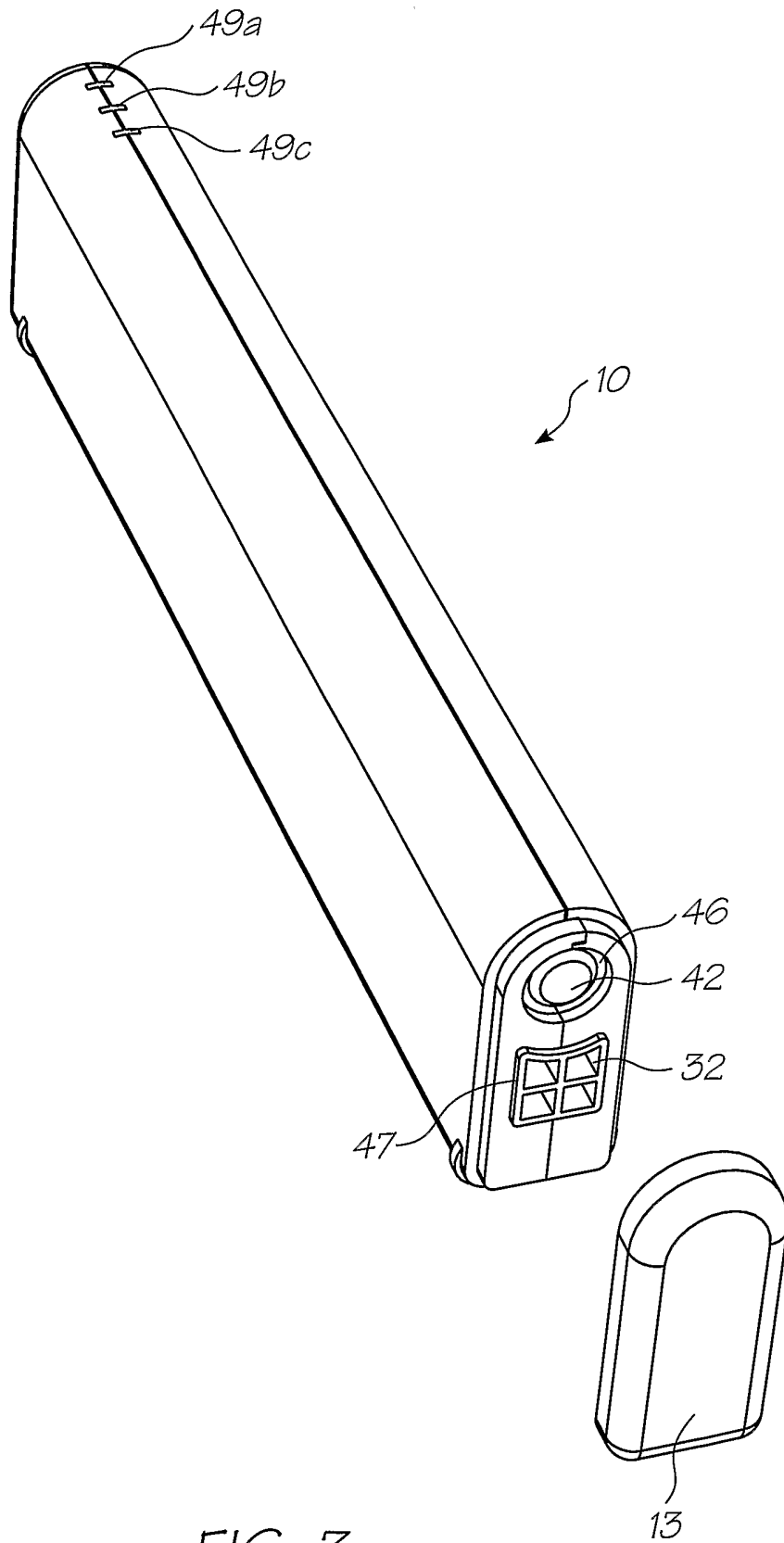

FIG. 3

4/10

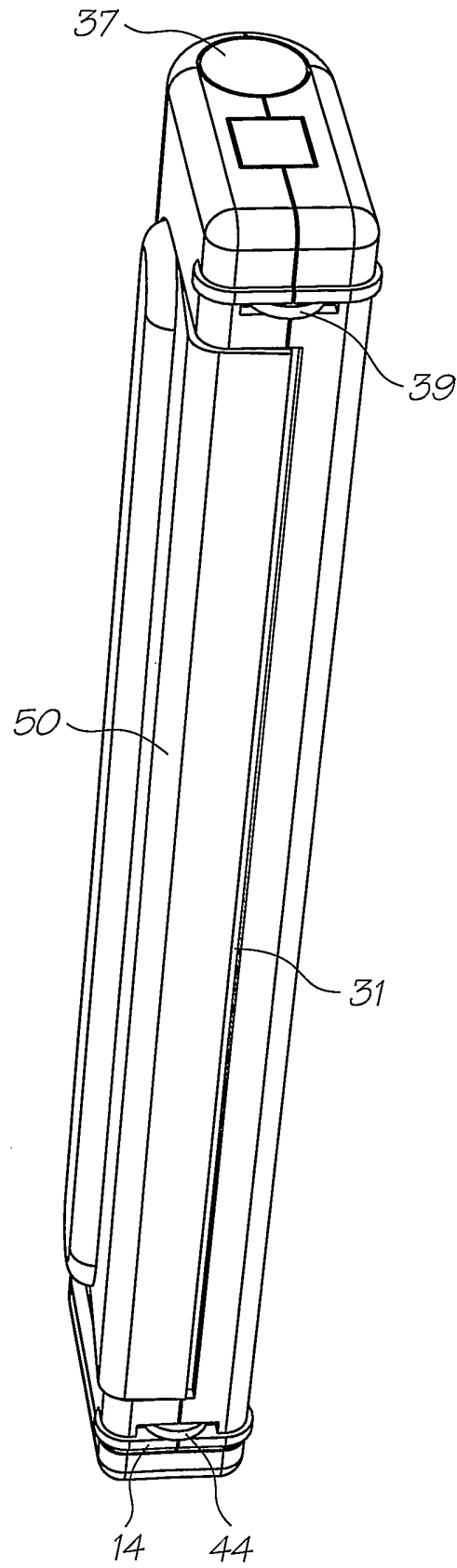

FIG. 4

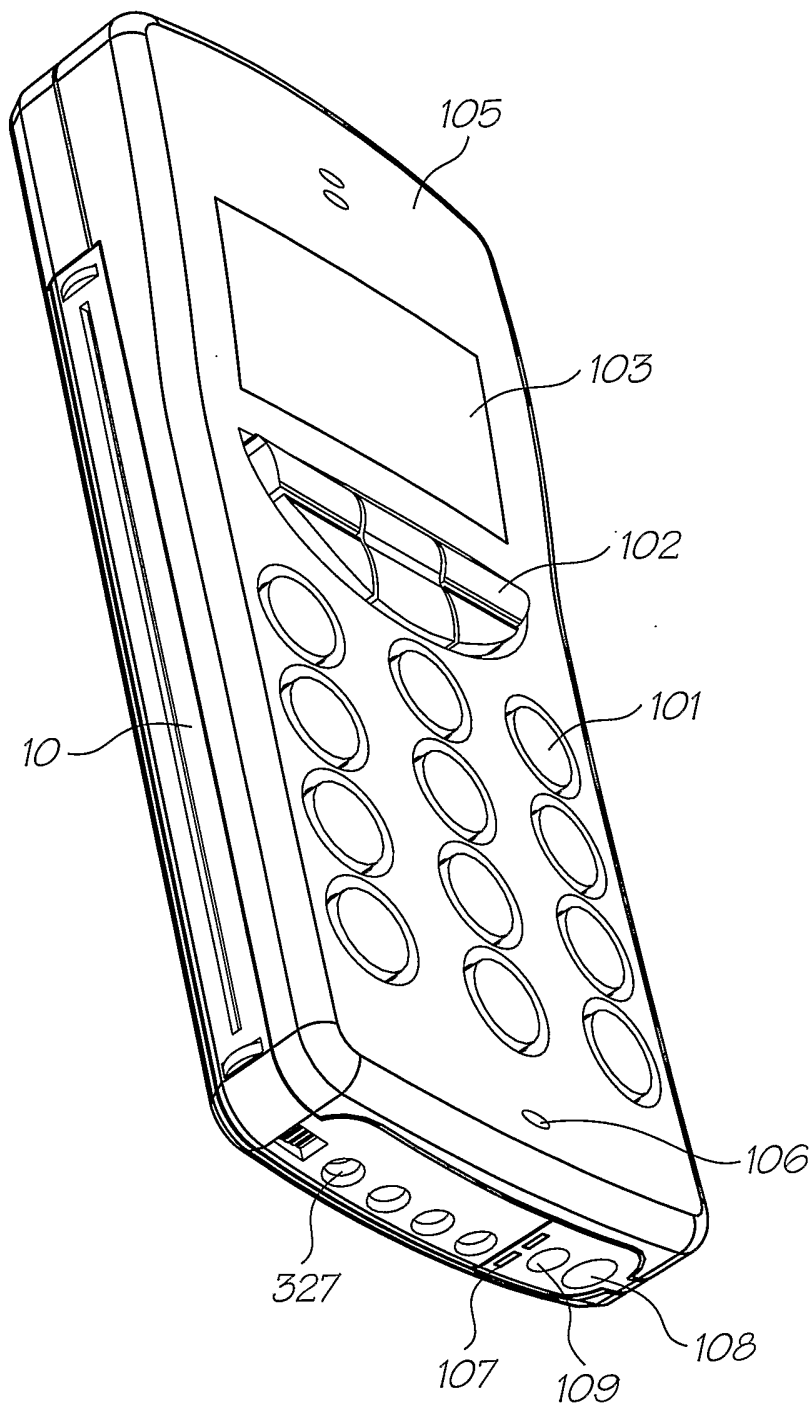

FIG. 5

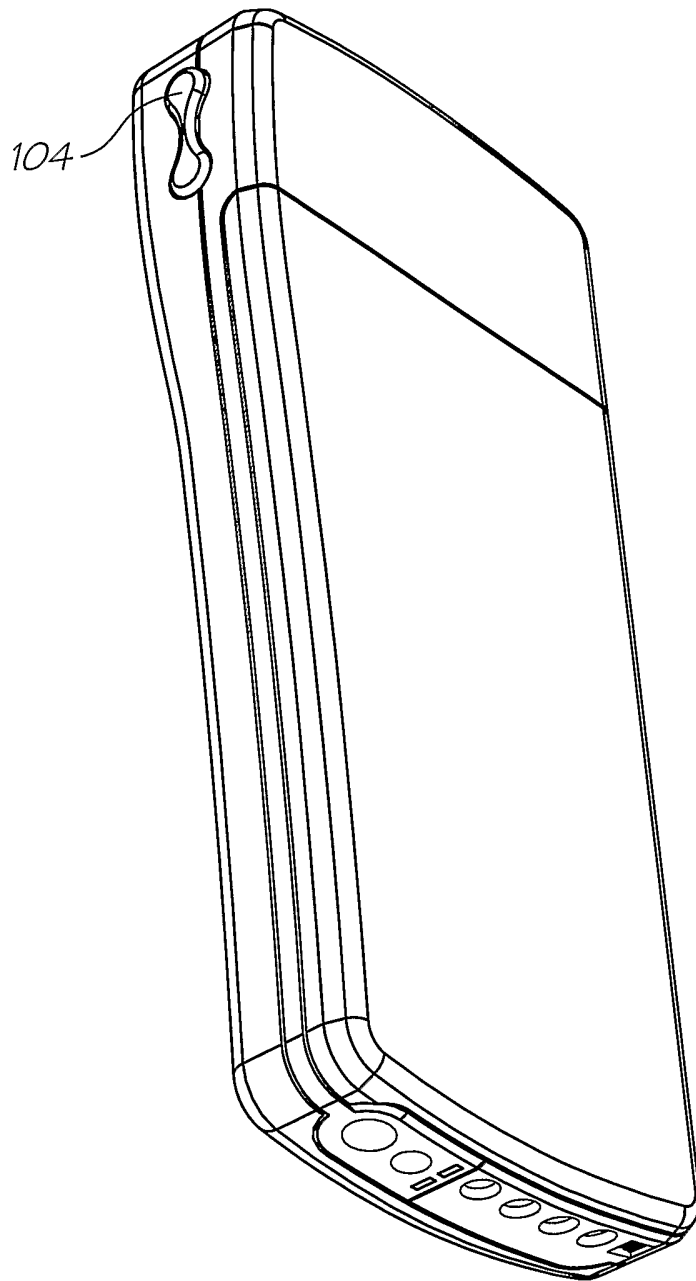

FIG. 6

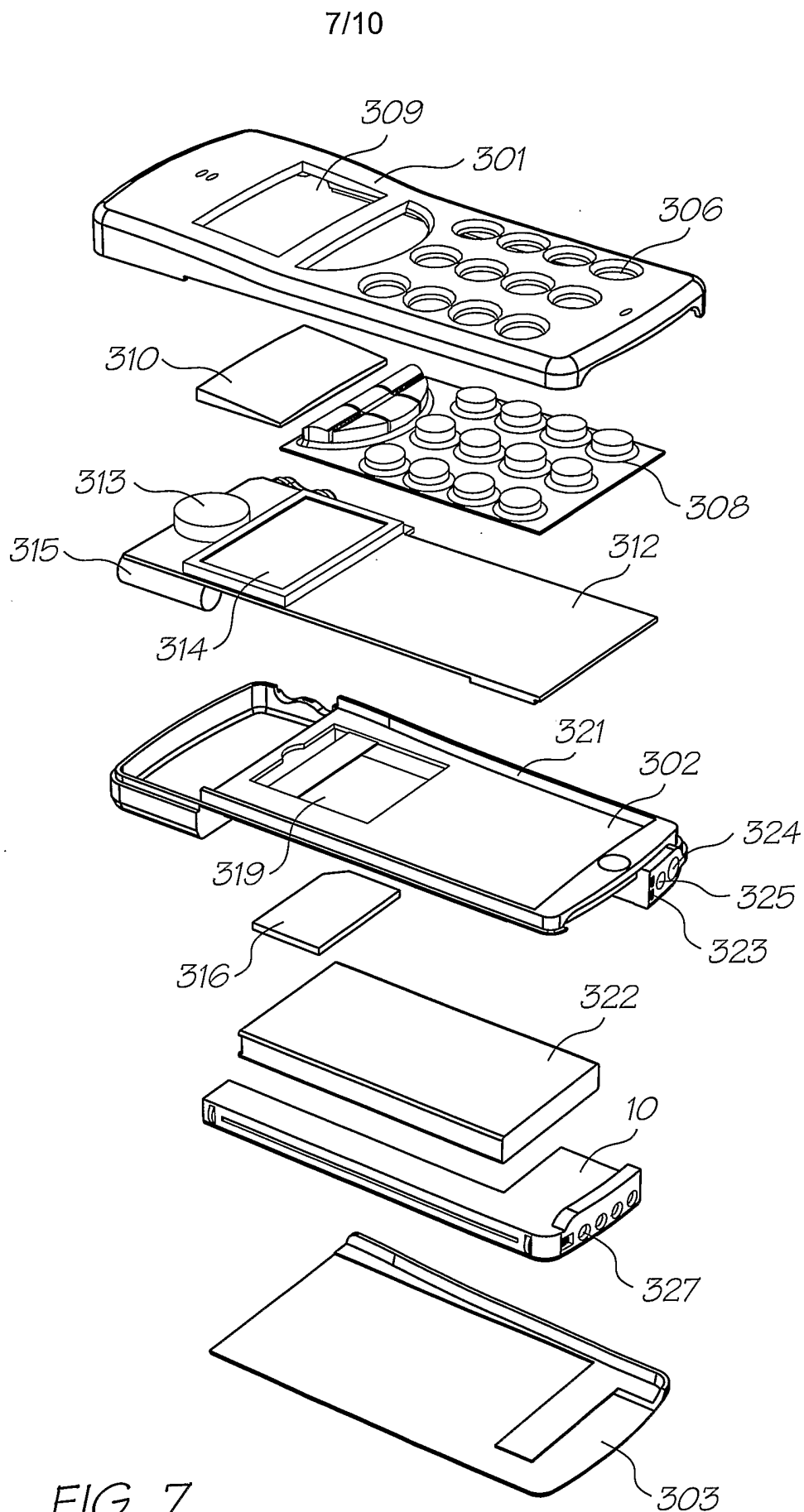

FIG. 7

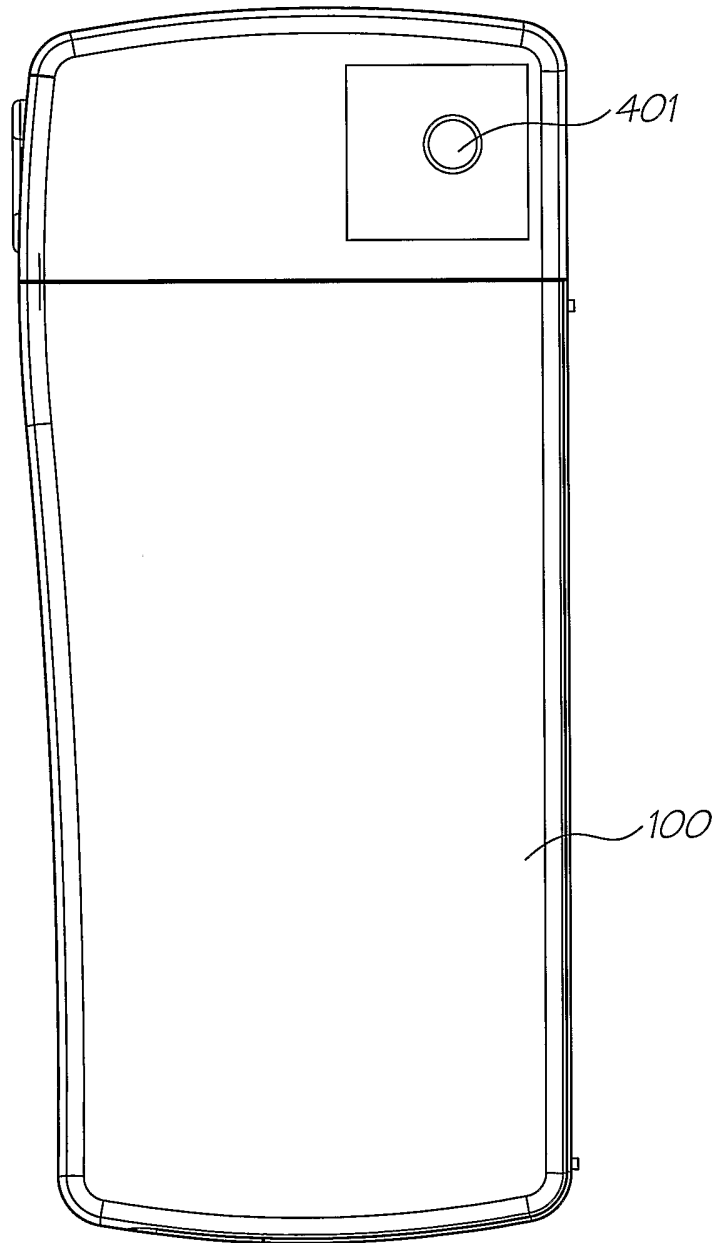

FIG. 8

9/10

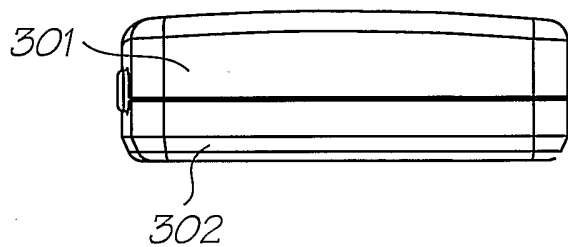

FIG. 11

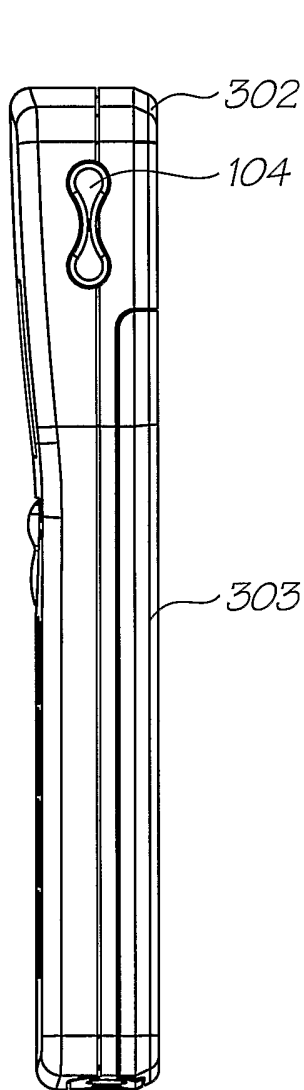

FIG. 9

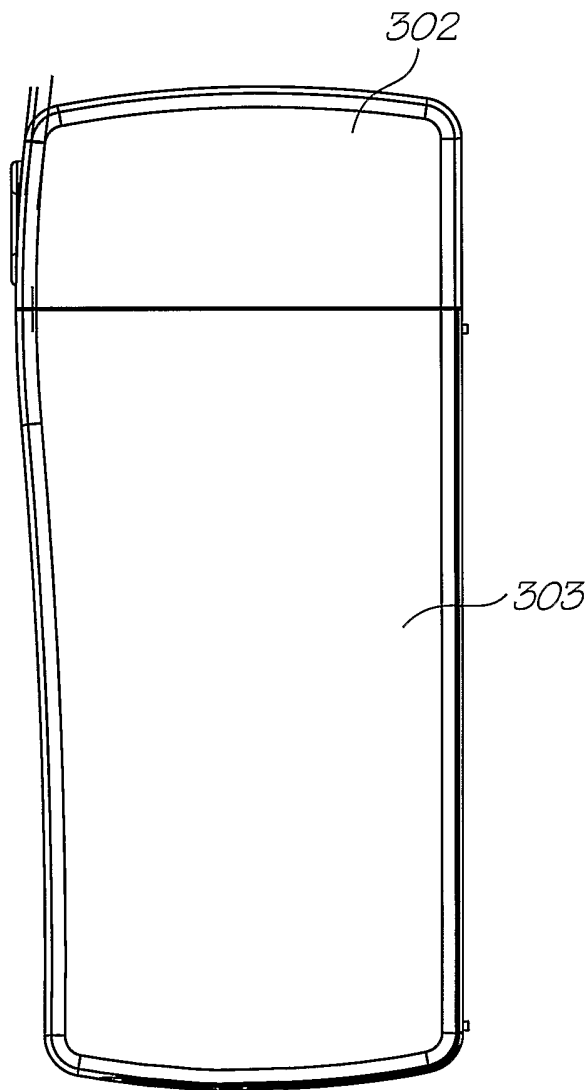

FIG. 10

10/10

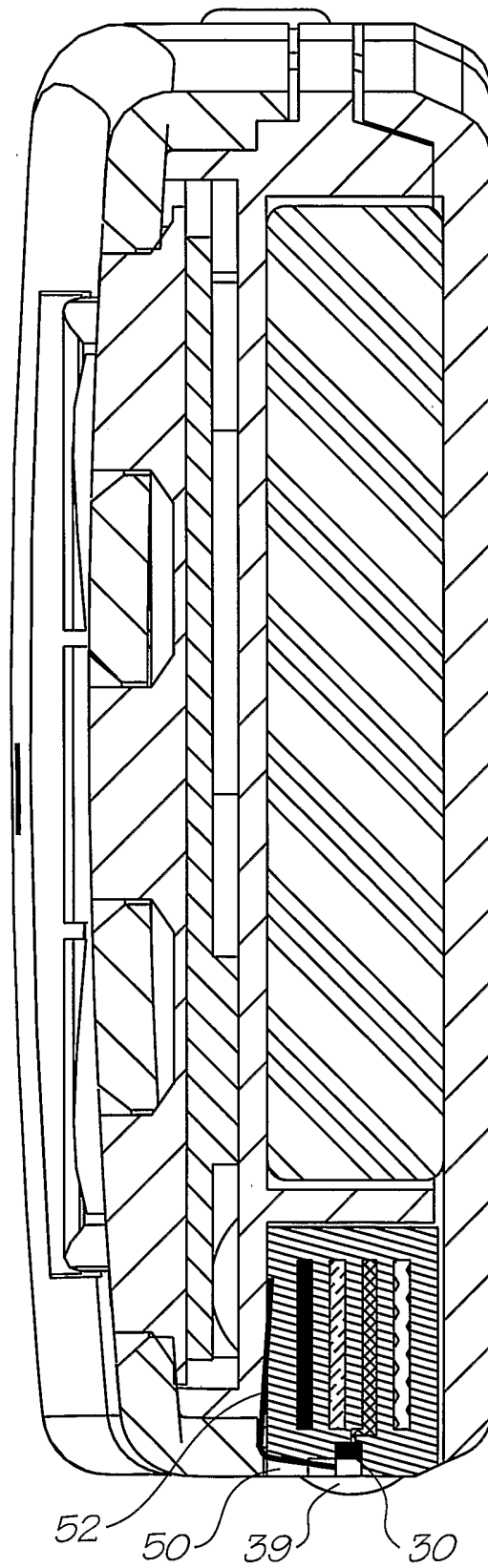

FIG. 12

INTERNATIONAL SEARCH REPORT

International application No.
PCT/AU03/00169

A. CLASSIFICATION OF SUBJECT MATTER		
Int. Cl. ⁷ : H04M 11/00, 1/21, B41J 3/36, 2/125, H04Q 7/32, H04B 7/26		
According to International Patent Classification (IPC) or to both national classification and IPC		
B. FIELDS SEARCHED		
Minimum documentation searched (classification system followed by classification symbols)		
Documentation searched other than minimum documentation to the extent that such documents are included in the fields searched		
Electronic data base consulted during the international search (name of data base and, where practicable, search terms used) WPAT Keywords: mobile,cell+, pda, +communication+, +phone+, device+, print+, speed and similar terms		
C. DOCUMENTS CONSIDERED TO BE RELEVANT		
Category*	Citation of document, with indication, where appropriate, of the relevant passages	Relevant to claim No.
X Y	DE 444295 A (SIEMENS AG) 20 June 1996 whole document	1 1-14
Y	Patent Abstracts of Japan, JP 2002-016679 (KONICA CORP) 18 January 2002 abstract	1-14
Y	WO 01/41480 A (SILVERBROOK RESEARCH PTY LTD) 7 June 2001 whole document	1-14
<input checked="" type="checkbox"/> Further documents are listed in the continuation of Box C <input checked="" type="checkbox"/> See patent family annex		
* Special categories of cited documents: "A" document defining the general state of the art which is not considered to be of particular relevance "E" earlier application or patent but published on or after the international filing date "L" document which may throw doubts on priority claim(s) or which is cited to establish the publication date of another citation or other special reason (as specified) "O" document referring to an oral disclosure, use, exhibition or other means "P" document published prior to the international filing date but later than the priority date claimed "T" later document published after the international filing date or priority date and not in conflict with the application but cited to understand the principle or theory underlying the invention "X" document of particular relevance; the claimed invention cannot be considered novel or cannot be considered to involve an inventive step when the document is taken alone "Y" document of particular relevance; the claimed invention cannot be considered to involve an inventive step when the document is combined with one or more other such documents, such combination being obvious to a person skilled in the art "&" document member of the same patent family		
Date of the actual completion of the international search 2 April 2003		Date of mailing of the international search report 15 APR 2003
Name and mailing address of the ISA/AU AUSTRALIAN PATENT OFFICE PO BOX 200, WODEN ACT 2606, AUSTRALIA E-mail address: pct@ipaustralia.gov.au Facsimile No. (02) 6285 3929		Authorized officer MANI RAMACHANDRAN Telephone No : (02) 6283 2233

INTERNATIONAL SEARCH REPORT

International application No.
PCT/AU03/00169

C (Continuation). DOCUMENTS CONSIDERED TO BE RELEVANT		
Category*	Citation of document, with indication, where appropriate, of the relevant passages	Relevant to claim No.
Y	US 5208446 A (MARTINEZ) 4 May 1993 whole document	1-14
A	GB 2287623 A (NOKIA MOBILE PHONES LTD) 20 September 1995 whole document	
<p><u>Note:</u> For the Y indications, DE 4444925 can be combined with any one of the other citations with relevance to the same claims.</p>		

INTERNATIONAL SEARCH REPORT
Information on patent family members

International application No. PCT/AU03/00169
--

This Annex lists the known "A" publication level patent family members relating to the patent documents cited in the above-mentioned international search report. The Australian Patent Office is in no way liable for these particulars which are merely given for the purpose of information.

Patent Document Cited in Search Report		Patent Family Member					
DE	4444295	NONE					
JP	2002016679	NONE					
WO	01/41480	EP	1234288	EP	1234464	EP	1236159
		EP	1236168	EP	1237727	EP	1240771
		EP	1242864	EP	1242916	EP	1247242
		EP	1247243	EP	1257938	WO	01/40926
		WO	01/40987	WO	01/41003	WO	01/41045
		WO	01/41046	WO	01/41047	WO	01/41055
		WO	01/41099	WO	01/41413		
US	5208446	CA	2091640	GB	2276258	US	5334824
		DE	4330254	MX	9307444	JP	7093411
GB	2287623	FI	941250				
END OF ANNEX							