



(12) **EUROPEAN PATENT APPLICATION**

(88) Date of publication A3:  
**08.02.2006 Bulletin 2006/06**

(51) Int Cl.:  
**A47K 3/36** (2006.01) **E05D 5/02** (2006.01)  
**E05D 7/04** (2006.01)

(43) Date of publication A2:  
**18.06.2003 Bulletin 2003/25**

(21) Application number: **02425744.6**

(22) Date of filing: **04.12.2002**

(84) Designated Contracting States:  
**AT BE BG CH CY CZ DE DK EE ES FI FR GB GR  
IE IT LI LU MC NL PT SE SI SK TR**  
Designated Extension States:  
**AL LT LV MK RO**

(72) Inventor: **Rabensteiner, Luigi**  
**39042 Bressanone (Bolzano) (IT)**

(74) Representative: **Crippa, Paolo Ernesto**  
**JACOBACCI & PARTNERS S.p.A.**  
**Piazzale Arnaldo, 2**  
**25121 Brescia (IT)**

(30) Priority: **13.12.2001 IT BS20010105**

(71) Applicant: **Duka S.r.l.**  
**39042 Bressanone (Bolzano) (IT)**

(54) **Shower box door**

(57) The present finding relates to a door for shower boxes comprising a mobile crystal plate (11) forming the actual door, a fixed crystal plate (12) to be fixed to the wall by a pair of metal brackets (13), and at least two hinges (14) for pivoting the mobile plate (11) relative to

the fixed one, characterised in that said hinges are glued to the respective plates. Another feature of the finding consists in the presence of adjustment pins having threaded ends in opposed direction intended to screw one into the hinge (14) and the other into the corresponding fixing bracket (13).

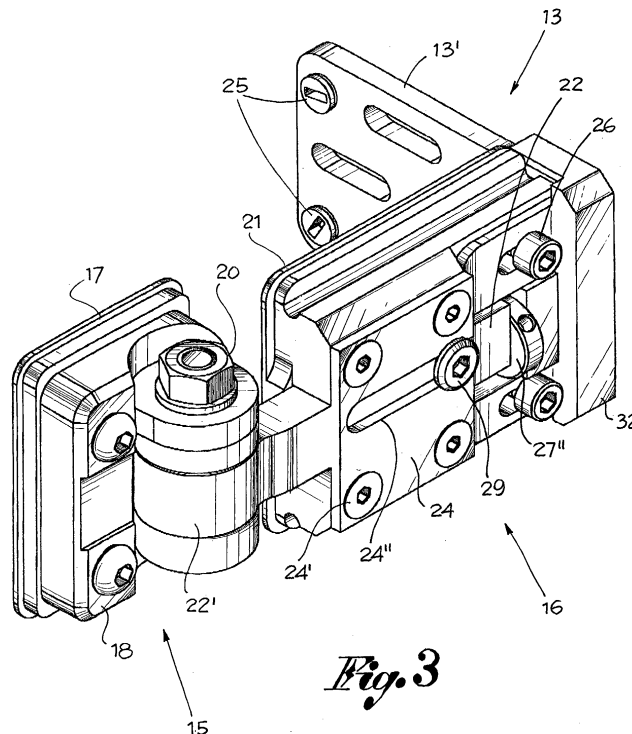

*Fig. 3*



DOCUMENTS CONSIDERED TO BE RELEVANT			
Category	Citation of document with indication, where appropriate, of relevant passages	Relevant to claim	CLASSIFICATION OF THE APPLICATION (IPC)
X	EP 1 108 843 A (DORMA GMBH + CO. KG) 20 June 2001 (2001-06-20)	1	A47K3/36 E05D5/02 E05D7/04
Y	* paragraphs [0016], [0022]; figures * -----	2,6,7	
Y	EP 0 372 206 A (PROFI-BESCHLAG GLASBESCHLAEGE HANDELS GMBH; VEGLA VEREINIGTE GLASWERKE) 13 June 1990 (1990-06-13) * claim 8; figures * -----	2	
Y	US 6 035 460 A (BORTER ET AL) 14 March 2000 (2000-03-14) * column 3, lines 12-60 * -----	6,7	
A	EP 1 013 210 A (ALTURA LEIDEN HOLDING B.V) 28 June 2000 (2000-06-28) * figures 2-4 * -----	1-3	
A	EP 1 121 886 A (DUKA S.R.L) 8 August 2001 (2001-08-08) * abstract * -----	1	
			TECHNICAL FIELDS SEARCHED (IPC)
			E05D A47K
The present search report has been drawn up for all claims			
Place of search The Hague		Date of completion of the search 14 December 2005	Examiner Witasse-Moreau, C
CATEGORY OF CITED DOCUMENTS X : particularly relevant if taken alone Y : particularly relevant if combined with another document of the same category A : technological background O : non-written disclosure P : intermediate document T : theory or principle underlying the invention E : earlier patent document, but published on, or after the filing date D : document cited in the application L : document cited for other reasons ..... & : member of the same patent family, corresponding document			

2  
EPC FORM 1503 03/82 (P04/C01)

**ANNEX TO THE EUROPEAN SEARCH REPORT  
ON EUROPEAN PATENT APPLICATION NO.**

EP 02 42 5744

This annex lists the patent family members relating to the patent documents cited in the above-mentioned European search report. The members are as contained in the European Patent Office EDP file on  
The European Patent Office is in no way liable for these particulars which are merely given for the purpose of information.

14-12-2005

Patent document cited in search report		Publication date		Patent family member(s)	Publication date
EP 1108843	A	20-06-2001	DE	19960722 A1	28-06-2001
EP 0372206	A	13-06-1990	DE	3840765 C1	31-05-1990
			ES	2039800 T3	01-10-1993
US 6035460	A	14-03-2000	NONE		
EP 1013210	A	28-06-2000	AT	296568 T	15-06-2005
			DE	29910496 U1	12-08-1999
			ES	2241519 T3	01-11-2005
			ZA	200002265 A	14-11-2000
EP 1121886	A	08-08-2001	IT	BS20000005 A1	07-08-2001