

**(12) STANDARD PATENT**  
**(19) AUSTRALIAN PATENT OFFICE**

(11) Application No. **AU 2008266678 B2**

(54) Title  
**Multi-element acoustic recharging system**

(51) International Patent Classification(s)  
**A61N 1/378** (2006.01)

(21) Application No: **2008266678**

(22) Date of Filing: **2008.05.28**

(87) WIPO No: **WO08/156981**

(30) Priority Data

(31) Number  
**60/943,939**

(32) Date  
**2007.06.14**

(33) Country  
**US**

(43) Publication Date: **2008.12.24**

(44) Accepted Journal Date: **2013.06.20**

(71) Applicant(s)  
**Cardiac Pacemakers, Inc.**

(72) Inventor(s)  
**Maile, Keith R.;Harguth, Robert S.;Mi, Bin;Tran, Binh C.**

(74) Agent / Attorney  
**Spruson & Ferguson, L 35 St Martins Tower 31 Market St, Sydney, NSW, 2000**

(56) Related Art  
**US 2006/0136004 A1**

(19) World Intellectual Property Organization  
International Bureau



(43) International Publication Date  
24 December 2008 (24.12.2008)

PCT

(10) International Publication Number  
**WO 2008/156981 A3**

(51) International Patent Classification:  
A61N 1/378 (2006.01)

(21) International Application Number:

PCT/US2008/064994

(22) International Filing Date: 28 May 2008 (28.05.2008)

(25) Filing Language: English

(26) Publication Language: English

(30) Priority Data:  
60/943,939 14 June 2007 (14.06.2007) US

(71) Applicant (for all designated States except US): **CARDIAC PACEMAKERS, INC.** [US/US]; 4100 Hamline Avenue North, St. Paul, MN 55112-5798 (US).

(72) Inventors; and

(75) Inventors/Applicants (for US only): **TRAN, Binh C.** [US/US]; 45 University Avenue SE, #409, Minneapolis, MN 55414 (US). **HARGUTH, Robert S.** [US/US]; 16248 Davenport Street NE, Ham Lake, MN 55304 (US). **MI, Bin** [CN/US]; 11225 42nd Avenue North, Plymouth, MN

55441 (US). **MAILE, Keith R.** [US/US]; 1380 N. Pike Lake Court, New Brighton, MN 55112 (US).

(74) Agents: **RODGERS, James G.** et al.; Faegre & Benson LLP, 2200 Wells Fargo, 90 South Seventh Street, Minneapolis, MN 55402 (US).

(81) Designated States (unless otherwise indicated, for every kind of national protection available): AE, AG, AL, AM, AO, AT, AU, AZ, BA, BB, BG, BH, BR, BW, BY, BZ, CA, CH, CN, CO, CR, CU, CZ, DE, DK, DM, DO, DZ, EC, EE, EG, ES, FI, GB, GD, GE, GH, GM, GT, HN, HR, HU, ID, IL, IN, IS, JP, KE, KG, KM, KN, KP, KR, KZ, LA, LC, LK, LR, LS, LT, LU, LY, MA, MD, ME, MG, MK, MN, MW, MX, MY, MZ, NA, NG, NI, NO, NZ, OM, PG, PH, PL, PT, RO, RS, RU, SC, SD, SE, SG, SK, SL, SM, SV, SY, TJ, TM, TN, TR, TT, TZ, UA, UG, US, UZ, VC, VN, ZA, ZM, ZW.

(84) Designated States (unless otherwise indicated, for every kind of regional protection available): ARIPO (BW, GH, GM, KE, LS, MW, MZ, NA, SD, SL, SZ, TZ, UG, ZM, ZW), Eurasian (AM, AZ, BY, KG, KZ, MD, RU, TJ, TM),

[Continued on next page]

(54) Title: MULTI-ELEMENT ACOUSTIC RECHARGING SYSTEM

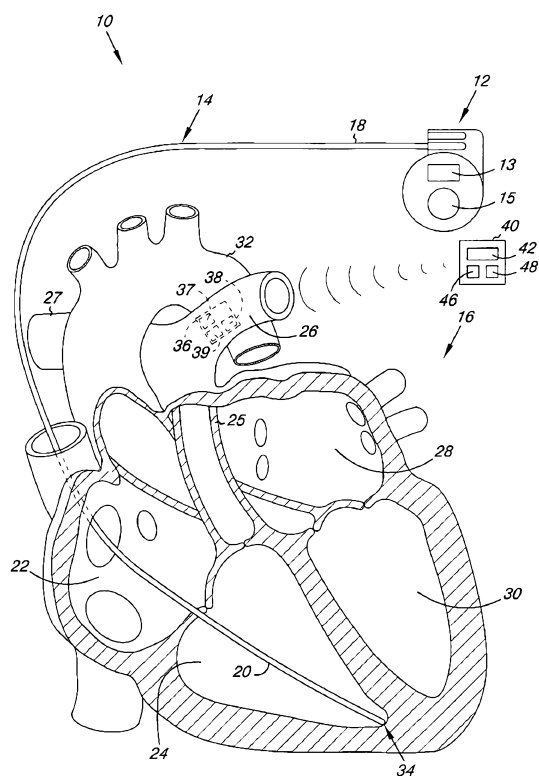


Fig. 1

(57) Abstract: An acoustic energy delivery system for delivering acoustic energy to an implantable medical device (IMD). The system includes an IMD having a power source and an energy delivery device. The energy delivery device includes a controller and an array of ultrasonic elements electrically coupled to the controller and configured to deliver acoustic energy to the IMD. Methods of delivering acoustic energy to an IMD are also disclosed.

WO 2008/156981 A3



European (AT, BE, BG, CH, CY, CZ, DE, DK, EE, ES, FI, FR, GB, GR, HR, HU, IE, IS, IT, LT, LU, LV, MC, MT, NL, NO, PL, PT, RO, SE, SI, SK, TR), OAPI (BF, BJ, CF, CG, CI, CM, GA, GN, GQ, GW, ML, MR, NE, SN, TD, TG).

— *before the expiration of the time limit for amending the claims and to be republished in the event of receipt of amendments*

**Published:**

— *with international search report*

**(88) Date of publication of the international search report:**

19 February 2009

## **MULTI-ELEMENT ACOUSTIC RECHARGING SYSTEM**

### **CROSS REFERENCE TO RELATED APPLICATION**

**[0001]** The present application claims priority under 35 U.S.C. § 119 to U.S. Provisional Patent Application No. 60/943,939, filed June 14, 2007, entitled "Multi-Element Acoustic Recharging System," which is incorporated herein by reference in its entirety.

### **TECHNICAL FIELD**

**[0002]** The present invention relates to implantable medical devices and methods of delivering energy to implantable medical devices. More specifically, the invention relates to devices and methods used to deliver energy to an implantable medical device using a device located external to a patient's body.

### **BACKGROUND**

**[0003]** Implantable medical devices are used to treat a variety of medical conditions. Examples of implantable medical devices include drug delivery devices, pain management devices, and devices that treat heart rhythm disorders. Examples of implantable medical devices that treat heart rhythm disorders are cardiac pacemakers, implantable cardioverter defibrillators, and cardiac resynchronization therapy ("CRT") devices. A cardiac pacemaker is commonly used to treat bradycardia. An implantable cardioverter defibrillator ("ICD") is commonly used to treat tachycardia. A CRT device is commonly used to treat heart failure associated dyssynchrony. These devices generally include a pulse generator and one or more leads that deliver electrical energy to the heart. The pulse generator typically includes a housing for a battery and electrical circuitry and a header for connecting the leads to the pulse generator. Other examples of implantable medical devices include remote devices with sensing, monitoring and/or stimulating functions. For

example, implantable pressure sensors can be located in the vasculature and used in conjunction with pacemakers, CRT devices, and ICDs.

[0004] At some point, the battery or power source within an implantable medical device runs out of energy. Generally, this energy depletion requires replacement of the implantable medical device. These devices, and others, may include a rechargeable power source to extend their usable lifetime. Due to the nature of implantable medical devices, methods for recharging are typically indirect, utilizing an external device not physically connected to the implantable medical device. One method of recharging the power source of an implantable medical device is by the conversion of acoustic energy to electrical energy. Using ultrasonic transducers, for example, acoustic energy can be transmitted through the body to the implantable medical device for recharging the electrical power source. Current technologies for acoustically charging a power source of an implantable medical device, however, are sometimes inefficient. Thus, there is a need for an improved device and method for delivering acoustic energy to implantable medical devices.

#### SUMMARY

[0005] According to one aspect, the present invention provides an acoustic energy delivery system for delivering acoustic energy to an implantable medical device ("IMD") located within a patient's body, the system comprising: an IMD including a power source and at least one ultrasonic transducer; and an energy delivery device configured to deliver acoustic energy for recharging the power source of the IMD, the energy delivery device including a controller and an array of ultrasonic elements electrically coupled to the controller and configured to transmit an acoustic field through the body to the IMD; wherein the controller is configured to selectively control one or more ultrasonic elements of the array for manipulating the acoustic field within the body based at least in part on one or more acoustic feedback signals transmitted by the at least one ultrasonic transducer of the IMD and received on the array of ultrasonic elements.

[0006] According to a further aspect, the present invention provides a system for acoustically powering a satellite pacing device located within a patient's body, the system comprising: a satellite pacing device configured to deliver therapy to the body, the satellite pacing device including at least one ultrasonic transducer configured for

converting acoustic energy into electrical energy for powering one or more components of the satellite pacing device; and an energy delivery device configured to transmit an acoustic field through the body to the satellite pacing device, the energy delivery device including an array of ultrasonic transducer elements coupled to a controller, the controller configured to selectively control one or more of the ultrasonic transducer elements of the array for focusing the acoustic field within the body based at least in part on one or more response signals received from the satellite pacing device.

[0007] According to a further aspect, the present invention provides a method of controlling an energy delivery device for delivering acoustic energy to an implantable medical device ("IMD") located within a patient's body, the method comprising: sending one or more acoustic signals to the IMD, the one or more acoustic signals configured to prompt the IMD to transmit one or more responsive acoustic feedback signals to the energy delivery device; receiving the one or more responsive acoustic feedback signals on an array of ultrasonic elements coupled to the energy delivery device; processing the one or more responsive acoustic feedback signals sent by the IMD; operating the array of ultrasonic elements coupled to the energy delivery device based at least in part on the one or more responsive acoustic feedback signals, wherein the ultrasonic elements are electrically coupled to a controller and are configured to output an acoustic field for delivering acoustic energy to the IMD; and charging a rechargeable power source within the IMD using the acoustic field.

#### BRIEF DESCRIPTION OF THE DRAWINGS

[0008] FIG. 1 is a combined cutaway and perspective view of a multi-element acoustic energy delivery system according to one embodiment of the present invention;

[0009] FIG. 2 is a schematic view of the multi-element energy delivery device of FIG. 1 according to one embodiment of the present invention;

[0010] FIG. 3 is a flowchart illustrating a method of controlling the multi-element array of Figure 2 according to one embodiment of the present invention;

[0011] FIG. 4 is a flowchart illustrating a method of using a multi-element energy delivery device to send a test pulse to an implantable medical device according to one embodiment of the present invention;

[0012] FIG. 5 is a top view of a multi-element energy delivery device according to one embodiment of the present invention;

[0013] FIG. 6 is a top view of a multi-element energy delivery device according to another embodiment of the present invention;

[0014] FIG. 7 is a top view of a multi-element energy delivery device according to another embodiment of the present invention;

[0015] FIG. 8 is a top view of a multi-element energy delivery device according to another embodiment of the present invention; and

[0016] FIG. 9 is a perspective view of a multi-element energy delivery device according to another embodiment of the present invention.

[0017] While the invention is amenable to various modifications and alternative forms, specific embodiments have been shown by way of example in the drawings and are described in detail below. The intention, however, is not to limit the invention to the particular embodiments described. On the contrary, the invention is intended to cover all modifications, equivalents, and alternatives falling within the scope of the invention as defined by the appended claims.

#### DETAILED DESCRIPTION

[0018] FIG. 1 is a combined cutaway and perspective view of an acoustic energy delivery system 10 according to one embodiment of the present invention. In the embodiment shown in FIG. 1, the system 10 includes a pulse generator 12 having a power source 13, a cardiac lead 14, and an acoustic transducer 15. The lead 14 operates to convey electrical signals between the heart 16 and the pulse generator 12. A proximal end 18 of the lead 14 is coupled to the pulse generator 12 and a distal end 20 is coupled to the heart 16. The heart 16 includes a right

atrium 22, a right ventricle 24, and a main pulmonary artery 25. The heart 16 also includes a left atrium 28, a left ventricle 30, and an aorta 32. In the embodiment shown, the system 10 includes one lead 14, but in other embodiments, the system 10 includes a plurality of leads 14. For example, the system 10 may include a first lead 14 adapted to convey electrical signals between the pulse generator 12 and the left ventricle 30 and a second lead 14 adapted to convey electrical signals between the pulse generator 12 and the right ventricle 24.

**[0019]** In the embodiment of FIG. 1, an electrode 34 is positioned in the right ventricle 24. When positioned as shown, the electrode 34 can be used to sense the electrical activity of the heart 16 and/or to apply a stimulating pulse to the right ventricle 24. In other embodiments, the cardiac lead 14 can also be implanted in other portions of the heart 16 as known in the art. For example, the lead 14 may be implanted in the right atrium 22, the left atrium 28, the left ventricle 30, or in the coronary veins (e.g., for bi-ventricular pacing and/or heart failure treatment). In one embodiment, the cardiac lead 14 includes multiple electrodes 34. In some embodiments, the lead 14 is an epicardial lead.

**[0020]** The system 10 includes a remote implantable medical device 36, which has a power source 37, an acoustic transducer 38, and circuitry 39 in addition to other components related to the IMD 36 function. In some embodiments, the system 10 also includes an energy delivery device 40, which has a multi-element transducer array 42, a power source 46, and a controller 48. In the embodiment shown in FIG. 1, the energy delivery device 40 is used to deliver acoustic energy to the IMD 36 (shown in FIG. 1 as waves emanating from the energy delivery device 40 toward the IMD 36). The transducer 38 in the IMD 36 converts acoustic energy to electrical energy, which can then be used immediately, in the short term, or stored for later use by the IMD 36 depending on the power source 48. The power source 37 in the IMD 36 can be a rechargeable battery, a

capacitor, or any other energy source for providing electrical operating power to various components of the IMD 36. The energy delivery device 40 is electronically reconfigurable by utilizing the controller 48 to adjust excitation parameters such as timing, phase, amplitude, and/or frequency of the multi-element transducer 42, and is thus able to deliver a range of acoustic fields to the IMD 36 to increase efficiency in recharging. In other embodiments, the energy delivery device 40 can deliver acoustic energy to the acoustic transducer 15 of the pulse generator 12 or to any other implantable medical device in place of or in addition to the IMD 36.

**[0021]** The IMD 36 shown in FIG. 1 is a pressure sensor for measuring pulmonary arterial pressure. Although the IMD 36 is shown in the left pulmonary artery 26, in other embodiments, the IMD 36 may be implanted in the main pulmonary artery 25 or in the right pulmonary artery 27. In other embodiments, the IMD 36 can be configured to measure other physiological parameters such as, for example, temperature, blood or fluid flow, strain, and/or electrical, chemical or magnetic properties within the body.

**[0022]** In other embodiments, the IMD 36 may be implanted in other regions of the patient's vasculature, in other body lumens, or in other areas of the body, and may comprise any type of chronically implanted device or remote sensor adapted to deliver therapy or monitor biological and chemical parameters, properties, and functions. For example, the IMD 36 could comprise a glucose level monitor, a pulmonary sound sensor, a satellite pacing device, or any other remote sensing or therapy-delivering device. In other embodiments, the IMD 36 could sense, measure, calculate, or derive associated parameters such as, for example, the flow rate, the maximum and minimum pressure, and the time rate change (slope) of the pressure. In some embodiments, a plurality of remote implantable medical devices 36 are implanted throughout the

body, and are configured to receive acoustic signals from the energy delivery device 40.

**[0023]** FIG. 2 is a schematic view of one embodiment of the energy delivery device 40 of FIG. 1. In the illustrated embodiment, the energy delivery device 40 includes an array 42 of ultrasonic elements 44. The array 42 is used to transmit an acoustic energy signal to and efficiently recharge the power source 37 in the IMD 36. Use of the array 42 in some embodiments may enable an increase in energy transfer efficiency. The ultrasonic elements 44 are electrically coupled to the controller 48, which can be a microprocessor, an integrated circuit, or any other processor or circuitry that can be used for operating the array 42. In some embodiments, the controller 48 selectively controls each ultrasonic element 44 individually such that the multi-element array 42 functions as a combination of ultrasonic elements 44. In one embodiment, for example, the controller 48 operates all ultrasonic elements 44 simultaneously and in-phase as if the array 42 were a single ultrasonic element. In other embodiments, the controller 48 operates all or some of the ultrasonic elements 44 with phase delays and/or amplitude modulations, electronically changing the effective aperture of the array 42. In still other embodiments, the controller 48 operates a single ultrasonic element 44 or a subset of ultrasonic elements 44. The controller 48 determines the appropriate configuration for transmission of acoustic energy from the array 42 to the IMD 36 and controls the operation of the ultrasonic elements 44 accordingly, as discussed further herein, for example, with respect to FIGS. 3-4. In some embodiments, the controller 48 utilizes feedback to determine the appropriate transmission configuration. In other embodiments, the controller 48 operates the transducer elements 44 without feedback.

**[0024]** In the embodiment shown in FIG. 2, the array 42 includes four ultrasonic elements 44, but in other embodiments, the array 42 can

include any number of ultrasonic elements 44. In one embodiment, the ultrasonic elements 44 operate at the same frequency. In other embodiments, the ultrasonic elements 44 do not all operate at the same frequency. In one embodiment, the ultrasonic elements 44 operate at a frequency of between about 20 kHz to about 200 kHz. In one embodiment, the ultrasonic elements 44 operate at a center frequency of about 40 kHz. In one embodiment, all of the ultrasonic elements 44 have the same resonant frequency, but in other embodiments, the ultrasonic elements 44 do not all have the same resonant frequency.

**[0025]** In the embodiment illustrated in FIG. 2, the ultrasonic elements 44 are piezoelectric elements including an active piezoelectric layer 50, a backing layer 52, and a front matching layer 54. The general principles of operation of piezoelectric elements are well known in the art. Briefly, the application of an AC voltage across electrodes coupled to the piezoelectric layer 50 causes the piezoelectric layer 50 to oscillate at the frequency of the applied voltage and produce an outward acoustic wave. In one embodiment, the piezoelectric layer 50 is made from a piezopolymer, piezoceramic, or piezocomposite material. In one embodiment, the piezoelectric layer 50 is a polyvinylidene difluoride ("PVDF") material. In another embodiment, the piezoelectric layer 50 is a lead zirconate titanate ("PZT") material. The ultrasonic elements 44 can have a variety of shapes and physical arrangements to maximize energy delivery to the IMD, as shown, for example, in FIGS. 5-9.

**[0026]** In the embodiment shown in FIG. 2, the backing layer 52 provides mechanical support and absorbs reflected acoustic energy. In one embodiment, the matching layer 54 provides an acoustic impedance match between the active layer 50 and the patient's skin, increasing energy transmission into the body. The matching layer 54 may be comprised of multiple layers to achieve the optimal acoustic impedance match. The piezoelectric layer 50, backing layer 52, and front matching

layer 54 have a high coupling coefficient. The high coupling coefficient results in a high sensitivity of the ultrasonic element 44 and a high signal to noise ratio. The high coupling coefficient also allows for a larger bandwidth, thereby allowing for a high energy transfer level and a low reverberation level. The delivery of acoustic energy from an external energy delivery device 40 to an IMD 36 located within a patient often requires transmission through a complex, indirect, and lossy propagation path. Propagation is often indirect and multipath through attenuating body tissues and reflecting tissue interfaces resulting from different acoustic impedances in tissues such as skin, bones, lungs, muscles, and blood. Despite these complexities, the energy delivery device 40 can be used to reduce propagation losses and more efficiently deliver energy to the power source 38 within the implantable medical device 36.

**[0027]** FIG. 3 illustrates an illustrative method 300 of controlling the multi-element array 42 of Figure 2 according to one embodiment of the present invention. As shown in Figure 3, the energy delivery device 40 sends a signal to the implantable medical device 36 (block 310). The signal can be a ping, a series of pings, an instruction, or a command. The remote implantable medical device 36 receives and processes the signal and sends a responsive signal back to the device 40 (block 320). The responsive signal can be a generic transmission signal, an encoded measurement of the signal strength received from the energy delivery device 40, or some other signal. The energy delivery device 40 then determines the operating configuration of the array 42 producing the most efficient recharging based on the responsive signal (block 330) and configures the controller 48 to operate the ultrasonic elements 44 to transmit the acoustic energy according to that determined configuration (block 340).

**[0028]** In one implementation of method 300, for example, the controller 48 determines which ultrasonic elements 44 have a minimum

attenuation in the acoustic path to the IMD 36 and operates only those ultrasonic elements 44 having the minimum attenuation in the acoustic path or those elements 44 having the least attenuating path. In one embodiment, the controller 48 determines which elements have minimum attenuation by first transmitting a signal from each element 44 individually to the IMD 36 and then receiving a response from the IMD 36. In one embodiment, the response from the IMD is a measurement of the acoustic signal amplitude of the IMD 36 received from the signal transmitted by each individual element 44 of the energy delivery device 40. In this embodiment, a response with a higher signal amplitude measurement may indicate less attenuation along the acoustic path than a response with a lower signal amplitude measurement. In another embodiment, the response from the IMD 36 is its standard response signal (e.g., an acknowledgement signal of known frequency and amplitude), and controller 48 determines the ultrasonic elements 44 having minimum attenuation by comparing the amplitude of the response signal received by the individual ultrasonic elements 44. The determination of whether the acoustic signal is sufficient can be determined, for example, by comparing the acoustic signal level received against a preset threshold programmed within the controller 48. In an alternative embodiment, the controller 48 operates a subset of the ultrasonic elements 44 that have a minimum attenuation in the acoustic path rather than a single ultrasonic element 44.

**[0029]** In another implementation of method 300, the controller 48 incorporates time reversal techniques to optimize the delivery of the acoustic energy to the IMD 36. Time reversal techniques enable phase alignment of acoustic fields at a desired target when the target's location is not precisely known or is changing. An illustrative technique for optimizing recharging efficiency using time reversal techniques is described, for example, in co-pending U.S. Provisional Patent Application Serial No. 61/027,983, entitled, "Systems and Methods For Controlling Wireless

Signal Transfers Between Ultrasound Enabled Medical Devices,” which is incorporated herein by reference in its entirety. In some embodiments, the time reversal process is implemented according to method 300. The energy delivery device 40 transmits an acoustic signal towards the IMD 36. The IMD 36 receives the acoustic signal and, in response, transmits a series of signals back to the energy delivery device 40. The signals from the IMD 36 are received by the individual ultrasonic elements 44. The controller 48 may then analyze the received signals, determine the phase and amplitude differences between the received signals, and compute compensation factors. The controller 48 then applies these compensation factors to control the ultrasonic elements 44 in order to deliver the acoustic energy to the IMD 36.

**[0030]** FIG. 4 is a flowchart showing an exemplary method 400 of processing a test pulse sent from the IMD 36 to the energy delivery device 40 using time reversal techniques according to one embodiment of the present invention. As shown in Figure 4, the IMD 36 transmits test pulses to the energy delivery device 40 (block 410). The test pulses can be any type of pulse. In one embodiment, for example, the test pulses are eight “1” bit pulses. The IMD 36 then enters into a charging mode (block 420). The energy delivery device 40 receives the test pulses on each ultrasonic element 44 of the device 40 and uses these pulses to determine the relative time delays between the signals received at each element 44 (block 430). The energy delivery device 40 transmits acoustic energy from the ultrasonic elements 44 using time reversal techniques. In one embodiment, for example, the energy delivery device 40 transmits acoustic energy in the opposite order from the order in which the device 40 received the test pulses and incorporating the relative time delays (block 440). Using the energy delivery device 40 shown in FIG. 2 as an example, if the charges received on elements 44a, 44b, 44c, and 44d are received in the order 44a, 44c, 44d, and 44b having a relative delay

between 44a and 44c of one second, the charging would occur in the order 44b, 44d, 44c, 44a with a one second transmit delay between 44c and 44a.

**[0031]** The methods described herein can be used at any time during the charging cycle. In one embodiment, the controller 48 electronically reconfigures the control of the array 42 to compensate for changes in location of the IMD 36 from a previous position due to a change in body position, organ movement, respiration, and/or for other reasons. In some embodiments, the controller 48 incorporates information regarding physiological patterns (e.g., respiratory rate, cardiac cycle, etc.) and controls the array 42 based upon the pattern information. In one embodiment, the method is used at the beginning of the charging cycle. In another embodiment, the method is used during the charging cycle. In one embodiment, the method is used during the charging cycle and is initiated when a charge pause occurs in the charging cycle. In some embodiments, the charge pause is a programmable event in the controller 48 and is used to re-evaluate the efficiency of charging. In some embodiments, the method is used if there is a loss of transmission during the charging cycle.

**[0032]** In various other embodiments, the controller 48 can operate the array 42 without feedback from the IMD 36 to achieve the desired charging efficiency. In one embodiment, for example, the controller 48 operates the array 42 by cycling through all or some of the ultrasonic elements 44, individually or as subsets, to avoid overheating at any one location on the patient's body. In another embodiment, the controller 48 can implement known beamsteering, beamshaping, and/or beamforming techniques to adjust the acoustic energy signal from the array 42. Generally, these processes involve using the controller 48 to apply time delays on the individual elements 44 to shape and/or steer the acoustic field produced by the array 42.

**[0033]** In one embodiment, the beamsteering is the sweeping of the acoustic field through a series of spatial locations, thus defining the range of interrogation. In one embodiment, beamforming is the definition of the acoustic field width to match a desired region of interrogation. In one embodiment, the beam width and steering range are varied. The energy delivery device 40 can be designed with a range of beamforming and beamsteering capabilities based on its intended use. In one embodiment, variable shape ultrasonic elements 44 and/or ultrasonic elements 44 having acoustic lens/mirrors are used in conjunction with the controller 48 and methods described herein to alter the acoustic field.

**[0034]** FIG. 5 is a top view of an energy delivery device 40 according to one embodiment of the present invention. In the embodiment illustrated in FIG. 5, the energy delivery device 40 includes an array 42 of ultrasonic elements 44 located on a support structure 45. A central ultrasonic element 44a is located at the center of the support structure 45 and six additional ultrasonic elements 44b are circumferentially spaced around the central ultrasonic element 44a. In one embodiment, the energy delivery device 40 has a diameter D between about 6 and about 7.5 centimeters and a height of less than about 5 centimeters. In one embodiment, the ultrasonic elements 44 have a generally circular shape and a diameter d between about 1.8 and about 2.5 centimeters. In one embodiment, the energy delivery device 40 weighs less than about 400 grams and can be readily incorporated into a wearable garment or hand-held device. In one embodiment, the energy delivery device 40 is capable of producing 40 kHz ultrasonic waves of 50 kPa at 20 centimeters of water along the maximum response axis when all of the ultrasonic elements 44 are driven in phase.

**[0035]** The ultrasonic elements 44 can have a variety of shapes and configurations. FIGS. 6-9 illustrate alternative embodiments of the array 42. In the embodiment shown in FIG. 6, the energy delivery device 40 has

an array 42 of four rectangular ultrasonic elements 44 arranged in a linear manner. In the embodiment shown in FIG. 7, the energy delivery device 40 has an array 42 of three linearly arranged rows of rectangular ultrasonic elements 44 arranged in a three by four matrix. In the asymmetric embodiment illustrated in FIG. 8, the energy delivery device 40 has an array 42 of one central ultrasonic element 44a and a plurality of additional ultrasonic elements 44b positioned around the central ultrasonic element 44 at unequal distances from the central ultrasonic element 44a.

[0036] In the embodiments shown in FIGS. 5-8, the elements 44 are located in the same plane. In other embodiments, the acoustic beam is mechanically focused to a desired depth by configuring the ultrasonic elements 44 towards the center of an imaginary sphere such that a focus is created at the center of the sphere. For example, the ultrasonic elements 44 can be attached on a focusing structure such as a spherical shell. In another embodiment, the ultrasonic elements 44 can include an acoustic lens/mirror to mechanically focus the acoustic beam to a desired depth within the patient.

[0037] FIG. 9 illustrates a dome or beehive-shaped array 42. As shown in FIG. 9, the array 42 includes a circular ultrasonic element 44a. An axis  $\alpha$ - $\alpha$  that is perpendicular to the circular ultrasonic element 44a extends through the center of the circular ultrasonic element 44a. An annular ultrasonic element 44b is centered on the axis  $\alpha$ - $\alpha$  and positioned along the axis  $\alpha$ - $\alpha$  at a distance b from the circular ultrasonic element 44a. Similarly, an annular ultrasonic element 44c has a greater diameter than ultrasonic element 44b, is centered on the axis  $\alpha$ - $\alpha$ , and is positioned along the axis  $\alpha$ - $\alpha$  at a distance c from the circular ultrasonic element 44a. An annular ultrasonic element 44d has a greater diameter than ultrasonic element 44c, is centered on the axis  $\alpha$ - $\alpha$ , and is positioned along the axis  $\alpha$ - $\alpha$  at a distance d from the circular ultrasonic element 44a. As shown in FIG. 9, the ultrasonic elements 44b, 44c, and 44d are non-planar. In

another embodiment, the ultrasonic elements 44b, 44c, 44d are planar. In yet another embodiment, the ultrasonic element 44a is non-planar.

**[0038]** Although FIGS. 5-9 illustrate specific numbers and configurations of ultrasonic elements 44, any number and configuration of ultrasonic elements 44 can be incorporated into the energy delivery device 40 for use in delivering acoustic energy to an implantable medical device. The array 42 can have a polygonal, a circular, or an annular configuration. The configuration can be symmetric or asymmetric about one or more axes. The ultrasonic elements 44 can have a polygonal, circular, or annular cross-sectional shape. In other embodiments, the ultrasonic elements 44 can be cylindrical, flat, or curved. In one embodiment, all of the ultrasonic elements 44 have the same shape. In other embodiments, the ultrasonic elements 44 have different shapes. For example, a central ultrasonic element 44a could have a generally circular shape and additional ultrasonic elements 44b could have a rectangular shape.

**[0039]** In one embodiment, the energy delivery device 40 is located on a handheld device (not shown). In another embodiment, the energy delivery device 40 is located on a wearable garment (not shown) such as a vest, shirt or belt, which can be tightly coupled to the patient's skin. The array 42 may be located directly on the handheld device or garment. Alternatively, the array 42 may be located on a support structure such as a flat plate or bed, which may or may not be coupled to a handheld device or garment.

**[0040]** Although the energy delivery device 40 has been described as delivering acoustic energy to a remote IMD 36, in other embodiments the energy delivery device 40 is used to deliver energy to other implantable medical devices capable of receiving acoustic energy and converting the acoustic energy to operating power. For example, the energy delivery device 40 can be used to deliver acoustic energy to a

power source within a drug delivery device, a neurostimulator, a pacemaker, or a defibrillator.

**[0041]** Various modifications and additions can be made to the exemplary embodiments discussed without departing from the scope of the present invention. For example, while the embodiments described above refer to particular features, the scope of this invention also includes embodiments having different combinations of features and embodiments that do not include all of the described features. Accordingly, the scope of the present invention is intended to embrace all such alternatives, modifications, and variations as fall within the scope of the claims, together with all equivalents thereof.

**CLAIMS:**

1. An acoustic energy delivery system for delivering acoustic energy to an implantable medical device ("IMD") located within a patient's body, the system comprising:  
an IMD including a power source and at least one ultrasonic transducer; and  
an energy delivery device configured to deliver acoustic energy for recharging the power source of the IMD, the energy delivery device including a controller and an array of ultrasonic elements electrically coupled to the controller and configured to transmit an acoustic field through the body to the IMD;  
wherein the controller is configured to selectively control one or more ultrasonic elements of the array for manipulating the acoustic field within the body based at least in part on one or more acoustic feedback signals transmitted by the at least one ultrasonic transducer of the IMD and received on the array of ultrasonic elements.
2. The system of claim 1, wherein at least one of the ultrasonic elements includes an acoustic lens or mirror.
3. The system of claim 1, wherein the array of ultrasonic elements is located on a supporting structure.
4. The system of claim 1, wherein the array of ultrasonic elements is located on a wearable garment or portable device.
5. The system of claim 1, wherein the acoustic field has a frequency of between about 20 kHz and about 200 kHz.
6. The system of claim 1, wherein the acoustic field has a frequency of about 40 kHz.
7. The system of claim 1, wherein the array has a polygonal, circular, annular, symmetric, or asymmetric configuration.

8. A system for acoustically powering a satellite pacing device located within a patient's body, the system comprising:
  - a satellite pacing device configured to deliver therapy to the body, the satellite pacing device including at least one ultrasonic transducer configured for converting acoustic energy into electrical energy for powering one or more components of the satellite pacing device; and
  - an energy delivery device configured to transmit an acoustic field through the body to the satellite pacing device, the energy delivery device including an array of ultrasonic transducer elements coupled to a controller, the controller configured to selectively control one or more of the ultrasonic transducer elements of the array for focusing the acoustic field within the body based at least in part on one or more response signals received from the satellite pacing device.
9. The system of claim 8, wherein the one or more response signals includes an acoustic feedback signal transmitted by the at least one ultrasonic transducer and received on the array of ultrasonic transducer elements.
10. The system of claim 8, wherein the satellite pacing device further includes a sensor for sensing one or more physiological parameters within the body.
11. The system of claim 10, wherein the controller is further configured to control the array of ultrasonic transducer elements based at least in part on information received from the physiological sensor.
12. The system of claim 11, wherein the information includes information related to cardiac and/or pulmonary rhythm or function.

13. A method of controlling an energy delivery device for delivering acoustic energy to an implantable medical device ("IMD") located within a patient's body, the method comprising:
  - sending one or more acoustic signals to the IMD, the one or more acoustic signals configured to prompt the IMD to transmit one or more responsive acoustic feedback signals to the energy delivery device;
  - receiving the one or more responsive acoustic feedback signals on an array of ultrasonic elements coupled to the energy delivery device;
  - processing the one or more responsive acoustic feedback signals sent by the IMD;
  - operating the array of ultrasonic elements coupled to the energy delivery device based at least in part on the one or more responsive acoustic feedback signals, wherein the ultrasonic elements are electrically coupled to a controller and are configured to output an acoustic field for delivering acoustic energy to the IMD;
  - and
  - charging a rechargeable power source within the IMD using the acoustic field.
14. The method of claim 13, wherein operating the array includes operating the ultrasonic elements at a frequency of between about 20 kHz and about 200 kHz.
15. The method of claim 13, wherein operating the array includes operating the ultrasonic elements in phase.
16. The method of claim 13, wherein operating the array includes manipulating the acoustic field using any combination of adaptive beamforming, beamsteering, or beamshaping.
17. The method of claim 13, wherein operating the array includes manipulating the acoustic field using a time reversal technique.
18. The method of claim 13, wherein the method further includes detecting a change in signal amplitude or signal efficiency in the one or more responsive acoustic feedback signals,

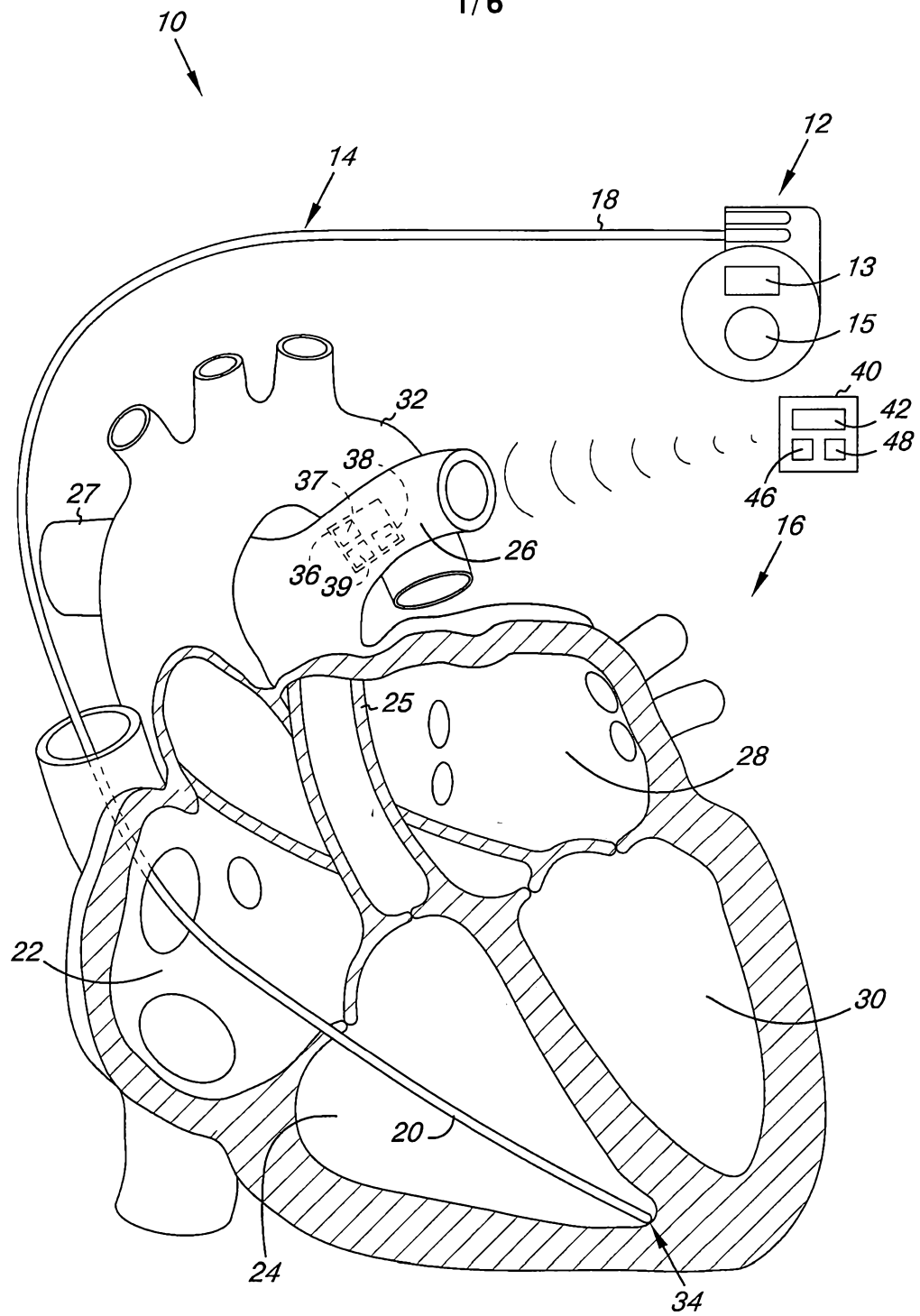
and wherein operating the array includes operating the array in response to the changed signal amplitude or signal efficiency.

19. The method of claim 13, wherein operating the array includes mechanically focusing the acoustic field to a desired depth within the patient's body.
20. The method of claim 13, wherein operating the array includes cycling one or more ultrasonic elements of the array.

**Cardiac Pacemakers, Inc.**

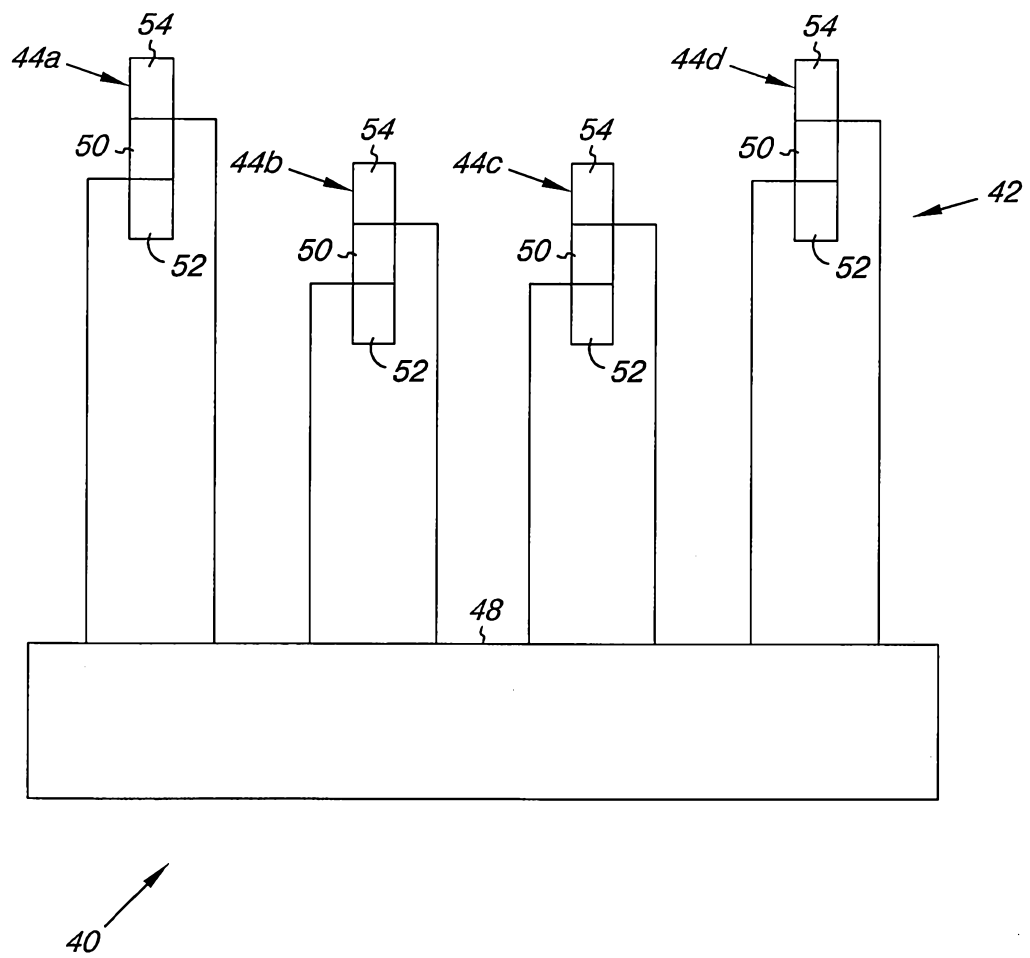
**Patent Attorneys for the Applicant/Nominated Person**

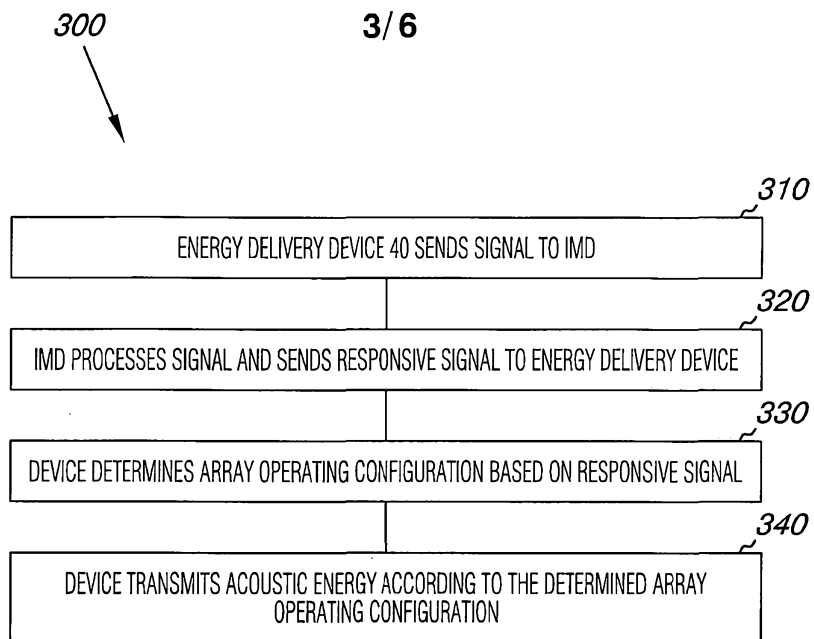
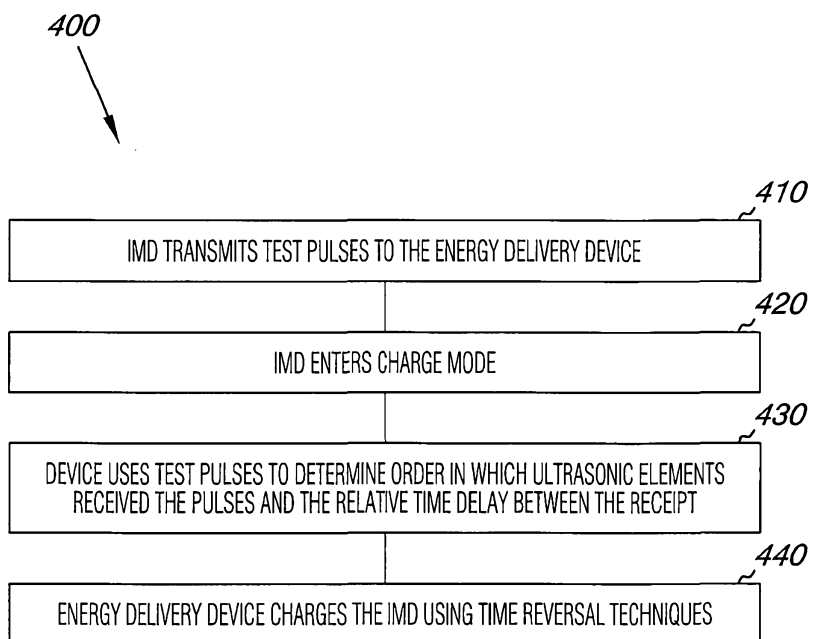
**SPRUSON & FERGUSON**

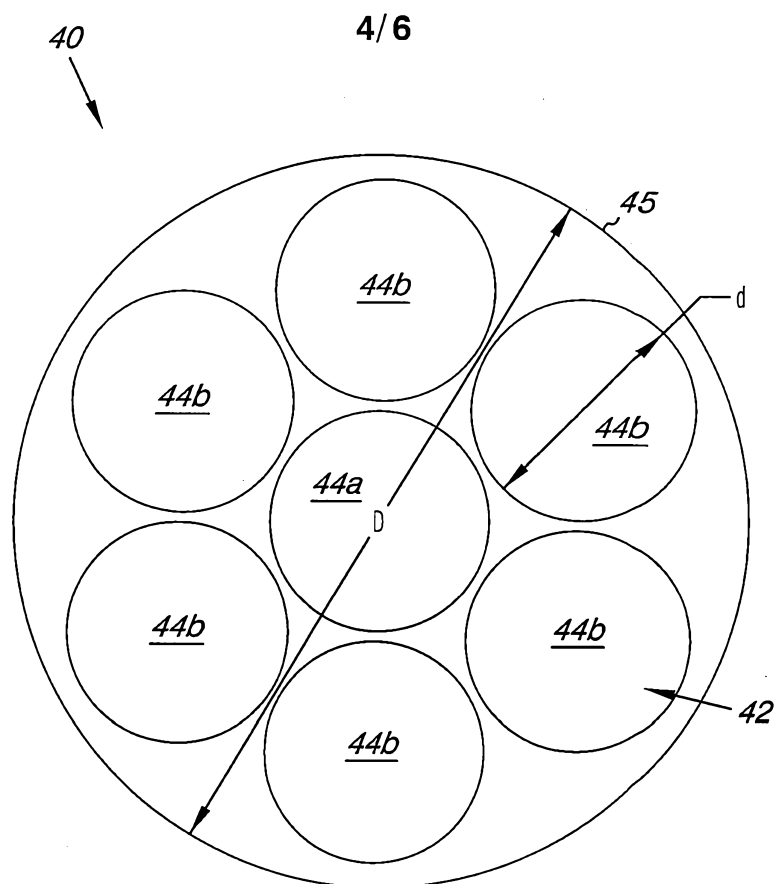


*Fig. 1*

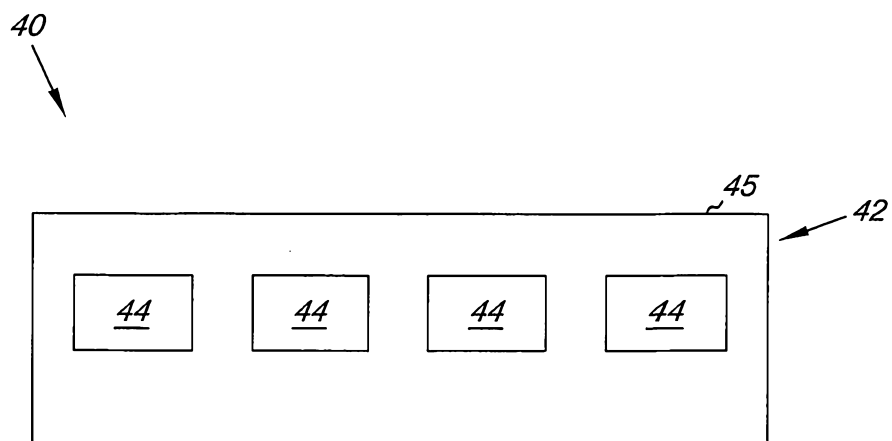
2/6

*Fig. 2*

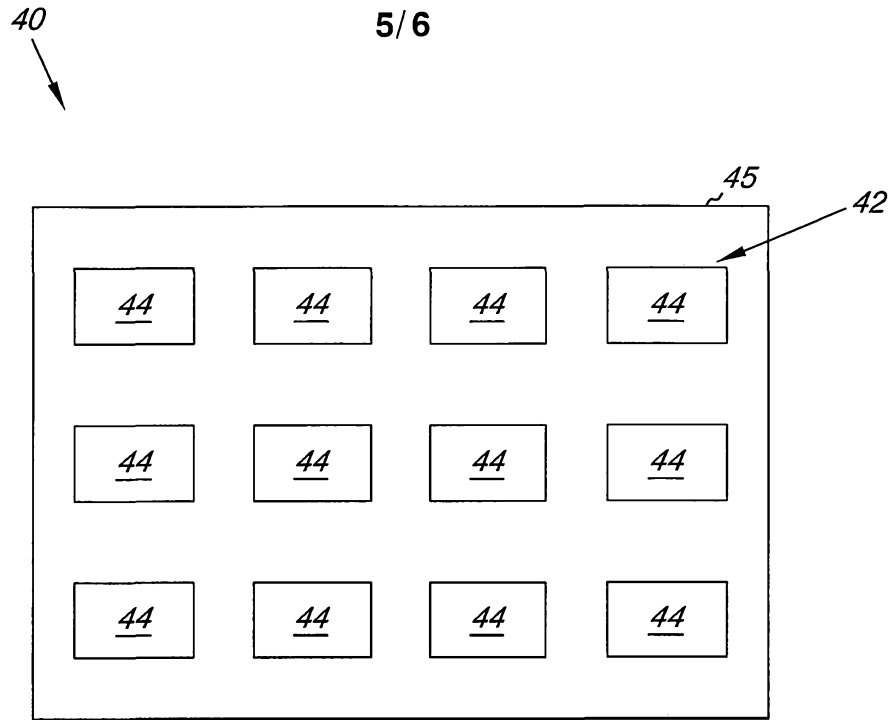
*Fig. 3**Fig. 4*



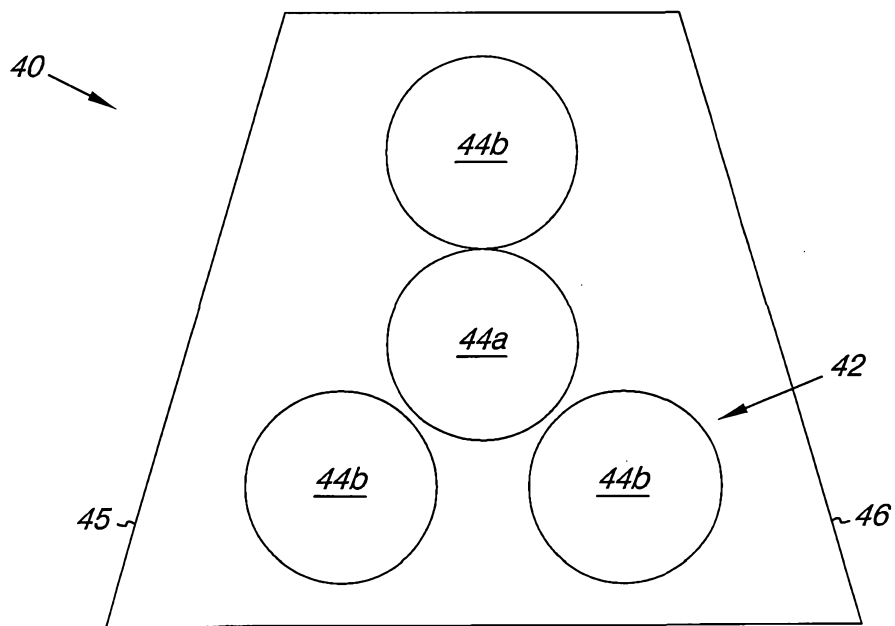
*Fig. 5*



*Fig. 6*



*Fig. 7*



*Fig. 8*

6/6

