



US007464847B2

(12) **United States Patent**
Viola et al.

(10) **Patent No.:** **US 7,464,847 B2**
(45) **Date of Patent:** **Dec. 16, 2008**

(54) **SURGICAL STAPLER WITH TIMER AND
FEEDBACK DISPLAY**

(75) Inventors: **Frank J. Viola**, Sandy Hook, CT (US);
Gregg Krehel, Newtown, CT (US);
Michael A. Soltz, North Haven, CT
(US); **Robert J. DeSantis**, Redding, CT
(US); **Henry P. Holsten**, Covington, GA
(US); **Russell Heinrich**, Madison, CT
(US)

(73) Assignee: **Tyco Healthcare Group LP**, North
Haven, CT (US)

(*) Notice: Subject to any disclaimer, the term of this
patent is extended or adjusted under 35
U.S.C. 154(b) by 65 days.

(21) Appl. No.: **11/446,282**

(22) Filed: **Jun. 2, 2006**

(65) **Prior Publication Data**

US 2006/0278680 A1 Dec. 14, 2006

Related U.S. Application Data

(60) Provisional application No. 60/687,406, filed on Jun.
3, 2005, provisional application No. 60/687,244, filed
on Jun. 3, 2005.

(51) **Int. Cl.**
A61B 17/068 (2006.01)

(52) **U.S. Cl.** **227/175.2**; 227/19; 227/176.1;
606/139; 606/219

(58) **Field of Classification Search** 227/19;
227/176.1, 175.1, 175.2, 180.1; 173/20;
606/139, 219, 143, 151, 9, 127
See application file for complete search history.

(56) **References Cited**

U.S. PATENT DOCUMENTS

4,508,253 A 4/1985 Green
4,508,523 A 4/1985 Leu

4,606,344 A 8/1986 Di Giovanni
4,990,153 A 2/1991 Richards
5,300,081 A 4/1994 Young et al.
5,364,001 A 11/1994 Bryan
5,383,880 A 1/1995 Hooven
5,389,098 A 2/1995 Tsuruta et al.
5,395,033 A 3/1995 Byrne et al.

(Continued)

FOREIGN PATENT DOCUMENTS

EP 0 537 570 B1 4/1993

(Continued)

OTHER PUBLICATIONS

Detemple, P., "Microtechnology in Modern Health Care", *Med
Device Technol.* 9(9):18-25 (1998).

(Continued)

Primary Examiner—Scott A. Smith

(57) **ABSTRACT**

A surgical apparatus has a clamp and a stapling mechanism. The clamp has a first jaw and a second jaw to clamp on a body tissue at a desired location for a stapling operation. The stapling mechanism is controlled by a trigger handle or a switch assembly. The surgical apparatus has a controller for providing a delay between clamping and actuating of the firing mechanism of the stapling mechanism. The delay provides for a desired amount of time for tissue compression producing a more uniform staple formation. The surgical apparatus also has an indicator. The indicator provides feedback about the status of the stapling mechanism and also displays a time of tissue compression by the clamp.

33 Claims, 15 Drawing Sheets

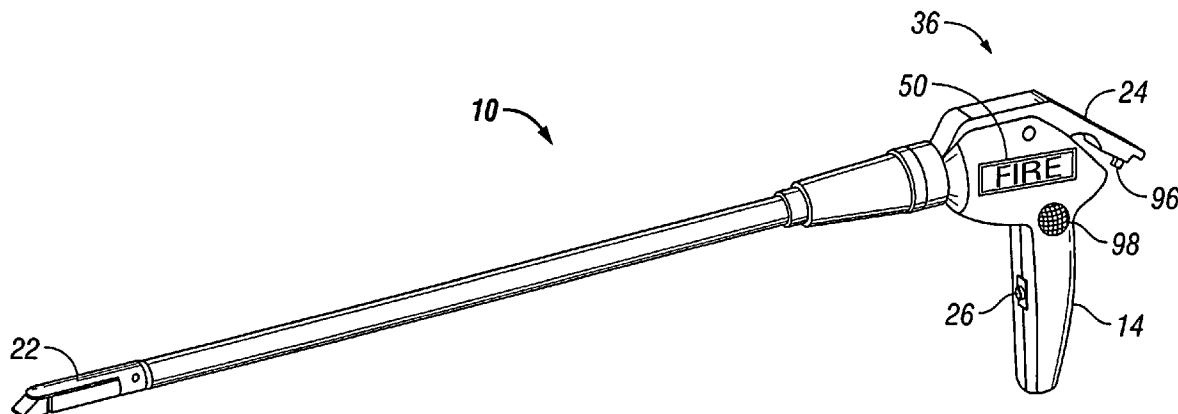

US 7,464,847 B2

Page 2

U.S. PATENT DOCUMENTS

5,403,312 A	4/1995	Yates et al.	6,250,532 B1	6/2001	Green et al.
5,411,508 A	5/1995	Bessler et al.	6,264,086 B1	7/2001	McGuckin, Jr.
5,464,144 A	11/1995	Guy et al.	6,264,087 B1	7/2001	Whitman
5,478,344 A	12/1995	Stone et al.	6,264,653 B1	7/2001	Falwell
5,503,320 A	4/1996	Webster et al.	6,281,471 B1	8/2001	Smart
5,507,743 A	4/1996	Edwards et al.	6,288,534 B1	9/2001	Starkweather et al.
5,518,163 A	5/1996	Hooven	6,293,943 B1	9/2001	Panescu et al.
5,518,164 A	5/1996	Hooven	6,315,184 B1	11/2001	Whitman
5,529,235 A	6/1996	Boiarski et al.	6,330,965 B1	12/2001	Milliman et al.
5,531,744 A	7/1996	Nardella et al.	6,346,104 B2	2/2002	Daly et al.
5,535,934 A	7/1996	Boiarski et al.	H2037 H	7/2002	Yates et al.
5,535,937 A	7/1996	Boiarski et al.	6,412,279 B1	7/2002	Coleman et al.
5,558,671 A	9/1996	Yates	6,436,097 B1	8/2002	Nardella
5,562,239 A	10/1996	Boiarski et al.	6,436,107 B1	8/2002	Wang et al.
5,582,611 A	12/1996	Tsuruta et al.	6,443,973 B1	9/2002	Whitman
5,624,452 A	4/1997	Yates	6,478,210 B2	11/2002	Adams et al.
5,658,300 A	8/1997	Bitto et al.	6,505,768 B2	1/2003	Whitman
5,665,085 A	9/1997	Nardella	6,601,749 B2	8/2003	Sullivan et al.
5,667,517 A	9/1997	Hooven	6,602,252 B2	8/2003	Mollenauer
5,695,524 A	12/1997	Kelley et al.	6,616,821 B2	9/2003	Broadley et al.
5,713,896 A	2/1998	Nardella	6,656,177 B2	12/2003	Truckai et al.
5,715,987 A	2/1998	Kelley et al.	6,669,705 B2	12/2003	Westhaver et al.
5,716,366 A	2/1998	Yates	6,696,008 B2	2/2004	Branding
5,735,848 A	4/1998	Yates et al.	6,698,643 B2	3/2004	Whitman
5,782,397 A	7/1998	Koukline	6,716,233 B1	4/2004	Whitman
5,810,811 A	9/1998	Yates et al.	6,817,508 B1	11/2004	Racenet et al.
5,849,028 A	12/1998	Chen	6,830,174 B2 *	12/2004	Hillstead et al. 227/175.1
5,861,005 A	1/1999	Kontos	6,843,403 B2	1/2005	Whitman
5,876,401 A	3/1999	Schulze et al.	6,872,214 B2	3/2005	Sonnenschein et al.
5,918,791 A	7/1999	Sorrentino et al.	6,900,004 B2	5/2005	Satake
5,928,222 A	7/1999	Kleinerman	6,905,057 B2 *	6/2005	Swayze et al. 227/176.1
5,944,717 A	8/1999	Lee et al.	6,926,636 B2	8/2005	Luper
5,954,259 A	9/1999	Viola et al.	6,981,941 B2	1/2006	Whitman et al.
5,964,394 A	10/1999	Robertson	6,988,649 B2 *	1/2006	Shelton et al. 227/175.2
5,980,518 A	11/1999	Carr et al.	7,032,798 B2 *	4/2006	Whitman et al. 227/175.1
5,980,548 A	11/1999	Evans et al.	7,044,353 B2	5/2006	Mastri et al.
5,991,650 A	11/1999	Swanson et al.	7,059,508 B2 *	6/2006	Shelton et al. 227/175.2
6,004,335 A	12/1999	Vaitekunas et al.	7,077,856 B2	7/2006	Whitman
6,007,550 A	12/1999	Wang et al.	7,122,029 B2 *	10/2006	Koop et al. 606/9
6,010,054 A *	1/2000	Johnson et al. 227/176.1	7,140,528 B2	11/2006	Shelton, IV
6,032,849 A	3/2000	Mastri et al.	7,246,734 B2 *	7/2007	Shelton, IV 227/175.1
6,039,731 A	3/2000	Taylor et al.	2002/0165541 A1	11/2002	Whitman
6,063,078 A	5/2000	Wittkamp	2003/0114851 A1	6/2003	Truckai et al.
6,063,095 A	5/2000	Wang et al.	2003/0120306 A1	6/2003	Burbank et al.
6,080,150 A	6/2000	Gough	2004/0232201 A1	11/2004	Wenchell et al.
6,092,422 A	7/2000	Binnig et al.	2005/0070925 A1	3/2005	Shelton, IV et al.
6,109,500 A	8/2000	Alli et al.	2005/0070958 A1	3/2005	Swayze et al.
6,113,592 A	9/2000	Taylor	2005/0072827 A1	4/2005	Mollenauer
6,123,702 A	9/2000	Swanson et al.	2005/0131390 A1	6/2005	Heinrich et al.
H1904 H	10/2000	Yates et al.	2005/0145674 A1	7/2005	Sonnenschein et al.
6,126,058 A	10/2000	Adams et al.	2006/0097025 A1	5/2006	Milliman et al.
6,126,651 A *	10/2000	Mayer 606/1			
6,127,811 A	10/2000	Shenoy et al.			
6,132,425 A	10/2000	Gough			
6,193,501 B1	2/2001	Masel et al.			
6,202,914 B1	3/2001	Geiste et al.			
6,217,573 B1	4/2001	Webster			
6,228,534 B1	5/2001	Takeuchi et al.			
6,231,565 B1	5/2001	Tovey et al.			
6,241,139 B1	6/2001	Milliman et al.			
6,245,065 B1	6/2001	Panescu et al.			
6,248,117 B1	6/2001	Blatter			

FOREIGN PATENT DOCUMENTS

EP	0 647 431 A2	4/1995
EP	0 738 501 A1	10/1996
WO	WO 97/40760 A1	11/1997
WO	WO 99/52489 A1	10/1999

OTHER PUBLICATIONS

International Search Report for corresponding PCT Application - PCT/US06/21524 - Date of Mailing May 28, 2008 (4 pages).

* cited by examiner

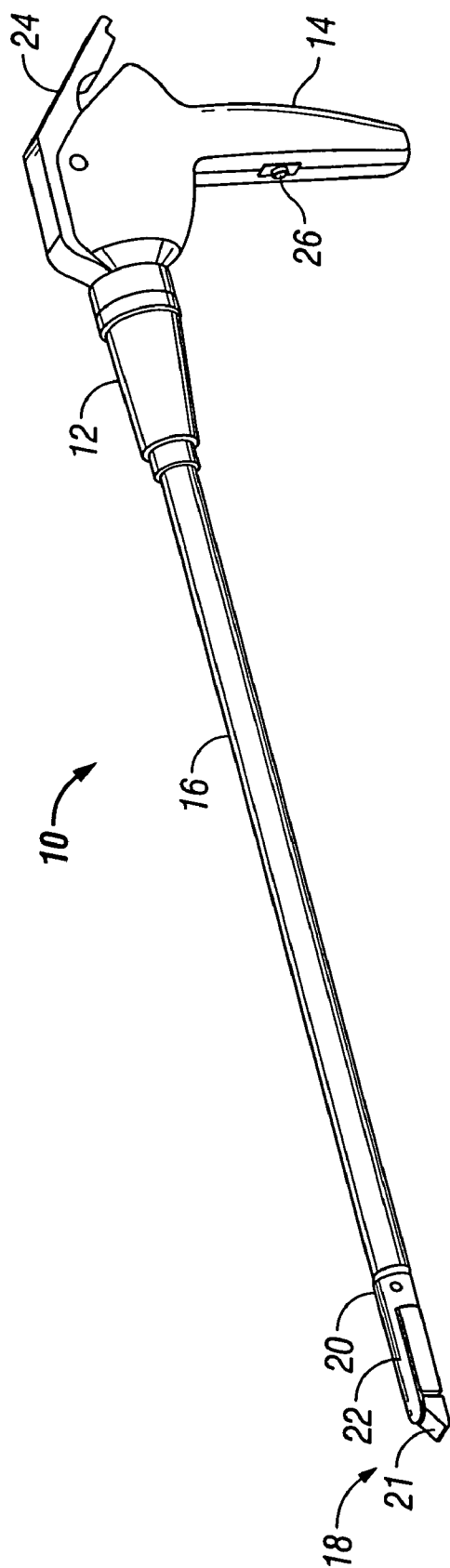
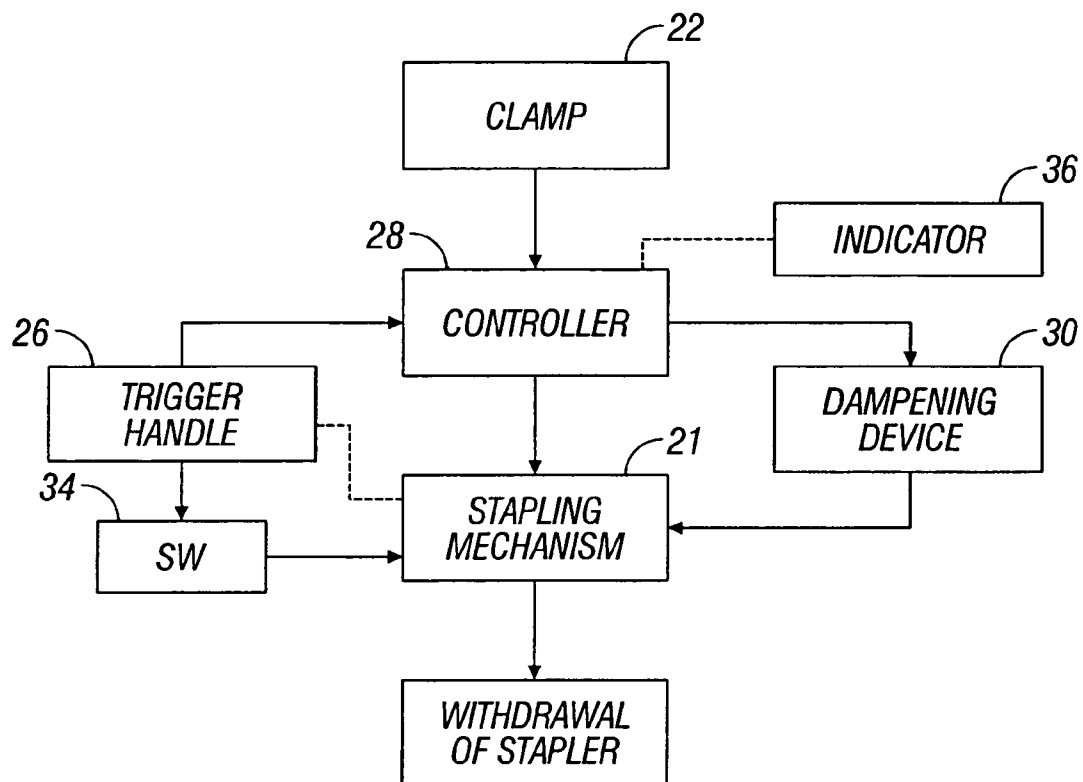

FIG. 1

**FIG. 2**

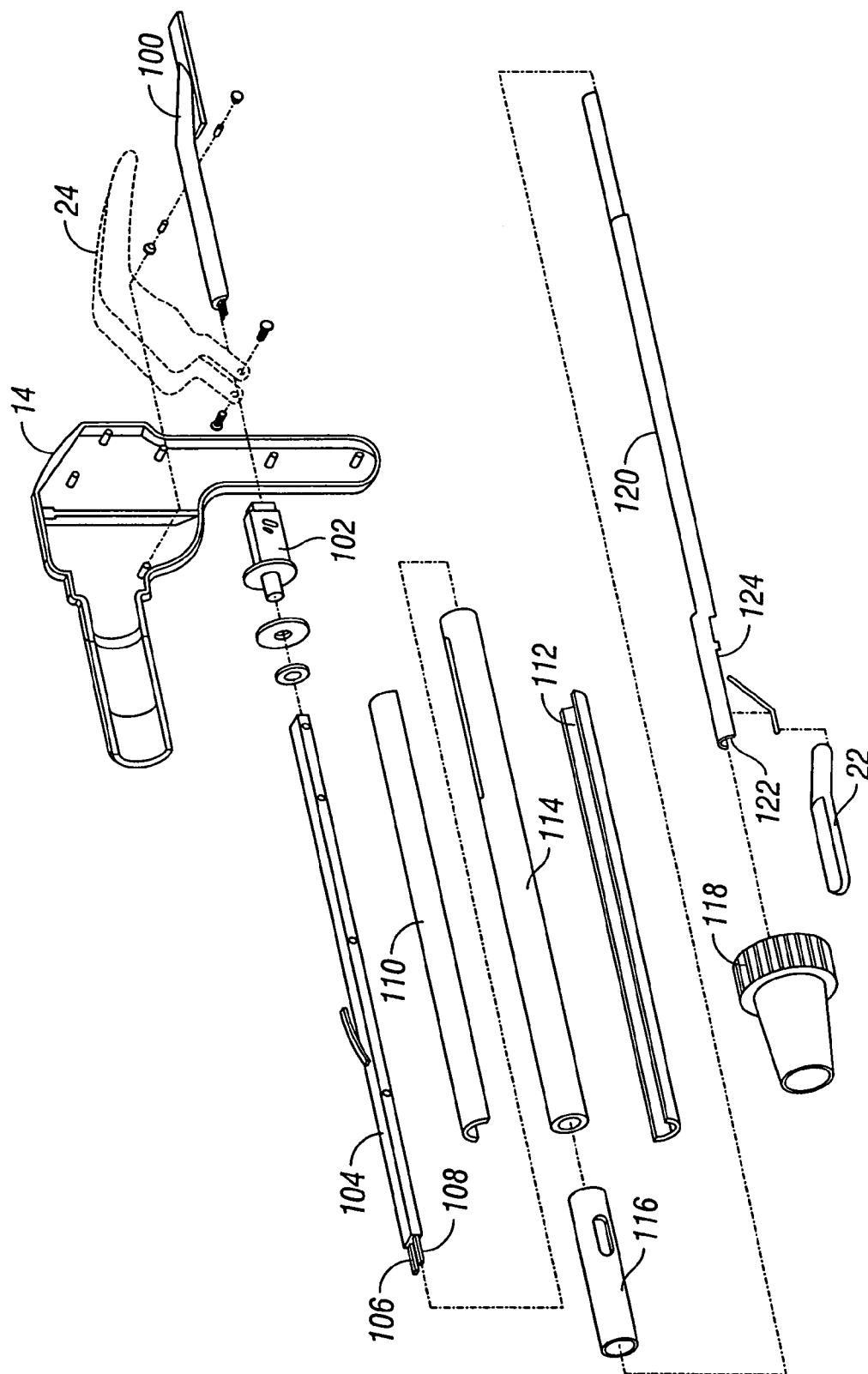

FIG. 2A

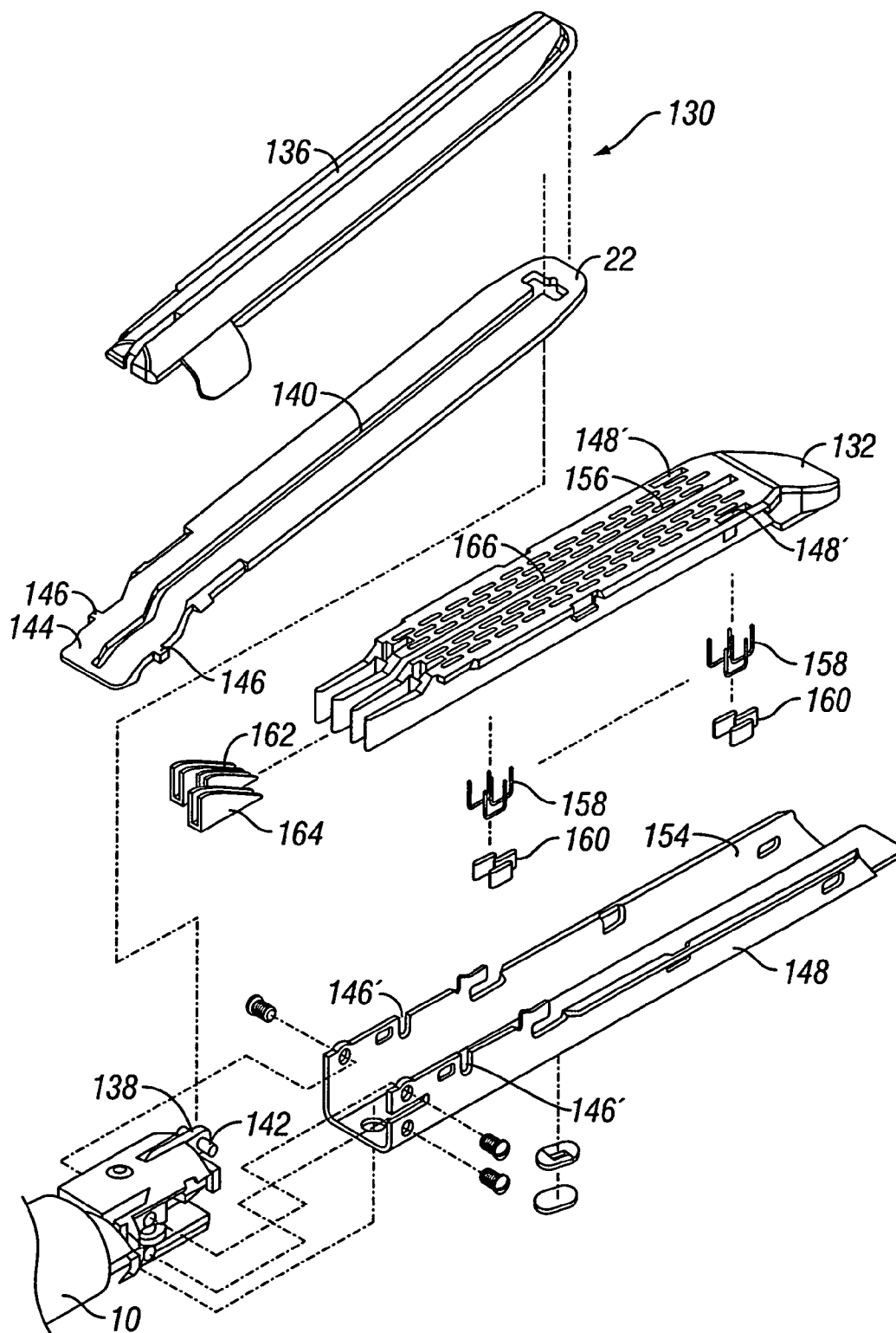

FIG. 2B

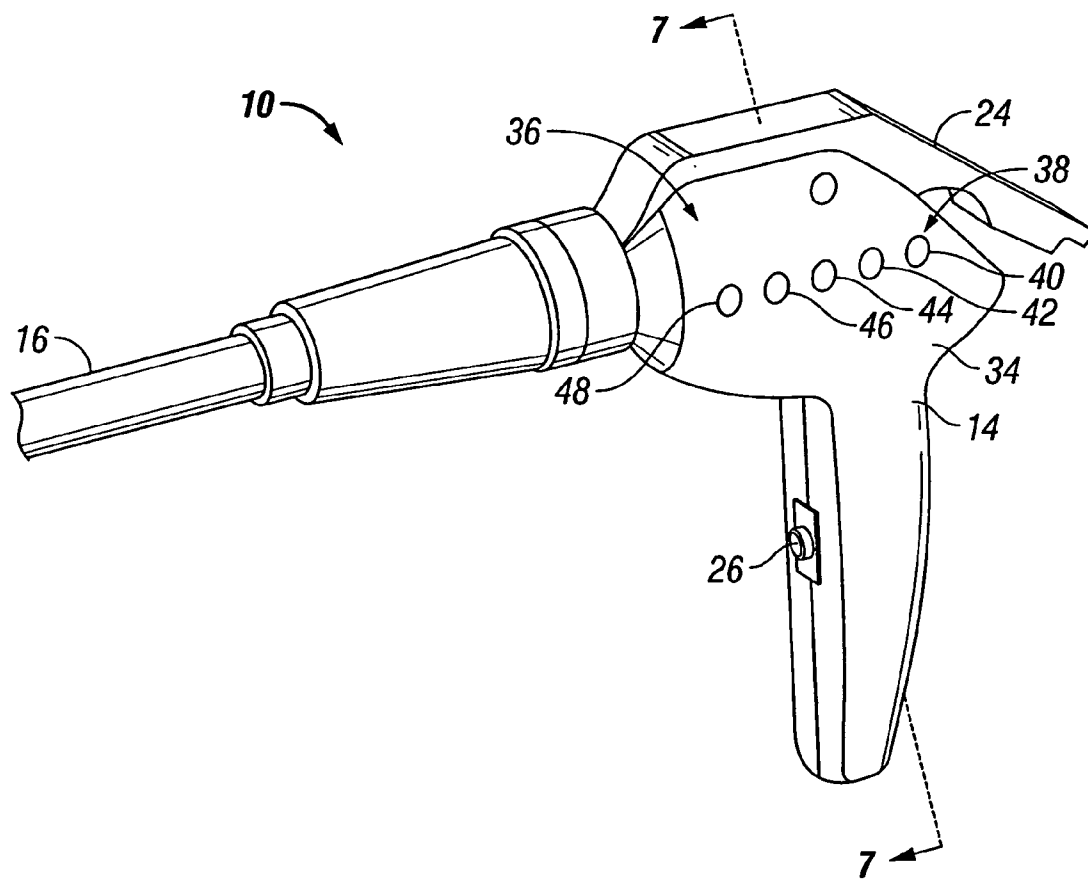
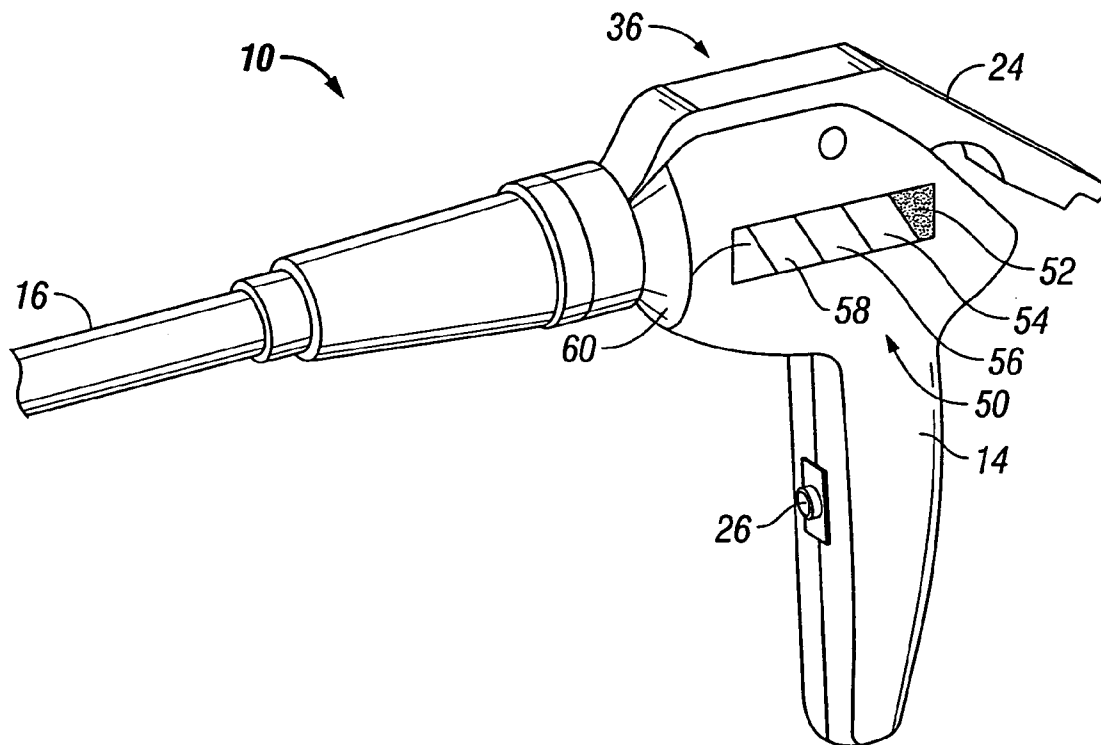
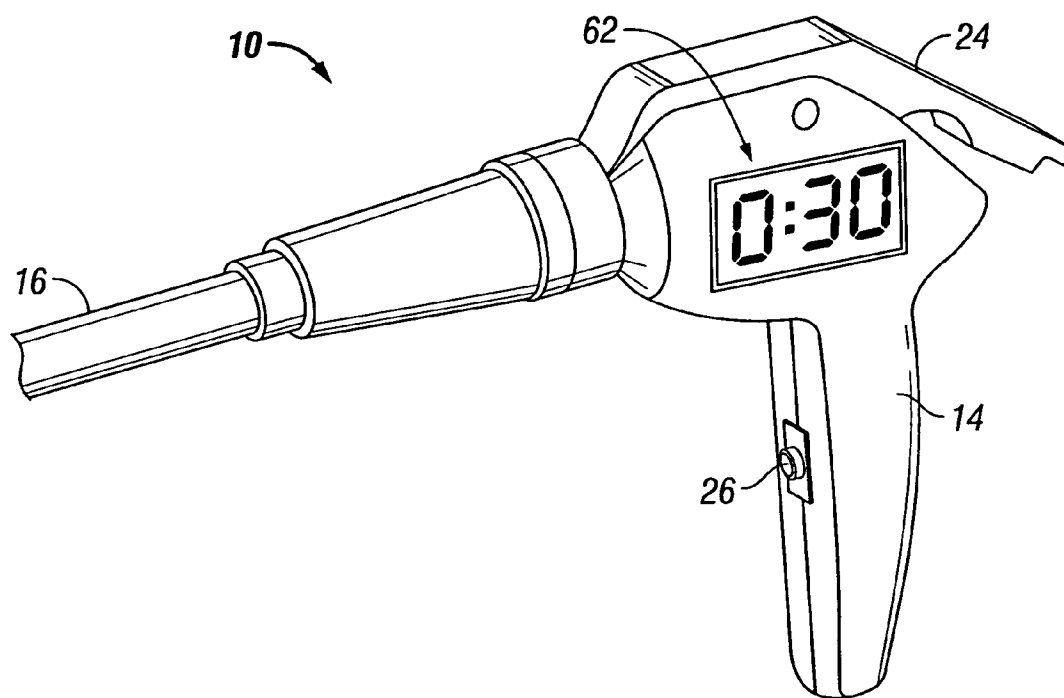
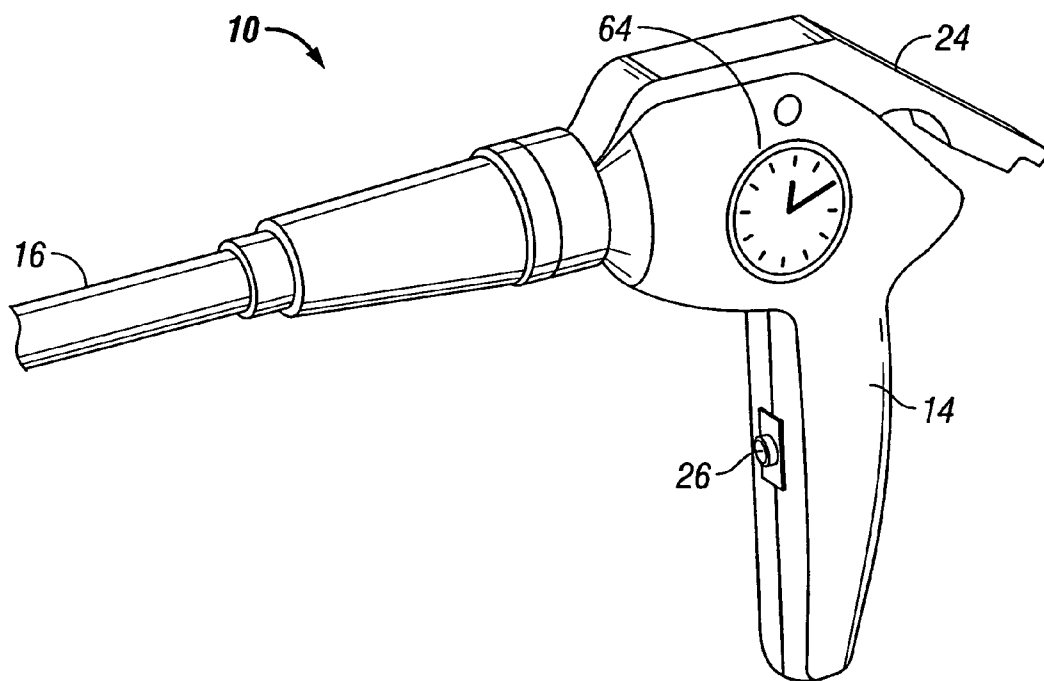

FIG. 3

**FIG. 4**

**FIG. 5**

**FIG. 6**

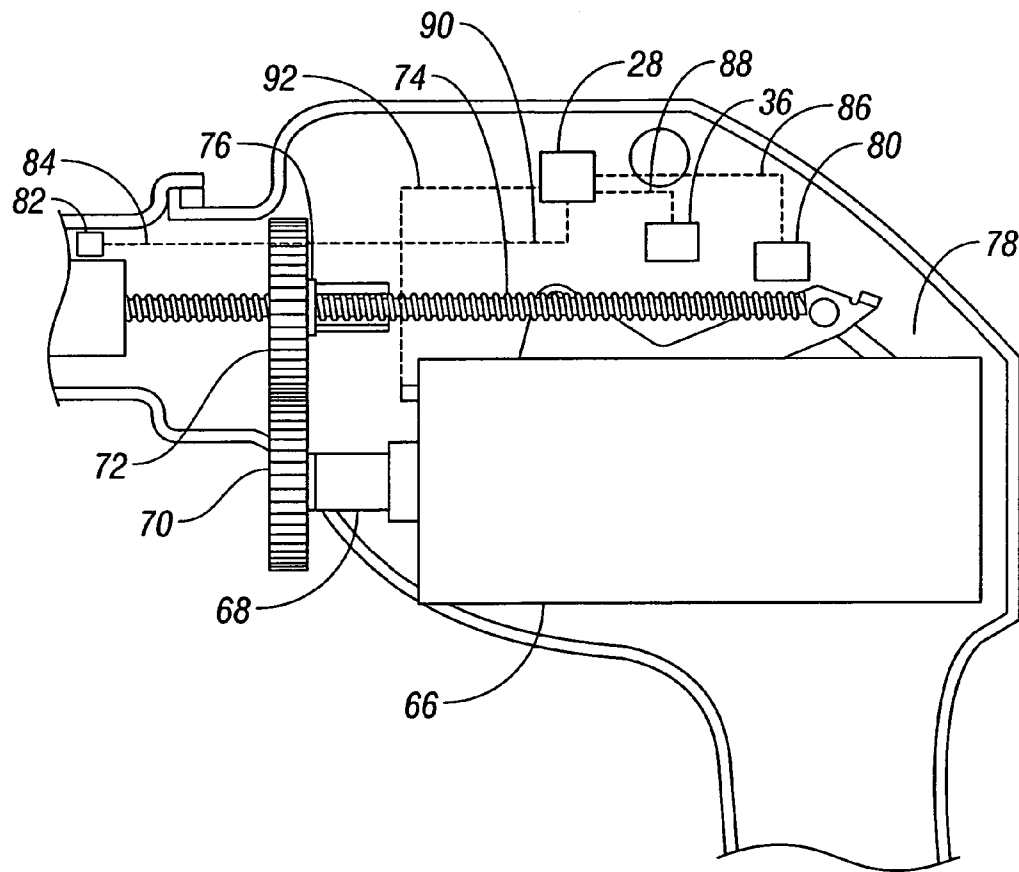

FIG. 7

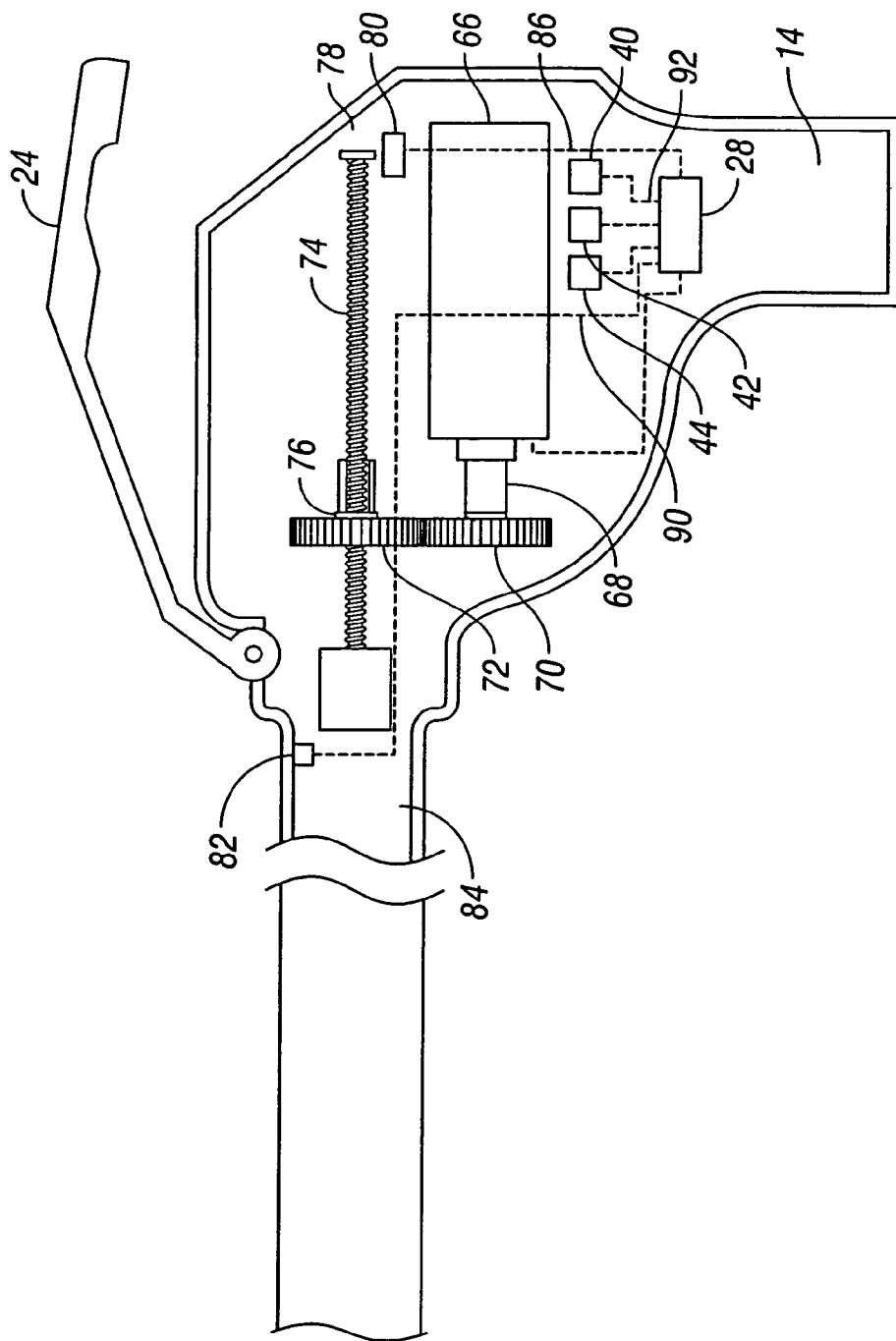

FIG. 8

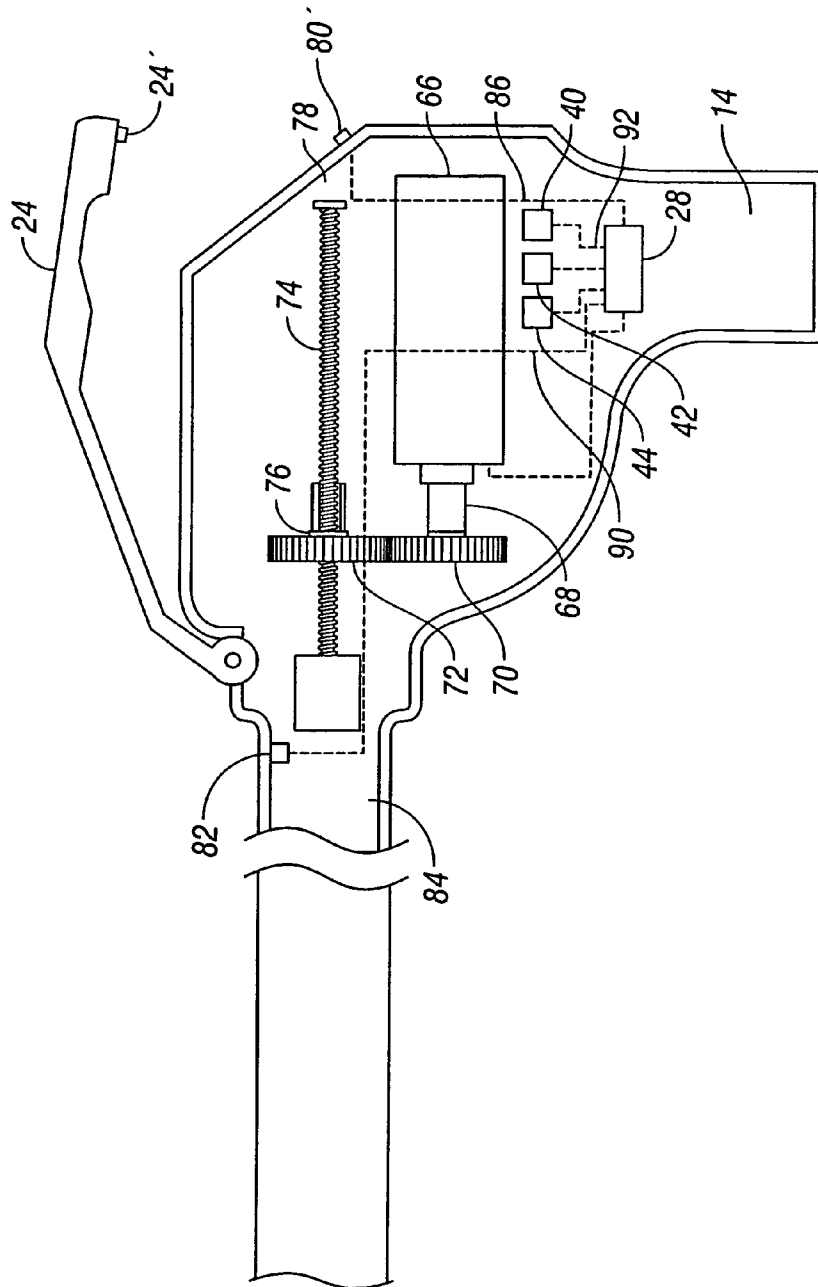

FIG. 8A

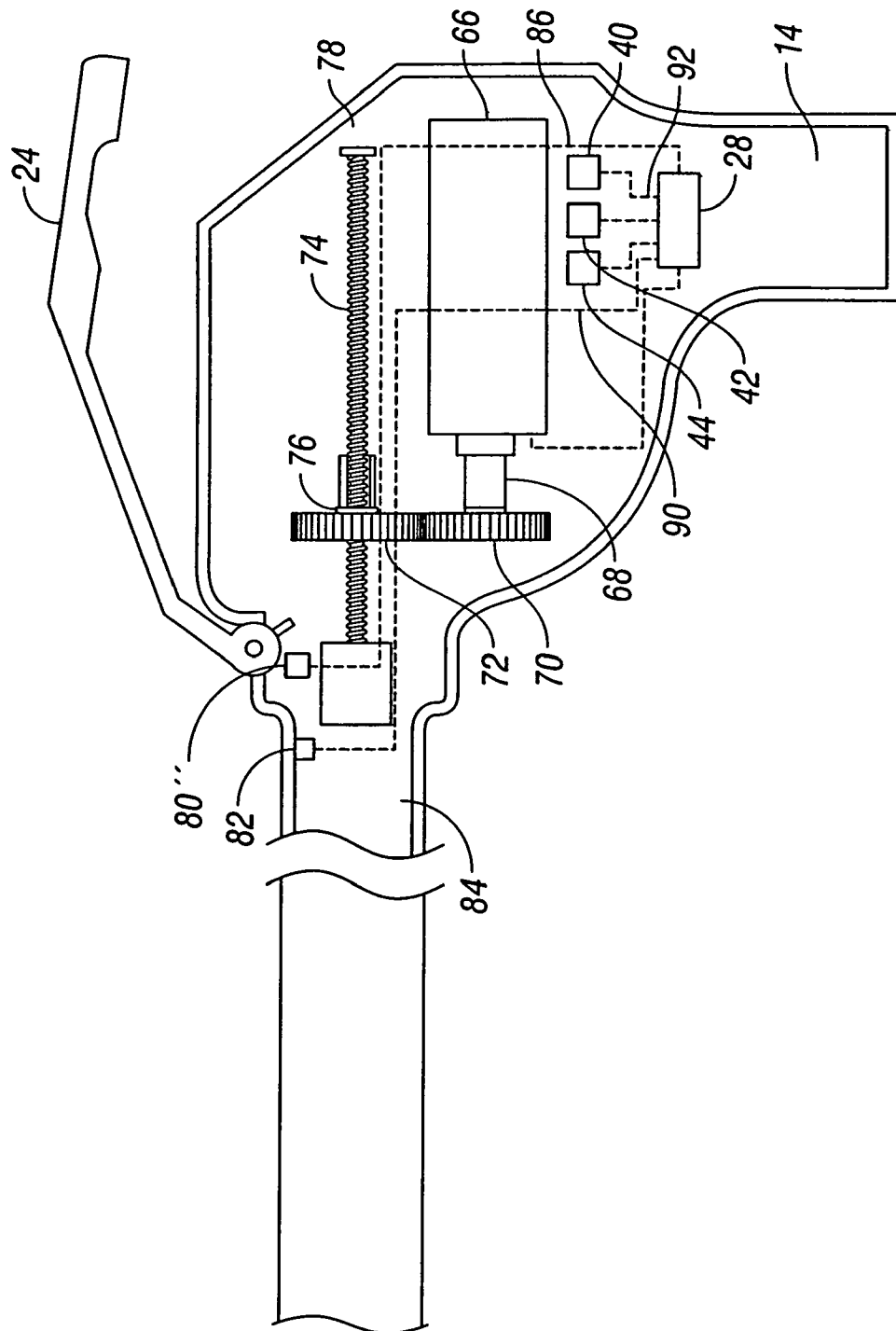
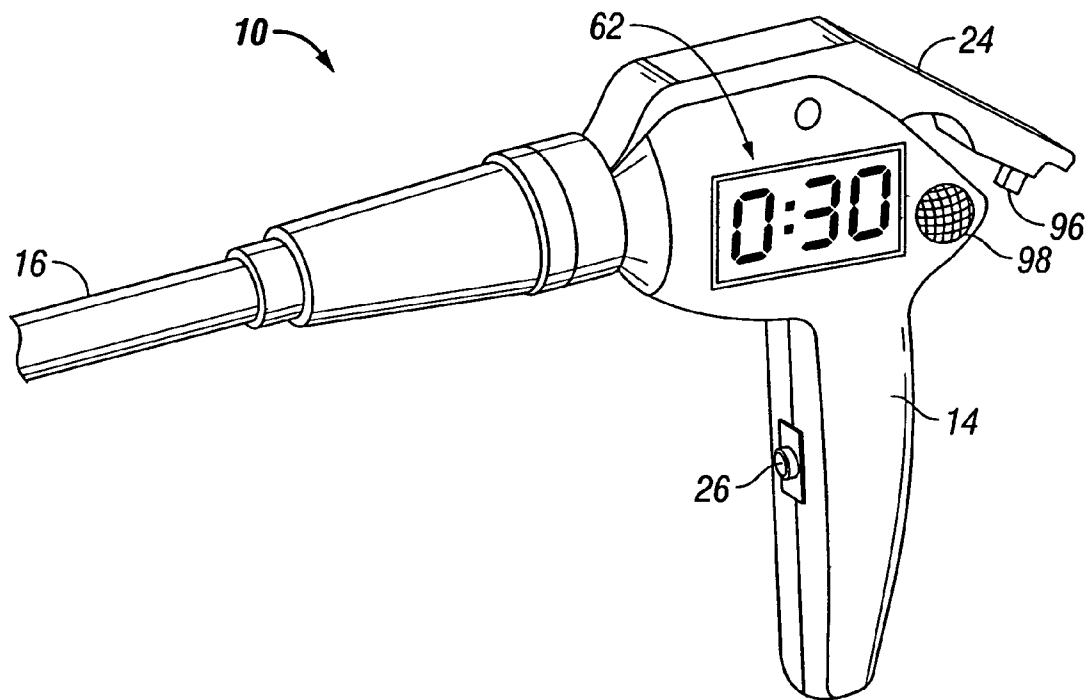

FIG. 8B

**FIG. 9**

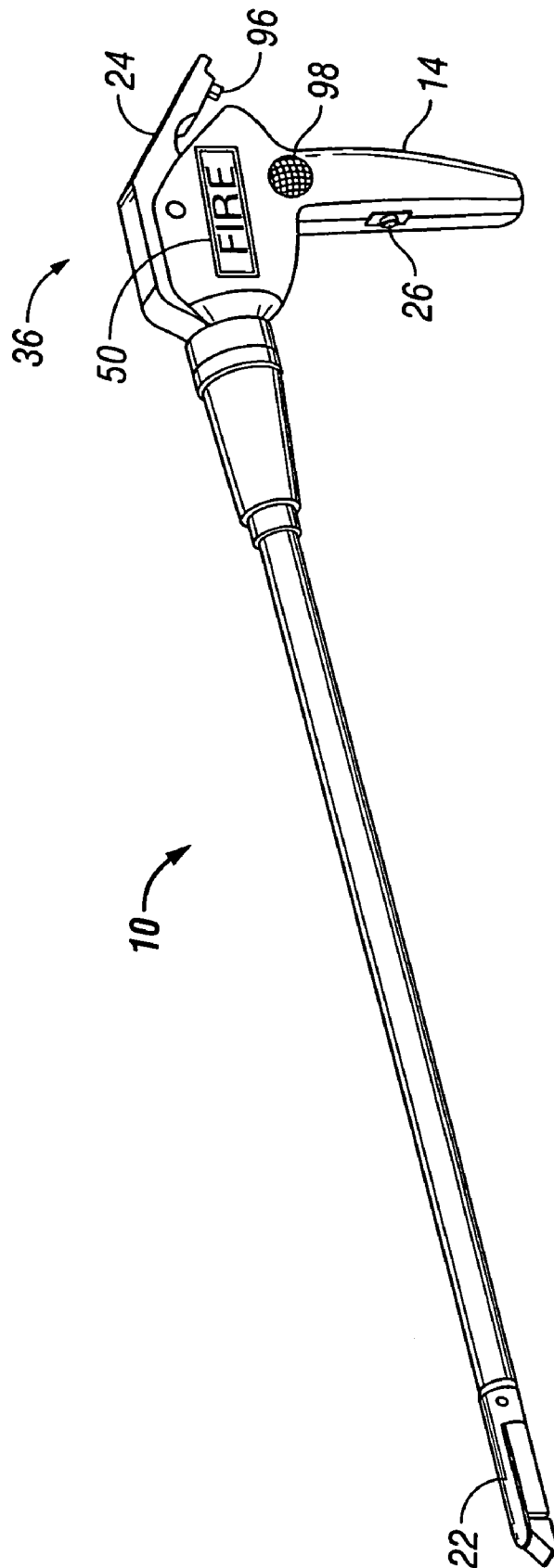

FIG. 10

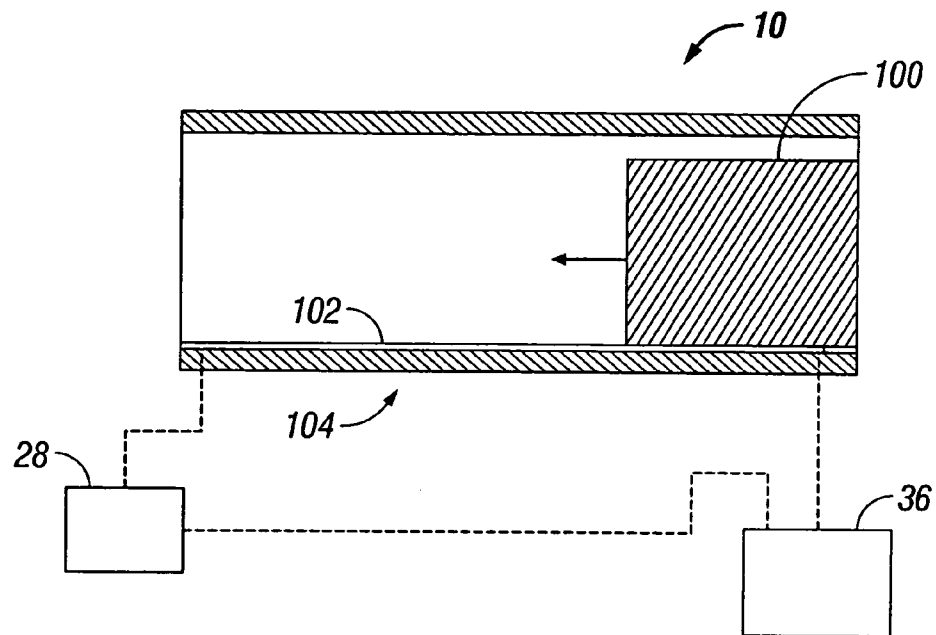

FIG. 11

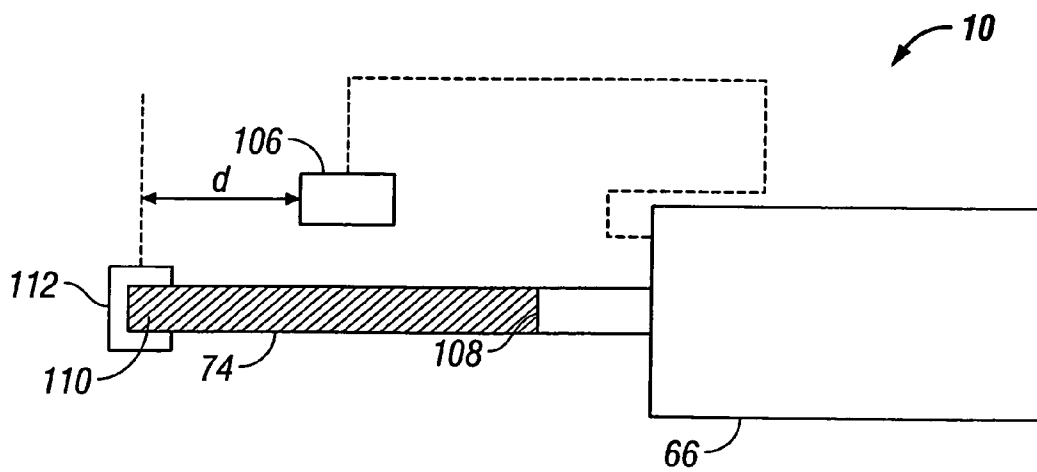

FIG. 12

1

SURGICAL STAPLER WITH TIMER AND FEEDBACK DISPLAY

CROSS REFERENCE TO RELATED PATENT APPLICATIONS

This patent application claims priority to U.S. Provisional Patent Application Ser. No. 60/687,406 to Viola, et al, filed on Jun. 3, 2005 which is herein incorporated by reference in its entirety. This patent application also claims priority to U.S. Provisional Patent Application Ser. No. 60/687,244 to Viola, et al, filed on Jun. 3, 2005 which is also herein incorporated by reference in its entirety. This patent application also relates to U.S. patent application Ser. No. 11/446,283 to Viola, et al, filed contemporaneously with the instant patent application which is herein incorporated by reference in its entirety.

BACKGROUND

1. Technical Field

The present disclosure relates to surgical instruments. More particularly, the present disclosure relates to a surgical stapling device that has a feedback and a timer device. Even more particularly, the present disclosure relates to a surgical stapling device that has a controller to modulate one or more parameters of the surgical stapling device and to provide for compression of tissue. Still even more particularly, the present disclosure relates to a surgical stapling device that may also include a sensory indicator (i.e., visual, audible, tactile) which determines position, time, or other valuable user feedback.

2. Background of the Related Art

Once under pressure from a jawed structure, such as a clamping device, of a surgical stapler, the body tissue will slowly compress. Compression by a clamping device reduces the amount of blood and fluid to the clamped tissue. Without such compression, an uncompressed body tissue remains thicker whereas the compressed body tissue would be thinner, and more compact. Compressing the tissue also causes blood and other fluid to generally traverse from the high pressure or compressed area to another low pressure or adjacent area.

Once released, the fluid due to the visco-elastic property of the tissue will return from the adjacent area to the previously compressed tissue. Some current surgical stapling devices initially compress tissue prior to the introduction of the staple into the body tissue. The amount of time tissue is compressed is currently left to the discretion of the surgeon. The surgeon manually controls the amount of time that the tissue is compressed prior to firing the staples into tissue. It would be therefore desirable to have a surgical stapling device that consistently fires staples after a predetermined amount of compression.

SUMMARY

According to a first embodiment of the present disclosure, there is provided a surgical stapler that has a handle assembly including a stationary handle and a pivotable handle mounted for manipulation through an actuating stroke. In another embodiment, the stapler may have a trigger that is operable to manipulate a cam member through the actuating stroke. The stapler also has an elongated body extending distally from the handle assembly and defining a longitudinal axis and a staple cartridge supported adjacent the distal end of the elongated body and containing a plurality of staples.

The stapler further has an anvil pivotally mounted in relation to the cartridge adjacent the distal end of the elongated

2

body with the anvil having a fastener forming surface thereon and being mounted for pivotal movement in relation to the cartridge between an open position having a distal end spaced from the staple cartridge and a closed position in close cooperative alignment with the staple cartridge. The stapler also has an actuation sled supported within the cartridge. The actuation sled moves to urge the plurality of staples from the cartridge.

The stapler further has a drive assembly including a body having a working end and a cam member supported on the working end. The cam member is positioned to translate relative to the anvil to maintain the anvil in the closed position during firing of the stapler. The trigger or pivotable handle is operatively connected to the drive assembly such that manipulation of the pivotable handle through its actuating stroke effects translation of the cam member relative to the anvil. The stapler also has a channel for supporting the staple cartridge and a controller configured to control the actuation sled supported within the cartridge. The controller delays movement of the actuation sled to urge the plurality of staples from the cartridge for a predetermined time period when the anvil is in the closed position and in cooperative alignment with the staple cartridge.

According to another aspect of the present disclosure, the surgical stapler has a handle assembly including a stationary handle and a trigger configured to manipulate a cam member through an actuating stroke. The stapler also has an elongated body extending distally from the handle assembly and defining a longitudinal axis and a staple cartridge supported adjacent the distal end of the elongated body with staples. The stapler further has an anvil pivotally mounted in relation to the cartridge adjacent the distal end of the elongated body. The anvil has a fastener forming surface thereon and is mounted for pivotal movement in relation to the cartridge between an open position having a distal end spaced from the staple cartridge and a closed position in close cooperative alignment with the staple cartridge.

The stapler also has an actuation sled supported within the cartridge. The actuation sled moves to urge the staples from the cartridge. The drive assembly includes a body having a working end and a cam member supported on the working end. The cam member is positioned to translate relative to the anvil to maintain the anvil in the closed position during firing of the stapler.

The trigger is connected to the drive assembly such that manipulation of the trigger through its actuating stroke effects translation of the cam member relative to the anvil. The stapler also has a channel for supporting the staple cartridge. The stapler also has a controller. The controller is configured to control the actuation sled supported within the cartridge. The controller delays the actuation sled's movement to urge the plurality of staples from the cartridge for a predetermined time period when the anvil is in the closed position and in cooperative alignment with the staple cartridge. The surgical stapler also has an indicator connected to the controller. The controller controls the indicator to provide an indication when the predetermined time period is reached.

According to another embodiment of the present disclosure, there is provided a method for stapling tissue. The method includes the steps of locating tissue between a staple cartridge and an anvil and compressing tissue between the staple cartridge and the anvil. The method also has the step of manipulating an actuator to fire staples from the staples cartridge. The actuator is configured to automatically delay firing staples for a predetermined time period. The predetermined time period is suitable in length to allow compression of the tissue for the predetermined time period and to allow

3

tissue to settle from a first initial state into a second compressed state. The method also has the steps of urging staples from the staple cartridge through the tissue at the elapse of the predetermined time period when the tissue is in the second compressed state.

According to another aspect of the present disclosure, the surgical stapler has a controller to place a delay between actuation of the firing mechanism component and actual firing of the staple.

According to another aspect of the present disclosure, the surgical stapler has a control device that controls a stroke parameter, a distance parameter and/or a time parameter of a firing mechanism component to increase a tissue compression time of the clamp.

According to still another aspect of the present disclosure, the surgical stapler has a motor and a first switch. The first switch is connected to a motor and delays the motor from actuating in order to achieve an amount of tissue compression by a clamp. The surgical stapler may have a second switch. The second switch senses another location of a drive screw and actuates a reverse function of the motor to return the drive screw to an initial position.

According to still yet another aspect of the present disclosure, the surgical stapler has an indicator that measure a distance traveled of the drive screw or a tissue compression time of the clamp.

According to still another aspect of the present disclosure, the surgical stapler has a visual indicator that indicates a position of the firing mechanism component or indicates a status condition of the surgical stapling.

In another embodiment of the present disclosure, there is provided a surgical stapler. The stapler has a handle assembly including a trigger and a clamping device with a staple cartridge including a plurality of staples and an anvil having a fastener forming surface thereon. The stapler has a controller configured to determine an occurrence of clamping by the anvil and the staple cartridge. The controller controls a firing of the plurality of staples from the staple cartridge. When the trigger is actuated the controller delays firing of the plurality of staples from the staple cartridge to provide for a predetermined time period of tissue compression of the tissue between the anvil and staple cartridge. The controller outputs a control signal to allow firing once the predetermined time period is reached.

DESCRIPTION OF THE DRAWINGS

Other and further objects, advantages and features of the present disclosure will be understood by reference to the following specification in conjunction with the accompanying drawings, in which like reference characters denote like elements of structure and:

FIG. 1 is a perspective view of a first embodiment of a surgical stapler of the present disclosure;

FIG. 2 is a block diagram of a number of components of the surgical stapler of FIG. 1;

FIG. 2A is an exploded view of a channel of the surgical stapler of FIG. 1;

FIG. 2B is an exploded view of the staple cartridge, anvil and the drive sled of FIG. 1;

FIG. 3 is a perspective view of another embodiment of the surgical stapler of the present disclosure having a plurality of lights;

FIG. 4 is a perspective view of still another embodiment of the surgical stapler with a linear indicator or display;

FIG. 5 is a perspective view of yet another embodiment of the surgical stapler having a digital indicator or display;

4

FIG. 6 is a perspective view of still another embodiment of the surgical stapler with an analog indicator or display;

FIG. 7 is a cross sectional view of the surgical stapler of FIG. 3 along line 7-7;

FIG. 8 is another cross sectional view of still another embodiment of the surgical stapler of the present disclosure along line 7-7 of FIG. 3 with the stapler having a first switch and a second switch;

FIG. 8A is another cross sectional view of another embodiment of the stapler of FIG. 8 having the first switch which engages a tab on the lever;

FIG. 8B is still another cross sectional view of yet another embodiment of the stapler of FIG. 8 having the first switch located distally on the lever;

FIG. 9 is another perspective view of still another embodiment of the surgical stapler with an audible alarm;

FIG. 10 is still another perspective view of another embodiment of the surgical stapler having the display showing an image;

FIG. 11 is a schematic/cross sectional view of a travel path of a drive member through an endoscopic portion of the surgical stapler with a resistor strip; and

FIG. 12 is a schematic of another embodiment of the surgical stapler having a non-contact sensor.

DETAILED DESCRIPTION

In the drawings and in the description which follows, the term "proximal", as is traditional, will refer to the end of the apparatus which is closest to the operator, while the term "distal" will refer to the end of the apparatus which is furthest from the operator.

The present disclosure can be used with any stapler device known in the art and is intended to encompass the same, and is intended to be discussed in terms of both conventional and endoscopic procedures and apparatus. However, use herein of terms such as "endoscopic", "endoscopically", and "endoscopic portion", among others, should not be construed to limit the present disclosure to an apparatus for use only in conjunction with an endoscopic tube. The apparatus of present disclosure may find use in procedures in these and other uses including but not limited to uses where access is limited to a small incision such as arthroscopic and/or laparoscopic procedures, or other conventional medical procedures. The present mechanism may also be used with surgical stapling devices that have independent or combined clamping and firing procedures. The present disclosure may further be incorporated with surgical stapling devices that have simultaneous or dependent clamping and firing mechanisms. The present disclosure is also intended to be used with such surgical stapling devices which have a discrete clamping gradient.

Referring now to the figures, wherein like reference numerals identify similar structural elements of the subject disclosure, there is illustrated in FIG. 1 a self-contained, powered surgical stapler constructed in accordance with an embodiment of the subject disclosure and designated generally by reference numeral 10. The surgical stapler 10 is generally intended to be disposable, however the disposable arrangement is non-limiting and other non-disposable arrangements may be contemplated and are within the scope of the present disclosure.

The surgical stapler 10 of the present disclosure (shown in a perspective view in FIG. 1 and described herein) includes a frame generally represented by reference numeral 12 and handle generally represented by reference numeral 14. The frame 12 defines a series of internal chambers or spaces for

5

supporting various inter-cooperating mechanical components of the surgical stapler **10** as well as a number of staples therein for the application to the body tissue.

The frame **12** supports a portion **16** or an extended tube-like portion. The portion **16** is capable of being rotated and has a relatively narrow diameter in a range of about 10 millimeters, and is for insertion into a small opening or tube inserted into the body, such as in the abdominal cavity, or other similar body cavities. The portion **16** has a longitudinal axis and has a length appropriate for reaching the operation site in the interior of the body. The surgical stapler **10** may be used in conjunction with other instruments such as endoscopes or other such optical devices for visually examining the interior of the body, for example, cameras by means of CCD devices, fiber optics or other optical or recording devices.

Generally, portion **16** of the surgical stapler **10** is inserted through the small opening or wound, and is manipulated to the operation site. The present disclosure is intended to be used with any surgical stapler including but not limited to surgical staplers having simultaneous clamping and independent clamping.

Portion **16** has a fastening assembly generally represented by reference number **18** and cutting assembly (not shown) that is known in the art. The fastening assembly **18** and the cutting assembly (not shown) are located in a housing **20** which carries a fastener and an optional cutter to the operation site. The fastening assembly **18** in this particular embodiment has a jaw or a staple cartridge **21** and a second jaw or anvil **22**. The staple cartridge **21** and the anvil **22** may be brought into close cooperative alignment with one another so the jaws **21**, **22** form a clamp therebetween. The jaws **21**, **22** may be a first and second jaw that open and close or may be another different clamping type structure as is known in the art. The staple cartridge **21** may be located at the distal end of the housing **20**, in the jaws **21**, **22** themselves or may be located in other locations as described in U.S. Pat. No. 7,044,353 to Mastro, et al. which is herein incorporated by reference in its entirety. The staple cartridge **21** has one or a number of rows of staples. The surgical stapler **10** also has an anvil (not shown) and further may include an optional knife (not shown) as is well known in the art for accomplishing the stapling. It is appreciated that the closing of the jaws **21**, **22** with the staple cartridge **21** and the anvil **22** may be accomplished by pivoting the anvil **22** relative to the staple cartridge **21**, or by pivoting the staple cartridge **21** relative to the anvil **22**, or by pivoting both the staple cartridge **21** and the anvil **22** relative to one another.

Generally, actuating the operating portion of the fastening assembly **18** is accomplished via intermediate components disposed on or within the narrow longitudinally extending tubular portion **16**. In one non-limiting embodiment, a cylindrical tubular sleeve member surrounds the portion **16**. The sleeve may be manipulated in a direction with the longitudinal axis of the surgical stapling device. The sleeve slides onto the anvil **22** for closing the jaws **21**, **22** that are biased open by a biasing device (not shown) to accomplish the clamping. The surgical stapler **10** of the present disclosure has three basic actions or functions, however, the present disclosure is intended to be used with any surgical stapler including but not limited to surgical staplers having simultaneous clamping (i.e., clamping and firing the stapler at the same time) and independent clamping (i.e., clamping prior to the staple firing).

First, portion **16** is introduced into the human or animal body and is positioned with the jaws **21**, **22** aligned at the desired stapling site to receive the target tissue. This may

6

involve rotation of the portion **16** relative to the body, either by rotating the surgical stapler **10** as a whole, by rotating simply the portion **16** relative to the frame **12** as permitted, or a combination of both actions. Thereafter (i.e., secondly), the surgical stapler **10** secures the target body tissue between the staple cartridge or jaw **21** in the distal portion of the housing **20** and the anvil **22**. This is accomplished by a clamping action of the jaws **21**, **22** or alternatively by another similar or different clamping member.

The jaws **21**, **22** are allowed to remain in the closed position for a desired period of time depending on the particular tissue. By configuring the jaws **21**, **22** to remain closed for a predetermined period of time allows any excess liquid or fluid in the tissues to drain out of the body tissues prior to actuation of the stapling cartridge **21**. This ensures that the liquid does not traverse out of the tissues after firing to form non-uniform staples and instead ensures a proper and uniform staple formation.

With the target tissue clamped between the anvil **22** and the staple cartridge **21**, a camming surface which surrounds the housing **20** and anvil **22** is employed to close the jaws **21**, **22** of the surgical stapler **10** and clamp the tissue between the anvil **22** and the tissue contacting surface of the staple cartridge **21**. The jaws **21**, **22** are clamped by actuation of a lever **24** opposite the jaws **21**, **22** as is known in the art. Thereafter, the surgeon applies the staples to the body tissue. A longitudinally extending channel is employed to deliver longitudinal motion to an axial drive member and a tissue cutting knife as is known in the art.

The axial drive member or an axial drive screw contacts pusher elements. The pusher elements drive the staples through the body tissue against the fastener or forming surface of the anvil as discussed herein. Typically, in the art the surgical stapler **10** fires usually by an actuation of a first trigger handle or alternatively using a trigger switch **26**. Thereafter, the clamping action of the jaws **21**, **22** is released and the surgical stapler **10** or a portion thereof may be withdrawn from the body.

Referring now to FIG. 2, there is shown a block diagram of the surgical stapler **10** of the present disclosure. According to a first aspect of the present disclosure, the surgical stapler **10** may have an optional controller **28**. The controller **28** is any electronic device being coupled to a memory for executing one or more readable program instructions or alternatively may be a suitable analog circuit. Still further, the controller **28** may be a suitable mechanical member or linkage for controlling one or more functions of the surgical stapler **10**.

The controller **28** is connected to an internal or external power supply and a motor and is connected between the anvil **22** and the stapling cartridge **21**. In an alternative embodiment, a trigger handle or another actuating switch or component **26** is mechanically or electronically linked or otherwise connected to the stapling cartridge **21** as is known in the art as indicated by a dotted line, and the present disclosure is not intended to be limited to any configuration. Once the stapling cartridge **21** is fired using the trigger switch **26**, the jaws **21**, **22** are opened and the firing mechanism is retracted. The surgical stapler **10** as a whole may be withdrawn from the body tissue or may be manipulated for a next or second stapling operation as shown.

The present surgical stapler **10** has the controller **28** which is connected to one of the jaw or anvil **21** or jaw or staple cartridge **21** and the trigger switch **26** or is connected to both jaws **21**, **22** and the trigger switch **26**. In one embodiment, once the desired site is reached, the surgeon uses the jaws **21**, **22** to compress the selected body tissue. Alternatively, the

surgical stapler **10** may have a single drive component that can actuate both the anvil **22** and stapling cartridge **21**.

Thereafter, the controller **28** may provide for a requisite amount of delay between clamping and firing (or after clamping and before firing) to ensure tissue compression and expulsion of fluid. After the desired compression is reached, the stapling cartridge **21** may be automatically engaged by the controller **28** to fire the staples from the stapling cartridge **21** into the body tissue or alternatively the controller **28** may send a signal to the surgeon thereby informing the surgeon a suggestion that the surgeon is to fire the staples. It is envisioned that the firing may be automatic or manual.

Furthermore, the controller **28** may control the speed with which the staples are fired from the staple cartridge **21**. Still further, the controller **28** may control an amount of delay before firing. The controller **28** in one embodiment may provide for a predetermined amount of time to elapse prior to outputting a signal to the stapling cartridge **21**. In another powered stapler embodiment, the controller **28** may slow a motor speed to increase the body tissue compression time.

In still another embodiment, the controller **28** may engage a dampening device **30**. The dampening device **30** is configured to slow the actuating of the staple cartridge **21** in order to increase the overall compression time of the body tissue. Such a dampening device **30** may be a hydraulic or a pneumatic type damper or any other device that may dampen or modulate the operation of one or more components of the surgical stapler **10**. In another embodiment, the trigger **26** may simply hold the fire signal for a predetermined time period in associated control circuitry and upon the expiration of the predetermined time period may communicate the signal to the stapling cartridge **21**.

The controller **28** may be configured to slow a motor speed, modulate a gear or, still further, engage a circuitry of the motor to slow an operation thereof to otherwise reduce actuation, i.e., a rotation rate of the axial drive screw. Still further, the surgical stapler **10** may also include an override switch **32**. The override switch **32** is an automatic or manual device (or other switch) that selectively disengages the controller **28** to permit direct actuation of the stapling cartridge **21** by the trigger switch **26** without any delay at the surgeon's discretion.

In one aspect of the present disclosure, the present surgical stapler **10** includes jaws **21**, **22** which compresses tissue between the anvil **130** and the stapler cartridge **132** of the stapling cartridge **21** (FIG. 2B). The jaws **21**, **22** are understood in the art as a device that allows the surgeon to manipulate and compress tissue between the anvil **130** and the staple cartridge **132** as shown in FIG. 2B. The jaws **21**, **22** may be independently powered by a power source such as a motor or pneumatic device, or may be powered by the same power source as the staple cartridge **21**. The surgical stapler **10** uses the jaws **21**, **22** to clamp tissue between the stapler cartridge **132** and the anvil **130** (FIG. 2b), then when the stapler **10** is fired the jaws **21**, **22** may be further tightened and then the staples **158** urged from the stapling cartridge **21**.

In one aspect, the surgical stapler **10** may pre-clamp or compress tissue using the jaws **21**, **22** for a first interval. The first time interval may be preset and fixed, or variable depending on the tissue type. The first time interval may be for minutes, seconds or any other variable or fixed predetermined period of time. Then prior to stapling, the jaws **21**, **22** may further tighten to further compress the tissue for another second compression time interval and then fire. The second time interval may be different from the first time interval and can be shorter or longer than the first. In another aspect, the

instrument may pre-clamp or compress tissue using the jaws **21**, **22** and then simply automatically fire the device to urge the staples **158** from the staple cartridge **132** at the conclusion of the first interval. Various configurations are possible, and the present surgical stapler **10** may have program instructions for any number of compression intervals desired by the surgeon and/or designer. The surgical stapler **10** may alternatively further use a second separate clamping device in association with the stapler **10**. It is understood that the present disclosure may be incorporated into an instrument that approximates the tissue before firing such as with a TA surgical stapler such as U.S. Pat. No. 6,817,508 to Racenet, et al. which is herein incorporated by reference in its entirety, or can be used with an instrument that requires no such approximation before firing.

In another embodiment of the present disclosure, the surgical stapling device **10** may provide the surgeon with feedback by virtue of an indicator **36**. The indicator **36** may display an amount of compression time and/or provide feedback of the status of the stapling, or display information relating to the location of the drive screw, or drive member. In another embodiment of the present disclosure, the surgical stapler **10** may not have separate clamping and firing actuators and include a clamping gradient indicator **36** or simultaneous clamping and firing indication mechanism. For example, the surgical stapler **10** may be configured to allow control of the firing speed which, in turn, controls the clamping speed and timing and then provide optimal compression for squeezing the tissue and pushing the blood and fluid out of the tissue at the desired site.

FIG. 2A shows an exploded view of a number of components of the surgical stapler **10** of FIG. 1. The stapler **10** has a rack **100** that is slidable in the handle portion **14**. The rack **100** interfaces with a clamp tube **102**. On a distal side of the clamp tube **102** is a channel **104**. The channel **104** engages with the clamp tube **102** and a pair of forks **106**, **108** on a distal side thereof. The stapler **10** also has an upper cover **110** and a lower cover **112**, and an extension tube **114**. The extension tube **114** engages with a collar tube **116**. The stapler **10** also has a rotation knob **118** with a channel portion **120**. The channel portion **120** has a pair of camming surfaces **122** on a distal end. The distal end also has a crimp **124** in a distal side to receive the anvil **22**.

In operation, the rack **100** slides and moves the clamp tube **102** distally. The clamp tube **102** is provided to interconnect the handle portion **14** and the extension tube **114**. The channel **104** is slidably mounted for reciprocal longitudinal motion. The extension tube **114** provides support for the surgical stapler **10** and has slots that interface with the collar tube **116**. The surgical stapler **10** also has a support **120** for longitudinal motion and to operate the stapling mechanism as described in FIG. 2b. The operation of these components is well known and is disclosed in U.S. Pat. No. 5,318,221 to Green, et al., which is herein incorporated by reference in its entirety.

Advantageously, the rack **100** moves distally to advance the channel **104** in a distal manner. The channel **104** delivers longitudinal motion to a pusher cam bar as is known in the art for operation of the stapler cartridge **21** shown in FIG. 2b. It should be appreciated that the components shown in FIG. 2a only illustrate one embodiment of the present surgical stapler **10**, and instead of the rack **100**, the surgical stapler **10** may have a drive screw (not shown) for longitudinal motion and in order to actuate the stapler cartridge **21**. Referring now to FIG. 2b, there is shown an exploded view of the anvil **22** and the stapler cartridge **132** having an actuation sled **169**.

Referring to FIG. 2b, the stapler cartridge **21** includes an anvil assembly **130** and a cartridge assembly **132** shown in an

exploded view for illustration purposes. The anvil assembly **130** includes anvil portion **22** having a plurality of staple deforming concavities (not shown) and a cover plate **136** secured to a top surface of anvil portion **134** to define a cavity (not shown). The cover plate **136** prevents pinching of tissue during clamping and firing of the surgical stapler **10**. The cavity is dimensioned to receive a distal end of an axial drive assembly **138**.

The anvil **130** has a longitudinal slot **140** that extends through anvil portion **130** to facilitate passage of retention flange **142** of the axial drive assembly **138** into the anvil slot **140**. A camming surface **144** formed on anvil **22** is positioned to engage axial drive assembly **138** to facilitate clamping of tissue. A pair of pivot members **146** formed on anvil portion **130** is positioned within slots **146'** formed in carrier **148** to guide the anvil portion **130** between the open and clamped positions.

The stapler **10** has a pair of stabilizing members **152** engage a respective shoulder formed on carrier **148** to prevent anvil portion **30** from sliding axially relative to staple cartridge **132** as camming surface of the anvil **130** is deformed. Cartridge assembly **132** includes the carrier **148** which defines an elongated support channel **154**. Elongated support channel **154** is dimensioned and configured to receive the staple cartridge **132** which is shown above the carrier **148** in the exploded view of FIG. 2b. Corresponding tabs and slots formed along staple cartridge **132** and elongated support channel **148'** function to retain staple cartridge **132** within support channel **154** of carrier **148**. A pair of support struts formed on the staple cartridge **132** are positioned to rest on side walls of carrier **148** to further stabilize staple cartridge **132** within support channel **154**, however other arrangements to support the cartridge **132** on the channel **154** can be used and this arrangement is not limiting.

Staple cartridge **132** includes retention slots **156** for receiving a plurality of fasteners **158** and pushers **160**. Longitudinal slots **156** extend through staple cartridge **132** to accommodate upstanding cam wedges **162** of the actuation sled **164**. A central longitudinal slot **166** extends along the length of staple cartridge **132** to facilitate passage of a knife blade (not shown). During operation of surgical stapler **10**, actuation sled **164** is drive distally to translate through longitudinal slot **156** of staple cartridge **132** and to advance cam wedges **162** distally and into sequential contact with pushers **160**, to cause pushers **160** to translate vertically within slots **156** and urge fasteners **158** from slots **156** into the staple deforming cavities of anvil assembly **130** to effect the stapling of tissue.

Referring to FIG. 3, the surgical stapler **10** may include indicator **36** which may be any device known in the art to provide sensory feedback to the surgeon. The indicator **36** may be any device that permits a visual, tactile or audible monitoring of one or more conditions of the surgical stapler **10**. The indicator **36** may be disposed on outer surface **34** and disposed on the handle **14**. Alternatively, the indicator **36** may be disposed on portion **16**, on the trigger switch **26**, on the lever **24** or in any other suitable location where the indicator **36** may be easily viewed by the surgeon without a change in position of change in footing by the surgeon.

In one embodiment, as shown the indicator **36** includes a number of light bulbs **38**. The lights **38** may be one light or a series of many lights bulbs or LEDs with one color or an assortment of two or more colors. Each of the lights **38** may have a color representing one or more conditions of the surgical stapler **10**. Alternatively, one or all of the lights **36** may flash to indicate a condition of the surgical stapler **10**.

Upon being actuated by the trigger switch **26**, the surgical stapler **10** may impart a delay before firing of the staples.

However, in order to provide the proper feedback to the surgeon, the lights **38** provide, for example, a visual indication of the progress of the firing of the stapling cartridge **21**. For example, still referring to FIG. 3, there is shown a first light **40**, a second light **42**, a third light **44**, a fourth light **46**, and a fifth light **48**. As the axial drive screw (not shown and in the handle) travels the predetermined drive path the lights **40**, **42**, **44**, **46**, and **48** illuminate in series to portray the relative distance of the drive screw on the exterior of the handle. When the lights **40**, **42**, **44**, **46**, and **48** are illuminated, the stapling cartridge **21** fires which ensures that proper tissue compression occurs prior to deployment of the staples.

Referring now to FIG. 4, in another exemplary embodiment of the present disclosure, the surgical stapler **10** includes a linear indicator **50** having a plurality of discrete segments, first segment **52**, second segment **54**, third segment **56**, fourth segment **58**, and fifth segment **60**. Again, once the trigger switch **26** is actuated to fire the stapling cartridge **21**, the segments **52**, **54**, **56**, **58**, and **60** each illuminate in a predetermined pattern to indicate to the surgeon the status of the progression of the drive screw in the handle **14**.

Upon all of the segments **52**, **54**, **56**, **58**, and **60** being illuminated, the stapling cartridge **21** fires the staple into the body tissue with assurance that an amount of compression time of the body tissue has lapsed. Linear display **50** may have one or more different colors or combinations of colors to indicate a position of the drive screw such as "red" to indicate firing and "green" to indicate that the firing is complete or vice versa. Still further the linear display **50** may display one or more graphical representations, images, or pictures to indicate one or more conditions or operating parameters of the surgical stapler **10**.

For example, the linear display **50** may indicate "FIRE" or "COMPLETE", or any other graphical representation to indicate that surgical stapler **10** will fire at the predetermined time period. Various possible combinations are possible and all are within the scope of the present disclosure.

In still another exemplary embodiment of the present disclosure shown in FIG. 5, the surgical stapler **10** may include a digital display **62**. The digital display **62** may indicate a count down or count up (or other time interval) after actuation of the trigger switch **26**. For example, the digital display **62** may count down to the desired stapling time after compression to ensure a predetermined amount of tissue compression by the jaws **21**, **22**. The digital display **62** may be activated by the jaws **21**, **22** being brought in close alignment with one another or activated independent of clamping. A desired clamping interval may be preset for desired tissue.

Alternatively, the digital display **62** may be selectively preset and input by the surgeon using an input device (not shown) or button. The surgeon may input a time period of clamping into the display **62**. Thereafter, the display **62** will suggest firing at the elapse of the clamping time period, or may automatically fire after a predetermined clamping time elapses (e.g., such as from about ten seconds to forty five seconds) to ensure proper tissue compression. The digital display **62** may be configured to count down from the predetermined set interval of clamping and visually communicate a signal to the controller **28**. The controller **28** after receiving the signal allows the desired time period of clamping to elapse. After the set time period expires, the controller **28** may communicate a second signal to actuate the stapling cartridge **21**. Alternatively, the controller **28** may simply modulate the speed of the motor to commence operation at a speed suitable to actuate the stapling cartridge **21** at the end of the desired time period. In still yet another embodiment, the digital display **62** may be configured to initiate counting after com-

11

mencement of the clamping of tissue and then simply display the time from that point onwards to allow the surgeon to monitor and manually actuate the trigger switch 26 at the expiration of the desired time period. Thereafter, the digital display 62 may simply display or flash the compression time to the surgeon and the exact amount of elapsed time. It is appreciated that the instrument may provide a predetermined delay and then indicate that the instrument is ready to be manually fired, or alternatively the instrument may delay then indicate and then automatically fire.

Referring now to FIG. 6, the surgical stapler 10 may alternatively have an analog display 64 disposed on the outer surface of the handle 14 which functions similar to the digital display 62. Analog display 64 may have an audible alarm or alternatively have a flashing light to indicate that the appropriate tissue compression time has been reached or exceeded.

Referring now to FIG. 7, there is shown a cross sectional view of the handle 12 of the surgical stapler along line 7-7 of FIG. 3. In this embodiment, the surgical stapler 10 is a powered device and has a motor 66 with a driving mechanism. The driving mechanism is a drive output shaft 68. Shaft 68 connects to a first gear 70. The first gear 70 is connected to a second gear 72 which, in turn, engages an axial drive screw 74. The motor 66 may be a device that drives one or more components of the surgical stapler 10.

The drive screw 74 is a threaded rod having a number of helical grooves that are intended to rotate and contact another member to actuate the stapling cartridge 21 in the distal location of the surgical stapler 10 once compression is made by the surgeon using the clamp or jaws 21, 22. The axial drive screw 74 is disposed in toothed engagement through a central bore 76 of the second gear 72. The axial drive screw may also be disposed offset from the second gear 72 or in any other desired geared arrangement. Upon actuation of the motor 66, the axial drive screw 74 rotates and traverses distally through the portion 16 of the surgical stapler 10 to engage the stapler cartridge 21 as is well known in the art. Alternatively, the surgical stapler 10 may have a drive piston or plunger instead of the axial drive screw 74 or a single drive mechanism to control both the anvil 22 and the stapling cartridge 21. Such mechanisms are well known in the art and may be found in U.S. Pat. No. 6,330,965 B1 to Milliman, et al., U.S. Pat. No. 6,250,532 B1 to Green, et al., U.S. Pat. No. 6,241,139 B1 to Milliman, et al., U.S. Pat. No. 6,109,500 to Alli et al., U.S. Pat. No. 6,202,914 B1 to Geiste, et al., U.S. Pat. No. 6,032,849 to Mastri, et al. and U.S. Pat. No. 5,954,259 to Viola, et al., which are all herein incorporated by reference in their entirety.

The surgical stapler 10 may include a first switch 80. Switch 80 is located in a fixed position of the handle as shown. The stapler 10 also has a second switch 82 disposed distally relative to the first switch 80 that is distal or near the path of the drive screw 74 in the first initial position 78. Likewise, the second switch 82 in a second firing position 84 which is disposed distally from the first initial position and proximal or near the path of the drive screw 74. Each of the first and second switches 80, 82 is a limit switch, but alternatively may be any switch known in the art to change or toggle from a first position to a second position by a simple motion of the axial drive screw 74 traversing past or adjacent to the respective limit switch.

Once the axial drive screw 74 or a portion thereof traverses past the first switch 80, the first switch communicates a signal to the controller 28 by lead 86. The controller 28 thus illuminates the indicator 36 or a portion thereof by lead 88 to indicate to the surgeon a first location of the axial drive screw 74.

12

Thereafter, the drive screw 74 or a portion thereof traverses or contacts the second switch 82 at the second firing position 84. The second switch 82 is also a limit switch and communicates a second signal to the controller 28 by lead 90 of the location or firing of the stapler cartridge 21. The controller 28 then illuminates indicator 36 (or another portion thereof) by lead 88 to indicate to the surgeon that the stapling has been completed. At the conclusion of the stapling, the surgeon/operator will initiate retraction and then will reverse a direction of the motor 66 by lead 92. The motor 66 then reverses operation and returns the axial drive screw 74 to the initial position 78 for the next stapling operation.

Alternatively, controller 28 upon receiving the first signal from the first switch 80 by lead 86 modulates one or more operations of the surgical stapler 10. For example, in response to receiving of the first signal, the controller 28 can control one or more parameters of the surgical stapler 10 including tissue gap, speed of the motor 66, control stroke of the axial drive screw 74, axial drive screw travel distance, rotational rate of the axial drive screw and any combinations thereof.

Referring now to FIG. 8, the surgeon may operate/engage the firing mechanism in order to actuate the stapling cartridge 21. The firing mechanism actuates the motor 66 shown in FIG. 8. The axial drive screw 74 commences rotation and by traversing past switch 80 the drive screw 74 actuates the first switch 80. The first switch 80 outputs the signal to the controller 28 by lead 86. The controller 28 in response to the signal from the first switch 80 then actuates the first light 40 by lead 92. The surgical stapler 10 may further have a suitable structure in order to engage a stop feature. The stop feature prohibits overdrive of the drive screw 74.

Thereafter, after the axial drive screw 74 traverses a predetermined distance to ensure tissue compression by the clamp or jaws 21, 22. The second switch 82 is actuated and outputs a second signal to the controller 28 by lead 90. The controller 28 in response to the second signal illuminates the second light 42 by lead 94. The second light 42 indicates that the stapling cartridge 21 has fired. The second switch 82 may further emit a signal to the controller 28 to reverse or cease motion in that direction of the motor 66 or to return the axial drive screw 74 to the initial position. The physician/operator may also manually reverse the direction of the motor 66. A third light 44 may illuminate to indicate to the surgeon that the axial drive screw 74 is returning to the initial position 78.

FIG. 8A illustrates another embodiment of the present stapler. In the embodiment shown, the surgeon may operate/engage the firing mechanism in order to actuate the stapling cartridge 21. However, the first switch 80' is in a different location than the embodiment shown in FIG. 8. In this embodiment, the first switch 80' is located immediately under the lever 24 proximal to handle 14. The switch 80' in the embodiment of FIG. 8A engages a tab 24' disposed on the lever 24. When the lever 24 is actuated and driven toward the handle 14, the tab 24' contacts switch 80', and the switch 80' outputs the signal to the controller 28 by lead 86. The controller 28 in response to the signal from the first switch 80 then actuates the first light 40 by lead 92.

Thereafter, after the axial drive screw 74 traverses a predetermined distance to ensure tissue compression by the clamp or jaws 21, 22, the second switch 82 is actuated and outputs a second signal to the controller 28 by lead 90. Again, the controller 28 in response to the second signal illuminates the second light 42 by lead 94. The second light 42 indicates that the stapling cartridge 21 has fired. The second switch 82 that is actuated by switch 80' may further emit a signal to the controller 28 to reverse or cease motion in that direction of the motor 66 or to return the axial drive screw 74 to the initial

13

position. A third indicator **44** may be included to indicate to the surgeon that the axial drive screw **74** is returning to the initial position **78**.

FIG. **8B** shows still another embodiment wherein the first switch **80**" is located at still another location of the handle **14**, and on an opposite distal side of the lever **24** in proximity to pivot. Various configurations are possible and within the scope of the present disclosure, and switch **80**" may be placed in various configurations relative to the lever **24**.

FIG. **9** shows the surgical stapler **10** with a lever **24**. The lever **24**, shown in the elevated position, controls the clamp or jaws **21**, **22**, however this arrangement is not limiting and another driving member may control the clamp or jaws **21**, **22** such as the motor **66** (FIG. **7**). The lever **24** opens and closes the jaws **21**, **22** of the clamp to compress the body tissue prior to surgical stapling. The surgical stapler **10** further includes an electrical contact **96** with an electrically conductive member to complete a suitable analog or digital circuit. The electrical contact **96** is in a complementary nesting location of the lever **24** when the lever is in a lowered position or mating with the handle **14**. When the lever **24** is lowered from an elevated or raised position to the lowered position or contacting the handle **14**, the lever **24** engages the electrical contact **96**. The electrical contact may complete a suitable timer circuit of the display **62** when in the lowered position. In this embodiment, the electrical contact **96** commences the display **62**. The display **62** may count upwards from zero to a predetermined time limit, or may count down from an ideal predetermined tissue compression time interval. Once the displayed time reaches the predetermined time interval, an audible alarm **98** may sound. The audible alarm **98** provides the surgeon with a cue that the optimal tissue compression time has been reached, and that the firing mechanism should be actuated in order to fire the staple from the staple cartridge **21** to ensure a uniform staple formation.

FIG. **10** illustrates in still another embodiment where the clamp formed by jaws **21**, **22** is actuated by lowering the lever **24**. Contemporaneously, the timer circuit of the display **62** is activated by the electrical contact **96** on the lever **24**. The indicator **36** may be the linear display **50** which indicates a first color to prompt for the actuation of the stapling mechanism **21** by the trigger switch or button **26**. The display **50** may then display a second image or illuminate the number of segments corresponding to a travel path of the axial drive screw **74** as shown in FIG. **7**. Upon actuation, the second switch **82** outputs a signal to the controller **28**. The controller **28** then stops the motor **66**, and the controller outputs a control signal to the display **50** to modulate the display from the first color to another second color or from a first image to a second image to indicate that the stapling cartridge **21** has fired. Optionally, the controller **28** may further sound the audible alarm **98** indicating that the stapling cartridge **21** has fired. The alarm may be any sound or audible pattern, including a buzzer, a song, a chirp, a chime or any combinations thereof. Various indicator configurations are possible and within the scope of the present disclosure.

In still another embodiment, the jaws **21**, **22** may be actuated by lowering the lever **24**. Contemporaneously, the timer circuit of the display **62** is activated by the lever **24**. Thereafter, the indicator **36** indicates a first indication to prompt for an actuation of the stapling cartridge **21** by actuating switch **26** after a desired time period elapses. Once the trigger switch **26** is actuated, the controller **28** activates the motor **30**. The motor **30** then moves the drive screw **74** as shown in FIG. **7**.

As the axial drive screw **74** moves in an axial manner, the drive screw (or another plunger **100** connected thereto as shown in FIG. **11**) contacts a second member **102**. Second

14

member **102** may be any member that modulates based on the motion of the plunger **100** and that can be detected or sensed by another device to provide an indication to the surgeon. The second member **102** may be a resistor strip which changes a resistance along a travel surface **104** of the plunger **100** as the plunger **100** or the axial drive screw **74** traverses along the portion **16** of the surgical stapler **10** (or other suitable travel surface location). The resistor strip **102** is coupled to indicator **36** such that the change in resistance of the resistor strip **102** selectively illuminates each of the lights **40** through **48** to signal an amount of travel by the axial drive screw **74** or the plunger **100** or other suitable drive member.

Alternatively, the resistor strip **102** may be coupled to another indicator **36** such as a linear display **50**. The display **50** may illuminate the number of segments **52**, **54**, **56**, **58**, and **60** corresponding to a travel of the axial drive screw **74** or the plunger **100** until the axial drive screw actuates the stapler cartridge **21**. Upon actuated, the resistor strip **102** outputs a signal to the controller **28** which modulates the operation of the motor **66**, and sends another second signal to the display **50** to indicate that the stapling cartridge **21** has fired. The display **50** in response thereto may then display a suitable graphical image, another color, a textual message, or any other indication to indicate to the surgeon that the firing of the stapling cartridge **21** has concluded. Various indicator configurations are possible and within the scope of the present disclosure.

Referring now to FIG. **12**, in yet another embodiment of the present disclosure, the surgical stapler **10** may further include a non-contact sensor **106**. The non-contact sensor **106** may optionally be a so-called "Hall effect non-contact sensor" (or alternatively any other non-contact sensor) that is based in part on the physical principle of the Hall effect named after its discoverer E. H. Hall.

For example, end **108** of the axial screw **74** is directly connected, geared to, or offset from the motor **74**, and a cap like free end **110** of axial screw **74** contacts the stapler cartridge **21** to actuate the stapler cartridge and to fire the staple as discussed previously. The free end **110** of the drive screw **74** has a magnetic member **112** which connects thereto and which will not become dislodged by a rotation of the drive screw **74**. Alternatively, the magnetic member **112** may be disc shaped and simply connect to the free end **110**. In one initial orientation, free end **110** and the magnetic member **112** are disposed closely adjacent, or near to the non-contact sensor **106**. At this initial orientation, the magnetic member **112** is separated by a first distance "d" from the non-contact sensor **106**.

Once the trigger switch or button **26** is actuated, the motor **66** is actuated, and rotates, the drive axial screw **74** to traverse distally to actuate the stapler cartridge **21** as described above. In the second orientation after the motor **66** has been actuated, the magnetic member **112** moves and is a second distance "d" away from the non-contact sensor **106**. The second distance is any distance greater than the first distance "d". As the magnetic member **112** moves away from the non-contact sensor **106**, the non-contact sensor now located the second distance away from the magnetic field of the magnetic member **112** modulates an operation of the motor **66**.

The term "modulation" is defined as modulating amount of voltage received by the motor **66** in a dynamic manner, turning the motor "off" at a desired stroke, changing the motor speed, drive gear reduction of the motor, reduction of the axial drive screw pitch, or a change in the voltage or the current input of the motor, or changing another firing component, a change of the motor components and any combinations thereof. This may thereby slow the operation of the motor **66**

15

to increase an amount of compression time of the body tissues between jaws 21, 22. In another alternative embodiment, the magnetic member 112 may be disposed on a suitable drive piston instead of the drive screw 66. As the drive piston travels away from the non-contact sensor 106, a reduced or modulated amount of voltage may be provided to the motor 66. Still further in another alternative embodiment, the non-contact sensor 106 may be placed at the free end 110 of the drive screw 74 and the magnetic member 112 fixed.

In another embodiment of the present disclosure, the surgical stapler may have a combined drive mechanism. The combined drive mechanism may control both a firing component of the stapling mechanism and a clamping mechanism. The surgical stapler 10 may, upon being actuated, has the drive mechanism advance to commence the clamping using the clamping mechanism and then hold and wait thus providing a predetermined delay. The surgical stapler 10 would then provide an indication to the surgeon/operator once a desired amount of compression is reached. Thereafter, the surgeon/operator would then actuate the drive mechanism after the time delay. The drive mechanism would then fire the staples from the stapling cartridge 21 into the compressed tissues and thus ensure a uniform staple formation. The surgical stapler 10 thus provides a time delay prior to stapling to ensure tissue compression.

Although being shown as an endoscopic surgical stapler, the present drive system may be used with any surgical stapling device known in the art, such as endoscopic surgical stapling devices, a pulmonary stapling device, a GIA surgical stapling devices, an endo-GIA stapling device, a TA surgical stapling device and any other stapler device for surgery known in the art. The present disclosure may also be used with a single drive surgical stapler that drives both the clamp and the stapling device. The present disclosure may be incorporated into a device that approximates and then fires such as with a TA surgical stapling device or with a surgical stapler without any such approximation of tissue.

It should be understood that the foregoing description is only illustrative of the present disclosure. Various alternatives and modifications can be devised by those skilled in the art without departing from the disclosure. Accordingly, the present disclosure is intended to embrace all such alternatives, modifications and variances. The embodiments described with reference to the attached drawing figures are presented only to demonstrate certain examples of the disclosure. Other elements, steps, methods and techniques that are insubstantially different from those described above and/or in the appended claims are also intended to be within the scope of the disclosure.

What is claimed is:

1. A surgical stapler comprising:

- a) a handle assembly including a stationary handle and a trigger configured to manipulate a cam member through an actuating stroke;
- b) an elongated body extending distally from the handle assembly and defining a longitudinal axis;
- c) a staple cartridge supported adjacent the distal end of the elongated body and containing a plurality of staples;
- d) an anvil pivotally mounted in relation to the cartridge adjacent the distal end of the elongated body, the anvil having a fastener forming surface thereon and being mounted for pivotal movement in relation to the cartridge between an open position having a distal end spaced from the staple cartridge and a closed position in close cooperative alignment with the staple cartridge;

16

e) an actuation sled supported within the cartridge, the actuation sled being movable to urge the plurality of staples from the cartridge;

f) a drive assembly including a body having a working end and a cam member supported on the working end, the cam member being positioned to translate relative to the anvil to maintain the anvil in the closed position during firing of the stapler, the trigger being operably connected to the drive assembly such that manipulation of the trigger effects translation of the cam member relative to the anvil;

g) a channel for supporting the staple cartridge; and

h) a controller configured to control the actuation sled supported within the cartridge, the controller delaying movement of the actuation sled to urge the plurality of staples from the cartridge for a predetermined time period when the anvil is in the closed position and in cooperative alignment with the staple cartridge.

2. The surgical stapler of claim 1, wherein the predetermined time period is suitable in length to allow compression of the tissue for the predetermined time period and to allow tissue to settle from a first initial state into a second compressed state when the anvil is in the closed position and in cooperative alignment with the staple cartridge.

3. The surgical stapler of claim 1, further comprising a dampening device, the controller configured to control the dampening device, the dampening device modulating the actuation sled movement for the predetermined time period to compress the tissue when the anvil is in the closed position and in cooperative alignment with the staple cartridge.

4. The surgical stapler of claim 3, wherein the dampening device slows the actuation sled movement to compress the tissue when the anvil is in the closed position and in cooperative alignment with the staple cartridge.

5. The surgical stapler of claim 3, wherein the dampening device is a hydraulic device.

6. The surgical stapler of claim 3, wherein the dampening device is a pneumatic device.

7. The surgical stapler of claim 1, further comprising a motor configured to control the actuation sled movement, wherein the controller controls the motor and delays the actuation sled from urging the plurality of staples from the cartridge into tissue, the delay permitting a predetermined compression time period when the anvil is in the closed position and in cooperative alignment with the staple cartridge.

8. The surgical stapler of claim 7, wherein the controller slows an operation of the motor to provide for the delay to compress the tissue.

9. The surgical stapler of claim 8, further comprising a geared assembly, the controller configured to actuate the geared assembly to slow the operation of the motor to provide for the delay to compress the tissue.

10. A surgical stapler comprising:

- a) a handle assembly including a stationary handle and a trigger configured to manipulate a cam member;
- b) an elongated body extending distally from the handle assembly and defining a longitudinal axis;
- c) a staple cartridge supported adjacent the distal end of the elongated body and containing a plurality of staples;
- d) an anvil pivotally mounted in relation to the cartridge adjacent the distal end of the elongated body, the anvil having a fastener forming surface thereon and being mounted for pivotal movement in relation to the cartridge between an open position having a distal end spaced from the staple cartridge and a closed position in close cooperative alignment with the staple cartridge;

17

- e) an actuation sled supported within the cartridge, the actuation sled being movable to urge the plurality of staples from the cartridge;
 - f) a drive assembly including a body having a working end and the cam member supported on the working end, the cam member being positioned to translate relative to the anvil to maintain the anvil in the closed position during firing of the stapler, the trigger being operably connected to the drive assembly such that manipulation of the trigger effects translation of the cam member relative to the anvil;
 - g) a channel for supporting the staple cartridge;
 - h) a controller configured to control the actuation sled supported within the cartridge, the controller delaying the actuation sled movement to urge the plurality of staples from the cartridge for a predetermined time period when the anvil is in the closed position and in cooperative alignment with the staple cartridge; and
 - i) an indicator connected to the controller, the controller controlling the indicator to provide an indication when the predetermined time period is reached.
11. The surgical stapler of claim 10, wherein the indicator is a visual indicator.
12. The surgical stapler of claim 10, wherein the indicator is an audible indicator.
13. The surgical stapler of claim 10, wherein the indicator is a tactile indicator.
14. The surgical stapler of claim 10, wherein the predetermined time period is an optimal compression time of the tissue being compressed between the anvil in the closed position and in cooperative alignment with the staple cartridge before firing of the plurality of staples.
15. The surgical stapler of claim 10, wherein the predetermined time period is a preset compression time of the tissue being between the anvil in the closed position and in cooperative alignment with the staple cartridge.
16. The surgical stapler of claim 10, wherein the indicator is a linear display having a plurality of segments, the plurality of segments illuminating in a sequential manner, wherein substantially at least two of the segments illuminate to provide the indication that the predetermined time period is reached.
17. The surgical stapler of claim 10, wherein the indicator is a linear display having a graphical representation, the graphical representation being arranged to provide an indication that the predetermined time period has been reached.
18. The surgical stapler of claim 10, wherein the indicator is a linear display having a graphical representation, the graphical representation being arranged to provide an indication of a parameter related to the stapler.
19. The surgical stapler of claim 10, wherein the indicator comprises a timer configured to count from a first interval to the predetermined time period.

18

20. The surgical stapler of claim 10, wherein the controller is configured to move the actuation sled supported within the cartridge automatically once the predetermined time period is reached, the actuation sled movement urging the plurality of staples from the cartridge.

21. The surgical stapler of claim 10, wherein the controller comprises a resistor strip, the controller being connected to the indicator, wherein the drive assembly contacts the resistor strip during a firing stroke, the contact between the resistor strip and the drive assembly modulating a resistance of the resistor strip during the stroke, the resistor strip being connected to the controller and configured to output the resistance to the controller, the controller modulating one or more parameters of the stapler based on the output.

22. The surgical stapler of claim 21, wherein the controller modulates the indicator based on the output.

23. The surgical stapler of claim 21, wherein the controller modulates the drive assembly based on the output.

24. The surgical stapler of claim 21, wherein the controller slows the drive assembly based on the output.

25. The surgical stapler of claim 21, further comprising a dampening device connected to the drive assembly, wherein the controller actuates the dampening device based on the output.

26. The surgical stapler of claim 10, further comprising a sensor, wherein the drive assembly comprises a magnetic member, and wherein the sensor detects at least one property of the magnetic member and outputs the detected property to the controller, wherein the controller modulates one or more parameters of the stapler based on the output.

27. The surgical stapler of claim 26, wherein the sensor is a Hall sensor.

28. The surgical stapler of claim 26, wherein the sensor is a non-contact sensor.

29. The surgical stapler of claim 26, wherein the controller modulates a gap measured between the anvil and the staple cartridge based on the output.

30. The surgical stapler of claim 26, wherein the controller modulates an actuation sled movement based on the output.

31. The surgical stapler of claim 26, wherein the controller slows the drive assembly in response to the output.

32. The surgical stapler of claim 31, wherein the controller provides an indication in response to the output.

33. The surgical stapler of claim 10, wherein the drive assembly includes the trigger being in contact with a switch, the switch being operably connected to a timer, wherein the trigger contacts the switch to actuate the timer when the trigger is manipulated, wherein the timer counts to the predetermined time interval, wherein when the timer reaches the predetermined time interval, the timer outputs a signal to the controller, the controller upon receiving the signal outputs a control signal to the indicator to provide the indication that the predetermined time interval has been reached.

* * * * *