



- (51) International Patent Classification:
A61J 17/00 (2006.01)
- (21) International Application Number:
PCT/US2012/033784
- (22) International Filing Date:
16 April 2012 (16.04.2012)
- (25) Filing Language: English
- (26) Publication Language: English
- (30) Priority Data:
61/475,771 15 April 2011 (15.04.2011) US
- (71) Applicant (for all designated States except US): **PLAY-TEX PRODUCTS, LLC.** [US/US]; 6 Research Drive, Shelton, CT 06484 (US).
- (72) Inventors; and
- (75) Inventors/Applicants (for US only): **VALDERRAMA, Vincent** [US/US]; 101 Washington Blvd., Unit 1121, Stamford, CT 06902 (US). **SIERRA, Diana** [US/US]; 31 75th Street, Apt. 4B, North Bergen, NJ 07047 (US).

(74) Agent: **RUGGIERO, Charles N.J.**; Ohlandt, Greeley, Ruggiero & Perle, LLP, One Landmark Square, 10th Floor, Stamford, CT 06901 (US).

(81) Designated States (unless otherwise indicated, for every kind of national protection available): AE, AG, AL, AM, AO, AT, AU, AZ, BA, BB, BG, BH, BR, BW, BY, BZ, CA, CH, CL, CN, CO, CR, CU, CZ, DE, DK, DM, DO, DZ, EC, EE, EG, ES, FI, GB, GD, GE, GH, GM, GT, HN, HR, HU, ID, IL, IN, IS, JP, KE, KG, KM, KN, KP, KR, KZ, LA, LC, LK, LR, LS, LT, LU, LY, MA, MD, ME, MG, MK, MN, MW, MX, MY, MZ, NA, NG, NI, NO, NZ, OM, PE, PG, PH, PL, PT, QA, RO, RS, RU, RW, SC, SD, SE, SG, SK, SL, SM, ST, SV, SY, TH, TJ, TM, TN, TR, TT, TZ, UA, UG, US, UZ, VC, VN, ZA, ZM, ZW.

(84) Designated States (unless otherwise indicated, for every kind of regional protection available): ARIPO (BW, GH, GM, KE, LR, LS, MW, MZ, NA, RW, SD, SL, SZ, TZ, UG, ZM, ZW), Eurasian (AM, AZ, BY, KG, KZ, MD, RU, TJ, TM), European (AL, AT, BE, BG, CH, CY, CZ, DE, DK, EE, ES, FI, FR, GB, GR, HR, HU, IE, IS, IT, LT, LU, LV, MC, MK, MT, NL, NO, PL, PT, RO, RS, SE, SI, SK,

[Continued on next page]

(54) Title: PACIFIER AND A STERILIZING CASE THEREFOR

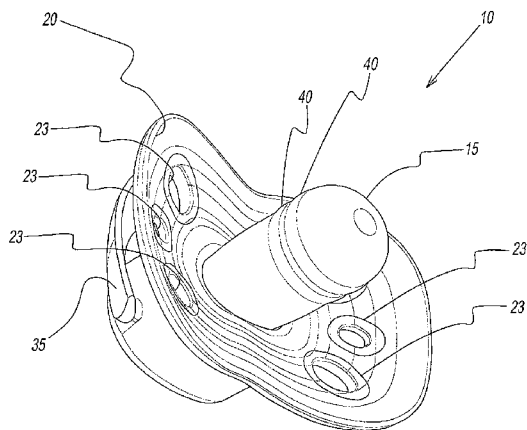

FIG. 1

(57) Abstract: A pacifier assembly has a pacifier having a shield with a convex surface and a concave surface. The pacifier has a back portion extending from the convex surface; and a teat extending from the concave surface. The convex surface has a plurality of undulations and a plurality of apertures extending through the shield. The pacifier assembly further includes a case. A pacifier assembly provides for a pacifier having a shield with a convex surface and a concave surface, a back portion extending from the convex surface and a teat extending from the concave surface. The pacifier assembly further provides for a case having a base and a cover. The base includes at least two compartments. One of the at least two compartments includes chamber for receiving fluid and the other of the at least two compartments is sized to receive the pacifier.





SM, TR), OAPI (BF, BJ, CF, CG, CI, CM, GA, GN, GQ,
GW, ML, MR, NE, SN, TD, TG).

— before the expiration of the time limit for amending the
claims and to be republished in the event of receipt of
amendments (Rule 48.2(h))

Declarations under Rule 4.17:

— of inventorship (Rule 4.17(iv))

(88) Date of publication of the international search report:

6 December 2012

Published:

— with international search report (Art. 21(3))

INTERNATIONAL SEARCH REPORT

International application No.
PCT/US2012/033784

A. CLASSIFICATION OF SUBJECT MATTER
IPC(8) - A61J 17/00 (2012.01)
USPC - 606/234
According to International Patent Classification (IPC) or to both national classification and IPC

B. FIELDS SEARCHED

Minimum documentation searched (classification system followed by classification symbols)
IPC(8) - A61L 2/00; A61J 17/00, 17/02; B08B 3/00 (2012.01)
USPC - 134/117,201; 206/205,207,438; 606/234,235,236; D3/201,273,294; D9/414,420,423; D24/194

Documentation searched other than minimum documentation to the extent that such documents are included in the fields searched

Electronic data base consulted during the international search (name of data base and, where practicable, search terms used)
PatBase

C. DOCUMENTS CONSIDERED TO BE RELEVANT

Category*	Citation of document, with indication, where appropriate, of the relevant passages	Relevant to claim No.
X -- Y	WO 2008/061291 A1 (SEDDON et al) 29 May 2008 (29.05.2008) entire document	14, 19, 20, 23, 26-29 ----- 1-13, 15-18, 21, 22, 24, 25
Y	US D501,256 S (ROEHRIG) 25 January 2005 (25.01.2005) entire document	1-13, 15, 16
Y	DE 42 29 224 A1 (MARR) 10 March 1994 (10.03.1994) entire document	3, 17, 18
Y	US D339,423 S (ROHRIG) 14 September 1993 (14.09.1993) entire document	10, 21, 22, 24, 25

Further documents are listed in the continuation of Box C.

* Special categories of cited documents:
 "A" document defining the general state of the art which is not considered to be of particular relevance
 "E" earlier application or patent but published on or after the international filing date
 "L" document which may throw doubts on priority claim(s) or which is cited to establish the publication date of another citation or other special reason (as specified)
 "O" document referring to an oral disclosure, use, exhibition or other means
 "P" document published prior to the international filing date but later than the priority date claimed
 "T" later document published after the international filing date or priority date and not in conflict with the application but cited to understand the principle or theory underlying the invention
 "X" document of particular relevance; the claimed invention cannot be considered novel or cannot be considered to involve an inventive step when the document is taken alone
 "Y" document of particular relevance; the claimed invention cannot be considered to involve an inventive step when the document is combined with one or more other such documents, such combination being obvious to a person skilled in the art
 "&" document member of the same patent family

Date of the actual completion of the international search 22 July 2012	Date of mailing of the international search report 05 OCT 2012
---	--

Name and mailing address of the ISA/US Mail Stop PCT, Attn: ISA/US, Commissioner for Patents P.O. Box 1450, Alexandria, Virginia 22313-1450 Facsimile No. 571-273-3201	Authorized officer: Blaine R. Copenheaver PCT Helpdesk: 571-272-4300 PCT OSP: 571-272-7774
---	---