



US010532412B2

(12) **United States Patent**
Ward

(10) **Patent No.:** **US 10,532,412 B2**
(45) **Date of Patent:** **Jan. 14, 2020**

(54) **HOLE SAW ARBOR ASSEMBLY**
(71) Applicant: **MILWAUKEE ELECTRIC TOOL CORPORATION**, Brookfield, WI (US)
(72) Inventor: **Bryan C. Ward**, Wauwatosa, WI (US)
(73) Assignee: **Milwaukee Electric Tool Corporation**, Brookfield, WI (US)

(*) Notice: Subject to any disclaimer, the term of this patent is extended or adjusted under 35 U.S.C. 154(b) by 0 days.

(21) Appl. No.: **15/712,268**
(22) Filed: **Sep. 22, 2017**

(65) **Prior Publication Data**
US 2018/0085833 A1 Mar. 29, 2018

Related U.S. Application Data
(60) Provisional application No. 62/398,619, filed on Sep. 23, 2016.

(51) **Int. Cl.**
B23B 51/04 (2006.01)
(52) **U.S. Cl.**
CPC **B23B 51/0473** (2013.01); **B23B 51/0426** (2013.01); **B23B 2231/0204** (2013.01); **B23B 2240/00** (2013.01); **B23B 2251/02** (2013.01); **B23B 2251/428** (2013.01);
(Continued)

(58) **Field of Classification Search**
CPC B23B 51/04; B23B 51/0473; B23B 51/05; Y10T 408/95; Y10T 408/895; Y10T 408/8957
See application file for complete search history.

(56) **References Cited**
U.S. PATENT DOCUMENTS
2,879,036 A 3/1959 Wheeler
3,049,033 A 8/1962 Benjamin et al.
3,080,934 A 3/1963 Berscheid
(Continued)

FOREIGN PATENT DOCUMENTS
CN 2865975 2/2007
CN 201394679 2/2010
(Continued)

OTHER PUBLICATIONS
European Patent Office Search Report for Application No. 17192777.5 dated Mar. 13, 2018, 7 pages.
(Continued)
Primary Examiner — Alan Snyder
Assistant Examiner — Yasir A Diab
(74) *Attorney, Agent, or Firm* — Michael Best & Friedrich LLP

(57) **ABSTRACT**
A cutting tool includes a hole saw, a pilot bit, and an arbor assembly. The assembly includes a shank having a first end and a second end. The first end of the shank is removably coupled to the hole saw and to the pilot bit, and the second end of the shank is configured to be coupled to a power tool. The assembly also includes a sleeve moveable along the shank and a first ball bearing disposed on the sleeve. The first ball bearing engages the hole saw to releasably secure the hole saw to the shank. The assembly includes a second ball bearing disposed on the shank. The second ball bearing engages the pilot bit to releasably secure the pilot bit to the shank. When the sleeve moves toward the second end of the shank, the first and second ball bearings disengage the hole saw and the pilot bit.

20 Claims, 10 Drawing Sheets

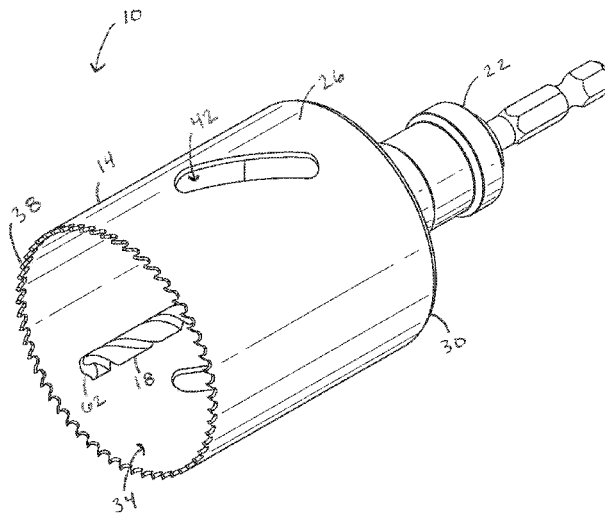

(56)

References Cited

FOREIGN PATENT DOCUMENTS

OTHER PUBLICATIONS

European Patent Office Search Report for Application No. 18150515.7
dated Jun. 20, 2018, 18 pages.
Co-pending U.S. Appl. No. 29/613,977, filed Aug. 15, 2017.

* cited by examiner

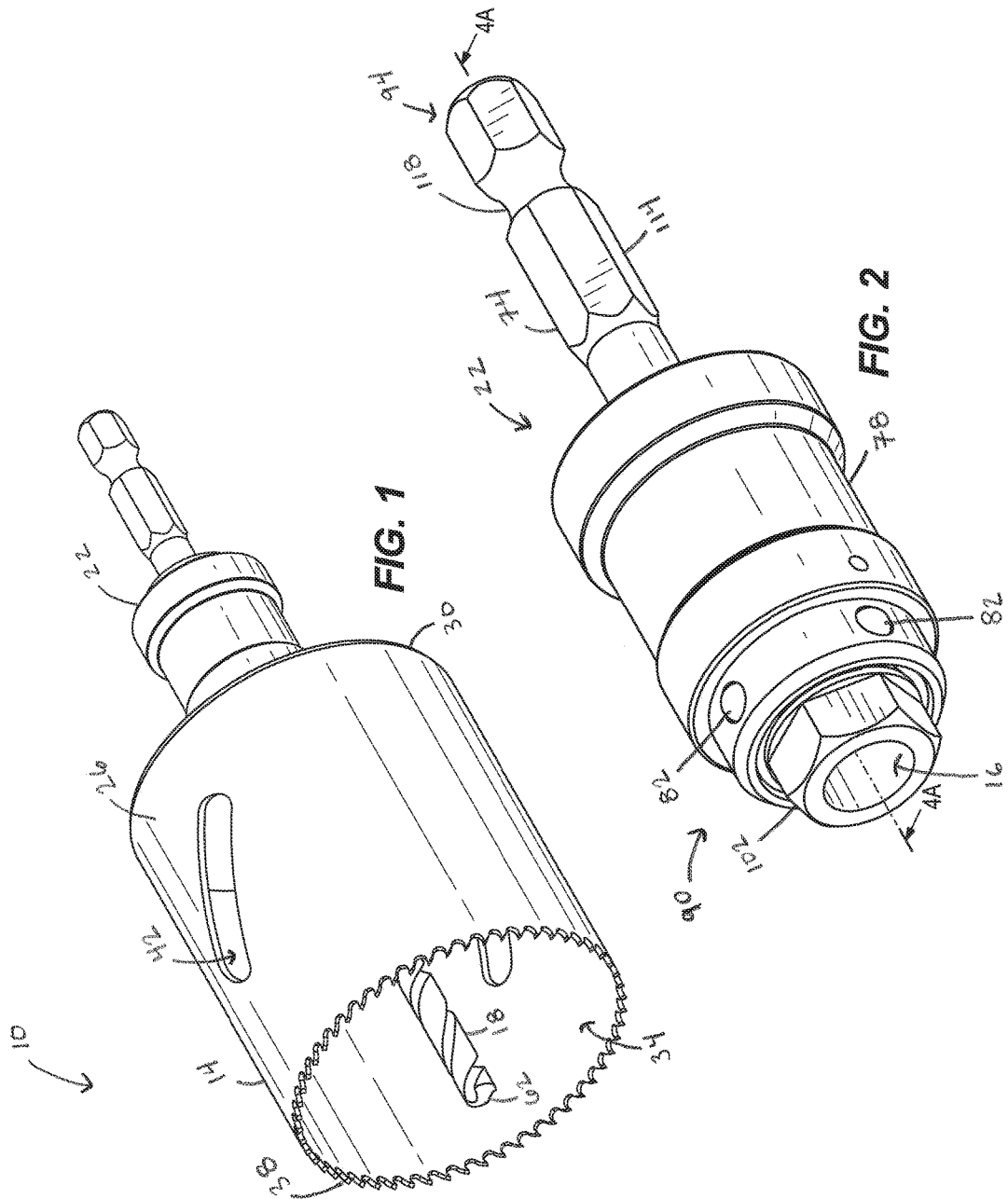

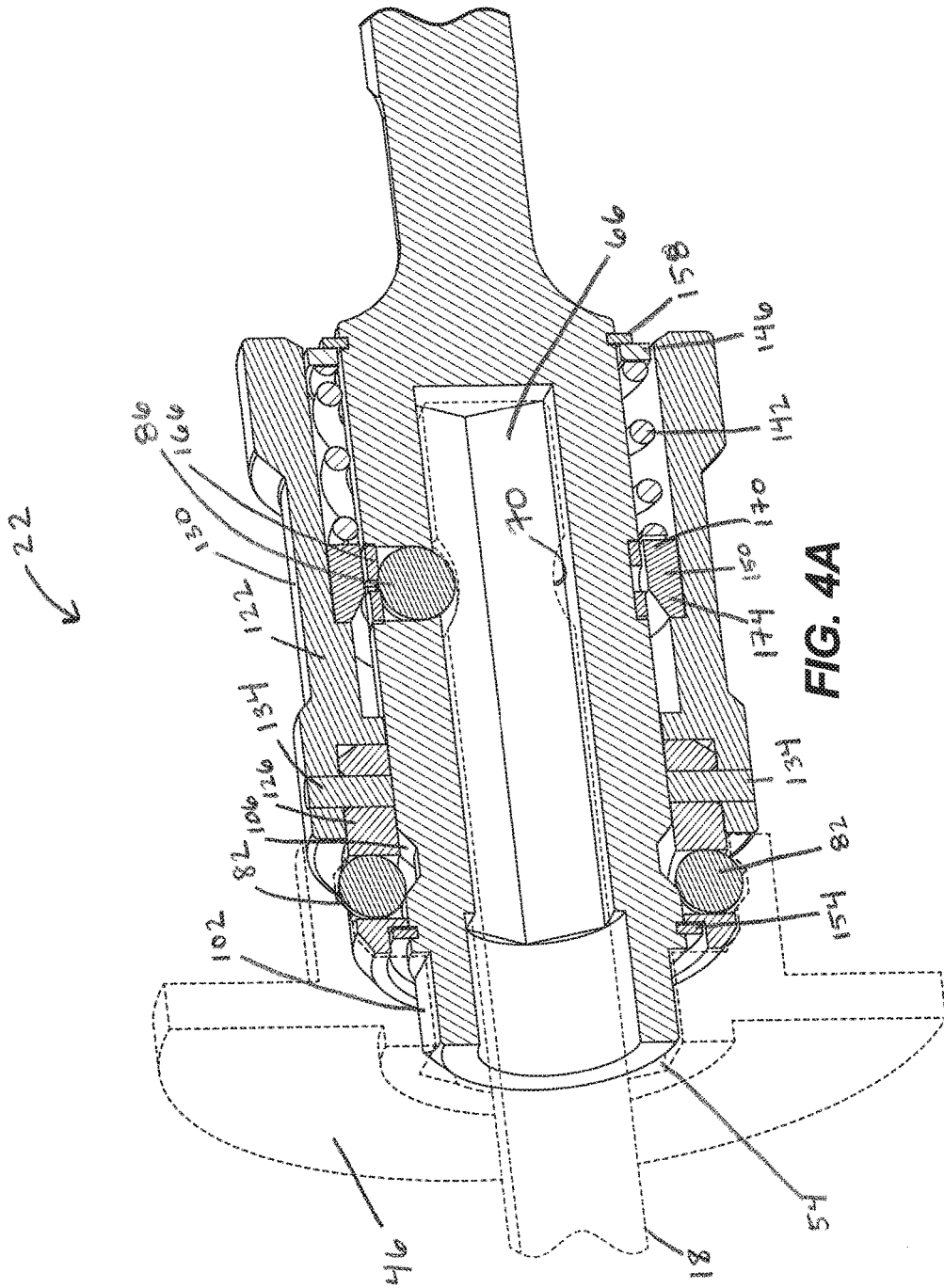

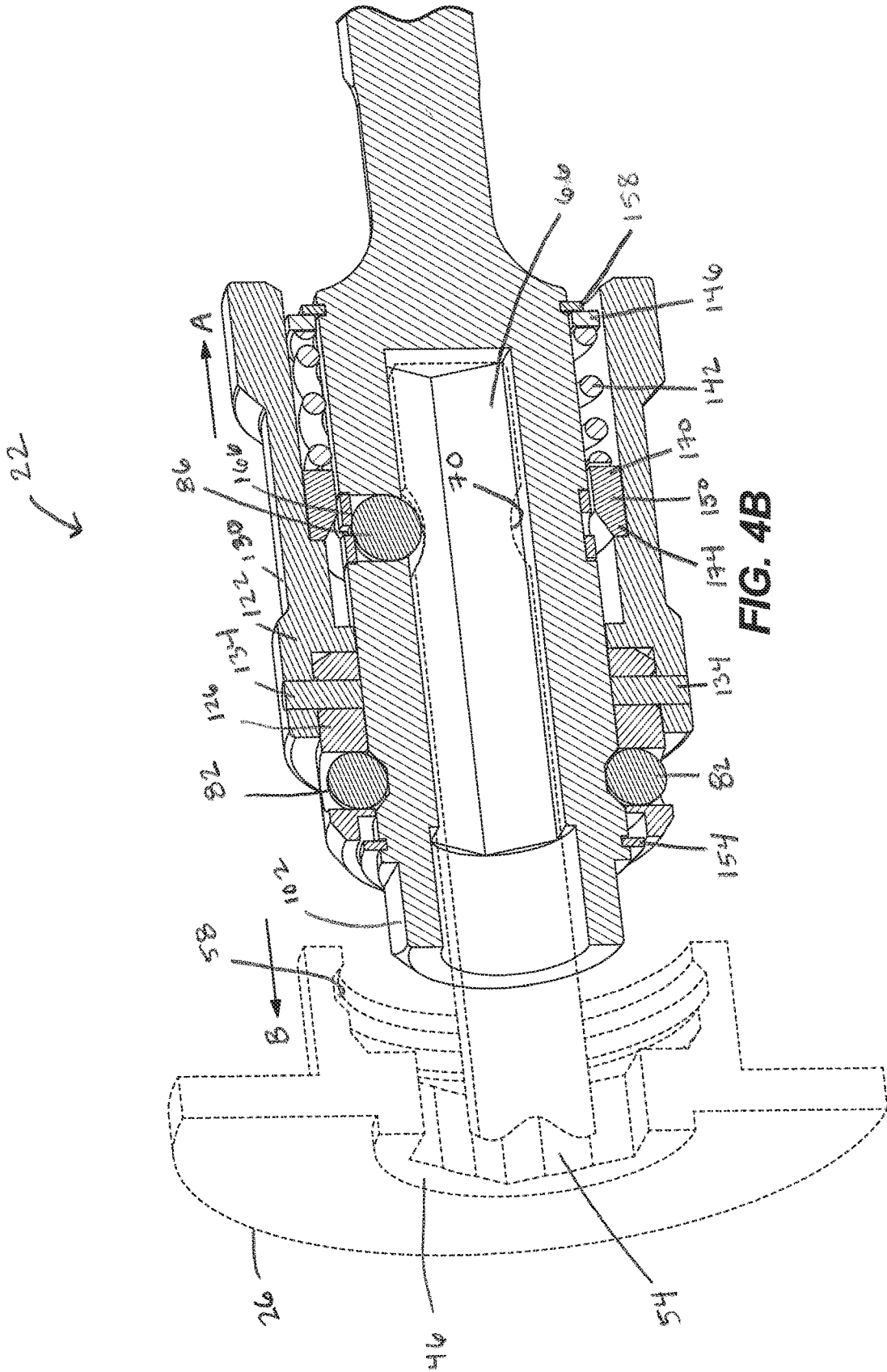

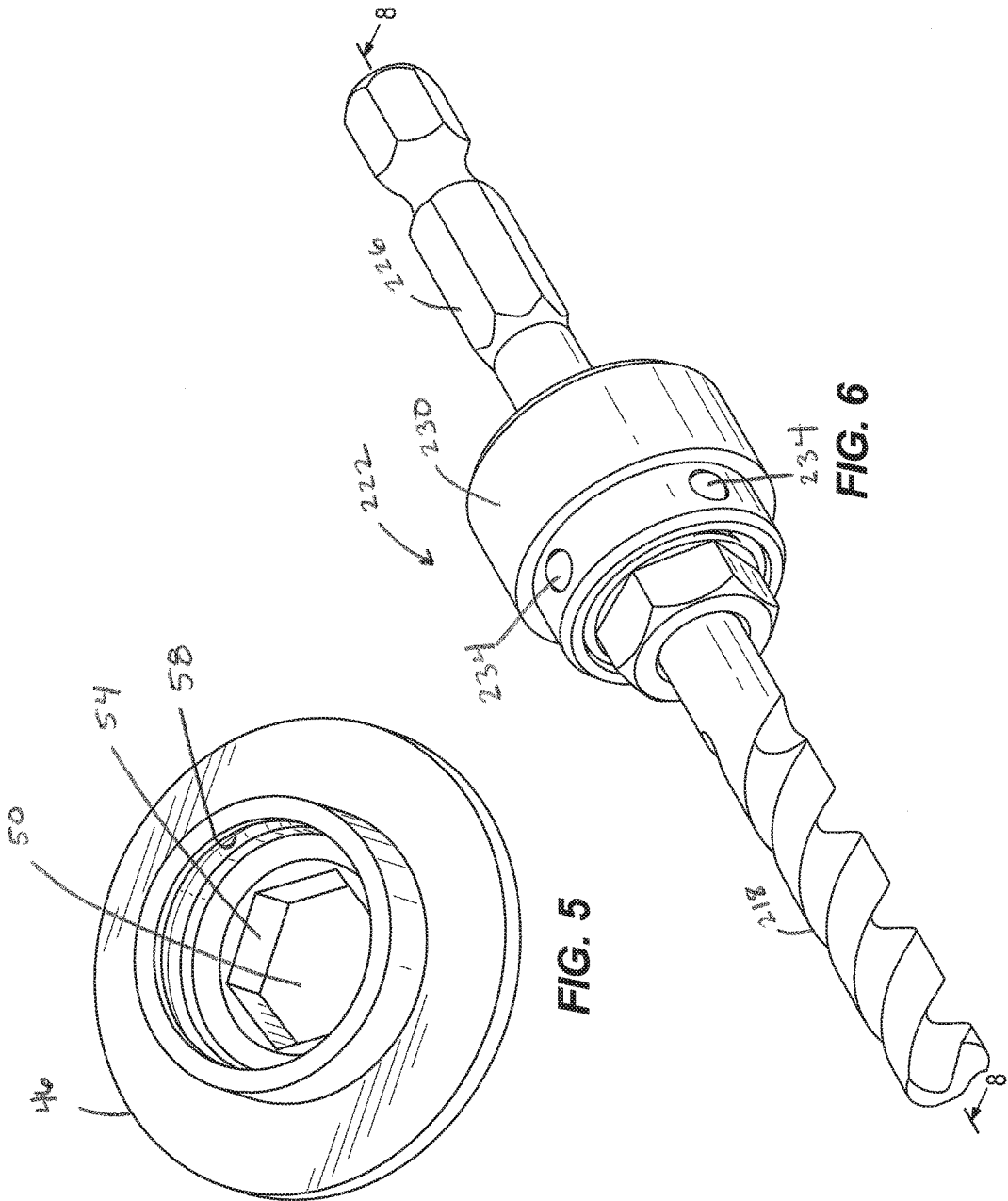
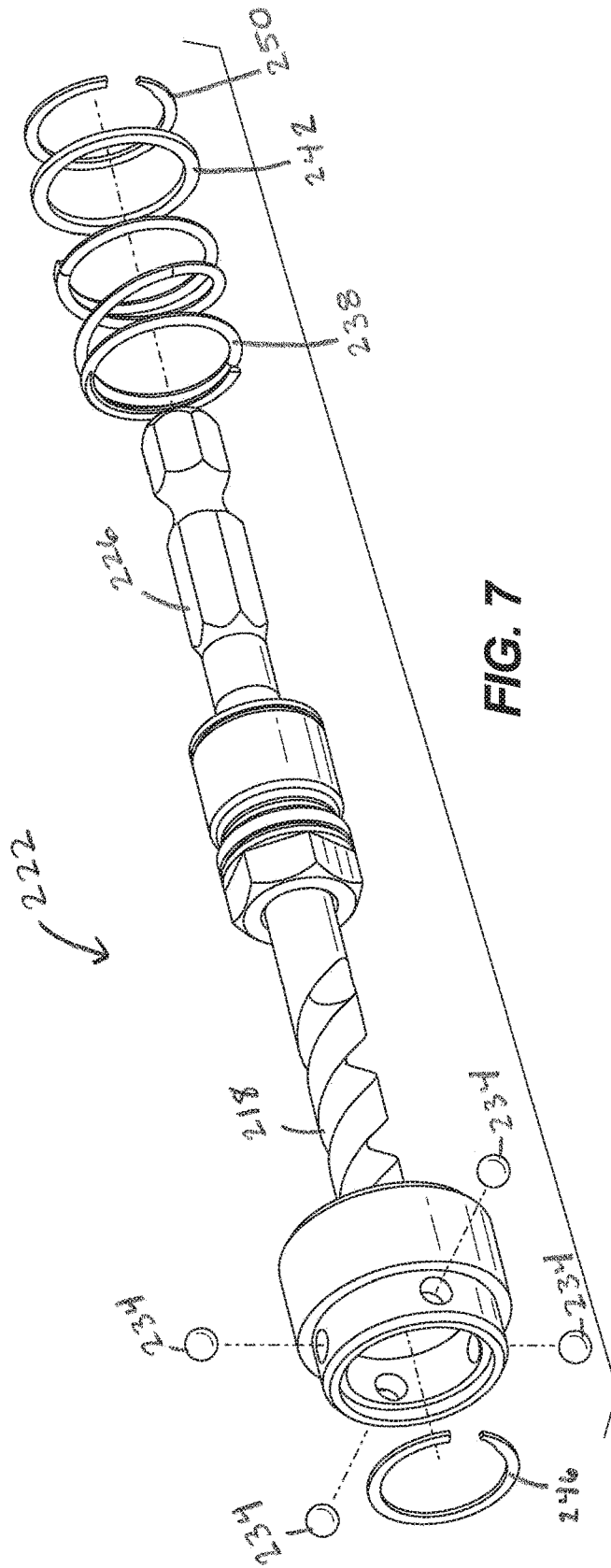
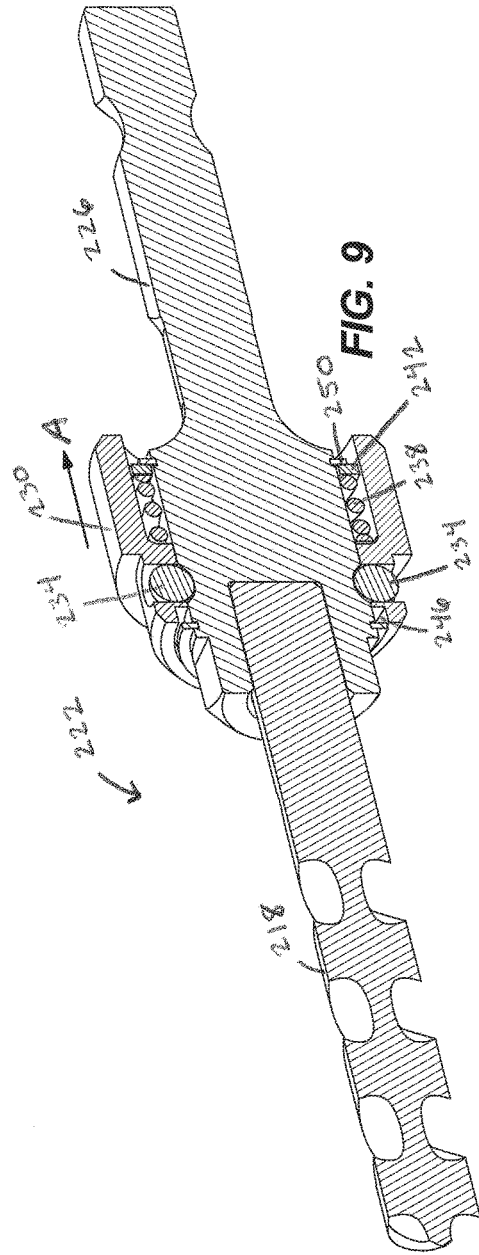
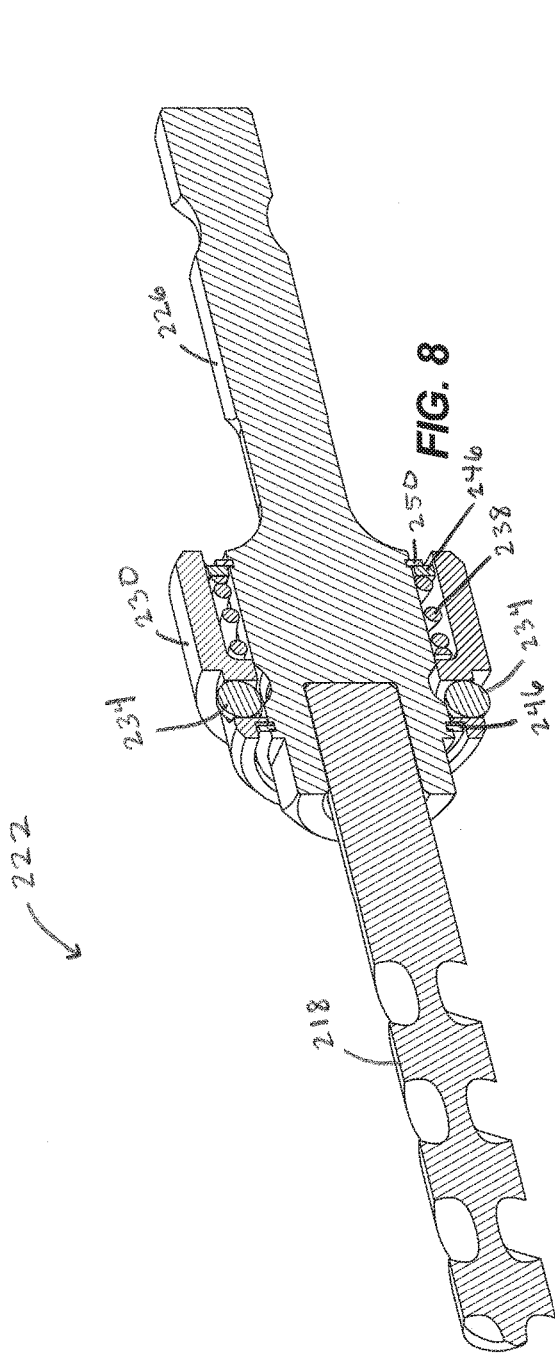
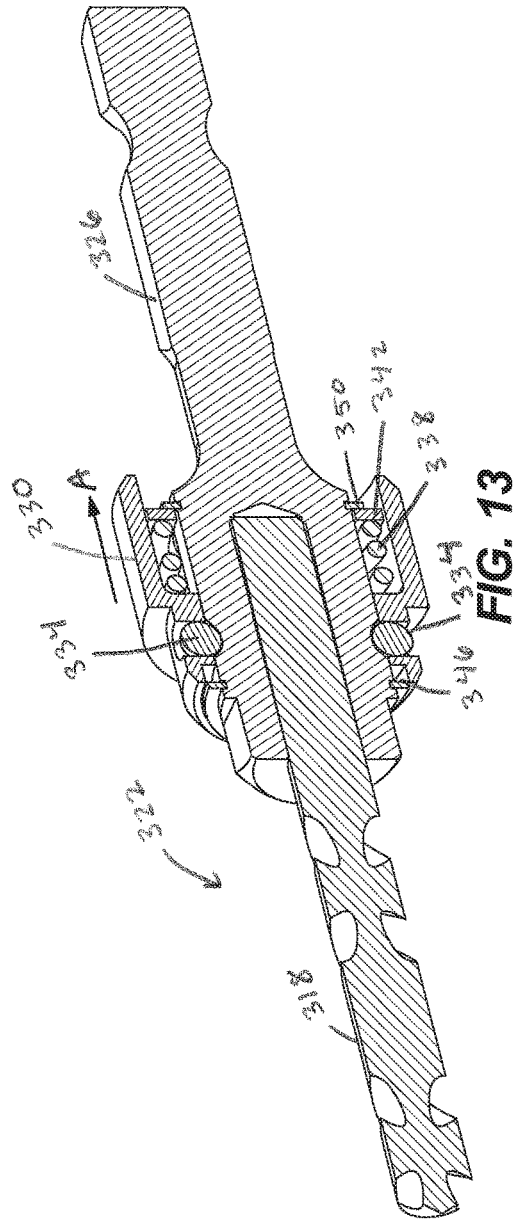
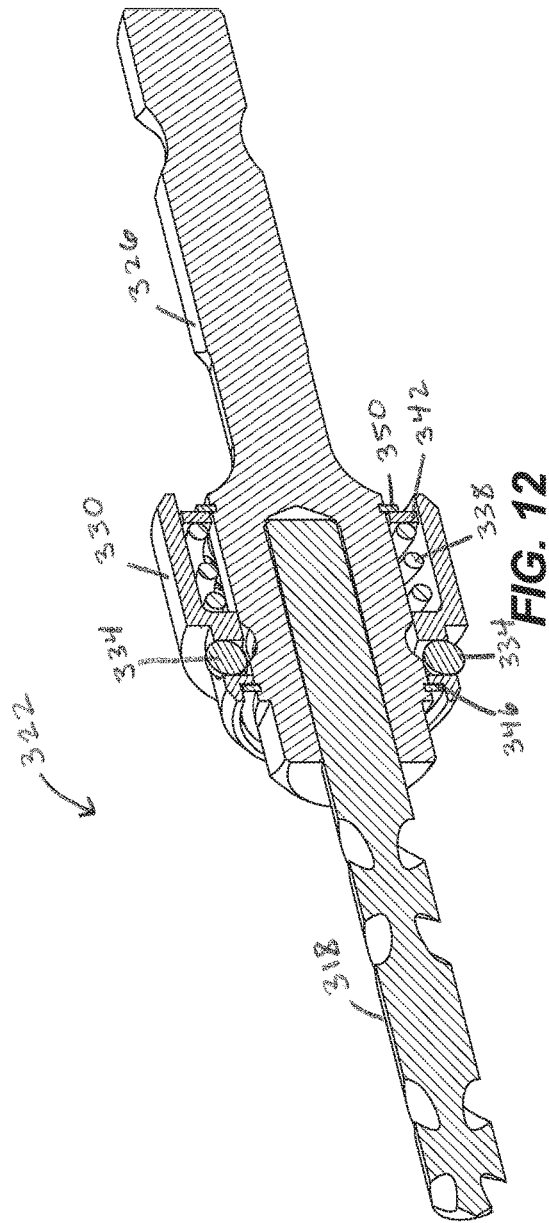

FIG. 5

FIG. 6







1

HOLE SAW ARBOR ASSEMBLYCROSS-REFERENCE TO RELATED
APPLICATIONS

This application claims priority to U.S. Provisional Patent Application No. 62/398,619, filed Sep. 23, 2016, the entire contents of which are incorporated by reference herein.

BACKGROUND

The present invention relates to arbor assemblies and, more particularly, to quick-release arbor assemblies for hole saws.

Typically, a hole saw is coupled to a rotating power tool using an arbor. An aperture defined by the hole saw is configured to receive a portion of the arbor. Furthermore, the aperture corresponds to threads on the portion of the arbor such that the hole saw is rotatably coupled to threads of the portion of the arbor. Quick removal of the hole saw from the arbor is typically desired.

SUMMARY

In one embodiment, the invention provides a cutting tool including a hole saw, a pilot bit, and an arbor assembly. The arbor assembly includes a shank having a first end and a second end and defining a longitudinal axis extending through the first and second ends. The first end of the shank is removably coupled to the hole saw and to the pilot bit, and the second end of the shank is configured to be coupled to a power tool. The arbor assembly also includes a sleeve moveable along the shank in a direction parallel to the longitudinal axis, and a first ball bearing disposed on the sleeve and moveable with the sleeve. The first ball bearing engages the hole saw to releasably secure the hole saw to the shank. The arbor assembly further includes a second ball bearing disposed on the shank and moveable relative to the sleeve. The second ball bearing engages the pilot bit to releasably secure the pilot bit to the shank. When the sleeve moves toward the second end of the shank, the first ball bearing disengages the hole saw and the second ball bearing disengages the pilot bit, allowing removal of the hole saw and the pilot bit from the shank.

In another embodiment, the invention provides a cutting tool including a hole saw and an arbor assembly. The arbor assembly includes a shank having a first end and a second end and defining a longitudinal axis extending through the first and second ends. The first end of the shank is removably coupled to the hole saw, and the second end of the shank is configured to be coupled to a power tool. The arbor assembly also includes a sleeve moveable along the shank in a direction parallel to the longitudinal axis, and a ball bearing disposed on the sleeve and moveable with the sleeve. The ball bearing engages the hole saw to releasably secure the hole saw to the shank. When the sleeve moves toward the second end of the shank, the ball bearing moves radially inward and disengages the hole saw, allowing removal of the hole saw from the shank.

In another embodiment, the invention provides an arbor assembly for use with a hole saw and a pilot bit. The arbor assembly includes a shank having a first end and a second end and defining a longitudinal axis extending through the first and second ends. The first end of the shank is configured to be coupled to the hole saw and to the pilot bit, and the second end of the shank is configured to be coupled to a power tool. The arbor assembly also includes a sleeve

2

moveable along the shank in a direction parallel to the longitudinal axis, a spring biasing the sleeve toward the first end, and a first ball bearing disposed on the sleeve and moveable with the sleeve. The first ball bearing is configured to engage the hole saw to releasably secure the hole saw to the shank. The arbor assembly further includes a second ball bearing disposed on the shank and moveable relative to the sleeve. The second ball bearing is configured to engage the pilot bit to releasably secure the pilot bit to the shank. When the sleeve moves toward the second end of the shank, the first ball bearing is configured to disengage the hole saw and the second ball bearing is configured to disengage the pilot bit, allowing removal of the hole saw and the pilot bit from the shank.

Other aspects of the invention will become apparent by consideration of the detailed description and accompanying drawings.

BRIEF DESCRIPTION OF THE DRAWINGS

FIG. 1 is a perspective view of a hole saw and an arbor assembly embodying the invention.

FIG. 2 is a perspective view of the arbor assembly of FIG. 1.

FIG. 3 is an exploded perspective view of the arbor assembly of FIG. 2.

FIG. 4A is a cross-sectional view of the arbor assembly taken along section line 4A-4A of FIG. 2, the arbor assembly including a sleeve in a first position.

FIG. 4B is a cross-sectional view of the arbor assembly with the sleeve in a second position.

FIG. 4C is a cross-sectional view of the arbor assembly with the sleeve in a third position.

FIG. 5 is a perspective view of an end cap of the hole saw shown in FIG. 1.

FIG. 6 is a perspective view of another arbor assembly embodying the invention.

FIG. 7 is an exploded perspective view of the arbor assembly shown in FIG. 6.

FIG. 8 is a cross-sectional view the arbor assembly taken along section line 8-8 of FIG. 6, the arbor assembly including a sleeve in a first position.

FIG. 9 is a cross-sectional view of the arbor assembly shown in FIG. 6 with the sleeve in a second position.

FIG. 10 is a perspective view of another arbor assembly embodying the invention.

FIG. 11 is an exploded perspective view of the arbor assembly shown in FIG. 10.

FIG. 12 is a cross-sectional view of the arbor assembly taken along section line 12-12 of FIG. 10, the arbor assembly including a sleeve in a first position.

FIG. 13 is a cross-sectional view of the arbor assembly shown in FIG. 10 with the sleeve in a second position.

DETAILED DESCRIPTION

Before any embodiments of the invention are explained in detail, it is to be understood that the invention is not limited in its application to the details of construction and the arrangement of components set forth in the following description or illustrated in the following drawings. The invention is capable of other embodiments and of being practiced or of being carried out in various ways.

FIG. 1 illustrates a cutting tool 10 including a hole saw 14, a pilot bit 18, and an arbor assembly 22 for a hole saw 14. The arbor assembly 22 includes a release mechanism for releasably coupling both the hole saw 14 and the pilot bit 18

to the arbor assembly 22. Thus, the arbor assembly 22 allows different types and/or sizes of hole saws and pilot bits to be interchangeably coupled to the arbor assembly 22 without the use of tools. Furthermore, if one part should fail first (e.g., the arbor assembly 22, the pilot bit 18, or the hole saw 14), a user can remove and replace that part instead of needing to throw away the entire cutting tool 10.

The hole saw 14 includes a generally cylindrical body 26 having a first or closed end 30 and a second or open end 34. The closed end 30 is configured to mount to the arbor assembly 22 for connecting the hole saw 14 to a power tool (e.g., a drill). The open end 34 includes a toothform 38 that is configured to cut through a work piece. In the illustrated embodiment, the toothform 38 is defined by a repeating pattern of cutting teeth and gullets. In other embodiments, the toothform 38 may have other configurations. At least one opening 42 is formed in the body 26 of the illustrated hole saw 14 between the closed and open ends 30, 34 to facilitate chip and plug removal from the hole saw 14.

As shown in FIGS. 4A, 4B, and 5, the hole saw 14 further includes an end cap 46 coupled to the cylindrical body 26. The end cap 46 forms the closed end 30 of the body 26. The end cap 46 defines an opening 50 that receives a portion of the arbor assembly 22 to couple the hole saw 14 to the arbor assembly 14. In the illustrated embodiment, the opening 50 includes a hex-shaped section 54, rather than a threaded section. The hex-shaped section 54 allows the hole saw 14 to slide linearly on to and off of the arbor assembly 22 without rotating the hole saw 14. The opening 50 also includes a channel 58 adjacent the hex-shaped section 54. The channel 58 selectively receives part of the arbor assembly 22 to releasably secure the hole saw 14 to the arbor assembly 22. In the illustrated embodiment, the channel 58 is defined by a continuous annular groove formed on an inner surface of the end cap 46.

Referring to FIGS. 1 and 4A-4C, the pilot bit 18 is coupled to the arbor assembly 22 and surrounded by the hole saw 14. The pilot bit 18 includes a cutting portion 62 and a shaft 66. The cutting portion 62 extends beyond the open end 34 of the cylindrical body 26. The shaft 66 is generally hex-shaped. The shaft 66 is received by the arbor assembly 22 and defines an annular groove 70. The annular groove 70 selectively receives part of the arbor assembly 22 to releasably secure the pilot bit 18 to the arbor assembly 22. In the illustrated embodiment, the pilot bit 18 is a twist drill bit. In other embodiments, the pilot bit 18 may be other types of drill bits, such as a spade bit. The hole saw 14 and the pilot bit 18 are both removable from the arbor assembly 22 separately or simultaneously.

As shown in FIGS. 2 and 3, the illustrated arbor assembly 22 includes a shank 74, a sleeve 78, first ball bearings 82, and a second ball bearing 86. The shank 74 forms the main body of the arbor assembly 22 and includes a first end 90 and a second end 94. The shank 74 also defines a longitudinal axis 98 extending through the first and second ends 90, 94. The first end 90 removably couples to the hole saw 14 and to the pilot bit 18. In particular, the illustrated first end 90 defines a hex-shaped boss 102, an annular recess 106, and an opening 110. The hex-shaped boss 102 is received in the hex-shaped section 54 (FIG. 5) of the end cap 46 to inhibit relative rotation between the hole saw 14 and the arbor assembly 22. The annular recess 106 is formed on an outer surface of the shank 74 adjacent the hex-shaped boss 102. The opening 110 is a bore formed through part of the shank 74. In the illustrated embodiment, the opening 110 is a hex-shaped opening that receives the shaft 66 of the pilot bit 18. The second end 94 of the shank 74 is configured to be

coupled to the power tool. In the illustrated embodiment, the second end 94 includes a hex-shaped shaft 114 having an annular groove 118 that is configured to be received in and engaged by a chuck of the power tool. In other embodiments, the second end 94 may include other suitable shafts or coupling mechanisms for connecting to a power tool.

The sleeve 78 is supported by the shank 74 and is movable (e.g., slidable) along the shank 74 in a direction parallel to the longitudinal axis 98. In some embodiments, the sleeve 78 may also or alternatively rotate relative to the shank 74. The illustrated sleeve 78 includes a first body 122 and a second body 126. The first body 122 includes an outer grip surface 130 configured to be engaged by a user to move the sleeve 78 relative to the shank 74. The second body 126, or carrier, is coupled to and extends from the first body 122 adjacent the first end 90 of the shank 74. In the illustrated embodiment, the second body 126 is secured to the first body 122 with pins 134 (FIGS. 4A-4C). In other embodiments, the second body 126 may be integrally formed as a single piece with the first body 122. The second body 126 defines apertures 138 (FIG. 3) that receive the first ball bearings 82.

In the illustrated embodiment, the sleeve 78 is biased toward the first end 90 of the shank 74 by a spring 142. The spring 142 is positioned around a portion of the shank 74 within the sleeve 78. The illustrated spring 142 is a coil spring, although other suitable springs may also or alternatively be used. The spring 142 is captured between a stop ring 146 and a ramped ring 150 coupled to an inner surface of the sleeve 78. In addition, movement of the sleeve 78 along the shank 74 is limited by two snap rings 154, 158. As shown in FIG. 4A, the first snap ring 154 is coupled to the outer surface of the shank 74 between the hex-shaped boss 102 and the annular recess 106. The sleeve 78 contacts the first snap ring 154 when the sleeve 78 is biased toward the first end 90 of the shank 74 by the spring 142. The second snap ring 158 is coupled to the outer surface of the shank 74 adjacent the hex-shaped shaft 114. The stop ring 146, under the bias of the spring 142, maintains contact with the second snap ring 158.

Referring back to FIGS. 2 and 3, the first ball bearings 82 are disposed on the sleeve 78. More particularly, the first ball bearings 82 are supported in the apertures 138 of the second body 126. In the illustrated embodiment, the arbor assembly 22 includes four first ball bearings circumferentially spaced around the shank 74. In other embodiments, the arbor assembly 22 may include fewer or more first ball bearings 82. The first ball bearings 82 are movable with the sleeve 78 as the sleeve 78 moves (e.g., slides) along the shank 74. As shown in FIG. 4A, the first ball bearings 82 extend radially outward from the second body 126 when the sleeve 78 is in a first position to engage the hole saw 14. More particularly, the first ball bearings 82 extend into the channel 58 in the end cap 46 of the hole saw 14 to releasably secure the hole saw 14 to the arbor assembly 22. As shown in FIG. 4B, the first ball bearings 82 move radially inward when the sleeve 78 is in a second position to disengage the hole saw 14. More particularly, the first ball bearings 82 move into the annular recess 106 of the shank 74 to allow removal of the hole saw 14 from the arbor assembly 22.

Referring back to FIG. 3, the second ball bearing 86 is disposed on the shank 74. More particularly, the second ball bearing 86 is received in an aperture 162 formed in the shank 74. The aperture 162 communicates with the opening 110 of the shank 74. In the illustrated embodiment, the arbor assembly 22 includes a single second ball bearing 86. In other embodiments, the arbor assembly 22 may include

more than one second ball bearing **86**. As shown in FIGS. 4A and 4B, the second ball bearing **86** extends radially inward when the sleeve **78** is in the first and second positions to engage the pilot bit **18**. More particularly, the second ball bearing **86** extends into the opening **110** and engages the annular groove **70** on the shaft **66** of the pilot bit **18** to releasably secure the pilot bit **18** to the arbor assembly **22**. As shown in FIG. 4C, the second ball bearing **86** moves radially outward when the sleeve **78** is in a third position to disengage the pilot bit **18**. More particularly, the second ball bearing **86** moves out of the annular groove **70** on the shaft **66** of the pilot bit **18** to allow removal of the pilot bit **18** from the arbor assembly **22**.

In the illustrated embodiment, the second ball bearing **86** is biased radially inward (e.g., into engagement with the pilot bit **18**) by a spring element **166**. The illustrated spring element **166** is an annular spring member positioned within the sleeve **78** and surrounding a portion of the shank **74**. In other embodiments, the second ball bearing **86** may be biased by other suitable spring elements (e.g., a coil compression spring). The ramped ring **150** engages the spring element **166** to help push the second ball bearing **86** radially inwardly. More particularly, when the sleeve **78** is in the first and second positions (FIGS. 4A and 4B), a relatively thick portion **170** of the ramped ring **150** engages the spring element **166**, holding the spring element **166** and the second ball bearing **86** radially inward. When the sleeve **78** is in the third position (FIG. 4C), a tapered portion **174** of the ramped ring **150** is aligned with the spring element **166** so that the spring element **166** and the second ball bearing **86** can move radially outward and release the pilot bit **18**.

FIGS. 4A-4C illustrate operation of the arbor assembly **22**. As shown in FIG. 4A, the sleeve **78** is in the first position such that the hole saw **14** and the pilot bit **18** are secured to the arbor assembly **22**. In this position, the sleeve **78** is moved (e.g., linearly slid) toward the first end **90** of the shank **74** under the bias of the spring **142**. The first ball bearings **82**, thereby, are moved out of the annular recess **106** of the shank **74** so that the first ball bearings **82** extend into and engage the channel **58** of the hole saw **14**. Likewise, the second ball bearing **86** is pushed radially inward by the ramped ring **150** and the spring element **166** so that the second ball bearing **86** extends into and engages the annular groove **70** of the pilot bit **18**. While in this position, the hole saw **14** and the pilot bit **18** cannot be readily pulled off of the arbor assembly **22**.

As shown in FIG. 4B, the sleeve **78** is in the second position such that the hole saw **14** is removable from the arbor assembly **22** and the pilot bit **18** is secured to the arbor assembly **22**. In this position, the sleeve **78** is moved in the direction of arrow A toward the second end **94** of the shank **74** against the bias of the spring **142**. The first ball bearings **82**, thereby, are moved into the annular recess **106** of the shank **74** so that the first ball bearings **82** disengage the channel **58** of the hole saw **14**. In contrast, the second ball bearing **86** remains engaged with the annular groove **70** of the pilot bit **18**. While in this position, the hole saw **14** can be removed from (e.g., pulled off of) the arbor assembly **22** in the direction of arrow B, but the pilot bit **18** remains secured to the arbor assembly **22**. The hex-shaped section **54** of the hole saw **14** and hex-shaped boss **102** of the shank **74** allow the hole saw **14** to be pulled linearly off of the arbor assembly **22** without rotating the hole saw **14** relative to the arbor assembly **22**.

As shown in FIG. 4C, the sleeve **78** is in the third position such that the pilot bit **18** is also removable from the arbor assembly **22**. In this position, the sleeve **78** is moved further

in the direction of arrow A toward the second end **94** of the shank **74** against the bias of the spring **142**. The tapered portion **174** of the ramped ring **150** is aligned with the spring element **166** so that the second ball bearing **86** can move radially outward and disengage the pilot bit **18**. While in this position, the pilot bit **18** can be removed from (e.g., pulled out of) the arbor assembly **22** in the direction of arrow B. As such, the sleeve **78** moves to different positions to separately allow removal of the hole saw **14** and the pilot bit **18** from the arbor assembly **22**. In other embodiments, both release actions may occur simultaneously at one position of the sleeve **78**.

Although the illustrated arbor assembly **22** is described as having the spring **142**, which biases the sleeve **78** in one direction, in other embodiments the spring **142** may be omitted. For example, the sleeve **78** may be moved along the shank **74** only in response to actuation from a user. In such embodiments, the shank **74** and/or the sleeve **78** may include detent-type mechanisms to releasably hold the sleeve **78** in one or more of its positions. Additionally, in further embodiments, the sleeve **78** may rotate relative to the shank **74** to change positions. For example, the sleeve **78** may be threadably coupled to the shank **74** such that rotation of the sleeve **78** causes movement along the shank **74**. Alternatively, the sleeve **78** may rotate about the shank **74** without changing axial positions, but such rotation may still cause movement of the ball bearings **82**, **86** to engage and disengage the hole saw **14** and the pilot bit **18**.

During use, interaction of hex-shaped profiles (e.g., the hex-shaped section **54** and the hex-shaped boss **102**, and the hex-shaped opening **110** and the hex-shaped shaft **66**) are used to drive rotation of the hole saw **14** and the pilot bit **18**. The first ball bearings **86** inhibit relative axial movement between the hole saw **14** and the arbor assembly **22**, but are not rotationally fixed relative to the hole saw **14**, which may increase bearing life. In addition, by having the first ball bearings **86** face outwardly to engage the hole saw **14**, the arbor assembly **22** can be smaller than previous arbors that have ball bearings extending inwardly. This is because in a previous arbor, there must be empty space in the middle of the arbor to allow for receipt of a portion of the hole saw that would extend into the arbor.

FIGS. 6-9 illustrate another arbor assembly **222** for a hole saw and a pilot bit **218**. Although not shown in this embodiment, the hole saw may be similar to the hole saw **14** described above with reference to FIGS. 1-5. The illustrated arbor assembly **222** is similar to the arbor assembly **22** described above and includes like parts. Reference is hereby made to the description of the arbor assembly **22** shown in FIGS. 1-4C for description of features and elements of the arbor assembly **222** not specifically included below.

The illustrated arbor assembly **222** includes a shank **226**, a sleeve **230**, ball bearings **234**, and a spring **238**. The arbor assembly **222** also includes a stop ring **242** and two snap rings **246**, **250**. In the illustrated embodiment, the pilot bit **218** is not removable from the shank **226**. As such, the arbor assembly **222** does not include a second (e.g., internal) ball bearing. When the sleeve **230** is slid in the direction of arrow A (FIG. 9), the ball bearings **234** only release the hole saw. The pilot bit **218** remains fixed (i.e., secured to) the arbor assembly **222**.

FIGS. 10-13 illustrate yet another arbor assembly **322** for a hole saw and a pilot bit **318**. Although not shown in this embodiment, the hole saw may be similar to the hole saw **14** described above with reference to FIGS. 1-5. The illustrated arbor assembly **322** is similar to the arbor assembly **22** described above and includes like parts. Reference is hereby

made to the description of the arbor assembly **22** shown in FIGS. 1-4C for description of features and elements of the arbor assembly **322** not specifically included below.

The illustrated arbor assembly **322** includes a shank **326**, a sleeve **330**, ball bearings **334**, and a spring **338**. The arbor assembly **322** also includes a stop ring **342** and two snap rings **346**, **350**. In the illustrated embodiment, the pilot bit **318** is not removable from the shank **326**. As such, the arbor assembly **322** does not include a second (e.g., internal) ball bearing. When the sleeve **330** is slid in the direction of arrow A (FIG. 13), the ball bearings **334** only release the hole saw. The pilot bit **318** remains fixed (i.e., secured to) the arbor assembly **322**.

Although the invention has been described in detail with reference to certain preferred embodiments, variations and modifications exist within the scope and spirit of one or more independent aspects of the invention as described. Various features and advantages of the invention are set forth in the following claims.

What is claimed is:

1. A cutting tool comprising:
 - a hole saw;
 - a pilot bit; and
 - an arbor assembly including
 - a shank having a first end and a second end and defining a longitudinal axis extending through the first and second ends, the first end of the shank removably coupled to the hole saw and to the pilot bit, the second end of the shank configured to be coupled to a power tool,
 - a sleeve moveable along the shank in a direction parallel to the longitudinal axis,
 - a first ball bearing disposed on the sleeve and moveable with the sleeve the first ball bearing engaging the hole saw to releasably secure the hole saw to the shank, and
 - a second ball bearing disposed on the shank and moveable relative to the sleeve, the second ball bearing engaging the pilot bit to releasably secure the pilot bit to the shank,
- wherein the sleeve is moveable to a first position where the hole saw and the pilot bit are secured to the arbor assembly, to a second position where the first ball bearing disengages the hole saw, allowing removal of the hole saw from the shank, and to a third position where the second ball bearing disengages the pilot bit, allowing removal of the pilot bit from the shank.
2. The cutting tool of claim 1, wherein the shank defines a recess, and wherein the first ball bearing aligns with the recess when the sleeve moves toward the second end of the shank.
3. The cutting tool of claim 2, wherein the first ball bearing is moved radially outward to engage the hole saw when the sleeve moves toward the first end of the shank, and wherein the first ball bearing is moved radially inward to disengage the hole saw when the sleeve moves toward the second end of the shank.
4. The cutting tool of claim 3, wherein the hole saw includes an end cap defining a channel, wherein the channel receives the first ball bearing when the sleeve moves towards the first end of the shank.
5. The cutting tool of claim 1, wherein the shank defines an opening, wherein the opening receives a portion of the pilot bit, and wherein the second ball bearing extends into the opening and engages the portion of the pilot bit when the sleeve moves towards the first end of the shank.

6. The cutting tool of claim 5, wherein the second ball bearing is moved radially inward to engage the pilot bit when the sleeve moves toward the first end of the shank, and wherein the second ball bearing is moved radially outward to disengage the hole saw when the sleeve moves toward the second end of the shank.

7. The cutting tool of claim 5, wherein the opening is a hex-shaped opening, and wherein the pilot bit includes a hex-shaped shaft that is received in the hex-shaped opening.

8. The cutting tool of claim 5, wherein the arbor assembly further includes a spring element supported by the sleeve, and wherein the spring element aligns with and engages the second ball bearing when the sleeve moves towards the first end of the shank.

9. The cutting tool of claim 1, wherein the first ball bearing is part of a plurality of first ball bearings circumferentially spaced around the shank, and wherein the plurality of first ball bearings engages the hole saw to releasably secure the hole saw to the shank.

10. The cutting tool of claim 1, wherein the arbor assembly further includes a spring coupled to the sleeve, and wherein the spring biases the sleeve toward the first end of the shank.

11. The cutting tool of claim 10, wherein the spring includes a coil spring positioned around a portion of the shank.

12. The cutting tool of claim 11, wherein the spring is positioned within the sleeve.

13. A cutting tool comprising:

- a hole saw; and
- an arbor assembly including
 - a shank having a first end and a second end and defining a longitudinal axis extending through the first and second ends, the first end of the shank removably coupled to the hole saw, the second end of the shank configured to be coupled to a power tool,
 - a sleeve moveable along the shank in a direction parallel to the longitudinal axis and including an aperture, and
 - a ball bearing supported in the aperture and axially moveable with the sleeve relative to the shank in the direction parallel to the longitudinal axis as the sleeve slides along the shank, the ball bearing engaging the hole saw to releasably secure the hole saw to the shank,

wherein when the sleeve moves toward the second end of the shank, the ball bearing moves radially inward and disengages the hole saw, allowing removal of the hole saw from the shank.

14. The cutting tool of claim 13, wherein the shank defines a recess, and wherein the ball bearing aligns with the recess when the sleeve moves toward the second end of the shank.

15. The cutting tool of claim 14, wherein the ball bearing is moved radially outward to engage the hole saw when the sleeve moves toward the first end of the shank, and wherein the ball bearing is moved radially inward to disengage the hole saw when the sleeve moves toward the second end of the shank.

16. The cutting tool of claim 15, wherein the hole saw includes an end cap defining a channel, wherein the channel receives the ball bearing when the sleeve moves towards the first end of the shank.

17. The cutting tool of claim 13, wherein the ball bearing is part of a plurality of ball bearings circumferentially

9

spaced around the shank, and wherein the plurality of ball bearings engages the hole saw to releasably secure the hole saw to the shank.

18. The cutting tool of claim 13, wherein the arbor assembly further includes a spring coupled to the sleeve, and wherein the spring biases the sleeve toward the first end of the shank.

19. The cutting tool of claim 18, wherein the spring includes a coil spring positioned around a portion of the shank within the sleeve.

20. An arbor assembly for use with a hole saw and a pilot bit, the arbor assembly comprising:

a shank having a first end and a second end and defining a longitudinal axis extending through the first and second ends, the first end of the shank configured to be coupled to the hole saw and to the pilot bit, the second end of the shank configured to be coupled to a power tool;

10

a sleeve moveable along the shank in a direction parallel to the longitudinal axis;

a spring biasing the sleeve toward the first end;

a first ball bearing disposed on the sleeve and moveable with the sleeve, the first ball bearing configured to extend radially outward and engage the hole saw to releasably secure the hole saw to the shank; and

a second ball bearing disposed on the shank and moveable relative to the sleeve, the second ball bearing configured to extend radially inward and engage the pilot bit to releasably secure the pilot bit to the shank;

wherein when the sleeve moves toward the second end of the shank, the first ball bearing is configured to axially move with the sleeve and to extend radially inward to disengage the hole saw and the second ball bearing is configured to extend radially outward to disengage the pilot bit, allowing removal of the hole saw and the pilot bit from the shank.

* * * * *