

가 , 가 .

2

(link margin)

man 1 5,303,286 " Wireless Telephone/Satellite Roaming System" (110
) (130) (120) (tr
ansponder) (public switched telephone network)(140)
(landline)
(beam) 1 (150)
(160) 가,
110) (120) (170) (
10) (110) (120) (180) (120) (1
가 /
(infrastructure)

(fading)

(Doppler shift) , 가

가

가

(time-varying)

가

(Rician)

(가

가

, 가

3

5

(decibels

2

4

(American Mobile Satellite Corporation)가 (Mobile Satellite System)(MSS) , /

(Personal Communication Service)(PCS)

가 . 가 , (). , MMS

1998 2000 MMS , 가 가 (additive white gaussian noise)(AWGN) 8 16 dB .

(shadowing) / (blockage)가 (line-of-site)(LO

S) 가 EP 0 724 336 A2

가 가
EP 0 302 455 A2 ,

EP 0 570 325 A1, 가, 가, (briefcase), / ,

(rainer)

가

가

가 .

가 , , - 가
(return) 가 .

(return) 가
 (patch antenna assembly)가

()

가 . ,

(isolation)

가

(housing)

가

가 . , 가
(hinge) (swivel)

(extension)

$$1$$

[illegible]

1	
2	
3	
4	3
5a	5b
6	
7	6

가

2가 (170) 가 (110) 2 (200)가 (120) (180)

가 (110) (170) (200) 1 (210)가 (200)

(175) (170) (120) (120) (120)

(180) (110) (200) 가 가 (200)

(200) 5a 5b 가가 (200)가

(200) 가 (200) 6

(200)가

3

(quadrifilar helix)

(210)가

(230)

(360)(170)(11)(filter)(240)(230)(2)

(260)가(250)(250)

N(173)(divider)(270)가

(280)(290)2(220)2(220)

(175)가(120)(200)(180)(300)2(220)3(300)

(300)가(310)(320)(320)

2(330)가,N(340)(360)(combiner)(183)(183)(350)

(200)(200)가(200)가가

(180)/(170)(180)(170)

30, 290 300, 360(isolation)(P_i) , 300, 360(P_o)

= 10 log (P_o/P_i) in dB.

(P_t) = 10 log (P_r/P_t) in dB.(P_r):

, 15 dB

[] dB + [] dB < 0가 5a 5b

5a(550)가(210)(550)5a22(220)

20)5b1(210)

, (hood) (220) , (590) .
, 2 (220) 1 2 (210, 220) .
가 가 ,
, 1 (210) 2 (220) .
가 가 ,
, ,
6 , 가 - (610) ,
(230) , (300), (290), (610)
(360)가 , (610)
, (620)가 (610) (620) , (610)
(pivot) , 가 (620) (620) 가 (2
90) (610) 1 (615) (300) (230)
(360) (620) , (230)
가 (360) (620) , (230, 360) (110)
가 , (610) (620)
, ON/OFF (indicator)(640) (650)가
(200) - (turn on) - (turn off) , 가 (610)
, AC (610) DC (connections)
- (plug-in)(660)
, 6 , - (670)
가 6 가 , 1 2 가
(670) (610) 가 , (610) 가
가
(upright) ,
가 , 가 , 6 -
가 - , ,
(120)
(230) , 가
가 (230) 가
, 7 1 (710) 2 (720) , 1
(710) 2 (720) 가 (850)가
1 (710) (700) (750) 가 ,

(750) 1 (710)가 (750) (700) 가
 , , (700) 가 (750)
 , (710) (750) 1 (710) 2 (720)가 1 (710)
 (720) (730) , (200) 1 (720) 2
 (730) 1 (740)가 2 (720)
 (740) (730)가 2 (730)가 1 (710)
 2 (790) , 1 2 (790)가 2 (790) , 1 (710)
 (detent), (snap), . 1 (710) 2 (720)
 0) , (730) 1 , (710) 2 (720)
 , , 가 , 가 ,
 .

(57)

1.
 (200) ,
 1 (230),
 (250),
 , 1 ,
 (290),
 (300), (350),
 2 ,
 (360) 1 , 1 2
 , 2 2
 ,
 2.
 3.
 1 , (230) 1 (210)
 , (300) 2 (220)
 .
 4.
 3 1 (210) 2 (220)
 5.
 1 - (610)
 (200) -
 .
 6.
 5 , (230) (36)

0) , 가 (620)

7.

5 , (670)

- (610) (670) -

8.

7 , (670) - (610) 가

9.

5 , (700) , (700) ;

1 (710),

2 (720),

1 가 (700),

2 (730) ,

1 (710) 1 2 (720) 가 1 가 1

2 가

10.

1 , 가

11.

10 , , 가 ,

12.

1 , ,

13.

(110),

(120),

(200) , (200) , (230), (250), (29

0), (300), (350), (360)

14.

13 ,

- 15.
- 14 ,
- , - (610)
- 16.
- 15 ,
- (230) (36
- 0) , 가 (620)
- 17.
- 15 ,
- (610) (670) , -
- 18.
- 15 ,
- (200) , (700) ;
- 1 (710),
- 2 (720),
- 1 가 (760),
- 2 (730) , 1
- 1 (710) 2 가 , 2
- 1 , 가
- 19.
- 15 ,
- 가
- 20.
- 15 ,
- 가 ,
- 21.
- 15 ,
- 22.
- (110) ,
- (120) (120) ,
- 23.
- 22 ,

24.

22

25.

22

26.

(200)

(230),

(250),

(29

 $0),$

(300),
(350),

260)

27.

28.

26

(610)

(200)가

29.

26

30.

29

가

31.

26

32.

26

가

1

선행기술

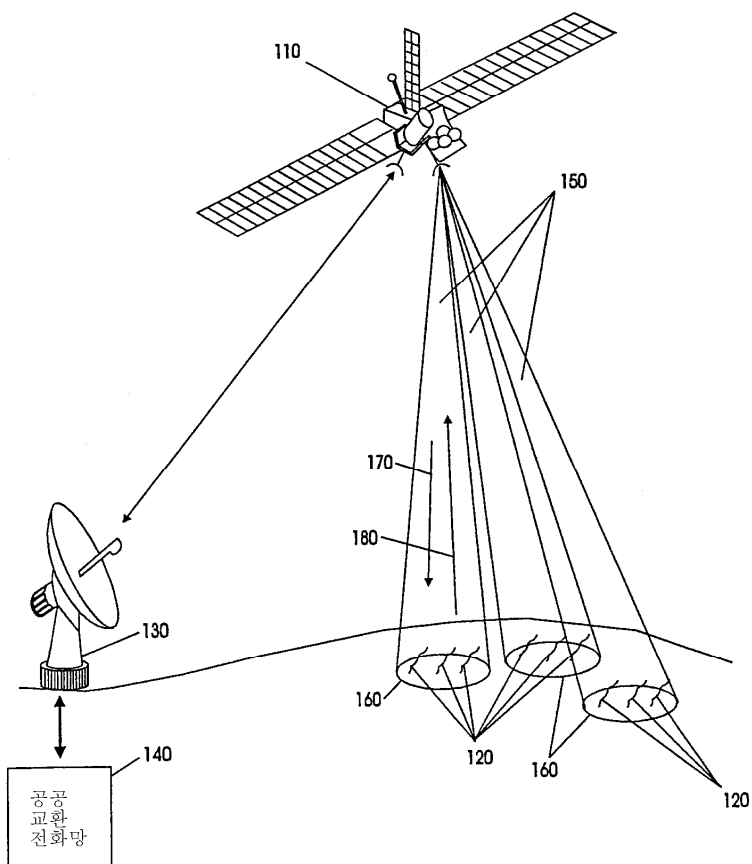

2

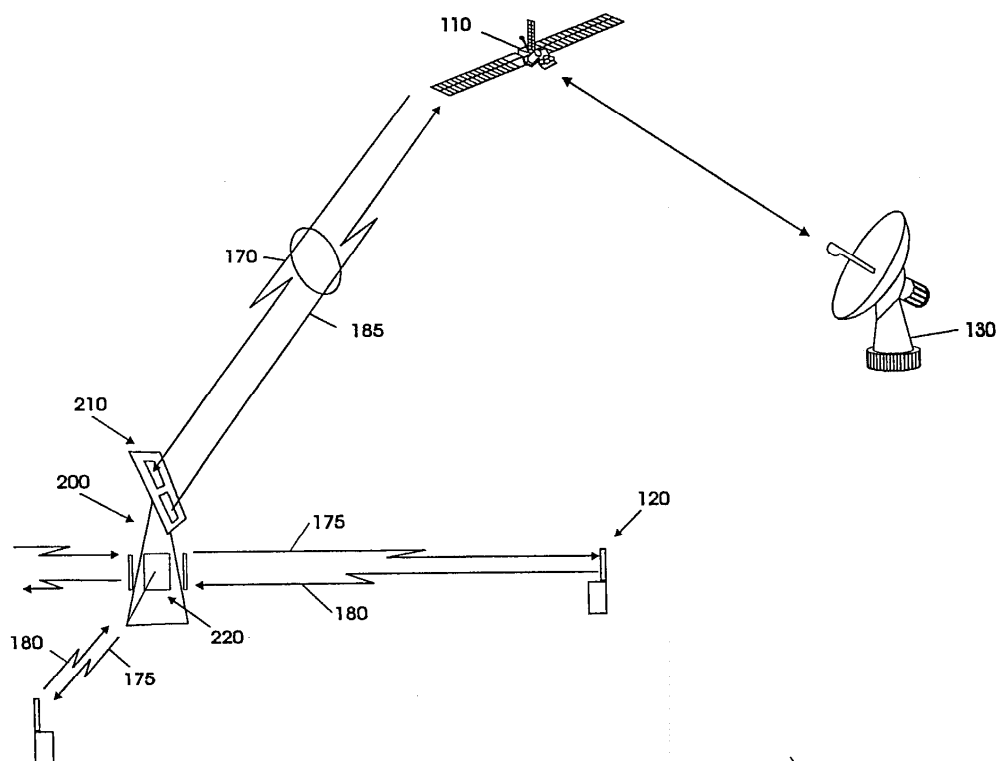

3

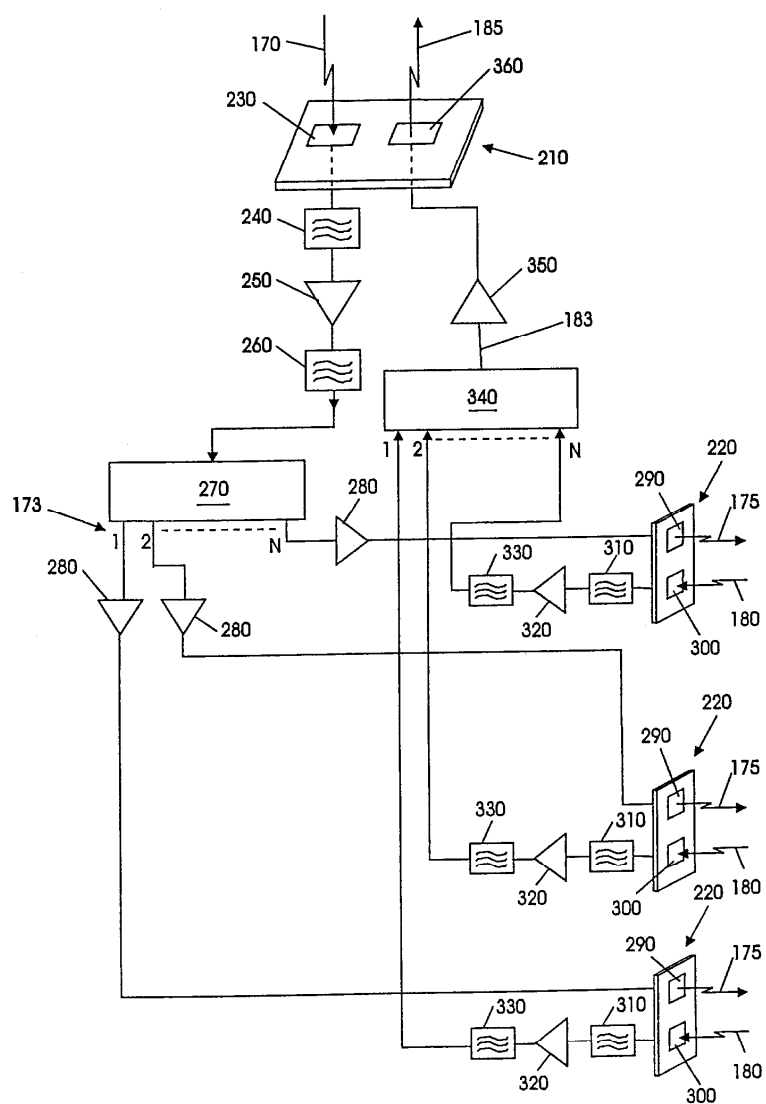

4

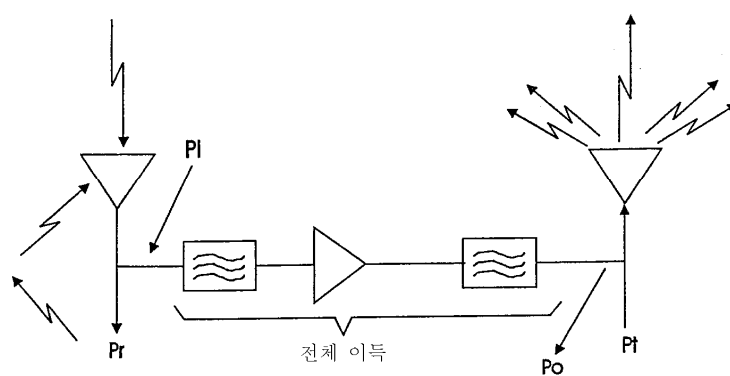

5a

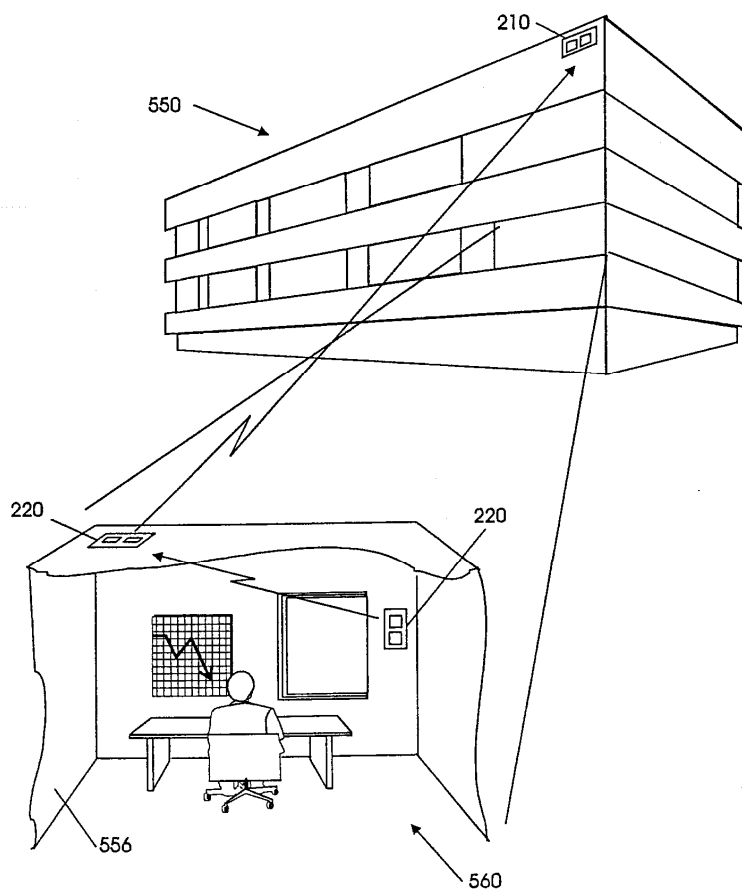

5b

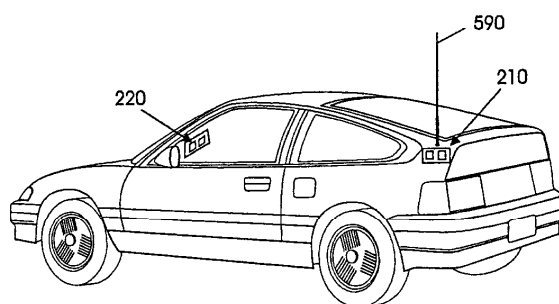

6

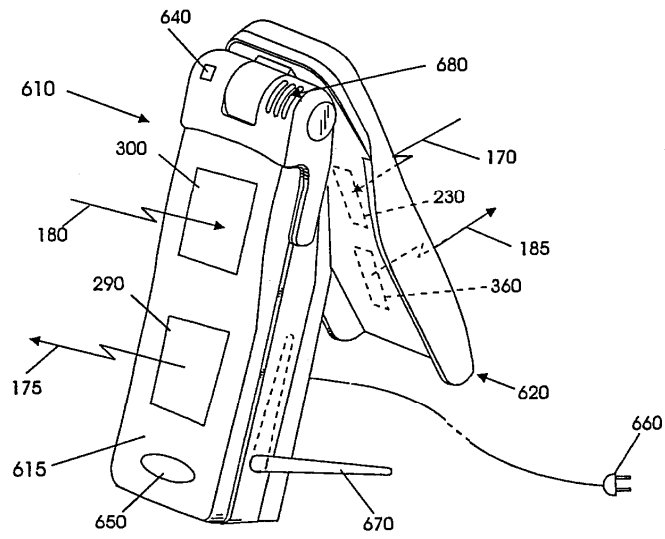

7

