

T. B. BALDWIN.
SHOE.
APPLICATION FILED APR. 28, 1917.

1,237,451.

Patented Aug. 21, 1917.

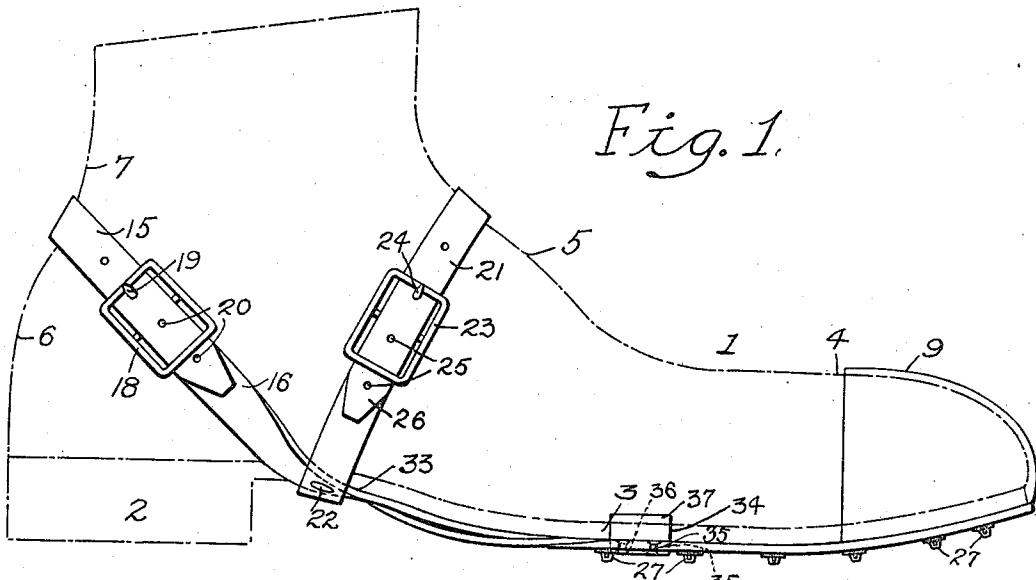

Fig. 1.

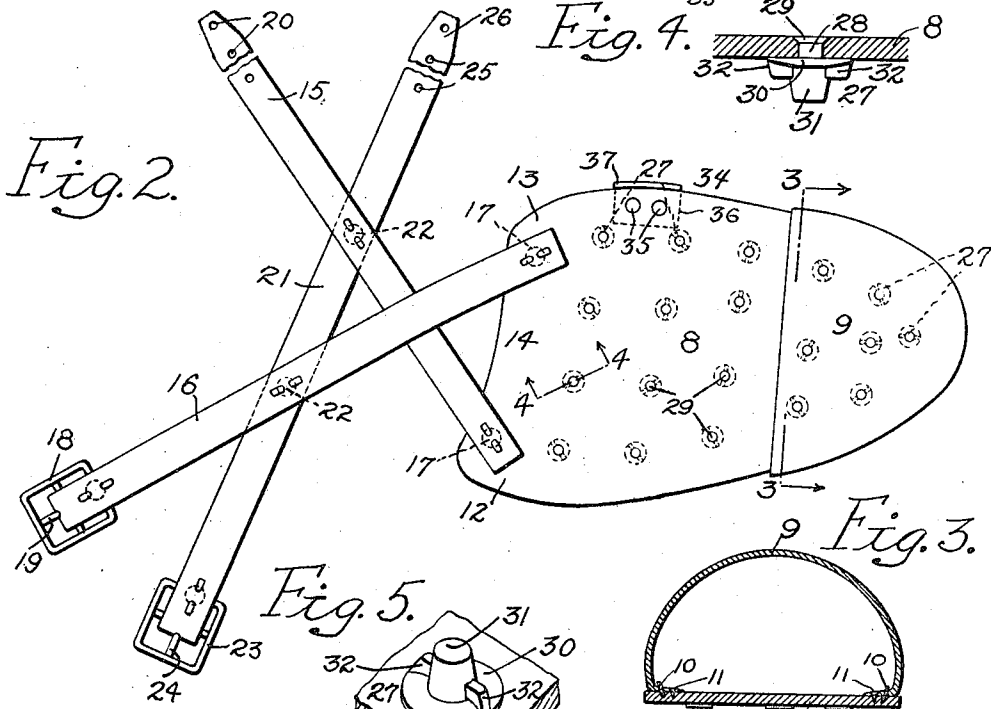

Fig. 2.

Fig. 4.

Fig. 5.

Fig. 3.

Witnesses,
M. A. Ingles.
C. R. Ziegler.

Inventor
Townsend B. Baldwin
by Joshua R. H. Hottel
his Attorney

UNITED STATES PATENT OFFICE.

TOWNSEND BURNET BALDWIN, OF EDGEWATER PARK, NEW JERSEY.

SHOE.

1,237,451.

Specification of Letters Patent.

Patented Aug. 21, 1917.

Application filed April 28, 1917. Serial No. 165,076.

To all whom it may concern:

Be it known that I, TOWNSEND BURNET BALDWIN, a citizen of the United States, residing at Edgewater Park, in the county of Burlington and State of New Jersey, have invented certain new and useful Improvements in Shoes, of which the following is a specification.

My invention consists of an improved shoe, one object of my invention being to provide a shoe which can be quickly and easily secured to the foot over an ordinary shoe.

Another object is to so construct my improved shoe that it will be especially adapted for golfers' use and will be of material assistance to a golfer when making a stroke.

Another object is to so construct my improved shoe that it will be of simple construction and can be easily carried in the pocket.

A further object is to so design my improved shoe that when once adapted to the foot, it will have a tendency to remain in the proper position and no move by the wearer will cause it to become dislodged.

A still further object is to so construct my improved shoe that it will be comfortable to the wearer and can be manufactured and sold at a comparatively low cost.

These objects, and other advantageous ends which will be described hereinafter, I attain in the following manner, reference being had to the accompanying drawings in which

Figure 1 is a side elevation of my improved shoe shown attached to an ordinary shoe, the ordinary shoe being illustrated in dot-and-dash lines.

Fig. 2 is a top plan view of my improved shoe as it appears when detached and ready to be secured to the foot.

Fig. 3 is a section through the sole taken on the line 3—3 of Fig. 2.

Fig. 4 is a fragmentary section through the sole and taken on the line 4—4 of Fig. 2.

Fig. 5 is an enlarged fragmentary perspective of the shoe sole showing one of the bottom cleats.

Referring to the drawings, 1 represents an ordinary shoe having a bottom heel 2, sole 3, and toe 4. 5 represents the instep portion of the shoe and 6 represents the back heel, the back heel forming a part of

the "upper" and blending with a concaved portion 7 to form the ankle.

The above mentioned portions form a part of any ordinary shoe and they do not form a part of my invention, but are merely mentioned that a more complete knowledge of the adaptability of my improved shoe can be obtained from the following description.

My improved shoe comprises a sole 8 which can be made of leather, fiber, or other suitable material and is shaped as clearly illustrated in Fig. 2 to conform and form a bearing for the shoe sole 3 above mentioned.

The extreme forward portion of the sole 8 is provided with a tip 9 which forms a hood or inclosure for the toe portion 4 of the shoe 1. The tip 9 is secured to the sole 8 by stitching 10 and if desired, short nails 11 can be used to reinforce and strengthen the connection (see Fig. 3).

The shoe illustrated in Figs. 1 and 2 is designed to be placed on the right foot of the wearer and it will be noted that the portion 12 extends farther rearward than the portion 13, said portions, together with the intervening part 14 of the sole, constituting the extreme rear part of the sole 8.

Two straps 15 and 16 loosely cross each other and at their inner ends are respectively attached to the portions 12 and 13 by rivets 17. The strap 16 has a buckle 18 provided with a prong 19 designed to enter any of a row of holes 20 in the strap 15, it being noted as hereinafter more fully described, that the free end of the strap 15 is designed to engage with the buckle 18 for the purpose of assisting in securing my improved shoe to the foot of the wearer.

A third strap 21 is secured to the lower surfaces of the straps 15 and 16 by rivets 22, it being noted that the strap 21 extends in a position nearly parallel with the connecting edge between the portions 12 and 13 when the straps are developed in a flat plane as clearly shown in Fig. 2.

The strap 21 is also provided with a buckle 23 having a prong 24 designed to enter any of a number of holes 25 in the opposite end 26 of the strap 21, it being noted that the end 26 is designed to engage the buckle 23 for the purpose of assisting to secure the shoe in position on the foot of the wearer.

The bottom of the sole 8 is provided with

cleats 27 which have stems 28 which, at their upper ends, are riveted at 29 to the sole 8. The cleats 27 have flanges 30 which engage the bottom surface of the sole 8 and heads 31 extend downwardly from said flanges.

Transverse ribs 32 intersect the heads 31 and thus provide desirable gripping surfaces. The cleats thus formed and positioned prevent slipping, and when the device is used as a golf shoe, it enables the golfer to firmly grip the ground with his foot and he is able to thus assume a steady position while making a drive.

The straps 15 and 16 are designed to pass under the ball of the foot and the strap 15 passes around the back heel 6 of the shoe 1 into engagement with the buckle 18. The straps being positioned as above described, will cause tension to be placed on the rear of the sole 8, and the strap 15 will snugly and neatly fit within the concaved portion 7 above the back heel 6. The strap 21 will in turn place tension on the straps 15 and 16, and when the end 26 of the strap 21 is inserted within the buckle 23, the straps 15 and 16 at their bottom portions will be firmly held against the ball portion 33 of the sole 3 of the shoe 1. This securing action of the straps 15, 16, and 21 will also cause the tip 9 to snugly fit the toe portion 4 of the shoe 1.

It requires only a few seconds to secure my improved shoe to the foot of the wearer, and when once in position, with the straps tightened, it will not become dislodged. Furthermore, freedom of motion is permitted by the wearer and it will be noted that the straps 15 and 16 as illustrated in Fig. 2, are not connected together other than through the medium of the strap 21 and the sole 8.

My invention, therefore, is of practical use and when not in use the straps may be conveniently folded so that the device may be readily carried in the pocket.

I preferably provide clips 34 adjacent the inner edge of the soles and secure these clips by rivets 35. The clips, as illustrated, consist of angular plates preferably of metal, and each plate has a portion 36 which is secured to the lower surface of a respective sole 8 and an upright portion 37, the inner surface of which is designed to form an abutment for the shoe sole 3 to prevent lateral movement of the latter relative to the sole 8.

While I have illustrated the tip 9 as formed of a separate piece, it will be understood that I can make the same integral with the sole by stamping the sole and tip from a single piece of material. It will further be understood that the tip 9 can be made of metal, leather, or other suitable material, and if desired the sole 8 and tip 9 can be made from metal.

While I have described my invention as taking a particular form, it will be understood that the various parts of my invention may be changed without departing from the spirit thereof, and hence I do not limit myself to the precise construction set forth, but consider that I am at liberty to make such changes and alterations as fairly come within the scope of the appended claims.

Having thus described my invention, what I claim as new and desire to secure by Letters Patent is:

1. A shoe comprising a sole portion, a tip thereon forming a hood, two straps each having an end secured to said sole, said straps crossing each other under the sole of the wearer's foot, said straps having their free ends designed to be secured around the back of the wearer's heel, and a third strap crossing said other two straps and being secured thereto under the sole of the wearer's foot, said third strap being designed to be secured around the instep of the wearer's foot, substantially as described.

2. A shoe comprising a sole portion, a tip thereon forming a hood, two straps each having an end secured to said sole, said straps freely crossing each other under the sole of the wearer's foot, said straps having their free ends designed to be secured around the back of the wearer's heel, and a third strap crossing said other two straps and being separately secured to each of said first two straps under the sole of the wearer's foot to the rear of the point of crossing of said first two straps, said third strap being designed to be secured around the instep of the wearer's foot, substantially as described.

In testimony whereof I have signed my name to this specification in the presence of two subscribing witnesses.

TOWNSEND BURNET BALDWIN.

Witnesses:

C. R. ZIEGLER,
CHAS. E. POTTS.

Copies of this patent may be obtained for five cents each, by addressing the "Commissioner of Patents, Washington, D. C."