

(19)



(11)

**EP 3 288 729 B1**

(12)

**EUROPEAN PATENT SPECIFICATION**

(45) Date of publication and mention of the grant of the patent:  
**26.06.2019 Bulletin 2019/26**

(51) Int Cl.:  
**B26B 29/04 (2006.01) B65D 73/00 (2006.01)**

(21) Application number: **15722479.1**

(86) International application number:  
**PCT/EP2015/059575**

(22) Date of filing: **30.04.2015**

(87) International publication number:  
**WO 2016/173673 (03.11.2016 Gazette 2016/44)**

**(54) PACKAGED CUTTING DEVICE**

VERPACKTE SCHNEIDVORRICHTUNG  
DISPOSITIF DE COUPE SOUS EMBALLAGE

(84) Designated Contracting States:  
**AL AT BE BG CH CY CZ DE DK EE ES FI FR GB GR HR HU IE IS IT LI LT LU LV MC MK MT NL NO PL PT RO RS SE SI SK SM TR**

- **SCHNEIDER, Regina**  
89250 Senden (DE)
- **KIESEL, Claudia**  
89189 Neenstetten (DE)
- **ARNDT, Wolfgang**  
89079 Ulm (DE)

(43) Date of publication of application:  
**07.03.2018 Bulletin 2018/10**

(74) Representative: **Finkele, Rolf**  
**Gardena Manufacturing GmbH**  
**Hans-Lorensen-Straße 40**  
**89079 Ulm (DE)**

(73) Proprietor: **Husqvarna AB**  
**561 82 Huskvarna (SE)**

(72) Inventors:  
• **MOCK, Axel**  
89134 Blaustein (DE)  
• **WANNENWETSCH, Christian**  
89182 Bernstadt (DE)

(56) References cited:  
**EP-A1- 1 990 292 DE-U1- 20 300 168**  
**DE-U1- 29 515 068 DE-U1- 29 621 047**  
**DE-U1- 29 801 894 US-A- 4 872 551**

**EP 3 288 729 B1**

Note: Within nine months of the publication of the mention of the grant of the European patent in the European Patent Bulletin, any person may give notice to the European Patent Office of opposition to that patent, in accordance with the Implementing Regulations. Notice of opposition shall not be deemed to have been filed until the opposition fee has been paid. (Art. 99(1) European Patent Convention).

## Description

**[0001]** The invention relates to a packaging for a manually operated cutting device, such as for example manually operated secateurs or pruning shears. The invention in particular relates to a packaged cutting device.

**[0002]** Cutting devices like secateurs are known in a wide variety of different configurations. Typically, these devices comprise a pair of cutting blades pivotably secured to each other at a pivot joint. The cutting blades are coupled to handles for manual operation. In some known configurations, it is possible to adjust the maximal available opening angle of the cutting blades, to thereby enable a user for example to adjust, to a certain degree, the operation mode of the secateurs to his hand size, or to adjust the available opening angle, to a certain degree, to the diameter of the objects to be cut.

**[0003]** Packaging for secateurs, in particular of the cardboard blister packaging type, is also known in the art. Cardboard blister packaging usually comprises a planar base member made from cardboard. A cover member typically made from a transparent plastic material is secured to the base member in manner that the cover member at least partially covers the packaged product. The cover member of the packaging is usually secured to the base member by means of a simple adhesive bond. In case of a packaging for secateurs or pruning shears, it is common that the cover member at least covers the cutting blades in the packaged state to minimize the risk of injuries.

**[0004]** The packaged cutting device has to be firmly retained in the packaged state for safety reasons and also to provide, at least to some degree, a protection against theft. As a known solution to this problem, the packaging is provided with additional securing means for securing the cutting device.

**[0005]** The packaging of the secateurs "RS 4000 Amboss-Gartenschere Premium Plus" distributed by the Wolf-Garten company comprises a base member with a loop or strap that engages one of the handles in order to secure the cutting device in the packaged state ([http://i.ebayimg.com/t/Wolf-Garten-RS-4000-Amboss-Gartenschere-Premium-Plus-/00/s/MTYwMFgxM-jAw/z/KwgAAOSwvOtU43vR/\\$\\_35.JPG](http://i.ebayimg.com/t/Wolf-Garten-RS-4000-Amboss-Gartenschere-Premium-Plus-/00/s/MTYwMFgxM-jAw/z/KwgAAOSwvOtU43vR/$_35.JPG)). A similar solution is known from the secateurs "Fiskars SingleStep P26" distributed by the Fiskars company ([http://www.kleverkaufen24.de/images/product\\_images/original\\_images/sam\\_0453.jpg](http://www.kleverkaufen24.de/images/product_images/original_images/sam_0453.jpg)). As the handles are fixed to the base member of the packaging in the packaged state, a user cannot check if the ergonomic layout of the cutting device fits to his personal needs without removing the packaging, the latter usually requiring the purchase of the product. Consequently, it is favorable to present packaged cutting devices to potential customers in a way that allows for a manual access of the handles.

**[0006]** The packing of the secateurs "Premium BP30" distributed by under the Gardena brand allows for a man-

ual access of the handles in the packaged state. The secateurs comprise a threaded connection in its central section in the vicinity of its pivot joint that is engaged by a separate screw that secures the base member of the packaging to the secateurs to firmly maintain the latter in the packaged state. Removal of the cutting device from the packaging without an additional tool is not possible. Moreover, this type of fixation requires structural modifications with the secateurs.

**[0007]** Document EP 1 990 292 A1 discloses a packaging for a manually operated cutting device comprising a pair of cutting blades pivotably secured to each other at a pivot joint with the help of a nut extending there through. The packaging comprises a base member made out of card board on which a cover member shaped as a cap is fixed. This cover member does not only cover the device's cutting blades but also helps to secure the cutting device to the packaging with the help of the protruding bolt fitting to a cut-out in the base member. In addition the cutting device is secured to the packaging by a retainer passing around one of the cutting blade's handles.

**[0008]** From US 4 872 551 A a similar packaged cutting device is known, whereby the packaging comprises a base and cover member that are hinged integrally and made out of transparent plastics material. Engagement of the two parts of the package secures the access to the device's cutting blades. In addition bridge formation is formed that engages the cutting device at a fixing point located between the handles and this secures it to the packaging.

**[0009]** It is an object of the present invention to provide a packaging that allows a user to test the ergonomics of cutting devices in the packaged state in an unrestricted manner. In particular, it is an object of the present invention to provide this functionality in a manner that does not require specific structural modifications with the cutting device.

**[0010]** The object is achieved by a packaged cutting device according to claim 1. Preferred embodiments of the invention are subject matter of the dependent claims.

**[0011]** A packaging for a manually operated cutting device comprises a pair of cutting blades pivotably secured to each other at a pivot joint. The cutting blades are coupled to handles for manual operation of the cutting device. The packaging comprises a base member defining a plane and a cover member shaped as cap. The cover member is secured to the base member in a packaged state, wherein, in said packaged state, the cover member at least partially covers at least one of the cutting blades but does not substantially cover the handles. The handles are accessible for manual engagement in the packaged state. According to the invention, the means of the cover member engaging the base member in a form fit connection or form fitting enclosure do secure the cutting device in the packaged state.

**[0012]** In a preferred embodiment, the cutting device is considered as being exclusively secured in the pack-

aged state by the engagement of the cover member and the base member if the cutting device is retained in the packaged state solely by securing means that secure the cover member to the base member. In other words, the packaging does not comprise any other securing means that directly engage the cutting device. The securing means securing the cover member to the base member may be integral to the cover member and/or the base member in the meaning of an arrangement as one piece. In other embodiments, the securing means may comprise separate parts.

**[0013]** A form fit connection in the sense of this specification is provided by securing means having corresponding shapes arranged to positively engage each other. Securing means of this type may be arranged as snap fit type connections, clips, threaded connections or the like. Supplementary to the form fit connection, other securing means may be present. In particular, the form fit connection may be supplemented by applying an adhesive bond.

**[0014]** The cutting device is retained in the packaged state by the engagement of the base member and the cover member. The cover member at least partially covers at least one of the cutting blades to provide protection against injuries. Preferably, the cover member is sized to allow a pivoting movement of the cutting blades while the cutting device is retained in the packaged state. In particular, the cover member may have a size that allows the cutting blades to pivot from a closed to an open position that corresponds to a maximal opening angle of the cutting blades.

**[0015]** Separate securing means that in particular separately engage the handles of the cutting device or otherwise limit the manual accessibility of handles are preferably omitted. Manual accessibility of the handles is understood as the possibility to grip the handles in a manner that is common to the operation of manual cutting devices like pruning shears or secateurs. In particular, both handles of the packaged cutting device may be gripped with one hand. This arrangement allows a user to check whether the functional and/or ergonomic layout of the cutting device fits to his personal needs while the cutting device is retained in the packaged state.

**[0016]** According to one preferred embodiment of the invention, the form fit connection between the cover member and the base member is provided by at least one locking protrusion that engages a corresponding opening disposed in the base member. The locking protrusion snugly fits into the opening of the base member to retain the cutting device in the packaged state. In the packaged state, at least a part of the cutting device is retained in the space between the base member and the cover member. Preferably, the locking protrusion comprises an abutment shoulder that is arranged to abut on the base member when the locking protrusion is inserted into the opening to provide a form-fit connection between the cover member and the base member.

**[0017]** Preferably, the cover member is secured to the

base member at at least one fixing point by a securing element having a boss. The securing element is disposed on the side of the base member opposite to the cover element. The boss protrudes through the base member and is form fitted into a recess disposed on the cover member. The boss may firmly engage the cover element at the fixing point to impede quick unpacking of the cutting device in an effort to provide, at least to a certain extent, protection against theft. It is obvious that alternatively to using a securing element employing a boss the cover member could be fixed to the base member at the fixing point by any other fixation means, such as a threaded connection or via an adhesive joint.

**[0018]** In the packaged state, the cover member is engaging the base member in at least one fixing point that is located between the handles. With this embodiment the cover member preferably extends over the central portion of the secateurs comprising the secateurs pivot joint. This arrangement does not substantially limit the movement of the handles so that the user may test the operability of the cutting device in the packaged state. On the other hand, the arrangement of the at least one fixing point between the handles prevents the user from pulling out the cutting device of the packaged state to expose the cutting blades.

**[0019]** In one preferred embodiment, the cover member is secured to the base member by at least one additional securing element having a boss that is form fitted into another recess of the cover member at another fixing point that is located adjacent to a front portion of the cover member arranged to cover a tip of at least one of the cutting blades. The securing of the base member to the cover member at the fixing points is provided by securing members having bosses that may be partially deformable to firmly engage the respective recesses in the cover member. In particular, the partially deformable securing element may engage the recess in a force-fitting manner.

**[0020]** According to another aspect of the invention, the cutting device comprises at least one adjustment mechanism with at least one operating element configured to be manually engaged. The cover member comprises at least one cut-out for providing manual access to the at least one operating element in the packaged state.

**[0021]** In particular, the adjustment mechanism may be a locking mechanism or a mechanism for adjusting the opening angle of the cutting blades. The operating element may be a slider, a button or a lever having a plurality of adjustment positions relating to different operating modes or settings. In particular, manual actuation of the operating element may cause the locking mechanism to lock or unlock a pivoting movement of the cutting blades about the pivot joint. In other embodiments, the settings of operating element correspond to different opening angles of the cutting blades and the handles, so that a user may adjust the opening angle to the size of his hand or to the size of the objects to be cut by manual actuation of the operating element. The cutting device

may be configured to restrict the available opening angle of the cutting blades to intermediate opening angles lying between opening angles defined by a fully closed state and a fully opened state of the cutting blades. An intermediate locking position may for example be represented by a specific operating or working position of the operating element in which the maximum opening angle of the cutting blades is restricted to an intermediate opening angle. The fully closed state may correspond to an operational condition or state of the cutting device in which cutting blades thereof are rotated towards each other as far as possible such that no further movement towards each other is possible. The fully opened state may, for example, correspond to an operational condition in which the cutting blades, or cutting edges thereof, are moved, i.e. pivoted, away from each other as far as allowed by the configuration of the pivot joint itself, i.e. without the locking mechanism imposing pivoting restrictions on the cutting blades. The cutting device is packaged in a manner that allows the operating element to be accessed in the packaged state. Various operating modes or user configurations in particular relating to different maximal opening angles of the cutting blades may be tested without removing the cutting device from the packaging.

**[0022]** According to another aspect of the invention, the base member extends beyond the longitudinal dimension of the cutting device in the packaged state. The base member has a sufficient size for displaying information related to the operation of the cutting device, in particular related to locking and/or adjustment mechanisms. Related information may be disposed on the front and/or the back side of the base member and may include illustrative drawings.

**[0023]** According to yet another aspect of the invention, the cover member covers, in the packaged state, a spring of the cutting device arranged to bias the cutting blades towards an open position. In many known cutting device configurations, the springs biasing the cutting blades are arranged in manner that allows them to be disassembled from the cutting device with relative ease. The cover element protects, at least to some extent, the spring from being removed as long as the cutting device is retained in the packaged state.

**[0024]** According to one preferred embodiment of the invention, the base member is configured to be folded along at least one folding line so as to allow a portion of the base member to be pivoted away from the handles for providing manual access to the handles of the cutting device in the packaged state. The portion of the base member is located, in the packaged state, adjacent to the handles of the cutting device. The portion may be used to display information related to the use of the cutting device. As one can simply fold away the portion from the handles, this embodiment further facilitates manual access to the manual actuatable parts of the cutting device.

**[0025]** As a result of the cover member being firmly secured to the base member, only portions of the base

member that do not carry parts of the cover member can be folded away in the packaged state. Hence, in particular the locations of the fixing points limit the extent of the portion of the base member that may be folded away.

5 This has in some particular arrangements negative consequences with respect to the manual accessibility of the handles in the packaged state. In one preferred embodiment of the invention, the base member comprises a cutting line that forms a continuous line with the at least one folding line. The continuous line defines the portion of the base member that is arranged to be pivoted away from the handles. A suitable combination of the folding line with the cutting line that defines a slit in the base member may be used to circumvent the above-mentioned problem and may in particular be utilized to design configurations, wherein full access to the handles is provided when the portion of the base member is pivoted away.

**[0026]** According to one specific embodiment of the invention, the cutting line at least partially extends around a periphery of a section of the base member that is firmly secured to the cover member. In particular, the cutting line may define an edge of a substantial u-shaped section of the base member that is firmly secured to the cover member. The u-shaped section of the base member may be firmly secured to the cover member at the fixing point located, in the packaged state, between the handles of the cutting device.

**[0027]** Preferably, the packaging is a cardboard blister packaging with the base member at least partially made from cardboard and the cover member at least partially made from plastic. The cover member may be made from a transparent or oblique plastic or polymer.

**[0028]** The invention also relates to the packaged cutting device comprising the pair of cutting blades pivotably secured to each other at the pivot joint. The cutting blades are coupled to the handles for manual operation. The cutting device is packaged in a package as described herein before. In particular, operation of the cutting device may be tested without removal of the packaging.

**[0029]** According to specific embodiments, the packaged cutting device may be configured as secateurs or pruning shears.

**[0030]** In the following, exemplary embodiments of the invention will be described with reference to the figures, in which:

FIG. 1 shows a packaged cutting device according to a first embodiment of the invention in a top view;

FIG. 2 shows a sectional view illustrating details of securing means securing a cover member to a base member of a packaging according to the first embodiment at a fixing point;

FIG. 3 shows the cover member of the first embodiment in a perspective view;

FIG. 4 shows the base member of the first embodiment in a top view;

FIG. 5 shows a packaged cutting device according to a second embodiment of the invention in a top view.

**[0031]** Corresponding elements are indicated in all figures by like reference numerals.

**[0032]** Figures 1 to 4 illustrate the first embodiment of a packaged cutting device 1 comprising a packaging 2. As shown in the top view of Figure 1, the packaged cutting device 1 is configured as secateurs. The packaging 2 of the cutting device 2 comprises a substantially flat base member 3 that carries a cover member 4 to secure the cutting device 1 in a packaged state. In the packaged state, the cutting device 1 is at least partially disposed in between the base member 3 and the cover member 4. The cover member 4 is shaped as a cap and is secured to the base member 3 by means of elements disposed on the base member 3 and the cover member 4 that positively engage each other in a form-fit manner. The base member 3 extends beyond the longitudinal extension of the cutting device 1 arranged in the packaged state. In particular, explanations related to the functionality and/or operability of the cutting device 1 may be printed on the backside of the base member 3.

**[0033]** For illustrative purposes only, parts of the cover member 4 are represented as transparent. The transparent part of the cover element 4 is indicated by a dashed line in figure 1.

**[0034]** According to preferred embodiments, the cover member 4 may be made from oblique or transparent plastic material. The substantially planar base member 3 may be at least partially made from cardboard. In other words, the package 2 may be configured as a particular kind of cardboard blistering packaging.

**[0035]** The cover member 4 is secured to the base member 3 at several locations by form-fit type of engagements. The base member 3 comprises a plurality of substantially rectangular openings 5 that are best seen in figure 4. The openings 5 are configured to receive corresponding locking protrusions 6 disposed on the cover member 4. As best illustrated in figure 3, the locking protrusions 6 comprise abutment shoulders 7 arranged to abut on the base member 3 when the cover member 4 is snapped onto the base member 3.

**[0036]** The locking protrusions 6 fit snugly into the openings 5 of the base member 3 when assembled and provide securing means for retaining a front part of the cutting device 1 in the space between the cover member 4 and the base member 3. The fixing provided by the locking protrusions 6 and the openings 5 is supplemented by additional securing means located at fixing points 8, 9.

**[0037]** The locations of the fixing points 8, 9 relative to the packaged cutting device 1 of the first embodiment are best illustrated in the top view of figure 1. One of the fixing points 8 is located between handles 10, 11 of the

cutting device 1 retained in the packaged state. The handles 11, 10 are coupled to cutting blades 12, 13 for manual operation of the cutting device 1. The cutting blades 12, 13 pivot about a pivot joint 14 during operation of the cutting device 1. The cover element 4 covers the cutting blades 12, 13 and is sized to allow a pivoting movement of the cutting blades 12, 13 while the cutting device 1 is retained in the packaged state illustrated in figure 1.

**[0038]** Additionally, the cover member 4 is firmly secured at another fixing point 9 located adjacent to a front part of the cover member 4 covering tips of the cutting blades 12, 13. The securing means securing the cover member 4 to the base member 3 at the fixing points 8, 9 comprise separate securing elements 15 having bosses 16 that are form fitted into corresponding recesses 17 disposed in the cover member 4.

**[0039]** The sectional view of figure 2 illustrates the arrangement of the securing element 15 engaging the cover member 4 at the fixing point 8. The sectional plane II illustrated in figure 2 is indicated in figure 1 by a corresponding reference numeral. The securing element 15 is arranged on the side of the base member 3 opposite to cover member 4. The boss 16 protrudes through another opening 18 disposed in base member 3 (see figure 4) and into the recess 17 disposed on the cover member 4 (see figure 3). For securing the cover member 4 at the fixing point 8, the respective recess 17 receiving the boss 16 is arranged at the tip of a conical section 19 of the cover member 4 adapted to be arranged between the handles 10, 11 of the cutting device 1. The boss 16 of the securing element 15 is resilient deformable and firmly engages the recess 17 when inserted therein.

**[0040]** With reference to figures 1 and 4, it can be seen that the cover member 4 further comprises projections 20 adapted to abut on the cutting device 1 in the packaged state. The projections 20 engage the cutting device 1 in manner that allows for a pivoting movement of the cutting blades 12, 13 while the cutting device 1 is retained in the packaged state. When the cover member 4 is firmly mounted on top of the base member 3, the projections 20 abut on a front part of the cutting device 1 to retain the latter in the packaged state without imposing restrictions with respect to a pivoting movement of the handles 10, 11 and/or the cutting blades 12, 13 around the pivot joint 14.

**[0041]** The cover member 4 comprises a cut-out 21 that provides manual access to an operating element 22 of an adjustment mechanism of the cutting device 1 when the latter is arranged in the packaged state (see figure 1). The operating element 22 is configured as a lever that may be set to different pivoting positions corresponding to various settings that limit the maximum opening angle of the handles 10, 11 to different values. The adjustment mechanism provides a means for adapting the maximum opening angle at least to some degree to a hand size of the user. The corresponding operating element 22 may be manually operated while the cutting device 1 is retained in its packaging 2, so that the user may fully test

the functionality of the adjustment mechanism without removing the packaging 2.

**[0042]** The cutting device 1 of the first embodiment comprises another operating element 23 arranged on a lateral side of the handle 11. The operating element 23 corresponds to a locking mechanism of the cutting device 1 and is configured as a slider. The operating element 23 may be positioned into at least one position that corresponds to a locked state and into at least another position that corresponds to an unlocked state. In the locked state, a pivoting movement of the handles 10, 11 and/or the cutting blades 12, 13 is blocked. In the unlocked state, the pivoting movement is released and the handles 10, 11 may be operated to pivot the cutting blades 12, 13 about the pivot joint 14. As the operating element 23 arranged on the lateral side of the cutting device 1 is not covered by the cover element 4 and the handles 10, 11 are accessible for manual operation in the packaged state, the user may also test the functionality of the locking mechanism while the cutting device 1 is secured to the packaging 2.

**[0043]** With reference to figures 1 and 4, it can be seen that the base member 3 comprises a folding line 24 that forms a continuous line with a cutting line 25. The continuous line defines a portion 26 of the base member 3 that is adapted to be folded away from the handles 10, 11 to further improve the accessibility of the cutting device 1 in the packaged state. The cutting line 25 extends partially around a periphery of the fixing point 8 and defines a generally u-shaped section of the base member 3 that is firmly secured to the cover member 4 in the packaged state. As a result, the extent of the folding line 24 may be shifted towards the front part of the cutting device 1. The portion 26 adjacent to the handles 10, 11 may be pivoted away by folding the base member 3 along the folding line 24 to provide access to the handles 10, 11.

**[0044]** Figure 5 shows another packaged cutting device 1 configured as secateurs of slightly different design. The features of the second embodiment shown in figure 5 essentially correspond to the ones of the first embodiment illustrated in figures 1 to 4. Hence, we refer to the description with respect to figures 1 to 4 to avoid repetitions.

**[0045]** For illustrative purposes only, parts of the cover member 4 are represented as transparent. The transparent part of the cover element 4 is indicated by a dashed line in figure 5.

**[0046]** The cover member 4 of the packaging 2 according to the second embodiment is arranged to cover a spring 27 of the cutting device 1 retained in the packaged state. During operation of the cutting device 1, the spring 27 is adapted to bias the handles 10, 11 away from each other towards an open position.

**[0047]** The adjustment mechanism of the cutting device 1 according to the second embodiment comprises a single operating element 23 arranged as a slider on a lateral side of the handle 11. The settings of operating element 23 relates to configurations of an adjustment

mechanism for locking the pivoting movement of the cutting blades 12, 13 and for adjusting the maximal opening angle of the cutting blades 12, 13 and/or the handles 12, 13. The possible settings of the operating element 23 in particular relates to at least three settings. In one possible setting relating to a locked mode, the pivoting movement of the cutting blades 12, 13 is blocked in a fully closed configuration. Another possible setting corresponds to an unlocked mode that allows for an unrestricted operation of the cutting device 1. At least one third setting of the operating element 23 restricts the maximum opening angle of the cutting blades 12, 13 and/or the handles 10, 11 to an intermediate angle that lies between the fully closed position of the locked mode and the maximal opening angle of the unlocked mode.

**[0048]** The operating element 23 and the handles 10, 11 are fully accessible while the cutting device 1 is retained in the packaged state. The packaging 2 does not impose any substantial restrictions on the packaged cutting device 1 regarding the pivoting movement of the cutting blades 12, 13 and/or the handles 10, 11 around the pivot joint 14. A user may thus ascertain the operability of the cutting device 1 while the latter is firmly secured in the packaged state.

**[0049]** The invention was described herein before with respect to preferred embodiments shown in the figures. However, it is understood that the invention is not limited to the illustrated embodiments.

#### 30 List of reference numerals

##### [0050]

1	cutting device
2	packaging
3	base member
4	cover member
5	opening
6	locking protrusion
7	abutment shoulder
8	fixing point
9	fixing point
10	handle
11	handle
12	cutting blade
13	cutting blade
14	pivot joint
15	securing element
16	boss
17	recess
18	opening
19	conical section
20	projection
21	cut-out
22	operating element
23	operating element
24	folding line
25	cutting line

- 26 portion
- 27 spring

II sectional plane

**Claims**

1. Packaged cutting device (1), comprising the cutting device (1) defined to comprise a pair of cutting blades (12, 13) pivotably secured to each other at a pivot joint (14), the cutting blades (12, 13) are coupled to handles (10, 11) for manual operation of the cutting device (1), and comprising a packaging (2) that comprises a base member (3) defining a plane and a cover member (4) shaped as cap, the cover member (4) being secured to the base member (3) in a packaged state, wherein, in said packaged state, the cover member (4) at least partially covers at least one of the cutting blades (12, 13) but does not substantially cover the handles (10, 11), the handles (10, 11) being accessible for manual engagement in the packaged state and wherein the means of the cover member (4) engaging the base member (3) in a form fit connection or form fitting enclosure do secure the cutting device (1) in the packaged state, and wherein in the packaged state, the cover member (4) is engaging the base member (3) in at least one fixing point (8) that is located between the handles (10, 11), whereby the cover member (4) extends over the central portion of the cutting device (1) comprising the pivot joint (14), **characterized in that**, the base member (3) is configured to be folded along at least one folding line (24) so as to allow a portion (26) of the base member (3) to be pivoted away from the handles (10, 11) for providing manual access to the handles (10, 11) of the cutting device (1) in the packaged state, the portion of the base member (3) located, in the packaged state, adjacent to the handles (10,11) of the cutting device (1).
2. Packaged cutting device (1) according to claim 1, **characterized in that** the base member (3) comprises a cutting line (25) that forms a continuous line with the at least one folding line (24), the continuous line defining the portion (26) of the base member (3) that is arranged to be pivoted away from the handles (10, 11).
3. Packaged cutting device (1) according to claim 2, **characterized in that** the cutting line (25) at least partially extends around a periphery of a section of the base member (3) that is firmly secured to the cover member (4).

4. Packaged cutting device (1) according to claim 1, **characterized in that** the cover member (4) is secured to the base member (3) at at least one fixing point (8,9) by a securing element (15) having a boss (16), the securing element (15) being disposed on the side of the base member (3) opposite to the cover element (4), wherein the boss (16) protrudes through the base member (3) and is form fitted into a recess (17) disposed on the cover member (4).
5. Packaged cutting device (1) according to any of the previous claims, **characterized in that** the cover member (4) is secured to the base member (3) by at least one additional securing element (15) having a boss (16) that is form fitted into another recess (17) of the cover member (4) at another fixing point (9) that is located adjacent to a front portion of the cover member (4) arranged to cover a tip of at least one of the cutting blades (13, 14).
6. Packaged cutting device (1) according to one of the previous claims, **characterized in that** the form fit connection between the cover member (4) and the base member (3) is provided by at least one locking protrusion (6) that engages a corresponding opening (5) disposed in the base member (3).
7. Packaged cutting device (1) according to one of the previous claims, **characterized in that** the cutting device (1) comprises at least one adjustment mechanism with at least one operating element (22, 23) configured to be manually engaged, wherein the cover member (4) comprises at least one cut-out (21) for providing manual access to the at least one operating element (22, 23) in the packaged state.
8. Packaged cutting device (1) according to claim 7, **characterized in that** the adjustment mechanism is a locking mechanism or a mechanism for adjusting the opening angle of the cutting blades (12, 13).
9. Packaged cutting device (1) according to one of the previous claims, **characterized in that** the base member (3) extends beyond the longitudinal dimension of the cutting device (1) in the packaged state.
10. Packaged cutting device (1) according to one of the previous claims, **characterized in that**, in the packaged state, the cover member (4) covers a spring (27) of the cutting device (1) arranged to bias the cutting blades (12, 13) towards an open position.
11. Packaged cutting device (1) according to one of the previous claims, **characterized in that** the packaging (2) is a cardboard blister packaging with the base member (3) at least partially made from cardboard and the cover member (3) at least partially made from plastic.

12. Packaged cutting device (1) according to one of the previous claims, **characterized in that** the cutting device (1) is configured as secateurs or pruning shears.

### Patentansprüche

1. Verpackte Schneidevorrichtung (1), umfassend die Schneidevorrichtung (1), die ausgebildet ist, um ein Paar Schneidmesser (12, 13) zu umfassen, die schwenkbar zueinander an einem Schwenkgelenk (14) befestigt sind, wobei die Schneidmesser (12, 13) mit Griffen (10, 11) zum manuellen Betätigen der Schneidevorrichtung (1) verbunden sind, und umfassend eine Verpackung (2), die ein Basiselement (3), das eine Ebene bildet und ein als Kappe geformtes Abdeckelement (4) umfasst, wobei das Abdeckelement (4) in einem verpackten Zustand an dem Basiselement (3) gesichert ist, wobei das Abdeckelement (4) in dem verpackten Zustand mindestens teilweise mindestens eines der Schneidmesser (12, 13) abdeckt, aber die Griffe (10, 11) nicht im Wesentlichen abdeckt, wobei die Griffe (10, 11) für den manuellen Eingriff im verpackten Zustand zugänglich sind und wobei die Vorrichtung des Abdeckelements (4) in das Basiselement (3) in einer Formschluss-Verbindung oder einem Formschlussgehäuse eingreift, um die Schneidevorrichtung (1) im verpackten Zustand zu sichern, und wobei das Abdeckelement (4) im verpackten Zustand in das Basiselement (3) in mindestens einen Befestigungspunkt (8) eingreift, der zwischen den Griffen (10, 11) angeordnet ist, wobei sich das Abdeckelement (4) über den mittleren Abschnitt der Schneidevorrichtung (1) erstreckt, die das Drehgelenk (14) umfasst, **dadurch gekennzeichnet, dass**, das Basiselement (3) ausgebildet ist, um entlang mindestens einer Falllinie (24) gefaltet zu werden, so dass ein Abschnitt (26) des Basiselements (3) von den Griffen (10, 11) weggeschwenkt werden kann, um einen manuellen Zugang zu den Griffen (10, 11) der Schneidevorrichtung (1) im verpackten Zustand zu ermöglichen, wobei der Abschnitt des Basiselements (3) im verpackten Zustand neben den Griffen (10, 11) der Schneidevorrichtung (1) angeordnet ist.
2. Verpackte Schneidevorrichtung (1) nach Anspruch 1, **dadurch gekennzeichnet, dass** das Basiselement (3) eine Schneidlinie (25) umfasst, die mit der mindestens einen Falllinie (24) eine durchgehende Linie bildet, wobei die durchgehende Linie den Abschnitt (26) des Basiselements (3) bildet, der von den Griffen (10, 11) weggeschwenkt werden kann.

3. Verpackte Schneidevorrichtung (1) nach Anspruch 2, **dadurch gekennzeichnet, dass** sich die Schneidlinie (25) zumindest teilweise um einen Umfang eines Abschnitts des Basiselements (3) erstreckt, der fest mit dem Abdeckelement (4) verbunden ist.
4. Verpackte Schneidevorrichtung (1) nach Anspruch 1, **dadurch gekennzeichnet, dass** das Abdeckelement (4) an dem Basiselement (3) an mindestens einem Befestigungspunkt (8, 9) durch ein Sicherungselement (15) mit einem Vorsprung (16) befestigt ist, das Sicherungselement (15) auf der dem Abdeckelement (4) gegenüberliegenden Seite des Basiselements (3) angeordnet ist, wobei der Vorsprung (16) durch das Basiselement (3) vorsteht und in eine am Abdeckelement (4) angeordnete Aussparung (17) angepasst ist.
5. Verpackte Schneidevorrichtung (1) nach einem der vorhergehenden Ansprüche, **dadurch gekennzeichnet, dass** das Abdeckelement (4) am Basiselement (3) durch mindestens ein zusätzliches Sicherungselement (15) mit einem Vorsprung (16) gesichert ist, der in eine andere Aussparung (17) des Abdeckelements (4) an einem anderen Befestigungspunkt (9) angepasst ist, der an einen vorderen Abschnitt des Abdeckelements (4) angrenzend angeordnet ist, um eine Spitze von mindestens einem der Schneidmesser (13, 14) abzudecken.
6. Verpackte Schneidevorrichtung (1) nach einem der vorhergehenden Ansprüche, **dadurch gekennzeichnet, dass** die formschlüssige Verbindung zwischen dem Abdeckelement (4) und dem Basiselement (3) durch mindestens einen Verriegelungsvorsprung (6) gebildet wird, der in eine entsprechende Öffnung (5) eingreift, die im Basiselement (3) angeordnet ist.
7. Verpackte Schneidevorrichtung (1) nach einem der vorhergehenden Ansprüche, **dadurch gekennzeichnet, dass** die Schneidevorrichtung (1) mindestens einen Einstellmechanismus mit mindestens einem Betätigungselement (22, 23) umfasst, das für den manuellen Eingriff ausgelegt ist, wobei das Abdeckelement (4) mindestens eine Ausnehmung (21) umfasst, um den manuellen Zugang zu dem mindestens einen Betätigungselement (22, 23) im verpackten Zustand zu ermöglichen.
8. Verpackte Schneidevorrichtung (1) nach Anspruch 7, **dadurch gekennzeichnet, dass** der Einstellmechanismus ein Verriegelungsmechanismus oder ein Mechanismus zum Einstellen des Öffnungswinkels der Schneidmesser (12, 13) ist.
9. Verpackte Schneidevorrichtung (1) nach einem der

vorhergehenden Ansprüche, **dadurch gekennzeichnet, dass** sich das Basiselement (3) im verpackten Zustand über die Längsabmessung der Schneidevorrichtung (1) hinaus erstreckt.

10. Verpackte Schneidevorrichtung (1) nach einem der vorhergehenden Ansprüche, **dadurch gekennzeichnet, dass** das Abdeckelement (4) im verpackten Zustand eine Feder (27) der Schneidevorrichtung (1) abdeckt, die so angeordnet ist, dass sie die Schneidmesser (12, 13) in eine offene Position vorspannt.
11. Verpackte Schneidevorrichtung (1) nach einem der vorhergehenden Ansprüche, **dadurch gekennzeichnet, dass** die Verpackung (2) eine Kartonblisterverpackung ist, wobei das Basiselement (3) zumindest teilweise aus Karton und das Abdeckelement (3) zumindest teilweise aus Kunststoff besteht.
12. Verpackte Schneidevorrichtung (1) nach einem der vorhergehenden Ansprüche, **dadurch gekennzeichnet, dass** die Schneidevorrichtung (1) als Schere oder Astschere ausgebildet ist.

#### Revendications

1. Dispositif de coupe emballé (1), comprenant le dispositif de coupe (1) défini pour comprendre une paire de lames de coupe (12, 13) fixées de manière pivotante l'une à l'autre au niveau d'une articulation pivotante (14), les lames de coupe (12, 13) sont couplées à des poignées (10, 11) pour le fonctionnement manuel du dispositif de coupe (1), et comprenant un emballage (2) qui comprend un élément de base (3) définissant un plan et un élément de recouvrement (4) en forme de capuchon, l'élément de recouvrement (4) étant fixé à l'élément de base (3) dans un état emballé, dans lequel, dans ledit état emballé, l'élément de recouvrement (4) recouvre au moins partiellement au moins l'une des lames de coupe (12, 13) mais ne recouvre pas sensiblement les poignées (10, 11), les poignées (10, 11) étant accessibles pour engagement manuel dans l'état emballé et dans lequel les moyens de l'élément de recouvrement (4) engageant l'élément de base (3) dans une connexion de forme ajustée ou boîtier de forme ajustée fixent le dispositif de coupe (1) dans l'état emballé, et ou dans l'état emballé, l'élément de recouvrement (4) engage l'élément de base (3) dans au moins un point de fixation (8) qui est situé entre les poignées (10, 11), dans lequel l'élément de recouvrement (4) s'étend sur la partie centrale du dispositif de coupe (1) comprenant l'articulation pivotante (14),

**caractérisé en ce que,**

l'élément de base (3) est configuré pour être plié le long d'au moins une ligne de pliage (24) de manière à permettre à une partie (26) de l'élément de base (3) de pivoter à l'écart des poignées (10, 11) pour fournir un accès manuel aux poignées (10, 11) du dispositif de coupe (1) dans l'état emballé, la partie de l'élément de base (3) située, dans l'état emballé, adjacente aux poignées (10,11) adjacente le dispositif de coupe (1).

2. Dispositif de coupe emballé (1) selon la revendication 1, **caractérisé en ce que** l'élément de base (3) comprend une ligne de coupe (25) qui forme une ligne continue avec l'au moins une ligne de pliage (24), la ligne continue définissant la partie (26) de l'élément de base (3) qui est disposée pour être pivotée loin des poignées (10,11).
3. Dispositif de coupe emballé (1) selon la revendication 2, **caractérisé en ce que** la ligne de coupe (25) s'étend au moins partiellement autour d'une périphérie d'une section de l'élément de base (3) qui est fermement fixée sur l'élément de recouvrement (4).
4. Dispositif de coupe emballé (1) selon la revendication 1, **caractérisé en ce que** l'élément de recouvrement (4) est fixé à l'élément de base (3) en au moins un point de fixation (8, 9) par un élément de fixation (15) comportant un bossage (16), l'élément de fixation (15) étant disposé sur le côté opposé à l'élément de base (3), le bossage (16) traversant l'élément de base (3) et étant fixé dans un évidement (17) disposé sur l'élément de recouvrement (4).
5. Dispositif de coupe emballé (1) selon l'une quelconque des revendications précédentes, **caractérisé en ce que** l'élément de recouvrement (4) est fixé à l'élément de base (3) par au moins un élément de fixation supplémentaire (15) comportant un bossage (16) qui est de forme adaptée dans un autre évidement (17) de l'élément de recouvrement (4) en un autre point de fixation (9) qui est situé adjacent à une partie avant de l'élément de recouvrement (4) agencé pour couvrir une pointe d'au moins l'une des lames coupantes (13, 14).
6. Dispositif de coupe emballé (1) selon l'une des revendications précédentes, **caractérisé en ce que** la liaison d'ajustement de forme entre l'élément de recouvrement (4) et l'élément de base (3) est assurée par au moins une saillie de verrouillage (6) qui vient en prise avec une ouverture correspondante (5) disposée dans l'élément de base (3).
7. Dispositif de coupe emballé (1) selon l'une des revendications précédentes, **caractérisé en ce que** le dispositif de coupe (1) comprend au moins un mé-

canisme d'ajustement publicitaire avec au moins un élément de commande (22, 23) configuré pour être engagé manuellement, dans lequel l'élément de recouvrement (4) comprend au moins une découpe (21) pour permettre un accès manuel à au moins un élément de commande (22, 23) dans l'état emballé. 5

8. Dispositif de coupe emballé (1) selon la revendication 7, **caractérisé en ce que** le mécanisme de réglage est un mécanisme de verrouillage ou un mécanisme pour régler l'angle d'ouverture des lames de coupe (12, 13). 10
9. Dispositif de coupe emballé (1) selon l'une des revendications précédentes, **caractérisé en ce que** l'élément de base (3) s'étend au-delà de la dimension longitudinale du dispositif de coupe (1) dans l'état emballé. 15
10. Dispositif de coupe emballé (1) selon l'une des revendications précédentes, **caractérisé en ce que**, dans l'état emballé, l'élément de recouvrement (4) recouvre un ressort (27) du dispositif de coupe (1) disposé de manière à polariser les lames de coupe (12, 13) vers une position ouverte. 20 25
11. Dispositif de découpe emballé (1) selon l'une des revendications précédentes, **caractérisé en ce que** l'emballage (2) est un emballage blister en carton avec l'élément de base (3) au moins partiellement en carton et l'élément de recouvrement (3) au moins partiellement en plastique. 30
12. Dispositif de coupe emballé (1) selon l'une des revendications précédentes, **caractérisé en ce que** le dispositif de coupe (1) est configuré comme sécateur ou sécateur. 35

40

45

50

55



FIG 2

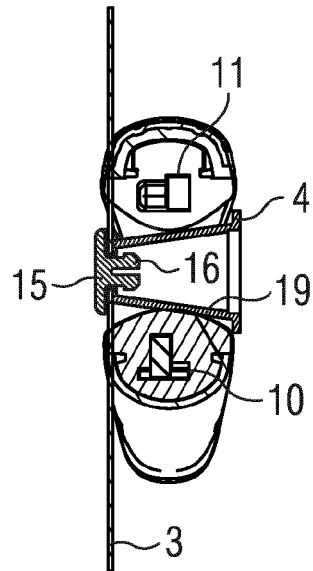

FIG 3

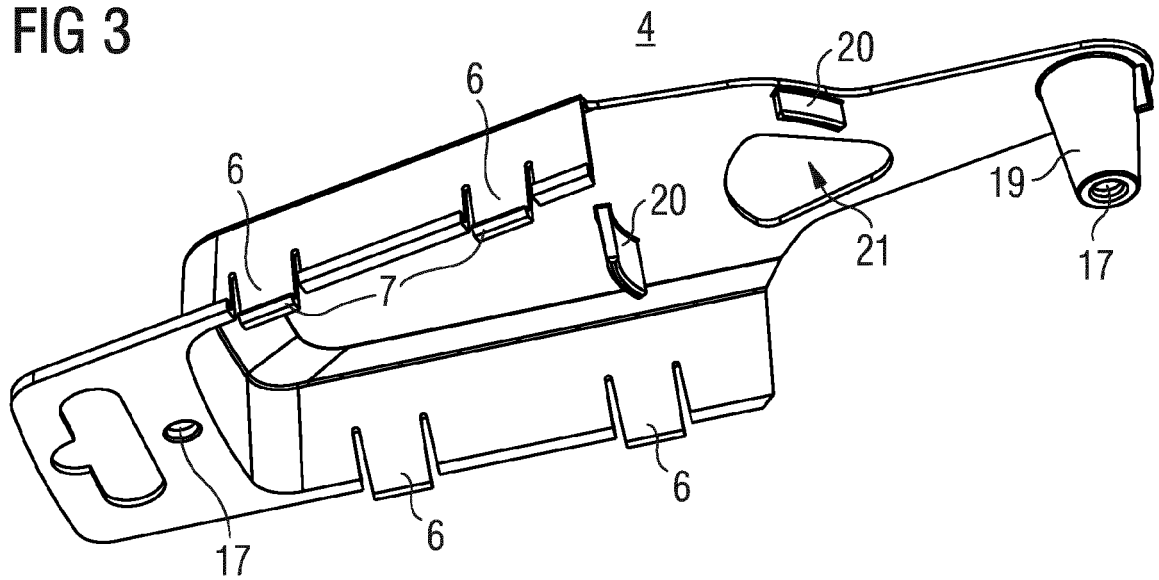

FIG 4

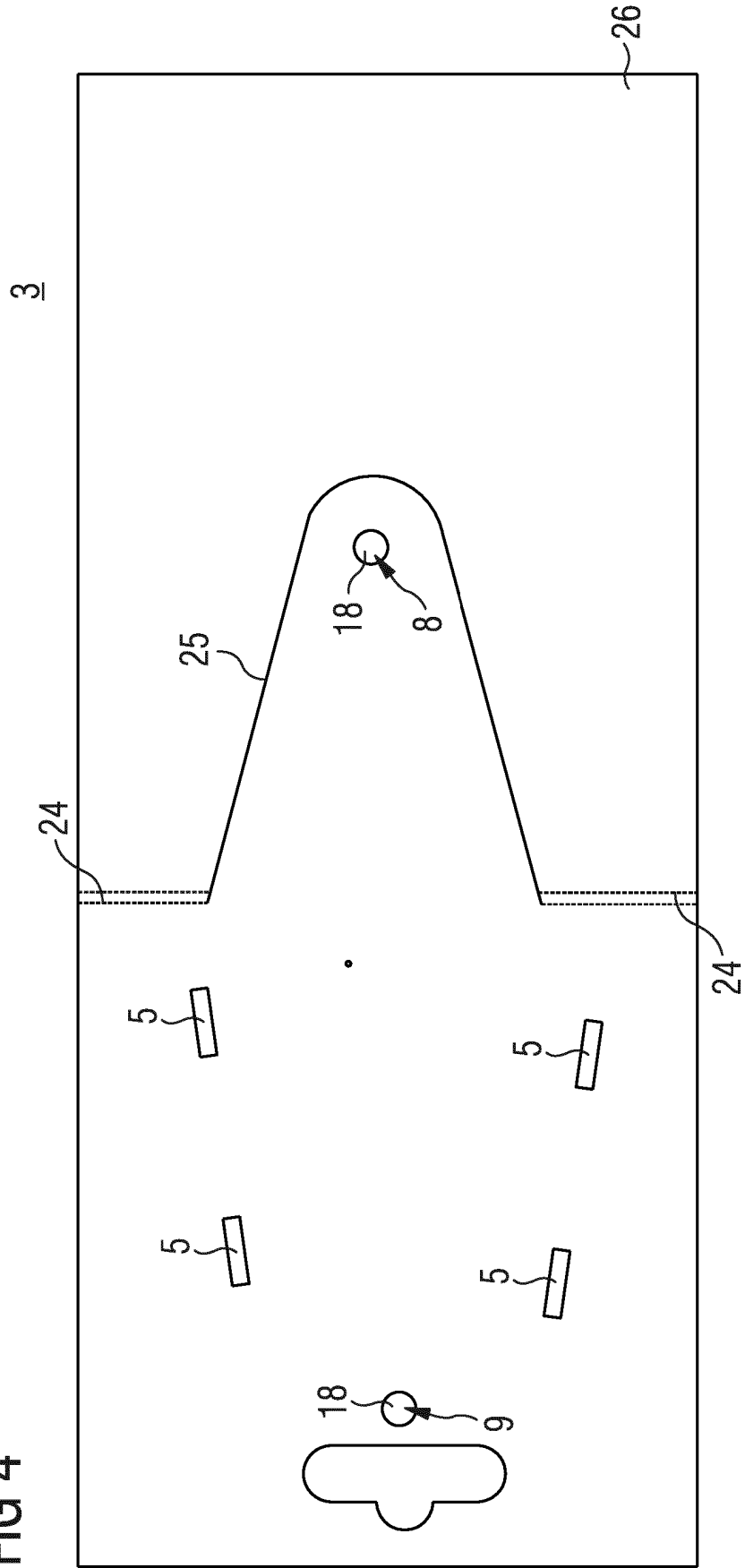
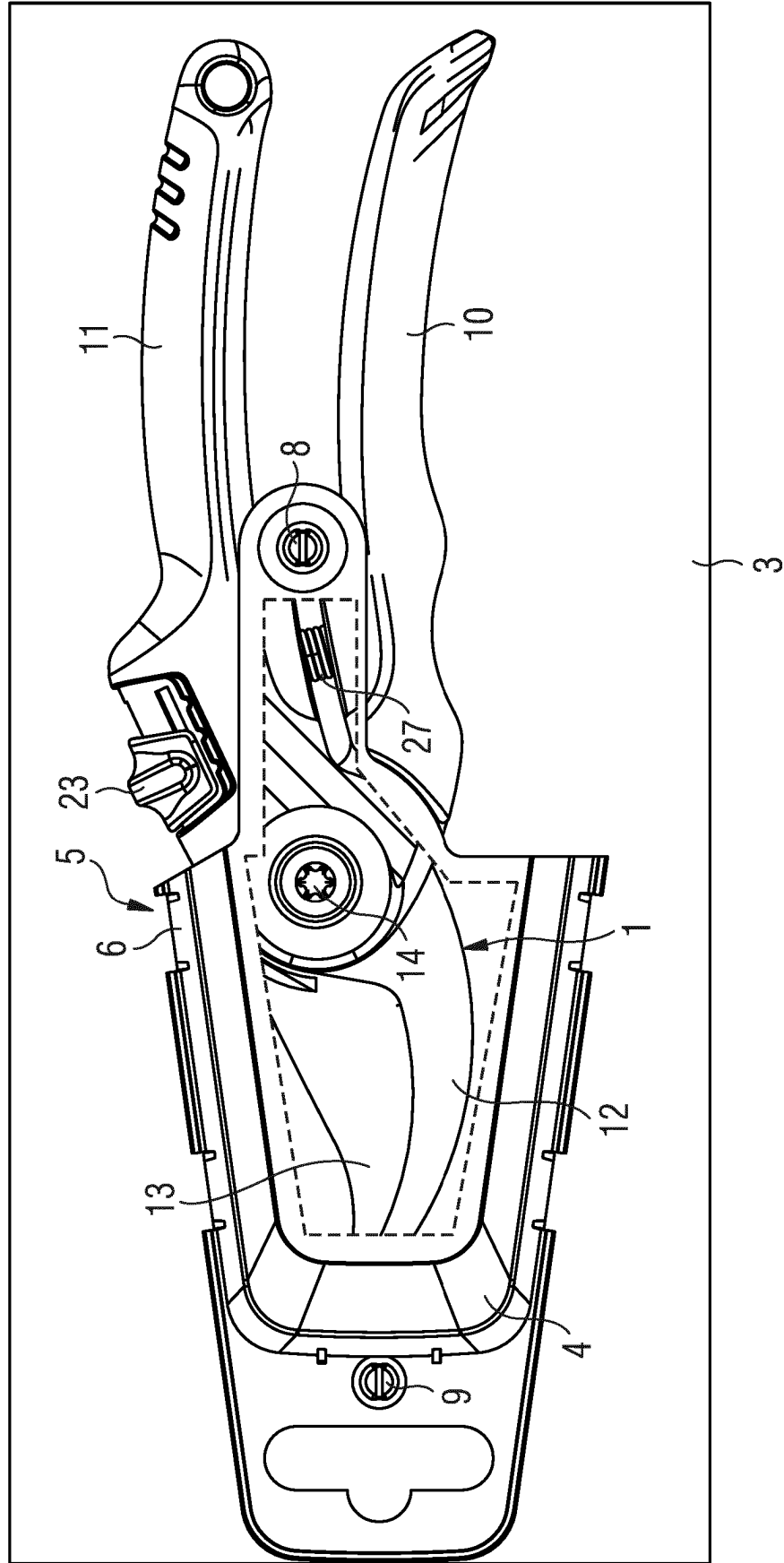

FIG 5



**REFERENCES CITED IN THE DESCRIPTION**

*This list of references cited by the applicant is for the reader's convenience only. It does not form part of the European patent document. Even though great care has been taken in compiling the references, errors or omissions cannot be excluded and the EPO disclaims all liability in this regard.*

**Patent documents cited in the description**

- EP 1990292 A1 [0007]
- US 4872551 A [0008]