

(51) International Patent Classification:
A61B 5/1468 (2006.01)(21) International Application Number:
PCT/US2011/055177(22) International Filing Date:
6 October 2011 (06.10.2011)

(25) Filing Language: English

(26) Publication Language: English

(30) Priority Data:
61/391,065 7 October 2010 (07.10.2010) US(71) Applicant (for all designated States except US): **ABBOTT DIABETES CARE INC.** [US/US]; 1360 South Loop Road, Alameda, CA 94502 (US).

(72) Inventors; and

(75) Inventors/Applicants (for US only): **FENNELL, Martin, L.** [US/US]; 1274 Kestrel Court, Concord, CA 94521 (US). **COLE, Jean-pierre** [US/US]; 23143 Grunauer Road, Tracy, CA 95304 (US). **KUNICH, Theodore, John** [US/US]; 3464 Beecham Court, Pleasanton, CA 94588 (US). **HOSS, Udo** [DE/US]; 5172 Stone Canyon Drive, Castro Valley, CA 94522 (US). **FELDMAN, Benjamin, Jay** [US/US]; 5830 Colby Street, Oakland, CA 94618 (US). **LIU, Zenghe** [US/US]; 101 Payot Court, Alameda, CA 94502 (US).(74) Agent: **OH, Seong-Kun**; Jackson & Co., LLP, 6114 La Salle Avenue, #507, Oakland, CA 94611 (US).

(81) Designated States (unless otherwise indicated, for every kind of national protection available): AE, AG, AL, AM, AO, AT, AU, AZ, BA, BB, BG, BH, BR, BW, BY, BZ, CA, CH, CL, CN, CO, CR, CU, CZ, DE, DK, DM, DO, DZ, EC, EE, EG, ES, FI, GB, GD, GE, GH, GM, GT, HN, HR, HU, ID, IL, IN, IS, JP, KE, KG, KM, KN, KP, KR, KZ, LA, LC, LK, LR, LS, LT, LU, LY, MA, MD, ME, MG, MK, MN, MW, MX, MY, MZ, NA, NG, NI, NO, NZ, OM, PE, PG, PH, PL, PT, QA, RO, RS, RU, RW, SC, SD, SE, SG, SK, SL, SM, ST, SV, SY, TH, TJ, TM, TN, TR, TT, TZ, UA, UG, US, UZ, VC, VN, ZA, ZM, ZW.

(84) Designated States (unless otherwise indicated, for every kind of regional protection available): ARIPO (BW, GH, GM, KE, LR, LS, MW, MZ, NA, RW, SD, SL, SZ, TZ, UG, ZM, ZW), Eurasian (AM, AZ, BY, KG, KZ, MD, RU, TJ, TM), European (AL, AT, BE, BG, CH, CY, CZ, DE, DK, EE, ES, FI, FR, GB, GR, HR, HU, IE, IS, IT, LT, LU, LV, MC, MK, MT, NL, NO, PL, PT, RO, RS, SE, SI, SK, SM, TR), OAPI (BF, BJ, CF, CG, CI, CM, GA, GN, GQ, GW, ML, MR, NE, SN, TD, TG).

Published:

— without international search report and to be republished upon receipt of that report (Rule 48.2(g))

(54) Title: ANALYTE MONITORING DEVICES AND METHODS

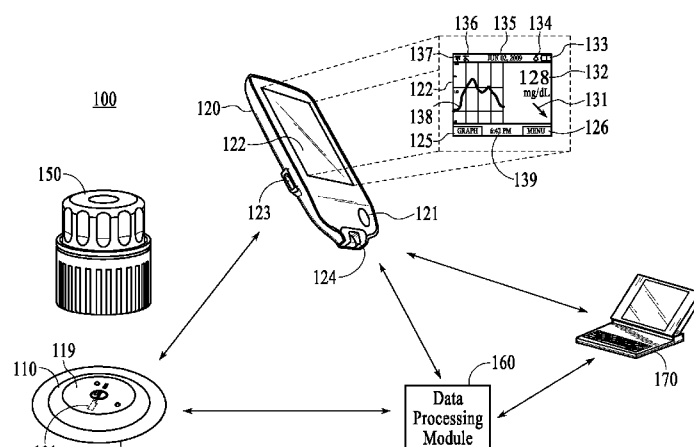

FIG. 1

(57) Abstract: Methods and devices for providing application specific integrated circuit architecture for a two electrode analyte sensor or a three electrode analyte sensor are provided. Systems and kits employing the same are also provided.

ANALYTE MONITORING DEVICES AND METHODS**PRIORITY**

[0001] The present application claims the benefit of U.S. provisional application no. 61/391,065 filed October 7, 2010, entitled “Analyte Monitoring Devices and Methods”, the disclosure of which is incorporated herein by reference for all purposes.

BACKGROUND

[0002] The detection and/or monitoring of glucose levels or other analytes, such as lactate, oxygen, A1C, or the like, in certain individuals is vitally important to their health. For example, the monitoring of glucose is particularly important to individuals with diabetes. Diabetics generally monitor glucose levels to determine if their glucose levels are being maintained within a clinically safe range, and may also use this information to determine if and/or when insulin is needed to reduce glucose levels in their bodies or when additional glucose is needed to raise the level of glucose in their bodies.

[0003] Growing clinical data demonstrates a strong correlation between the frequency of glucose monitoring and glycemic control. Despite such correlation, many individuals diagnosed with diabetic condition do not monitor their glucose levels as frequently as they should due to a combination of factors including convenience, testing discretion, pain associated with glucose testing, and/or cost.

[0004] Devices have been developed for the automatic or continuous monitoring of analyte(s), such as glucose, in bodily fluid such as in the blood stream or in interstitial fluid (“ISF”), or other biological fluid. Some of these analyte measuring devices are configured so that at least a portion of the devices are positioned below a skin surface of a user, e.g., in a blood vessel or in the subcutaneous tissue of a user, so that the monitoring is accomplished in vivo.

[0005] With the continued development of analyte monitoring devices and systems, there is a need for such analyte monitoring devices, systems,

and methods, as well as for processes for manufacturing analyte monitoring devices and systems that are cost effective, convenient, and with reduced pain, provide discreet monitoring to encourage frequent analyte monitoring to improve glycemic control.

INCORPORATION BY REFERENCE

[0006] Patents, applications and/or publications described herein, including the following patents, applications and/or publications are incorporated herein by reference for all purposes: U.S. Patent Nos. 4,545,382, 4,711,245, 5,262,035, 5,262,305, 5,264,104, 5,320,715, 5,356,786, 5,509,410, 5,543,326, 5,593,852, 5,601,435, 5,628,890, 5,820,551, 5,822,715, 5,899,855, 5,918,603, 6,071,391, 6,103,033, 6,120,676, 6,121,009, 6,134,461, 6,143,164, 6,144,837, 6,161,095, 6,175,752, 6,270,455, 6,284,478, 6,299,757, 6,338,790, 6,377,894, 6,461,496, 6,503,381, 6,514,460, 6,514,718, 6,540,891, 6,560,471, 6,579,690, 6,591,125, 6,592,745, 6,600,997, 6,605,200, 6,605,201, 6,616,819, 6,618,934, 6,650,471, 6,654,625, 6,676,816, 6,730,200, 6,736,957, 6,746,582, . 6,749,740, 6,764,581, 6,773,671, 6,881,551, 6,893,545, 6,932,892, 6,932,894, 6,942,518, 7,041,468, 7,167,818, 7,299,082, and 7,866,026, U.S. Patent Publication Nos. 2004/0186365, 2005/0182306, 2006/0025662, 2006/0091006, 2007/0056858, 2007/0068807, 2007/0095661, 2007/0108048, 2007/0199818, 2007/0227911, 2007/0233013, 2008/0066305, 2008/0081977, 2008/0102441, 2008/0148873, 2008/0161666, 2008/0267823, 2009/0054748, 2009/0294277, 2010/0213057, 2010/0081909, 2009/0247857, 2011/0106126, 2011/0082484, 2010/0326842, 2010/0198034, 2010/0324392, 2010/0230285, 2010/0313105, 2011/0213225, 2011/0021889, 2011/0193704, 2011/0190603, and 2011/0191044, U.S. Patent Application Nos. 13/071,461, 13/071,487, and 13/071,497, and U.S. Provisional Application No. 61/325,260.

SUMMARY

- [0007]** In view of the foregoing, devices, methods and systems for providing electronics for coupling to analyte sensors are provided including, for example, application specific integrated circuit (ASIC) configurations that provide electrical coupling of electrodes of analyte sensors having one or more configurations such as, for example, self powered two electrode analyte sensors, or three electrode analyte sensors.
- [0008]** Embodiments of the present disclosure include analyte monitoring devices. Certain aspects of analyte monitoring devices comprise an analyte sensor including a plurality of electrodes, including an in vivo portion of the analyte sensor configured for fluid contact with a bodily fluid under a skin layer, the analyte sensor configured to monitor an analyte level in the bodily fluid and to generate one or more signals associated with the monitored analyte level and sensor electronics including a sensor interface section and a data processing section, the sensor interface section configured to electrically couple to the plurality of electrodes of the analyte sensor, and the data processing section configured to process one or more signals received from the analyte sensor, wherein the sensor interface section includes an electrical interface to couple to two electrodes of the plurality of electrodes, or three electrodes of the plurality of electrodes, and further wherein the data processing section includes an application specific integrated circuit with programmable logic to perform one or more operations of the data processing section including processing the one or more signals from the analyte sensor for filtering, calibration, storage, transmission, or one or more combinations thereof.
- [0009]** Certain embodiments include providing an analyte sensor including a plurality of electrodes, including an in vivo portion of the analyte sensor for fluid contact with a bodily fluid under a skin layer, the analyte sensor for monitoring an analyte level in the bodily fluid and for generating one or more signals associated with the monitored analyte level and providing sensor electronics including a sensor interface section and a data processing section, wherein providing sensor electronics includes

configuring the sensor interface section to electrically couple to the plurality of electrodes of the analyte sensor, and configuring the data processing section to process one or more signals received from the analyte sensor, wherein configuring the sensor interface section includes providing an electrical interface to couple to two electrodes of the plurality of electrodes, or three electrodes of the plurality of electrodes and further wherein configuring the data processing section includes providing an application specific integrated circuit with programmable logic to perform one or more operations of the data processing section including processing the one or more signals from the analyte sensor for filtering, calibration, storage, transmission, or one or more combinations thereof.

[0010] These and other objects, features and advantages of the present disclosure will become more fully apparent from the following detailed description of the embodiments, the appended claims and the accompanying drawings.

BRIEF DESCRIPTION OF THE DRAWINGS

[0011] FIG. 1 shows an overall in vivo sensor based analyte monitoring system for use in certain embodiments of the present disclosure;

[0012] FIG. 2 illustrates a block diagram of the on body electronics configured for operation with a two electrode analyte sensor in certain embodiments;

[0013] FIG. 3 illustrates a block diagram of the on body electronics configured for operation with a two electrode analyte sensor with a power source in certain embodiments;

[0014] FIG. 4 illustrates a block diagram of the on body electronics configured for operation with a two electrode sensor or a three electrode analyte sensor in certain embodiments; and

[0015] FIGS. 5 and 6 are graphical illustrations of thermistor characteristics for use in the analyte monitoring system of FIG. 1 in certain embodiments.

DETAILED DESCRIPTION

- [0016]** Before the present disclosure is described in detail, it is to be understood that this disclosure is not limited to particular embodiments described, as such may, of course, vary. It is also to be understood that the terminology used herein is for the purpose of describing particular embodiments only, and is not intended to be limiting, since the scope of the present disclosure will be limited only by the appended claims.
- [0017]** Where a range of values is provided, it is understood that each intervening value, to the tenth of the unit of the lower limit unless the context clearly dictates otherwise, between the upper and lower limit of that range and any other stated or intervening value in that stated range, is encompassed within the disclosure. The upper and lower limits of these smaller ranges may independently be included in the smaller ranges is also encompassed within the disclosure, subject to any specifically excluded limit in the stated range. Where the stated range includes one or both of the limits, ranges excluding either or both of those included limits are also included in the disclosure.
- [0018]** Unless defined otherwise, all technical and scientific terms used herein have the same meaning as commonly understood by one of ordinary skill in the art to which this disclosure belongs. Although any methods and materials similar or equivalent to those described herein can also be used in the practice or testing of the present disclosure, the preferred methods and materials are now described. All publications mentioned herein are incorporated herein by reference to disclose and describe the methods and/or materials in connection with which the publications are cited.
- [0019]** It must be noted that as used herein and in the appended claims, the singular forms “a”, “an”, and “the” include plural referents unless the context clearly dictates otherwise.
- [0020]** The publications discussed herein are provided solely for their disclosure prior to the filing date of the present application. Nothing herein is to be construed as an admission that the present disclosure is not entitled to antedate such publication by virtue of prior disclosure. Further,

the dates of publication provided may be different from the actual publication dates which may need to be independently confirmed.

[0021] As will be apparent to those of skill in the art upon reading this disclosure, each of the individual embodiments described and illustrated herein has discrete components and features which may be readily separated from or combined with the features of any of the other several embodiments without departing from the scope or spirit of the present disclosure.

[0022] The figures shown herein are not necessarily drawn to scale, with some components and features being exaggerated for clarity.

[0023] FIG. 1 shows an exemplary in vivo based analyte monitoring system 100 in accordance with embodiments of the present disclosure. As shown, in certain embodiments, analyte monitoring system 100 includes on body electronics 110 electrically coupled to in vivo analyte sensor 101 (a proximal portion of which is shown in FIG. 1) and attached to adhesive layer 140 for attachment on a skin surface on the body of a user. On body electronics 110 includes on body housing 119, that defines an interior compartment. Also shown in FIG. 1 is insertion device 150 that, when operated, transcutaneously positions a portion of analyte sensor 101 through a skin surface and in fluid contact with ISF, and positions on body electronics 110 and adhesive layer 140 on a skin surface. In certain embodiments, on body electronics 110, analyte sensor 101 and adhesive layer 140 are sealed within the housing of insertion device 150 before use, and in certain embodiments, adhesive layer 140 is also sealed within the housing or itself provides a terminal seal of the insertion device 150. Devices, systems and methods that maybe used with embodiments herein are described, e.g., in U.S. Patent Publication Nos. 2010/0198034, 2010/0324392 and 2011/0213225, the disclosures of each of which are incorporated herein by reference for all purposes.

[0024] Referring back to the FIG. 1, analyte monitoring system 100 includes display device 120 which includes a display 122 to output information to the user, an input component 121 such as a button, actuator, a touch sensitive switch, a capacitive switch, pressure sensitive

switch, jog wheel or the like, to input data or command to display device 120 or otherwise control the operation of display device 120.

[0025] In certain embodiments, input component 121 of display device 120 may include a microphone and display device 120 may include software configured to analyze audio input received from the microphone, such that functions and operation of the display device 120 may be controlled by voice commands. Display device 120 also includes data communication port 123 for wired data communication with external devices such as remote terminal (personal computer) 170, for example. Display device 120 may also include an integrated in vitro glucose meter, including in vitro test strip port 124 to receive an in vitro glucose test strip for performing in vitro blood glucose measurements.

[0026] Referring still to FIG. 1, display 122 in certain embodiments is configured to display a variety of information - some or all of which may be displayed at the same or different time on display 122. Display 122 may include but is not limited to graphical display 138, numerical display 132, trend or directional arrow display 131 date display 135, time of day information display 139, battery level indicator display 133, sensor calibration status icon display 134, and wireless connectivity status icon display 137 that provides indication of wireless communication connection with other devices such as on body electronics, data processing module 160, and/or remote terminal 170. As additionally shown in FIG. 1, display 122 may further include simulated touch screen button 125, 126 for accessing menus, changing display graph output configurations or otherwise for controlling the operation of display device 120.

[0027] Further details and other display embodiments can be found in, e.g., U.S. Patent Publication Nos. 2011/0193704 and 2011/0213225, the disclosures of each of which are incorporated herein by reference for all purposes.

[0028] After the positioning of on body electronics 110 on the skin surface and analyte sensor 101 in vivo to establish fluid contact with ISF (or other appropriate body fluid), on body electronics 110 in certain embodiments is configured to wirelessly communicate analyte related data (such as, for

example, data corresponding to monitored analyte level and/or monitored temperature data, and/or stored historical analyte related data) when on body electronics 110 receives a command or request signal from display device 120. In certain embodiments, data from on body electronics 110 is retrieved using display device 120 or a reader via a wireless link that operates using a near field reflective communication technique such as used in radio frequency identification (RFID) system. Using such systems, in certain embodiments, analyte measurement from analyte sensor 101 can be obtained by positioning the display device 120 within a short range of the on body electronics 110, and optionally actuating a button such as input component 121.

[0029] In certain embodiments, the RFID communication operates at a nominal operating frequency of 13.56 MHz, with minimum antenna input voltage for normal operation at about 2.5 Volts. Data rate for transmit and receive between on body electronics 110 and display device 120 may be about 20-30 kbits/second, or about 22-28 kbits/second, or about 26.48 kbits/second (data bits) in certain embodiments. Within the scope of the present disclosure, other operating frequencies for RFID communication as well as other parameters such as data transmission rates, and/or antenna input voltages are contemplated.

[0030] In certain embodiments, on body electronics 110 may be configured to at least periodically broadcast real time data associated with monitored analyte level which is received by display device 120 when display device 120 is within communication range of the data broadcast from on body electronics 110, i.e., it does not need a command or request from a display device to send information.

[0031] In certain embodiments, the received data from the on body electronics 110 may be stored (permanently or temporarily) in one or more memory of the display device 120. Referring still to FIG. 1, also shown in analyte monitoring system 100 are data processing module 160 and remote terminal 170. Remote terminal 170 may include a personal computer, a server terminal a laptop computer or other suitable data processing devices including software for data management and analysis

and communication with the components in the analyte monitoring system 100.

[0032] Data processing module 160 may include components to communicate using one or more wireless communication protocols such as, for example, but not limited to, infrared (IR) protocol, BLUETOOTH[®] protocol, ZIGBEE[®] protocol, and 802.11 wireless LAN protocol. Additional description of communication protocols including those based on BLUETOOTH[®] protocol and/or ZIGBEE[®] protocol can be found in U.S. Patent Publication No. 2006/0193375 incorporated herein by reference for all purposes.

[0033] In a further aspect, software algorithms for execution by data processing module 160 may be provided to a communication device such as a mobile telephone including, for example, WiFi or Internet enabled smart phones or personal digital assistants (PDAs) as a downloadable application for execution by the downloading communication device. Additional details describing field upgradability of software of portable electronic devices, and data processing are provided in U.S. Patent Publication Nos. 2010/0198034, 2010/0313105, 2010/0198142, 2010/0204557 and 2011/0126188, and U.S. Provisional Application No. 61/325,155 the disclosures of each of which are incorporated by reference herein for all purposes.

[0034] FIG. 2 illustrates a block diagram of the on body electronics configured for operation with a two electrode analyte sensor in certain embodiments.

[0035] In certain embodiments, sensor 210 is inserted under the skin into the interstitial fluid of a user, and responds to changes in glucose concentration. The sensor 210 is a two terminal device including working electrode 211 and counter electrode 212 that can be electrically modeled as a current source which generates a current signal as a function of the detected or monitored glucose concentration. The sensor 210 output may be dependent on temperature. In certain embodiments, a high-value resistor is connected across the sensor terminals 211, 212 and may be part of the sensor assembly. In certain embodiments, sensor 210 is a self

generating, self powered sensor and does not require a bias potential applied from an external power source. In certain embodiments, the sensor output may vary up to about 400 millivolts over the full range of glucose and temperature monitored and/or detected. Further detail of sensor 210 is provided in U.S. Patent Publication No. 2010/0213057 and U.S. Provisional Application No. 61/325,260, the disclosures of each of which are incorporated herein by reference.

[0036] Referring to FIG. 2, in certain embodiments, sensor 210 is operatively coupled to resistors 215a, 215b as shown whose terminals respectively are coupled to capacitors 216a, 216b. In certain embodiments, resistors 215a, 215b may include 2.5 M Ω resistors, while capacitors 216a, 216b may include 100 μ Farad, 1 μ Farad capacitors, respectively. Thermistor or other resistance temperature device (RTD) 282 and reference resistor 283 are provided as shown and coupled to ASIC 220.

[0037] In certain embodiments, upon initialization of sensor 210, reference resistance R is measured once and the measured resistance is stored (for example, in a memory device provided on ASIC 220). After measuring the reference resistance R, in certain embodiments, the resistance is measured or detected based on the measurement from the thermistor or RTD 282.

[0038] Referring to FIG. 2, in certain embodiments, ASIC 220 is powered by a magnetic field generated by the display device 120 (FIG. 1). As described above, the sensor interface in certain embodiments includes a network of two resistors 215a, 215b and two capacitors 216a, 216b across sensor electrodes 211, 212. In certain embodiments, ASIC 220 is configured to sample two voltages from this sensor network for each analyte measurement acquisition. In a steady-state, both differential voltages from the sensor network will be at similar in level and range from about 0 to 200 mV. Also shown in FIG. 2 is temperature detection circuit 280 coupled to 12 bit A/D converter 222 of ASIC 220 via analog multiplexer 221. The temperature detection circuit 280 includes current source 281, an external thermistor 282 and corresponding switch 284 and

reference resistor 283 and corresponding switch 285. In certain embodiments, current source 281 includes one or more of a physical current source such as a resistor current source (e.g., a voltage source), an active current source (e.g., a transistor current source), or an inductor type current source (e.g., using a voltage regulator).

[0039] More specifically, in certain embodiments, ASIC 220 includes an internal band-gap temperature sensor 225 (e.g., having a forward voltage of a diode that is temperature dependent) with a predetermined level of or controlled slope variation (e.g., with a minimum tolerance threshold) from ASIC component to ASIC component during manufacturing, and the temperature sensor calibration may be achieved with a single point temperature calibration with, for example, a predetermined an offset error. Also shown in ASIC 220 are analog multiplexer 221 that interfaces with the sensor electrodes 211, 212, and is operatively coupled to 12-bit A/D converter 222, which in certain embodiments, may be controlled based at least in part on logic from state machine 223. In certain embodiments, ASIC 220 may include a processor, such as a reduced instruction set computing (RISC) processor or other processing unit containing programming to implement the logic of ASIC 220 in lieu of state machine 223.

[0040] In certain embodiments, to protect the integrity of the A/D conversion (such as, for example, to minimize undesirable noise affecting the A/D conversion), display device 120 (FIG. 1) may be configured to disable RF communication during the A/D conversion process. An external capacitor (not shown) of a few hundred nano Farads may be provided to store sufficient charge to power the A/D converter, based for example, upon logic implemented by state machine 223, in the absence of RF power from display device 120.

[0041] Referring still to FIG. 2, in certain embodiments, RF power is provided to the ASIC via the antenna 240 and RFID 224 and power 226 sections of the ASIC 220. When RF power is presented or within the range of antenna 240 and a predetermined RF command is received (for example, from display device 120), ASIC 220 may be configured to

perform four A/D conversions - two conversions from the sensor 210 and two for the temperature measurement - and also, to store the raw A/D values in ASIC memory to be retrieved by display device 120. This routine in certain embodiments comprises one complete analyte measurement acquisition.

[0042] FIG. 3 illustrates a block diagram of the on body electronics configured for operation with a two electrode analyte sensor with a power source in certain embodiments. Referring to FIG. 3, in the embodiment shown, battery 350 is provided with a switch 329 to allow for ASIC 320 to perform analyte level measurements with sensor 210 autonomously, and to be retrieved at a later time by display device 120 (FIG. 1). More specifically, the embodiment of ASIC 320 shown in FIG. 3 (compared to the embodiment shown in FIG. 2) includes charge pump 327 with capacitor 335 operatively coupled to the state machine 323, configured to convert the 1.5 Volts from battery 350 to about 3 Volts needed by ASIC 320 analog front-end circuitry for the measurement circuit. Also included in ASIC 320 is timer 328 which is a free-running timer clock providing a time of day information. In certain embodiments, a crystal oscillator 326 and resistor 334 may be provided.

[0043] Additionally, ASIC 320 may include extra memory for storage of measurement data, and battery isolation switch for long-term shelf life. Battery 350 may be configured to make analyte measurements without the RF power applied from display device 120 (FIG. 1). In this manner, only one differential voltage may need to be sampled between working electrode 211 and counter electrode 212 (coupled to resistor 315 (e.g., 5 MΩ) and capacitor 316 (e.g., 1 μFarad)) for each monitored analyte measurement.

[0044] In certain embodiments, analyte level trend information may be determined by display device 120 (FIG. 1) based on a pre-determined number of analyte measurements retained by ASIC 320. ASIC 320 in certain embodiments may measure each sample spaced at a pre-determined time interval and store each measurement in the ASIC memory. The oldest of the samples may be overwritten with each new

sample taken. The retained data may be available to determine analyte level trend. Additionally, ASIC 320 may be configured to capture a pre-determined number of sensor and temperature samples spaced further apart for historical data logging for a total of about 8 hours. Within the scope of the present disclosure other suitable time periods may be used for historical data logging, such as 1 hour, 3 hours, 6 hours, 12 hours, 24 hours, 3 days, 5 days, 10 days, 14 days or more.

[0045] In certain embodiments, to provide sufficient time accuracy over an 8 hour period, for example (or other time periods), the internal clock of ASIC 320 may be configured to be as accurate to at least $\pm 3\%$. The accuracy may be improved or assisted by an external precision resistor.

[0046] Referring again to FIG. 3, battery isolation switch 329 may be configured to preserve the battery life during long-term inventory storage or increase the shelf life of battery 350. ASIC 320 in certain embodiments may be configured to activate battery isolation switch 329 upon receipt of a qualified or predetermined RF message or command from display device 120. Thus, the RFID portion 324 of the ASIC 320 may be configured to operate under RF power. Additional description of RF command or close proximity communication is provided in U.S. Patent No. 7,826,382, the disclosure of which is incorporated herein by reference.

[0047] Further, as discussed above, internal band-gap temperature sensor 325 in certain embodiments includes a predetermined level of controlled slope variation (e.g., with a minimum tolerance threshold) from ASIC component to ASIC component during manufacturing, and the temperature sensor calibration may be achieved with a single point temperature calibration with, for example, a predetermined offset error. Provided below is a table illustrating exemplary, non limiting parameters and associated values for the embodiment shown in FIG. 3. While specific ranges and/or values are shown below, within the scope of the present disclosure, other ranges and/or values are contemplated.

Item	Parameter	Value
1	Charge pump input voltage range	1.2V to 1.8V
2	External capacitance for charge pump	2 uF max.

3	Battery switch off-mode leakage	20 nA max.
4	Clock timer frequency accuracy (with external precision reference resistor)	+/- 5%, from 5°C – 60°C
5	Internal memory	800 bytes, volatile or non-volatile

[0048] FIG. 4 illustrates a block diagram of the on body electronics configured for operation with a two electrode sensor or a three electrode analyte sensor in certain embodiments. Referring to FIG. 4, in certain embodiments, ASIC 420 may be configured for use with either a two electrode analyte sensor 410 or a three electrode analyte sensor. In certain embodiments, the two electrode sensor may include a working electrode (WRK) 411 and a reference electrode (REF) 412, while the three electrode sensor additionally includes a counter electrode (CNTR) 413. Referring still to FIG. 4, the sensor, whether a two electrode or a three electrode sensor, is coupled to ASIC 420 for operation.

[0049] In certain embodiments, the analog front end (AFE) of ASIC 420 includes two amplifiers, U1 430 and U2 431. As can be seen in FIG. 4, when a two electrode sensor is connected to the ASIC AFE, the inverting input terminal of amplifier U1 430 is coupled to the working electrode 411 of the sensor, the non-inverting input terminal of amplifier U1 430 is connected to a reference voltage source, and the output terminal of amplifier U1 430 is connected to the reference electrode 412, as illustrated by dotted line 402 of FIG. 4. In certain embodiments, a feedback resistor 415, which is a high resistance resistor (e.g., 5 MΩ resistor) and capacitor 416, are provided between the working and reference electrodes 411, 412 respectively. In certain embodiments where the sensor is a two electrode sensor, the connection between amplifier U2 431 and sensor 410 is open, such that amplifier U2 431 and the circuits shown with dotted line 403 are not connected to the sensor.

[0050] In certain embodiments where a three electrode sensor is connected to the ASIC AFE, the inverting input terminal of amplifier U1 430 is connected to the working electrode 411 of the sensor, just as in the two electrode sensor embodiments, however, the reference electrode 412 is coupled to the inverting input terminal of amplifier U2 431 instead of the

output terminal of amplifier U1 430. Further, the counter electrode 413 may be coupled to the output terminal of amplifier U2 431. In the three electrode sensor embodiments, the connection between reference electrode 412 and amplifier U2 431 (dotted line 403) is closed thereby coupling amplifier U2 431 to sensor 410, while the connection between the output of amplifier U1 430 and the reference electrode 412 (dotted line 402) is open, such that the output of amplifier U1 430 is not connected to reference electrode 412 of the sensor.

[0051] Similar to the ASIC configuration of FIG. 3, in certain embodiments, ASIC 420 shown in FIG. 4 includes battery 450 provided with switch 429 such that ASIC 420 is configured to process and/or store analyte level measurements from sensor 410 autonomously. ASIC 420 as shown in FIG. 4 also includes charge pump 427 with capacitor 435 operatively coupled to state machine 423. Charge pump 427, in certain embodiments, is configured to convert the 1.5 Volt signal from battery 450 to about 3 Volts for ASIC 420 to operate to acquire, filter, store or otherwise process signals received from the analyte sensor 410. In certain embodiments, ASIC 420 also includes timer 428 which is a free-running timer clock providing a time of day information, crystal oscillator 426 and resistor 434 operatively coupled to crystal oscillator 426.

[0052] Referring back to FIGS. 3 and 4, also provided is temperature detection circuit 280 as shown and described in conjunction with FIG. 2 above, and which is coupled to the respective A/D converter 322 of ASIC 320 (FIG. 3), and to A/D converter 422 of ASIC 420 (FIG. 4) via the respective analog multiplexer 321, 421.

[0053] In certain embodiments, signals corresponding to monitored analyte levels from the sensor, whether a two electrode sensor or a three electrode sensor, are processed by ASIC 420. Referring to FIG. 4, in certain embodiments, ASIC 420 includes an A/D converter 422 which may be 15 bit A/D converter. In certain embodiments, the A/D conversion may include a sigma-delta modulator. Sigma-delta modulation may provide other functions in addition to simple A/D conversion, including, but not limited to, adjustable conversion resolution, which may be proportional

with the converter modulator clock frequency or acquisition period of the conversion, and signal filtering. Further, a sigma-delta modulator may be configured for low power consumption as a sigma-delta modulator may be configured for use with a low clock rate, utilizing less power. In certain embodiments, utilizing a longer duration acquisition period for the sigma-delta conversion may provide signal filtering of the data signals. Variation in the acquisition period duration may affect the level of signal filtering provided by the sigma-delta modulation.

[0054] In the manner described above, the ASIC power source may include a low-power disposable power source, e.g., a battery that may be used for the voltage source for the reference voltage signals for the amplifiers of ASIC 420 and to power the clock and sigma-delta modulator without draining the power source rapidly. In this manner, increased battery life may result and in turn, increased electronics use life can be attained. Further examples and details related to sigma-delta modulation and analog-to-digital conversion can be found in, among others, U.S. Patent Publication No. 2011/0060530, the disclosure of which is incorporated herein by reference for all purposes.

[0055] In certain embodiments, the configuration of ASIC 420 may be based on a 0 Volts to 2 Volts input voltage range of the A/D converter 422. In such embodiments, with an analyte sensor that requires a compliance range of about 2 Volts, a 2 Volt voltage source may be provided to the inverting terminal of amplifier U1 430, such that the terminal is biased at a fixed 2 Volts. This configuration may be applicable to both the two electrode and the three electrode analyte sensors. In the embodiments where the sensor is a three electrode analyte sensor, the input voltage to the positive terminal of amplifier U2 431 may be 1.96V. While specific values are provided for voltages, within the scope of the present disclosure, other voltages and ranges of voltages are contemplated.

[0056] For an analyte sensor current range of 0nA to 85nA and a feedback resistance of 5M Ω , the output voltage of amplifier U1 430 may change by 0.425V (5,000,000 Ω * 85nA), which in turn results in a A/D converter input voltage in the range of 2V - 1.575V. In certain embodiments, ASIC clock,

which may be provided by timer 428, includes a 32.786KHz clock and the analyte measurement may be performed over a 30 second time window data acquisition period. In such embodiments, the resulting resolution of the A/D converter is approximately 30,720 counts full scale (approximately 15 bits), and the digital conversion of about 0 Volt to about 2 Volt input voltage range would be from 0 to 30,720 counts.

[0057] Referring still to FIG 4, in certain embodiments, the transimpedance amplifier U1 430 may be used to convert sensor current into an output voltage. The range of sensor current that is accommodated include about 0nA to about 85nA. Moreover, in certain embodiments, A/D conversion range may include $(0.425\text{V}/2\text{V}) \times 30,720 = 6,528$ Counts. This provides a resolution of 13pA. In certain embodiments, a low threshold for sensor sensitivity may be about 11.1 pA/mg/dL resulting in a resolution of about 1.1 mg/dL, for example.

[0058] The table below illustrates exemplary, non-limiting parameters and values for the embodiment shown in FIG. 4. As such, within the scope of the present disclosure, other ranges and/or values are contemplated:

Item	Parameter	Value
1	WRK electrode voltage	2V +/- 250 mV
2	Poise voltage = WRK – REF	40mV +/- 25 mV (part to part variation.)
3	Poise voltage stability (20°C to 50°C)	+/- 25 mV. This means worse case stack up of part to part variation + temperature is 40mV +/- 50 mV.
4	Servo Amplifier output voltage	0.2 to WRK Potential (Volts)
5	Servo Amplifier input leakage current	< +/- 10pA (Biased at 1.96V at about 25 °C)
6	Servo Amplifier input offset Voltage	+/- 10 mV
7	Servo Amplifier input offset drift	+/- 75 uV / °C
8	WRK Amplifier output voltage	1.25 V to WRK Potential + 75 mV.
9	WRK Amplifier input leakage current	< +/- 20pA (Biased at about 2 Volts)
10	WRK Amplifier input offset Voltage	+/- 10mV
11	WRK Amplifier input offset drift	+/- 75uV/°C

[0059] In certain embodiments, one measurement cycle may include first 30 seconds including glucose data, second 15 seconds temperature thermistor or RTD data, thirds 15 seconds of internal temperature measurement to result in a total of 60 seconds per measurement cycle.

[0060] Table below provides exemplary, non limiting parameters and values for the analyte sensor analog front end electronics in certain embodiments. While specific values and/or ranges of values are shown below, within the scope of the present disclosure other suitable values or ranges of values are contemplated:

Item	Parameter	Value
1	Sensor Measurement Resolution. The resolution covers the sensor sensitivity range, accomplishing 2 bits of this resolution with variable gain in front of the converter.	12 bits or better for an input operating range of 425mV.
2	Maximum input leakage current for both the condition where the ASIC is powered and also when it is not powered. (Assumes limited temperature range from (Specified 25°C to 40 °C) and limited voltage input up to 100mV)	<+/- 10pA (measured at 100mV input at about 25 °C)
3	Total Measurement Error – Linearity post calibration error. (Assumes that offset is calibrated to +/- 1 A/D Count and slope is calibrated to +/- 0.5% at full scale.)	<+/- 1.5 %
4	AFE measurement. Thermal drift – change in offset post calibration. (Specified 25 °C to 40 °C)	+/- 5 A/D Count.
5	AFE measurement. Thermal drift – slope (Specified 25 °C to 40 °C)	+/- 1.5%
6	Electrostatic discharge (ESD) Protection	Achieve +/- 2KV human body model (HBM) for each pin on the ASIC. For low leakage inputs, use +/-500V human body model (HBM).
7	RF interference	Measurement accuracy is maintained when the display device is used to acquire sensor data. Display device may terminate RF transmission

		temporarily for RF quieting during measurement. For the architectures with a battery, data may be marked “bad” if measurement occurs during RF communication.
--	--	--

[0061] FIGS. 5 and 6 are graphical illustrations of thermistor characteristics for use in the analyte monitoring system of FIG. 1 in certain embodiments.

[0062] In certain embodiments, the ASIC may also be configured to accommodate two types of temperature sensors in addition to the two or three electrode analyte sensors. In certain embodiments, the temperature sensor is a resistive device, such as a thermistor or a resistive thermal device (RTD), in addition to a reference resistor. The resistive temperature sensor and the reference resistor are both ground referenced with a current source provided by the ASIC, in certain embodiments. In certain embodiments, the current source current is determined based on the desired input voltage range of the A/D converter. This current may be in the 1 μ A or 1mA range, for example. The input voltage range, and thus the current, may be based on the desired resolution of the output of the A/D converter. For example, utilizing a 32.768KHz ASIC clock and a 15 second temperature detection acquisition window, operating at a 0 Volt to 0.5 Volt input range, the resulting resolution of the temperature sensor would be 0 – 3,840 counts, or 0.13mV/count.

[0063] In certain embodiments, the sensor has about + 7% /°C dependency. Skin temperature may be measured using a thermistor 282. This method in certain embodiments, includes reference resistor 283 and the measurement thermistor 282 multiplexed into a 12 bit (or other suitable resolution) A/D converter. Excitation of the thermistor 282 and reference resistor 283 may utilize a common 1 μ A current source 281.

[0064] In certain embodiments, an internal (e.g., internal to ASIC) temperature sensor 225 (FIG. 2), 325 (FIG. 3), 425 (FIG. 4) in addition to the external thermistor interface 280 may be provided. The internal temperature sensor 225, 325, 425 may be used for thermal gradient correction. As discussed above, internal ASIC temperature sensor may be

calibrated using a single point temperature calibration. To this end, in certain embodiments, the part-to-part consistency of the slope of the temperature sensor in the ASIC component is maintained within a predetermined threshold range or above a preset level, and further, errors observed during temperature calibration may be attributed to offset errors.

[0065] In certain embodiments, the temperature sensor is a resistive device that can be either a thermistor or an RTD in addition to a reference resistor. The reference resistor and resistive temperature sensor are ground referenced and will have a current source excitation provided by the ASIC.

[0066] In certain embodiments, current source may be either in the 1uA or 1mA range depending on the device selected, and may be designed so that the desired input voltage range to the A/D is met. The input voltage range to the A/D converter in certain embodiments is sized to ensure that the desired resolution is achieved.

[0067] In certain embodiments, temperature and reference resistor measurement may be achieved over a 15 second acquisition period and the modulator clock may be $32,768 \text{ Hz}/8 = 32 = 1,024 \text{ Hz}$ and is derived from the ASIC 32.768KHz clock. The resulting resolution over the operating input range 0V – 0.5V may be $1,024 * 15 * 0.5/2 = 3840$ counts or 0.13mV/count. For a change from 40°C to 41°C, the thermistor resistance changes by 49,304 Ω to 47,124 Ω . For an input range that accommodates down to 20°C = 0.5V the excitation current is given by: Excitation current = $0.5\text{V}/128192 = 3.9\mu\text{A}$.

[0068] For this level of excitation, the change in A/D input at the worse case portion of the thermistor range (40 °C) is $49,304 * 3.9\mu\text{A} - 47,124 * 3.9\mu\text{A} = 8.5\text{mV}$. In certain embodiments, the effective thermistor temperature resolution includes $0.13/8.5 = 0.01^\circ\text{C}$.

[0069] In certain embodiments, the AFE for the temperature measurement interface may include the following characteristics and/or parameters. While specific values and/or ranges or values are provided below, within the scope of the present disclosure other suitable values and/or ranges of values are contemplated.

Item	Parameter	Value
1	Resistive temperature sensor measurement resolution.	12 bits over the input operating range.
2	Current source excitation. compatible with A/D input requirement.	+/- 12%
3	Channels	1 100K Ω at 25 °C Thermistor or 400 Ω RTD, and 1 Reference resistor for a total of 2 inputs. Individually multiplexed to the same A/D converter and the same current source.
4	Resistive temperature measurement. Thermal drift – offset. (specified 25 °C to 40 °C)	+/- 10 A/D Count.
5	Resistive temperature measurement. Thermal drift – slope (specified 30 °C +/- 20 °C)	+/- 0.5%
6	Internal band-gap temperature measurement resolution:	Less than or equal to about 0.3 °C
7	Internal band-gap temperature measurement offset error:	Less than or equal to about 10 °C
8	Internal band-gap temperature measurement slope variation part to part:	Less than or equal to about +/- 1.5%
6	ESD Protection	It is desirable to achieve +/-2KV HBM for each pin on the ASIC.
7	RF interference	The specifications for measurement accuracy must be met when the reader is being used to acquire data, or data must be marked “bad”.

[0070] In certain embodiments, ASIC architecture is configured to withstand a 10MeV e-beam with a dosage of about 25 kGy to about 60 kGy, such as, about 35 kGy, about 40 kGy, about 45 kGy, about 50 kGy, about 55 kGy, for example, for the on body electronics sterilization process to attain a desired predetermined sterility assurance level (SAL) (e.g., approximately 10^{-6} SAL). In certain embodiments, one or more predetermined annealing profiles may be provided for radiation recovery. Additional description related to sterilization can be found in U.S. Patent Publication No. 2009/0257911, the disclosure of which is incorporated by reference.

- [0071]** Certain embodiments may include an analyte sensor including a plurality of electrodes, including an in vivo portion of the analyte sensor configured for fluid contact with a bodily fluid under a skin layer, the analyte sensor configured to monitor an analyte level in the bodily fluid and to generate one or more signals associated with the monitored analyte level, and sensor electronics including a sensor interface section and a data processing section, the sensor interface section configured to electrically couple to the plurality of electrodes of the analyte sensor, and the data processing section configured to process one or more signals received from the analyte sensor, wherein the sensor interface section includes an electrical interface to couple to two electrodes of the plurality of electrodes, or three electrodes of the plurality of electrodes, and further wherein the data processing section includes an application specific integrated circuit with programmable logic to perform one or more operations of the data processing section including processing the one or more signals from the analyte sensor for filtering, calibration, storage, transmission, or one or more combinations thereof.
- [0072]** In certain embodiments, the application specific integrated circuit may include a state machine, and wherein the state machine is configured to implement the programmable logic.
- [0073]** In certain embodiments, the application specific integrated circuit may include a reduced instruction set computing (RISC) processor, wherein the RISC processor includes programming configured to implement the programmable logic.
- [0074]** In certain embodiments, the generated one or more signals from the sensor may include voltage signals.
- [0075]** In certain embodiments, the generated one or more signals from the sensor may include current signals.
- [0076]** In certain embodiments, two electrodes of the plurality of electrodes may include an anode and a cathode, wherein the anode comprises carbon or gold and sensing chemistry, and further, wherein the cathode includes platinum or platinized carbon.

- [0077]** In certain embodiments, the three electrodes of the plurality of electrodes may include a working electrode, a counter electrode and a reference electrode, wherein the working electrode comprises one or more of carbon, gold silver, or platinum.
- [0078]** Certain embodiments may further include an antenna operatively coupled to the sensor electronics and configured to communicate data associated with the monitored analyte level.
- [0079]** In certain embodiments, the antenna may include a radio frequency antenna.
- [0080]** In certain embodiments, the application specific integrated circuit may include radio frequency identification (RFID) communication component operatively coupled to the antenna.
- [0081]** In certain embodiments, the RFID communication component may be configured to transmit data corresponding to the monitored analyte level to a remote location.
- [0082]** In certain embodiments, the RFID communication component may be configured to transmit the data in response to a request received from the remote location.
- [0083]** Certain embodiments may include providing an analyte sensor including a plurality of electrodes, including an in vivo portion of the analyte sensor for fluid contact with a bodily fluid under a skin layer, the analyte sensor for monitoring an analyte level in the bodily fluid and for generating one or more signals associated with the monitored analyte level, and providing sensor electronics including a sensor interface section and a data processing section, wherein providing sensor electronics includes configuring the sensor interface section to electrically couple to the plurality of electrodes of the analyte sensor, and configuring the data processing section to process one or more signals received from the analyte sensor, wherein configuring the sensor interface section includes providing an electrical interface to couple to two electrodes of the plurality of electrodes, or three electrodes of the plurality of electrodes, and further wherein configuring the data processing section includes providing an application specific integrated circuit with programmable logic to perform

one or more operations of the data processing section including processing the one or more signals from the analyte sensor for filtering, calibration, storage, transmission, or one or more combinations thereof.

[0084] In certain embodiments, providing the application specific integrated circuit may include providing a state machine to implement the programmable logic to process the one or more signals.

[0085] In certain embodiments, providing the application specific integrated circuit may include providing a reduced instruction set computing (RISC) processor configured to implement the programmable logic to process the one or more signals.

[0086] In certain embodiments, the one or more signals generated by the analyte sensor may include voltage signals.

[0087] In certain embodiments, the one or more signals generated by the analyte sensor may include current signals.

[0088] Certain embodiments may further include operatively coupling an antenna to the sensor electronics.

[0089] Certain embodiments may further include transmitting data corresponding to the monitored analyte level to a remote location via a radio frequency identification (RFID) communication component of the application specific integrated circuit operatively coupled to the antenna.

[0090] In certain embodiments, transmitting data corresponding to the monitored analyte level may include transmitting the data in response to a request received from the remote location.

[0091] Various other modifications and alterations in the structure and method of operation of the embodiments of the present disclosure will be apparent to those skilled in the art without departing from the scope and spirit of the present disclosure. Although the present disclosure has been described in connection with certain embodiments, it should be understood that the present disclosure as claimed should not be unduly limited to such embodiments. It is intended that the following claims define the scope of the present disclosure and that structures and methods within the scope of these claims and their equivalents be covered thereby.

WHAT IS CLAIMED IS:

1. An analyte monitoring device, comprising:
an analyte sensor including a plurality of electrodes, including an in vivo portion of the analyte sensor configured for fluid contact with a bodily fluid under a skin layer, the analyte sensor configured to monitor an analyte level in the bodily fluid and to generate one or more signals associated with the monitored analyte level; and
sensor electronics including a sensor interface section and a data processing section, the sensor interface section configured to electrically couple to the plurality of electrodes of the analyte sensor, and the data processing section configured to process one or more signals received from the analyte sensor;
wherein the sensor interface section includes an electrical interface to couple to two electrodes of the plurality of electrodes, or three electrodes of the plurality of electrodes, and further
wherein the data processing section includes an application specific integrated circuit with programmable logic to perform one or more operations of the data processing section including processing the one or more signals from the analyte sensor for filtering, calibration, storage, transmission, or one or more combinations thereof.
2. The device of claim 1 wherein the application specific integrated circuit includes a state machine, and wherein the state machine is configured to implement the programmable logic.
3. The device of claim 1 wherein the application specific integrated circuit includes a reduced instruction set computing (RISC) processor, wherein the RISC processor includes programming configured to implement the programmable logic.
4. The device of claim 1 wherein the generated one or more signals from the sensor include voltage signals.

5. The device of claim 1 wherein the generated one or more signals from the sensor include current signals.
6. The device of claim 1 wherein two electrodes of the plurality of electrodes includes an anode and a cathode, wherein the anode comprises carbon or gold and sensing chemistry, and further, wherein the cathode includes platinum or platinized carbon.
7. The device of claim 1 wherein the three electrodes of the plurality of electrodes includes a working electrode, a counter electrode and a reference electrode, wherein the working electrode comprises one or more of carbon, gold silver, or platinum.
8. The device of claim 1 further including an antenna operatively coupled to the sensor electronics and configured to communicate data associated with the monitored analyte level.
9. The device of claim 8 wherein the antenna includes a radio frequency antenna.
10. The device of claim 8 wherein the application specific integrated circuit includes a radio frequency identification (RFID) communication component operatively coupled to the antenna.
11. The device of claim 10 wherein the RFID communication component is configured to transmit data corresponding to the monitored analyte level to a remote location.
12. The device of claim 11 wherein the RFID communication component is configured to transmit the data in response to a request received from the remote location.
13. A method, comprising:

providing an analyte sensor including a plurality of electrodes, including an in vivo portion of the analyte sensor for fluid contact with a bodily fluid under a skin layer, the analyte sensor for monitoring an analyte level in the bodily fluid and for generating one or more signals associated with the monitored analyte level; and

providing sensor electronics including a sensor interface section and a data processing section, wherein providing sensor electronics includes configuring the sensor interface section to electrically couple to the plurality of electrodes of the analyte sensor, and configuring the data processing section to process one or more signals received from the analyte sensor;

wherein configuring the sensor interface section includes providing an electrical interface to couple to two electrodes of the plurality of electrodes, or three electrodes of the plurality of electrodes; and further

wherein configuring the data processing section includes providing an application specific integrated circuit with programmable logic to perform one or more operations of the data processing section including processing the one or more signals from the analyte sensor for filtering, calibration, storage, transmission, or one or more combinations thereof.

14. The method of claim 13 wherein providing the application specific integrated circuit includes providing a state machine to implement the programmable logic to process the one or more signals.

15. The method of claim 13 wherein providing the application specific integrated circuit includes providing a reduced instruction set computing (RISC) processor configured to implement the programmable logic to process the one or more signals.

16. The method of claim 13 wherein the one or more signals generated by the analyte sensor includes voltage signals.

17. The method of claim 13 wherein the one or more signals generated by the analyte sensor includes current signals.
18. The method of claim 13 further comprising operatively coupling an antenna to the sensor electronics.
19. The method of claim 18 further comprising transmitting data corresponding to the monitored analyte level to a remote location via a radio frequency identification (RFID) communication component of the application specific integrated circuit operatively coupled to the antenna.
20. The method of claim 19 wherein transmitting data corresponding to the monitored analyte level includes transmitting the data in response to a request received from the remote location.

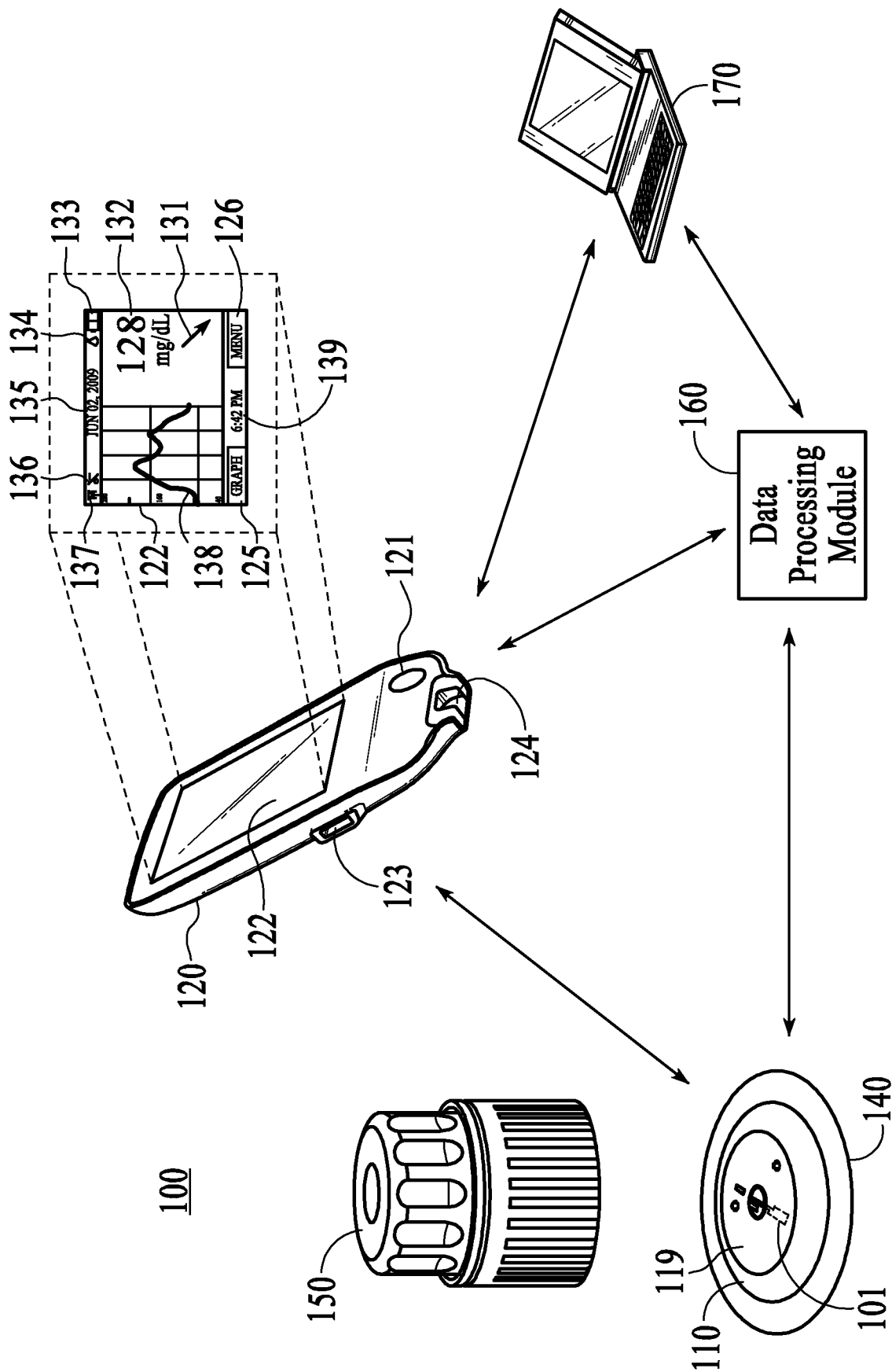

FIG. 1

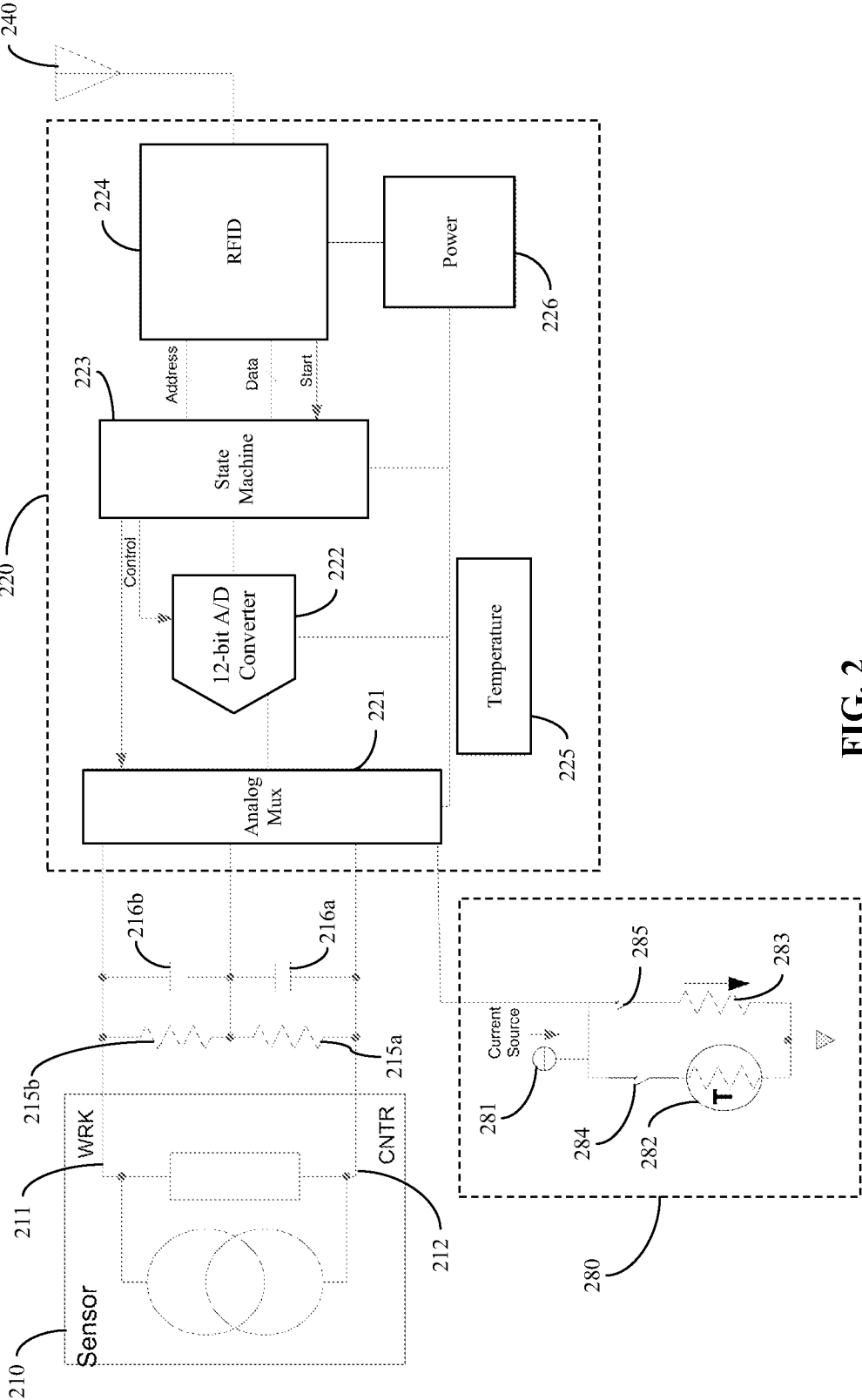

FIG. 2

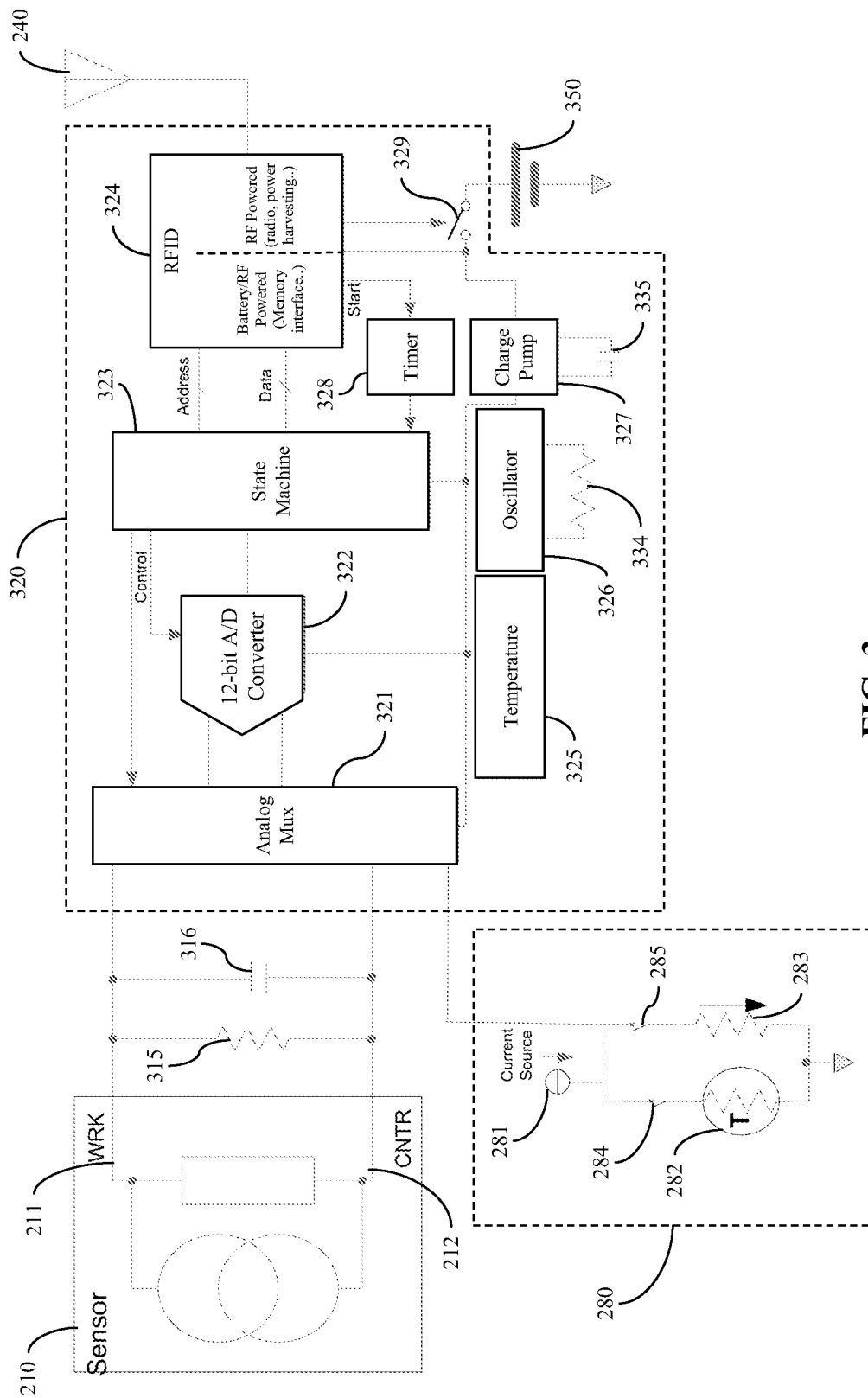

FIG. 3

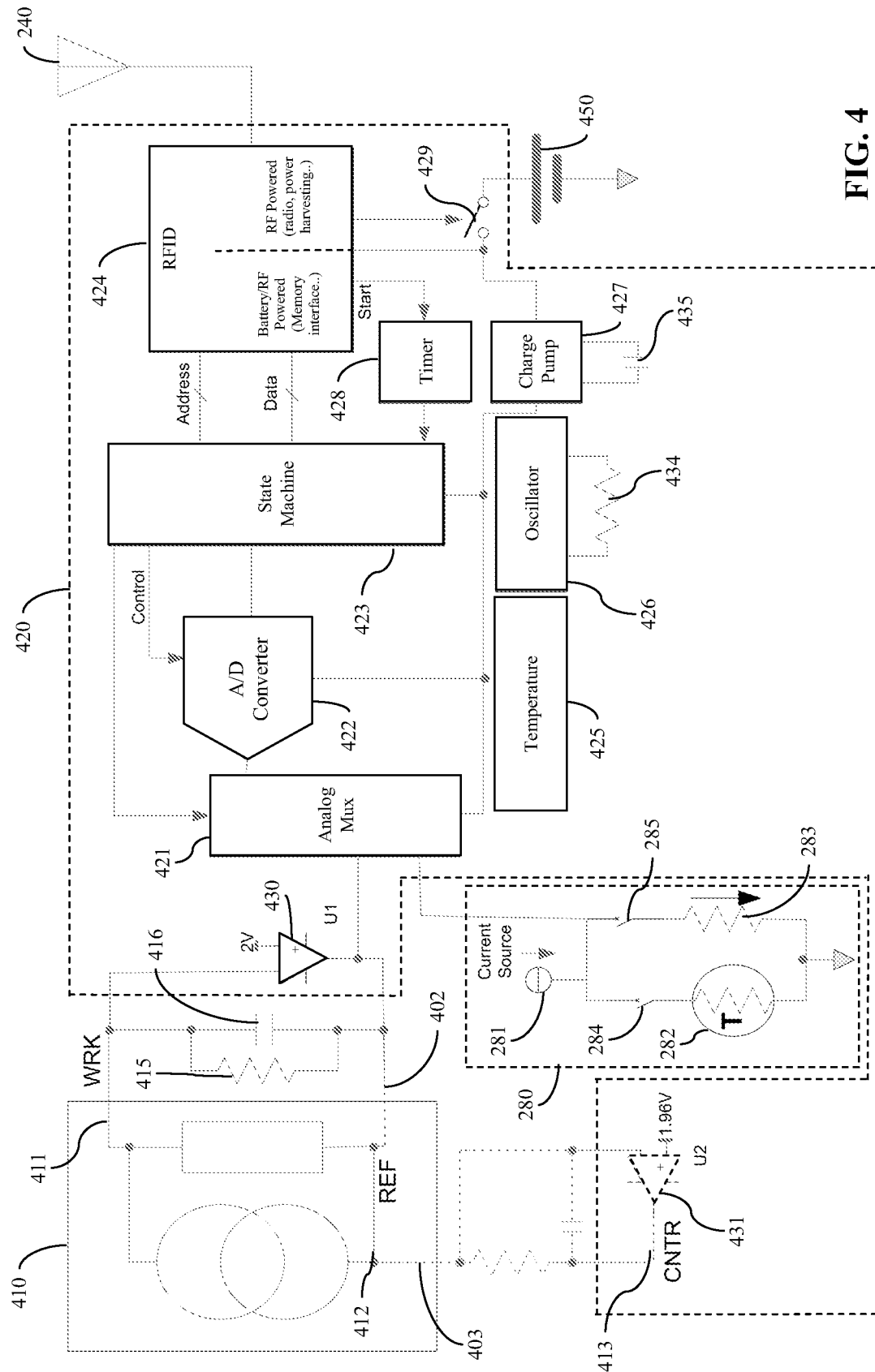

FIG. 4

