



US011230883B2

(12) **United States Patent**  
**Sonzini et al.**

(10) **Patent No.:** **US 11,230,883 B2**  
(45) **Date of Patent:** **Jan. 25, 2022**

(54) **TUBULAR ELECTROMECHANICAL ACTUATOR, HOME AUTOMATION EQUIPMENT COMPRISING SUCH AN ACTUATOR AND METHOD FOR CONNECTING SUCH AN ACTUATOR**

(58) **Field of Classification Search**  
CPC ... E06B 9/40; E06B 9/68; E06B 9/171; E06B 9/72; E06B 9/725; E06B 9/50;  
(Continued)

(71) Applicant: **SOMFY ACTIVITES SA**, Cluses (FR)

(56) **References Cited**

(72) Inventors: **Marc Sonzini**, Allinges (FR); **Florian Doche**, Annecy (FR)

U.S. PATENT DOCUMENTS

(73) Assignee: **SOMFY ACTIVITES SA**, Cluses (FR)

4,146,288 A \* 3/1979 Ramsay ..... H01R 13/625  
285/2  
4,247,216 A \* 1/1981 Pansini ..... B25G 3/18  
15/1.7

(\* ) Notice: Subject to any disclaimer, the term of this patent is extended or adjusted under 35 U.S.C. 154(b) by 0 days.

(Continued)

FOREIGN PATENT DOCUMENTS

(21) Appl. No.: **16/754,404**

CN 101881130 A 11/2010  
CN 104935105 A 9/2015

(Continued)

(22) PCT Filed: **Oct. 9, 2018**

OTHER PUBLICATIONS

(86) PCT No.: **PCT/EP2018/077468**

French Search Report, dated May 31, 2018, from corresponding/  
related French Application No. 1759470.

§ 371 (c)(1),

(2) Date: **Apr. 8, 2020**

(Continued)

(87) PCT Pub. No.: **WO2019/072842**

*Primary Examiner* — Daniel P Cahn

PCT Pub. Date: **Apr. 18, 2019**

(74) *Attorney, Agent, or Firm* — Nixon & Vanderhye

(65) **Prior Publication Data**

US 2020/0308909 A1 Oct. 1, 2020

(57) **ABSTRACT**

(30) **Foreign Application Priority Data**

Oct. 10, 2017 (FR) ..... 1759470

A tubular electromechanical actuator includes an electric motor, a housing, a closure element and a crown. The housing includes a first end and a second end. The closure element is configured to close off the second end of the housing and includes indentations configured to engage with recesses in the housing. The crown is arranged at least around the housing and at the second end of the housing. The crown is a monobloc part and includes clearances and a stop. The clearances of the crown are configured to engage with the indentations of the closure element. The stop is configured to engage with the indentations of the closure element, following the assembly of the crown with the closure element and a rotational movement of the crown relative to

(Continued)

(51) **Int. Cl.**

**E06B 9/72** (2006.01)

**E06B 9/171** (2006.01)

**E06B 9/44** (2006.01)

(52) **U.S. Cl.**

CPC ..... **E06B 9/72** (2013.01); **E06B 9/171** (2013.01); **E06B 9/44** (2013.01)

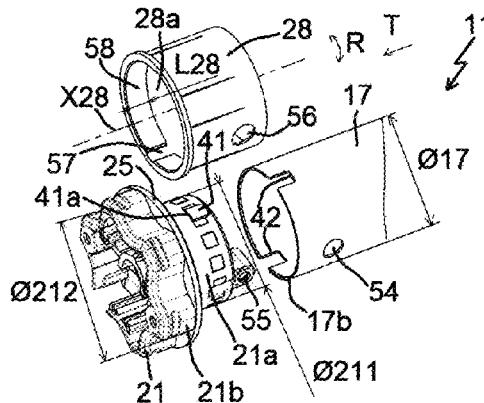
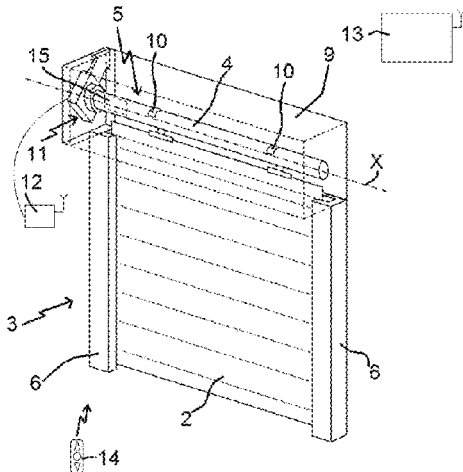

the closure element, so as to block the translation of the crown with respect to the closure element.

**11 Claims, 7 Drawing Sheets**

(58) **Field of Classification Search**

CPC ..... E06B 2009/6845; E06B 2009/725; E06B 2009/6872; E06B 9/80; E06B 2009/905; H02K 11/33; H02K 7/116; H02K 2207/03; B21F 11/005; B21F 3/02; B21F 35/00; F16F 1/04; G01B 11/08; G01B 11/24

See application file for complete search history.

(56) **References Cited**

U.S. PATENT DOCUMENTS

4,399,857 A \* 8/1983 Honma ..... E06B 9/50  
160/323.1  
6,162,082 A \* 12/2000 Karsten ..... H01R 13/523  
439/318  
6,226,068 B1 \* 5/2001 Arcykiewicz ..... H01R 13/625  
439/314  
6,666,701 B1 \* 12/2003 Burkhardt ..... H01R 13/625  
439/314  
2010/0282890 A1 \* 11/2010 Ducornetz ..... E06B 9/174  
242/404

2011/0203754 A1 \* 8/2011 Mullet ..... E06B 9/72  
160/405  
2013/0102178 A1 \* 4/2013 Van Swearingen .. H01R 13/641  
439/314  
2013/0260580 A1 \* 10/2013 Hour Alami ..... H01R 13/24  
439/135  
2015/0034259 A1 \* 2/2015 Bohlen ..... E06B 9/62  
160/310  
2015/0034260 A1 2/2015 Blair et al.  
2017/0006740 A1 1/2017 Holt et al.  
2018/0171710 A1 \* 6/2018 Kirby ..... F16D 1/087  
2018/0202226 A1 \* 7/2018 Georgeault ..... E06B 9/32  
2018/0259033 A1 \* 9/2018 Basutto ..... E06B 9/582

FOREIGN PATENT DOCUMENTS

CN 106593279 A 4/2017  
DE 2015-166133 \* 10/2014  
EP 3 219 899 A1 9/2017  
FR 2916011 \* 5/2007  
FR 2 983 368 A1 5/2013  
JP 2000 160969 A 6/2000

OTHER PUBLICATIONS

International Search Report and Written Opinion, dated Jan. 22, 2019, from corresponding/related International Application No. PCT/EP2018/077468.

\* cited by examiner

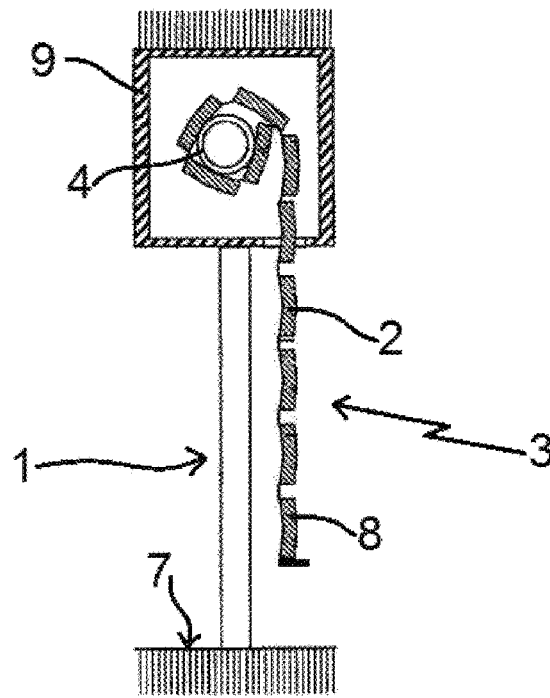

FIG. 1

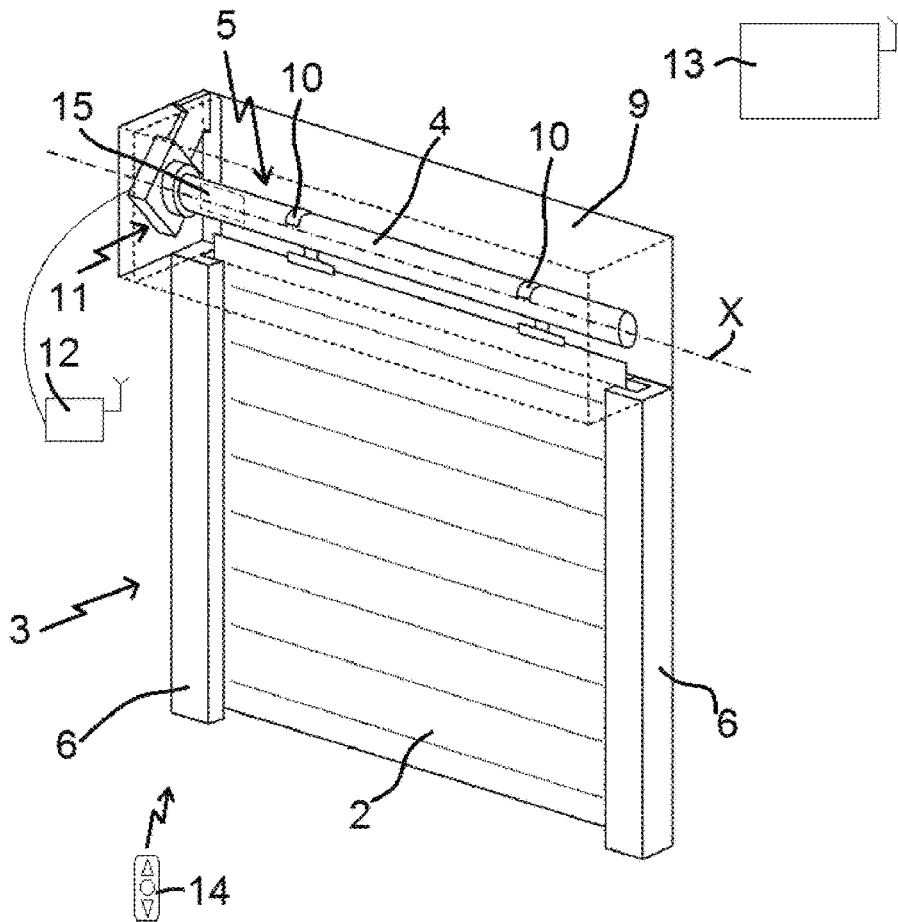

FIG. 2



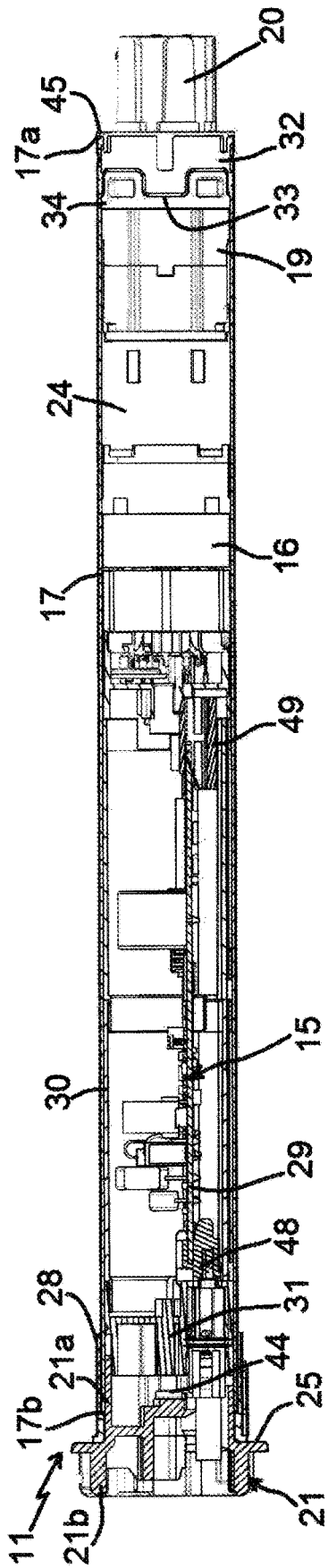

FIG. 4

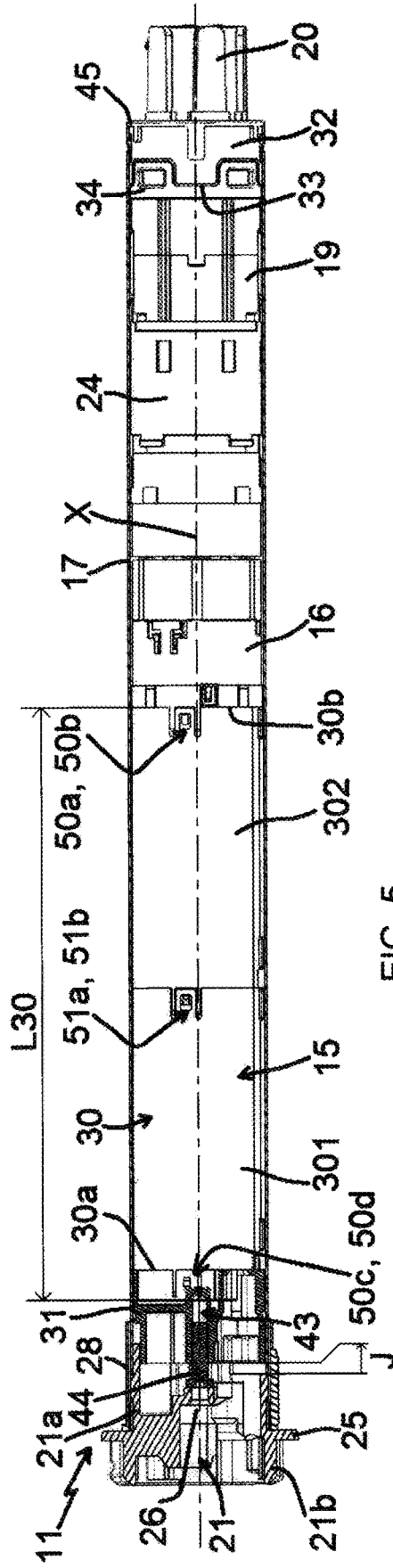

FIG. 5

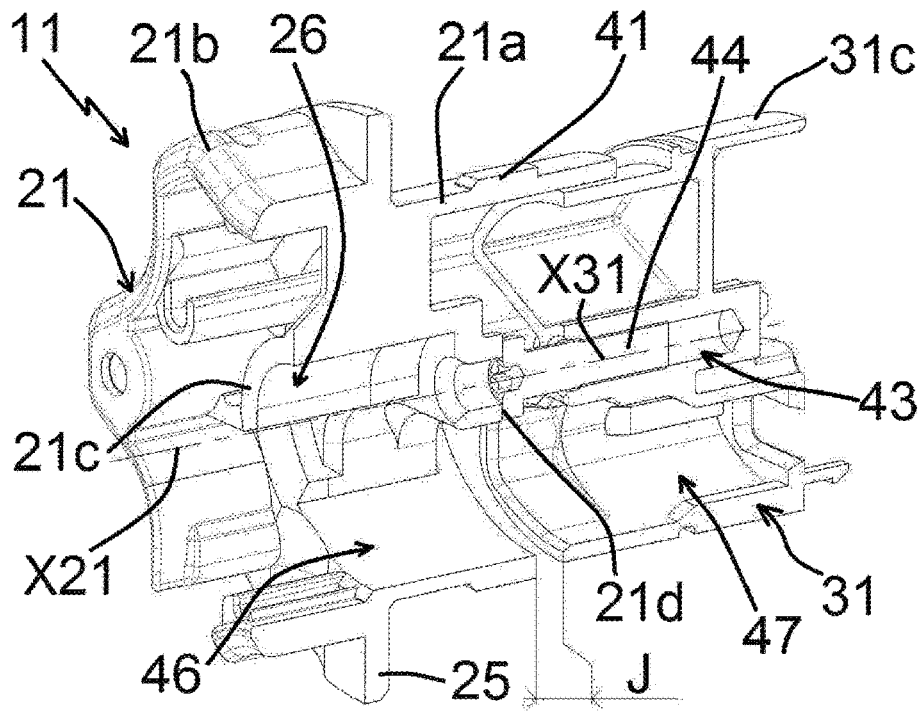

FIG. 6

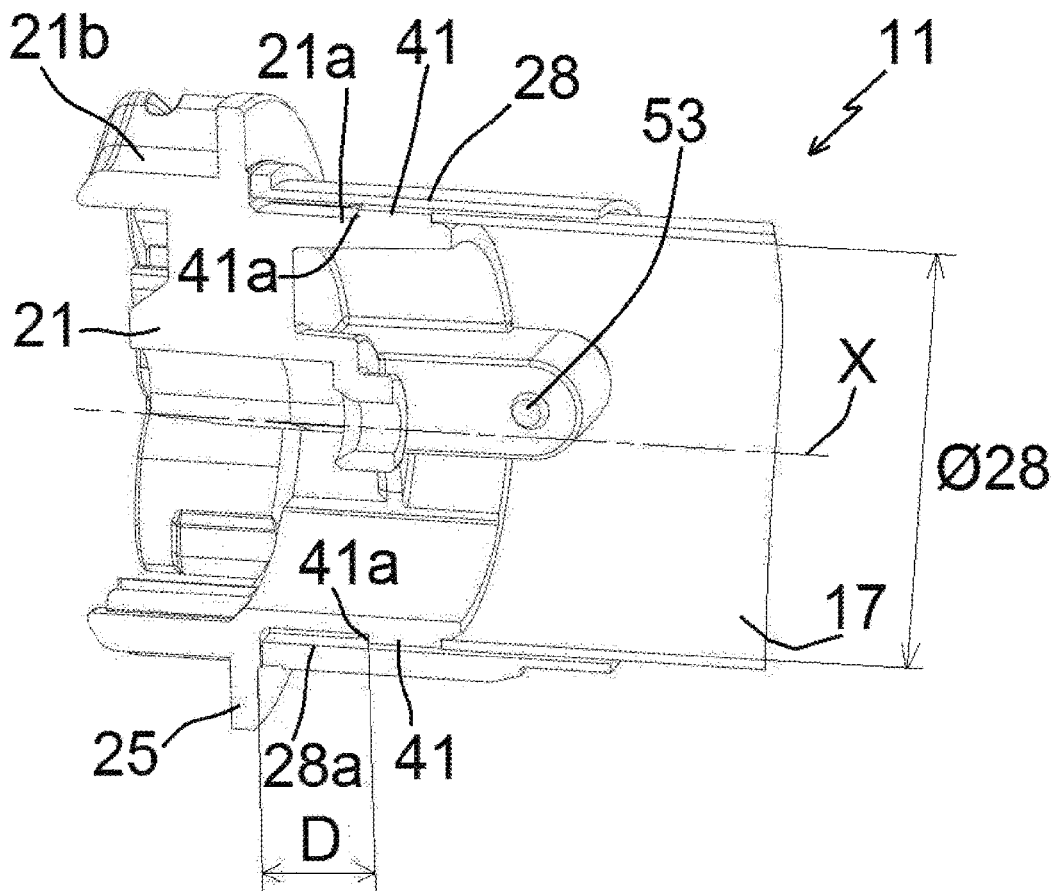

FIG. 7

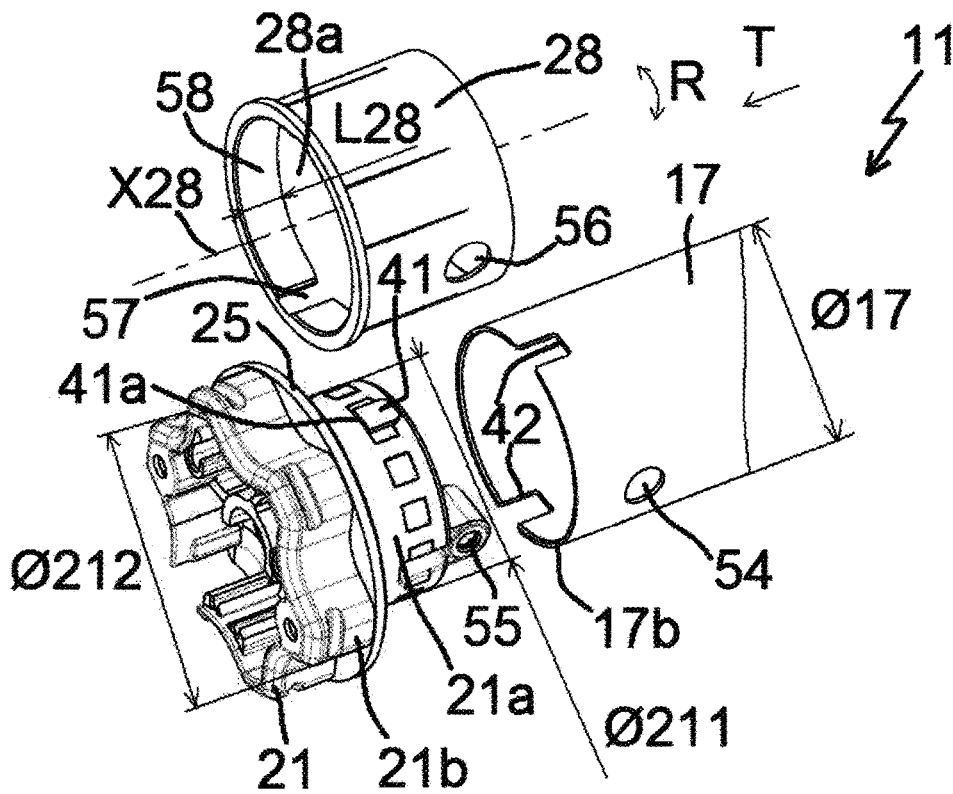

FIG. 8

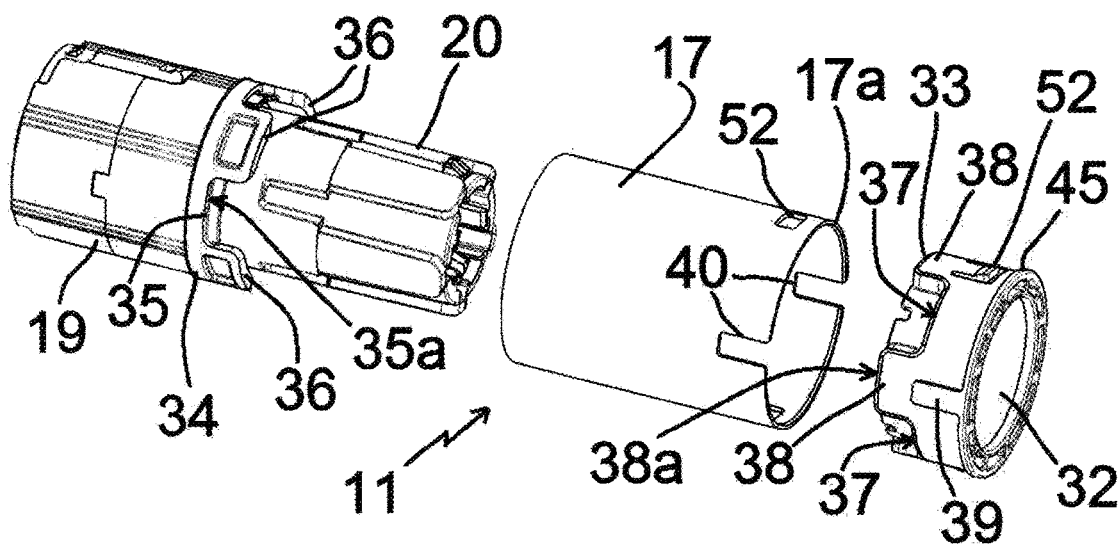

FIG. 9

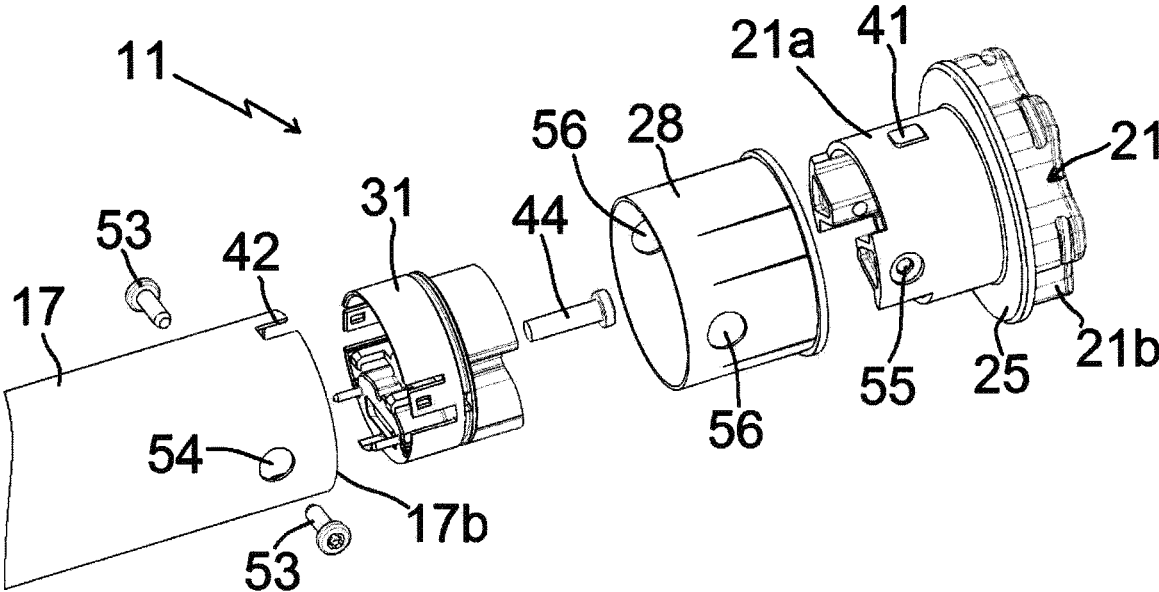

FIG. 10

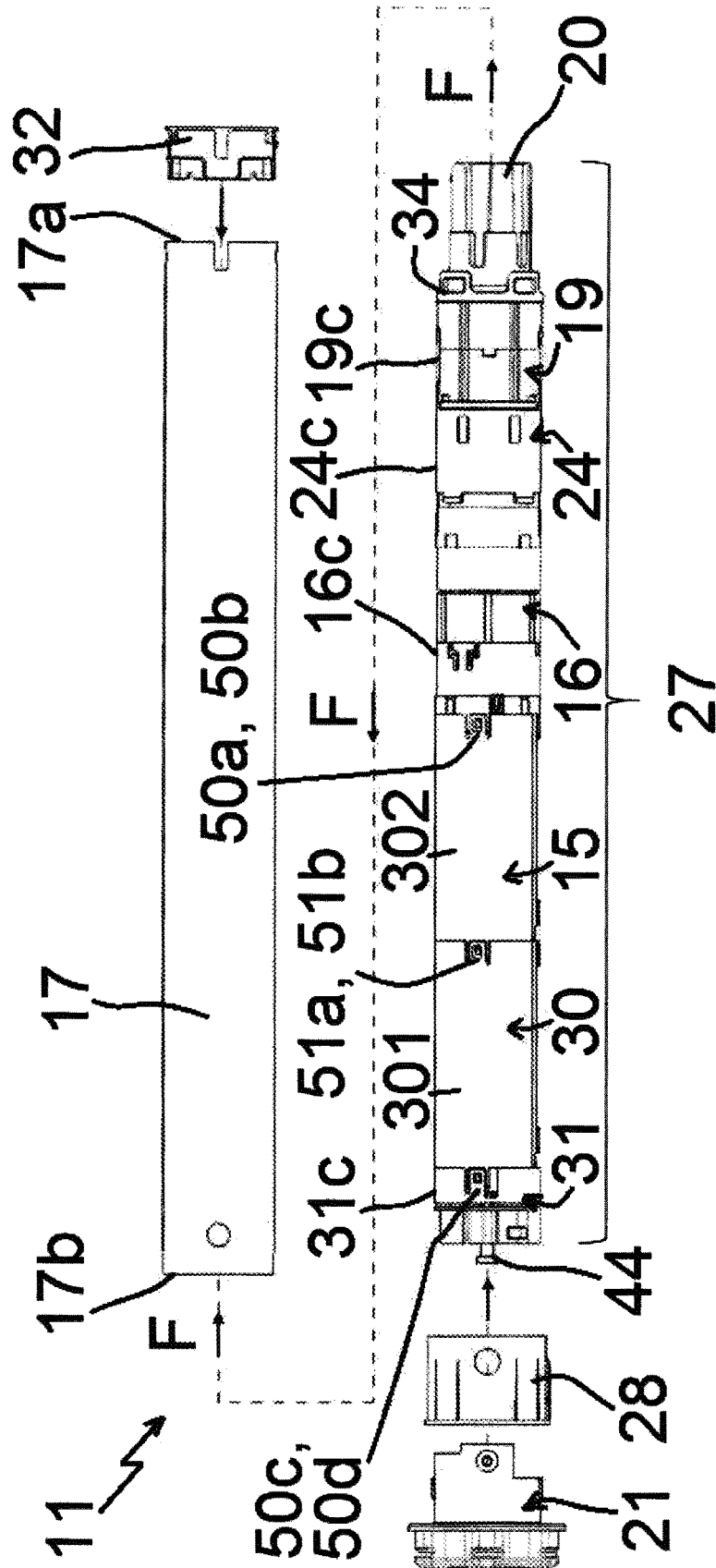

FIG. 11

1

**TUBULAR ELECTROMECHANICAL  
ACTUATOR, HOME AUTOMATION  
EQUIPMENT COMPRISING SUCH AN  
ACTUATOR AND METHOD FOR  
CONNECTING SUCH AN ACTUATOR**

BACKGROUND OF THE INVENTION

Field of the Invention

The present invention relates to a tubular electromechanical actuator, a closure or sun protection home automation installation comprising such an actuator, and a method for assembling such an actuator.

Description of the Related Art

In general, the present invention relates to the field of concealing devices comprising a motorized driving device setting a screen in motion, between at least one first position and at least one second position.

A motorized driving device comprises an electromechanical actuator for a movable element for closing, concealing or sun protection such as a shutter, door, gate, blind or any other equivalent material, hereinafter referred to as a screen.

Document FR 2,983,368 A1 is already known, which describes a tubular electromechanical actuator for a closure or sun protection home automation installation. The electromechanical actuator comprises an electric motor, a casing, a closure element and a ring. The casing is hollow and configured to house the electric motor. The casing comprises a first end and a second end. The second end is opposite the first end. The closure element is configured to close off the second end of the casing. The ring is positioned around the casing and at the second end of the casing.

One known solution for the assembly of the ring relative to the casing and the closure element is to use a ring made in the form of a monobloc piece.

In such a case, the closure element comprises two parts made from a plastic material. The first part of the closure element comprises a first part of the closure element configured to cooperate with the casing of the electromechanical actuator. The second part of the closure element comprises a second part of the closure element configured to cooperate with a support, in particular a flange, of a box of a concealing device.

The first part of the closure element comprises accommodations configured to cooperate with studs of the second part of the closure element.

The assembly of such an electromechanical actuator comprises a step for assembling the ring relative to the first part of the closure element, so as to form a subassembly, a step for assembling the subassembly made up of the ring and the first part of the closure element relative to the casing, a step for assembling the second part of the closure element relative to the first part of the closure element, then a step for fastening the first and second parts of the closure element relative to the casing.

The step for assembling the subassembly made up of the ring and the first part of the closure element relative to the casing is carried out by nesting the first part of the closure element relative to the casing and by fitting protrusions of the first part of the closure element inside recesses of the casing, arranged at the second end of the casing.

The step for assembling the second part of the closure element relative to the first part of the closure element is

2

carried out by nesting studs of the second part of the closure element inside accommodations of the first part of the closure element.

Furthermore, the step for fastening the first and second parts of the closure element relative to the casing is carried out by fastening screws passing through first passage holes arranged in the ring and second passage holes arranged in the casing and screwed in first fastening holes of the second part of the closure element and second fastening holes of the first part of the closure element.

The ring is therefore mounted, on the one hand, on the first part of the closure element and, on the other hand, on the casing.

However, this electromechanical actuator has the drawback of producing the closure element in two parts respectively comprising retaining elements cooperating with one another, in particular studs and accommodations, so as to allow the assembly of the ring made in the form of a monobloc part relative to the casing and the closure element.

As a result, such an assembly of the electromechanical actuator is complex to implement.

Furthermore, the obtainment of the closure element using two nesting parts creates flaws in the flexural holding of the electromechanical actuator relative to the support of the concealing device and mechanical dimensioning difficulties of the two parts of the closure element, which may cause plastic deformation problems of the two parts of the closure element, in particular creep problems.

As a result, the closure element using two nesting parts has rigidity flaws.

Furthermore, the cost of obtaining the electromechanical actuator is high.

SUMMARY OF THE INVENTION

The present invention aims to address the aforementioned drawbacks and to propose a tubular electromechanical actuator, a closure or sun protection home automation installation comprising such an actuator, and a method for assembling such an actuator, making it possible to simplify the assembly of a ring relative to the closure element and a casing of the electromechanical actuator, while minimizing the costs of obtaining the electromechanical actuator, as well as the risks of quality defects of the electromechanical actuator.

To that end, according to a first aspect, the present invention relates to a tubular electromechanical actuator for a closure or sun protection home automation installation, the electromechanical actuator comprising at least:

- an electric motor,
- a casing, the casing being hollow and configured to house at least the electric motor, the casing comprising a first end and a second end, the second end being opposite the first end,
- a closure element, the closure element being configured to close off the second end of the casing, the closure element comprising protrusions configured to cooperate with recesses of the casing, the recesses being arranged at the second end of the casing, and
- a ring, the ring being positioned at least around the casing and at the second end of the casing, the ring being a monobloc part.

According to the invention, the ring comprises:

- , the clearances of the ring being configured to cooperate with the protrusions of the closure element, during the assembly of the ring with the closure element, and

stop, the stop being configured to cooperate with the protrusions of the closure element, following the assembly of the ring with the closure element and a rotational movement of the ring relative to the closure element, so as to block the translation of the ring with respect to the closure element.

Thus, the assembly of the electromechanical actuator is simplified, while minimizing the costs of obtaining the electromechanical actuator, as well as the risks of quality defects of the electromechanical actuator, since the ring is of the monobloc type and has clearances configured to cooperate with the protrusions of the closure element, during the assembly of the ring with the closure element, and since the stop is configured to cooperate with the protrusions of the closure element, in an assembled configuration of the electromechanical actuator.

Furthermore, such an electromechanical actuator comprises a monobloc ring, that is to say without opening along its longitudinal axis to allow the assembly of the latter with respect to the casing and the closure element, so as to do away with a closing element of a first edge of an opening of the ring with respect to a second edge of the opening of the ring, in particular a staple.

According to one advantageous feature of the invention, the closure element is a monobloc part. Furthermore, the closure element comprises a first part configured to cooperate with the casing and a second part configured to cooperate with a support.

According to another advantageous feature of the invention, the stop of the ring is formed by a rib extending radially from an inner surface of the ring toward a longitudinal axis of the ring.

According to another advantageous feature of the invention, the stop of the ring extends axially, along a direction parallel to the longitudinal axis of the ring. Furthermore, the stop of the ring has a length smaller than a distance between a stop of the closure element and an edge of the protrusions of the closure element, opposite this stop.

According to another advantageous feature of the invention, the stop of the closure element is configured to cooperate with the casing, at the second end of the casing, in the assembled configuration of the electromechanical actuator.

According to another advantageous feature of the invention, each clearance of the ring is formed by a hollow arranged in the stop of the ring.

According to another advantageous feature of the invention, the closure element and the casing are assembled to one another using fastening elements.

According to another advantageous feature of the invention, the fastening elements are fastening screws. In an assembled configuration of the electromechanical actuator, the fastening elements pass through passage holes arranged in the casing and are screwed in fastening holes of the closure element. Furthermore, the fastening elements pass through passage holes arranged in the ring.

According to a second aspect, the invention relates to a home automation installation for closing or sun protection that comprises a screen able to be wound on a winding tube rotated by a tubular electromechanical actuator according to the invention.

This home automation installation has features and advantages similar to those previously described relative to the tubular electromechanical actuator described above.

According to a third aspect, the present invention relates to a method for assembling a tubular electromechanical actuator for a closure or sun protection home automation installation,

the electromechanical actuator comprising at least: an electric motor,

a casing, the casing being hollow and configured to house at least the electric motor, the casing comprising a first end and a second end, the second end being opposite the first end,

a closure element, the closure element being configured to close off the second end of the casing, the closure element comprising protrusions configured to cooperate with recesses of the casing, the recesses being arranged at the second end of the casing, and

a ring, the ring being positioned at least around the casing and at the second end of the casing, the ring being a monobloc part.

The method comprises at least the following steps: assembling the ring relative to the closure element, and assembling the casing relative to the closure element and the ring.

According to the invention, the method also comprises at least:

during the step for assembling the ring relative to the closure element, a step for positioning clearances of the ring relative to the protrusions of the closure element, a first step for moving the ring relative to the closure element by a translational movement of the clearances of the ring relative to the protrusions of the closure element, then a second step for moving the ring relative to the closure element by a rotational movement, so as to block the translation of the ring with respect to the closure element by causing a stop of the ring to bear against the protrusions of the closure element, and during the step for assembly of the casing relative to the closure element and the ring, a step for insertion of the casing between the closure element and the ring, then a step for introduction of the protrusions of the closure element inside recesses arranged at the second end of the casing.

This method for assembling a tubular electromechanical actuator has features and advantages similar to those previously described relative to the tubular electromechanical actuator according to the invention and as described above.

#### BRIEF DESCRIPTION OF THE DRAWINGS

Other particularities and advantages of the invention will also appear in the description below, done in reference to the appended drawings, provided as non-limiting examples:

FIG. 1 is a cross-sectional schematic view of a home automation installation according to one embodiment of the invention;

FIG. 2 is a perspective schematic view of the home automation installation illustrated in FIG. 1;

FIG. 3 is a partial and axial sectional schematic view of the home automation installation illustrated in FIGS. 1 and 2, showing a tubular electromechanical actuator of the installation;

FIG. 4 is a sectional schematic view of the electromechanical actuator illustrated in FIG. 3, in an offset section plane relative to a longitudinal axis of the actuator;

FIG. 5 is a partial sectional schematic view of the electromechanical actuator illustrated in FIG. 3, in a section plane passing through the longitudinal axis of the actuator;

FIG. 6 is a sectional and perspective schematic view of part of the electromechanical actuator illustrated in FIGS. 4 and 5, showing a closure element, an interface element and an inhibiting element;

FIG. 7 is a sectional and perspective schematic view of part of the electromechanical actuator illustrated in FIGS. 4 and 5, showing part of a casing of the electromechanical actuator, the closure element and a ring;

FIG. 8 is an exploded and perspective schematic view of part of the electromechanical actuator illustrated in FIGS. 4 and 5, showing part of the casing of the electromechanical actuator, the ring and the closure element;

FIG. 9 is an exploded and perspective schematic view of part of the electromechanical actuator illustrated in FIGS. 4 and 5, showing part of the casing of the electromechanical actuator, a reduction gear, an output shaft, an endpiece and a retaining element;

FIG. 10 is an exploded and perspective schematic view of part of the electromechanical actuator illustrated in FIGS. 4 and 5, showing part of the casing of the electromechanical actuator, the ring, the closure element, the interface element and the inhibiting element; and

FIG. 11 is a schematic view of the electromechanical actuator illustrated in FIGS. 4 and 5, representative of an assembly method of this actuator.

#### DESCRIPTION OF THE PREFERRED EMBODIMENTS

In reference to FIGS. 1 and 2, we first describe a home automation installation according to the invention and installed in a building comprising an opening 1, window or door, equipped with a screen 2 belonging to a concealing device 3, in particular a motorized rolling shutter.

The concealing device 3 can be a rolling shutter, a canvas blind or a blind with adjustable slats, or a rolling gate. The present invention applies to all types of concealing devices.

A rolling shutter according to one embodiment of the invention is described in reference to FIGS. 1 and 2.

The screen 2 of the concealing device 3 is wound on a winding tube 4 driven by a motorized driving device 5 and movable between a wound position, in particular an upper position, and an unwound position, in particular a lower position.

The moving screen 2 of the concealing device 3 is a closure, concealing and/or sun protection screen, winding on the winding tube 4, the inner diameter of which is generally greater than the outer diameter of an electromechanical actuator 11, such that the electromechanical actuator 11 can be inserted into the winding tube 4 during the assembly of the concealing device 3.

The motorized driving device 5 comprises the electromechanical actuator 11, of the tubular type, making it possible to set the winding tube 4 in rotation, so as to unwind or wind the screen 2 of the concealing device 3.

The concealing device 3 comprises the winding tube 4 for winding the screen 2. In the mounted state, the electromechanical actuator 11 is inserted into the winding tube 4.

In a known manner, the rolling shutter, which forms the concealing device 3, comprises an apron comprising horizontal slats articulated on one another, forming the screen 2 of the rolling shutter 3, and guided by two lateral guideways 6. These slats are joined when the apron 2 of the rolling shutter 3 reaches its unwound lower position.

In the case of a rolling shutter, the wound upper position corresponds to the bearing of a final end slat 8, which is, for example, L-shaped, of the apron 2 of the rolling shutter 3 against an edge of a box 9 of the rolling shutter 3, and the unwound lower position corresponds to the bearing of the final end slat 8 of the apron 2 of the rolling shutter 3 against a threshold 7 of the opening 1.

The first slat of the apron 2 of the rolling shutter 3, opposite the final end slat 8, is connected to the winding tube 4 using at least one articulation 10, in particular a fastener in strip form.

The winding tube 4 is positioned inside the box 9 of the rolling shutter 3. The apron 2 of the rolling shutter 3 winds and unwinds around the winding tube 4 and is housed at least partially inside the box 9.

In general, the box 9 is positioned above the opening 1, or in the upper part of the opening 1.

The motorized driving device 5 is controlled by a control unit. The control unit may, for example, be a local control unit 12, where the local control unit 12 can be connected through a wired or wireless connection with a central control unit 13. The central control unit 13 drives the local control unit 12, as well as other similar local control units distributed throughout the building.

The central control unit 13 can be in communication with a weather station located outside the building, in particular including one or more sensors that can be configured, for example, to determine a temperature, a brightness, or a wind speed.

A remote control 14, which can be a type of local control unit, and provided with a control keypad, which comprises selection and display elements, further allows a user to intervene on the electromechanical actuator 11 and/or the central control unit 13.

The motorized driving device 5 is, preferably, configured to carry out the unwinding or winding commands of the screen 2 of the concealing device 3, which may, in particular, be acquired by the remote control 14.

The electromechanical actuator 11 belonging to the home automation installation of FIGS. 1 and 2 is now described in reference to FIGS. 3 to 11.

The electromechanical actuator 11 comprises an electric motor 16.

Furthermore, the electromechanical actuator 11 may comprise an electronic control unit 15, a reduction gear 19 and an output shaft 20.

Here, the electronic control unit 15, the electric motor 16, the reduction gear 19 and the output shaft 20 form an assembly 27, as illustrated in FIGS. 3 and 11.

Thus, the assembly 27 is formed by members of the electromechanical actuator 11, of which the electronic control unit 15, the electric motor 16, the reduction gear 19 and the output shaft 20 are an integral part.

The electric motor 16 comprises a rotor and a stator, not shown, which are positioned coaxially around a rotation axis X, which is also the rotation axis of the winding tube 4 in the assembled configuration of the motorized driving device 5.

Here, the reduction gear 19 is of the type with gear pairs.

In practice, the electric motor 16 comprises an output shaft, not shown, configured to cooperate with an input shaft, not shown, of the reduction gear 19, in the assembled configuration of the electromechanical actuator 11.

Control means for controlling the electromechanical actuator 11, making it possible to move the screen 2 of the concealing device 3, comprise at least the electronic control unit 15. This electronic control unit 15 is able to operate the electric motor 16 of the electromechanical actuator 11 and, in particular, to allow the supply of electricity for the electric motor 16.

Thus, the electronic control unit 15, in particular, controls the electric motor 16, so as to open or close the screen 2, as previously described.

The electronic control unit 15 also comprises an order receiving module, in particular for wireless orders sent by an

order transmitter such as the remote control **14** designed to control the electromechanical actuator **11** or one of the local **12** or central **13** control units.

The order receiving module can also allow the reception of orders sent by wired means.

The control means of the electromechanical actuator **11** comprise hardware and/or software means.

As a non-limiting example, the hardware means may comprise at least one microcontroller.

The electromechanical actuator **11** also comprises a casing **17**, which is, in particular, tubular.

The casing **17** of the electromechanical actuator **11** is, preferably, in cylindrical shape and, more specifically, has a circular section.

In one embodiment, the casing **17** is made from an electrically conductive material, in particular metallic.

The material of the casing of the electromechanical actuator is not limiting and may be different. It can, in particular, be a plastic.

The casing **17** is hollow and configured to house the electric motor **16** and, optionally, the electronic control unit **15** and the reduction gear **19**. Furthermore, the casing **17** can, optionally, be configured to house part of the output shaft **20**.

The casing **17** comprises a first end **17a** and a second end **17b**. The second end **17b** is opposite the first end **17a**.

The output shaft **20** of the electromechanical actuator **11** protrudes past the casing **17** at the first end **17a** of the casing **17**, in the assembled configuration of the electromechanical actuator **11**.

Thus, the output shaft **20** of the electromechanical actuator **11** is positioned inside the winding tube **4** and at least partially outside the casing **17** of the electromechanical actuator **11**.

Advantageously, the output shaft **20** of the electromechanical actuator **11** is coupled, by a connecting element **22**, to the winding tube **4**, in particular using a wheel-shaped connecting element.

The electromechanical actuator **11** is supplied with electricity by an electricity grid of the sector, or using a battery, which can, for example, be recharged by a photovoltaic panel. The electromechanical actuator **11** makes it possible to move the screen **2** of the concealing device **3**.

Here, the electromechanical actuator **11** comprises an electrical power cable **18** allowing it to be supplied with electricity from the electricity grid of the sector.

Advantageously, the electromechanical actuator **11** also comprises a brake **24**.

Here, the brake **24** of the electromechanical actuator **11** is an integral part of the assembly **27**.

As a non-limiting example, the brake **24** may be a spring-loaded brake, a cam brake or an electromagnetic brake.

Advantageously, the electromechanical actuator **11** may also comprise an end-of-travel and/or obstacle detection device, which may be mechanical or electronic.

The electromechanical actuator **11** also comprises a closure element **21**. The closure element **21** is configured to close off the second end **17b** of the casing **17**.

The closure element **21** protrudes past the casing **17** at the second end **17b** of the casing **17**, in the assembled configuration of the electromechanical actuator **11**.

In practice, the closure element **21** is positioned at one end of the tubular electromechanical actuator **11** opposite that at which the output shaft **20** protrudes from the casing **17**.

Here, the casing **17** of the electromechanical actuator **11** is fastened to a support **23**, in particular a flange, of the box

**9** of the concealing device **3** using the closure element **21** forming a torque pin, in particular a closure and torque-reacting head. In such a case where the closure element **21** forms a torque pin, the closure element **21** is also called a fixed point of the electromechanical actuator **11**.

Advantageously, the closure element **21** is made from plastic and, more specifically, by molding.

Preferably and as illustrated in FIGS. **3** to **11**, the closure element **21** is a monobloc part, that is to say a single part.

Here, the closure element **21** is a revolving part.

The closure element **21** comprises a first part **21a** configured to cooperate with the casing **17** of the electromechanical actuator **11** and a second part **21b** configured to cooperate with the support **23**.

Thus, the embodiment of the closure element **21** comprising the first and second parts **21a**, **21b** made in a single part makes it possible to improve the rigidity of the closure element **21**.

At least a portion of the first part **21a** of the closure element **21** is generally in cylindrical shape and is arranged inside the casing **17** of the electromechanical actuator **11**, in the assembled configuration of the electromechanical actuator **11**.

Preferably, the outer diameter  $\varnothing 212$  of the second part **21b** of the closure element **21** is greater than the outer diameter  $\varnothing 17$  of the casing **17** of the electromechanical actuator **11**.

Advantageously, the closure element **21** comprises a stop **25** configured to cooperate with the casing **17**, at the second end **17b** of the casing **17**, in the assembled configuration of the electromechanical actuator **11**, via a ring **28**.

Thus, the stop **25** of the closure element **21** makes it possible to limit the pushing in of the first part **21a** of the closure element **21** in the casing **17**.

Furthermore, the stop **25** of the closure element **21** delimits the first and second parts **21a**, **21b** of the closure element **21**.

Thus, only the first part **21a** of the closure element **21** is arranged inside the casing **17** of the electromechanical actuator **11**, following the fitting of the closure element **21** inside the casing **17**, up to the stop **25**.

Here, the stop **25** of the closure element **21** is made in the form of a flange ring, in particular with a cylindrical and planar shape.

The electromechanical actuator **11** comprises the ring **28**, as illustrated in FIGS. **3** to **5**, **7**, **8**, **10** and **11**. The ring **28** is positioned at least around the casing **17** of the electromechanical actuator **11** and at the second end **17b** of the casing **17**.

Here, the winding tube **4** is rotated about the rotation axis **X** and the casing **17** of the electromechanical actuator **11** supported by two pivot links. The first pivot link is produced at a first end of the winding tube **4** using the ring **28**. The ring **28** thus makes it possible to produce a bearing. The second pivot link, not shown, is produced at a second end of the winding tube **4**.

The ring **28** is a monobloc part, that is to say a single part, in particular with no opening extending along a longitudinal axis **X28** of the ring **28**.

Here, in the assembled configuration of the electromechanical actuator **11**, the longitudinal axis **X28** of the ring **28** is aligned with the rotation axis **X** of the electromechanical actuator **11**.

The closure element **21** and, more specifically, the first part **21a** of the closure element **21** comprises protrusions **41**, each in the form of a radial protrusion, configured to

cooperate with first recesses 42 of the casing 17. The first recesses 42 are arranged at the second end 17b of the casing 17.

Here, the first part 21a of the closure element 21 comprises two diametrically opposite protrusions 41 relative to the second longitudinal axis X21 and, more specifically, relative to the axis of rotation X, in the assembled configuration of the electromechanical actuator 11. Furthermore, the casing 17 comprises two first recesses 42 that are diametrically opposite, relative to the axis of rotation X, in the assembled configuration of the electromechanical actuator 11.

In this way, such an assembly of the closure element 21 and the casing 17 makes it possible to block the rotation of the closure element 21 relative to the casing 17.

Furthermore, the closure element 21 and the casing 17 are also assembled to one another using fastening elements 53, in particular by screwing.

In this way, the assembly of the closure element 21 with the casing 17 makes it possible to block the translation of the closure element 21 relative to the casing 17 and, more specifically, relative to the second end 17b of the casing 17.

Here, the fastening of the closure element 21 with the casing 17 is carried out using fastening screws 53, which may, for example, be of the self-tapping type. In the assembled configuration of the electromechanical actuator 11, the fastening screws 53 pass through passage holes 54 arranged in the casing 17 and are screwed in fastening holes 55 of the closure element 21. Furthermore, the fastening screws 53 pass through passage holes 56 arranged in the ring 28.

In a variant, not shown, the fastening elements 53 of the closure element 21 with the casing 17 can be rivets or fastening elements by resilient snapping.

The ring 28 comprises clearances 57. The clearances 57 of the ring 28 are configured to cooperate with the protrusions 41 of the closure element 21, during the assembly of the ring 28 with the closure element 21.

In reference to FIG. 8, only one of the clearances 57 of the ring 28 is shown.

The ring 28 also comprises a stop 58. The stop 58 is configured to cooperate with the protrusions 41 of the closure element 21, following the assembly of the ring 28 with the closure element 21 and a rotational movement of the ring 28 relative to the closure element 21, in particular relative to the axis of rotation X, so as to block the translation of the ring 28 with respect to the closure element 21.

Thus, the assembly of the electromechanical actuator 11 is simplified, while minimizing the costs of obtaining the electromechanical actuator 11, as well as the risks of quality defects of the electromechanical actuator 11, since the ring 28 is of the monobloc type and has clearances 57 configured to cooperate with the protrusions 41 of the closure element 21, during the assembly of the ring 28 with the closure element 21, and since the stop 58 is configured to cooperate with the protrusions 41 of the closure element 21, in the assembled configuration of the electromechanical actuator 11.

Furthermore, such an electromechanical actuator 11 comprises the monobloc ring 28, that is to say without opening along its longitudinal axis X28 to allow the assembly of the ring 28 with respect to the casing 17 and the closure element 21, so as to do away with a closing element of a first edge of an opening of the ring 28 with respect to a second edge of the opening of the ring 28, in particular a staple.

Furthermore, the clearances 57 of the ring 28 make it possible to guarantee the assembly of the ring 28 relative to the protrusions 41 of the closure element 21, in particular in the case where the closure element 21 is monobloc, that is to say comprising the first and second parts 21a, 21b.

Advantageously, the inner diameter  $\varnothing 28$  of the ring 28, outside the area comprising the stop 58 of the ring 28, is larger than the outer diameter  $\varnothing 211$  of the first part 21a of the closure element 21, at the protrusions 41.

Thus, the ring 28 can be moved following a translational movement, in particular by sliding, relative to the first part 21a of the closure element 21.

Advantageously, the stop 58 of the ring 28 is formed by a rib extending radially from an inner surface 28a of the ring 28 toward the longitudinal axis X28 of the ring 28.

Here, the longitudinal axis X28 of the ring 28 is also the axis of rotation of the ring 28, in the assembled configuration of the electromechanical actuator 11.

Advantageously, the stop 58 of the ring 28 extends axially, along a direction parallel to the longitudinal axis X28 of the ring 28. Furthermore, the stop 58 of the ring 28 has a length L28, measured along the longitudinal axis X28, smaller than a distance D between the stop 25 of the closure element 21 and an edge 41a of the protrusions 41 of the closure element 21, opposite the stop 25.

Preferably, each clearance 57 of the ring 28 is formed by a hollow arranged in the stop 58 of the ring 28.

Here, the ring 28 comprises two diametrically opposite clearances 57 relative to the second longitudinal axis X28 and, more specifically, relative to the axis of rotation X, in the assembled configuration of the electromechanical actuator 11, since the closure element 21 comprises two protrusions 41.

The electromechanical actuator 11 also comprises an interface element 31, as illustrated in FIGS. 4 to 7 and 10 to 11. The interface element 31 is arranged between the closure element 21 and, more specifically, the first part 21a of the closure element 21, and the electronic control unit 15, along the direction of the rotation axis X.

Here, the interface element 31 of the electromechanical actuator 11 is an integral part of the assembly 27.

Here, and as illustrated in FIGS. 4 and 5, the electronic control unit 15, the electric motor 16, the reduction gear 19, the interface element 31 and the brake 24 are positioned inside the casing 17 of the electromechanical actuator 11.

Preferably, the members 31, 15, 16, 19, 24, 20 of the assembly 27 are assembled to one another in a predetermined order. The predetermined assembly order of the members 31, 15, 16, 19, 24, 20 of the assembly 27 first comprises the assembly of the interface element 31 with the electronic control unit 15, then the assembly of the electronic control unit 15 with the electric motor 16, then the assembly of the electric motor 16 with the reduction gear 19 and the assembly of the reduction gear 19 with the output shaft 20.

In the exemplary embodiment illustrated in FIGS. 3 to 5 and 11, the brake 24 is positioned between the electric motor 16 and the reduction gear 19.

In a variant, not shown, the brake 24 is positioned between the reduction gear 19 and the output shaft 20.

Here, each member 31, 15, 16, 19, 24, 20 of the assembly 27 has an axis that is combined with the rotation axis X, in the assembled configuration of the electromechanical actuator 11. The axis of each of the members 15, 16, 19, 24, 20 of the assembly 27 is not shown in FIGS. 3 to 11, so as to simplify the reading thereof.

## 11

Advantageously, the electronic control unit **15** comprises a housing **30** and an electronic board **29**. The electronic board **29** is positioned inside the housing **30**, in the assembled configuration of the electronic control unit **15**.

Thus, the housing **30** of the electronic control unit **15** makes it possible to protect the electronic board **29**, during the assembly of the electromechanical actuator **11** and following the assembly of the latter, as well as to ensure the rigidity of the assembly **27**.

Furthermore, the housing **30** of the electronic control unit **15** makes it possible to electrically insulate the electronic board **29** relative to the casing **17**.

Here and as illustrated in FIGS. **5** and **11**, the housing **30** comprises a first section **301**, made in the form of a first hollow tube, and a second section **302**, made in the form of a second hollow tube.

The first and second sections **301**, **302** are configured to house the electronic board **29**, in the assembled configuration of the electronic control unit **15**.

In a variant, not shown, the housing **30** comprises a single section.

The housing **30** of the electronic control unit **15** is, preferably, in cylindrical shape and, more specifically, has a circular section.

Preferably, the outer diameter of the housing **30** of the electronic control unit **15** is smaller than the inner diameter of the casing **17** of the electromechanical actuator **11**, such that the housing **30** can be inserted into the casing **17** of the electromechanical actuator **11**, during the assembly of the electromechanical actuator **11**.

Here, the housing **30** of the electronic control unit **15** comprises a first end **30a** configured to cooperate with the interface element **31** and a second end **30b** configured to cooperate with the electric motor **16**.

Furthermore, the electronic board **29** is configured to cooperate with an electrical connector **48** of the interface element **31**, in the assembled configuration of the electromechanical actuator **11**. Furthermore, the electronic board **29** is configured to cooperate with an electrical connector **49** of the electric motor **16**, in the assembled configuration of the electromechanical actuator **11**.

The various members of the electromechanical actuator **11** belonging to the home automation installation of FIGS. **1** and **2** are now described in reference to FIGS. **3** to **11**.

Advantageously, the electric motor **16** has a body **16c**, as illustrated in FIG. **11**. Furthermore, the body **16c** of the electric motor **16** is, preferably, in cylindrical shape and, more specifically, has a circular section.

Preferably, the outer diameter of the body **16c** of the electric motor **16** is smaller than the inner diameter of the casing **17** of the electromechanical actuator **11**, such that the body **16c** of the electric motor **16** can be inserted into the casing **17** of the electromechanical actuator **11**, during the assembly of the electromechanical actuator **11**.

Advantageously, the reduction gear **19** has a body **19c**, as illustrated in FIG. **11**. Furthermore, the body **19c** of the reduction gear **19** is, preferably, in cylindrical shape and, more specifically, has a circular section.

Preferably, the outer diameter of the body **19c** of the reduction gear **19** is smaller than the inner diameter of the casing **17** of the electromechanical actuator **11**, such that the body **19c** of the reduction gear **19** can be inserted into the casing **17** of the electromechanical actuator **11**, during the assembly of the electromechanical actuator **11**.

Advantageously, the interface element **31** has a body **31c**, as illustrated in FIGS. **6** and **11**. Furthermore, the body **31c**

## 12

of the interface element **31** is, preferably, in cylindrical shape and, more specifically, has a circular section.

Preferably, the outer diameter of the body **31c** of the interface element **31** is smaller than the inner diameter of the casing **17** of the electromechanical actuator **11**, such that the body **31c** of the interface element **31** can be inserted into the casing **17** of the electromechanical actuator **11**, during the assembly of the electromechanical actuator **11**.

Advantageously, the brake **24** has a body **24c**, as illustrated in FIG. **11**. Furthermore, the body **24c** of the brake **24** is, preferably, in cylindrical shape and, more specifically, has a circular section.

Preferably, the outer diameter of the body **24c** of the brake **24** is smaller than the inner diameter of the casing **17** of the electromechanical actuator **11**, such that the body **24c** of the brake **24** can be inserted into the casing **17** of the electromechanical actuator **11**, during the assembly of the electromechanical actuator **11**.

Advantageously, the body **31c** of the interface element **31**, the first and second sections **301**, **302** of the housing **30** of the electronic control unit **15**, the body **16c** of the electric motor **16**, the body **19c** of the reduction gear **19** and, optionally, the body **24c** of the brake **24** are assembled to one another using fastening elements **50a**, **50b**, **50c**, **50d**, **51a**, **51b**, in particular by resilient snapping, so as to form the assembly **27**.

Thus, the fastening elements **50a**, **50b**, **50c**, **50d**, **51a**, **51b** of the various members **31**, **15**, **16**, **19**, **24** of the assembly **27** make it possible to secure these members **31**, **15**, **16**, **19**, **24** to one another in rotation and in translation.

In this way, following the fastening of the members **31**, **15**, **16**, **19**, **24** of the assembly **27** relative to one another, the links between these members **31**, **15**, **16**, **19**, **24** of the assembly **27** have no axial travel, outside the assembly tolerances of the members **31**, **15**, **16**, **19**, **24** relative to one another.

Furthermore, the assembly of the various members **31**, **15**, **16**, **19**, **24** of the assembly **27** using fastening elements **50a**, **50b**, **50c**, **50d**, **51a**, **51b** makes it possible to introduce the assembly **27**, in a single operation, into the casing **17**, following a translational movement.

Here, the fastening elements **50a**, **50b**, **50c**, **50d**, **51a**, **51b** by resilient snapping are made using tongues and slugs.

Here, one of the members of the assembly **27** is assembled to another of the members of the assembly **27** using fastening elements **50a**, **50b**, **50c**, **50d**, **51a**, **51b** by resilient snapping, of which there may be four that are angularly offset by an angle of 90° about the axis of rotation X.

The number and the angular position of the fastening elements by resilient snapping between two of the members of the assembly are not limiting and can be different, in particular, these fastening elements can be three in number and angularly offset by an angle of 120° about the axis of rotation.

Preferably, the outer diameter, respectively, of the body **31c** of the interface element **31**, the housing **30** of the electronic control unit **15**, the body **16c** of the electric motor **16**, the body **19c** of the reduction gear **19** and the body **24c** of the brake **24** have a same value.

Advantageously, the electromechanical actuator **11** also comprises a retaining element **32**. The retaining element **32** is assembled at the first end **17a** of the casing **17**. The retaining element **32** comprises a first stop **33** configured to cooperate with the assembly **27** and, more specifically, with the reduction gear **19**, in the assembled configuration of the electromechanical actuator **11**.

13

In the exemplary embodiment illustrated in FIGS. 4, 5, 9 and 11, the assembly 27 and, more specifically, the reduction gear 19 comprises an endpiece 34 configured to cooperate with the retaining element 32, at the first end 17a of the casing 17, in the assembled configuration of the electromechanical actuator 11. In FIG. 9, only part of the casing 17 is shown, near its end 17a.

Here, the endpiece 34 comprises notches 35 and tongues 36, positioned alternating around the axis of rotation X, configured to cooperate, respectively, with tongues 38 and notches 37 of the retaining element 32.

Thus, the tongues 38 of the retaining element 32 are configured to engage in the notches 35 of the endpiece 34, in the assembled configuration of the electromechanical actuator 11. Furthermore, the tongues 36 of the endpiece 34 are configured to engage in the notches 37 of the retaining element 32, in the assembled configuration of the electromechanical actuator 11.

In such a case, the first stop 33 of the retaining element 32 configured to cooperate with the assembly 27 and, more specifically, with the reduction gear 19, in the assembled configuration of the electromechanical actuator 11, is produced by an end wall 38a of each of the tongues 38, these end walls 38a bearing against the bottom walls 35a of each of the notches 35 of the endpiece 34.

Here, the endpiece 34 comprises four notches 35 that are angularly offset by an angle of 90°, around the axis of rotation X, and four tongues 36 that are angularly offset by an angle of 90°, around the axis of rotation X. Furthermore, the retaining element 32 comprises four notches 37 that are angularly offset by an angle of 90°, around the axis of rotation X, and four tongues 38 that are angularly offset by an angle of 90°, around the axis of rotation X.

The number and the angular position of the notches and tongues of the endpiece and of the retaining element are not limiting and can be different, in particular, these notches and tongues can be three in number and angularly offset by an angle of 120° about the axis of rotation.

Furthermore, the retaining element 32 comprises protrusions 39, each in the form of a radial protrusion, configured to cooperate with second recesses 40 of the casing 17. The second recesses 40 are arranged at the first end 17a of the casing 17.

Here, the retaining element 32 comprises two diametrically opposite protrusions 39 relative to the axis of rotation X. Furthermore, the casing 17 comprises two second recesses 40 that are diametrically opposite relative to the axis of rotation X.

In this way, such an assembly of the endpiece 34, the retaining element 32 and the casing 17 makes it possible to block the rotation of the assembly 27 relative to the casing 17 and, more specifically, the reduction gear 19 relative to the casing 17.

Advantageously, the retaining element 32 comprises a second stop 45 configured to cooperate with the casing 17, at the first end 17a of the casing 17, in the assembled configuration of the electromechanical actuator 11.

Thus, the second stop 45 of the retaining element 32 makes it possible to limit the pushing in of the retaining element 32 in the casing 17.

Here, the second stop 45 of the retaining element 32 is made in the form of a flange ring, in particular with a cylindrical and planar shape, perpendicular to the axis of rotation X, in the assembled configuration of the electromechanical actuator 11.

14

Furthermore, the retaining element 32 and the casing 17 are also assembled to one another using fastening elements 52, in particular by resilient snapping.

Thus, the assembly of the retaining element 32 with the casing 17 makes it possible to block the translation of the retaining element 32 and, more specifically, the assembly 27 relative to the casing 17 and, more specifically, relative to the first end 17a of the casing 17.

In this way, following the fastening of the retaining element 32 with respect to the casing 17, the retaining element 32 serves as a stop for the assembly 27, during the sliding of the assembly 27 inside the casing 17, along the axial direction of the electromechanical actuator 11, from the second end 17b of the casing 17 toward the first end 17a of the casing 17.

Such an assembly of the electromechanical actuator 11 makes it possible to provide play J, in particular axial, between the closure element 21 and the interface element 31, along the axial direction of the electromechanical actuator 11, as illustrated in FIGS. 5 and 6.

The play J makes it possible to guarantee the assembly of the closure element 21 relative to the casing 17.

Here and non-limitingly, the play J between the closure element 21 and the interface element 31, along the axial direction of the electromechanical actuator 11, can be of the order of plus or minus two millimeters.

Advantageously, the interface element 31 comprises a first accommodation 43 inside which an inhibiting element 44 is positioned inhibiting the play J between the closure element 21 and the interface element 31, along the axial direction of the electromechanical actuator 11.

Thus, the inhibiting element 44 of the play J between the closure element 21 and the interface element 31, along the axial direction of the electromechanical actuator 11, makes it possible to improve the holding of the members 31, 15, 16, 19, 24, 20 of the electromechanical actuator 11 that are positioned inside the casing 17 and to eliminate the risk of electrical disconnection of the electronic control unit 15 with respect to the electrical power cable 18 and with respect to the electric motor 16, in particular upon impact of the electromechanical actuator 11, which may occur during a manipulation or the transport of the electromechanical actuator 11, or during abnormal operation of the electromechanical actuator 11.

In this way, such a construction of the electromechanical actuator 11 makes it possible to inhibit the play J between the closure element 21 and the interface element 31, along the axial direction of the electromechanical actuator 11, following the assembly of the electromechanical actuator 11, so as to guarantee a functional state of the electromechanical actuator 11, during different phases in the lifetime of the electromechanical actuator 11.

Furthermore, the inhibiting element 44 makes it possible to block the translation of the interface element 31 relative to the closure element 21.

Here, the first accommodation 43 of the interface element 31 has a generally cylindrical shape, centered on a longitudinal axis X31 of the interface element 31.

Furthermore, the longitudinal axis X31 of the interface element 31 is combined with the rotation axis X of the electric motor 16 of the electromechanical actuator 11, or the rotation axis of the winding tube 4, in the mounted configuration of the motorized driving device 5.

Preferably, the closure element 21 comprises a first accommodation 26 emerging at a first face 21c of the closure element 21 and at a second face 21d of the closure element 21.

15

The first accommodation 26 of the closure element 21 is positioned opposite the inhibiting element 44, in the assembled configuration of the electromechanical actuator 11, so as to allow a position adjustment of the inhibiting element 44 from the outside of the closure element 21.

Thus, the position adjustment of the inhibiting element 44 with respect to the interface element 31 and the closure element 21, along the axial direction of the electromechanical actuator 11, can be carried out from the outside of the closure element 21 and, more specifically, of the electromechanical actuator 11, by maneuvering the inhibiting element 44 using a tool, not shown, such as a screwdriver, that passes through the first accommodation 26 of the closure element 21, as explained hereinafter.

In this way, the positioning of the inhibiting element 44 relative to the interface element 31 and the closure element 21, along the axial direction of the electromechanical actuator 11, can be carried out as a function of the value of the play J, without having to disassemble one or several elements of the electromechanical actuator 11.

Here, the first accommodation 26 of the closure element 21 has a generally cylindrical shape, centered on a longitudinal axis X21 of the closure element 21.

Furthermore, the longitudinal axis X21 of the closure element 21 is combined with the rotation axis X of the electric motor 16 of the electromechanical actuator 11, or the rotation axis of the winding tube 4, in the mounted configuration of the motorized driving device 5. Furthermore, the longitudinal axis X21 of the closure element 21 is combined with the longitudinal axis X31 of the interface element 31, in the assembled configuration of the electromechanical actuator 11.

Advantageously, the inhibiting element 44 is configured to cooperate with a face of the closure element 21 and, more specifically, the second face 21d of the closure element 21, following a position adjustment of the inhibiting element 44 relative to the closure element 21, along the axial direction of the electromechanical actuator 11, so as to inhibit the play J between the closure element 21 and the interface element 31.

Thus, the inhibition of the play J between the closure element 21 and the interface element 31 is implemented by the position adjustment of the inhibiting element 44 relative to the interface element 31 and the closure element 21, along the axial direction of the electromechanical actuator 11 and, more specifically, the bearing of the inhibiting element 44 against the second face 21d of the closure element 21.

Preferably, the inhibiting element 44 is a screw. Furthermore, the first accommodation 43 of the interface element 31 is a bore.

Here, the inhibiting element 44 is a screw having a metric thread. Furthermore, the first accommodation 43 of the interface element 31 is a tapped bore.

In a variant, not shown, the inhibiting element 44 is a self-tapping screw. In this case, the first accommodation 43 of the interface element 31 is a smooth bore.

In one exemplary embodiment, the screw forming the inhibiting element 44 is a screw identical to the screws forming the fastening elements 53 of the closure element 21 with the casing 17.

Thus, the number of screw models for manufacturing the electromechanical actuator 11 is limited, so as to simplify industrialization and avoid reference error risks.

In practice, a head of the screw forming the inhibiting element 44 is configured to cooperate with the second face 21d of the closure element 21, following unscrewing of the

16

screw 44 relative to the bore 43 of the interface element 31, so as to inhibit the play J between the closure element 21 and the interface element 31.

Advantageously, the first accommodation 26 arranged in the closure element 21 allows the passage of a tool, in particular a screwdriver, so as to reach the inhibiting element 44 and, more specifically, to allow the unscrewing of the screw forming the inhibiting element 44.

Preferably, the inhibiting element 44 is assembled on the interface element 31 before the assembly 27 is introduced inside the casing 17.

Thus, the operation to assemble the inhibiting element 44 on the interface element 31 does not cause an extension of the time to assemble the assembly 27 inside the casing 17, since this operation can be carried out during hidden time, during the manufacturing of the electromechanical actuator 11.

Here, the screw 44 is screwed to the inside of the first accommodation 43 of the interface element 31 before the assembly 27 is introduced inside the casing 17, in particular until the head of the screw 44 is made to bear against the rim of the first accommodation 43 of the interface element 31.

Advantageously, the closure element 21 comprises a second accommodation 46. The second accommodation 46 of the closure element 21 is configured to allow the passage of the electrical power cable 18.

Furthermore, the interface element 31 comprises a second accommodation 47. The second accommodation 47 of the interface element 31 comprises part of the first electrical connector 48. The first electrical connector 48 arranged in the second accommodation 47 of the interface element 31 is configured to cooperate with an electrical connector of the electrical power cable 18.

Furthermore, the first electrical connector 48 of the interface element 31 is electrically coupled to the electronic control unit 15, using electrical connection elements, in particular using electrical pins, not shown, configured to cooperate with tracks of the electronic board 29 of the electronic control unit 15.

Thus, the electrical connector of the electrical power cable 18 is configured to cooperate with the first electrical connector 48 of the interface element 31, so as to supply electrical energy to the electric motor 16, using the electrical power cable 18.

In one exemplary embodiment, not shown, the second accommodation 46 of the closure element 21 is also configured to allow the passage of a data exchange cable.

In this case, the interface element 31 comprises a third accommodation. The third accommodation of the interface element 31 comprises a second electrical connector. The second electrical connector arranged in the third accommodation of the interface element 31 is configured to cooperate with an electrical connector of the data exchange cable.

Furthermore, still in this case, the second electrical connector of the interface element 31 is electrically coupled to the electronic control unit 15, using electrical connection elements, in particular using electrical pins, not shown, configured to cooperate with tracks of the electronic board 29 of the electronic control unit 15.

In such a case where the electromechanical actuator 11 is coupled to the data exchange cable, the latter allows the electronic control unit 15 to receive and/or send data with a control unit, in particular with the local control unit 12 and/or the central control unit 13, via a wired link.

Thus, the electrical connector of the data exchange cable is configured to cooperate with the second electrical con-

nector of the interface element **31**, so as to exchange data between at least one of the control units **12**, **13** and the electronic control unit **15**.

We now describe a method for assembling the tubular electromechanical actuator **11** according to one embodiment of the invention.

The assembly method comprises a step for assembling the ring **28** relative to the closure element **21** and a step for assembling the casing **17** relative to the closure element **21** and the ring **28**.

During the step for assembling the ring **28** relative to the closure element **21**, the method comprises a step for positioning clearances **57** of the ring **28** relative to the protrusions **41** of the closure element **21**, a first step for moving the ring **28** relative to the closure element **21** by a translational movement T of the clearances **57** of the ring **28** relative to the protrusions **41** of the closure element **21**, then a second step for moving the ring **28** relative to the closure element **21** by a rotational movement R, so as to block the translation of the ring **28** with respect to the closure element **21** by causing the stop **58** of the ring **28** to bear against the protrusions **41** of the closure element **21**.

After the positioning step, the clearances **57** of the ring **28** are aligned, along directions parallel to the longitudinal axis X**28**, with the protrusions **41** of the closure element **21**.

Furthermore, during the step for assembly of the casing **17** relative to the closure element **21** and the ring **28**, the method comprises a step for insertion of the casing **17** between the closure element **21** and the ring **28**, then a step for introduction of the protrusions **41** of the closure element **21** inside first recesses **42** arranged at the second end **17b** of the casing **17**.

Owing to the present invention, the assembly of the electromechanical actuator is simplified, while minimizing the costs of obtaining the electromechanical actuator, as well as the risks of quality defects of the electromechanical actuator, since the ring is of the monobloc type and has clearances configured to cooperate with the protrusions of the closure element, during the assembly of the ring with the closure element, and since the stop is configured to cooperate with the protrusions of the closure element, in an assembled configuration of the electromechanical actuator.

Furthermore, such an electromechanical actuator comprises a monobloc ring, that is to say without opening along its longitudinal axis to allow the assembly of the latter with respect to the casing and the closure element, so as to do away with a closing element of a first edge of an opening of the ring with respect to a second edge of the opening of the ring, in particular a staple.

Many changes can be made to the example embodiment previously described without going beyond the scope of the invention.

In a variant, not shown, the housing **30** of the electronic control unit **15** comprises a number of sections, made in the form of a hollow tube, greater than or equal to three.

In a variant, not shown, the electronic control unit **15** is positioned outside the casing **17** of the electromechanical actuator **11** and, in particular, mounted on the support **23** or in the closure element **21**.

Furthermore, the considered embodiments and variants may be combined to generate new embodiments of the invention, without going beyond the scope of the invention.

The invention claimed is:

1. A tubular electromechanical actuator for a closure or sun protection home automation installation, the electromechanical actuator comprising at least:

an electric motor,

a casing, the casing being hollow and configured to house at least the electric motor, the casing comprising a first end and a second end, the second end being opposite the first end,

a closure element, the closure element closing off the second end of the casing, the closure element comprising protrusions configured to cooperate with recesses of the casing, the recesses being arranged at the second end of the casing, and

a ring, the ring being positioned outside of an outermost circumference of the casing and at the second end of the casing, the ring being a monobloc part, the ring being rotatable with respect to the closure element and forming a bearing for a winding tube,

wherein the ring comprises:

clearances, the clearances of the ring being configured to cooperate with the protrusions of the closure element, during an assembly of the ring with the closure element, and

a stop, the stop being configured to cooperate with the protrusions of the closure element, following the assembly of the ring with the closure element and a rotational movement of the ring relative to the closure element, so as to block a translation of the ring with respect to the closure element.

2. The tubular electromechanical actuator for a closure or sun protection home automation installation according to claim 1, wherein the closure element is a monobloc part and wherein the closure element comprises a first part configured to cooperate with the casing and a second part configured to cooperate with a support.

3. The tubular electromechanical actuator for a closure or sun protection home automation installation according to claim 1, wherein the stop of the ring is formed by a rib extending radially from an inner surface of the ring toward a longitudinal axis of the ring.

4. The tubular electromechanical actuator for a closure or sun protection home automation installation according to claim 3, wherein the stop of the ring extends axially, along a direction parallel to the longitudinal axis of the ring, and wherein the stop of the ring has a length smaller than a distance between a stop of the closure element and an edge of the protrusions of the closure element, opposite the stop of the closure element.

5. The tubular electromechanical actuator for a closure or sun protection home automation installation according to claim 4, wherein the stop of the closure element is configured to cooperate with the casing, at the second end of the casing, in an assembled configuration of the electromechanical actuator, via the ring.

6. The tubular electromechanical actuator for a closure or sun protection home automation installation according to claim 3, wherein each clearance of the ring is formed by a hollow arranged in the stop of the ring.

7. The tubular electromechanical actuator for a closure or sun protection home automation installation according to claim 1, wherein the closure element and the casing are assembled to one another using fastening elements.

8. The tubular electromechanical actuator for a closure or sun protection home automation installation according to claim 7, wherein the fastening elements are fastening screws, wherein, in an assembled configuration of the electromechanical actuator, the fastening screws pass through passage holes arranged in the casing and are screwed in fastening holes of the closure element, and wherein the fastening elements pass through passage holes arranged in the ring.

19

9. The tubular electromechanical actuator for a closure or sun protection home automation installation according to claim 1, wherein the ring is mounted around the casing at the second end of the casing.

10. A home automation installation for closing or providing sun protection that comprises a screen able to be wound on a winding tube rotated by a tubular electromechanical actuator, wherein said installation further comprises the tubular electromechanical actuator according to claim 1.

11. A method for assembling a tubular electromechanical actuator for a closure or sun protection home automation installation,

the electromechanical actuator comprising at least:

- an electric motor,
- a casing, the casing being hollow and configured to house at least the electric motor, the casing comprising a first end and a second end, the second end being opposite the first end,
- a closure element, the closure element closing off the second end of the casing, the closure element comprising protrusions configured to cooperate with recesses of the casing, the recesses being arranged at the second end of the casing, and
- a ring, the ring being positioned outside of an outermost circumference of the casing and at the second end of the casing, the ring being a monobloc part, the ring

20

being rotatable with respect to the closure element and forming a bearing for a winding tube, the method comprising at least the following steps: assembling the ring relative to the closure element, and assembling the casing relative to the closure element and the ring,

wherein the method also comprises at least:

during the step for assembling the ring relative to the closure element, a step for positioning clearances of the ring relative to the protrusions of the closure element, a first step for moving the ring relative to the closure element by a translational movement of the clearances of the ring relative to the protrusions of the closure element, then a second step for moving the ring relative to the closure element by a rotational movement, so as to block a translation of the ring with respect to the closure element by causing a stop of the ring to bear against the protrusions of the closure element, and

during the step for assembly of the casing relative to the closure element and the ring, a step for insertion of the casing between the closure element and the ring, then a step for introduction of the protrusions of the closure element inside recesses arranged at the second end of the casing.

\* \* \* \* \*