



INTERNATIONAL APPLICATION PUBLISHED UNDER THE PATENT COOPERATION TREATY (PCT)

| | | |
|--|------------------|--|
| <p>(51) International Patent Classification⁶ : F16B 21/08, B60N 3/02, F16B 5/06</p> | <p>A1</p> | <p>(11) International Publication Number: WO 96/17178</p> <p>(43) International Publication Date: 6 June 1996 (06.06.96)</p> |
| <p>(21) International Application Number: PCT/US95/15705</p> <p>(22) International Filing Date: 4 December 1995 (04.12.95)</p> <p>(30) Priority Data: 08/349,031 2 December 1994 (02.12.94) US</p> <p>(71) Applicant: DONNELLY CORPORATION [US/US]; 414 East Fortieth Street, Holland, MI 49423 (US).</p> <p>(72) Inventor: ADAMS, Edward, R.; 14548 Boom Road, Spring Lake, MI 49456 (US).</p> <p>(74) Agent: VISSERMAN, Peter; Varnum, Riddering, Schmidt & Howlett L.L.P., Bridgewater Place, P.O. Box 352, Grand Rapids, MI 49501-0352 (US).</p> | | <p>(81) Designated States: AM, AT, AU, BB, BG, BR, BY, CA, CH, CN, CZ, DE, DK, EE, ES, FI, GB, GE, HU, IS, JP, KE, KG, KP, KR, KZ, LK, LR, LT, LU, LV, MD, MG, MN, MW, MX, NO, NZ, PL, PT, RO, RU, SD, SE, SG, SI, SK, TJ, TM, TT, UA, UG, UZ, VN, European patent (AT, BE, CH, DE, DK, ES, FR, GB, GR, IE, IT, LU, MC, NL, PT, SE), OAPI patent (BF, BJ, CF, CG, CI, CM, GA, GN, ML, MR, NE, SN, TD, TG), ARIPO patent (KE, LS, MW, SD, SZ, UG).</p> <p>Published <i>With international search report.</i></p> |

(54) Title: MOUNTING CLIP

(57) Abstract

A mounting clip assembly (10) for mounting an accessory (16) to a roof sheet metal bracket (18). A mounting clip (12) is fastened to or molded with the accessory (16) and comprises two diverging legs (30, 32), which are snap-fit into an aperture (24) in the roof sheet metal bracket (18). A locking bezel (14) has a pair of lugs (52) and a locking finger (54), which are inserted between the legs (30, 32) to prevent the relative movement of the legs (30, 32). The locking finger (54) is received within a slot (36) on one of the legs (30, 32) to releasably fasten the bezel (14) to the clip (12).

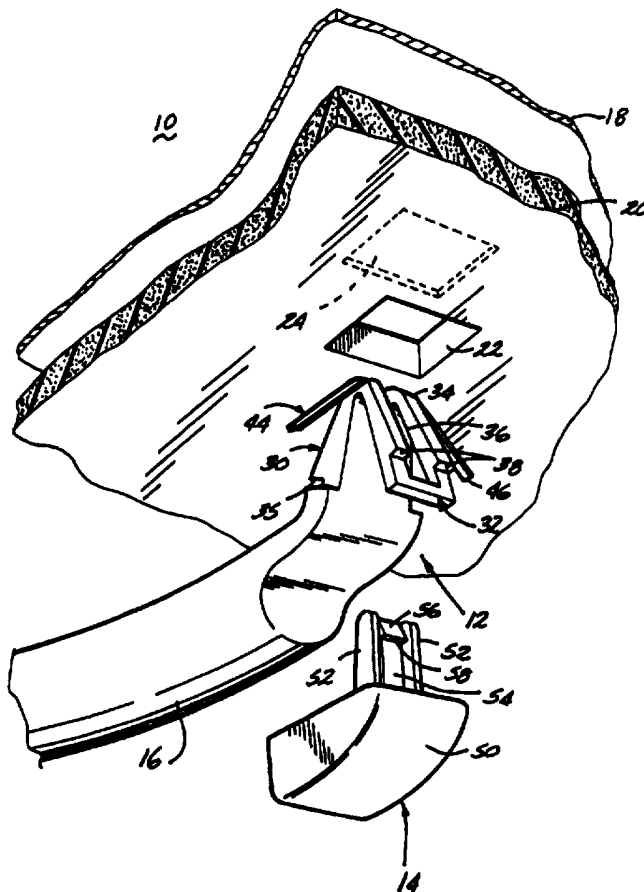

FOR THE PURPOSES OF INFORMATION ONLY

Codes used to identify States party to the PCT on the front pages of pamphlets publishing international applications under the PCT.

| | | | | | |
|----|--------------------------|----|--|----|--------------------------|
| AT | Austria | GB | United Kingdom | MR | Mauritania |
| AU | Australia | GE | Georgia | MW | Malawi |
| BB | Barbados | GN | Guinea | NE | Niger |
| BE | Belgium | GR | Greece | NL | Netherlands |
| BF | Burkina Faso | HU | Hungary | NO | Norway |
| BG | Bulgaria | IE | Ireland | NZ | New Zealand |
| BJ | Benin | IT | Italy | PL | Poland |
| BR | Brazil | JP | Japan | PT | Portugal |
| BY | Belarus | KE | Kenya | RO | Romania |
| CA | Canada | KG | Kyrgystan | RU | Russian Federation |
| CF | Central African Republic | KP | Democratic People's Republic of Korea | SD | Sudan |
| CG | Congo | KR | Republic of Korea | SE | Sweden |
| CH | Switzerland | KZ | Kazakhstan | SI | Slovenia |
| CI | Côte d'Ivoire | LI | Liechtenstein | SK | Slovakia |
| CM | Cameroon | LK | Sri Lanka | SN | Senegal |
| CN | China | LU | Luxembourg | TD | Chad |
| CS | Czechoslovakia | LV | Latvia | TG | Togo |
| CZ | Czech Republic | MC | Monaco | TJ | Tajikistan |
| DE | Germany | MD | Republic of Moldova | TT | Trinidad and Tobago |
| DK | Denmark | MG | Madagascar | UA | Ukraine |
| ES | Spain | ML | Mali | US | United States of America |
| FI | Finland | MN | Mongolia | UZ | Uzbekistan |
| FR | France | | | VN | Viet Nam |
| GA | Gabon | | | | |

MOUNTING CLIP

Background of the Invention

Field of the Invention

5 This invention relates to a mounting clip, and, more specifically a mounting clip for mounting automobile accessories to an automobile structure.

Description of Related Art

 The passenger compartments of contemporary automobiles have a headliner mounted to the sheet metal roof of the passenger compartment. The headliner is typically a foam layer molded with a decorative surface or covered with an outer decorative layer. The headliner can be attached to the vehicle roof by clips which pass through the aligned slots in the headliner and the roof. It is common for the clips which mount the headliner to the roof to also mount automobile accessories to the vehicle. These accessories include: pull grips, garment hooks, light assemblies, mirror assemblies, visors, and visor mounts, for example.

 U.S. Patent No. 5,314,227, issued May 24, 1994, illustrates a clip in combination with a locking bezel for mounting a visor to a vehicle roof. The clip comprises a body from which two opposed arms extend outwardly and downwardly, each arm having a locking flange which is seated behind the upper surface of a sheet metal roof bracket when the clip is inserted through an aperture in the roof bracket. The locking bezel has two locking tongues that extend between the body and the arms and snap-fit within an aperture in the arms to limit the inward deflection of the arms, preventing the removal of the clip, unless the bezel is first removed. A similar clip/bezel combination is shown in U.S. Patent No. 5,082,323, issued January 21, 1992, except that the locking tongues abut the arms.

 U.S. Patent No. 5,082,322, issued January 21, 1992, discloses a clip for mounting the visor to the vehicle roof. The visor includes a molded-on torque fitting, including a spring clip having triangular flanges with an edge which snaps onto and locks behind a ledge in a header socket positioned above

the vehicle roof. A bezel is snap-fit to the molded-on torque fitting and prevents access to the spring clip to prevent removal of the spring clip. Similar clips without a locking flange are shown in U.S. Patent Nos. 4,708,895, issued November 24, 1987, 4,517,711, issued May 21, 1985, and 4,765,036, issued
5 August 23, 1988.

U.S. Patent No. 4,569,552, issued February 11, 1986, discloses a clip for mounting a visor to the vehicle roof. The clip includes a torque fitting surrounding the elbow of the visor and a spring clip disposed over the torque fitting. The spring clip has two opposing spring arms which seat behind the
10 upper surface of sheet metal brackets adjacent an aperture upon insertion of the torque fitting into the aperture.

Summary of Invention

The invention is a mounting clip assembly, which is adapted to mount an accessory to a support structure. The mounting clip assembly
15 comprises a mounting clip with first and second legs resiliently joined at one end to define an apex. The legs diverge from the apex and form a gap therebetween at another end. One of the legs has a free end and the other leg is adapted to mount the accessory. Each leg has lips that are adapted to pass through an aperture in the support structure and seat on an upper surface of the support
20 structure to lock the clip to the support structure. The mounting clip assembly further comprises a bezel having a cover and at least one upstanding lug adapted to extend into the gap formed between the legs. The lug prevents the legs from moving toward each other and, thus, the inadvertent removal of the clip from the support structure.

25 Preferably, one of the legs has a slot formed therein with a bottom surface. The bezel includes a locking finger, which projects upwardly from the cover and has a locking tab that projects laterally behind the bottom surface of the leg slot. The locking finger is resilient and flexes when the lug and the finger are inserted into the gap of the clip. A slanted flat can be formed on the
30 locking finger to engage the bottom surface of the slot so that the bezel can be removed from the clip by pulling the bezel away from the clip.

In one embodiment of the invention, the mounting clip has at least one resilient retaining finger projecting outwardly and downwardly from the side of the first and second legs. The retaining finger is adapted to mount the clip to a headliner. Preferably, the finger is mounted at the apex of the legs. The
5 mounting clip can be integrally molded with the accessory or can be connected to the accessory by a mechanical connector such as a rivet.

In one embodiment of the invention, the mounting clip assembly is adapted to mount an accessory to a headliner with an aperture. The mounting clip assembly comprises a mounting clip with first and second legs, which are
10 adapted to mount the accessory. At least one resilient retaining finger projects outwardly and downwardly from a side of the legs for mounting the clip to the headliner whereby when the clip is inserted into the headliner aperture, the retaining finger is adapted to abut an upper surface of the headliner to mount the clip to the headliner. There can be one or more resilient fingers on
15 different sides of the legs.

In yet another embodiment of the invention, the bezel can be integrally molded with the accessory and the bezel defines an opening which provides access to the mounting clip. The cover is mounted to the bezel by a living hinge. Also, the cover can have at least one snap tab for locking the
20 cover to the bezel.

Brief Description of the Drawings

The invention will now be described with reference to the drawings wherein:

FIG. 1 is a perspective view of a mounting clip assembly
25 according to the invention mounted to a grab handle and a partial view of a vehicle headliner and roof;

FIG. 2 is a partial sectional view of the mounting clip assembly of FIG. 1 mounted to a vehicle headliner and to a roof sheet metal bracket;

FIG. 3 is an end view of the mounting clip assembly of FIG. 1
30 assembled to a vehicle headliner;

FIG. 4 is a sectional view like FIG. 2 of an assembled mounting clip assembly of a second embodiment shown attached to a vehicle roof and to a vehicle headliner;

FIG. 5 is a perspective view of a third embodiment of the mounting clip assembly according to the invention; and

FIG. 6 is a side view of the mounting clip assembly of FIG. 5.

Description of the Preferred Embodiments

Referring now to the drawings, FIG. 1 illustrates a mounting clip assembly 10 in accordance with the invention. For illustration purposes, the mounting clip assembly 10 is shown in the context of mounting a vehicle accessory to a vehicle. However, the mounting clip assembly 10 can be used in a variety of different applications other than for mounting accessories to an automotive vehicle.

Mounting clip assembly 10 is shown mounting a vehicle accessory, such as grab handle 16, to a roof sheet metal bracket 18. The mounting clip assembly 10 comprises a mounting clip 12 in combination with a locking bezel 14, which prevents the inadvertent removal of the mounting clip 12 from the vehicle roof. A vehicle headliner 20 is positioned against the roof sheet metal bracket 18. In the grab handle 16 application, the mounting clip 12 is affixed to the end of the grab handle 16. To mount the grab handle 16 to the roof sheet metal bracket 18, the mounting clip 12 is inserted through aligned apertures 22 and 24 in the headliner 20 and bracket 18, respectively, and the clip 12 is shaped to prevent the direct removal of the clip from the aligned apertures and thereby secures the grab handle 16 to the roof sheet metal bracket 18.

The mounting clip 12 is substantially V-shaped in profile and comprises a first leg 30 and a second leg 32, which meet at an apex 34. The first leg 30 extends from the grab handle 16 to the apex 34 and has a lip 35, which snaps behind the upper surface of the bracket 18 when the grab handle 16 is mounted to the bracket 18. The second leg 32, unlike the first leg 30, can have a centrally disposed slot extending substantially the length of the first leg. Like the first leg 30, the second leg 32 has a lip 38, which snaps into and seats

behind the upper surface of the roof sheet metal bracket 18 when the grab handle is mounted to the bracket 18. The lip 38 is shown as being discontinuous because of the slot 36. Depending on the length of the slot 36, the lip 38 may or may not be discontinuous. The legs 30 and 32 are preferably
5 both resilient so that the legs can flex toward each other about the apex 34 when the legs are inserted into the bracket aperture 24 and exert a resilient force against the aperture with the lips 35 and 38 firmly seated on the upper surface of the bracket 18 to lock the clip 12 to the bracket 18 with the headliner therebetween.

10 A pair of retaining fingers 44, 46 extend outwardly and downwardly from the sides of the legs 30 and 32 at apex 34. The retaining fingers 44, 46 are relatively thin, especially when compared to the legs 30 and 32. Preferably, the retaining fingers 44, 46 are longer than the distance from the apex 34 to the lips 35 or 38 so that the retaining fingers are retained against the
15 legs 30 and 32 upon the insertion of the clip 12 into the roof bracket aperture 24. The retaining fingers 44 and 46 are resilient and are normally biased outwardly at an acute angle up to 90° with respect to legs 30 and 32. Also, the clip 12, including retaining fingers 44 and 46, is preferably injection molded as a single piece from a resilient plastic material. Alternatively, the clip can be
20 shaped from a resilient metal such as spring steel.

The locking bezel 14 comprises a decorative cover 50, which hides the mounting clip 12 from view when the locking bezel 14 is secured to the mounting clip 12. As illustrated, the decorative cover 50 has a shape conforming to the contour of the grab handle 16. However, the decorative
25 cover 50 can have any shape depending on the particular application. A pair of spaced locking lugs 52 extend from the inner surface of the decorative cover 50. The locking lug 52 is sized to fit between the legs 30, 32 to prevent them from flexing inwardly toward each other. A single locking lug 52 can be used instead of two locking lugs.

30 A resilient locking finger 54 is disposed between the spaced locking lugs 52 and extends upwardly from the inner surface of the cover 50 and has a locking tab 56 at an outer end thereof. The locking finger 54 is sized so

that it can be flexed inwardly and be received within the slot 36 of the second leg 32. A flat 58 is formed on the locking tab 56 and seats above the lower surface of the clip slot 36. The flat is angled such that the locking finger 54 can be separated from the slot 36 by pulling on the cover 50 with sufficient force.

5 Thus, the finger 54 resiliently retains the locking bezel 14 in locking relationship to the mounting clip 12.

Referring to FIGS. 1 and 2, the grab handle 16 is mounted to the roof sheet metal bracket 18 (or to the vehicle rail sheet metal) by first inserting the mounting clip 12 into the headliner aperture 22 and roof bracket aperture
10 24. As the mounting clip 12 is inserted, the second leg 32 is flexed inwardly with respect to the first leg. Although the first leg 30 is made from resilient material like the second leg 32, the first leg 30 tends to be more rigid than the second leg because it is thicker than the apex 34.

The retaining fingers 44, 46 are used to mount the clip 12 (and the
15 grab handle 16) to the headliner prior to assembly of the headliner 20 to the vehicle. Thus, various accessories can be assembled to the headliner before the headliner is positioned in the vehicle. The clip 12 is inserted into the aperture 22 of the headliner 20 so that the retaining fingers 44, 46 spring behind the headliner 20 as illustrated in FIG. 2. The retaining fingers 44, 46 are relatively
20 light and will not damage the headliner 20 during shipment or assembly. When the headliner 20 is positioned in the vehicle, the clips 12, already properly positioned in the headliner 20 for insertion into the aperture 24, are pushed into place through the apertures 24.

For example, referring to FIG. 3, therein it is illustrated the grab
25 handle 16 of FIG. 1 mounted to the headliner 20 prior to the assembly of the grab handle 16 and headliner 20 the roof sheet metal bracket 18. In the preassembled position, the mounting clip 12 is inserted into the headliner aperture 22 of the headliner 20 a sufficient distant so that the retaining fingers 44 and 46 are biased outwardly by their inherent resiliency and abut the upper
30 surface of the headliner 20 to secure the grab handle 16 to the headliner without relying on the first leg 30 and second leg 32 of the mounting clip. In this manner, the vehicle accessory, such as the grab handle 16, can be mounted

to the vehicle headliner so that the headliner and its vehicle accessories can be shipped and installed as a single unit.

Once the lips 34 and 38 are inserted beyond the roof sheet metal bracket 18, the inherent resiliency of the first leg 30 and second leg 32 biases the legs 30, 32 outwardly to position the lips 34 and 36 above the roof sheet metal bracket 18 adjacent the roof bracket aperture 24. In this position, the lips 34, 36 lock the mounting clip 12 to the bracket. To remove the mounting clip 12, the legs 30, 32 can be squeezed together to position the lips 34, 36 within the perimeter of the roof bracket aperture 24.

The locking bezel 14 is snap-fit to the mounting clip 12 to prevent the inadvertent or unauthorized removal of the mounting clip 12. The locking lugs 52 prevent the first leg 30 and the second leg 32 from being squeezed together while the cover 50 simultaneously performs the function of hiding from view the first leg 30 and second leg 32. To mount the locking bezel 14, the locking bezel 14 is oriented so that the lugs 52 are positioned between the first leg 30 and second leg 32 and the locking finger 54 is aligned with the slot 36 of the mounting clip 12. The locking bezel 14 is then pressed upwardly to insert the locking finger 54 and locking tab 56 within the slot 36. As the locking bezel 14 is moved upwardly, the locking lug 52 abuts the first and second legs 30, 32 to prevent the inward movement of the second leg 32 with respect to leg 30. The locking finger 54 and tab 56 are completely received within the slot 36 to hold the bezel into locking relationship with the clip 12 with the locking tab flat 58 in abutting relationship with the lower surface of the slot 36.

Referring to FIG. 4, there is illustrated a second embodiment of the mounting clip assembly according to the invention. The second embodiment of the mounting clip assembly is illustrated in the same context of a passenger compartment of an automobile. The second embodiment is similar to the first embodiment except that the clip is mechanically fastened to the grab handle instead of being integrally molded therewith. Like numerals are used to identify like parts.

In the second embodiment, the mounting clip assembly 10 is substantially the same as the first embodiment except that the first leg 30 has a base 70 extending substantially perpendicular to the first leg.

The grab handle 16 is similar to the first embodiment except that
5 it has a metal strip 72 molded within and extending from the end of the grab handle 16 and the grab handle 16 has a molded extension 74. The metal strip 72 overlies the molded extension 74. The mounting clip 12 is secured to the grab handle 16 by positioning the base 70 against the metal strip 72 and passing a fastener 76 through grab handle extension 74 and base 72. Once the clip 12 is
10 fastened to the handle 16, the clip is installed in the same manner as described for the first embodiment.

Referring to FIGS. 5 and 6, a mounting clip assembly 110 is illustrated in the context of a grab handle 116. However, it is understood that the mounting clip assembly 110 can be used to mount a variety of accessories to
15 a roof sheet metal bracket and the vehicle headliner of the type as previously illustrated in FIGS. 1-4.

The mounting clip assembly 110 comprises a mounting clip 112 integrally molded with the grab handle 116. Unlike the previously described grab handles, the grab handle 116 has an integrally molded bezel 114 which
20 through a peripheral flange 124 defines an opening 118. A cover 120 is connected to a portion of the bezel 114 by a living hinge 122, whereby the cover can be rotated between a first position where the cover substantially closes the opening 118 and a second position where the cover 120 is displaced from the opening 118.

25 The mounting clip 112 is substantially V-shaped in profile and comprises a first leg 130 and a second leg 132, which meet at an apex 134. The first leg extends from the grab handle 116 to the apex 134 and has a groove 135 that snaps behind the upper surface of a roof sheet metal bracket when the grab handle 116 is mounted to the bracket. The second leg 132 has a lip 138 that
30 snaps into and seats behind the upper surface of a roof sheet metal bracket when the grab handle is mounted to the bracket.

The cover 120 comprises a locking lug 152 positioned in a central portion of the cover 120. Preferably, the locking lug is positioned on the cover 120 so that when the cover is moved to the first position, the lug 152 is positioned between the first leg 130 and the second leg 132 to prevent relative movement of the legs towards each other. The cover 120 also comprises resilient spring tabs 154 positioned at the periphery of the cover 120. The spring tabs are triangle-shaped in cross section and extend beyond the periphery of the cover to snap fit behind the peripheral flange 124 when the cover is in the first position to the lock the cover 120 to the bezel 114.

The mounting clip assembly 110 and its associated accessory, grab handle 116, are mounted to a vehicle in substantially the same manner as described above with respect to the first and second embodiments. Specifically, the mounting clip 112 is inserted into an aperture in the roof sheet metal bracket until the edge of the roof sheet metal bracket defining the aperture is received within the groove 135 of the first leg 130 and the lip 138 of the second leg 132 is seated against the upper surface of the roof sheet metal bracket. In this position, the clip 112 is secured to the roof sheet metal bracket. However, the clip 112 can be removed by moving the second leg 132 toward the first leg 130 until the clip 138 is unseated from the upper surface of the roof sheet metal bracket. To prevent such movement, the cover 120 is rotated about the living hinge 122 to insert the locking lug 152 between the first and second legs 130, 132. The cover 120 is pressed toward the legs 130, 132 until the spring tabs snap in place with respect to the bezel 114 to secure the cover 120 to the bezel and close the opening 118.

The V-shape construction of the invention advantageously provides a clip that is lockable with a bezel having only a single locking lug. The single locking lug prevents the movement of both legs along with positioning the bezel. The combination of the V-shaped clip and the single locking lug is a significant simplification over the prior art and a reduction in the relative cost and manufacturing complexity.

While particular embodiments of the invention have been shown, it will be understood, of course, that the invention is not limited thereto since

modifications may be made by those skilled in the art, particularly in light of the foregoing teachings. Reasonable variation and modification are possible within the scope of the foregoing disclosure of the invention without departing from the spirit of the invention.

Claims

The embodiments of the invention in which an exclusive property or privilege is claimed are defined as follows:

1. A mounting clip assembly adapted to mount an accessory to a support structure, the mounting clip assembly comprising:
a mounting clip comprising:
first and second legs resiliently joined at one end to define
5 an apex, the legs diverging from the apex to form a gap therebetween at another end,
one of the first and second legs having a free end and the other of the first and second leg adapted to mount the accessory,
the first and second legs having lips adapted to pass
10 through an aperture in the support structure and seat on an upper surface of the support structure to lock the clip to the support structure; and
a bezel having a cover and at least one upstanding lug adapted to extend into the gap between the first and second legs to prevent the legs from moving toward each other and, thus, the inadvertent removal of the
15 clip from the support structure.
2. A mounting clip assembly according to claim 1 wherein one of the first and second legs has a slot with a bottom surface, and the bezel further comprising a locking finger projecting upwardly from the cover and having a locking tab that projects laterally behind the bottom surface of the leg
5 slot.
3. A mounting clip assembly according to claim 2 wherein the locking finger is resilient to flex when the lug and the finger are inserted into the gap of the clip.
4. A mounting clip assembly according to claim 3 wherein the locking finger has a slanted flat, which engages the bottom surface of the slot, to

facilitate removal of the bezel from the clip when the bezel is pulled away from the clip.

5. A mounting clip assembly according to claim 1 wherein the clip has at least one resilient retaining finger that projects outwardly and downwardly from a side of the first and second legs and is adapted to mount the clip to a headliner.

6. A mounting clip assembly according to claim 5 wherein there are two retaining fingers on different sides of the first and second legs.

7. A mounting clip assembly according to claim 6 wherein the resilient fingers are mounted at the apex of the legs.

8. A mounting clip assembly according to claim 1 wherein the clip is integrally molded with an accessory.

9. A mounting clip assembly according to claim 1 wherein the clip is connected to an accessory by a mechanical connector.

10. A mounting clip assembly according to claim 9 wherein the mechanical connector is a rivet.

11. A mounting clip assembly according to claim 1 wherein the bezel is integrally molded to an accessory and through a peripheral flange defines an opening providing access to the mounting clip.

12. A mounting clip assembly according to claim 11 further comprising a living hinge mounting the cover to the peripheral flange of the bezel for moving the cover between a first position where it closes the opening and a second position displaced from the opening.

13. A mounting clip assembly according to claim 12 wherein the cover further comprises at least one tab at the periphery of the cover to snap behind the peripheral flange to lock the cover to the bezel.

14. An accessory mounting comprising:

a structural support with an upper and lower surface and at least one aperture extending through the structural support;

an accessory;

5 a mounting clip comprising:

first and second legs resiliently joined at one end to define an apex, the legs diverging from the apex to form a gap therebetween at another end,

10 one of the first and second legs having a free end and the other of the first and second legs mounted to the accessory,

the first and second legs having lips adapted to pass through the support structure aperture and seat on the upper surface of the support structure to lock the clip to the support structure; and

15 a bezel having a cover and at least one upstanding lug adapted to extend into the gap between the first and second legs to prevent the legs from moving toward each other and, thus, the inadvertent removal of the clip from the support structure.

15. A mounting clip assembly according to claim 14 wherein one of the first and second legs has a slot with a bottom surface, and the bezel further comprising a locking finger projecting upwardly from the cover and having a locking tab that projects laterally behind the bottom surface of the leg
5 slot.

16. A mounting clip assembly according to claim 15 wherein the locking finger is resilient to flex when the lug and the finger are inserted into the gap of the clip.

17. A mounting clip assembly according to claim 16 wherein the locking finger has an slanted flat to facilitate removal of the bezel from the clip when the bezel is pulled away from the clip.

18. A mounting clip assembly according to claim 14 wherein the clip has at least one resilient retaining finger that projects outwardly and downwardly from a side of the first and second legs and adapted to mount the clip to a headliner.

19. A mounting clip assembly according to claim 18 wherein there are two resilient fingers on different sides of the first and second legs.

20. A mounting clip assembly according to claim 19 wherein the resilient fingers are mounted at the apex of the legs.

21. A mounting clip assembly adapted to mount an accessory to a headliner with an aperture, the mounting clip assembly comprising:

a mounting clip having first and second legs and adapted to mount the accessory; and

5 at least one resilient retaining finger, which projects outwardly and downwardly from a side of the first and second legs for mounting the clip to the headliner whereby when the clip is inserted into the headliner aperture, the retaining finger is adapted to abut an upper surface of the headliner to mount the clip to the headliner.

22. A mounting clip assembly according to claim 21 wherein there are two resilient fingers, each on a different side of the first and second legs.

2/3

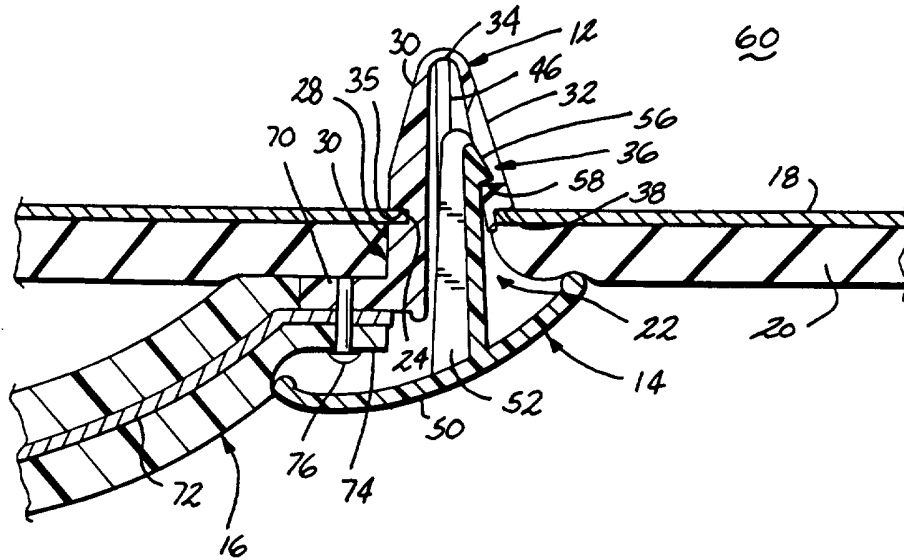

Fig. 4

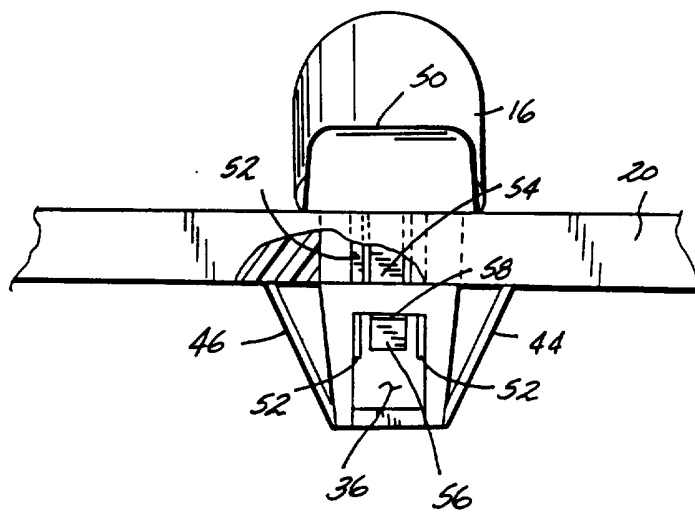
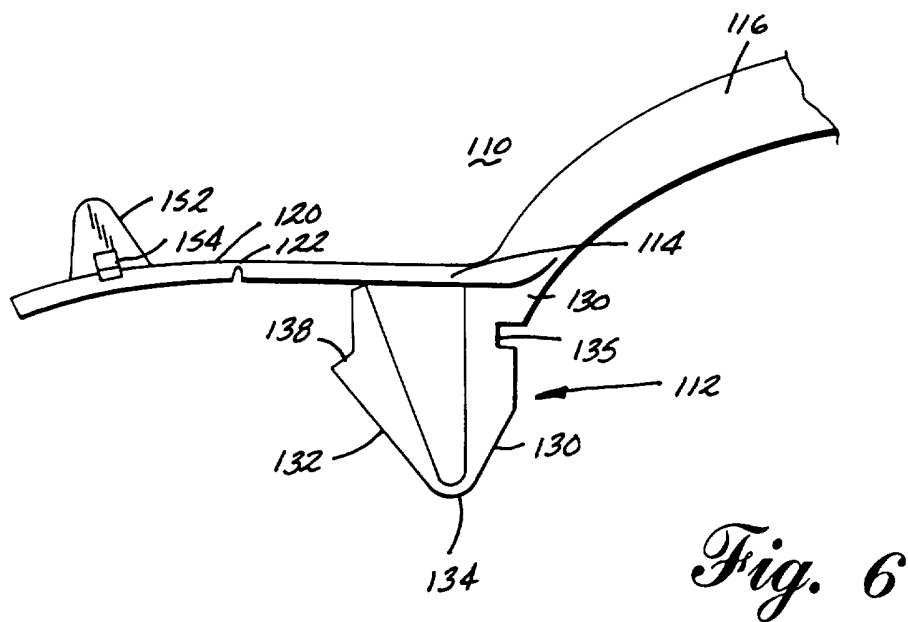
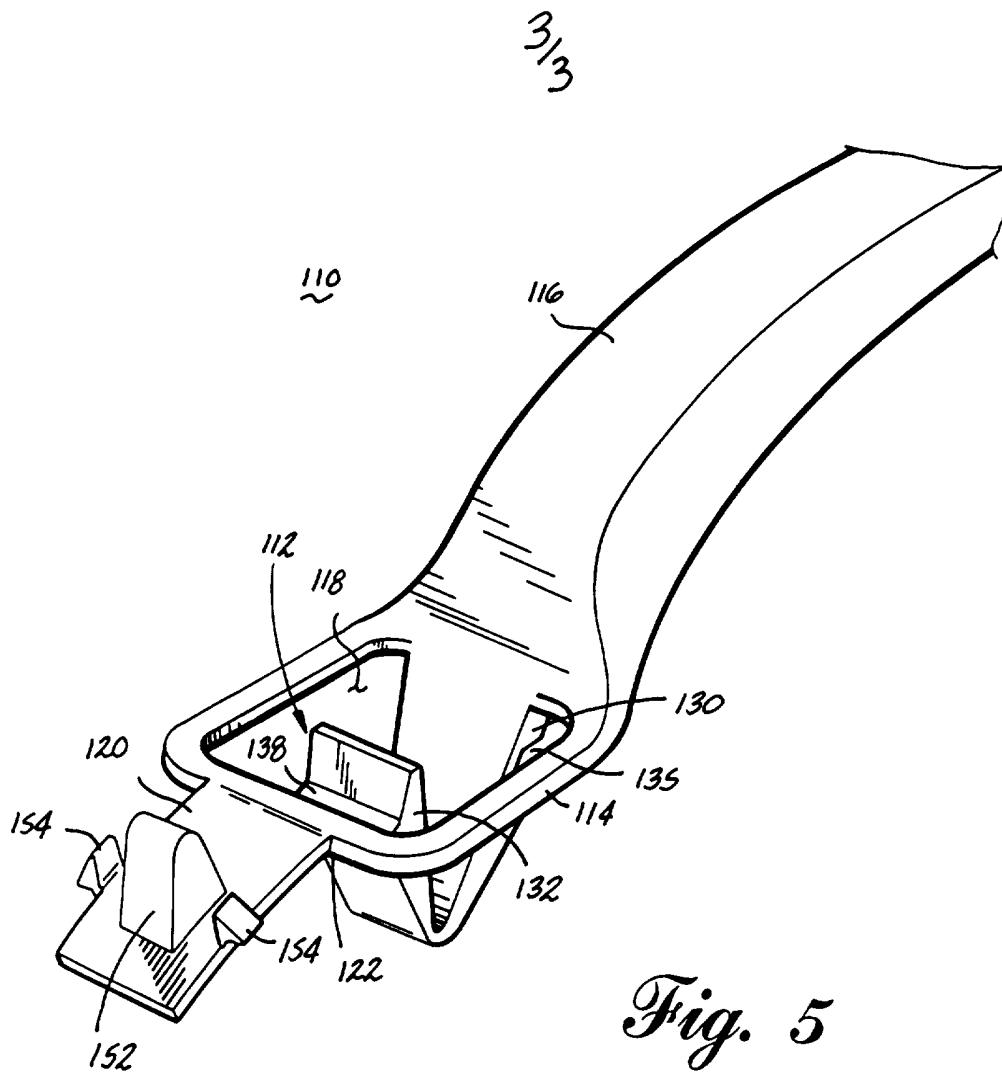

Fig. 3



INTERNATIONAL SEARCH REPORT

Inter J Application No
PCT/US 95/15705

A. CLASSIFICATION OF SUBJECT MATTER
IPC 6 F16B21/08 B60N3/02 F16B5/06

According to International Patent Classification (IPC) or to both national classification and IPC

B. FIELDS SEARCHED

Minimum documentation searched (classification system followed by classification symbols)
IPC 6 F16B B60N B60J

Documentation searched other than minimum documentation to the extent that such documents are included in the fields searched

Electronic data base consulted during the international search (name of data base and, where practical, search terms used)

C. DOCUMENTS CONSIDERED TO BE RELEVANT

| Category * | Citation of document, with indication, where appropriate, of the relevant passages | Relevant to claim No. |
|------------|---|-----------------------------|
| A | FR,A,1 381 705 (ILLINOIS TOOL WORKS INC.) 14 December 1964 see the whole document --- | 1,12,14, 21 |
| A | US,A,4 517 711 (TANAKA) 21 May 1985 cited in the application see column 2, line 44 - column 4, line 34; figures 1-5 --- | 1,12,14, 21 |
| A | FR,A,2 259 273 (SONOFAM) 22 August 1975 see page 3, line 24 - line 34; figures 1-5 --- | 1,14,21 |
| A | FR,A,2 385 931 (ALL STATES PLASTIC MANUFACTURING COMPANY) 27 October 1978 see page 2, line 28 - line 30; figures 1-7 ----- | 1,5,6,8, 18,19, 21,22 |

Further documents are listed in the continuation of box C.

Patent family members are listed in annex.

* Special categories of cited documents :

- *A* document defining the general state of the art which is not considered to be of particular relevance
- *E* earlier document but published on or after the international filing date
- *L* document which may throw doubts on priority claim(s) or which is cited to establish the publication date of another citation or other special reason (as specified)
- *O* document referring to an oral disclosure, use, exhibition or other means
- *P* document published prior to the international filing date but later than the priority date claimed

- *T* later document published after the international filing date or priority date and not in conflict with the application but cited to understand the principle or theory underlying the invention
- *X* document of particular relevance; the claimed invention cannot be considered novel or cannot be considered to involve an inventive step when the document is taken alone
- *Y* document of particular relevance; the claimed invention cannot be considered to involve an inventive step when the document is combined with one or more other such documents, such combination being obvious to a person skilled in the art.
- *&* document member of the same patent family

Date of the actual completion of the international search

29 February 1996

Date of mailing of the international search report

08.03.96

Name and mailing address of the ISA

European Patent Office, P.B. 5818 Patentlaan 2
NL - 2280 HV Rijswijk
Tel. (+ 31-70) 340-2040, Tx. 31 651 epo nl,
Fax: (+ 31-70) 340-3016

Authorized officer

Calamida, G

INTERNATIONAL SEARCH REPORT

Information on patent family members

| | |
|-----------------|------------------|
| Inter | J Application No |
| PCT/US 95/15705 | |

| Patent document cited in search report | Publication date | Patent family member(s) | Publication date |
|--|------------------|-------------------------|------------------|
| FR-A-1381705 | 22-03-65 | GB-A- 1051265 | |
| US-A-4517711 | 21-05-85 | NONE | |
| FR-A-2259273 | 22-08-75 | NONE | |
| FR-A-2385931 | 27-10-78 | US-A- 4143577 | 13-03-79 |
| | | BE-A- 865150 | 17-07-78 |
| | | CA-A- 1112917 | 24-11-81 |
| | | DE-A- 2812155 | 02-11-78 |
| | | GB-A- 1576589 | 08-10-80 |
| | | JP-A- 53118808 | 17-10-78 |
| | | NL-A- 7802888 | 02-10-78 |