



US010165644B2

(12) **United States Patent**  
**Li**

(10) **Patent No.:** **US 10,165,644 B2**  
(45) **Date of Patent:** **Dec. 25, 2018**

(54) **CONTROL FEATURES OF IMITATION CANDLE DEVICES**

(71) Applicant: **Xiaofeng Li**, Shenzhen (CN)

(72) Inventor: **Xiaofeng Li**, Shenzhen (CN)

(\* ) Notice: Subject to any disclaimer, the term of this patent is extended or adjusted under 35 U.S.C. 154(b) by 0 days.

(21) Appl. No.: **15/860,530**

(22) Filed: **Jan. 2, 2018**

(65) **Prior Publication Data**

US 2018/0132326 A1 May 10, 2018

**Related U.S. Application Data**

(63) Continuation of application No. 15/418,451, filed on Jan. 27, 2017, now Pat. No. 9,860,953, which is a (Continued)

(30) **Foreign Application Priority Data**

Apr. 25, 2016 (CN) ..... 2016 1 0261921

(51) **Int. Cl.**  
**H05B 33/08** (2006.01)  
**F21S 9/02** (2006.01)  
(Continued)

(52) **U.S. Cl.**  
CPC ..... **H05B 33/0854** (2013.01); **F21S 6/001** (2013.01); **F21S 9/02** (2013.01);  
(Continued)

(58) **Field of Classification Search**  
CPC ..... H05B 33/0815; H05B 33/0818; H05B 33/0845; H05B 33/0809; H05B 33/0848;  
(Continued)

(56) **References Cited**

U.S. PATENT DOCUMENTS

6,491,516 B1 \* 12/2002 Tal ..... A47G 33/00  
273/147  
2004/0089289 A1 5/2004 Tingley  
(Continued)

FOREIGN PATENT DOCUMENTS

CN 201093300 7/2008  
CN 204268356 4/2015  
(Continued)

OTHER PUBLICATIONS

Office Action in German Patent Application No. 102016008225.9, dated Dec. 19, 2016.

(Continued)

*Primary Examiner* — Douglas W Owens

*Assistant Examiner* — Syed M Kaiser

(74) *Attorney, Agent, or Firm* — Perkins Coie LLP

(57) **ABSTRACT**

Devices and methods for facilitating the operations and usage of electronic candle devices are disclosed. In one exemplary aspect, an imitation candle device is disclosed. The imitation candle device comprises a body; a flame element protruding from top of the body; one or more light sources positioned to illuminate the flame element to produce an appearance of a true fire flame; a plurality of touch sensitive segments positioned on, or embedded in, a peripheral section of the body, wherein each of the plurality of touch sensitive segments is operable to produce an electrical signal in response to sensing a touch; and an electronic control circuitry operable to receive the electrical signal produced in response to sensing the touch by one or more of the plurality of touch sensitive segments and to control at least an output of the one or more light sources based on the electrical signal.

**20 Claims, 16 Drawing Sheets**

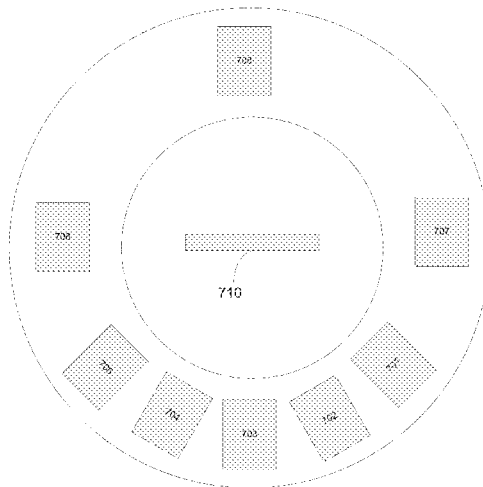

**Related U.S. Application Data**

continuation-in-part of application No. 15/145,739, filed on May 3, 2016, now Pat. No. 9,605,824.

(51) **Int. Cl.**

**F21S 6/00** (2006.01)  
**H05B 37/02** (2006.01)  
**F21S 10/04** (2006.01)  
**F21Y 115/10** (2016.01)  
**F21W 121/00** (2006.01)

(52) **U.S. Cl.**

CPC ..... **F21S 10/04** (2013.01); **F21S 10/046** (2013.01); **H05B 33/0845** (2013.01); **H05B 33/0857** (2013.01); **H05B 37/0227** (2013.01); **H05B 37/0236** (2013.01); **H05B 37/0272** (2013.01); **H05B 37/0281** (2013.01); **F21W 2121/00** (2013.01); **F21Y 2115/10** (2016.08)

(58) **Field of Classification Search**

CPC ..... H05B 33/0896; H05B 37/0272; H05B 37/022  
USPC ..... 315/291, 294, 307  
See application file for complete search history.

(56) **References Cited**

U.S. PATENT DOCUMENTS

2005/0007779 A1\* 1/2005 Nozawa ..... F21S 10/04  
362/253  
2006/0192503 A1\* 8/2006 Trombetta ..... F21S 6/001  
315/308  
2008/0117634 A1 5/2008 Wong  
2008/0151571 A1 6/2008 Chen  
2009/0213597 A1 8/2009 Nelkin  
2010/0207538 A1 8/2010 Chen  
2011/0000666 A1\* 1/2011 Couto ..... F22B 1/1853  
166/272.3  
2011/0195787 A1\* 8/2011 Wells ..... G07F 9/026  
463/42  
2012/0093491 A1 4/2012 Browder et al.  
2013/0050985 A1\* 2/2013 Kwok ..... F21S 6/001  
362/96  
2014/0035483 A1\* 2/2014 Becker ..... F21S 9/02  
315/294  
2014/0042916 A1 2/2014 Gutstein  
2014/0140042 A1 5/2014 Schreiber

2014/0286024 A1 6/2014 Li  
2014/0198949 A1\* 7/2014 Garlington ..... G03B 21/10  
382/103  
2014/0268652 A1 9/2014 Li  
2015/0070874 A1 3/2015 Beesley  
2016/0029461 A1 1/2016 Noh et al.  
2016/0057829 A1\* 2/2016 Li ..... H05B 33/0827  
315/313  
2016/0150624 A1\* 5/2016 Meerbeek ..... H05B 33/0863  
315/297  
2016/0153650 A1\* 6/2016 Chien ..... F21V 33/0004  
362/253  
2017/0118815 A1\* 4/2017 Altamura ..... H05B 33/0863  
2017/0155750 A1\* 6/2017 Li ..... H04M 1/7253  
2017/0191632 A1\* 7/2017 Li ..... F21S 10/043

FOREIGN PATENT DOCUMENTS

DE 212011100014 4/2012  
DE 202015000490 3/2013  
DE 202013012047 2/2015  
DE 202015102274 5/2015  
EP 1639291 5/2009  
GB 2267746 12/1993  
GB 2443926 5/2008  
GB 2527626 12/2015  
WO WO2012099718 7/2012  
WO WO2013020439 2/2013  
WO WO2014139483 9/2014  
WO WO2015061623 4/2015  
WO WO2016000517 1/2016

OTHER PUBLICATIONS

Examination Report in Canadian Patent Application No. 2930099, dated Jan. 5, 2017.  
Examination Report in Canadian Patent Application No. 2930099, dated Aug. 15, 2016.  
Combined Search and Examination Report in British Patent Application No. 1613387.8, dated Sep. 9, 2016.  
Examination Report in Canadian Patent Application No. 2936225, dated Sep. 29, 2016.  
Office Action in German Patent Application No. 102016008825.7, dated Mar. 20, 2017.  
Combined Search and Examination Report in British Patent Application No. 1613393.6, dated Sep. 9, 2016.  
Search Report in Dutch Patent Application No. 2018661, dated Feb. 8, 2018.

\* cited by examiner

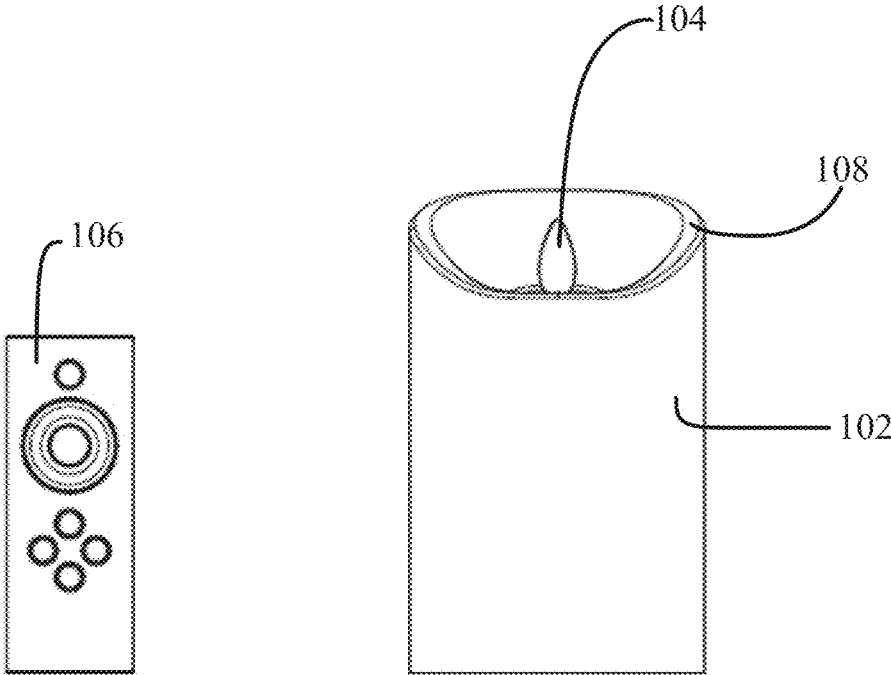

FIG. 1

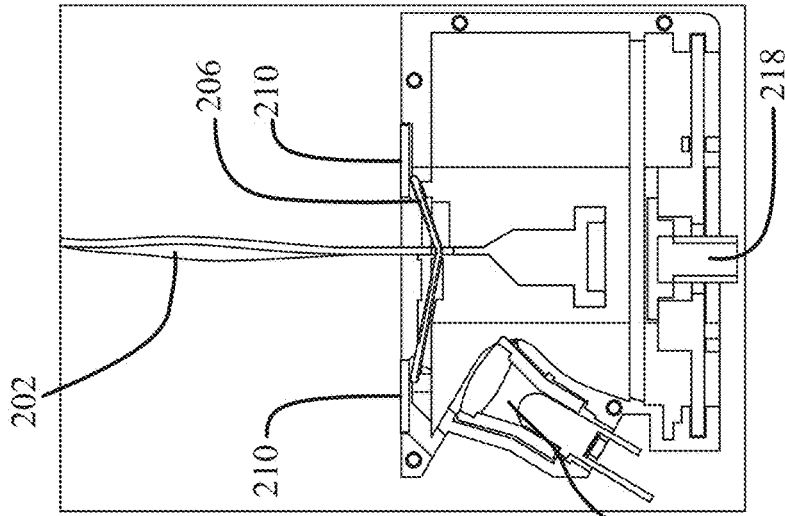

FIG. 2C

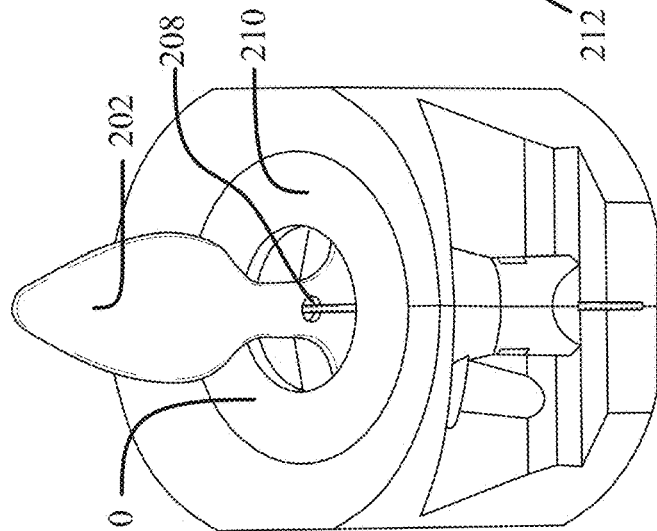

FIG. 2B

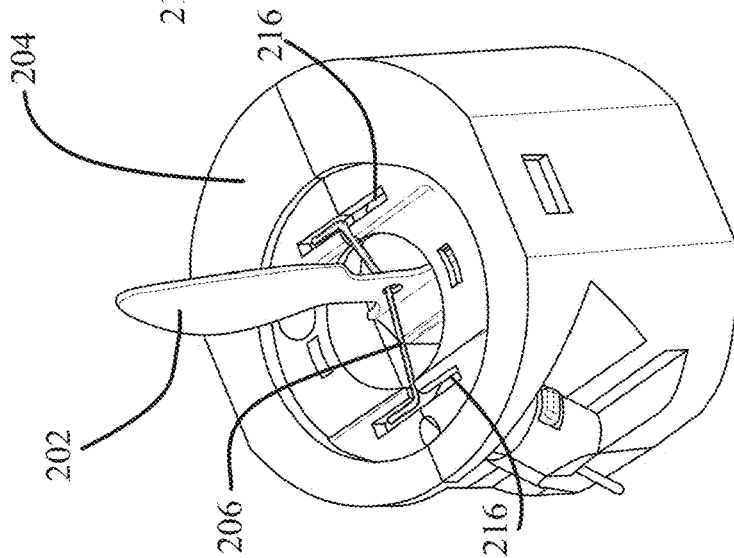

FIG. 2A

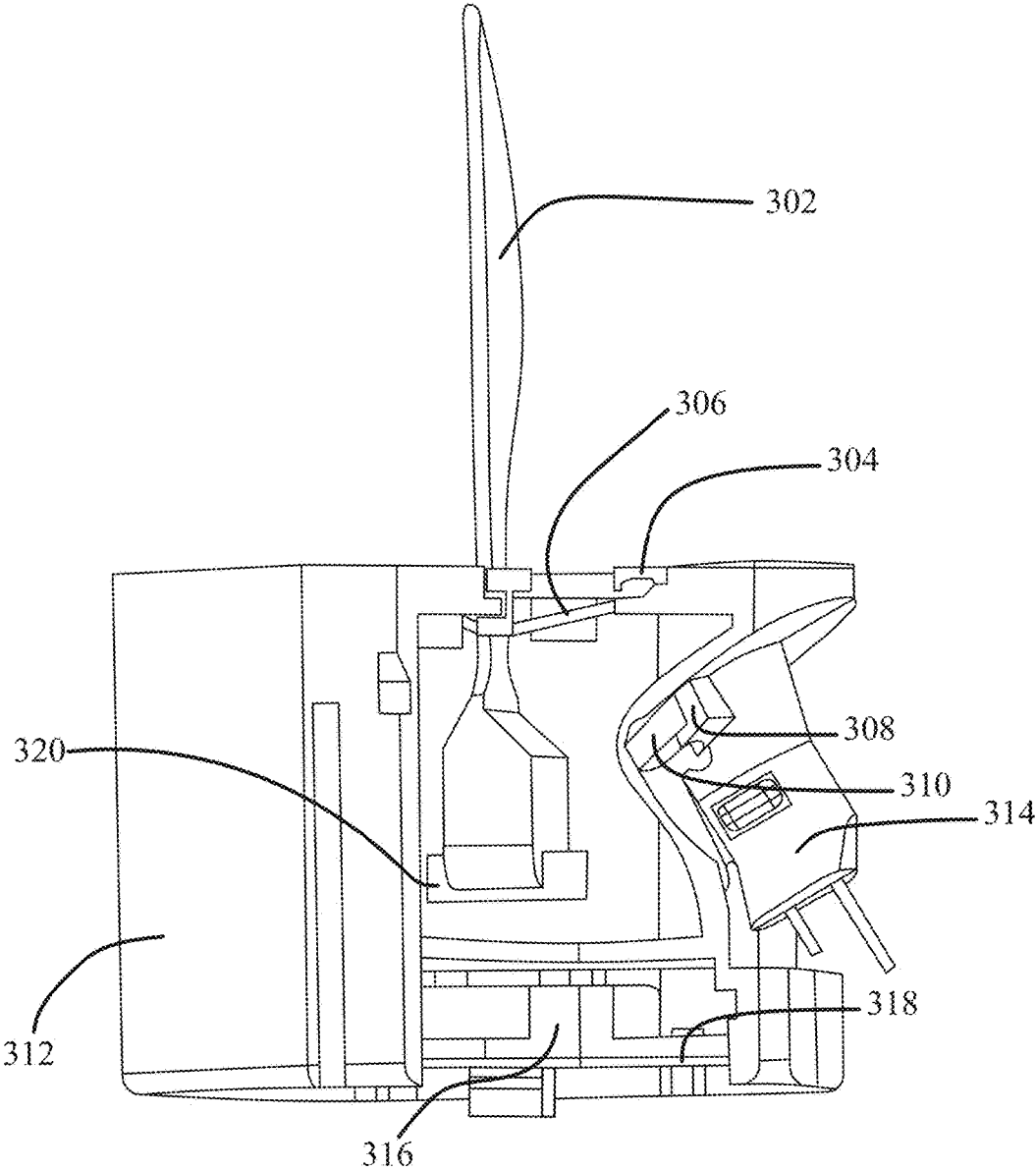

FIG. 3

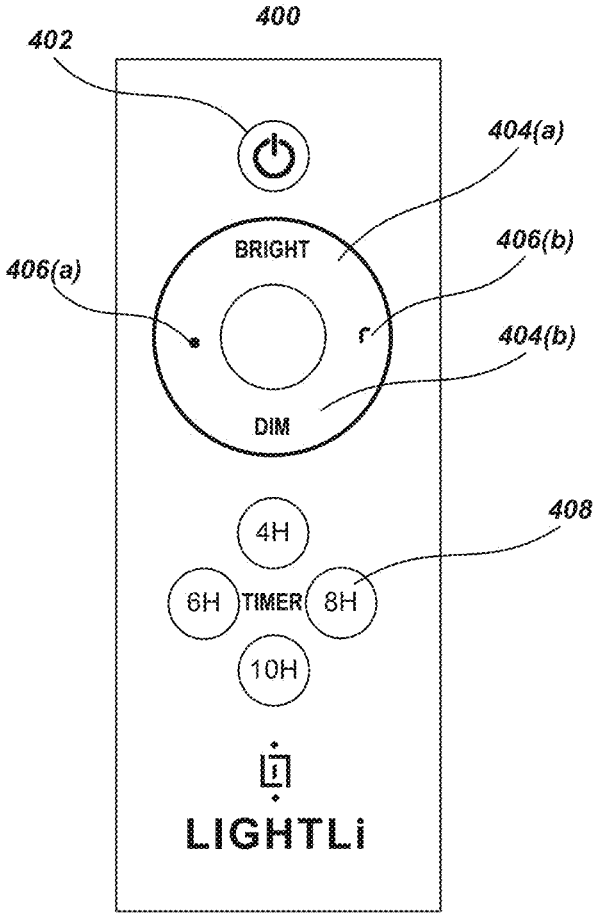

FIG. 4A

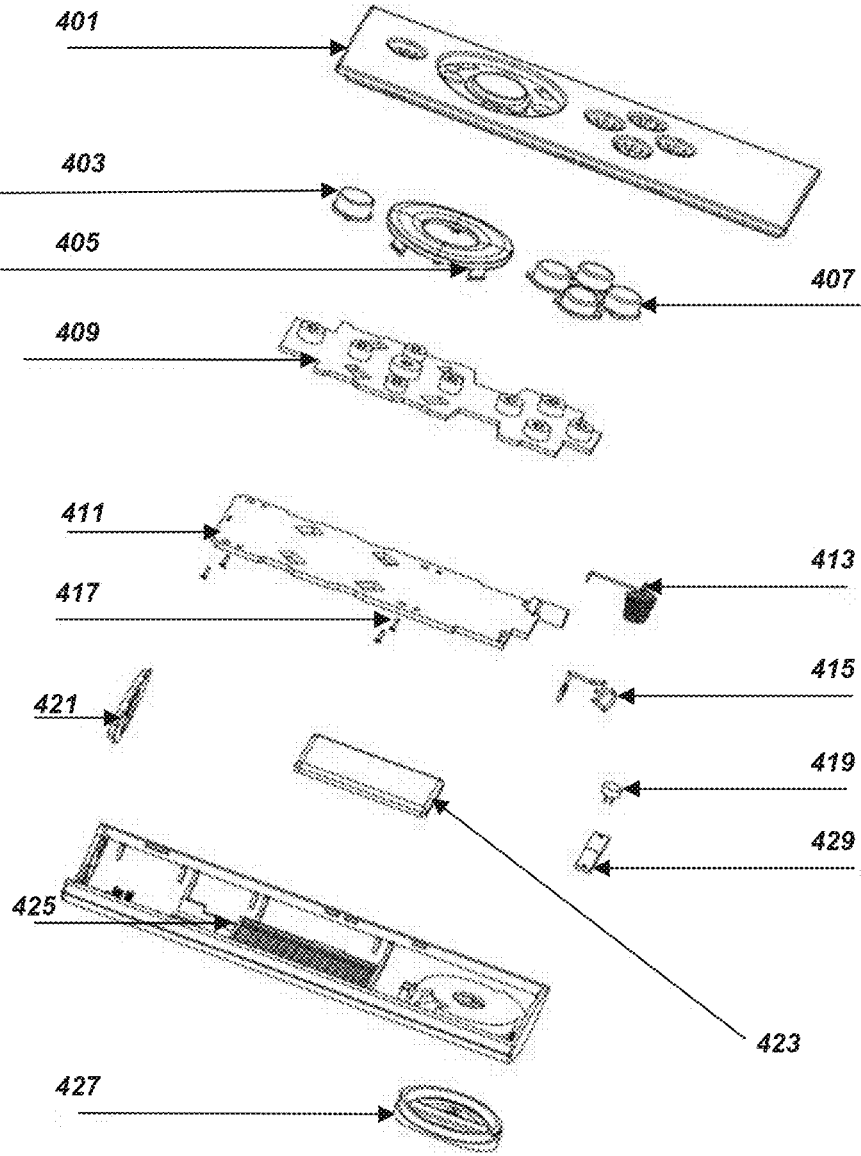

FIG. 4B

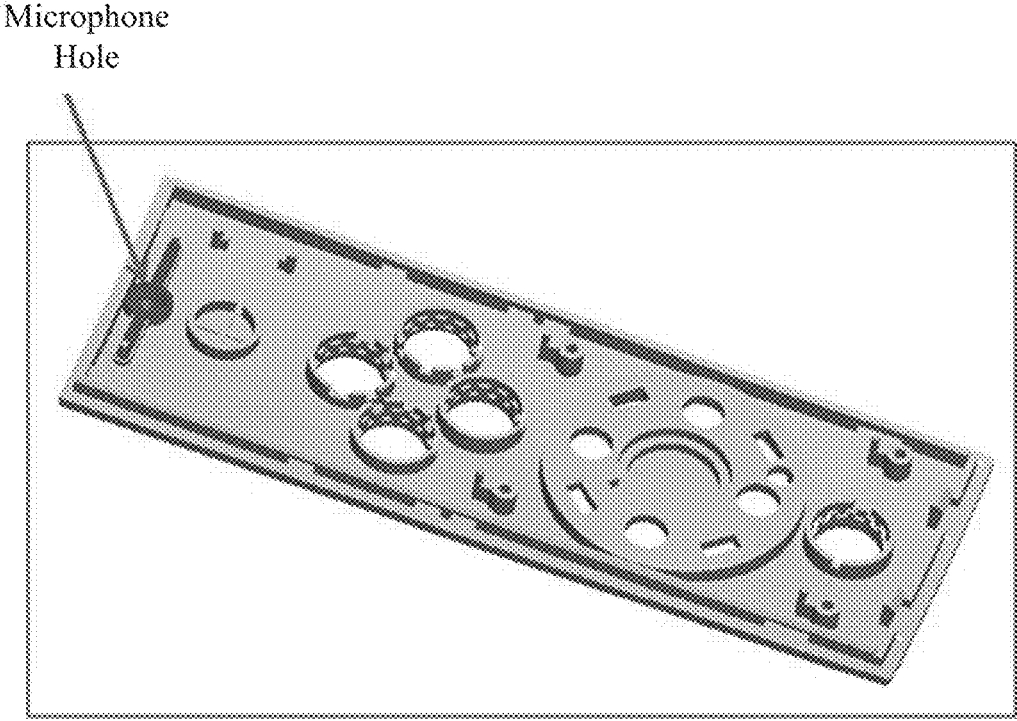

FIG. 4C

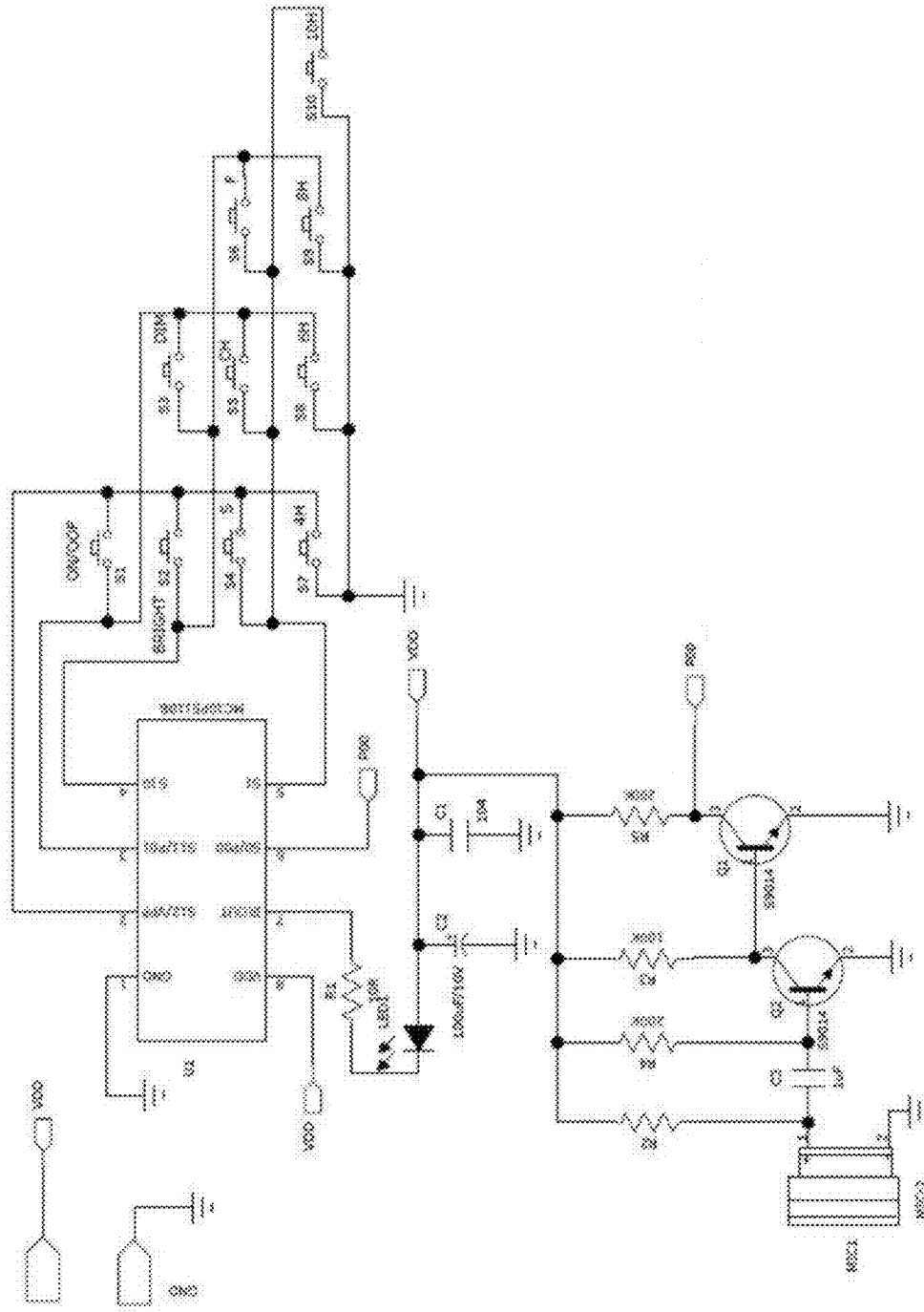
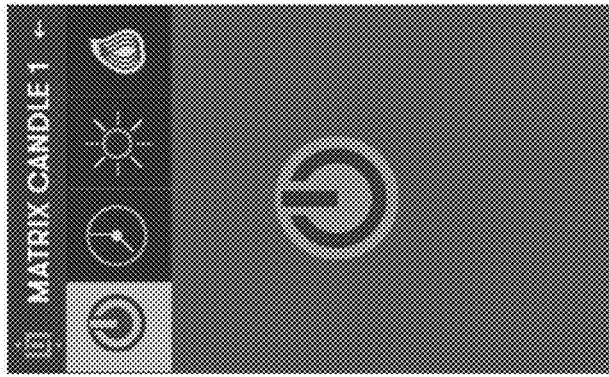
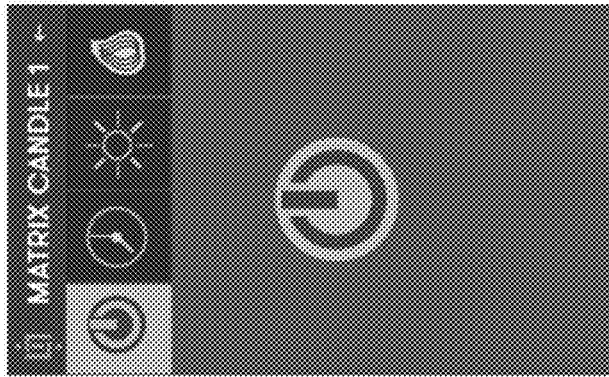

FIG. 4D



Turn Candle  
On or Off



Power On-Off  
Selection

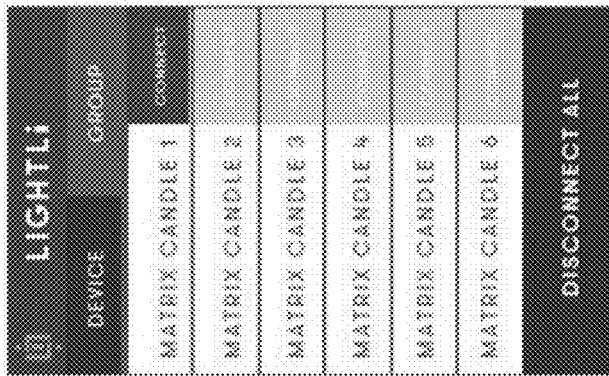

Device  
Selection

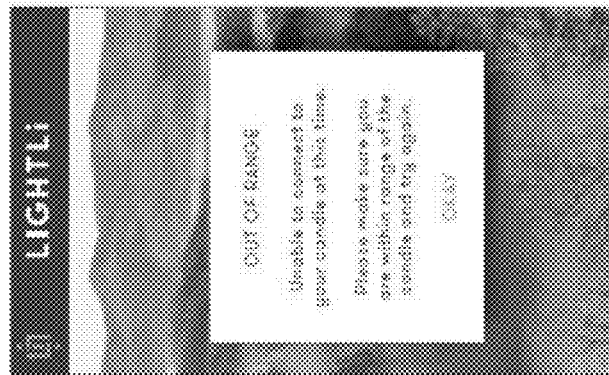

Connection  
Failure

FIG. 5A

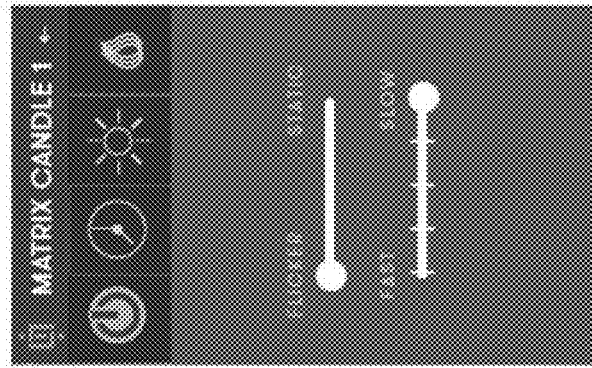

Flame  
Movement  
Selection

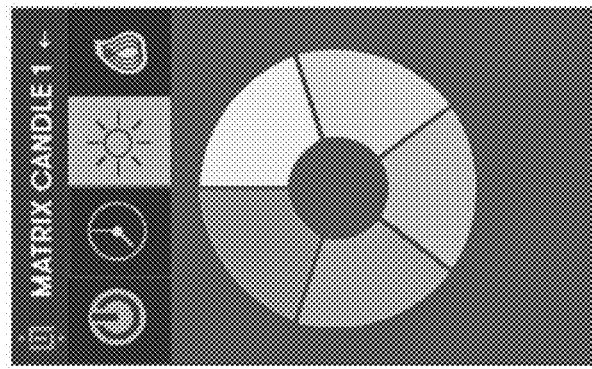

Light Intensity  
Selection

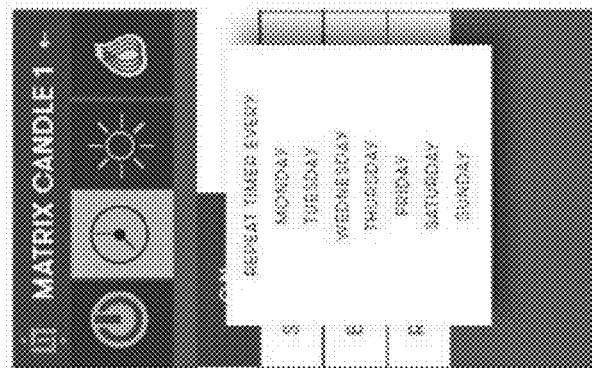

Timer Settings

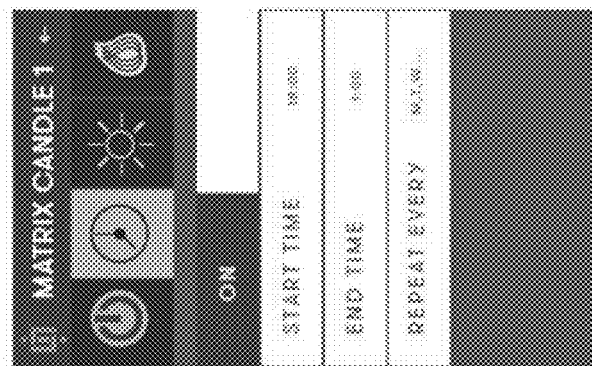

Timer  
Selection

FIG. 5B

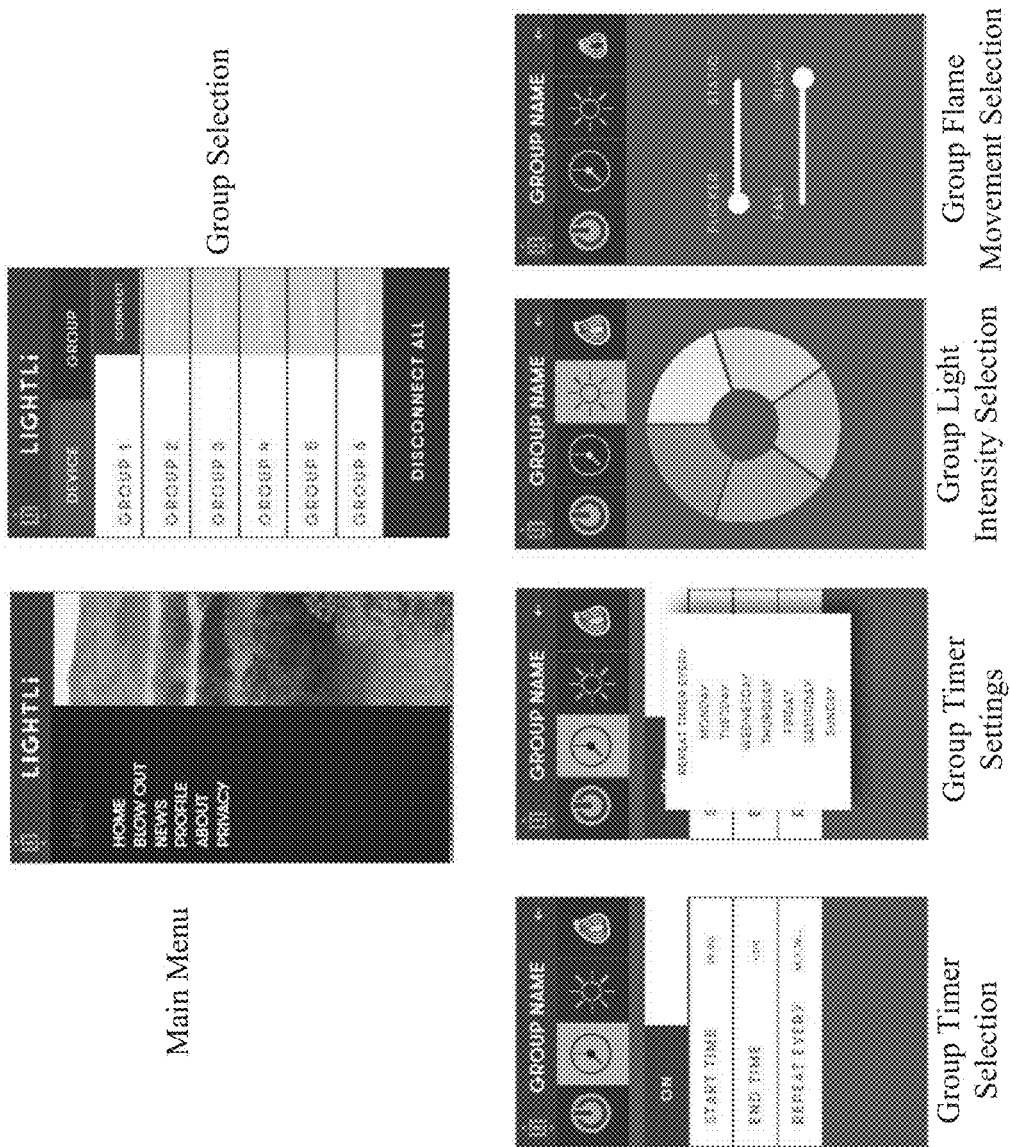

FIG. 5C

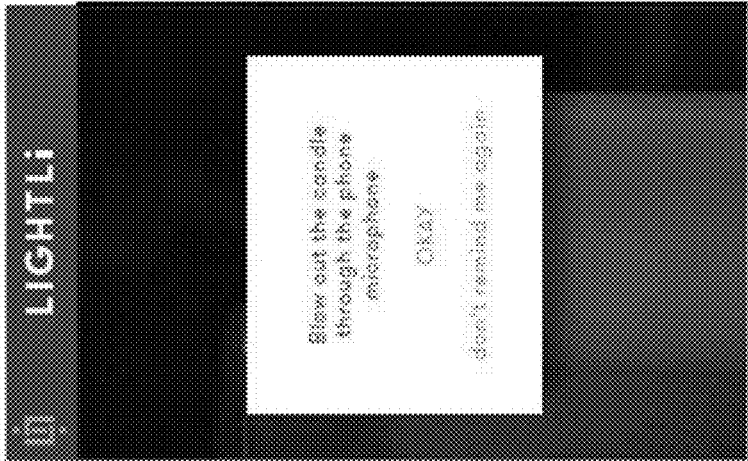

FIG. 5D

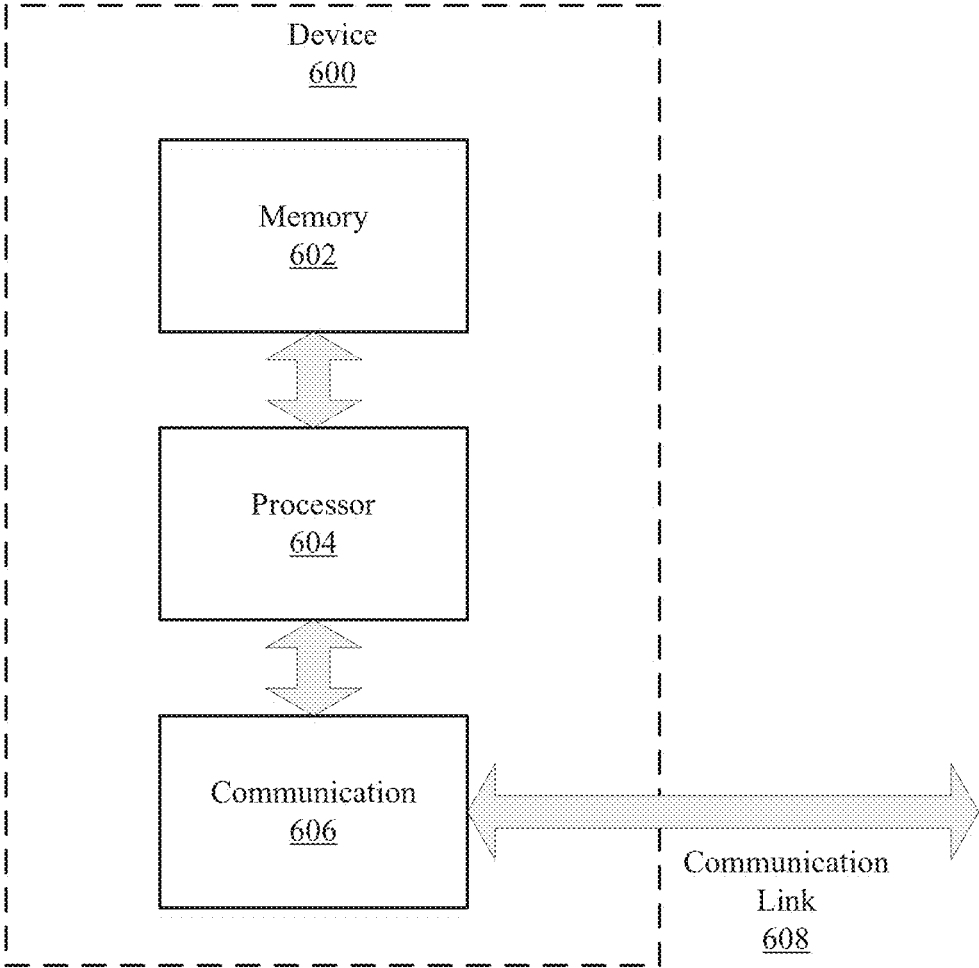

FIG. 6

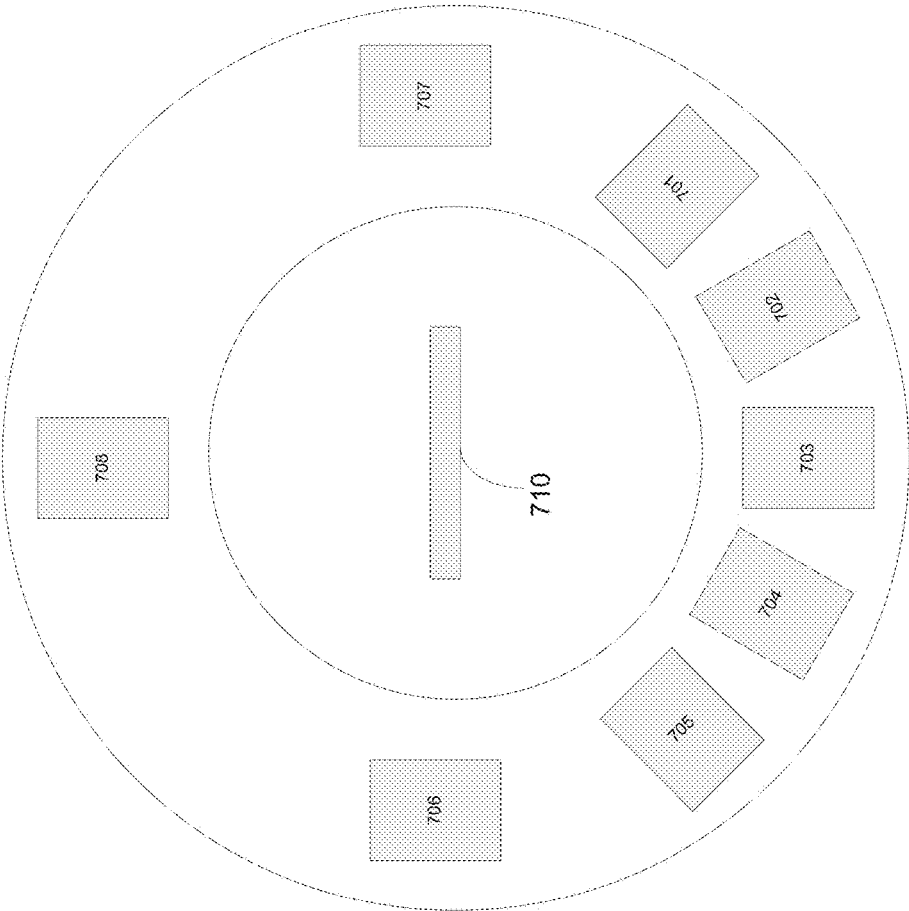

FIG. 7A

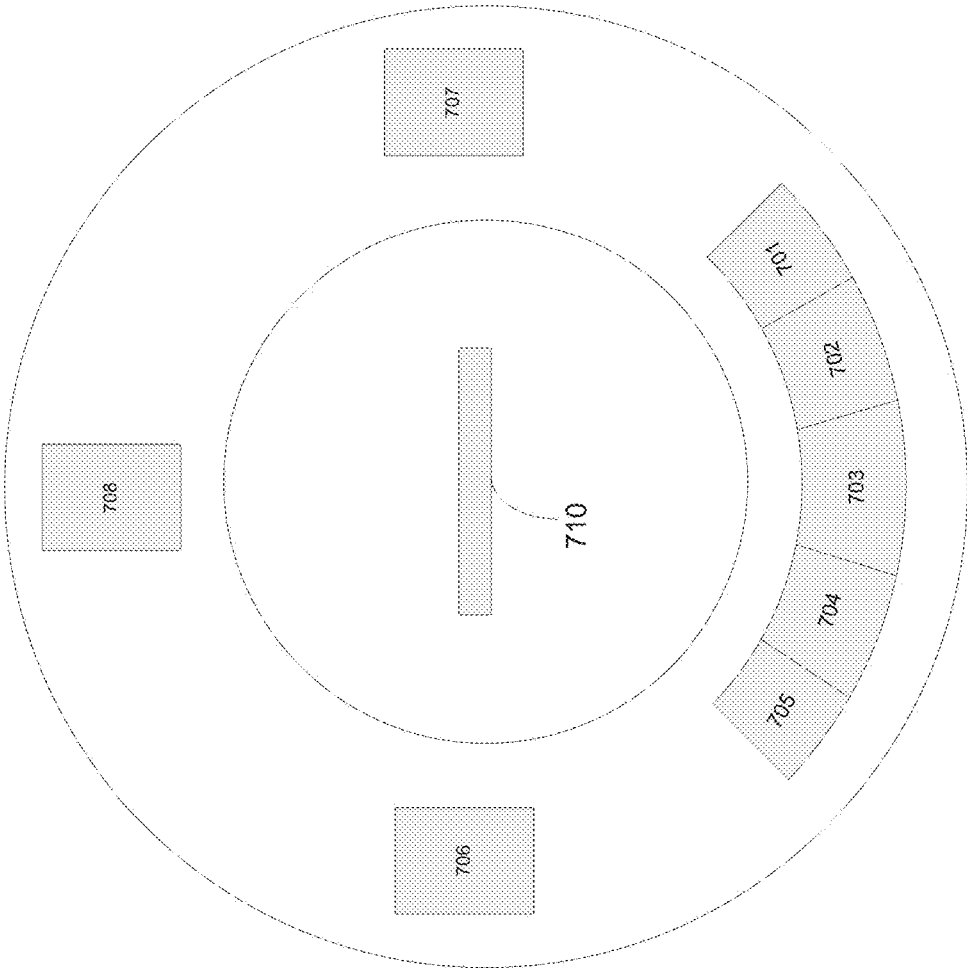

FIG. 7B

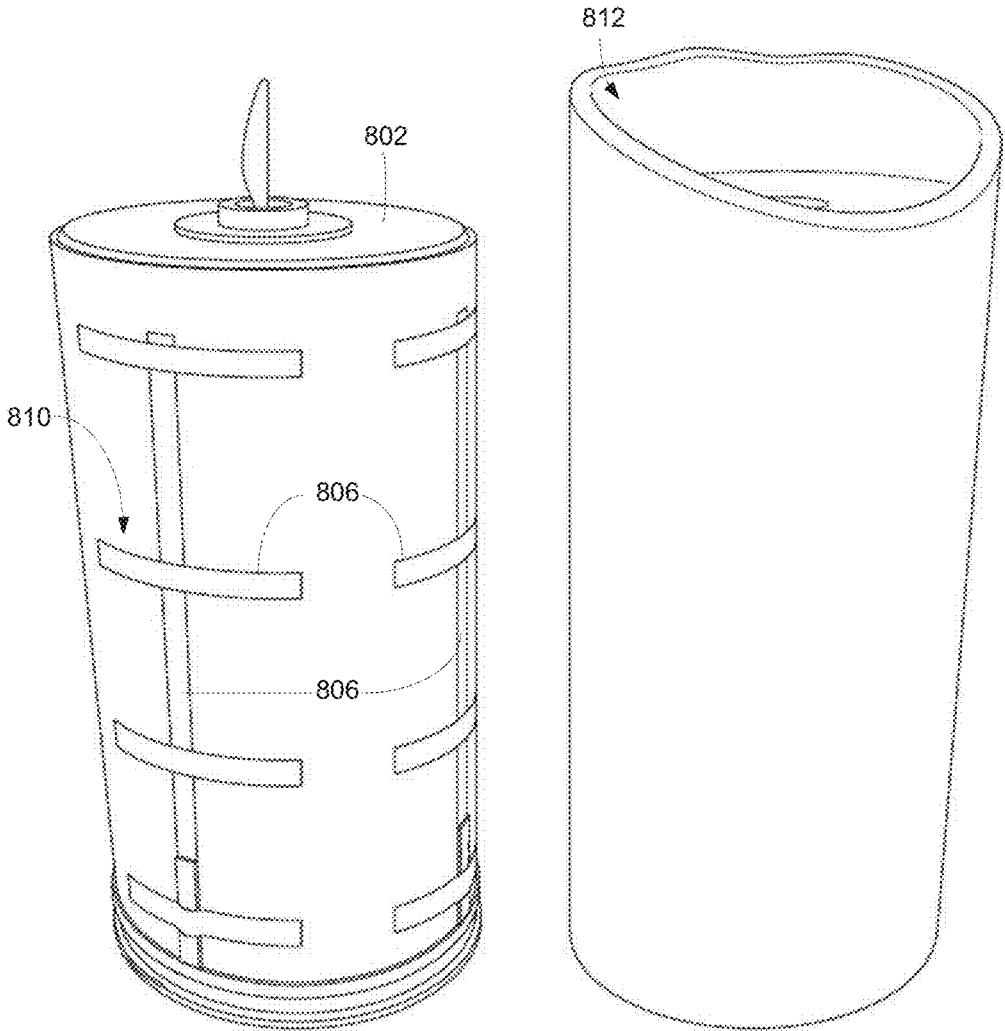

FIG. 8A

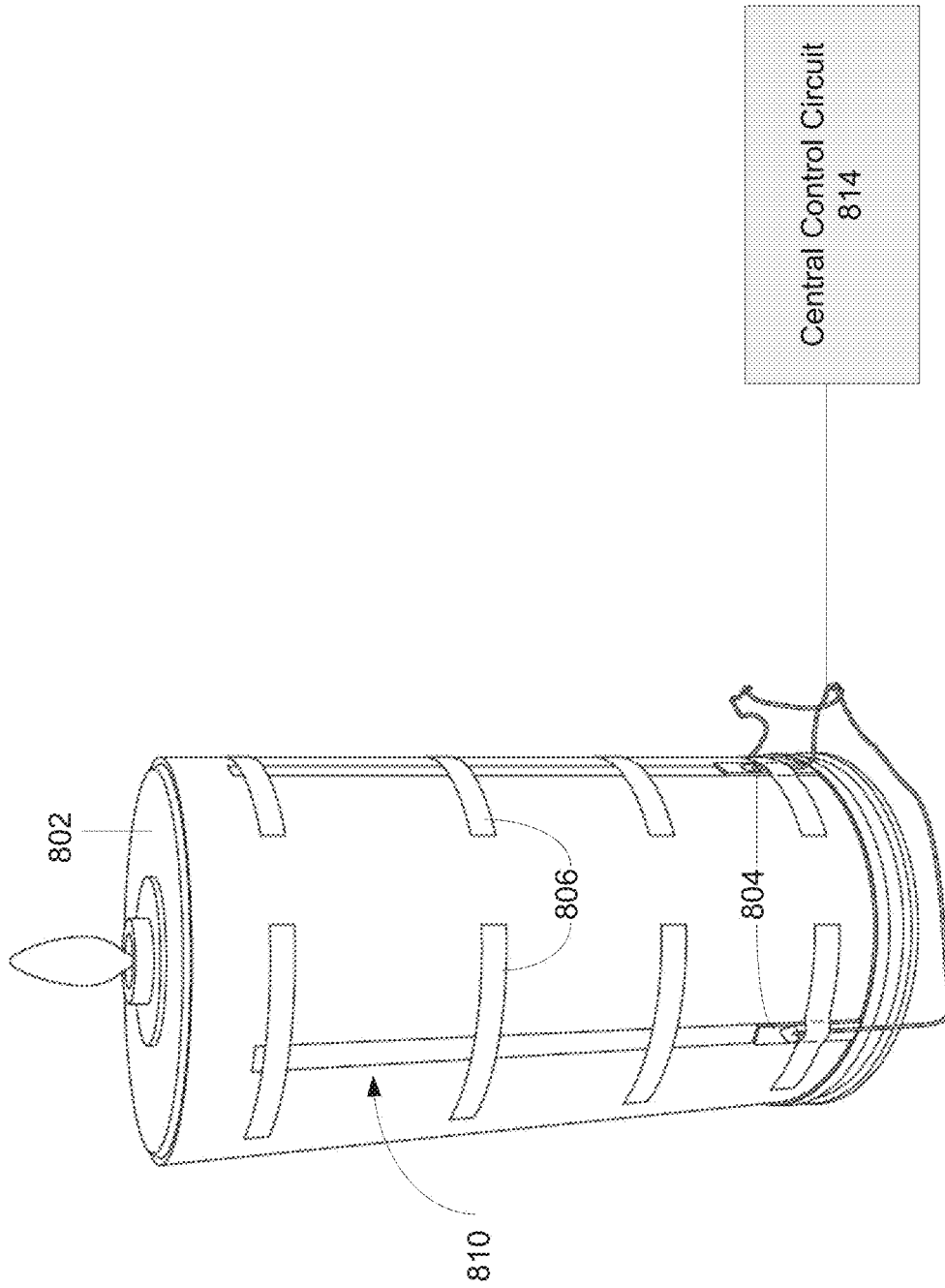

FIG. 8B

## CONTROL FEATURES OF IMITATION CANDLE DEVICES

### CROSS-REFERENCE TO RELATED APPLICATIONS

This application is a continuation of U.S. patent application Ser. No. 15/418,451, filed Jan. 27, 2017, now U.S. Pat. No. 9,860,953, entitled "CONTROL FEATURES OF IMITATION CANDLE DEVICES," which is a continuation-in-part of U.S. patent application Ser. No. 15/145,739 filed May 3, 2016, now U.S. Pat. No. 9,605,824, entitled "IMITATION CANDLE DEVICE WITH ENHANCED CONTROL FEATURES," which claims the benefits and priorities of Chinese patent application no. CN201610261921.2 filed on Apr. 25, 2016. The entire contents of the before mentioned patent applications are incorporated by reference in this patent document.

### TECHNICAL FIELD

The subject matter of this patent document relates to a candle devices that use an imitation flame, and particularly, to features that control the operation of imitation candle devices.

### BACKGROUND

Traditional true flame candles, when lit, provide a pleasant ambience in many homes, hotels, churches, businesses, etc. Traditional candles, however, provide a variety of hazards including risk of fire, damage to surfaces caused by hot wax, and the possible emission of soot. Flameless candles have become increasingly popular alternatives to traditional candles. With no open flame or hot melted wax, flameless candles provide a longer-lasting, safe, and clean alternative. Such imitation candle devices often include light sources, such as LEDs, and include electronic circuits that control the operation the imitation candle device.

### SUMMARY

The disclosed embodiments relate to devices and methods for facilitating the operations and usage of electronic candle devices. The disclosed features enable an electronic candle device to be turned on or off by a simple user's actions including touching the imitation candle device, or blowing at or speaking to the imitation candle.

In one exemplary aspect, an imitation candle device is disclosed. The imitation candle device includes a body; a flame element protruding from top of the body; one or more light sources positioned to illuminate the flame element to produce an appearance of a true fire flame; a plurality of touch sensitive segments positioned on, or embedded in, a peripheral section of the body, wherein each of the plurality of touch sensitive segments is operable to produce an electrical signal in response to sensing a touch; and an electronic control circuitry operable to receive the electrical signal produced in response to sensing the touch by one or more of the plurality of touch sensitive segments and to control at least an output of the one or more light sources based on the electrical signal, wherein the plurality of touch sensitive segments includes a set of segments positioned in close proximity to each other, the set of segments operable to produce a plurality of electrical signals in response to sensing a sliding touch motion from the set of segments.

Another exemplary aspect of the disclosed embodiments relates to an imitation candle device that includes a body; an inner enclosure positioned beneath the body; a flame element protruding from top of the body; one or more light sources positioned to illuminate the flame element to produce an appearance of a true fire flame; a plurality of plates positioned on an outer surface of the inner enclosure operable to sense a touch and to produce an electrical signal in response to sensing the touch; and an electronic control circuitry operable to receive the electrical signal from the plurality of plates and to control at least an output of the one or more light sources based on the electrical signal.

Another exemplary aspect of the disclosed embodiments relates to an imitation candle device that includes a body, a flame element protruding from top of the body, one or more light sources positioned to illuminate the flame element to produce an appearance of a true fire flame, a sensor positioned within the body to detect a blow of air directed at the imitation candle device, and electronic circuitry positioned within the body to receive electrical signals produced by the sensor and to modify an output light of the one or more light sources in response to detection of the blow.

Yet another exemplary aspect of the disclosed embodiments relates to an imitation candle system that includes an imitation candle device and a portable electronic device wirelessly coupled to the imitation candle device. The imitation candle device in such a system includes a body, a flame element protruding from top of the body, one or more light sources positioned to illuminate the flame element to produce an appearance of a true fire flame, and electronic circuitry positioned within the body to control at least the an output of the one or more light sources, the electronic circuitry including a wireless receiver to receive wireless signals. The portable electronic device of this system includes a display, a wireless transceiver, a processor, and a memory including processor executable code. The processor executable code, when executed by the processor, configures the portable electronic device to present a graphical user interface on the display. The graphical user display includes buttons or fields that allow activation of a blow off feature of the imitation candle device on the electronic device, and one or more of the following operations of the imitation candle device: a power-on or power-off operation, a selection of a particular imitation candle device, a selection of a timer feature, a setting of a timer value, a selection of a light intensity level, an adjustment of a light intensity level, a selection of a movement of the flame element, a setting of a level of movement of the flame element, or a selection of a group of imitation candle devices

The above and other aspects and their implementations are described in greater detail in the drawings, the description and the claims.

### BRIEF DESCRIPTION OF THE DRAWINGS

FIG. 1 illustrates an exemplary imitation candle device with an associated remote control device.

FIG. 2A illustrates certain components including a support mechanism for an artificial flame element of an exemplary imitation candle device.

FIG. 2B illustrates certain components including a touch-sensitive structure of an exemplary imitation candle device.

FIG. 2C illustrates is a side view of FIG. 2B including certain internal candle components.

FIG. 3 illustrates components of an exemplary imitation candle device in more detail.

3

FIG. 4A is a picture of an exemplary remote control device for an imitation candle device.

FIG. 4B illustrates components of the remote control device of FIG. 4A.

FIG. 4C illustrates an exemplary location of a microphone hole on the remote control device.

FIG. 4D illustrates an exemplary circuit diagram associated with a remote control device.

FIG. 5A is a series of exemplary user interface screens associated with an application for controlling the operations of an imitation candle device.

FIG. 5B is a series exemplary user interface screens for setting a timer and controlling illumination properties of an imitation candle device.

FIG. 5C is a series of exemplary user interface screens for controlling the operations of a group of imitation candle devices.

FIG. 5D is an exemplary user interface screen related to a blow out feature of an imitation candle device.

FIG. 6 is a block diagram of electronic components of a device that can be used to accommodate some of the disclosed embodiments.

FIG. 7A shows an exemplary configuration of touch sensitive elements located close to the flame element.

FIG. 7B shows another exemplary configuration of touch sensitive elements located close to the flame element.

FIG. 8A illustrates a configuration of the plates positioned on the enclosure of an exemplary imitation candle device.

FIG. 8B shows a configuration of the plates coupled to the central control circuits of an exemplary imitation candle device.

#### DETAILED DESCRIPTION

In this patent document, the word “exemplary” is used to mean serving as an example, instance, or illustration. Any embodiment or design described herein as “exemplary” is not necessarily to be construed as preferred or advantageous over other embodiments or designs. Rather, use of the word exemplary is intended to present concepts in a concrete manner.

Imitation candle devices can simulate a real candle with a flame that resembles a real-life flame with flickering effects using optical, mechanical and electrical components. The disclosed embodiments provide further features and functionalities that enhance the operation of these devices, and in some cases, enable additional features that cannot be obtained with real candles.

FIG. 1 illustrates an exemplary imitation candle device **102** with an associated remote control device **106** in accordance with an exemplary embodiment. The flame element **104** protrudes upward from the body of the imitation candle device **102**, and the top portion **108** of the body is formed to resemble a melted candle wax to enhance the resemblance of the candle device **102** to a real candle. The remote control device **106** is configured to operate with the imitation candle device **102** via a wireless channel. For example, the remote control device **106** can include an infrared transmitter to provide various commands and signals to an infrared receiver of the imitation candle device **102**. In some embodiments, other wireless communication protocols and techniques, such as Bluetooth, cellular, WiFi, etc., can be used. In certain applications, the communication channel that allows remote control of the imitation candle device can include a wired communication channel.

FIGS. 2A, 2B and 2C illustrate some of the components of an exemplary imitations candle device including an

4

enclosure **214** that houses the internal candle components, and a flame element **202** that protrudes from top of the enclosure **214**. The flame element **202** includes a hole **208** that allows a support structure **206** to pass through the hole to suspend the flame element **202**. The ends of the support structure **206** are secured within slots **216** that are formed on top of the enclosure **214**. As shown in the exemplary diagram of FIG. 2A, the support structure **206** is bent at two ends to fit within the slots **216**, and is slightly bent downwards at the location of the hole **208**. The top portion of the enclosure include an indentation to accommodate a plate **210** in the form of an annulus. It should be noted that in other implementations, the plate **210** can include other shapes, such as rectangular or triangular shapes, can be configured to not fully encircle the flame element **202** and/or made smaller or larger in size. As will be described in detail below, the annulus not only operates as a decorative element to hide the internal candle components from plain view and secures the ends of the support structure **206** in place, it also enables touch-sensitive operation of the candle.

A light source **212**, such as an LED, can be placed inside the enclosure **214**, as shown in FIG. 2C. The light source **212** can, for example, project light of suitable color and/or intensity to the flame element **202**. In some implementations, more than one light source **212** is used to illuminate the flame element **202** from one side, and/or from both sides. In some embodiments, the light source **212** can be an incandescent light source, a plasma light source, a laser light source, or can include other suitable light producing mechanisms.

FIG. 3 shows additional details of the components of an exemplary imitation candelled device that includes a flame element **302** that is suspended by a steel wire support structure **306**. The bottom section of the flame element **302** below the steel wire support structure **306** can include a magnetic element **320** that interacts with a magnetic field produced by a coil **316**. The coil **316** can be energized by control signals generated by electronic circuits that are located on, for example, a PCB board **318**. In some implementations, the electronic circuits can generate pulses that cause the electromagnet to turn on and off, to vary the produced magnetic field strength, or to reverse polarity, at particular time instances. In one example, the signals that energize the coil **306** is a pulse-width modulated signal. In other examples, such signals provide an amplitude modulated, a phase modulated or a frequency modulated signal to the coil **306**. Due to interactions of the magnetic element **320** with the magnetic field of the coil **306**, the flame element **302** can oscillate and produce a flickering effect when illuminated by the light produced by the one or more light source **314**. The imitation candle device can further include a wireless receiver component receives and decodes wireless signals transmitted thereto. For example, some components of such a wireless receiver can be located on the PCB board **318**, and can operate based on one or more wireless technologies and protocols, such as infrared technology, Bluetooth or cellular protocols.

FIG. 3 also illustrates a ring **304** that is positioned on top of the imitation candle housing, around and in the vicinity of the flame element **302**. In some embodiments, the ring **304** serves as a decorative piece to hide the internal components of the imitation candle device and/or to resemble melted wax. In this regard, the ring **304** can have a particular color and/or reflectivity to produce the desired visual effect when viewed under ambient illumination, or under the scattered and/or reflected illumination of the candle light source **314**. In some embodiments, the ring **304** operates as a touch

sensitive on-off switch. In particular, the ring **304** can be made of conductive material that forms a capacitive element in electrical connection with one or more components on the PCB board **318**. When a user's finger contacts, or is within close proximity of, the ring **304**, a capacitive contact is formed to complete a circuit. The touch-sensitive mechanism can be used for turning the candle on or off, or for controlling other functions of the imitation candle in a step-wise manner. For example, each touch can increase or decrease intensity of the light source **314**, to switch the color of light, or to change a mode of operation (e.g., from flickering to constant intensity). In some embodiments, the touch sensitive element (shaped as a ring, or other shapes) includes two segments that are preferably poisoned at two different sides of the flame element on the top surface of the imitation candle device. In such embodiments, the two-piece touch sensitive element is configured to operate as a switch (e.g., conduct a current) only if both segments of the touch sensitive element are touched. For example, a user can touch one segment of the touch sensitive element that is positioned close to, and on one side of, the flame element with his/her thumb, and the other segment of the touch sensitive element that is positioned close to, and on an opposite side of, the flame element with his/her index finger to activate the switch and turn off the imitation candle device. As such, the multi-segment touch element can be used to simulate the appearance that the user is extinguishing the candle flame using his/her fingers.

The imitation candle device of FIG. **3** also includes a microphone **310** that is held in place within the interior of the imitation candle device by a microphone support element **308**. The microphone **310** converts acoustic signals into electrical signals that are provided to an electronic component on the PCB board **318**. The microphone **310** is positioned closer to the top surface of the imitation candle device to intercept sound waves that travel into the interior of the imitation candle device. For example, the top section of the imitation candle device can include an opening (e.g., the same opening that allows light from the light source **314** to reach the flame element **302**) that allows the microphone to capture acoustic waves that travel down into the interior of the imitation candle device. In this way, when a user blows in the direction of the imitation flame element **302**, the blow is captured by the microphone **310**, and the appropriate signals are generated to turn off the imitation candle device.

The electrical signals produced by the microphone **310** can be processed by the components of the PCB board **318**. The PCB board **318** can, for example, include filters, analog-to-digital circuits and/or a processor or controller (e.g., a microprocessor, a digital signal processor (DSP), an FPGA, an ASIC, etc.) that receive signals representing the captured sound waves. The processor can execute program code stored on a non-transitory storage medium, such as ROM, a RAM or other memory device, to analyze the signals corresponding to the sound waves and to determine that a blow has occurred. Upon detection of a blow, a corresponding signal can be produced to turn off the light source **314** and/or the entire imitation candle device. The program code that is executed by the processor can include an algorithm that differentiates between captured sounds of blowing air and other sounds such as clapping or human conversation.

In some embodiments, the blow detection circuitry can be implemented as a separate component from other components of the PCB board **318**. For example, the blow detection can be implemented using analog or digital circuits. In some embodiments, to facilitate the detection of a blow, the microphone **310** that is mounted is coupled to an amplifier

to generate an AC signal above a predetermined threshold voltage value (e.g., 200 mV), or a within a predetermined range of values (e.g., 200 mV to 3.5 V). Whereas the sound pressure/level due to a blow provides voltage values above such a threshold (or within such predetermined range of values), other sounds, such as a clapping sound, detected by the microphone can only generate an AC signal below the threshold value (e.g., at 20-100 mV), or outside of the predetermined range of values that correspond to the detection of the blow. The resulting signal of the amplifier can be further coupled to a second stage amplifier with a high amplification factor (e.g., 100 to 300 times). In some implementations, the second stage amplifier is a capacitive coupling transistor amplifier that forms a square wave that is provided to the processor to shut down the candle device. If the captured sound wave produces a signal below the threshold, such a signal does not activate the second stage amplifier (e.g., the transistor amplifier), and thus the appropriate signal for shutting down the candle device is not generated. It should be noted that, in the above description, voltage values are provided as examples to facilitate the understanding of the disclosed embodiments. It is, however, understood that other measurements, such as measured current values, may be used for identifying the blow, and/or different ranges of values may be used to effectuate the identification.

It should be noted the above description has been provided with reference to an imitation candle device with a moving flame element. It is, however, understood that the use of a microphone for blow detection can be implemented in other imitation candle configurations, such as those that utilize non-magnetic means for moving the flame element, in candle devices with a stationary flame element, or any other imitation candle device that can accommodate a microphone and the associated circuitry. Moreover, in some applications, the disclosed technology may be implanted as part of an imitation fireplace, an imitation candelabra, or other lighting fixtures. Further, in some implementations, a device other than a microphone, such as flow sensor, can be used to detect the blow.

As noted in connection with FIG. **1**, the disclosed imitation candle devices may be equipped with a remote control device that enables control of various candle functionalities from a remote location. An exemplary remote control device **400** is shown in FIG. **4A**. Various buttons on the remote control device **400** enable a user to remotely control various features of one or more associated imitation candle devices. In particular, an on-off button **402** allows the imitation candle device to be turned on or off remotely. The brightness/dimness of the candle device is controlled by two switches, **404(a)** and **404(b)**, that are positioned below the on-off button **402**, and the speed of the flickering and/or movement of the candle's flame element is controlled via switches **406(a)** and **406(b)**. The remote control device **400** further includes one or more timer buttons **408** (e.g., 4-stage timer buttons) that allow the imitation candle device to operate for any one of several timed durations (e.g., a 4-hour, a 6-hour, a 8-hour or a 10-hour duration) before the candle device is automatically turned off. To activate the timer operation, a user can, for example, press the central timer button followed by the desired duration button. The remote control device **400** can also include additional buttons (e.g., a candle selection button, a blow on-off activation button, a wireless coupling button, etc.) to enable additional operations and communications with one or more imitation candle devices.

FIG. 4B illustrates an exploded view of the components of the exemplary remote control device of FIG. 4A. An upper cover 401 includes openings that accommodate different buttons, such as a power button 403, a circular button 405 with quad activation sections and one or more timer buttons 407. A flexible layer 409 (such as a silicone sheet) with appropriate stiffness is positioned below the buttons on top of a PCB board 411 that includes electronic circuitry. The remote control device also includes a negative side spring 413 and positive side spring 415 and screws 417. A microphone 419 is placed on a microphone board 429 to capture sounds and to generate electric signals therefrom. The remote control device may also include a side cover 421 that allows (e.g., through a hole in the side cover 421) an infrared receiver and/or transmitter to communicate with another device. A weight 423 may also be added, as needed, to assist with obtaining the desired weight and/or balance for the remote control device. The bottom cover 425 includes a battery compartment that accommodates one or more batteries and the corresponding battery cover 427.

As evident from FIG. 4B, the remote control device includes a microphone 419 and the corresponding circuit board 429 that are used for capturing and identifying a blow. FIG. 4C illustrates an exemplary location of microphone hole on the top cover of the remote control device. Similar to the above description regarding the imitation candle device, in some embodiments, a user can blow at the remote control device in the vicinity of the microphone hole to control a functionality of the imitation candle device, such as to turn the candle off.

FIG. 4(D) illustrates an exemplary circuit diagram associated with the electrical components of the remote control device. The circuit is powered (at VDD) using a battery, such as a CR2032 lithium button battery that supplies a voltage in the range 2.2 to 3.2 V to the chip U1. In some implementations, the chip U1 includes a microprocessor. It is, however, understood that the chip U1 may include, or be designed as, an FPGA, an ASIC, a DSP, or discrete circuit components. The chip U1 controls various operations of the remote control device, such as detecting that a switch (e.g., one of switches S1 to S10) has been pressed. The chip U1 includes an IRout pin that controls an infrared LED for transmitting an infrared signal to another device. The electric current from the battery is filtered by capacitors C1 and C2 and provided to the IR LED. A microphone (MIC1) is coupled to a two-stage electronic circuitry, notably transistors Q1 and Q2 and associated biasing and amplification components (e.g., resistors R2-R5). In some embodiments, the chip U1 remains in an idle operating status when a "high" voltage is present at an input pin that corresponds to a certain functionality, such as an on/off functionality, a timing functionality, a brightness increase functionality, a brightness decrease functionality, a pause/slow/stop flame movement functionality, a fluctuating/fast/start flame movement functionality, a blow detection functionality, and so on. In such embodiments, the chip U1 waits until a low signal occurs. For example, when a blow is directed to the microphone hole of the remote control device, a sound wave having a certain intensity or sound pressure is produced at the head of the microphone. In an exemplary embodiment, such a blow generates an AC signal of about 200 mV or more that is subsequently amplified by 100-300 times, forming square waves that pull the appropriate input of the chip U1 to a low voltage value for a predetermined duration. As a result, the infrared transmitter is activated and a signal is transmitted to the candle device to turn the candle off. Implementing the blow detection circuits as a separate

subsystem of the remote control system (as done in the exemplary diagram of FIG. 4(D)) allows the blow detection capability to be added to an existing remote control device without having to redesign the internal circuits or programming of the chip U1. In addition, implementation of the blow detection subsystem in discrete components can allow faster detection speed since additional delays due to processing by the chip U1 are avoided. As noted earlier, the disclosed embodiments also prevent inadvertent activation of this feature based on background noises and unwanted sounds. In some embodiments, the blow detection circuitry and/or associated recognition software instructions can be adapted to cause a fluttering movement of the simulated flame. For example, if the strength of the detected blow is below a particular threshold (e.g., a particular voltage value), the blow can be identified as not being strong enough to extinguish the simulated flame. As such, the detection of such a blow can cause the intensity and pattern of illumination of the flame element to change to simulate a real candle that is fluttering in the wind.

It is thus evident that, in one aspect of the disclosed technology, an imitation candle device is provided that includes a body, a flame element protruding from top of the body, one or more light sources positioned to illuminate the flame element to produce an appearance of a true fire flame, a sensor positioned within the body to detect a blow of air directed at the imitation candle device, and electronic circuitry positioned within the body to receive electrical signals produced by the sensor and to modify an output light of the one or more light sources in response to detection of the blow. In one exemplary embodiment, the sensor is a microphone that produces the electrical signals in response to detection of an acoustic wave. In another exemplary embodiment, the sensor is an air flow sensor that produces the electrical signals in response to detection of flowing air in the vicinity of the air flow sensor. In yet another exemplary embodiment, the imitation candle device includes an opening at a top section of the body in the vicinity of the flame element to receive the blow of air and to direct at least a portion of the blow to within the body.

According to another exemplary embodiment, the electronic circuitry is configured to differentiate the received electrical signals that are associated with the blow of air from the received electrical signals that are not associated with the blow of air. For example, the received electrical signals that are not associated with the blow of air can include electrical signals associated with: an ambient noise, a clap, or a human speech. In another exemplary embodiment, the electronic circuitry includes a first stage detection circuit coupled to the sensor to receive the electrical signals produced by the sensor, and a second stage detection circuit having an input that is coupled to an output of the first stage detection circuit. The second stage detection circuit has an output that indicates the detection of the blow in response to receiving a voltage or a current value within a predetermined range from the first stage detection circuit. For example, the first stage detection circuit produces an output in the predetermined range upon detection of the electrical signals that correspond to the blow, and produces an output that is outside of the predetermined range upon detection of the electrical signals that do not correspond to the blow.

In still another exemplary embodiment, the electronic circuitry, in response to detection of the blow, turns off one or more of the light sources. In yet another exemplary embodiment, the electronic circuitry, in response to detection of the blow, turns off the imitation candle device. In some embodiments, the electronic circuitry is configured to

turn off the imitation candle device in response to detection of the blow for a predetermined duration of time. In yet another embodiment, the imitation candle device further includes a touch sensitive component positioned on, or close to, an outer surface of the body to sense a touch and to produce an electrical signal in response to the detected touch that turns the imitation candle device, or the one or more of the light sources, on or off. According to another exemplary embodiment, the touch sensitive component is shaped as an annulus that encircles the flame element.

In some exemplary embodiments, the imitation candle device further includes a remote control device that is configured to transmit a signal to the electronic circuits to control one or more operations of the imitation candle device. In one exemplary embodiment, the remote control device includes an electronic circuit board and a microphone coupled to the electronic circuit board. The microphone is positioned to intercept sounds through an opening on the remote control device, to produce an electrical signal in response to the detected sounds, and to provide the electrical signals to a component on the electronic circuit board. For example, the component on the electronic circuit board can include a two-stage detection circuitry having an output that indicates the detection of a blow of air in response to detecting a voltage or a current value within a predetermined range.

In some exemplary embodiments, the remote control device further comprises a wireless transmission device that is activated to produce a signal for transmission to a receiver device within the body of the imitation candle device upon detection of the output that indicates the detection of a blow of air. For example, the wireless transmission device can include one or more of: an infrared transmission device, a Bluetooth transmission device, or a cellular transmission device.

In some embodiments, the remote control functionalities and features are implemented as an application on an electronic device, such as a smart phone, a tablet, a laptop or similar devices. Such an application enables different features to be implemented in a user-friendly manner on a graphical user interface (GUI), and further facilitates the addition of new features and/or improvements via software updates. FIGS. 5A to 5C provide exemplary user interface screens of one exemplary application. For example, as shown in FIG. 5A, the application can determine as to whether or not a particular imitation candle device is within the range of communication, and provides an indication if the application is unable to establish a link with one or more candles. For example, such a link can be established via Bluetooth. The application further enables a user to select a particular candle device among a plurality of candle devices, as shown in FIG. 5A's selection of Matrix Candle 1. As further shown in FIG. 5A, once a particular candle device is selected, the user interface allows the selected candle to be turned on or off by selecting the on-off button, and activating the button as needed.

FIG. 5B illustrates activation of additional functionalities through the user interface. In particular, in the exemplary user interface screen in FIG. 5B, the timer selection option allows setting of a start time, an end time and repetition period. The timer setting can further be customized to activate the desired feature on particular days of the week (e.g., by clicking on or highlighting the particular day(s) of interest on the menu of the user interface). The remote application further allows the selection of an appropriate candle light intensity by, for example, clicking on one of the segments of the depicted light wheel. Such a selection

allows adjustment of light intensity in order to, for example, accommodate different moods and/or different ambient lighting conditions. The movement of the flame element can also be controlled via the remote application, by, for example, selecting an amount of flicker on a sliding bar that ranges from full flicker to an appearance of a static flame. Additional control features (e.g., via a second sliding bar) may also be provided to control the speed of flickering. Upon selection of the appropriate level of light intensity and/or flame movement, the appropriate control signals are generated at the remote control device and transmitted to the imitation candle device. Upon reception of such control signals, the imitation candle device adjusts or activates/deactivates the selected features.

FIG. 5C illustrates additional exemplary operations and selection capabilities of the remote control application. For example, selection of an item on the Main Menu (e.g., Home, Blow Out, news, Profile, About and Privacy) allows the user to navigate through the corresponding menu item. One feature of the disclosed remote application enables the selection of a group of candle devices. Such a group can, for example, be formed by selecting individual candle devices to be part of the group, and assigning a group name (e.g., by typing a desired group name). Once a group is formed, various functionalities of the candle devices within the group can be activated and/or adjusted. For example, as shown in FIG. 5C, group timer selection, group time settings, group light intensity selection and group flame movement selection can be made in a similar manner as described in connection with an individual candle device. Additionally, if desired, a single disconnect button on the user interface can sever communications with all devices within the group or groups.

The blow on-off functionality can also be activated via the user interface by selection the Blow Out item on the main menu (see FIG. 5C). Once the blow out functionality on the remoted device is activated, the application can provide a notification to the user (see FIG. 5D) that the candle device can be turned off by blowing into the microphone of the electronic device (e.g., a mobile phone). The candle application receives the signals that are produced by the device's microphone, and upon detection of the blow, generates an appropriate signal for transmission to the candle device. The candle device, upon receiving the signal from the remote control device, turns the candle off. In some implementations, the blow is detected by processing the intensity and/or pattern of data that is received from the microphone to distinguish and prevent ambient or unwanted sounds from inadvertently generating a blow off signal. Such a processing can, for example, include correlation and pattern recognition operations that produce a match only when a pattern and/or intensity of a blow is detected. In some implementations, the detection of the blow is carried out cooperatively between the remote control device and the imitation candle device.

In some embodiments, a variety of imitation candle devices (e.g., produced by the same manufacturer) can be operated by a single multi-customized remote control device (e.g., a dedicated remote control device, such as the one illustrated in FIGS. 4A to 4C, or remote control implemented on an electronic device). The function buttons or selections on the remote control device allows a user to control different features of the imitation candle device (e.g., the brightness to dimness, fast to slow movement/flame, different hours of timer) for each of the imitation candle devices individually, or as a group. Such selectivity, greatly enhances the user's interactions with multiple devices, and enables detailed customization of the desired candle func-

tions for candles that are located in different locations and ambient conditions. In one example, the remote control device is IR-based and can operate on multiple frequencies. In some embodiments, the remote control device is configured to ascertain remote control operating frequencies from other imitation candle products and devices and, once obtained, effectuate remote control of the functionalities of those devices. For example, the remote control device can attempt communicating with an unknown imitation candle device at different operating frequencies in a trial and error fashion until the unknown imitation candle device responds (e.g., turns off). In one example implementation, an infrared remote control candle operates at 32 KHz frequency. In another example, the candle can accept and receive a plurality of codes (e.g., 1 through N) to identify particular candles (e.g., entered by a user). Moreover, in some embodiments, a user may have a specific identification code that identifies a specific user.

FIG. 6 illustrates a block diagram of a device 600 within which some of the disclosed embodiments may be implemented. The device 600 comprises at least one processor 602 and/or controller, at least one memory 604 unit that is in communication with the processor 602, and at least one communication unit 606 that enables the exchange of data and information, directly or indirectly, through the communication link 608 with other entities, devices and networks. The communication unit 606 may provide wired and/or wireless communication capabilities in accordance with one or more communication protocols, and therefore it may comprise the proper transmitter/receiver (transceiver) antennas, circuitry and ports, as well as the encoding/decoding capabilities that may be necessary for proper transmission and/or reception of data and other information.

For example, the device 600 can facilitate implementation of an imitation candle system. Such a system includes an imitation candle device and a portable electronic device wirelessly coupled to the imitation candle device. The imitation candle device includes a body, a flame element protruding from top of the body, one or more light sources positioned to illuminate the flame element to produce an appearance of a true fire flame, and electronic circuitry to control at least an output of the one or more light sources. The electronic circuitry also includes a wireless receiver to receive wireless signals. The portable electronic device includes a display, a wireless transceiver, a processor, and a memory including processor executable code. The processor executable code, when executed by the processor, configures the portable electronic device to present a graphical user interface on the display. The graphical user display includes buttons or fields that allow activation of a blow off feature of the imitation candle device by blowing on the portable electronic device, and activation one or more of the following operations of the imitation candle device: a power-on or power-off operation, a selection of a particular imitation candle device, a selection of a timer feature, a setting of a timer value, a selection of a light intensity level, an adjustment of a light intensity level, a selection of a movement of the flame element, a setting of a level of movement of the flame element, or a selection of a group of imitation candle devices.

In one exemplary embodiment, the portable electronic device further includes a microphone. In this embodiment, the processor executable code, when executed by the processor, configures the portable electronic device to, upon activation of the blow off feature on the electronic device, detect an intensity or pattern of electrical signals produced by the microphone that correspond to a blow of air, and to

activate the wireless transceiver of the electronic device to transmit a signal to the imitation candle device to allow the imitation candle device to be turned off. In some exemplary embodiments, the processor executable code, when executed by the processor, configures the wireless transceiver to, upon selection of the particular imitation candle device, transmit a signal to the particular imitation candle device to establish a wireless connection with the particular imitation candle device. In some embodiments, the wireless transceiver can be configured to operate according to a Bluetooth or a cellular wireless communication protocol.

In some embodiments, the above noted system includes one or more additional imitation candle devices. In such embodiments, the processor executable code, when executed by the processor, configures the portable electronic device to, upon the selection of a group comprising more than one imitation candle device, transmit command signals to conduct identical operations on all imitation candle devices in the group. For example, the command signals can include one or more of: an indication to change light intensity levels, an indication to change movement level of flame elements, an indication to change set timer values, an indication to turn off all imitation candle devices, or an indication to disconnect all imitation candle devices.

In one exemplary embodiment, the portable electronic device is one of a smart phone, a table device, or a laptop computer. In another exemplary embodiment, the imitation candle device further includes a magnetic drive, and a magnetic element coupled to a bottom section of the flame element that interacts with the magnetic drive to cause movement of the flame element. In yet another exemplary embodiment, the processor executable code, when executed by the processor, configures the portable electronic device to, upon the selection of a movement of the flame element and setting of the movement to a particular level, transmit a signal to the imitation candle device to cause a change in amount of movement of the flame element

The imitation candle can further include a plurality of touch sensitive segments positioned on or embedded in a peripheral section of the body. For example, one or more touch sensitive segments of can be positioned close to, and on one side of, the flame element while one or more segments are positioned close to, and on an opposite side of, the flame element. Additional segments can locate at other positions close to the flame element. FIG. 7A shows an exemplary configuration of the touch sensitive segments 701-708 close to the flame element 710. In this embodiment, the touch sensitive segments are positioned on or embedded in a top portion of the candle body. A number of segments 701-705 are positioned at the front side of the flame element 710 and are separated with a short distance from each other. At least a portion of the segments 701-705 (e.g. segments 701-703) can be used as a sliding control that allows a user to slide a finger across the segments to, for example, change the brightness of the LED lights. The segments 701-705 can also be positioned adjacent to each other with no gaps, or very small gaps, between each other. For example, segments 701-705 are positioned adjacent to each without any gaps in the specific embodiment depicted in FIG. 7B. In some implementations, segments 701-705 correspond to five levels of brightness of the LED lights. As the user slides his or her finger from the 701 segment to the 705 segment, the LED lights, and thus the illuminated flame element 710, get brighter. As the user slides his or her finger from the 705 segment to the 701 segment, the LED lights, and thus the flame element 710, become dimmer.

The specific configurations to segments **701-705** depicted in FIGS. 7A-B and described above are made to illustrate examples on how a number of segments can be used as a sliding control to operate the imitation candle device. It is however understood that other configurations can be assigned to those segments, and more or fewer number of segments may be used to implement the described features and functionalities. For example, in some embodiments, instead of segments **701-705** corresponding to five specific levels of brightness of the LED, the detection of a direction of sliding motion (e.g., sensing a touch that persists from segment **701** to segment **702** to segment **703**, and so on) triggers an increase in LED's brightness, whereas detection of the sliding motion in an opposite direction (e.g., sensing a touch that persists from segment **705** to segment **704** to segment **703**, and so on) triggers a decrease in LED's brightness. Such an increase or decrease in LED brightness can continue as long as the sliding motion of the touch is being sensed by the plurality of segments, or upon sensing additional sliding motions in the corresponding direction. Moreover, the sensing of the sliding motion can be used to control additional features of the imitation candle device, such as movement of the flame element (e.g., sliding motion in one direction causing the flame element to move faster, and sliding motion in the opposite direction causing the flame element to move slower). In some embodiments, a particular touch sensitive segment (or another selection mechanism) is used as a means for selecting a particular function of the imitation candle (e.g., brightness, flame movement, flickering speed, etc.), which allows the same plurality of segments to be used to provide sliding control of the selected function.

In the embodiment depicted in FIGS. 7A-B, the segment **703** can function as an on/off touch key at the same time. For example, touching the segment **703** alone turns on the imitation candle device. Touching the segment **703** one more time turns off the imitation candle device. The segment **703** can also be used to enable a particular timer setting. In some embodiments, touching the segment **703** for a predetermined amount of time, e.g. three seconds, sets a timer to a predefined time duration, e.g. five hours, so that the imitation candle device can turn off automatically after the default time duration expires. After the segment **703** is touched for the predetermined amount of time, the LED lights blink once to indicate that the timer has been set successfully.

FIGS. 7A-B further shows that additional segments **706** and **707** are positioned at the side of the flame element **710** and the segment **708** is positioned behind the flame element **710**. The segment **706** can be used in conjunction to the timer functionality discussed above. For example, after the user touches the segment **706**, the imitation candle device shows the current timer status via the LED lights. For example, if the timer is currently set to one hour, the LED lights blink once. Similarly, if the timer is currently set to two hours, the LED lights blink twice, and so on. In some embodiments, touching the segment **706** for a predetermined amount of time, e.g. three seconds, allows the user to set a custom timer duration in a custom timer setting mode. The LED lights blink multiple times (e.g. three times) to indicate that the imitation candle device is in the custom timer setting mode and the user can start setting the custom timer duration. The user then touches the segment **703** to increase timer time. For example, touching the segment **703** once sets an one-hour timer; touching the segment **703** twice sets a two-hour timer, and so on. The LED lights blink once after each successful setting. In some embodiments, the user needs to touch the segment **703** again within an predeter-

mined interval of time (e.g. six seconds) after the previous touch to continue setting the custom timer, otherwise the imitation candle device exits the custom timer setting mode. If the user does not start touching the segment **703** after a predetermined amount of time (e.g. six seconds) following the start of the custom timer setting mode, the imitation candle device exits the custom timer setting mode without setting any timer.

In some embodiments, the segment **707** can be used to control the mode of operation of the LED lights. For example, touching the segment **707** once changes the flickering speed of the LED lights to a slow speed. Touching the segment **707** again changes the flickering speed to a fast speed. Touching the segment **707** for a predetermined amount of time, e.g. three seconds, changes the LED lights to a constant intensity. Alternatively, the segment **707** can be used to control the mode of operation of the flame element **710** if the flame element **710** is movable. For example, touching the segment **707** once changes the moving speed of the flame element **710** to a slow speed. Touching the segment **707** again changes the moving speed to a fast speed. Touching the segment **707** for a predetermined amount of time, e.g. three seconds, stops the movement of the flame element **710**.

In some embodiments, the segment **708** is used to enable and disable the remote control functionality. For example, touching the segment **708** for a predetermined amount of time, e.g. three seconds, turns off the remote control functionality of the imitation candle device so that the imitation candle device consumes less power. After the remote control functionality is successfully turned off, the LED lights blink three times to indicate the success. In some embodiments, the remote control functionality remains off even after the imitation candle device restarts. In order to turn it back on, the user needs to touch the segment **708** again. The LED lights blink once to indicate that the remote control functionality has been turned back on successfully. It should be noted that the specific references to segments **701-708** in the above description is made to illustrate an example on how these segments can be used to operate the imitation candle device. It is however understood that other functionalities can be assigned to those segments, and other segments may be used to implement the described features and functionalities.

The segments that are described in connection with FIG. 7 can be placed under the top cover of the imitation candle (e.g., under the top wax-like section), thus hiding the physical appearance of the segments. In such configurations, markings (e.g., numbers, letters, arrows, etc.) on the top side of the candle may be provided to identify the location of the segments.

It is thus evident that, in one aspect of the disclosed technology, an imitation candle device can be implemented to include a body, a flame element protruding from top of the body, one or more light sources positioned to illuminate the flame element to produce an appearance of a true fire flame, a plurality of touch sensitive segments positioned on, or embedded in, a peripheral section of the body, and an electronic control circuitry operable to receive the electrical signal produced in response to sensing the touch by one or more of the plurality of touch sensitive segments and to control at least an output of the one or more light sources based on the electrical signal. Each of the plurality of touch sensitive segments is operable to produce an electrical signal in response to sensing a touch. The plurality of touch sensitive segments includes a set of segments positioned in close proximity to each other, the set of segments operable

to produce a plurality of electrical signals in response to sensing a sliding touch motion from the set of segments. In particular, the electronic control circuitry is operable to control a brightness level of the one or more light sources based on the electrical signal. The peripheral section of the body includes a top section of the body.

In some embodiments, the electronic control circuitry is operable to control a brightness level of the one or more light sources based on the electrical signal. The electronic control circuitry is also operable to receive the plurality of electrical signals produced in response to sensing the sliding motion and to adjust a brightness level of the one or more light sources based on the sliding touch motion. The peripheral section of the body includes a top section of the body.

In some embodiments, the imitation candle device further includes a timer coupled to the electronic control circuitry that is operable to turn off the imitation candle device after a predetermined timer duration expires. The plurality of touch sensitive segments includes a segment operable to produce a plurality of electrical signals in response to a plurality of touch patterns. The plurality of electrical signals enables the electronic control circuitry to turn the imitation candle device, or the one or more light sources, on and off. The plurality of electrical signals also enables the electronic control circuitry to set the timer duration to a predetermined value such that imitation candle device turns off after the timer duration of the predetermined value expires. The plurality of touch patterns includes a touch pattern that lasts for a predetermined amount of time, such as three seconds.

In some embodiments, the plurality of touch sensitive segments includes a first segment operable to produce a plurality of electrical signals in response to a plurality of touch patterns. The plurality of electrical signals enables the electronic control circuitry to control the one or more light sources to indicate a predetermined timer duration of the timer. The plurality of electrical signals also enables the electronic control circuitry to set the predetermined timer duration to a custom value. The custom value can be determined based on one or more touches of a second segment among the plurality of segments.

In some embodiments, the plurality of touch sensitive segments includes a segment operable to produce a plurality of electrical signals in response to a plurality of touch patterns. The plurality of electrical signals enables the electronic control circuitry to control an operation mode of the one or more light sources or the flame element. The operation mode of the one or more light sources includes a flickering speed of the one or more light sources, and the operation mode of the flame element includes a swing speed of the flame element. In some embodiments, the electronic control circuitry of the imitation candle device further includes a wireless receiver to receive wireless signals. The plurality of touch sensitive segments includes a segment operable to produce an electrical signal to turn the wireless receiver on and off.

As discussed above in connection with FIGS. 2A to 2C, a touch sensitive plate **810** positioned around the flame element can include other shapes, such as rectangular or triangular shapes. In some embodiments, one or more touch sensitive plates can also be positioned on other parts of the enclosure. FIG. 8A illustrates an exemplary configuration of a plurality of plates **810** positioned on the side wall of the enclosure **802**. In this embodiment, a plurality of branch-shaped plates **810** are positioned on the enclosure **802**. Each branch-shaped plate includes a stem section **804** and several branches **806**. In some embodiments, the plates **810** operate as decorative pieces. For example, the plates **810** can have

a particular color and/or reflectivity to produce the desired visual effect on the candle body **812** (e.g., a semi-transparent or a translucent material) when viewed under ambient illumination. In some embodiments, the plates **810** may have several different colors to achieve a desired visual effect.

In some embodiments, the plates **810** also operates as a touch sensitive on-off switch. In some embodiments, the plates **810** can be positioned under a substantially opaque body **812**, thus being invisible to the user. FIG. 8B shows an exemplary configuration of the plates **810** positioned on the enclosure **802**. In this embodiment, the stem section **804** of each of the branch-shaped plates is electrically coupled to the central control circuit **814**. When a user's finger contacts, or is within close proximity of, the stem **804** or the branches **806**, a capacitive contact is formed to complete a circuit. The touch-sensitive mechanism can be used for turning the candle on or off, or for controlling other functions of the imitation candle. For example, each touch can increase or decrease intensity of the light source, to switch the color of light, or to change a mode of operation (e.g., from flickering to constant intensity).

Therefore, in another aspect of the disclosed technology, an imitation candle device is provided that includes a body, an inner enclosure positioned beneath the body, a flame element protruding from top of the body, one or more light sources positioned to illuminate the flame element to produce an appearance of a true fire flame, a plurality of plates positioned on an outer surface of the inner enclosure operable to sense a touch and to produce an electrical signal in response to sensing the touch, and an electronic control circuitry operable to receive the electrical signal from the plurality of plates and to control at least an output of the one or more light sources based on the electrical signal.

In some embodiments, the plurality of plates is disposed on a side surface of the outer surface of the inner enclosure. Each of the plurality of plates includes a stem section and a plurality of branches.

In some embodiments, the body of the imitation candle is made of a semi-transparent or translucent material. The plurality of plates has one or more predetermined colors visible through the translucent body under ambient illumination. In some embodiments, the body is substantially opaque such that the plurality of plates are invisible.

Some of the embodiments described herein are described in the general context of methods or processes, which may be implemented in one embodiment by a computer program product, embodied in a computer-readable medium, including computer-executable instructions, such as program code, executed by computers in networked environments. A computer-readable medium may include removable and non-removable storage devices including, but not limited to, Read Only Memory (ROM), Random Access Memory (RAM), compact discs (CDs), digital versatile discs (DVD), etc. Therefore, the computer-readable media can include a non-transitory storage media. Generally, program modules may include routines, programs, objects, components, data structures, etc. that perform particular tasks or implement particular abstract data types. Computer- or processor-executable instructions, associated data structures, and program modules represent examples of program code for executing steps of the methods disclosed herein. The particular sequence of such executable instructions or associated data structures represents examples of corresponding acts for implementing the functions described in such steps or processes.

Some of the disclosed embodiments can be implemented as devices or modules using hardware circuits, software, or

combinations thereof. For example, a hardware circuit implementation can include discrete analog and/or digital components that are, for example, integrated as part of a printed circuit board. Alternatively, or additionally, the disclosed components or modules can be implemented as an Application Specific Integrated Circuit (ASIC) and/or as a Field Programmable Gate Array (FPGA) device. Some implementations may additionally or alternatively include a digital signal processor (DSP) that is a specialized micro-processor with an architecture optimized for the operational needs of digital signal processing associated with the disclosed functionalities of this application. Similarly, the various components or sub-components within each module may be implemented in software, hardware or firmware. The connectivity between the modules and/or components within the modules may be provided using any one of the connectivity methods and media that is known in the art, including, but not limited to, communications over the Internet, wired, or wireless networks using the appropriate protocols.

The foregoing description of embodiments has been presented for purposes of illustration and description. The foregoing description is not intended to be exhaustive or to limit embodiments of the present invention to the precise form disclosed, and modifications and variations are possible in light of the above teachings or may be acquired from practice of various embodiments. The embodiments discussed herein were chosen and described in order to explain the principles and the nature of various embodiments and its practical application to enable one skilled in the art to utilize the present invention in various embodiments and with various modifications as are suited to the particular use contemplated. The features of the embodiments described herein may be combined in all possible combinations of methods, apparatus, modules, systems, and computer program products.

What is claimed are:

1. An imitation candle device, comprising:
  - a body;
  - a flame element protruding from top of the body;
  - one or more light sources positioned to illuminate the flame element to produce an appearance of a true fire flame;
  - a plurality of touch sensitive segments in close proximity to each other positioned on, or embedded in, a peripheral section of the body, wherein each of the plurality of touch sensitive segments is operable to produce an electrical signal in response to sensing a touch; and
  - an electronic control circuitry operable to receive a plurality of electrical signals in response to sensing a sliding touch motion from the plurality of the segments and to control an operation of the imitation candle device based in-part on sensing a particular direction of the sliding touch motion.
2. The imitation candle device of claim 1, wherein the electronic control circuitry is operable to control a brightness level of the one or more light sources based on the sliding touch motion.
3. The imitation candle device of claim 2, wherein the electronic control circuitry is operable increase brightness of the one or more light sources in response to detection of a first direction of the sliding touch motion, and to decrease brightness of the one or more light sources in response to detection of a second direction of the sliding touch motion.
4. The imitation candle device of claim 1, further including an additional touch sensitive segment that is positioned on, or embedded in, the body, the additional touch sensitive

segment operable to produce an electrical signal in response to sensing a touch to enable a selection of a one or more functions of the imitation candle device.

5. The imitation candle device of claim 4, wherein the one or more functions includes:
  - a brightness of the one or more light sources,
  - a flickering speed of the one or more light sources, or
  - a timer operation.
6. The imitation candle device of claim 1, wherein the electronic control circuitry is operable increase a flickering speed of the one or more light sources in response to detection of a first direction of the sliding touch motion, and to decrease the flickering speed of the one or more light sources in response to detection of a second direction of the sliding touch motion.
7. The imitation candle device of claim 1, wherein the electronic control circuitry is operable to turn the imitation candle device on or off in response to detection of an electrical signal indicative of sensing a touch from one of the plurality of touch sensitive segments.
8. The imitation candle device of claim 1, wherein the electronic control circuitry is operable to set one or more timer values associated with the imitation candle device in response to detection of one or more touches from one of the plurality of touch sensitive segments.
9. The imitation candle device of claim 1, further including an additional touch sensitive segment that is positioned on, or embedded in, the body, the additional touch sensitive segment operable to produce an electrical signal in response to sensing a touch to enable or disable a control functionality of the imitation candle device.
10. The imitation candle device of claim 1, wherein the peripheral section of the body includes a top section of the body.
11. The imitation candle device of claim 1, wherein the electronic control circuitry includes a wireless receiver to receive wireless signals.
12. The imitation candle device of claim 1, wherein each of the plurality of touch sensitive segments is separated from another one of the touch sensitive segments.
13. The imitation candle device of claim 1, wherein each of the plurality of touch sensitive segments is positioned directly adjacent to another one of the touch sensitive segments.
14. The imitation candle device of claim 1, wherein the plurality of touch sensitive segments includes at least four touch sensitive segments.
15. The imitation candle device of claim 1, wherein the body includes a semi-transparent or a translucent material.
16. The imitation candle device of claim 1, wherein the one or more light sources are positioned inside the body to illuminate the flame at an inclined angle.
17. The imitation candle device of claim 1, wherein the electronic control circuitry is operable to change a color of light that illuminates the flame element in response to detection of one or more touches from one of the plurality of touch sensitive segments.
18. The imitation candle device of claim 1, wherein the electronic control circuitry is operable to enable or disable a remote control functionality of the imitation candle device in response to detection of a touch from one of the plurality of touch sensitive segments.
19. The imitation candle device of claim 18, wherein the remote control functionality is enable or disabled in response to detection of the touch for a predetermined interval of time.

**19**

**20.** The imitation candle device of claim **19**, wherein the predetermined interval of time is three seconds.

\* \* \* \* \*

**20**