



(11) **EP 2 148 010 A3**

(12) **EUROPEAN PATENT APPLICATION**

(88) Date of publication A3:  
**24.11.2010 Bulletin 2010/47**

(51) Int Cl.:  
**E02B 11/00 (2006.01)**

(43) Date of publication A2:  
**27.01.2010 Bulletin 2010/04**

(21) Application number: **09175828.4**

(22) Date of filing: **02.06.2006**

(84) Designated Contracting States:  
**AT BE BG CH CY CZ DE DK EE ES FI FR GB GR HU IE IS IT LI LT LU LV MC NL PL PT RO SE SI SK TR**  
Designated Extension States:  
**AL BA HR MK YU**

(71) Applicant: **The Waterflow Group plc**  
**Colnbrook, SL3 0DG (GB)**

(72) Inventors:  
• **Lusher, Mark David**  
**Colnbrook, SL3 0DG (GB)**  
• **Kern, Roger John Graham**  
**Colnbrook, SL3 0DG (GB)**

(30) Priority: **03.06.2005 GB 0511324**

(62) Document number(s) of the earlier application(s) in accordance with Art. 76 EPC:  
**06252882.3 / 1 728 929**

(74) Representative: **Lindsay, David Ian**  
**Murgitroyd & Company**  
**165-169 Scotland Street**  
**Strathclyde**  
**Glasgow G5 8PL (GB)**

(54) **Improvements in or relating to pipelines for drainage**

(57) A method of repairing an underground drainage pipe, conduit or passageway (12, 142), by inserting a liner (40, 144) and then launching a pipeline pig (10, 110) through the pipe which simultaneously creates multiple holes (60) through the liner (40, 144) and the pipe wall

(24). The pipeline pig (10, 110) is also described having a number of cutting elements (54, 148) arranged substantially symmetrically about a central axis (52) which can be extended to drill or jet through the liner (40, 144) and wall (24). Existing conduits are thus made selectively permeable.

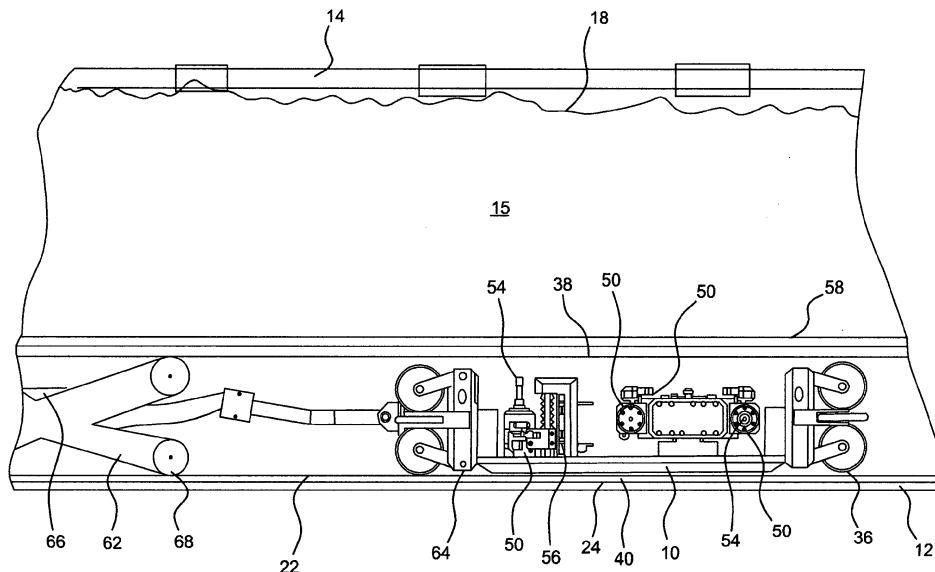

**Fig. 1**

**EP 2 148 010 A3**



EUROPEAN SEARCH REPORT

Application Number  
EP 09 17 5828

DOCUMENTS CONSIDERED TO BE RELEVANT			
Category	Citation of document with indication, where appropriate, of relevant passages	Relevant to claim	CLASSIFICATION OF THE APPLICATION (IPC)
A	EP 0 172 307 A2 (INSITUFORM GROUP LTD [GB]) 26 February 1986 (1986-02-26) * page 6 - page 11; figures * -----	1-5	INV. E02B11/00
			TECHNICAL FIELDS SEARCHED (IPC)
			E03F E02B F16L B26F
The present search report has been drawn up for all claims			
Place of search <b>The Hague</b>		Date of completion of the search <b>20 October 2010</b>	Examiner <b>Van Bost, Sonia</b>
<b>CATEGORY OF CITED DOCUMENTS</b> X : particularly relevant if taken alone Y : particularly relevant if combined with another document of the same category A : technological background O : non-written disclosure P : intermediate document		T : theory or principle underlying the invention E : earlier patent document, but published on, or after the filing date D : document cited in the application L : document cited for other reasons ..... & : member of the same patent family, corresponding document	

1  
EPO FORM 1503 03/02 (P04C01)

**ANNEX TO THE EUROPEAN SEARCH REPORT  
ON EUROPEAN PATENT APPLICATION NO.**

EP 09 17 5828

This annex lists the patent family members relating to the patent documents cited in the above-mentioned European search report. The members are as contained in the European Patent Office EDP file on  
The European Patent Office is in no way liable for these particulars which are merely given for the purpose of information.

20-10-2010

Patent document cited in search report	Publication date	Patent family member(s)	Publication date
EP 0172307 A2	26-02-1986	US 4701988 A	27-10-1987

EPO FORM P.0459

For more details about this annex : see Official Journal of the European Patent Office, No. 12/82