



- (51) International Patent Classification:  
*B64D 27/26* (2006.01)
- (21) International Application Number:  
PCT/US2015/017267
- (22) International Filing Date:  
24 February 2015 (24.02.2015)
- (25) Filing Language: English
- (26) Publication Language: English
- (30) Priority Data:  
14/196,570 4 March 2014 (04.03.2014) US
- (71) Applicant: **MRA SYSTEMS, INC.** [US/US]; 103 Chesapeake Park Plaza, Baltimore, MD 21220 (US).
- (72) Inventors: **WOOLLEY, Allen Madsen**; 890 West Rosewood, Rose Hill, KS 67133 (US). **CLEGG, Brian Kelby**; 103 Chesapeake Park Plaza, Baltimore, MD 21220 (US). **JUST, Michael Scott**; 103 Chesapeake Park Plaza, Baltimore, MD 21220 (US). **PATEL, Rameshchandra Dahyabhai**; 195 Chesapeake Park Plaza, Baltimore, MD 21220 (US).
- (74) Agents: **MUNNERLYN, William S.** et al.; General Electric Company, Global Patent Operation, 3135 Easton Turnpike, Fairfield, CT 06828 (US).

- (81) Designated States (unless otherwise indicated, for every kind of national protection available): AE, AG, AL, AM, AO, AT, AU, AZ, BA, BB, BG, BH, BN, BR, BW, BY, BZ, CA, CH, CL, CN, CO, CR, CU, CZ, DE, DK, DM, DO, DZ, EC, EE, EG, ES, FI, GB, GD, GE, GH, GM, GT, HN, HR, HU, ID, IL, IN, IR, IS, JP, KE, KG, KN, KP, KR, KZ, LA, LC, LK, LR, LS, LU, LY, MA, MD, ME, MG, MK, MN, MW, MX, MY, MZ, NA, NG, NI, NO, NZ, OM, PA, PE, PG, PH, PL, PT, QA, RO, RS, RU, RW, SA, SC, SD, SE, SG, SK, SL, SM, ST, SV, SY, TH, TJ, TM, TN, TR, TT, TZ, UA, UG, US, UZ, VC, VN, ZA, ZM, ZW.
- (84) Designated States (unless otherwise indicated, for every kind of regional protection available): ARIPO (BW, GH, GM, KE, LR, LS, MW, MZ, NA, RW, SD, SL, ST, SZ, TZ, UG, ZM, ZW), Eurasian (AM, AZ, BY, KG, KZ, RU, TJ, TM), European (AL, AT, BE, BG, CH, CY, CZ, DE, DK, EE, ES, FI, FR, GB, GR, HR, HU, IE, IS, IT, LT, LU, LV, MC, MK, MT, NL, NO, PL, PT, RO, RS, SE, SI, SK, SM, TR), OAPI (BF, BJ, CF, CG, CI, CM, GA, GN, GQ, GW, KM, ML, MR, NE, SN, TD, TG).

**Declarations under Rule 4.17:**

- as to applicant's entitlement to apply for and be granted a patent (Rule 4.17(ii))
- as to the applicant's entitlement to claim the priority of the earlier application (Rule 4.17(iii))

[Continued on next page]

(54) Title: ENGINE PYLON STRUCTURE

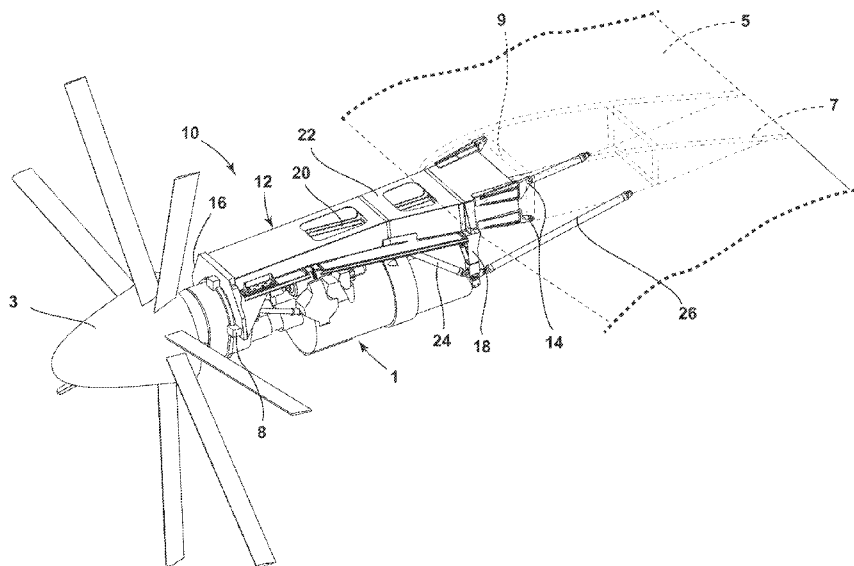

**FIG. 1**

(57) Abstract: A pylon structure (10) for mounting an aircraft engine to a wing. The pylon structure comprises a torque box (12) having a wing mount (14) on the aft portion, a first engine mount (16) on the fore portion and second engine mount (18) on the aft portion.

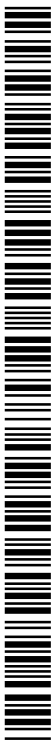

**Published:**

— *with international search report (Art. 21(3))*

## ENGINE PYLON STRUCTURE

## BACKGROUND OF THE INVENTION

[0001] Contemporary aircraft may include a mounting structure to mount an engine to the wing of an aircraft. Typical mounting structures include a plurality of interconnected trusses that create a space frame to carry the loads of the engine into the wing. The design of such mounting structures take into account resistance to engine loads, mass of the structure and structural integrity of the structure in the event of an uncontained engine rotor failure.

## BRIEF DESCRIPTION OF THE INVENTION

[0002] In one aspect, an embodiment of the invention relates to a pylon structure for mounting an aircraft engine to a wing. The pylon structure comprises a torque box having a wing mount on the aft portion, a first engine mount on the fore portion and second engine mount on the aft portion.

## BRIEF DESCRIPTION OF THE DRAWINGS

[0003] In the drawings:

[0004] Figure 1 is perspective view of a portion of an aircraft including an engine, pylon structure and a wing shown in phantom according to an embodiment of the invention. [0005] Figure 2 is perspective view of the pylon structure of Figure 1 with a cover fairing showing exploded according to an embodiment of the invention.

[0006] Figure 3 is a perspective view of the pylon structure of Figure 1 with portions of the stressed skins and other components removed according to an embodiment of the invention.

## DESCRIPTION OF EMBODIMENTS OF THE INVENTION

[0007] Figure 1 illustrates a pylon structure 10 for mounting an engine 1 to the wing 5 of an aircraft according to an embodiment of the invention. The pylon structure 10 may be configured for securing the engine 1 to a portion of the wing 5, such as the wings spar 9 and wing ribs 7. The nacelle has been removed for clarity as the nacelle surrounds the engine 1 and at least a portion of the pylon structure 10. The wing 5 is shown in phantom also for clarity.

[0008] The engine 1 is a turboprop engine having a propeller 3 and may be coupled to the wing 5 of an aircraft to provide propulsion. While only one engine 1 is illustrated mounted to the wing 5, it should be noted that that any number of engines 1 may be mounted to the wing 5. While a commercial aircraft having a turboprop engine has been illustrated, it is contemplated that embodiments of the invention may be used in any type of aircraft, for example, without limitation, fixed-wing, rotating-wing, and military aircraft, and may be used for any type of engine, for example, without limitation, turboshaft, turbojet, turbofan and reciprocating engines.

[0009] The pylon structure 10 comprises a torque box 12, which is mounted by wing mounts 14 to the wing. First and second engine mounts 16, 18 along with connecting rods 24 and thrust links 26, mount the engine 1 to the torque box 12. The pylon structure 10 reacts engine loads, including but not limited to the engine weight, thrust and torque and creates a load path for the loads into the wing 5 of the aircraft. As will become clear from the following description, the loads are transferred through the engine mounts 16, 18, the torque box 12, connecting rods 24 and thrust links 26 into the front spar 9 and ribs 7 of the wing 5. The pylon structure 10 is configured to react loads generated by an engine 1 having a horsepower (HP) in the range of 5,000 HP but it is contemplated that embodiments of the invention may be used to react loads from an engine having any horsepower or thrust rating. [0010] The torque box 12 extends along a longitudinal axis between the first engine mount 16 and the wing mounts 14 wherein the longitudinal axis is defined as extending through the center of the torque box 12 from the first engine 16 to second engine mount 18. The first engine mount is provided on a fore portion of the torque box 12 wherein fore is defined as in the direction of the propeller 3 from the wing 5. The second engine mount 18 is provided on an aft portion of the torque box 12 wherein aft is defined as in the direction of the wing 5 from the propeller 3.

[0011] The torque box 12 may be mounted to the engine 1 such that it is disposed substantially above the engine 1. The first engine mount 16 mounts to the engine 1 at a fore portion of the engine 1 aft of the propeller 3 wherein fore mounting supports 8 configured to mate with the first engine mount 16 are disposed. The second engine mount 18 mounts to the engine 1 in an aft portion of the engine 1 wherein aft mounting supports (not shown) configured to mate with the second engine mount 18 are disposed.

[0012] The wing mounts 14 are provided on an aft portion of the torque box 12 configured to mate with the spar 9 of the wing 5. The wing mounts 14 may comprise multiple brackets 14a, 14b, 14c, 14d (shown Figures 2 and 3). The wing mounts 14 acts as the load

transferring component of the pylon structure 10 to direct loads from the engine 1 into the spar 9 of the wing 5. Loads directed through the torque box 12 from the first and second engine mounts 16, 18 may travel through the wing mounts 14 into the spar 9 of the wing 5. The wing mounts 14 acts as the primary load path to direct engine loads into the spar 9. [0013] The connecting rods 24 extend from the second engine mount 18 to a portion of the torque box 12 aft of the first engine mount 16 in both the longitudinal and downward directions. The thrust links 26 extend from the second engine mount 18 to the wing 5 in both the longitudinal and upwards direction. Loads directed through the torque box 12 may travel through the connecting rods 24, second engine mount 18 and thrust links 26 into the ribs 7 of the wing 5. The connecting rods 24 and thrust links 26 act as a secondary load path to direct portion of the loads into the ribs 7 so as to reduce the loads transferred into the spar 9.

[0014] The torque box 12 comprises a skeletal frame 20 and stressed skins 22 mounted to the skeletal frame 20. Figure 2 more clearly illustrates the stressed skins 22 of the torque box 12. The stressed skins 22 comprise a top skin 22a, bottom skin 22b, side skins 22c, 22d and aft skin 22e (best seen in Figure 3) wherein the stressed skins 22 may cover the outer portions of the skeletal frame 20.

[0015] The first and second engine mounts 16, 18 may comprise a yoke configured to correspond to a portion of the engine 1 to mount to the fore engine supports 8 (shown in Figure 1). The first engine mount may be provided on the fore portion of the torque box 12. Gussets 36, extending between the first engine mount 16 and the torque box 12, may be provided to aid in transferring engine loads to the torque box 12 by triangulating the first engine mount 16 to torque box 12 interface to improve the load transferring characteristics thereof. The second engine mount 18 may comprise a plurality of brackets 19 of the like for mounting to the aft engine supports (not shown). The second engine mount 18 mounts to the aft portion of the torque box 12 encompassing a portion of the side skins 22c, 22d.

[0016] Figure 3 shows the pylon structure 10 with the top, bottom and side skins 22 removed to more clearly illustrate the skeletal frame 20. The skeletal frame 20 comprises a plurality of formers 30 in the form of webs spaced along the longitudinal axis of the torque box 12. The formers 30 are connected to at least two stringers 28 disposed between the first and second engine mounts 16, 18 radially offset from the longitudinal axis of and on opposite sides of the torque box 12. The stringers 28 may have a planarity of voids 46 formed in the stringer 28 in order to save weight. The aft skin 22e connects between the stringers 28 at the aft portion of the torque box 12 between the wing mounts 14 and may comprise a monolithic

grid structure 23 to add rigidity to the aft skin 22e.

[0017] Referring again to Figure 2, the stressed skins 22 are mounted to the skeletal frame 20 so that the stressed skins 22 provide tension between the members of the skeletal frame 20. Furthermore, the stressed skins 22 may be integrally formed with portions of the skeletal frame 20 or as separate pieces. The combination of the skins 22 and the skeletal frame 20 form a box beam structure, which is substantially more resistant to reacted torque from the engine than traditional pylon structures that use a truss frame.

[0018] The top skin 22a may comprise at least one opening 32 configured to allow access to an engine controller compartment defined by the torque box 12 wherein an engine control unit 34 may be mounted. It is contemplated that other components may be mounted inside the torque box, for example, without limitation, electrical wiring and fuel lines. A thermal barrier 38 may be disposed under the bottom skin 22b and mounted thereto. A plurality of hinges 40 may be mounted to the torque box 12, defining a hinge line 42 so as to pivotally mount a fairing 44 to the torque box 12. The fairing 44 may be pivotally mounted to the hinges 40 along the hinge line 42 to selectively allow or prevent access to the opening 32 as well as provide aerodynamic properties.

[0019] The embodiments described above provide for a variety of benefits including that the embodiments allow for a structurally efficient (low weight) load path to direct engine loads into the wing of the aircraft. The box beam structure of the torque box 12 provides much greater resistance to reacted torque from the engine. The torque box 12 is also mounted to the leading edge of the wing, which simplifies the offset from the engine output shaft to the rotational axis of the propeller. In turboprop aircraft, for efficiency purposes, it is desirable to locate the rotational axis of the propeller along the leading edge of the wing, which results in an offset between the engine output (drive shaft or the like) and the propeller drive shaft. This offset is normally filled by some type of drive mechanism connecting the engine output and the propeller drive shaft. Prior pylon structures mount to the underside of the wing and further increase the distance between the engine output and the propeller drive shaft. The torque box 12 of the invention mounts to the leading edge of the wing, which does not increase the distance between the engine output and the propeller drive shaft.

[0020] The inherent compartments of the torque box 12 formed within the stressed skins 22 between the formers 30 and stringers 28 of the skeletal frame 20 provide mounting locations for components, such as an engine control unit 34, away from the engine 1 which reduces engine heat applied to the components and thereby increases component life as well as

eliminates the need for dedicated component mounting locations, thereby saving weight. The openings in the torque box 12 with integrated hinge line 42 allow for efficient access to components mounted therein, thereby reducing maintenance times and eliminating the need for a hinge beam which saves weight. The wing mounts 14 provided on the aft most portion of the torque box 12 allows the torque box 12 to be mounted in front of the spar 9, enabling the engine 1 to be mounted closer to the wing 5, improving the propeller aerodynamics. By providing a secondary load path through the thrust links 26 into the ribs 7 of the wing 5, the loads applied to the spar 9 are reduced, thereby allowing for smaller spars with reduced weight. Furthermore, disposing the torque box 12 above the engine 1, minimizes the critical load bearing structure (torque box 12) surrounding the engine 1, resulting in a lower probability of failure in the event of a rotor burst event as well as provides open access to greater portions of the engine 1 which reduce maintenance times.

[0021] To the extent not already described, the different features and structures of the various embodiments may be used in combination with each other as desired. That one feature may not be illustrated in all of the embodiments is not meant to be construed that it may not be, but is done for brevity of description. Thus, the various features of the different embodiments may be mixed and matched as desired to form new embodiments, whether or not the new embodiments are expressly described. All combinations or permutations of features described herein are covered by this disclosure.

[0022] This written description uses examples to disclose the invention, including the best mode, and also to enable any person skilled in the art to practice the invention, including making and using any devices or systems and performing any incorporated methods. The patentable scope of the invention is defined by the claims, and may include other examples that occur to those skilled in the art. Such other examples are intended to be within the scope of the claims if they have structural elements that do not differ from the literal language of the claims, or if they include equivalent structural elements with insubstantial differences from the literal languages of the claims.

## CLAIMS

What is claimed is:

1. A pylon structure for mounting an aircraft engine to a wing, comprising: a torque box;  
  
a wing mount provided on an aft portion of the torque box;  
  
a first engine mount provided on a fore portion of the torque box; and a second engine mount provided on the aft portion of the torque box.
2. The pylon structure of claim 1 wherein the torque box comprises a skeletal frame with stressed skins mounted to the skeletal frame.
3. The pylon structure of claim 2 wherein the skeletal frame comprises a plurality of formers.
4. The pylon structure of claim 3 wherein the torque box has a longitudinal axis and at least some of the formers are spaced along the longitudinal axis.
5. The pylon structure of claim 3 wherein the skeletal frame comprises a plurality of formers connected by a plurality of stringers.
6. The pylon structure of claim 5 wherein the torque box has a longitudinal axis and at least some of the stringers are radially offset from the longitudinal axis.
7. The pylon structure of claim 1 wherein the first engine mount comprises a first yoke mounted to the fore end of the torque box.
8. The pylon structure of claim 7 wherein the first engine mount further comprises gussets extending from the first yoke to the torque box.
9. The pylon structure of claim 7 wherein the second engine mount comprises a second yoke.

10. The pylon structure of claim 9 further comprises at least one thrust link extending from the second yoke aft of the wing mount.
11. The pylon structure of claim 9 wherein the wing mount comprises a front spar mount provide on the aft end of the torque box.
12. The pylon structure of claim 11 wherein the front spar mount comprises multiple brackets mounted to the aft end.
13. The pylon structure of claim 1 wherein the torque box defines an engine controller compartment and has an opening providing access to the engine controller compartment.
14. The pylon structure of claim 13 further comprising a fairing covering the opening to the engine controller compartment.
15. The pylon structure of claim 1 further comprising a hinge line provided along the torque box.

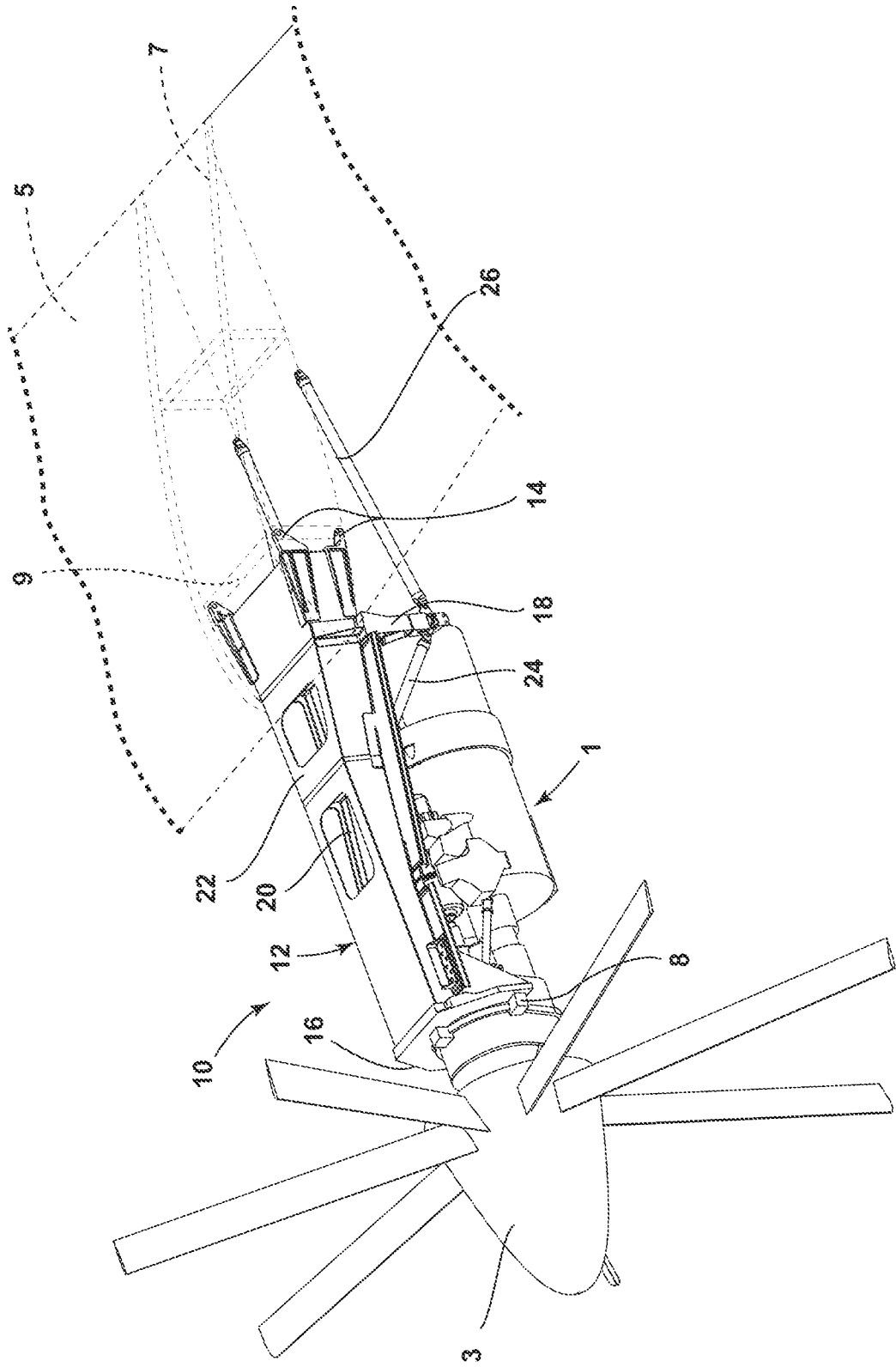

FIG. 1

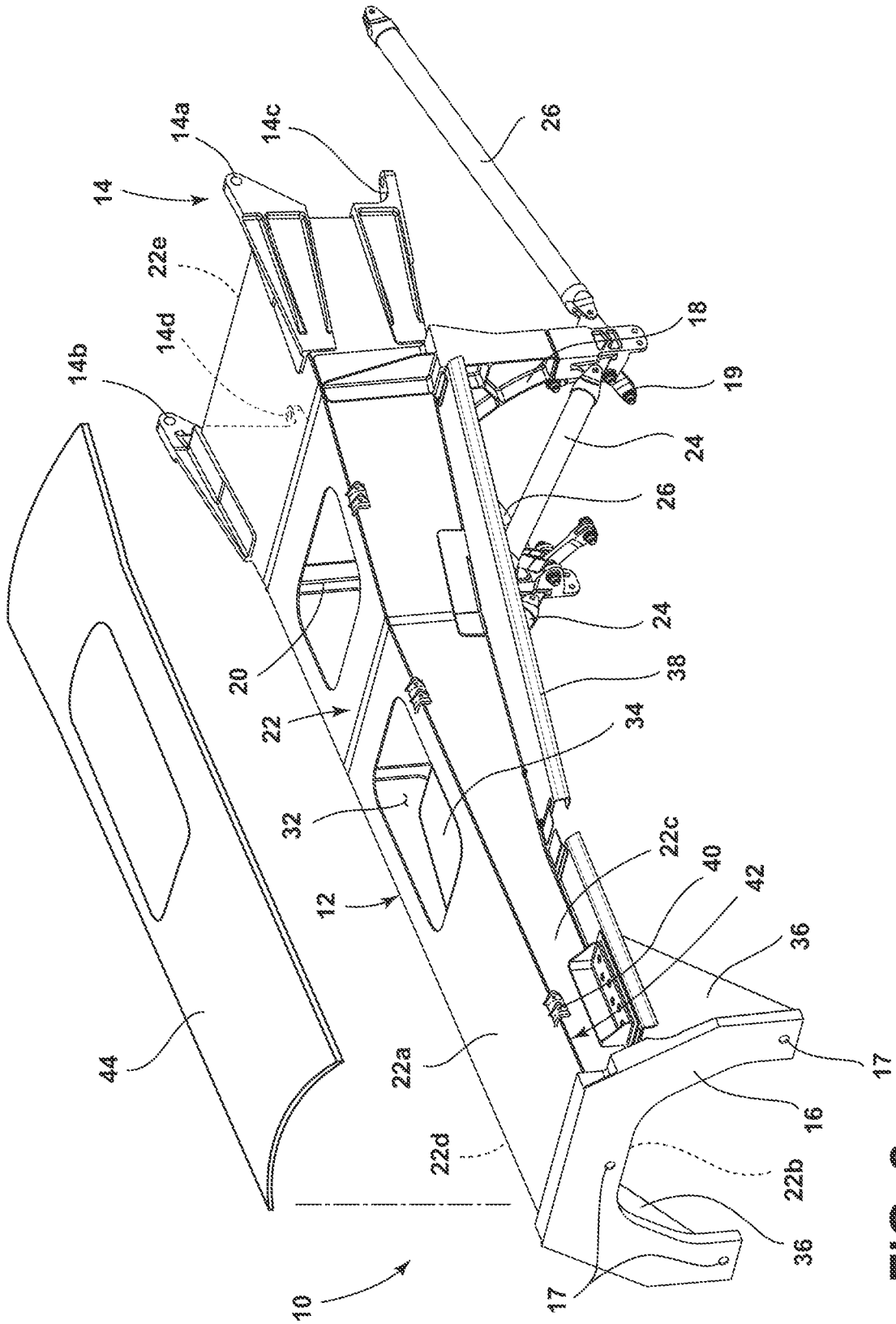

FIG. 2

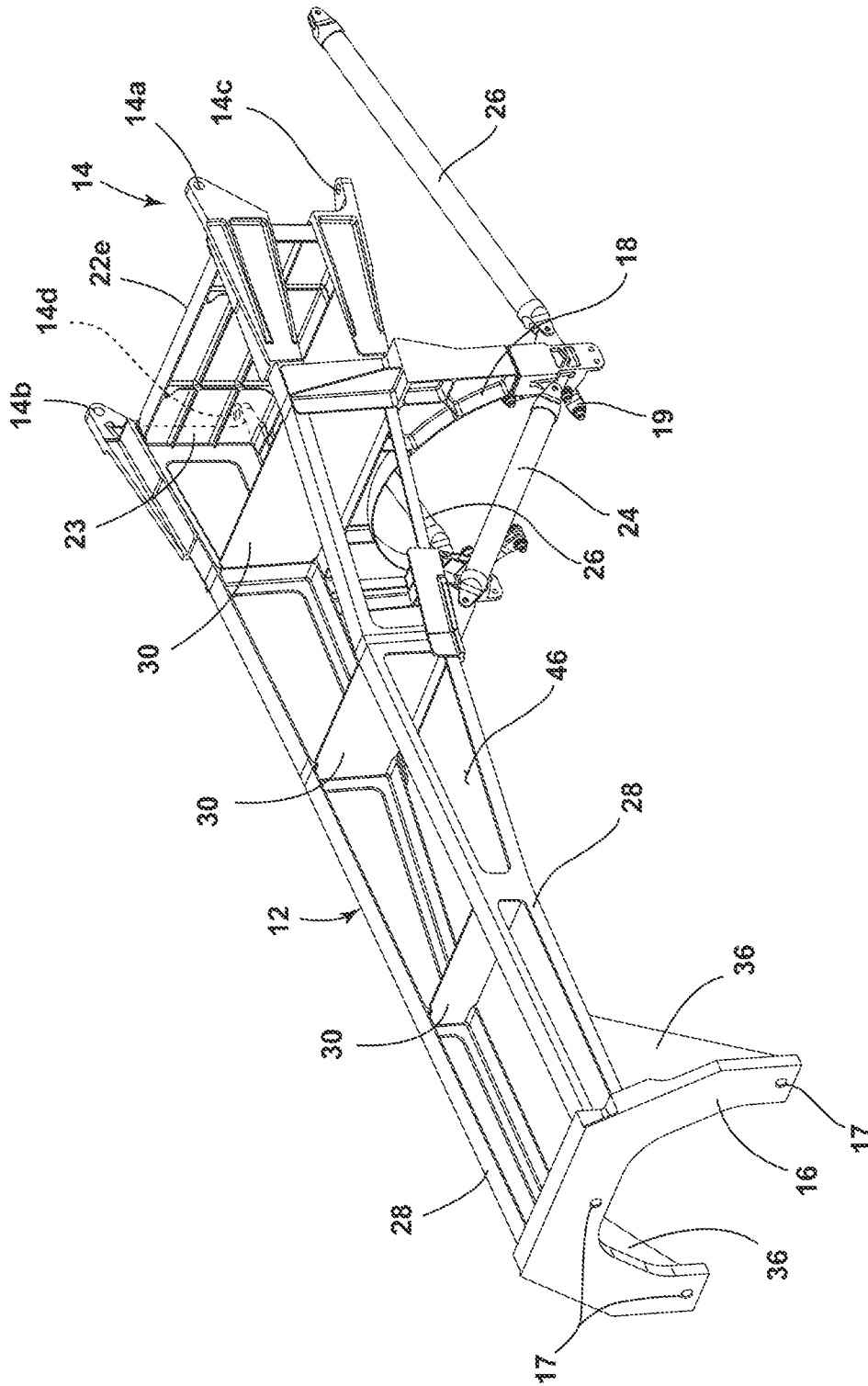

FIG. 3

**INTERNATIONAL SEARCH REPORT**

International application No  
PCT/US2015/017267

A. CLASSIFICATION OF SUBJECT MATTER  
INV. B64D27/26  
ADD.  
  
According to International Patent Classification (IPC) or to both national classification and IPC

B. FIELDS SEARCHED  
Minimum documentation searched (classification system followed by classification symbols)  
B64D

Documentation searched other than minimum documentation to the extent that such documents are included in the fields searched

Electronic data base consulted during the international search (name of data base and, where practicable, search terms used)  
EPO-Internal, WPI Data

**C. DOCUMENTS CONSIDERED TO BE RELEVANT**

Category*	Citation of document, with indication, where appropriate, of the relevant passages	Relevant to claim No.
X	FR 2 909 973 A1 (AIRBUS FRANCE SA [FR]) 20 June 2008 (2008-06-20) abstract; figures 7-14 -----	1-15
X	US 2011/127371 A1 (TAKEUCHI AKIRA [JP]) 2 June 2011 (2011-06-02) figure 1 -----	1
A	WO 95/18042 A1 (BOEING CO [US]) 6 July 1995 (1995-07-06) figures 1,2 -----	1-15
A	FR 2 915 178 A1 (AIRBUS FRANCE SA [FR]) 24 October 2008 (2008-10-24) figure 1 -----	1-15

Further documents are listed in the continuation of Box C.

See patent family annex.

\* Special categories of cited documents :

- "A" document defining the general state of the art which is not considered to be of particular relevance
- "E" earlier application or patent but published on or after the international filing date
- "L" document which may throw doubts on priority claim(s) or which is cited to establish the publication date of another citation or other special reason (as specified)
- "O" document referring to an oral disclosure, use, exhibition or other means
- "P" document published prior to the international filing date but later than the priority date claimed

- "T" later document published after the international filing date or priority date and not in conflict with the application but cited to understand the principle or theory underlying the invention
- "X" document of particular relevance; the claimed invention cannot be considered novel or cannot be considered to involve an inventive step when the document is taken alone
- "Y" document of particular relevance; the claimed invention cannot be considered to involve an inventive step when the document is combined with one or more other such documents, such combination being obvious to a person skilled in the art
- "&" document member of the same patent family

Date of the actual completion of the international search  8 May 2015	Date of mailing of the international search report  20/05/2015
---	--

Name and mailing address of the ISA/ European Patent Office, P.B. 5818 Patentlaan 2 NL - 2280 HV Rijswijk Tel. (+31-70) 340-2040, Fax: (+31-70) 340-3016	Authorized officer  Wojski, Guadalupe
--	---

# INTERNATIONAL SEARCH REPORT

Information on patent family members

International application No PCT/US2015/017267
---

Patent document cited in search report	Publication date	Patent family member(s)	Publication date
FR 2909973	A1	20-06-2008	NONE
US 2011127371	A1	02-06-2011	CA 2718684 A1 01-06-2011
			CA 2872814 A1 01-06-2011
			JP 5642379 B2 17-12-2014
			JP 2011116186 A 16-06-2011
			US 2011127371 A1 02-06-2011
WO 9518042	A1	06-07-1995	AU 1255495 A 17-07-1995
			US 5467941 A 21-11-1995
			WO 9518042 A1 06-07-1995
FR 2915178	A1	24-10-2008	AT 542741 T 15-02-2012
			EP 2139769 A1 06-01-2010
			FR 2915178 A1 24-10-2008
			US 2010090056 A1 15-04-2010
			WO 2008129042 A1 30-10-2008