



US 20220248829A1

(19) **United States**

(12) **Patent Application Publication**
Williams

(10) **Pub. No.: US 2022/0248829 A1**

(43) **Pub. Date: Aug. 11, 2022**

(54) **HAIR FOIL DISPENSER UNIT**

Publication Classification

(71) Applicant: **Scott Williams**, Lakeland, FL (US)

(51) **Int. Cl.**
A45D 44/04 (2006.01)

(72) Inventor: **Scott Williams**, Lakeland, FL (US)

A45D 19/00 (2006.01)

(21) Appl. No.: **17/508,716**

(52) **U.S. Cl.**
CPC **A45D 44/04** (2013.01); **A45D 19/018**
(2021.01)

(22) Filed: **Oct. 22, 2021**

Related U.S. Application Data

(57) **ABSTRACT**

(60) Provisional application No. 63/106,353, filed on Oct. 27, 2020.

A hair foil dispenser unit that can be secured to a salon instrument tray is described.

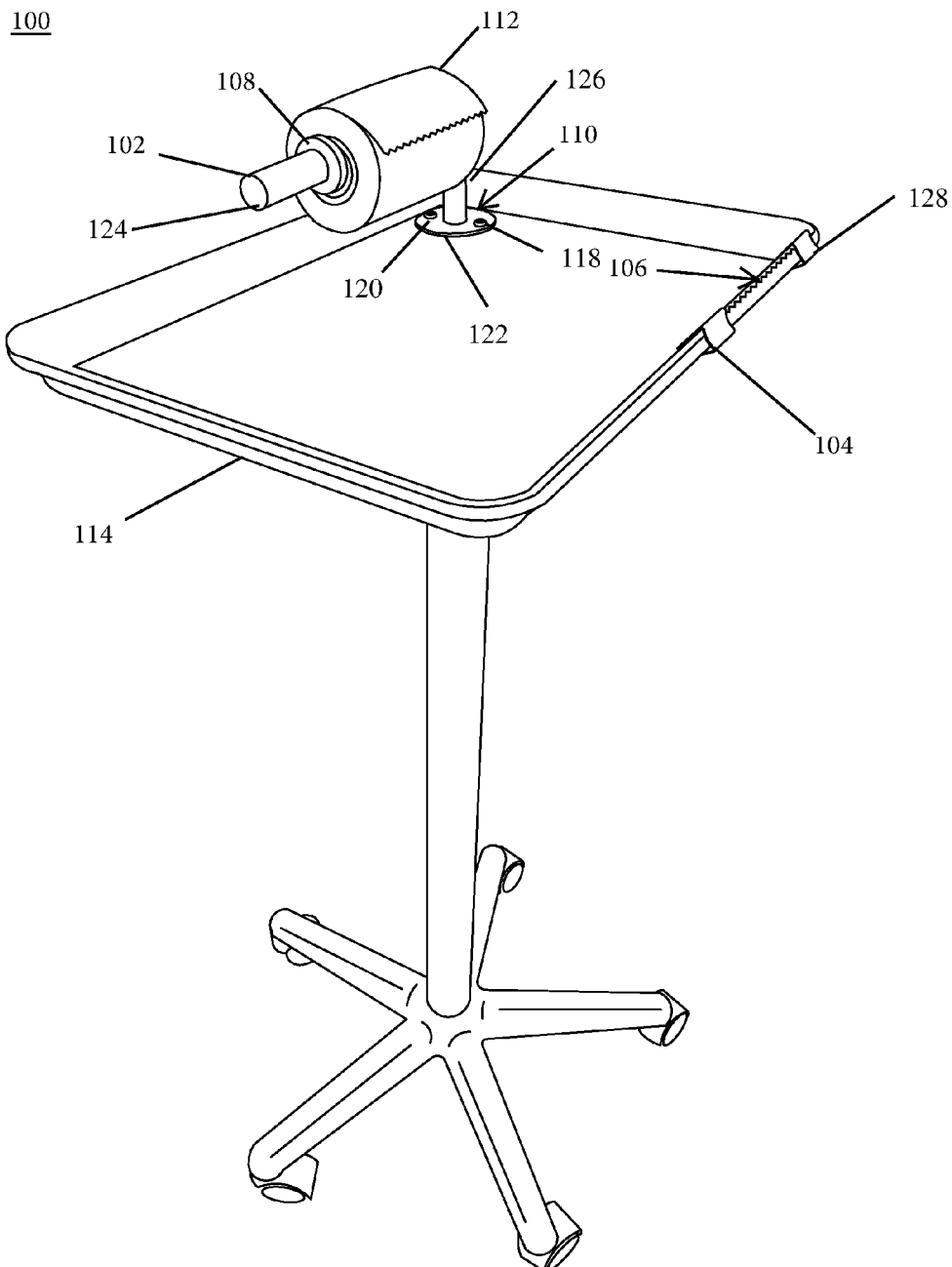

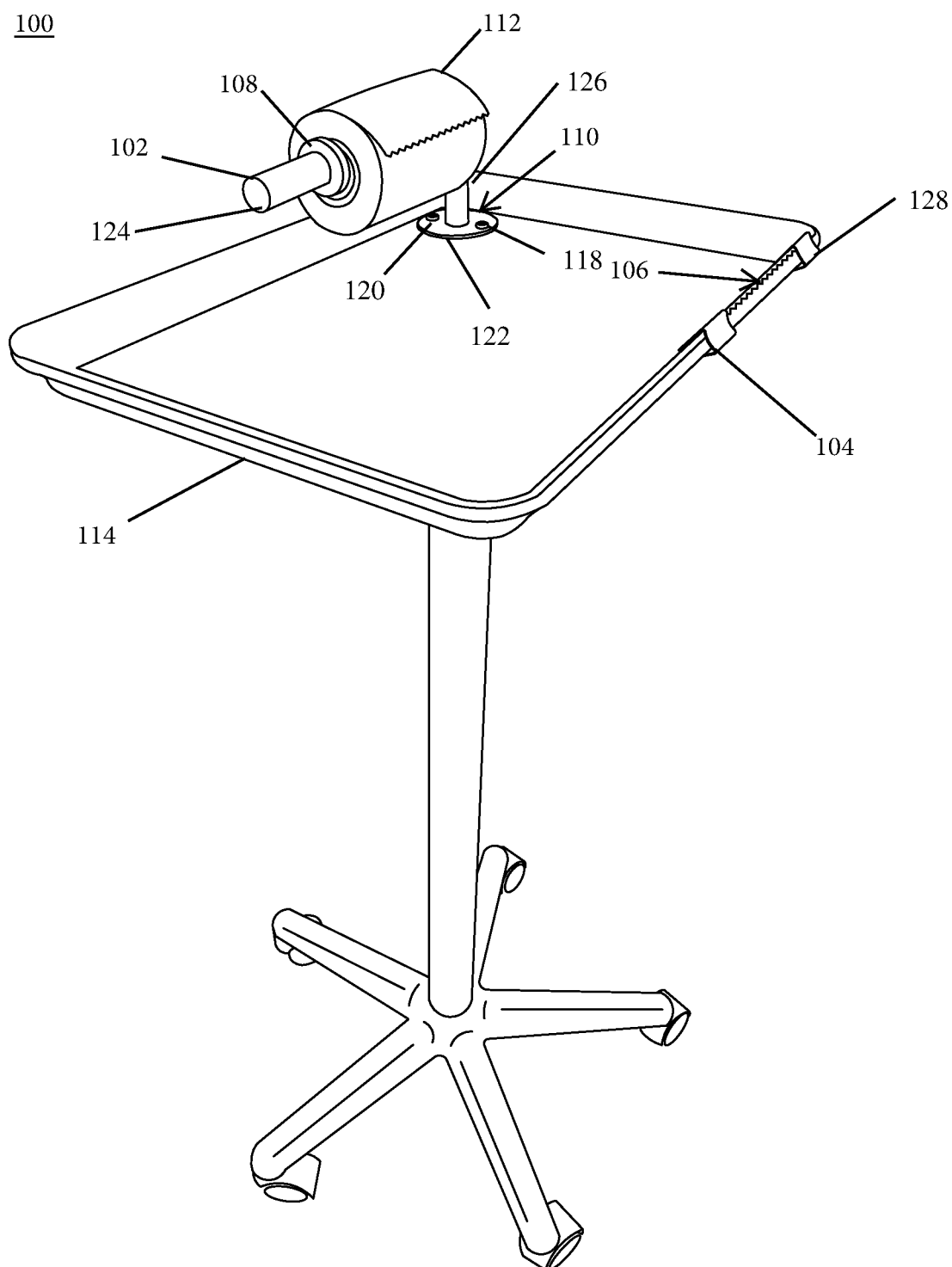

FIG. 1

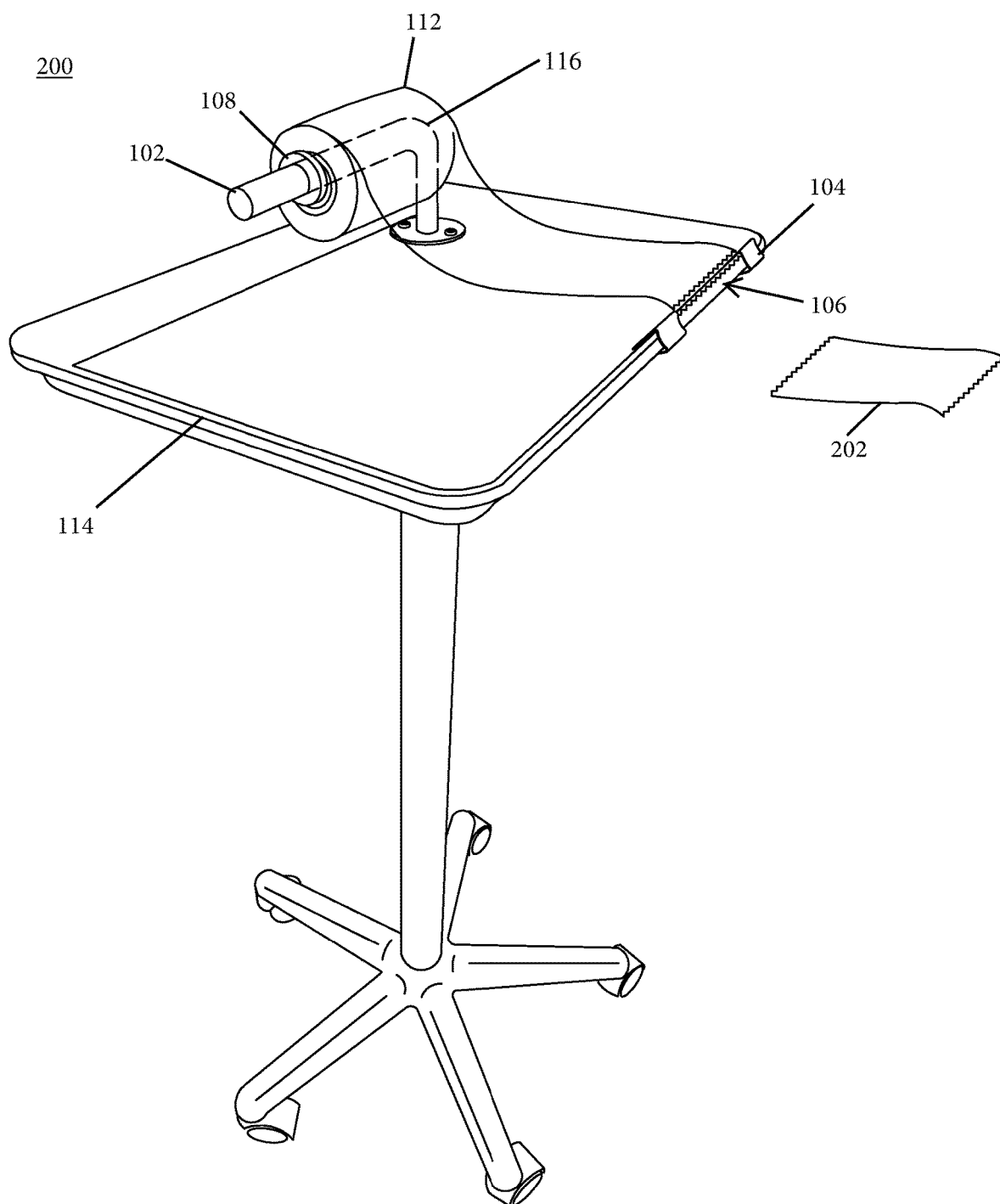

FIG. 2

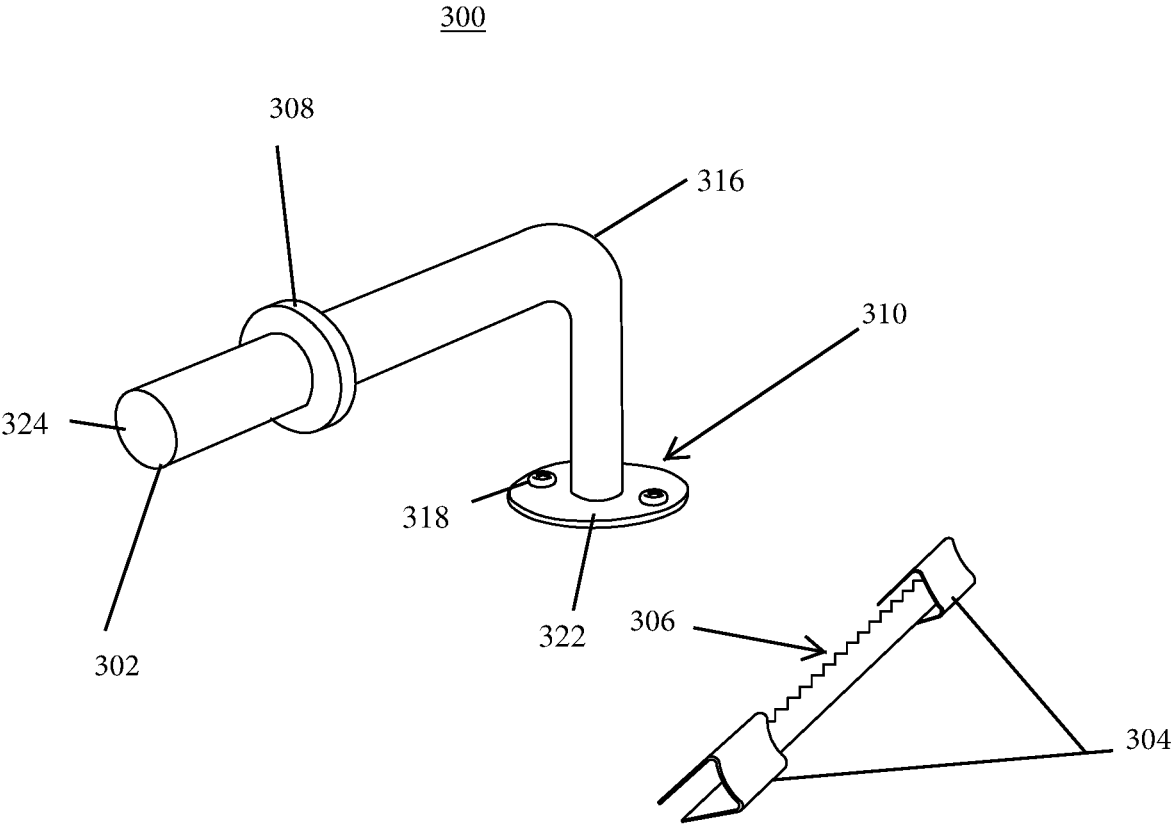

FIG. 3

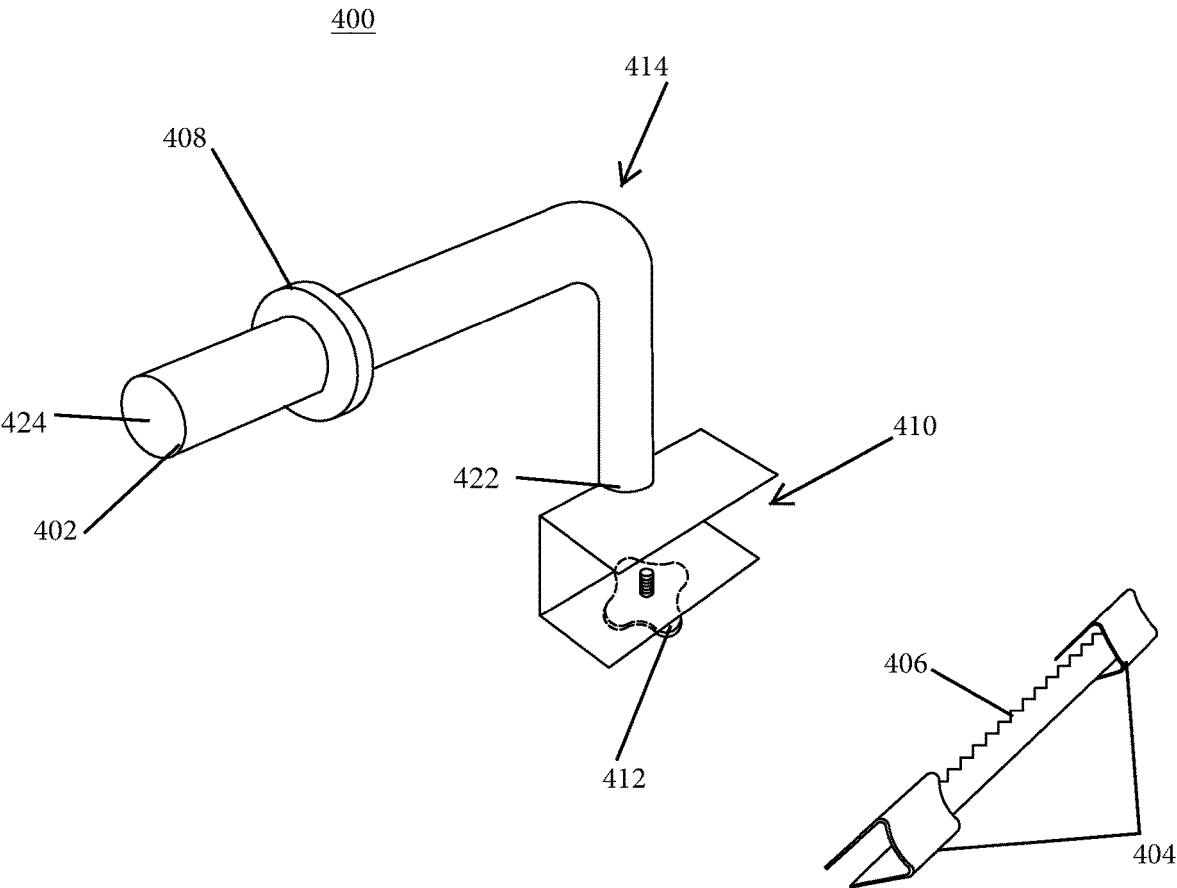

FIG. 4

HAIR FOIL DISPENSER UNIT

RELATED APPLICATIONS

[0001] This application claims the benefit of U.S. Application No. 63/106,353, titled “Hair Foil Dispenser Unit” and filed on Oct. 27, 2020, which is incorporated herein by reference in its entirety.

FIELD

[0002] Some implementations relate generally to a hair foil dispenser unit and more particularly to a hair foil dispenser unit that is secured to a salon instrument tray.

BACKGROUND

[0003] Foil rolls for hair coloring or styling typically come packaged in a box that usually has a serrated strip of metal at the edge of the box. The serrated strip of metal is used to cut the foil by pulling the foil against the edge. Cutting the roll or foil normally involves one hand holding the box as the foil is pulled with the other hand to the desired length, and then pulling the foil against the serrated strip of metal at the edge of the box. Another way to cut the foil is to unroll the foil to the desired length and then cut it with a scissor. Both of the above methods are inconvenient processes as they require the use of both hands to separate the foil from the foil roll in the box.

[0004] Embodiments were conceived in light of the above-mentioned problems and limitations, among other things.

SUMMARY

[0005] Some implementations can include a salon instrument tray system comprising a salon instrument tray and a hair foil dispenser unit. In some implementations, the hair foil dispenser unit can include a tubular body portion having a first end and a second end. In some of the implementations, the tubular body portion can also include a flange. In some implementations, the first end of the tubular body portion can include the flange. The flange can have a plurality of apertures in some implementations. In some implementations, the flange can be attached to the salon instrument tray via a plurality of fasteners, with each fastener inserted into a corresponding aperture of the plurality of apertures. In some implementations, the flange can be attached to the salon instrument tray, adjacent a first edge of the salon instrument tray. The tubular body portion can include a bend disposed between the first end and the second end in some implementations.

[0006] In some implementations, the hair foil dispenser unit can also include a removable locking ring configured to fit onto the second end of the tubular body portion to retain a roll of foil on the tubular body portion. In some implementations, the hair foil dispenser unit can also include a serrated strip of metal having a first end and a second end. In some implementations, the first end of the serrated strip can have a first fastener and the second end of the serrated strip can have a second fastener. In some implementations, the first fastener and the second fastener can each be attached to a second edge of the salon instrument tray opposite to the first edge.

[0007] In some implementations, the first fastener and/or the second fastener of the serrated strip of the hair foil dispenser unit can include a screw, a nut, a bolt, a rivet, a clamp, or an adhesive.

[0008] Some implementations can include a retro fit hair foil dispenser unit comprising a tubular body portion having a first end and a second end. The tubular body portion can include a bend disposed between the first end and the second end in some of the implementations. In some implementations, the tubular body portion can include a flange. The first end of the tubular body portion can include the flange in some implementations. The flange can be attached to the salon instrument tray, adjacent to a first edge of the salon instrument tray in some implementations. In some implementations, the flange can have a plurality of apertures. In some implementations, the flange can be attached to the salon instrument tray via a plurality of fasteners, with each fastener being inserted into a corresponding aperture of the plurality of apertures of the flange.

[0009] In some implementations, the retro fit hair foil dispenser unit can also include a removable locking ring configured to fit onto the second end of the tubular body portion to retain a roll of foil on the tubular body portion. In some implementations, the retro fit hair foil dispenser unit can also include a serrated strip of metal having a first end and a second end. In some implementations, the first end of the serrated strip can have a first fastener and the second end of the serrated strip can have a second fastener. In some implementations, the first adjustable fastener and the second adjustable fastener of the serrated strip can each be attached to a second edge of the salon instrument tray opposite to the first edge of the salon instrument tray.

[0010] In some implementations, the first fastener and/or the second fastener of the retro fit hair foil dispenser unit can include one or more of a screw, a nut, a bolt, a rivet, a clamp, or adhesive.

[0011] Some implementations can include a retro fit hair foil dispenser unit with an adjustable clamp. In some implementations, the retro fit hair foil dispenser unit can comprise a tubular body portion having a first end and a second end. The tubular body portion can have a bend disposed between the first end and the second end in some implementations. In some implementations, the tubular body may include the adjustable clamp. In some implementations, the first end of the tubular body can include the adjustable clamp. The adjustable clamp can be attached to the salon instrument tray, adjacent to a first edge of the salon instrument tray in some implementations. The adjustable clamp can also be secured to the tray via a fastener in some implementations.

[0012] In some implementations, the retro fit hair foil dispenser unit with an adjustable clamp can also include a removable locking ring configured to fit onto the second end of the tubular body portion to retain a roll of foil on the tubular body portion. In some implementations, the retro fit hair foil dispenser unit with an adjustable clamp can also include a serrated strip of metal having a first end and a second end. In some implementations, the first end of the serrated strip can have a first fastener and the second end of the serrated strip can have a second fastener. In some implementations, the first adjustable fastener and the second adjustable fastener can each be attached to a second edge of the salon instrument tray, opposite to the first edge of the tray.

[0013] In some implementations, the first fastener and/or the second fastener of the retro fit hair foil dispenser unit can include one or more of a screw, a nut, a bolt, a rivet, a clamp, or adhesive.

BRIEF DESCRIPTION OF THE DRAWINGS

[0014] FIG. 1 is a diagram showing a top perspective view of an example hair foil dispenser unit in accordance with some implementations.

[0015] FIG. 2 is a diagram showing a top perspective view of an example hair foil dispenser unit in accordance with some implementations.

[0016] FIG. 3 is a diagram showing a top perspective view of an example retro fit hair foil dispenser unit in accordance with some implementations.

[0017] FIG. 4 is a diagram showing a top perspective view of an example retro fit hair foil dispenser unit with an adjustable clamp in accordance with some implementations.

DETAILED DESCRIPTION

[0018] Some implementations can include a hair foil dispenser unit that can be secured to a salon instrument tray.

[0019] FIG. 1 is a diagram showing a top perspective view of an example hair foil dispenser unit installed in accordance with some implementations. The hair foil dispenser unit 100 includes a tubular body portion 102, a set of adjustable fasteners 104, a serrated strip of metal 106, a removable locking ring 108, a flange 110, a roll of foil 112, and a salon instrument tray 114.

[0020] The tubular body portion 102 can include a first end 122 and a second end 124, a bend 116 disposed between the first end 122 and the second end 124, and a flange 110. The first end 122 of the tubular body portion can include the flange 110. The flange 110 can have a plurality of apertures 118. The flange 110 can be attached to the salon instrument tray 114, adjacent a first edge 126 of the salon instrument tray 114, via a plurality of fasteners 120, with each fastener of the plurality of fasteners 120 being inserted into a corresponding aperture of the flange 110.

[0021] The hair foil dispenser unit 100 can also include a removable locking ring 108 configured to fit onto the second end 124 of the tubular body portion to retain a roll of foil 112 on the tubular body portion 102. The serrated strip of metal 106 includes a first end and a second end. The first end of the serrated strip can have a first fastener (e.g., one of 104) and the second end of the serrated strip can have a second fastener (e.g., the other of 104). The first fastener and the second fastener can be attached to a second edge 128 of the salon instrument tray 114 opposite to the first edge 126, where the first and second fasteners 104 of the serrated strip can include one or more of a screw, a nut, a bolt, a rivet, a clamp, an adhesive, or any other suitable fasteners.

[0022] The hair foil dispenser unit 100 is configured to hold the roll of foil 112 in place via the tubular body portion 102 and requires a user to only have to use one hand to cut off a piece of foil (e.g., as shown in FIG. 2 at 202). This is achieved by a user pulling on a distal end or a free edge of the foil on the roll of foil 112 in a horizontal direction, unrolling the foil to the desired length, and then pulling the foil in a downward direction against the serrated strip of metal 106 at the edge of the salon instrument tray 114, thereby separating a piece of foil (202) by cutting it with the serrated strip of metal 106. Some implementations can include a salon tray with the flange, the tubular body portion, and/or the serrated strip fully integrated into the salon tray.

[0023] FIG. 2 is a diagram showing a top perspective view of an example hair foil dispenser unit in accordance with some implementations. The hair foil dispenser unit 200

includes a tubular body portion 102, a set of adjustable fasteners 104, a serrated strip of metal 106, a removable locking ring 108, a roll of foil 112, a salon instrument tray 114, and a cut piece of foil 202.

[0024] The first adjustable fastener and the second adjustable fastener 104 can include one or more of a screw, a nut, a bolt, a rivet, a clamp, or an adhesive, among other suitable fasteners.

[0025] FIG. 3 is a diagram showing a top perspective view of an example retro fit hair foil dispenser unit 300 in accordance with some implementations. The retro fit hair foil dispenser unit 300 includes a tubular body portion 302, a set of adjustable fasteners 304, a serrated strip of metal 306, a removable locking ring 308, and a flange 310.

[0026] The retro fit hair foil dispenser unit 300 can include a tubular body portion 302 having a first end 322 and a second end 324, a bend 316 disposed between the first end 322 and the second end 324, and a flange 310. The first end 322 of the tubular body can include the flange 310. The flange 310 can have a plurality of apertures 318. The flange 310 can be attached to the salon instrument tray 314, adjacent a first edge of the salon instrument tray (e.g., similar to 114), via a plurality of fasteners, with each fastener of the plurality of these fasteners being configured to be inserted into a corresponding aperture of the plurality of apertures 318 of the flange 310.

[0027] The retro fit hair foil dispenser unit 300 can also include a removable locking ring 308 configured to fit onto the second end 324 of the tubular body portion 302 to retain a roll of foil (e.g., 112) on the tubular body portion 302. The serrated strip of metal 306 has a first end and a second end, where the first end can have a first adjustable fastener and the second end can have a second adjustable fastener of the set of adjustable fasteners 304. The first adjustable fastener and the second adjustable fastener 304 can be attached to a second edge of a salon instrument tray (e.g., similar to 114) opposite to the first edge of the salon instrument tray (e.g., similar to 114).

[0028] The retro fit hair foil dispenser unit 300 is configured to permanently attach to an existing salon instrument tray and hold a roll of foil (e.g., 112), thereby allowing a user to unroll the foil by pulling on a distal end or a free edge of the foil on the roll of foil (e.g., 112) to the desired length, and then pull the foil in a downward direction against the serrated strip of metal 306 at the edge of the salon instrument tray to cut off a piece of foil from the roll (e.g., similar to 202).

[0029] The first adjustable fastener and the second adjustable fastener 304 can include one or more of a screw, a nut, a bolt, a rivet, a clamp, or an adhesive, among other suitable fasteners.

[0030] FIG. 4 is a diagram showing a top perspective view of an example retro fit hair foil dispenser unit 400 with an adjustable clamp in accordance with some implementations. The hair foil dispenser unit 400 includes a tubular body portion 402, a set of adjustable fasteners 404, a serrated strip of metal 406, a removable locking ring 408, an attachment clamp 410, a fastener 412, and a bend 414 between a first end and a second end of the tubular body portion 402.

[0031] The retro fit hair foil dispenser unit 400 with an adjustable clamp can include a tubular body portion 402 having a first end and a second end, a bend 414 disposed between the first end 422 and the second end 424, and an adjustable clamp 410. The first end 422 of the tubular body

portion can include the adjustable clamp **410**. The adjustable clamp **410** can be attached to a salon instrument tray (e.g., similar to **114**), adjacent a first edge of the salon instrument tray, and secured via a fastener **412**. The adjustable clamp **410** can be fully integrated into the first end of the tubular body portion **402** or can be attached or affixed to the tubular body by suitable means.

[0032] The retro fit hair foil dispenser unit with an adjustable clamp **400** can also include a removable locking ring **408** configured to fit onto the second end **424** of the tubular body portion **402** so as to retain a roll of foil (e.g., **112**) on the tubular body portion **402**. The serrated strip of metal **406** has a first end and a second end, where the first end can have a first adjustable fastener and the second end can have a second adjustable fastener of the set of adjustable fasteners **404**. The first adjustable fastener and the second adjustable fastener **404** can be attached to a second edge of the salon instrument tray opposite to the first edge of the same salon instrument tray.

[0033] The retro fit hair foil dispenser unit with an adjustable clamp **400** is configured to be removably attached to a salon instrument tray (e.g., similar to **114**) and hold a roll of foil (e.g., **112**), and allows a user to unroll the foil by pulling on a distal end or a free edge of the foil to the desired length and then pull the foil in a downward direction against the serrated strip of metal **406** at the edge of the salon instrument tray to cut off a piece of the foil (e.g., similar to **202**).

[0034] The first adjustable fastener and the second adjustable fastener **404** can include one or more of a screw, a nut, a bolt, a rivet, a clamp, or an adhesive, among other suitable fasteners.

[0035] It will also be appreciated that the hair foil dispenser unit, the tubular body portion, the set of adjustable fasteners, the serrated strip of metal, the removable locking ring, the flange, the plurality of apertures, the plurality of fasteners, the clamp, the roll of foil, and the salon instrument tray described herein are for illustration purposes only and are not intended to be limiting. Other types of hair foil dispenser units, tubular body portions, adjustable fasteners, serrated strips of metal, removable locking rings, flanges, apertures, fasteners, clamps, rolls of foil, and salon instrument trays may/can be used depending on a contemplated implementation.

[0036] It is therefore apparent that there is provided, in accordance with the various example implementations disclosed herein, a hair foil dispenser unit that can be secured to a salon instrument tray or a hair foil dispenser unit that can be integrated into a salon instrument tray.

What is claimed is:

1. A salon instrument tray system comprising:

a salon instrument tray; and

a hair foil dispenser unit including:

a tubular body portion having a first end and a second end, wherein the tubular body portion is attached to the salon instrument tray, adjacent a first edge of the salon instrument tray; and

a serrated strip of metal having a first end and a second end, wherein the first end of the serrated strip has a first fastener and the second end of the serrated strip has a second fastener, wherein the first fastener and the second fastener are each attached to a second edge of the salon instrument tray, wherein the second edge is opposite to the first edge.

2. The salon instrument tray system of claim 1, wherein the hair foil dispenser unit further comprises a bend that is disposed between the first end and the second end.

3. The salon instrument tray system of claim 1, wherein the hair foil dispenser unit further comprises a flange that is adjacent to the first end of the tubular body portion.

4. The salon instrument tray system of claim 3, wherein the flange is attached to the salon instrument tray, adjacent to the first edge of the salon instrument tray.

5. The salon instrument tray system of claim 4, wherein the flange has a plurality of apertures, and wherein the flange is attached to the salon instrument tray via a plurality of fasteners, each fastener being inserted into a corresponding aperture.

6. The salon instrument tray system of claim 1, wherein the hair foil dispenser unit further comprises a removable locking ring configured to fit onto the second end of the tubular body portion to retain a roll of foil on the tubular body portion.

7. The salon instrument tray system of claim 1, wherein the first fastener and the second fastener include one or more of a screw, a nut, a bolt, a rivet, a clamp, or an adhesive.

8. A retro fit hair foil dispenser unit comprising:

a tubular body portion having a first end and a second end, wherein the tubular body portion is configured to be attached to a salon instrument tray, adjacent a first edge of the salon instrument tray; and

a serrated strip of metal having a first end and a second end, wherein the first end of the serrated strip has a first adjustable fastener and the second end of the serrated strip has a second adjustable fastener, wherein the first adjustable fastener and the second adjustable fastener are each configured to be attached to a second edge of the salon instrument tray, wherein the second edge is opposite to the first edge.

9. The retro fit hair foil dispenser unit of claim 8, further comprising a bend that is disposed between the first end and the second end.

10. The retro fit hair foil dispenser unit of claim 8, further comprising a flange that is adjacent to the first end of the tubular body portion.

11. The retro fit hair foil dispenser unit of claim 10, wherein the flange is attached to the salon instrument tray, adjacent to the first edge of the salon instrument tray.

12. The retro fit hair foil dispenser unit of claim 11, wherein the flange has a plurality of apertures, and wherein the flange is attached to the salon instrument tray via a plurality of fasteners, each fastener being inserted into a corresponding aperture.

13. The retro fit hair foil dispenser unit of claim 8, further comprising a removable locking ring configured to fit onto the second end of the tubular body portion to retain a roll of foil on the tubular body portion.

14. The retro fit hair foil dispenser unit of claim 8, wherein the first fastener and the second fastener include one or more of a screw, a nut, a bolt, a rivet, a clamp, or an adhesive.

15. A retro fit hair foil dispenser unit with an adjustable clamp comprising:

a tubular body portion having a first end and a second end, wherein the first end of the tubular body portion has an adjustable clamp, wherein the adjustable clamp is configured to be attached to a salon instrument tray, adjacent a first edge of the salon instrument tray; and

a serrated strip of metal having a first end and a second end, wherein the first end of the serrated strip has a first adjustable fastener and the second end of the serrated strip has a second adjustable fastener, wherein the first adjustable fastener and the second adjustable fastener are each configured to be attached to a second edge of the salon instrument tray, wherein the second edge is opposite to the first edge.

16. The retro fit hair foil dispenser unit with an adjustable clamp of claim **15**, wherein the tubular body portion further comprises a bend disposed between the first end and the second end of the tubular body portion.

17. The retro fit hair foil dispenser unit with an adjustable clamp of claim **15**, further comprising a removable locking ring configured to fit onto the second end of the tubular body portion to retain a roll of foil on the tubular body portion.

18. The retro fit hair foil dispenser unit with an adjustable clamp of claim **15**, wherein the first fastener and the second fastener include one or more of a screw, a nut, a bolt, a rivet, a clamp, or an adhesive.

* * * * *