

(19) **DANMARK**

(10) **DK/EP 3255331 T3**



(12) **Oversættelse af
europæisk patentskrift**

Patent- og
Varemærkestyrelsen

-
- (51) Int.Cl.: **F 16 L 23/10 (2006.01)** **A 61 M 39/12 (2006.01)** **A 61 M 39/18 (2006.01)**
F 16 J 15/06 (2006.01) **F 16 L 23/22 (2006.01)**
- (45) Oversættelsen bekendtgjort den: **2021-06-28**
- (80) Dato for Den Europæiske Patentmyndigheds bekendtgørelse om meddelelse af patentet: **2021-03-31**
- (86) Europæisk ansøgning nr.: **17174666.2**
- (86) Europæisk indleveringsdag: **2017-06-07**
- (87) Den europæiske ansøgnings publiceringsdag: **2017-12-13**
- (30) Prioritet: **2016-06-07 NL 2016906**
- (84) Designerede stater: **AL AT BE BG CH CY CZ DE DK EE ES FI FR GB GR HR HU IE IS IT LI LT LU LV MC MK MT NL NO PL PT RO RS SE SI SK SM TR**
- (73) Patenthaver: **ULTRAPHARMA HOLDING BV, De Droogmakerij 12, 1851 LX Heiloo, Holland**
- (72) Opfinder: **SEPPENWOOLDE, Hendrikus Antoon, Velsbroekstraat 6, 2071 ET Santpoort Noord, Holland**
- (74) Fuldmægtig i Danmark: **Novagraaf Brevets, Bâtiment O2, 2 rue Sarah Bernhardt CS90017, F-92665 Asnières-sur-Seine cedex, Frankrig**
- (54) Benævnelse: **FREMANGSMÅDE TIL FORBINDELSE AF TO LEDNINGER FRA UDSTYR TIL STERILISERING**
- (56) Fremdragne publikationer:
WO-A1-2009/146764
WO-A1-2010/144500
US-A- 3 042 430
US-A- 4 438 960
US-A1- 2011 254 268

DESCRIPTION

[0001] The present invention relates to a method of connecting two conduits of equipment to be sterilised, each conduit comprising at a free end thereof a ferrule, wherein a gasket comprising a through-hole is provided between the ferrules of the conduits and a clamp is used to clamp the ferrules together, said clamp comprising two arms, each arm comprising a recess for receiving a circumferential section of the ferrules;

wherein in a state wherein the ferrules are clamped by the clamp, the ferrules provide a passage and the inner surface of the through-hole of the gasket after clamping is flush with the inner wall of the passage provided by the ferrules, and the gasket is capable of bulging into said passage by a temporary increase in temperature.

[0002] It is known in the art to connect two conduits each comprising a ferrule. A ferrule comprises a flange that tapers to a reduced thickness towards the circumference of the flange. A gasket is provided between the two opposing parallel first surfaces of the flanges. The gasket is a disk of elastomeric (resilient) material, such as EPDM, and has a through-hole with a diameter that is slightly larger than the inner diameter of the ferrules. By clamping the ferrules together by pressing the clamp against second surfaces of the flanges that provide the taper, the gasket is somewhat compressed. As a result of the compression of the gasket, the diameter of the through-hole of the gasket is reduced. The objective is that when the ferrules have been clamped together, the through-hole of the gasket has the same diameter as the inner diameter of the ferrules, i.e. the inner surface of the through-hole of the gasket after clamping is flush with the inner wall of the passage provided by the ferrules. This helps to avoid that dirt accumulates at the location of the gasket, and also the flow resistance of liquid passed through the connection is not affected, i.e. there is no pressure drop at the joint. The latter may be in particular significant in case there are several connections, each with a pressure drop.

[0003] The above method is in use in biotech plants and in particular in pharmaceutical plants. There it is often required to sterilise the equipment containing the connection provided by the two clamped ferrules. To this end steam is passed through the conduits, e.g. at 121°C and about 2 Bar steam pressure. As a result of the resulting thermal expansion, the gasket is compressed even more and bulges into the lumen of the connection. Being resilient material, it should return to its original shape once the temperature is back to the regular operating temperature, but it has been found that this is often not the case. As a result, the edge of the hole of the gasket protruding into the lumen of the connection results in a pressure drop. In addition, protruding material of the gasket is vulnerable and may break off, which is undesirable. The problem of bulging, which increases with the number of sterilisation operations, exists even if a torque wrench is used to close the clamp to the intended strength so as to have inner surface of the through-hole of the gasket the flush with the inside of the conduits, the torque wrench preventing over tightening which could exacerbate the problem.

[0004] The object of the present invention is to provide a method in which the problem of gasket bulging caused by a temporary increase in temperature, such as in case of sterilisation,

is reduced.

[0005] To this end, a method according to the preamble is characterized in that a resilient element is provided in the recess of at least one arm of the clamp between said at least one arm and the ferrules, wherein the resilient element is an elastomeric lining, wherein the recess of at least one arm of the clamp comprises said elastomeric lining.

[0006] For gaskets that have even been subjected to multiple heat cycles (steam sterilisation at 121°C and about 2 Bar)) it has surprisingly been found that the damage is reduced or even absent.

[0007] The thickness of the elastomeric element will in general be at least 0.3 mm. The elastomeric element is for example made of EPDM rubber. It is for example a rubber band, which is preferably wider than the combined width of the circumferential edges of the flanges of the ferrules and the gasket. Thus, at least part of the rubber band will be in contact with a second surface of a flange of a ferrule.

[0008] An arm of a clamp used in the method according to the invention may be an articulated arm.

[0009] US3828403 discloses a clamp for sealing the circumference of a joint using an elastomeric material.

[0010] US3432189A discloses a method of joining plain-ended pipes by providing a sleeve over both pipe ends.

[0011] GB552080A discloses a clamp for providing a compression joint, said clamp comprising an elastic ring.

[0012] US5380052A discloses a clamp comprising two identical arms.

[0013] WO2009146764 discloses a clamp for joining two pipe ends comprising ferrules with a gasket in between.

[0014] US2011254268 discloses a clamp for connecting cooling hoses to an engine of an automotive vehicle.

[0015] None of these publications disclose or suggest that a problem caused by bulging of a gasket between the ferrules can be reduced with a clamp comprising a resilient element.

[0016] According to a favourable embodiment, the thickness of the elastomeric lining is at least 0.7 mm, preferably at least 1 mm.

[0017] This has been found to give both excellent performance with respect to reduction of the

problem, and provides good sealing against leakage of liquid at the connection for most usage conditions as seen in practice.

[0018] According to a favourable embodiment, the thickness of the elastomeric lining is less than 10 mm, preferably less than 6 mm.

[0019] This has been found to give both excellent performance with respect to reduction of the problem, and still provides good sealing against leakage of liquid at the connection for most usage conditions as seen in practice.

[0020] According to a favourable embodiment, the elastomer is silicone.

[0021] Silicone was found to have excellent suitability for preventing damage to gaskets.

[0022] According to a favourable embodiment, the clamp comprising two arms is a clamp comprising a first arm and a second arm, each of said arms comprising a first end section and a second end section and between said first end section and said second end section a third section, said third section comprising

- a first wall section extending between the first end section and the second end section,
- a second wall section extending between the first end section and the second end section, and
- a third connecting section connecting the first wall section and the second wall section; a first face of the first wall section, a first face of the third connecting section and a first face of the second wall section defining a groove, wherein the first face of the first wall section and the first face of the second wall section defining the groove as tapering towards the first face of the third connecting section, wherein
at least one of the first end sections is releasably connectable
 - to lock the clamp in a first closed state, and
 - to open the clamp defining a second state of the clamp; wherein of at least one arm at least one of i) the first face of the first wall section, and ii) the first face of the second wall section comprises the elastomeric lining.

[0023] Use of such a clamp for clamping an assembly comprising ferrules and a gasket has been found to result in less damage to the gasket when the assembly is subjected to frequent temporary elevated temperatures such as occurring during sterilisation.

[0024] Preferably both first faces of the wall sections are provided with the elastomeric lining.

[0025] Preferably both arms are provided with the elastomeric lining.

[0026] The elastomeric lining is preferably silicone.

[0027] An arm of a clamp according to the invention may be an articulated arm.

[0028] According to a favourable embodiment, the first end section and the second end section are connected using a hinge.

[0029] By being hingeably connected, the use of separate arms can be avoided, making the clamp easier to handle.

[0030] According to a favourable embodiment, the method further comprising the step of sterilising the equipment.

[0031] This is the ultimate purpose of the invention, and in particular allowing repeated sterilisation operations with a reduced risk of the gasket not returning properly when the temperature is reduced after sterilisation.

[0032] According to a favourable embodiment, the sterilisation is performed using steam.

[0033] The present invention will now be illustrated with reference to the drawing where

Fig. 1A to Fig. 1D show perspective views of a method of connecting two ferrules of two conduits; and

Fig. 2A and Fig. 2B show cross-sectional views through an assembly of two ferrules and a gasket, without a clamp and with a clamp respectively.

[0034] Fig. 1A to Fig. 1D show perspective views of a method of connecting two ferrules (ferrule 110a and ferrule 110b) of conduits (not shown for reasons of clarity) using a clamp 150 according to the invention.

[0035] The two ferrules 110a, 110b are separated by a gasket 120 having a central hole 121 having a diameter that is slightly larger than the inner diameter of the ferrules 110a, 110b. In addition, the gasket 120 comprises at both faces thereof an annular ridge (ridge 121a is visible in Fig. 1A) that is received in a corresponding annular recess (annular recess 111b is visible in Fig. 1A) of the ferrules. This helps to center the gasket 120 between the ferrules 110a, 110b and thus to center the hole 121 (Fig. 1B).

[0036] A clamp 150 is used to hold the assembly of the ferrules 110a, 110b and the gasket 120 together. In the embodiment shown, the clamp 150 comprises a first arm 151 and a second arm 152. The arms of a clamp may be separate pieces, but in the embodiment discussed here they are capable of hinging at first ends of said arms 151, 152 at hinge 153. The arms 151, 152 are typically made of metal. In the art such clamping arms are also referred to as shells or clamping members. The second end of the first arm 151 is forked comprising two prongs to

provide a first aperture 161 that is provided with a threaded rod 154 capable of hinging about pin 155 held by the prongs at a first end thereof. The threaded rod 154 is provided with a nut 156 for tightening the clamp 150.

[0037] The second arm 152 also has a forked second end comprising two prongs providing a second aperture 162 for receiving the threaded rod 154 and to provide a contact surface for the nut 156 when the clamp 150 is tightened.

[0038] The first arm 151 comprises a first groove 171 and the second arm 152 comprises a second groove 172 as recesses for receiving part of the circumference of the assembly of both ferrules 110a, 110b and the gasket 120 in a closed state of the clamp (the closed state is shown Fig 1D).

[0039] As described so far, this is a normal clamp.

[0040] The clamp 150 according to the present invention comprises an elastomeric lining 157, here of silicone having a thickness of 1.5 mm.

[0041] Fig. 1C shows that the assembly of both ferrules 110a, 110b and the gasket 120 is received in the first groove 171 of the first arm 151 over part of the circumference thereof, in contact with the elastomeric lining 157.

[0042] To clamp the assembly of both ferrules 110a, 110b and the gasket 120 together the second arm 152 is rotated using the hinge 153, the threaded rod 154 is pivoted so as to receive it in the second aperture 162 of the second arm 152 and the nut 156 is tightened (Fig. 1D).

[0043] Fig. 2A and Fig. 2B show a cross-sectional view through an assembly of two ferrules 110a, 110b and a gasket 120 without a clamp 150 and with a clamp 150 respectively.

[0044] It can be seen that in Fig. 2A before the clamp 150 is applied the diameter of the hole 121 of gasket 120 is somewhat larger than the inner diameter of the ferrules 110a, 110b. By tightening the clamp (Fig. 2B), the gasket 120 which is made of an elastomeric material such as EPDM is compressed and the diameter of the hole 121 is reduced accordingly such that it is flush with the inner walls of the ferrules 110a, 110b.

[0045] Fig. 2A and Fig. 2B show that a ferrule 110 comprises a flange 212 that tapers to a reduced thickness towards the circumference of the flange 212. Similarly, the grooves provided with lining 157 of the arms are also tapered towards the circumference of the closed clamp 150. It has been found that when the clamped assembly as shown in Fig. 2B is subjected to elevated temperature and pressure repeatedly (e.g. as is necessary during sterilisation with steam), the gasket 120 that is compressed even further during such an operation causing the diameter of the hole 121 to be reduced even further (effectively bulging into the passage provided by the assembly) will return to the original (flush) state reliably and repeatedly. Thus,

equipment can be operated for a longer period of time with reduced maintenance. The risk of debris piling up at the joint is reduced. Also, the risk of gasket material ending up downstream and possibly in the product is reduced.

REFERENCES CITED IN THE DESCRIPTION

This list of references cited by the applicant is for the reader's convenience only. It does not form part of the European patent document. Even though great care has been taken in compiling the references, errors or omissions cannot be excluded and the EPO disclaims all liability in this regard.

Patent documents cited in the description

- US3828403A [0009]
- US3432189A [0010]
- GB552080A [0011]
- US5380052A [0012]
- WO2009146764A [0013]
- US2011254268A [0014]

Patentkrav

1. Fremgangsmåde til forbindelse af to ledninger fra udstyr, der skal steriliseres, hver ledning omfatter i en fri ende deraf en ferul, hvori en pakning (120), der
5 omfatter et gennemgående hul, er tilvejebragt mellem ferulerne (110a, 110b) på ledningerne, og en klemme (150) anvendes til at klemme (150) ferulerne (110a, 110b) sammen, nævnte klemme (150) omfatter to arme (151, 152), hver arm omfatter en indfældning (171, 172) til modtagelse af en tværsnitsdel af ferulerne (110a, 110b);
10 hvori i en tilstand, hvor ferulerne (110a, 110b) er klemt sammen med en klemme (150), ferulerne (110a, 110b) tilvejebringer en passage, og den indvendige overflade af det gennemgående hul i pakningen (120) efter sammenklemning flugter med den indvendige væg af passagen, der er tilvejebragt af ferulerne (110a, 110b), og pakningen (120) er i stand til at bule ud ind i nævnte passage
15 ved en midlertidig forøgelse af temperaturen;
kendetegnet ved, at et resistent element (157) er tilvejebragt i indfældningen (171, 172) på mindst én arm af klemmen (150) mellem nævnte mindst én arm og ferulerne (110a, 110b), hvor det resistente element (157) er en elastomertætning (157), hvor indfældningen (171, 172) på mindst én arm af klemmen (150)
20 omfatter nævnte elastomertætning.
2. Fremgangsmåden ifølge krav 1, hvor tykkelsen af elastomertætningen er mindst 0,7 mm, fortrinsvis mindst 1 mm.
- 25 3. Fremgangsmåden ifølge krav 1 eller 2, hvor tykkelsen af elastomertætningen er mindre end 10 mm, fortrinsvis mindre end 6 mm.
4. Fremgangsmåden ifølge ethvert af de foregående krav, hvor elastomeren er silikone.
- 30 5. Fremgangsmåden ifølge ethvert af de foregående krav, hvor klemmen (150), der omfatter to arme (151, 152), er en klemme (150), der omfatter en første arm

(151) og en anden arm (152), hver af nævnte arme (151, 152) omfatter en første endesektion og en anden endesektion, og mellem nævnte første endesektion og nævnte anden endesektion en tredje endesektion, nævnte tredje sektion omfatter

- 5 – en første vægsektion, der strækker sig mellem den første endesektion og den anden endesektion,
 – en anden vægsektion, der strækker sig mellem den første endesektion og den anden endesektion, og
 – en tredje forbindelsessektion, der forbinder den første vægsektion og den
10 anden vægsektion; en første flade på den første vægsektion, en første flade på den tredje forbindelsessektion og en første flade på den anden vægsektion, som definerer en rille,

15 hvor den første flade på den første vægsektion og den første flade på den anden vægsektion definerer rillen som tilspidsende mod den første flade på den tredje forbindelsessektion,

hvor

mindst én af de første endesektioner kan forbindes genudløseligt

- 20 – til låsning af klemmen (150) i en første lukket tilstand,
 og
 – til åbningen af klemmen (150), der definerer en anden tilstand af klemmen (150);

25 hvor af mindst én arm (151, 152) mindst én af i) den første flade på den første vægsektion, og ii) den første flade på den anden vægsektion omfatter elastomertætningen (157).

- 30 6. Fremgangsmåden ifølge krav 5, hvor den første endesektion og den anden endesektion er forbundet med et hængsel (153).

7. Fremgangsmåden ifølge ethvert af de foregående kravene, hvor fremgangsmåden desuden omfatter trinnet til sterilisering af udstyret.
8. Fremgangsmåden ifølge krav 7, hvor steriliseringen udføres ved hjælp af damp.

DRAWINGS

Fig. 1A

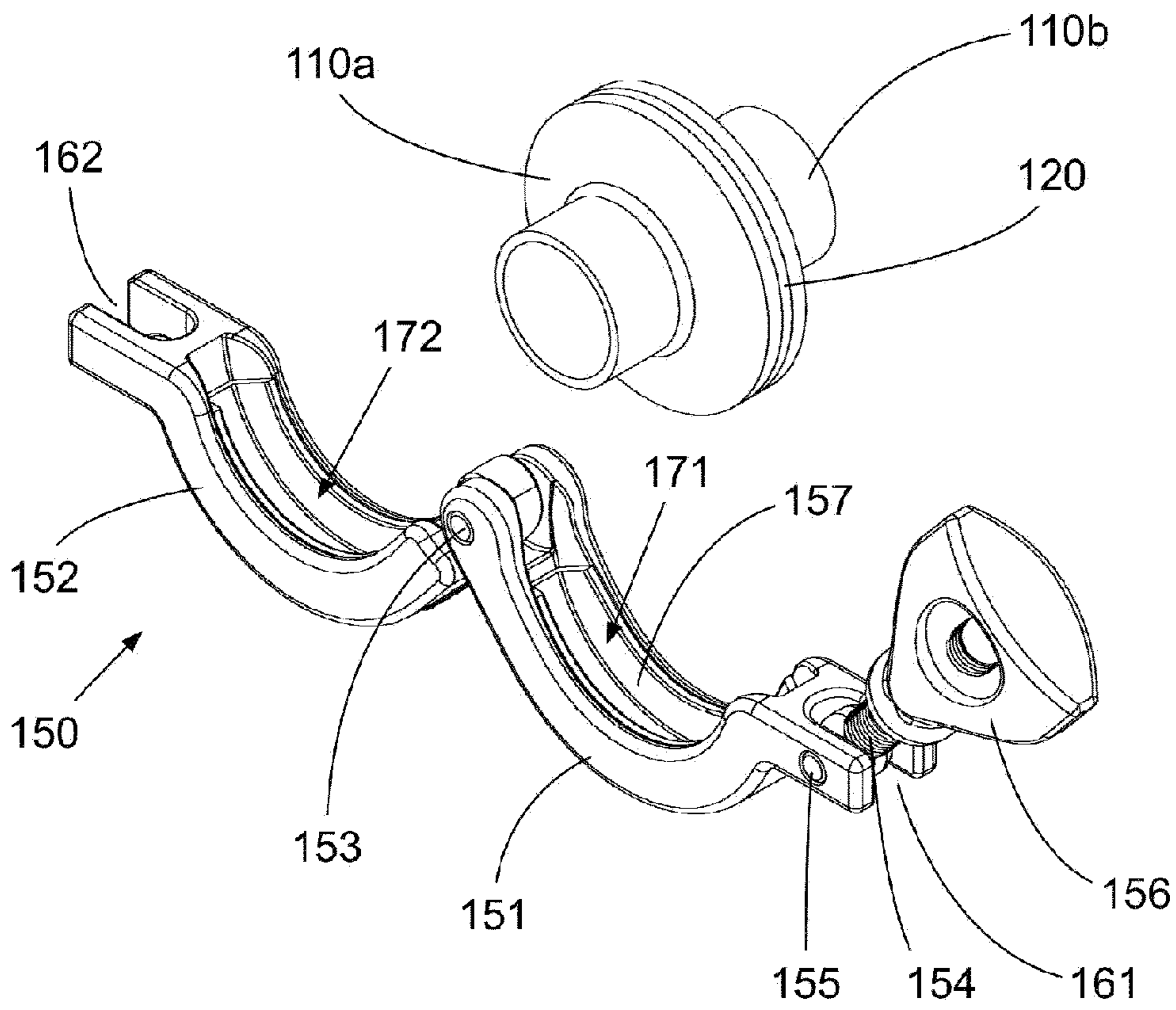
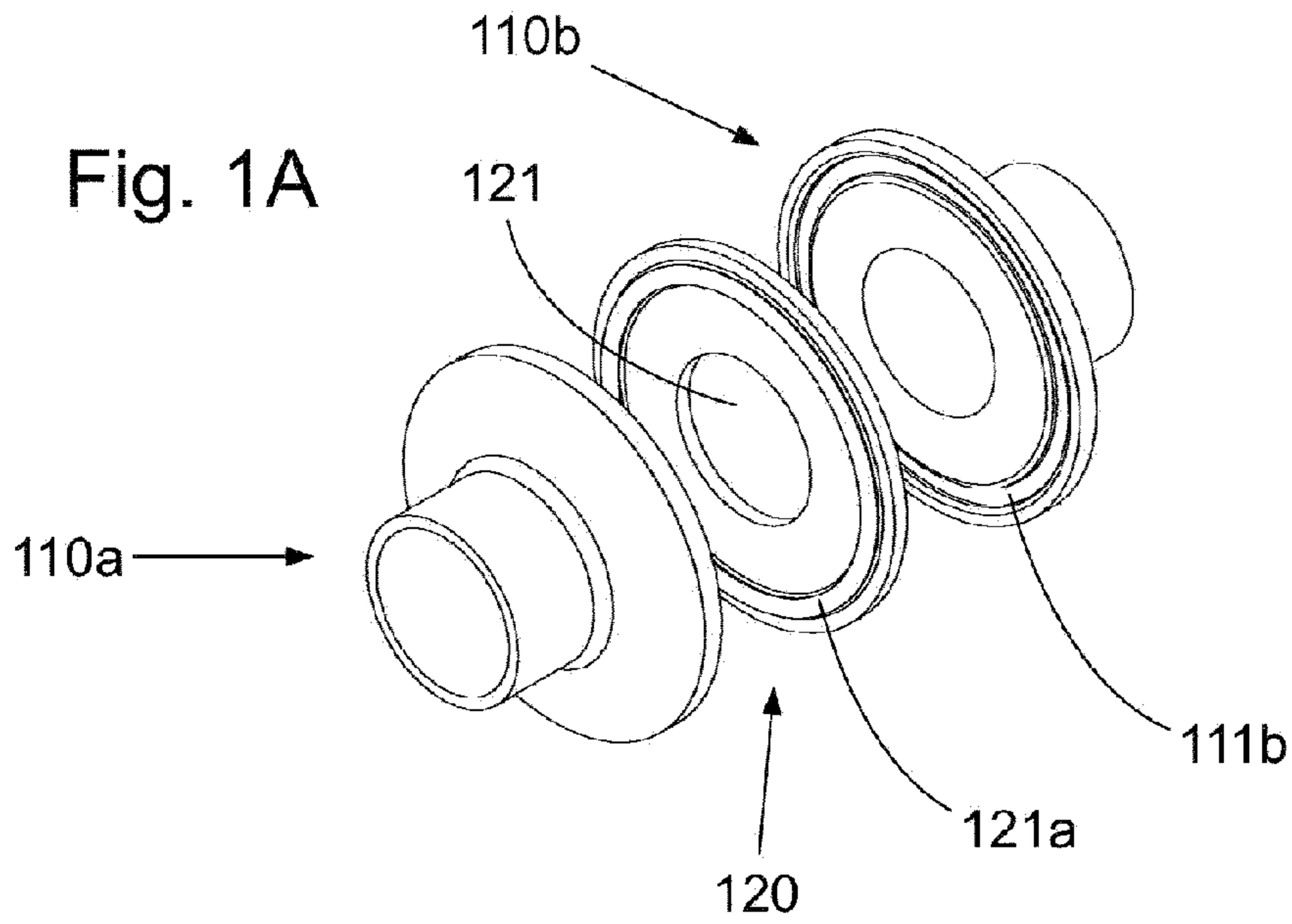

Fig. 1B

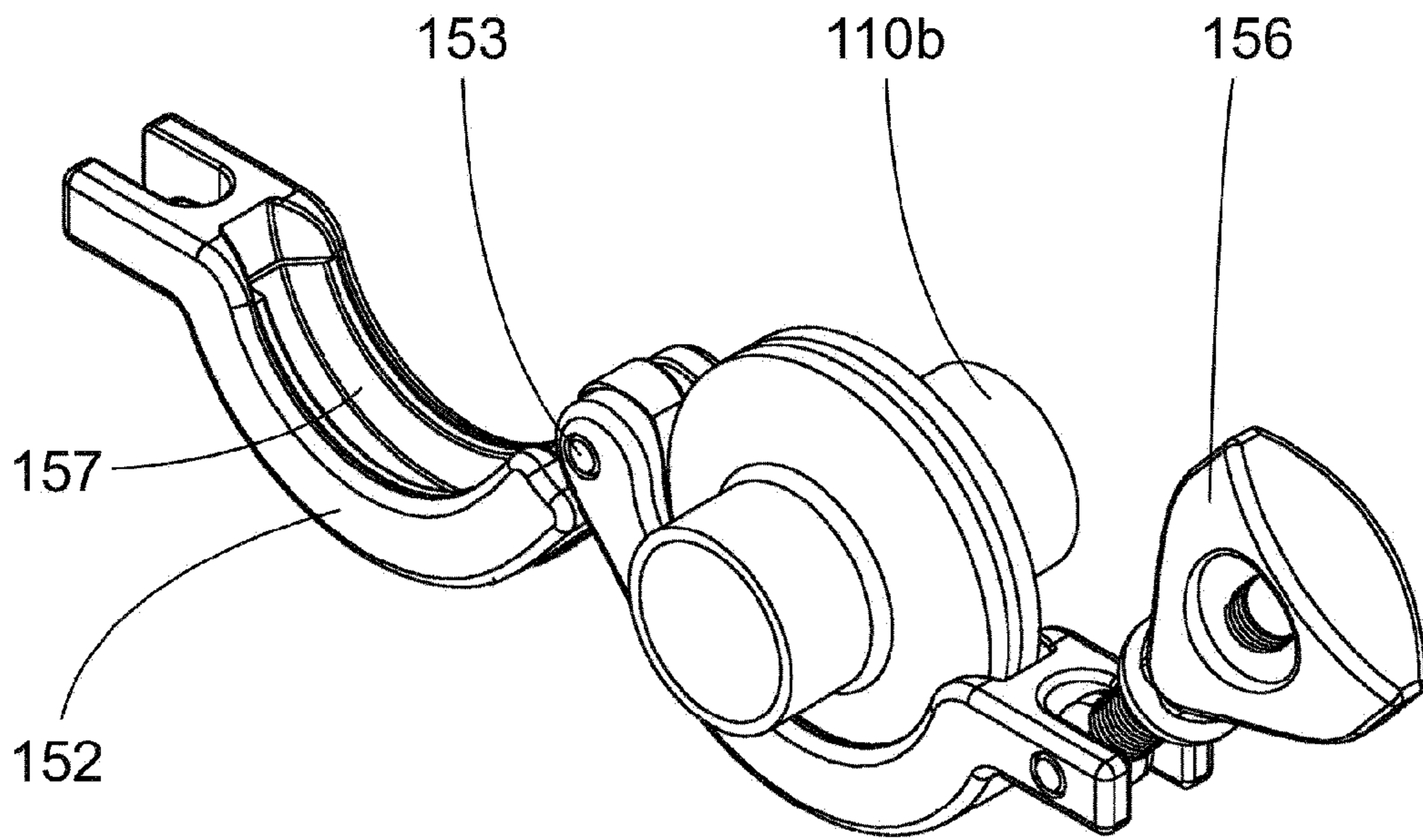

Fig. 1C

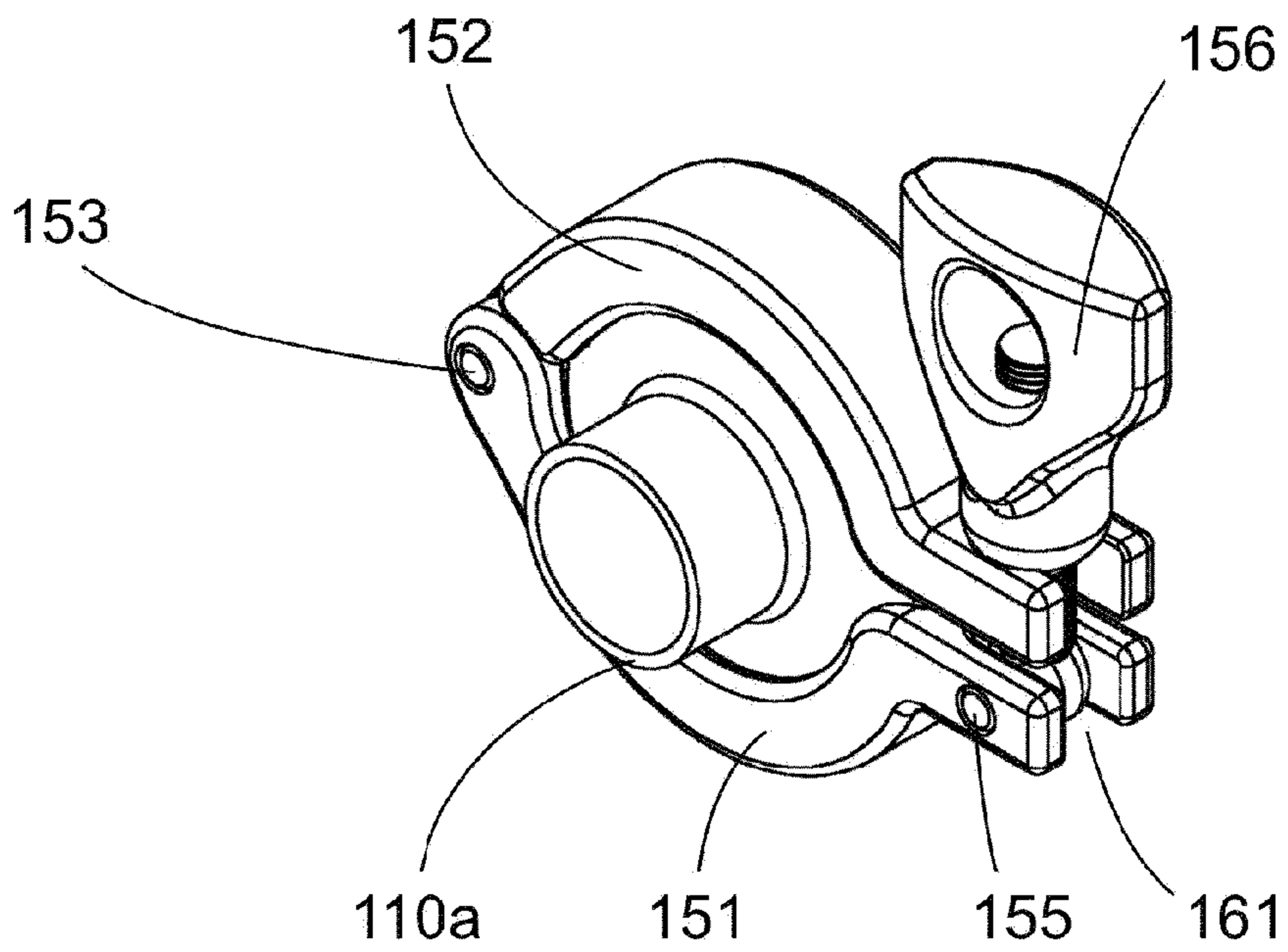

Fig. 1D

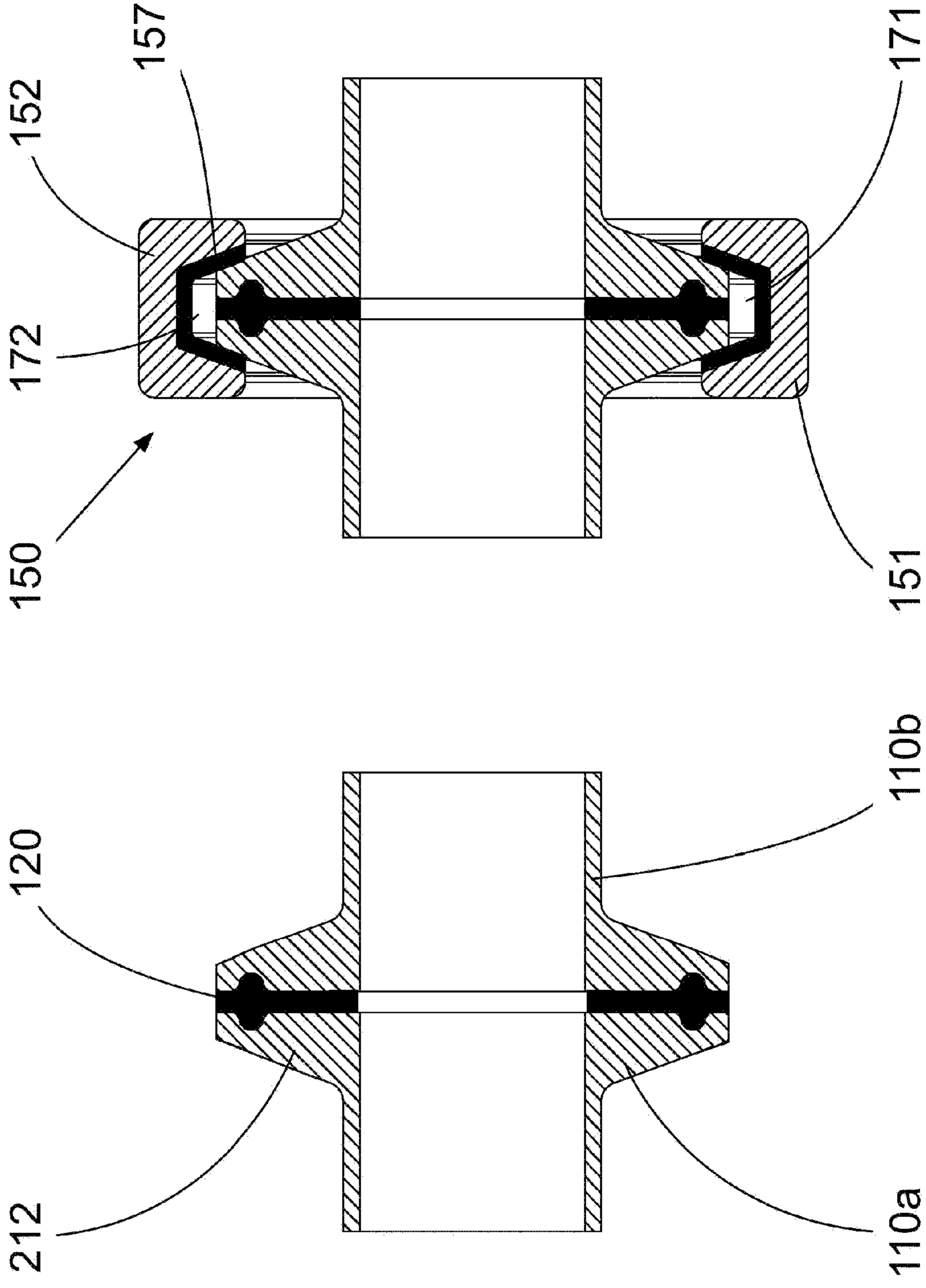

Fig. 2B

Fig. 2A