

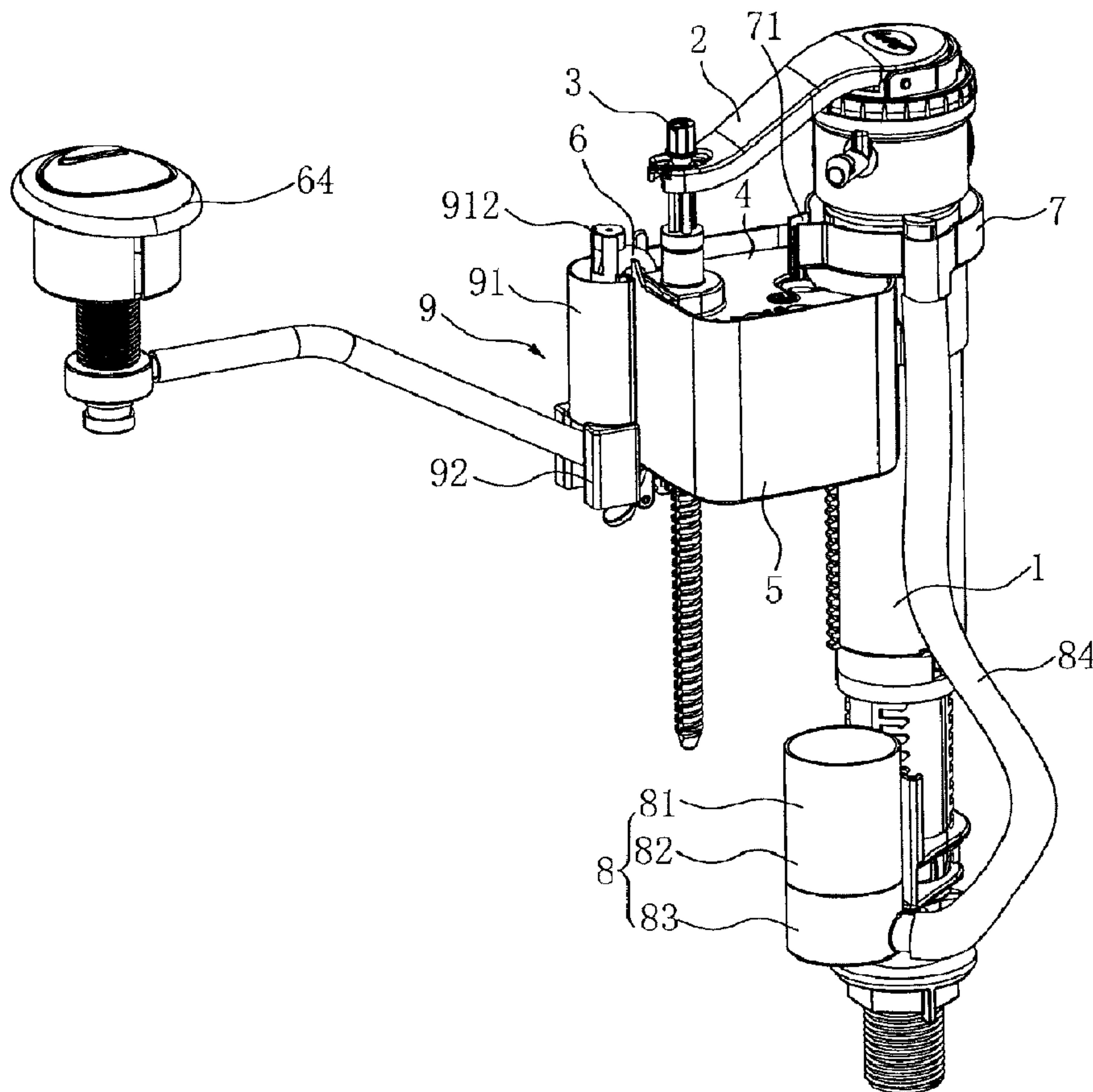

(86) **Date de dépôt PCT/PCT Filing Date:** 2014/06/06
 (87) **Date publication PCT/PCT Publication Date:** 2015/12/10
 (45) **Date de délivrance/Issue Date:** 2019/02/19
 (85) **Entrée phase nationale/National Entry:** 2016/06/13
 (86) **N° demande PCT/PCT Application No.:** CN 2014/079364
 (87) **N° publication PCT/PCT Publication No.:** 2015/184640

(51) **Cl.Int./Int.Cl. F16K 31/18** (2006.01),
E03D 1/32 (2006.01), **F16K 27/00** (2006.01)
 (72) **Inventeurs/Inventors:**
LIU, YONGMAO, CN;
ZHANG, ZIPENG, CN
 (73) **Propriétaire/Owner:**
LAB (XIAMEN) SANITARY FITTINGS INC, CN
 (74) **Agent:** MACRAE & CO.

(54) **Titre : APPAREIL DE PROTECTION CONTRE LES FUITES D'EAU IMPORTANTES POUR ROBINET D'ARRIVEE D'EAU**
 (54) **Title: MAJOR WATER LEAK PREVENTION APPARATUS FOR WATER INLET VALVE**



(57) **Abrégé/Abstract:**

A major water leak prevention apparatus for a water inlet valve, wherein: a float (4) is disposed on an adjusting rod (3) and within a small water tank (5), the small water tank (5) is disposed on a water inlet valve body (1), and the small water tank (5) is provided

(57) Abrégé(suite)/Abstract(continued):

with a siphon tube (6); a water tray (7) is disposed on the water inlet valve body (1) and is positioned above the small water tank (5), said tray (7) is provided with a water overflow opening (71) and is aligned with the small water tank (5), and the bottom of the tray (7) is provided with an opening (72); a counterweight float (8) is disposed at the bottom end of the water inlet valve body (1), the counterweight float (8) comprises a water cavity (81) and a buoyancy cavity (82), each being independent of the other and integrally formed; the water cavity (81) and the buoyancy cavity (82) are disposed at the bottom end of the water inlet valve body (1), and, the opening (72) at the bottom of the water tray (7) is connected to the counterweight float (8) by means of a conduit (84); when the gravitational force on the water cavity (81) is greater than the buoyancy of same, the water cavity (81) plugs an outlet at the bottom end of the conduit (84); and, when the gravitational force on the water cavity (81) is less than the buoyancy of same, the water cavity (81) opens the outlet at the bottom end of the conduit (84). The major water leak prevention apparatus causes the water inlet valve immediately to stop letting water in when a major water leak occurs in the water tank, thus saving water resources.

(12) 按照专利合作条约所公布的国际申请

(19) 世界知识产权组织
国际局(43) 国际公布日
2015年12月10日 (10.12.2015)(10) 国际公布号
WO 2015/184640 A1

- (51) 国际专利分类号:
F16K 31/18 (2006.01) *E03D 1/32* (2006.01)
F16K 27/00 (2006.01)
- (21) 国际申请号: PCT/CN2014/079364
- (22) 国际申请日: 2014年6月6日 (06.06.2014)
- (25) 申请语言: 中文
- (26) 公布语言: 中文
- (71) 申请人: 厦门立业卫浴工业有限公司 (LAB (XIAMEN) SANITARY FITTING INC) [CN/CN]; 中国福建省厦门市同安工业集中区思明园41号, Fujian 361100 (CN)。
- (72) 发明人: 刘永茂 (LIU, Yongmao); 中国福建省厦门市湖里区长岸路414号703室, Fujian 361000 (CN)。
张子鹏 (ZHANG, Zipeng); 中国福建省厦门市同安工业集中区思明园41号, Fujian 361100 (CN)。
- (74) 代理人: 厦门市新华专利商标代理有限公司 (XIAMEN SHINHWA PATENT & TRADEMARK AGENCY CO., LTD.); 中国福建省厦门市思明区软件园二期望海路15号201, Fujian 361008 (CN)。

- (81) 指定国 (除另有指明, 要求每一种可提供的国家保护): AE, AG, AL, AM, AO, AT, AU, AZ, BA, BB, BG, BH, BN, BR, BW, BY, BZ, CA, CH, CL, CN, CO, CR, CU, CZ, DE, DK, DM, DO, DZ, EC, EE, EG, ES, FI, GB, GD, GE, GH, GM, GT, HN, HR, HU, ID, IL, IN, IR, IS, JP, KE, KG, KN, KP, KR, KZ, LA, LC, LK, LR, LS, LT, LU, LY, MA, MD, ME, MG, MK, MN, MW, MX, MY, MZ, NA, NG, NI, NO, NZ, OM, PA, PE, PG, PH, PL, PT, QA, RO, RS, RU, RW, SA, SC, SD, SE, SG, SK, SL, SM, ST, SV, SY, TH, TJ, TM, TN, TR, TT, TZ, UA, UG, US, UZ, VC, VN, ZA, ZM, ZW。
- (84) 指定国 (除另有指明, 要求每一种可提供的地区保护): ARIPO (BW, GH, GM, KE, LR, LS, MW, MZ, NA, RW, SD, SL, SZ, TZ, UG, ZM, ZW), 欧亚 (AM, AZ, BY, KG, KZ, RU, TJ, TM), 欧洲 (AL, AT, BE, BG, CH, CY, CZ, DE, DK, EE, ES, FI, FR, GB, GR, HR, HU, IE, IS, IT, LT, LU, LV, MC, MK, MT, NL, NO, PL, PT, RO, RS, SE, SI, SK, SM, TR), OAPI (BF, BJ, CF, CG, CI, CM, GA, GN, GQ, GW, KM, ML, MR, NE, SN, TD, TG)。

本国际公布:

- 包括国际检索报告(条约第21条(3))。

(54) Title: MAJOR WATER LEAK PREVENTION APPARATUS FOR WATER INLET VALVE

(54) 发明名称: 一种进水阀的防止大漏水装置



图1 / FIG. 1

(57) Abstract: A major water leak prevention apparatus for a water inlet valve, wherein: a float (4) is disposed on an adjusting rod (3) and within a small water tank (5), the small water tank (5) is disposed on a water inlet valve body (1), and the small water tank (5) is provided with a siphon tube (6); a water tray (7) is disposed on the water inlet valve body (1) and is positioned above the small water tank (5), said tray (7) is provided with a water overflow opening (71) and is aligned with the small water tank (5), and the bottom of the tray (7) is provided with an opening (72); a counterweight float (8) is disposed at the bottom end of the water inlet valve body (1), the counterweight float (8) comprises a water cavity (81) and a buoyancy cavity (82), each being independent of the other and integrally formed; the water cavity (81) and the buoyancy cavity (82) are disposed at the bottom end of the water inlet valve body (1), and, the opening (72) at the bottom of the water tray (7) is connected to the counterweight float (8) by means of a conduit (84); when the gravitational force on the water cavity (81) is greater than the buoyancy of same, the water cavity (81) plugs an outlet at the bottom end of the conduit (84); and, when the gravitational force on the water cavity (81) is less than the buoyancy of same, the water cavity (81) opens the outlet at the bottom end of the conduit (84). The major water leak prevention apparatus causes the water inlet valve immediately to stop letting water in when a major water leak

occurs in the water tank, thus saving water resources.

(57) 摘要:

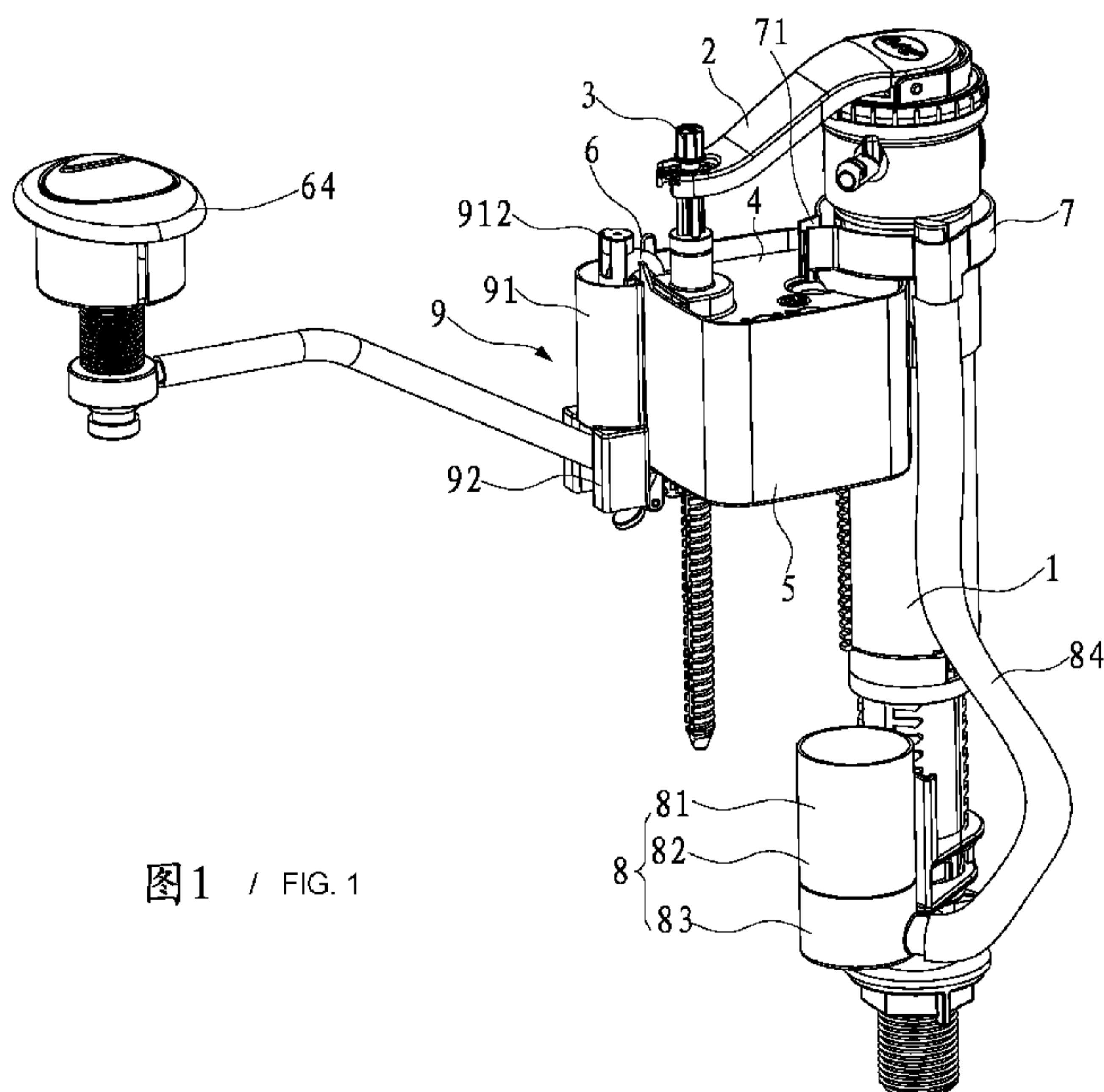
[见续页]



一种进水阀的防止大漏水装置，其中浮筒（4）安装在调节杆（3）上置于小水箱（5）中，小水箱（5）安装在进水阀本体（1）上，在小水箱（5）上安装虹吸管（6）；接水盘（7）安装在进水阀本体（1）上，位于小水箱（5）上方，接水盘（7）上设置溢水口（71），溢水口（71）与小水箱（5）相对，接水盘（7）底部设置开口（72）；配重浮筒（8）安装在进水阀本体（1）下端，配重浮筒（8）包括水腔（81）及浮力腔（82），水腔（81）及浮力腔（82）相互独立一体成型，水腔（81）及浮力腔（82）安装在进水阀本体（1）下端，接水盘（7）底部开口（74）通过管道（84）与配重浮筒（8）连接，水腔（81）重力大于浮力状态下，水腔（81）堵住管道（84）下端出口，水腔（81）重力小于浮力状态下，水腔（81）开启管道（84）下端出口。所述防止大漏水装置可以使水箱出现大漏水时，及时停止进水阀进水，节约水资源。

MAJOR WATER LEAK PREVENTION APPARATUS FOR WATER INLET VALVE

(a) Technical Field of the Invention

The present invention relates generally to the technical field of water inlet valves, and
5 more particularly to a major water leak prevention apparatus for water inlet valves.

(b) Description of the Prior Art

Heretofore, a water inlet valve generally comprises a water inlet tube, a top cover, a back
pressure pad, a swing arm, a float, and a water container. A lower end of the water inlet tube is
10 mounted to a water supply tube of a water tank. The top cover is set on an upper end on the
water inlet tube. The cover is formed with a back pressure hole. The swing arm has a middle
section that is pivotally mounted on the top cover. An end of the swing arm corresponds to the
back pressure hole and is provided with the back pressure pad. An opposite end of the swing
arm is connected to a regulation bar of the float. The float is arranged in the water container and
15 the water container is mounted on the water inlet tube. Sealing members are provided among
these components to secure water tightness.

In use, when water level of the water container drops, the float is driven by gravity to
descend, causing the swing arm to rotate so that the back pressure pad opens the back pressure
hole to allow water that flows through the water supply tube moves through the water inlet tube,
20 the top cover, and the back pressure hole to enter the water tank, achieving water ingress. After
the water levels of the water container rises, the float is brought upward by buoyance so as to
cause the swing arm to rotate, making the back pressure pad re-close the back pressure hole,
whereby a water stop pad generates back pressure expansion to block the water ingress opening,
and thus shutting down water ingress.

25 Such as water inlet valve comprises a water drain hole formed in the bottom of the water
container. When the water level of the water tank drops down, water contained in the water
container flows through the water drain hole into the water tank to cause the float to lose
buoyance and driven by gravity to descend for causing the swing arm to rotate and open the back
pressure hole for water ingress. However, after a long period of service, the water tank may get
30 malfunctioning and cannot be shut down properly, such as major water leakage may occur in the

water discharge valve. Under such a condition, water is maintained supplied through the water inlet valve and water continuously leaks from the water tank thereby leading to a waster of water resources.

Thus, the present invention aims to improve the structure of the water inlet valve in order to shut down water ingress through the water inlet valve in case of any event of the above-discussed situation.

SUMMARY OF THE INVENTION

An object of the present invention is to provide a major water leak prevention apparatus for a water inlet valve, which stops water ingress through the water inlet valve when major water leakage occurs in a water tank so as to help save water resources.

To achieve the above object, the present invention adopts a solution as follows:

A major water leak prevention apparatus for a water inlet valve is provided, which is mounted to a water inlet valve body and comprises a swing arm, a regulation bar, a float, a water container, a siphon tube, a water receptacle tray, and a counterweight float; the swing arm is rotatably mounted to the water inlet valve body, the swing arm having an end to which a back pressure pad is mounted to correspond to a back pressure hole of the water inlet valve body, the swing arm having an opposite end connected to the regulation bar, the float being mounted on the regulation bar and received in the water container, the water container being mounted on the water inlet valve body, the siphon tube being mounted on the water container; the water receptacle tray is mounted on the water inlet valve body and is located above the water container, the water receptacle tray comprising an overflow port formed thereon, the overflow port being opposite to the water container, the water receptacle tray having a bottom in which an opening is formed; and the counterweight float is mounted on a lower end of the water inlet valve body, the counterweight float comprising a water compartment and a buoyance compartment, the water compartment and the buoyance compartment being independent of each other but integrated together, the water compartment and the buoyance compartment being arranged at the lower end of the water inlet valve body, the bottom opening of the water receptacle tray being connected, via a passageway pipe, to the counterweight float, wherein in a condition where the gravity of the water compartment is greater than buoyance, the water compartment blocks a lower end opening

of the passageway pipe; and in a condition where the gravity of the water compartment is smaller than the buoyance, the water compartment opens the lower end opening of the passageway pipe.

The counterweight float further comprises a fixation seat, the fixation seat being mounted to the lower end of the water inlet valve body, the fixation seat comprising a water discharge opening in communication with the lower end opening of the passageway pipe, the water compartment and the buoyance compartment being mounted, movably, to the fixation seat in an up-and-down slidable manner, wherein the up-and-down slidable manner is such that the buoyance compartment is provided with a support frame mounted thereto and the support frame is fit in the water discharge opening of the fixation seat, wherein an engagement block is mounted to a lower end of the support frame and an engagement strip is mounted in the fixation seat and wherein in the condition that the water compartment blocks the water discharge opening of the fixation seat, a lower end of the engagement strip is spaced from the engagement block; and in the condition that the water compartment opens the water discharge opening of the fixation seat, the engagement block is in contact engagement with the lower end of the engagement strip so as to stop or restrict upward movement of the water compartment and the buoyance compartment.

The counterweight float further comprises a closure seat, the closure seat being arranged at one side of the water compartment and the buoyance compartment, the counterweight float being rotatably mounted to the lower end of the passageway pipe, wherein in a condition where the gravity of the water compartment is greater than buoyance, the water compartment and the buoyance compartment swing downward and sink down so that the closure seat blocks the lower end opening of the passageway pipe; and in a condition where the gravity of the water compartment is smaller than buoyance, the water compartment and the buoyance compartment swing upward and float up so that the water compartment opens the lower end opening of the passageway pipe.

A counterweight buoyance switch is further included, the counterweight buoyance switch being mounted on the water container, the counterweight buoyance switch comprising a counterweight water compartment and a buoyance water compartment that are independent of each other, the counterweight water compartment having a lower end in which a water drain hole is formed, an upper end of the siphon tube being provided with an air aperture, the counterweight

water compartment having an upper end to which a closure pressing plate is provided, the closure pressing plate corresponding to the air aperture, the counterweight buoyance switch controlling opening/closing of the air aperture.

Further, the counterweight buoyance switch is mounted on the siphon tube in an up and down slidable manner, wherein in a condition where buoyance of the counterweight buoyance switch is greater than the gravity thereof, the counterweight buoyance switch slides upward and thus float up thereby opening the air aperture of the siphon tube; and in a condition where the buoyance of the counterweight buoyance switch is smaller than the gravity thereof, the counterweight buoyance switch slides downward and sinks down thereby making the closure pressing plate block the air aperture and thus closing the air aperture of the siphon tube.

Further, the counterweight buoyance switch is rotatably mounted, through a pivot pin, to the water container wherein in a condition where the buoyance of the counterweight buoyance switch is greater than the gravity thereof, the counterweight buoyance switch swings upwards and floats up thereby opening the air aperture of the siphon tube and in a condition where the buoyance of the counterweight buoyance switch is smaller than the gravity thereof, the counterweight buoyance switch swings downward and sinks down, making the closure pressing plate block the air aperture thereby closing the air aperture of the siphon tube.

Further, an air evacuation hole is formed in a lower end portion of the siphon tube, the air evacuation hole being connected, via the passageway pipe, with an air pump, whereby actuating the air pump to evacuate air from the siphon tube releases pressure from the siphon tube so that water of the water container is drained through the siphon tube.

Further, a leverage bar is pivotally connected to the water container, the leverage bar having an end to which a counterweight is mounted and an opposite end that is provided with a closure pad corresponding to and mateable with the water egress opening of the siphon tube, the closure pad being opposite to the water egress opening such that in a condition where the air pump evacuate away air from the siphon tube, the closure pad closes the water egress opening.

Further, a link bar is pivotally connected to the water container, the link bar having an end corresponding to the float received in the water container and an opposite end connected to a pull wire, the pull wire being connected to an actuation button, whereby actuating the actuation

button pulls the pull wire to make the link bar swing and one end of the link bar depresses the float down to have water contained in the water container drained through the siphon tube.

A major water leak prevention apparatus for a water inlet valve is provided, which is mounted on a water inlet valve body and comprises a swing arm, a regulation bar, a float, a water container, and a link bar; the swing arm is rotatably mounted to the water inlet valve body, the swing arm having an end to which a back pressure pad is mounted to correspond to a back pressure hole of the water inlet valve body, the swing arm having an opposite end connected to the regulation bar; the float is mounted to the regulation bar and is received in the water container, the water container being mounted on the water inlet valve body; and the link bar is rotatably mounted to the water container, the link bar having an end corresponding to the float received in the water container and an opposite end to which a pull wire is connected, the pull wire being connected to an actuation button so that actuating the actuation button pulls the pull wire to make the link bar swing, whereby an end of the link bar presses down the float to make water drained from the water container.

And, further included are a water receptacle tray and a counterweight float. The water receptacle tray is mounted on the water inlet valve body and is located above the water container, the water receptacle tray comprising an overflow port formed thereon, the overflow port being opposite to the water container, the water receptacle tray having a bottom in which an opening is formed; and the counterweight float is mounted on a lower end of the water inlet valve body, the counterweight float comprising a water compartment and a buoyance compartment, the water compartment and the buoyance compartment being independent of each other but integrated together, the water compartment and the buoyance compartment being arranged at the lower end of the water inlet valve body, the bottom opening of the water receptacle tray being connected, via a passageway pipe, to the counterweight float, wherein in a condition where the gravity of the water compartment is greater than buoyance, the water compartment blocks a lower end opening of the passageway pipe; and in a condition where the gravity of the water compartment is smaller than the buoyance, the water compartment opens the lower end opening of the passageway pipe.

With the above solution, the water container of the present invention is not provided with an opening in a bottom thereof. When a water tank suffers continuous major water leakage, the water level of the water tank would drop down quickly such that a siphon effect is induced in the

siphon tube that is mounted to the water container to drain, substantially completely, water out of the water container. The back pressure pad of the swing arm opens the back pressure hole of the water inlet valve body and water flows through the water inlet valve body into the water tank so that the water inlet valve enables water ingress.

5 The water receptacle tray is mounted on the water inlet valve body and water enters the water receptacle tray and flows via the opening in the bottom of the water receptacle tray into the passageway pipe. Under this condition, since the water tank is suffering major water leakage, the water compartment would lose buoyance and the water compartment is filled with water and the water compartment blocks the lower end opening of the passageway pipe so that water that
10 flows into the passageway pipe flows backward to pass through the overflow port of the water receptacle tray and enter the water container. Since the bottom of the water container does not have an opening, the water level in the water container raises, making the float received in the water container to ascend and driving the swing arm to rotate thereby allowing the back pressure pad to close the back pressure hole, whereby water cannot flow through the water inlet valve
15 body into the water tank. As such, ingress of water is stopped and water resources can be save.

 When it is necessary to have the water inlet valve to enable water ingress again, the float is pressed down to make water contained in the water container to drain through the siphon tube so that the water level inside the water container drops down and the float descends to drive the swing arm to rotate such that the back pressure pad opens the back pressure hole, and the water
20 inlet valve may enable water ingress.

 The foregoing objectives and summary provide only a brief introduction to the present invention. To fully appreciate these and other objects of the present invention as well as the invention itself, all of which will become apparent to those skilled in the art, the following detailed description of the invention and the claims should be read in conjunction with the
25 accompanying drawings. Throughout the specification and drawings identical reference numerals refer to identical or similar parts.

 Many other advantages and features of the present invention will become manifest to those versed in the art upon making reference to the detailed description and the accompanying sheets of drawings in which a preferred structural embodiment incorporating the principles of the
30 present invention is shown by way of illustrative example.

BRIEF DESCRIPTION OF THE DRAWINGS

FIG. 1 is a perspective view of the present invention.

FIG. 2 is a perspective view of the present invention, partly sectioned to illustrate a
5 counterweight float and a water receptacle tray.

FIG. 3 is a cross-sectional view of the present invention.

FIG. 4 is a cross-sectional view of the present invention taken from a different angle.

FIG. 5 is a schematic view illustrating another structure of press releasing and unlocking
mechanism of the present invention.

10 FIG. 6 is a schematic view illustrating an operation of a counterweight float during a
normal water ingress condition.

FIG. 7 is a schematic view illustrating an operation of a counterweight float during a
major water leakage.

FIG. 8 is a partly exploded view of the present invention.

15 FIG. 9 is a schematic view showing another mounting structure of a counterweight
buoyance switch of the present invention.

FIG. 10 is a perspective view showing another embodiment of the counterweight
buoyance switch of the present invention.

20 FIG. 11 is a perspective view showing another embodiment of the counterweight
buoyance switch of the present invention at a different angle.

FIG. 12 is a partly exploded view of another embodiment of the present invention.

DETAILED DESCRIPTION OF THE PREFERRED EMBODIMENTS

25 The following descriptions are exemplary embodiments only, and are not intended to
limit the scope, applicability or configuration of the invention in any way. Rather, the following
description provides a convenient illustration for implementing exemplary embodiments of the
invention. Various changes to the described embodiments may be made in the function and
arrangement of the elements described without departing from the scope of the invention as set
forth in the appended claims.

Referring to FIGS. 1-9, the present invention discloses a major water leak prevention apparatus for a water inlet valve, which is installed on a water inlet valve body 1 and comprises a swing arm 2, a regulation bar 3, a float 4, a water container 5, a siphon tube 6, a water receptacle tray 7, and a counterweight float 8.

5 As shown in FIG. 6, the swing arm 2 is rotatably mounted to the water inlet valve body 1. The swing arm 2 has an end to which a back pressure pad 21 is mounted to exactly correspond to a back pressure hole 11 of the water inlet valve body 1. The swing arm 2 has an opposite end connected to the regulation bar 3. The float 4 is mounted on the regulation bar 3 and is received in the water container 5. The water container 5 is mounted on the water inlet valve body 1. The
10 structure so described is a known structure.

As shown in FIG. 3, the siphon tube 6 is mounted on the water container 5. The siphon tube 6 has a water ingress opening 61 that is located on a bottom of the water container 5. The siphon tube 6 has a water egress opening 62 that is located outside the water container 5. The water ingress opening 61 is at a height that is greater than a height of the water egress opening 62
15 such that the water ingress opening 61 is located higher than the water egress opening 62; and the height of the water egress opening 62 is lower than the bottom of the water container 5. The description is the common principle of the siphon tube 6.

As shown in FIGS. 1 and 2, the water receptacle tray 7 is mounted on the water inlet valve body 1 and is located above the water container 5. The water receptacle tray 7 comprises
20 an overflow port 71 formed thereon. The overflow port 71 is opposite to the water container 5. The water receptacle tray 7 has a bottom in which an opening 72 is formed.

The counterweight float 8 is mounted on a lower end of the water inlet valve body 1. The counterweight float 8 comprises a water compartment 81 and a buoyance compartment 82. The water compartment 81 and the buoyance compartment 82 are independent of each other but are
25 integrated together. The water compartment 81 and the buoyance compartment 82 are arranged at the lower end of the water inlet valve body 1. The bottom opening 72 of the water receptacle tray 7 is connected, via a passageway pipe 84, to the counterweight float 8. In a condition where the gravity of the water compartment 81 is greater than buoyance, the water compartment 81 blocks a lower end opening of the passageway pipe 84; and in a condition where the gravity of

the water compartment 81 is smaller than the buoyance, the water compartment 81 opens the lower end opening of the passageway pipe 84.

As shown in FIG. 7, the counterweight float 8 further comprises a fixation seat 83. The fixation seat 83 is mounted to the lower end of the water inlet valve body 1. The fixation seat 83 comprises a water discharge opening 831 in communication with the lower end opening of the passageway pipe 84. The water compartment 81 and the buoyance compartment 82 are mounted, movably, to the fixation seat 83 in an up-and-down slidable manner. The up-and-down slidable manner is such that the buoyance compartment 82 is provided with a support frame 821 mounted thereto and the support frame 821 is fit in the water discharge opening 831 of the fixation seat 83, wherein an engagement block 822 is mounted to a lower end of the support frame 821 and an engagement strip 832 is mounted in the fixation seat 83 and wherein in the condition that the water compartment 81 blocks the water discharge opening 831 of the fixation seat 83, a lower end of the engagement strip 832 is spaced from the engagement block 822; and in the condition that the water compartment 81 opens the water discharge opening 831 of the fixation seat 83, the engagement block 822 is in contact engagement with the lower end of the engagement strip 832 so as to stop or restrict upward movement of the water compartment 81 and the buoyance compartment 82. The passageway pipe 84 can be a hose or a flexible tube.

As shown in FIGS. 10-12, which are schematic views illustrating another embodiment of the counterweight float 8, the counterweight float 8 may further comprise a closure seat 85. The closure seat 85 is arranged at one side of the water compartment 81 and the buoyance compartment 82. The counterweight float 8 is rotatably mounted to the lower end of the passageway pipe 84. In a condition where the gravity of the water compartment 81 is greater than buoyance, the water compartment 81 and the buoyance compartment 82 swing downward and sink down so that the closure seat 85 blocks the lower end opening of the passageway pipe 84; and in a condition where the gravity of the water compartment 81 is smaller than buoyance, the water compartment 81 and the buoyance compartment 82 swing upward and float up so that the water compartment 81 opens the lower end opening of the passageway pipe 84. The passageway pipe 84 can be rigid passageway pipe that is extendable.

In the present invention, the water container 5 has a bottom that does not have an opening. When a water tank suffers continuous major water leakage, the water level of the water

tank would drop down quickly such that a siphon effect is induced in the siphon tube 6 that is mounted to the water container 5 to drain, substantially completely, water out of the water container 5. The back pressure pad 21 of the swing arm 2 opens the back pressure hole 11 of the water inlet valve body 1 and water flows through the water inlet valve body 1 into the water tank so that the water inlet valve enables water ingress.

The water receptacle tray 7 is mounted on the water inlet valve body 1 and water enters the water receptacle tray 7 and flows via the opening 72 in the bottom of the water receptacle tray 7 into the passageway pipe 84. Under this condition, since the water tank is suffering major water leakage, the water compartment 81 would lose buoyance and the water compartment 81 is filled with water and the water compartment 81 blocks the lower end opening of the passageway pipe 84 so that water that flows into the passageway pipe 84 flows backward to pass through the overflow port 71 of the water receptacle tray 7 and enter the water container 5. Since the bottom of the water container 5 does not have an opening, the water level in the water container 5 raises, making the float 4 received in the water container 5 to ascend and driving the swing arm 2 to rotate thereby allowing the back pressure pad 21 to close the back pressure hole 11, whereby water cannot flow through the water inlet valve body 1 into the water tank. As such, ingress of water is stopped and water resources can be saved.

When it is necessary to have the water inlet valve to enable water ingress again, the float 4 is pressed down to make water contained in the water container 5 to drain through the siphon tube 6 so that the water level inside the water container 5 drops down and the float 4 descends to drive the swing arm 2 to rotate such that the back pressure pad 21 opens the back pressure hole 11, and the water inlet valve may enable water ingress.

Thus, the present invention comprises an air evacuation hole 63 formed in a lower end portion of the siphon tube 6. As shown in FIG. 3, the air evacuation hole 63 is connected, via the passageway pipe, with an air pump 64. The air pump 64 has an actuation button that is common to a button of a discharge valve. Pressing down and thus actuating the air pump 64 to evacuate air from the siphon tube 6 would release pressure from the siphon tube 6 so that water of the water container 5 is drained through the siphon tube 6 to allow for water ingress of the water inlet valve. The air pump 64 is a known technique and structure specifics will not be provided herein.

As shown in FIG. 3, to more clearly evacuate air from the siphon tube 6, the present invention comprises a leverage bar 51 pivotally connected to the water container 5. The leverage bar 51 has an end to which a counterweight 511 is mounted and an opposite end that is provided with a closure pad 512 that corresponds to and is mateable with the water egress opening 62 of the siphon tube 6. The closure pad 512 is opposite to the water egress opening 62. When the air pump 66 is actuated to evacuate air from the siphon tube 6, the closure pad 512 of the leverage bar 51 closes the water egress opening 62 of the siphon tube 6 so that evacuation of air from the siphon tube 6 can be made complete. When the siphon tube 6 drains water, said opposite end of the leverage bar 51 is spaced from the water egress opening 62.

As shown in FIG. 5, the present invention may comprise a link bar 52 pivotally connected to the water container 5. The link bar 52 has an end corresponding to the float 4 received in the water container 5 and an opposite end connected to a pull wire (not shown). The pull wire is connected to an actuation button that is common to a button of a discharge valve such that pressing down the actuation button pulls the pull wire to make the link bar 52 swing and one end of the link bar 52 depresses the float 4 down to have water contained in the water container 5 drained through the siphon tube 6 thereby allowing the water inlet valve to enable water ingress.

In this way, in an event of major water leakage occurring in a water tank, the water inlet valve is closed so as to prevent water ingress thereby saving water resources. The present invention also involves the following solution for closing water inlet valve to prevent water ingress so as to handle minor water leakage (water creep or seepage) of the water tank.

The present invention may further comprise a counterweight buoyance switch 9. As shown in FIGS. 1 and 2, the counterweight buoyance switch 9 is mounted on the water container 5. The counterweight buoyance switch 9 comprises a counterweight water compartment 91 and a buoyance water compartment 92 that are independent of each other. The counterweight water compartment 91 has a lower end in which a water drain hole 911 is formed. An upper end of the siphon tube 6 is provided with an air aperture 65. As shown in FIG. 8, the counterweight water compartment 91 has an upper end to which a closure pressing plate 912 is provided. The closure pressing plate 912 corresponds to the air aperture 65. The counterweight buoyance switch 9 controls opening/closing of the air aperture.

As shown in FIG. 8, the counterweight buoyance switch 9 is mounted on the siphon tube 6 in an up and down slidable manner. In a condition where buoyance of the counterweight buoyance switch 9 is greater than the gravity thereof, the counterweight buoyance switch 9 slides upward and thus float up thereby opening the air aperture 65 of the siphon tube 6; and in a condition where the buoyance of the counterweight buoyance switch 9 is smaller than the gravity thereof, the counterweight buoyance switch 9 slides downward and sinks down thereby making the closure pressing plate 912 block the air aperture 65 and thus closing the air aperture 65 of the siphon tube 6. A specific way of mounting is such that an insertion strip 66 is formed on the siphon tube 6 and an insertion slot 93 is formed in the counterweight buoyance switch 9, wherein the insertion strip 66 is inserted into the insertion slot 93 to allow the counterweight buoyance switch 9 to be mounted, in an up and down slidable manner, to the siphon tube 6.

As shown in FIG. 9, the counterweight buoyance switch 9 can be rotatably mounted, through a pivot pin 94, to the water container 5. In a condition where the buoyance of the counterweight buoyance switch 9 is greater than the gravity thereof, the counterweight buoyance switch 9 swings upwards and floats up thereby opening the air aperture 65 of the siphon tube 6 and in a condition where the buoyance of the counterweight buoyance switch 9 is smaller than the gravity thereof, the counterweight buoyance switch 9 swings downward and sinks down, making the closure pressing plate 912 block the air aperture 65 thereby closing the air aperture 65 of the siphon tube 6.

During normal water discharging, since the water level outside the water container 5 of the water inlet valve, water contained in the counterweight water compartment 91 mounted to the counterweight buoyance switch 5 is constrained by the water drain hole 911 so as to drain relatively slow, whereby inside and outside water levels generated during the process of water discharging spontaneously overcome the buoyance from the lower side and changed into gravity to have the opening of the siphon tube 6 blocked, inducing a siphon effect to automatically drain water from the water container 5 of the water inlet valve (without unlocking device).

When the water tank is continuously suffering minor water leakage (seepage or creep), the water level of the water tank slowly drops down and under this condition, the counterweight buoyance switch 9 is acted upon by the buoyance of the buoyance water compartment 92, where the buoyance acting on the counterweight buoyance switch 9 is greater than the gravity thereof,

the air aperture 65 of the siphon tube 6 is opened and the siphon effect of the siphon tube 6 is released. In the present invention, the bottom of the water container 5 is not provided with an opening so that the water level inside the water container 5 does not drop and thus, the swing arm 2 is not caused to rotate and the back pressure hole 11 is not opened, whereby the water inlet valve does not allow for water ingress and the water resources can be saved.

With the water level of the water tank slowly dropping down and water contained in the counterweight water compartment 91 of the counterweight buoyance switch 9 slowly flowing out through the water drain hole 911, the counterweight buoyance switch 9 is still acted upon by the buoyance of the buoyance water compartment 92 and the buoyance of the counterweight buoyance switch 9 is still greater than the gravity thereof so that the air aperture 65 of the siphon tube 6 is kept open and no water ingress is allowed through the water inlet valve.

Continuous dropping of the water level of the water tank eventually drain off the water contained in the counterweight water compartment 91 and the counterweight buoyance switch 9 is acted upon by the gravity to close the air aperture 65 of the siphon tube 6. Under this condition, the water level of the water tank drops with a greater extent and a slower speed, making it not possible to induce is large suction force and no siphon effect is induced in the siphon tube 6, so that the water level of the water container 5 is still kept from dropping down. And, thus, water ingress through the water inlet valve is not enabled and water resources can be saved.

The present invention also discloses a major leakage prevention apparatus for a water inlet valve, which is mounted on a water inlet valve body 1 and comprises a swing arm 2, a regulation bar 3, a float 4, a water container 5, and a link bar 52. The swing arm 2 is rotatably mounted to the water inlet valve body 1. The swing arm 2 has an end to which a back pressure pad 21 is mounted to correspond to a back pressure hole 11 of the water inlet valve body 1. The swing arm 2 has an opposite end connected to the regulation bar 3. The float 4 is mounted to the regulation bar 3 and is received in the water container 5. The water container 5 is mounted on the water inlet valve body 1. The link bar 52 is rotatably mounted to the water container 5. The link bar 52 has an end corresponding to the float 4 received in the water container 5 and an opposite end to which a pull wire is connected. The pull wire is connected to an actuation button so that pressing down the actuation button pulls the pull wire to make the link bar 52 swing,

whereby an end of the link bar 52 presses down the float 4 to make water drained from the water container, allowing the water inlet valve to enable water ingress.

It will be understood that each of the elements described above, or two or more together may also find a useful application in other types of methods differing from the type described
5 above.

While certain novel features of this invention have been shown and described and are pointed out in the annexed claim, it is not intended to be limited to the details above, since it will be understood that various omissions, modifications, substitutions and changes in the forms and details of the device illustrated and in its operation can be made by those skilled in the art
10 without departing in any way from the claims of the present invention.

I CLAIM:

1. A major water leak prevention apparatus for a water inlet valve, where the major water leak prevention apparatus is mounted to a water inlet valve body and comprises a swing arm, a regulation bar, a float, a water container, a siphon tube, a water receptacle tray, and a counterweight float; the swing arm is rotatably mounted to the water inlet valve body, the swing arm having an end to which a back pressure pad is mounted to correspond to a back pressure hole of the water inlet valve body, the swing arm having an opposite end connected to the regulation bar, the float being mounted on the regulation bar and received in the water container, the water container being mounted on the water inlet valve body, the siphon tube being mounted on the water container; the water receptacle tray is mounted on the water inlet valve body and is located above the water container, the water receptacle tray comprising an overflow port formed thereon, the overflow port being connected with the water container, the water receptacle tray having a bottom in which an opening is formed; and the counterweight float is mounted on a lower end of the water inlet valve body, the counterweight float is integrated comprising a water compartment and a buoyance compartment, the water compartment and the buoyance compartment being independent of each other, the water compartment and the buoyance compartment being arranged at the lower end of the water inlet valve body, the bottom opening of the water receptacle tray being connected, via a passageway pipe, to the counterweight float, wherein in a condition where the weight of the water compartment is greater than a buoyance of the water compartment, the water compartment blocks a lower end opening of the passageway pipe; and in a condition where the weight of the water compartment is smaller than the buoyance of the water compartment, the water compartment opens the lower end opening of the passageway pipe.

2. The major water leak prevention apparatus for a water inlet valve according to claim 1, wherein the counterweight float further comprises a fixation seat, the fixation seat being mounted to the lower end of the water inlet valve body, the fixation seat comprising a water discharge opening in communication with the lower end opening of the passageway pipe, the water compartment and the buoyance compartment being mounted, movably, to the fixation seat in an up-and-down slidable manner, wherein the up-and-down slidable manner is such that the buoyance

compartment is provided with a support frame mounted thereto and the support frame is fit in the water discharge opening of the fixation seat, wherein an engagement block is mounted to a lower end of the support frame and an engagement strip is mounted in the fixation seat and wherein in the condition that the water compartment blocks the water discharge opening of the fixation seat, a lower end of the engagement strip is spaced from the engagement block; and in the condition that the water compartment opens the water discharge opening of the fixation seat, the engagement block is in contact engagement with the lower end of the engagement strip so as to stop or restrict upward movement of the water compartment and the buoyance compartment.

3. The major water leak prevention apparatus for a water inlet valve according to claim 1, wherein the counterweight float further comprises a closure seat, the closure seat being arranged at one side of the water compartment and the buoyance compartment, the counterweight float being rotatably mounted to the lower end of the passageway pipe, wherein in the condition where the weight of the water compartment is greater than the buoyance of the water compartment, the water compartment and the buoyance compartment swing downward and sink down so that the closure seat blocks the lower end opening of the passageway pipe; and in the condition where the weight of the water compartment is smaller than the buoyance of the water compartment, the water compartment and the buoyance compartment swing upward and float up so that the water compartment opens the lower end opening of the passageway pipe.

4. The major water leak prevention apparatus for a water inlet valve according to claim 1 further comprising a counterweight buoyance switch, the counterweight buoyance switch being mounted on the water container, the counterweight buoyance switch comprising a counterweight water compartment and a buoyance water compartment that are independent of each other, the counterweight water compartment having a lower end in which a water drain hole is formed, an upper end of the siphon tube being provided with an air aperture, the counterweight water compartment having an upper end to which a closure pressing plate is provided, the closure pressing plate corresponding to the air aperture, the counterweight buoyance switch controlling opening/closing of the air aperture.

5. The major water leak prevention apparatus for a water inlet valve according to claim 4, wherein the counterweight buoyance switch is mounted on the siphon tube in an up and down slidable manner, wherein in a condition where a buoyance of the counterweight buoyance switch is greater than the weight thereof, the counterweight buoyance switch slides upward and thus float up thereby opening the air aperture of the siphon tube; and in a condition where the buoyance of the counterweight buoyance switch is smaller than the weight thereof, the counterweight buoyance switch slides downward and sinks down thereby making the closure pressing plate block the air aperture and thus closing the air aperture of the siphon tube.

6. The major water leak prevention apparatus for a water inlet valve according to claim 4, wherein the counterweight buoyance switch is rotatably mounted, through a pivot pin, to the water container wherein in a condition where the buoyance of the counterweight buoyance switch is greater than the weight thereof, the counterweight buoyance switch swings upwards and floats up thereby opening the air aperture of the siphon tube and in a condition where the buoyance of the counterweight buoyance switch is smaller than the weight thereof, the counterweight buoyance switch swings downward and sinks down, making the closure pressing plate block the air aperture thereby closing the air aperture of the siphon tube.

7. The major water leak prevention apparatus for a water inlet valve according to claim 1, wherein an air evacuation hole is formed in a lower end portion of the siphon tube, the air evacuation hole being connected, via the passageway pipe, with an air pump, whereby actuating the air pump to evacuate air from the siphon tube releases pressure from the siphon tube so that water of the water container is drained through the siphon tube.

8. The major water leak prevention apparatus for a water inlet valve according to claim 1, wherein a link bar is pivotally connected to the water container, the link bar having an end corresponding to the float received in the water container and an opposite end connected to a pull wire, the pull wire being connected to an actuation button, whereby actuating the actuation button pulls the pull wire to make the link bar swing and one end of the link bar depresses the float down to have water contained in the water container drained through the siphon tube.

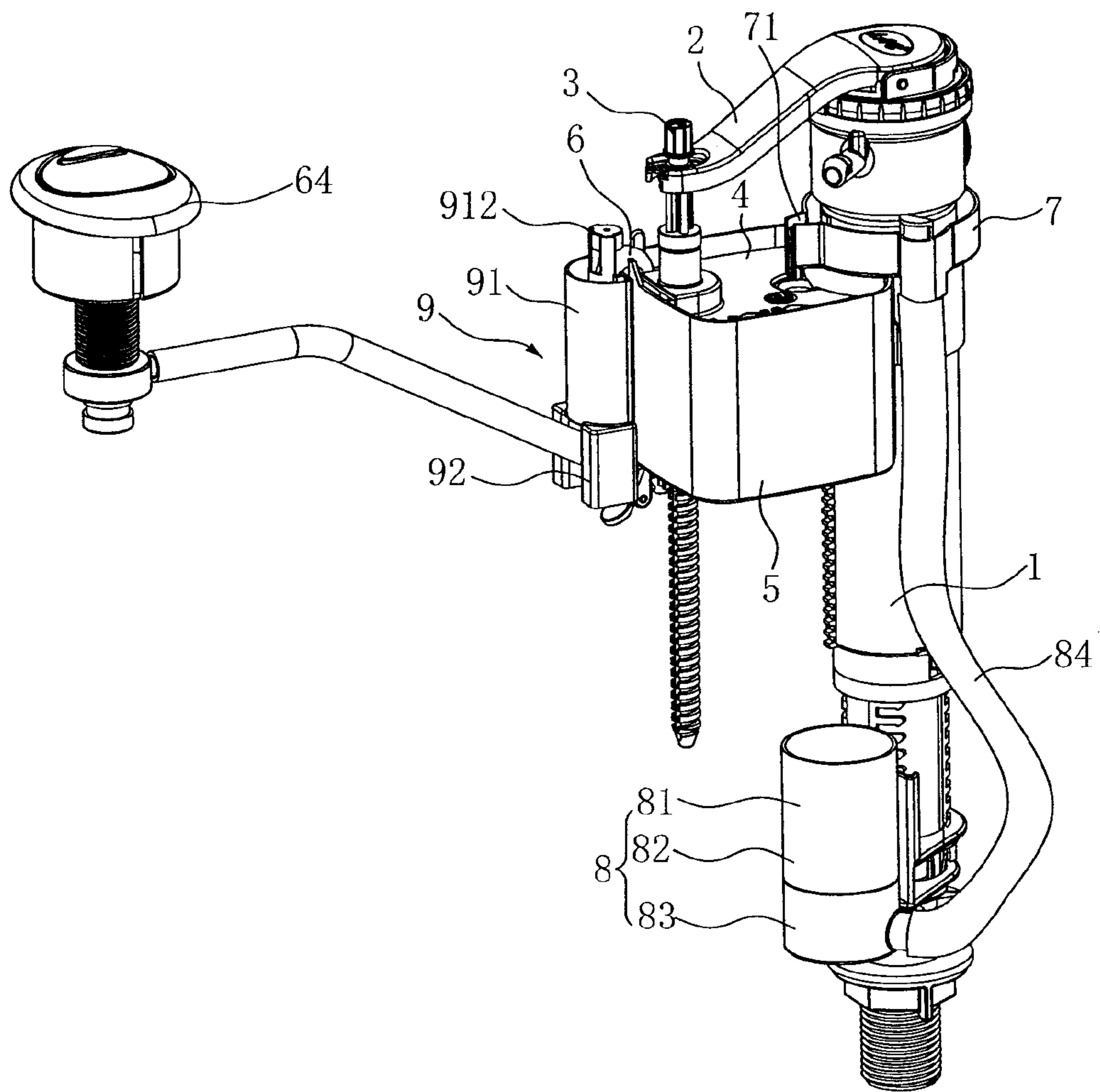

FIG. 1

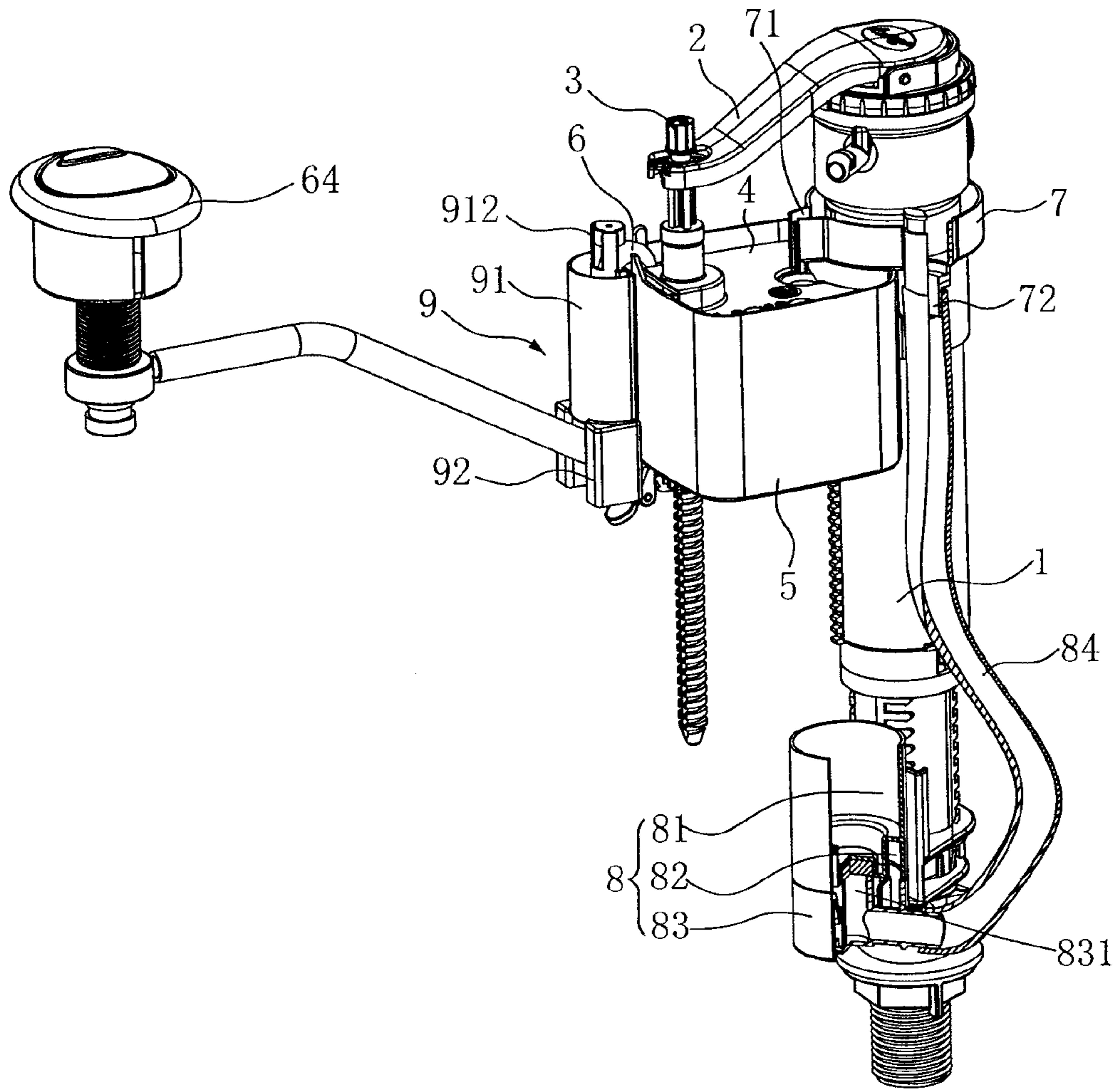

FIG. 2

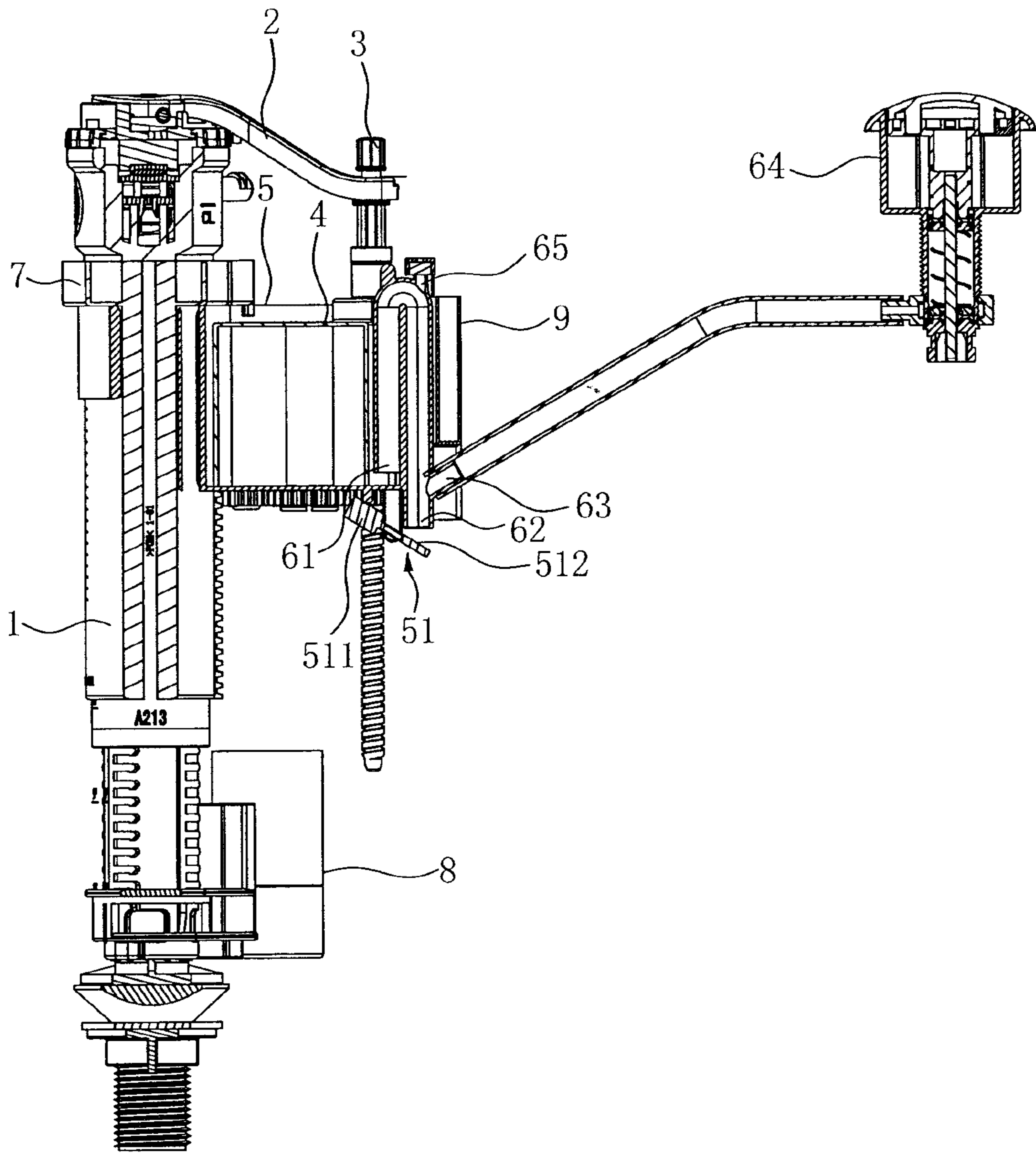

FIG. 3

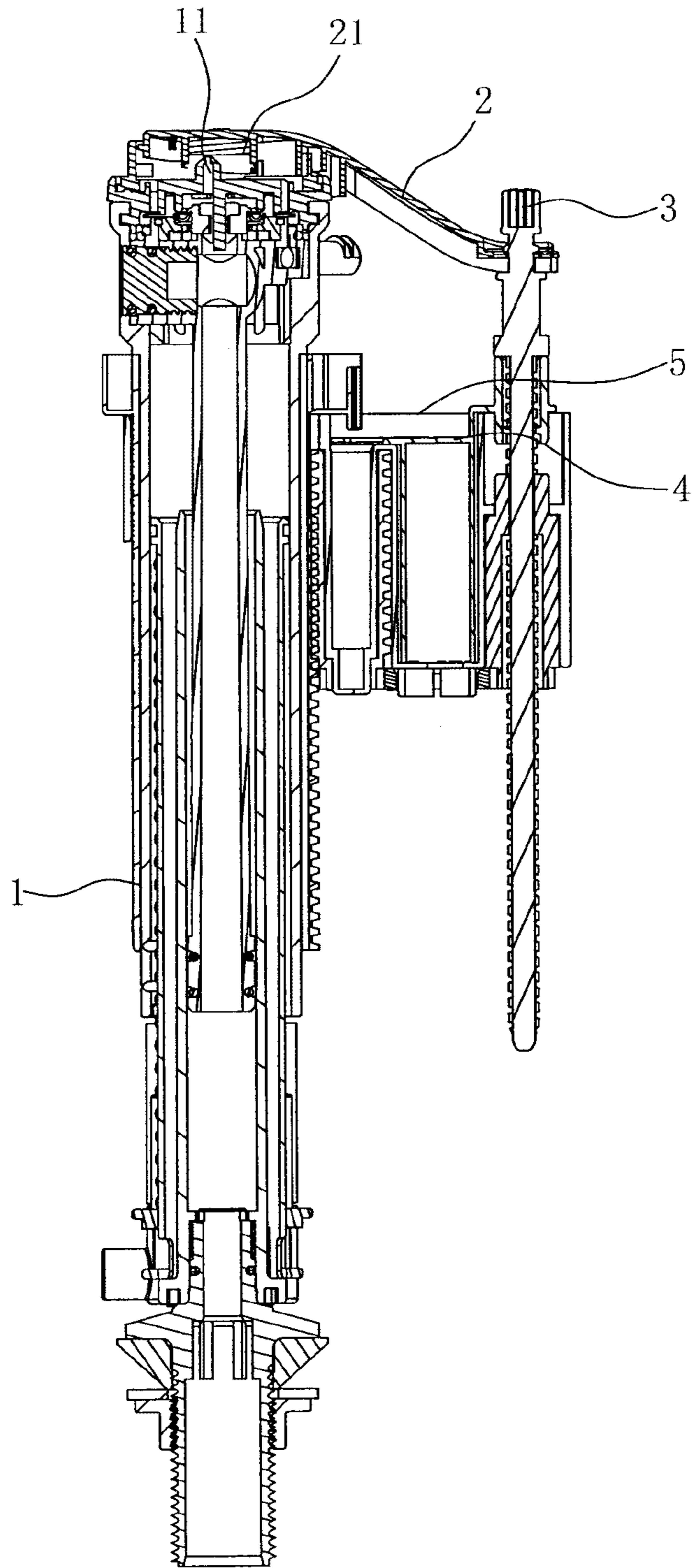

FIG. 4

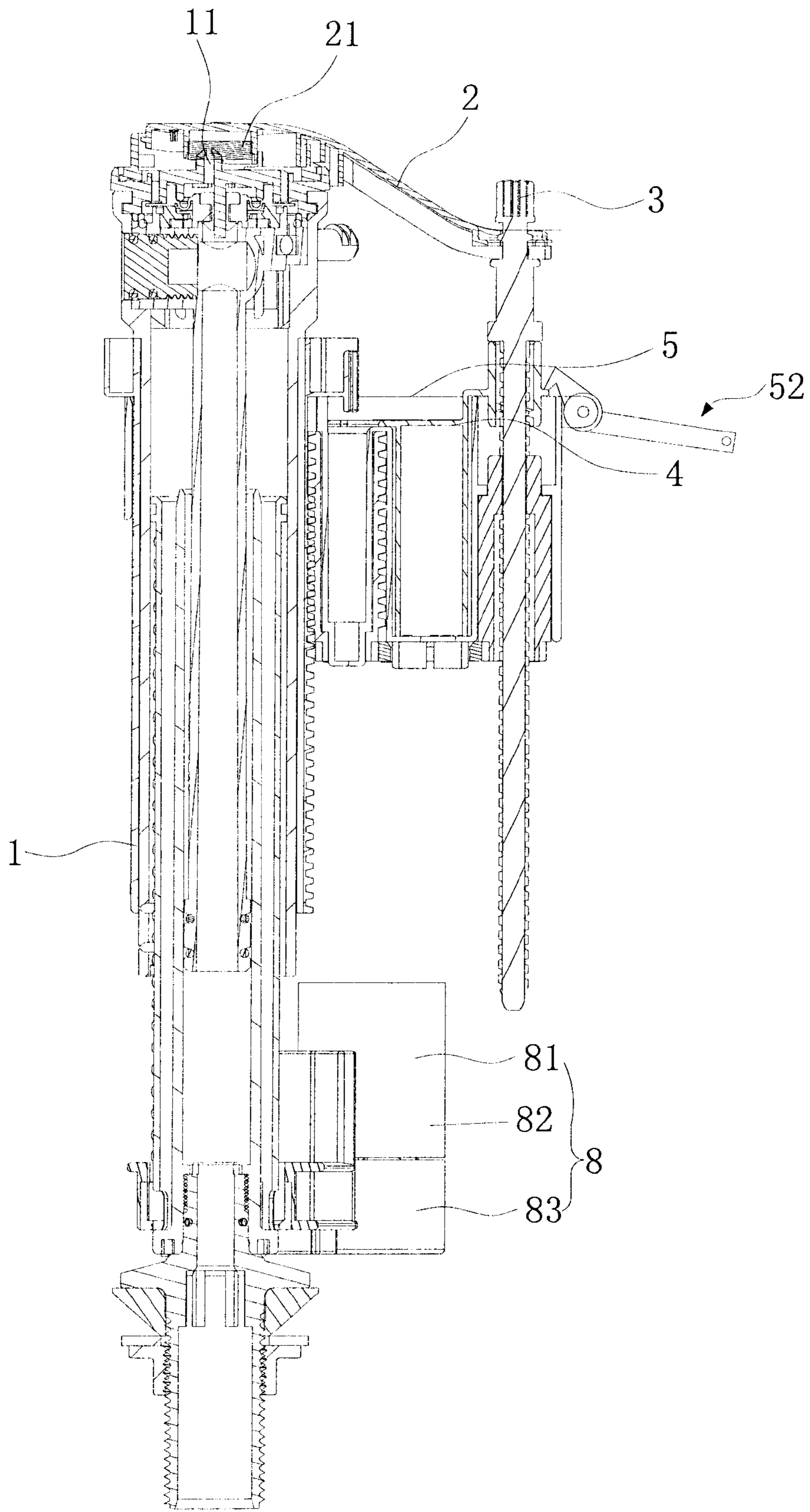

FIG. 5

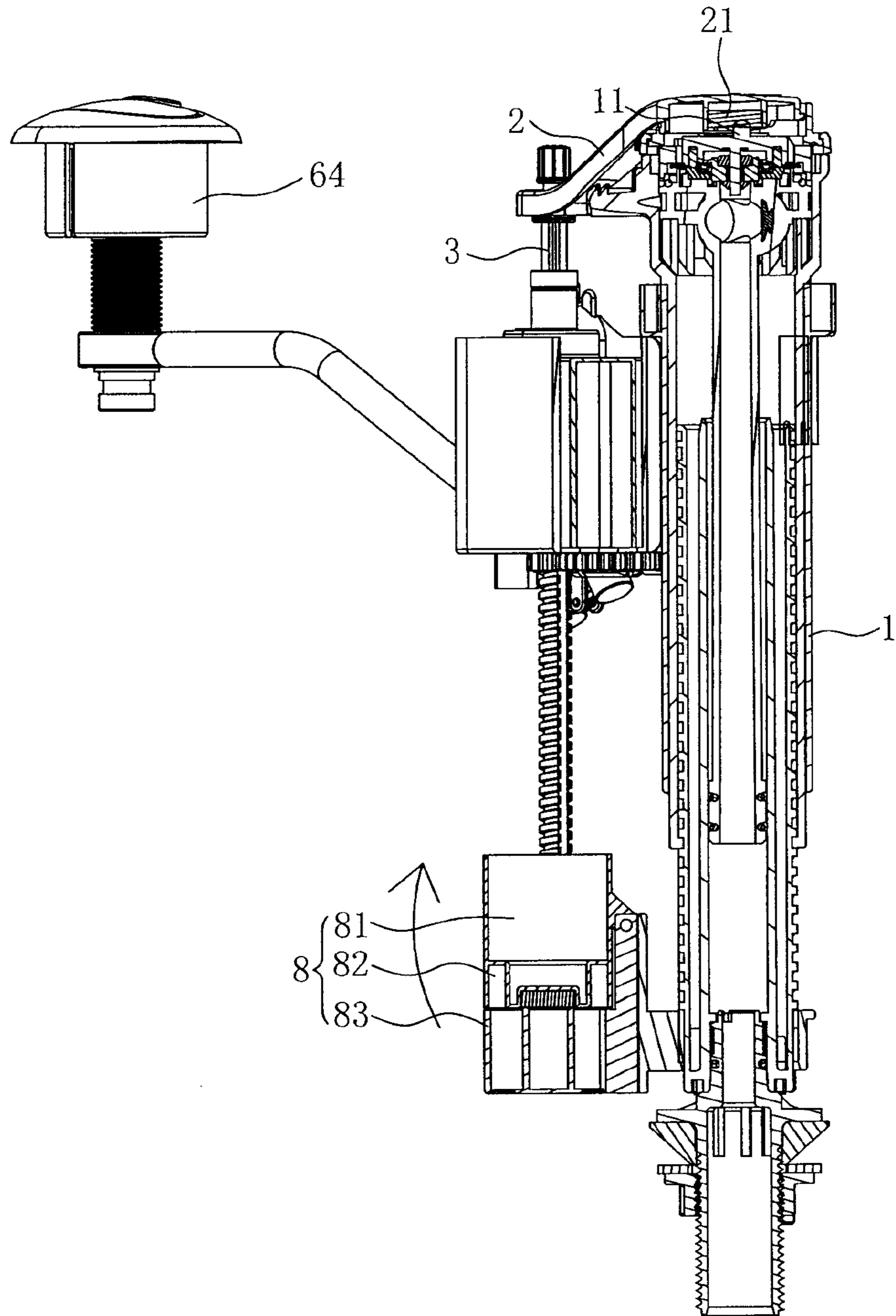

FIG. 6

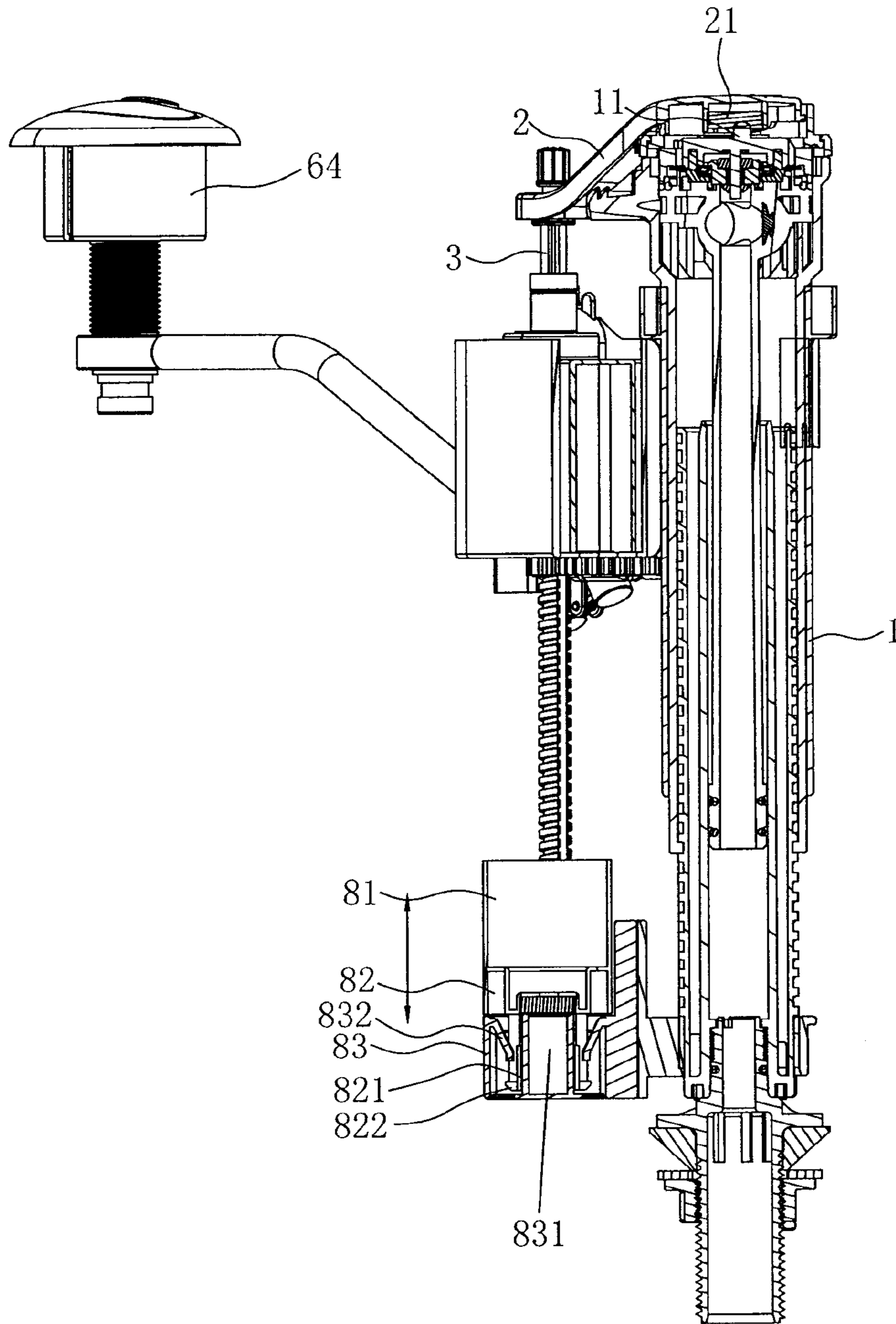

FIG. 7

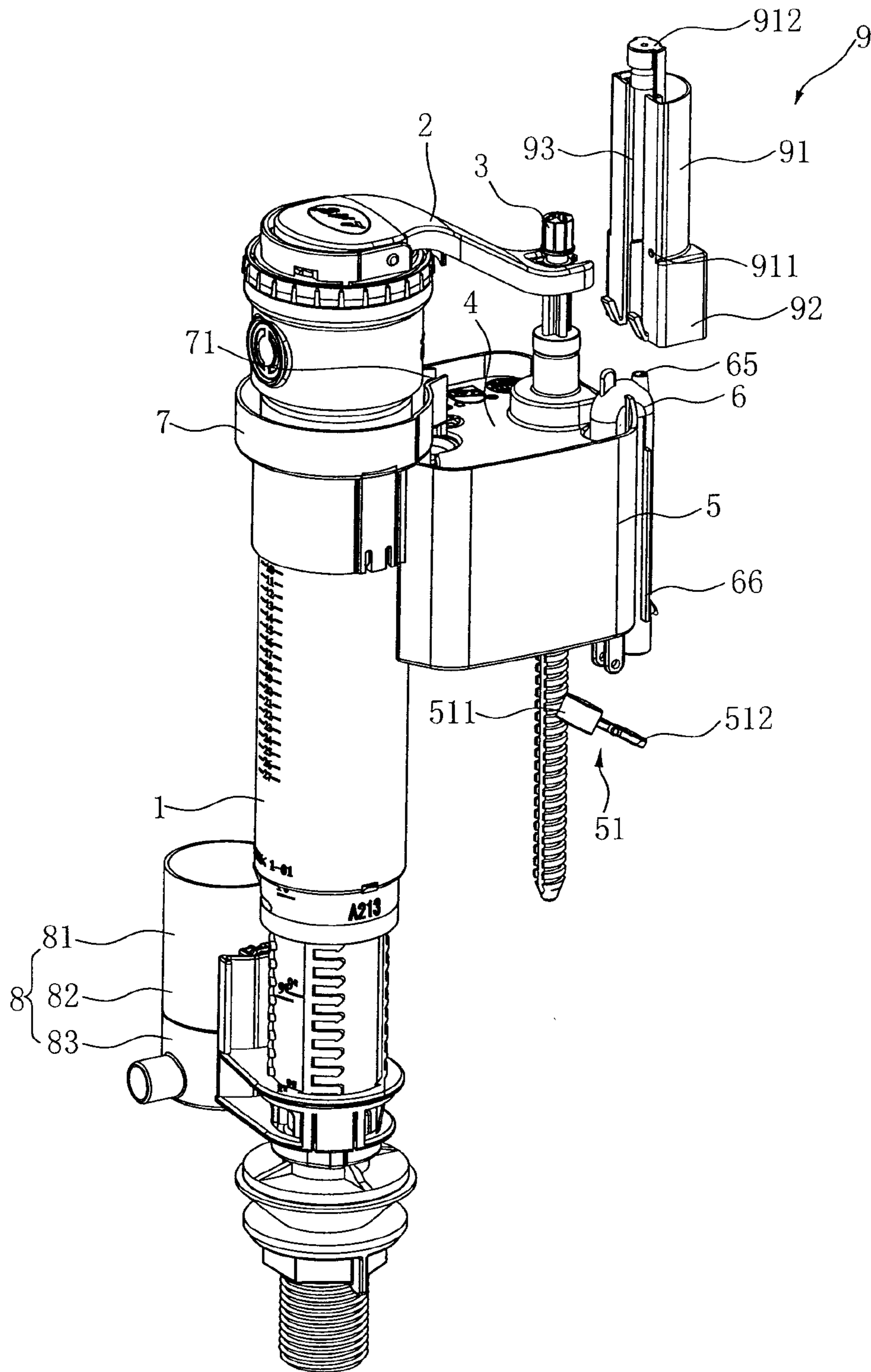

FIG. 8

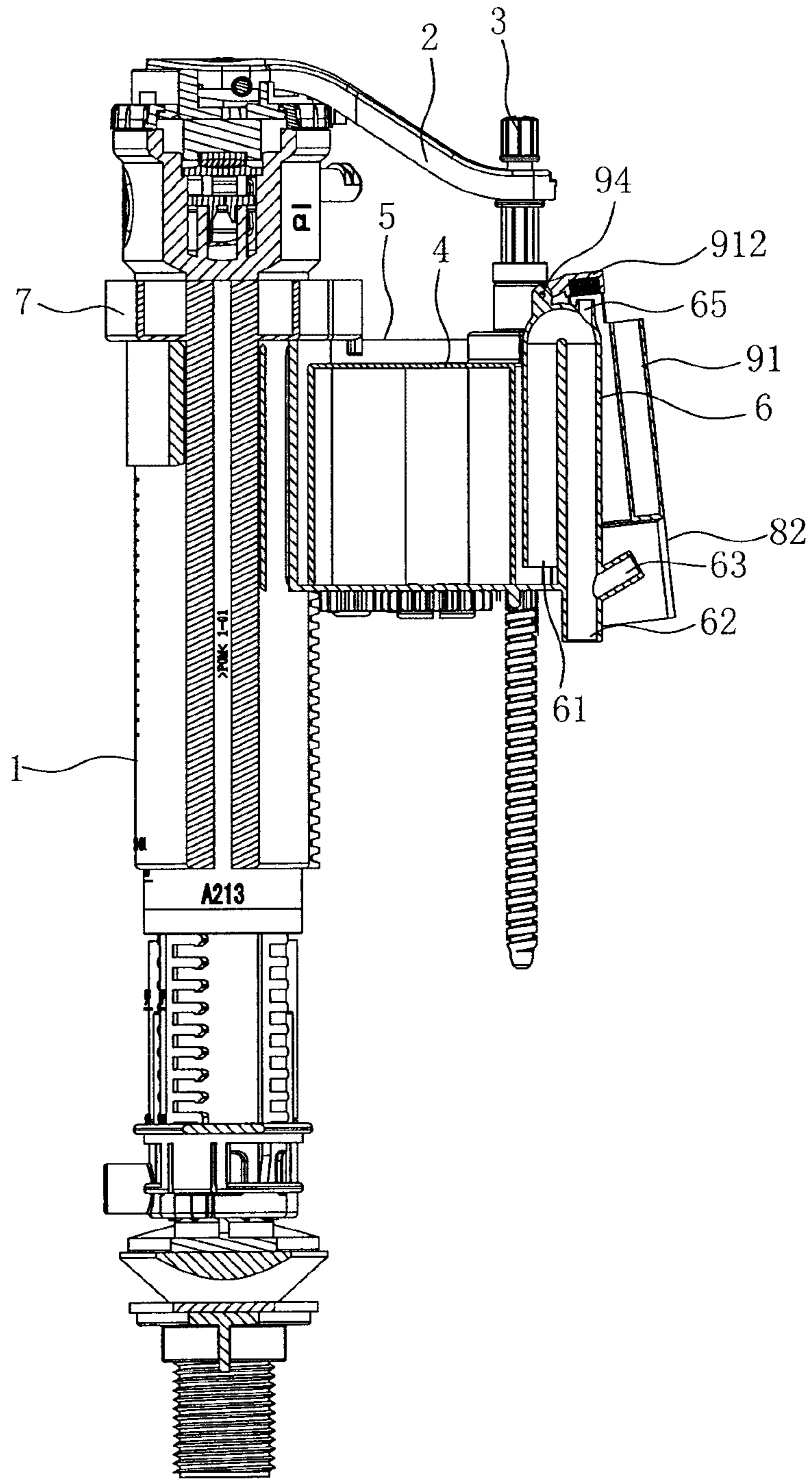

FIG. 9

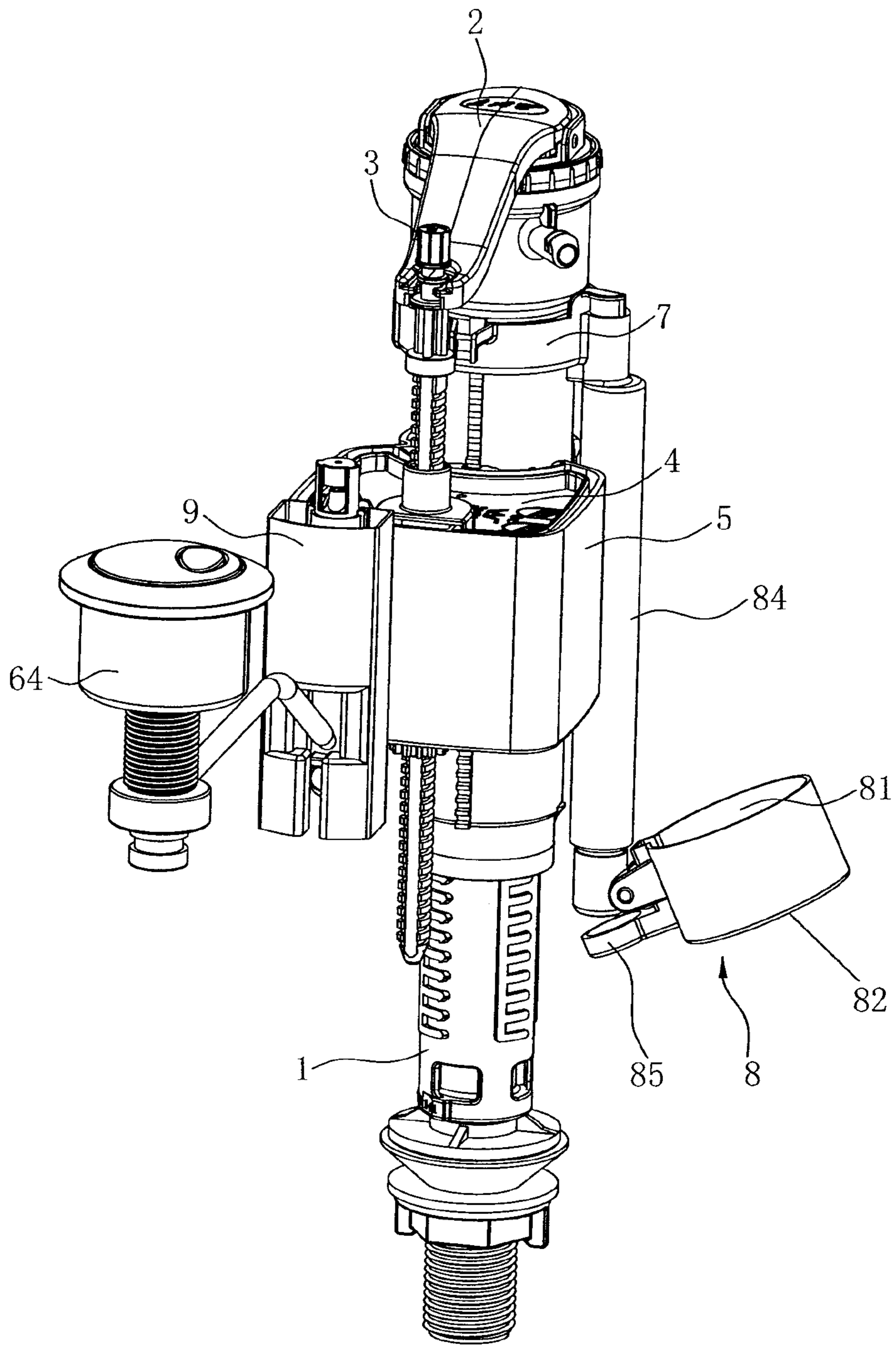

FIG. 10

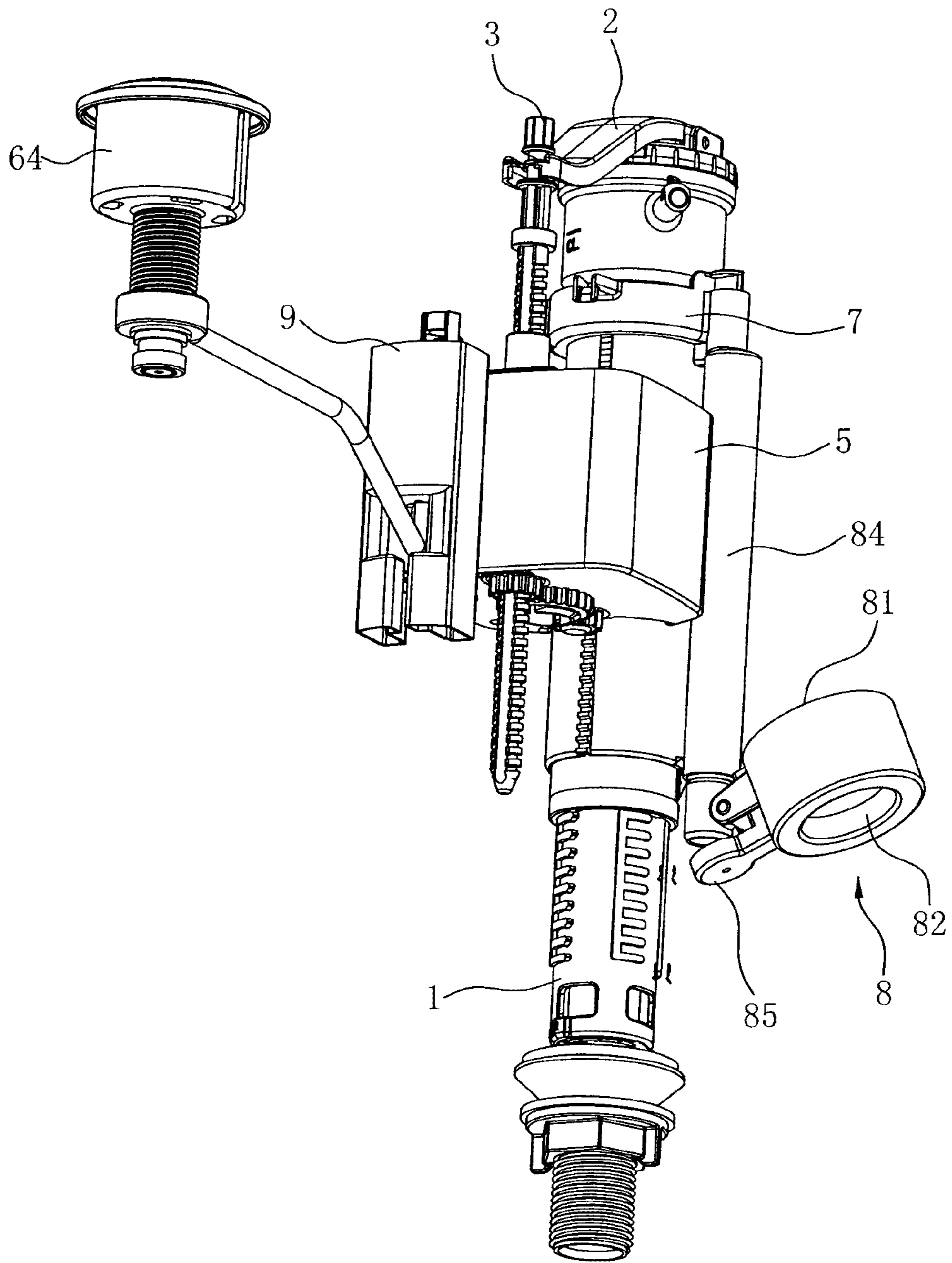

FIG. 11

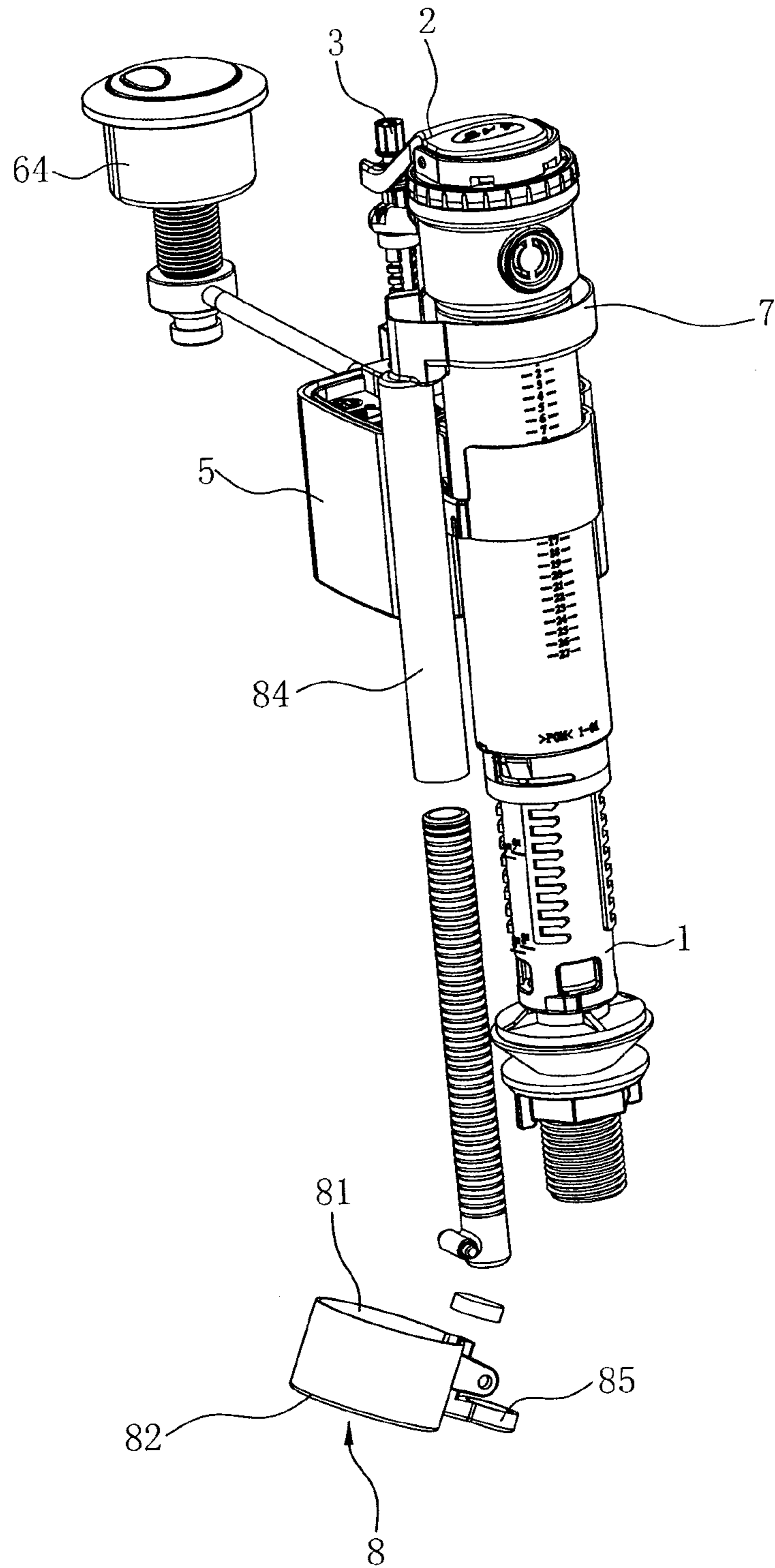

FIG. 12

