



HU000033429T2

(19) **HU**(11) Lajstromszám: **E 033 429**(13) **T2****MAGYARORSZÁG**  
Szellemi Tulajdon Nemzeti Hivatala**EURÓPAI SZABADALOM**  
**SZÖVEGÉNEK FORDÍTÁSA**(21) Magyar ügyszám: **E 07 831406**(51) Int. Cl.: **G03G 21/18** (2006.01)(22) A bejelentés napja: **2007. 11. 01.****F16D 3/04** (2006.01)**G03G 15/00** (2006.01)

(96) Az európai bejelentés bejelentési száma:

**EP 20070831406**

(86) A nemzetközi (PCT) bejelentési szám:

**PCT/JP 07/071675**

(97) Az európai bejelentés közzétételi adatai:

**EP 2054777 A1** **2008. 06. 19.**

(87) A nemzetközi közzétételi szám:

**WO 08072432**

(97) Az európai szabadalom megadásának meghirdetési adatai:

**EP 2054777 B1** **2017. 05. 31.**

(30) Elsőbbségi adatok:

**2006332838** **2006. 12. 11.** **JP****2007259661** **2007. 10. 03.** **JP**

(73) Jogosult(ak):

**Canon Kabushiki Kaisha, Tokyo 146-8501 (JP)**

(72) Feltaláló(k):

**CHADANI, Kazuo, Tokyo 146-8501 (JP)****MORI, Tomonori, Tokyo 146-8501 (JP)****HASHIMOTO, Koji, Tokyo 146-8501 (JP)**

(74) Képviselő:

**SBGK Szabadalmi Ügyvivői Iroda, Budapest**

(54)

**Feldolgozó patron és képforgató berendezés**

Az európai szabadalom ellen, megadásának az Európai Szabadalmi Közlönyben való meghirdetésétől számított kilenc hónapon belül, felszólalást lehet benyújtani az Európai Szabadalmi Hivatalnál. (Európai Szabadalmi Egyezmény 99. cikk(1))

A fordítást a szabadalmas az 1995. évi XXXIII. törvény 84/H. §-a szerint nyújtotta be. A fordítás tartalmi helyességét a Szellemi Tulajdon Nemzeti Hivatala nem vizsgálta.

(19)



(11)

**EP 2 054 777 B1**

(12)

**EUROPEAN PATENT SPECIFICATION**

(45) Date of publication and mention  
of the grant of the patent:  
**31.05.2017 Bulletin 2017/22**

(51) Int Cl.:  
**G03G 21/18 (2006.01) G03G 15/00 (2006.01)**  
**F16D 3/04 (2006.01)**

(21) Application number: **07831406.9**

(86) International application number:  
**PCT/JP2007/071675**

(22) Date of filing: **01.11.2007**

(87) International publication number:  
**WO 2008/072432 (19.06.2008 Gazette 2008/25)**

**(54) PROCESS CARTRIDGE AND IMAGE FORMING APPARATUS**

PROZESSKARTUSCHE UND BILDERZEUGUNSGERÄT

CARTOUCHE DE TRAITEMENT ET APPAREIL DE FORMATION D'IMAGE

(84) Designated Contracting States:  
**AT BE BG CH CY CZ DE DK EE ES FI FR GB GR  
HU IE IS IT LI LT LU LV MC MT NL PL PT RO SE  
SI SK TR**

(30) Priority: **11.12.2006 JP 2006332838**  
**03.10.2007 JP 2007259661**

(43) Date of publication of application:  
**06.05.2009 Bulletin 2009/19**

(60) Divisional application:  
**17164940.3**

(73) Proprietor: **Canon Kabushiki Kaisha**  
**Tokyo 146-8501 (JP)**

(72) Inventors:  
• **CHADANI, Kazuo**  
**Tokyo 146-8501 (JP)**  
• **MORI, Tomonori**  
**Tokyo 146-8501 (JP)**  
• **HASHIMOTO, Koji**  
**Tokyo 146-8501 (JP)**

(74) Representative: **TBK**  
**Bavariaring 4-6**  
**80336 München (DE)**

(56) References cited:  
**EP-A- 1 178 370 GB-A- 2 141 520**  
**US-A- 3 985 436 US-A- 4 835 565**  
**US-A1- 2002 110 388 US-B1- 6 285 847**

**EP 2 054 777 B1**

Note: Within nine months of the publication of the mention of the grant of the European patent in the European Patent Bulletin, any person may give notice to the European Patent Office of opposition to that patent, in accordance with the Implementing Regulations. Notice of opposition shall not be deemed to have been filed until the opposition fee has been paid. (Art. 99(1) European Patent Convention).

## Description

### [TECHNICAL FIELD]

**[0001]** The present invention relates to a process cartridge according to claim 1 and an electrophotographic image forming apparatus which uses the same.

**[0002]** Here, the electrophotographic image forming apparatus forms an image on a recording material using an electrophotographic type process. The examples of the electrophotographic image forming apparatus include an electrophotographic copying machine, an electrophotographic printer (for example, laser beam printer, LED printer, and so on), a facsimile device, and a word processor.

**[0003]** The process cartridge is a cartridge which comprises at least developing means and an electrophotographic photosensitive drum in the cartridge integrally, and it is detachably mountable to the main assembly of the electrophotographic image forming apparatus.

### [BACKGROUND ART]

**[0004]** Heretofore, the photosensitive drum and the process means actable on the said photosensitive drum are integrally unified into a cartridge in the electrophotographic image forming apparatus using the electrophotographic image forming process. The process cartridge type in which this cartridge is detachably mountable to the main assembly of the electrophotographic image forming apparatus, is employed. In this process cartridge type, the maintenance operation of the apparatus can be performed without depending on a service person, and therefore, the operativity can be remarkably and can be improved. Therefore, this process cartridge type is used widely in the electrophotographic image forming apparatus.

**[0005]** Light corresponding to the image information, such as the laser, LED, or the lamp, is projected onto the photosensitive drum in the electrophotographic image forming apparatus. By doing so, an electrostatic latent image is formed on the photosensitive drum. This electrostatic latent image is developed by a developing device. The developed image formed on the photosensitive drum is transferred onto a recording material. By doing so, the image is formed on the recording material.

**[0006]** JP 2001-255806A discloses the color electrophotographic image forming apparatus of the inline type in which a plurality of process cartridges are put in order by the one array. The process cartridge 40 has a drum unit 41 which includes a photosensitive drum 44, and a developing unit 42 which includes a developing roller 68, and they are rotatably connected relative to each other by a pin 43. The photosensitive drum 44 is provided with a cartridge coupling 60 on an axial end of the photosensitive drum 44. When the process cartridge 40 is mounted to the main assembly of the apparatus, a cartridge coupling 60 engages with a main assembly coupling 61 pro-

vided in the main assembly of the apparatus, so that the driving force is transmitted. A driving force is transmitted to the developing roller 68 through the idler gears 65 and 66 from the input gear 64 as the development driving force transmission member provided on the pin 43 of the developing unit 42. When the process cartridge 40 is mounted to the main assembly of the apparatus The input gear 64 is engaged with the gear 67 provided in the main assembly of the apparatus, and the engagement to receive the driving force., More particularly, the drive transmissions to the photosensitive drum 44 and to the developing roller 68 from the main assembly of the apparatus are carried out independently from each other.

**[0007]** However, recently, further downsizing and image quality improvement of the process cartridge and the electrophotographic image forming apparatus are desired. The input gear is provided on the swing center which does not change in the position even if the developing unit swings in the conventional example. For this reason, the developing roller requires a space in order to receive the driving force from the input gear through the idler gear of the process cartridge. The rotational accuracy of the developing roller is influenced by the engagement among the input gear, the idler gear, and the main assembly gear.

**[0008]** A generic process cartridge having the features of the preamble of claim 1 is known from US 6 285 847 B1.

**[0009]** A further prior art process cartridge is known from GB 2 141 520 A.

### [DISCLOSURE OF THE INVENTION]

**[0010]** The present invention further develops the prior art structures mentioned above.

**[0011]** Thus, it is an object of the present invention to provide an easily mountable process cartridge with separate drives for the electrophotographic photosensitive drum and the developing roller.

**[0012]** This object is achieved by a process cartridge having the features of claim 1. Advantageous further developments are set out in the dependent claims. An electrophotographic image forming apparatus comprising such a process cartridge is defined in claim 13.

**[0013]** The present invention provides a process cartridge and a small size electrophotographic image forming apparatus wherein a rotational driving force is directly inputted to the developing roller through the shaft coupling member from the main assembly of the apparatus independently from the driving input to the photosensitive drum.

**[0014]** According to the present invention a process cartridge and an image forming apparatus are provided wherein the rotational accuracy of the developing roller is improved, so that the image quality is improved.

**[0015]** The object as well as features, and advantages of the present invention will become more apparent upon consideration of the following description of the preferred embodiments of the present invention, taken in conjunc-

tion with the accompanying drawings.

[BRIEF DESCRIPTION OF THE DRAWINGS]

[0016]

Figure 1 is a general arrangement of a color electro-photographic image forming apparatus according to an embodiment 1 of the present invention.

Figure 2 is a sectional view of a process cartridge according to Embodiment 1.

Figure 3 is the perspective view of an outer appearance of the process cartridge according to Embodiment 1.

Figure 4 is a perspective view of a developing unit according to Embodiment 1.

Figure 5 illustrates a mounting operation relative to a main assembly of the image forming apparatus of the process cartridge according to Embodiment 1.

Figure 6 is a perspective view in the state where the process cartridge according to Embodiment 1 is positioned in the main assembly of the image forming apparatus.

Figure 7 illustrates a supporting structure for a developing roller according to Embodiment 1.

Figure 8 is an exploded view of a shaft coupling member according to Embodiment 1.

Figure 9 is a sectional view of the shaft coupling member according to Embodiment 1.

Figure 10 is a perspective view of the shaft coupling member of a developing unit according to Embodiment 1.

Figure 11 is a perspective view which illustrates a first main assembly drive transmission member and a second main assembly drive transmission member of the image forming apparatus according to Embodiment 1.

Figure 12 is a side view which illustrates an operation of the shaft coupling member before the mounting of the process cartridge according to Embodiment 1.

Figure 13 is a schematic illustration which illustrates the operation of the shaft coupling member before the mounting of the process cartridge according to Embodiment 1.

Figure 14 is a side view which illustrates the operation of the shaft coupling member after the mounting of the process cartridge according to Embodiment 1.

Figure 15 is a schematic illustration which illustrates the operation of the shaft coupling member after the mounting of the process cartridge according to Embodiment 1.

Figure 16 is a side view which illustrates the positioning for the shaft coupling member according to Embodiment 2.

Figure 17 is a perspective view which illustrates the shaft coupling member according to Embodiment 3.

Figure 18 illustrates an operation of the shaft coupling member according to Embodiment 3.

Figure 19 illustrates an operation of the shaft coupling member according to Embodiment 4.

Figure 20 illustrates an operation of the shaft coupling member according to Embodiment 4.

5

[BEST MODE FOR CARRYING OUT THE INVENTION]

[0017] The preferred embodiments of the present invention will be described in conjunction with the accompanying drawings.

10

Embodiment 1

[0018] Referring to Figure 1 - Figure 15, the process cartridge and the electrophotographic image forming apparatus according to an embodiment of the present invention will be described.

15

[0019] Figure 1 illustrates a general arrangement of the color electrophotographic image forming apparatus according to this embodiment.

20

(General arrangement of image forming apparatus)

[0020] Figure 1 shows a general arrangement of an electrophotographic image forming apparatus (hereinafter, image forming apparatus) 100. As shown in Figure 1, four detachably mountable process cartridges 7 (7a, 7b, 7c, 7d) are mounted by mounting members (unshown). In Figure 1, the process cartridges 7 are inclined relative to the horizontal direction in the main assembly of the apparatus 100.

25

[0021] Each process cartridge 7 has an electrophotographic photosensitive member drum (hereinafter, photosensitive drum) 1 (1a, 1b, 1c, 1d). Around the photosensitive drum 1 of the process cartridge 7, there are provided process means, such as a charging roller 2 (2a, 2b, 2c, 2d), a developing roller 25 (25a, 25b, 25c, 25d), and a cleaning member 6 (6a, 6b, 6c, 6d), are provided integrally. The charging roller 2 has a function of charging charges the surface of the photosensitive drum 1 uniformly. The developing roller 25 has a function of developing, with the toner, a latent image formed on the photosensitive drum 1 into a visualized image. The cleaning member 6 removes the toner which remains on the photosensitive drum 1, after the developer image formed on the photosensitive drum 1 is transferred onto a recording material.

35

40

45

[0022] A scanner unit 3 for forming the latent image on the photosensitive drum 1 by exposing the photosensitive drum 1 selectively on the basis of the image information, is provided in a lower part of the process cartridge 7.

[0023] A cassette 17 which contains the recording materials S is provided in a lower position of the main assembly 100A of the apparatus. A recording material feeding means is provided so that the recording material S passes through a secondary transfer roller 70 portion and a fixing portion 74 portion to the upper portion of apparatus main assembly A. In the detail, it comprises a feed-

50

55

ing roller 54 for carrying out the separation and feeding of the recording materials S from the cassette 17 one by one. It further comprises a conveying roller pair 76 for feeding the fed recording material S, and a resist roller pair 55 for synchronizing latent image formed on the photosensitive drum 1 with the recording material S. In an upper part of the process cartridge 7 (7a, 7b, 7c, 7d), an intermediary transfer unit 5 as the intermediary transfer means for transferring the toner images formed on the photosensitive drums 1 (1a, 1b, 1c, 1d), is provided. The intermediary transfer unit 5 comprises a driving roller 56 and a follower roller 57. It further comprises a primary transfer rollers 58 (58a, 58b, 58c, 58d) provided in the position opposed to the photosensitive drum 1 for each color, and an opposing rollers 59 opposed to a secondary transfer rollers 70, respectively. A transfer belt 9 is extended around the rollers. The circulative movement of the transfer belt 9 is carried out contacting to all the photosensitive drums 1. By applying a voltage to the primary transfer rollers 58 (58a, 58b, 58c, 58d), the toner images are transferred primarily onto the transfer belt 9 from the photosensitive drums 1. The voltage is applied between the opposition 59 rollers disposed in the transfer belt 9, and the secondary transfer rollers 70 to transfer the toner image from the transfer belt 9 onto the recording material S.

**[0024]** Each photosensitive drum 1 is rotated in the image forming operation and the drum 1 is charged uniformly by the charging roller 2. Subsequently, the photosensitive drum 1 is selectively exposed with the scanner unit 3. By doing so, an electrostatic latent image is formed on the photosensitive drum 1. The latent image is developed by the developing roller 25. This forms the color developer image on each photosensitive drum 1. In synchronism with this image formation, a resist roller pair 55 feeds the recording material S to the secondary transfer position where the opposing roller 59 and the secondary transfer roller 70 are opposed to each other with the transfer belt 9 therebetween. An image transfer bias voltage is applied to the secondary transfer roller 70 to transfer the secondary color developer images on the transfer belt onto the recording material S. By doing so, a color image is formed on the recording material S. The recording material S which has the formed color image is heated and pressed by the fixing portion 74, so that the developer image is fixed. Thereafter, the recording material S is discharged to the discharging portion 75 by the discharging roller 72. The fixing portion 74 is disposed in the upper position of Main assembly of the apparatus A.

(Process cartridge)

**[0025]** Referring to Figure 2 - Figure 4, the process cartridge 7 of this embodiment will be described. Figure 2 is a major section of the process cartridge 7 which contains the developer (hereinafter, toner). A cartridge 7 which contains the toner of the yellow color, a cartridge 7b which contains the toner of a magenta color, a car-

tridge 7c which contains the toner of the cyan color, and a cartridge 7d which contains the toner of the black color, have the same structures.

**[0026]** Each process cartridge 7 (7a, 7b, 7c, 7d) includes a drum unit 26 (26a, 26b, 26c, 26d) as a first frame, and a developing unit 4 (4a, 4b, 4c, 4d) as a second frame. The drum unit 26 is provided with the photosensitive drum 1 (1a, 1b, 1c, 1d), and the charging roller 2 (2a, 2b, 2c, 2d) and the cleaning member 6 (6a, 6b, 6c, 6d). And, the developing unit 4 is provided with a developing roller 25.

**[0027]** The drum unit 26 includes a cleaning frame 27 and the photosensitive drum 1 is rotatably mounted to it through a drum-front bearing 10 and a drum-rear bearing 11 (Figure 3). The end of the photosensitive drum 1 is provided with the drum coupling 16 and the flange 85.

**[0028]** Around the photosensitive drum 1, as mentioned above, the charging roller 2 and the cleaning member 6 are disposed. The residual toner removed by the cleaning member 6 from the photosensitive drum 1 surface is let fall in a removed toner chamber 27a. A driving force is transmitted to the drum unit 26 from a main assembly driving motor (unshown) as a driving source, so that the photosensitive drum 1 is rotated correspondingly to the image forming operation process. The charging roller 2 is rotatably mounted to the cleaning frame 27 through the charging roller bearings 28. And, it is pressed by a charging roller pressing member 46 toward the photosensitive drum 1, by which it is rotated by the photosensitive drum 1.

**[0029]** The developing unit 4 comprises a developing roller 25 which contacts with the photosensitive drum 1 and is rotated in the direction of arrow B, and a developing device frame 31 for supporting the developing roller 25. The developing roller 25 is rotatably supported on the developing device frame 31 through a developing-device-front bearing 12 and a developing-device-rear bearing 13 which are mounted to the respective sides of the developing device frame 31 (Figure 4). A toner supplying roller 34 rotates in the direction of arrow C, contacting to the outer periphery of the developing roller 25. A developing blade 35 regulates the toner layer thereon, contacting to the outer periphery of the developing roller 25. In the toner accommodating portion 31a of the developing device frame 31, the toner feeding member 36 for agitating the contained toner and for feeding the toner to the toner supplying roller 34 is provided.

**[0030]** Figure 3 is an outer appearance perspective view of the process cartridge 7. The developing unit 4 is rotatably mounted to the drum unit 26. A front supporting pin 14 and a rear supporting pin 15 which are press-fitted in the cleaning frame 27 are engaged into the hanging holes 12a and 13a of the developing-device-front bearing 12 and the developing-device-rear bearing 13. By doing so, the developing unit 4 is rotatably supported about the axis of the supporting pins 14 and 15 to the cleaning frame 27 (Figure 2). The cleaning frame 27 is provided with a drum-front bearing 10 and a drum-rear bearing 11

for supporting the photosensitive drum 1 rotatably. The drum-rear bearing 11 supports a drum coupling 16 connected with the photosensitive drum 1. The drum-front bearing 10 supports the flange 85. The drum coupling 16 transmits the rotational driving force (first rotational driving force) to the photosensitive drum 1 from the main assembly 100A of the apparatus.

**[0031]** The developing unit 4 shown in Figure 4 is urged to the drum unit 26 by a pressing spring 38 provided in the developing device frame 31, and a tension spring (unshown) provided in the developing-device-front bearing 12 during the image formation of the process cartridge 7. The developing roller 25 is revolved by the pressing springs 38 and the tension spring 39 about the holes 12a and 13a of the developing-device-front bearing 12 and the developing-device-rear bearing 13, so that it is contacted to the photosensitive drum 1.

**[0032]** In a contact type developing system which effects the development with the contact between the photosensitive drum 1 and the developing roller 25, it is desirable that the photosensitive drum 1 is a rigid member and the developing roller 25 is an elastic member. This elastic member may be a solid rubber monolayer, and it may have the solid rubber layer and a resin material coating thereon in consideration of the charging application property to the toner.

**[0033]** The image forming operation of the process cartridge 7 will be described (Figure 1 and Figure 2). When the image information is supplied to the image forming apparatus 100, the main assembly driving motor (unshown) starts the rotation and the rotational driving forces is transmitted to the photosensitive drum 1, to the developing roller 25, to the toner supplying roller 34, and to the toner feeding member 36. The charging bias voltage is applied to the charging roller 2 from the main assembly 100A of the apparatus to charge electrically the surface of the photosensitive drum 1 uniformly. Corresponding to the image information, the exposure is effected by the scanner unit 3, so that a latent image is formed on the photosensitive drum 1.

**[0034]** The toner in the toner accommodating portion 31a is fed by the rotation of the toner feeding member 36 to the toner supplying roller 34. The toner supplying roller 34 rotates to supply the toner to the outer periphery of the rotating developing roller 25. The supplied toner is triboelectrically charged by the developing blade 35 on the outer periphery of the developing roller 25. The developing bias voltage is applied to the developing roller 25 from the voltage source portion (unshown) provided in the image forming apparatus 100. By doing so, the electrostatic latent image formed on the photosensitive drum 1 is developed. Here, the developing roller 25 is provided opposed to the photosensitive drum 1. The developing roller 25 is contacted to the photosensitive drum 1 and develops the electrostatic latent image formed on the photosensitive drum 1.

(Mechanism for mounting process cartridge to main assembly of image forming apparatus)

**[0035]** Referring to Figure 5, the mounting mechanism, according to this embodiment, for mounting the process cartridge 7 in the apparatus main assembly 100A will be described.

**[0036]** In Figure 5, (a) illustrates a state before the setting, in the apparatus main assembly 100A, of the process cartridge 7. In the state of (a), the process cartridge 7 is mounted in the direction of arrow E through an opening 82a provided in a front side plate 82 of the apparatus main assembly 100A. In that case, a guide portion 27b integrally provided in the cleaning frame 27 of the process cartridge 7 is guided on a main assembly guide member 81 provided in the main assembly 100A of the apparatus. The main assembly guide member 81 is the mounting member for mounting the process cartridge 7 dismountably.

**[0037]** In Figure 5, (b) illustrates the state where the mounting of the process cartridge 7 to the apparatus main assembly 100A is completing. The guiding member 81 provided in the main assembly 100A of the apparatus is provided with an inclined portion 81a inclined upwardly toward downstream with respect to the mounting direction. The cleaning frame 27 is provided with a downwardly inclined portion 27c in an upstream end with respect to the mounting direction. When the process cartridge 7 is mounted to the apparatus main assembly 100A, the guide portion 27b of the cleaning frame 27 rides on the inclined portion 81a, and the inclined portion 27c rides on the main assembly guide portion 81. By doing so, the process cartridge 7 is displaced toward the intermediary transfer unit 5 (upwardly).

**[0038]** In Figure 5, (c) illustrates the state where the process cartridge is mounted to the main assembly 100A of the apparatus. When the mounting operation of the process cartridge 7 is further continued in after the process cartridge 7 moves toward the intermediary transfer unit 5, the abutting portion 27d provided integrally on the cleaning frame 27 contacts to a rear side plate 83 of the apparatus main assembly 100A. By doing so, the mounting of the process cartridge 7 to the image forming apparatus 100 completes.

**[0039]** In this state, a portion-to-be-urged 11a of the drum-rear bearing 11 contacts with the back pressed member 91 provided in the rear side plate 83, so that it is upwardly pushed by the pressing spring 92. And, the cartridge positioning portion 11b provided in the upper position of the drum-rear bearing 11 contacts to the abutting portion 83a, which functions as the main assembly positioning portion, of the rear side plate 83, by which the process cartridge 7 is positioned relative to the apparatus main assembly 100A in the rear side.

**[0040]** In addition, a portion-to-be-pulled 10a of the drum-front bearing 10 engages with the pulling member 93 provided in a front side plate 82. The pulling member 93 is upwardly raised by a tension spring 94 provided on

the front side plate 82, and by doing so, the portion-to-be-pulled 10a is also upwardly raised. And, an abutting portion 10b which is cartridge positioning portion for the drum-front bearing 10 contacts to a positioning portion 82b which is the main assembly positioning portion of the main assembly front side plate 82, so that the process cartridge 7 is positioned relative to the apparatus main assembly 100A in the front side.

**[0041]** As shown in Figure 6, the abutting portion 83a substantially has V configuration, and contacts to the positioning surface 11b of the drum-rear bearing 11. The drum-front bearing 10 is pulled in the direction of Arrow P by the locking with the portion-to-be-pulled 10a of the drum-front bearing 10 of the pulling member 93 provided in the front side plate 82. Relating to positioning, it is contacted to the drum positioning portion 82b which is provided in the front side plate 82 and which has a substantially V configuration, similarly to the case of the drum-rear bearing 11. The pressure required for the positioning, relative to the main assembly 100A of the apparatus, of the drum-front bearing 10 and the drum-rear bearing 11, is applied in the direction of Arrows P and R. Therefore, the process cartridge 7 is positioned, namely the drum-front bearing 10 and the drum-rear bearing 11 which support the photosensitive drum 1 rotatably can be correctly positioned relative to the main assembly 100A of the apparatus. In addition, the cleaning frame 27 is provided with a boss 27g which functions as a rotation stopper for the process cartridge 7 on the side surface, and the boss 27g engages with the rotation stopper receptor member 51 provided in the apparatus main assembly 100A. By doing so, the rotation in the apparatus main assembly 100A of the process cartridge 7 is prevented. For easy understanding of the description, the driving side engaging portion 23 is omitted in Figure 6.

(Structures of developing roller supporting portion and developing drive force input portion in process cartridge)

**[0042]** Referring to Figure 7 - Figure 11, the description will be made about the supporting structure for the structure of the developing drive force input portion, and the developing roller 25 in the process cartridge 7 of this embodiment. Figure 7 illustrates one longitudinal end side (rear side) of the supporting portion of the developing roller 25. In Figure 7, the developing roller shaft 25j of the developing roller 25 is rotatably engaged with the inner surface of the developing-device-rear bearing 13. Between the rubber roller portion 25g of the developing roller 25 and the developing-device-rear bearing 13, a regulation roller 47 for regulating the degree of contact, to the photosensitive drum 1, of the developing roller 25 engages with the developing roller shaft 25j rotatably. Heretofore, the supporting structure by the side of the one longitudinal end of the developing roller 25 is described, but the bearing portion is similarly provided to the bearing member integrally at the other end side in the longitudinal direction to support the other end side of

the developing roller shaft 25j rotatably.

**[0043]** In this embodiment, an Oldham coupling 20 which is a shaft coupling member is used as the developing drive force input portion. Referring to Figure 8 and Figure 9, the structure of the Oldham coupling 20 will be described. For easy understanding of the Oldham coupling 20, the developing-device-rear bearing 13 is omitted, here.

**[0044]** As shown in Figure 8, the Oldham coupling 20 comprises a driven side engaging portion 21, an intermediary engaging portion 22, and a driving side engaging portion 23.

**[0045]** The driven side engaging portion 21 is fixed to the end of the developing roller shaft 25j. As for the fixing method, the spring pin and the parallel pin can be used. In addition, as shown in Figure 8, in an alternative structure, the cut portion 25c is provided on a peripheral surface of the developing roller shaft 25j, and a hole provided in the driven side engaging portion 21 is provided with the complementary configuration. A shaft portion 23b of the driving side engaging portion 23 is rotatably retained in the hole 19a of an engaging portion bearing member 19. The driving side engaging portion 23 is provided integrally with the projections 23c1 to 23c4 engageable with a main assembly development coupling 53 (Figure 11) which is a second main assembly drive transmission member of the main assembly 100A of the apparatus, as will be described hereinafter. This Oldham coupling 20 transmits the rotational driving force (second rotational driving force) from the main assembly 100A of the apparatus to the developing roller 25, permitting the deviation between the axis of the main assembly development coupling 53 and the axis of the developing roller 25.

**[0046]** Referring to sectional view of Figure 9, the Oldham coupling 20 will be described in more detail. Figure 9 (a) is the sectional view taken along the surface perpendicular to the direction of arrow H of Figure 18 and Figure 9 (b) is the sectional view taken along the surface perpendicular to the direction of arrow I in Figure 8.

**[0047]** The driven side engaging portion 21 is provided integrally with a rib 21a as shown in Figure 9 (a). A groove 22a is formed on the intermediary engaging portion 22, and the rib 21a and the groove 22a are engaged with each other in Figure 8 for movement in the direction of arrow H.

**[0048]** The driving side engaging portion 23 is provided integrally with a rib 23a as shown in Figure 9 (b). A groove 22b is formed in the intermediary engaging portion 22, and the rib 23a and the groove 22b are engaged with each other for the movement in the direction of arrow I in Figure 8.

**[0049]** Figure 10 illustrates the structure of the coupling provided in the process cartridge 7. The projections 23c1-23c3 projected toward the axial direction are formed in the end surface of the driving side engaging portion 23 of the Oldham coupling 20 mounted to the developing unit 4. A centering boss 23c4 for alignment (rotation axis) relative to the main assembly development

coupling 53 projects in the direction of the axis from the end surface of the driving side engaging portion 23. The one end side of the axial direction of the photosensitive drum 1 is provided with a drum coupling 16 of a triangular prism configuration. A guide portion 19b of the engaging portion bearing member 19 is guided by the groove 48a of a side cover 48 fixed by an unshown screw and so on to the developing unit 4, for movement in the direction crossing with the axial direction of the developing roller 25. In other words, the driving side engaging portion 23 is movable in the direction crossing with the developing unit 4.

**[0050]** Figure 11 illustrates the structure of the coupling provided in the main assembly 100A of the apparatus. As shown in Figure 11, the drum drive coupling 66 which is the first main assembly drive transmission member for transmitting the driving force of the main assembly 100A of the apparatus to the photosensitive drum 1 is provided with a hole 66a which has the section of substantially triangular shape. The main assembly development coupling 53 which is the second main assembly drive transmission member for transmitting the rotational driving force (second rotational driving force) to the developing roller 25 from the main assembly 100A of the apparatus, is provided with holes 53a-53c. The drum drive coupling 66 is urged by a pressing member 77, such as the compression spring, toward the process cartridge 7. The drum drive coupling 66 is movable in the axial direction of the photosensitive drum. When the phase deviation occurs between the drum coupling 16 and the hole 66a of the drum drive coupling 66 at the time of the mounting, to the main assembly 100A of the apparatus, of the process cartridge 7, the drum drive coupling 66 is pushed and retracted by the drum coupling 16. However, the drum coupling 16 and the hole 66a are brought into engagement with each other by the drum drive coupling 66 rotating, so that the rotational driving force is transmitted to the photosensitive drum 1.

**[0051]** The main assembly development coupling 53 is urged by a pressing member 73, such as a compression spring, toward the process cartridge 7 in the direction parallel with the axial direction of the photosensitive drum 1. However, the main assembly development coupling 53 is mounted to the main assembly 100A of the apparatus without play with respect to the direction crossing with the axial direction. In other words, the main assembly development coupling 53 is movable only in the axial direction except during the rotation for the drive transmission.

**[0052]** When the driving side engaging portion 23 and the main assembly development coupling 53 engage with each other by the entrance in the main assembly 100A of the apparatus of the process cartridge 7, a phase deviation may occur between the projections 23c1 to 23c3 and the holes 53a-53c. In this case, the free ends of the projections 23c1 to 23c3 abut at the positions other than the holes 53a-53c, and the main assembly development coupling 53 retracts in the axial direction against the urg-

ing force of the pressed member 73. However, when the main assembly development coupling 53 rotates and the phases between projections 23c1 - 23c3 and the holes 53a-53c align with each other, the main assembly development coupling 53 is advanced by the urging force of the pressing member 73. The projections 23c1 to 23c3 and the holes 53a-53c are brought into the engagement with each other, so that the centering boss 23c4 which is the engaging portion positioning portion and the centering hole 53e which is transmission member positioning portion are engaged with each other. The axis (rotation axis) of the driving side engaging portion 23 and the main assembly development coupling 53 are aligned. The projections 23c1 to 23c3 and the holes 53a-53c are engaged with each other by the main assembly development coupling 53 rotating, so that the rotational driving force is transmitted to the developing roller 25.

**[0053]** Here, the driving force to the drum drive coupling 66 and to the main assembly development coupling 53 is supplied from a motor provided in the main assembly 100A of the apparatus. One motor may be provided for each of the process cartridges, or commonly for a plurality of the process cartridges.

(Operation of Oldham coupling at the time of development separation-contact operation in process cartridge)

**[0054]** Referring to Figure 12 - Figure 15, the operation of the Oldham coupling in the process cartridge 7 of this embodiment will be described.

**[0055]** Figure 12 is a side view which illustrates the state before the process cartridge 7 is mounted to the image forming apparatus 100 main assembly, and Figure 13 is a longitudinal sectional view thereof.

**[0056]** As shown in Figure 12, as mentioned above, before the process cartridge 7 is mounted to the main assembly 100A of the apparatus, the developing roller 25 and the photosensitive drum 1 are in abutment to each other. An arm portion 18a of an urging member 18 which is a torsion coil spring provided on the side cover 48, is in abutment to the locking portion 19c of the engaging portion bearing member 19. By doing so, the driving side engaging portion 23 is urged in the direction (the direction of arrow Q in Figure 13) crossing with the axial direction of the developing roller 25. Therefore, the contact portion 19d of the engaging portion bearing member 19 is contacted to the contact portion 11c which is the holding portion provided in the drum-rear bearing 11, and the engaging portion bearing member 19 is positioned. More particularly, the driving side engaging portion 23 is positioned in the constant position. Here, the contact portion 11c of the drum-rear bearing 11 is formed by the two surfaces which are in parallel with the axis of the photosensitive drum 1 and which constitute the shape of V. The engaging portion bearing member 19 can be retained in parallel with the axis 1c of the photosensitive drum 1 by contacting the engaging portion bearing member 19 to this contact portion 11c. In addition, the drum-

rear bearing 11 is provided integrally with a positioning portion 11b. Therefore, the driving side engaging portion 23 rotatably supported by the engaging portion bearing member 19 is positioned with high precision relative to the rear side plate 83 of the apparatus main assembly 100A which positions the positioning portion 11b. Therefore, it is positioned with high precision also relative to the axis 53d of the main assembly development coupling 53 provided in the apparatus main assembly 100A. The driving side engaging portion 23 of the Oldham coupling 20 is rotatably engaged with the engaging portion bearing member 19. For this reason, although the axis 23c5 of the driving side engaging portion 23 of the Oldham coupling 20 is separated from the axis 25k of the developing roller 25 by the distance d3 in this state, they are very close to each other. More particularly, the driving side engaging portion 23 is in the positioning position, such that the engagement with the main assembly development coupling 53 is smooth at the time of the entrance of the process cartridge 7 to the main assembly 100A of the apparatus. Although the member which urges the engaging portion bearing member 19 is the urging member 18 in this embodiment, the engaging portion bearing member 19 may be provided with the elastically deformable elastic portion, so that the engaging portion bearing member 19 is contacted to the contact portion 11c.

**[0057]** The still more detailed description will be made referring to Figure 13 here. When the driving side engaging portion 23 engages with the main assembly development coupling 53 and it rotates, the driving side engaging portion 23 is positioned by the main assembly development coupling 53 as will be described hereinafter. By this, the contact portion 19b of the engaging portion bearing member 19 spaces from the drum-rear bearing 11 i.e. the contact portion 11c. Therefore, when the process cartridge 7 enters the main assembly 100A of the apparatus, the axis 23c5 of the driving side engaging portion 23 begins the engagement in the state of being deviated from axis 53d of the main assembly development coupling 53 to the photosensitive drum 1 side by a predetermined distance d3. The process cartridge further enters from this state, by which the bevelled portion 23c6 (Figure 10) provided in the centering boss 23c4 and 53f (Figure 11) of bevelled portions provided in the hole 53e contact with each other, and they engage with each other, correcting the axial deviation. At this time, the driving side engaging portion 23 is positioned by the contact portion 11c with high precision relative to the main assembly 100A of the apparatus. Therefore, it is positioned with high precision relative to the main assembly development coupling 53 provided in the apparatus main assembly 100A. Therefore, there is no need of upsizing extremely the bevelled portion 23c6 and the bevelled portion 53f, and the driving side engaging portion 23 and the main assembly development coupling 53 can be downsized. As shown in Figure 15, when the main assembly development coupling 53 rotates and the phases of the projections 23c1 to 23c3 of the driving side engaging portion

23 and the holes 53a-53c of the main assembly development coupling 53 align, the boss 23c4 and the hole 53e engage with each other. By this, the rotation axis 23c of the driving side engaging portion 23 and the rotation axis 53d of the main assembly development coupling 53 align with each other.

**[0058]** Figure 14 illustrates the state where the process cartridge is mounted to the main assembly 100A of the apparatus. Figure 15 is a longitudinal sectional view. The driving side engaging portion 23 of the Oldham coupling 20 in the process cartridge 7 and the main assembly development coupling 53 of the apparatus main assembly 100A are engaged with each other in an unshown the main assembly 100A of the apparatus. More particularly, the driving side engaging portion 23 of the Oldham coupling 20 is positioned in the main assembly development coupling 53 by the engagement with the boss 23c4 and the hole 53e. As shown in Figure 15, the driving side engaging portion 23 and the main assembly development coupling 53 are locked with each other with the gap 80 between the engaging portion bearing member 19 and the drum-rear bearing 11. The axis 25k of the developing roller, the axis 23c5 of the driving side engaging portion 23, and the axis 53d of the main assembly development coupling 53 are substantially aligned. The distances from the respective drum axis 1c are d4.

**[0059]** In the above described embodiment, the rotational driving force is directly inputted to the developing roller 25 through the coupling 22 from the main assembly development coupling 53 rotated independently of the drum drive coupling 66 for inputting the rotational driving force to the photosensitive drum 1. Therefore, the influence of the rotation of the developing roller 25 to the rotational accuracy of the photosensitive drum 1 is suppressed, and furthermore, the rotational accuracy of the developing roller 25 per se is improved, and therefore, the image quality is improved.

**[0060]** In addition, the driving side engaging portion 23 of the Oldham coupling 20 is positioned relative to the cartridge 7, and it is movable in the direction crossing with the axis 25k of the developing roller 25, and therefore, the main assembly development coupling 53 and the driving side engaging portion 23 can engage without using the large guide (space-saving) and so on. Therefore, the process cartridge 7 and the image forming apparatus 100 can be downsized. In addition, the mounting operativity of the process cartridge 7 to the main assembly 100A of the apparatus is improved.

## Embodiment 2

**[0061]** In the first embodiment, the engaging portion bearing member 19 is urged to the drum-rear bearing 10 which supports the photosensitive drum 1. As shown in Figure 16, however, the contact portion 27f which is the holding portion contactable to the engaging portion bearing member 19 may be provided in the cleaning frame 27.

**[0062]** Figure 16 illustrates the state before the process

cartridge 7 is mounted to the main assembly 100A of the apparatus. As has been described with respect to Embodiment 1, the arm portion 18a of the urging member 18 which is provided on the side cover 48 and which is a twisted coil spring contacts to the locking portion 19c of the engaging portion bearing member 19. By this, the driving side engaging portion 23 is urged in the direction crossing with the axial direction of the developing roller 25. Therefore, the contact portion 19d of the engaging portion bearing member 19 is contacted to the contact portion 27f provided in the cleaning frame 27, so that the engaging portion bearing member 19 is positioned in place. The contact portion 27f of the cleaning frame 27 is formed by two surfaces which are in parallel with the axis of the photosensitive drum 1 and which constitute V configuration. The cleaning frame 27 is provided with the drum-rear bearing 11, and the drum-rear bearing 11 is provided integrally with positioning portion 11b. Therefore, the driving side engaging portion 23 rotatably supported by the engaging portion bearing member 19 is positioned with high precision relative to the rotation axis of the photosensitive drum 1 and the main assembly 100A of the apparatus. For this reason, it can be positioned with high precision relative to the axis 53d of the main assembly development coupling 53 provided in the main assembly 100A of the apparatus. The other structures are the same as that of those of the first embodiment, and the effects similar to the effects of the first embodiment are provided.

#### Embodiment 3

**[0063]** Although the Oldham coupling is used as the shaft coupling member in the first embodiment, a spring which is the elastic portion may be used as the intermediary engaging portion 22 of the shaft coupling member 20 as shown in Figure 17, in the process cartridge which includes the developing roller which has a small diameter.

**[0064]** In Figure 17, the shaft coupling member 20 comprises a driven side engaging portion 21, an intermediary engaging portion 22, and a driving side engaging portion 23. The intermediary engaging portion includes a spring 22. The driven side engaging portion 21 is provided with a boss 21a for the engagement of the spring 22. Similarly, the driving side engaging portion 23 is provided with a boss 23a which engages with the spring 22. The spring 22 is provided with an arm portion 22a engaged with the driven side engaging portion boss 21a, and an arm portion 22b engaged with the driving side engaging portion boss 23a. The shaft portion 23b of the driving side engaging portion 23 is rotatably engaged with the hole 19a of the engaging portion bearing member 19. The driving side engaging portion 23 is provided integrally with the projections 23c1 - 23c4 engaged with the main assembly development coupling 53 which is the second main assembly drive transmission member of the main assembly 100A of the apparatus. Similarly to embodi-

ment 1, when the drive of the main assembly 100A of the apparatus is transmitted to the driving side engaging portion 23, the drive is transmitted to the arm portion 22b of the spring 22 from the development side coupling boss 23a. The rotational driving force transmitted to the spring 22 is transmitted to the boss 21a of the follow-engaging portion 21 from the arm portion 22a of the spring 22.

**[0065]** As shown in Figure 18, although the spring 22 is used as the intermediary engaging portion in this embodiment, an elastic rubber 22 of the cylindrical-shape may be used as the elastic portion. The inside circumference of the elastic rubber 22 is provided with a rib 22a for transmitting the driving force by the engagement with the boss 23a of the driving side engaging portion 23 and with the boss 21a of the driven side engaging portion 21.

**[0066]** The other structures are the same as that of those of the first embodiment, and the effects similar to the effects of the first embodiment are provided.

#### Embodiment 4

**[0067]** In the first embodiment, the engaging portion bearing member 19 is urged to the drum-rear bearing 10 which supports the photosensitive drum 1 by the urging spring 18. As shown in Figure 19 (a), in this embodiment, the drum-rear bearing 11 is provided with a hole 11f which is the holding portion for retaining driving side engaging portion 23. An inner diameter of the hole 11f is large as compared with the outer diameter of the driving side engaging portion 23. More particularly, the driving side engaging portion 23 is retained for movement in the direction crossing with the axis of the developing roller 25 relative to the hole 11f. As shown in Figure 18, in embodiment 1, the driving side engaging portion 23 is positioned through the engaging portion bearing member 19 with the deviation relative to the axis 53d of the main assembly development coupling 53 in the direction of positioning relative to the drum-rear bearing 11. In this embodiment, the structure is such that the axis 23c5 of the driving side engaging portion 23 deviates to whichever direction with respect to the direction crossing with the axis of the developing roller 25. For this reason, also when the process cartridge 7 enters the main assembly 100A of the apparatus, the driving side engaging portion 23 is smooth in the engagement with the main assembly development coupling 53. Figure 19 (b) illustrates the state where the driving side engaging portion 23 is positioned by the main assembly development coupling (unshown). In more detail, the driving side engaging portion 23 is positioned by the main assembly development coupling (unshown), by which it is in the state of not contacting the hole 11f.

**[0068]** As shown in Figure 20, the hole 27f for retaining the driving side engaging portion 23 may be provided in the cleaning frame 27.

**[0069]** The other structures are the same as that of those of the first embodiment, and provide the effects similar to the effects of the first embodiment.

## Other Examples

**[0070]** In The above described embodiment, although the four process cartridges are used, this number is not inevitable but may be selected suitably, if necessary, by one-skilled-in-the-art.

**[0071]** In the embodiments mentioned above, although the image forming apparatus is the type of printer, the present invention is not limited to this. For example, it is applicable also to other image forming apparatuses, such as the copying machine and the facsimile device, and the image forming apparatuses, such as a composite machine thereof. In addition, although the intermediary transfer member is used in the embodiment mentioned above, the color toner images are superimposedly transferred onto the intermediary transfer member sequentially and the toner images carried by the intermediary transfer member are transferred onto the transfer material all together, the present invention is not limited to this type. For example, in an alternative structure, the recording material carrying member is used and the color toner images are superimposedly transferred onto the recording material carried by the recording material carrying member sequentially. The similar effects are provided when the present invention is applied to these types of image forming apparatuses.

**[0072]** As has been described hereinbefore, according to the present invention, the large guide for the engagement with the engaging portion and the second main assembly drive transmission member is unnecessary. Accordingly, the process cartridge and the electrophotographic image forming apparatus are downsized. Furthermore, the engaging portion and the second main assembly drive transmission member of the shaft coupling member engage with each other smoothly, and therefore, the mounting property is improved.

**[0073]** In addition, the rotational accuracy of the developing roller can be improved, and therefore, the image quality can be improved.

## [INDUSTRIAL APPLICABILITY]

**[0074]** According to the present invention, it is possible to provide a process cartridge and a small size electrophotographic image forming apparatus wherein a rotational driving force is directly inputted to the developing roller through the shaft coupling member from the main assembly of the apparatus independently from the driving input to the photosensitive drum.

**[0075]** It is also possible to provide a process cartridge and an image forming apparatus wherein the rotational accuracy of the developing roller is improved, so that the image quality is improved.

While the invention has been described with reference to the structures disclosed herein, it is not confined to the details set forth, and this application is intended to cover modifications or changes within the scope of the following claims.

## Claims

1. A process cartridge (7) detachably mountable to a main assembly of an electrophotographic image forming apparatus, wherein the main assembly includes a first rotatable main assembly drive transmission member (66), and a second rotatable main assembly drive transmission member (53), said process cartridge (7) comprising:

an electrophotographic photosensitive drum (1); a developing roller (25) for developing an electrostatic latent image formed on said electrophotographic photosensitive drum (1) with a developer;

a drum coupling member (16), provided on one axial end of said electrophotographic photosensitive drum (1), for engaging with the first main assembly drive transmission member (66) and transmitting a first rotational driving force to the electrophotographic photosensitive drum (1), when said process cartridge (7) is mounted to the main assembly of the apparatus along an axial direction of said electrophotographic photosensitive drum (1); and

a shaft coupling member (20), provided on one axial end of said developing roller (25), for transmitting a second rotational driving force with a deviation permitted between an axis of the second main assembly drive transmission member (53) and an axis of said developing roller (25), wherein said shaft coupling member (20) includes an engaging portion (23) for engaging with the second main assembly drive transmission member (53) and receiving the second rotational driving force, when said process cartridge (7) is mounted to the main assembly of the apparatus;

**characterized in that**

said process cartridge further comprises a holding portion (11c, 27f) provided on a frame (26, 4) of said process cartridge (7) and

said engaging portion (23) is configured to be movable in a direction crossing with the axial direction of said developing roller (25) when said process cartridge (7) enters said main assembly of the apparatus, and wherein

said engaging portion (23) is configured to be positioned to said holding portion (11c, 27f) by being urged in the crossing direction when said process cartridge (7) enters the main assembly of the apparatus.

2. A process cartridge according to Claim 1, wherein said frame (26, 4) includes a drum bearing (11) for supporting rotatably said electrophotographic photosensitive drum (1).

3. A process cartridge according to Claim 2, wherein said holding portion (11c) is provided on said drum bearing (11).
4. A process cartridge according to Claim 2 or 3, wherein said drum bearing (11) is provided with a cartridge positioning portion (11b) for positioning said process cartridge (7) by contacting a main assembly positioning portion (83a) provided in the main assembly of the apparatus.
5. A process cartridge according to any one of Claims 1 to 4, wherein said frame (26, 4) includes:
- a first frame (26) for holding said electrophotographic photosensitive drum (1), and  
a second frame (4) for holding said developing roller (25).
6. A process cartridge according to claim 5, wherein said holding portion (11c, 27f) is provided on said first frame (26).
7. A process cartridge according to any one of Claims 1 to 6, wherein said process cartridge (7) includes an urging member (18) for urging said engaging portion (23) in the crossing direction.
8. A process cartridge according to any one of Claims 1 to 7, wherein said engaging portion (23) includes an engaging portion positioning portion (23c4) for engaging with the second main assembly drive transmission member (53) to be positioned by the second main assembly drive transmission member (53) when the second main assembly drive transmission member (53) rotates.
9. A process cartridge according to any one of Claims 1 to 8, wherein said process cartridge (7) includes an engaging portion bearing member (19) which is movable in the crossing direction relative to the axis of said developing roller (25) and which supports rotatably said engaging portion (23), and said engaging portion (23) is positioned to said holding portion (11c) through said engaging portion bearing member (19).
10. A process cartridge according to any one of Claims 1 to 9, wherein said shaft coupling member (20) is an Oldham coupling.
11. A process cartridge according to any one of Claims 1 to 10, wherein said shaft coupling member (20) includes an elastic portion for permitting a deviation between an axis of said engaging portion (23) and the axis of said developing roller (25).
12. A process cartridge according to any one of Claims 1 to 11, wherein an axis of said engaging portion (23) is deviated from the axis of said developing roller (25) in the crossing direction when said process cartridge (7) enters the main assembly of the apparatus.
13. An electrophotographic image forming apparatus for forming an image on a recording material, comprising:
- (i) a rotatable first main assembly drive transmission member (66) and a rotatable second main assembly drive transmission member (53);  
(ii) a process cartridge (7) according to any of the preceding Claims and  
(iii) feeding means (54, 76, 55, 56, 57, 58, 59, 70, 72) for feeding a recording material (S).
14. An apparatus according to Claim 13, further comprising a main assembly positioning portion for positioning said process cartridge (7) by engaging with a drum bearing (11) having said holding portion (11c) for supporting rotatably said electrophotographic photosensitive drum (1).
15. An apparatus according to Claim 13 or 14, wherein the second main assembly drive transmission member (53) is provided with a hole (53a-53c) for transmitting the second rotational driving force, wherein said hole (53a-53c) is engaged with a projection (23c1-23c3) provided on said engaging portion (23) when the second main assembly drive transmission member (53) is engaged with said engaging portion (23), and wherein the second main assembly drive transmission member (23) is urged toward said process cartridge (7) by an urging member (73) provided in said main assembly of the apparatus.
16. An apparatus according to any one of Claims 13 to 15, wherein the second main assembly drive transmission member (53) has a transmission member positioning portion (53e) engageable with said engaging portion (23) to position said engaging portion (23) when the second main assembly drive transmission member (53) rotates.

#### Patentansprüche

1. Prozesskartusche (7), die an einer Hauptbaugruppe einer elektrofotografischen Bilderzeugungsvorrichtung abnehmbar montiert ist, wobei die Hauptbaugruppe ein erstes drehbares Hauptbaugruppenantriebsübertragungsbauteil (66) und ein zweites drehbares Hauptbaugruppenantriebsübertragungsbauteil (53) enthält, wobei die Prozesskartusche (7) Folgendes aufweist:

eine elektrofotografische lichtempfindliche

- Trommel (1);  
eine Entwicklungswalze (25) zum Entwickeln eines elektrostatischen latenten Bildes, das an der elektrofotografischen lichtempfindlichen Trommel (1) mit einem Entwickler ausgebildet ist;  
ein Trommelkupplungsbauteil (16), das an einem axialen Ende der elektrofotografischen lichtempfindlichen Trommel (1) vorgesehen ist, zum Eingreifen mit dem ersten Hauptbaugruppenantriebübertragungsbauteil (66) und Übertragen einer ersten Rotationsantriebskraft auf die elektrofotografische lichtempfindliche Trommel (1), wenn die Prozesskartusche (7) an der Hauptbaugruppe der Vorrichtung entlang einer axialen Richtung der elektrofotografischen lichtempfindlichen Trommel (1) montiert ist; und ein Wellenkupplungsbauteil (20), das an einem axialen Ende der Entwicklungswalze (25) vorgesehen ist, zum Übertragen einer zweiten Rotationsantriebskraft mit einer Abweichung, die zwischen einer Achse des zweiten Hauptbaugruppenantriebübertragungsbauteils (53) und einer Achse der Entwicklungswalze (25) zugelassen ist, wobei das Wellenkupplungsbauteil (20) einen Eingriffsabschnitt (23) zum Eingreifen mit dem zweiten Hauptbaugruppenantriebübertragungsbauteil (53) und Aufnehmen der zweiten Rotationsantriebskraft enthält, wenn die Prozesskartusche (7) an der Hauptbaugruppe der Vorrichtung montiert ist;  
**dadurch gekennzeichnet, dass**  
die Prozesskartusche des Weiteren einen Halteabschnitt (11c, 27f) aufweist, der an einem Rahmen (26, 4) der Prozesskartusche (7) vorgesehen ist, und der Eingriffsabschnitt (23) gestaltet ist, um in eine Richtung, die mit der Axialrichtung der Entwicklungswalze (25) kreuzt, beweglich zu sein, wenn die Prozesskartusche (7) in die Hauptbaugruppe der Vorrichtung eintritt, und wobei der Eingriffsabschnitt (23) gestaltet ist, um an dem Halteabschnitt (11c, 47f) durch ein Gedrängt werden in die Kreuzungsrichtung positioniert zu sein, wenn die Prozesskartusche (7) in die Hauptbaugruppe der Vorrichtung eintritt.
2. Prozesskartusche gemäß Anspruch 1, wobei der Rahmen (26, 4) ein Trommellager (11) zum drehbaren Stützen der elektrofotografischen lichtempfindlichen Trommel (1) enthält.
  3. Prozesskartusche gemäß Anspruch 2, wobei der Halteabschnitt (11c) an dem Trommellager (11) vorgesehen ist.
  4. Prozesskartusche gemäß Anspruch 2 oder 3, wobei das Trommellager (11) mit einem Kartuschenpositionierungsabschnitt (11b) zum Positionieren der Prozesskartusche (7) durch Berühren eines Hauptbaugruppenpositionierungsabschnitts (83a), der in der Hauptbaugruppe der Vorrichtung vorgesehen ist, versehen ist.
  5. Prozesskartusche gemäß einem der Ansprüche 1 bis 4, wobei der Rahmen (26, 4) folgendes enthält:
    - einen ersten Rahmen (26) zum Halten der elektrofotografisch fotografischen lichtempfindlichen Trommel (1), und
    - einen zweiten Rahmen (4) zum Halten der Entwicklungswalze (25).
  6. Prozesskartusche gemäß Anspruch 5, wobei der Halteabschnitt (11c, 27f) an dem ersten Rahmen (26) vorgesehen ist.
  7. Prozesskartusche gemäß einem der Ansprüche 1 bis 6, wobei die Prozesskartusche (7) ein Drängbauteil (18) zum Drängen des Eingriffsabschnitts (23) in die Kreuzungsrichtung enthält.
  8. Prozesskartusche gemäß einem der Ansprüche 1 bis 7, wobei der Eingriffsabschnitt (23) einen Eingriffsabschnittpositionierungsabschnitt (23c4) zum Eingreifen mit dem zweiten Hauptbaugruppenantriebübertragungsbauteil (53) enthält, um durch das zweite Hauptbaugruppenantriebübertragungsbauteil (53) positioniert zu werden, wenn das zweite Hauptbaugruppenantriebübertragungsbauteil (53) rotiert.
  9. Prozesskartusche gemäß einem der Ansprüche 1 bis 8, wobei die Prozesskartusche (7) ein Eingriffsabschnittlagerbauteil (19) enthält, das in der Kreuzungsrichtung bezüglich der Achse der Entwicklungswalze (25) beweglich ist und das den Eingriffsabschnitt (23) drehbar stützt, und der Eingriffsabschnitt (23) an dem Halteabschnitt (11c) durch das Eingriffsabschnittlagerbauteil (19) positioniert ist.
  10. Prozesskartusche gemäß einem der Ansprüche 1 bis 9, wobei das Wellenkupplungsbauteil (20) eine Oldham-Kupplung ist.
  11. Prozesskartusche gemäß einem der Ansprüche 1 bis 10, wobei das Wellenkupplungsbauteil (20) einen elastischen Abschnitt enthält, um eine Abweichung zwischen einer Achse des Eingriffsabschnitts (23) und der Achse der Entwicklungswalze (25) zuzulassen.
  12. Prozesskartusche gemäß einem der Ansprüche 1 bis 11, wobei eine Achse des Eingriffsabschnitts (23)

von der Achse der Entwicklungswalze (25) in der Kreuzungsrichtung abweicht, wenn die Prozesskartusche (7) in die Hauptbaugruppe der Vorrichtung eintritt.

13. Elektrofotografische Bilderzeugungsvorrichtung zum Ausbilden eines Bildes auf ein Aufzeichnungsmaterial, die Folgendes aufweist:

- (i) ein drehbares erstes Hauptbaugruppenantriebübertragungsbauteil (66) und ein drehbares zweites Hauptbaugruppenantriebübertragungsbauteil (53);
- (ii) eine Prozesskartusche (7) gemäß einem der vorhergehenden Ansprüche;
- (iii) ein Zufuhrmittel (54, 76, 55, 56, 57, 58, 59, 70, 72) zum Zuführen eines Aufzeichnungsmaterials (S).

14. Vorrichtung gemäß Anspruch 13, des Weiteren mit einem Hauptbaugruppenpositionierungsabschnitt zum Positionieren der Prozesskartusche (7) durch Eingreifen mit einem Trommellager (11), das den Halteabschnitt (11c) zum drehbaren Stützen der elektrofotografischen lichtempfindlichen Trommel (1) hat.

15. Vorrichtung gemäß Anspruch 13 oder 14, wobei das zweite Hauptbaugruppenantriebübertragungsbauteil (53) mit einem Loch (53a-53c) zum Übertragen der zweiten Rotationsantriebskraft versehen ist, wobei das Loch (53a-53c) mit einem Vorsprung (23c1-23c3), der an dem Eingriffsabschnitt (23) vorgesehen ist, im Eingriff ist, wenn das zweite Hauptbaugruppenantriebübertragungsbauteil (53) mit dem Eingriffsabschnitt (23) im Eingriff ist, und wobei das zweite Hauptbaugruppenantriebübertragungsbauteil (23) in Richtung der Prozesskartusche (7) durch ein Drängbauteil (73), das in der Hauptbaugruppe der Vorrichtung vorgesehen ist, gedrängt wird.

16. Vorrichtung gemäß einem der Ansprüche 13 bis 15, wobei das zweite Hauptbaugruppenantriebübertragungsbauteil (53) einen Übertragungsbauteilpositionierungsabschnitt (53e) hat, der mit dem Eingriffsabschnitt (23) eingreifen kann, um den Eingriffsabschnitt (23) zu positionieren, wenn das zweite Hauptbaugruppenantriebübertragungsbauteil (53) rotiert.

## Revendications

1. Cartouche de traitement (7) montée de manière détachable sur un ensemble principal d'un appareil de formation d'image électrophotographique, où l'ensemble principal comporte un premier élément rotatif

de transmission d'entraînement d'ensemble principal (66), et un deuxième élément rotatif de transmission d'entraînement d'ensemble principal (53), ladite cartouche de traitement (7) comprenant :

- un tambour photosensible électrophotographique (1) ;
- un rouleau de développement (25) pour développer une image latente électrostatique formée sur ledit tambour photosensible électrophotographique (1) avec un développateur ;
- un élément de couplage de tambour (16), prévu sur une extrémité axiale dudit tambour photosensible électrophotographique (1), pour s'engager avec le premier élément de transmission d'entraînement d'ensemble principal (66) et transmettre une première force d'entraînement en rotation au tambour photosensible électrophotographique (1), lorsque ladite cartouche de traitement (7) est montée sur l'ensemble principal de l'appareil le long d'une direction axiale dudit tambour photosensible électrophotographique (1) ; et
- un élément de couplage d'arbre (20), prévu sur une extrémité axiale dudit rouleau de développement (25), pour transmettre une deuxième force d'entraînement en rotation avec une déviation autorisée entre un axe du deuxième élément de transmission d'entraînement d'ensemble principal (53) et un axe dudit rouleau de développement (25), où ledit élément de couplage d'arbre (20) comporte une partie d'engagement (23) pour s'engager avec le deuxième élément de transmission d'entraînement d'ensemble principal (53) et recevoir la deuxième force d'entraînement en rotation, lorsque ladite cartouche de traitement (7) est montée sur l'ensemble principal de l'appareil ;

## caractérisée en ce que :

ladite cartouche de traitement comprend en outre une partie de maintien (11c, 27f) prévue sur un cadre (26, 4) de ladite cartouche de traitement (7), et ladite partie d'engagement (23) est configurée pour être mobile dans une direction croisant la direction axiale dudit rouleau de développement (25) lorsque ladite cartouche de traitement (7) entre dans ledit ensemble principal de l'appareil, et où ladite partie d'engagement (23) est configurée pour être positionnée sur ladite partie de maintien (11c, 27f) en étant poussée dans la direction de croisement lorsque ladite cartouche de traitement (7) entre dans l'ensemble principal de l'appareil.

2. Cartouche de traitement selon la revendication 1, dans laquelle ledit cadre (26, 4) comporte un support de tambour (11) pour supporter en rotation ledit tambour photosensible électrophotographique (1).
3. Cartouche de traitement selon la revendication 2, dans laquelle ladite partie de maintien (11c) est prévue sur ledit support de tambour (11).
4. Cartouche de traitement selon la revendication 2 ou 3, dans laquelle ledit support de tambour (11) est pourvu d'une partie de positionnement de cartouche (11b) pour positionner ladite cartouche de traitement (7) par contact avec une partie de positionnement d'ensemble principal (83a) prévue dans l'ensemble principal de l'appareil.
5. Cartouche de traitement selon l'une quelconque des revendications 1 à 4, dans laquelle ledit cadre (26, 4) comporte :
- un premier cadre (26) pour maintenir ledit tambour photosensible électrophotographique (1), et
- un deuxième cadre (4) pour maintenir ledit rouleau de développement (25).
6. Cartouche de traitement selon la revendication 5, dans laquelle ladite partie de maintien (11c, 27f) est prévue sur ledit premier cadre (26).
7. Cartouche de traitement selon l'une quelconque des revendications 1 à 6, dans laquelle ladite cartouche de traitement (7) comporte un élément de poussée (18) pour pousser ladite partie d'engagement (23) dans la direction de croisement.
8. Cartouche de traitement selon l'une quelconque des revendications 1 à 7, dans laquelle ladite partie d'engagement (23) comporte une partie de positionnement de partie d'engagement (23c4) pour s'engager avec le deuxième élément de transmission d'entraînement d'ensemble principal (53) pour être positionnée par le deuxième élément de transmission d'entraînement d'ensemble principal (53) lorsque le deuxième élément de transmission d'entraînement d'ensemble principal (53) tourne.
9. Cartouche de traitement selon l'une quelconque des revendications 1 à 8, dans laquelle ladite cartouche de traitement (7) comporte un élément de support de partie d'engagement (19) qui est mobile dans la direction de croisement par rapport à l'axe dudit rouleau de développement (25) et qui supporte en rotation ladite partie d'engagement (23), et ladite partie d'engagement (23) est positionnée sur ladite partie de maintien (11c) par l'intermédiaire dudit élément de support de partie d'engagement (19).
10. Cartouche de traitement selon l'une quelconque des revendications 1 à 9, dans laquelle ledit élément de couplage d'arbre (20) est un accouplement Oldham.
11. Cartouche de traitement selon l'une quelconque des revendications 1 à 10, dans laquelle ledit élément de couplage d'arbre (20) comporte une partie élastique pour permettre une déviation entre un axe de ladite partie d'engagement (23) et l'axe dudit rouleau de développement (25).
12. Cartouche de traitement selon l'une quelconque des revendications 1 à 11, dans laquelle un axe de ladite partie d'engagement (23) est dévié de l'axe dudit rouleau de développement (25) dans la direction de croisement lorsque ladite cartouche de traitement (7) entre dans l'ensemble principal de l'appareil.
13. Appareil de formation d'image électrophotographique pour former une image sur un matériau d'enregistrement, comprenant :
- (i) un premier élément rotatif de transmission d'entraînement d'ensemble principal (66) et un deuxième élément rotatif de transmission d'entraînement d'ensemble principal (53) ;
- (ii) une cartouche de traitement (7) selon l'une des revendications précédentes ; et
- (iii) un moyen d'alimentation (54, 76, 55, 56, 57, 58, 59, 70, 72) pour l'alimentation en matériau d'enregistrement (S).
14. Appareil selon la revendication 13, comprenant en outre une partie de positionnement d'ensemble principal pour positionner ladite cartouche de traitement (7) par engagement avec un support de tambour (11) ayant ladite partie de maintien (11c) pour supporter en rotation ledit tambour photosensible électrophotographique (1).
15. Appareil selon la revendication 13 ou 14, dans lequel le deuxième élément de transmission d'entraînement d'ensemble principal (53) est pourvu d'un trou (53a-53c) pour transmettre la deuxième force d'entraînement en rotation, où ledit trou (53a-53c) est engagé avec une saillie (23c1-23c3) prévue sur ladite partie d'engagement (23) lorsque le deuxième élément de transmission d'entraînement d'ensemble principal (53) est engagé avec ladite partie d'engagement (23), et où le deuxième élément de transmission d'entraînement d'ensemble principal (23) est poussé vers ladite cartouche de traitement (7) par un élément de poussée (73) prévu dans ledit ensemble principal de l'appareil.
16. Appareil selon l'une quelconque des revendications 13 à 15, dans lequel le deuxième élément de transmission d'entraînement d'ensemble principal (53) a

une partie de positionnement d'élément de transmission (53e) pouvant s'engager avec ladite partie d'engagement (23) pour positionner ladite partie d'engagement (23) lorsque le deuxième élément de transmission d'entraînement d'ensemble principal (53) tourne. 5

10

15

20

25

30

35

40

45

50

55

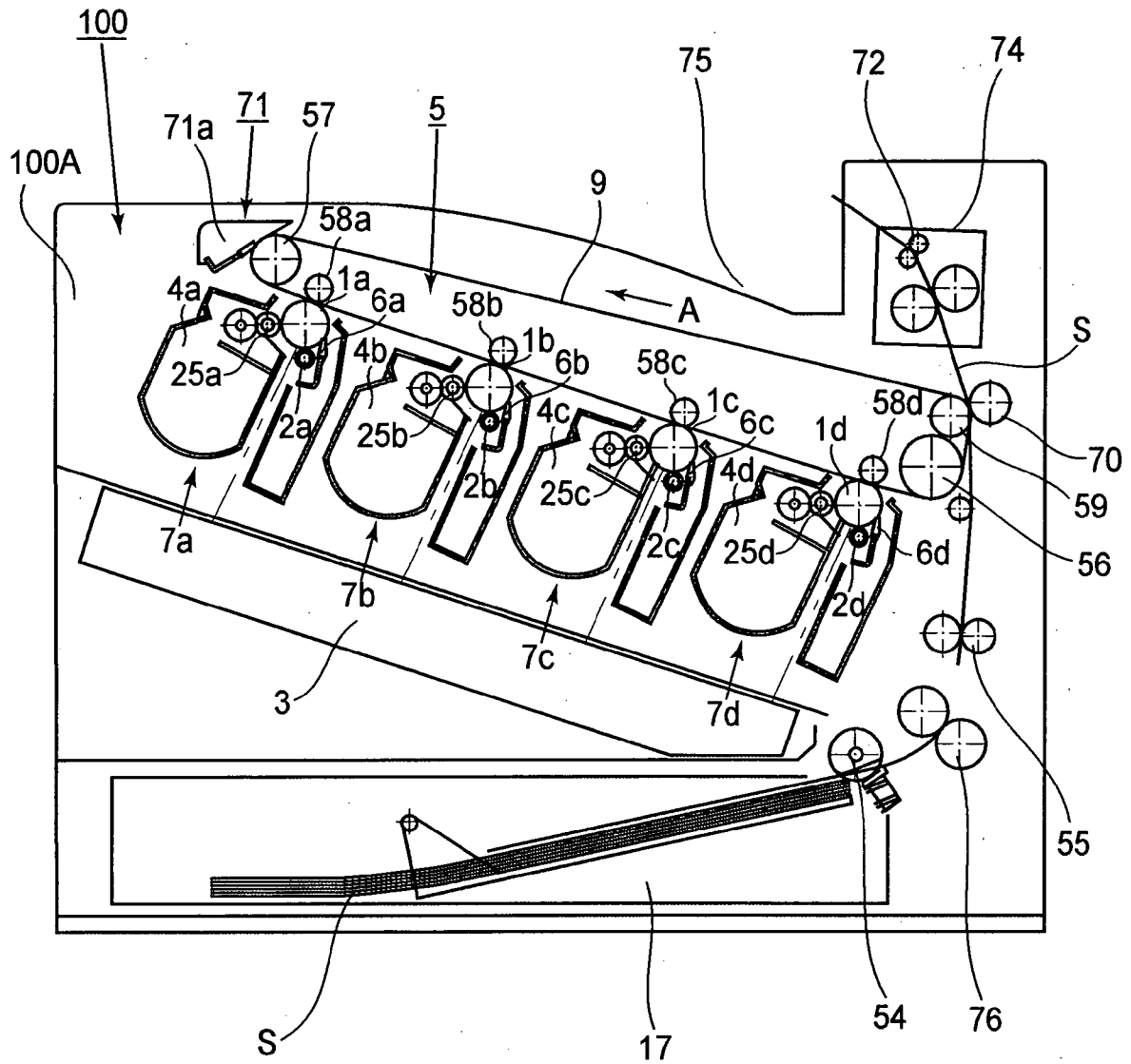

FIG. 1

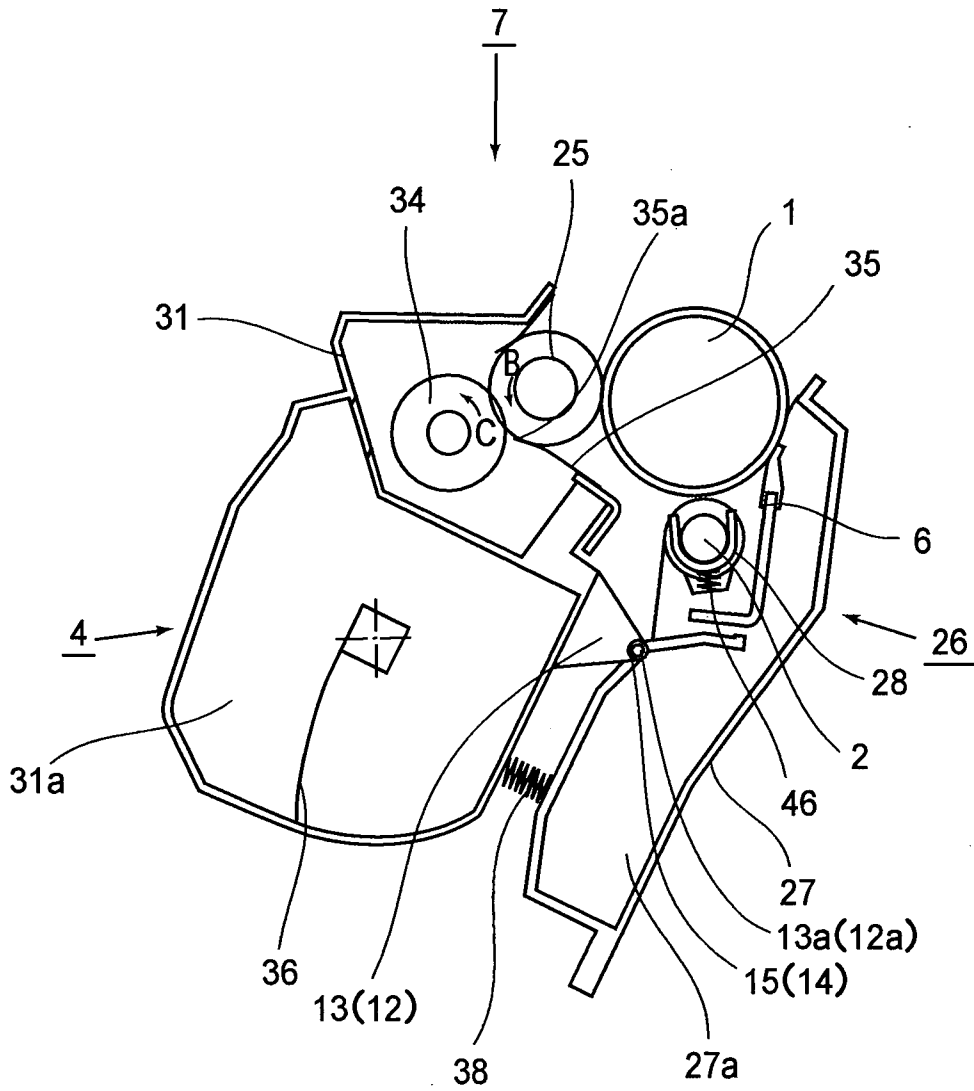
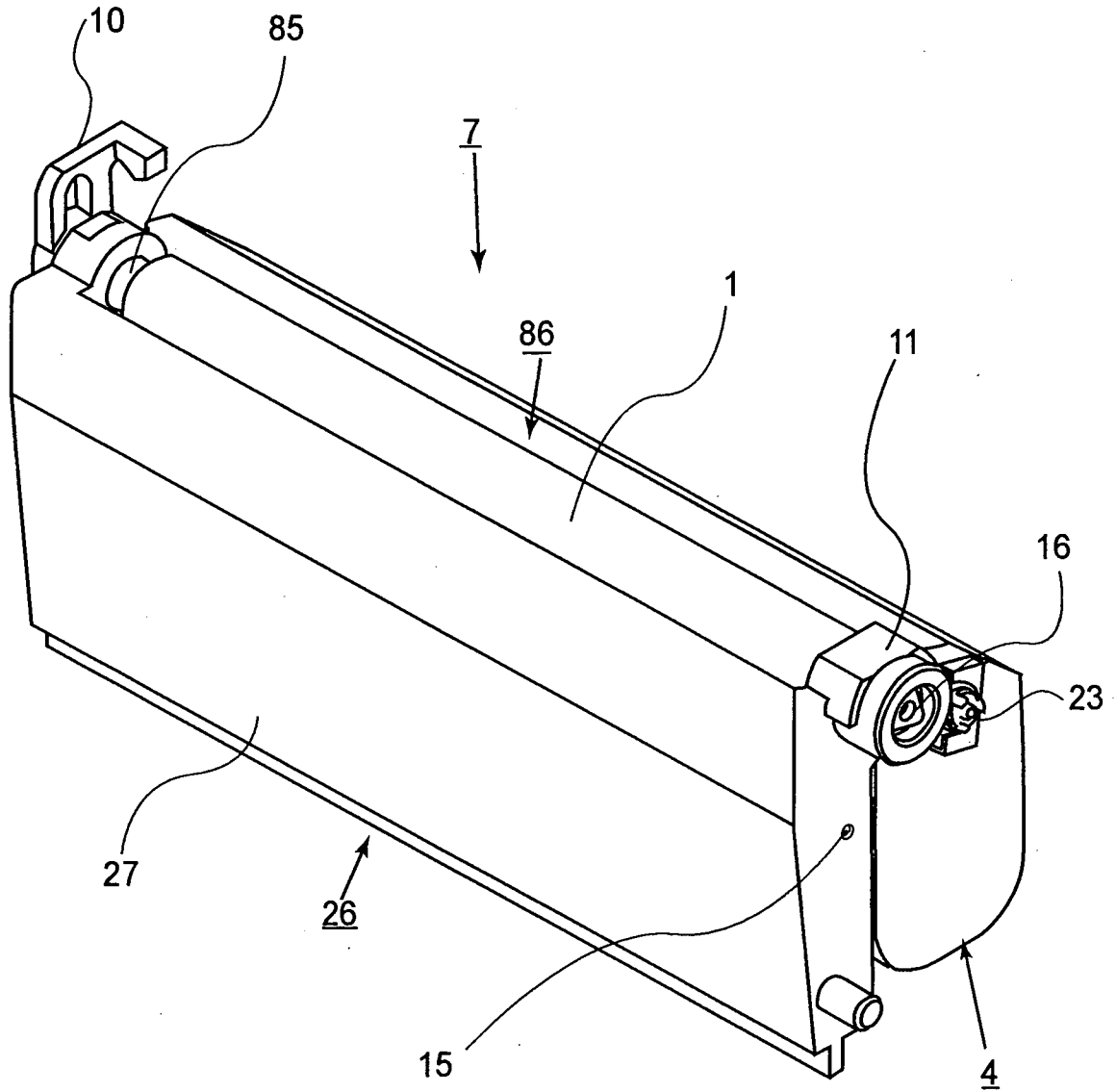
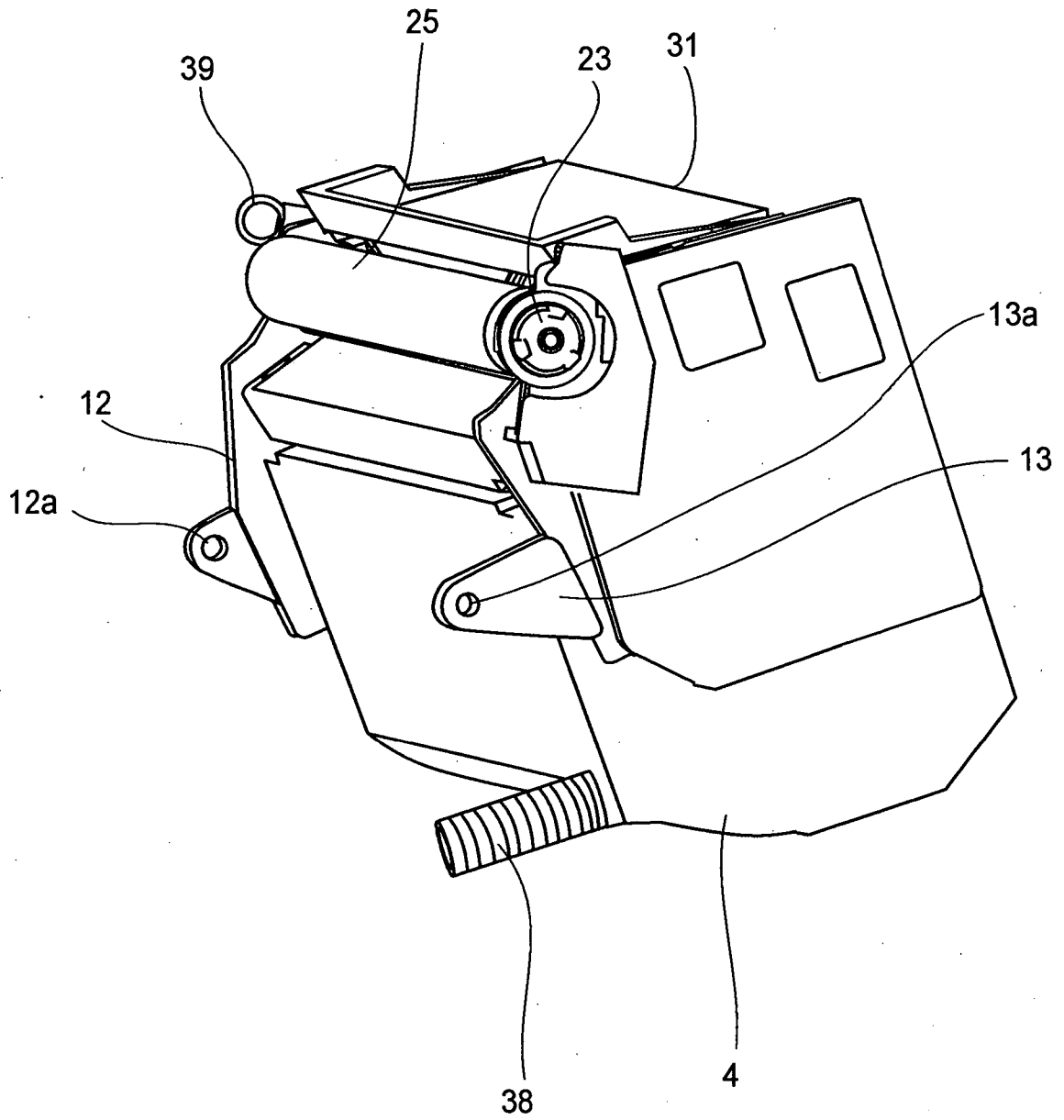

FIG.2



**FIG. 3**



**FIG. 4**

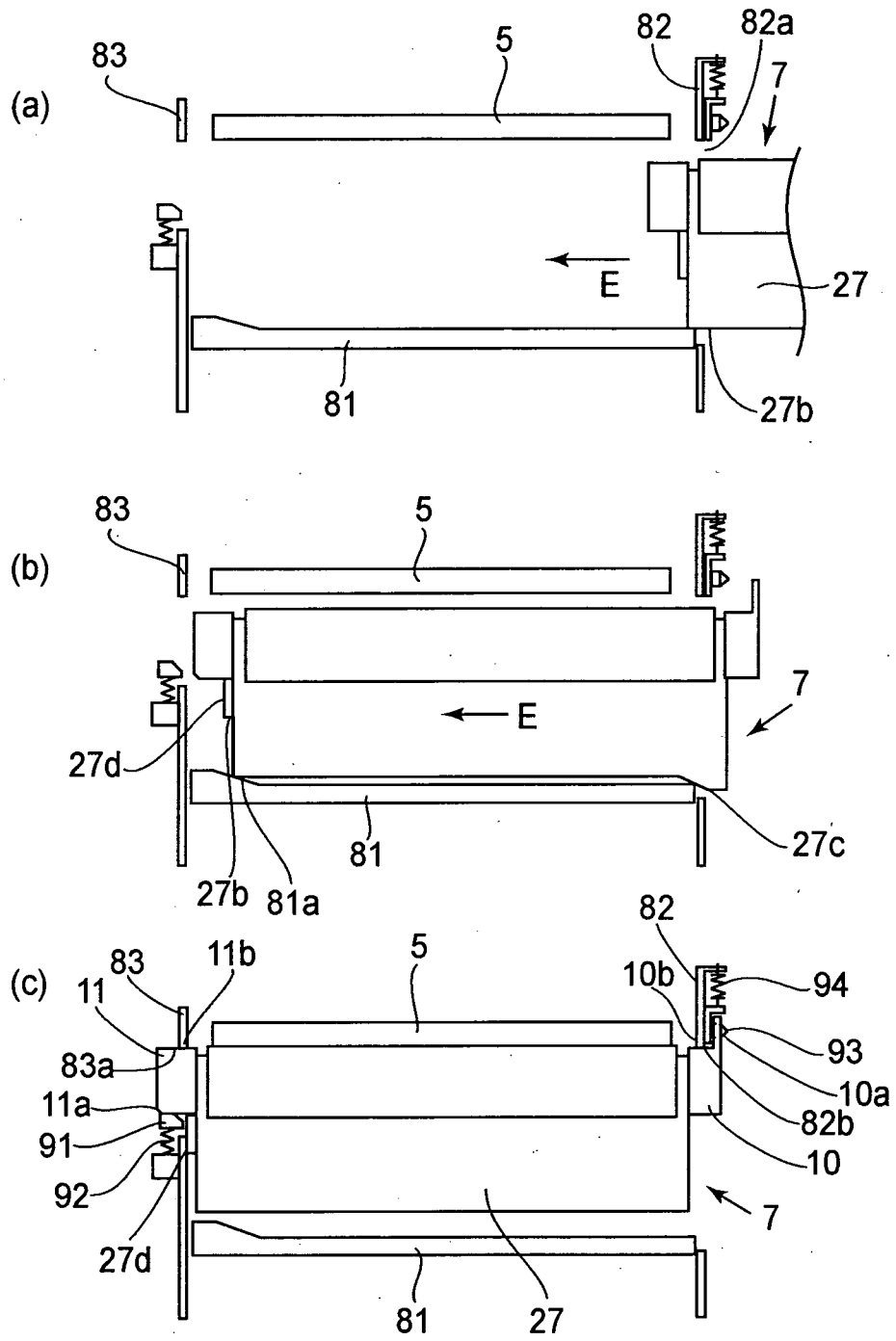

FIG. 5

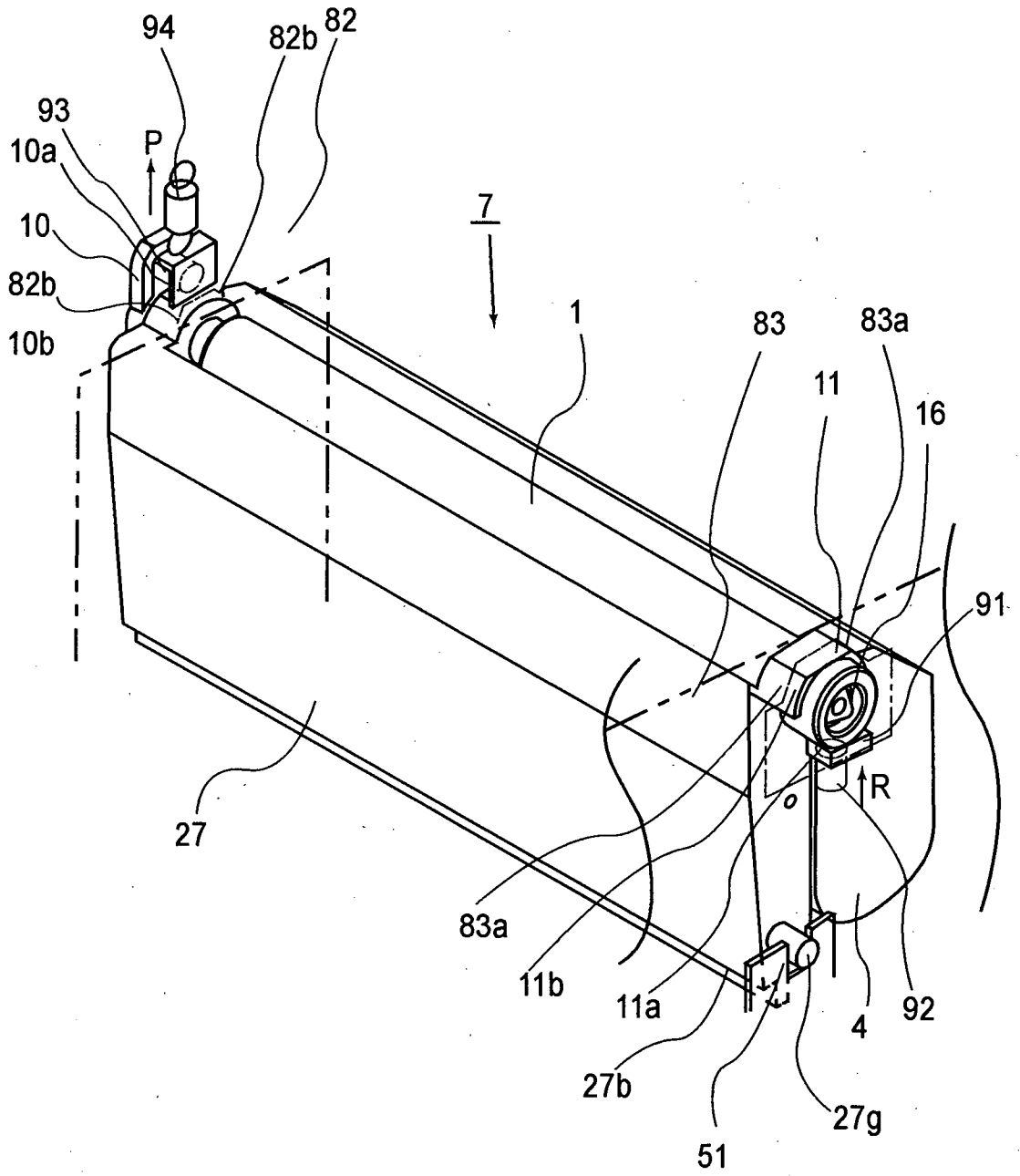
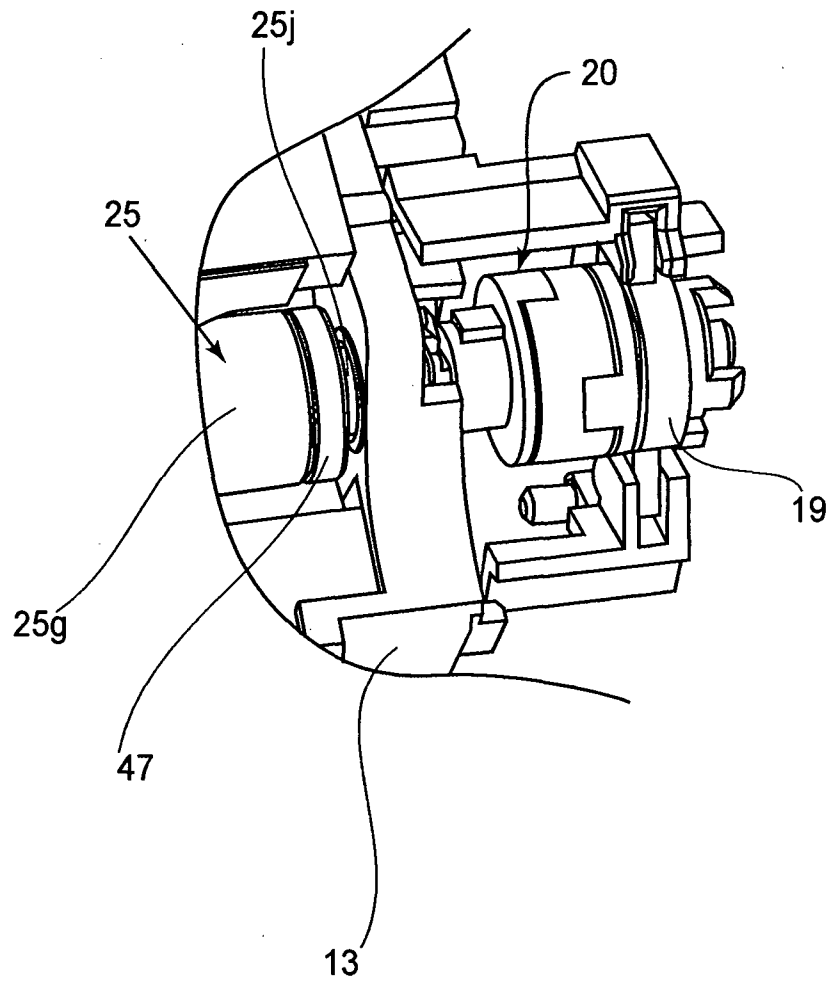

FIG. 6



**FIG. 7**

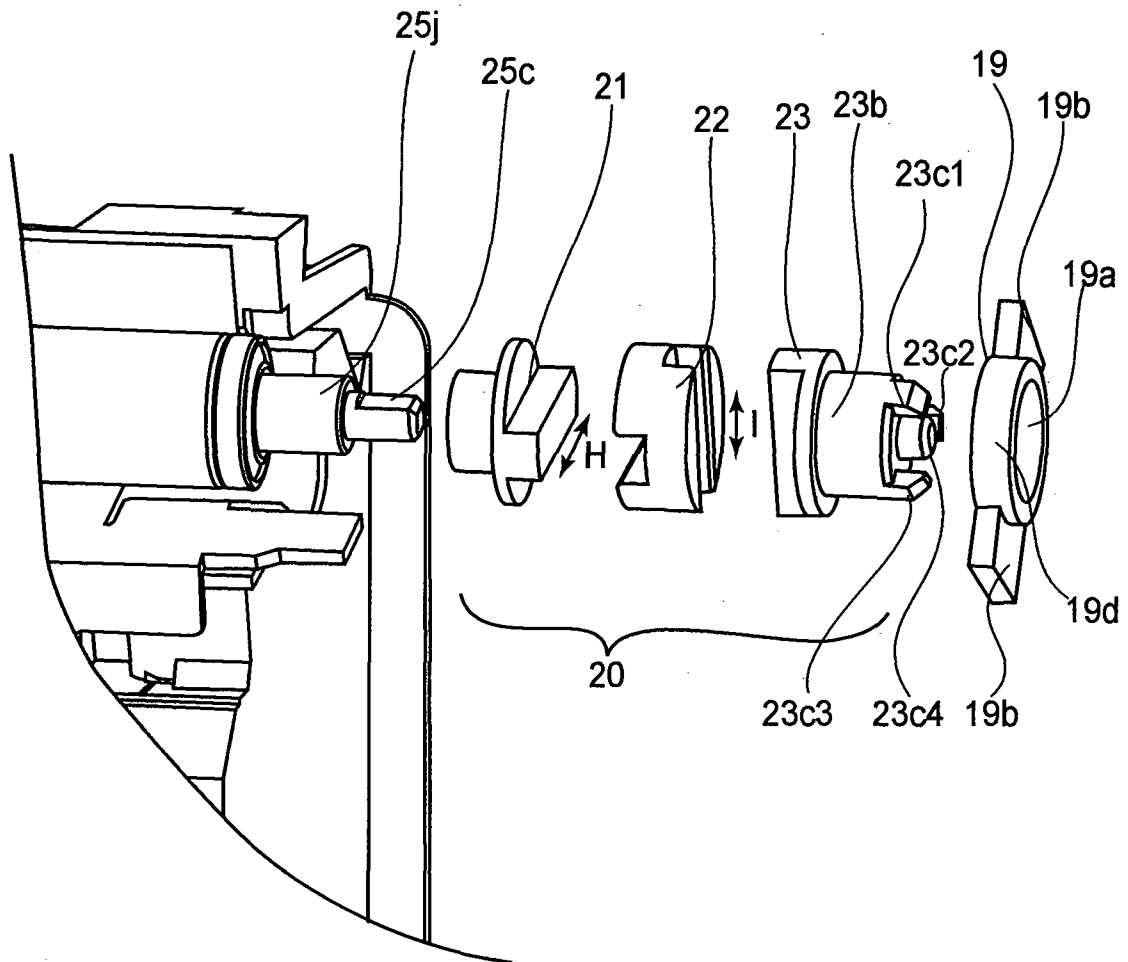
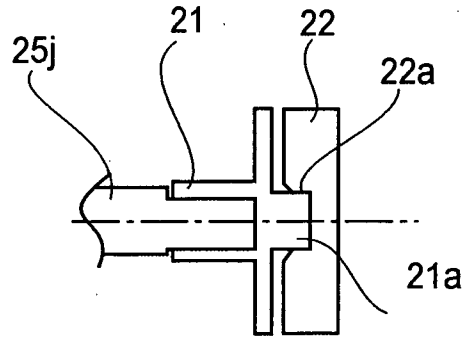
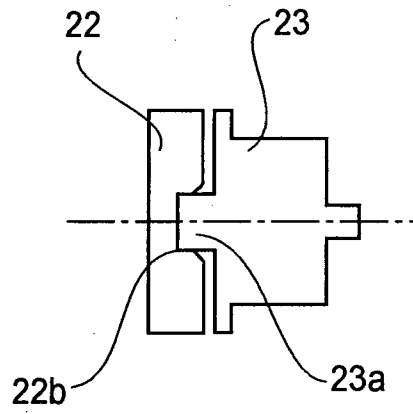

FIG. 8

(a)



(b)



**FIG. 9**

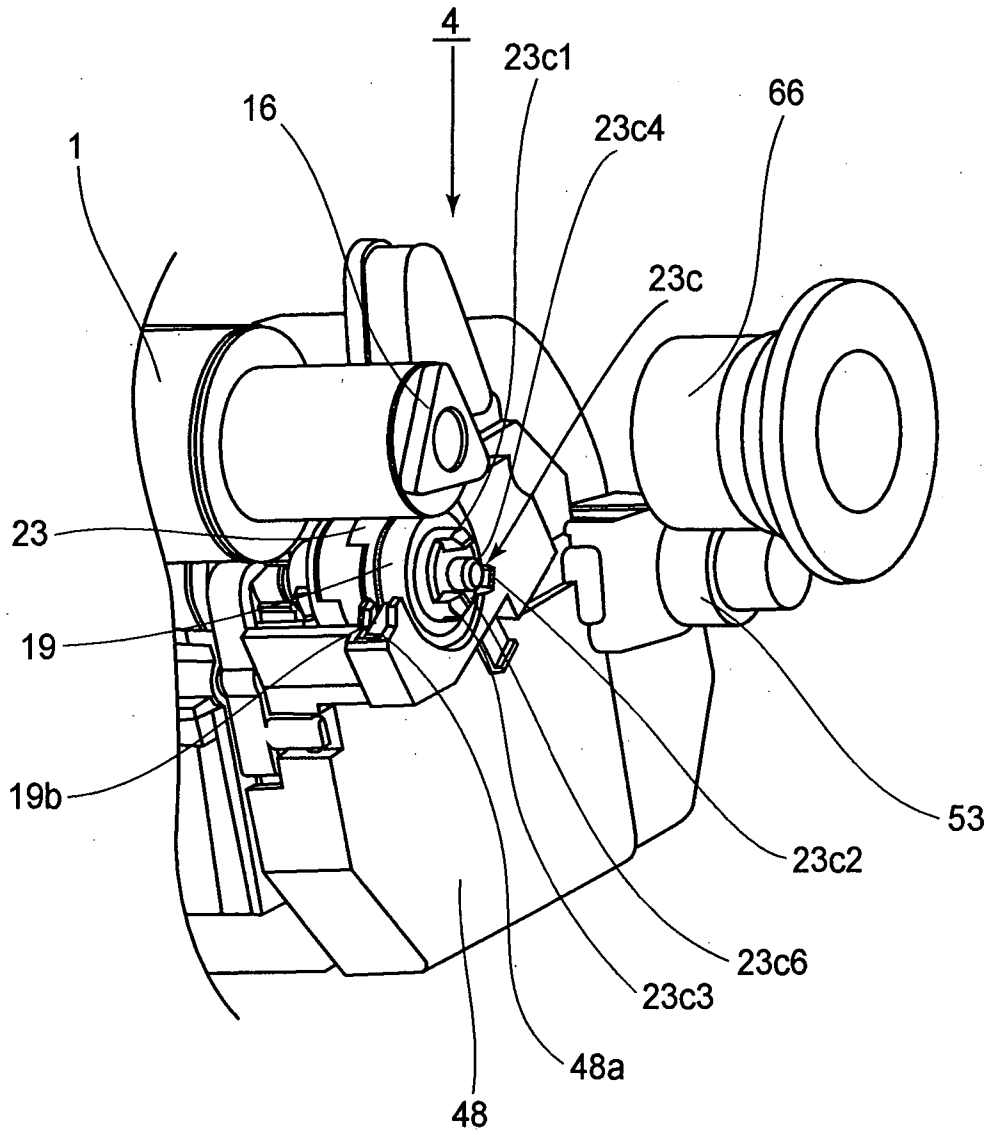

**FIG.10**

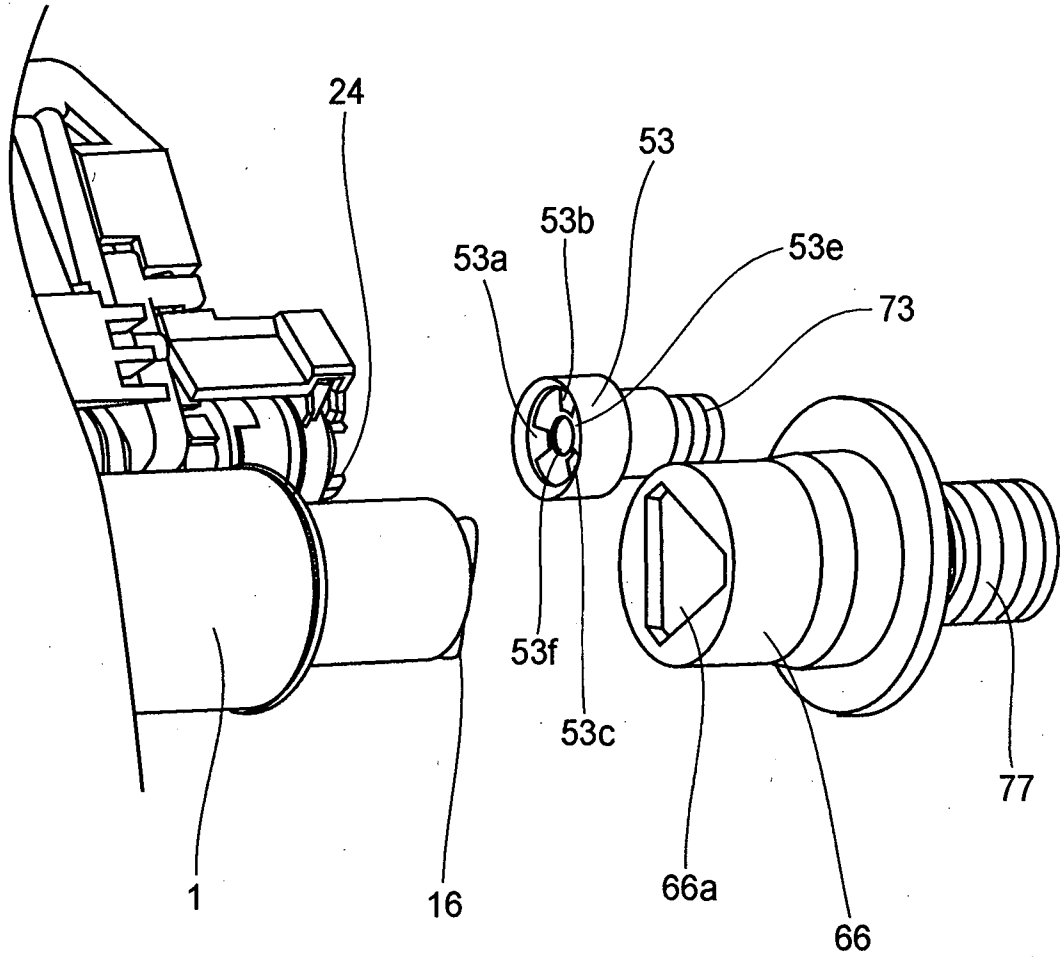

**FIG. 11**

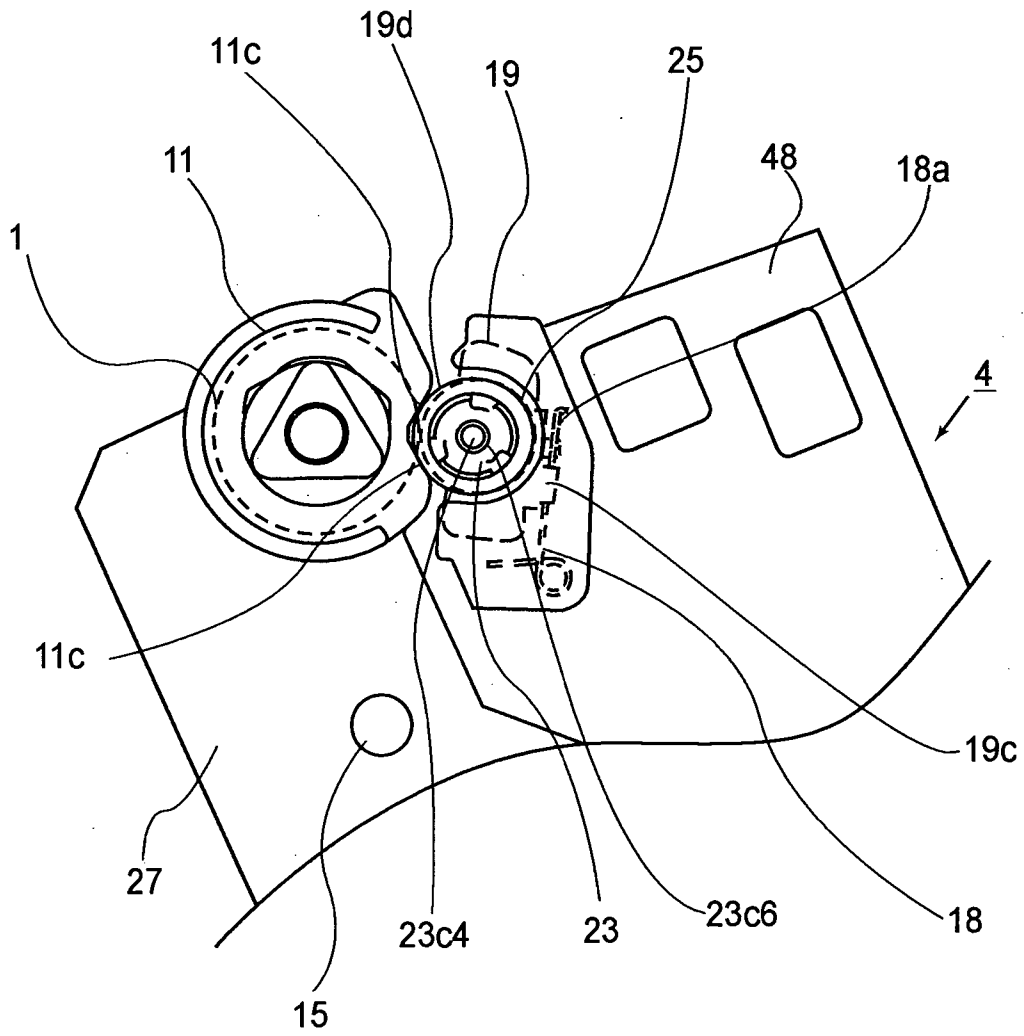

**FIG. 12**

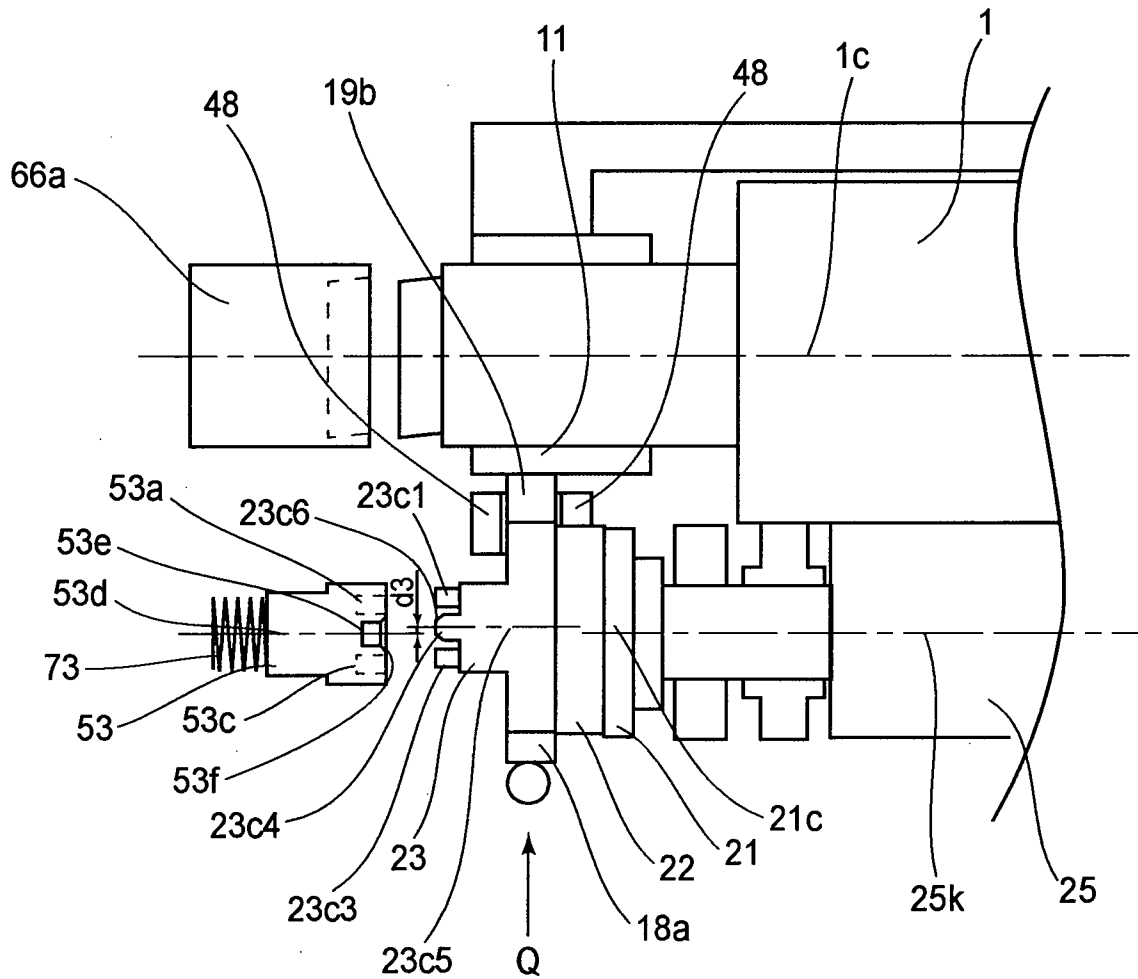
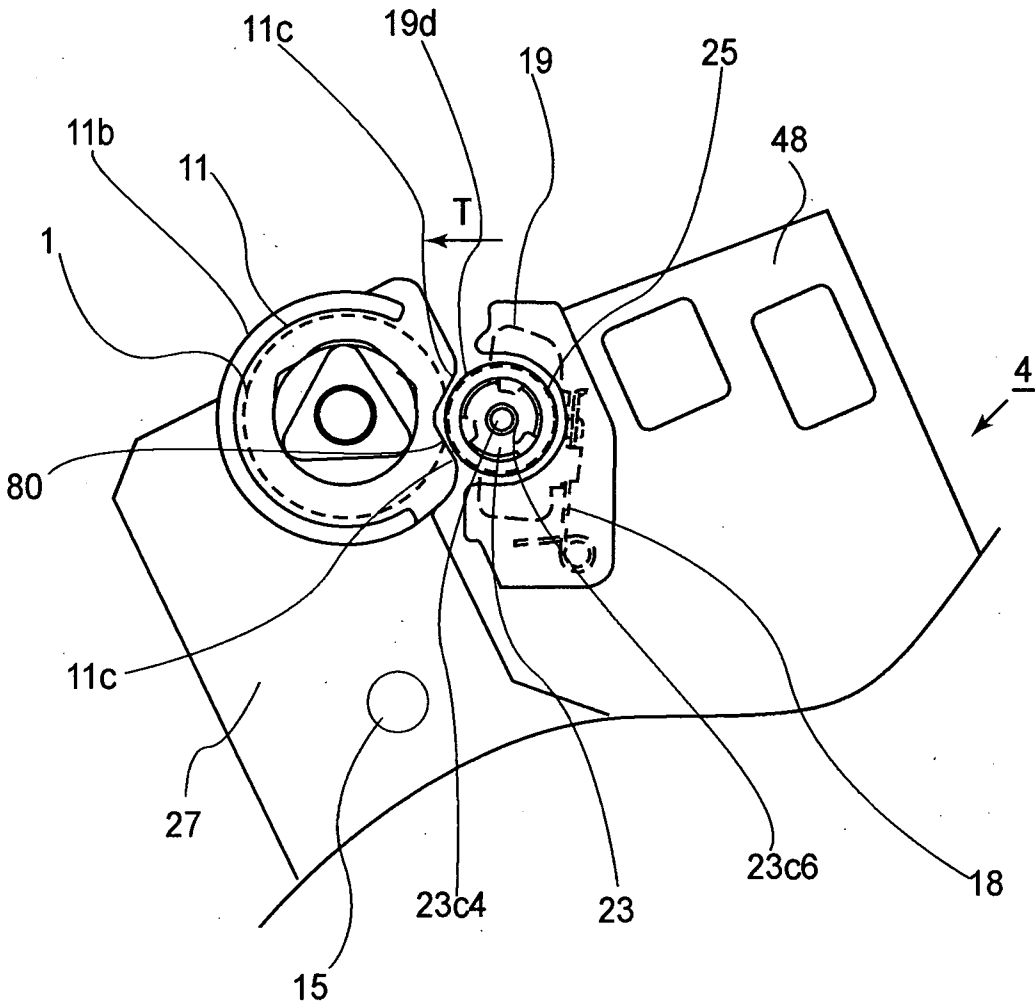

FIG. 13



**FIG.14**

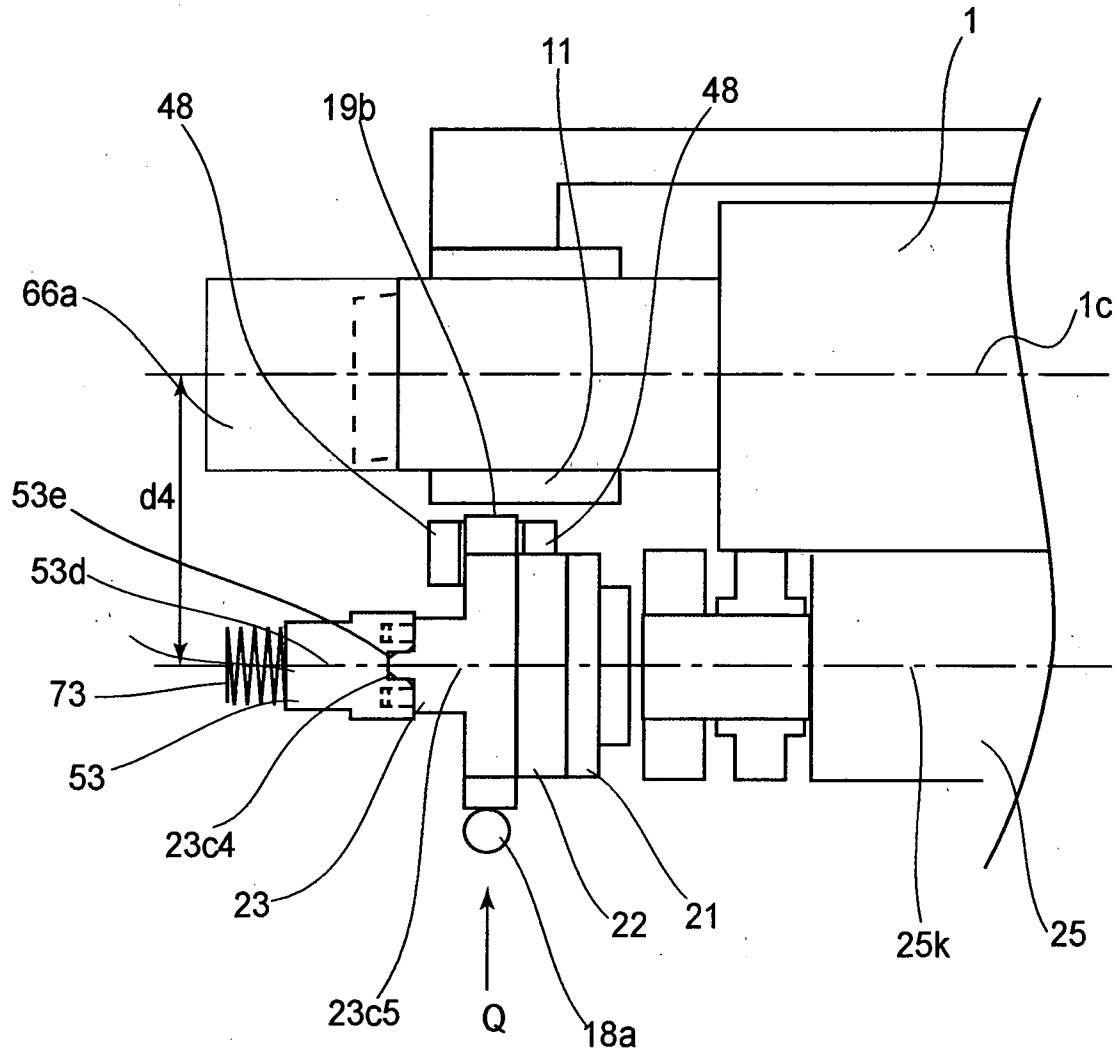

FIG. 15

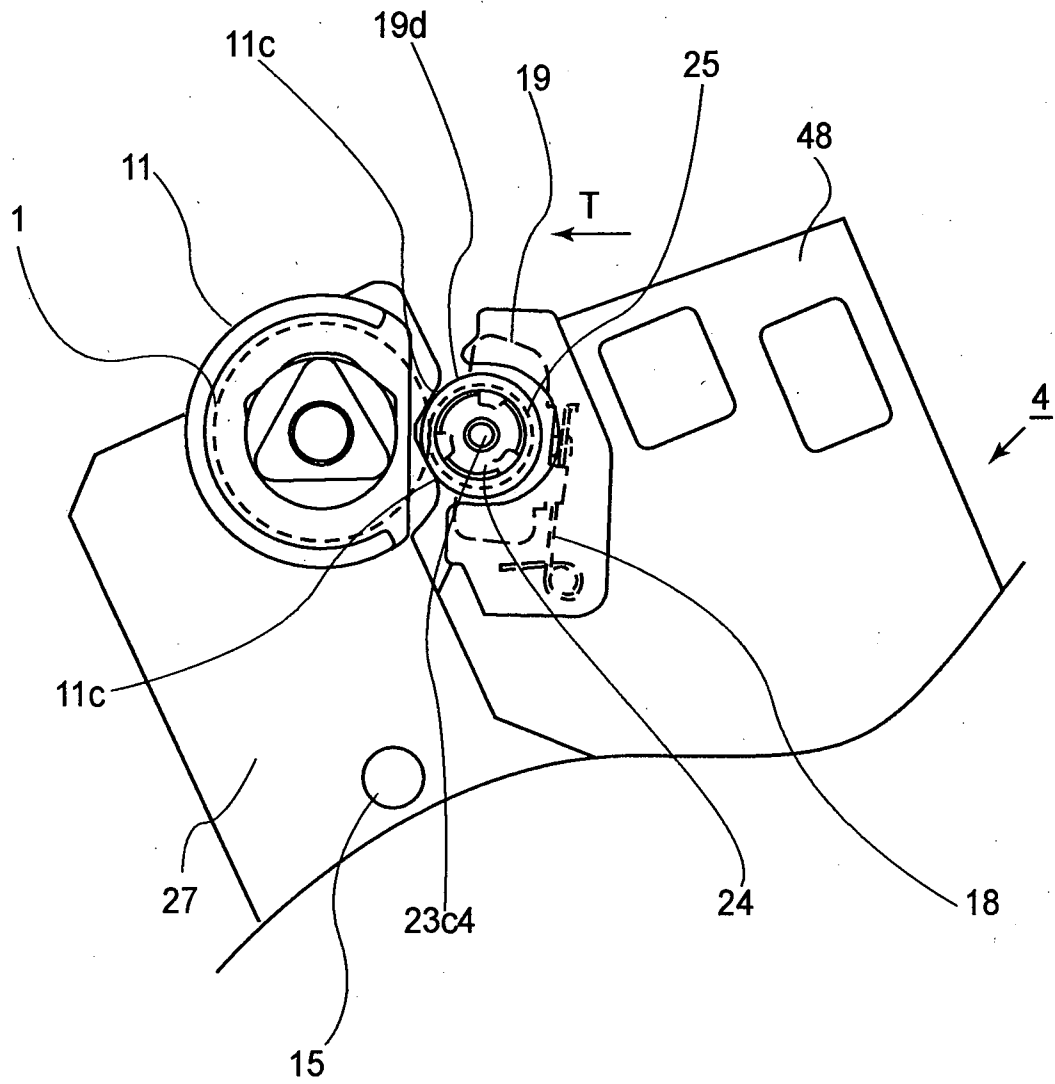
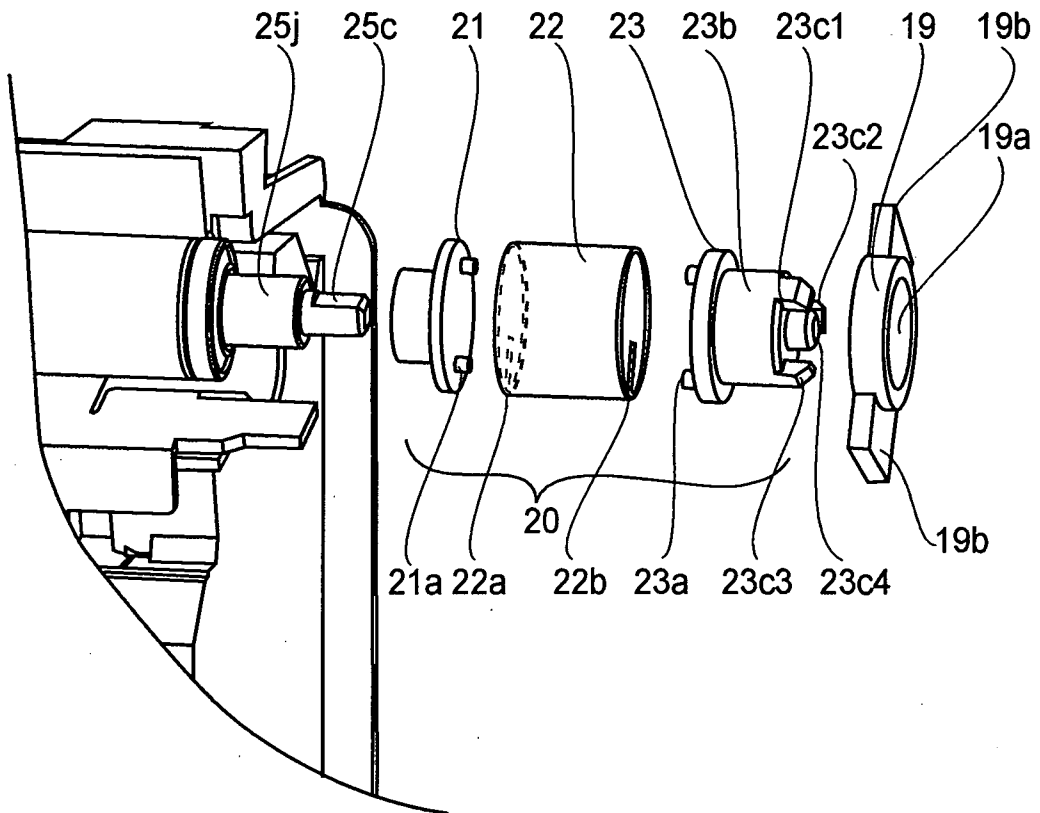
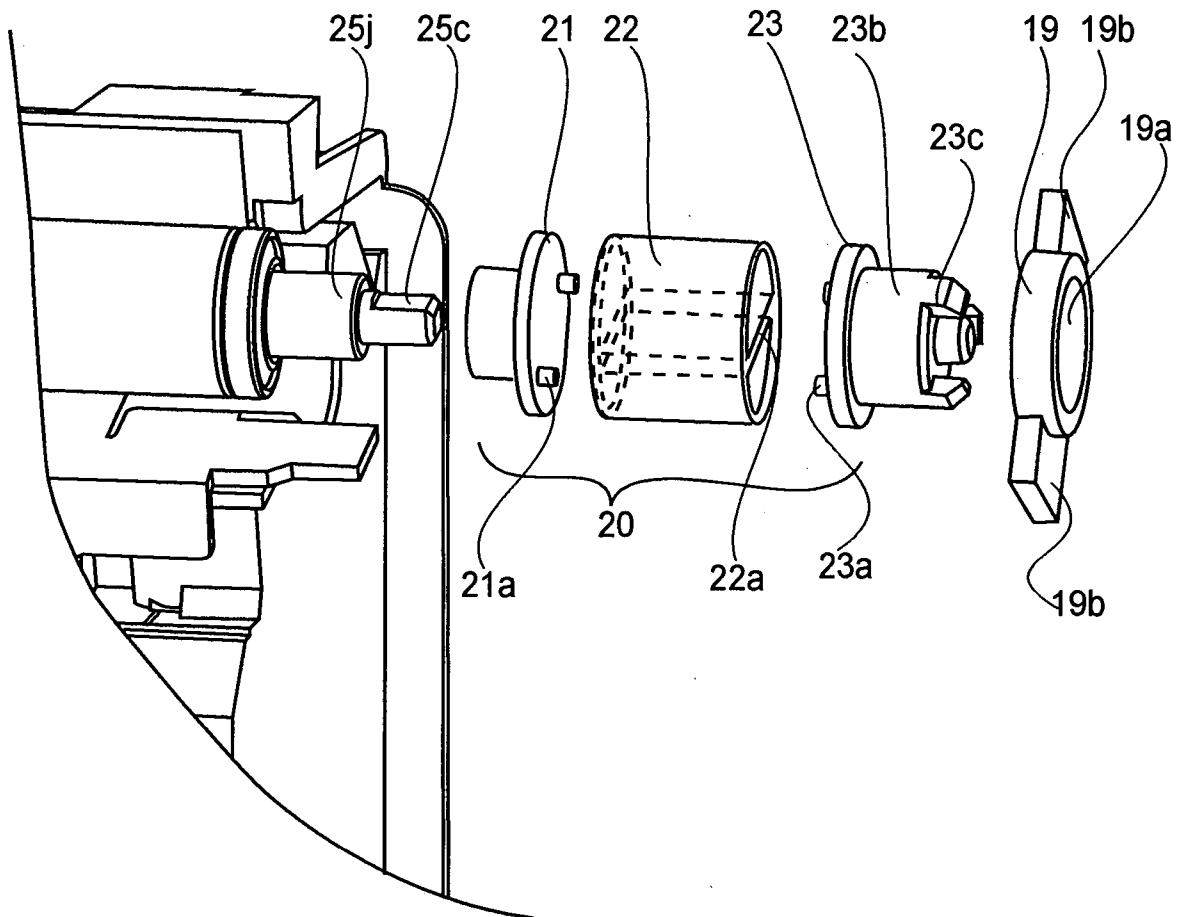

FIG. 16



**FIG.17**



**FIG. 18**

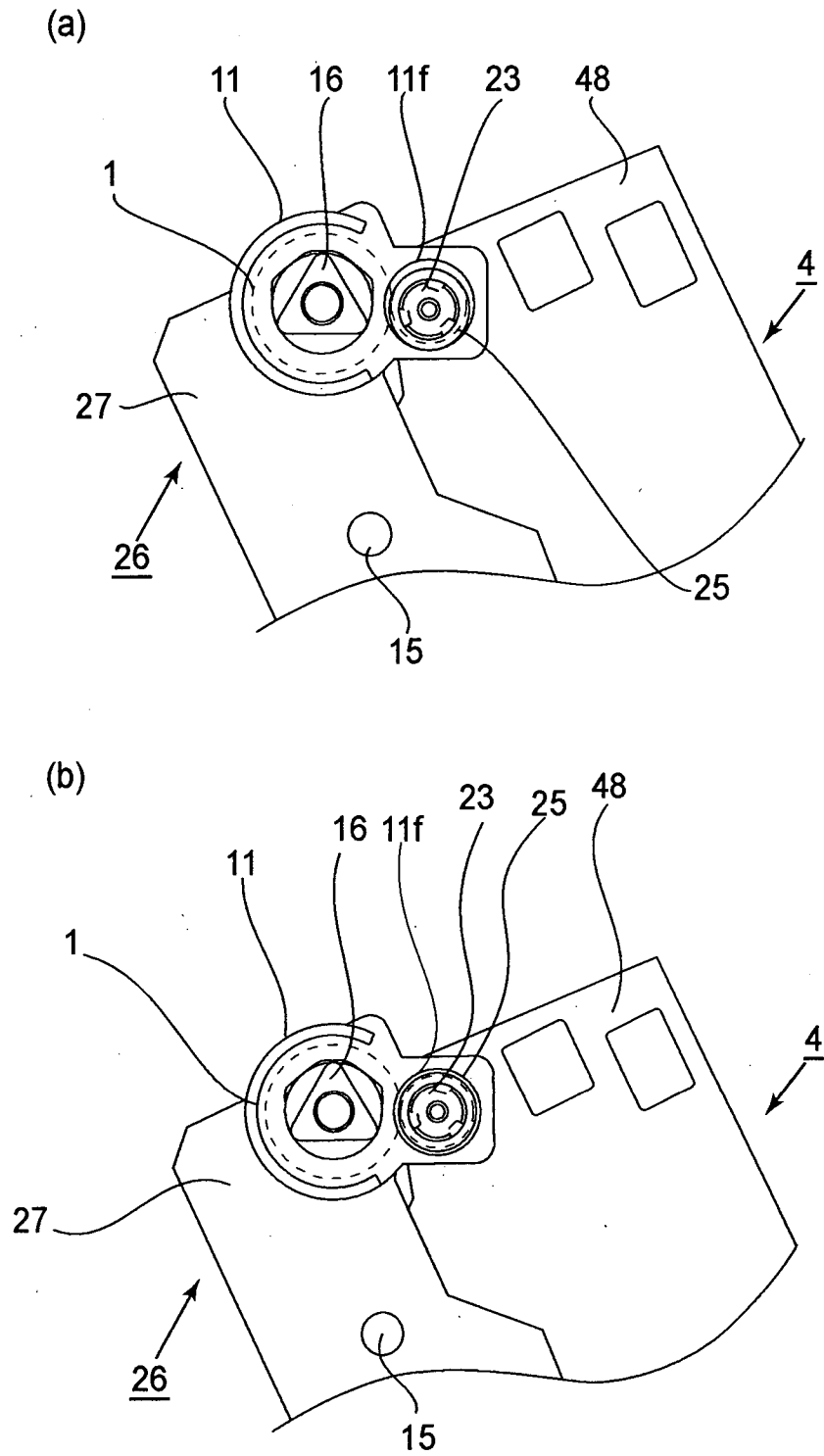

**FIG. 19**

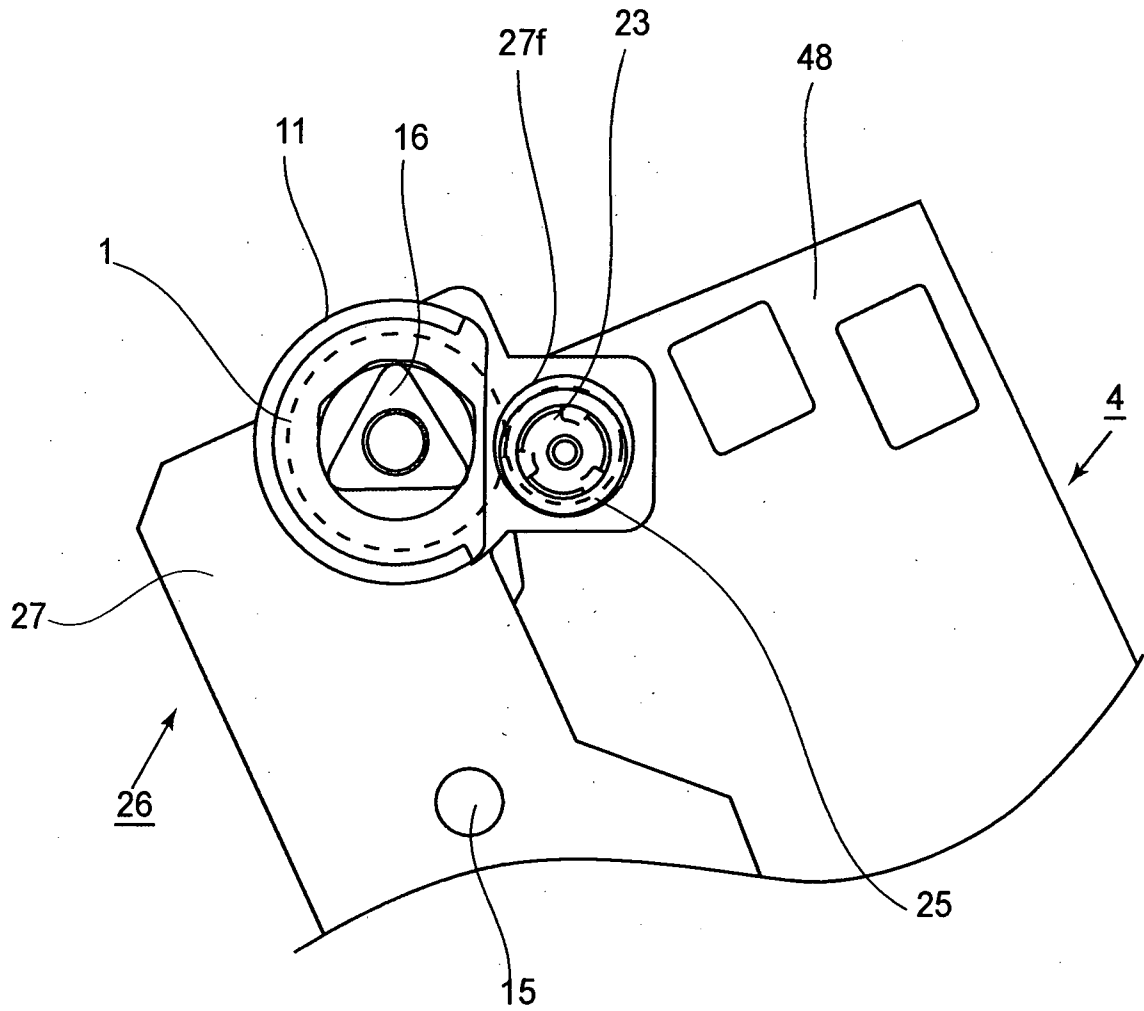

**FIG. 20**

**REFERENCES CITED IN THE DESCRIPTION**

*This list of references cited by the applicant is for the reader's convenience only. It does not form part of the European patent document. Even though great care has been taken in compiling the references, errors or omissions cannot be excluded and the EPO disclaims all liability in this regard.*

**Patent documents cited in the description**

- JP 2001255806 A [0006]
- US 6285847 B1 [0008]
- GB 2141520 A [0009]

## FELDOLGOZÓ PATRON ÉS KÉPFORMÁLÓ BERENDEZÉS

### Szabadalmi igénypontok

1. Feldolgozó patron (7), amely leválaszthatóan felszerelhető egy elektrofotografikus képformáló berendezés főblokkjára, ahol a főblokk tartalmaz egy első főblokkbeli forgatható hajtótágot (66) és egy második főblokkbeli forgatható hajtótágot (53), a feldolgozó patron (7) a következőket tartalmazza:

elektrofotografikus fényérzékeny dob (1);

előhívó henger (25) az elektrofotografikus fényérzékeny dobon (1) kialakított elektrosztatikus rejtett képnek egy előhívóval való előhívásához;

dobcsatoló tag (16), amely az elektrofotografikus fényérzékeny dob (1) egyik tengelyvégén van biztosítva az első főblokkbeli hajtótaggal (66) való összekapcsolódáshoz és egy első forgatási hajtóerőnek az elektrofotografikus fényérzékeny dobbhoz (1) való átviteléhez, amikor a feldolgozó patron (7) föl van szerelve a berendezés főblokkjára az elektrofotografikus fényérzékeny dob (1) tengelyirányában; és

tengelykapcsoló tag (20), amely az előhívó henger (25) egyik tengelyvégén van biztosítva, egy második forgató hajtóerőnek a második főblokk hajtótagjának (53) a tengelye és az előhívó henger (25) tengelye között engedélyezett eltéréssel történő átvitelére, ahol a tengelykapcsoló tag (20) tartalmaz egy összekapcsoló részt (23) a második főblokk hajtótagjával (53) való összekapcsolódáshoz és a második forgató erőnek a fogadásához, amikor a feldolgozó patron (7) föl van szerelve a berendezés főblokkjára;

**azzal jellemezve, hogy** a feldolgozó patron továbbá tartalmaz egy tartó részt (11c, 27f), amely a feldolgozó patron (7) keretén (26, 4) van biztosítva, és az összekapcsoló rész (23) arra van kialakítva, hogy mozgatható legyen az előhívó henger (25) tengelyirányát keresztező irányban, amikor a feldolgozó patron (7) belép a berendezés főblokkjába, és ahol



az összekapcsoló rész (23) arra van kialakítva, hogy a tartó részhez (11c, 27f) legyen elhelyezve keresztetű irányban sűrgetve, amikor a feldolgozó patron (7) belép a berendezés főblokkjába.

2. Az 1. igénypont szerinti feldolgozó patron, ahol a keret (26, 4) tartalmaz egy dobcsapágyat (11) az elektrofotografikus fényérzékeny dob (1) forgatható megtámasztására.
3. A 2. igénypont szerinti feldolgozó patron, ahol a tartó rész (11c) a dobcsapágyon (11) van biztosítva.
4. A 2. vagy 3. igénypont szerinti feldolgozó patron, ahol a dobcsapágy (11) egy patronelhelyező résszel (11b) van biztosítva a feldolgozó patronnak (7) az elhelyezéséhez a berendezés főblokkjában biztosított főblokk-elhelyező rész (83a) csatlakoztatása által.
5. Az 1 – 4. igénypontok egyike szerinti feldolgozó patron, ahol a keret (26, 4) a következőket tartalmazza:

első keret (26) az elektrofotografikus fényérzékeny dob (1) tartására, és  
 második keret (4) az előhívó henger (25) tartására.

6. Az 5. igénypont szerinti feldolgozó patron, ahol a tartó rész (11c, 27f) az első kereten (26) van biztosítva.
7. Az 1 – 6. igénypontok egyike szerinti feldolgozó patron, ahol a feldolgozó patron (7) tartalmaz egy sűrgető számot (18) az összekapcsoló résznek (23) a keresztirányban való sűrgetésére.
8. Az 1 – 7. igénypontok egyike szerinti feldolgozó patron, ahol az összekapcsoló rész (23) tartalmaz egy összekapcsoló részbeli elhelyező részt (23c4) a második főblokkbeli hajtótaggal (53) való összekapcsolódáshoz, hogy el legyen helyezve a második főblokkbeli hajtótag (53) által, amikor a főblokkbeli hajtótag (53) forog.

9. Az 1 – 8. igénypontok egyike szerinti feldolgozó patron, ahol a feldolgozó patron (7) tartalmazza az összekapcsoló rész csapágytagját (19), amely mozgatható az előhívó henger (25) tengelyirányához képest keresztirányban, és amely támogatja a forgatható összekapcsoló részt (23), és az összekapcsoló rész (23) a tartórészhez (11c) az összekapcsoló rész csapágytagján (19) keresztül van elhelyezve.
10. Az 1 – 9. igénypontok egyike szerinti feldolgozó patron, ahol a tengelykapcsoló tag (20) egy Oldham csatolás.
11. Az 1 – 10. igénypontok egyike szerinti feldolgozó patron, ahol a tengelykapcsoló tag (20) tartalmaz egy rugalmas részt, hogy lehetővé tegye az összekapcsoló tag (23) és az előhívó henger (25) közötti eltérést.
12. Az 1 – 11. igénypontok egyike szerinti feldolgozó patron, ahol az összekapcsoló rész (23) tengelye eltér az előhívó henger (25) tengelyétől keresztirányban, amikor a feldolgozó patron (7) belép a berendezés főblokkjába.
13. Elektrofotografikus képformáló berendezés képnek rögzítő anyagon való kialakítására, amely a következőket tartalmazza:
- (i) forgatható első főblokkbeli hajtótag (66) és forgatható második főblokkbeli hajtótag (53);
  - (ii) az előző igénypontok egyike szerinti feldolgozó patron (7) és
  - (iii) adagoló eszköz (54, 76, 55, 56, 57, 58, 59, 70, 72) rögzítő anyag (S) adagolásához.
14. A 13. igénypont szerinti berendezés, amely továbbá tartalmaz egy főblokkbeli elhelyező részt a feldolgozó patronnak (7) olyan dobcsapágy (11) által való elhelyezéséhez, amely rendelkezik a tartó résszel (11c) az elektrofotografikus fényérzékeny dob (1) forgatható megtámasztására.
15. A 13. vagy 14. igénypont szerinti berendezés, ahol a második főblokkbeli hajtótag (53) egy lyukkal (53a-53c) van biztosítva a második forgató hajtóerő átviteléhez, ahol a lyuk

(53a-53c) össze van kapcsolva egy nyúlvánnyal (23e1-23e3), amely az összekapcsoló részen (23) van biztosítva, amikor a második főblokkbeli hajtótag (53) össze van kapcsolva az összekapcsoló résszel (23), és ahol a második főblokkbeli hajtótag (23) siettetve van a feldolgozó patron (7) irányában egy siettető tag (73) által, amely a berendezés főblokkjában van biztosítva.

16. A 13 – 15. igénypontok egyike szerinti berendezés, ahol a második főblokkbeli hajtótagnak (53) van egy hajtótagot elhelyező része (53e), amely összekapcsolható az összekapcsoló résszel (23), hogy elhelyezze az összekapcsoló részt (23), amikor a második főblokkbeli hajtótag (53) forog.