

- (21) Application No 8204731
(22) Date of filing 17 Feb 1982
(43) Application published
1 Sep 1983
(51) INT CL³
A01K 27/00
(52) Domestic classification
A1M CB
(56) Documents cited
GB 1601908
GB 1559082
GB 1546235
GB 1020700
GB 0788170
GB 0332327
US 4197817
US 4018189
(58) Field of search
A1M
(71) Applicant
Kent Lin,
No. 131 Yuyuan Road,
Shinjuang Village, Lonjing
County, Taichun Hsian,
Taiwan
(72) Inventor
Kent Lin
(74) Agent and/or Address for
Service
Marks and Clerk,
57—60 Lincoln's Inn
Fields, London WC2A 3LS

(54) **Combined collar and leash
assembly for a pet animal**

(57) A combined collar and leash assembly for a dog comprises a casing 2 containing a spiral spring 3 between two plates 8, 9. An elastic leash 4 is connected to the outer end of the spring 3 and, just like a self-coiling measuring tape, a variable amount of the leash 4 can be made to protrude out of the casing 2, secured by means

of a catch 6. A decorative handle 5 in the form of a bow is connected by a connector 13 to the outer end of leash 4. A collar 7 extends through an opening in the casing and is prevented from slipping along the collar 7 by means of a button 15 engaging in a buttonhole of collar 7. The size of the collar 7 can be adjusted by engaging buttonhole 14 in any one of five buttonholes 16 in the collar 7. The collar 7 as well as the leash 4 are elastic.

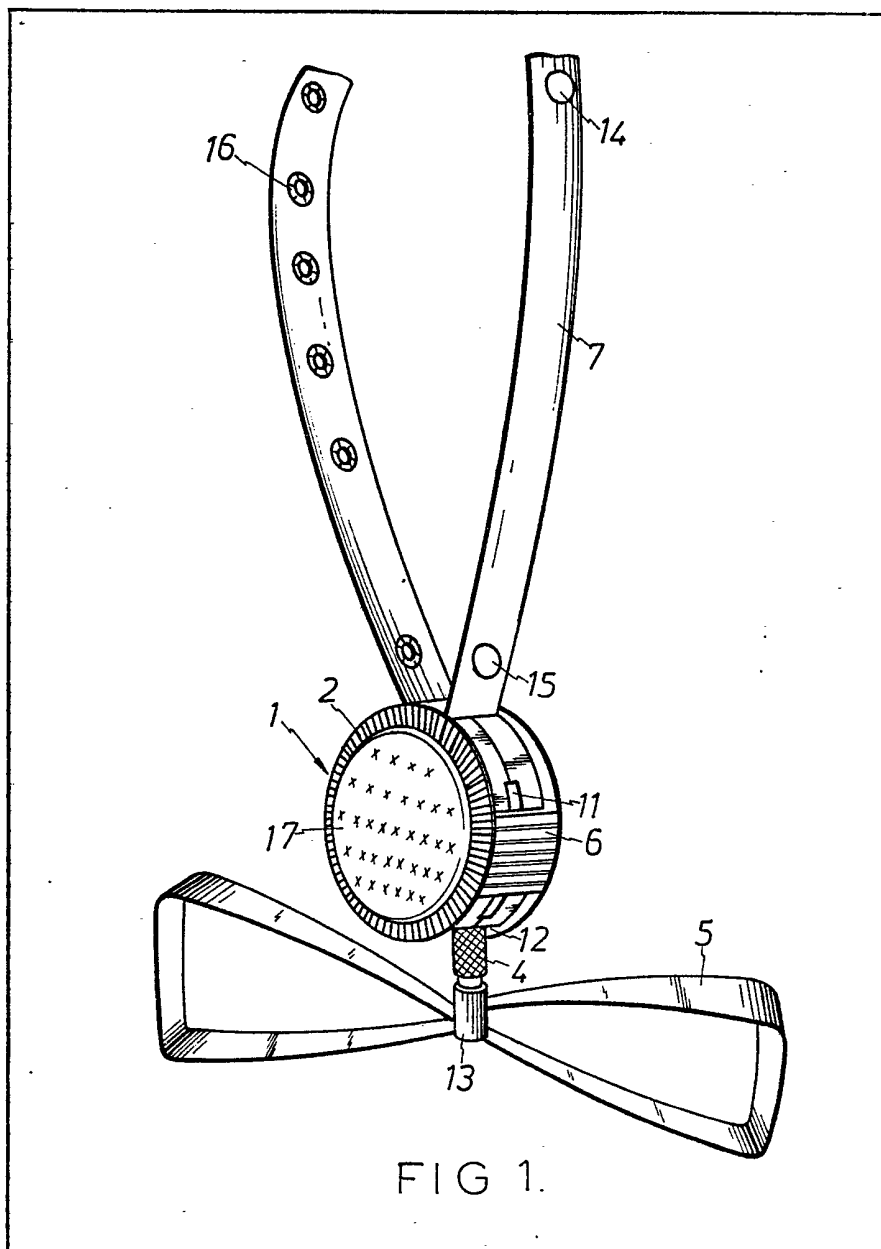

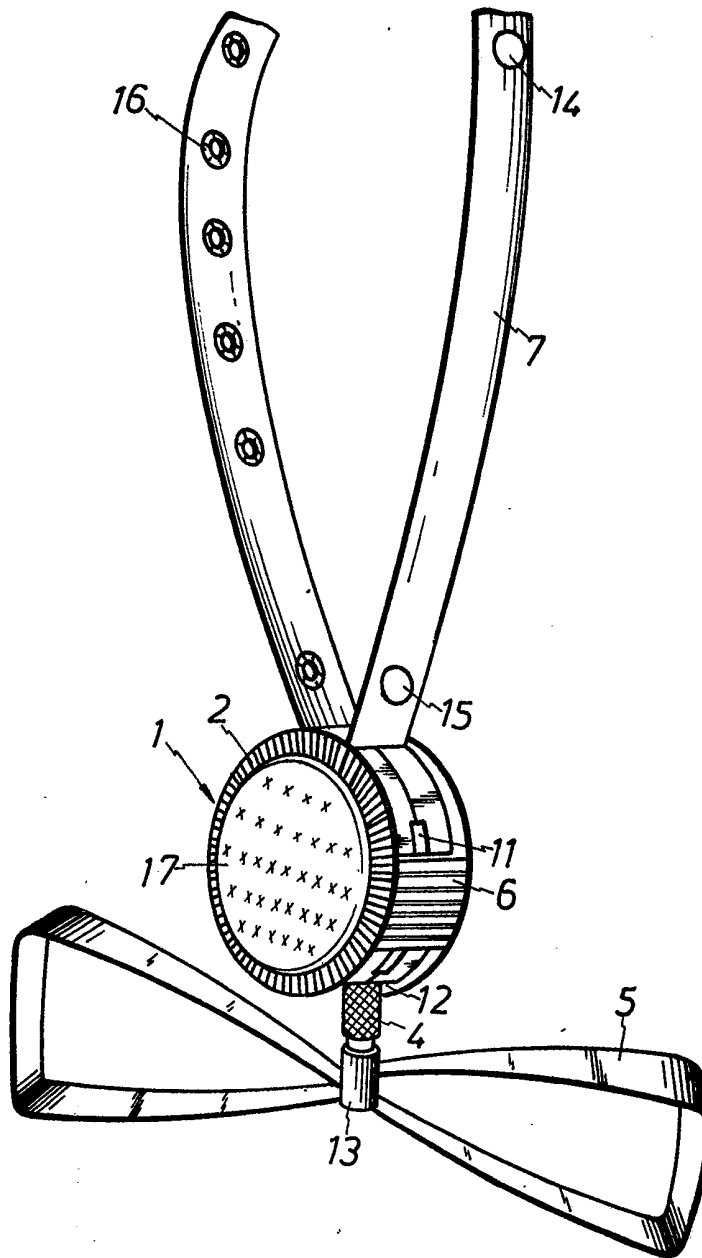

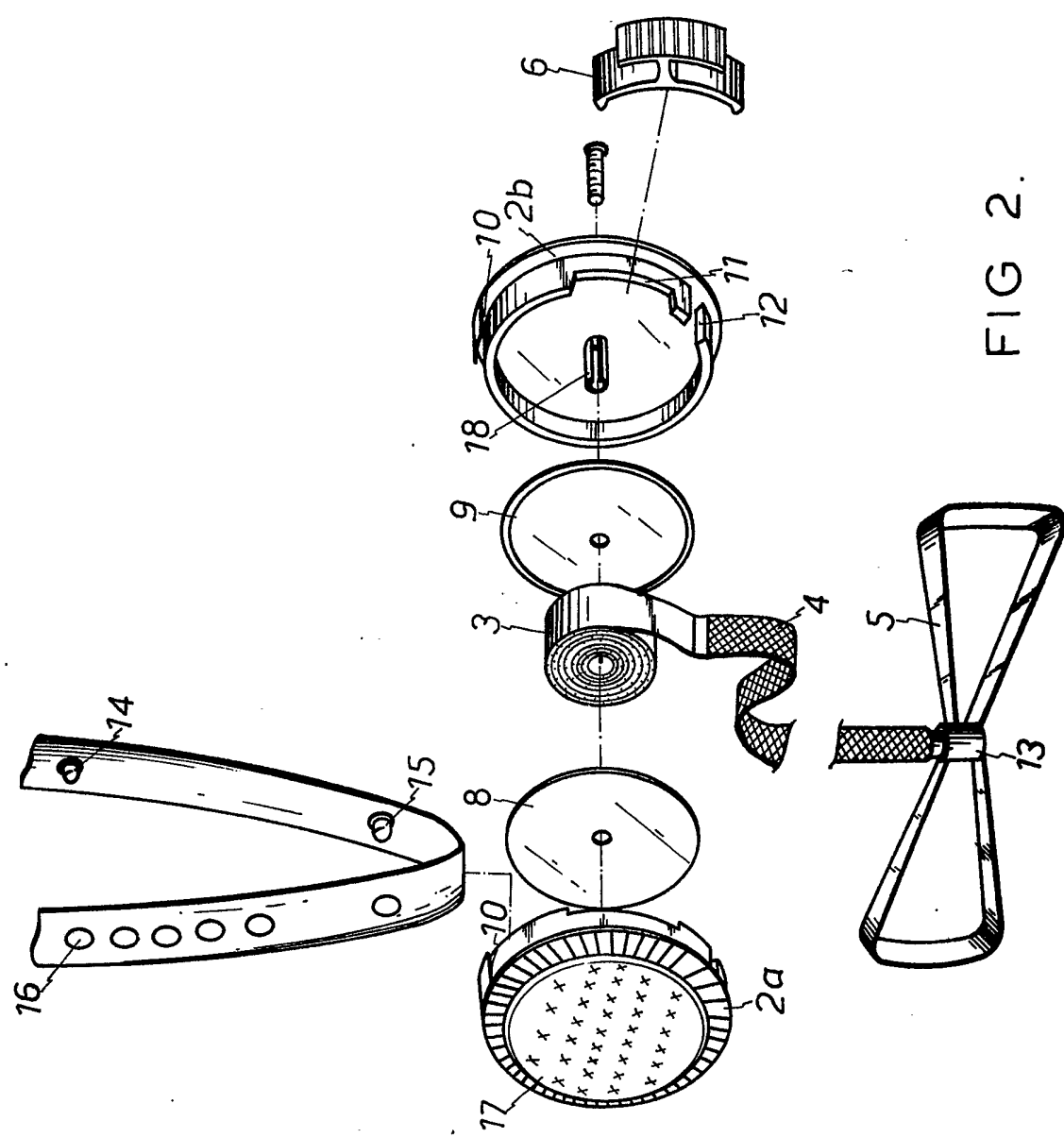

FIG 2.

SPECIFICATION

Combined collar and leash assembly for a pet animal

5 This invention relates to a combined collar and leash assembly for a pet animal.

According to the invention there is provided a combined collar and leash assembly for a pet animal, the assembly comprising a casing containing a spiral spring, a leash connected to the spiral spring and protruding at least partly out of the casing, a handle connected or connectible to the leash and a collar connected to the casing, the assembly being adapted for the spring to coil the leash at least partly up in the casing, a catch being provided so that a variable amount of the leash as desired can be left protruding out of the casing against the pull of the spring.

Preferably the casing is in two halves, namely, a back half and a front half, the spring is connected to a spigot integral with one of the halves of the casing, the spring being arranged between two plates in the casing.

Preferably the leash and the collar are both elastic and the handle is in the form of a bow.

25 Preferably the collar extends through an opening in the casing and is provided with a button and buttonhole restricting the casing from slipping along the collar. Furthermore, the collar size is preferably adjustable by button-and-buttonhole means.

The invention will be described by way of example with reference to the accompanying drawings, wherein:—

35 Fig. 1 is a perspective view of a combined collar and leash assembly embodying the invention, showing the collar partly broken away; and

Fig. 2 is an exploded view of the combined collar and leash assembly of Fig. 1.

Referring to the drawings, the illustrated combined collar and leash assembly for a pet animal, such as a dog, comprises a casing 2 containing a spiral spring 3, an elastic leash 4 connected to the spiral spring 3 and protruding at least partly out of the casing, a handle 5 in the form of a bow connected or connectible to the leash 4 and a collar 7 connected to the casing 2. The assembly is adapted for the spring 3 to coil the leash 4 at least partly up in the casing 2. A catch 6 is provided so that a variable amount of the leash 4 as desired can be left protruding out of the casing 2 against the pull of the spring 3.

The casing 2 is in two halves, namely, a front half 2a and a back half 2b, the spring 3 being arranged between two circular plates 8, 9 in the casing 2, with the inner end of spring 3 keyed non-rotatably with a spigot 18 which is integral with back casing half 2b.

The collar 7 is provided with an upper button 14 and lower button 15 and also with five (the number not being important) upper buttonholes 16 and a lower buttonhole as shown in each of the Figures. Button 14 is engageable with any one of the five upper buttonholes to adjust the size of the collar to the pet's neck. The lower button 15 is

65 engageable with the lower buttonhole to restrict or prevent the casing 2 from slipping along the collar and also to restrict the casing 2 from swinging about relative to the collar.

The collar 7 extends through an opening 10 formed in both halves of the casing 2 at the top as seen in Figs. 1 and 2. The leash 4 projects through an opening 12, likewise formed in both halves 2a and 2b of casing 2. The catch 6 is mounted in an opening 11 in casing 2 so that the catch 6 can be moved slidably up and down as seen in Figs. 1 and 2 for locking and unlocking the leash 4 against retraction and extension of the leash 4 into and out of the casing 2, rather in the manner of the well-known self-coiling measuring tape.

80 The bow handle 5 is connected to the leash 4 by means of a connecting sleeve 13, by means of which the bow handle 5 can be disconnected from the leash 4 if desired. When leash 4 is fully retracted into casing 2, the bow handle 5 forms a decoration on the animal's neck rather like a bow tie.

An identity card 17 is stuck on the front casing half 2a of casing 2, to show the pet's name and breed and the pet owner's telephone number and address and so forth.

90 The elasticity of the collar and leash makes it possible to secure the pet properly but not too tightly. Also, if the pet suddenly tries to rush off when being walked "on the leash" the elasticity of the leash reduces the violence of the pull on both the pet itself and the person walking the pet.

Just as a self-coiling measuring tape can have a selectively variable amount of measuring tape protruding out of its casing, so also a selectively variable amount of the leash 4 can be made to protrude out of the casing 2 and secured by sliding down the catch 6 against both further withdrawal of leash 4 and recoiling of leash 4.

100 The casing halves 2a, 2b, the plates 8, 9, the spring 3 and the catch 6 are all held together by means of a screw (Fig. 2) to form an assembly 1.

CLAIMS

1. A combined collar and leash assembly for a pet animal, the assembly comprising a casing containing a spiral spring, a leash connected to the spiral spring and protruding at least partly out of the casing, a handle connected or connectible to the leash and a collar connected to the casing, the assembly being adapted for the spring to coil the leash at least partly up in the casing, a catch being provided so that a variable amount of the leash as desired can be left protruding out of the casing against the pull of the spring.

2. An assembly as claimed in claim 1 wherein the casing is in two halves, namely, a back half and a front half.

3. An assembly as claimed in claim 1 or 2 wherein the spring is connected to a spigot integral with at least part of the casing.

4. An assembly as claimed in claim 1, 2 or 3 wherein the spring is arranged between two plates in the casing.

5. An assembly as claimed in any preceding

claim wherein the leash is elastic.

6. An assembly as claimed in any preceding claim wherein the collar is elastic.

5 7. An assembly as claimed in any preceding claim wherein the handle is in the form of a bow.

8. An assembly as claimed in any preceding claim wherein the collar extends through an opening in the casing and is provided with means restricting or preventing the casing from slipping

10 along the collar.

9. An assembly as claimed in claim 8 wherein said means comprises a button and buttonhole.

10. An assembly as claimed in any preceding claim wherein the collar size is adjustable.

15 11. An assembly as claimed in claim 10 wherein the collar size is adjustable by button-and-buttonhole means.