



US00D402628S

United States Patent [19]
Canuto et al.

[11] Patent Number: Des. 402,628
[45] Date of Patent: **Dec. 15, 1998

- [54] ELECTRICAL CONNECTOR HOUSING
- [75] Inventors: **Oscare Canuto**, Collegno; **Mylène Roussin**, Turin, both of Italy
- [73] Assignee: **The Whitaker Corporation**,
Wilmington, Del.
- [**] Term: **14 Years**
- [21] Appl. No.: **83,747**
- [22] Filed: **Feb. 17, 1998**
- [30] **Foreign Application Priority Data**
- | | | | |
|---------------|------|----------------|---------|
| Aug. 21, 1997 | [GB] | United Kingdom | 2068479 |
|---------------|------|----------------|---------|
- [51] **LOC (6) Cl.** **13-03**
- [52] **U.S. Cl.** **D13/133**
- [58] **Field of Search** D13/133, 146,
D13/147; 439/350, 352-354, 357, 358,
607-610

- [56] **References Cited**
- U.S. PATENT DOCUMENTS**
- | | | | | |
|------------|--------|------------------|-------|---------|
| D. 210,533 | 3/1968 | Pauza | | D13/147 |
| D. 323,141 | 1/1992 | Sueyoshii et al. | | D13/133 |
| D. 323,316 | 1/1992 | Ohkura et al. | | D13/133 |
| D. 324,026 | 2/1992 | Ichida et al. | | D13/133 |
| 5,487,677 | 1/1996 | Hoffner | | 439/293 |

Primary Examiner—Alan P. Douglas
Assistant Examiner—Lavone D. Tabor
Attorney, Agent, or Firm—Driscoll A. Nina

[57] **CLAIM**

An ornamental design for an electrical connector housing, as shown and described.

DESCRIPTION

FIG. 1 is a top, rear, and side perspective view of an electrical connector housing showing our new design; FIG. 2 is a perspective view of the electrical connector housing showing the bottom, front, and the side that is shown in FIG. 1; FIG. 3 is a perspective view of the electrical connector housing showing the top, front, and opposite side; FIG. 4 is a perspective view of the electrical connector housing showing the top, rear, and the side that is shown in FIG. 3; FIG. 5 is a top view of the electrical connector housing; FIG. 6 is a bottom view of the electrical connector housing; FIG. 7 is a front view of the electrical connector housing; FIG. 8 is a side view of the electrical connector housing; FIG. 9 is an opposite side view of the electrical connector housing; and, FIG. 10 is a rear view of the electrical connector housing.

1 Claim, 4 Drawing Sheets

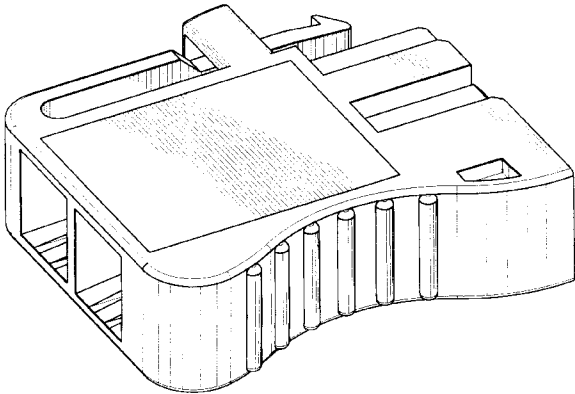
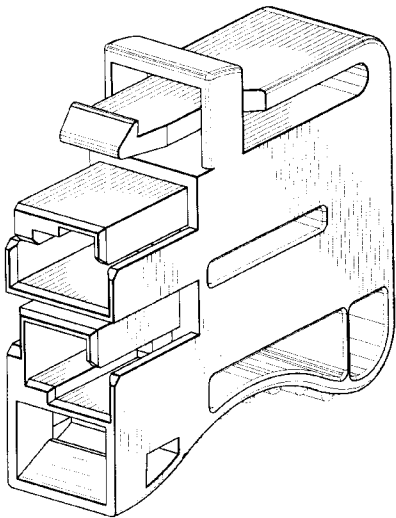

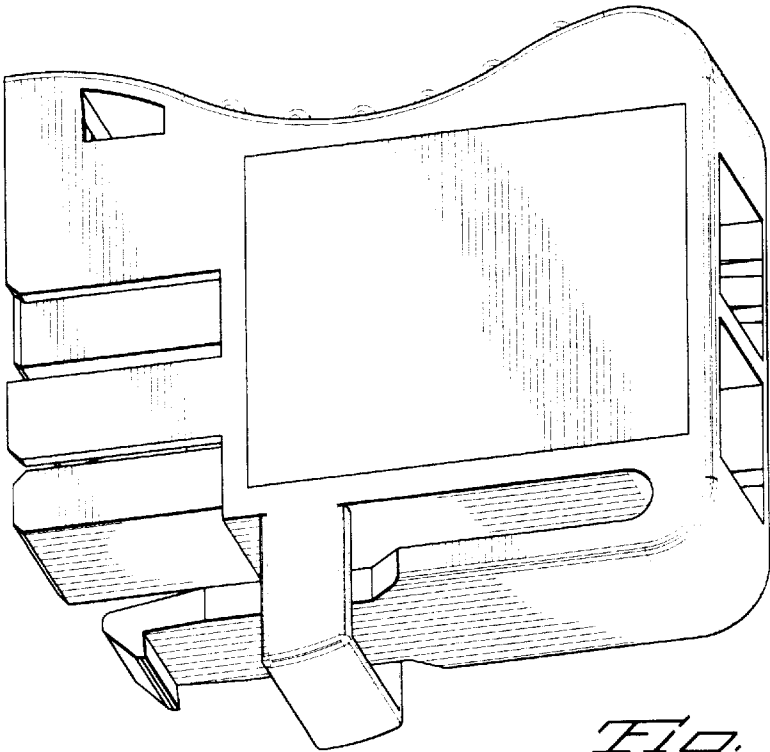

Fig. 1

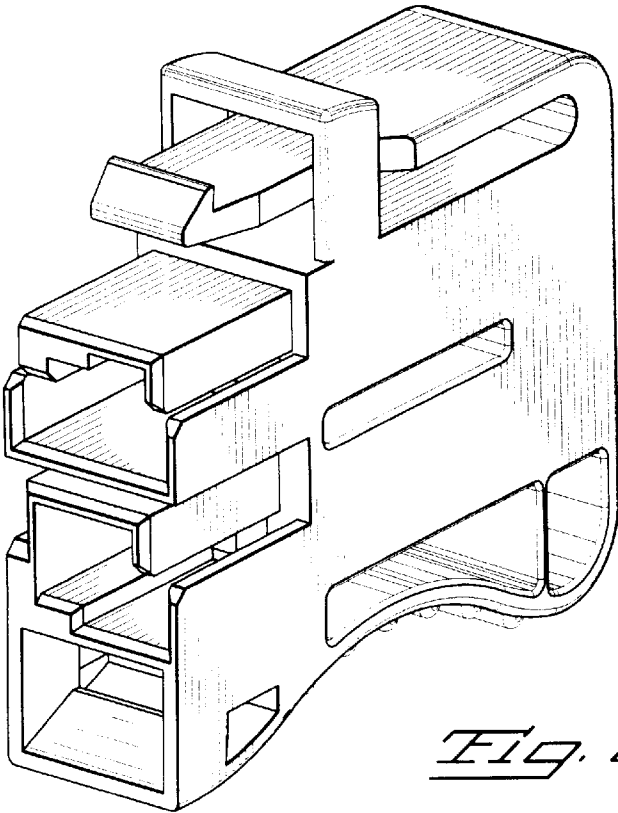

Fig. 2

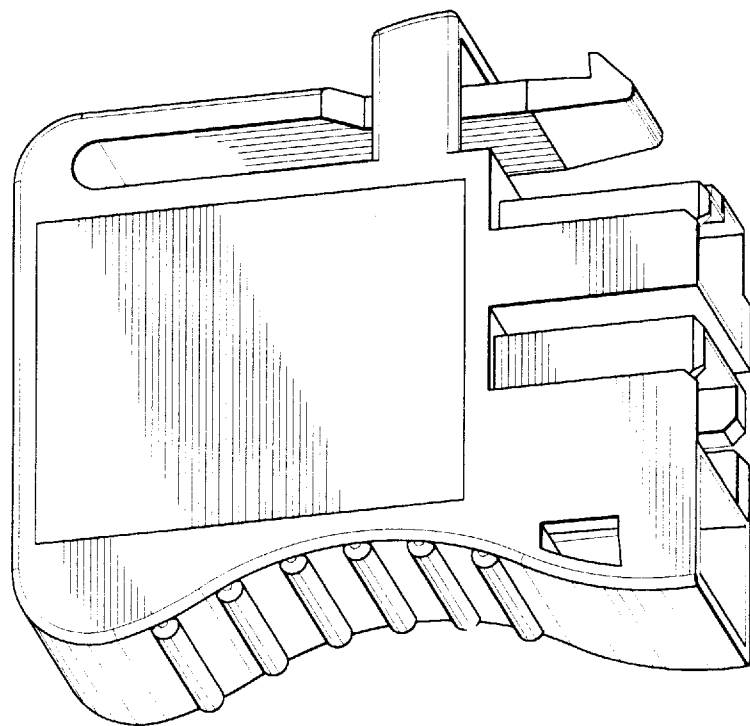

Fig. 3

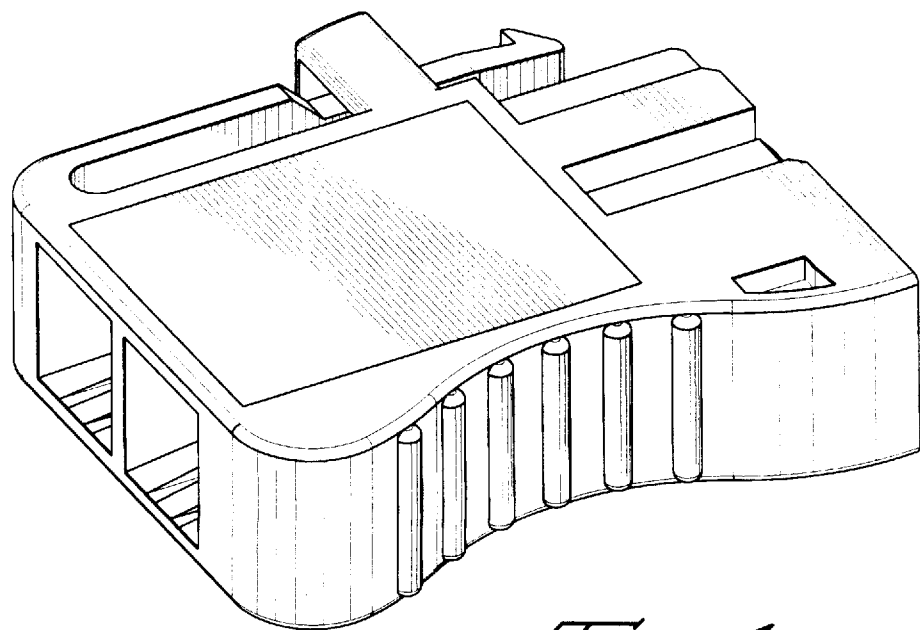

Fig. 4

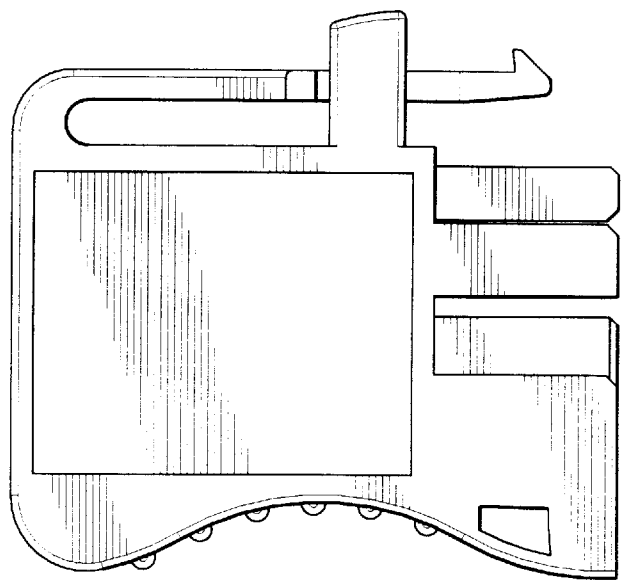

Fig. 5

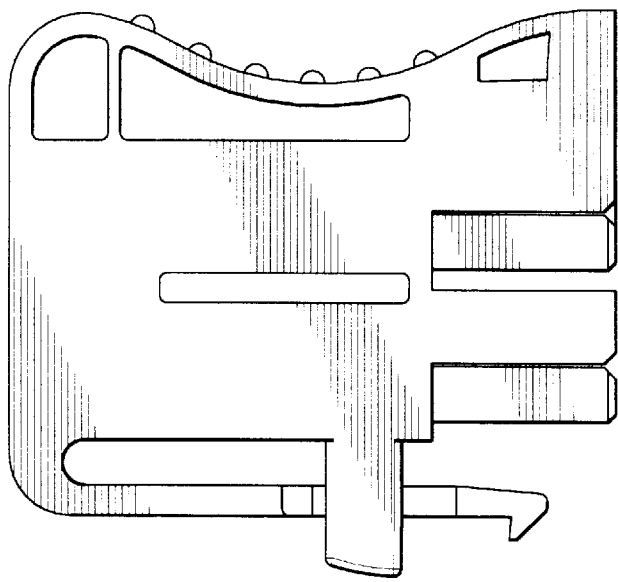

Fig. 6

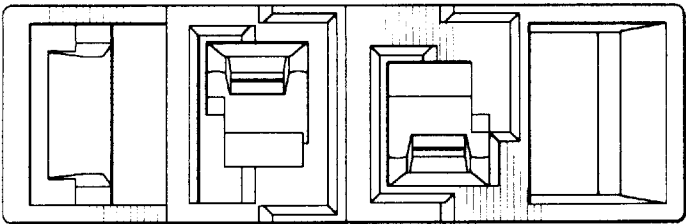

Fig. 7

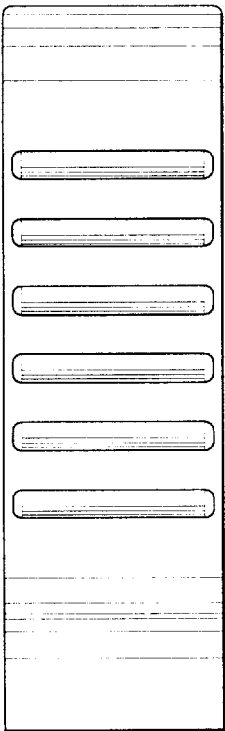

Fig. 8

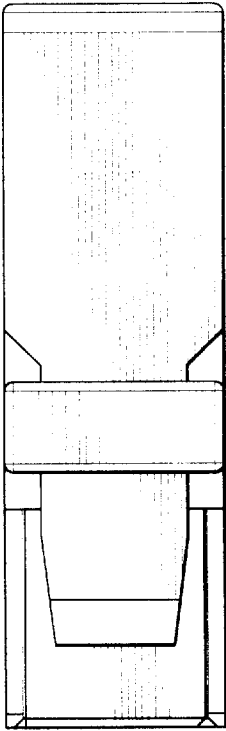

Fig. 9

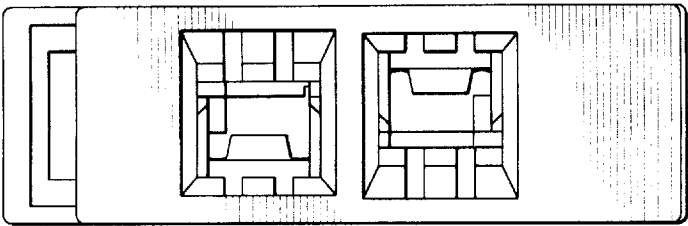

Fig. 10