

(19) World Intellectual Property Organization  
International Bureau



(43) International Publication Date  
20 August 2009 (20.08.2009)

(10) International Publication Number  
**WO 2009/102774 A2**

- (51) International Patent Classification:  
*H01Q 21/26* (2006.01)
- (21) International Application Number:  
PCT/US2009/033773
- (22) International Filing Date:  
11 February 2009 (11.02.2009)
- (25) Filing Language: English
- (26) Publication Language: English
- (30) Priority Data:  
61/027,530 11 February 2008 (11.02.2008) US
- (71) Applicant: AMPHENOL CORPORATION [US/US];  
358 Hall Avenue, Wallingford, CT 06492 (US).
- (71) Applicants and
- (72) Inventors: GIRARD, Gregory [—/FR]; 15, Rue, Des  
Brosses, F-37390 Saint-roch (FR). SOULIE, Frank [—/  
FR]; 42, Bis, Route De Chambord, F-41350 Montlivault  
(FR). PROTEAU, Eric [—/FR]; 52 Rue Nationale,  
F-37530 Mosnes (FR). PALLONE, Anthony [—/FR]; 6,  
Rue De La Liberte, F-37150 Civray-de-touraine (FR).
- (74) Agent: MEHRMAN, Michael, J.; Mehrman Law Office,  
P.c., P.o. Box 420797, Atlanta, GA 30342 (US).

(81) Designated States (unless otherwise indicated, for every kind of national protection available): AE, AG, AL, AM, AO, AT, AU, AZ, BA, BB, BG, BH, BR, BW, BY, BZ, CA, CH, CN, CO, CR, CU, CZ, DE, DK, DM, DO, DZ, EC, EE, EG, ES, FI, GB, GD, GE, GH, GM, GT, HN, HR, HU, ID, IL, IN, IS, JP, KE, KG, KM, KN, KP, KR, KZ, LA, LC, LK, LR, LS, LT, LU, LY, MA, MD, ME, MG, MK, MN, MW, MX, MY, MZ, NA, NG, NI, NO, NZ, OM, PG, PH, PL, PT, RO, RS, RU, SC, SD, SE, SG, SK, SL, SM, ST, SV, SY, TJ, TM, TN, TR, TT, TZ, UA, UG, US, UZ, VC, VN, ZA, ZM, ZW.

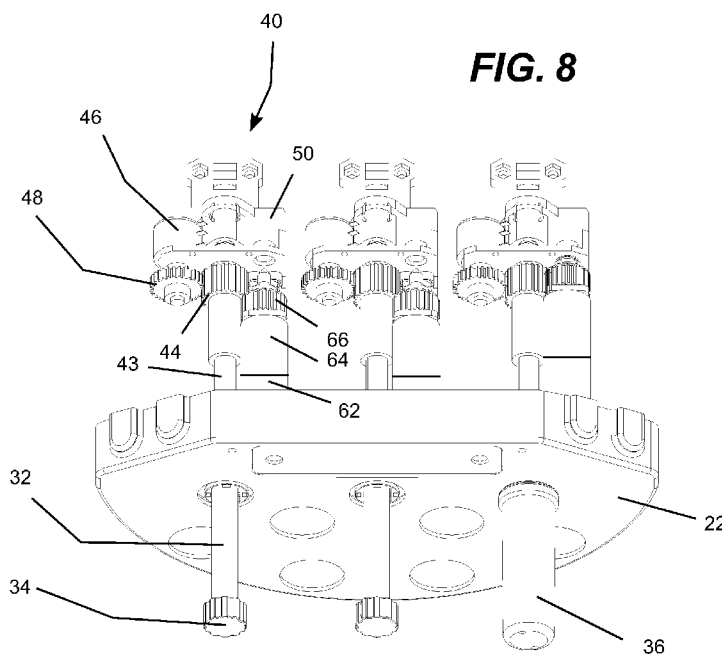
(84) Designated States (unless otherwise indicated, for every kind of regional protection available): ARIPO (BW, GH, GM, KE, LS, MW, MZ, NA, SD, SL, SZ, TZ, UG, ZM, ZW), Eurasian (AM, AZ, BY, KG, KZ, MD, RU, TJ, TM), European (AT, BE, BG, CH, CY, CZ, DE, DK, EE, ES, FI, FR, GB, GR, HR, HU, IE, IS, IT, LT, LU, LV, MC, MK, MT, NL, NO, PL, PT, RO, SE, SI, SK, TR), OAPI (BF, BJ, CF, CG, CI, CM, GA, GN, GQ, GW, ML, MR, NE, SN, TD, TG).

**Declarations under Rule 4.17:**

- as to the applicant's entitlement to claim the priority of the earlier application (Rule 4.17(iii))
- of inventorship (Rule 4.17(iv))

[Continued on next page]

(54) Title: REMOTE ELECTRICAL TILT ANTENNA WITH MOTOR AND CLUTCH ASSEMBLY



(57) Abstract: RET antenna with motor and clutch assembly that is operative to mechanically disengage the DC motor and drive unit (also called the gear-motor unit) from the phase shifter adjustment shaft during a manual tilt operation. Disengaging the gear-motor unit removes the drag of the motor and the high gear ratio gear box from the phase shifter control rod making it easier to manually turn the phase shifter control knob. In addition, the clutch disengages the gear-motor without disengaging the position detector from the phase shifter control rod so that position calibration is not lost during manual tilt adjustment. When the manual tilt operation is completed, the mechanical tilt clutch enables the gear-motor unit to be reliably re-engaged with the phase shifter control rod for motorized electrical tilt operation without having to re-calibrate the position detector.

WO 2009/102774 A2

**Published:**

- *without international search report and to be republished upon receipt of that report (Rule 48.2(g))*

## 5     **REMOTE ELECTRICAL TILT ANTENNA WITH MOTOR AND CLUTCH ASSEMBLY**

### REFERENCE TO PRIORITY APPLICATIONS

      This application claims priority to commonly-owned United States Provisional Patent Application No. 60/027,530, which is incorporated herein by reference.

10

### TECHNICAL FIELD

      This invention relates to the field of cellular or mobile telephone base station antennas and, more particularly, relates to a remote electrical tilt (RET) base station antenna with a motor and clutch assembly that disengages the tilt motor to facilitate manual tilt adjustment.

15

### BACKGROUND OF THE INVENTION

      Antennas with variable electrical tilt (VET) functionality are known in the art. These antennas, which often are used in cellular networks, enable network operators to tilt the elevation beam pointing direction of an antenna by manually rotating a knob or translating a shaft on the exterior of the antenna. The knob or shaft is linked to phase shifters inside the antenna to convert the mechanical rotation or translation of the shaft to phase changes in the radio frequency beam forming network inside the antenna. Changes in phase between radiating elements inside the antenna cause the beam emitted from the antenna to tilt up or down relative to mechanical boresite of the antenna. An example of a cellular base station antenna demonstrating VET technology is depicted in US 7,068,236, which is incorporated by reference.

20

25

      Beam tilt adjustment is needed in cellular networks to reduce signal propagation between sites in the network in order to minimize signal interference and to maximize network capacity. Antennas with VET functionality allow network operators to make accurate tilt adjustments at a cell site without mechanically tilting the antenna and without changing the visual appearance of the site. Antennas with VET functionality typically include some sort of tilt indicator to provide visual feedback of the antenna electrical tilt setting to the person making the tilt adjustment.

30

Remote electrical tilt (RET) antennas are also known in the art. RET antennas incorporate an electro-mechanical actuator attached to or installed inside of the antenna to rotate the knob or translate the shaft on a VET antenna. This enables the electrical tilt of the VET antenna to be controlled from a remote location, eliminating  
5 the expense of hiring a rigger to climb the tower and manually adjust the electrical tilt of the antenna beam.

With most RET antennas, the electro-mechanical actuator attaches to the VET antenna at or near the manual tilt adjustment mechanism of the antenna. With the RET actuator installed, the tilt of the antenna can no longer be adjusted manually. In  
10 order to manually adjust the tilt of the antenna, the RET actuator must be physically removed or separated from the antenna to provide access to the manual tilt adjustment mechanism. Removing the actuator is often tedious and time consuming due to small attachment screws and delicate interface components. In addition, calibration can be lost between the electro-mechanical actuator and the antenna tilt  
15 setting once the actuator is removed. A calibration sequence must to be run to re-calibrate the actuator to the antenna before proper remote operation can be restored.

An improvement on the standard RET antenna design is depicted in US 7,286,092, which is incorporated by reference. In this design, the electro-mechanical actuator inserts inside the antenna body without blocking access to the manual tilt  
20 adjustment mechanism of the antenna. With the RET actuator engaged, the tilt of this antenna can be adjusted manually using a 10mm wrench to rotate the tilt adjustment mechanism. In this design, the wrench is needed to overcome the mechanical resistance of the phase shifters plus the mechanical resistance of the motor. In this design, the motor does not separate from the drive chain during a manual tilt  
25 operation.

A low gear ratio drive unit is required in this design to enable manual tilt adjustment with the RET actuator is installed. The low gear ratio drive unit allows the motor and the drive unit to be manually turned with relatively low drive torque. If a  
30 high gear ratio drive unit were used, it would be very difficult to adjust the tilt manually and the high torque required to manually back-drive the motor and the drive unit could potentially break the plastic teeth on the tilt indicator drive shaft.

A problem with using low gear ratio drive units, however, is that a higher torque DC motor is required to generate sufficient torque to operate the RET actuator during remote tilt operation. The high torque DC motor is expensive by itself. In addition,

the motor draws high current during tilt operations forcing the use of expensive, high current rated components on the controller circuit.

There is, therefore, a continuing need for a RET antenna that uses low current, low torque DC motors to reduce cost without losing the ability to manually tilt the antenna when the electro-mechanical actuator is installed. A further need exists for a  
5 RET antenna that allows for both electro-mechanical and manually tilt adjustment without losing the tilt calibration of the antenna.

#### SUMMARY OF THE INVENTION

10 The present invention meets the need described above in a RET antenna with a motor and clutch assembly that is operative to mechanically disengage the DC motor and drive unit (also called the gear-motor unit) from the phase shifter adjustment shaft during a manual tilt operation. Disengaging the gear-motor unit removes the drag of the motor and the high gear ratio gear box from the phase shifter  
15 control rod making it easier to manually turn the phase shifter control knob. In addition, the clutch disengages the gear-motor without disengaging the position detector from the phase shifter control rod so that position calibration is not lost during manual tilt adjustment. When the manual tilt operation is completed, the mechanical tilt clutch enables the gear-motor unit to be reliably re-engaged with the  
20 phase shifter control rod for motorized electrical tilt operation without having to re-calibrate the position detector.

The invention may be practiced in a base station antenna for a telecommunications system that is configured for remote electrical tilt ("RET") and manual tilt adjustment. The base station antenna may be a single or multiple-beam  
25 antenna with single or dual polarization elements. In a preferred embodiment, the base station antenna includes three dual polarization antenna arrays supported within a common antenna enclosure. Typically, one phase shifter can be used to control the pointing direction of an associated single or dual polarization antenna element. In some cases, one of the antenna elements serves as a pivot point for  
30 beam tilting and, for this reason, need not have an associated phase shifter. The features of a single antenna array will be described as representative of each array for descriptive convenience, it being understood that the antenna may include multiple arrays, single or dual polarization antenna elements as a matter of design

choice. The antennas also include a wide range of other features that have been omitted from the description as ancillary to the present invention.

Generally described, the antenna includes a number of antenna elements for directing a beam of electromagnetic energy in a propagation direction. A number of  
5 phase shifters, typically one for each antenna element, are operatively connected to the antenna elements for tilting the beam propagation direction. A control device is operatively connected to the phase shifters for operating the phase shifters to tilt the beam propagation direction. A gear-motor unit is operatively connected to the control  
10 device for electro-mechanically driving the control device to tilt the beam propagation direction. In addition, a manual beam tilt mechanism is operatively connected to the control device for manually driving the control device to tilt the beam propagation direction. A clutch is operative for disengaging the gear-motor unit from the control  
15 device to facilitate manual adjustment of the beam propagation direction and reengaging the gear-motor unit with the control device to permit electro-mechanical adjustment of the beam propagation direction. The antenna may also include a position detector operatively connected to the control device for registering  
20 movement of the control device to track changes in the beam propagation direction. The position detector remains operatively connected to the control device during manual and electro-mechanical adjustment of the beam propagation direction so that beam tilt calibration is not lost during manual or electro-mechanical adjustment of the  
beam propagation direction.

In a particular embodiment, the antenna includes a removable cover configured to be selectively attached to the antenna to prevent access to the manual beam tilt mechanism and removed to permit access to the manual beam tilt  
25 mechanism. Manual removal of the cover operates the clutch to disengage the gear-motor unit from the control device to facilitate manual adjustment of the beam propagation direction. Similarly, manual attachment of the cover operates the clutch to reengage the gear-motor unit with the control device to permit electro-mechanical  
adjustment of the beam propagation direction.

30 More specifically, the clutch may include a spring-loaded plunger mechanism that selectively moves a drive gear unit into and out of engagement with a control gear operatively connected to the control device. The spring-loaded plunger mechanism may include a slide supporting the gear-motor unit that is slidably engaged within a guide frame inside the antenna. The control device may include a

control rod that rotates to adjust the beam propagation direction, and the manual beam tilt mechanism may include a tilt adjustment knob connected to the control rod for manually rotating the control rod.

5 In addition, the antenna is typically housed within an enclosure, the control extends through the antenna enclosure, and the tilt adjustment knob is connected to the control rod outside and proximate to the antenna enclosure. In this arrangement, the removable cover selectively attaches to the antenna enclosure to cover tilt adjustment knob. To operate the clutch, the removable cover includes a collar configured to be manually inserted into the antenna enclosure to push the spring-  
10 loaded plunger mechanism against a spring bias of the mechanism to move the drive gear into engagement with the control gear when the cover is attached to the antenna enclosure. The spring-loaded plunger mechanism is further configured to move under the spring bias of the mechanism to disengage the drive gear from the control gear when the collar of the removable cover is manually removed from the antenna  
15 enclosure.

The antenna may also include a tilt indicator operatively carried by the control rod located at least partially outside the antenna enclosure visually indicating a tilt setting associated with the beam propagation direction. In this case, the removable cover may include a sight tube permitting visual access to the tilt indicator when the  
20 removable cover is attached to the antenna enclosure and covering the tilt indicator.

In view of the foregoing, it will be appreciated that the present invention provides a cost effective RET antenna that includes a mechanical clutch that separates a low current, low torque DC motor from the tilt adjustment mechanism to permit manual tilt adjustment of the antenna. The RET antenna also allows both  
25 electro-mechanical and manually tilt adjustment without losing the tilt calibration of the antenna. The specific techniques and structures for implementing particular embodiments of the invention, and thereby accomplishing the advantages described above, will become apparent from the following detailed description of the embodiments and the appended drawings and claims.

30

#### BRIEF DESCRIPTION OF THE DRAWINGS

FIG. 1 is a conceptual illustration of a side view of a remote electrical tilt antenna with a motor and clutch assembly to facilitate manual tilt adjustment.

FIG. 2 is a conceptual illustration of a front view of tri-band remote electrical tilt antenna with a motor and clutch assembly to facilitate manual tilt adjustment.

FIG. 3 is a conceptual illustration of a front view of the tri-band remote electrical tilt antenna a tilt indicator removed for manual tilt adjustment.

5 FIG. 4 is a conceptual block diagram of the motor and clutch assembly of the remote electrical tilt antenna with the motor in the engaged position.

FIG. 5 is a conceptual block diagram of the motor and clutch assembly of the remote electrical tilt antenna with the motor in the disengaged position.

10 FIG. 6: is a perspective view of the bottom of a tri-band antenna showing the cable connectors, beam tilt indicators, manual adjustment knobs, and indicator covers.

FIG. 7 is a perspective view of an illustrative indicator cover.

FIG. 8 is a perspective view of an illustrative motor and clutch assembly for a tri-band remote electrical tilt antenna.

15 FIG. 9 is a front view of an illustrative motor and clutch assembly for a remote electrical tilt antenna.

FIG. 10 is a perspective view of the front side of a guide frame for an illustrative motor and clutch assembly for a remote electrical tilt antenna.

20 FIG. 11 is a perspective view of the rear side of the guide frame for the illustrative motor and clutch assembly.

FIG. 12 is a perspective view of the front side of a slide for an illustrative motor and clutch assembly for a remote electrical tilt antenna.

FIG. 13 is a perspective view of the read side of the slide frame for the illustrative motor and clutch assembly.

25

#### DETAILED DESCRIPTION OF THE EMBODIMENTS

The present invention meets the need described above in a RET antenna with a motor and clutch assembly that is operative to mechanically disengage the DC motor and drive unit (also called the gear-motor unit) from the phase shifter  
30 adjustment shaft during a manual tilt operation. Disengaging the gear-motor unit removes the drag of the motor and the high gear ratio gear box from the phase shifter control rod making it easier to manually turn the phase shifter control knob. In addition, the clutch disengages the gear-motor without disengaging the position detector from the phase shifter control rod so that position calibration is not lost

during manual tilt adjustment. When the manual tilt operation is completed, the mechanical tilt clutch enables the gear-motor unit to be reliably re-engaged with the phase shifter control rod for motorized electrical tilt operation without having to re-calibrate the position detector.

5           The mechanical tilt clutch incorporates a shaft position detector to provide feedback to the remote control system to identify the current beam tilt of the antenna. To maintain the tilt calibration of the antenna, the shaft position detector is fixed in location and does not disengage from the phase shifter drive shaft during electro-  
10           mechanical or manual or remote tilt operations. Calibration is set at the factory during antenna assembly and is not lost in the field during a manual tilt operation. The invention may be applied to single band antennas with only one electro-  
            mechanical tilt actuator as well as multi-band antennas with multiple electro-  
            mechanical tilt actuators.

            In the particular embodiment illustrated in the figures, the mechanical tilt clutch  
15           allows the DC motor and drive unit to be engaged and disengaged from the exterior of the antenna using the tilt indicator cover. When the tilt indicator cover is installed on the antenna body it encapsulates the manual tilt adjustment drive unit for the antenna, preventing access for manual operation. At the same time, the installed tilt indicator cover causes the DC motor and drive unit to become engaged with the  
20           phase shifter drive shaft. In this position, the antenna is ready for remote tilt operation. When the tilt indicator cover is rotated and removed from the antenna, springs internal to the antenna body apply force to the DC motor and drive unit to disengage them from the phase shifter drive shaft. Also, when the tilt indicator cover is removed, the manual tilt adjustment unit for the antenna becomes exposed. In this  
25           position, the antenna is ready for manual adjustment. With the DC motor and drive unit disengaged from the phase shifter drive shaft, manual tilt operation is possible without back driving the DC motor and drive unit. As a result, high gear ratio drive units with low current DC motors can be used, meeting the design objective of the invention.

30           The tilt indicator cover is tethered to the antenna body with a length of cord to prevent losing the cover when it is disengaged during a manual tilt operation. The uninstalled cover dangling at the end of the cord is highly visible to the operator performing the manual tilt operation. It is very unlikely that the operator would leave the site without remembering to re-install the tilt indicator cover. It would be easy to

visually inspect the antenna from the ground with binoculars to verify whether or not the tilt indicator cover had been properly reinstalled.

Another embodiment of this invention could include turning a lever, pushing a button or rotating a screw on the exterior of the antenna to disengage the DC motor and drive unit from the phase shifter drive shaft. This is a less desirable solution since the screw, button or lever would be less visible than an uninstalled tilt indicator cover. The operator might forget to re-engage the device after completing the manual tilt operation and it would be difficult to verify proper reinstallation without climbing the tower.

Another embodiment of this invention could be to press and hold or turn and hold a feature of the antenna to disengage the DC motor and drive unit during a tilt operation. When the manual tilt operation is completed the feature would be released. Springs inside the antenna could re-engage the DC motor and drive unit with the phase shifter drive shaft. This would prevent an operator from accidentally forgetting to re-engage the DC motor and drive unit but would also require two hands on the antenna during a manual tilt operation. This is undesirable from a climbing safety perspective.

Turning now to the drawings, in which like numerals refer to like elements throughout the figures, FIG. 1 is a conceptual illustration of a side view of a tri-band, dual polarization remote electrical tilt antenna **10** with a motor and clutch assembly to facilitate manual tilt adjustment. The basic construction and operation of tri-band, dual polarization remote electrical tilt antennas are well known. In brief summary, this particular example of this type of antenna includes three vertical arrays of dual-polarization antenna elements. Only one vertical array **12a** is shown in the side view of FIG. 1 and many well known components are not shown to avoid cluttering the figure. The vertical array **12a**, which is carried on a back plane **14**, includes a number of dual-polarization antenna elements **16a-n**, each of which has its beam elevation controlled by an associated phase shifter **18a-n**. The phase shifters implement vertical beam tilt, as shown conceptually in FIG. 1. The antenna is covered by a radome **20** and carried within an antenna enclosure **22**. The antenna as shown also includes a cable connector **24** for receiving RF antenna signals from a coaxial cable **26**. Although only one cable connector shown, the antenna would typically have two cable connectors for each band, one for each polarization.

A remote electrical tilt (RET) controller **30** and an associated gear-motor unit including a DC motor and drive unit (also called the gear-motor, shown FIGS. 4 and 5) allows remote control over the electrical tilt of the antenna. The drive unit is a high gear ratio gear box that translates high speed, low torque motor rotation to lower speed, higher torque rotation of the drive gear turned by the motor. In this particular example, a relatively small number of antenna elements and associated phase shifters are shown in each vertical array to illustrate the conceptual design, but any sized array may be deployed. For example, a typical tri-band antenna 2.7 meters tall could include 7 antenna elements for the lowest frequency band and 17 antenna elements for the highest frequency band. As a design alternative, the center antenna element may serve as the electrical tilt pivot point and, for this reason, may not have an associated phase shifter for electrical tilt. Much detail, such as the power distribution networks, filters, grounding systems, RET communication equipment, and so forth have not been illustrated to avoid cluttering the figure.

In this particular antenna, the phase shifters **16a-n** of a vertical array (corresponding to an operational frequency band of the antenna) are operated by a common phase shifter control rod. The bottom of the phase shifter control rod extends beyond the bottom of the antenna enclosure **22**, where it carries a visual beam tilt indicator **32a**. A manual adjustment knob **34a** allows an operator to manually rotate the phase shifter control rod to adjust the electrical tilt of the corresponding array. An indicator cover **36a** covers the beam tilt indicator **32a** and the manual adjustment knob **34a** to protect them from the weather. As described in more detail with reference to FIGS. 4 and 5, the antenna **10** includes a motor and clutch assembly for each vertical array that disengages the tilt motor from the phase shifter control rod to facilitate manual adjustment of the electrical tilt, which is accomplished by turning the manual adjustment knob **34a**. More particularly, removal of the indicator cover **36a**, which is necessary to manually access the manual adjustment knob **34a**, mechanically causes the clutch assembly to disengage the motor from the phase shifter control rod.

FIGS. 2 and 3 are conceptual illustrations of the front side of the tri-band remote electrical tilt antenna **10** without the radome. As shown in this view, the antenna includes three vertical arrays **12a-c** of dual polarization antenna elements and associated phase shifters. The size and spacing of the antenna elements typically vary from array to array depending on the frequency band, but are shown

aligned in FIG. 2 to simplify the conceptual illustration. The RET control unit is operational to control the electrical tilt of all three vertical arrays **12a-c**, typically but not necessarily in a coordinated manner. The beam tilt indicators **32a-c**, manual adjustment knobs **34a-c**, and indicator covers **36a-c** are located at the bottom of the antenna enclosure **22**. As shown in FIG. 3, the indicator cover **36a** may be removed to access the manual adjustment knob **34a** for manual adjustment of the beam tilt of the associated array **12a**. As noted previously, removing the indicator cover **36a** mechanically disengages the RET beam tilt motor for the antenna array **12a** from the associated phase shifter control rod to facilitate manual rotation of the control rod.

5 The indicator cover **36a** is preferably attached to the antenna enclosure **22** by a tether **38a** so that the indicator cover will not become misplaced and to help to prompt the operator replace the indicator cover, and thereby re-engage the tilt motor, upon completion of manual tilt adjustment.

FIGS. 4 and 5 are conceptual block diagrams of an illustrative motor and clutch assembly **40** for the remote electrical tilt antenna **10**. Each antenna array **12a-c** has a similar motor and clutch assembly (i.e., one motor and clutch assembly per band). FIG. 4 shows the antenna with the indicator cover installed and the motor in the engaged position, whereas FIG. 5 shows the antenna with the indicator cover removed and the motor in the disengaged position. FIG. 4 shows the bottom portion of the antenna enclosure **22** with a beam tilt indicator **32**, manual adjustment knob **34**, and indicator cover **36** located below the enclosure. The motor and clutch assembly **40** includes a guide frame **41** that is mounted to and does not move with respect to the antenna enclosure **22**. The guide frame **41** includes a guide slot **42** in which a slide **60** carrying the tilt motor **62** and associated components including a gear box **64** slides as a spring-loaded plunger mechanism. The beam tilt indicator **32** and manual adjustment knob **34** are located on the bottom portion of a phase shifter control rod **43**. Rotation of the phase shifter control rod **43**, whether accomplished manually by rotation of the manual adjustment knob **34** or electrically by the tilt motor **62**, causes vertical translation of the phase shifter control rod, which in turn adjusts the associated phase shifters to electrically tilt the beam emitted by the associated vertical antenna array. The phase shifter control rod **43** carries a main control gear **44**, which the motor **62** turns to rotate the control rod and thereby change the electrical tilt of the associated antenna array.

15  
20  
25  
30

The guide frame **41** supports a position detector **46**, typically a potentiometer, which is driven by a position gear **48**. The position gear **48**, in turn, is driven by the control gear **44** to provide signals indicating rotation of the control rod **43**. The guide frame **41** also supports a spring housing **50** that supports two return springs **52a-b** that bias the slide **60** downward toward the bottom of the enclosure **22**. The slide **60** translates vertically within the guide slot **42** and is biased toward the bottom of the antenna enclosure **22** by the return springs **52a-b**. The slide **60** carries the motor **62** and a high gear ratio gear box **64**, which are connected together to form an integral gear-motor unit. A drive gear **66** attached to the drive shaft of the gear-motor unit can be moved into engagement with the main control gear **44** to adjust the antenna tilt. The slide **60** also includes an abutment **68** that is positioned to be pushed by the indicator cover **36** as the indicator cover is pushed into the housing **22** and turned to latch in place. Pushing the latching the indicator cover **36** moves the abutment **68** and the entire slide **60** a distance "L" as indicated in FIGS. 4 and 5. FIG. 4 shows the motor and clutch assembly **40** with the indicator cover **36** pushed in and latched to the housing **22**, which corresponds to the slide **60** being displaced upward by a distance "L" to engage the drive gear **66** with the control gear **44** and thereby configure the antenna for motorized electrical tilt through operation of the motor **62**.

FIG. 5 shows the motor and clutch assembly **40** with the indicator cover **36** removed from the housing **22** and hanging from the tether **38**. The indicator cover **36** includes a latch **37** for securing the indicator cover to the antenna enclosure and a transparent sight tube **39** for viewing the associated beam tilt indicator **32**. When the indicator cover **36** has been removed as shown in FIG. 5, this allows the slide **60** to travel downward a distance "L" under the force of the return springs **52a-b**, which disengages the drive gear **66** from the control gear **44** and thereby configures the antenna for manual electrical tilt through rotation of the manual adjustment knob **34**. The engagement and disengagement of the drive gear **66** and the control gear **44** represents the clutch action of the motor and clutch assembly **40**. FIG. 5 also shows a guide pin **69** on top of the drive gear **66** that moves within a corresponding guide shaft in the spring housing **50** to keep the drive gear from slipping on the control gear **44**. The slide **60** also includes a motor mount, a tie-down boss for the gear-motor unit, and two guide prongs on which the return springs **52a-b** are carried, which are shown FIG. 13.

FIG. 6 is a perspective view of the bottom portion of the tri-band antenna **10** shown substantially to scale. For this particular antenna, the maximum width across the bottom of the antenna enclosure **22** is approximately 10 inches (24.5 cm) and the maximum depth across the bottom of the antenna enclosure is approximately 6 inches (14.2 cm). The height of the antenna is not shown and can vary considerably for different embodiments. For example, a typical tri-beam antenna may be approximately 8 feet 10 inches (2.7 meters) tall. This view shows the radome **20**, the back plane **14**, and the antenna enclosure **22**. The bottom of the enclosure carries six cable connectors represented by the enumerated cable connector **24**. Each vertical array transmits and receives one band of the tri-band antenna, and each band has two cable connectors, one for each polarization. Also at the bottom of the enclosure, there are three beam tilt indicators represented by the enumerated tilt indicator **32**, three manual adjustment knobs represented by the enumerated manual adjustment knob **34**, and three indicator covers represented by the enumerated indicator cover **36**.

FIG. 7 is a perspective view of an illustrative indicator cover **36**, which includes a latch **37**, a tether **38**, and a sight tube **39**. The latch **37** includes a catch **31** that engages with a stop on the antenna enclosure **22** and a cuff **33** that extends into the antenna enclosure when the indicator cover is pushed into and turned to latch onto the housing. The distance "L" that the indicator cover moves the slide corresponds to the distance by which the cuff **33** extends beyond the catch **31**. In this particular antenna, the distance "L" is approximately 0.5 inch (1.3 cm). Referring to FIGS. 4 and 5, this is the same distance "L" that the slide **60** travels to engage and disengage the drive gear **66** with the control gear **44** to implement the clutch action of the motor and clutch assembly **40**.

FIG. 8 is a perspective view of an illustrative motor and clutch assembly **40** substantially to scale, which includes three motor and clutch units, one for each band. One representative motor and clutch assembly **40** has parts enumerated and some components are not illustrated to avoid cluttering the figure. FIG. 8 shows the beam tilt indicator **32**, the manual adjustment knob **34**, and the indicator cover **36** located below the antenna enclosure **22**. The manual adjustment knob **34** is connected to the phase shifter control rod **43**, which carries the control gear **44**. The position detector **46** is driven by the position gear **48**, which is engaged with the control gear **44**. In

this view, the motor **62**, gear box **64**, and drive gear **66** are shown in the disengaged position. The spring housing **50** is also shown in FIG. 8.

FIG. 9 is a front view of an illustrative motor and clutch assembly **40**. The beam tilt indicator **32** carried on the phase shifter control rod **43** are visible in this perspective view. This view shows the control gear **44**, the position detector **46**, and the position gear **48**, which is engaged with the control gear **44**. The slide **60**, motor **62**, gear box **64**, drive gear **66**, and abutment **68** are shown in the disengaged position. The spring housing **50** and the return springs **52a-b** are shown with spring **52b** labeled. The guide pin **69** on the top of the drive gear **66**, a cable tie **70** that attaches the bottom of the gear-motor unit to the slide, and the motor mount **80** are also shown in FIG. 9.

FIG. 10 is a perspective view of the front side and FIG 11 is a perspective view of the rear side of the guide frame **41**, which includes the guide slot **42** in which the slide translates. The guide frame **41** includes a mounting plate **72**, which includes a position indicator receptacle **74**, a spring housing receptacle **75**, and a control rod receptacle **76**. The spring housing receptacle **75** includes two guide shafts **77** for the spring mounting prongs **87** on the slide (shown in FIGS. 12 and 13) and third guide receptacle **78** for the guide pin **69** on the drive gear **66** (shown in FIGS. 5 and 9). Movement of the spring mounting prongs **87** within the guide shafts **77** keeps the slide **60** aligned with the guide frame **41**. FIG 11 shows a slot recess **79** that receives spring clips **84a-c** on the slide (shown in FIG. 12) to clip the slide **60** to the guide frame **41**.

FIG. 12 is a perspective view of the front side and FIG. 13 is a perspective view of the rear side of the slide **60**. The slide includes a slide body **82** between the motor mounting plate **80** at one end and the abutment **68** at the other end. The motor mounting plate **80** includes four screw holes for attaching the front of the gear-motor unit to the slide **60**. The slide body **82** includes a tie-down boss **83** for attaching the rear of the gear-motor unit to the slide **60**. FIG. 13 shows the spring clips **84a-c** that snap into the slot **42** and are received within the slot recess **79** shown in FIG. 11. The spring mounting prongs **87**, the mounting plate **80** and the abutment **68** are also shown in FIG. 13. The guide frame **41** and slide **60** are preferably fabricated from injection molded plastic.

## CLAIMS

The invention claimed is:

- 5           1.     A base station antenna for a telecommunications system comprising:  
          a plurality of antenna elements for directing a beam of electromagnetic energy  
          in a propagation direction;  
          a plurality of phase shifters operatively connected to the antenna elements for  
          tilting the beam propagation direction;  
10           a control device operatively connected to the phase shifters for operating the  
          phase shifters to tilt the beam propagation direction;  
          a gear-motor unit operatively connected to the control device for electro-  
          mechanically driving the control device to tilt the beam propagation direction;  
          a manual beam tilt mechanism operatively connected to the control device for  
15           manually driving the control device to tilt the beam propagation direction; and  
          a clutch operative for disengaging the gear-motor unit from the control device  
          to facilitate manual adjustment of the beam propagation direction and reengaging the  
          gear-motor unit with the control device to permit electro-mechanical adjustment of the  
          beam propagation direction.
- 20           2.     The antenna of claim 1, further comprising a position detector  
          operatively connected to the control device for registering movement of the control  
          device to track changes in the beam propagation direction, wherein the position  
          detector remains operatively connected to the control device during manual and  
25           electro-mechanical adjustment of the beam propagation direction so that beam tilt  
          calibration is not lost during manual or electro-mechanical adjustment of the beam  
          propagation direction.
- 30           3.     The antenna of claim 1, further comprising a removable cover  
          configured to be selectively attached to the antenna to prevent access to the manual  
          beam tilt mechanism and removed to permit access to the manual beam tilt  
          mechanism, wherein manual removal of the cover operates the clutch to disengage  
          the gear-motor unit from the control device to facilitate manual adjustment of the  
          beam propagation direction, and wherein manual attachment of the cover operates

the clutch to reengage the gear-motor unit with the control device to permit electro-mechanical adjustment of the beam propagation direction.

4. The antenna of claim 3, wherein the clutch comprises a spring-loaded plunger mechanism that selectively moves a drive gear unit into and out of engagement with a control gear operatively connected to the control device.

5. The antenna of claim 4, wherein the spring-loaded plunger mechanism comprises a slide supporting the gear-motor unit.

10

6. The antenna of claim 5, wherein the spring-loaded plunger mechanism further comprises a guide frame that slidably engages the slide supporting the gear-motor unit.

15

7. The antenna of claim 6, wherein:  
the control device comprises a control rod that rotates to adjust the beam propagation direction; and  
the manual beam tilt mechanism comprises a tilt adjustment knob connected to the control rod for manually rotating the control rod.

20

8. The antenna of claim 7, wherein:  
the antenna is housed within an enclosure;  
the control extends through the antenna enclosure;  
the tilt adjustment knob is connected to the control rod outside and proximate to the antenna enclosure.

25

9. The antenna of claim 8, wherein the removable cover selectively attaches to the antenna enclosure to cover tilt adjustment knob.

30

10. The antenna of claim 9, wherein:  
the removable cover comprises a collar configured to be manually inserted into the antenna enclosure to push the spring-loaded plunger mechanism against a spring bias of the mechanism to move the drive gear into engagement with the control gear when the cover is attached to the antenna enclosure; and

the spring-loaded plunger mechanism is configured to move under the spring bias of the mechanism to disengage the drive gear from the control gear when the collar of the removable cover is manually removed from the antenna enclosure.

5           11. The antenna of claim 10, further comprising a tilt indicator operatively carried by the control rod located at least partially outside the antenna enclosure visually indicating a tilt setting associated with the beam propagation direction.

10           12. The antenna of claim 11, wherein the removable cover comprises a sight tube permitting visual access to the tilt indicator when the removable cover is attached to the antenna enclosure and covering the tilt indicator.

15           13. The base station antenna of claim 1, wherein the plurality of antenna elements, plurality of phase shifters, control device, gear-motor unit, manual beam tilt mechanism, and clutch as associated with a first antenna array, further comprising one or more additional similarly equipped antenna arrays supported within a common antenna enclosure.

20           14. The base station antenna of claim 13, wherein the antenna comprises three dual polarization antenna arrays supported within the common antenna enclosure.

25           15. A base station antenna for a telecommunications system comprising:  
a plurality of antenna elements for directing a beam of electromagnetic energy  
in a propagation direction;

a plurality of phase shifters operatively connected to the antenna elements for tilting the beam propagation direction;

a control device operatively connected to the phase shifters for operating the phase shifters to tilt the beam propagation direction;

30           a gear-motor unit operatively connected to the control device for electro-mechanically driving the control device to tilt the beam propagation direction;

a manual beam tilt mechanism operatively connected to the control device for manually driving the control device to tilt the beam propagation direction;

a clutch operative for disengaging the gear-motor unit from the control device to facilitate manual adjustment of the beam propagation direction and reengaging the gear-motor unit with the control device to permit electro-mechanical adjustment of the beam propagation direction;

5 a position detector operatively connected to the control device for registering movement of the control device to track changes in the beam propagation direction, wherein the position detector remains operatively connected to the control device during manual and electro-mechanical adjustment of the beam propagation direction so that beam tilt calibration is not lost during manual or electro-mechanical  
10 adjustment of the beam propagation direction; and

a removable cover configured to be selectively attached to the antenna to prevent access to the manual beam tilt mechanism and removed to permit access to the manual beam tilt mechanism, wherein manual removal of the cover operates the clutch to disengage the gear-motor unit from the control device to facilitate manual  
15 adjustment of the beam propagation direction, and wherein manual attachment of the cover operates the clutch to reengage the gear-motor unit with the control device to permit electro-mechanical adjustment of the beam propagation direction.

16. The base station antenna of claim 15, wherein the plurality of antenna  
20 elements, plurality of phase shifters, control device, gear-motor unit, manual beam tilt mechanism, and clutch as associated with a first antenna array, further comprising one or more additional similarly equipped antenna arrays supported within a common antenna enclosure.

25 17. The base station antenna of claim 16, wherein the antenna comprises three dual polarization antenna arrays supported within the common antenna enclosure.

18. The antenna of claim 15, wherein:  
30 the clutch comprises a spring-loaded plunger mechanism that selectively moves a drive gear unit into and out of engagement with a control gear operatively connected to the control device;

the spring-loaded plunger mechanism comprises a slide supporting the gear-motor unit; and

the spring-loaded plunger mechanism further comprises a guide frame that slidably engages the slide supporting the gear-motor unit.

19. The antenna of claim 18, wherein:

5 the antenna is housed within an enclosure;

the control device comprises a control rod that rotates to adjust the beam propagation direction;

the manual beam tilt mechanism comprises a tilt adjustment knob connected to the control rod for manually rotating the control rod;

10 the control extends through the antenna enclosure;

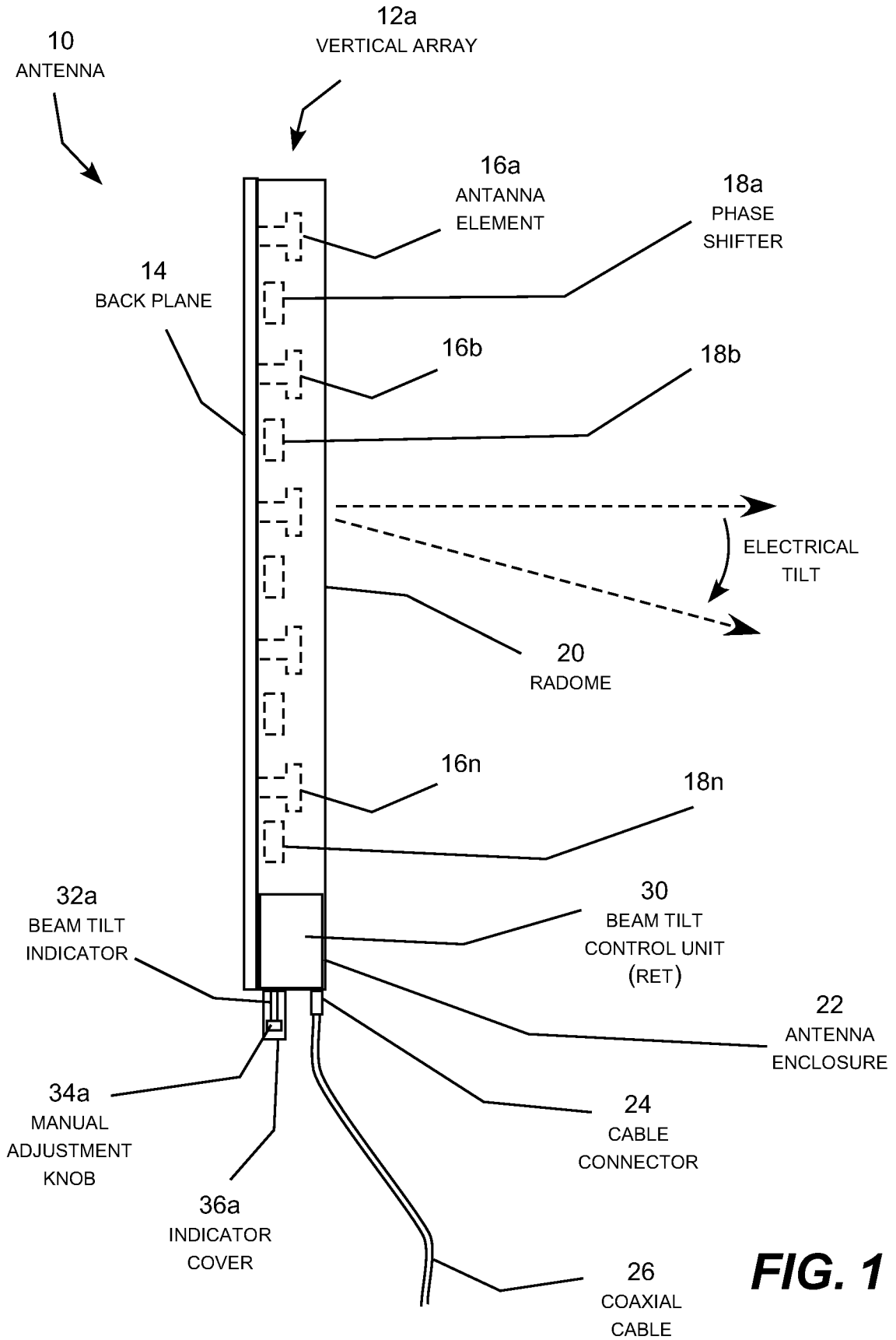
the tilt adjustment knob is connected to the control rod outside and proximate to the antenna enclosure;

the removable cover selectively attaches to the antenna enclosure to cover tilt adjustment knob;

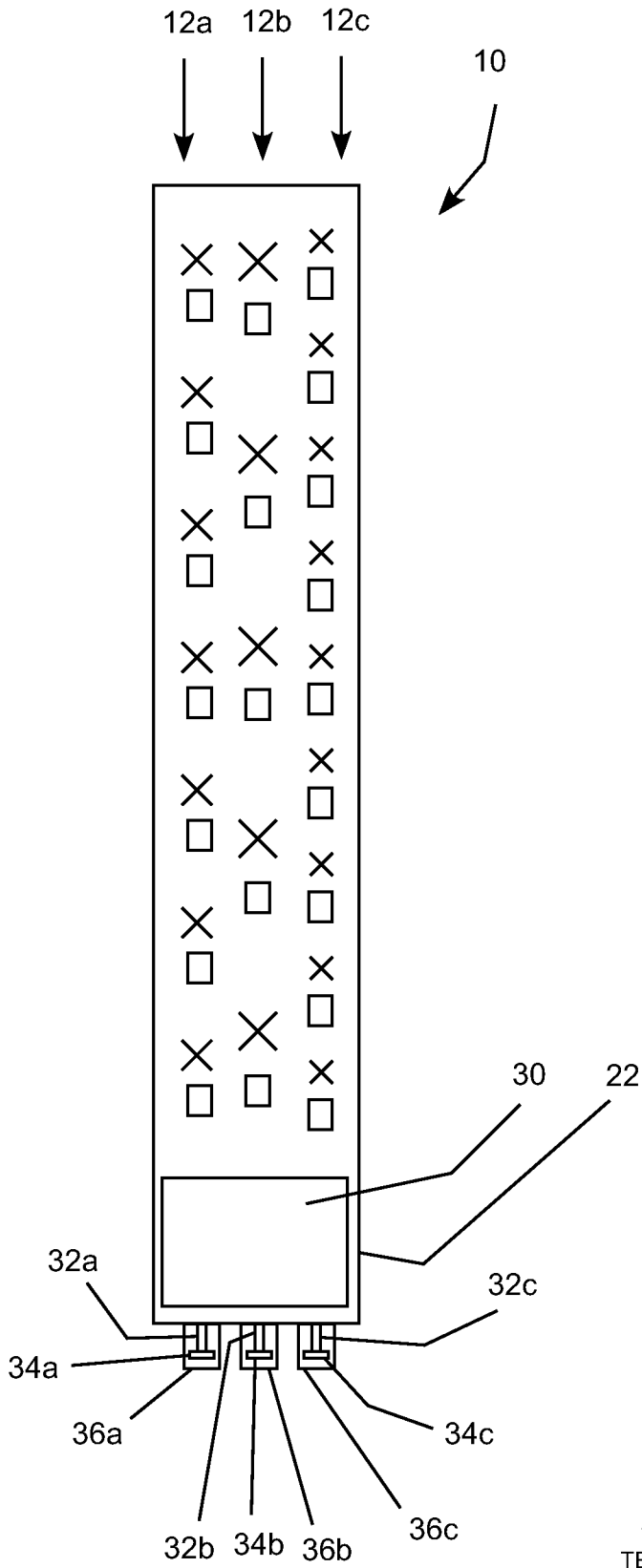
15 the removable cover comprises a collar configured to be manually inserted into the antenna enclosure to push the spring-loaded plunger mechanism against a spring bias of the mechanism to move the drive gear into engagement with the control gear when the cover is attached to the antenna enclosure; and

20 the spring-loaded plunger mechanism is configured to move under the spring bias of the mechanism to disengage the drive gear from the control gear when the collar of the removable cover is manually removed from the antenna enclosure.

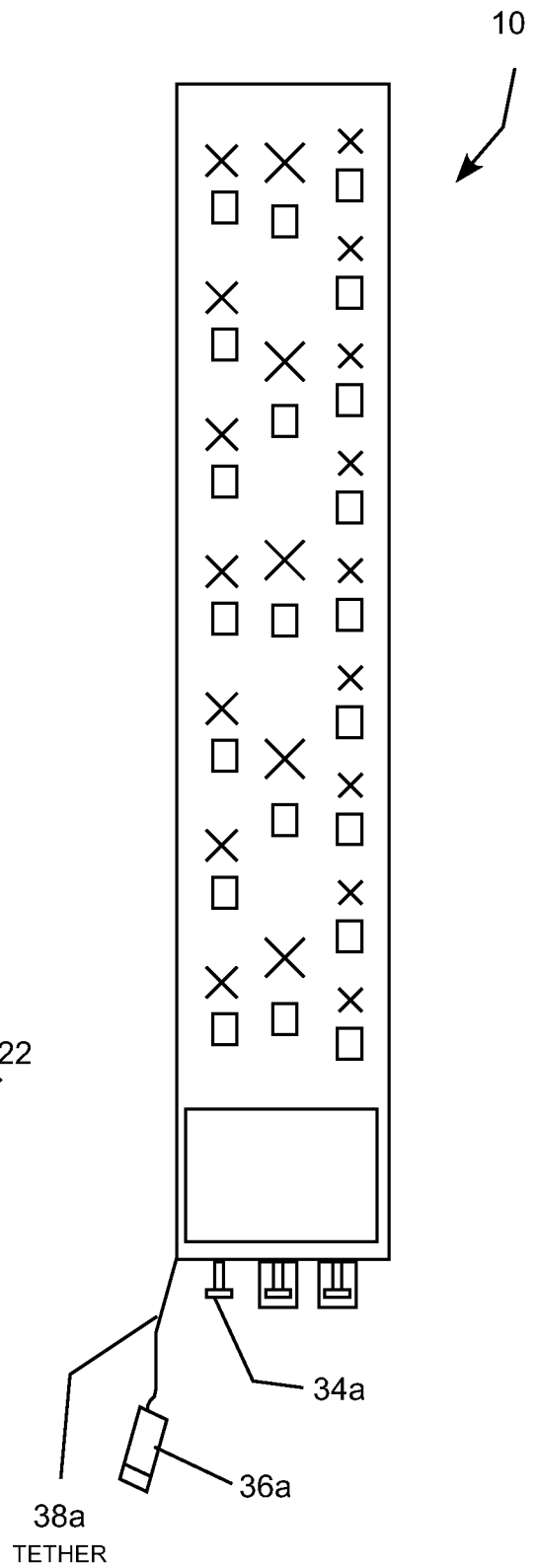
20. The antenna of claim 19, further comprising a tilt indicator operatively carried by the control rod located at least partially outside the antenna enclosure  
25 visually indicating a tilt setting associated with the beam propagation direction, wherein the removable cover comprises a sight tube permitting visual access to the tilt indicator when the removable cover is attached to the antenna enclosure and covering the tilt indicator.



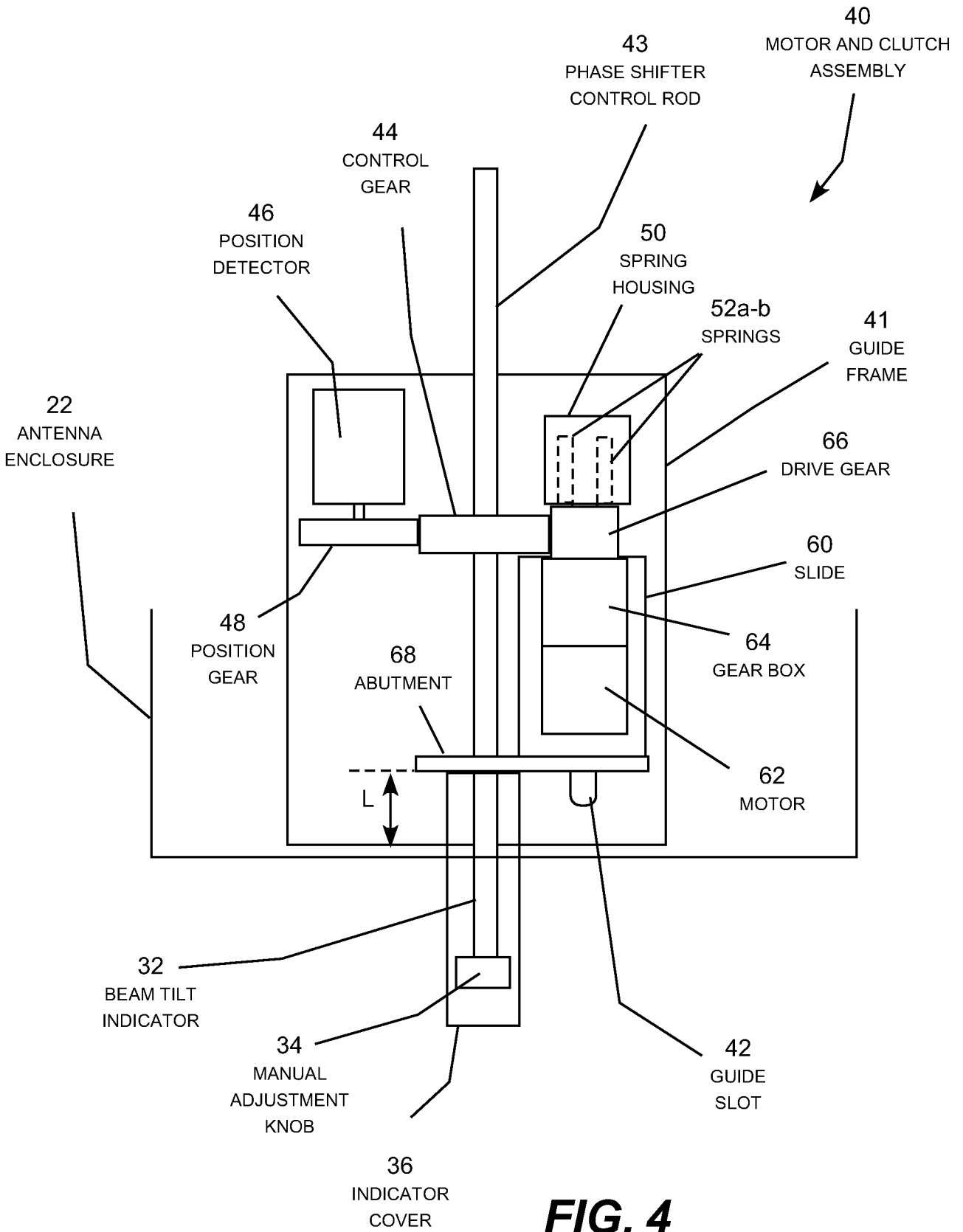
**FIG. 1**

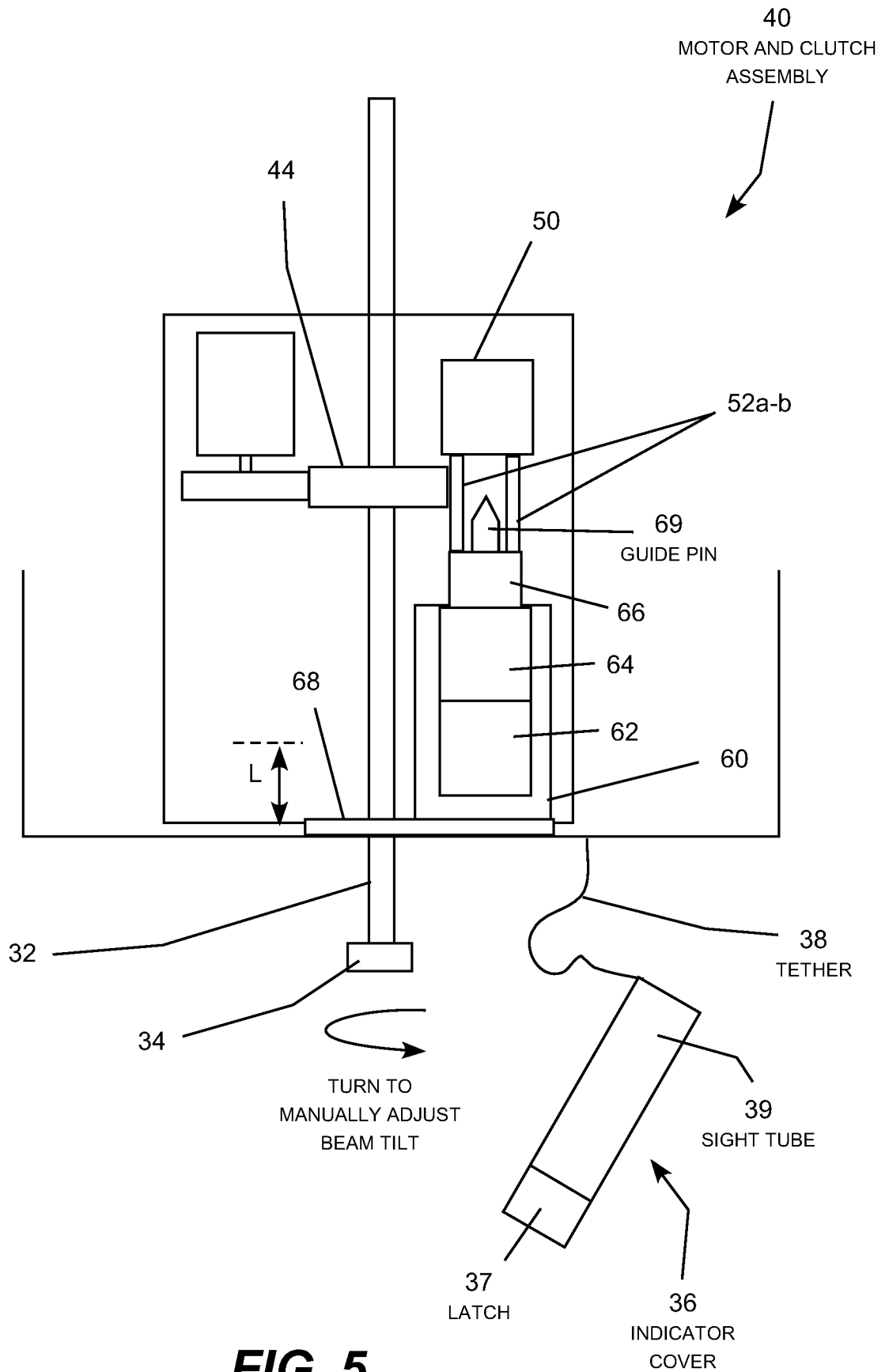


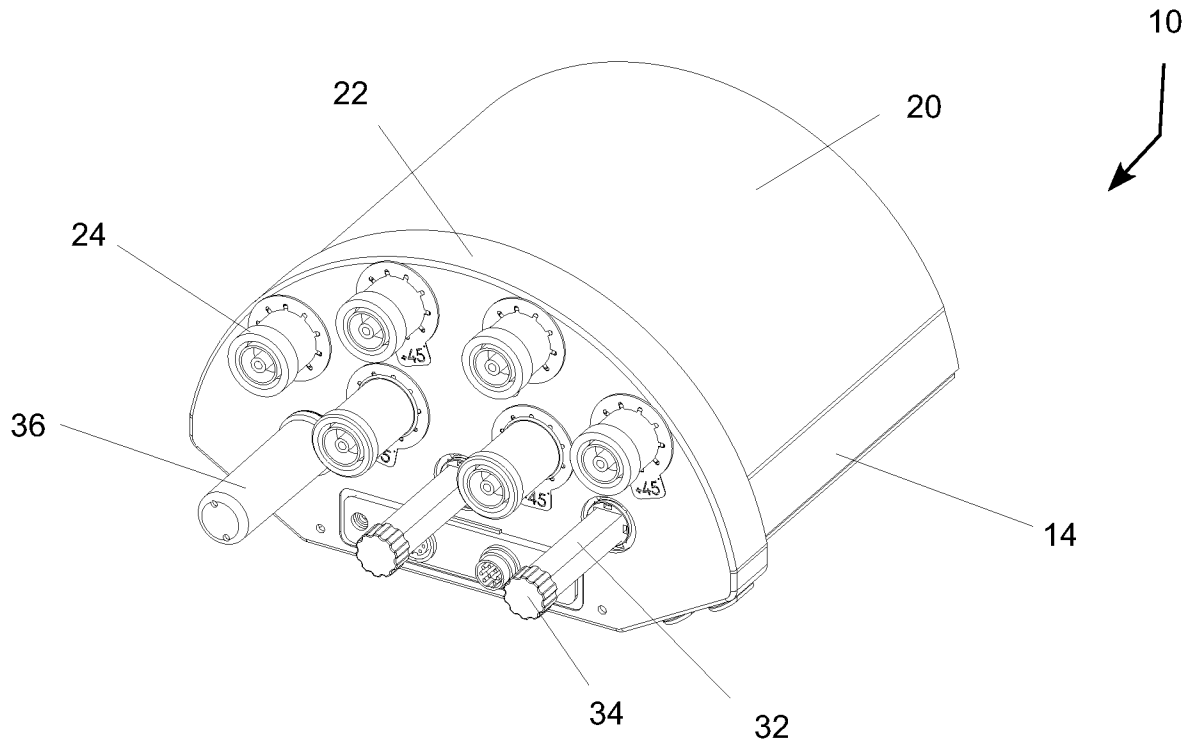
**FIG. 2**



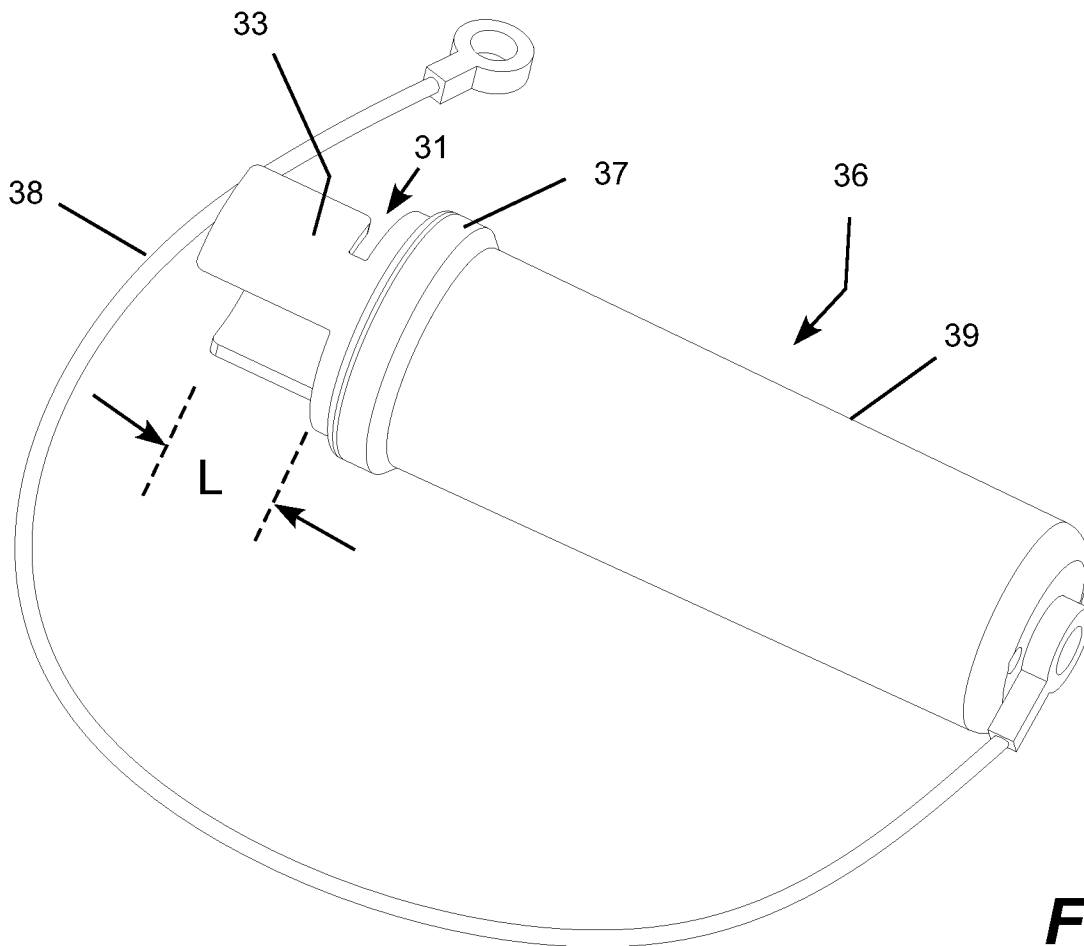
**FIG. 3**





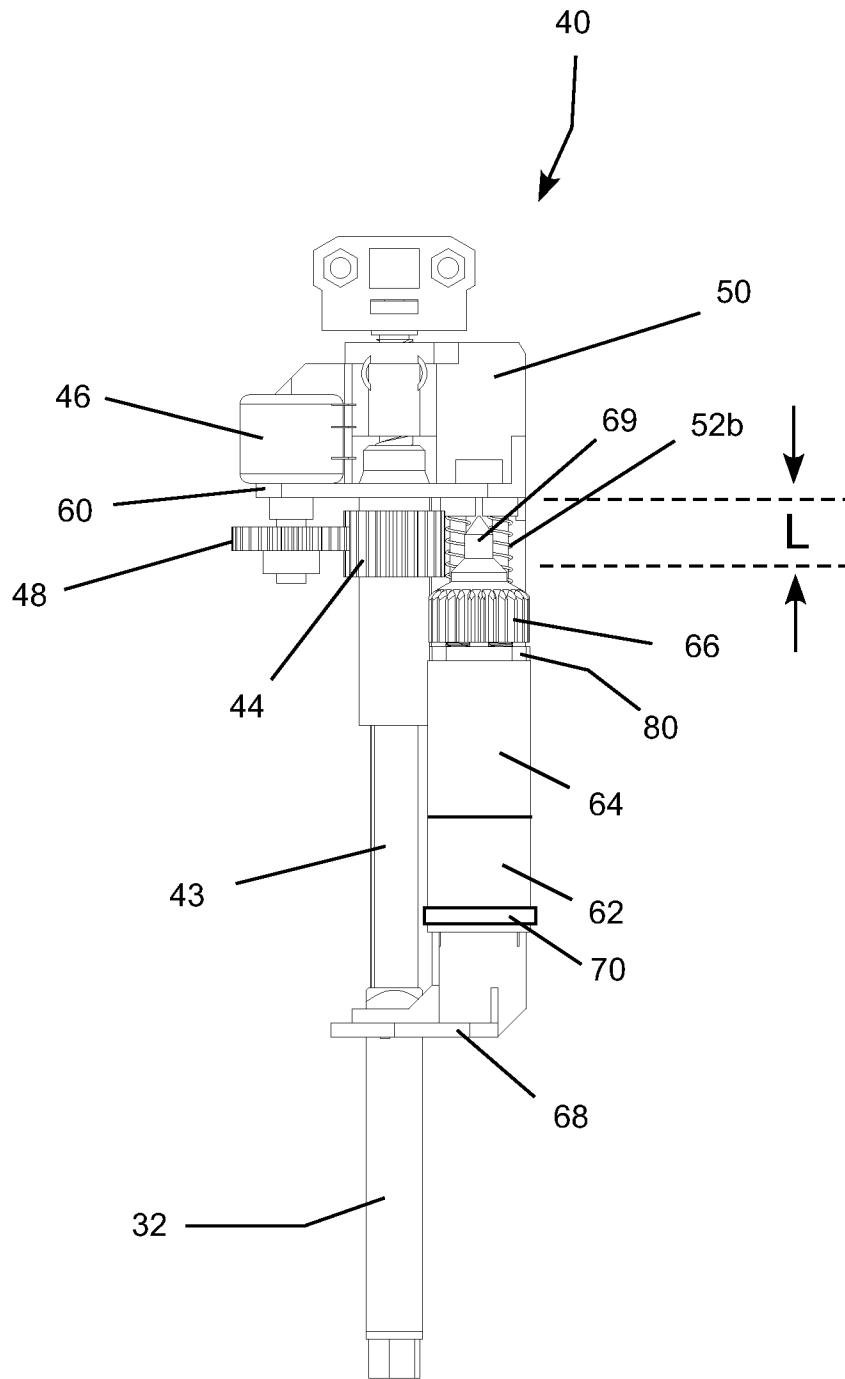


**FIG. 6**

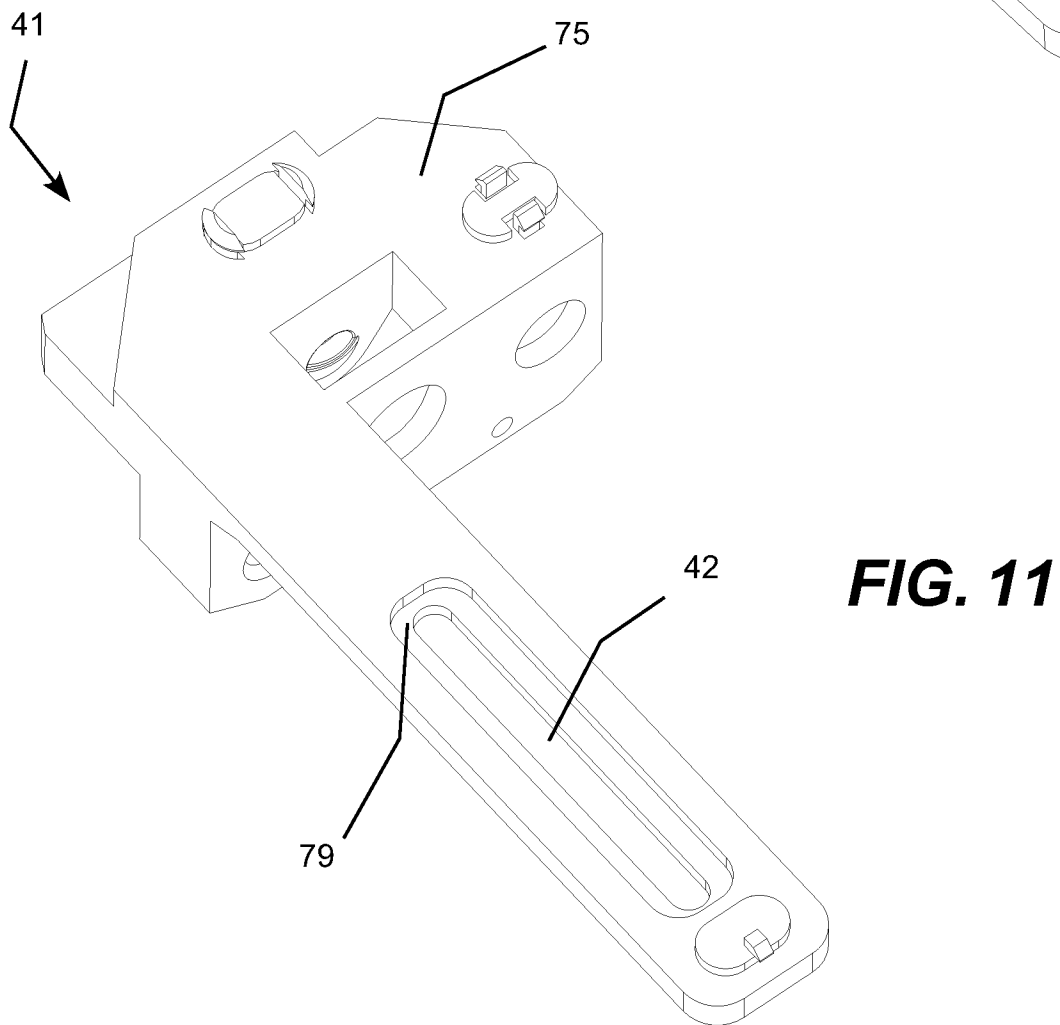
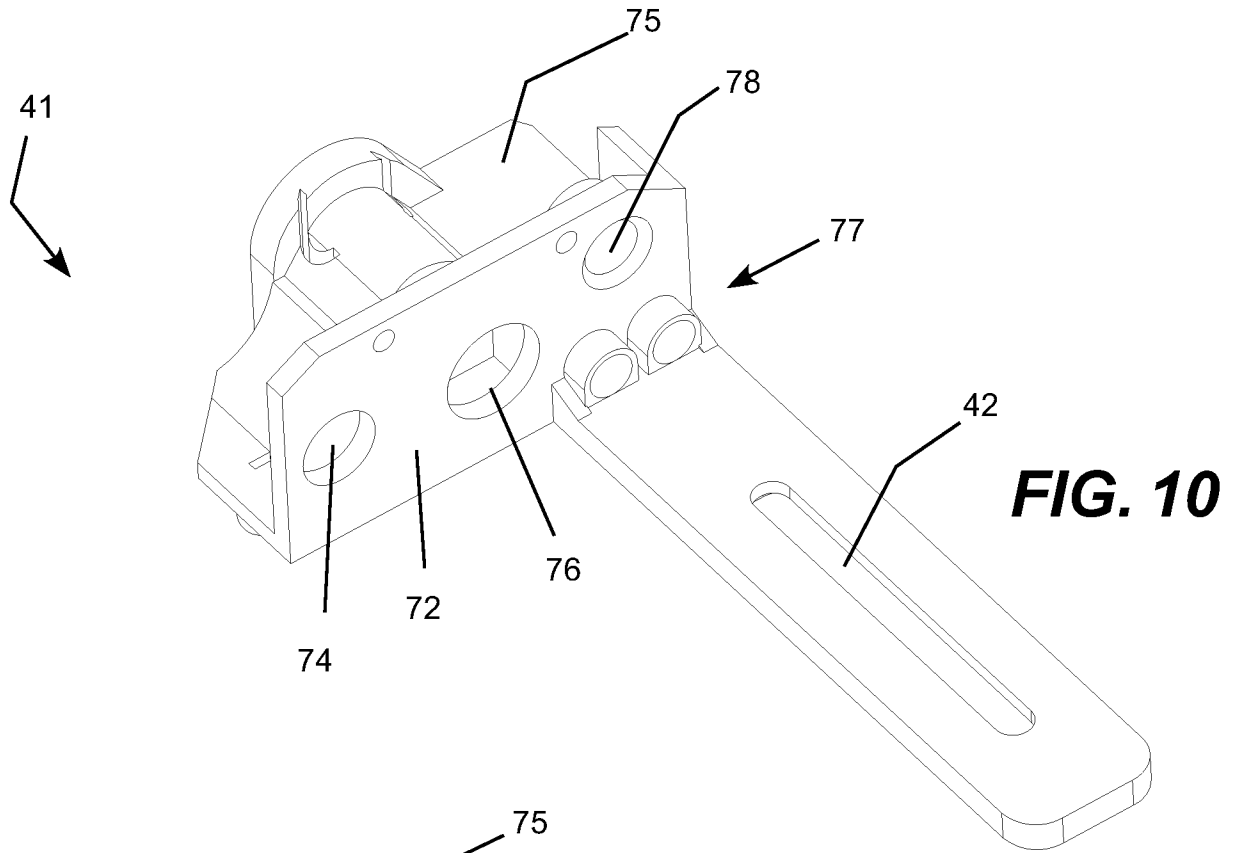


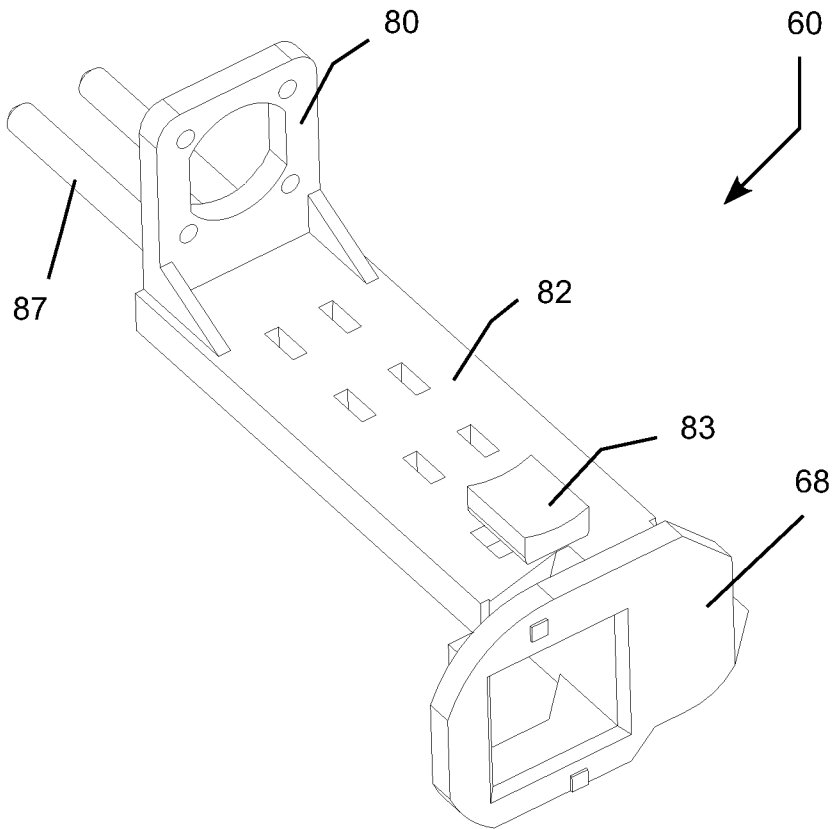
**FIG. 7**



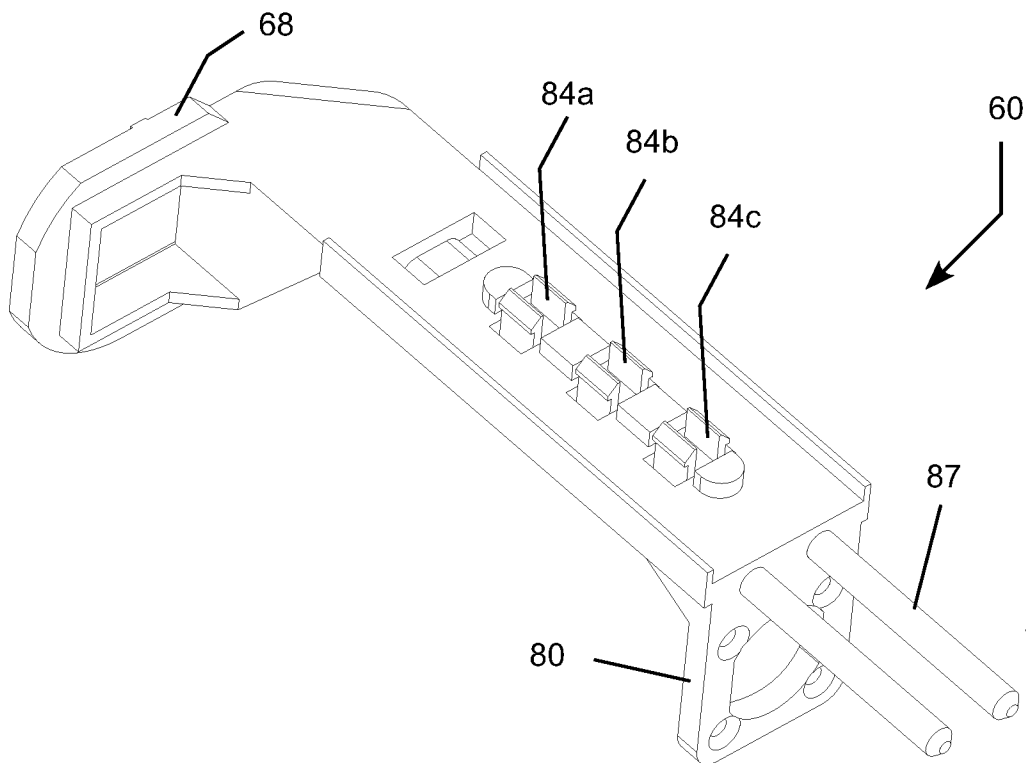


**FIG. 9**

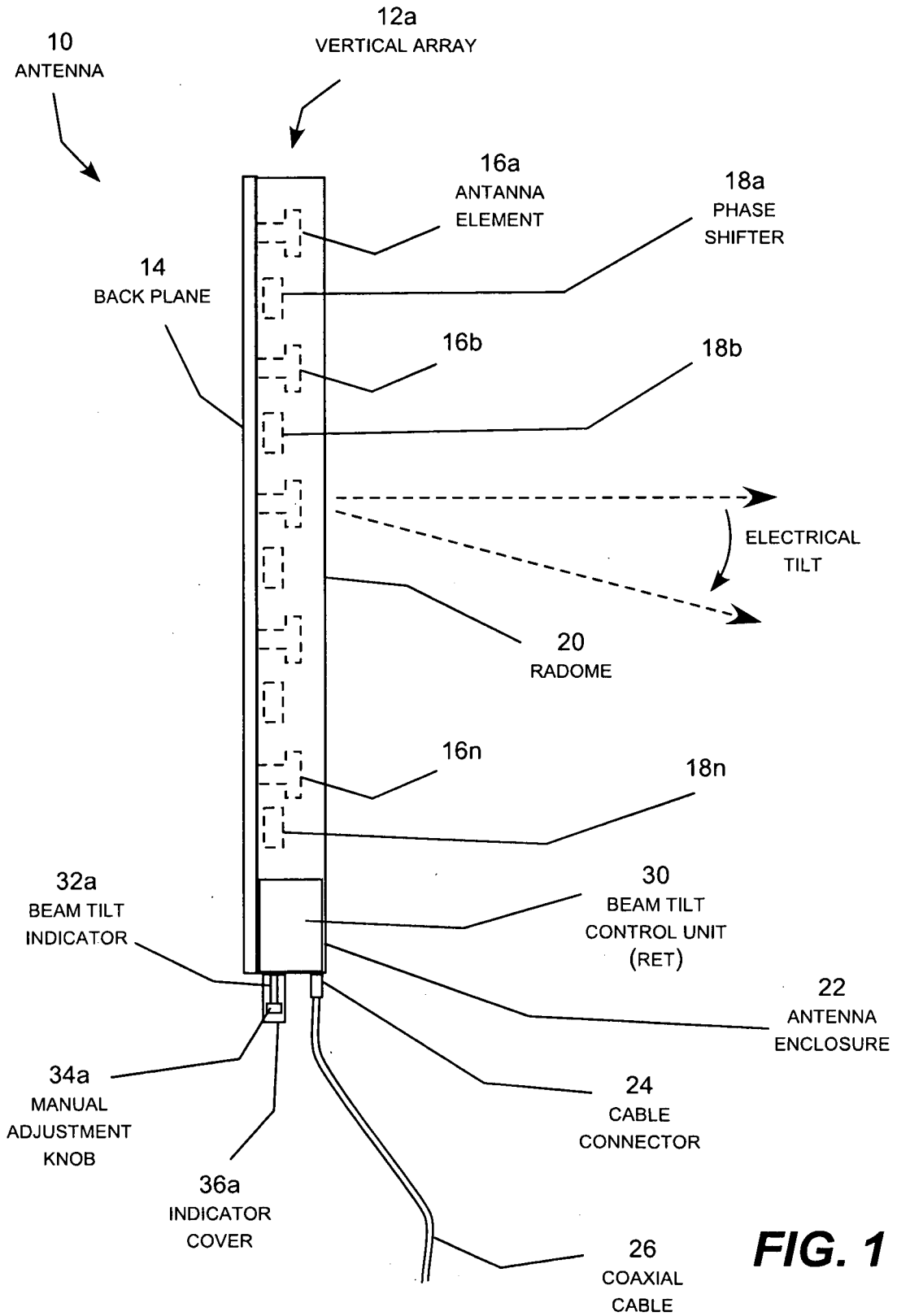


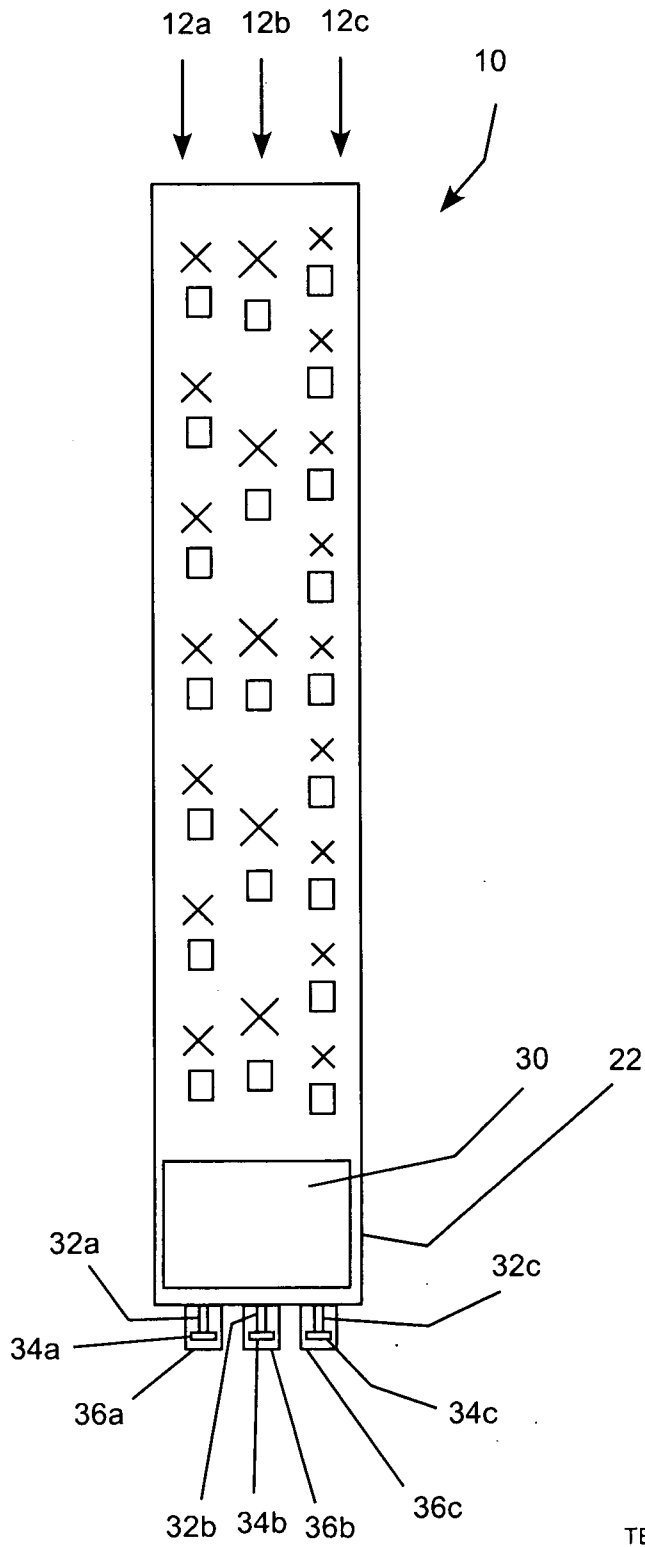


**FIG. 12**

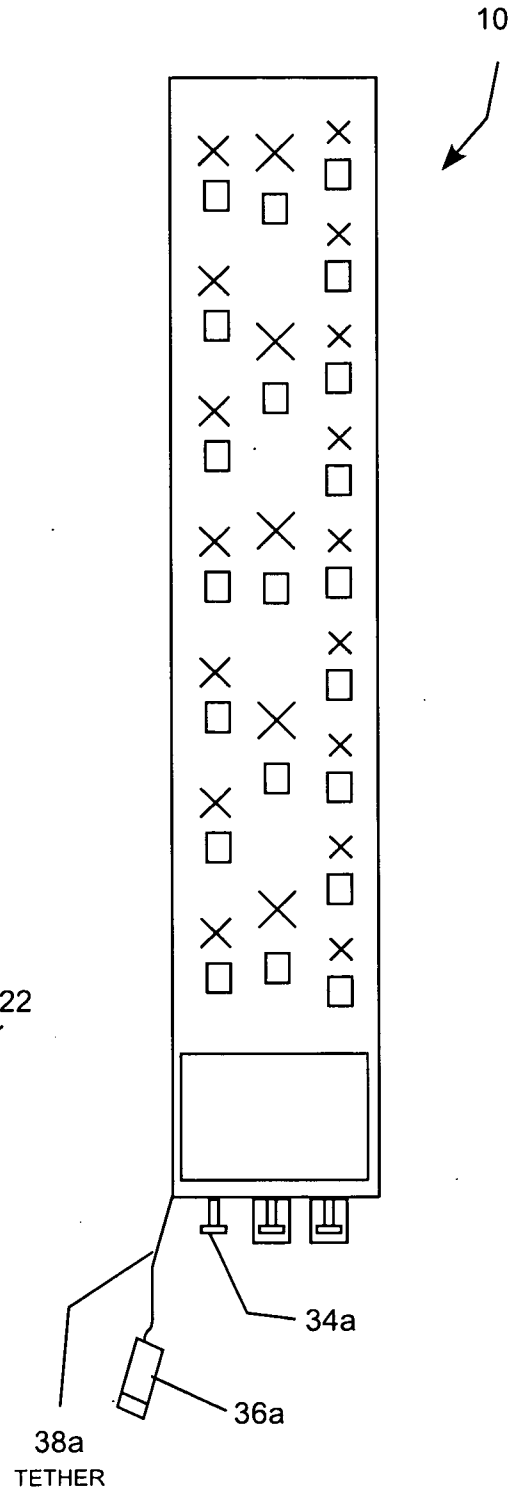


**FIG. 13**

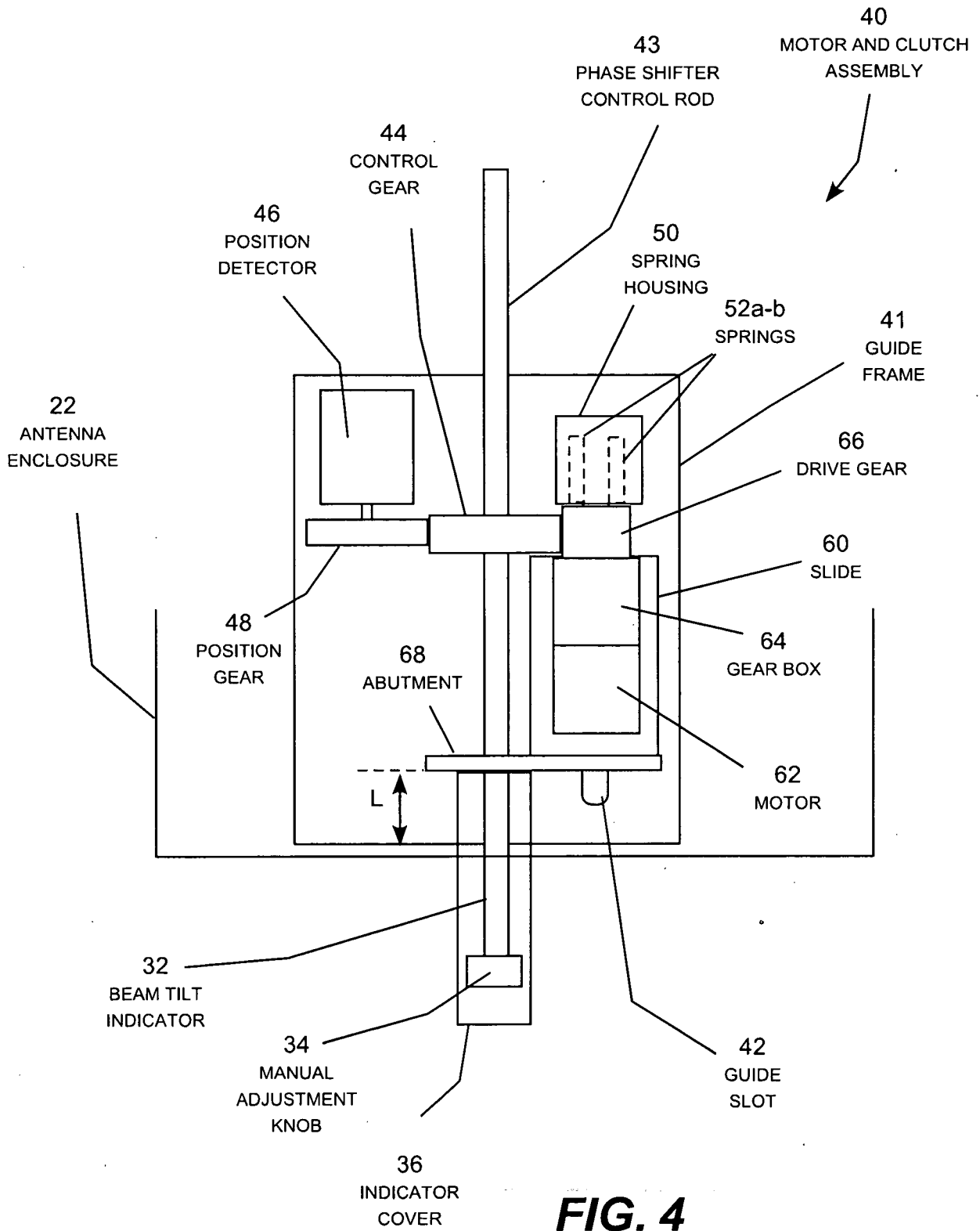


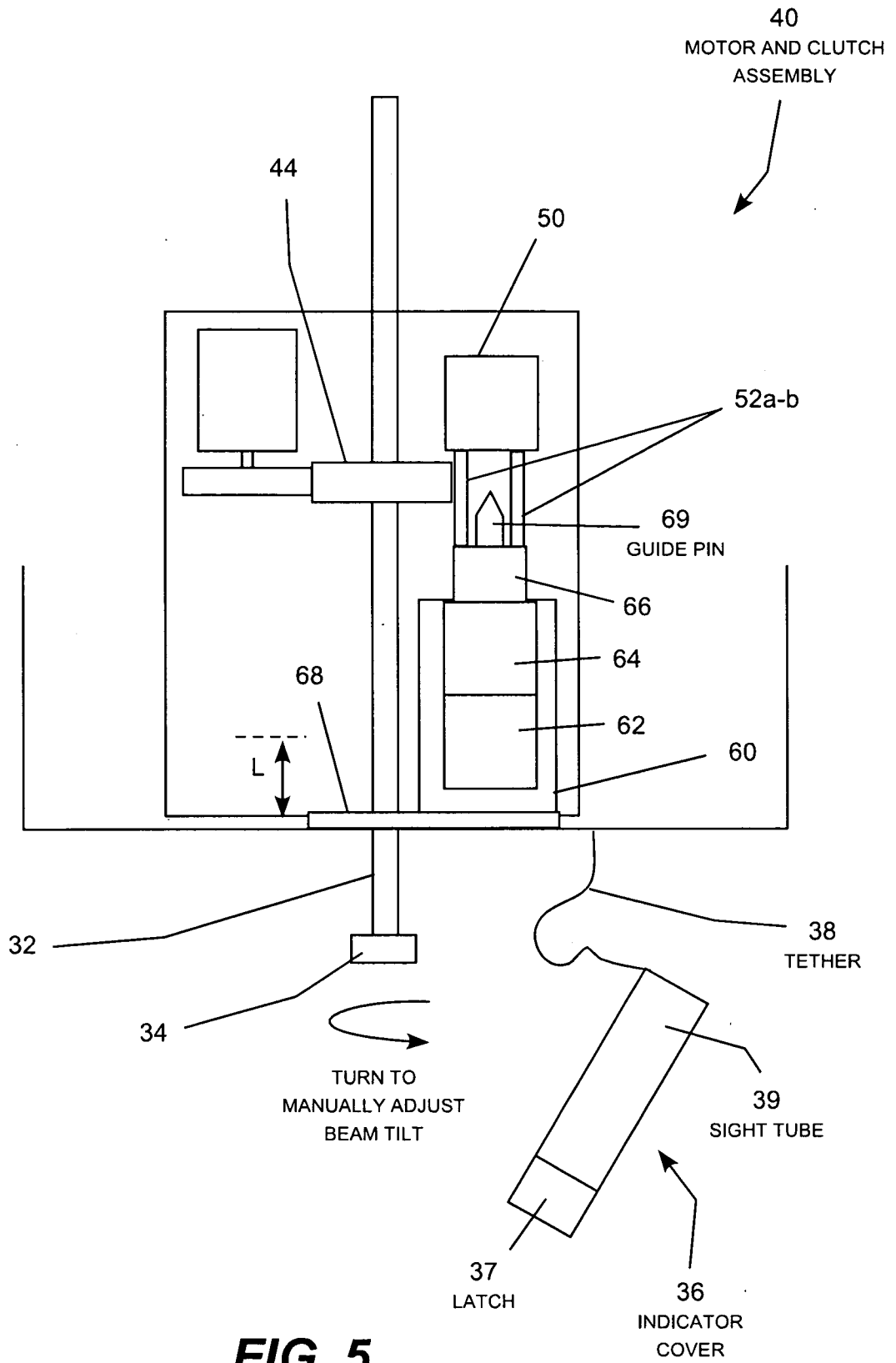


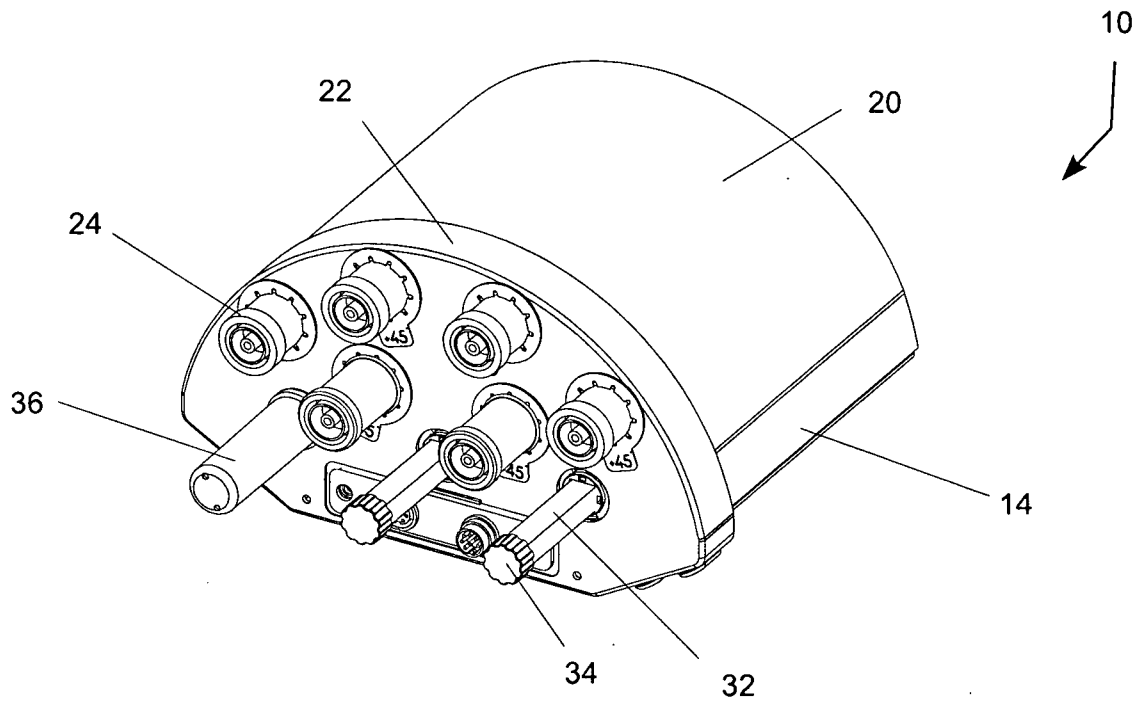
**FIG. 2**



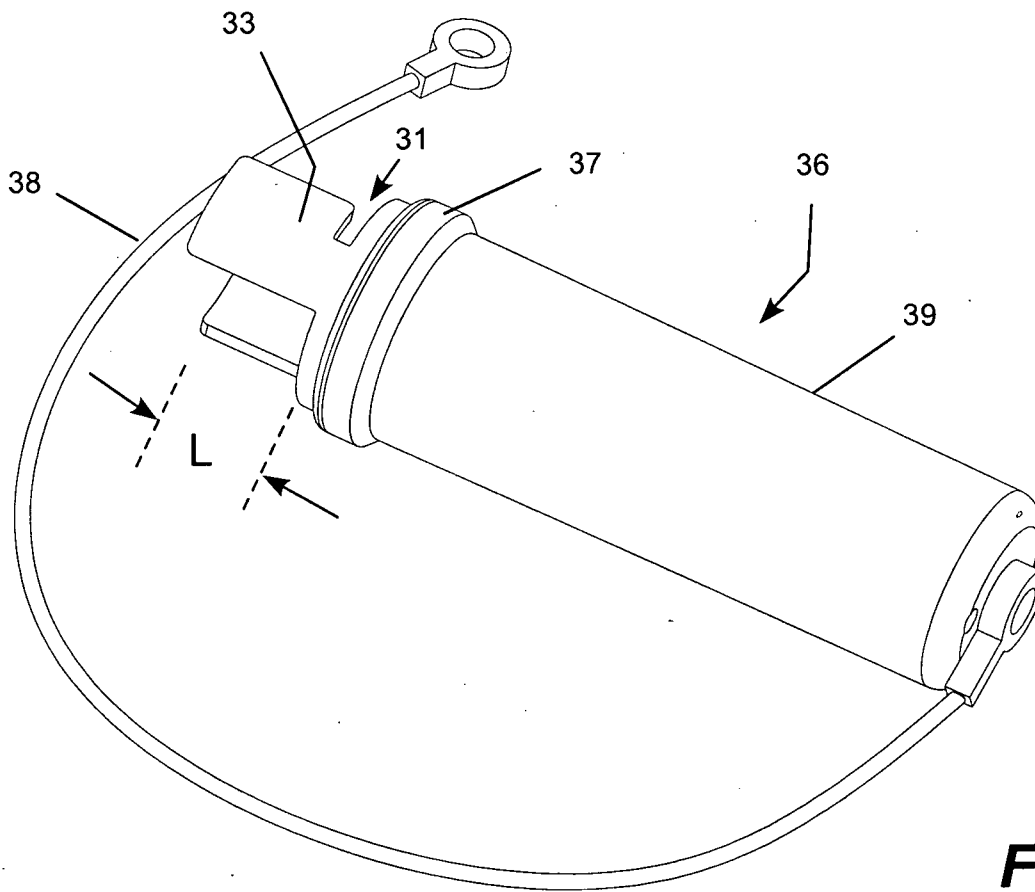
**FIG. 3**



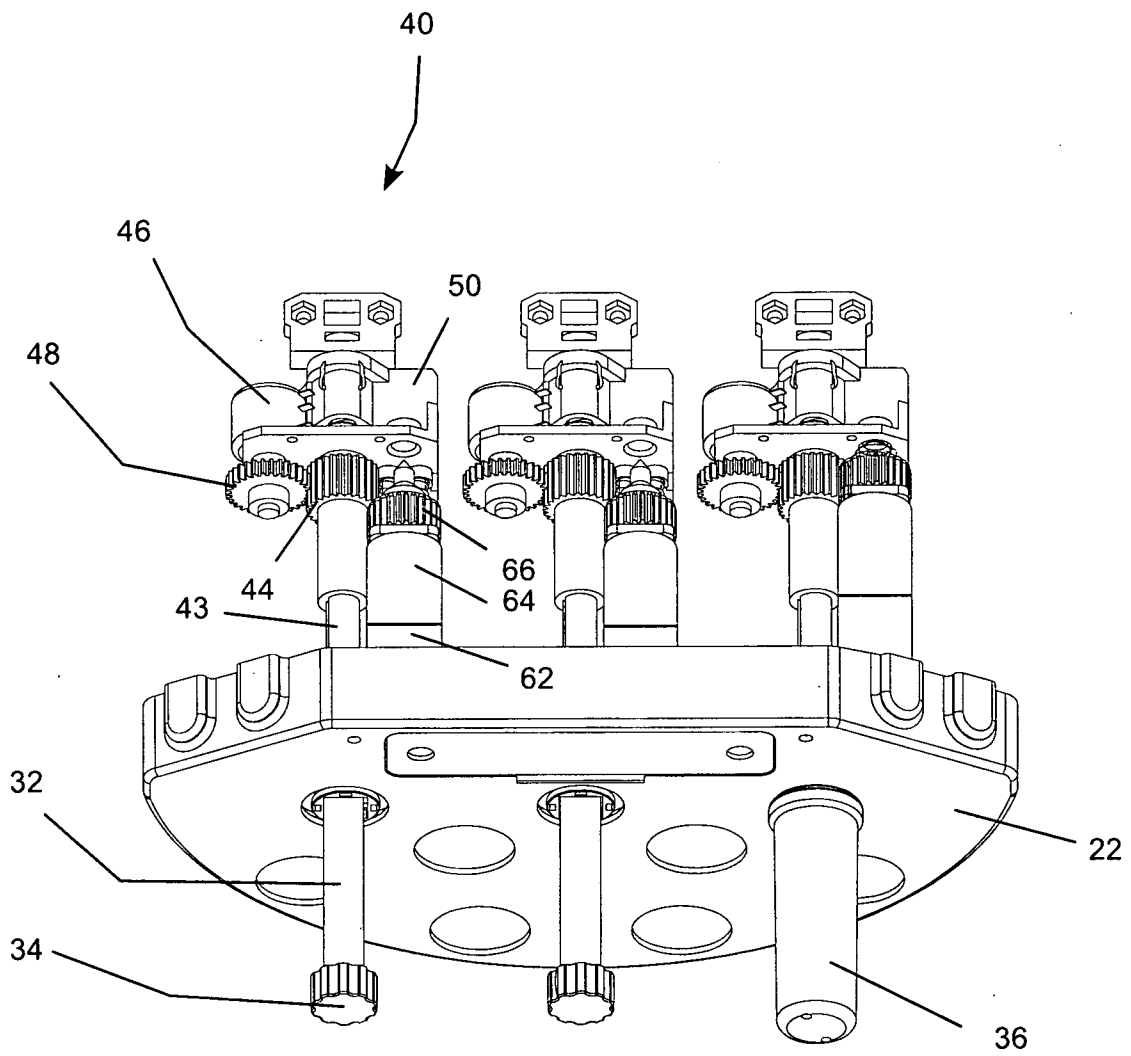




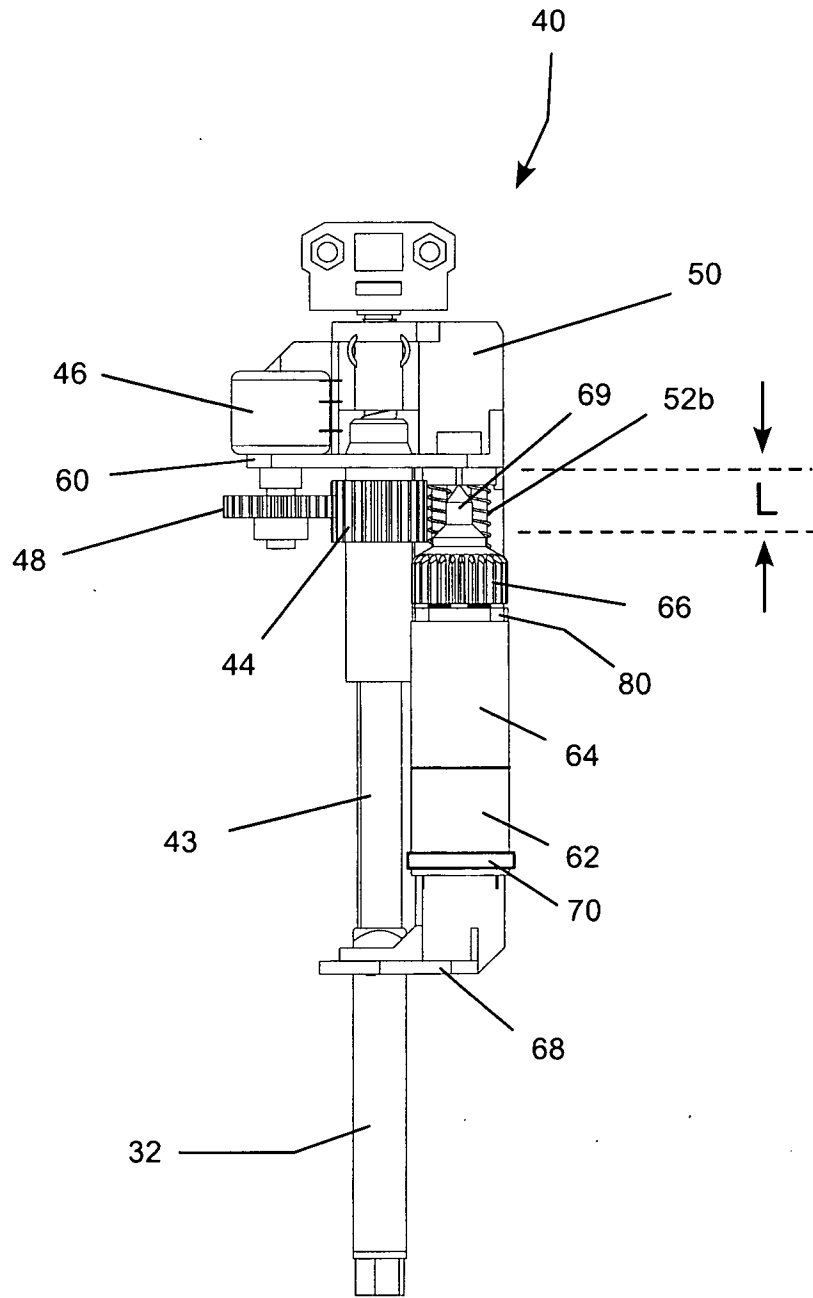
**FIG. 6**



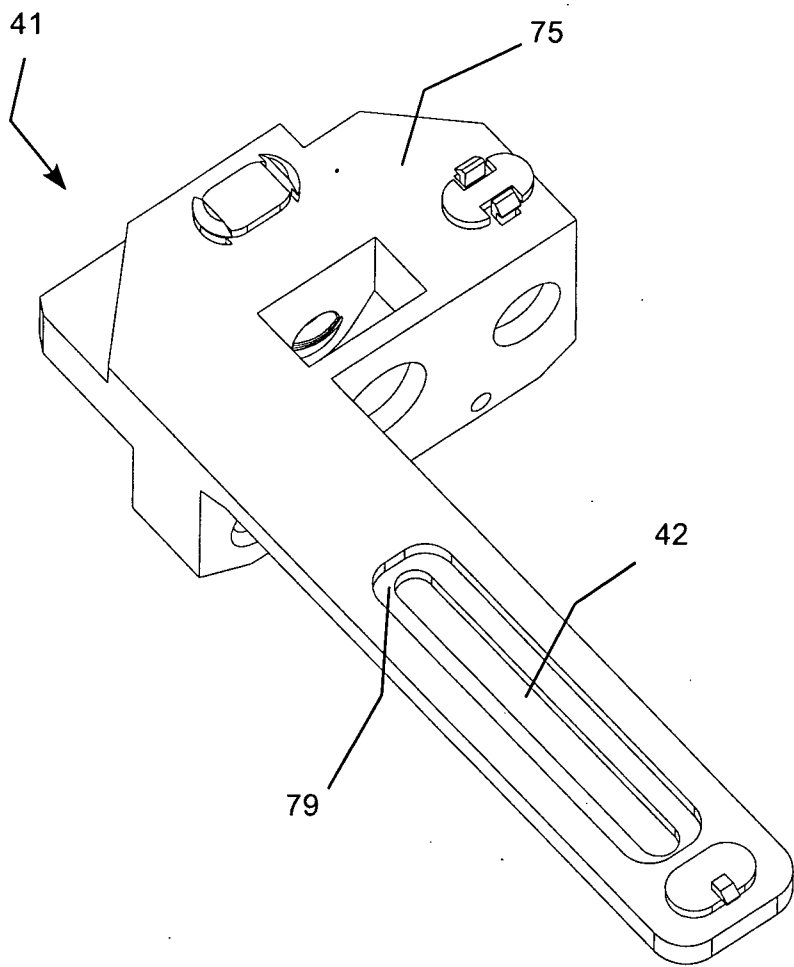
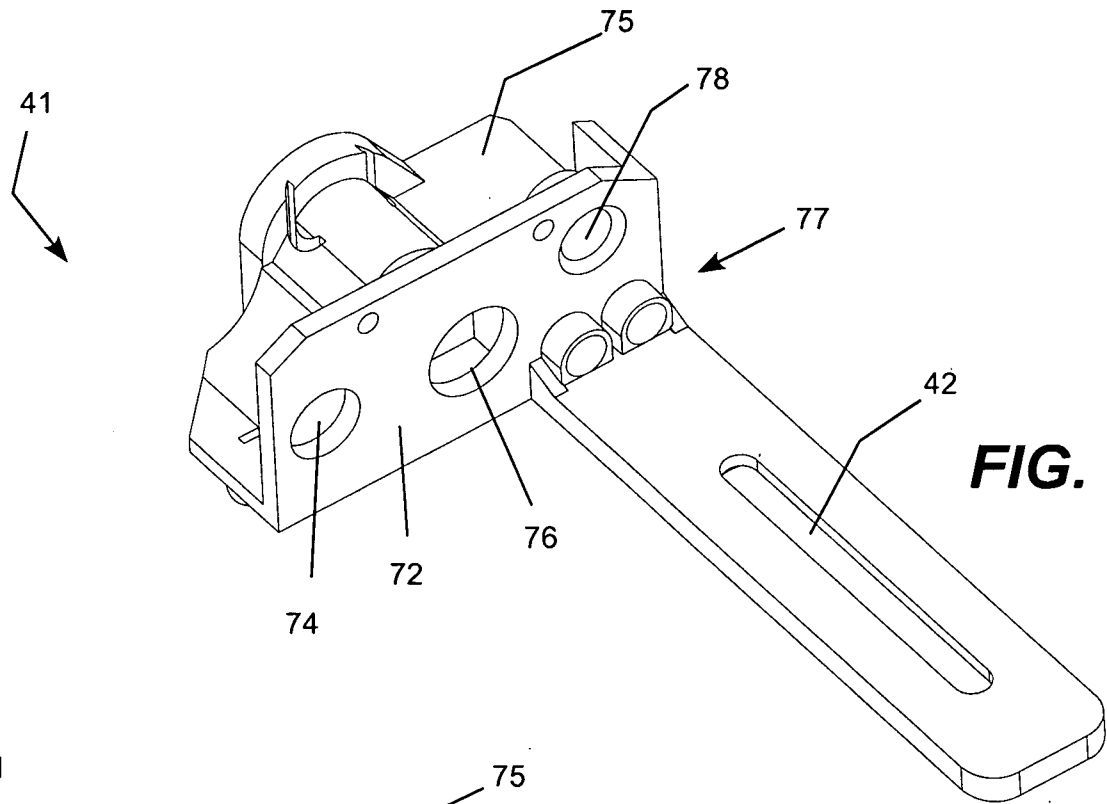
**FIG. 7**

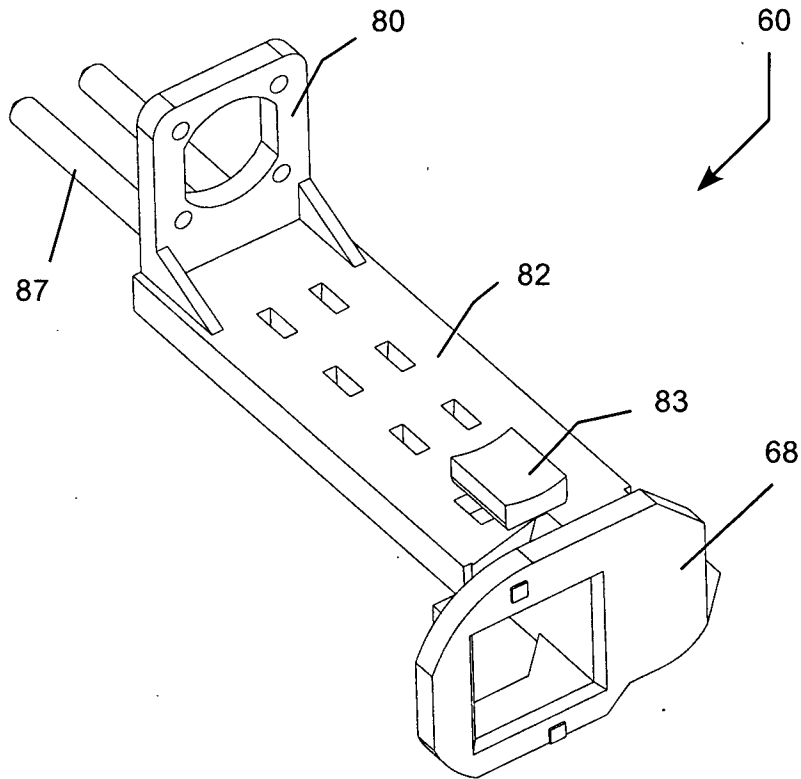


**FIG. 8**

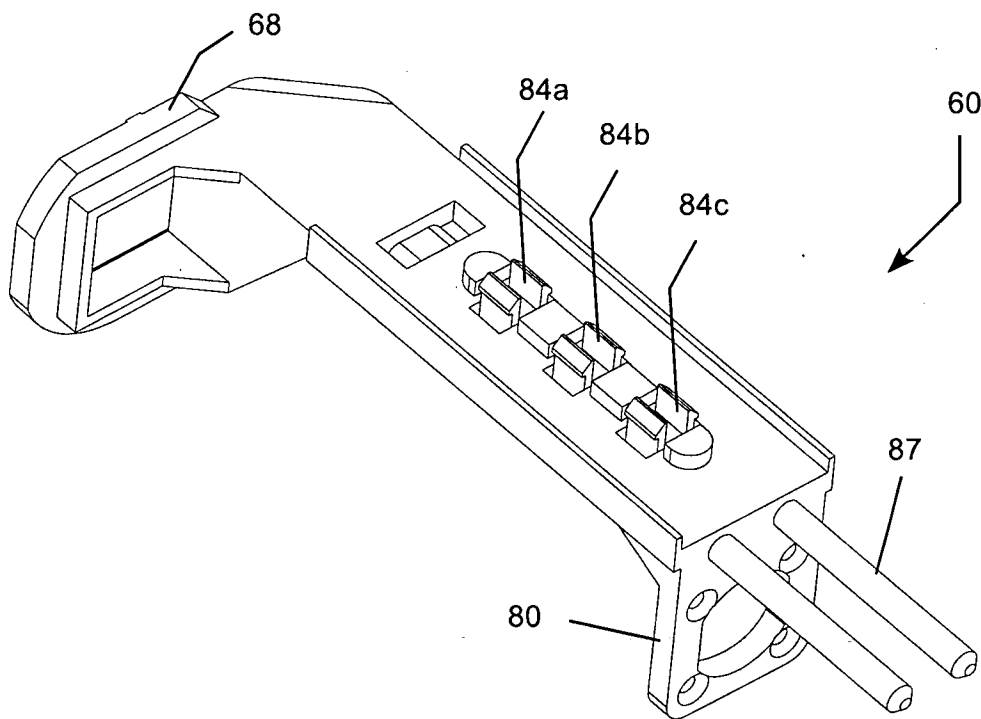


**FIG. 9**





**FIG. 12**



**FIG. 13**