

(19)



(11)

**EP 2 439 366 A3**

(12)

**EUROPEAN PATENT APPLICATION**

(88) Date of publication A3:  
**18.07.2012 Bulletin 2012/29**

(51) Int Cl.:  
**E05F 11/54<sup>(2006.01)</sup>** **E05B 17/00<sup>(2006.01)</sup>**  
**F25D 23/02<sup>(2006.01)</sup>**

(43) Date of publication A2:  
**11.04.2012 Bulletin 2012/15**

(21) Application number: **11183358.8**

(22) Date of filing: **29.09.2011**

(84) Designated Contracting States:  
**AL AT BE BG CH CY CZ DE DK EE ES FI FR GB GR HR HU IE IS IT LI LT LU LV MC MK MT NL NO PL PT RO RS SE SI SK SM TR**  
Designated Extension States:  
**BA ME**

(71) Applicant: **Dervet S.r.l.**  
**26025 Pandino (CR) (IT)**

(72) Inventor: **Milanesi, Paolo**  
**26020 MADIGNANO (CR) (IT)**

(30) Priority: **11.10.2010 IT MI20101850**

(74) Representative: **Ripamonti, Enrico**  
**Giambrocono & C. S.p.A.**  
**Via Rosolino Pilo, 19/B**  
**20129 Milano (IT)**

**(54) Device for opening sliding doors for cold rooms**

(57) The device (10) enables a cold room sliding door to be released from its closed position, and comprises: a bush (12) incorporated into the thickness of the door panel (56) and fixed to the door panel (56) such that its axis is perpendicular to this latter (56); a central shaft (20) coaxially inserted into the bush (12) to be able both to rotate about the axis of this latter (12) and to move along said axis; means (26, 24; 27, 24) for guiding the movement and rotation of the central shaft (20), which enable it to rotate in the direction compatible with the door opening direction; elastic return means (28) to bring the central shaft (20) into a position withdrawn outwards from the door panel (56) when left free to move coaxially; external means (44) for rotating the central shaft (20); internal means (46) for rotating the central shaft (20) and provided with a striker (54) adapted to come into contact with a fixed point. The bush (12) has a length less than the thickness of all or at least part of the door panels (56) of such doors, a ring cap (14) being provided coupleable coaxially to the bush (12) such that the bush (12)-ring cap (14) assembly has a length adapted to the thickness of the specific door panel (56).

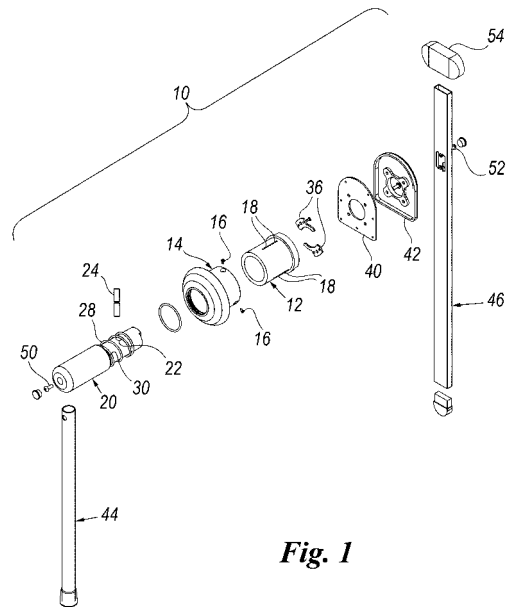

**Fig. 1**

**EP 2 439 366 A3**



EUROPEAN SEARCH REPORT

Application Number  
EP 11 18 3358

DOCUMENTS CONSIDERED TO BE RELEVANT			
Category	Citation of document with indication, where appropriate, of relevant passages	Relevant to claim	CLASSIFICATION OF THE APPLICATION (IPC)
A	DE 27 58 521 A1 (MARKUS HERMETISCHE DEUREN) 5 July 1979 (1979-07-05) * page 4, line 5 - line 12; figure 1 * -----	1	INV. E05F11/54 E05B17/00 F25D23/02
			TECHNICAL FIELDS SEARCHED (IPC)
			E05F E05B F25D
The present search report has been drawn up for all claims			
Place of search The Hague		Date of completion of the search 6 June 2012	Examiner Guillaume, Geert
<b>CATEGORY OF CITED DOCUMENTS</b> X : particularly relevant if taken alone Y : particularly relevant if combined with another document of the same category A : technological background O : non-written disclosure P : intermediate document		T : theory or principle underlying the invention E : earlier patent document, but published on, or after the filing date D : document cited in the application L : document cited for other reasons ..... & : member of the same patent family, corresponding document	

1  
EPO FORM 1503 03.82 (P04C01)

**ANNEX TO THE EUROPEAN SEARCH REPORT  
ON EUROPEAN PATENT APPLICATION NO.**

EP 11 18 3358

This annex lists the patent family members relating to the patent documents cited in the above-mentioned European search report. The members are as contained in the European Patent Office EDP file on  
The European Patent Office is in no way liable for these particulars which are merely given for the purpose of information.

06-06-2012

Patent document cited in search report	Publication date	Patent family member(s)	Publication date
DE 2758521	A1	05-07-1979	NONE
-----			

EPO FORM P0459

For more details about this annex : see Official Journal of the European Patent Office, No. 12/82