



(51) International Patent Classification:
B29C 39/10 (2006.01)

(21) International Application Number:
PCT/US2013/050026

(22) International Filing Date:
11 July 2013 (11.07.2013)

(25) Filing Language: English

(26) Publication Language: English

(30) Priority Data:
13/547,331 12 July 2012 (12.07.2012) US

(71) Applicant: **BIOMET MANUFACTURING, LLC**
[US/US]; 56 E. Bell Dr., Warsaw, Indiana 46582 (US).

(72) Inventors: **SMITH, Daniel B.**; 2489 South Paxton Drive,
Warsaw, Indiana 46580 (US). **SCHINDLER, Katie M.**;
3327 Buckeye Run, Fort Wayne, Indiana 46814 (US).
CUNNINGHAM, Grant; 3416 S. Wildwood Trail,
Warsaw, Indiana 46580 (US).

(74) Agents: **SUTER, David L.** et al.; Harness, Dickey &
Pierce, P.L.C., P.O. Box 828, Bloomfield Hills, Michigan
48303 (US).

(81) Designated States (unless otherwise indicated, for every
kind of national protection available): AE, AG, AL, AM,
AO, AT, AU, AZ, BA, BB, BG, BH, BN, BR, BW, BY,
BZ, CA, CH, CL, CN, CO, CR, CU, CZ, DE, DK, DM,

DO, DZ, EC, EE, EG, ES, FI, GB, GD, GE, GH, GM, GT,
HN, HR, HU, ID, IL, IN, IS, JP, KE, KG, KN, KP, KR,
KZ, LA, LC, LK, LR, LS, LT, LU, LY, MA, MD, ME,
MG, MK, MN, MW, MX, MY, MZ, NA, NG, NI, NO, NZ,
OM, PA, PE, PG, PH, PL, PT, QA, RO, RS, RU, RW, SC,
SD, SE, SG, SK, SL, SM, ST, SV, SY, TH, TJ, TM, TN,
TR, TT, TZ, UA, UG, US, UZ, VC, VN, ZA, ZM, ZW.

(84) Designated States (unless otherwise indicated, for every
kind of regional protection available): ARIPO (BW, GH,
GM, KE, LR, LS, MW, MZ, NA, RW, SD, SL, SZ, TZ,
UG, ZM, ZW), Eurasian (AM, AZ, BY, KG, KZ, RU, TJ,
TM), European (AL, AT, BE, BG, CH, CY, CZ, DE, DK,
EE, ES, FI, FR, GB, GR, HR, HU, IE, IS, IT, LT, LU, LV,
MC, MK, MT, NL, NO, PL, PT, RO, RS, SE, SI, SK, SM,
TR), OAPI (BF, BJ, CF, CG, CI, CM, GA, GN, GQ, GW,
KM, ML, MR, NE, SN, TD, TG).

Declarations under Rule 4.17:

- as to applicant's entitlement to apply for and be granted a
patent (Rule 4.17(ii))
- as to the applicant's entitlement to claim the priority of the
earlier application (Rule 4.17(iii))

Published:

- without international search report and to be republished
upon receipt of that report (Rule 48.2(g))

(54) Title: DEVICE FOR COATING INTRAMEDULLARY RODS WITH CEMENT

(57) Abstract: A mold for forming a coated intramedullary (IM) nail can include a tubular member having an insertion end and an opposite end. The tubular member can comprise a sidewall extending along a longitudinal axis between an outer surface and an inner surface. The sidewall can define at least one threaded inlet port therealong. The tubular member can be configured to receive the IM nail therein. The tubular member can be further configured to locate a flowable material against the IM nail within the inner surface.



DEVICE FOR COATING INTRAMEDULLARY RODS WITH CEMENT

INTRODUCTION

[0001] The present technology relates generally to cement coated rods and
5 more specifically to a mold and related method for coating intramedullary (IM) rods with
an antibiotic-loaded hardenable material.

[0002] In some instances during treatment of fractures on various long bones,
such as diaphyseal fractures of the femur, tibia, and humerus bones, it may be desirable
to introduce a longitudinal rod or nail through the IM canal of the bone to assist in
10 stabilizing long bones during bone healing. In these instances, it also may be desirable to
provide an IM nail that is coated with antibiotic-loaded cement to assist in treatment or
prevention of infection. The IM nail can have an elongated metallic member that
includes one or more cylindrical cavities that can be perpendicular to the long axis of the
IM nail for receiving a fastener element, such as a transcortical screw. The IM nail can
15 be positioned within the medullary cavity and can be secured to the proximal and distal
fracture segments using transcortical screws, which penetrate both cortices of the bone,
as well as pass through the cylindrical cavities formed in the IM nail.

[0003] In some cases, it can be challenging to produce an IM nail having an
antibiotic-loaded cement coating. In some known examples, antibiotic-loaded cement
20 can be introduced into an open end of a tube and an IM nail can be subsequently
introduced into the tube. Once the antibiotic-loaded cement cures, the tube can be
removed. This configuration and method can be unfavorable to a user as the flowable
cement can be quite viscous. In this regard, filling a relatively long tube with such
material can be difficult. In examples where the tube is formed of a relatively thin-
25 walled elastomeric material, filling the tube can become more difficult as the tubing may
expand during the introduction of the cement. In this regard, cement may be inhibited
from flowing down the length of the tube. In other examples, the tubing may expand
during the delivery stroke, and then contract, allowing cement to flow back into the
cement delivery device between delivery strokes. In examples where the flowable
30 material is introduced into the tube before insertion of the IM rod, the insertion of the IM
rod can be uncontrolled and generally messy as the cement out of the tube and/or can
easily flow onto parts of the IM rod where it is undesired.

SUMMARY

[0004] This section provides a general summary of the disclosure, and is not a comprehensive disclosure of its full scope or all of its features.

[0005] A mold for forming a coated intramedullary (IM) nail can include a tubular member having an insertion end and an opposite end. The tubular member can comprise a sidewall extending along a longitudinal axis between an outer surface and an inner surface. The sidewall can define at least one threaded inlet port therealong. The tubular member can be configured to receive the IM nail therein. The tubular member can be further configured to locate a flowable material against the IM nail and the inner surface of the tubular member.

[0006] According to additional features, the inner surface of the tubular member can comprise at least one inwardly and radially extending protrusion. In other features, the inner surface can comprise three inwardly extending protrusions radially spaced substantially equally to each other on the inner surface. The protrusions can extend substantially along the length of the tubular member between the insertion end and an opposite end.

[0007] According to other features, the protrusions can each include longitudinally spaced nibs extending inwardly toward the longitudinal axis. Each nib can have a nail engaging surface configured to engage the nail and offset the nail inwardly along the longitudinal axis and spaced from a remainder of the protrusion. The opposite end of the tubular member can be closed and define a concave surface. The tubular member can further comprise a first inlet port formed through the sidewall and configured to accept the flowable material therethrough. The first inlet port can comprise a threaded port extending outwardly from the outer surface.

[0008] According to still other features, the tubular member can further comprise a plurality of threaded inlet ports spaced from each other and formed through the sidewall configured to accept flowable material therethrough. The sidewall can comprise a plurality of vent holes therealong. The plurality of vent holes can comprise at least one distinct row of vent holes formed longitudinally along the sidewall. According to one configuration, the plurality of vent holes can comprise at least two distinct rows of vent holes, each row radially spaced between two adjacent protrusions. According to one configuration, the mold can be transparent. In one example, the mold can be

flexible. In one configuration, the mold can be cuttable. The mold can be formed of a material that releases from cured flowable material. The material can comprise silicone. In some examples, the silicone can be reinforced silicone. In one configuration, the mold can further comprise a pull member disposed on the tubular member. The pull member
5 can be configured to influence formation of a slit or cut on the tubular member upon pulling for removing the tubular member subsequent to curing of the flowable material. A sheath can be configured to be disposed onto the IM nail and inhibit introduction of the flowable material into the IM nail.

[0009] A method of coating an intramedullary (IM) nail with flowable
10 material can include, advancing the IM nail into a tubular member from an insertion end of the tubular member toward an opposite end of the tubular member. The flowable material can be advanced through a first port defined through a sidewall at a first location on the tubular member. Subsequent to curing of the flowable material, the tubular member can be removed from the IM nail having the cured flowable material thereon.

[0010] The method can further comprise advancing the flowable material
15 through a second port through the sidewall at a second location, distinct from the first location, on the tubular member. According to other features, the method can further comprise observing the flowable material advancing within the tubular member. The advancing of the flowable material can be stopped through the first port based on the
20 flowable material advancing substantially toward the second port.

[0011] According to other features, the method can further comprise slidably
translating the IM nail along at least two longitudinally extending protrusions formed on the inner cylindrical surface of the sidewall. The method can further comprise coupling a flowable material delivery device to a boss formed on the tubular member proximate to
25 the first port. In one example, coupling can include one of threadably coupling, luer lock coupling, and nozzle coupling the flowable material delivery device to the tubular member. According to additional features, advancing the IM nail can comprise advancing the IM nail into the tubular member until a distal end of the IM nail engages a concave surface at the opposite end of the tubular member. Removing the tubular
30 member can comprise cutting the tubular member away from the coated IM nail. Removing the tubular member can comprise pulling a pull member disposed on the tubular member causing a slit to be formed along the tubular member.

[0012] Further areas of applicability will become apparent from the description provided herein. The description and specific examples in this summary are intended for purposes of illustration only and are not intended to limit the scope of the present disclosure.

5

DRAWINGS

[0013] The drawings described herein are for illustrative purposes only of selected embodiments and not all possible implementations, and are not intended to limit the scope of the present disclosure.

10 **[0014]** Figure 1 is a side perspective view of a mold for forming a coated IM nail constructed in accordance to one example of the present teachings;

[0015] Figure 2 is a partial cross-sectional view of the mold taken along lines 2-2 of Figure 1;

[0016] Figure 3 is an end perspective view of the mold of Figure 1;

15 **[0017]** Figure 4 is a side perspective view of the mold of Figure 1 and shown with an IM nail inserted into the tubular member and a flowable material delivery device threadably coupled to a first port according to one example of the present disclosure;

[0018] Figure 5 is a side perspective view of the mold of Figure 4 and shown with the flowable material delivery device moved to an adjacent threaded port subsequent to delivery of a sufficient amount of flowable material into the first port;

20 **[0019]** Figure 6 is a cross-sectional view taken along lines 6-6 of Figure 5 taken through a set of nibs extending from protrusions on an inner surface of the tubular member;

[0020] Figure 7 is a cross-sectional view taken along lines 7-7 of the tubular member taken along a section of the tubular member without nibs;

25 **[0021]** Figure 8 is a side perspective view of a mold constructed in accordance to additional features of the present disclosure and formed of wire-reinforced silicone; and

[0022] Figure 9 is a side perspective view of a coated IM nail subsequent to removal of the mold according to one example of the present disclosure and shown having a protective membrane cover disposed around a distal end thereof to inhibit flowable material from entering the IM nail.

30

[0023] Corresponding reference numerals indicate corresponding parts throughout the several views of the drawings.

DETAILED DESCRIPTION

5 **[0024]** The following description of technology is merely exemplary in nature of the subject matter, manufacture and use of one or more disclosures, and is not intended to limit the scope, application, or uses of any specific disclosure claimed in this application or in such other applications as may be filed claiming priority to this application, or patents issuing therefrom. Moreover, although the following description and illustrations refer specifically to a mold and related method for coating an IM nail, it will be understood that the molds and related methods disclosed herein may be applied to other implants. In addition, it will be understood that the terms “nail” and “rod” are used herein interchangeably to refer to the same or similar components. Furthermore, while the molds and related methods disclosed herein are specifically directed toward
10 fabrication of antibiotic-loaded, cement-coated rods, the molds and methods disclosed herein may also be adapted to introduce other flowable material onto a surface of a prosthetic implant. Moreover, the molds and related methods disclosed herein may be used to create antibiotic-loaded, cement-coated implants applicable for use with other bones in the body. Therefore, it will be understood that the present description and the
15 claims are applicable to any appropriate bone in the body. A non-limiting discussion of terms and phrases intended to aid understanding of the present technology is provided at the end of this Detailed Description.

[0025] With initial reference to Fig. 1, a mold that may be used to form a coated intramedullary (IM) nail according to one example of the present disclosure is shown and generally identified at reference numeral 10. The mold 10 can include a tubular member 12 having an insertion end 14 and an opposite end 16. In the example shown, the insertion end 14 defines an opening whereas the opposite end 16 provides a closed end 22. In the example shown, the closed end 22 can have a generally convex outer surface 24. The tubular member 12 can extend generally along a longitudinal axis
25 30.

[0026] With continued reference to Fig. 1 and additional reference now to Fig. 2, the tubular member 12 can have a sidewall 34 that has an outer surface 36 and an

inner surface 38. In the example shown, the sidewall 34 is cylindrical however other cross-sections are contemplated. The sidewall 34 can generally extend along the longitudinal axis 30. The sidewall 34 defines a plurality of inlet ports 40a, 40b, 40c, and 40d. A corresponding plurality of boss structures 42a, 42b, 42c, and 42d can extend
5 from the outer surface 36 on the sidewall 34. Each boss structure 42a, 42b, 42c, and 42d can incorporate threads 44a, 44b, 44c, and 44d, respectively. The inlet port 40a, boss 42a, and threads 44a can collectively comprise a first threaded inlet port 48a. Similarly, the inlet port 40b, boss 42b, and threads 44b can collectively define a second threaded inlet port 48b. The inlet port 40c, boss 42c, and threads 44c can collectively comprise a
10 third threaded inlet port 48c. The inlet port 40d, boss 42d, and threads 44d can collectively comprise a fourth threaded inlet port 48d. It will be appreciated that while the particular tubular member 12 shown in the examples herein incorporates four threaded inlet ports, additional or fewer threaded inlet ports may be incorporated thereon. Moreover, some or all of the threaded inlet ports 48a, 48b, 48c, and 48d may be provided
15 without threads. In this regard, other coupling structures may be formed or included onto the respective bosses 42a, 42b, 42c, and/or 42d that are configured to selectively couple with a flowable material delivery device as will become appreciated herein. A series of threaded caps 49a, 49b, 49c, and 49d can threadably mate with the first, second, third and fourth threaded inlet ports 48a, 48b, 48c, and 48d, respectively. It will be
20 appreciated that the terms “first”, “second”, “third” and “fourth” are used arbitrarily herein and are not meant to denote a particular priority or sequence of use.

[0027] With particular reference now to Figs. 2 and 3, additional features of the tubular member 12 will be described. A first, second, and third protrusion 50a, 50b, and 50c, respectively, can be formed on the inner surface 38 of the sidewall 34. In the
25 example shown, the protrusions 50a, 50b, and 50c can be radially disposed around the inner surface 38 at radially equidistant intervals. In the example shown, the protrusions 50a, 50b, and 50c are arranged at substantially 120 degrees relative to each other. Each protrusion can extend substantially along a length of the tubular member 12 between the insertion end 14 (Fig. 1) and the opposite end 16 (Fig. 1). While three protrusions are
30 shown, it is appreciated that additional or fewer protrusions may be incorporated. According to one example, the protrusions 50a, 50b, and 50c can each include longitudinally spaced nibs 54a, 54b, and 54c extending inwardly toward the longitudinal axis 30. Each nib 54a, 54b, and 54c can have a nail engaging surface 56a, 56b, and 56c,

respectively. The respective nail engaging surfaces 56a, 56b, and 56c can be configured to engage a nail 60 (Fig. 6) and offset the nail 60 inwardly along the longitudinal axis 30 and spaced from a remainder of the protrusions 50a, 50b, and 50c. As will be described, the protrusions 50a, 50b, and 50c can facilitate formation of one or more vent grooves 62 (Fig. 9) in the cement surface of a resulting cement-coated IM nail 60'. The vent grooves 62 can inhibit pressure build-up during implantation of the cement coated IM nail 60'.

[0028] With specific reference now to Fig. 3, additional features of the tubular member 12 will be described. A first, second, and third plurality of vent holes or ports 66a, 66b, and 66c can be formed through the sidewall 34. In the example shown, each row of vent ports 66a, 66b, and 66c is located generally between an adjacent pair of protrusions 50a, 50b, and 50c. The vent ports 66a, 66b, and 66c can be configured to permit air to escape the tubular member 12 during advancement of the flowable material within the tubular member 12 as will become appreciated from the following discussion.

[0029] The tubular member 12 can be formed of easily cuttable, transparent or translucent material such as silicone. The material can further be flexible and conducive to cement-releasing. In some examples, the silicone can have a reinforcing structure such as a wire mesh. The tubular member 12 can be formed in any dimensions to accommodate receipt of an IM nail (or other prosthetic implant) having any given dimension. Furthermore, and as identified above, the tubular member 12 can be cut to length to accommodate an IM nail having any length.

[0030] According to another example of the present disclosure, a pull member 80 (Fig. 3) can be incorporated into or adjacent the sidewall 34. The pull member 80 can extend partially or completely along the length of the sidewall 34 of the tubular member 12. The pull member 80 can be configured to facilitate removal of the tubular member 12 subsequent to curing of the flowable material against the IM nail. In this regard, the pull member 80 can include a pull structure 82 such as a loop or other easily graspable configuration where a user can pull the pull structure 82 generally away from the longitudinal axis 30 creating a cut or slit along and through the length of the sidewall 34 of the tubular member 12. Once the slit has been formed along the tubular member 12, the user can easily peel away the tubular member 12 to reveal the coated IM nail 60'.

[0031] With particular reference now to Figs. 4-7, a method of coating the IM nail 60 according to one example of the present disclosure will be described. According to the present disclosure, multiple molds 10 will be provided having various inner and outer diameters. A user can select an appropriate mold 10 that suits a particular nail 60 for a given application. It will be understood that the overall length of the mold 10 can be modified such as by cutting a length off of the insertion end 14.

[0032] At the outset, the IM nail 60 can be introduced into the tubular member 12 as shown in Fig. 4. Next, one of the threaded caps, such as 49d, can be removed from its threaded inlet port, such as the threaded inlet port 48d. A flowable material delivery device 100 can be coupled to the threaded inlet port 48d. Next, a user can advance flowable material 102 through the inlet port 40d and into the tubular member 12. In the example shown, the flowable material delivery device 100 can include a handle 108 (Fig. 5) that can be actuated to influence emission of the flowable material 102 out of the delivery device 100 and into the inlet port 40d. Other configurations of the flowable material delivery device may be used. Furthermore, it will be appreciated that other connections may be made between the flowable material delivery device 100 and the respective inlet ports. For example, a luer lock coupling, a nozzle coupling or other coupling may be employed.

[0033] A user can continue to introduce the flowable material 102 into the tubular member 12 until the flowable material 102 has advanced sufficiently along a portion of the tubular member 12 toward an adjacent inlet port 40c. As the tubular member 12 is formed of a transparent material, a user can observe the flowable material 102 advancing along a length of the tubular member 12 (between the inner surface 38 of the sidewall 34 and the IM nail 60). In one example, a user can stop introduction of the flowable material 102 into the tubular member 12 once the flowable material 102 has advanced substantially, such as about three-fourths of the way, toward the adjacent inlet port 40c. Other examples are contemplated.

[0034] Next, a user can remove the flowable material delivery device 100 from the threaded inlet port 48d and replace the cap 49d onto the threaded inlet port 48d. The cap 49c can then be removed from the adjacent threaded inlet port 48c. The flowable material delivery device 100 can then be coupled to the threaded inlet port 48c. Next, a user can urge the flowable material 102 through the inlet port 40c and into the

tubular member 12. Notably, the flowable material 102 can backfill toward the fourth threaded inlet port 48d as well as advance in an opposite direction toward the second threaded inlet port 48b. As can be appreciated, as the flowable material 102 backfills toward the fourth threaded inlet port 48d, the flowable material will spread evenly along the IM nail 60 between the fourth and third threaded inlet ports 48d and 48c.

[0035] The process is repeated for subsequent inlet ports along the length of the tubular member 12 until the flowable material 102 has been sufficiently coated along the length of the IM nail 60. It will be appreciated that while not necessary, in some examples, the flowable material 102 may extend out of some or all of the vent ports 66a, 66b, and 66c. Furthermore, during introduction of the flowable material 102 into the tubular member 12, the vent ports 66a, 66b, and 66c allow air to escape the tubular member 12 to accommodate introduction of the flowable material between the tubular member 12 and the IM nail 60.

[0036] With reference to Fig. 8, a tubular member 12' constructed in accordance to additional features is shown. The tubular member 12' can include a reinforced silicone material. The reinforced silicone material can include a wire mesh 104. Other reinforcing structures may be incorporated.

[0037] With particular reference to Fig. 9, once the flowable material 102 has cured a sufficient amount, the tubular member 12 can be cut away from the coated IM nail 60' and discarded. The resulting coated IM nail 60' can include the longitudinally extending grooves 62 formed therealong that can accommodate air escape and inhibit pressure build-up during implantation into an IM canal. According to a further example of the disclosure, a thin membrane sheath 120 can be incorporated onto an end of the IM nail 60 prior to insertion of the IM nail 60 into the tubular member 12. The sheath 120 can inhibit introduction of flowable material into the IM nail 60 such as through an exposed cannulation thereon. Additionally or alternatively, a plug or collection of plugs, such as formed by flexible silicone, can be inserted into screw holes or the cannulation of the nail to inhibit introduction of flowable material into the IM nail 60.

[0038] The foregoing description of the embodiments has been provided for purposes of illustration and description. It is not intended to be exhaustive or to limit the disclosure. Individual elements or features of a particular embodiment are generally not limited to that particular embodiment, but, where applicable, are interchangeable and can

be used in a selected embodiment, even if not specifically shown or described. The same may also be varied in many ways. Such variations are not to be regarded as a departure from the disclosure, and all such modifications are intended to be included within the scope of the disclosure.

5

Non-limiting Discussion of Terminology

[0039] The headings (such as “Introduction” and “Summary”) and sub-headings used herein are intended only for general organization of topics within the present disclosure, and are not intended to limit the disclosure of the technology or any aspect thereof. In particular, subject matter disclosed in the “Introduction” may include novel technology and may not constitute a recitation of prior art. Subject matter disclosed in the “Summary” is not an exhaustive or complete disclosure of the entire scope of the technology or any embodiments thereof. Classification or discussion of a material within a section of this specification as having a particular utility is made for convenience, and no inference should be drawn that the material must necessarily or solely function in accordance with its classification herein when it is used in any given composition.

[0040] The description and specific examples, while indicating embodiments of the technology, are intended for purposes of illustration only and are not intended to limit the scope of the technology. Moreover, recitation of multiple embodiments having stated features is not intended to exclude other embodiments having additional features, or other embodiments incorporating different combinations of the stated features. Specific examples are provided for illustrative purposes of how to make and use the compositions and methods of this technology and, unless explicitly stated otherwise, are not intended to be a representation that given embodiments of this technology have, or have not, been made or tested.

[0041] As used herein, the words “desire” or “desirable” refer to embodiments of the technology that afford certain benefits, under certain circumstances. However, other embodiments may also be desirable, under the same or other circumstances. Furthermore, the recitation of one or more desired embodiments does not imply that other embodiments are not useful, and is not intended to exclude other embodiments from the scope of the technology.

[0042] As used herein, the word “include,” and its variants, is intended to be non-limiting, such that recitation of items in a list is not to the exclusion of other like items that may also be useful in the materials, compositions, devices, and methods of this technology. Similarly, the terms “can” and “may” and their variants are intended to be non-limiting, such that recitation that an embodiment can or may comprise certain elements or features does not exclude other embodiments of the present technology that do not contain those elements or features.

[0043] Although the open-ended term “comprising,” as a synonym of non-restrictive terms such as including, containing, or having, is used herein to describe and claim embodiments of the present technology, embodiments may alternatively be described using more limiting terms such as “consisting of” or “consisting essentially of.” Thus, for any given embodiment reciting materials, components or process steps, the present technology also specifically includes embodiments consisting of, or consisting essentially of, such materials, components or processes excluding additional materials, components or processes (for consisting of) and excluding additional materials, components or processes affecting the significant properties of the embodiment (for consisting essentially of), even though such additional materials, components or processes are not explicitly recited in this application. For example, recitation of a composition or process reciting elements A, B and C specifically envisions embodiments consisting of, and consisting essentially of, A, B and C, excluding an element D that may be recited in the art, even though element D is not explicitly described as being excluded herein.

[0044] When an element or layer is referred to as being “on”, “engaged to”, “connected to” or “coupled to” another element or layer, it may be directly on, engaged, connected or coupled to the other element or layer, or intervening elements or layers may be present. In contrast, when an element is referred to as being “directly on”, “directly engaged to”, “directly connected to” or “directly coupled to” another element or layer, there may be no intervening elements or layers present. Other words used to describe the relationship between elements should be interpreted in a like fashion (e.g., “between” versus “directly between,” “adjacent” versus “directly adjacent,” etc.). As used herein, the term “and/or” includes any and all combinations of one or more of the associated listed items.

CLAIMS

What is claimed is:

1. A mold for forming a coated intramedullary (IM) nail, the mold
5 comprising:
a tubular member having an insertion end and an opposite end, the tubular member comprising a sidewall extending along a longitudinal axis between an outer surface and an inner surface, the sidewall defining at least one threaded inlet port therealong, wherein the tubular member is configured to receive the IM nail therein and
10 wherein the tubular member is further configured to locate a flowable material against the IM nail within the inner surface.
2. The mold of claim 1 wherein the inner surface further comprises at least one inwardly and radially extending protrusion.
15
3. The mold of claim 2 wherein the inner surface comprises three inwardly extending protrusions radially spaced substantially equally relative to each other on the inner surface.
- 20 4. The mold of claim 3 wherein the protrusions extend substantially along a length of the tubular member between the insertion end and an opposite end.
5. The mold of claim 3 wherein the protrusions each include longitudinally spaced nibs extending inwardly toward the longitudinal axis, each nib having a nail
25 engaging surface configured to engage the nail and offset the nail inwardly along the longitudinal axis and spaced from a remainder of the protrusion.
6. The mold of claim 1 wherein the opposite end of the tubular member defines a concave surface.
30
7. The mold of claim 1 wherein the tubular member further comprises a first inlet port formed through the sidewall and configured to accept flowable material therethrough.

8. The mold of claim 1 wherein the first inlet port comprises a threaded port extending outwardly from the outer surface.

5 9. The mold of claim 8, further comprising a plurality of threaded inlet ports spaced from each other and formed through the sidewall configured to accept flowable material therethrough.

10 10. The mold of claim 1 wherein the sidewall comprises a plurality of vent holes therealong.

11. The mold of claim 10 wherein the plurality of vent holes comprise at least one distinct row of vent holes formed longitudinally along the sidewall.

15 12. The mold of claim 11 wherein the plurality of vent holes comprise at least two distinct rows of vent holes, each row radially spaced between two adjacent protrusions.

20 13. The mold of claim 1 wherein the mold is transparent.

14. The mold of claim 1 wherein the mold is flexible.

15. The mold of claim 1 wherein the mold is cuttable.

25 16. The mold of claim 1, further comprising a pull member disposed on the tubular member and configured to influence a slit formation on the tubular member upon pulling for removing the tubular member subsequent to curing of the flowable material.

30 17. The mold of claim 1 wherein the mold is formed of a material that releases from cured flowable material.

18. The mold of claim 17 wherein the material comprises silicone.

19. The mold of claim 18 wherein the silicone is reinforced silicone.

20. The mold of claim 1, further comprising a sheath configured to be disposed onto the IM nail and inhibit introduction of the flowable material into the IM
5 nail.

21. A method of coating an intramedullary (IM) nail with flowable material, the method comprising:

10 advancing the IM nail into a tubular member from an insertion end of the tubular member toward an opposite end of the tubular member;

advancing flowable material through a first port defined through a sidewall at a first location on the tubular member;

15 subsequent to curing of the flowable material, removing the tubular member from the IM nail having the cured flowable material thereon.

22. The method of claim 21 wherein advancing the IM nail further comprises: slidably translating the IM nail along at least two longitudinally extending protrusions formed on an inner cylindrical surface of the sidewall.

20 23. The method of claim 22 wherein advancing the IM nail comprises advancing the IM nail into the tubular member until a distal end of the IM nail engages a concave surface at the opposite end of the tubular member.

24. The method of claim 21 further comprising:
25 coupling a flowable material delivery device to a boss formed on the tubular member proximate to the first port.

25. The method of claim 24 wherein coupling comprises one of threadably coupling, luer lock coupling, and nozzle coupling the flowable material delivery device
30 to the tubular member.

26. The method of claim 21 further comprising:
advancing flowable material through a second port defined through
the sidewall at a second location, distinct from the first location, on the tubular member.

5 27. The method of claim 26, further comprising:
observing the flowable material advancing within the tubular member;
and
stopping the advancing of the flowable material through the first
port based on the flowable material advancing substantially toward the second port.

10

28. The method of claim 21 wherein removing the tubular member comprises
cutting the tubular member away from the coated IM nail.

29. The method of claim 21 wherein removing the tubular member comprises
15 pulling a pull member disposed on the tubular member causing a slit to be formed along
the tubular member.

30. The method of claim 21, further comprising disposed a sheath onto an end
of the IM nail prior to the advancing of the IM nail into the tubular member.

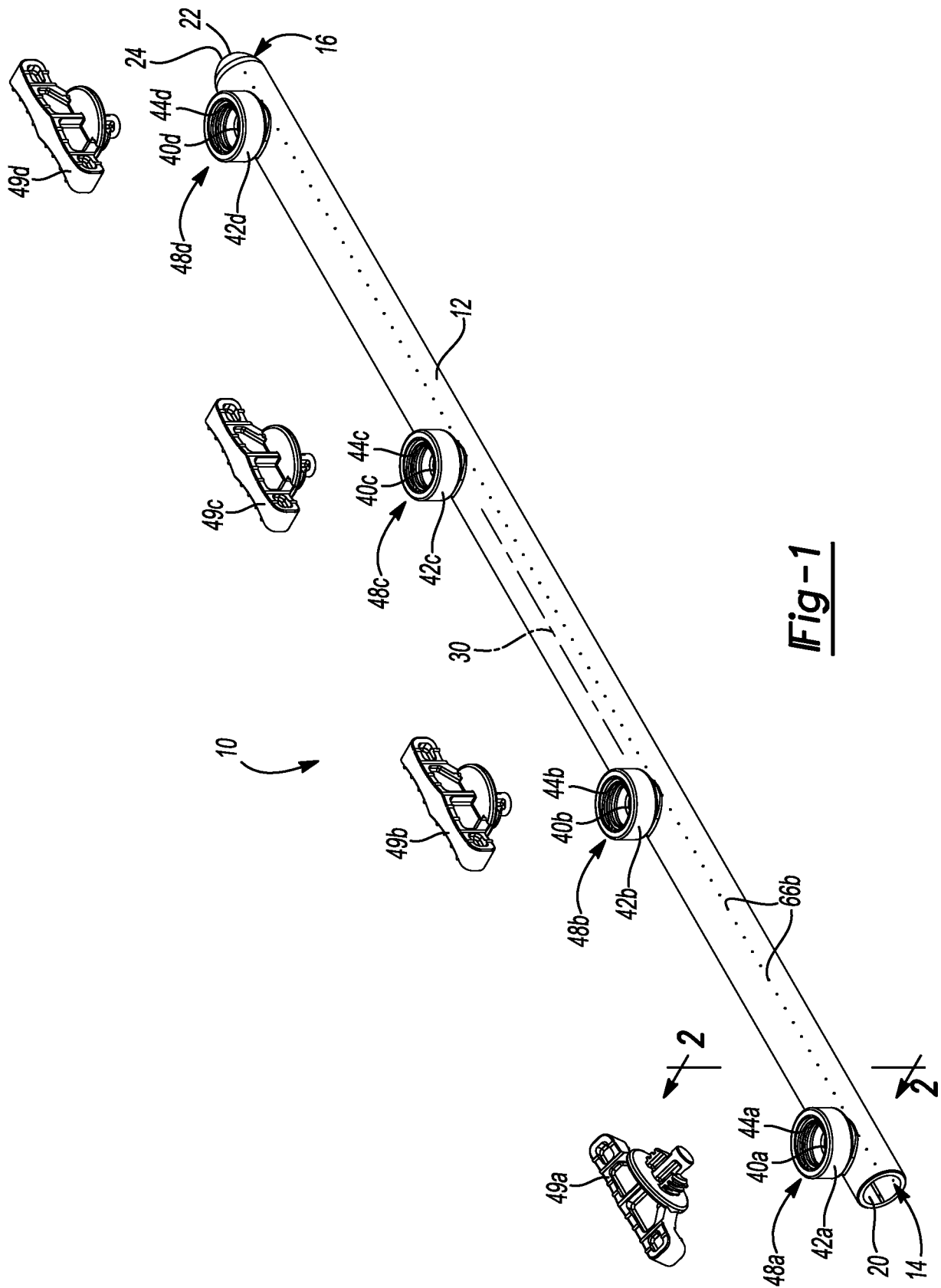

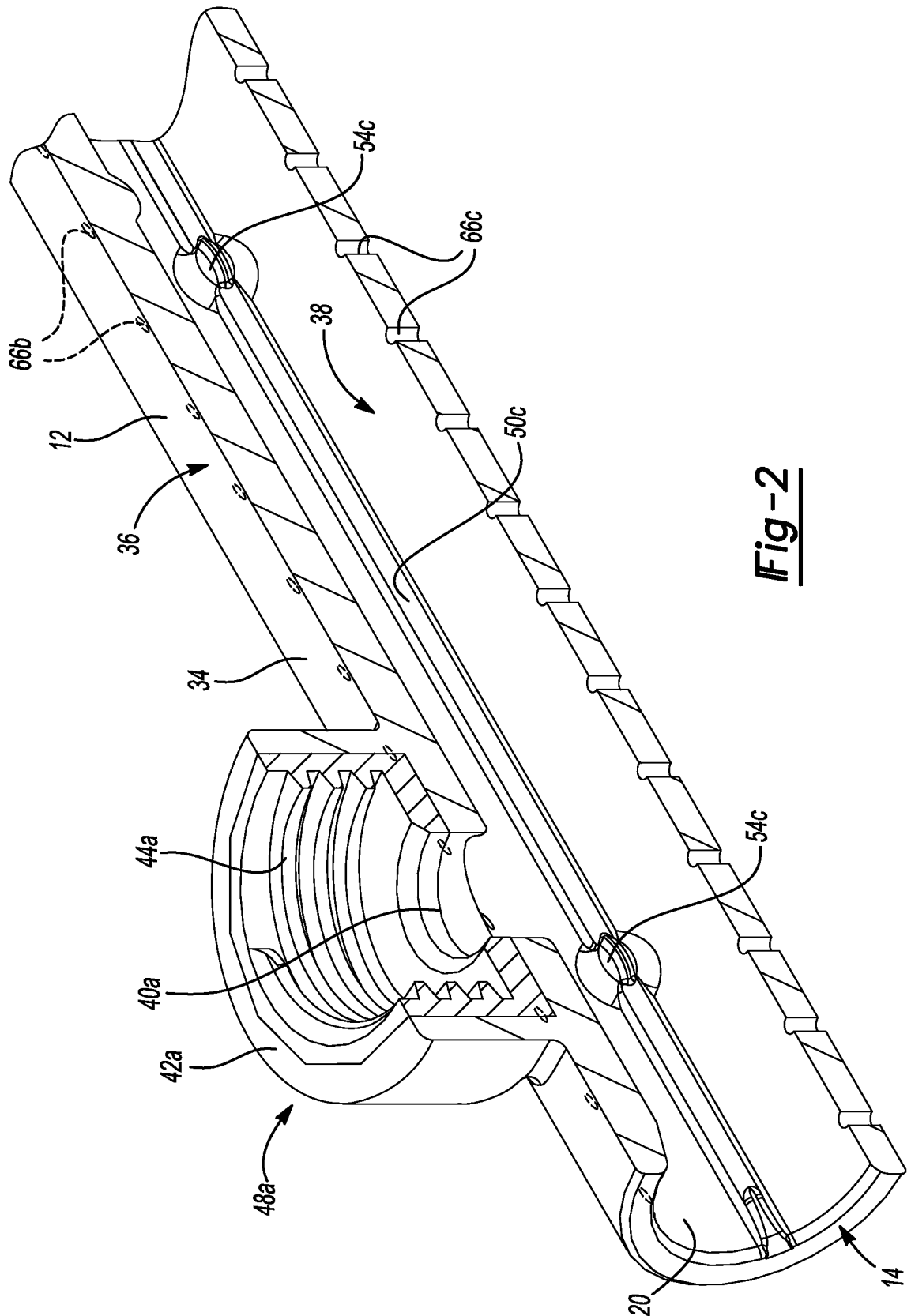
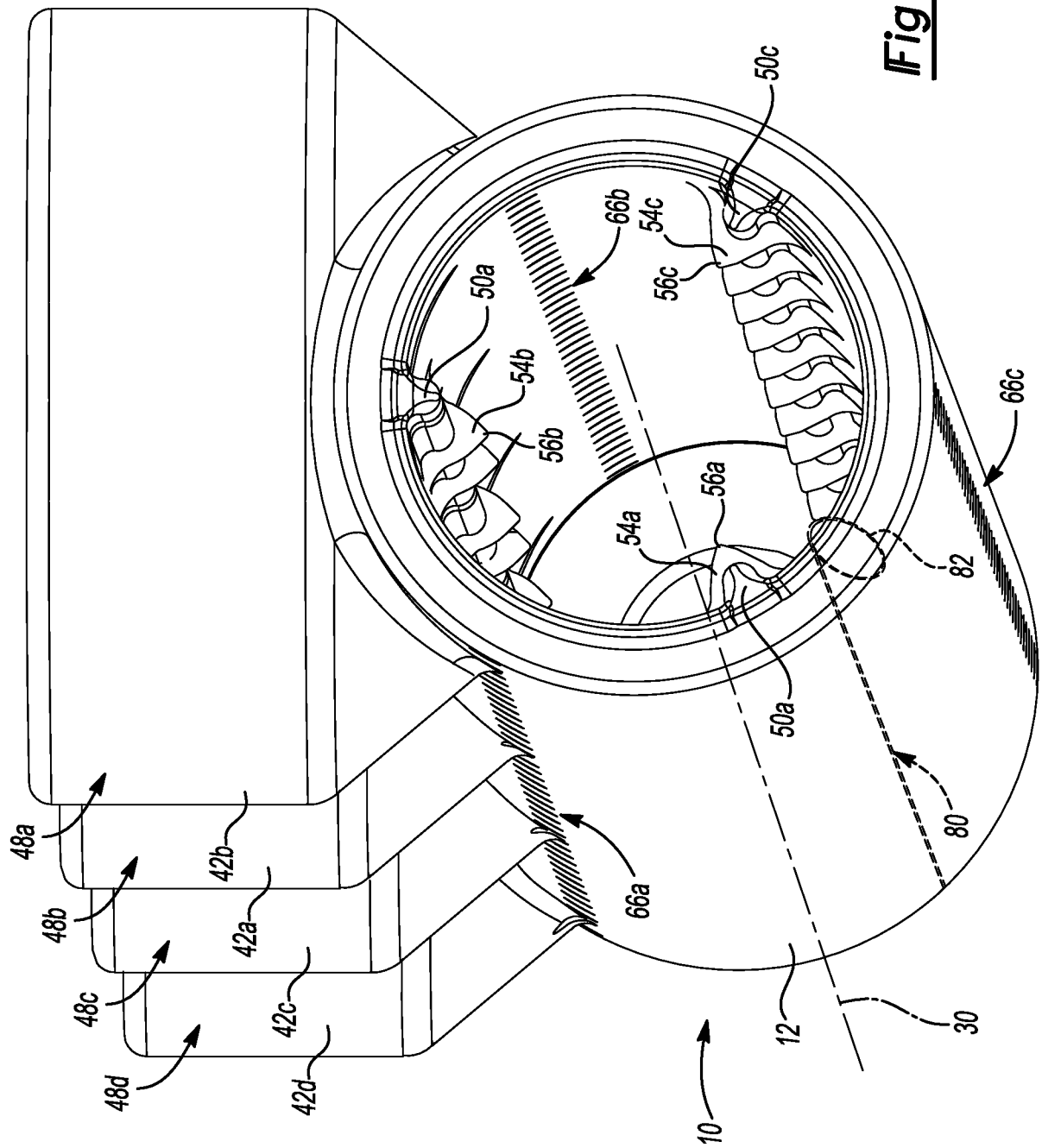
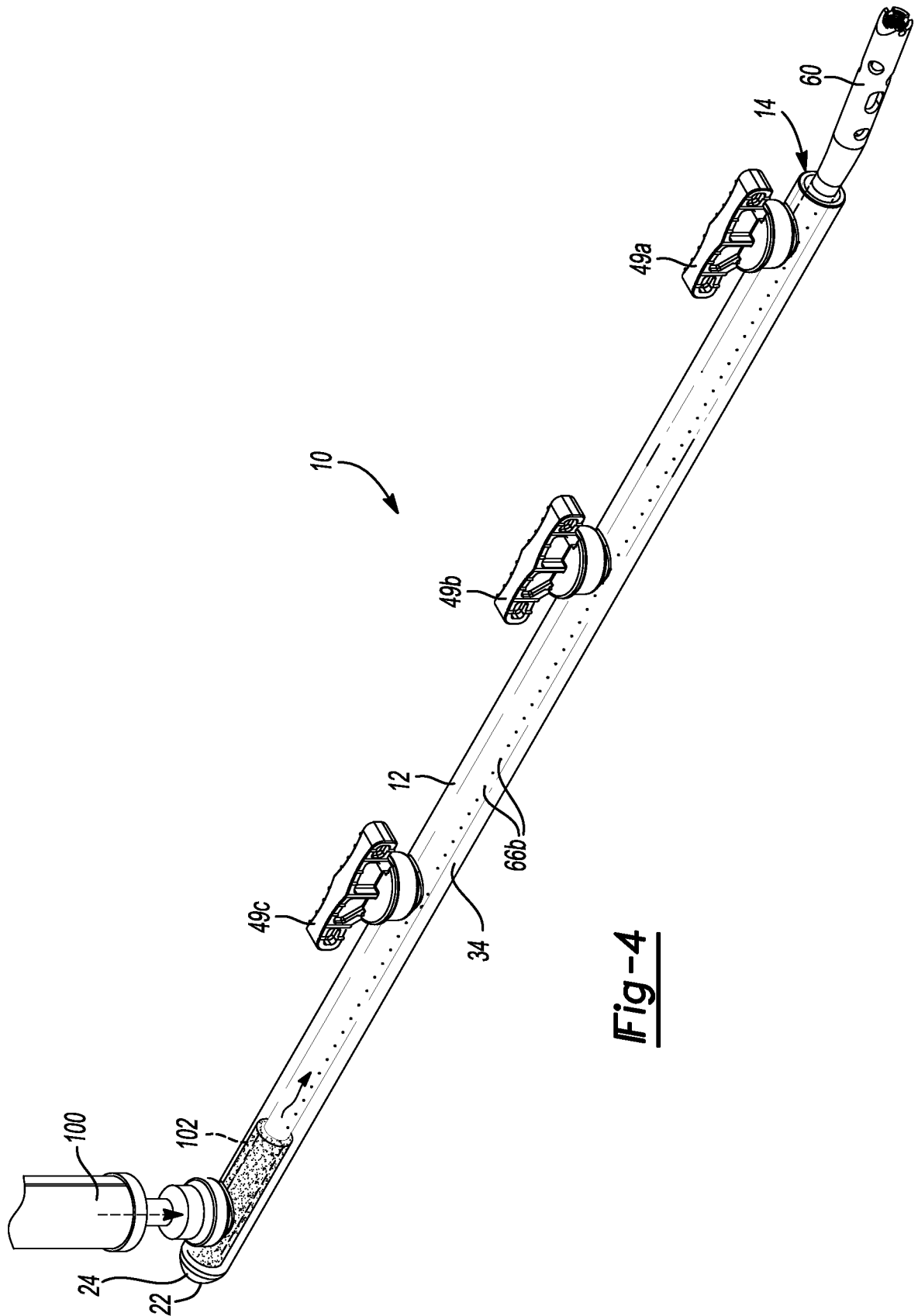
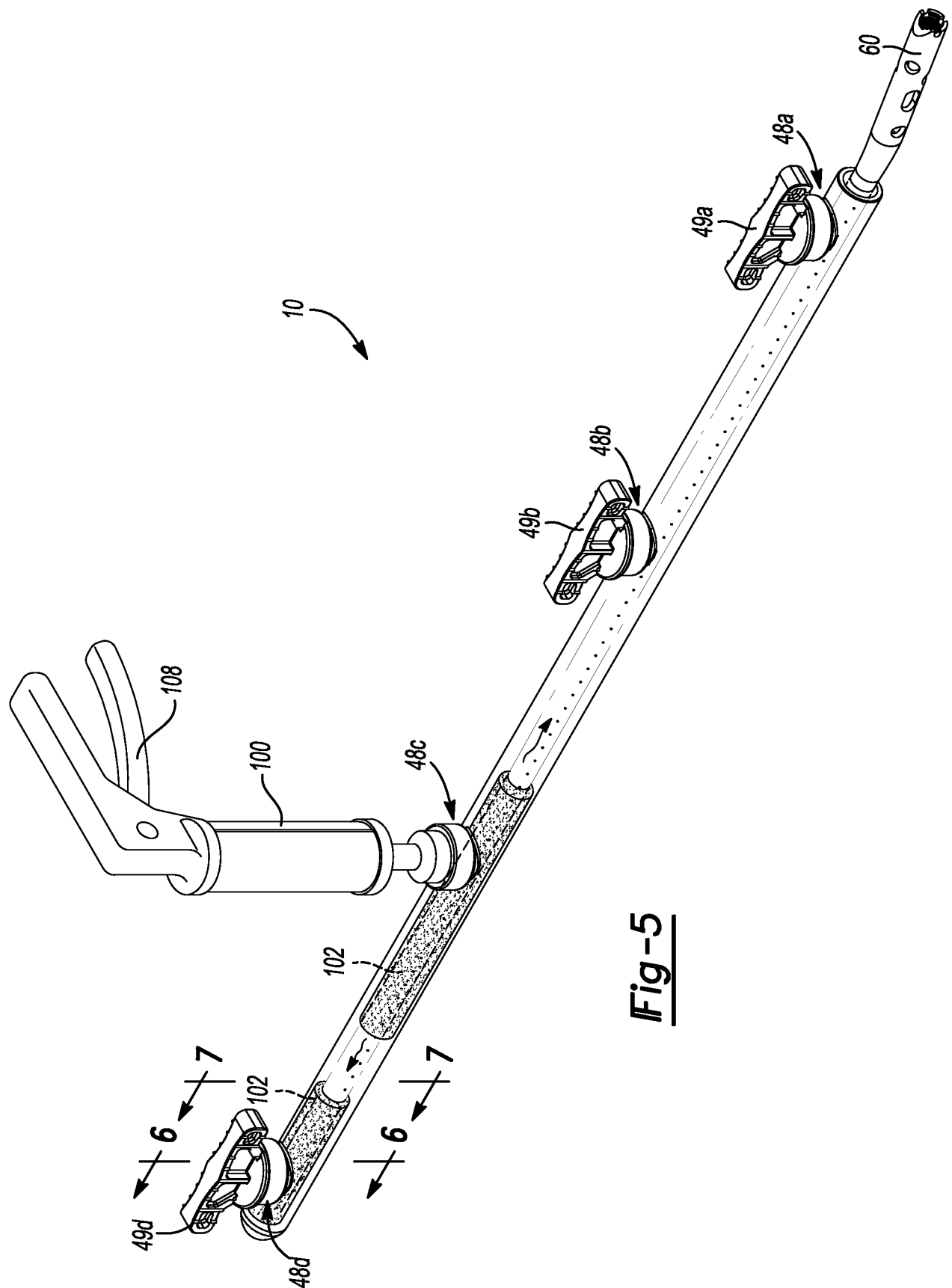

Fig-3







6/9

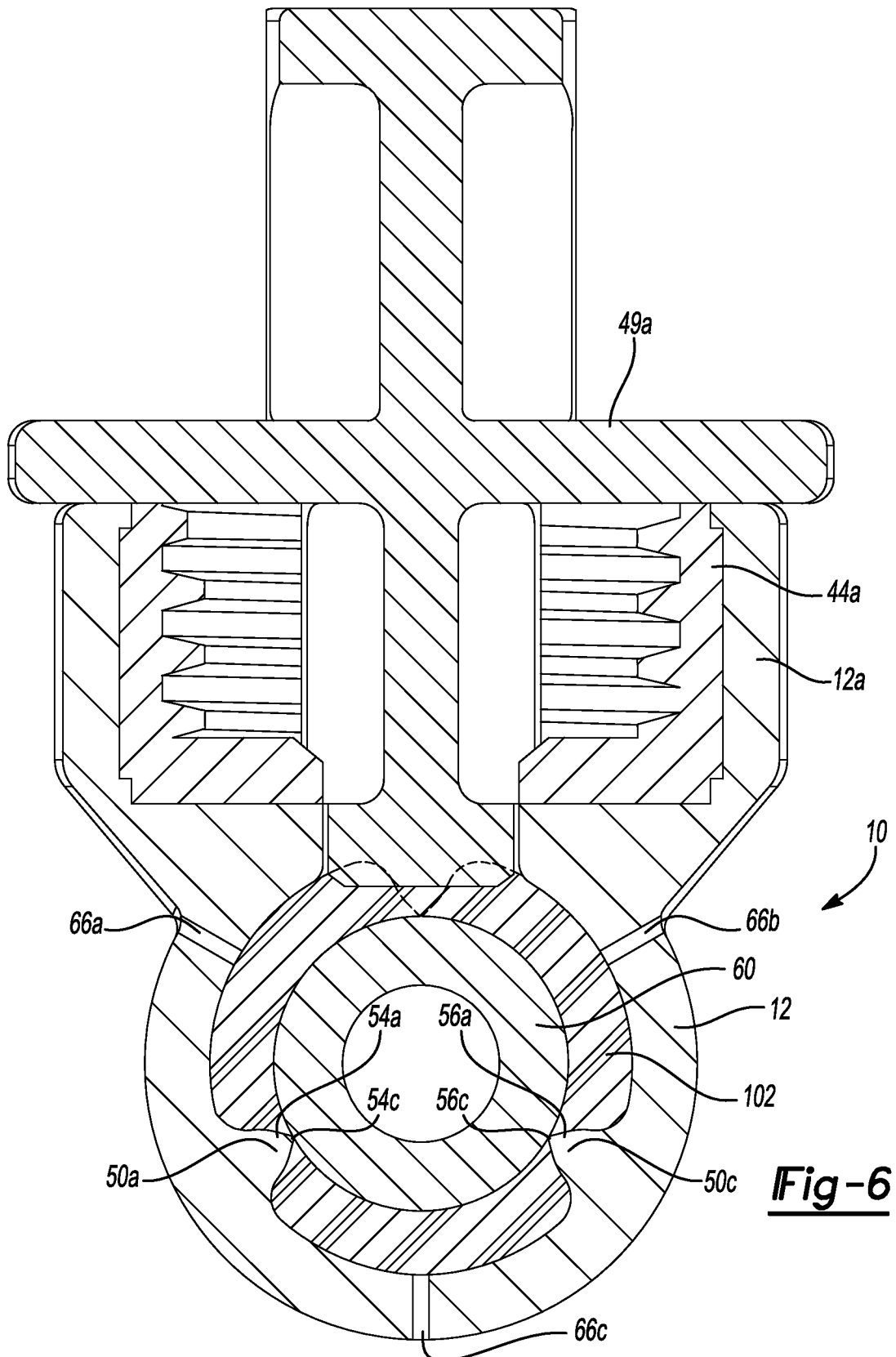

7/9

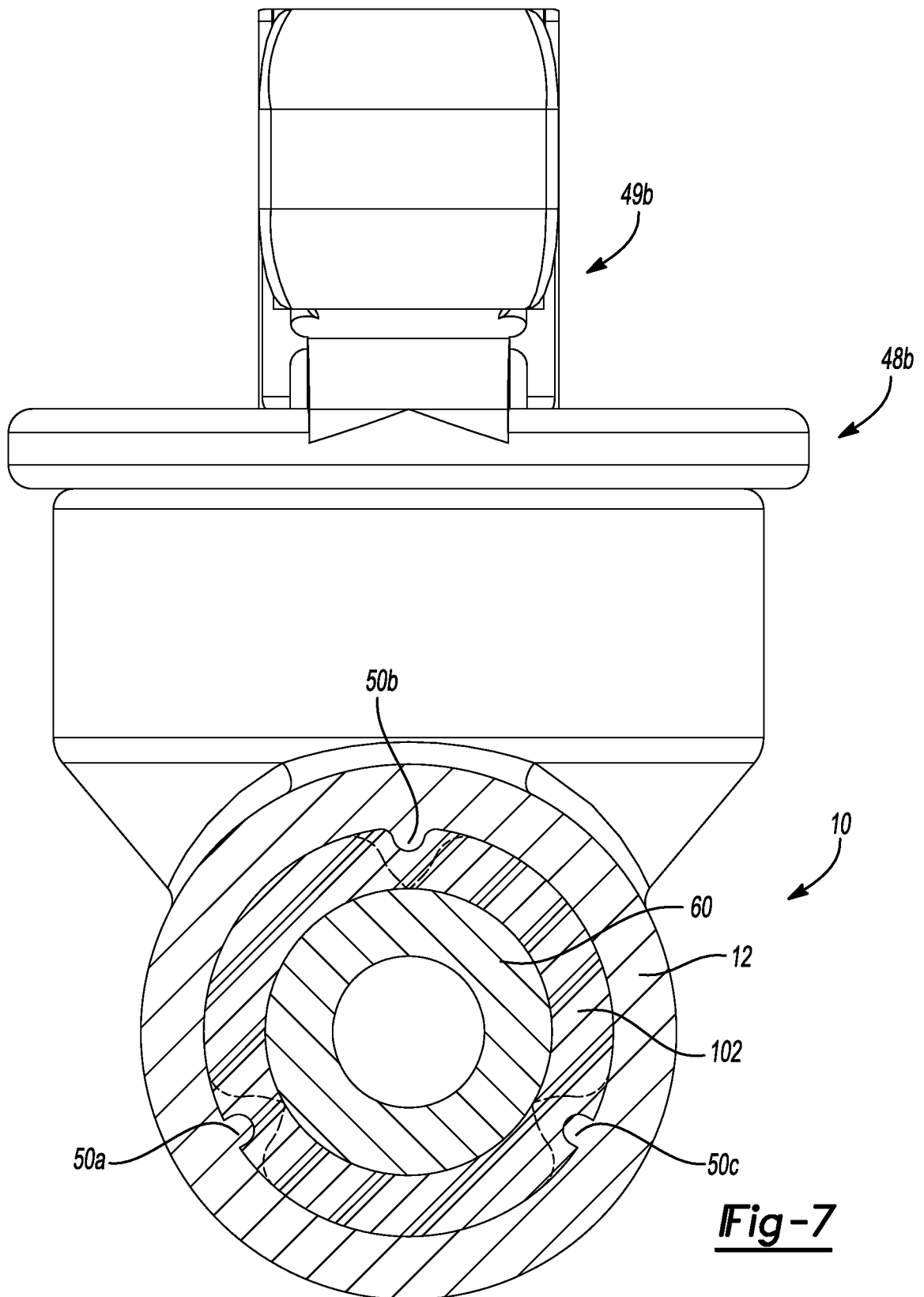

Fig-7

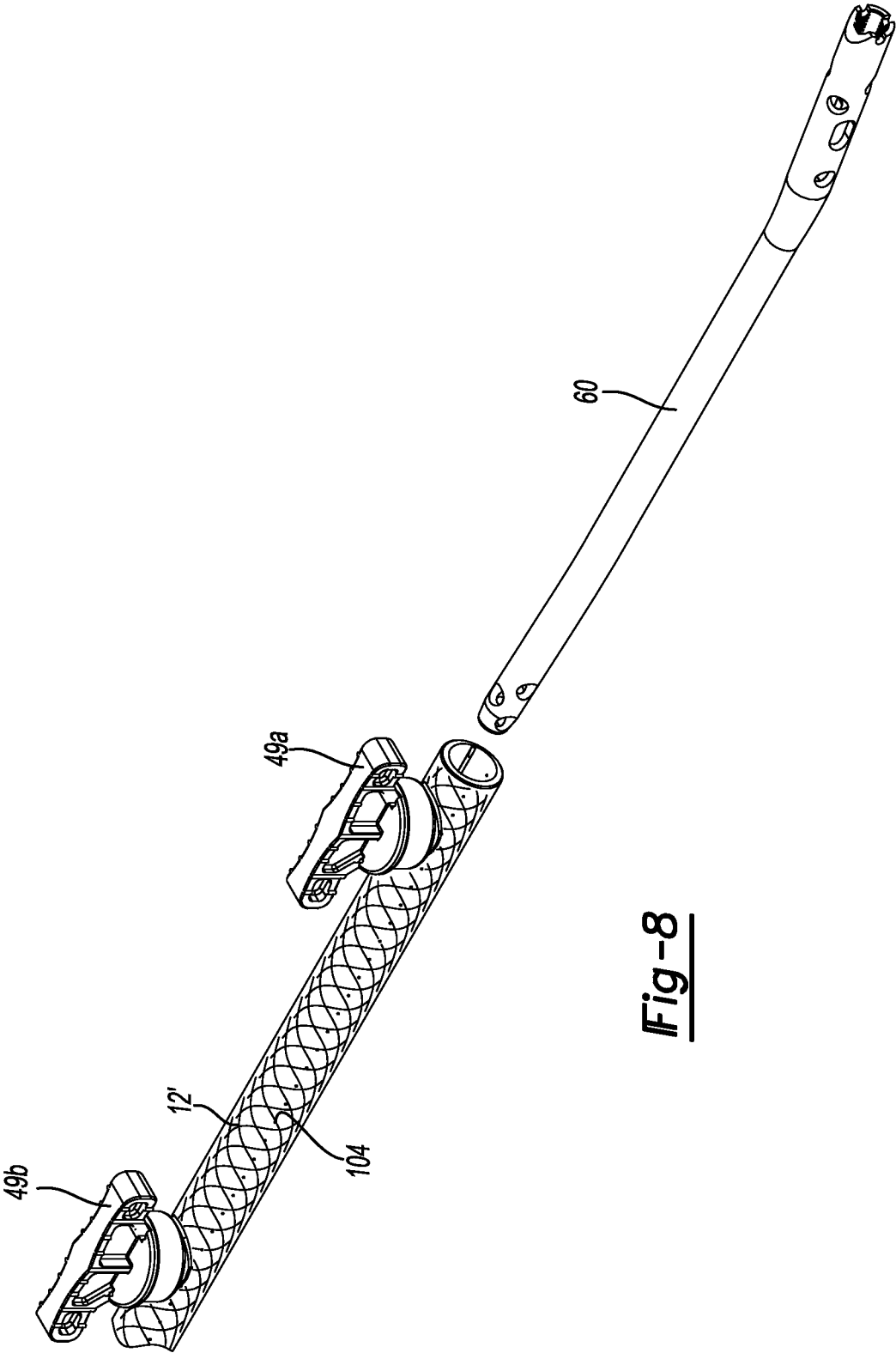

Fig-8

9/9

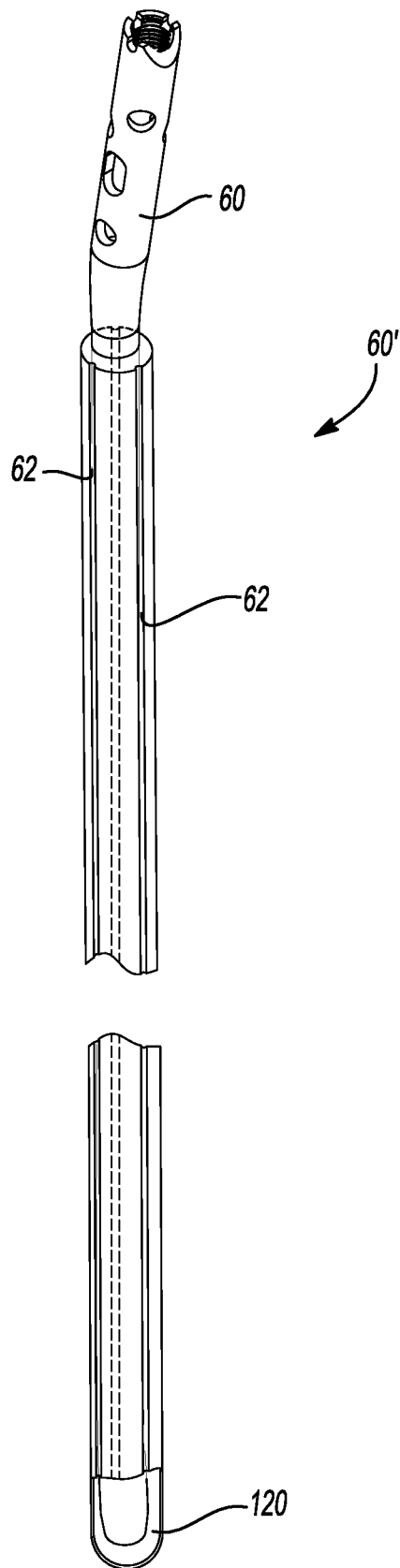

Fig-9