



## PCT

**(10) International Publication Number**  
**WO 2009/081399 A1**

**(43) International Publication Date**  
**2 July 2009 (02.07.2009)**

**(51) International Patent Classification:**

**A61B 5/00** (2006.01)      **A61M 5/172** (2006.01)  
**A61M 5/142** (2006.01)

**(72) Inventors; and**

**(75) Inventors/Applicants (for US only): YODFAT, Ofer**  
[IL/IL]; 72 Galil St., 71908 Maccabim-Reut (IL). **KERET,**  
**Avihoo, P.** [IL/IL]; 18 Moran St., 25147 Kfar Vradim (IL).

**(21) International Application Number:**

PCT/IL2008/001650

**(81) Designated States** (*unless otherwise indicated, for every kind of national protection available*): AE, AG, AL, AM, AO, AT, AU, AZ, BA, BB, BG, BH, BR, BW, BY, BZ, CA, CH, CN, CO, CR, CU, CZ, DE, DK, DM, DO, DZ, EC, EE, EG, ES, FI, GB, GD, GE, GH, GM, GT, HN, HR, HU, ID, IL, IN, IS, JP, KE, KG, KM, KN, KP, KR, KZ, LA, LC, LK, LR, LS, LT, LU, LY, MA, MD, ME, MG, MK, MN, MW, MX, MY, MZ, NA, NG, NI, NO, NZ, OM, PG, PH, PL, PT, RO, RS, RU, SC, SD, SE, SG, SK, SL, SM, ST, SV, SY, TJ, TM, TN, TR, TT, TZ, UA, UG, US, UZ, VC, VN, ZA, ZM, ZW.

**(22) International Filing Date:**

21 December 2008 (21.12.2008)

**(25) Filing Language:**

English

**(26) Publication Language:**

English

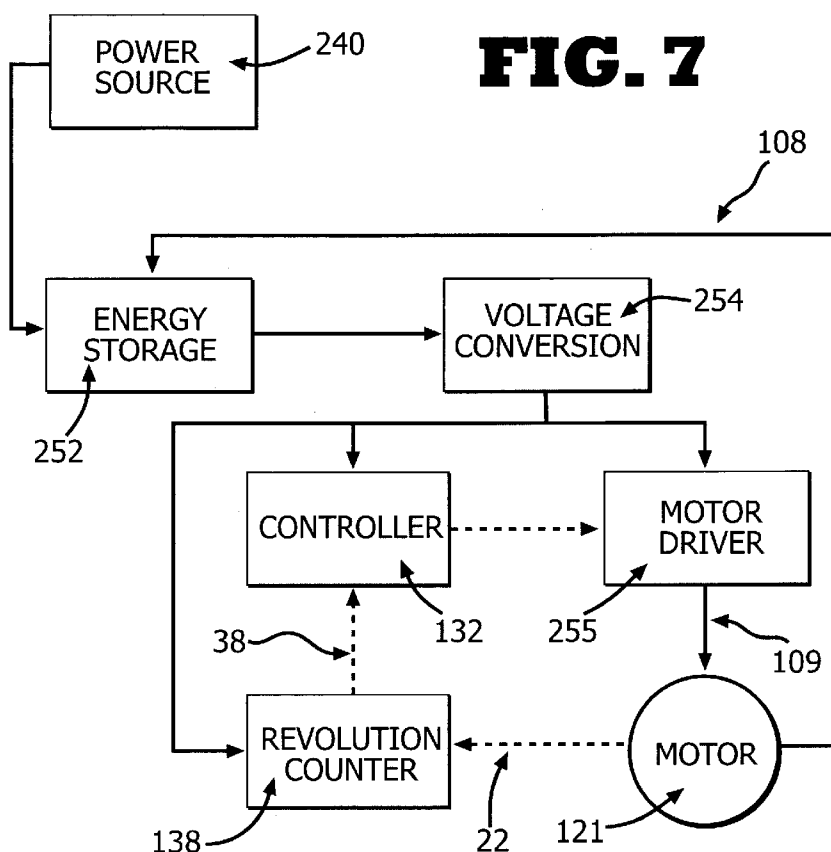
**(30) Priority Data:**

61/008,693	21 December 2007 (21.12.2007)	US
61/065,142	8 February 2008 (08.02.2008)	US

**(84) Designated States** (*unless otherwise indicated, for every kind of regional protection available*): ARIPO (BW, GH, GM, KE, LS, MW, MZ, NA, SD, SL, SZ, TZ, UG, ZM, ZW), Eurasian (AM, AZ, BY, KG, KZ, MD, RU, TJ, TM), European (AT, BE, BG, CH, CY, CZ, DE, DK, EE, ES, FI,

[Continued on next page]

**(54) Title:** DEVICES AND METHODS FOR POWERING A MEDICAL DEVICE



**(57) Abstract:** Devices and methods for powering a medical device for sustained delivery of fluids or continuous monitoring of body analyte. The devices may comprise a pumping mechanism, a driving mechanism for activating the pumping mechanism to dispense fluid, and a power source coupled to the driving mechanism and having an energy storage cell for providing a pulsed power to the driving mechanism. The methods may be implemented by activating the driving mechanism using pulsed energy in the form of at least one pulse train pattern accumulated in and discharged from an energy storage component.



FR, GB, GR, HR, HU, IE, IS, IT, LT, LU, LV, MC, MT, NL,  
NO, PL, PT, RO, SE, SI, SK, TR), OAPI (BF, BJ, CF, CG,  
CI, CM, GA, GN, GQ, GW, ML, MR, NE, SN, TD, TG).

— *before the expiration of the time limit for amending the  
claims and to be republished in the event of receipt of  
amendments*

**Published:**

— *with international search report*

## DEVICES AND METHODS FOR POWERING A MEDICAL DEVICE

### CROSS-REFERENCE TO RELATED APPLICATIONS

**[0001]** The present invention claims priority to U.S. Provisional Patent Application Nos. 61/008,693, entitled "System and Method for Powering an Infusion Pump," filed on December 21, 2007, and 61/065,142, entitled "System and Method for Powering an Infusion Pump," filed on February 8, 2008, the disclosures of which are incorporated herein by reference in their entireties.

### FIELD

**[0002]** Devices and methods for sustained delivery of fluids and/or continuous monitoring of body analyte are described herein. More particularly, a portable infusion, patch-like pump, adherable to the skin that can also continuously monitor body analytes is described. Also provided herein is a fluid dispensing and/or body analyte monitoring device having a power source and components for energy conservation.

### BACKGROUND

**[0003]** Medical treatment of certain illnesses requires continuous drug infusion into various body compartments, such as subcutaneous and intravenous injections. Diabetes mellitus (DM) patients, for example, require the administration of varying amounts of insulin throughout the day to control their blood glucose levels. In recent years, ambulatory portable insulin infusion pumps have emerged as a superior alternative to multiple daily syringe injections of insulin for Type 1 (Diabetes Medicine 2006; 23(2):141-7) and Type 2 (Diabetes Metab 2007 Apr 30, Diabetes Obes Metab 2007 Jun 26) diabetes patients. These pumps, which deliver insulin at a continuous basal rate, as well as in bolus volumes, were developed to liberate patients from repeated self-administered injections and allow them to maintain a near-normal daily routine.

Both basal and bolus volumes must be delivered in precise doses according to individual prescription, since an overdose or underdose of insulin could be fatal.

[0004] The first generation of portable insulin pumps refers to a “pager-like” device with a reservoir contained within a housing. A long tube is provided for delivering insulin from the pump attached to a patient’s belt to a remote insertion site. The reservoir, delivery tube and the hypodermic cannula altogether constitute an “infusion set”. The recommended time for replacing an infusion set is every 2-3 days to avoid local infection at the cannula insertion site. Most users, however, extend this period until the reservoir is empty, sometimes up to 7 days. Examples of such devices are disclosed in U.S. Patent Nos. 3,631,847, 3,771,694, 4,657,486, and 4,544,369. These devices represent a significant improvement over multiple daily injections but suffer from major drawbacks, including large size, heavy weight and long tubing. The size and weight of these devices is primarily attributable to the size and number of batteries (i.e., AA or AAA-type) employed in the devices for supplying the required high energy demand of the motor, screen, alarms, and other components which consume energy.

[0005] These bulky devices with long tubes are uncomfortable and are rejected by the majority of users because they interfere with daily activities, *e.g.*, walking, running, and sports. To avoid the tubing limitations, a second generation concept was proposed, directed to a remote controlled skin adherable device with a housing having a bottom surface adapted to be in contact with the patient’s skin, with a reservoir contained within the housing, and with an injection needle adapted for fluid communication with the reservoir. These skin adherable devices are designed for replacement every 2-3 days similarly to the currently available pump infusion sets. Most patients, however, prefer to extend this period until the reservoir is empty. This concept is discussed in U.S. Patent Nos. 4,498,843, 5,957,895, 6,589,229, 6,740,059, 6,723,072, and 6,485,461.

[0006] These second generation skin adherable devices still have at least two major drawbacks:

- The entire device should be disposed every 3 days including all expensive components (*e.g.*, electronics, driving mechanism).

- The device is still heavy and bulky, which is exceptionally important drawback because the device should be directly attached to the patient's skin and remain in place for at least 3 days. The main reason for the large size and heavy weight is the size and number of batteries (*e.g.*, AA, AAA or button-type) that supply energy to the motor, alarms, and maintain a communication link between the skin adherable device and the remote control unit. For example, the voltage required by many of the low voltage controllers and motors is 3 Volts, while the output of the batteries is less than 1.6 Volts.

[0007] In U.S. Patent No. 7,144,384 to Gorman et al., assigned to Insulet Corporation, a skin adherable device is disclosed. The patent discusses that a large portion of the device is occupied by four silver-oxide button batteries positioned perpendicular to the longitudinal axis of the device, making the device thick (18 mm) and bulky. Moreover, due to high energy consumption, such batteries typically last only 3 days, forcing the user to dispose of the entire device every 3 days.

[0008] A third generation skin adherable device was devised to increase patient customization. An example of such a device is described in the co-owned, co-pending U.S. Patent Application No. 11/397,115 and International Patent Application No. PCT/IL06/001276. This third generation device contains a remote control unit and a skin adherable patch unit (also referred to as "dispensing patch unit") that includes two parts:

- Reusable part -- containing the metering portion, electronics, and other relatively expensive components.
- Disposable part -- containing the reservoir and in some embodiments, batteries. A tube delivers the fluid from the reservoir to an exit port that contains a connecting lumen.

[0009] This concept provides a cost-effective skin adherable device and allows for a diversity of features, including various reservoir sizes and various needle and cannula types.

[0010] In the co-owned, co-pending U.S. Patent Application No. 12/004,837 and International Patent Application No. PCT/IL2007/001578, a fourth generation device is disclosed. This device is configured as a patch that can be disconnected and reconnected to a skin adherable cradle unit. The patch can be remotely controlled or can be operated by buttons that are located on the patch

as disclosed in the co-pending, co-owned U.S. Provisional Patent Application No. 60/961,527. In this configuration, the user can deliver a required bolus dose by repetitive button pressing according to a predetermined dose per button press ("Bolus buttons").

[0011] The co-owned, co-pending U.S. Patent Application No. 11/706,606, the disclosure of which is incorporated herein by reference in its entirety, discloses a device that contains a dispensing patch unit and an analyte sensing means (*e.g.*, sensor). This dual function device has the same configuration that was outlined above and can also be disconnected and reconnected at the patient's discretion.

[0012] Both third and fourth generation devices may use a single, small-sized battery. An example of such a battery is a zinc-air battery, as disclosed in co-pending, co-owned U.S. Provisional Application No. 60/961,484. These batteries have many advantages, including low weight, small size, low cost, long shelf lives, high specific energy and high stability. However, such batteries have a limited amount of stored energy of about 0.3 W·h, while a single use zinc-carbon AA battery has stored energy of about 1.2 W·h. AAA batteries, however, are more than ten times larger and heavier than zinc-air batteries. Therefore, in order to enable employment of a small size power source, which has limited stored energy, the energy consumption of the electrical components of the dispensing patch should be reduced, especially the energy consumption of the motor, which is the primary energy consumer.

[0013] The motor requires a substantial amount of energy for its operation: a current of about 500 mA and voltage of about 3 Volts, *i.e.*, 1.5 Watts of electrical power. The power output of a zinc-air battery provides an electrical current of 10 mA and voltage of about 1.2 Volts, *i.e.*, 0.012 Watts of electrical power. To provide the 3 Volts required by the motor and the CPU from a battery output of 1.2 Volts, a DC-DC step-up converter is used. The current requirements are provided by a pulsed power method, *i.e.*, accumulating energy over a relatively long period of time and releasing it very quickly, thereby increasing the instantaneously supplied power. As such, the pulsed method is based on generating periodic pulses of high power.

[0014] It is, therefore, essential that the pulses' parameters (*e.g.*, duty cycle, pulse duration, width and amplitude) comply with the electromechanical properties of the motor (*e.g.*, load, torque friction). This can be carried out, for example, by changing pulse duration according to

the load on the motor, as discussed in U.S. Patent No. 5,774,426 to Mai Xuan Tu et al. The electrical load on the motor is measured to determine missed steps of the motor (i.e., momentary failure of the motor). The energy supply to the motor is increased upon detection of the missed steps. Unfortunately, this invention is applicable only to a single phase step motor and it may require several iterations (including additional missed steps of the motor and loss of energy) prior to actually supplying energy sufficient to rotate the motor.

[0015] Another method to control the motor electronically is based on changing the duty cycle according to energy stored in an implanted infusion device power source, as discussed in U.S. Patent No. 7,122,026 to Rogers et al. The duty cycle is increased to compensate for power source depletion. Yet, some energy supply devices (e.g., zinc-air batteries) maintain nearly constant power supply even when depleted. Thus, applying this method would result in unnecessary energy consumption. This method also ignores other mechanical factors associated with the motor's operation, such as inertia and load.

## SUMMARY

[0016] A device for the delivery of fluid to a patient's body is provided. The device may include a miniature and thin portable programmable fluid dispensing unit. The dispensing unit may be a small, low cost, portable dispensing patch unit which is adherable to the patient's body. The dispensing unit may include two-parts: a disposable part and a reusable part. A power source may be incorporated into the infusion device and may include without limitation a single, small-sized, button battery.

[0017] In some embodiments, the dispensing unit includes a driving mechanism and pumping mechanism to dispense fluid from a reservoir to an outlet port that can be connected to a cannula subcutaneously inserted in the patient's body.

[0018] The device includes a motor (e.g., stepper motor or DC motor) requiring energy for its operation. The amount of required energy may include a current of about 500 mA and voltage of about 3 Volts, i.e., 1.5 Watts of electrical power. A zinc-air battery provides a current of 10 mA and voltage of about 1.2 Volts, i.e., 0.012 Watts of electrical power. To provide the 3 Volts

required by the motor and CPU from a battery output of 1.2 Volts, a DC-DC step-up converter is used. The current requirements are provided by a pulsed power method, i.e., accumulating energy over a relatively long period of time in a high capacity capacitor and releasing it very quickly, thus, increasing the instantaneous current and generating high power pulses for a short period of time. The motor is provided with a sequence of customized pulses, also referred to as a pulse train, each pulse being characterized by its current, width, duty cycle and frequency. Each pulse's width is adjusted to fulfill the power requirements of the motor, i.e., when changing the motor rotational velocity (*e.g.*, during acceleration or slow down), the pulses are wider than pulses associated with constant rotational velocity. It should be noted that although a stepper motor rotates in a fixed angle with each pulse provided to it, the motor output (*e.g.*, torque or steps per second) can be adjusted by customizing the pulses. For example, short duration pulses (*e.g.*, 0.4-0.6 milliseconds) will result in higher rotational velocity compared to long duration pulses (*e.g.*, 0.9-1.2 milliseconds).

[0019] In some embodiments, the motor is provided with pulsed power that is adjustable according to its rotational velocity. In turn, when the motor velocity changes, more power is provided to overcome the friction and inertia of the driving mechanism or pumping mechanism. On the other hand, when the velocity remains constant, only minimal power is supplied because only minor forces are exerted upon the driving mechanism or pumping mechanism. These forces may be utilized for stopping the pumping mechanism, and thereby less power would be required to stop the motor. The motor rotational velocity can be measured by counting the motor's revolutions per time unit as described in the co-owned, co-pending International Patent Application No. PCT/IL2008/000642, filed May 11, 2007, and entitled "Methods and Apparatus for Monitoring Rotation of an Infusion Pump Driving Mechanism," the disclosure of which is incorporated herein by reference in its entirety. In some embodiments, the motor may utilize a step-up voltage converter and pulsed power mechanism.

[0020] In some embodiments, the device may include a miniature energy source which is a sufficient energy source by virtue of a dedicated energy saving method employed for controlling a motor driver. Such may consider the driving mechanism's inertia and be implemented regardless of motor type, battery, pumping mechanism and other parameters and characteristics of the device.



[0021] In some embodiments, the device may employ an energy saving mode for the operation of the dispensing unit.

[0022] In some embodiments, a power supply mode may exploit the rotational inertia of the motor or pumping mechanism to save energy. In other embodiments, the power supply mode may exploit friction forces applied to the motor or pumping mechanism for saving energy.

[0023] In some embodiments, implementing the pulsed power method by using a low power source (*e.g.*, zinc-air battery) and energy storage device (*e.g.*, capacitor), the motor cannot rotate for a long period of time without a controller (*e.g.*, CPU). This safety mechanism inherently restricts an uncontrolled motor rotation which may result in drug overdose, fatal to the patient.

[0024] In some embodiments, the device includes a miniature dispensing unit having a small and low power battery that is sufficient to supply energy for the entire usage duration.

[0025] It is an object of some embodiments to provide accurate control of the motor's rotation while employing an energy saving mode.

[0026] It is an object of some of embodiments to provide a method to control the pulse parameters of the motor to save energy during the motor operation.

[0027] The foregoing and other features, aspects, and advantages of the present invention will be more apparent from the following detailed description.

## BRIEF DESCRIPTION OF THE DRAWINGS

[0028] Figs. 1a-c show a single-part dispensing unit (Fig. 1b), a two-part dispensing unit (Fig. 1c) and a remote control unit.

[0029] Figs. 2a-b show a single-part dispensing unit (Fig. 2a) and a two-part dispensing unit (Fig. 2b) employing a peristaltic pumping mechanism.

[0030] Figs. 3a-b show a two-part dispensing unit employing a peristaltic pumping mechanism.

[0031] Figs. 4a-b show a single-part dispensing unit (Fig. 4b) and a two-part dispensing unit (Fig. 4a) employing a syringe-piston pumping mechanism.

[0032] Fig. 5 shows a sensing and monitoring device for the control of rotational movements of the driving mechanism and pumping mechanism.

[0033] Fig. 6 shows a block diagram of the dispensing unit including energy suppliers and consumers.

[0034] Fig. 7 shows a block diagram of an energy supply and motor control of the dispensing unit.

[0035] Figs. 8a-b show an energy storage device for providing pulsed power.

[0036] Figs. 9a-b show power versus time and current versus time plots of the pulsed power supplied by a capacitor.

[0037] Figs. 10a-b are plots illustrating rotational velocity and power profiles as a function of time as supplied to the motor.

[0038] Figs. 11a-b are plots illustrating alternative rotational velocity and power profiles as a function of time.

[0039] Fig. 12 is a plot illustrating a pulse distribution required for a power profile as supplied to the motor.

[0040] Fig. 13 is a plot illustrating an energy distribution during a pulse train implementing the power profile shown in Fig. 10b.

[0041] Fig. 14 is a plot illustrating an energy distribution during a pulse train implementing the power profile shown in Fig. 11b.

[0042] Fig. 15 is a plot illustrating an example of a pulse train implementing the rotational velocity shown in Fig. 10a.

[0043] Fig. 16 is a plot illustrating an example of a pulse train implementing the rotational velocity shown in Fig. 10a.

[0044] Fig. 17 is a plot illustrating an example of a pulse train implementing the rotational velocity shown in Fig. 11a.

## DETAILED DESCRIPTION

[0045] A dispensing unit (10) and a remote control unit (40) are described herein. In some embodiments, the dispensing unit (10) may include a single part (as shown in Fig. 1b) or two parts (as shown in Fig. 1c). The two-part dispensing unit includes a reusable part (100) and a disposable part (200). The dispensing unit (10) may employ different dispensing mechanisms, including without limitation a syringe-type reservoir with a propelling plunger, peristaltic positive displacement pump. In some embodiments, the dispensing unit (10) can be adhered to the patient's body by a skin adherable cradle unit. An example of such a cradle unit is disclosed in the co-owned, co-pending U.S. Patent Application No. 12/004,837 and International Patent Application No. PCT/IL2007/001578, the disclosures of which are incorporated herein by reference in their entireties. The term "dispensing unit" is not limited to fluid delivery. In some embodiments, the dispensing unit (10) may be capable of dispensing fluid (*e.g.*, insulin) to a patient's body or sensing analyte (*e.g.*, glucose) in the body.

[0046] Infusion programming, data transferring and control of the dispensing unit (10) can be carried out by a remote control unit (40), which may be configured as a personal digital assistant ("PDA"), a hand watch, a cellular phone, or any other means. The remote control unit (40) is capable of establishing a unidirectional communication with the dispensing unit (10), i.e., the remote control unit (40) only transmits data to the dispensing unit (10) or only receives data from the dispensing unit (10). The communication link between remote control unit (40) and dispensing unit (10) can be also bidirectional, i.e., the remote control unit (40) is capable of transmitting and receiving data to and from the dispensing unit (10).

[0047] Figs. 2a-b show exemplary embodiments of the dispensing unit (10) employing a peristaltic pumping mechanism for dispensing fluid to a user's body. Fig. 2a shows a single-part

dispensing unit (10). The fluid is delivered from a reservoir (220) provided in the dispensing unit (10) through a delivery tube (230) to an exit port (213). The peristaltic pump includes a rotary wheel (110) provided with rollers (not shown) and a stator (190). Rotation of the rotary wheel (110) and periodic squeezing of the delivery tube (230) against the stator (190) positively displaces fluid from the reservoir (220) to the exit port (213). An example of such a positive displacement pump is disclosed in the co-owned, co-pending U.S. Patent Application No. 11/397,115, filed on April 3, 2006, the disclosure of which is incorporated herein by reference in its entirety. A driving mechanism (120) for rotating the rotary wheel (110) can be provided. The driving mechanism (120) includes a gear and a motor. The motor can be a Stepper motor, a DC motor, SMA actuator or any other motor. The driving mechanism (120) is controlled by electronic components (130) residing in the dispensing unit (10). The electronic components (130) may include a controller (not shown), a processor (132), a transceiver (131) and/or a transmitter (133). An appropriate power source (240) and an energy storage device (252) (*e.g.*, a capacitor) are also provided. The power source (240) may include without limitation one or more batteries, such as a button-sized zinc-air battery.

**[0048]** In some embodiments, the power source (240) may be a button battery and the energy storage device (252) may be a high capacity (*e.g.*, about 0.2 F) capacitor. Using a button battery usually requires the supply of pulsed power in order to increase the current output by the battery. The pulsed power mode is established by periodically charging and discharging the high capacity capacitor. Infusion programming of the dispensing unit (10) can be carried out either by remote control unit (40) and/or by manual buttons (15) provided on the dispensing unit (10).

**[0049]** Fig. 2b shows a two-part dispensing unit (10) that includes a reusable part (100) and a disposable part (200). The reusable part (100) includes a positive displacement pump provided with rotary wheel (110), driving mechanism (120), and electronic components (130). The disposable part (200) includes reservoir (220), delivery tube (230), power source (*e.g.*, button battery) (240), energy storage device (252), exit port (213), and stator (190). Pumping is enabled upon attachment of the two parts to each other. This arrangement is discussed in the co-owned, co-pending U.S. Patent Application No. 11/397,115, filed on April 3, 2006, the disclosure of which is incorporated herein by reference in its entirety. The power source (240) may also be located in the reusable part (100) and can be rechargeable.

[0050] Figs. 3a and 3b show respectively an embodiment of the two-part dispensing unit (10) prior to (as shown in Fig. 3a) and subsequent to (as shown in Fig. 3b) connection of the two parts. The reusable part (100) contains a peristaltic pumping mechanism provided with rotary wheel (110) and a driving mechanism (120) having a motor (121), a worm (126), a shaft (128) and gears (124). The reusable part (100) also contains electronic components (130). The disposable part (200) includes reservoir (220), delivery tube (230), power source (240), exit port (213), and stator (190). The power source (240) may be a zinc-air battery or button battery.

[0051] Figs. 4a-b show embodiments of the dispensing unit (10) employing a piston-plunger pumping mechanism for dispensing fluid to a user's body. Fig. 4a shows a two-part dispensing unit (10) having a reusable part (100) and a disposable part (200). The disposable part (200) includes reservoir (220) provided with plunger assembly (110), power source (*e.g.*, battery) (240), energy storage device (252), and exit port (213). In alternative embodiments, the plunger assembly (110) may be located in the reusable part (100) or be shared by both parts. The reusable part (100) includes a driving mechanism (120), which has a motor (121) (*e.g.*, Stepper motor, DC motor, or SMA actuator) and a driving gear (not shown) for displacing the plunger assembly (110). The driving mechanism (120) is controlled by electronic components (130), which has a controller (not shown), a processor (132), a transceiver (131), and/or a transmitter (133). Infusion programming can be carried out by a remote control unit (not shown) and/or by one or more buttons (15) provided on the dispensing unit (10). The power source (240) may be located in the reusable part (100) and may be rechargeable. An example of such a dispensing unit is disclosed in the co-owned, co-pending U.S. Provisional Patent Application No. 61/123,509, filed on April 9, 2008, the disclosure of which is incorporated herein by reference in its entirety.

[0052] Fig. 4b shows a single-part dispensing unit (10), which includes substantially similar components as the two-part dispensing unit (10). The components of the single-part dispensing unit (10) are deployed within a common housing (11). The embodiments shown in Figs. 4a-b are disclosed in the co-owned, co-pending International Patent Application No. PCT/IL2008/000641, the disclosure of which is incorporated herein by reference in its entirety.

[0053] Any of the above-mentioned embodiments may be provided with a sensing and monitoring device for controlling operation of the driving mechanism (120). Fig. 5 shows this

device employing a photo interrupter (113) as disclosed in the co-owned, co-pending International Patent Application No. PCT/IL2008/000642, the disclosure of which is incorporated herein by reference in its entirety. The sensing and monitoring device is provided with an encoder vane (116) configured as a 180 degree sector, which is affixed to a shaft (128) such that the encoder vane (116) rotates with the shaft (128) at the same rotational velocity. Photo-interrupter (113) is positioned such that as encoder vane (116) rotates it passes through space (S) between LED (112) and light detector (114). The motor's (121) rotational velocity can be derived from the shaft's (128) rotational velocity by taking into consideration the gear (124) reduction ratio. For example, when the shaft (128) rotates at 1 rotation per minute (RPM) and the gear (124) ratio is 3:1; the motor's (121) speed is 3 RPM. Other sensing and monitoring devices may also be employed to measure the motor's (121) rotational velocity.

[0054] Fig. 6 shows schematically the power source (240) and energy consuming components of the dispensing unit (10) controlled by controller (132). The energy consuming components include:

- a communication device (134), which may include without limitation RF, IR and other communication types (*e.g.*, magnetic relay, manual buttons, audible commands).
- a pumping mechanism (136) actuated by a driving mechanism having a motor and motor driver.
- a sensing and monitoring device (138), which may include without limitation an occlusion sensor or motion sensor.
- an indication device (140), (also referred to as "notification device"), which may include without limitation a buzzer or vibration alarm.

[0055] Fig. 7 shows a flow chart depicting an energy supply and control of the motor (121). In practice, a low price, small-sized power source (240) (*e.g.*, button battery) may be used, particularly a small quantity thereof, to provide a dispensing unit (10) that is of miniature size and lightweight. Due to the small size of a button battery, the electrical power output produced thereby, *i.e.*, current ("*i*") and voltage ("*v*"), is substantially lower than the electrical power required for motor operation, *i.e.*, a condition is satisfied whereby

$$i_{battery} \cdot v_{battery} \ll i_{motor} \cdot v_{motor} \text{ or } W_{battery} \ll W_{motor}$$

[0056] For example, a zinc-air battery has a maximum power output of about 0.03 Watts (*e.g.*, current of about 25 mA and voltage of about 1.2 Volts), while the motor (121) requires electrical power of 1.5 Watts (*e.g.*, current of about 500 mA and voltage of about 3 Volts). It can be seen in this example that the electrical power ( $W_{motor}$ ) required by the motor is 50 times larger than what the battery ( $W_{battery}$ ) is able to supply. The electric power required by the motor is not limited to the particular electrical power indicated above.

[0057] Thus, in order to enable operation of the motor (121), the voltage and current supplied thereto are increased. Voltage increase can be carried out by virtue of a DC-DC converter (254) which can for example convert the 1.2 Volts supplied by the battery, *i.e.*, power source (240), to the voltage required by the motor (121), *i.e.*, 3 Volts. Increasing the current can be carried out by a pulsed power method, *i.e.*, by charging the energy storage device (252) (*e.g.*, a 0.2 F capacitor) for approximately 1 second and then discharging it for about 20 milliseconds. This enables multiplication of the current by 50 times.

[0058] The 3V voltage is also supplied to the controller (132) and to the sensing and monitoring device (138) (*e.g.*, revolution counters). Such a sensing and monitoring device (138) is disclosed in the co-owned, co-pending International Patent Application No. PCT/IL2008/000642, as noted above. The motor driver (255), which is controlled by the controller (132), operates the motor (121) by providing it with a pulsed power, as shown by line (109). The pulsed power is supplied by the energy storage device (252).

[0059] In some embodiments, the motor's (121) operation is controlled by the principle of a closed-loop feedback, according to which the amount of power supplied to the motor (121) is adjusted based on the motor's (121) rotational velocity (38). Sensing and monitoring device (138) (*e.g.*, revolution counter or rotation sensor) measures the motor's (121) output as shown by dashed line (22) and provides the controller (132) with the required data, including without limitation, the motor's (121) instant rotational velocity, as shown by dashed line (38). In some embodiments, the sensing and monitoring device (138) merely provides a number of revolutions of the motor (121), while the velocity is calculated by the controller (132). In some

embodiments, the motor's (121) mechanical energy may be converted into electrical energy, as shown by line (108). This energy can be stored in the energy storage device (252) for later use.

[0060] Figs. 8a-b show the main components depicted in Fig. 7: the motor (121), the energy storage device (252), and the power source (240) connected by flat strip connectors (241) to other electrical components (130). The energy storage device (252) can be a high capacity capacitor having a capacity of 180 mF to 200 mF. It is advantageous if the capacitor has a flat configuration and reduced dimensions (*e.g.*, 29 mm x 17 mm x 0.9 mm). Consequently, the capacitor may be placed parallel to the electronic components (130) (*e.g.*, a printed circuit board), which allows the dispensing unit (10) to be kept as small and thin as possible. In practice, the capacitor having the above-mentioned configuration and dimensions provides a dispensing unit having thickness less than 15 mm.

[0061] Figs. 9a-b are power-time plots illustrating a pulsed power produced by a capacitor and supplied to the motor. In some embodiments, the supply of pulsed power includes two modes: accumulation mode (400) and release mode (500). During the accumulation mode (400), a battery charges the capacitor. During the release mode (500), the capacitor is being discharged and supplies current to power consuming components of the dispensing unit, including without limitation, the motor and electronic elements.

[0062] The ratio between the accumulation time (" $t_{accumulation}$ ") and release time (" $t_{release}$ ") is proportional to the ratio between the power required for operation of power consuming components, such as a motor (" $W_{motor}$ ") and the electrical power outputted by a battery (" $W_{battery}$ "), *i.e.*,

$$\frac{t_{accumulation}}{t_{release}} \propto \frac{W_{motor}}{W_{battery}}$$

[0063] Fig. 9a shows a graph of a typical charging/discharging cycle of the capacitor having the two modes. It is clear that the duration of the accumulation mode (400) is substantially longer than the release mode (500). In practice, this duration may be 50 times longer. Therefore, the maximal pulse train duration applied for activating the motor is less than the release mode (500) duration. In alternative embodiments, the charge stored in the capacitor may be monitored (*e.g.*,



by an A/D converter), thereby allowing a dynamic control over the discharging and recharging of the capacitor to be achieved.

[0064] Fig. 9b shows schematic graphs of the power (“Power”) and current (“ $i$ ”) of a charging/discharging cycle of the capacitor. During accumulation mode (400), the energy that is supplied by the battery is accumulated and stored in the capacitor. In practice, when applying a 0.2F capacitor and a zinc-air battery, it may take 980 milliseconds. The energy ( $p_1$ ) that is stored in the capacitor gradually increases while the supplied current ( $i_1$ ) remains constant. During the release mode (500), the capacitor discharges and, supplies the required amount of power to the power consuming components. When the capacitor has 0.1F capacity and the battery is a silver-oxide button-sized battery with 0.186 Watt output, the release mode can take 10 milliseconds, while the accumulation time is about 8 times higher. Discharged power and current are designated as  $p_2$  and  $i_2$ , respectively. In some embodiments, there may be continued charging of the capacitor, even during the discharge phase, which shortens the time interval between two consecutive pulses. If the capacitor is fully loaded, the charging process may not continue.

[0065] Fig. 10a shows the angular velocity ( $\omega_m$ ) of the motor versus time (t) and Fig. 10b shows the corresponding power (P) discharged from the capacitor and supplied to the motor. During this period, the motor operates the pump to deliver fluid (e.g., insulin) via the dispensing unit. When the motor is rotated based on energy from the capacitor only a limited amount of fluid can be delivered during a single charging/discharging cycle and, therefore, more than one cycle may be required to deliver the appropriate amount of fluid required for therapeutic treatment.

[0066] In some embodiments, a variant pulse train can be supplied to the motor each time the capacitor is being discharged. The amount of power supplied during the discharge of the capacitor depends upon whether the motor rotates with constant or variable rotational velocity.

[0067] At  $t = t_0$ , the motor begins to rotate and its rotational velocity should be gradually increased up to a certain velocity. The increasing velocity is designated as  $a_1$ . The velocity increases due to supplying a certain amount of electrical power delivered by the capacitor to the motor ( $P > 0$ ). This power is designated as  $b_1$ . At  $t = t_1$ , the motor’s angular velocity is constant, as represented on the graph in Fig. 10a as a plateau. The achieved velocity is designated as  $a_2$ . The amount of power required to keep the motor rotating at constant velocity  $a_2$  can be  $b_2$ , which

is less than  $b_1$  since constant angular velocity ( $\omega_m$ ) is maintained due to inertia. Thus, the required power ( $b_2$ ) is less than  $b_1$ . During the time interval from  $t = t_2$  to  $t = t_3$ , the velocity of the motor is decreased until full stop (the decreasing velocity is designated as  $a_3$ ). The velocity can be reduced by supplying power  $b_3$ , as may be required to overcome inertia until stopping the motor. In some embodiments, the time interval from  $t = t_1$  to  $t = t_3$  is about 20 milliseconds.

[0068] The pattern of the pulses is typically predetermined when the pulse trains are tailored. That is, the dispensing pump is initially configured with at least one pulse train. In some embodiments, the dispensing pump controller can adjust and combine various pulses and pulse trains as needed. In other embodiments, the controller can adjust and schedule the pulse train (e.g., energy, number of pulses, width of pulses, or frequency) based on the energy stored in the energy storage device or power source.

[0069] Figs. 11a-b refer to another embodiment and show graphs of the angular velocity ( $\omega_m$ ) of the motor versus time ( $t$ ) and the corresponding power ( $P$ ) required by the motor versus time ( $t$ ). The graphs depict variations in velocity and power during drug delivery, while an alternative operational mode of the motor is employed for saving energy. The two first phases designated by  $a_1$ ,  $a_2$  and  $b_1$ ,  $b_2$  are identical to those referred to in Figs. 10a-b. During the time interval starting at  $t = t_2$  and ending at  $t = t_3$ , the velocity of the motor is decreased merely due to friction forces until a full stop (the reducing velocity is designated in Fig. 11a as  $a_4$ ). Fig. 11b shows that in this time interval ( $t = t_2$  to  $t = t_3$ ), the motor continues to rotate and no energy is required. Therefore, energy associated with the rotation of the motor is available for use by the energy consuming components while the motor itself does not require supply of energy, i.e., during this phase the motor may operate like a dynamo.

[0070] Fig. 12 shows current ( $i$ ) supplied to the motor versus time ( $t$ ), during a pulse train employing the operation mode described in Figs. 10a-b. The current ( $i$ ) is supplied by pulses while each pulse is characterized by a time interval ("T") (i.e., a period). The initial pulse (e.g., between  $t_1$  and  $t_2$ ) has long period  $t_1$ , typically lasting for 1 to 1.5 millisecond, for setting the driving mechanism into motion and for accelerating the motor. The duration of each consecutive pulse is either equal or shorter than the former. In some embodiments, the second phase has a minimal pulse period  $t_2$  of about 0.5 milliseconds. This trend is turned over when the motor

speed is decreased, i.e., in this phase the motor is decelerating and each period  $t_3$  of each pulse is either equal or longer than the former.

[0071] For example, the duration of the  $n$  pulses of an exemplary pulse train can be written as shown in the following equation:

$$t_1 \geq t_2 \geq t_3 \geq \dots \leq t_{n-1} \leq t_n$$

[0072] Since a pulse duration ( $t$ ) is inversely proportional to the angular velocity of the motor ( $\omega$ ), ( $t \propto 1/\omega$ ), the above equation can be accordingly rewritten as follows:

$$\omega_1 \leq \omega_2 \leq \omega_3 \leq \dots \geq \omega_{n-1} \geq \omega_n$$

[0073] According to some embodiments, every pulse is tailored to rotate the motor's axis through an identical angle (known as a 'step'). Enabling a constant angular rotation resulting from each discrete pulse and providing the same amount of fluid is highly advantageous in that it simplifies the dispensing pump control and calibration, for example, when calculating the number of pulses needed to deliver a required amount of therapeutic fluid. This is achieved by maintaining constant the multiple of pulse duration by the rotational velocity it causes:

$$t_1 \cdot \omega_1 = t_2 \cdot \omega_2 = t_3 \cdot \omega_3 = \dots = t_{n-1} \cdot \omega_{n-1} = t_n \cdot \omega_n = 18^\circ$$

[0074] Figs. 13-14 shows current ( $i$ ) supplied to the motor versus time ( $t$ ), according to some embodiments. Conventional methods for supplying energy to motors of infusion devices employ pulses in which a constant level of power is provided to the motor during each pulse period (i.e., a 100% duty cycle). This method can be employed to the device disclosed herein as well, i.e., power pulse trains may be supplied to the motor while each pulse train includes pulses of power during which power would be supplied non-invariantly at three various levels  $b_1$ ,  $b_2$  and  $b_3$  lasting during respective periods  $t_1$ ,  $t_2$  and  $t_3$  following without interruption.

[0075] In some embodiments, supply of power may be organized during each pulse with interruptions. As shown schematically in Fig. 13 there could be provided three different operational phases and each pulse of the pulse train includes:

- A discharge phase (510) – pulsed power is provided to the motor by discharging a capacitor.
- A null phase (520) – power supply is interrupted and power is not supplied to and neither generated by the motor.
- A charge phase (530) – energy is generated by the motor and this energy can be supplied to power consuming components.

[0076] The pulses typically include discharge (510) and null (520) phases or null (520) and charge (530) phases but may include only discharge (510) or charge (530) phases.

[0077] Fig. 13 shows a graph of the current ( $i$ ) supplied to the motor versus time ( $t$ ), for generating the angular velocity according to principles described in connection with Figs. 10a-b. The graph shows a single pulse train, which includes three initial pulses. Each one of initial pulses (*e.g.*, the pulses designated as  $p_1$ ,  $p_2$  and  $p_3$ ) have two phases: a discharge phase (510) (designated as  $w_1$ ,  $w_2$  and  $w_3$ ), followed by a null phase (520).

[0078] In some embodiments, the null phase (520) is 10% to 30% of the pulse period, *i.e.*, the width of these pulses is of 70% to 90%. In some embodiments, the dispensing pump controller applies pulse width modulation (PWM) for changing the width of the pulses to generate the determined pulse train. It should be appreciated that other methods for exploiting the motor's inertia for reducing the energy supply may be implemented, such as by changing the pulse period, amplitude, or shape (*e.g.*, triangle, square, sine wave).

[0079] Halting motor operation is carried out by the last pulses of the pulse train (*e.g.*,  $p_{n-1}$  and  $p_n$ ). The discharge phase (510) of these pulses equals the duty cycle;  $p_{n-1} = \omega_{n-1}$  and  $p_n = \omega_n$ . This causes the motor to stop almost immediately, so that no excess fluid is delivered by the dispensing unit.

[0080] Fig. 14 shows a graph of current ( $i$ ) supplied to the motor versus time ( $t$ ), for implementing the principle described above in connection with Figs. 10a-b. The graph shows a pulse train. The last pulses of the pulse train (*e.g.*,  $p_{n-1}$  and  $p_n$ ) include a single phase, *i.e.*, the

charge phase (530). This mode of operation enables the motor to generate energy due to its rotation and to transfer it to an energy storage device.

[0081] The halting method is shown in Figs. 11a-b and may require the use of a sensing and monitoring device (*e.g.*, a sensor) to detect the relative position (*i.e.*, angle) of the rotary wheel. The sensing and monitoring device may be required to achieve an accurate fluid delivery employing a flow correction mechanism.

[0082] Although particular embodiments have been disclosed herein in detail, this has been done by way of example for purposes of illustration only, and is not intended to be limiting with respect to the scope of the claims. In particular, it is contemplated by the inventors that various substitutions, alterations, and modifications may be made without departing from the spirit and scope of the devices and methods defined by the claims. Other aspects, advantages, and modifications are considered to be within the scope of the claims. The claims presented are representative of the devices and methods disclosed herein. Other, presently unclaimed devices and methods, are also contemplated. The inventors reserve the right to pursue such devices and methods in later claims.

[0083] The following examples serve to illustrate embodiments of the disclosed devices and methods and are given for illustrative purposes only and are not intended to limit the present disclosure.

## EXAMPLES

[0084] Figs. 15, 16 and 17 show examples of pulse train supplied to the motor according to some embodiments. These figures show the discharge phase (510), in which power is supplied to the motor, the null phase (520) in which no power is supplied to the motor and the charge phase (530) when power is generated by the motor.

[0085] The pulse trains were tailored to reduce the power provided to the motor while each pulse rotates the motor by 20 degrees. The power source in these examples is a zinc-air button battery,

a 0.2F capacitor and two phase motor commercially provided by Nidec Copal Corporation (U.S.A.).

[0086] The pulses are provided by PWM and/or by changing the pulse period.

#### Example 1

[0087] Fig. 15 shows a pulse train for rotating the motor by 160 degrees composed of three sets of pulses:

- The first set of pulses is applied for accelerating the motor and includes three pulses lasting for 2.3 milliseconds.
- The second set of pulses is designed for maintaining the motor speed and includes four pulses, each having a 1.15 millisecond period. This set of pulses rotates the motor by the same angle as the first set but requires 50% less power. To increase the energy efficiency, the last two pulses may have 80% width of the duty cycle.
- The third set of pulses is for stopping the motor and is identical to the first set but in reversed phase.

[0088] In this example all the pulses have 100% pulse width (i.e., the pulse width equals the pulse duration).

#### Example 2

[0089] Fig. 16 shows a pulse train designed to rotate the motor by 520 degrees at a lower rotation velocity than that disclosed in Example 1. This pulse train is composed of three sets of pulses:

- The first set of pulses is applied for accelerating the motor and includes four pulses lasting for 1.0 millisecond.
- The second set of pulses is designed for maintaining the motor speed and includes 22 pulses, each having a 0.7 millisecond period. If the pulses in this set were tailored as the

first set (as described in the prior art), the energy consumption of this set would be 40% higher.

- The third set of pulses includes two stop pulses lasting for 1.0 millisecond, wherein a 90% duty cycle is applied to stop the motor rotation.

### Example 3

[0090] Fig. 17 shows a pulse train that does not apply power to stop the motor. The pulse train includes two sets of pulses:

- The first set of pulses is applied for accelerating the motor and includes four pulses lasting for 1.0 millisecond.
- The second set of pulses is designed for maintaining the motor speed and includes 22 pulses, each having a 0.7 millisecond period.
- Also shown are two pulses (530) supplied by the motor for recharging the capacitor, i.e., the motor functions as a dynamo by transferring kinetic energy to electrical power.

[0091] Example 3 requires less energy than the pulse train described in Example 2 and provides two more steps to the motor (which are applied to stop the motor in Example 2). The inertia of the motor at the end of this pulse train can be converted by the motor to electrical power, which can be provided to other electrical components of the dispensing unit. This pulse train requires 29.1 J, provides 26 steps of rotation and can also retrieve part of the excess power provided to the motor. A standard method of motor activation would be composed of 20 pulses lasting 1.0 millisecond each, whereby at least two of them are applied for stopping the motor. Thus, less than 20 steps can be provided in this method.

What is claimed is:

1. A method for powering a medical device for delivering fluid to a body or sensing body analyte by activating a driving mechanism of the medical device, the method comprising transferring energy to the driving mechanism in a form of at least one pulse train pattern, wherein at least two pulses of the at least one pulse train pattern are different.
2. A method for powering a medical device for delivering fluid to a body or sensing body analyte by activating a driving mechanism of the medical device, the method comprising:  
  
accumulating energy by charging an energy storage device; and  
  
discharging the energy from the energy storage device to operate the driving mechanism, wherein discharging comprises transferring the energy to the driving mechanism in a form of pulsed power using at least one pulse train pattern.
3. The method according to claim 2, wherein accumulating energy is performed during a first period of time and discharging energy is performed during a second period of time, wherein a ratio of said first period of time to said second period of time is proportional to a ratio of a minimum power required for activation of the driving mechanism to a power provided by the energy storage device.
4. The method according to claim 2, further comprising changing at least one pulse in the at least one pulse train pattern.
5. The method according to claims 1 or 2, further comprising changing at least one pulse in the at least one pulse train pattern by changing at least one of a width, a frequency, a duty cycle, a period and/or energy delivered by the at least one pulse.
6. The method according to claim 5, wherein the at least one pulse comprises a first period of time during which energy is delivered and a second period of time during which energy is not delivered.



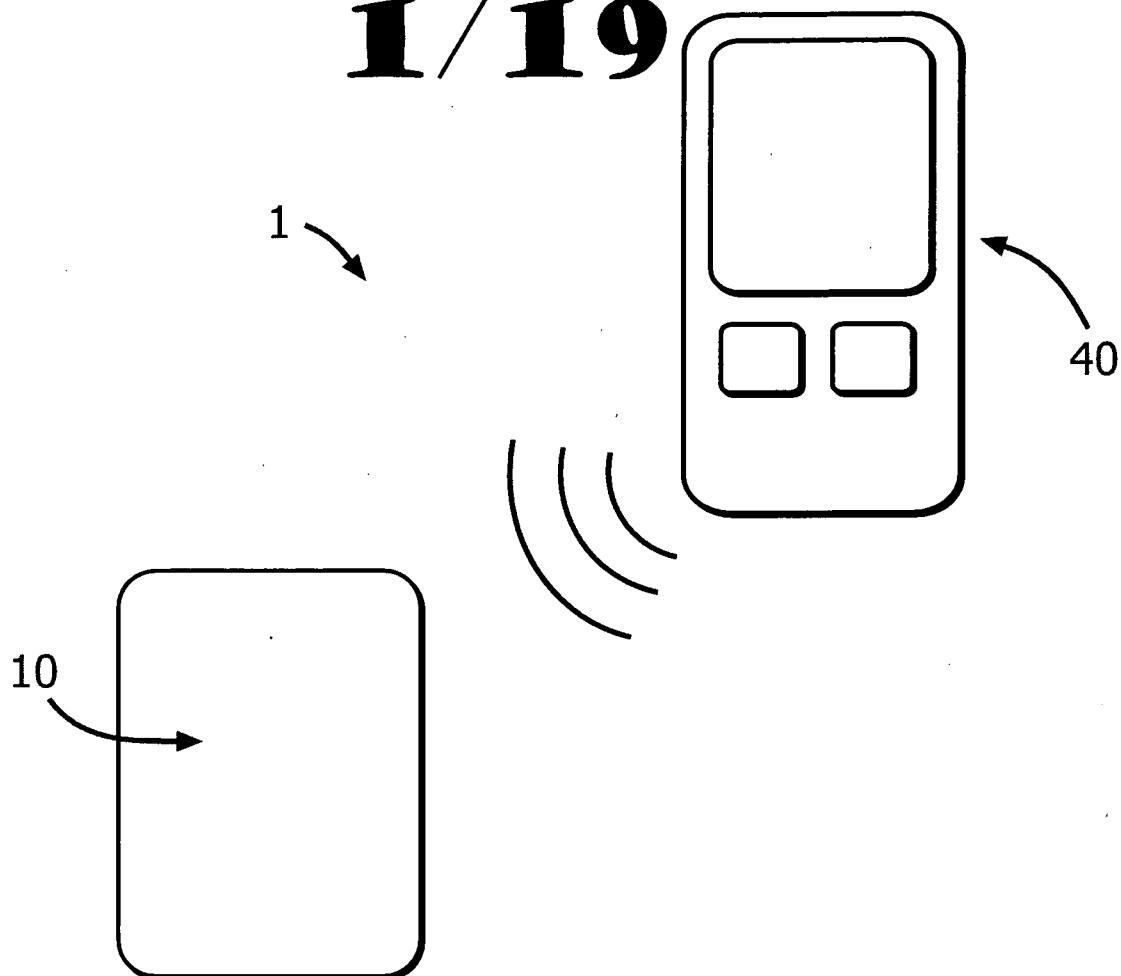
7. The method according to claim 2, wherein discharging energy comprises using at least one pulse in the at least one pulse train pattern to achieve one or more of the following:  
  
maintaining a constant rotational velocity of the driving mechanism;  
  
altering a rotational acceleration of the driving mechanism; or  
  
altering a rotational velocity of the driving mechanism.
8. The method according to claims 1 or 2, further comprising altering at least one pulse of the at least one pulse train pattern to stop the driving mechanism.
9. The method according to claims 1 or 2, further comprising altering at least one pulse of the at least one pulse train pattern to reduce a rotational velocity of the driving mechanism.
10. The method according to claim 9, wherein the driving mechanism is decelerated when a power supply to the driving mechanism is reduced.
11. The method according to claim 10, further comprising:  
  
generating energy from the deceleration of the driving mechanism; and  
  
applying said generated energy to charge said energy storage device or to operate another component in the medical device.
12. The method according to claims 1 or 2, wherein the energy provided to the driving mechanism is dependent on the speed of the driving mechanism.
13. The method according to claim 12, wherein the speed of the driving mechanism is measured by a sensing and monitoring device and communicated to a controller.
14. The method according to claim 3, wherein there is substantially no time delay between the first period of time and the second period of time.

15. The method according to claims 1 or 2, wherein the rotational velocity of the driving mechanism increases during a first period of time due to a first amount of constant energy delivered, remains constant during a second period of time due to a second amount of constant energy delivered and decreases during a third period of time due to a third amount of constant energy delivered.
16. The method according to claim 2, further comprising providing a zinc-air battery for charging the energy storage device.
17. The method according to claims 4 or 5, wherein changing the at least one pulse in the at least one pulse train pattern is based on the energy stored in the energy storage device.
18. The method according to any one of claims 1-17, wherein the medical device comprises a dispensing unit adherable to the body of a patient.
19. The method according to claim 17, wherein the dispensing unit comprises:  
a reusable part containing at least part of said driving mechanism and electronic components, including the energy storage device;  
a disposable part having a reservoir; and  
a power source electrically coupled to at least one of said electronic components for supplying energy upon connection of said reusable part and said disposable part.
20. The method according to claim 18, wherein the medical device further comprises a skin adherable cradle unit and a remote control unit, wherein said dispensing unit is connectable to and disconnectable from the cradle unit, and said remote control is capable of communicating with the dispensing unit for its operation.
21. The method according to any of claims 1-20, wherein the fluid comprises insulin and the body analyte comprises glucose.
22. A medical device comprising a controller for executing software instructions that implement the method of any of claims 1-21.

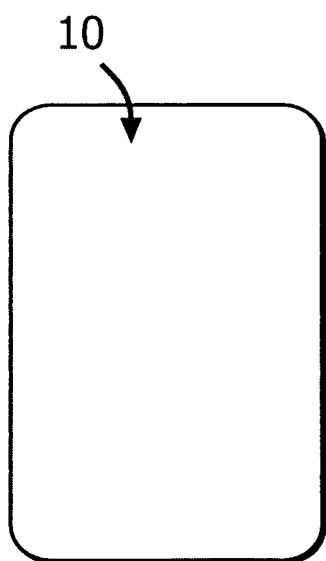
23. A medical device for delivering fluid to a body or sensing body analyte, the medical device comprising:
- a pumping mechanism;
  - a driving mechanism for activating said pumping mechanism to dispense fluid; and
  - a power source coupled to said driving mechanism and having an energy storage device for providing a pulsed power to activate said driving mechanism.
24. The medical device according to claim 23, wherein the pulsed power is transferred to said driving mechanism using at least one pulse train pattern.
25. The medical device according to claim 24, wherein during said activation of said driving mechanism at least two different pulses are transferred to said driving mechanism.
26. The medical device according to claim 25, wherein said at least two different pulses are characterized by a width, a frequency, a duty cycle, a period and/or energy delivered by each pulse.
27. The medical device according to claim 26, wherein at least one pulse of said at least two different pulses comprises a first period of time during which energy is delivered and a second period of time during which energy is not delivered.
28. The medical device according to claim 24, wherein said at least one pulse train pattern is configured to achieve one or more of the following:
- maintaining a constant rotational velocity of said driving mechanism;
  - altering a rotational acceleration of said driving mechanism; or
  - altering a rotational velocity of said driving mechanism.
29. The medical device according to claim 24, wherein said driving mechanism is stopped using at least one pulse of at least one pulse train pattern.

30. The medical device according to claim 23, wherein said medical device further comprises a controller for adjusting the at least one pulse train pattern.
31. The medical device according to claim 30, wherein adjusting the at least one pulse train pattern is based on the energy stored in the energy storage device.
32. The medical device according to claim 25, wherein the controller is coupled to a sensing and monitoring device to adjust the speed of the driving mechanism and measure the speed of the driving mechanism.
33. The medical device according to claim 23, wherein the rotational velocity of the driving mechanism increases during a first period of time due to a first amount of constant energy delivered, remains constant during a second period of time due to a second amount of constant energy delivered and decreases during a third period of time due to a third amount of constant energy delivered.
34. The medical device according to claim 23, wherein the power source is a zinc-air battery.
35. The medical device according to claim 23, comprising:
  - a reusable part containing at least part of said driving mechanism and electronic components, including the energy storage component;
  - a disposable part having a reservoir, wherein the power source is electrically coupled to at least one of said electronic components for supplying energy upon connection of said reusable part and said disposable part.
36. The medical device according to any one of claims 23-35, further comprising:
  - a skin adherable cradle unit;
  - a remote control unit; and
  - a dispensing unit having the pumping mechanism and driving mechanism and being connectable to and disconnectable from the cradle unit, wherein said remote control communicates with the dispensing unit for its operation.
37. The medical device according to any of claims 23-36, wherein the fluid comprises insulin and the body analyte comprises glucose.

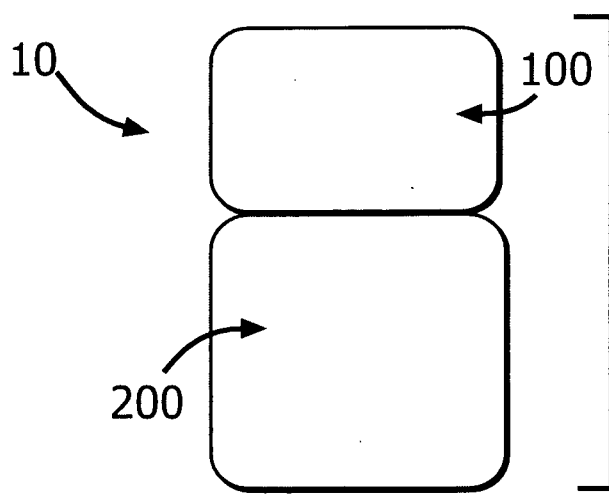
**1 / 19**



**FIG. 1a**

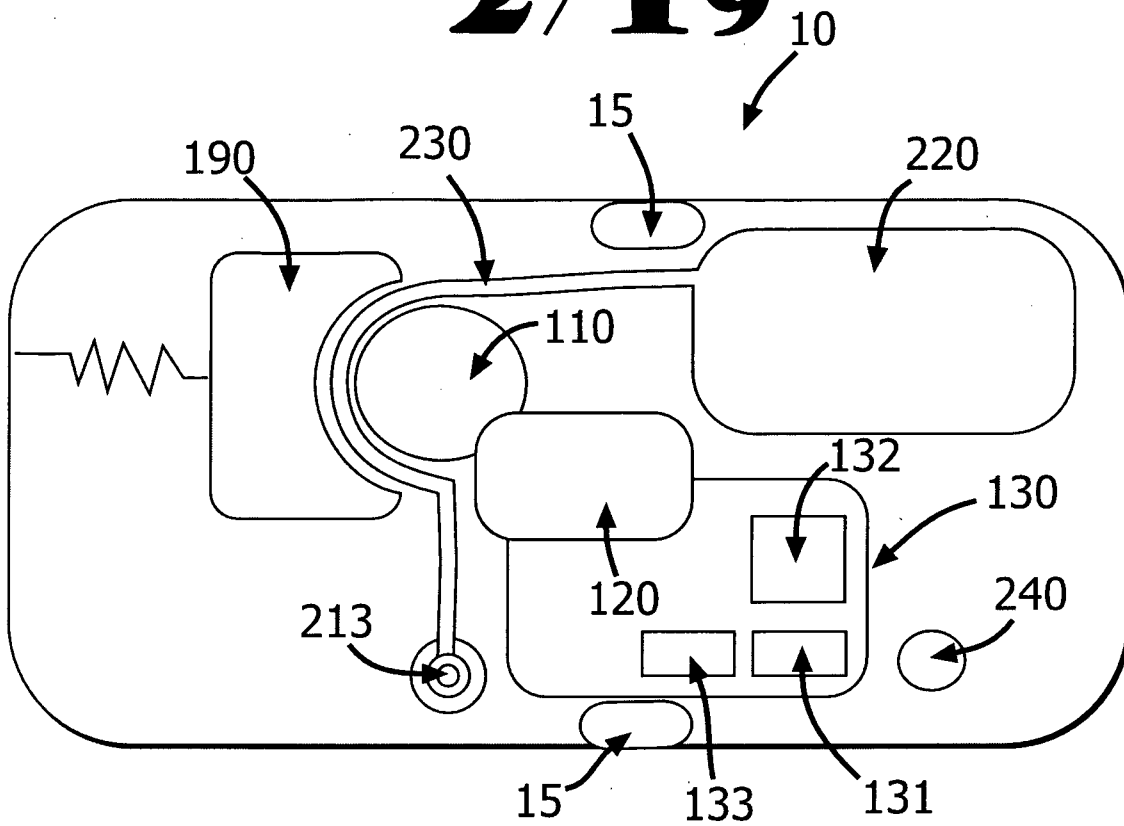


**FIG. 1b**

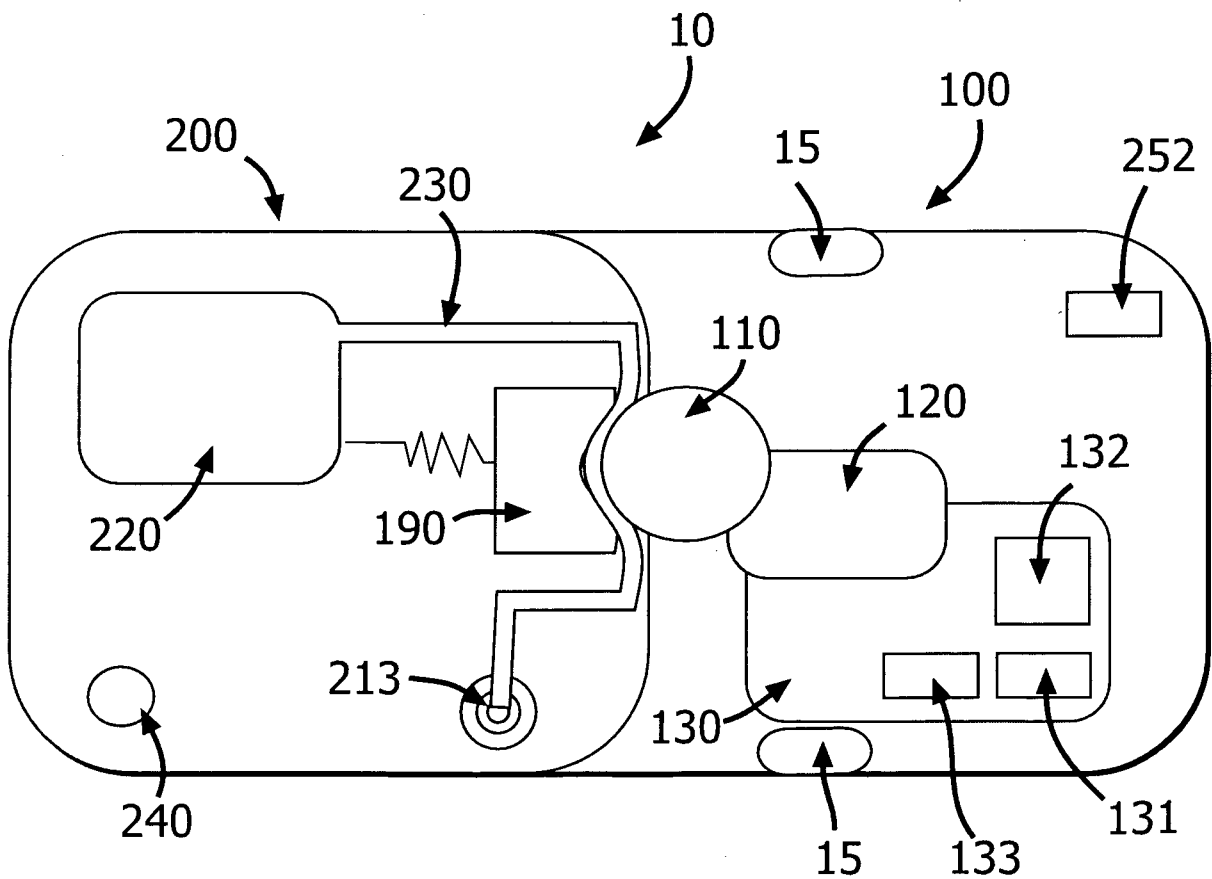


**FIG. 1c**

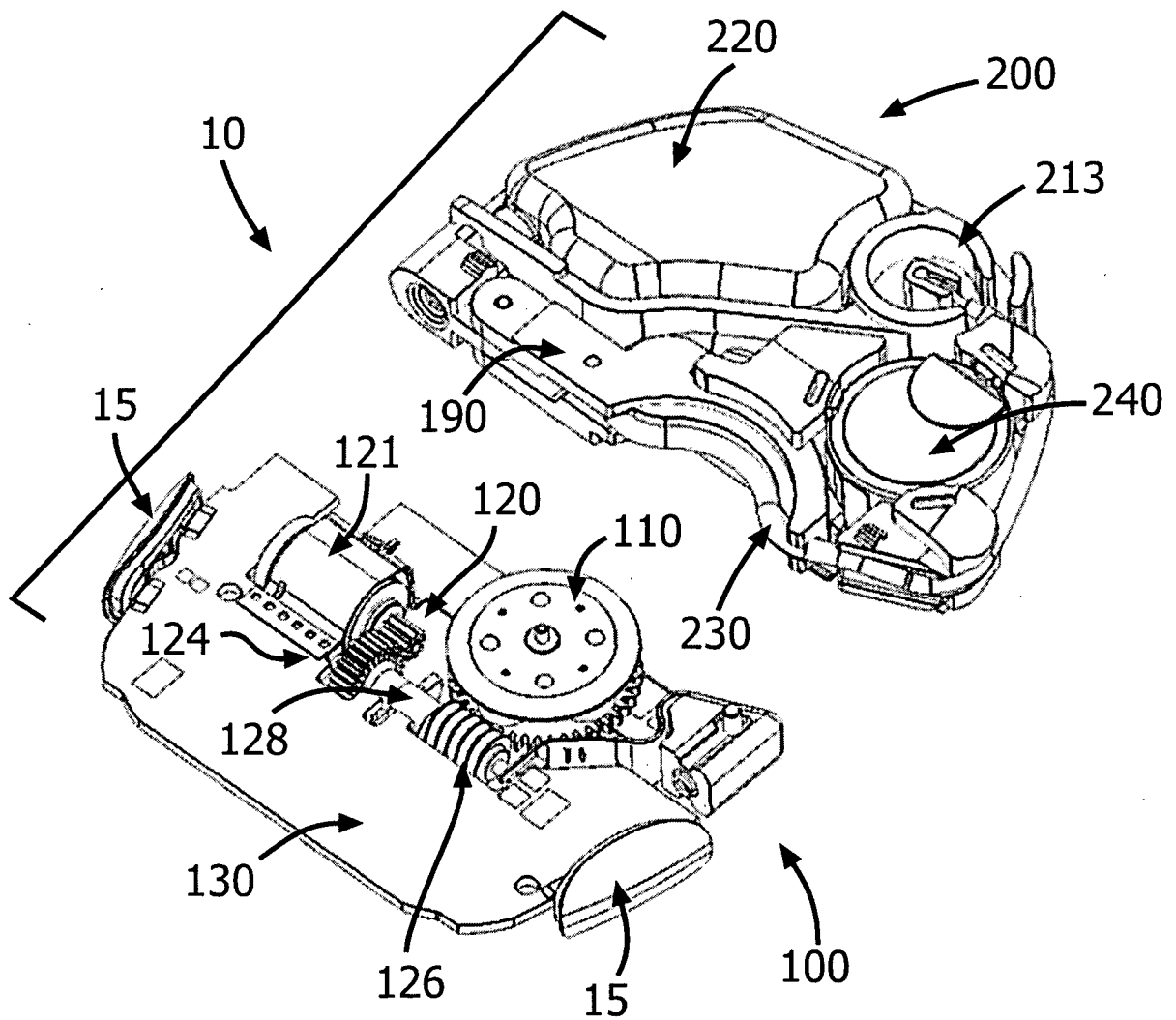
**2/19**

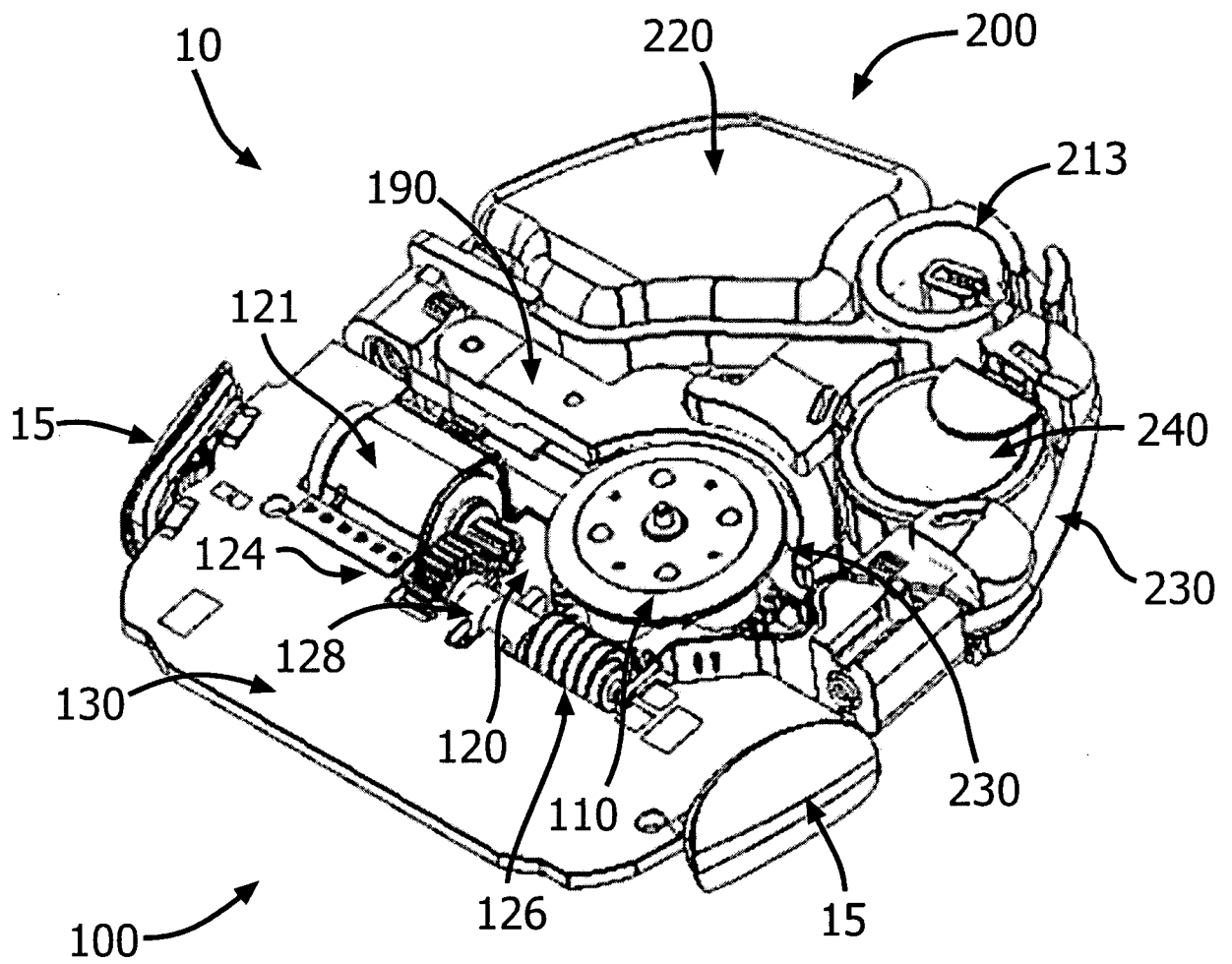


**FIG. 2a**

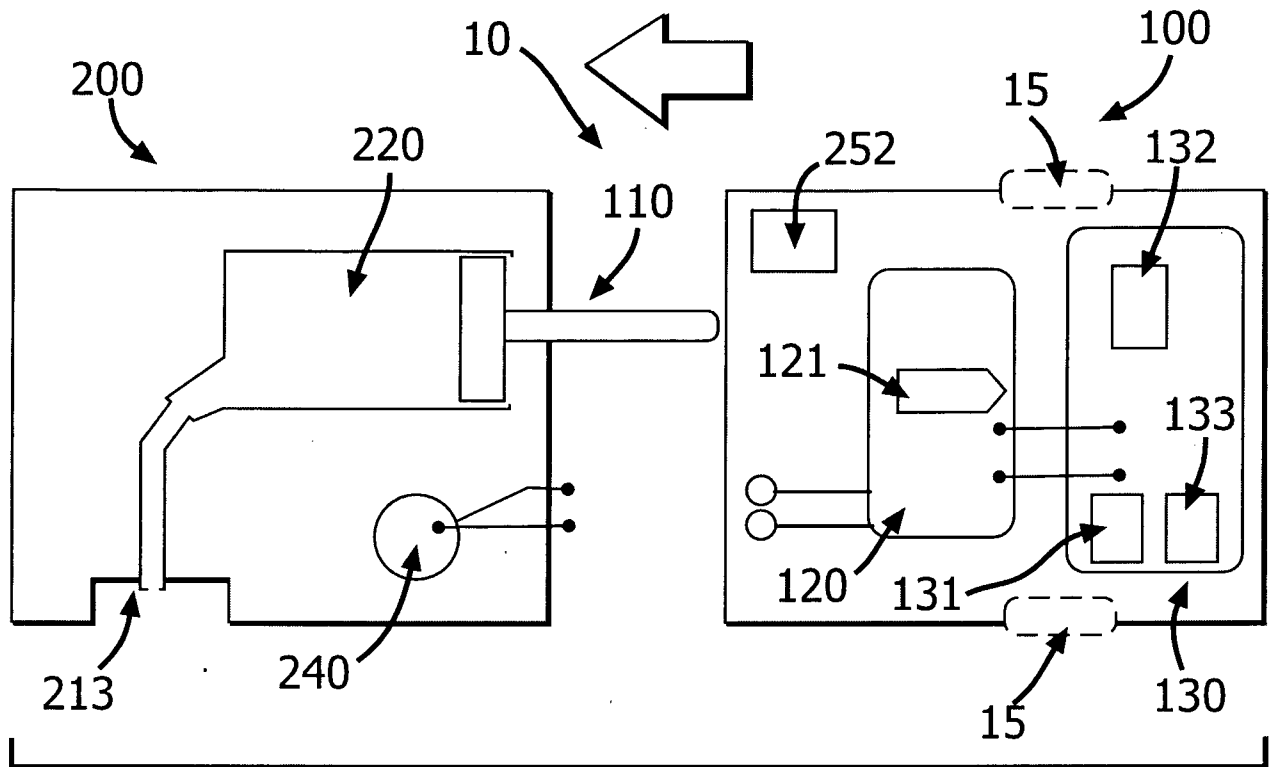
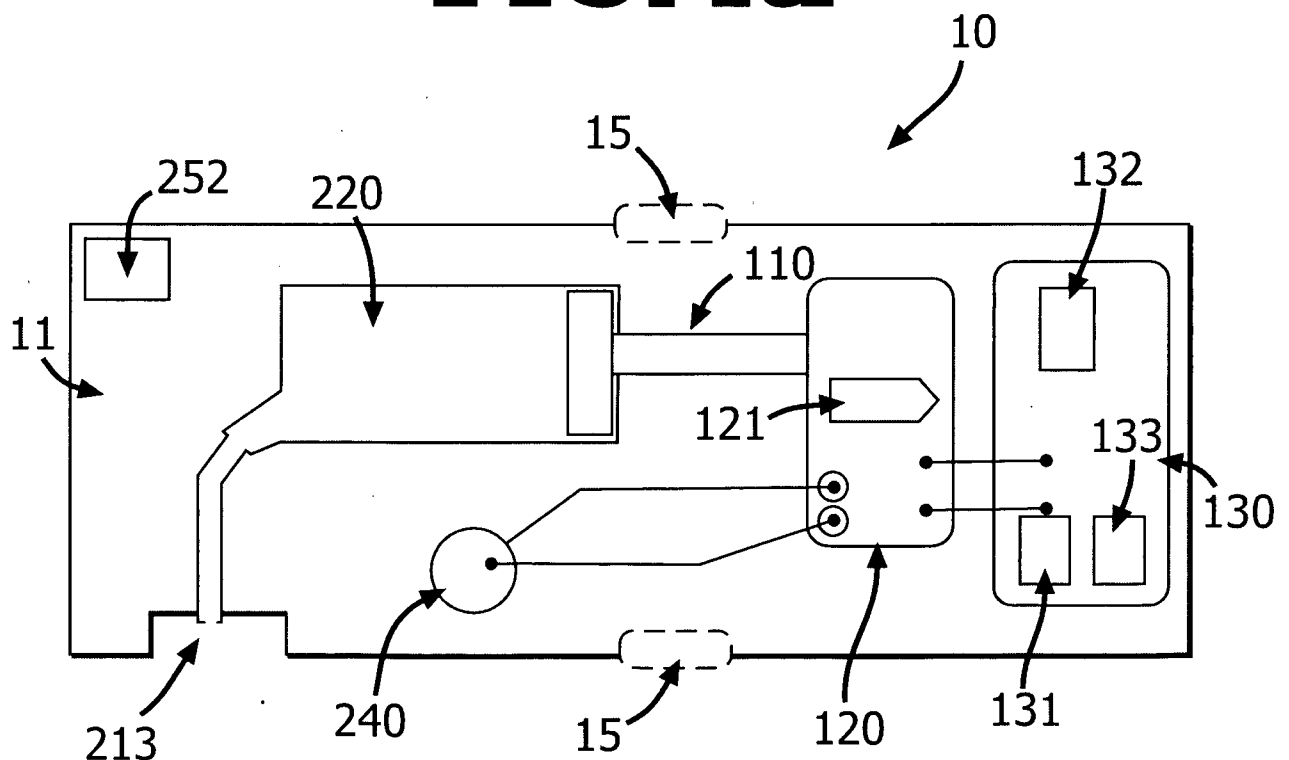


**FIG. 2b**

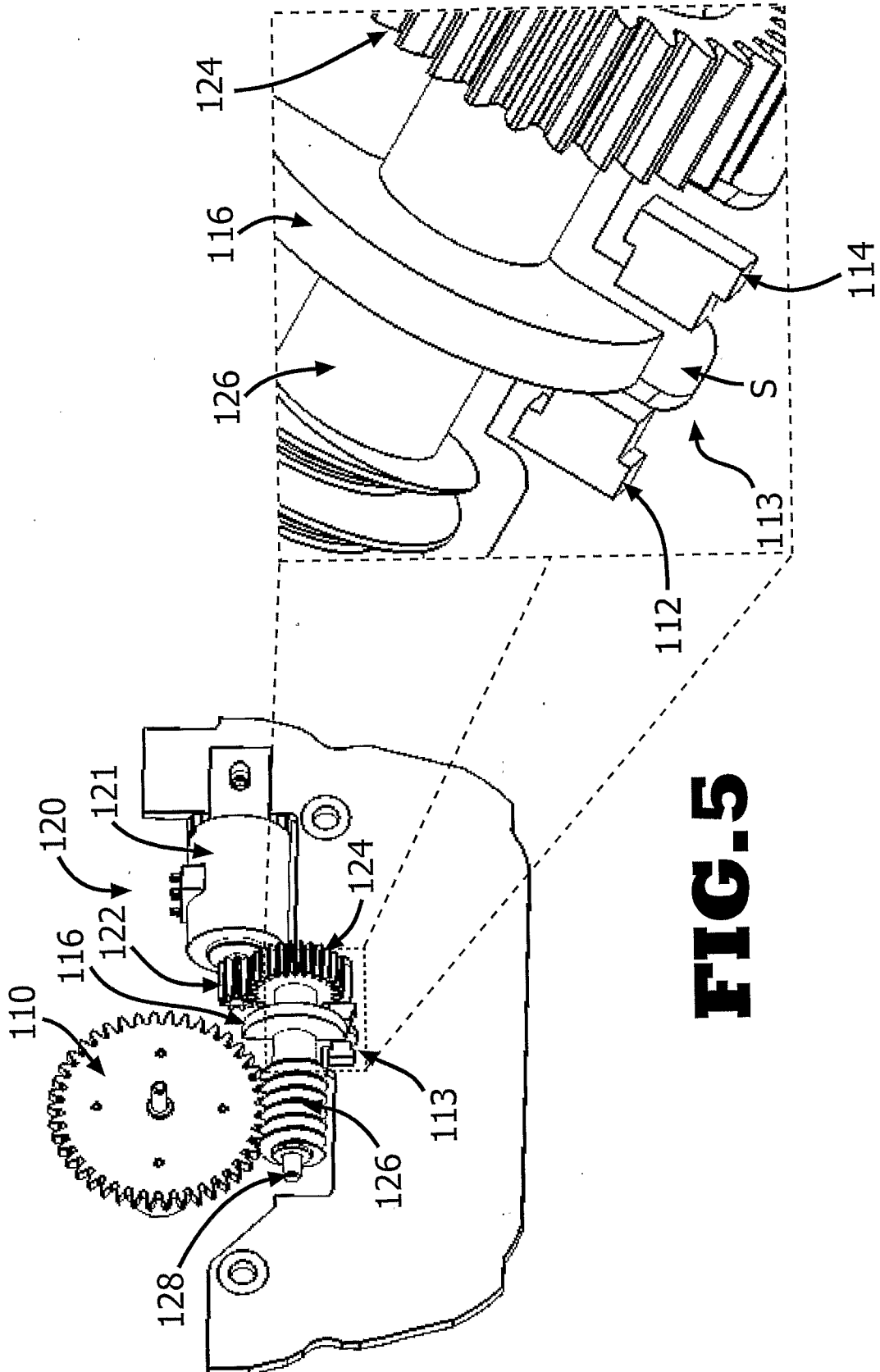
**3 / 19****FIG. 3a**

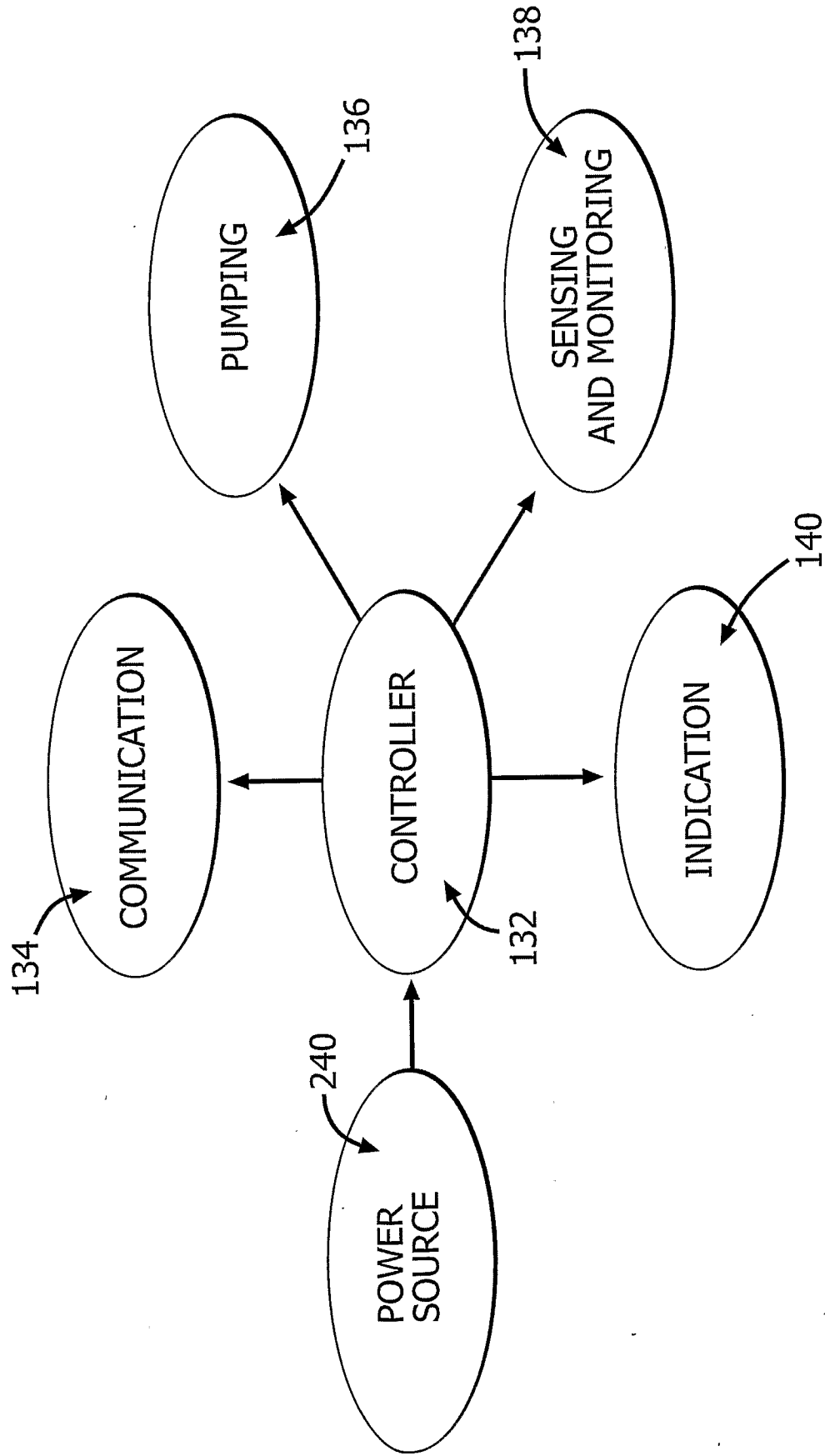
**4/19****FIG.3b**



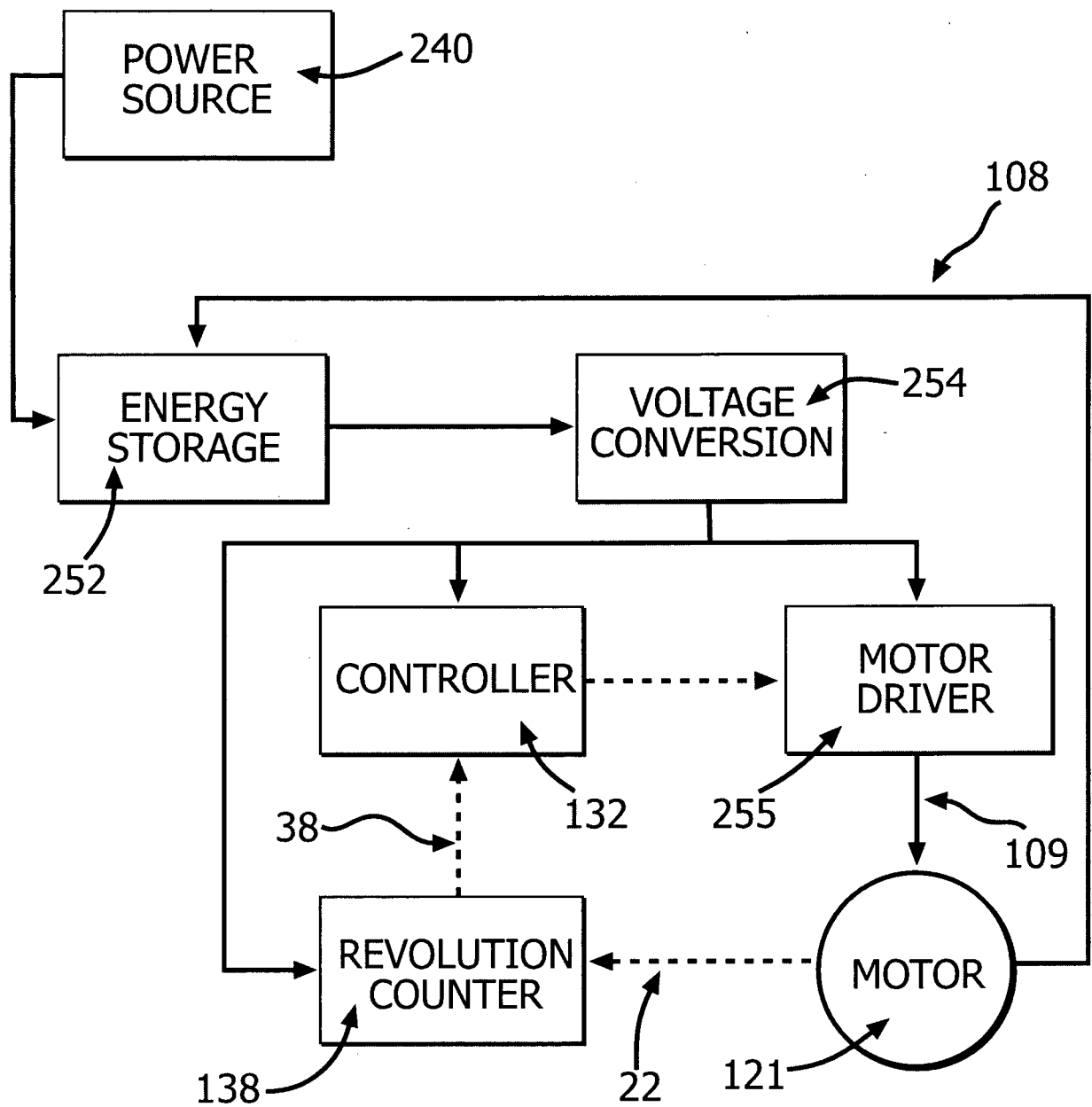
**5 / 19****FIG. 4a****FIG. 4b**

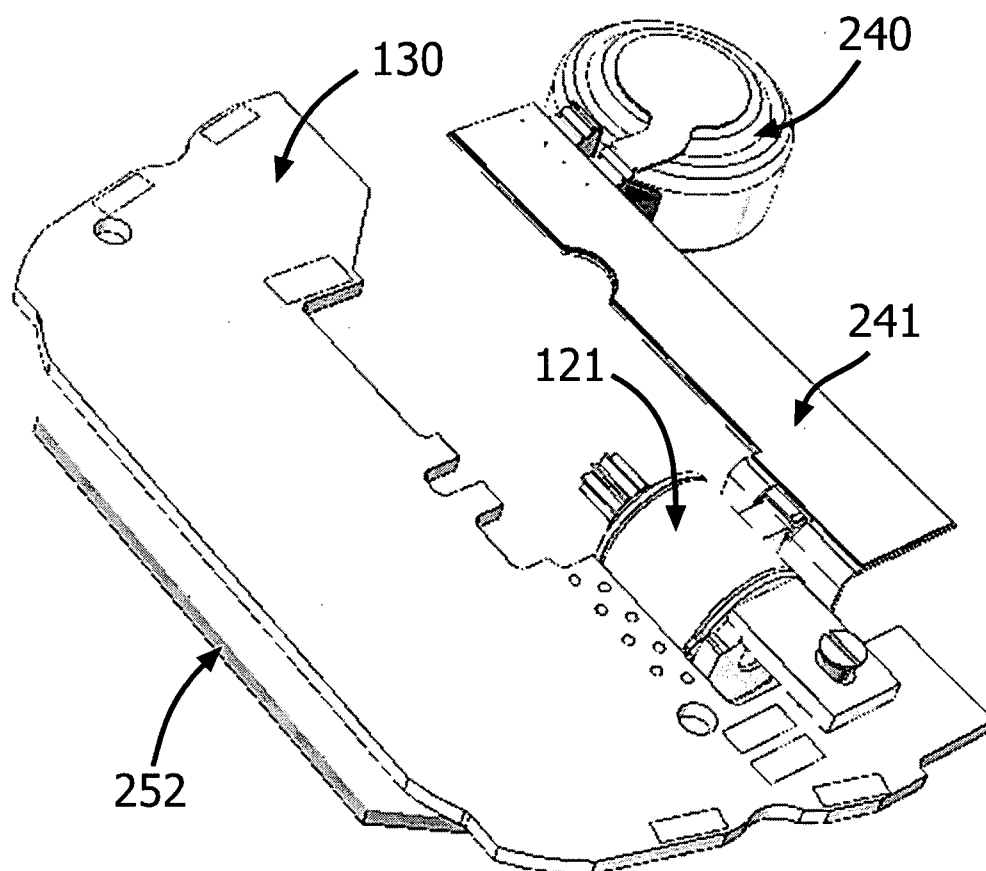
6/19

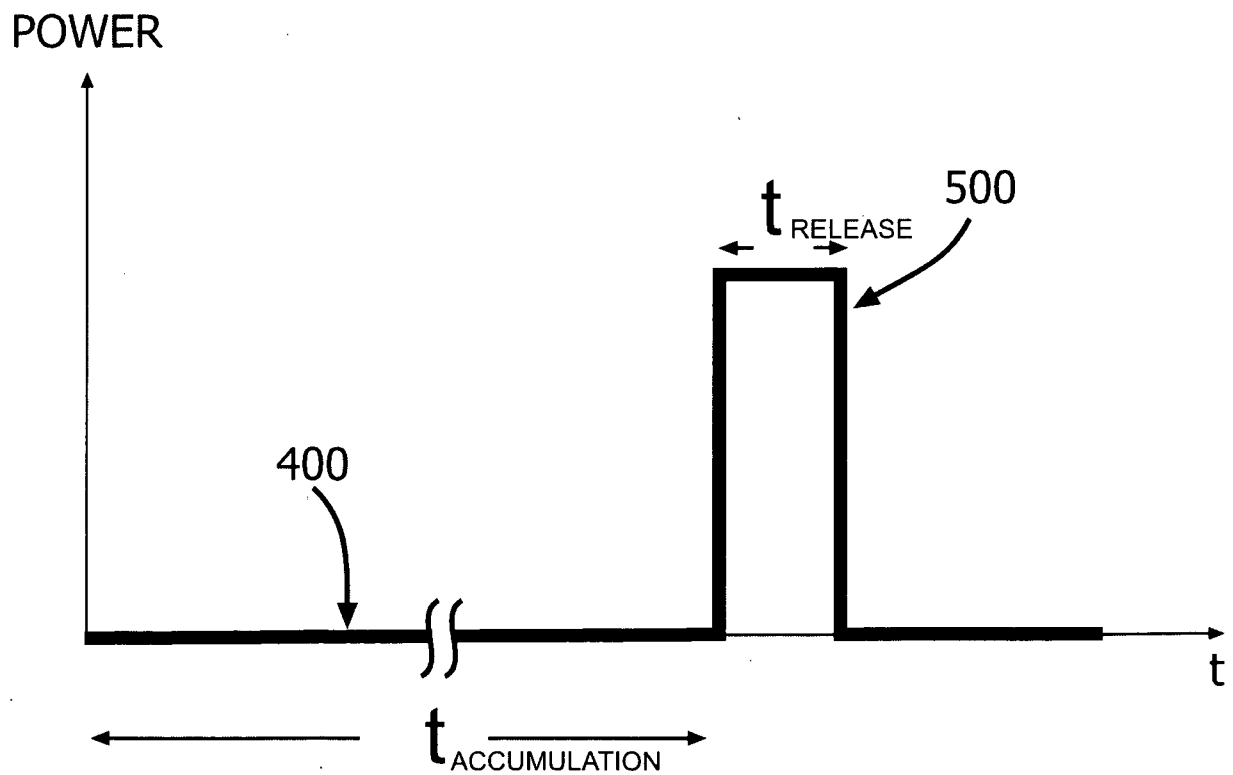
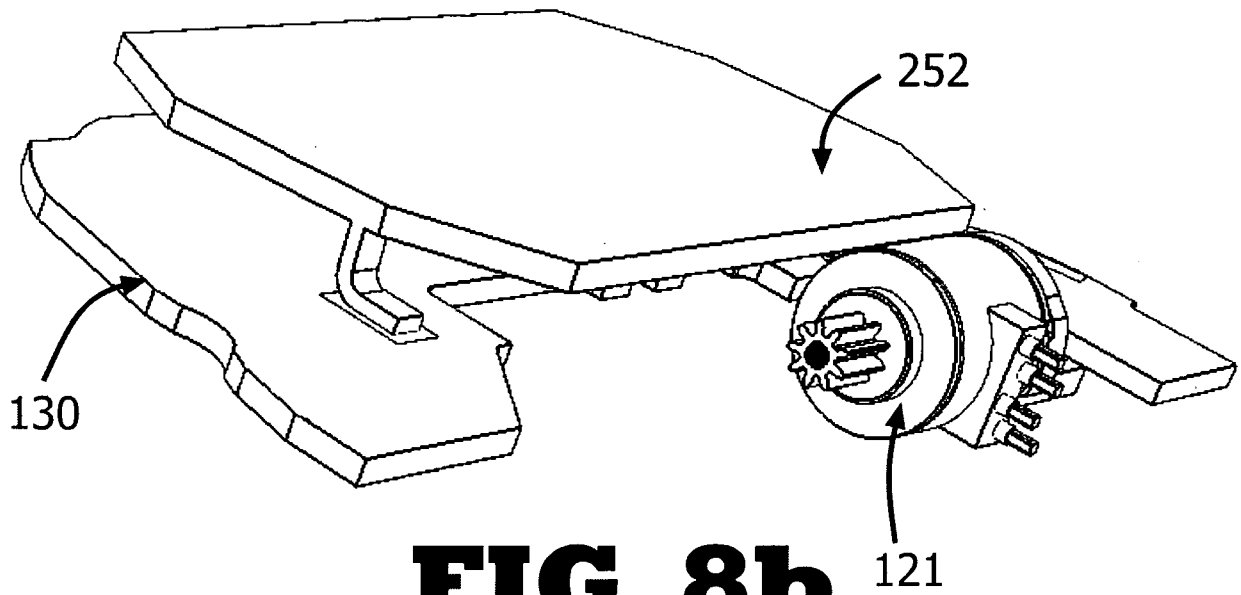




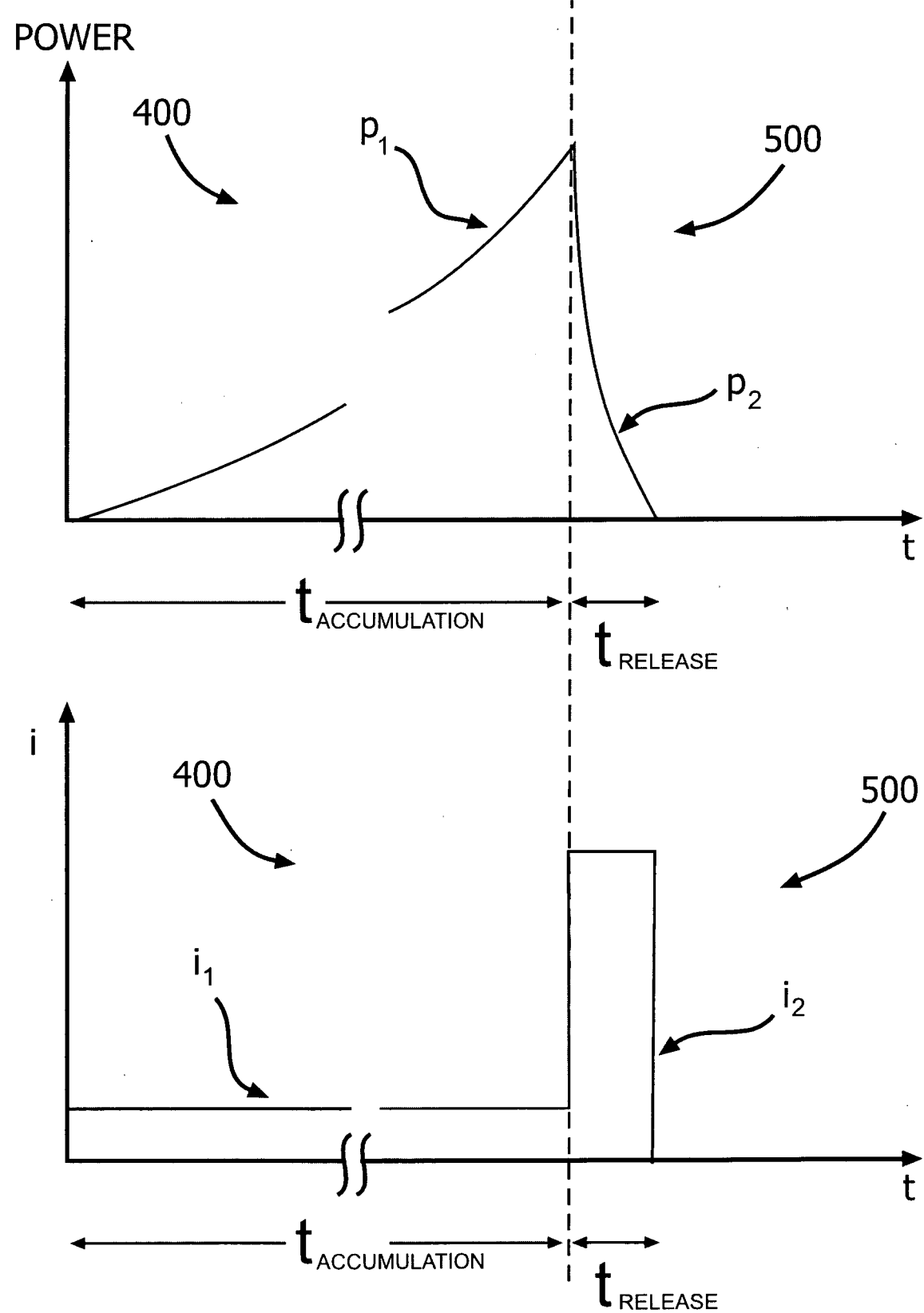
**FIG. 6**

**8 / 19****FIG. 7**

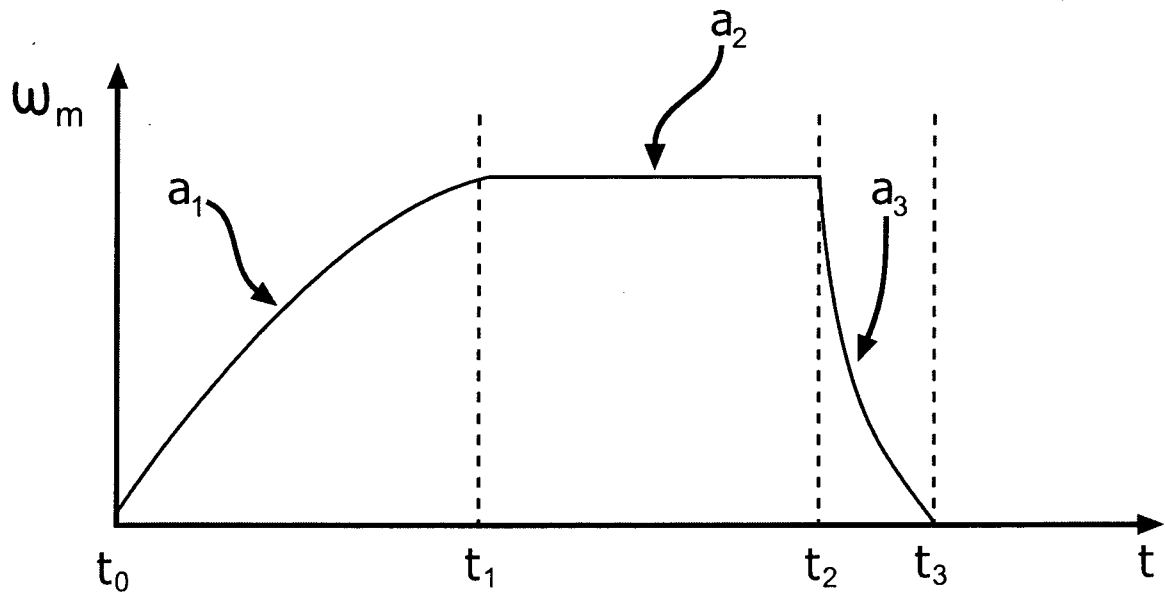
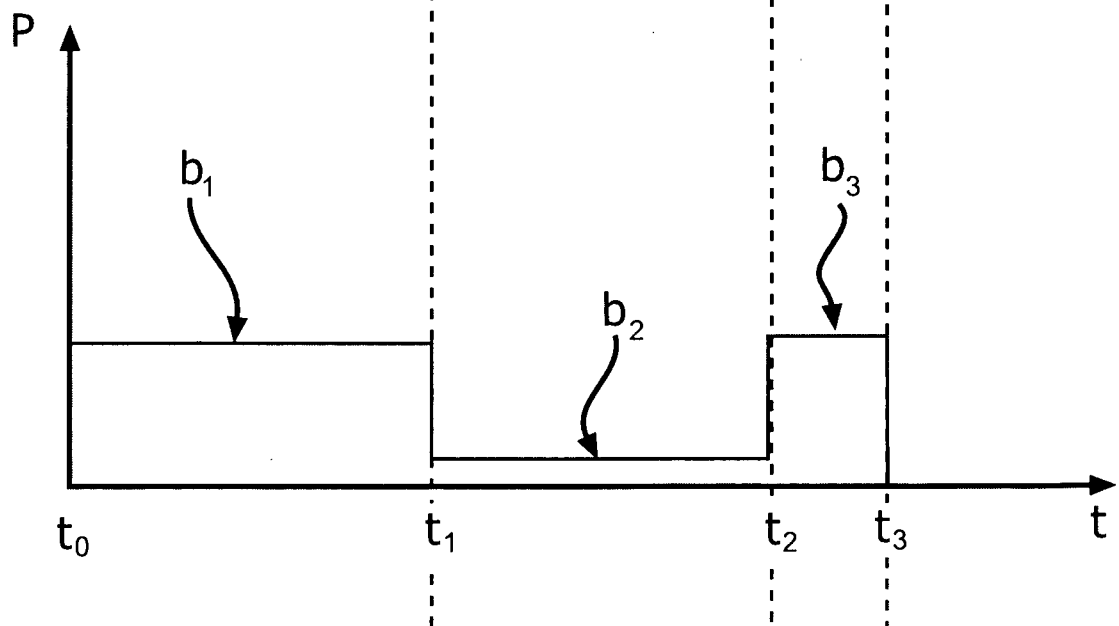
**9 / 19****FIG. 8a**

**10/19****FIG. 9a**

11/19

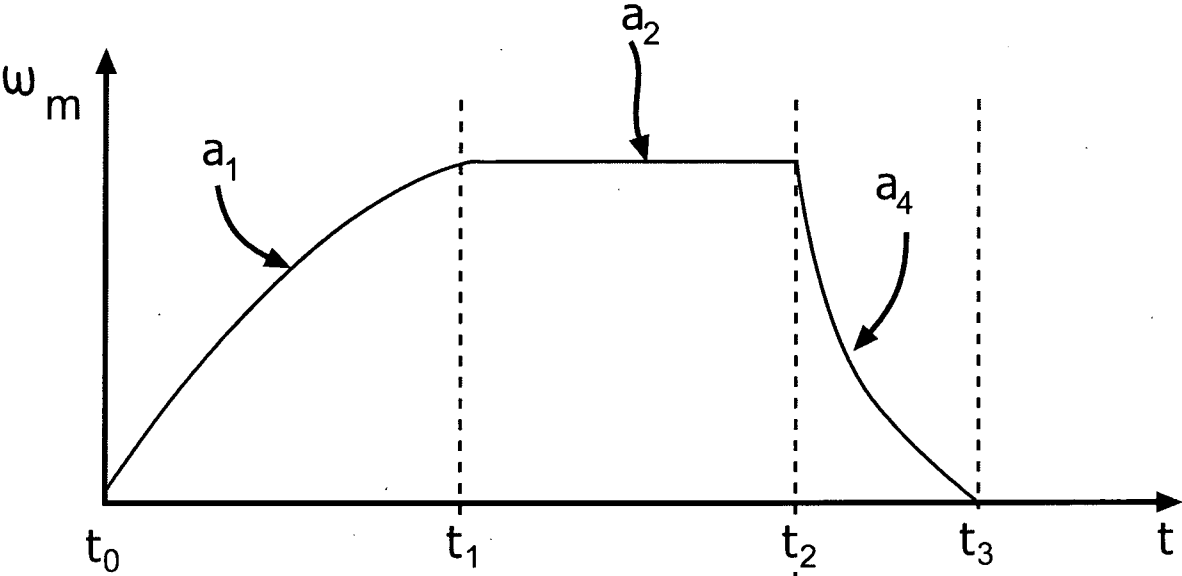


**FIG. 9b**

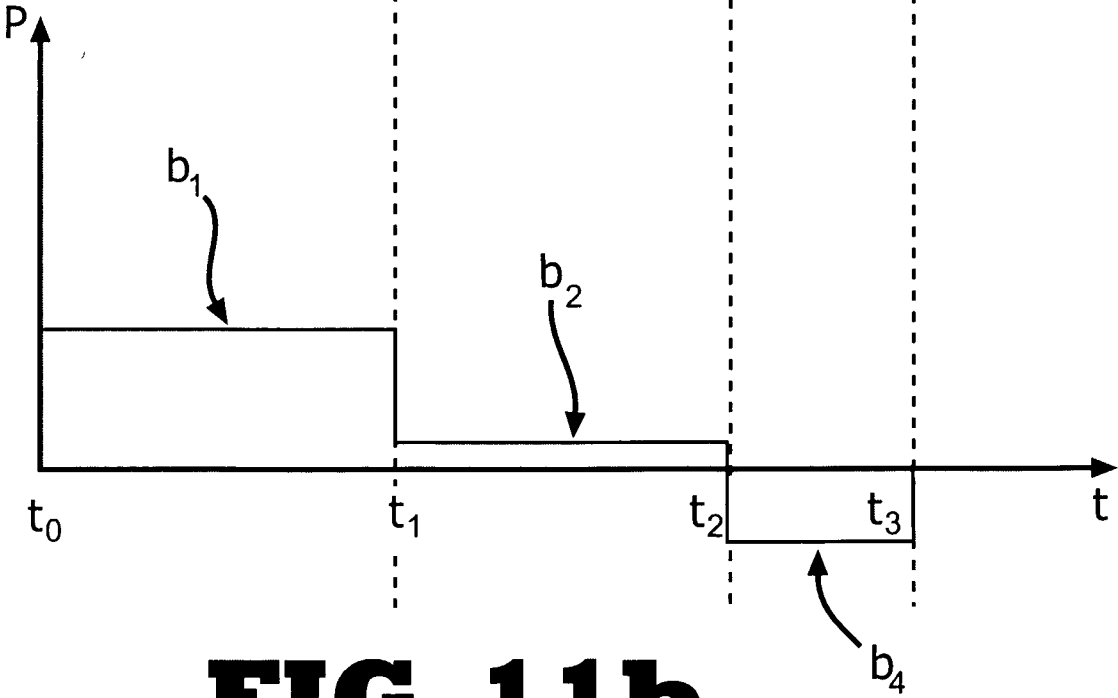
**12/19****FIG. 10a****FIG. 10b**



**13 / 19**



**FIG. 11a**



**FIG. 11b**

14 / 19

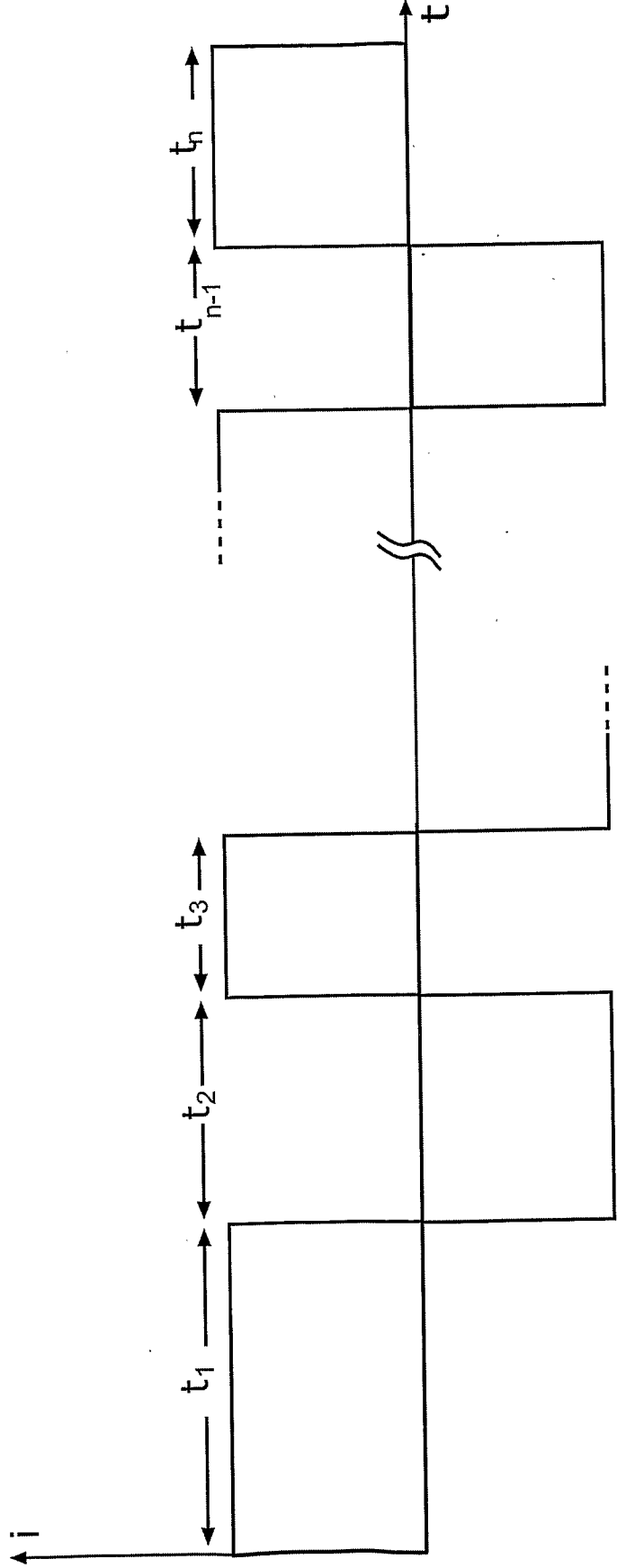


FIG. 12

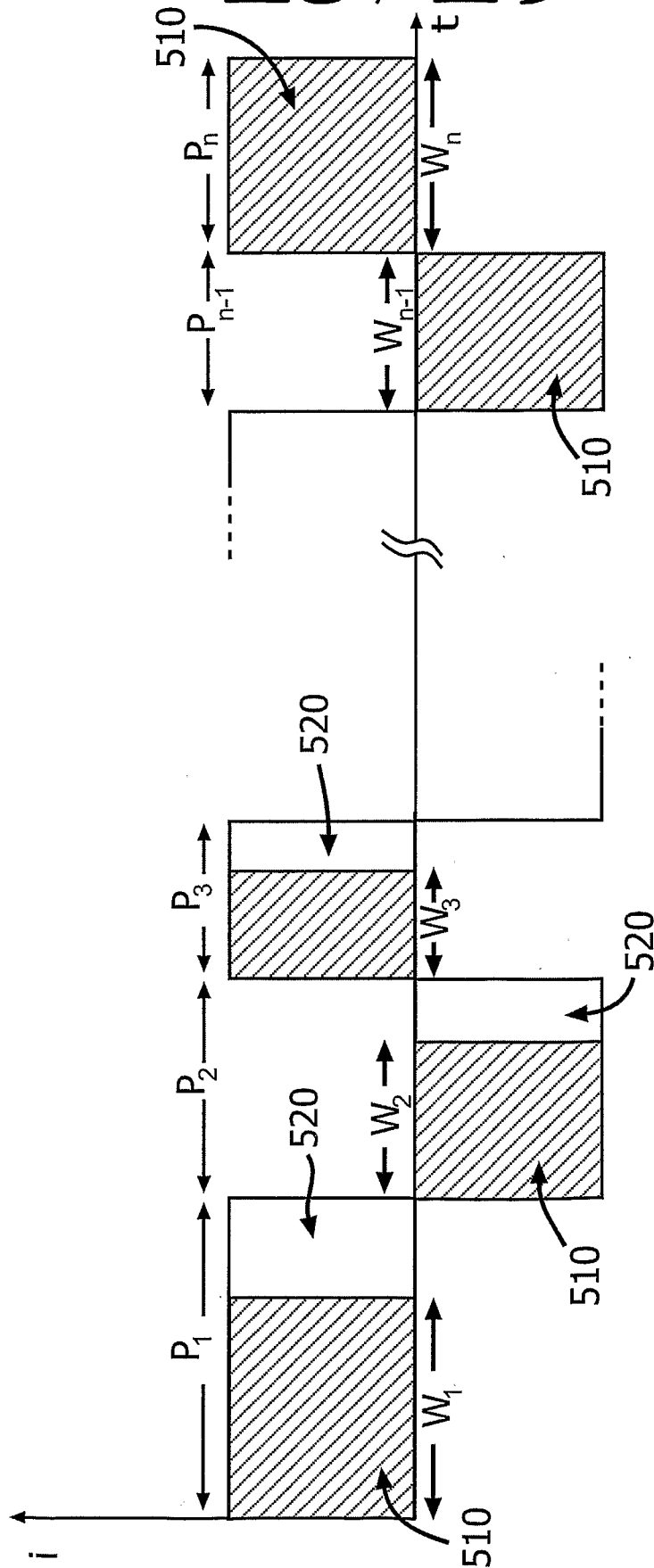


FIG. 13

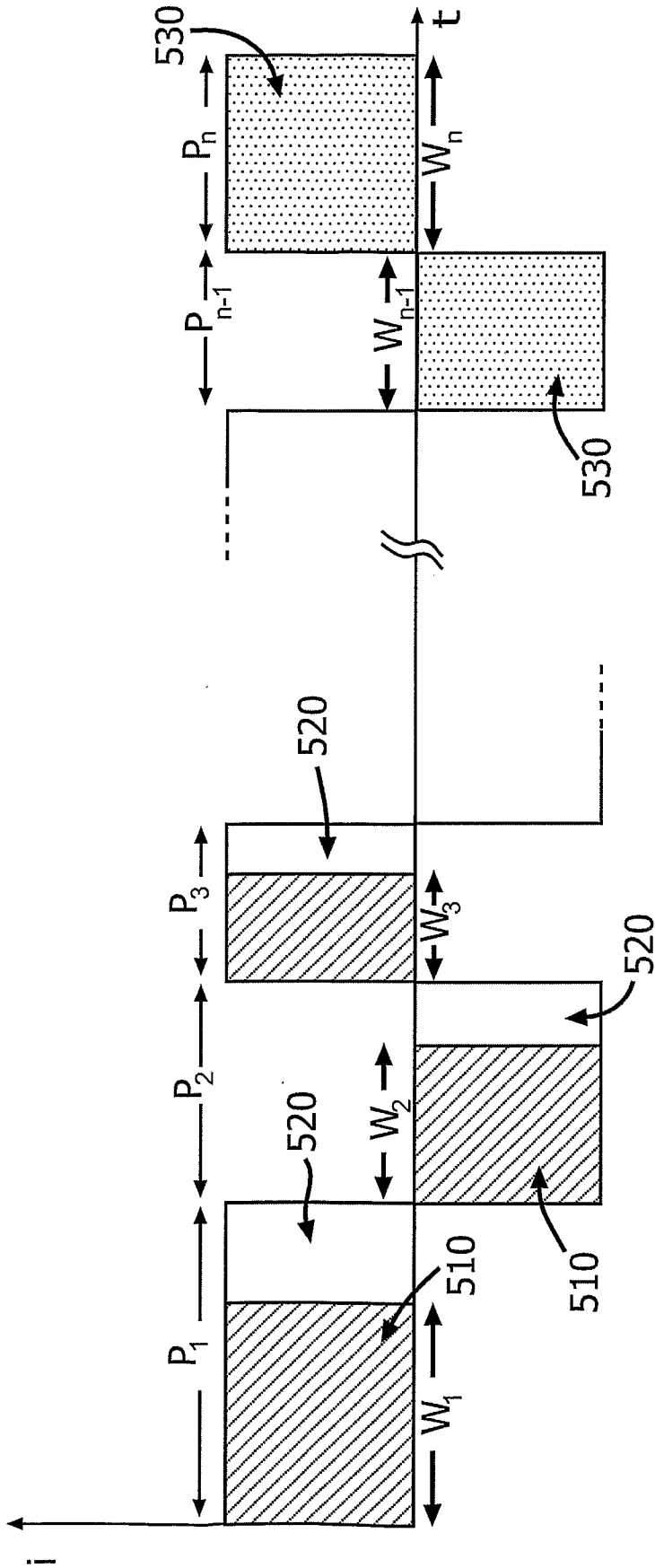


FIG. 14

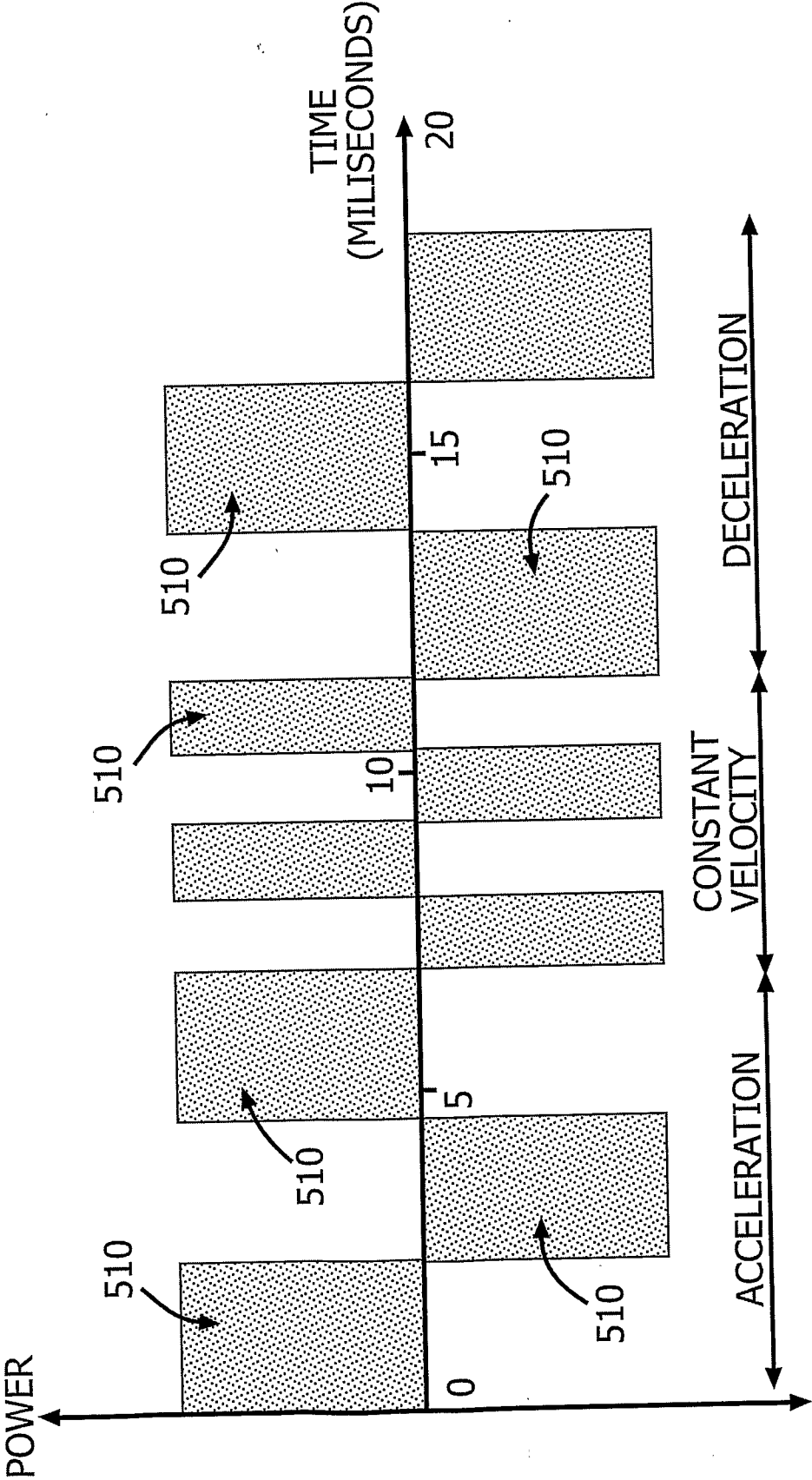


FIG. 15

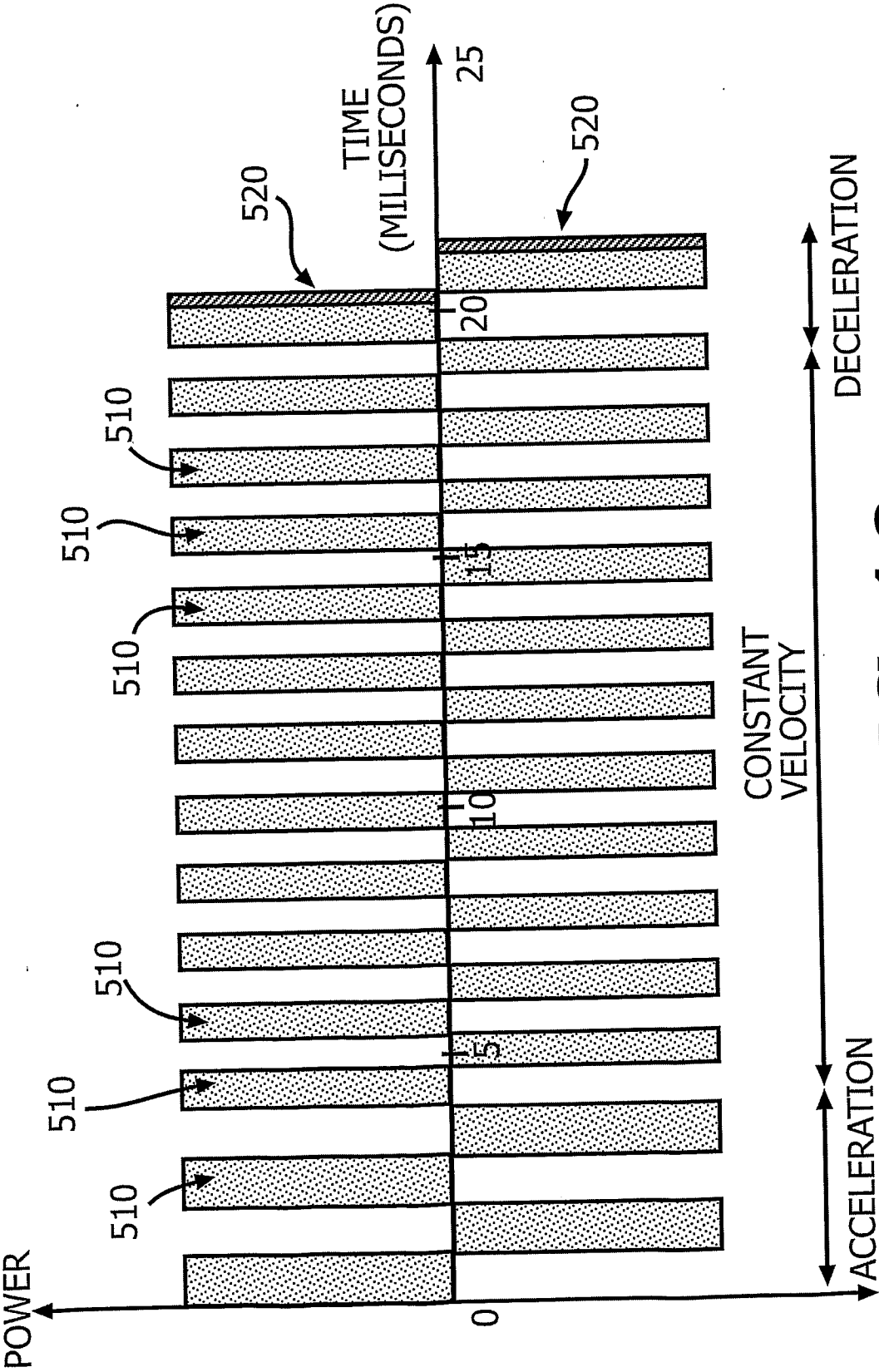


FIG. 16

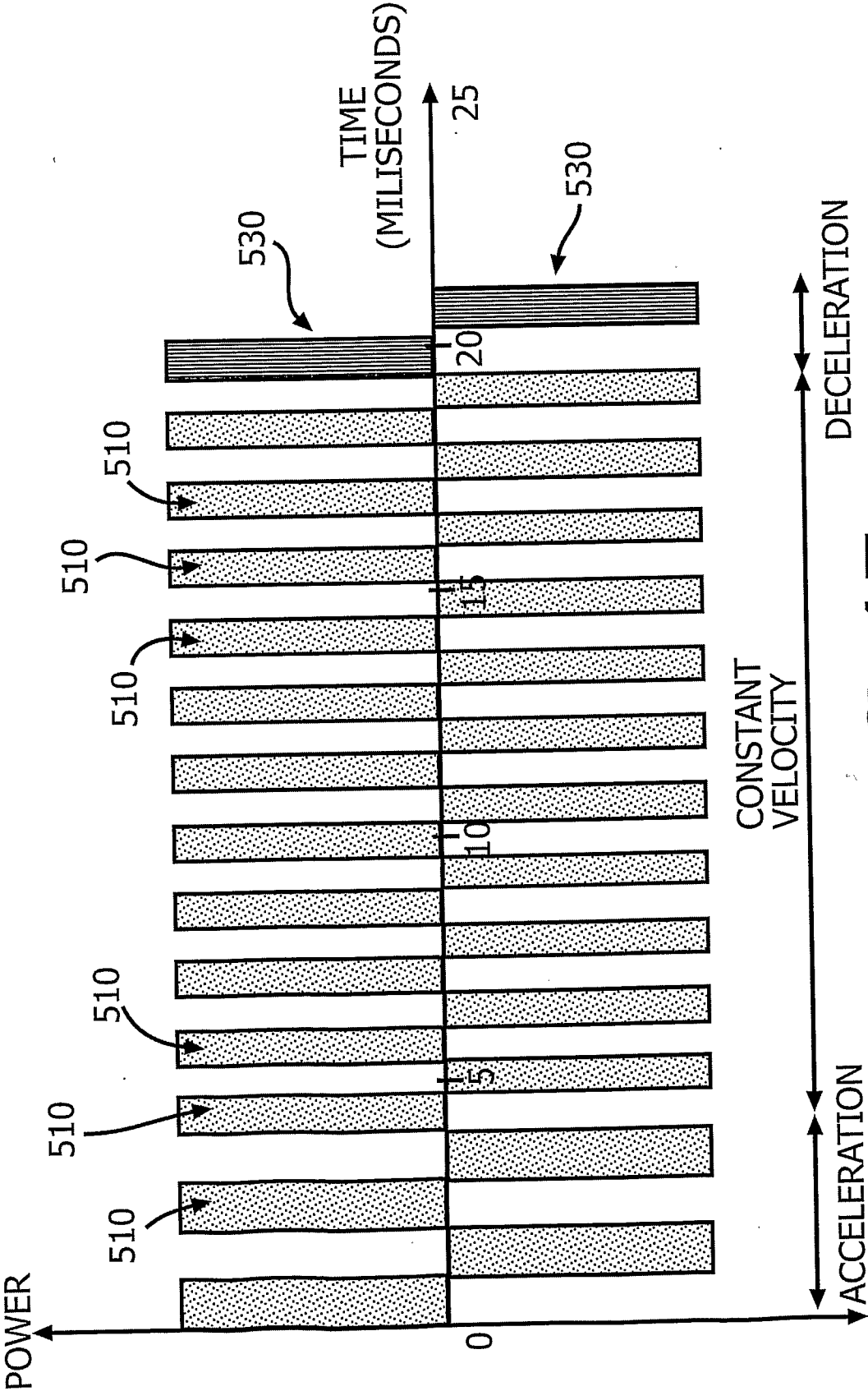


FIG. 17

# INTERNATIONAL SEARCH REPORT

International application No  
PCT/IL2008/001650

**A. CLASSIFICATION OF SUBJECT MATTER**  
INV. A61B5/00 A61M5/142 A61M5/172

According to International Patent Classification (IPC) or to both national classification and IPC

**B. FIELDS SEARCHED**

Minimum documentation searched (classification system followed by classification symbols)  
A61B A61M

Documentation searched other than minimum documentation to the extent that such documents are included in the fields searched

Electronic data base consulted during the international search (name of data base and, where practical, search terms used)

EPO-Internal

**C. DOCUMENTS CONSIDERED TO BE RELEVANT**

Category*	Citation of document, with indication, where appropriate, of the relevant passages	Relevant to claim No.
X	US 2007/073235 A1 (ESTES MARK C [US] ET AL) 29 March 2007 (2007-03-29)	22-36
Y	the whole document	37
Y	WO 2006/102412 A (ABBOTT DIABETES CARE INC [US]) 28 September 2006 (2006-09-28) abstract	37
X	US 2003/229310 A1 (FLAHERTY J CHRISTOPHER [US] ET AL) 11 December 2003 (2003-12-11) the whole document	22-32, 35, 37
X	US 3 771 694 A (KAMINSKI A) 13 November 1973 (1973-11-13) the whole document	23-29
	----- -/-- -----	

☒ Further documents are listed in the continuation of Box C.

☒ See patent family annex.

\* Special categories of cited documents :

- \*A\* document defining the general state of the art which is not considered to be of particular relevance
- \*E\* earlier document but published on or after the international filing date
- \*L\* document which may throw doubts on priority claim(s) or which is cited to establish the publication date of another citation or other special reason (as specified)
- \*O\* document referring to an oral disclosure, use, exhibition or other means
- \*P\* document published prior to the international filing date but later than the priority date claimed

- \*T\* later document published after the international filing date or priority date and not in conflict with the application but cited to understand the principle or theory underlying the invention
- \*X\* document of particular relevance; the claimed invention cannot be considered novel or cannot be considered to involve an inventive step when the document is taken alone
- \*Y\* document of particular relevance; the claimed invention cannot be considered to involve an inventive step when the document is combined with one or more other such documents, such combination being obvious to a person skilled in the art.
- \*&\* document member of the same patent family

Date of the actual completion of the international search

21 April 2009

Date of mailing of the international search report

04/05/2009

Name and mailing address of the ISA/  
European Patent Office, P.B. 5818 Patentlaan 2  
NL - 2280 HV Rijswijk  
Tel. (+31-70) 340-2040,  
Fax: (+31-70) 340-3016

Authorized officer

Guidoin, M



## INTERNATIONAL SEARCH REPORT

International application No

PCT/IL2008/001650

C(Continuation). DOCUMENTS CONSIDERED TO BE RELEVANT

Category*	Citation of document, with indication, where appropriate, of the relevant passages	Relevant to claim No.
X	US 5 938 640 A (MAGET HENRI J R [US] ET AL) 17 August 1999 (1999-08-17) the whole document	23-30, 33-35
X	US 2003/199855 A1 (ROGERS CHARLES R [US] ET AL) 23 October 2003 (2003-10-23) the whole document	22-33
X	WO 2004/032994 A (THERASENSE INC [US]) 22 April 2004 (2004-04-22) the whole document	22-33, 35, 37
X	US 5 919 167 A (MULHAUSER PAUL J [US] ET AL) 6 July 1999 (1999-07-06) the whole document	22-29, 33, 36
X	US 4 150 672 A (MARTIN JOHN K [US] ET AL) 24 April 1979 (1979-04-24) abstract figures 1-8 column 5, line 4 - column 13, line 14	22-31, 35
X	US 6 056 716 A (D ANTONIO NICHOLAS F [US] ET AL) 2 May 2000 (2000-05-02) abstract figures 1-4 column 9, line 22 - column 20, line 53	22-33
A	US 5 774 426 A (TU MAI XUAN [CH] ET AL) 30 June 1998 (1998-06-30) the whole document	22-37
A	US 2002/072733 A1 (FLAHERTY J CHRISTOPHER [US]) 13 June 2002 (2002-06-13) the whole document	22-32, 35, 37

# INTERNATIONAL SEARCH REPORT

International application No.  
PCT/IL2008/001650

## Box No. II Observations where certain claims were found unsearchable (Continuation of item 2 of first sheet)

This international search report has not been established in respect of certain claims under Article 17(2)(a) for the following reasons:

1. ☒ Claims Nos.: 1-21  
because they relate to subject matter not required to be searched by this Authority, namely:  
Rule 39.1(iv) PCT - Method for treatment of the human or animal body by surgery  
Rule 39.1(iv) PCT - Method for treatment of the human or animal body by therapy
2. ☐ Claims Nos.:  
because they relate to parts of the international application that do not comply with the prescribed requirements to such an extent that no meaningful international search can be carried out, specifically:
3. ☐ Claims Nos.:  
because they are dependent claims and are not drafted in accordance with the second and third sentences of Rule 6.4(a).

## Box No. III Observations where unity of invention is lacking (Continuation of item 3 of first sheet)

This International Searching Authority found multiple inventions in this international application, as follows:

1. ☐ As all required additional search fees were timely paid by the applicant, this international search report covers allsearchable claims.
2. ☐ As all searchable claims could be searched without effort justifying an additional fees, this Authority did not invite payment of additional fees.
3. ☐ As only some of the required additional search fees were timely paid by the applicant, this international search reportcovers only those claims for which fees were paid, specifically claims Nos.:
4. ☐ No required additional search fees were timely paid by the applicant. Consequently, this international search report is restricted to the invention first mentioned in the claims; it is covered by claims Nos.:

### Remark on Protest

- ☐ The additional search fees were accompanied by the applicant's protest and, where applicable, the payment of a protest fee.
- ☐ The additional search fees were accompanied by the applicant's protest but the applicable protest fee was not paid within the time limit specified in the invitation.
- ☐ No protest accompanied the payment of additional search fees.

## INTERNATIONAL SEARCH REPORT

Information on patent family members

International application No

PCT/IL2008/001650

Patent document cited in search report	Publication date	Patent family member(s)	Publication date
US 2007073235 A1	29-03-2007	EP 1933902 A2	25-06-2008
		EP 1933901 A2	25-06-2008
		US 2007173762 A1	26-07-2007
		US 2007156092 A1	05-07-2007
		US 2007167905 A1	19-07-2007
		US 2008045903 A1	21-02-2008
		US 2008045904 A1	21-02-2008
		US 2008045902 A1	21-02-2008
		US 2008045931 A1	21-02-2008
		WO 2007038059 A2	05-04-2007
		WO 2007038060 A2	05-04-2007
		WO 2007038091 A2	05-04-2007
WO 2006102412 A	28-09-2006	AU 2006226988 A1	28-09-2006
		CA 2601441 A1	28-09-2006
		CN 101180093 A	14-05-2008
		EP 1863559 A2	12-12-2007
		JP 2008535548 T	04-09-2008
		US 2006224141 A1	05-10-2006
US 2003229310 A1	11-12-2003	AU 2003245338 A1	22-12-2003
		EP 1513573 A1	16-03-2005
		WO 03103758 A1	18-12-2003
US 3771694 A	13-11-1973	NONE	
US 5938640 A	17-08-1999	NONE	
US 2003199855 A1	23-10-2003	AU 2003222633 A1	03-11-2003
		WO 03089032 A2	30-10-2003
		US 2006047367 A1	02-03-2006
WO 2004032994 A	22-04-2004	AU 2003279237 A1	04-05-2004
		CA 2501825 A1	22-04-2004
		EP 1552146 A2	13-07-2005
		US 2005238503 A1	27-10-2005
		US 2004115067 A1	17-06-2004
US 5919167 A	06-07-1999	NONE	
US 4150672 A	24-04-1979	NONE	
US 6056716 A	02-05-2000	NONE	
US 5774426 A	30-06-1998	AT 164689 T	15-04-1998
		DE 69600215 D1	07-05-1998
		DE 69600215 T2	08-10-1998
		EP 0790539 A1	20-08-1997
		ES 2115422 T3	16-06-1998
		HK 1001792 A1	02-06-2000
		JP 9219994 A	19-08-1997
US 2002072733 A1	13-06-2002	US 2003097092 A1	22-05-2003
		US 2004260233 A1	23-12-2004