



(51) International Patent Classification:

A47J 31/36 (2006.01) B65D 85/804 (2006.01)
A47J 31/06 (2006.01)

(21) International Application Number:

PCT/US2015/011542

(22) International Filing Date:

15 January 2015 (15.01.2015)

(25) Filing Language:

English

(26) Publication Language:

English

(30) Priority Data:

14/157,853 17 January 2014 (17.01.2014) US

(71) Applicant: **KEURIG GREEN MOUNTAIN, INC.**
[US/US]; 33 Coffee Lane, Waterbury, VT 05676 (US).

(72) Inventors: **SMITH, Geoffrey, Y.**; 63 South Avenue, Burlington, MA 01803 (US). **LAUNIE, Peter, Thomas**; 63 South Avenue, Burlington, MA 01803 (US). **BRODIE, Jonathan, Alexander**; 63 South Avenue, Burlington, MA 01803 (US). **FOSTER, Stuart, Jay**; 63 South Avenue, Burlington, MA 01803 (US). **HRISTOV, Stoyan, Plamenov**; 63 South Avenue, Burlington, MA 01803 (US). **GREINER, Jordan, Dean Jack**; 63 South Avenue, Burlington, MA 01803 (US). **WOSKOV, Peter, Nicholas**; 63 South Avenue, Burlington, MA 01803 (US). **RABINO, Yoav**; 63 South Avenue, Burlington, MA 01803 (US). **SHEPARD, James, E.**; 63 South Avenue, Burlington, MA 01803 (US). **TINKLER, Ian**; 63 South Avenue, Burlington, MA 01803 (US). **JACOBS, William, T.**; 63 South Avenue, Burlington, MA 01803 (US). **LAZATIN, Patrick, J.**; 63 South Avenue, Burlington, MA 01803 (US). **MCHUGH, William, Philip**; 63 South Avenue,

Burlington, MA 01803 (US). **BRANDIMARTE, Kevin, Thomas**; 33 Coffee Lane, Waterbury, VT 05676 (US). **LI-UZZA, Mario**; 63 South Avenue, Burlington, MA 01803 (US). **MACLEAN, Timothy**; 63 South Avenue, Burlington, MA 01803 (US).

(74) Agent: **HUNT, Robert, E.**; Wolf, Greenfield & Sacks, P.C., 600 Atlantic Avenue, Boston, MA 02210-2206 (US).

(81) Designated States (unless otherwise indicated, for every kind of national protection available): AE, AG, AL, AM, AO, AT, AU, AZ, BA, BB, BG, BH, BN, BR, BW, BY, BZ, CA, CH, CL, CN, CO, CR, CU, CZ, DE, DK, DM, DO, DZ, EC, EE, EG, ES, FI, GB, GD, GE, GH, GM, GT, HN, HR, HU, ID, IL, IN, IR, IS, JP, KE, KG, KN, KP, KR, KZ, LA, LC, LK, LR, LS, LU, LY, MA, MD, ME, MG, MK, MN, MW, MX, MY, MZ, NA, NG, NI, NO, NZ, OM, PA, PE, PG, PH, PL, PT, QA, RO, RS, RU, RW, SA, SC, SD, SE, SG, SK, SL, SM, ST, SV, SY, TH, TJ, TM, TN, TR, TT, TZ, UA, UG, US, UZ, VC, VN, ZA, ZM, ZW.

(84) Designated States (unless otherwise indicated, for every kind of regional protection available): ARIPO (BW, GH, GM, KE, LR, LS, MW, MZ, NA, RW, SD, SL, ST, SZ, TZ, UG, ZM, ZW), Eurasian (AM, AZ, BY, KG, KZ, RU, TJ, TM), European (AL, AT, BE, BG, CH, CY, CZ, DE, DK, EE, ES, FI, FR, GB, GR, HR, HU, IE, IS, IT, LT, LU, LV, MC, MK, MT, NL, NO, PL, PT, RO, RS, SE, SI, SK, SM, TR), OAPI (BF, BJ, CF, CG, CI, CM, GA, GN, GQ, GW, KM, ML, MR, NE, SN, TD, TG).

Published:

— with international search report (Art. 21(3))

(54) Title: BEVERAGE MACHINE CARTRIDGE HOLDER

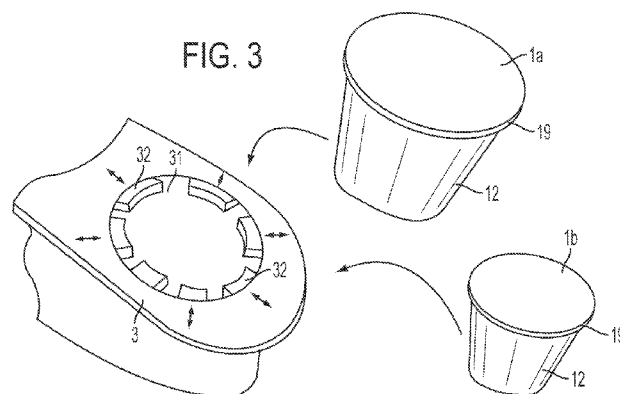

(57) Abstract: A method and apparatus for opening and closing a cartridge holder of a beverage forming machine. The cartridge holder may have an opening arranged to receive and hold a cartridge with the cartridge holder. The opening may be adjustable in size and/or shape to allow the cartridge holder to receive and engage with cartridges of different size and/or shape. The cartridge holder may include one or more movable portions that are adjustable in position to effectively adjust a size and/or shape of the opening.



BEVERAGE MACHINE CARTRIDGE HOLDER

BACKGROUND

1. Field of Invention

5 This invention relates to beverage forming systems, such as coffee brewers that use a liquid to form a coffee beverage.

2. Related Art

Beverage forming systems that use a liquid, such as water, to form a beverage are well known. For example, U.S. Patent 8,361,527 discloses a beverage forming system
10 that uses a beverage cartridge containing a beverage material to make a beverage by introducing liquid into the cartridge. Liquid provided to the cartridge may be heated in a tank prior to delivery to the cartridge.

SUMMARY OF INVENTION

Aspects of the invention relate to methods and apparatus for receiving cartridges
15 of different size and/or shape in a cartridge holder of a beverage forming machine. For example, in some embodiments, the cartridge holder may be arranged to receive and support cartridges that have different sizes, e.g., circular rims of different diameters, and/or that have different shapes, e.g., one cartridge may have a circular rim while another cartridge may have a rim with an irregular shape, without the user having to
20 manipulate an adapter or other component of the cartridge holder. In one embodiment, the cartridge holder may be arranged to expand and/or contract to adjust a size and/or shape of an opening in which cartridges are received. Thus, a user may simply place cartridges having different sizes or shapes in the cartridge holder without having to take any specific action to adjust a receiving opening of the holder or otherwise configure the
25 machine.

In some embodiments, the cartridge holder may have an engagement portion that engages with, and optionally supports the weight of, cartridges placed in the holder. The engagement portion may include one or more radially movable portions which can move to adjust a size and/or shape of an opening in which the cartridges are received. In some
30 embodiments, the engagement portion may include one or more compliant portions which can move resiliently such that the act of placing a cartridge in the holder causes movement of the compliant portions and adjustment of the size and/or shape of the

- 2 -

receiving opening. Such an arrangement may make for an easy and convenient way for users to place differently sized/shaped cartridges in a cartridge holder.

In some embodiments, the cartridges may be differently sized and/or shaped in a region where the cartridge holder engages with, and supports the weight of, the cartridge.

5 For example, an engagement portion of the cartridge holder may engage with cartridges at a rim of the cartridges (e.g., at a location just below and/or around a top edge where a sealing lid is attached to the cartridge). In some embodiments, the different cartridges may have rims of different diameters and/or shapes. For example, in one embodiment, a first cartridge may have a rim with an irregular shape (such as a rim with a circular
10 section and a spout portion extending from one part of the circular section), and a second cartridge may have a circular rim. Despite these different shapes at the cartridge rim, the cartridge holder may accommodate both cartridge types while supporting the cartridges at a location at or near the rim.

In an aspect of the invention, a beverage forming machine may provide water or
15 other fluid to different cartridges, and/or may receive beverage from different cartridges, using different inlet and/or outlet ports. For example, a first cartridge may receive water from an inlet port that pierces a top lid of the cartridge, and beverage may exit the cartridge to an outlet port that also pierces the top lid of the cartridge (though in a different location than the inlet port). However, a second cartridge held by the same
20 cartridge holder may receive water from an inlet port that pierces the cartridge at a different location (such as the bottom of the cartridge as opposed to the top), and/or beverage may exit the second cartridge to an outlet port that pierces the cartridge at a different location (such as the bottom of the cartridge). For example, inflow of water into a first cartridge may be downwardly into the cartridge, while beverage outflow is
25 upwardly from the cartridge. In contrast, inflow of water into a second cartridge may be downwardly into the cartridge, but beverage outflow may be downwardly from the second cartridge. Thus, inflow and/or outflow for different cartridges may occur in different relative places and/or directions.

In one embodiment, a first cartridge may be pierced in two locations at a top lid
30 for inlet and outlet openings, respectively. Water or other fluid may be introduced into the cartridge in a downward direction through the inlet opening, and beverage may exit the cartridge in an upward direction through the outlet opening. In contrast, a second

- 3 -

cartridge may be pierced in one location at the top lid for an inlet opening, and pierced at a location below the lid, e.g., at a bottom of the cartridge, for an outlet opening. Thus, water or other fluid may be introduced into the cartridge in a downward direction through the inlet opening, and beverage may exit the cartridge in a downward direction through the outlet opening. Such different flows may be accommodated by a single cartridge holder which can not only accommodate differently sized and/or shaped cartridges, but also different flow arrangements for fluid into and beverage out of the cartridges.

In one aspect of the invention, a beverage forming apparatus includes a frame arranged to support components of the beverage forming apparatus, and a cartridge holder including a cartridge engagement portion that defines an opening and that is arranged to engage with a cartridge placed in the opening. The engagement portion may include one or more radially movable sections that are movable to accommodate and engage with first and second cartridges that are differently sized and/or shaped relative to each other in a region where the engagement portion engages with the first and second cartridges. For example, the first and second cartridges may have differently sized rims, and the engagement portion may have one or more sections move to accommodate one or both of the cartridges. A cover may cooperate with the cartridge holder to at least partially enclose a cartridge held by the cartridge holder for formation of a beverage using the cartridge. For example, the cover may move to cover a part of a cartridge, or the cover may be fixed to the frame and the cartridge holder may move so that the cover is positioned over at least part of a cartridge. A liquid supply system at least partially supported by the frame may be arranged to provide a liquid for combination with a beverage medium in a cartridge held by the cartridge holder to form a beverage.

In one embodiment, the cartridge engagement portion may include a plurality of wall sections that are movable away from (and/or toward) each other to accommodate the first or second cartridge. The cartridge engagement portion may include at least one trigger that is mounted for sliding movement away from the opening, e.g., the trigger may be movable to receive a spout of the first or second cartridge. In some embodiments, the cartridge engagement portion may engage with a rim of the first and second cartridge to support a weight of the cartridge, where the first cartridge has a rim with a first diameter, and the second cartridge has a rim with a second diameter that is

- 4 -

smaller than the first diameter. The rim of the second cartridge may be circular, and the rim of the first cartridge may have a circular portion and a spout portion that extends outwardly from the circular portion.

In one embodiment, the cartridge engagement portion may include a plurality of
5 wall portions that extend upwardly from a bottom of the engagement portion, where the wall portions are joined together, to a top of the engagement portion. The wall portions located at the top of the engagement portion may be radially movable relative to each other, e.g., so as to move to accommodate and engage with the first and second cartridge. The wall portions may be radially movable based on flexing movement of the wall
10 portions relative to the bottom of the engagement portion or may be movable in other ways, such as by pivoting about a hinge.

In one embodiment, the cover includes a liquid inlet to introduce liquid from the liquid supply system to a cartridge held in the cartridge holder, and/or includes a first beverage outlet to receive beverage exiting a cartridge held in the cartridge holder. The
15 apparatus may also include a second beverage outlet mounted to the cartridge holder and arranged to receive beverage exiting a cartridge held in the cartridge holder. The first and second beverage outlets may be selectively employed to receive beverage from a cartridge, e.g., depending on a type of cartridge. For example, the second beverage outlet may be selectively movable into and out of a cartridge receiving area of the
20 cartridge holder based on whether the first or second cartridge is received in the cartridge holder. The liquid inlet and the first and second beverage outlets may each include a piercing element to pierce a cartridge, and the piercing elements of the liquid inlet and the first beverage outlet may face downwardly and the second beverage outlet may face upwardly.

25 In one embodiment, the engagement portion includes a plurality of radially movable sections and at least one of the radially movable sections has a smaller range of motion than at least one other radially movable section. This arrangement may help properly locate cartridges in the cartridge holder, e.g., so that an inlet and/or outlet may properly align with the cartridge. For example, since different cartridges may have
30 different sizes, the engagement portions may be required to move different amounts to accommodate different cartridges. However, if the engagement portions do not move in an appropriate way, the cartridge may be misaligned with respect to an inlet and/or

- 5 -

outlet. Thus, by having one or more engagement portions have a limited range of motion, the engagement portions may effectively function as stops for one or more cartridges, helping to ensure proper positioning of the cartridges. In one embodiment, the cartridge holder is arranged to receive a cartridge with a rim having a partially
5 circular portion and a spout section extending outwardly from the partially circular portion. The at least one radially movable section with a smaller range of motion may be located on a side of the opening opposite where the spout section of the cartridge is received. This positioning of the movable section having a smaller range of motion can be helpful where the spout section contacts a trigger, which may resist radially outward
10 movement to a greater extent than other engagement portions. By limiting movement of a movable portion opposite the trigger, the radially inward force of the trigger on the cartridge may be resisted, helping to properly position the cartridge.

In another aspect of the invention, a method for forming a beverage using a beverage forming apparatus includes providing a beverage forming apparatus having a
15 cartridge holder with an engagement portion arranged to engage with a cartridge placed in an opening of the cartridge holder. A first or second cartridge may be provided into the opening of the cartridge holder, where the first and second cartridges are differently sized and/or shaped relative to each other in a region where the engagement portion engages with the first and second cartridges to support a weight of the cartridge. One or
20 more sections of the engagement portion may be moved radially to accommodate and engage with a region of the first or second cartridge provided into the opening, and liquid may be combined with a beverage medium in the first or second cartridge held by the cartridge holder to form a beverage. In one embodiment, a plurality of wall sections may move away from each other to accommodate the first or second cartridge.

25 In one embodiment, a cover may cooperate with the cartridge holder to at least partially enclose a cartridge and liquid may be introduced from the liquid supply system to a cartridge held in the cartridge holder via a liquid inlet of the cover. Beverage may be received from the cartridge at a first beverage outlet, which may be attached to the cover. In some cases, beverage may be received at a first beverage outlet if a first
30 cartridge is received in the cartridge holder, but beverage may be received at a second beverage outlet if a second cartridge is received in the cartridge holder. For example, the second beverage outlet may be selectively moved out of a cartridge receiving area of

- 6 -

the cartridge holder if the first cartridge is received in the cartridge holder, and the first beverage outlet may interact with the first cartridge to receive beverage.

In another aspect of the invention, a beverage forming apparatus includes a frame arranged to support components of the beverage forming apparatus, and a cartridge holder having a cartridge engagement portion that defines an opening and that is arranged to engage with a cartridge placed in the opening and support a weight of the cartridge. The engagement portion may include one or more compliant sections that are movable to adjust a size and/or shape of the opening to accommodate and engage with first and second cartridges that are differently sized and/or shaped relative to each other in a region where the engagement portion engages with the first and second cartridges. A cover may be arranged to cooperate with the cartridge holder to at least partially enclose a cartridge held by the cartridge holder for formation of a beverage using the cartridge, and a liquid supply system may be arranged to provide a liquid for combination with a beverage medium in a cartridge held by the cartridge holder to form a beverage. In one embodiment, the one or more compliant sections each include a resilient element that deforms in response to insertion of the first or second cartridge into the opening of the cartridge holder. For example, the one or more compliant sections may include a plurality of wall sections that are movable away from each other to accommodate the first or second cartridge. The one or more compliant sections may include at least one trigger that is mounted for sliding movement away from the opening, e.g., the trigger may be movable to receive a spout of the first or second cartridge. Other features described above may be incorporated as well, such as having the one or more compliant sections include wall elements that are joined together and are capable of flexing to receive one or more cartridges.

In another aspect of the invention, a method for forming a beverage using a beverage forming apparatus includes providing a beverage forming apparatus having a cartridge holder with an engagement portion arranged to engage with a cartridge placed in an opening of the cartridge holder and support a weight of the cartridge. The engagement portion may include one or more resilient elements that are movable to adjust a size and/or shape of the opening. A first or second cartridge may be placed into the opening of the cartridge holder, where the first and second cartridges are differently sized and/or shaped relative to each other in a region where the engagement portion

- 7 -

engages with the first and second cartridges to support a weight of the cartridge. One or more resilient elements of the engagement portion may be moved to adjust a size and/or shape of the opening and to accommodate and engage with a region of the first or second cartridge provided into the opening, and liquid may be combined with a beverage
5 medium in the first or second cartridge held by the cartridge holder to form a beverage.

These and other aspects of the invention will be apparent from the following description and claims.

BRIEF DESCRIPTION OF DRAWINGS

Aspects of the invention are described below with reference to the following
10 drawings in which like numerals reference like elements, and wherein:

FIG. 1 is a front perspective view of a beverage forming apparatus in an illustrative embodiment;

FIG. 2 is a front perspective view of the FIG. 1 embodiment with the cartridge holder exposed to receive a cartridge;

15 FIG. 3 is a perspective side view of a cartridge holder arranged to receive cartridges having different sizes;

FIG. 4 is a perspective side view of an engagement portion for the cartridge holder mechanism in the FIG. 3 embodiment;

FIG. 5 is a schematic side view of a cartridge holder and cover in an illustrative
20 embodiment;

FIG. 6 is an exploded view of a beverage cartridge in an illustrative embodiment;

FIG. 7 is an assembled, cross-sectional view of the cartridge of FIG. 6;

FIG. 8 is a cross-sectional view of the FIG. 6 cartridge and optional inlet and outlet locations for the cartridge;

25 FIG. 9 is perspective view of another beverage cartridge arrangement that may be received by a cartridge holder also arranged to receive the cartridge of FIGs. 6-8;

FIG. 10 is schematic side view of a cartridge holder and cover in an illustrative embodiment in which different outlet ports are used for different cartridges;

FIG. 11 is a schematic side view of the cartridge holder of FIG. 10 illustrating
30 how a different outlet port is used with a different cartridge than that shown in FIG. 10;

FIG. 12 is a side view of a cartridge holder having an outlet port that is pivotal about a vertical axis;

- 8 -

FIG. 13 is a top view of the FIG. 12 cartridge holder;

FIG. 14 is a side view of a cartridge holder having an outlet port that is pivotal about a horizontal axis;

FIG. 15 is a partially exploded view of a cartridge holder employing the engagement portion of FIG. 4;

FIG. 16 is a perspective view of a cartridge holder, associated cover and components for moving the cover in an illustrative embodiment; and

FIG. 17 is a schematic diagram of components of a beverage forming apparatus in an illustrative embodiment.

DETAILED DESCRIPTION

It should be understood that aspects of the invention are described herein with reference to certain illustrative embodiments and the figures. The illustrative embodiments described herein are not necessarily intended to show all aspects of the invention, but rather are used to describe a few illustrative embodiments. Thus, aspects of the invention are not intended to be construed narrowly in view of the illustrative embodiments. In addition, it should be understood that aspects of the invention may be used alone or in any suitable combination with other aspects of the invention.

FIGs. 1 and 2 show a perspective view of a beverage forming apparatus 100 in an illustrative embodiment that incorporates aspects of the invention. Although the beverage forming apparatus 100 may be used to form any suitable beverage, such as tea, coffee, other infusion-type beverages, beverages formed from a liquid or powdered concentrate, soups, juices or other beverages made from dried materials, or other, in this illustrative embodiment, the apparatus 100 is arranged to form coffee or tea beverages. As is known in the art, a beverage cartridge 1 may be provided to the apparatus 100 and used to form a beverage that is deposited into a container 2. The cartridge 1 may be manually or automatically placed in a cartridge holder 3 of a beverage forming station 11 of the beverage forming machine 10. For example, the cartridge holder 3 may be exposed to receive the cartridge 1 when the user operates a handle 5 or other actuator. In this embodiment, movement of the handle 5 or other actuator may cause a cover 8 to move relative to the cartridge holder 3 (or the cover 8 and holder 3 to otherwise move relative to each other, e.g., by having the holder 3 move) to expose the holder 3 for reception of a cartridge 1. With the cartridge 1 placed in the cartridge holder 3, the

- 9 -

actuator 5 may be operated to at least partially enclose the cartridge 1, e.g., so that the cover 8 moves to cooperate with the holder 3 to at least partially enclose the cartridge 1 so water or other precursor liquid can be introduced into the cartridge 1 to form a beverage. For example, with the cartridge 1 held in the beverage forming station 11 by the cartridge holder 3, the cartridge 1 may be pierced to form inlet and outlet openings through which water or other precursor liquid enters the cartridge 1 and beverage that exits the cartridge 1, respectively. U.S. Patent 8,361,527 describes a cartridge and a system for introducing liquid into the cartridge that may be used in embodiments of this invention, and is hereby incorporated by reference in its entirety. Of course, aspects of the invention may be employed with any suitably arranged apparatus 100, including drip-type coffee brewers, carbonated beverage machines, and others arranged to form a beverage regardless of how the beverage is formed. For example, a cartridge 1 may include any suitable materials to form a beverage, such as a carbon dioxide source used to carbonate water, a beverage mix, etc.

In this embodiment, the beverage forming machine 10 includes a housing 17 that houses and/or supports components of the machine 10, such as a user interface 14 used to control system operation, and defines a container receiving area 12 at which the container 2 is positionable to receive beverage dispensed by the machine 10 via a beverage outlet. Thus, at the container receiving area 12, the container 2 is associated with the machine 10 to receive a dispensed beverage and may be supported by the housing 17. The container 2 may be received at the container receiving area 12 so that the container 2 is at least partially surrounded by the housing 17, or the container 2 may be more exposed when at the container receiving area 12, as shown in FIG. 2.

In accordance with an aspect of the invention, a cartridge holder having an opening arranged to receive and support a cartridge may be arranged to receive cartridges of different sizes and/or shapes. In particular, the cartridges may have different sizes and/or shapes in a region where the cartridge holder engages with the cartridge to support the weight of the cartridge. For example, the cartridge holder may engage cartridges at a rim (e.g., at or below a flange to which a lid of the cartridge is attached), and different cartridges may have different rim sizes and/or shapes. In some embodiments, the cartridge holder may include an engagement portion that engages with the cartridges to support the cartridges in the holder. The engagement portion may

- 10 -

include one or more movable portions that may move relative to each other to adjust a size and/or shape of an opening of the cartridge holder at which the cartridges are received. For example, the movable portions may be radially movable relative to each other so as to enlarge and/or reduce the size of the opening, or to adjust a shape of the opening. Thus, in some embodiments, radial movement of the movable portions may move one or more of the movable portions in a plane that is parallel to a plane of the opening. Radial movement need not necessarily involve linear movement of a portion along a radius or diameter of a circularly shaped opening. Instead, the opening may have any suitable shape, such as a square or other polygon, and the movable portions may move in any suitable way to change the size and/or shape of the opening, such as along a linear path, a curved path, a rotational path, etc. For example, a cylindrical element may rotate about a longitudinal axis that is offset from the longitudinal center of the cylinder so as to effectively move the contact area of the cylinder radially relative to the opening. Such movement and others are termed radial movement herein. The moveable portions of the engagement portion may be compliant, e.g., include resilient sections that flex or otherwise resiliently deform to adjust the size of the opening so as to accommodate cartridges of different size/shape at the region where the engagement portion engages with the cartridges. The parts of the engagement portion at the opening may engage with a cartridge to support the weight of the cartridge or otherwise exert a force on the cartridge, e.g., to clamp the cartridge in place.

FIG. 3 shows a partial, close up view of a cartridge holder 3 that may be employed in the FIGs. 1 and 2 embodiment. In this embodiment, an opening 31 of the cartridge holder 3 is oriented in an upwardly inclined position with the opening 31 facing toward a front of the machine 10. In this upwardly inclined position, an axis that is perpendicular to the plane of the opening 31 may be arranged at an angle above the horizontal of about 25 to 85 degrees, e.g., about 45 degrees. Such an orientation may make placement of a cartridge in the holder easy and convenient for a user, e.g., the holder 3 may securely hold the cartridge 1 with the cover 8 in the open position. Thereafter, the handle 5 may be returned to the position of FIG. 1, and in response the cover 8 may move to a closed position, e.g., such that the cover 8 is positioned over the opening 31. Closing of the cover 8 may also cause one or more piercing elements to pierce the cartridge, e.g., to introduce liquid into the cartridge or allow beverage to exit.

- 11 -

Note, however, that the cartridge holder 3 need not be positioned in an upwardly inclined orientation, and instead may be arranged in a horizontal, vertical, inverted or other orientation. Also, the cartridge holder 3 may move relative to the cover 8 and/or housing 17, e.g., in a horizontal, translational movement, in a pivoting motion, etc. to
5 open and close the beverage forming station 11.

In accordance with an aspect of the invention, the cartridge holder 3 may include one or more moveable portions 32 that are movable to adjust a size of the opening 31 at which the cartridges are received and engaged by the cartridge holder 3. For example, in this embodiment, the cartridge holder 3 is arranged to receive both a first cartridge 1a
10 and a second cartridge 1b that are different from each other, e.g., the first cartridge 1a has a circular rim 19 with a diameter that is larger than the diameter of the circular rim 19 of the second cartridge 1b. The sizes of the rim diameters and the difference between the two may be any suitable value, e.g., one rim 19 may have diameter of about 50mm and the other rim 19 diameter may be about 63mm. The rim 19 diameter is relevant in this
15 embodiment because the cartridge holder 3 engages with the cartridges 1 in a region at or near (e.g., just below) the rim 19. For example, the cartridge may be received into the opening 31 such that an underside of the rim 19 rests on the movable portions 32. In cases where the cartridges 1 are engaged by the holder 3 in other regions, such as at a mid-section of the cartridges 1, at a bottom of the cartridges, etc., the cartridges 1 may be
20 different in size and/or shape in these regions.

In this embodiment, the movable portions 32 are movable in a radial direction as shown by the arrows so that the size of the opening 31 can be adjusted to receive the differently sized cartridges 1a, 1b. The movable portions 32 may move in any suitable way, such as being spring biased to move radially inwardly so that when the first and/or
25 second cartridge 1a, 1b is placed in the holder 3, the movable portions 32 are pushed outwardly by the cartridge 1a, 1b sidewall 12 until the rim 19 contacts the movable portions 32 or other stop. In the embodiment shown in FIG. 3, each of the movable portions 32 may be slidable in a corresponding slot of the cartridge holder 3, and a coil spring (not shown) may bias each of the movable portions 32 to move radially inwardly
30 in the corresponding slot. A stop or other feature may limit each movable portion's 32 radial movement, e.g., the movable portions 32 may be normally biased to a position in which the movable portions 32 define a size and/or shape of the opening 31 that

- 12 -

corresponds to the smaller second cartridge 1b. Thus, when the second cartridge 1b is placed in the holder 3, the movable portions 32 need not move to allow the holder to receive the second cartridge 1b. However, the movable portions 32 may move radially to accept the larger first cartridge 1a.

5 In other embodiments, the movable portions 32 may move in other ways, such as by a cam mechanism, screw drive, linkage, or other. For example, the movable portions may each have a cam follower pin that engages with a corresponding cam slot of a cam ring that extends around the opening 31. When the cam ring is rotated, the cam slots may move the follower pins radially in/out, and thereby moving the movable portions
10 in/out. Other arrangements are possible, such as a diaphragm or iris mechanism used to open/close a photographic camera diaphragm so as to control an amount of light entering the camera lens or a collet chuck arrangement used to hold drill bits in a hand-held drill. In such cases, the cartridge holder 3 may include a user-operable element, such as a knob or ring, that is movable to adjust a size and/or shape of the opening 31.

15 In another embodiment, an engagement portion of the cartridge holder may include one or more “finger” or wall portions that are arranged to move to accommodate differently sized/shaped cartridges. For example, FIG. 4 shows one embodiment of an engagement portion that includes five “fingers” or wall portions 32. The wall portions 32 are arranged together to form a sort of basket in which the cartridges 1 are placed.
20 Thus, the structure shown in FIG. 4 may be positioned in the cartridge holder 3 such that top parts 32a of the wall portions 32 define the opening 31 of the holder 3, e.g., the top parts 32a may contact an underside of the rim 19 of the cartridges 1. The wall portions 32 may be joined together at a bottom of the engagement portion and include at least one resilient portion that allows the wall portions 32 to flex outwardly and/or inwardly so as
25 to adjust a size and/or shape of the opening 31. For example, with the wall portions 32 at rest in an undeformed state, the smaller second cartridge 1b may be received into the opening 31 defined by the wall portions 32 with little or no movement of the wall portions 32. However, when the larger first cartridge 1a is placed in the opening 31, the sidewall 12 of the cartridge 1a may force the wall portions 32 to flex outwardly until the
30 underside of the rim 19 contacts the top parts 32a of the wall portions 32.

FIGs. 3 and 4 also illustrate another aspect of the invention, i.e., that the cartridge holder may include one or more compliant portions that are resiliently deformable or

- 13 -

otherwise movable to accommodate differently sized and/or shaped cartridges (at least in the region where the cartridges are engaged by the cartridge holder). That is, the engagement portion of FIG. 4 is compliant in that the wall portions 32 can resiliently change shape to accommodate differently sized and shaped cartridges (the same is true of the spring-loaded movable portions 32 in FIG. 3). This can allow for simplified cartridge insertion into a holder 3, e.g., because neither the machine nor user need take any specific action to adjust the size and/or shape of the opening 31. Instead, the interaction of the cartridge 1 with the cartridge holder 3 may itself adjust the size and/or shape of the opening 31 due to the compliant nature of the engagement portion. Of course, other arrangements for compliant movable portions 32 are possible, such as forming the movable portions in FIG. 3 of a foam or silicone material that deforms to adjust a size and/or shape of the opening 31.

In accordance with another aspect of the invention, different inlet and/or outlet ports at the cartridge holder may be used with different cartridges to form a beverage. For example, in one embodiment, a first outlet port may be used to receive beverage from a first cartridge, and a second outlet port may be used to receive beverage from a second cartridge. Such an arrangement may be useful, for example, when a first cartridge type is configured to be pierced at a top for a beverage outlet, and a second cartridge type is configured to be pierced at a bottom for a beverage outlet. FIG. 5 shows a schematic side view of an inlet and outlet port configuration that may be employed in an embodiment like that shown in FIG. 3 where a cartridge holder is arranged to receive cartridges of different sizes and/or shapes. As can be seen in FIG. 5, the cover 8 of the beverage machine 10 may include an inlet port 50 and an outlet port 52a, and may be pivotal about a cover pivot 81 between an open position (shown in dashed line) and a closed position (shown in solid line). In this embodiment, the inlet and outlet ports 50, 52a include piercing elements to pierce the cartridge 1 and form an opening, but piercing elements for either or both ports is not required. Instead, the cartridge 1 may have pre-formed inlet/outlet openings, or the openings may be formed by pressure applied to the outside or inside of the cartridge. For example, water pressure may be applied to the exterior of the cartridge 1 to form an inlet opening, and beverage pressure inside the cartridge may form an outlet opening in the cartridge, e.g., a septum, burstable seal or other structure may open in response to pressure.

- 14 -

In this embodiment, when the larger first cartridge 1a is received into the cartridge holder 3 and the cover 8 is moved to the closed position, the inlet and outlet ports 50, 52a may form openings in a top of the cartridge 1a so that water or other fluid may be provided into the cartridge 1a via the inlet port 50, and beverage may be received
5 from the cartridge 1a via the outlet port 52a. However, a second outlet port 52b does not contact the first cartridge 1a because the first cartridge 1a is not tall enough to contact the outlet second port 52b. In contrast, when the second cartridge 1b is received in the cartridge holder 3, the inlet port 50 may form an opening in a top of the cartridge 1b when the cover 8 is in the closed position, but the first outlet port 52a does not penetrate
10 the second cartridge 1b because the second cartridge 1b is smaller in diameter at the rim 19. Instead, the second outlet port 52b may form an outlet opening in a bottom of the cartridge 1b because in this embodiment, the second cartridge 1b is taller than the first cartridge 1a so that the piercing element of the outlet port 52b penetrates the second cartridge 1b. Thus, beverage formed in the cartridge 1b may flow to the second outlet
15 port 52b. Of course, it will be understood that other inlet/outlet port arrangements are possible for use with different cartridges and are not limited to this illustrative embodiment. For example, the inlet and/or outlet ports may introduce or receive fluid in any suitable locations relative to the cartridges, such as at the top, bottom, side or other locations of the cartridge, and may depend on the cartridge arrangements.

20 Cartridges used with various cartridge holder embodiments may be arranged in different ways, and may depend at least in part on the nature of how a beverage medium in the cartridge is accessed to form a beverage. FIG. 6 shows an exploded view and FIG. 7 shows an assembled view of one cartridge embodiment that may be used in some embodiments. Details regarding such a cartridge are provided in U.S. Patent 8,361,527,
25 which is hereby incorporated by reference. As will be understood, the cartridge 1 may contain any suitable beverage medium 20, e.g., ground coffee, tea leaves, dry herbal tea, powdered beverage concentrate, dried fruit extract or powder, powdered or liquid concentrated bouillon or other soup, powdered or liquid medicinal materials (such as powdered vitamins, drugs or other pharmaceuticals, nutraceuticals, etc.), and/or other
30 beverage-making material (such as powdered milk or other creamers, sweeteners, thickeners, flavorings, and so on).

- 15 -

In this illustrative embodiment, the cartridge 1 includes a container 12 that includes an interior space 14 having a first chamber 14a and a second chamber 14b that are separated by a filter 30. The container 12 may have a frustoconical cup shape with a sidewall 17 and an opening 13, although other arrangements are possible, e.g., the
5 container 12 may have a fluted, conical, or cylindrical shape, may be in the form of a square or rectangular cup, a domed cup, a sphere or partial sphere, or other suitable form, may have a fluted, corrugated, or otherwise shaped sidewall, and so on. Also, the container 12 need not necessarily have a defined shape, as is the case with some beverage sachets and pods. For example, although the container 12 in this embodiment
10 has a relatively rigid and/or resilient construction so that the container 12 tends to maintain its shape, the container 12 could be made to have a more compliant and/or deformable arrangement, e.g., like a sachet container made from a sheet of deformable material. Thus, an interior space defined by the container 12 may be formed only after the container material is formed around a beverage medium, filter and/or other cartridge
15 components, similar to when two filter paper layers (container material) are joined together around a charge of coffee grounds to form a pod or other form of cartridge.

The opening 13 may be closed by a lid 38, e.g., a flexible sheet of foil and polymer laminate material that is attached to a rim 19 of the container 12. (Although in this embodiment the rim 19 is arranged as an annular flange-like element, the rim 19
20 may be arranged in other ways. For example, the rim 19 may be the top edge of the sidewall 17 without any flange element.) The filter 30 may be attached to the lid 38 at a periphery 32 that is spaced inwardly and away from the rim 19, e.g., for reasons discussed more below. In addition, the filter 30 may extend from the periphery 32 at least partially into the interior space 14. In this illustrative embodiment, the filter 30 may
25 have a substantially frustoconical shape with fluted or pleated sidewalls and a generally flat bottom 31, as shown. However, the filter 30 may have any suitable shape, such as a cylindrical shape, a square cup shape, a domed shape, a flat sheet, or other. Also, the use of a filter 30 is not necessary, and instead the cartridge 1 may be filterless.

When using the cartridge 1 to form a beverage, the lid 38 and/or the container 12
30 may be pierced to introduce liquid into the cartridge and receive beverage from the cartridge. (As used herein, "beverage" refers to a liquid substance intended for drinking that is formed when a liquid interacts with a beverage medium. Thus, beverage refers to

- 16 -

a liquid that is ready for consumption, e.g., is dispensed into a cup and ready for drinking, as well as a liquid that will undergo other processes or treatments, such as filtering or the addition of flavorings, creamer, sweeteners, another beverage, etc., before being consumed.) To introduce liquid into the cartridge, for example, as shown in FIG. 8, a portion of the lid 38 generally circumscribed by the periphery 32 may be pierced by an inlet piercing element 50 (e.g., a needle) so that water or other liquid may be injected into the cartridge 1. Other inlet piercing arrangements are possible, such as multiple needles, a shower head, a non-hollow needle, a cone, a pyramid, a knife, a blade, etc. A beverage machine that uses the cartridge may include multiple piercing elements of the same type or of different types, as the invention is not limited in this respect. In another arrangement, a beverage machine may include a piercing element (such as a spike) that forms an opening and thereafter a second inlet element (such as a tube) may pass through the formed hole to introduce liquid into (or conduct liquid out of) the container. In other embodiments, the lid 38 may be pierced, or otherwise effectively opened for flow, by introducing pressure at an exterior of the lid 38. For example, a water inlet may be pressed and sealed to the lid 38 exterior and water pressure introduced at the site. The water pressure may cause the lid 38 to be pierced or otherwise opened to allow flow into the cartridge 1. In another arrangement, the lid 38 may include a valve, conduit or other structure that opens when exposed to a suitable pressure and/or when mated with a water inlet tube or other structure. Fluid introduced into the cartridge 1 may be slowed, distributed or otherwise acted on by a flow distributor 33, e.g., an element with holes to help more evenly wet the beverage medium 20.

The cartridge 1 may also be penetrated by an outlet piercing element 52b (e.g., a needle) at a bottom 16 of the container 12, or by an outlet piercing element 52a at a second portion of the lid 38 outside of the periphery 32 and apart from the inlet opening. As with the inlet piercing arrangement, the outlet piercing arrangement may be varied in any suitable way. Thus, the outlet piercing element 52 may include one or more hollow or solid needles, knives, blades, tubes, and so on. Alternately, the cartridge 1 may include a valve, septum or other element that opens to permit beverage to exit when liquid is introduced into the cartridge, but otherwise remains closed (e.g., to protect the beverage medium from external conditions such as oxygen, moisture or others). In such a case, no piercing element for forming the outlet opening is necessarily required

- 17 -

although may be used, e.g., to allow the valve or other element to open. Also, in this illustrative embodiment the piercing element 52 remains in place to receive beverage as it exits the opening formed in the container 12 or lid 38. However, in other embodiments, the piercing element 52 may withdraw after forming an opening, allowing
5 beverage to exit the opening and be received without the piercing element 52 being extended into the cartridge 1.

It should be understood that while a cartridge arranged like that in FIGs. 6-8 may be used in an embodiment like that in FIGs. 3 and 5, other cartridge types are possible, such as those described in U.S. Patents 6607762; 6645537; 6589577 and others. Also, it
10 should be appreciated that cartridges that can be received by a cartridge holder 3 may differ in shape, in addition to, or instead of, size (at least in a region where the cartridges are engaged by the cartridge holder to support the cartridge). For example, U.S. Patent 8,361,527 also describes a cartridge with an irregular rim shape, which is shown in FIG. 9. In this embodiment, the cartridge 1 is arranged similarly to that in FIGs. 6-8, but the
15 container 12 has a rim 19 with a circular portion 19a and a spout portion 19b that extends from the circular portion 19a. Thus, the rim 19 has an irregular shape, and the cartridge holder 3 may be arranged to not only accommodate a larger overall rim size of the cartridge 1, but also the irregular shape of the rim 19.

The example of FIG. 5 is only one that illustrates how different inlet and/or outlet
20 ports 50, 52 may be used for different cartridges. For example, in some embodiments, one or more ports 52 may be movable to exchange fluid, or not, with a cartridge in the holder 3. For example, FIG. 10 shows a schematic side view of the cartridge holder 3 of FIG. 3 with a second cartridge 1b having a relatively smaller, circularly-shaped rim diameter (e.g., as seen in FIGs. 6 and 7) received in the holder 3. In contrast, FIG. 11
25 shows a schematic side view of the cartridge holder 3 of FIG. 3 with a first cartridge 1a having a relatively larger rim diameter and an irregular rim shape (e.g., as seen in FIG. 9) received in the holder 3. The view in FIG. 10 is similar to that shown in FIG. 5 for the second cartridge 1b. That is, the second cartridge 1b, which has a relatively small circular rim 19 in this embodiment, is pierced at the top by the inlet port 50 to
30 accommodate downward inflow of fluid into the cartridge 1b, and pierced at the bottom by the second outlet port 52b to accommodate downward outflow of beverage from the cartridge 1b.

- 18 -

However, with the first cartridge 1a held in the cartridge holder 3, the top of the cartridge is pierced by both the inlet port 50 and the first outlet port 52a. The first cartridge 1a may be pierced by the first outlet port 52a at an area of the lid 38 which is located in the spout area near the spout portion 19b of the rim 19, although other areas of the lid are possible. Inclining the cartridge holder 3 and cartridge 1a such that the spout portion 19b is at a lower end of the cartridge 1a may aid in removing beverage from the cartridge 1a, since beverage may collect in the spout area for outflow in an upward direction.

Note that while in the FIG. 5 embodiment, the first cartridge 1a is too short to contact the second outlet port 52b, this need not be the case and the first cartridge 1a may be made taller. In such a case, the second outlet port 52b may be moved out of a cartridge receiving space so that the port 52b can avoid contact with the cartridge 1a. Such movement may be accomplished in different ways, such as by a motorized drive, a linkage, having a user physically move one of the ports into/out of a cartridge receiving area, and others. In one aspect of the invention, one or more ports may be selected for use with a cartridge based on one or more features of the cartridge that is inserted into the cartridge holder 3. For example, insertion of a cartridge having a relatively larger rim diameter may cause the second outlet port 52b to be moved out of a cartridge receiving area so as to avoid potential contact with the cartridge 1. In other embodiments, insertion of a particular cartridge type may release a port for movement, e.g., insertion of the larger rim cartridge may release the second outlet port 52b so that the cartridge 1a may contact the second outlet port 52b and move it.

For example, FIGs. 12 and 13 show an illustrative embodiment in which insertion of a cartridge having a spout, such as that shown in FIG. 9, causes the second outlet port 52b to move out of a cartridge receiving area. In this embodiment, one of the movable portions 32, e.g., a trigger 33, may contact the spout area of the cartridge 1a and be moved radially outwardly, i.e., to the right in FIGs. 12 and 13. The trigger 33 may be coupled to the second outlet port 52b by a linkage that causes the second outlet port 52b to pivot about an axis 53 as the sliding portion 32 is moved radially outwardly. This may move the second outlet port 52b out of an area of potential contact with the cartridge 1a. The trigger 33 may be spring loaded such that when the first cartridge 1a having a spout is removed from the cartridge holder 3, the trigger 33 may move radially inwardly,

- 19 -

allowing the second outlet port 52b to pivot back into a cartridge receiving area. Thus, if a second cartridge 1b is inserted into the holder 3 having no spout, the trigger 33 may remain stationary, and the second outlet port 52b may pierce the second cartridge 1b at its bottom or other suitable location. The second outlet port 52b may include or be
5 connected to a conduit to conduct beverage from the second cartridge 1b to a dispensing area of the beverage forming machine 10, or beverage may simply exit the cartridge 1b without being conducted by a conduit.

In another embodiment, movement of the trigger or other part of the cartridge holder 3 may release one or more ports for movement, e.g., based on contact with a
10 cartridge, so that the port does not pierce or otherwise interact with the cartridge to exchange fluid. For example, FIG. 14 shows an embodiment in which a trigger 33 like that in FIGs. 12 and 13 may be moved by a contact with a spout of a first cartridge 1a. Movement of the trigger 33 may release the second outlet port 52b for movement upon contact with the cartridge 1a so that the second outlet port 52b does not substantially
15 resist movement. For example, with the first cartridge 1a inserted into the cartridge holder 3, a bottom of the first cartridge 1a may contact the second outlet port 52b and pivot the port 52b about a horizontal axis 54 so the port 52b moves out of a cartridge receiving area and does not pierce the cartridge 1a. However, if a second cartridge 1b is inserted into the cartridge holder 3, the lack of movement of the trigger 33 may lock the
20 second outlet port 52b in place so that it pierces or otherwise interacts with the second cartridge 1b to receive beverage. In this embodiment, the trigger 33 is linked to a latch 331 that engages with the second outlet port 52b to prevent pivoting of the port 52b about the axis 54 when the trigger 33 is positioned to the left. However, movement of the trigger 33 to the right disengages the latch 331 from the port 52b, allowing the port
25 52b to pivot about the axis 54. The trigger 33 may be spring loaded to move to the left as shown in FIG. 14; thus, the latch 331 may normally engage the port 52b unless the trigger 33 is moved, e.g., by a first cartridge 1a.

Although the examples above show and describe embodiments in which only one outlet port is moved, other arrangements are possible, such as where two or more outlet
30 ports are moved, one or more inlet ports are moved, or other combinations of port selections are made. Also, movement of inlet and/or outlet ports may be effected by a motor drive or other mechanism, and may be controlled by based on reading of a

- 20 -

machine readable feature or other indicia on a cartridge. For example, the machine 10 may read an RFID tag, barcode, etc., on a cartridge 1, and make suitable port selections based on a cartridge type or other information associated with the identified cartridge 1.

FIGs. 15 and 16 show an exploded view and an assembled view of a cartridge holder, associated cover, handle actuator and other selected components of a beverage forming apparatus 10. In this embodiment, the engagement portion of the cartridge holder 3 includes a plurality of movable portions 32 in the form of “fingers” or wall portions that are joined together at a bottom of the engagement portion, as in FIG. 4. This embodiment also includes a trigger 33 to cause and/or allow movement of an outlet port from a cartridge receiving area. That is, this embodiment is arranged to receive both a first cartridge 1a that has an irregular rim having a circular portion and spout portion, and a second cartridge 1b that has a circular rim with a diameter smaller than that of the circular portion of the first cartridge 1a. Contact of the spout area of the first cartridge 1a with the trigger 33 causes the trigger 33 to move radially outwardly, releasing the second outlet port 52b for movement (or actually moving the second outlet port 52b). Note that the wall portions 32 of the engagement portion are arranged to provide a suitable opening for the second outlet port 52b to move into/out of the cartridge receiving area as needed.

As can be seen in FIG. 15, the engagement portion is received into a hole 35 in a portion of the frame 6 that helps define the cartridge holder 3. In this embodiment, the engagement portion is supported in the hole 35 so that the wall portions 32 located opposite the trigger 33 have a smaller range of radial motion than wall portions 32 located nearer the trigger 33. That is, one or more wall portions 32 opposite the trigger 33 may be permitted to move radially outwardly to some extent, but then contact the hole 35 or other part of the frame 6 so the wall portion(s) 32 are prevented from further outward radial movement. This may help the cartridge holder 3 to urge a cartridge 1a having a spout section into proper contact with the trigger 33 and move the trigger 33 suitably radially outwardly. In addition, this may help the cartridge holder 3 to properly position the cartridge 1a for alignment with an inlet and outlet port 50, 52a. That is, the trigger 33 may be biased to move radially inwardly by a spring or other resilient element of suitable strength so that insertion of the cartridge having a spout section causes the wall portion(s) 32 opposite the trigger 33 to flex outwardly and contact the hole 35 or

- 21 -

other stop of radial movement before the cartridge 1a is fully inserted into the opening 31. Further insertion of the cartridge 1a may then cause the trigger 33 to slide outwardly because the wall portion(s) 32 opposite the trigger 33 are prevented from further outward radial movement. This may ensure that the cartridge 1 is properly positioned for piercing
5 by an inlet and/or outlet piercing element.

FIG. 16 also shows how in this embodiment the cover 8 may be moved relative to the cartridge holder 3. The cover 8 is arranged for pivotal movement relative to the frame 6 about a cover pivot 61 based on movement of a handle 5 which is pivotally mounted to the cover 8 at a handle pivot 63. A plate 81 is also pivotally mounted to the
10 frame 6 about a plate pivot 62 and moves based on movement of the handle 5. The plate 81 operates to contact a cartridge 1 placed in the cartridge holder 3, and push the cartridge 1 into the holder 3 so that the cartridge 1 is fully received into the holder 3 before the cover 8 engages the cartridge 1. This helps ensure that the cartridge 1 is fully seated in the holder 3 before piercing elements on the cover 8 pierce the cartridge 1. A
15 pivot pin 64 of the handle 5 is engaged with a slot 82 of the plate 81 and moves in a cam slot 65 of the frame 6 so that as the handle 5 is pivoted about the handle pivot 63 from an open position (shown in FIG. 16) to a closed position, the pivot pin 64 moves in the cam slot 65, thereby pivoting the plate 81 about the plate pivot 62 toward the cartridge holder 3. At the same time, the cover 8 is pivoted about the cover pivot 63 to move toward the
20 cartridge holder 3. The plate 81 is arranged to contact a cartridge 1 in the holder 3 before the cover 8, forcing the cartridge 1 to be seated into the holder 3. This action may cause movable portions 32 of the engagement portion to move as needed to receive the cartridge 1. Further movement of the handle 5 toward the closed position causes the pivot pin 64 to move further downwardly in the cam slot 65 so the cover 8 engages the
25 cartridge 1. In this embodiment, piercing elements at the inlet and/or outlet ports 50, 52a may pierce the cartridge 1, although such piercing elements are not required. With the handle 5 at a closed position, the pivot pin 64 may move into a "J" shaped section of the cam slot 65 which effectively locks the cover 8 and the plate 81 in place over the cartridge holder 3. Lifting of the handle 5 from the closed position reverses movement
30 of the pivot pin 64 in the cam slot 65, thereby pivoting the cover 8 and plate 81 to the open positions.

- 22 -

FIG. 17 shows a schematic block diagram of various components that may be included in a beverage forming apparatus 100 in one illustrative embodiment. Those of skill in the art will appreciate that a beverage forming apparatus 100 may be configured in a variety of different ways, and thus aspects of the invention should not be narrowly
5 interpreted as relating only to one type of beverage forming apparatus. In this embodiment, water or other precursor liquid may be provided by a liquid supply 15 to mix with a beverage material at a beverage forming station 11. The beverage material (such as coffee grounds, tea leaves, a powdered drink mix, etc.) may be provided in a cartridge 1, or not, and beverage produced by mixing the liquid with the beverage
10 material may be dispensed into the container 2 via a beverage outlet.

The liquid supply 15 in this embodiment controls the volume of liquid provided to the beverage forming station 11 by filling the tank to a liquid dispense level 159, 160 and then pressurizing the tank 152 by way of an air pump 154 so that liquid in the tank 152 is forced out of the conduit 156 to the beverage forming station 11. The volume of
15 liquid delivered to the beverage forming station 11 is equal to the volume in the tank 152 between the liquid delivery level 159, 160 and a post-delivery level 158 at a bottom of the conduit 156 in the tank 152. Since there are two delivery levels 159, 160 in this embodiment, two different volumes can be provided to the beverage forming station 11. However, more than two levels, or a single level, may be used.

20 In this embodiment, the liquid supply 15 provides liquid to the tank 152 via a valve 151 that is coupled to a source **W**. The source **W** may have any suitable arrangement, e.g., may provide liquid from a storage tank, a mains water supply or other source. Thus, in some cases, the liquid provided to the tank 152 may vary in temperature by a wide degree depending on various factors, such as time of year, a temperature of a
25 room in which the machine 10 is located, etc. For example, if the source **W** is a reservoir that is filled by a user, the temperature of liquid in the reservoir may vary between room temperature (e.g., if liquid sits in the reservoir for an extended time) and a cooler temperature (e.g., if the reservoir has just been filled with water that is dispensed from a tap).

30 To provide liquid to the tank 152 in this embodiment, the valve 151 is controlled by the control circuit 16 to open and close to provide a desired volume of liquid to the tank 152. For example, if the tank 152 is empty or at the post-dispense level 158, the

- 23 -

valve 151 may be opened until a conductive probe or other liquid level sensor 157 provides a signal to the control circuit 16 that indicates when liquid arrives at the dispense level 159, 160. In response to the level sensor 157 detecting liquid at the sensor 157, the control circuit 16 may close the valve 151. Of course, other
5 arrangements are possible, such using a pump to move liquid from a storage reservoir to the tank 152.

Although in this embodiment the liquid level sensor includes a pair of conductive probes capable of contacting liquid in the tank 152 and providing a signal (e.g., a resistance change) indicative of liquid being present at respective dispense levels 159 or
10 160 in the tank 152, the liquid level sensor may be arranged in other ways. For example, the sensor may include a microswitch with an attached float that rises with liquid level in the tank 152 to activate the switch. In another embodiment, the liquid level sensor may detect a capacitance change associated with one or more liquid levels in the tank, may use an optical emitter/sensor arrangement (such as an LED and photodiode) to detect a
15 change in liquid level, may use a pressure sensor, may use a floating magnet and Hall effect sensor to detect a level change, and others. Thus, the liquid level sensor is not necessarily limited to a conductive probe configuration. Moreover, the liquid level sensor may include two or more different types sensors to detect different levels in the tank. For example, a pressure sensor may be used to detect liquid at the dispense level
20 160 (e.g., complete filling of the tank 152 may coincide with a sharp rise in pressure in the tank 152), while a conductive probe may be used to detect liquid at the other dispense level 159.

Further, a liquid level sensor need not be used to fill the tank to the dispense level 159, 160. Instead, other techniques may be used to suitably fill the tank 152, such as
25 opening the valve 151 for a defined period of time that is found to correspond to approximate filling of the tank 152 to the desired level. Of course, other arrangements for providing liquid to the tank 152 are possible, such as by a pump (e.g., a centrifugal pump, piston pump, solenoid pump, diaphragm pump, etc.), gravity feed, or other, and the way by which the tank is filled to the dispense level 159, 160 may depend on the
30 technique used to provide liquid to the tank. For example, control of a volume of liquid provided to fill the tank 152 to the dispense level 159, 160 may be performed by running a pump for a predetermined time, detecting a flow rate or volume of liquid entering the

- 24 -

tank 152 (e.g., using a flow meter), operating a pump for a desired number of cycles (such as where the pump is arranged to deliver a known volume of liquid for each cycle), detecting a pressure rise in the tank 152 using a pressure sensor, or using any other viable technique.

5 Liquid in the tank 152 may be heated by way of a heating element 153 whose operation is controlled by the control circuit 16 using input from a temperature sensor or other suitable input. Of course, heating of the liquid is not necessary, and instead (or additionally) the apparatus 100 may include a chiller to cool the liquid, a carbonator to carbonate the liquid, or otherwise condition the liquid in a way that alters the volume of
10 liquid in the tank 152. (Generally speaking, components of the liquid supply 15 that heat, cool, carbonate or otherwise condition liquid supplied to the beverage forming station 11 are referred to as a “liquid conditioner.”)

 In this embodiment, liquid may be discharged from the tank 152 by an air pump 154 operating to force air into the tank 152 to pressurize the tank and force liquid to flow
15 in the conduit 156 to the beverage forming station 11. Since the conduit extends downwardly into the tank 152, the volume of liquid delivered to the forming station 11 is defined as the volume in the tank 152 between the dispense level 159, 160 and the bottom end of the conduit 156. Again, liquid may be caused to flow from the tank 152 to the beverage forming station 11 in other ways. For example, a pump may be used to
20 pump liquid from the tank 152 to the forming station 11, liquid may be allowed to flow by gravity from the tank 152, and others. A vent 155, which can be opened or closed to vent the tank 152, may be provided to allow the tank 152 to be filled without causing a substantial rise in pressure in the tank 152 and to allow liquid to be delivered from the tank 152 by pressurizing the tank using the air pump 154. In this embodiment, the vent
25 155 is actually not controlled by the control circuit 16, but remains always open with an orifice of suitable size to allow venting for filling of the tank 152, and air pressure buildup in the tank 152 to allow liquid delivery. Other flow control features may be provided as well, such as a check valve or other flow controller that can prevent backflow in the conduit between the source **W** and the tank 152, or between the tank 152
30 and the beverage forming station 11.

 The beverage forming station 11 may use any beverage making ingredient, such as ground coffee, tea, a flavored drink mix, or other beverage medium, e.g., contained in

- 25 -

a cartridge 1 or not. Alternately, the beverage forming station 11 may function simply as an outlet for heated, cooled or otherwise conditioned water or other liquid, e.g., where a beverage medium is contained in the container 2. Once liquid delivery from the tank 156 to the station 11 is complete, the air pump 154 (or other air pump) may be operated to
5 force air into the conduit 156 to purge liquid from the beverage forming station 11, at least to some extent.

Operation of the valve 151, air pump 154 and other components of the apparatus 100 may be controlled by the control circuit 16, e.g., which may include a programmed processor and/or other data processing device along with suitable software or other
10 operating instructions, one or more memories (including non-transient storage media that may store software and/or other operating instructions), temperature and liquid level sensors, pressure sensors, input/output interfaces, communication buses or other links, a display, switches, relays, triacs, or other components necessary to perform desired input/output or other functions.

15 In accordance with an aspect of the invention, the beverage forming apparatus may include multiple detectors to detect characteristics of a cartridge received in the cartridge holder. Operation of the apparatus 100 may be controlled by the control circuit 16 based on information detected by the detectors. For example, in the embodiment shown in FIG. 17, the apparatus includes first, second and third detectors 161, 162, 163
20 that each detect a different characteristic regarding a cartridge 1 in the cartridge holder 3. A first detector 161 may detect the presence or absence of a cartridge 1, e.g., may include an infrared detector that illuminates an area of the cartridge holder 3 with infrared light and detects whether infrared light is reflected by a cartridge or not. Detection of a suitable amount or other level of reflected light may be used to determine that a cartridge
25 1 is present, whereas no or lower light levels may indicate the absence of a cartridge. Such an infrared detector may include an infrared emitter and a photodetector or other suitable element(s). Other detector arrangements are possible, such as mechanical switches, a bar code reader, an RFID interrogator, etc.

A second detector 162 may detect a type of cartridge, e.g., may detect whether a
30 cartridge includes a spout portion or not. The second detector may be arranged in a variety of different ways, and in one embodiment may include the trigger 33 of FIGs. 12-16 and a switch to detect movement of the trigger 33. For example, the trigger 33 may

- 26 -

include a magnet that moves with the trigger 33 and a reed or other suitable switch may detect the presence or absence of the magnet, thereby detecting movement of the trigger 33. Other arrangements for the second detector 162 are possible, such as an optical detector, bar code reader, etc.

5 The third detector 163 may detect information related to whether a cartridge is authorized for use with the beverage forming apparatus, and may include a bar code reader, a camera or other image capture device with image analysis capability, an RFID interrogator, and others. In this illustrative embodiment, the third detector 163 includes an illumination element that illuminates a portion of a cartridge with suitable light, e.g.,
10 one or more LED sources may illuminate a cartridge with light having any suitable set of wavelengths. The third detector 163 may also include a light detector that is arranged to detect light emitted and/or reflected by a cartridge portion and assess whether the light detected is consistent with an authorized cartridge. For example, authorized cartridges may carry a security ink or other material that provides a specific spectral response to
15 being illuminated by certain light. The third detector 163 may detect whether the spectral response is present, and if so, indicate that the cartridge is authorized for use in forming a beverage.

 The control circuit 16 may control operation of the liquid supply 15 and/or other portions of the apparatus 100 based on information detected by the first, second and/or
20 third detectors 161, 162, 163. For example, if no cartridge is detected by the first detector 161 and an operator presses a brew indication button, the control circuit 16 may cause the apparatus 100 to perform a cleaning operation by which the cartridge holder 3 and/or other parts of the apparatus 100 are cleaned. However, if a cartridge 1 is detected, the control circuit 16 may cause the display of beverage forming options to a
25 user at the user interface 14, may start a beverage creation cycle, may begin heating of water in the tank 152, etc. As another example, if the second detector 162 detects a particular type of cartridge, the control circuit 162 may control the system to adjust beverage forming parameters in some way, e.g., by adjusting a heating temperature, an amount of liquid used to make a beverage, displaying and requiring particular user input
30 to form a beverage, and so on. The control circuit 16 may prevent all or certain ones of beverage production processes if a cartridge is not detected by the third detector 163 to be an authorized one. Instead, the control circuit 16 may only permit a cleaning

- 27 -

operation, provided no cartridge is detected in the cartridge holder. Alternately, the control circuit 16 may cause the apparatus to perform a default beverage process, e.g., including a specific set of brew water temperature, volume, delivery time, etc.

While aspects of the invention may be used with any suitable cartridge, or no
5 cartridge at all, some cartridges may include features that enhance the operation of a beverage forming apparatus 100. As is known in the art, the cartridge 1 may take any suitable form such as those commonly known as a sachet, pod, capsule, container or other. For example, the cartridge 1 may include an impermeable outer covering within which is housed a beverage medium, such as roasted and ground coffee or other. The
10 cartridge 1 may also include a filter so that a beverage formed by interaction of the liquid with the beverage medium passes through the filter before being dispensed into a container 2. As will be understood by those of skill in the art, cartridges in the form of a pod (e.g., having opposed layers of permeable filter paper encapsulating a beverage medium) may use the outer portion of the cartridge 1 to filter the beverage formed. The
15 cartridge 1 in this example may be used in a beverage machine to form any suitable beverage such as tea, coffee, other infusion-type beverages, beverages formed from a liquid or powdered concentrate, etc. Thus, the cartridge 1 may contain any suitable beverage medium, e.g., ground coffee, tea leaves, dry herbal tea, powdered beverage concentrate, dried fruit extract or powder, powdered or liquid concentrated bouillon or
20 other soup, powdered or liquid medicinal materials (such as powdered vitamins, drugs or other pharmaceuticals, nutriaceuticals, etc.), and/or other beverage-making material (such as powdered milk or other creamers, sweeteners, thickeners, flavorings, and so on). In one illustrative embodiment, the cartridge 1 contains a beverage medium that is configured for use with a machine that forms coffee and/or tea beverages, however,
25 aspects of the invention are not limited in this respect.

As used herein, "beverage" refers to a liquid substance intended for drinking that is formed when a liquid interacts with a beverage medium. Thus, beverage refers to a liquid that is ready for consumption, e.g., is dispensed into a cup and ready for drinking, as well as a liquid that will undergo other processes or treatments, such as filtering or the
30 addition of flavorings, creamer, sweeteners, another beverage, etc., before being consumed.

- 28 -

Having thus described several aspects of at least one embodiment of this invention, it is to be appreciated various alterations, modifications, and improvements will readily occur to those skilled in the art. Such alterations, modifications, and improvements are intended to be part of this disclosure, and are intended to be within the
5 spirit and scope of the invention. Accordingly, the foregoing description and drawings are by way of example only.

What is claimed is:

- 29 -

CLAIMS

1. A beverage forming apparatus, comprising:

a frame arranged to support components of the beverage forming apparatus;

5 a cartridge holder including a cartridge engagement portion that defines an opening and that is arranged to engage with a cartridge positioned in the opening, the engagement portion including one or more radially movable sections that are movable to accommodate and engage with first and second cartridges that are differently sized and/or shaped relative to each other in a region where the engagement portion engages
10 with the first and second cartridges;

a cover arranged to cooperate with the cartridge holder to at least partially enclose a cartridge held by the cartridge holder for formation of a beverage using the cartridge; and

a liquid supply system at least partially supported by the frame arranged to
15 provide a liquid for combination with a beverage medium in a cartridge held by the cartridge holder to form a beverage.

2. The apparatus of claim 1, wherein the cartridge engagement portion includes a plurality of wall sections that are movable relative to each other to accommodate the first
20 or second cartridge.

3. The apparatus of claim 1, wherein the cartridge engagement portion includes at least one trigger that is mounted for sliding movement away from the opening.

25 4. The apparatus of claim 3, wherein the trigger is movable to receive a spout of the first or second cartridge.

5. The apparatus of claim 1, wherein the cartridge engagement portion engages with a rim of the first and second cartridge positioned in the opening to support a weight
30 of the cartridge, and wherein the first cartridge has a rim with a first diameter, and the second cartridge has a rim with a second diameter that is smaller than the first diameter.

- 30 -

6. The apparatus of claim 5, wherein the rim of the second cartridge is circular, and the rim of the first cartridge has a circular portion and a spout portion or other geometric feature that extends outwardly from the circular portion.

5 7. The apparatus of claim 1, wherein the cartridge engagement portion includes a plurality of wall portions that extend upwardly from a bottom of the engagement portion, where the wall portions are joined together, to a top of the engagement portion, the wall portions located at the top of the engagement portion being radially movable relative to each other and arranged for engagement with the first and second cartridge.

10

8. The apparatus of claim 7, wherein the wall portions are radially movable based on flexing movement of the wall portions relative to the bottom of the engagement portion.

15

9. The apparatus of claim 1, wherein the cover includes a liquid inlet to introduce liquid from the liquid supply system to a cartridge held in the cartridge holder.

10. The apparatus of claim 9, wherein the cover includes a first beverage outlet to receive beverage exiting a cartridge held in the cartridge holder.

20

11. The apparatus of claim 9, further comprising a second beverage outlet mounted to the cartridge holder and arranged to receive beverage exiting a cartridge held in the cartridge holder.

25

12. The apparatus of claim 11, wherein the second beverage outlet is selectively movable into and out of a cartridge receiving area of the cartridge holder based on whether the first or second cartridge is received in the cartridge holder.

30

13. The apparatus of claim 12, wherein the liquid inlet and the first and second beverage outlets each include a piercing element to pierce a cartridge.

- 31 -

14. The apparatus of claim 13, wherein the piercing elements of the liquid inlet and the first beverage outlet face downwardly and the second beverage outlet faces upwardly with the cover cooperating with the cartridge holder to at least partially enclose a cartridge.

5

15. The apparatus of claim 1, wherein the cover is movable relative to the cartridge holder between an open position in which the cartridge holder is exposed to receive a cartridge into the opening, and a closed position in which the cover cooperates with the cartridge holder to at least partially enclose a cartridge held by the cartridge holder.

10

16. The apparatus of claim 1, wherein regions of the first and second cartridges where the engagement portion engages with the first and second cartridges have different shapes.

15

17. The apparatus of claim 1, wherein regions of the first and second cartridges where the engagement portion engages with the first and second cartridges have different sizes.

20

18. The apparatus of claim 1, wherein the engagement portion includes a plurality of radially movable sections and at least one of the radially movable sections has a smaller or larger range of motion than at least one other radially movable section.

25

19. The apparatus of claim 18, wherein the cartridge holder is arranged to receive a cartridge with a rim having a partially circular portion and a spout section extending outwardly from the partially circular portion, and wherein the at least one radially movable section with a smaller range of motion is located on a side of the opening opposite where the spout section of the cartridge is received.

30

20. A method for forming a beverage using a beverage forming apparatus, comprising:

- 32 -

providing a beverage forming apparatus including a cartridge holder having an engagement portion arranged to engage with a cartridge placed in an opening of the cartridge holder;

providing a first or second cartridge into the opening of the cartridge holder, the
5 first and second cartridges being differently sized and/or shaped relative to each other in a region where the engagement portion engages with the first and second cartridges;

radially moving one or more sections of the engagement portion to accommodate and engage with a region of the first or second cartridge provided into the opening; and

combining liquid with a beverage medium in the first or second cartridge held by
10 the cartridge holder to form a beverage.

21. The method of claim 20, wherein the step of radially moving includes moving a plurality of wall sections relative to each other to accommodate the first or second cartridge.

15

22. The method of claim 20, wherein the step of radially moving includes sliding at least one trigger of the engagement portion away from the opening.

23. The method of claim 22, wherein the first cartridge is provided into the
20 opening, and the trigger is moved to receive a spout of the first cartridge.

24. The method of claim 20, wherein the cartridge engagement portion engages with a rim of the first or second cartridge to support a weight of the cartridge, and wherein the first cartridge has a rim with a first diameter, and the second cartridge has a
25 rim with a second diameter that is smaller than the first diameter.

25. The method of claim 24, wherein the rim of the second cartridge is circular, and the rim of the first cartridge has a circular portion and a spout portion that extends outwardly from the circular portion.

30

26. The method of claim 20, wherein the step of radially moving includes moving a plurality of wall portions away from each other to accommodate the first or

- 33 -

second cartridge, wherein the plurality of wall portions extend upwardly from a bottom of the engagement portion where the wall portions are joined together, to a top of the engagement portion, and wherein the wall portions are flexed to move the wall portions away from each other.

5

27. The method of claim 20, further comprising moving a cover to at least partially enclose a cartridge held by the cartridge holder.

10 28. The method of claim 27, further comprising introducing liquid from the liquid supply system to a cartridge held in the cartridge holder via a liquid inlet of the cover.

29. The method of claim 28, further comprising receiving beverage from the cartridge at a first beverage outlet attached to the cover.

15

30. The method of claim 20, further comprising receiving beverage at a first beverage outlet if a first cartridge is received in the cartridge holder, and receiving beverage at a second beverage outlet if a second cartridge is received in the cartridge holder.

20

31. The method of claim 30, wherein the second beverage outlet is selectively moved out of a cartridge receiving area of the cartridge holder if the first cartridge is received in the cartridge holder.

25 32. The method of claim 20, wherein regions of the first and second cartridges where the engagement portion engages with the first and second cartridges have different shapes.

30 33. The method of claim 20, wherein regions of the first and second cartridges where the engagement portion engages with the first and second cartridges have different sizes.

- 34 -

34. A beverage forming apparatus, comprising:

a frame arranged to support components of the beverage forming apparatus;

a cartridge holder including a cartridge engagement portion that defines an opening and that is arranged to engage with a cartridge placed in the opening and support
5 a weight of the cartridge, the engagement portion including one or more compliant sections that are movable to adjust a size and/or shape of the opening to accommodate and engage with first and second cartridges that are differently sized and/or shaped relative to each other in a region where the engagement portion engages with the first and second cartridges;

10 a cover arranged to cooperate with the cartridge holder to at least partially enclose a cartridge held by the cartridge holder for formation of a beverage using the cartridge; and

a liquid supply system at least partially supported by the frame arranged to provide a liquid for combination with a beverage medium in a cartridge held by the
15 cartridge holder to form a beverage.

35. The apparatus of claim 34, wherein the one or more compliant sections each include a resilient element that deforms in response to insertion of the first or second cartridge into the opening of the cartridge holder.

20

36. The apparatus of claim 34, wherein the one or more compliant sections includes a plurality of wall sections that are movable relative to each other to accommodate the first or second cartridge.

25

37. The apparatus of claim 34, wherein the one or more compliant sections includes at least one trigger that is mounted for sliding movement away from the opening.

30

38. The apparatus of claim 37, wherein the trigger is movable to receive a spout of the first or second cartridge.

- 35 -

39. The apparatus of claim 34, wherein the cartridge engagement portion engages with a rim of the first and second cartridge to support a weight of the cartridge, and wherein the first cartridge has a rim with a first diameter, and the second cartridge has a rim with a second diameter that is smaller than the first diameter.

5

40. The apparatus of claim 45, wherein the rim of the second cartridge is circular, and the rim of the first cartridge has a circular portion and a spout portion that extends outwardly from the circular portion.

10

41. The apparatus of claim 34, wherein the one or more compliant sections includes a plurality of wall portions that extend upwardly from a bottom of the engagement portion, where the wall portions are joined together, to a top of the engagement portion, the wall portions located at the top of the engagement portion being radially movable relative to each other and arranged for engagement with the first and

15

42. The apparatus of claim 41, wherein the wall portions are radially movable based on flexing movement of the wall portions relative to the bottom of the engagement portion.

20

43. The apparatus of claim 34, wherein the cover includes a liquid inlet to introduce liquid from the liquid supply system to a cartridge held in the cartridge holder.

25

44. The apparatus of claim 43, wherein the cover includes a first beverage outlet to receive beverage exiting a cartridge held in the cartridge holder.

45. The apparatus of claim 43, further comprising a second beverage outlet mounted to the cartridge holder and arranged to receive beverage exiting a cartridge held in the cartridge holder.

- 36 -

46. The apparatus of claim 45, wherein the second beverage outlet is selectively movable into and out of a cartridge receiving area of the cartridge holder based on whether the first or second cartridge is received in the cartridge holder.

5 47. The apparatus of claim 46, wherein the liquid inlet and the first and second beverage outlets each include a piercing element to pierce a cartridge.

10 48. The apparatus of claim 47, wherein the piercing elements of the liquid inlet and the first beverage outlet face downwardly and the second beverage outlet faces upwardly with the cover cooperating with the cartridge holder to at least partially enclose a cartridge.

15 49. The apparatus of claim 34, wherein regions of the first and second cartridges where the engagement portion engages with the first and second cartridges have different shapes.

20 50. The apparatus of claim 34, wherein regions of the first and second cartridges where the engagement portion engages with the first and second cartridges have different sizes.

51. A method for forming a beverage using a beverage forming apparatus, comprising:

25 providing a beverage forming apparatus including a cartridge holder having an engagement portion arranged to engage with a cartridge placed in an opening of the cartridge holder and support a weight of the cartridge, the engagement portion including one or more resilient elements that are movable to adjust a size and/or shape of the opening;

30 providing a first or second cartridge into the opening of the cartridge holder, the first and second cartridges being differently sized and/or shaped relative to each other in a region where the engagement portion engages with the first and second cartridges to support a weight of the cartridge;

- 37 -

moving one or more resilient elements of the engagement portion to adjust a size and/or shape of the opening and to accommodate and engage with a region of the first or second cartridge provided into the opening; and

combining liquid with a beverage medium in the first or second cartridge held by
5 the cartridge holder to form a beverage.

52. The method of claim 51, wherein the step of moving one or more resilient elements includes moving a plurality of wall sections away from each other to accommodate the first or second cartridge.

10

53. The method of claim 51, wherein the step of moving one or more resilient elements includes sliding at least one trigger of the engagement portion away from the opening.

15 54. The method of claim 53, wherein the first cartridge is provided into the opening, and the trigger is moved to receive a spout of the first cartridge.

55. The method of claim 51, wherein the cartridge engagement portion engages with a rim of the first or second cartridge to support a weight of the cartridge, and
20 wherein the first cartridge has a rim with a first diameter, and the second cartridge has a rim with a second diameter that is smaller than the first diameter.

56. The method of claim 55, wherein the rim of the second cartridge is circular, and the rim of the first cartridge has a circular portion and one or more spout portions
25 that extends outwardly from the circular portion.

57. The method of claim 51, wherein the step of moving one or more resilient elements includes moving a plurality of wall portions away from each other to accommodate the first or second cartridge, wherein the plurality of wall portions extend
30 upwardly from a bottom of the engagement portion where the wall portions are joined together, to a top of the engagement portion, and wherein the wall portions are flexed to move the wall portions away from each other.

- 38 -

58. The method of claim 51, further comprising moving a cover to at least partially enclose a cartridge held by the cartridge holder.

5 59. The method of claim 58, further comprising introducing liquid from the liquid supply system to a cartridge held in the cartridge holder via a liquid inlet of the cover.

60. The method of claim 59, further comprising receiving beverage from the
10 cartridge at a first beverage outlet attached to the cover.

61. The method of claim 51, further comprising receiving beverage at a first beverage outlet if a first cartridge is received in the cartridge holder, and receiving beverage at a second beverage outlet if a second cartridge is received in the cartridge
15 holder.

62. The method of claim 61, wherein the second beverage outlet is selectively moved out of a cartridge receiving area of the cartridge holder if the first cartridge is received in the cartridge holder.

20

63. The method of claim 51, wherein regions of the first and second cartridges where the engagement portion engages with the first and second cartridges have different shapes.

25 64. The method of claim 51, wherein regions of the first and second cartridges where the engagement portion engages with the first and second cartridges have different sizes.

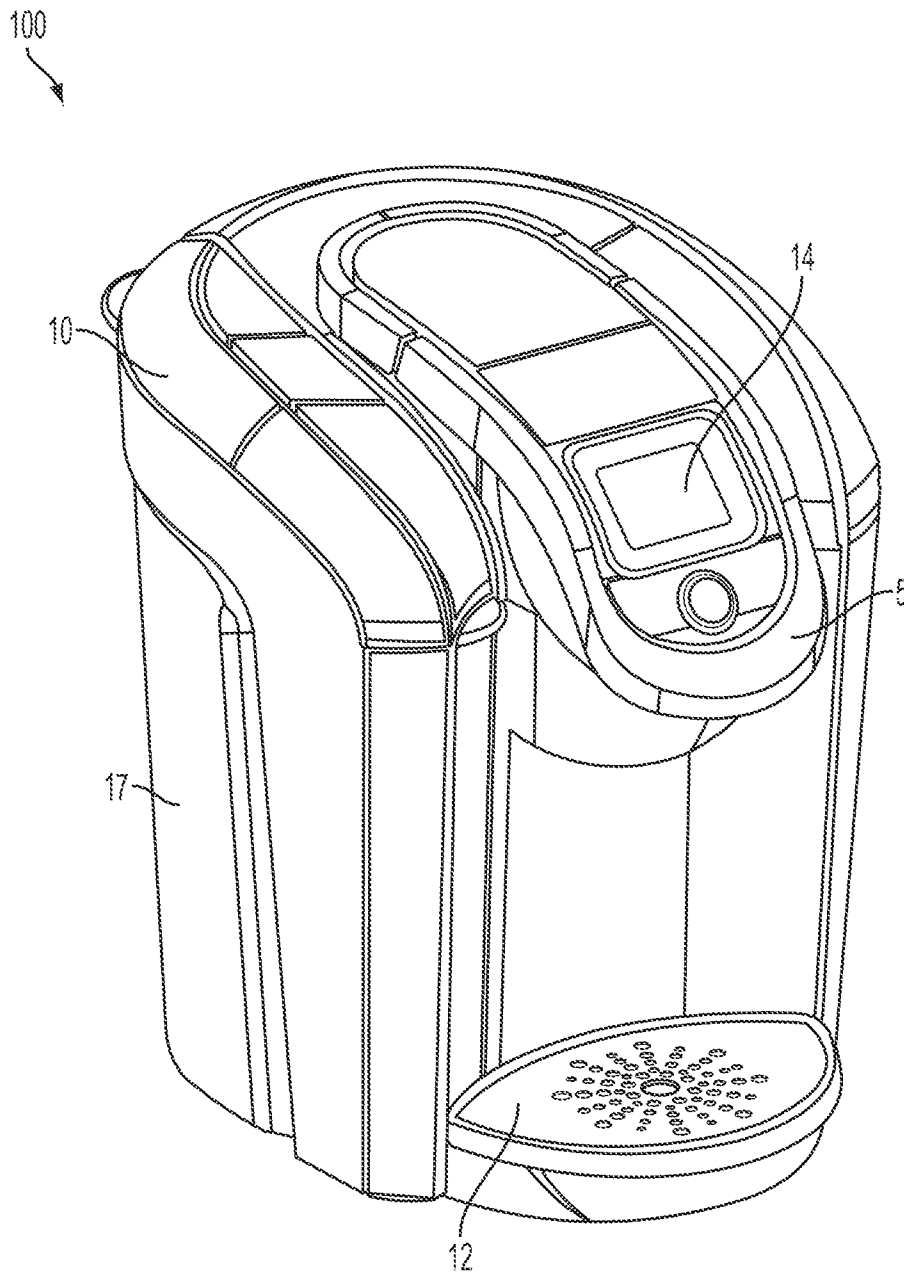

FIG. 1

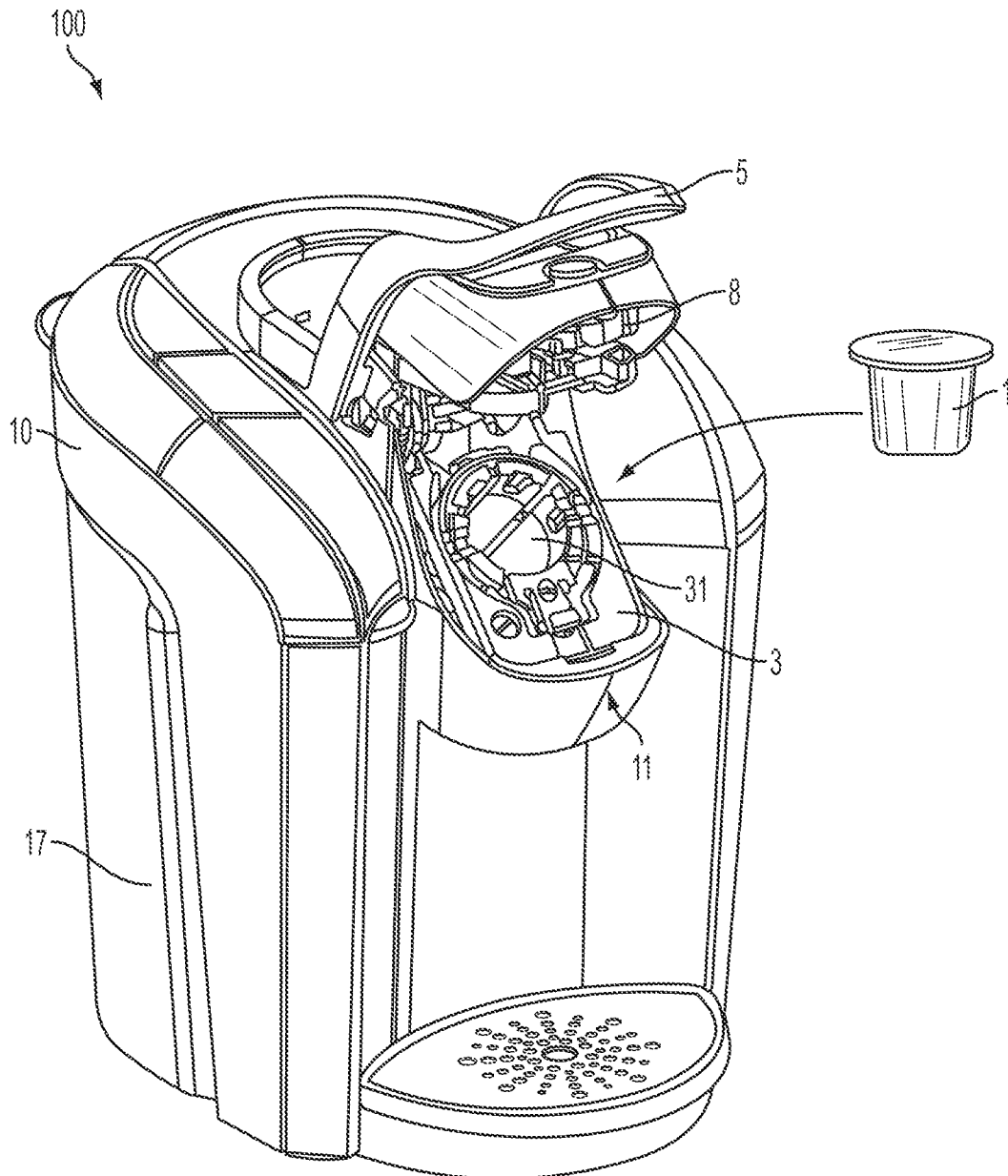

FIG. 2

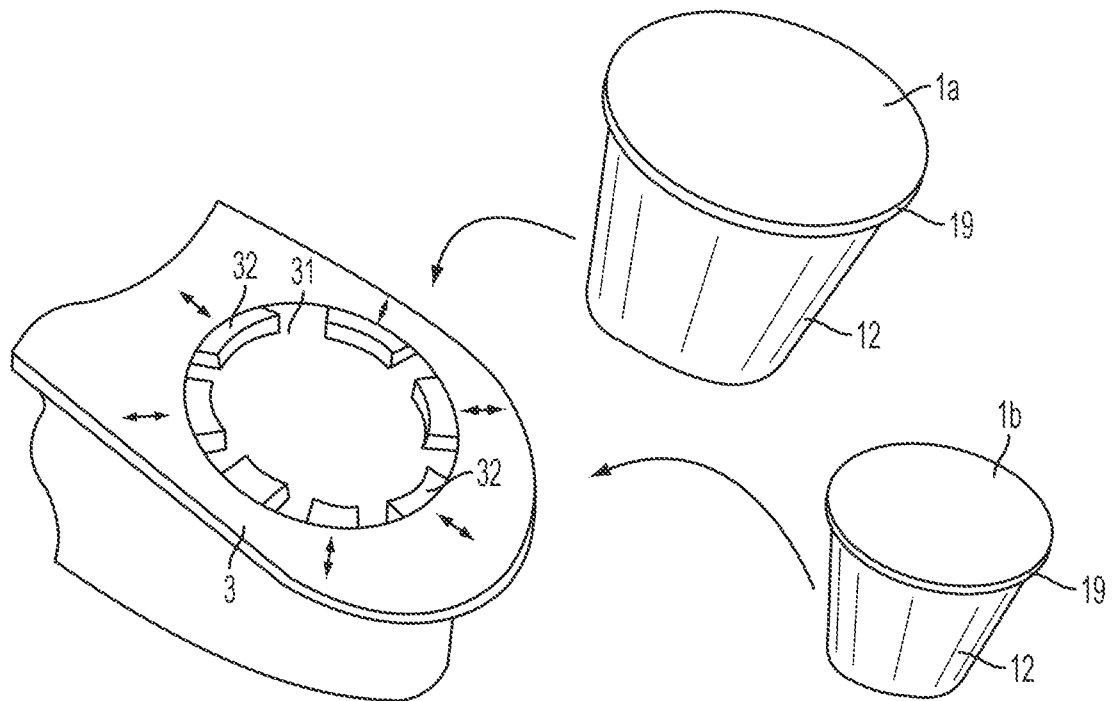

FIG. 3

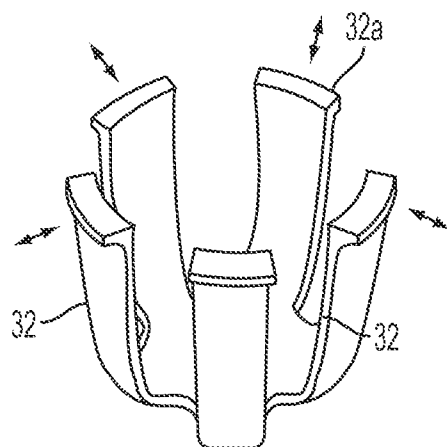

FIG. 4

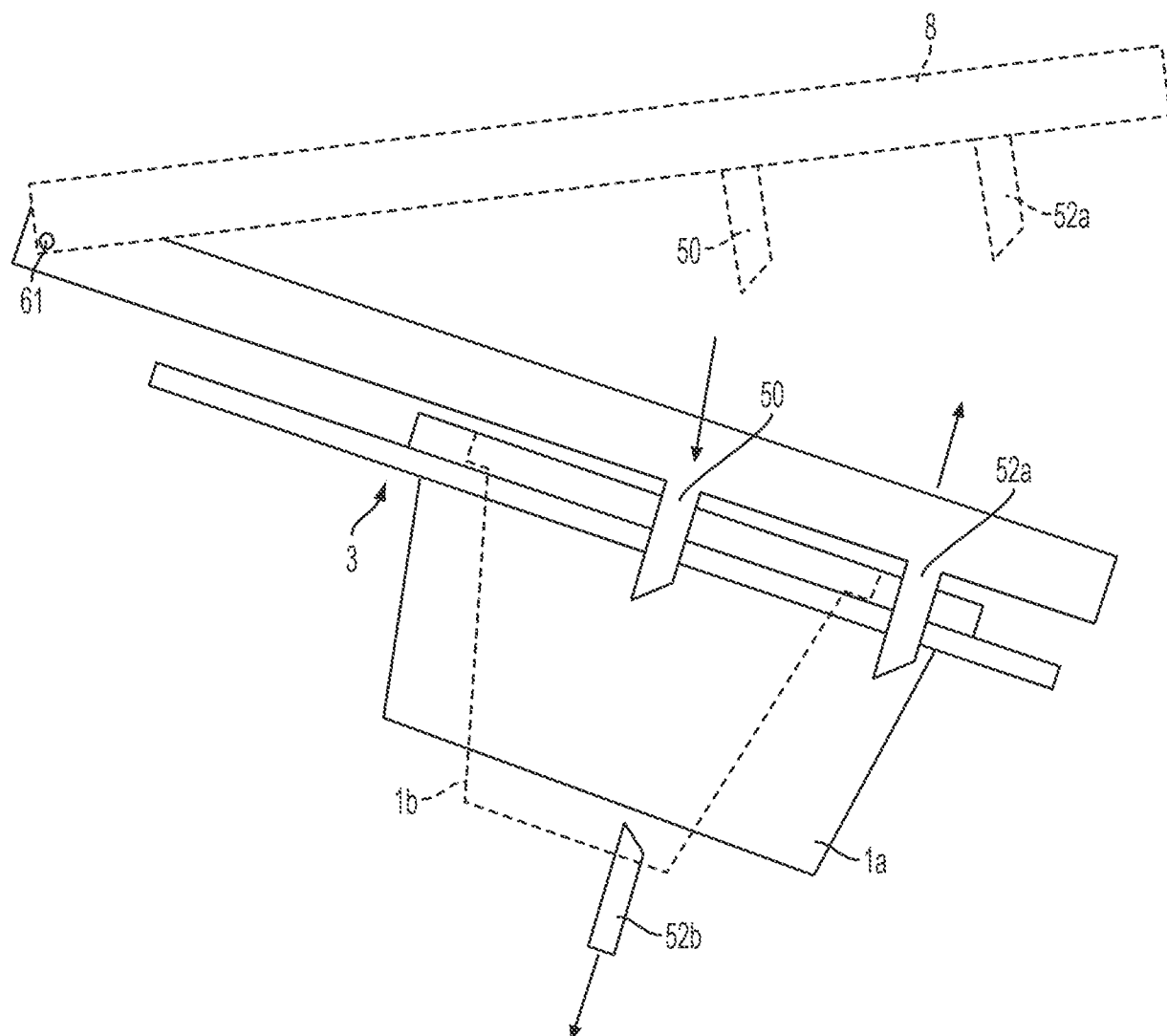

FIG. 5

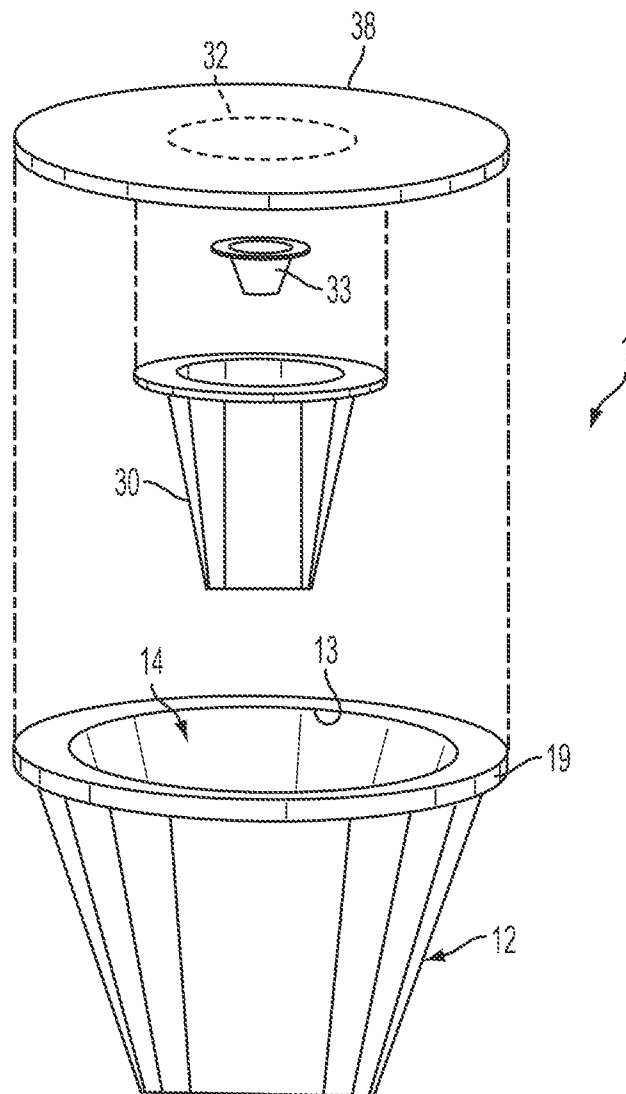

FIG. 6

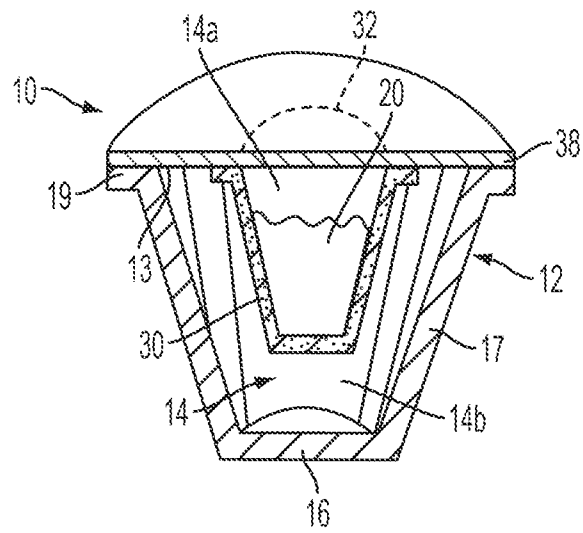

FIG. 7

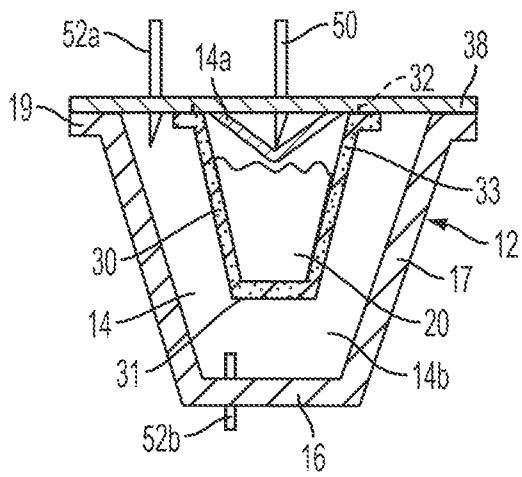

FIG. 8

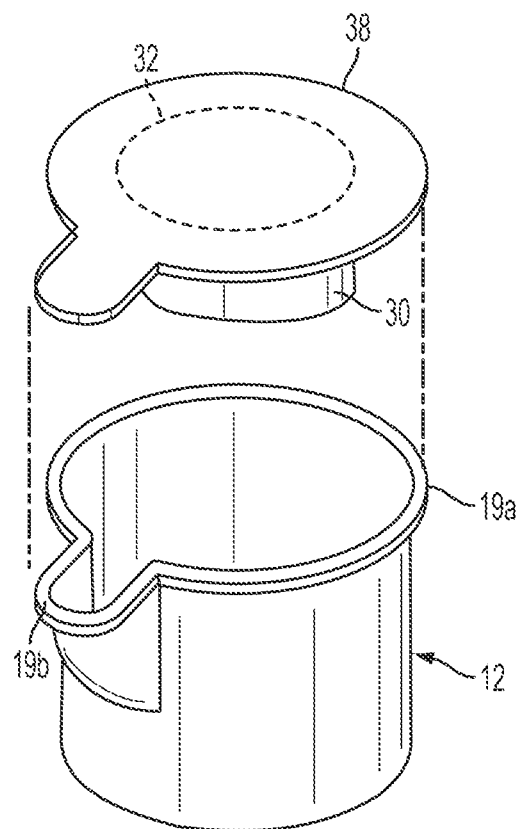

FIG. 9

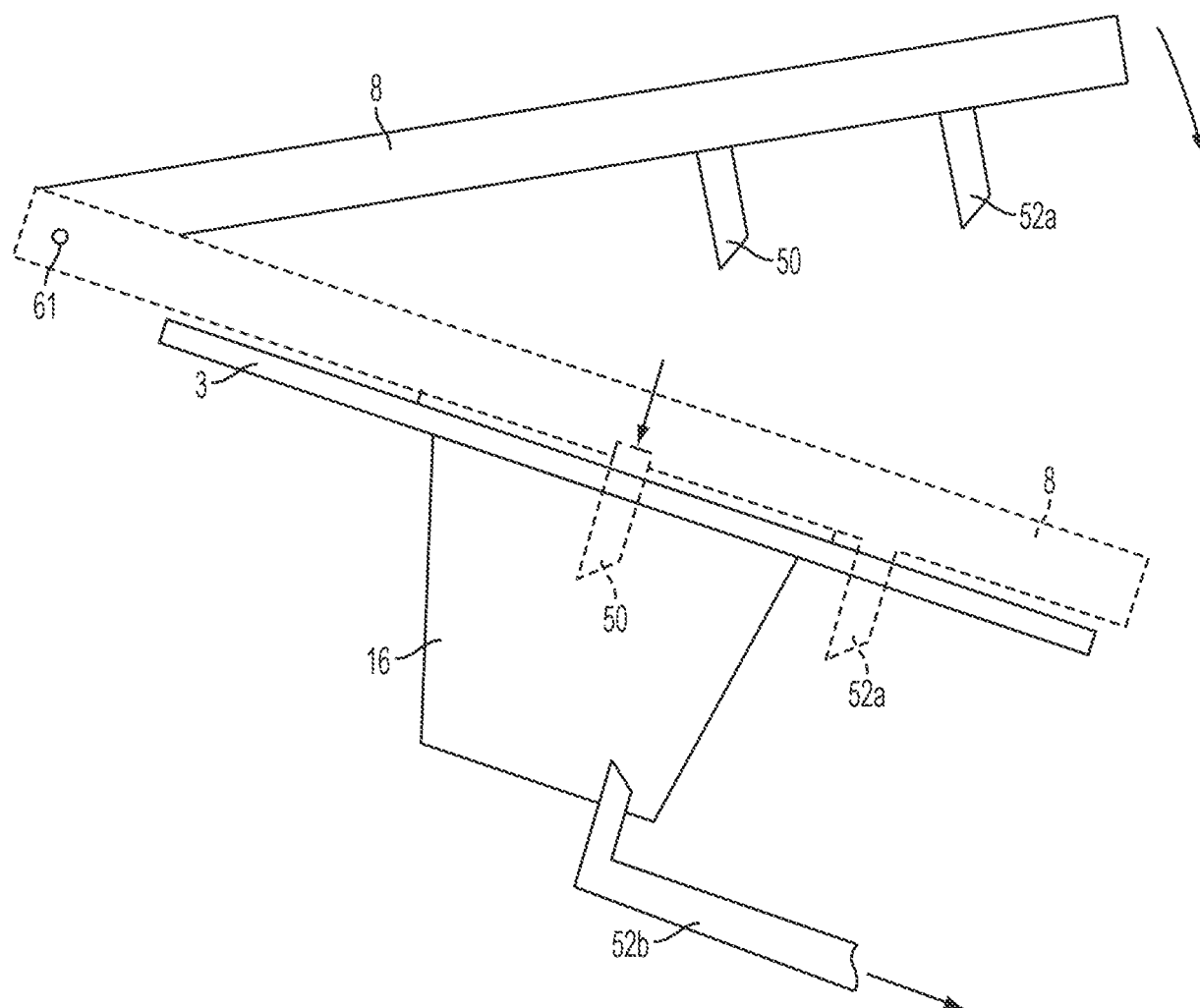

FIG. 10

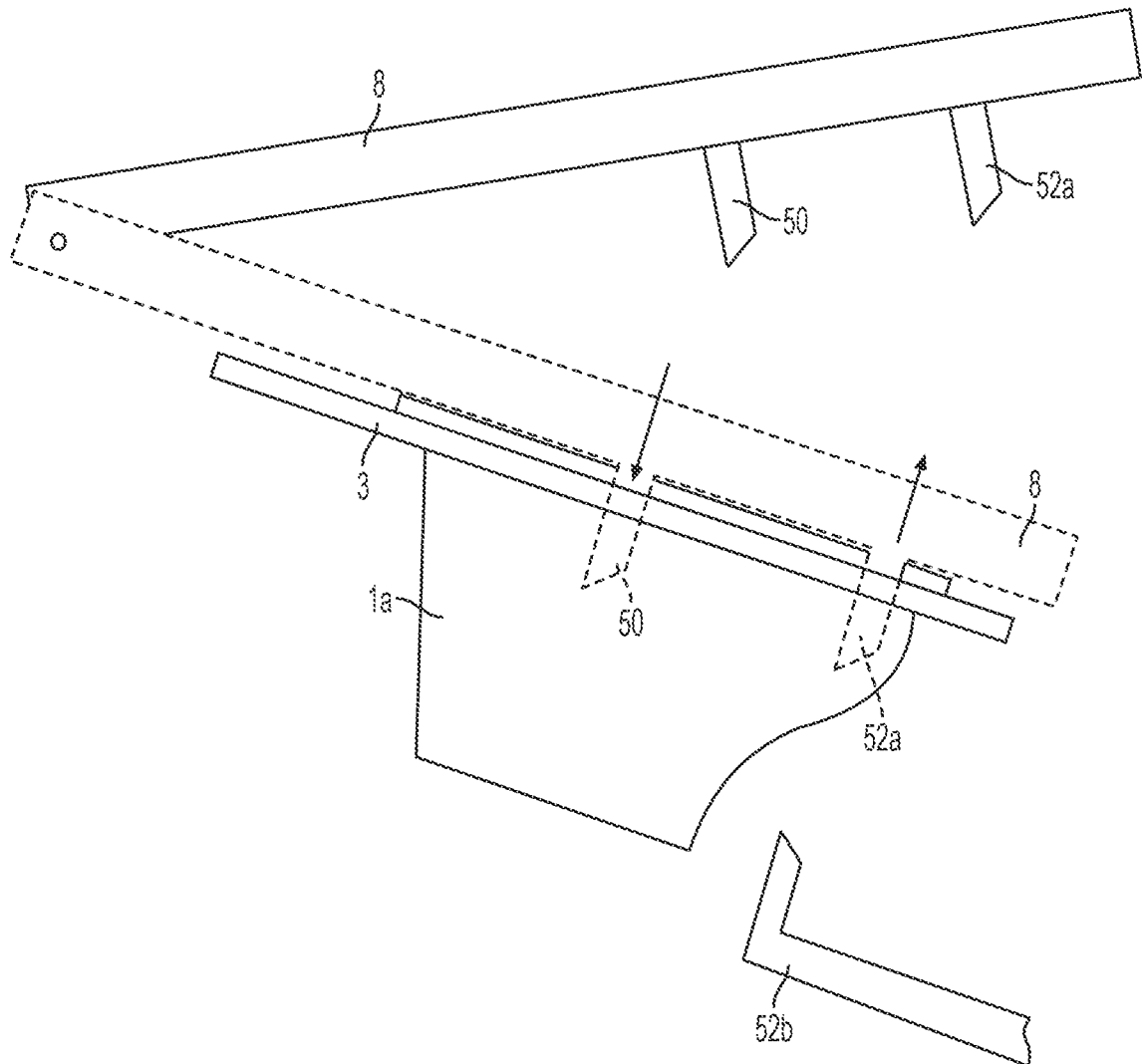

FIG. 11

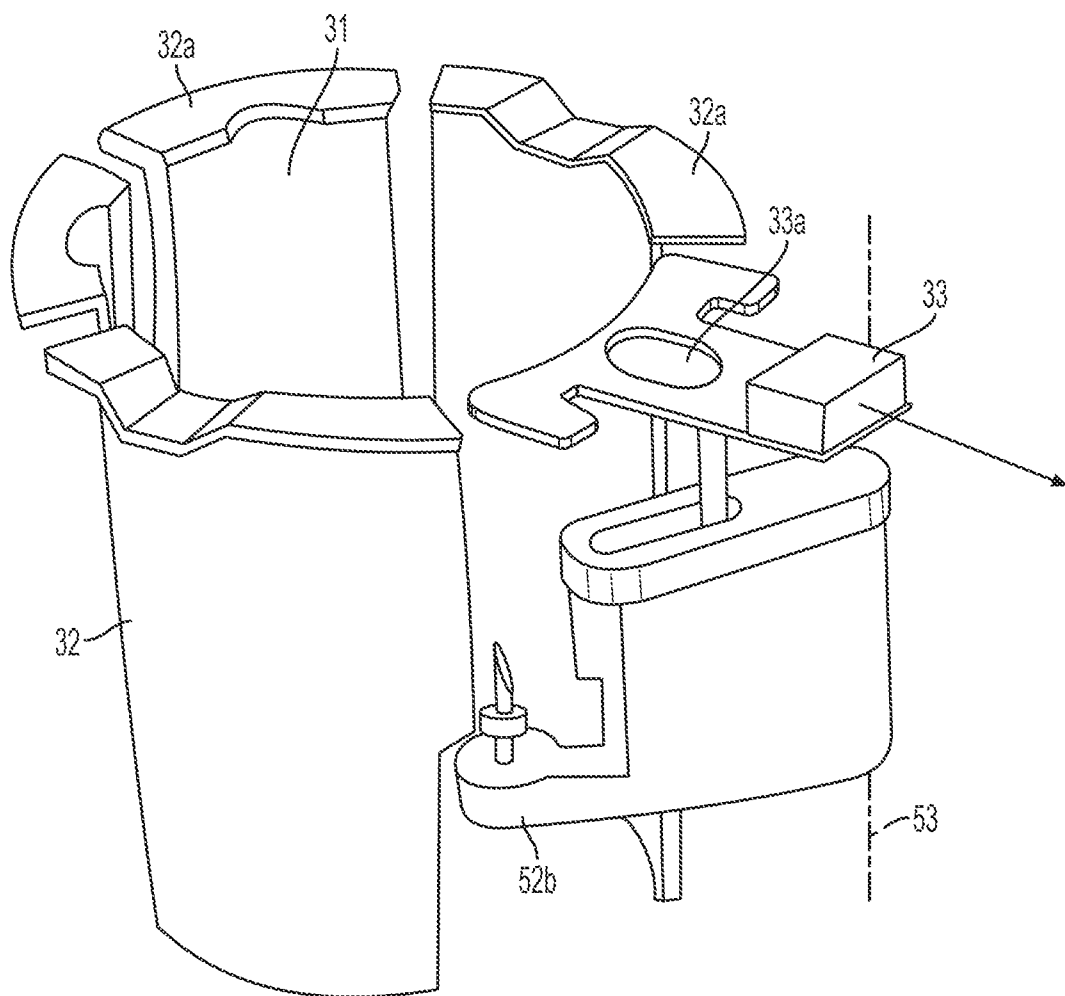

FIG. 12

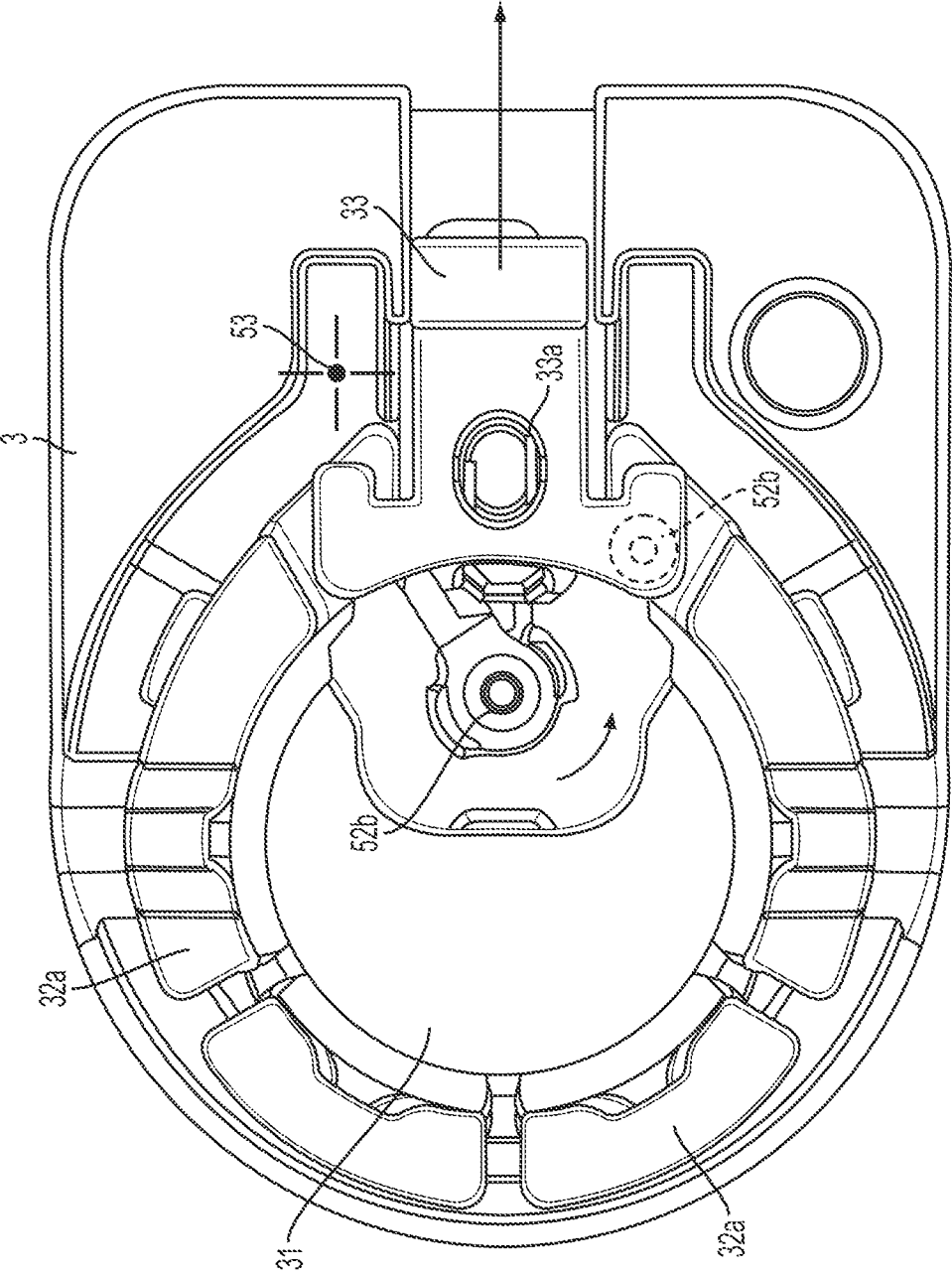

FIG. 13

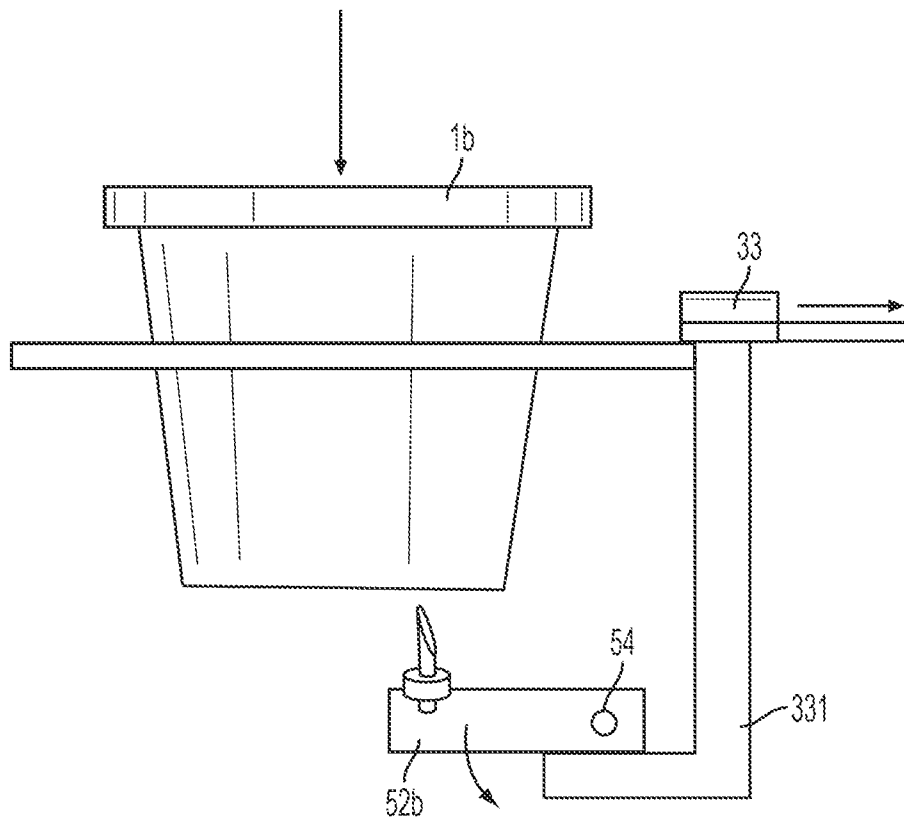

FIG. 14

12/14

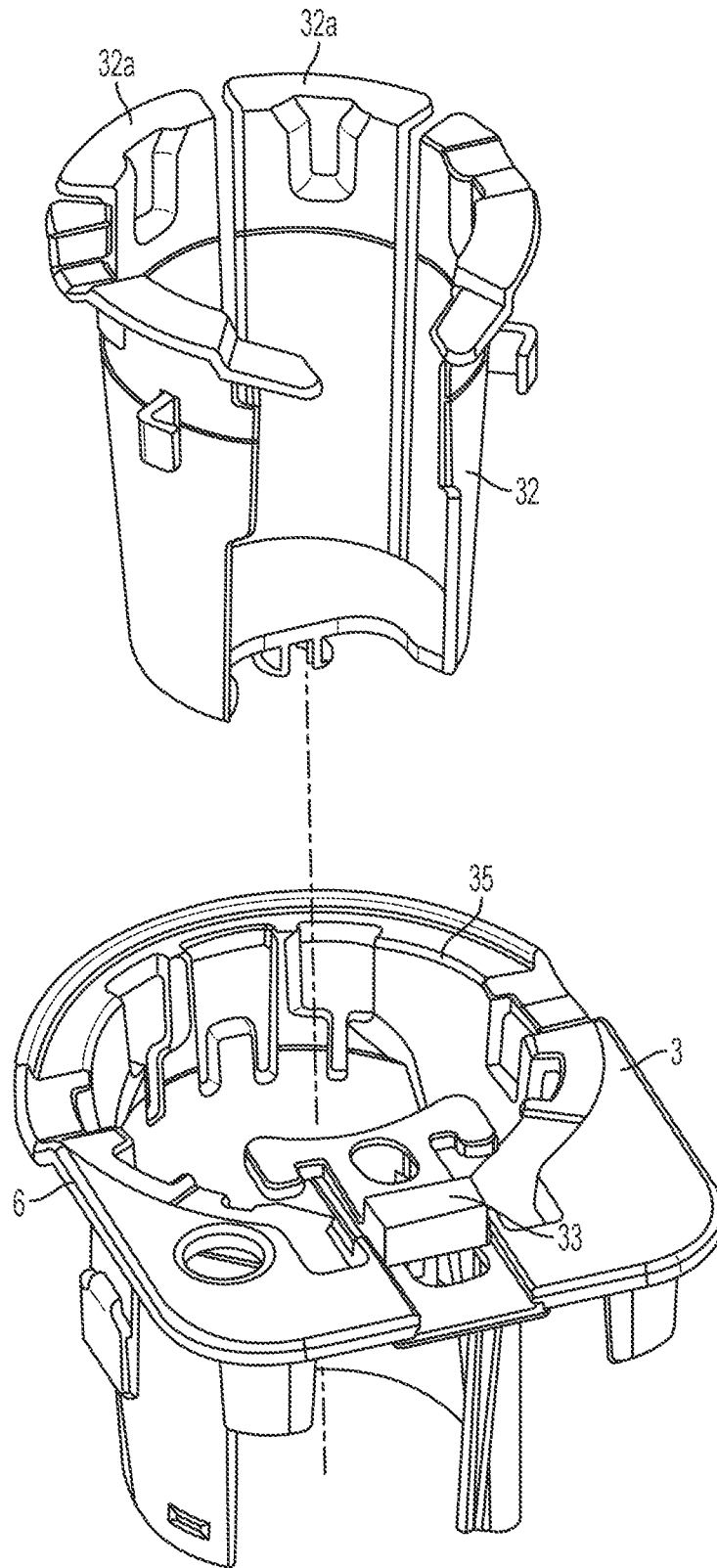

FIG. 15

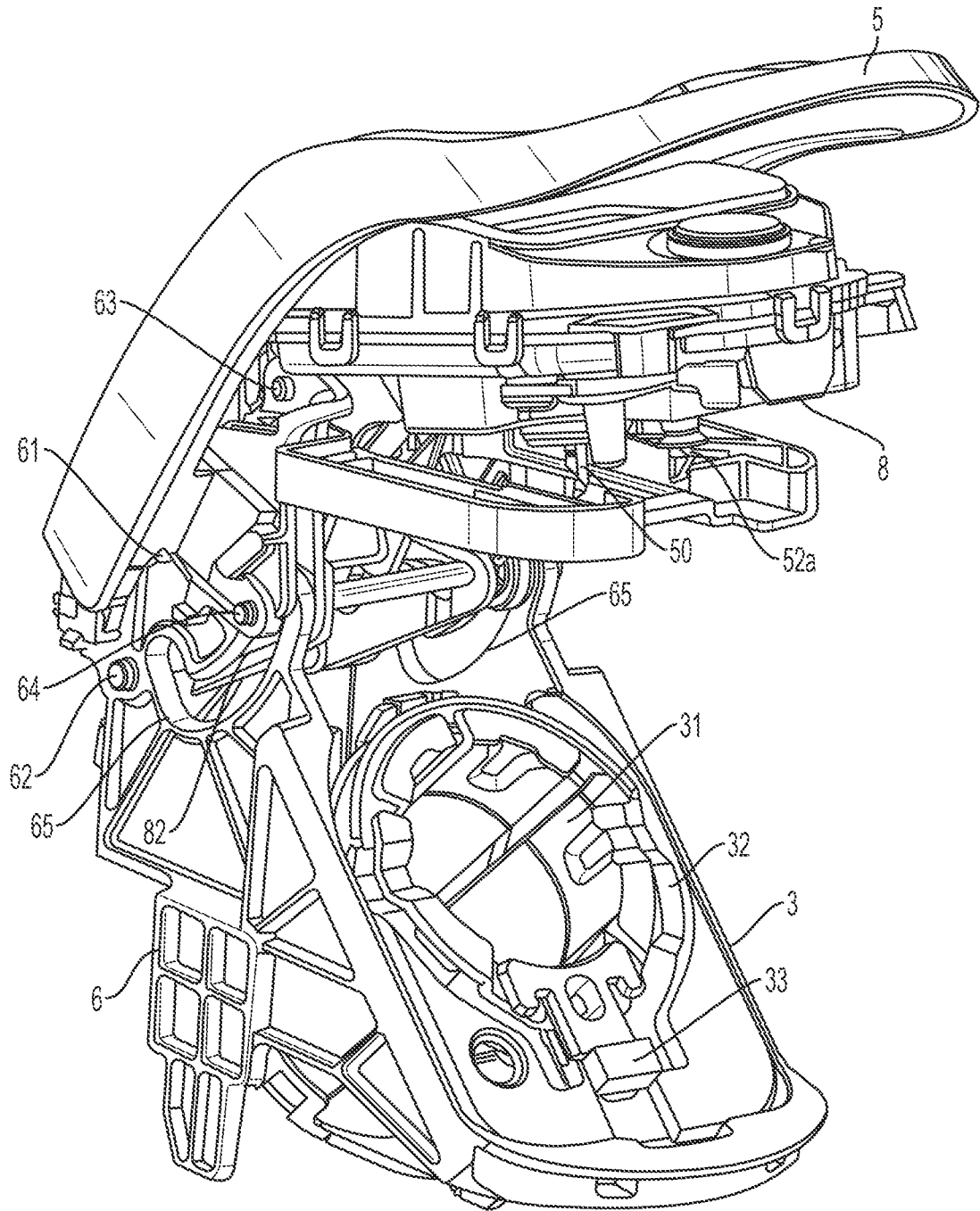

FIG. 16

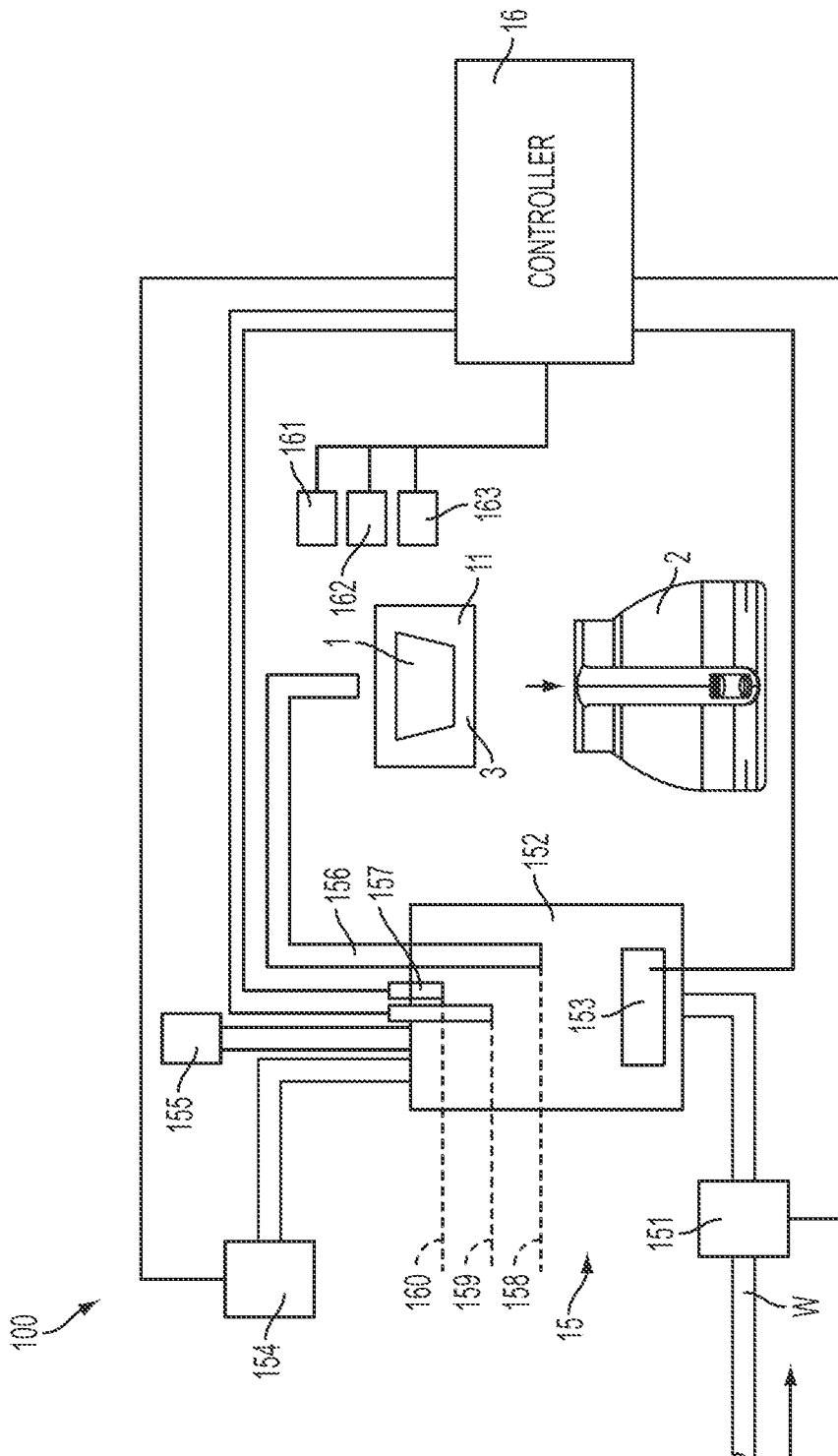

FIG. 17

INTERNATIONAL SEARCH REPORT

International application No
PCT/US2015/011542

A. CLASSIFICATION OF SUBJECT MATTER
INV. A47J31/36 A47J31/06 B65D85/804
ADD.

According to International Patent Classification (IPC) or to both national classification and IPC

B. FIELDS SEARCHED

Minimum documentation searched (classification system followed by classification symbols)
A47J B65D

Documentation searched other than minimum documentation to the extent that such documents are included in the fields searched

Electronic data base consulted during the international search (name of data base and, where practicable, search terms used)

EPO-Internal

C. DOCUMENTS CONSIDERED TO BE RELEVANT

Category*	Citation of document, with indication, where appropriate, of the relevant passages	Relevant to claim No.
X	US 2013/139699 A1 (RIVERA ADRIAN) 6 June 2013 (2013-06-06) paragraph [0202]; figures 39A, 39B, 39C, 40A, 40B, 40C -----	1, 9, 10, 15, 20, 27-29, 34-36, 43, 44, 51, 58-60
X	US 2011/274802 A1 (RIVERA ADRIAN) 10 November 2011 (2011-11-10) paragraphs [0009], [0018]; figures 7, 8 -----	34-36, 43, 44, 51, 58-60



Further documents are listed in the continuation of Box C.



See patent family annex.

* Special categories of cited documents :

"A" document defining the general state of the art which is not considered to be of particular relevance

"E" earlier application or patent but published on or after the international filing date

"L" document which may throw doubts on priority claim(s) or which is cited to establish the publication date of another citation or other special reason (as specified)

"O" document referring to an oral disclosure, use, exhibition or other means

"P" document published prior to the international filing date but later than the priority date claimed

"T" later document published after the international filing date or priority date and not in conflict with the application but cited to understand the principle or theory underlying the invention

"X" document of particular relevance; the claimed invention cannot be considered novel or cannot be considered to involve an inventive step when the document is taken alone

"Y" document of particular relevance; the claimed invention cannot be considered to involve an inventive step when the document is combined with one or more other such documents, such combination being obvious to a person skilled in the art

"&" document member of the same patent family

Date of the actual completion of the international search

25 March 2015

Date of mailing of the international search report

02/04/2015

Name and mailing address of the ISA/

European Patent Office, P.B. 5818 Patentlaan 2
NL - 2280 HV Rijswijk
Tel. (+31-70) 340-2040,
Fax: (+31-70) 340-3016

Authorized officer

Reichhardt, Otto

INTERNATIONAL SEARCH REPORT

Information on patent family members

International application No

PCT/US2015/011542

Patent document cited in search report	Publication date	Patent family member(s)	Publication date
US 2013139699	A1	06-06-2013	NONE

US 2011274802	A1	10-11-2011	NONE
