



(51) International Patent Classification:

A61B 17/70 (2006.01) A61L 27/04 (2006.01)
A61F 2/44 (2006.01) A61L 27/14 (2006.01)

(21) International Application Number:

PCT/US2013/061323

(22) International Filing Date:

24 September 2013 (24.09.2013)

(25) Filing Language:

English

(26) Publication Language:

English

(30) Priority Data:

61/704,800 24 September 2012 (24.09.2012) US
14/034,378 23 September 2013 (23.09.2013) US

(71) Applicant: SPINEFRONTIER, INC. [US/US]; 500 Cummings Center, Suite 3500, Beverly, MA 01915 (US).

(72) Inventors: CHIN, Kingsley; 2617 NE 14th Ave. #113, Wilton Manors, FL 33305 (US). YIN, Lin; 100 Academy Hill Road, Brighton, MA 02135 (US). LORE, Vito; 31 Hawthorne Street, Somerville, MA 02144 (US). IBARRA, Matthew; 20402 Hawaiian Ave, Lakewood, CA 90715

(US). DRNEK, Michael; c/o Spinefrontier, Inc., 500 Cummings Center, Suite 3500, Beverly, MA 01915 (US).

(74) Agent: COLLINS, Aliki, K.; AKC Patents, 215 Grove Street, Newton, MA 02466 (US).

(81) Designated States (unless otherwise indicated, for every kind of national protection available): AE, AG, AL, AM, AO, AT, AU, AZ, BA, BB, BG, BH, BN, BR, BW, BY, BZ, CA, CH, CL, CN, CO, CR, CU, CZ, DE, DK, DM, DO, DZ, EC, EE, EG, ES, FI, GB, GD, GE, GH, GM, GT, HN, HR, HU, ID, IL, IN, IS, JP, KE, KG, KN, KP, KR, KZ, LA, LC, LK, LR, LS, LT, LU, LY, MA, MD, ME, MG, MK, MN, MW, MX, MY, MZ, NA, NG, NI, NO, NZ, OM, PA, PE, PG, PH, PL, PT, QA, RO, RS, RU, RW, SA, SC, SD, SE, SG, SK, SL, SM, ST, SV, SY, TH, TJ, TM, TN, TR, TT, TZ, UA, UG, US, UZ, VC, VN, ZA, ZM, ZW.

(84) Designated States (unless otherwise indicated, for every kind of regional protection available): ARIPO (BW, GH, GM, KE, LR, LS, MW, MZ, NA, RW, SD, SL, SZ, TZ, UG, ZM, ZW), Eurasian (AM, AZ, BY, KG, KZ, RU, TJ, TM), European (AL, AT, BE, BG, CH, CY, CZ, DE, DK,

[Continued on next page]

(54) Title: SYSTEM AND METHOD FOR AN INTERBODY SPINAL FUSION ASSEMBLY

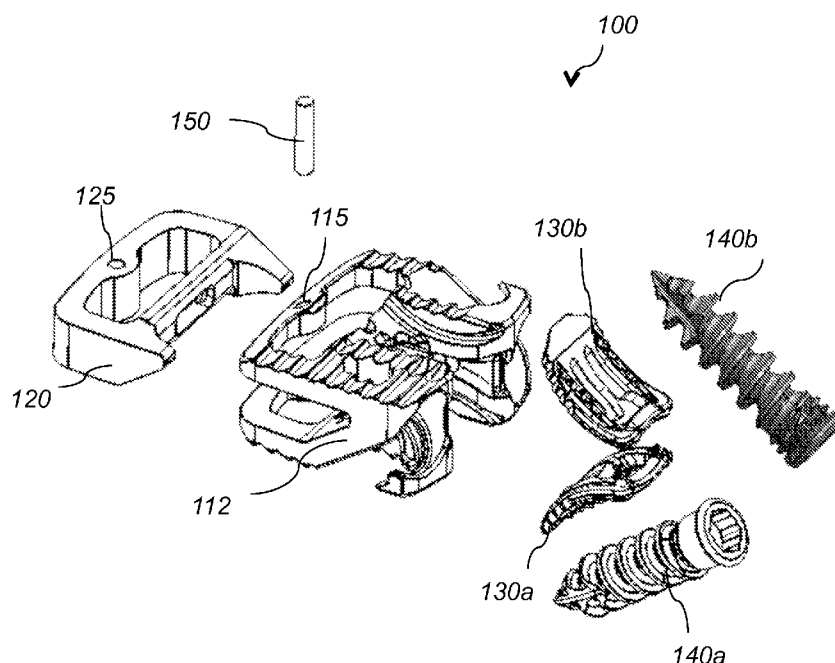

FIG. 3

(57) Abstract: An interbody spinal fusion assembly includes an interbody cage, planar metal pins and bone fasteners. The interbody cage includes a metal cage and a PEEK insert. The PEEK insert is inserted into a slot of the metal cage and is secured to the metal cage with a pin. The assembled interbody cage is inserted in the space between two adjacent vertebrae and is secured in place with the planar metal pins and the bone fasteners.



EE, ES, FI, FR, GB, GR, HR, HU, IE, IS, IT, LT, LU, **Published:**

LV, MC, MK, MT, NL, NO, PL, PT, RO, RS, SE, SI, SK,

SM, TR), OAPI (BF, BJ, CF, CG, CI, CM, GA, GN, GQ,

GW, KM, ML, MR, NE, SN, TD, TG).

— *with international search report (Art. 21(3))*

SYSTEM AND METHOD FOR AN INTERBODY SPINAL FUSION ASSEMBLY

Cross Reference to related Co-Pending Applications

- 5 This application claims the benefit of U.S. provisional application Serial No. 61/704,800 filed September 24, 2012 and entitled “SYSTEM AND METHOD FOR AN INTERBODY SPINAL FUSION ASSEMBLY”, the contents of which are expressly incorporated herein by reference.

10 Field of the Invention

The present invention relates to a system and a method for an interbody spinal fusion assembly, and more particularly to an interbody spinal fusion assembly that includes an interbody cage, planar metal pins and bone engaging fasteners.

15 Background of the Invention

- Fibula strut grafts have a proven history of effectiveness for anterior cervical corpectomies but are inherently vulnerable to complications such as early or late fracture, dislodgement, displacement, telescoping into the vertebral body, or nonunion. The settling and resultant segmental kyphosis after multi-level anterior cervical reconstruction have also been documented. The risk of graft migration, displacement, or fracture appears more likely with more vertebral bodies removed and longer grafts, and with corpectomies involving a fusion ending at the C7 vertebral body. Newer interbody stabilization options have emerged such as polyetherketone (PEEK) which have the advantages of greater endplate coverage leading to a more stable construct and with similar modulus of elasticity as bone. However, PEEK cages tend to move out of position and usually require separate fixation plates. Other options include metal expandable cages but these can be bulky, risk adjacent body fracture, and have limited room for bone graft, and therefore, do not provide the most ideal biologic environment.

30

Summary of the Invention

The present invention relates to an interbody spinal fusion assembly that includes an interbody cage, planar metal pins and bone fasteners. The interbody cage includes a metal cage and a PEEK insert. The PEEK insert is inserted into a slot of the metal

cage and is secured to the metal cage with a pin. The assembled interbody cage is inserted in the space between two adjacent vertebrae and is secured in place with metal planar pins and bone engaging fasteners.

- 5 In general, in one aspect, the invention features, an interbody spinal fusion assembly configured for implantation at least partially between a superior vertebra and an inferior vertebra. The interbody spinal fusion assembly includes an interbody cage that has left and right side surfaces, front and back surfaces and top and bottom surfaces. The interbody cage comprises a metal cage, a plastic insert, and first and
10 second planar metal pins. The metal cage comprises a front slot extending from the front surface towards the center of the interbody cage and the plastic insert is shaped and dimensioned to fit within the front slot. The metal cage further comprises a back slot extending from the back surface towards the center of the interbody cage and the first and second metal pins are shaped and dimensioned to fit and sit within the back
15 slot. The front slot does not intersect with the back slot.

- Implementations of this aspect of the invention may include one or more of the following features. The back slot comprises left and right upwards curved grooves and left and right downwards curved grooves. The first and second planar metal pins
20 comprise left and right sides that are shaped and dimensioned to slide within the left and right upwards curved grooves and the left and right downwards curved grooves, respectively, after the implantation of the interbody cage. The left and right upwards curved grooves do not intersect with the left and right downwards curved grooves. The interbody spinal fusion assembly further includes first and second bone fasteners,
25 and the metal cage further comprises a top through opening extending from the top surface towards the bottom surface and first and second through openings starting in the back surface and extending diagonally towards the top and bottom surfaces, respectively. The first and second through openings are dimensioned to receive the first and second bone fasteners, respectively. The interbody spinal fusion assembly
30 further includes a pin and the position of the plastic insert is secured within the front slot of the metal cage with the pin. The top and bottom surfaces of the interbody cage comprise bone engaging teeth. Each of the first and second planar metal pins comprises an elongated curved body having a trapezoid shaped front end, a rectangular through opening and a central pin. The central pin extends from the front

end of the elongated curved body within the rectangular opening and comprises a distal end projecting in a direction opposite to the curvature of the elongated curved body. The metal cage further comprises top and bottom depressions on the top and bottom surfaces, respectively, and the top and bottom depressions are shaped and dimensioned to engage the distal end of the central pin of the first and second planar metal pins, respectively. The elongated curved body comprises a back portion with smooth left and right sides, a front portion with toothed left and right sides, and teeth along the left and right edges of the top surface. The metal cage comprises one of titanium, stainless steel, biocompatible metal or alloys thereof. The first and second planar metal pins comprise one of titanium, stainless steel, biocompatible metal or alloys thereof. The plastic insert comprises PEEK.

In general, in one aspect, the invention features a method for spinal stabilization including the following. First providing an interbody spinal fusion assembly comprising an interbody cage that includes left and right side surfaces, front and back surfaces and top and bottom surfaces. The interbody cage comprises a metal cage, a plastic insert, and first and second planar metal pins. The metal cage comprises a front slot extending from the front surface towards the center of the interbody cage and the plastic insert is shaped and dimensioned to fit within the front slot. The metal cage further comprises a back slot extending from the back surface towards the center of the interbody cage and the first and second planar metal pins are shaped and dimensioned to fit and sit within the back. The front slot does not intersect with the back slot. Next, inserting and implanting the interbody cage at least partially between a superior vertebra and an inferior vertebra. Next, pushing the first and second planar metal pins from within the back slot towards the front surface of the interbody cage and engaging the vertebral endplates of the superior and inferior vertebrae with the first and second planar metal pins, respectively.

The details of one or more embodiments of the invention are set forth in the accompanying drawings and description below. Other features, objects, and advantages of the invention will be apparent from the following description of the preferred embodiments, the drawings, and the claims

Brief Description of the Drawings

Referring to the figures, wherein like numerals represent like parts throughout the several views:

5 FIG. 1 is a perspective view of an interbody spinal fusion assembly in the “non-engaged position”, according to this invention;

FIG. 2 is a perspective view of the interbody spinal fusion assembly of FIG. 1 in the “engaged position”;

10

FIG. 3 is an exploded view of the interbody spinal fusion assembly of FIG. 2;

FIG. 4A is a top perspective view of the interbody cage of FIG. 3;

15 FIG. 4B is a front perspective view of the interbody cage of FIG. 3;

FIG. 4C is a right side perspective view of the interbody cage of FIG. 3;

FIG. 4D is a left side perspective view of the interbody cage of FIG. 3;

20

FIG. 5A is a perspective view of the planar pins of FIG. 3 in the “non-engaged” position;

FIG. 5B is a perspective view of the planar pins of FIG. 3 in the “engaged” position;

25

FIG. 6 is a perspective view of an inserter tool for the interbody cage of FIG. 3;

FIG. 7A is an exploded view of the inserter tool of FIG. 6;

30 FIG. 7B is a transparent view of the handle of the inserter tool of FIG. 6;

FIG. 8A is a detailed view of the distal portion of the inserter tool of FIG. 6 holding the interbody cage of FIG. 3;

FIG. 8B is a detailed view of the distal portion of the inserter tool of FIG. 6;

FIG. 9A is a perspective view of a pin removal tool having a distal end engaged with the interbody cage of FIG. 3;

5

FIG. 9B is a detailed view of the distal end of the pin removal tool of FIG. 9A;

FIG. 10A is a side view of the pin removal tool;

10 FIG. 10B is a top perspective view of the pin removal tool of FIG. 10A;

FIG. 11A is another embodiment of the planar pins in the 'non-engaged' position;

FIG. 11B depicts the planar pins of FIG. 11A in the 'engaged' position;

15

FIG. 12 is an exploded view of the planar pins of FIG. 11A;

FIG. 13A depicts another embodiment of the interbody spinal fusion assembly and inserted tool, according to this invention;

20

FIG. 13B is a side view of the interbody spinal fusion assembly and inserted tool of FIG. 13A;

FIG. 13C is a top view of the interbody spinal fusion assembly and inserter tool of

25 FIG. 13A;

FIG. 14A is perspective view of the interbody spinal fusion assembly of FIG. 13A engaged with the inserter tool of FIG. 13A ;

30 FIG. 14B is a side view of the distal end of the interbody spinal fusion assembly engaged with the inserter tool of FIG. 13A;

FIG. 15A is perspective view of the interbody spinal fusion assembly of FIG. 13A engaged with the inserter tool of FIG. 13A with the planar pins in the “engaged position;

5 FIG. 15B depicts a side view of assembly of FIG. 15A;

FIG. 15C depicts a top view of the assembly of FIG. 15A;

FIG. 16A depicts another embodiment of the interbody spinal fusion assembly,
10 according to this invention;

FIG. 16B depicts a side view of the interbody spinal fusion assembly of FIG. 16A;

FIG. 16C depicts the embodiment of the interbody spinal fusion assembly of FIG.
15 16A with the planar pins partially engaged;

FIG. 16D depicts the embodiment of the interbody spinal fusion assembly of FIG.
16A with the planar pins fully engaged;

20 FIG. 17A depicts another embodiment of the interbody spinal fusion assembly,
according to this invention;

FIG. 17B depicts a side view of the interbody spinal fusion assembly of FIG. 17A;

25 FIG. 17C depicts the embodiment of the interbody spinal fusion assembly of FIG.
17A with a planar pin partially engaged;

FIG. 17D depicts the embodiment of the interbody spinal fusion assembly of FIG.
17A with a planar pin fully engaged;

30

FIG. 17E depicts a side view of the embodiment of FIG. 17D;

FIG. 18A depicts another embodiment of the interbody spinal fusion assembly,
according to this invention;

FIG. 18B depicts a side view of the interbody spinal fusion assembly of FIG. 18A;

FIG. 18C depicts the embodiment of the interbody spinal fusion assembly of FIG.
5 18A with the flat pins fully engaged;

FIG. 19A depicts an exploded view of another embodiment of the interbody spinal fusion assembly, according to this invention;

10 FIG. 19B depicts a side view of the interbody spinal fusion assembly of FIG. 19A;

FIG. 19C depicts the first step in assembling the interbody spinal fusion assembly of FIG. 19A;

15 FIG. 19D depicts the embodiment of the interbody spinal fusion assembly of FIG. 19A with the planar pins fully engaged;

FIG. 19E depicts the second step in assembling the interbody spinal fusion assembly of FIG. 19A;

20

FIG. 19F depicts the assembled interbody spinal fusion assembly of FIG. 19A;

FIG. 20A depicts an exploded view of another embodiment of the interbody spinal fusion assembly, according to this invention;

25

FIG. 20B depicts the assembled interbody spinal fusion assembly of FIG. 20A;

FIG. 21A depicts an exploded view of another embodiment of the interbody spinal fusion assembly, according to this invention;

30

FIG. 21B depicts the assembled interbody spinal fusion assembly of FIG. 21A;

FIG. 22A depicts an exploded view of another embodiment of the interbody spinal fusion assembly, according to this invention;

FIG. 22B depicts the assembled interbody spinal fusion assembly of FIG. 22A;

FIG. 23A depicts an exploded view of another embodiment of the interbody spinal
5 fusion assembly, according to this invention; and

FIG. 23B depicts the assembled interbody spinal fusion assembly of FIG. 23A.

Detailed Description of the Invention

10 The present invention relates to an interbody spinal fusion assembly that includes an interbody cage, planar metal pins and bone fasteners. The interbody cage is inserted in the space between two adjacent vertebrae and is secured in place with metal planar pins and bone engaging fasteners.

15 Referring to FIG. 1, FIG. 2 and FIG. 3, interbody spinal fusion assembly 100 includes an interbody cage 110, planar pins 130a, 130b and bone engaging fasteners 140a, 140b. Interbody cage 110 includes a metal cage 112 and an insert 120. Insert 120 is made of PEEK or other plastic material and is positioned within a slot 114 formed at the front side 112a of the metal cage 112. Metal cage 112 is made of titanium, steel,
20 or any other biocompatible metal or alloy. Insert 120 is secured to the metal cage 112 with a pin 150 positioned within through opening 115 of the metal cage and through opening 125 of the insert. Referring to FIG. 4A-FIG. 4D, metal cage 112 has a slot opening 114 in the front side 112a, slot opening 118 in the back side 112b, depressions 111 on the top and bottom surfaces, and through openings 117a, 117b
25 starting in the back side 112b and extending diagonally toward the bottom and top surfaces 112f, 112e, respectively. Through openings 117a, 117b are dimensioned to receive the bone engaging fasteners 140a, 140b, respectively. Metal cage 112 also includes a through opening 116 having a rectangular perimeter and extending from the top surface 112e to the bottom surface 112f. There is also a pin receiving opening
30 115, as was mentioned above. Slot opening 114 is shaped and dimensioned to receive insert 120 which has a complementary shape and dimensions. Slot opening 118 is formed in the back side 112b and is shaped and dimensioned to receive the two planar pins 130a, 130b. The left and right inner sides of opening 118 include top and bottom upward and downward curved grooves 119b, 119d and 119a, 119c, respectively. The

left and right inner sides of opening 118 also include central grooves 119e, 119f and openings 119g, 119h, respectively. Planar pins 130a, 130b are curved downwards and upwards, respectively, and their sides are dimensioned to slide within grooves 119a, 119c, and 119b, 119d, respectively. The top and bottom surfaces 112e, 112f of the metal cage 112 have bone engaging teeth 113. Planar pin 130a is made of metal and includes a downward curved body 132a having a rectangular central through opening 133a and a central pin 138a. Central pin 138a extends from the front surface of the planar pin 130a within the central opening 133a and has a distal end that projects in a direction opposite to the curvature of the planar pin 130a and engages the protrusion 111 in the bottom surface of the metal cage 112, when the metal planar pin 130a is in the “engaged position”. The front end 134a is trapezoid shaped with the shortest side being in the front. The side surfaces 135a, 135b are partially smooth in order to facilitate sliding within grooves 119a, 119c. The front portion of side surfaces 135a, 135b includes teeth 136. The edges of the top surface also include teeth 137. Similarly, planar pin 130b is made of metal and includes an upward curved body 132b having a rectangular central through opening 133b and a central pin 138b extending from the front surface within the central opening 133b. Central pin 138b extends from the front surface within the central opening 133b and has a distal end that projects in a direction opposite to the curvature of the planar pin 130b and engages the protrusion 111 in the top surface of the metal cage 112, when the metal planar pin 130b is in the “engaged position”. The front end 134b is trapezoid shaped with the shortest side being in the front. The side surfaces 135a, 135b are partially smooth in order to facilitate sliding within grooves 119b, 119d. The front portion of side surfaces 135a, 135b includes teeth 136. The edges of the top surface also include teeth 137. In the “non-engaged” configuration pins 130a, 130b are parallel to each other and are stored within opening 118 of the metal cage 112, as shown in FIG. 1 and FIG. 5A. In the “engaged” configuration pin 130a is curved downward and pin 130b is curved upward, and their front ends 134a, 134b project out of the metal cage 112, as shown in FIG. 2 and FIG. 5B. The front ends 134a, 134b and the toothed front sides 135a, 135b engage the superior and inferior vertebral endplates, respectively.

In operation, interbody cage 110 including the metal cage 112, the insert 120 and planar pins 130a, 130b is inserted within an intervertebral opening between two adjacent vertebrae. A special inserter 180 is used to insert the interbody cage 110

within the intervertebral opening. Next, the inserter 180 pushes the back of the top and bottom pins 130b, 130a, and moves them upward and downward, respectively. The top and bottom pins 130b, 130a slide forward within grooves 119b, 119d and 119a, 119c, respectively, and engage the top vertebral endplate and the bottom vertebral endplate with their front ends 134b, 134a, and toothed front side surfaces 136b, 136a, respectively. Next, the two bone fasteners 140a, 140b are inserted into the interbody cage openings 117a, 117b, respectively, and they are screwed into the vertebral bodies. Bone fastener 140a is directed diagonally toward the bottom surface of the interbody cage 112 and engages the adjacent bottom vertebral body. Bone fastener 140b is directed diagonally toward the top surface of the interbody cage 112 and engages the adjacent top vertebral body. In summary, the interbody cage 110 is secured in the intervertebral opening with the two bone engaging fasteners 140a, 140b and with the two metal planar pins 130a, 130b. A special removal tool 190 is used to disengage the planar pins 130b, 130a from the vertebral endplates, as will be described below.

Referring to FIG. 6, inserter tool 180 includes a cannula 182, an impactor 184, a stop shaft 183, and a handle 186. Cannula 182 has an elongated body 182c with a central bore opening 182d and a rectangular cross section and terminates in two parallel distal extensions 182a, 182b extending from the distal end of the elongated body 182c. Impactor 184 slides within the cannula bore opening 182d slides impactor 184. Handle 186 surrounds the proximal end of the cannula 182 and is secured to it with a pin 181. Impactor 184 includes an elongated body 184c terminating in two parallel blades 184a, 184b. An impactor cap 185 is attached to the proximal end of the impactor elongated body 184c. Impactor cap 185 is used to push the impactor 184 forward. The cross section of the impactor's elongated body 184c matches the cross section of the cannula bore opening 182d and the two parallel blades 184a, 186b are oriented parallel to the distal extensions 182a, 182b of the cannula 182. Distal extensions 182a, 182b include trapezoid shaped ends 192a, 192b terminating in outward pointing tips 193a, 193b, respectively. Cannula 182 attaches to insert 100 by sliding distal extensions 182a, 182b into central grooves 119e, 119f of the insert 100 and inserting tips 193a, 193b into openings 119 g, 119h, respectively. Once cannula 182 is attached to insert 100, the inserter 180 is used to guide and place the insert 100 in the prepared intervertebral opening between two adjacent vertebrae. After placing

the insert 100 in the intervertebral opening, the impactor cap 185 is pushed forward to move blades 184a, 184b forward and thereby to push planar pins 130a, 130b downward and upward within grooves 119a, 119c and 119b, 119d, respectively. Stop shaft 183 is oriented parallel to the cannula 182 and impactor 184 and includes

5 ratchet grooves 183a at the proximal end and a curved front end 183b at the distal end. The position of the stop shaft 183 is adjusted via the ratchet grooves and is set at a fixed distance 195 from the intervertebral opening. Stop shaft 183 prevents overextending the cannula 182 past the set fixed distance 195. Pins 130a, 130b are moved in the “non-engaged” position by inserting a removal tool 190 into openings

10 133a, 133b, respectively. Removal tool 190 includes an elongated shaft 192 having a handle 192a at the proximal end a hook 192b at the distal end, as shown in FIG. 9A, FIG. 9B, FIG. 10A, FIG. 10B. Hook 192b is shaped and dimensioned to fit within openings 133a, 133b of planar pins 130a, 130b, respectively, and thereby attaches the hook tool to the planar pins. Once the hook tool 190 is attached to the planar pins

15 130a, 130b, it is pull back to move the planar pins 130a, 130b back into the “non engaged position”, as shown in FIG. 9B.

In another embodiment, planar pins 230a, 230b include a center link member 235, as shown in FIG. 11A, FIG. 11B and FIG. 12. In this embodiment, each of the planar

20 pins 230b, 230a, includes an upward or downward curved body 132a having a rectangular central through openings 233a. The front end 234a is trapezoid shaped with the shortest side being in the front. The side surfaces 235a, 235b are partially smooth in order to facilitate sliding within grooves 119a, 119c. The front portion of side surfaces 235a, 235b includes teeth 136. Center link member 235 slides between

25 planar pins 230a, 230b and connects them. Center link member 235 includes a threaded through opening 236 and upward and downward extensions 237a, 237b. Extensions 237a, 237b are inserted into the central openings 233a of the planar pins and thereby engage the planar pins. An inserter tool (not shown) with a threaded distal end is inserted into the threaded opening 236 and is used to move the planar

30 pins 230a, 230b simultaneously forward or backward into the “engaged” or “non-engaged” positions, respectively.

Referring to FIG. 13A, FIG. 13B, FIG. 13C, FIG. 14A, FIG. 14B and FIG. 15A-FIG. 15C, in another embodiment, the intervertebral cage 250 includes a body made of

PEEK and has two slots 252a, 252b extending from the front 250a (proximal side) of the cage toward the center and a central through bore 255 extending from the top surface 250c to the bottom surface 250d of the cage 250. Two planar pins 240a, 240b with downward and upward curved bodies, respectively, are inserted into the slots 252a, 252b, with a helical inserter 245. Helical inserter 245 includes an elongated shaft 246 and a threaded conical distal end 245a. Each of the planar pins 240a, 240b includes a center slot 242 with inner teeth 243. As the helical inserter 245 is rotated, the threaded conical distal end 245a contacts the inner teeth 243 of the corresponding planar pins 240a, 240b and thereby engages them distally and moves them simultaneously forward into the corresponding slots 252a, 252b of the cage 250.

Referring to FIG. 16A, FIG. 16B, FIG. 16C, FIG. 16D, in another embodiment, the intervertebral cage 260 includes a body made of PEEK and has a slot 262, extending from the front 260a (proximal side) of the cage toward the center and a central through bore 265 extending from the top surface 260c to the bottom surface 260d of the cage 260. Two planar pins 270a, 270b with downward and upward curved bodies, respectively, are inserted into slots 262 with an inserter. Each of the planar pins 270a, 270b includes a rectangular opening 273a, 273b and they are connected to each other via a center link member 275 that slides within the openings 273a, 273b. Center link member 275 has a C-shaped body 276 and upward and downward extending extensions 276a, 276b, respectively. Extensions 276a, 276b fit within cutouts 262a, 262b formed in bottom and top surfaces 260 d, 260c of the cage in the front 260a of the slot 262, and function as stops for the center link member 275 within the slot 262. The planar pins are held together with the center link member 275 and are inserted into the slot 262 simultaneously via impaction.

Referring to FIG. 17A, FIG. 17B, FIG. 17C, FIG. 17D, and 17E, in another embodiment, the intervertebral cage 280 includes a body made of PEEK and a vertical structure 285 recessed in a slot 283 having an opening 283a on the top surface 280a and an opening 283b in the front surface 280b. Vertical structure 285 has teeth 284 on the top surface and an inclined front surface 285a. A planar pin 282 is inserted into slot 283 through the front opening 283b. The front surface 282a of planar pin 282 is also inclined and it complements the inclined front surface 285a of vertical structure 285. Inserting of the pin 282 into slot 283 matches the two inclined

surfaces 282a and 285a and raises the recessed vertical structure 285 up through the top opening 283a of the slot 283 and exposes the teeth 284. The exposed teeth 284 engage the vertebral endplate and secure the cage 280 in the intervertebral space. Intervertebral cage 280 also includes a central opening 281.

5

Referring to FIG. 18A, FIG. 18B, FIG. 18C, in another embodiment, the intervertebral cage 290 includes a body made of PEEK and has two intersecting front slots 292a, 292b, extending from the front 290a (proximal side) of the cage toward the center and a central through bore 295 extending from the top surface 290c to the bottom surface 290d of the cage 290. Two flat pins 296, 297 are inserted into slots 292a, 292b and they intersect each other as they pass through the central through bore 295. Flat pin 296 includes two rectangular shaped protrusions 296a, 296b connected at the proximal end by a cross bar 296c and separated by a rectangular opening 296b. Flat pin 297 includes a T shaped body having a rectangular shaped protrusion 297a and a cross-bar 297b attached to the proximal end of protrusion 297a. The distal ends of protrusions 296a, 296b, and 297a are pointed and engage the top and bottom vertebral endplates to secure the cage 290 in the intervertebral space.

10

15

20

25

30

Referring to FIG.19A-FIG.19F, in another embodiment, an intervertebral insert assembly 300 includes a two component cage body 320, two connected planar pins 345a, 345b and plate 310. Cage 320 includes a front component 330 made of PEEK and a back component 340 made of metal. The two components 330, 340 are held together with pins 342a, 342b, 331a, 331b and they form a rectangular shaped body having a central opening 344. The front surface of the front component 330 includes a slot 332, through which planar pins 345a, 345b are inserted. After inserting the assembled cage body 320 in the intervertebral space, the two connected planar pins 345a, 345b are compressed and are inserted into slot 332. When the planar pins 345a, 345b reach the central opening 344, they are released and their distal ends expand upward and downward, respectively, and they engage the top and bottom vertebral plates, respectively. Next, plate 310 is placed in front of the inserted cage 320 and vertebral bodies and is attached to the front surface of the cage 320 and the front surfaces of the vertebral bodies with four bone fasteners 312. Plate 310 includes four through opening dimensioned to receive the four bone fasteners 312.

Referring to FIG. 20A and FIG. 20B, in another embodiment, the intervertebral insert assembly 400 includes a cage body 420, two planar pins 445a, 445b and plate 410. In this embodiment, plate 410 includes two openings 411a, 411b dimensioned to received bone fasteners 412a, 412b. After inserting the cage body 420 in the intervertebral space, the connected planar pins 445a, 445b are compressed and are inserted into slots 432a, 432b of body 420. When the planar pins 445a, 445b reach the central opening 444, they are released and their distal ends expand upward and downward, respectively, and they engage the top and bottom vertebral plates, respectively. Plate 410 is then attached to the front surface of the cage 420 with two bone fasteners 412a, 412b.

Referring to FIG. 21A and FIG. 21B, in another embodiment, the intervertebral insert assembly 400 includes a cage body 420, two planar pins 445a, 445b and plate 410. In this embodiment, plate 410 and planar pins 445a, 445b are connected and form one assembly. The main body of plate 410 is made of plastic 410b wrapped with a metal covering 410a. Pins 445a, 445b are made of metal and are part of the metal covering 410a of plate 410. After inserting the cage body 420 in the intervertebral space, the connected planar pins 445a, 445b are compressed and are inserted into slots 432a, 432b of body 420. When the planar pins 445a, 445b reach the central opening 444, they are released and their distal ends expand upward and downward, respectively, and they engage the top and bottom vertebral plates, respectively. Plate 410 is then attached to the front surface of the cage 420 with two bone fasteners 412a, 412b. In yet another embodiment, planar pins 445a, 445b are part of metal plate 410 and extend directly from plate 410, as shown in FIG. 22a and FIG. 22B.

Referring to FIG. 23A and FIG. 23B, in another embodiment, the intervertebral insert assembly 500 includes a cage body 520, and front component including a solid plate 510 and two planar pins 545a, 545b extending from and plate 410. The interbody cage 520 is made of PEEK and includes two front holes 522a, 522b configured to receive bone anchors 512a, 512b, and two recessed front slots 532a, 532b configured to receive planar pins 545a, 545b. The two recessed slot openings 532a, 532b are shaped and dimensioned to receive the compressed planar pins 545a, 545b. One of the two recessed slots is directed upward 532a and the other downward 532b. In this case, the interbody cage 520 is inserted into the intervertebral space and is secured with the

anchors 512a, 512b. Next, the planar pins 545a, 545b are compressed and are inserted into slots 532a, 532b of body 520. When the planar pins 545a, 545b reach the central opening 544, they are released and their distal ends expand upward and downward, respectively, and they engage the top and bottom vertebral plates, respectively. Plate 510 is positioned in front of the bone anchors 512a, 512b and acts as an anti-backout feature for the bone anchors.

Several embodiments of the present invention have been described. Nevertheless, it will be understood that various modifications may be made without departing from the spirit and scope of the invention. Accordingly, other embodiments are within the scope of the following claims.

What is claimed is:

15

20

25

1. An interbody spinal fusion assembly configured for implantation at least partially between a superior vertebra and an inferior vertebra comprising:

an interbody cage comprising left and right side surfaces, front and back surfaces and top and bottom surfaces;

5 wherein the interbody cage comprises a metal cage, a plastic insert, and first and second planar metal pins;

wherein the metal cage comprises a front slot extending from the front surface towards the center of the interbody cage and wherein the plastic insert is shaped and dimensioned to fit within the front slot;

10 wherein the metal cage further comprises a back slot extending from the back surface towards the center of the interbody cage and wherein the first and second metal pins are shaped and dimensioned to fit and sit within the back slot; and

wherein the front slot does not intersect with the back slot.

15 2. The interbody spinal fusion assembly of claim 1, wherein the back slot comprises left and right upwards curved grooves and left and right downwards curved grooves and wherein the first and second planar metal pins comprise left and right sides that are shaped and dimensioned to slide within the left and right upwards curved grooves and the left and right downwards curved grooves, respectively, after
20 the implantation of the interbody cage, and wherein the left and right upwards curved grooves do not intersect with the left and right downwards curved grooves.

3. The interbody spinal fusion assembly of claim 1, further comprising first and second bone fasteners, and wherein the metal cage further comprises a top through
25 opening extending from the top surface towards the bottom surface and first and second through openings starting in the back surface and extending diagonally towards the top and bottom surfaces, respectively, wherein the first and second through opening are dimensioned to receive the first and second bone fasteners, respectively.

30

4. The interbody spinal fusion assembly of claim 1, further comprising a pin and wherein the position of the plastic insert is secured within the front slot of the metal cage with the pin.

5. The interbody spinal fusion assembly of claim 1 wherein the top and bottom surfaces of the interbody cage comprise bone engaging teeth.

6. The interbody spinal fusion assembly of claim 1, wherein each of the first and second planar metal pins comprises an elongated curved body having a trapezoid shaped front end, a rectangular through opening and a central pin, and wherein the central pin extends from the front end of the elongated curved body within the rectangular opening and comprises a distal end projecting in a direction opposite to the curvature of the elongated curved body.

10

7. The interbody spinal fusion assembly of claim 6 wherein the metal cage further comprises top and bottom depressions on the top and bottom surfaces, respectively, and wherein the top and bottom depressions are shaped and dimensioned to engage the distal end of the central pin of the first and second planar metal pins, respectively.

15

8. The interbody spinal fusion assembly of claim 6, wherein the elongated curved body comprises a back portion with smooth left and right sides, a front portion with toothed left and right sides, and teeth along the left and right edges of the top surface.

20

9. The interbody spinal fusion assembly of claim 1, wherein the metal cage comprises one of titanium, stainless steel, biocompatible metal or alloys thereof.

10. The interbody spinal fusion assembly of claim 1, wherein the first and second planar metal pins comprise one of titanium, stainless steel, biocompatible metal or alloys thereof.

25

11. The interbody spinal fusion assembly of claim 1, wherein the plastic insert comprises PEEK.

30

12. A method for spinal stabilization comprising:

providing an interbody spinal fusion assembly comprising an interbody cage, wherein the interbody cage comprises left and right side surfaces, front and back surfaces and top and bottom surfaces;

5 wherein the interbody cage comprises a metal cage, a plastic insert, and first and second planar metal pins;

wherein the metal cage comprises a front slot extending from the front surface towards the center of the interbody cage and wherein the plastic insert is shaped and dimensioned to fit within the front slot;

10 wherein the metal cage further comprises a back slot extending from the back surface towards the center of the interbody cage and wherein the first and second planar metal pins are shaped and dimensioned to fit and sit within the back;

wherein the front slot does not intersect with the back slot;

inserting and implanting the interbody cage at least partially between a superior vertebra and an inferior vertebra; and

15 pushing the first and second planar metal pins from within the back slot towards the front surface of the interbody cage and engaging the vertebral endplates of the superior and inferior vertebrae with the first and second planar metal pins, respectively.

20 13. The method of claim 12, wherein the back slot comprises left and right upwards curved grooves and left and right downwards curved grooves and wherein the first and second planar metal pins comprise left and right sides that are shaped and dimensioned to slide within the left and right upwards curved grooves and the left and right downwards curved grooves, respectively, and wherein the left and right upwards
25 curved grooves do not intersect with the left and right downwards curved grooves.

14. The method of claim 12, wherein the interbody spinal fusion assembly further comprises first and second bone fasteners, and wherein the metal cage further comprises a top through opening extending from the top surface towards the bottom
30 surface and first and second through openings starting in the back surface and extending diagonally towards the top and bottom surfaces, respectively, wherein the first and second through opening are dimensioned to receive the first and second bone fasteners, respectively; and

wherein the method further comprises inserting and screwing the first and second bone fasteners into the vertebral endplates of the superior and inferior vertebrae, respectively.

5 15. The method of claim 12, wherein the interbody spinal fusion assembly further comprises a pin and wherein the position of the plastic insert is secured within the front slot of the metal cage with the pin.

10 16. The method of claim 12, wherein the top and bottom surfaces of the interbody cage comprise bone engaging teeth.

17. The method of claim 12, wherein each of the first and second planar metal pins comprises an elongated curved body having a trapezoid shaped front end, a rectangular through opening and a central pin, and wherein the central pin extends
15 from the front end of the elongated curved body within the rectangular opening and comprises a distal end projecting in a direction opposite to the curvature of the elongated curved body.

18. The method of claim 17, wherein the metal cage further comprises top and
20 bottom depressions on the top and bottom surfaces, respectively, and wherein the top and bottom depressions are shaped and dimensioned to engage the distal end of the central pin of the first and second planar metal pins, respectively.

19. The method of claim 17, wherein the elongated curved body comprises a back
25 portion with smooth left and right sides, a front portion with toothed left and right sides, and teeth along the left and right edges of the top surface.

20. The method of claim 12, wherein the metal cage comprises one of titanium, stainless steel, biocompatible metal or alloys thereof.

30

21. The method of claim 12, wherein the first and second planar metal pins comprise one of titanium, stainless steel, biocompatible metal or alloys thereof.

22. The method of claim 12, wherein the plastic insert comprises PEEK.

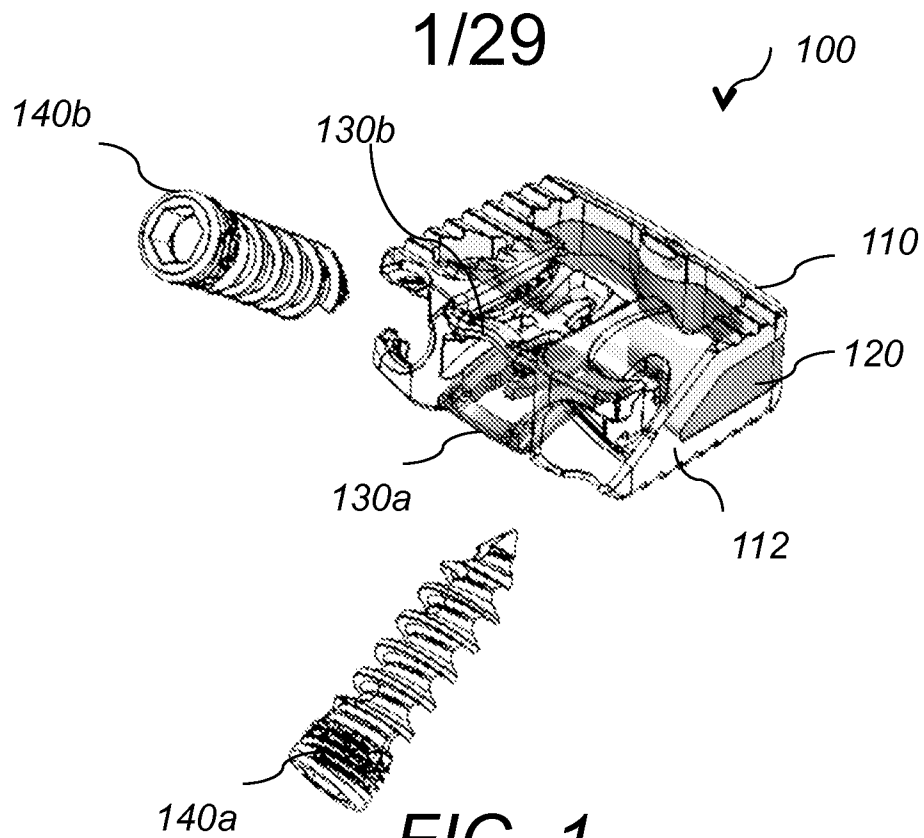

FIG. 1

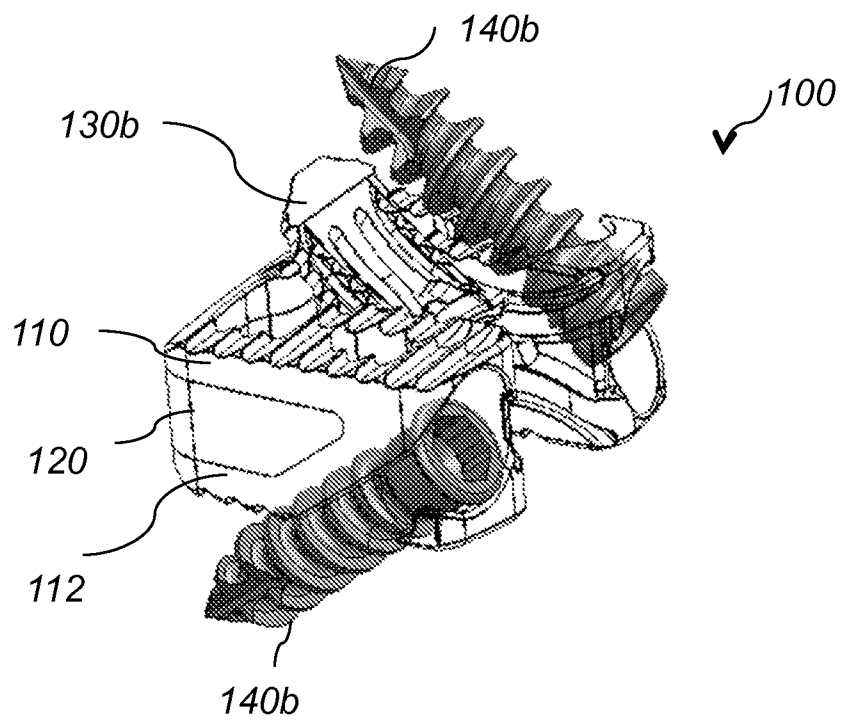

FIG. 2

2/29

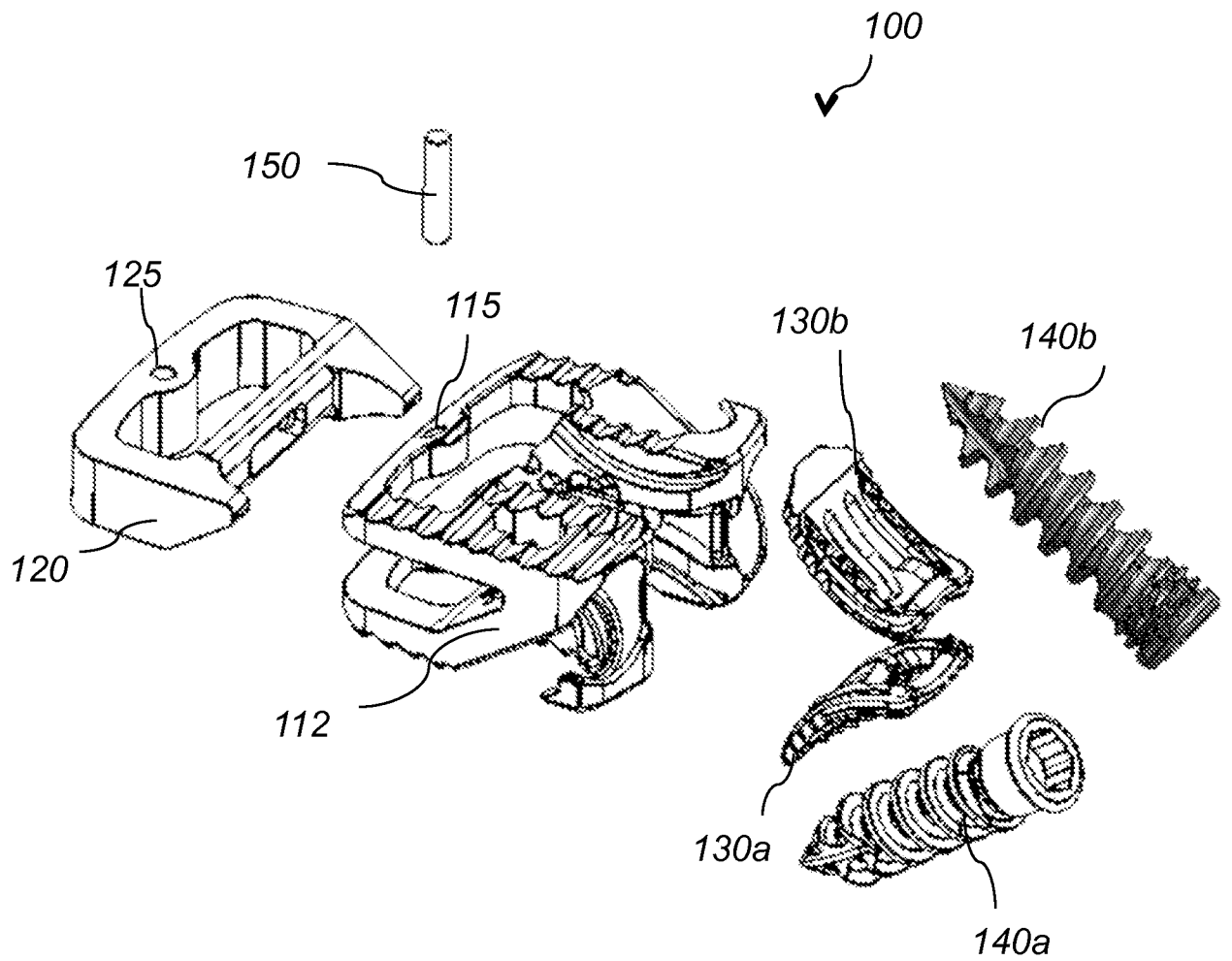

FIG. 3

3/29

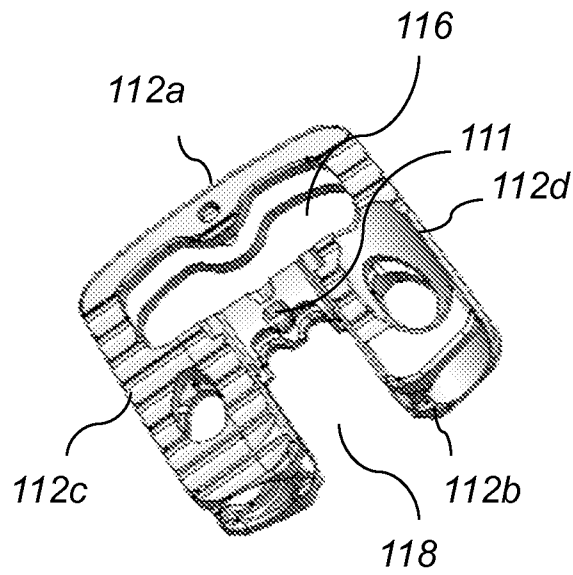

FIG. 4A

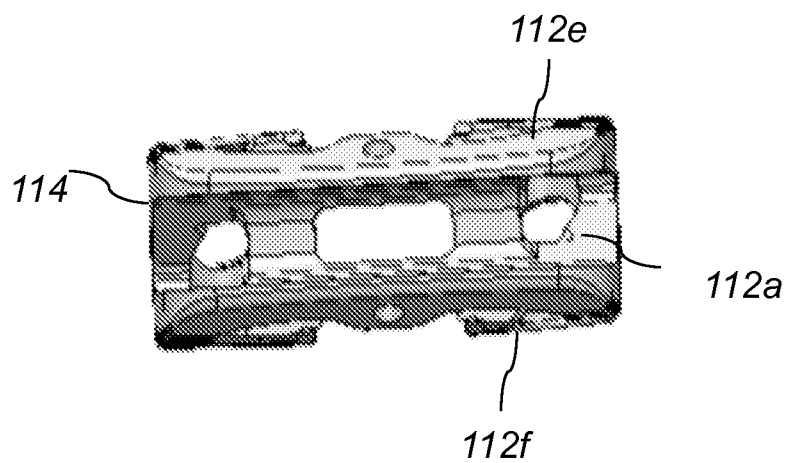

FIG. 4B

4/29

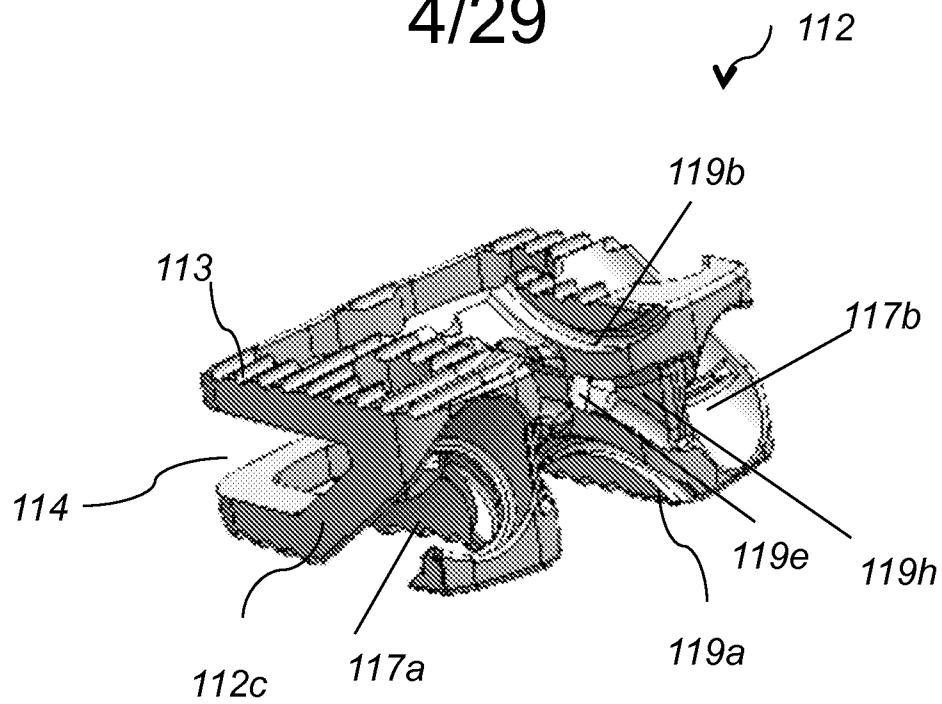

FIG. 4C

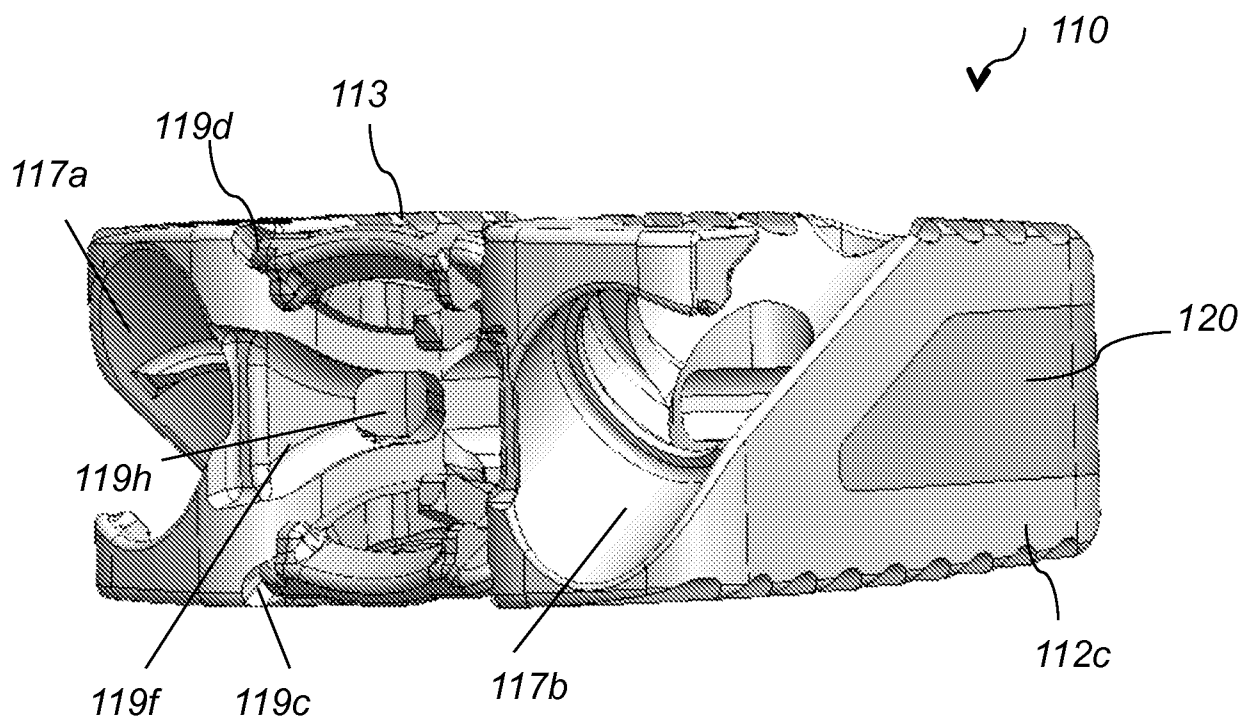

FIG. 4D

5/29

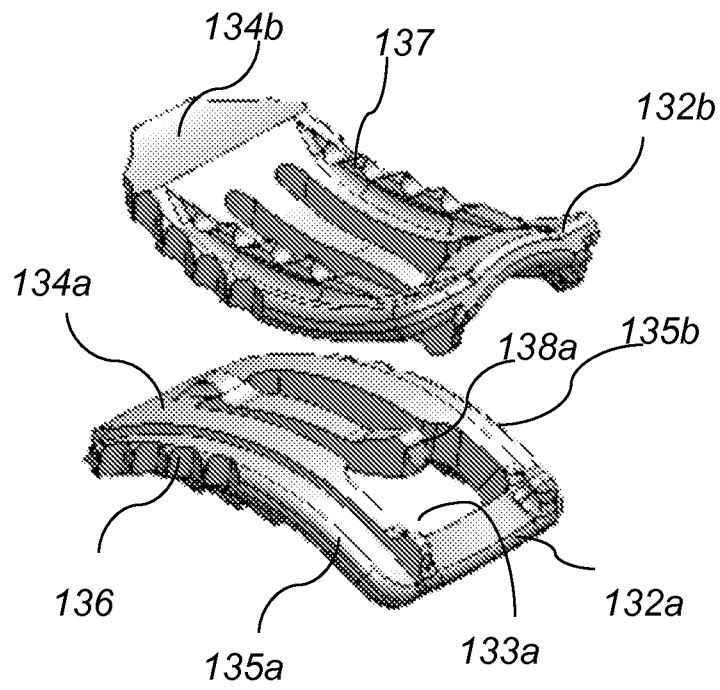

FIG. 5A

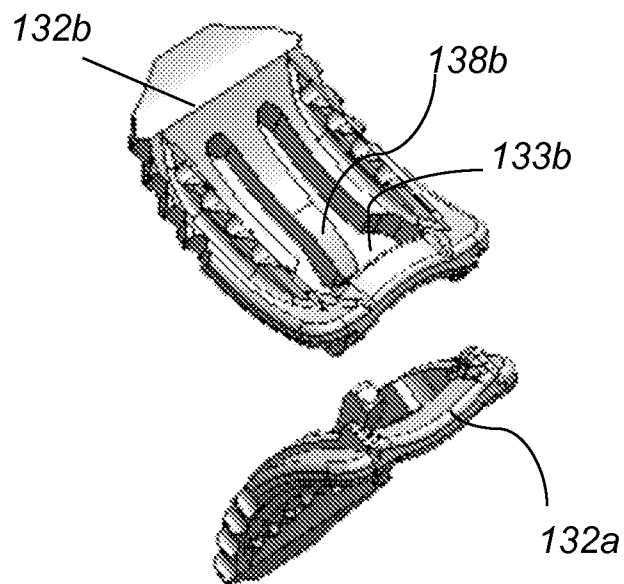

FIG. 5B

6/29

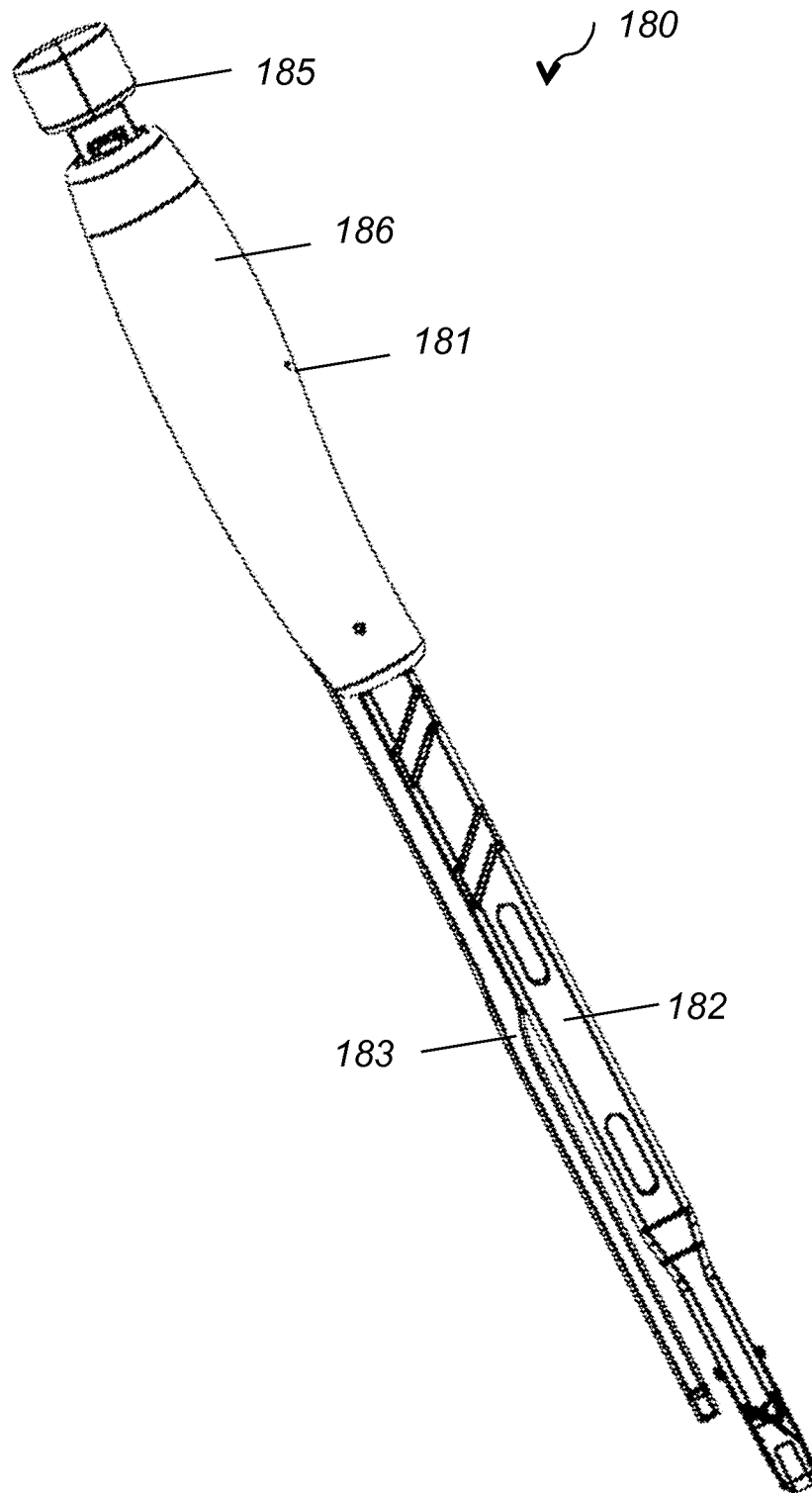

FIG. 6

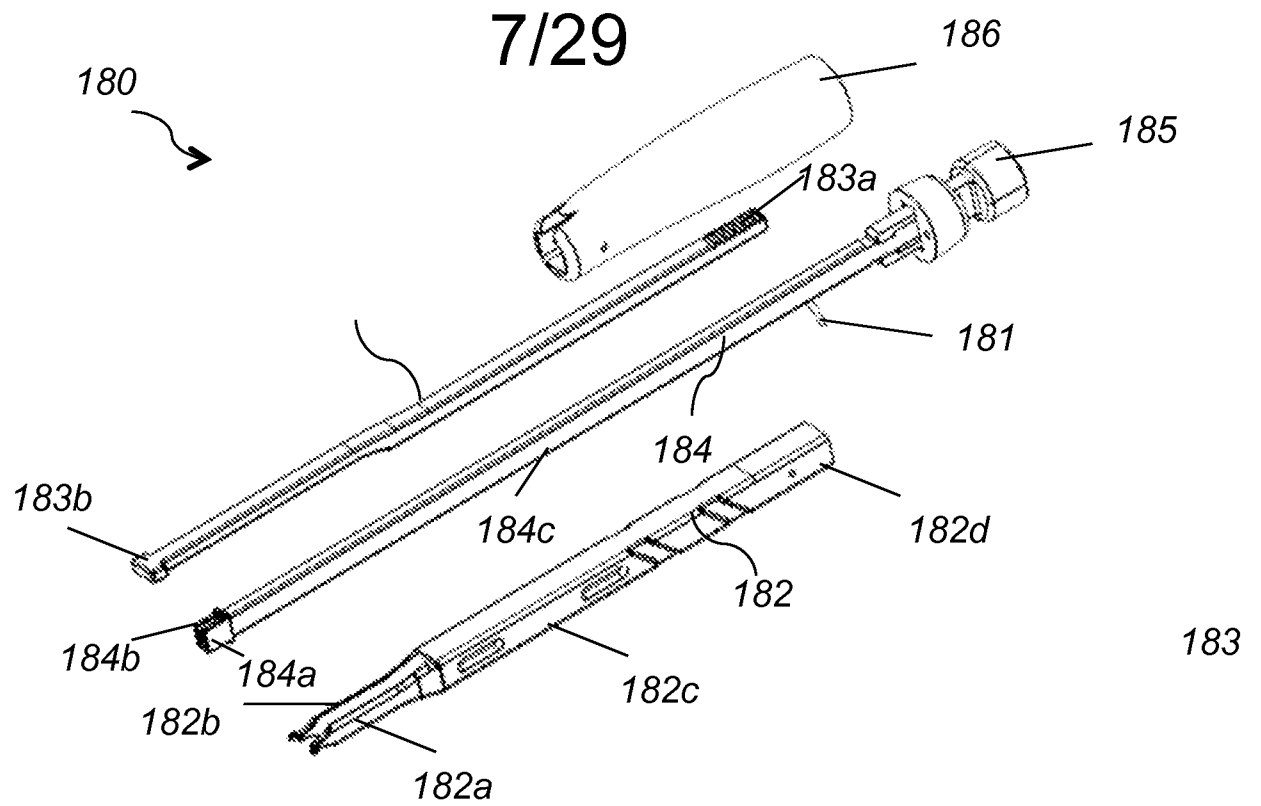

FIG. 7A

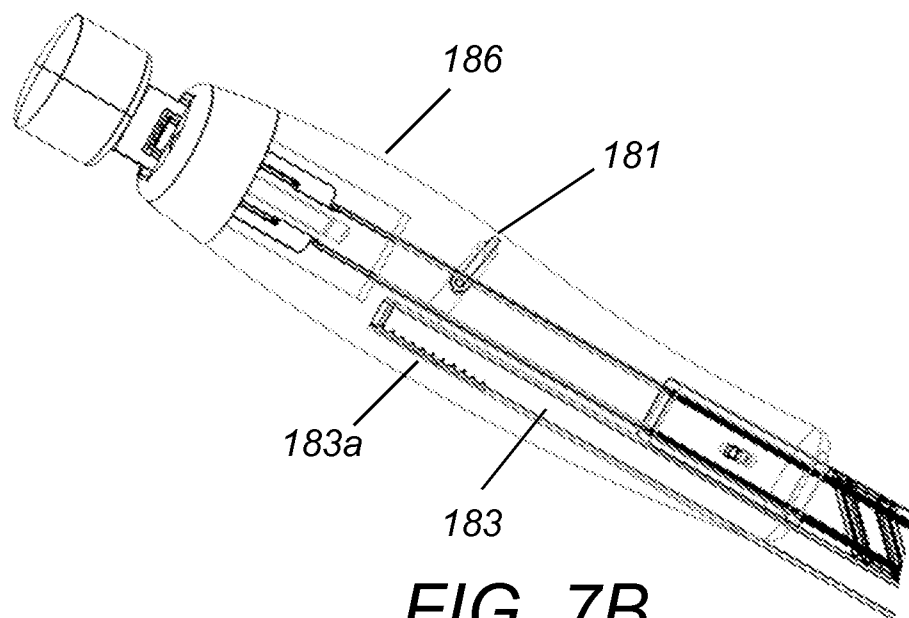

FIG. 7B

8/29

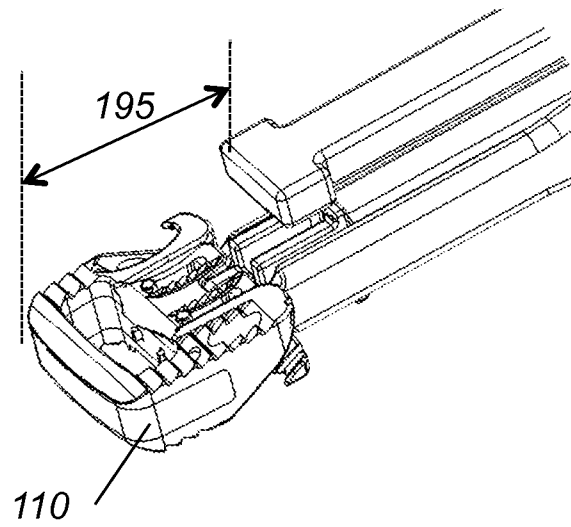

FIG. 8A

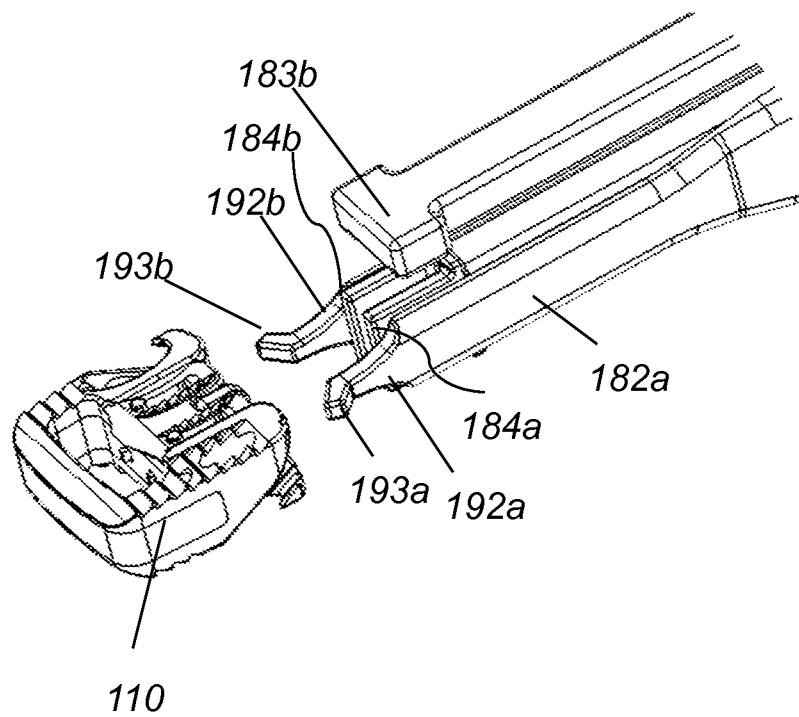

FIG. 8B

9/29

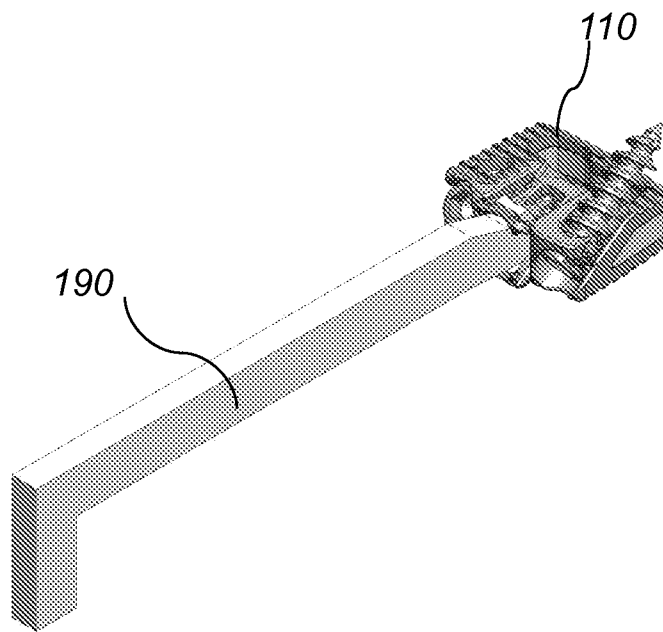

FIG. 9A

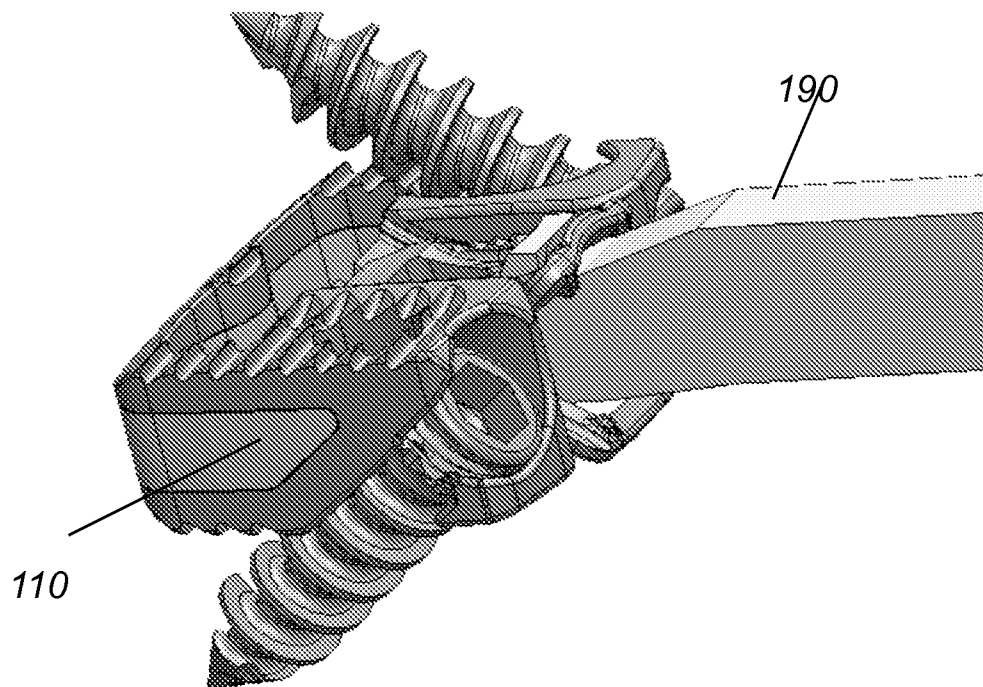

FIG. 9B

10/29

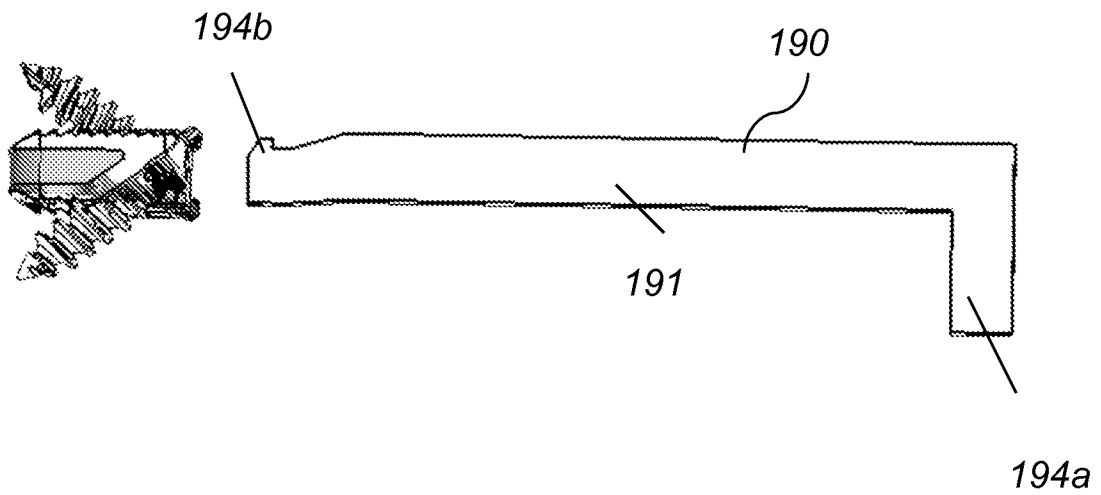

FIG. 10A

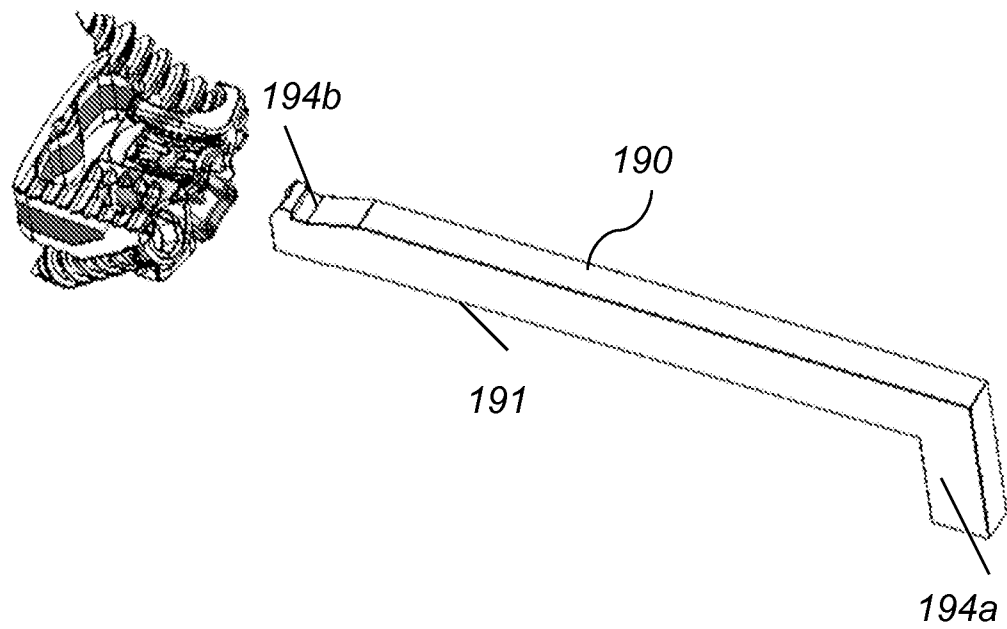

FIG. 10B

11/29

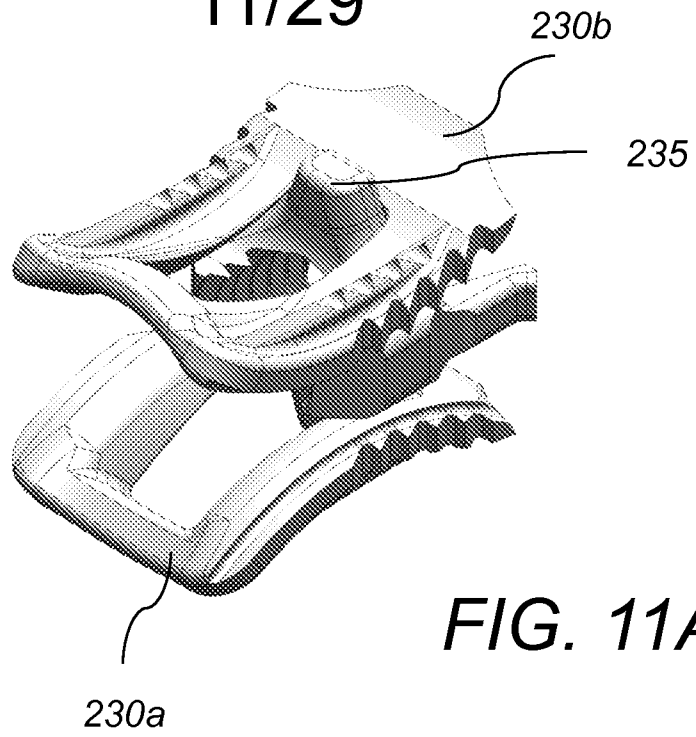

FIG. 11A

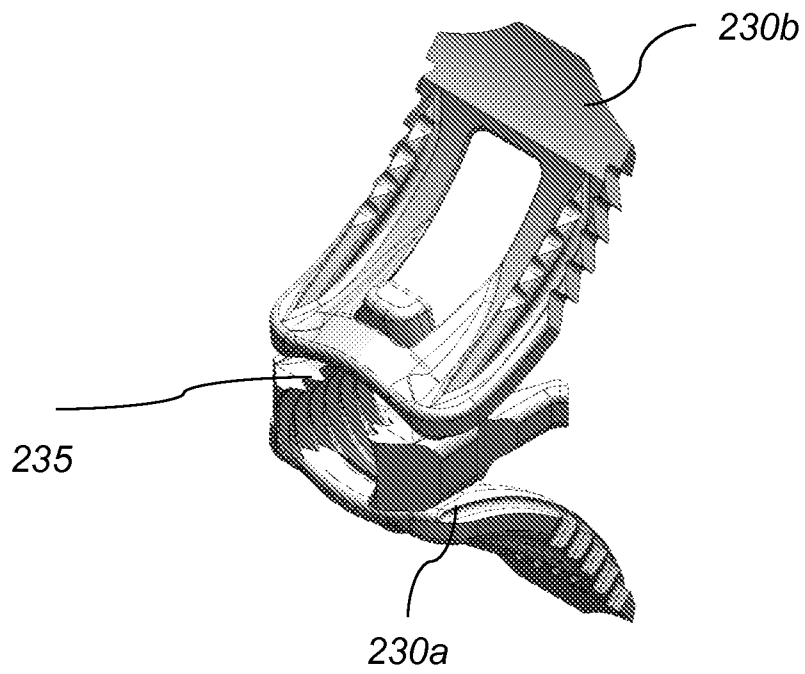

FIG. 11B

12/29

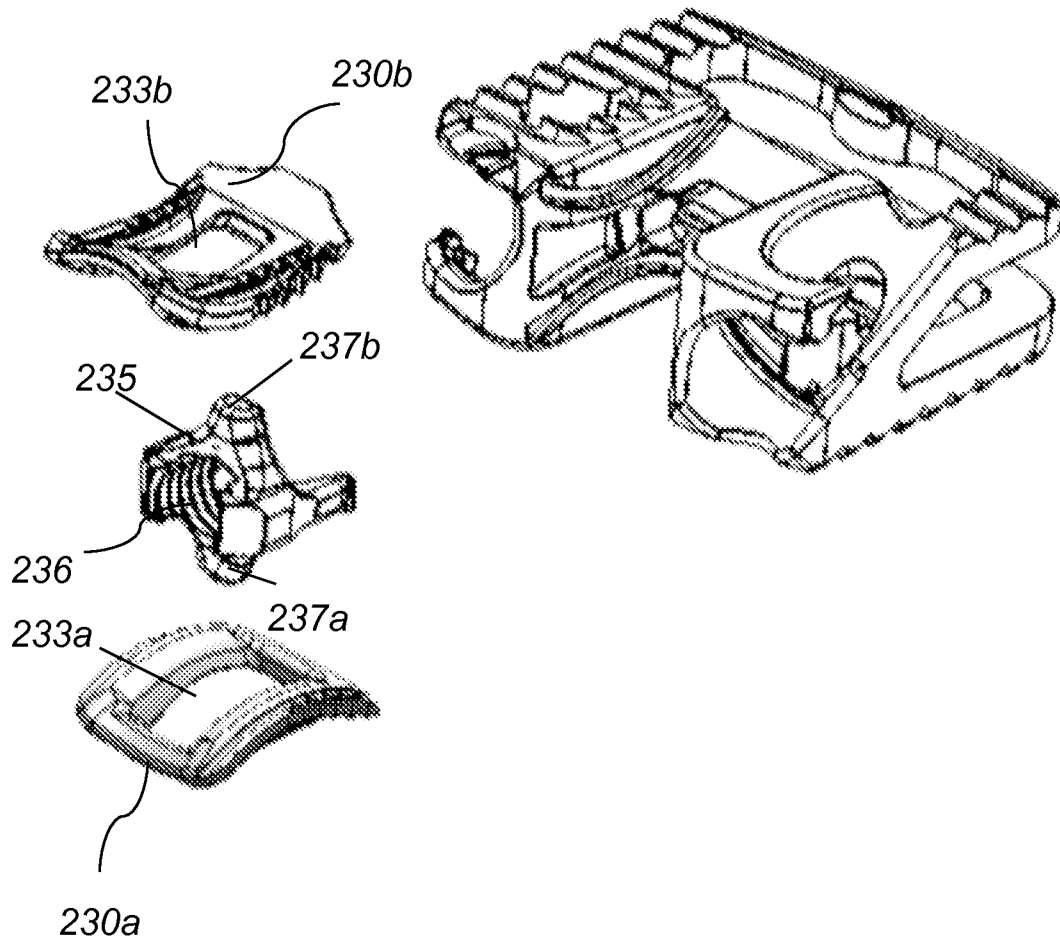
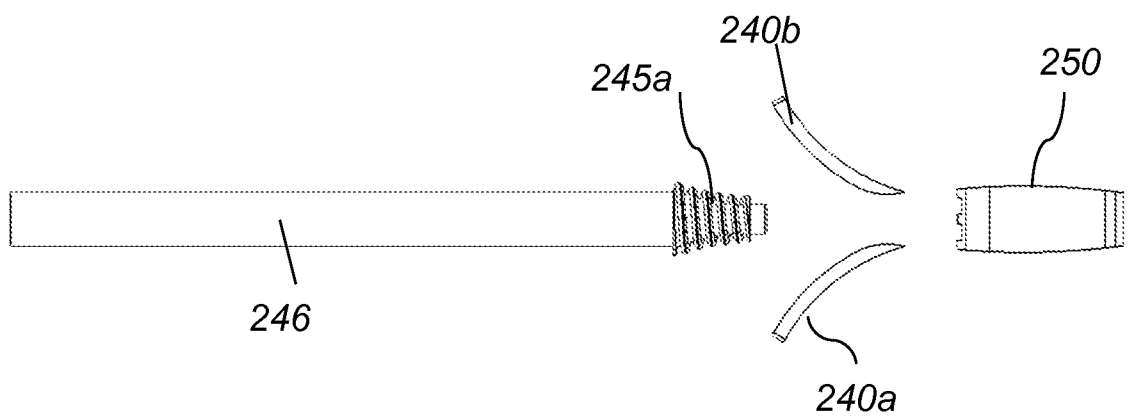
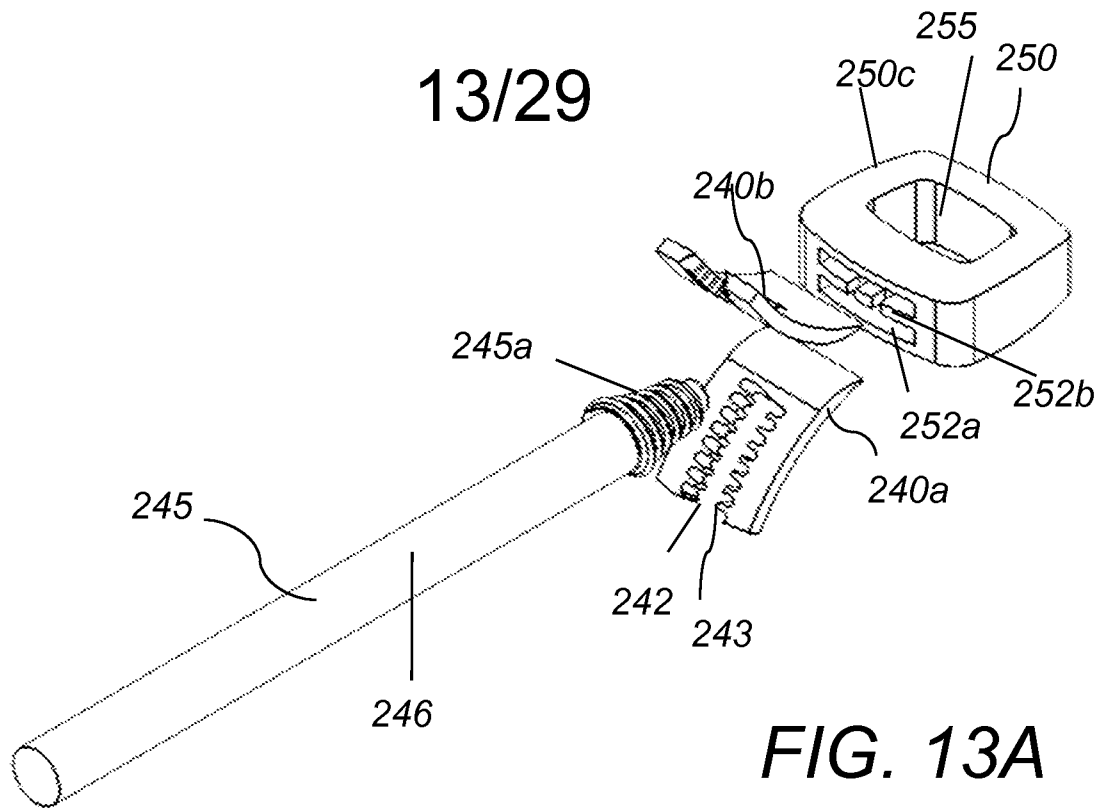

FIG. 12



14/29

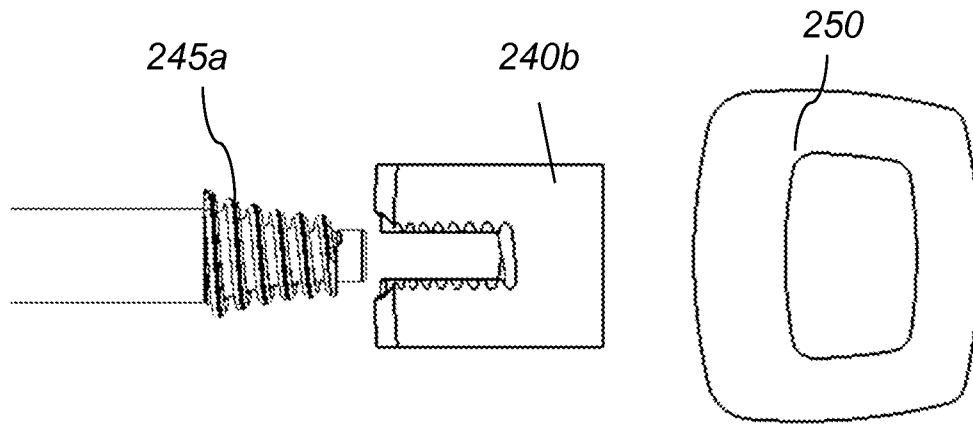

FIG. 13C

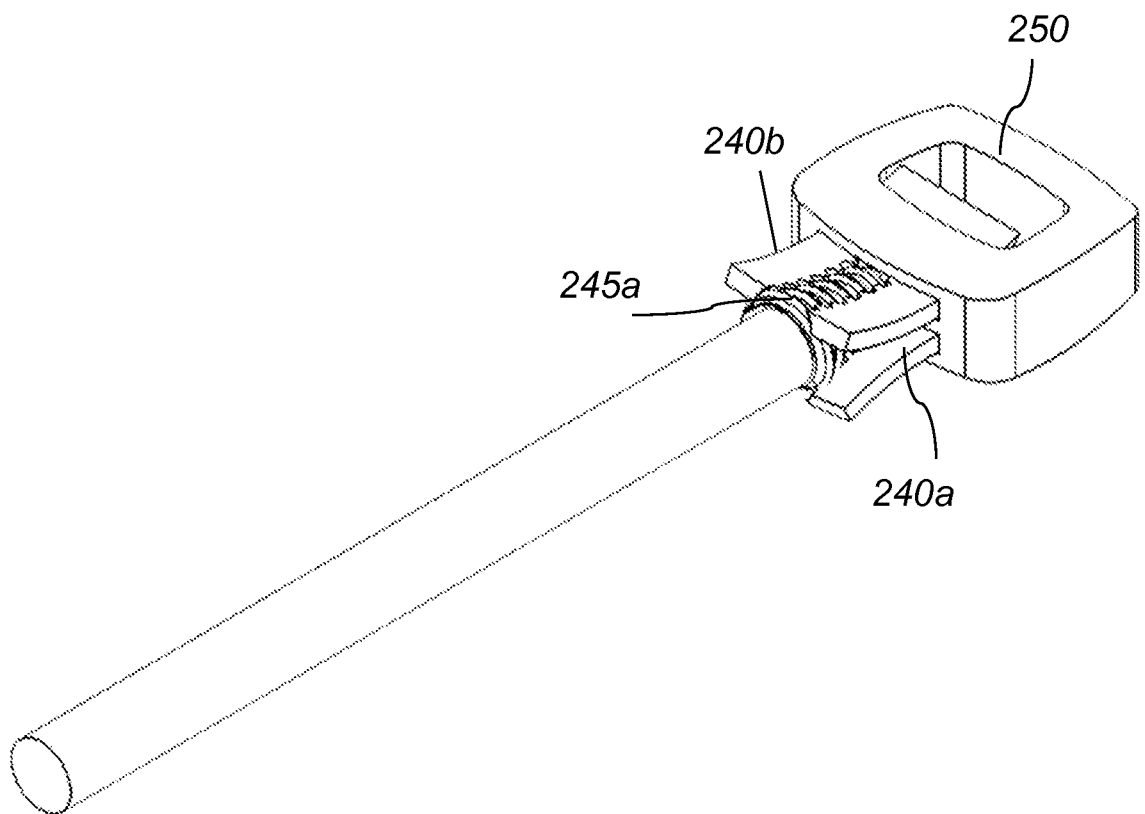

FIG. 14A

15/29

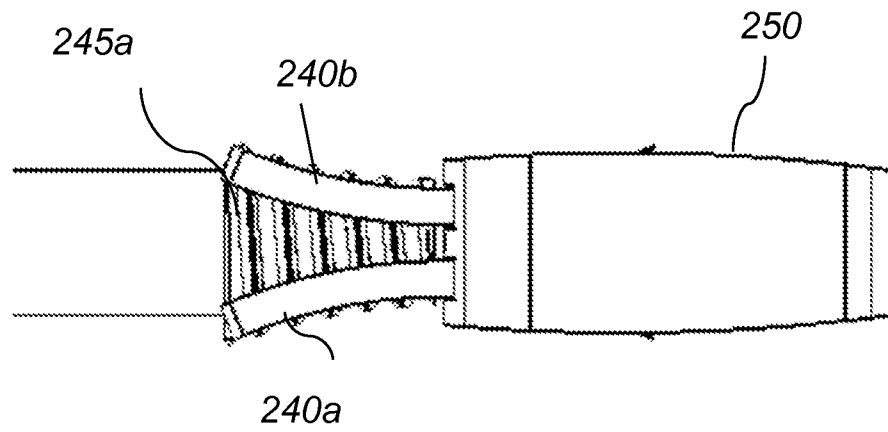

FIG. 14B

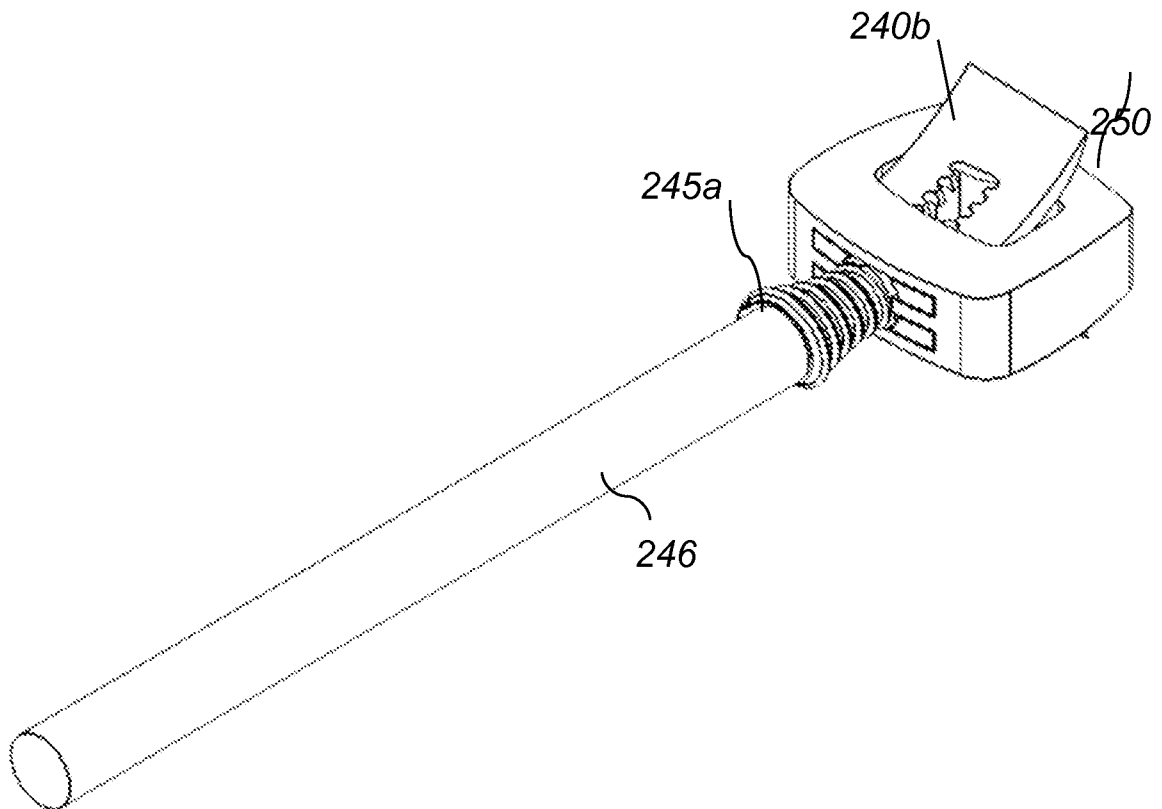

FIG. 15A

16/29

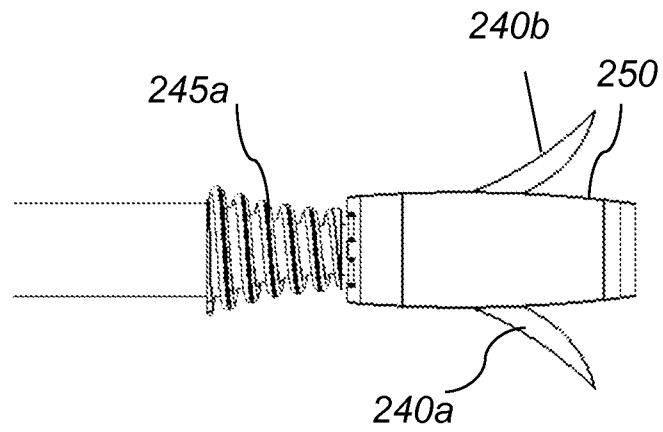

FIG. 15B

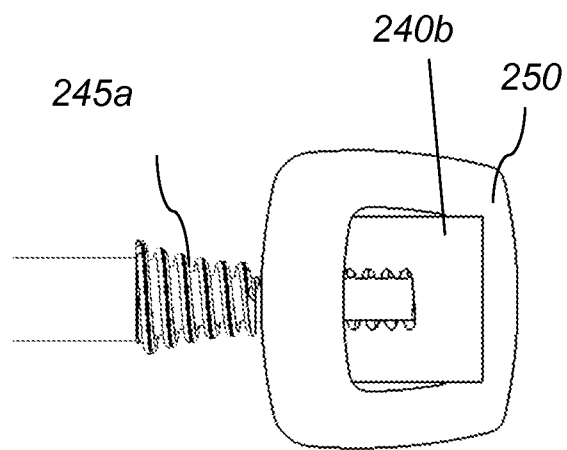

FIG. 15C

17/29

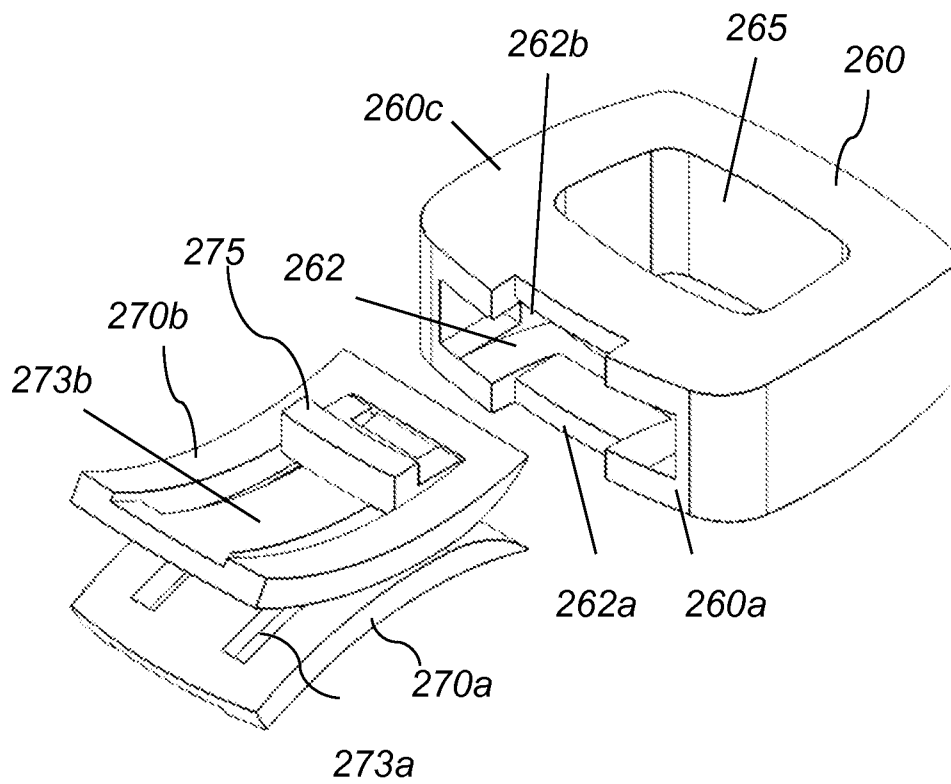

FIG. 16A

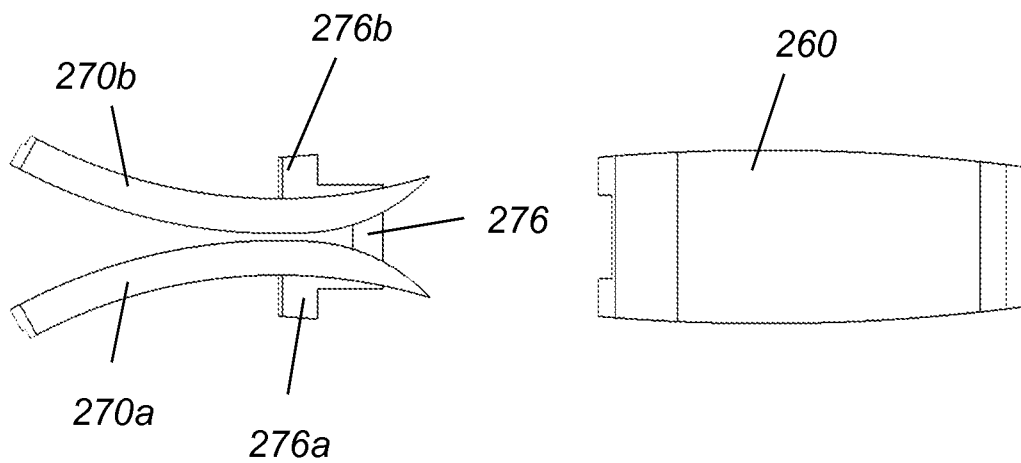

FIG. 16B

18/29

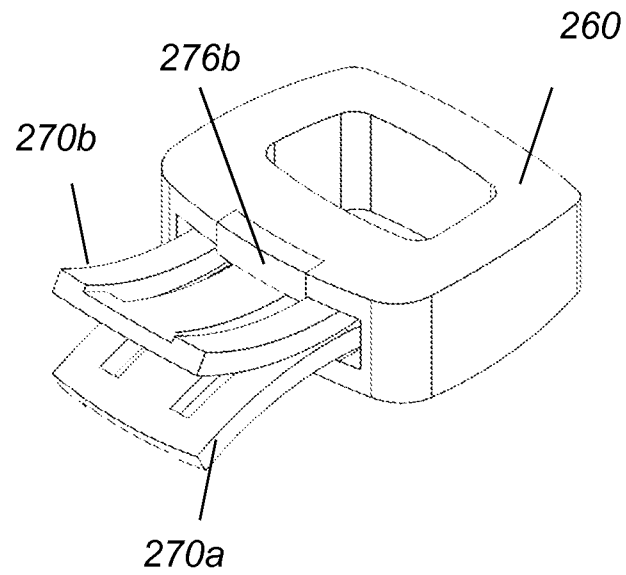

FIG. 16C

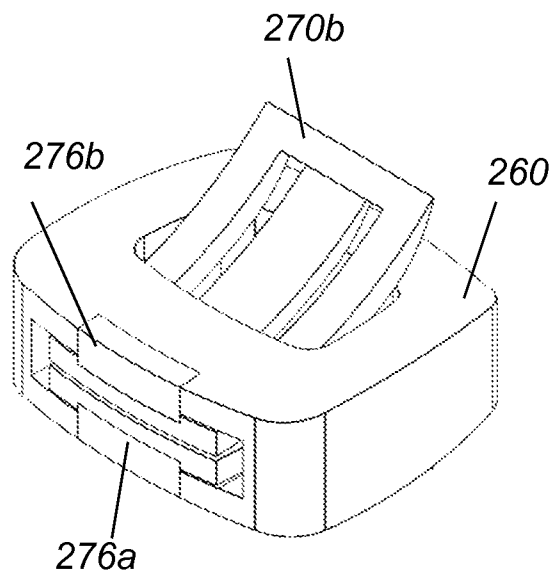

FIG. 16D

19/29

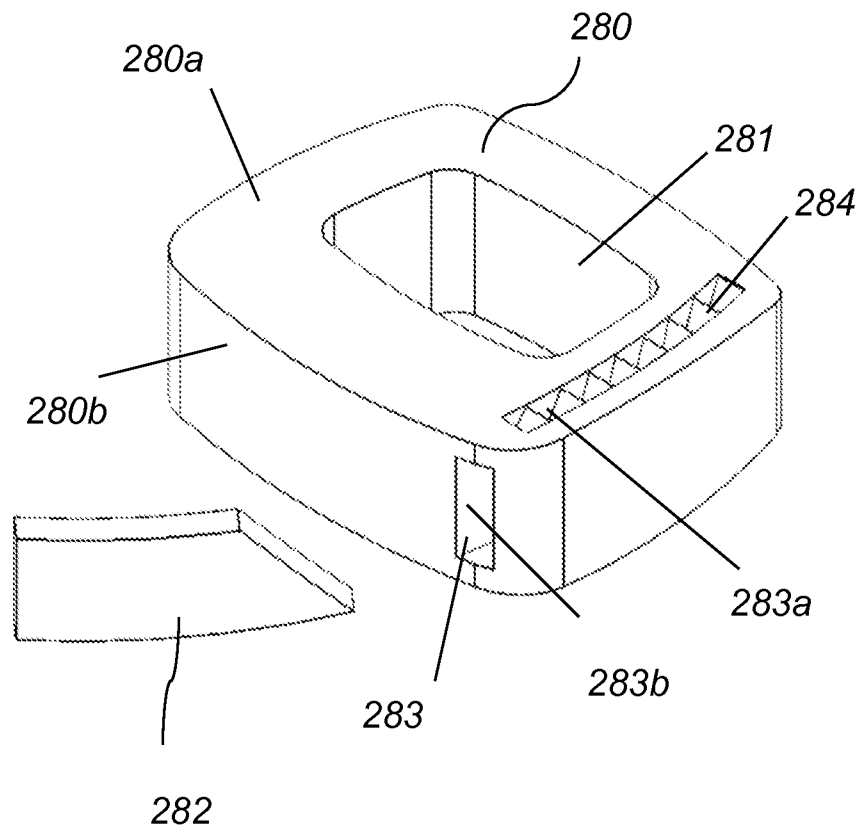

FIG. 17A

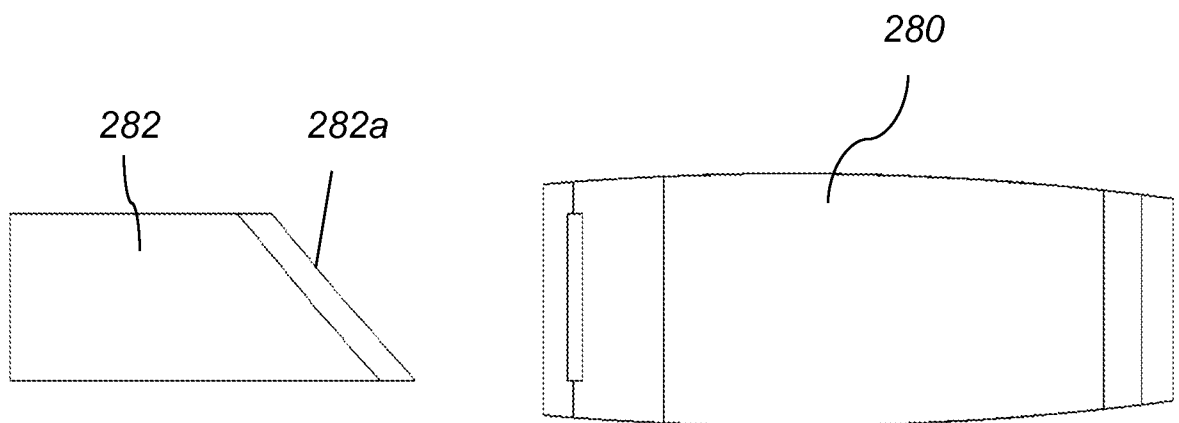

FIG. 17B

20/29

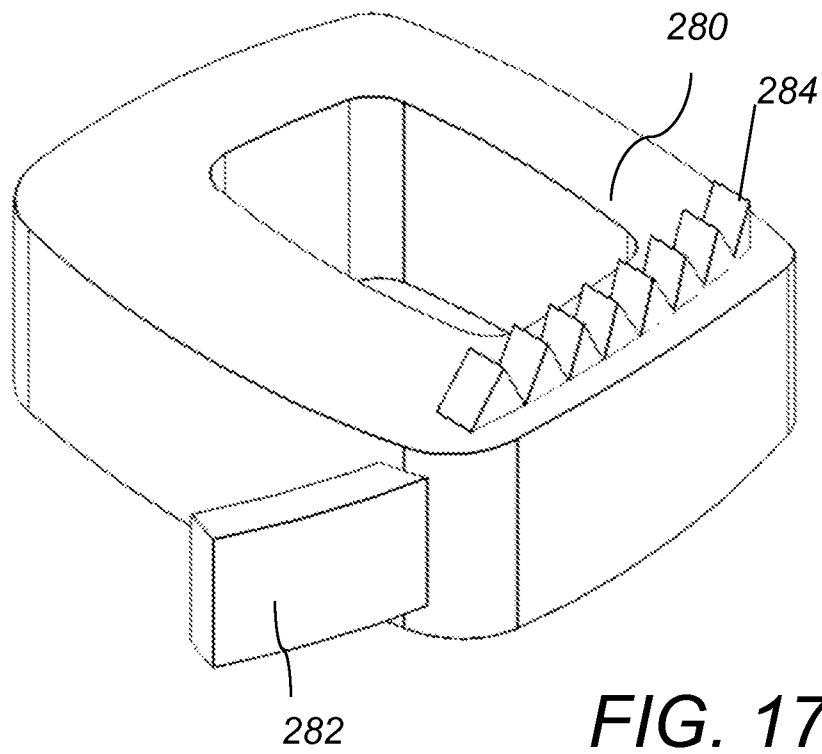

FIG. 17C

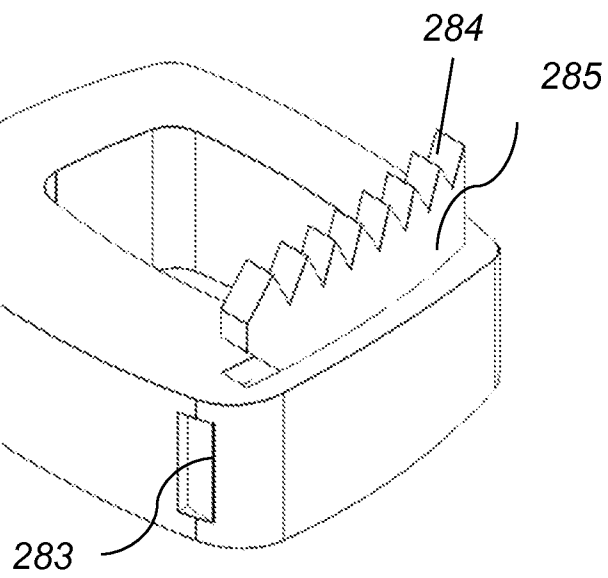

FIG. 17D

21/29

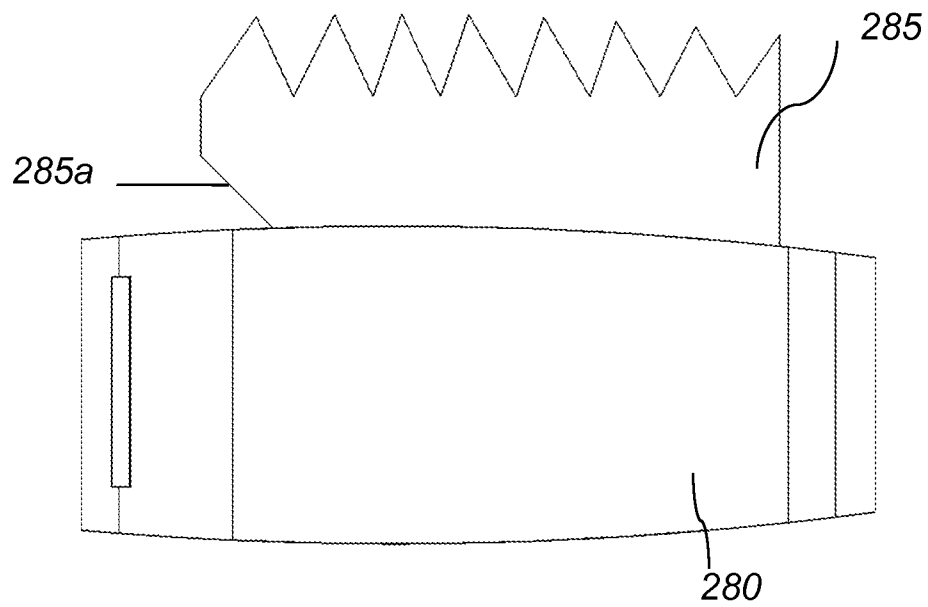

FIG. 17E

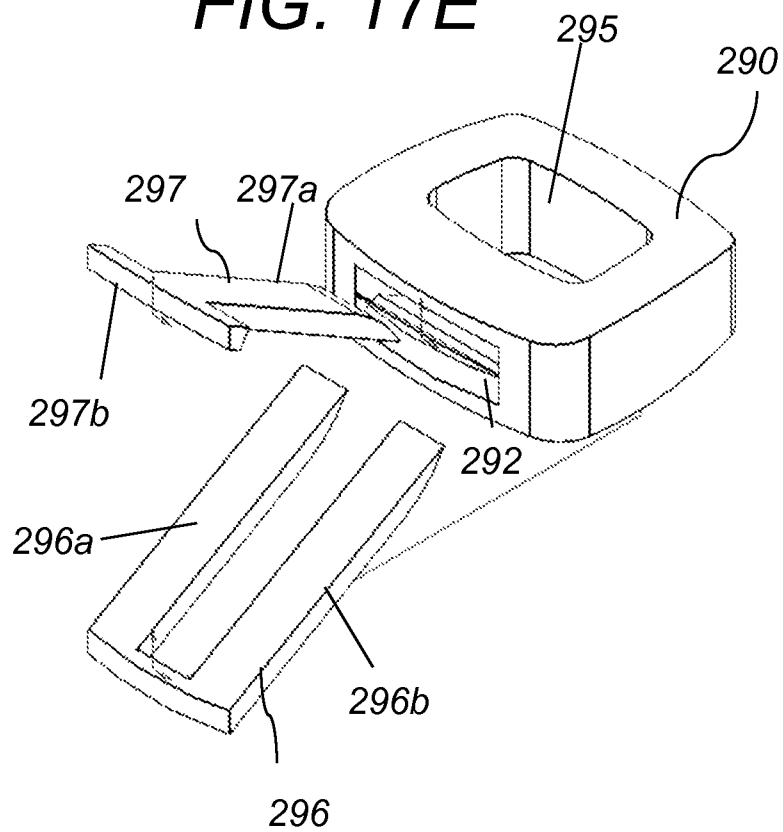
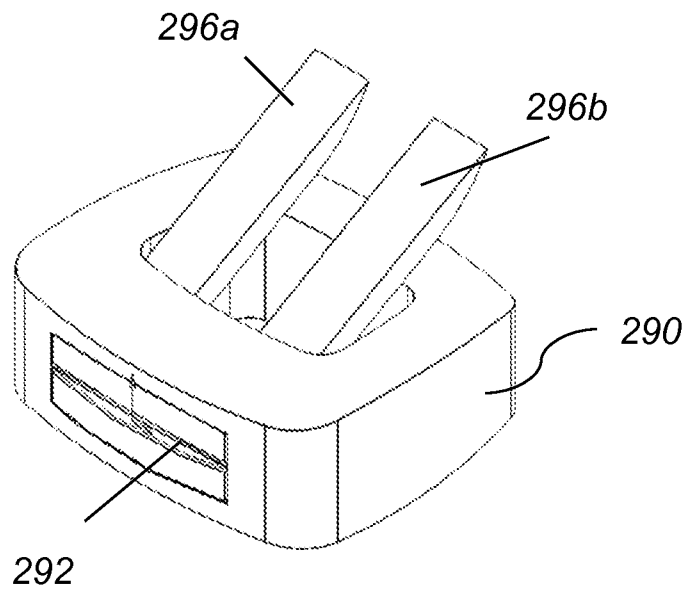
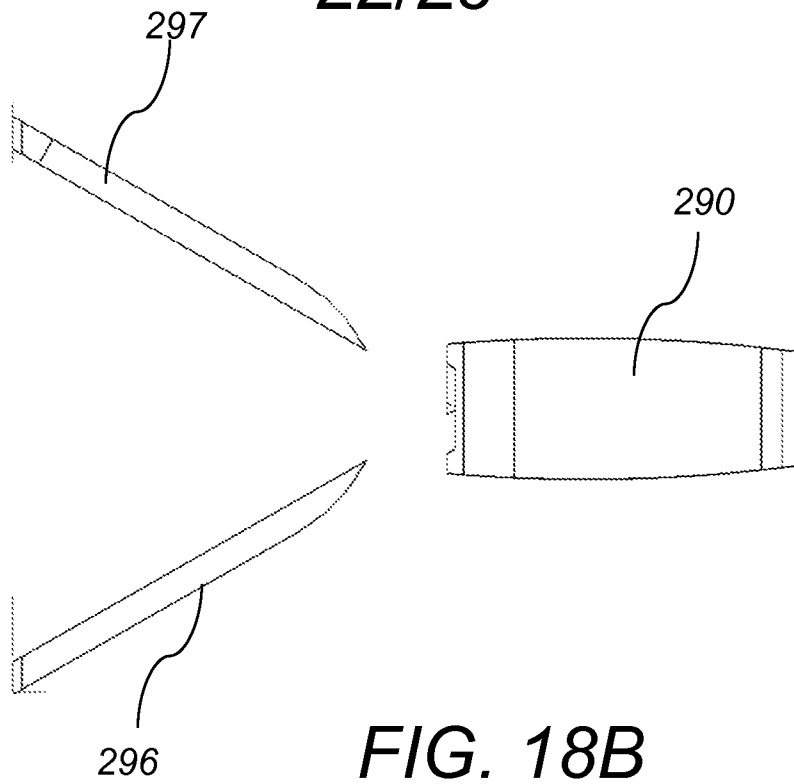

FIG. 18A

22/29



23/29

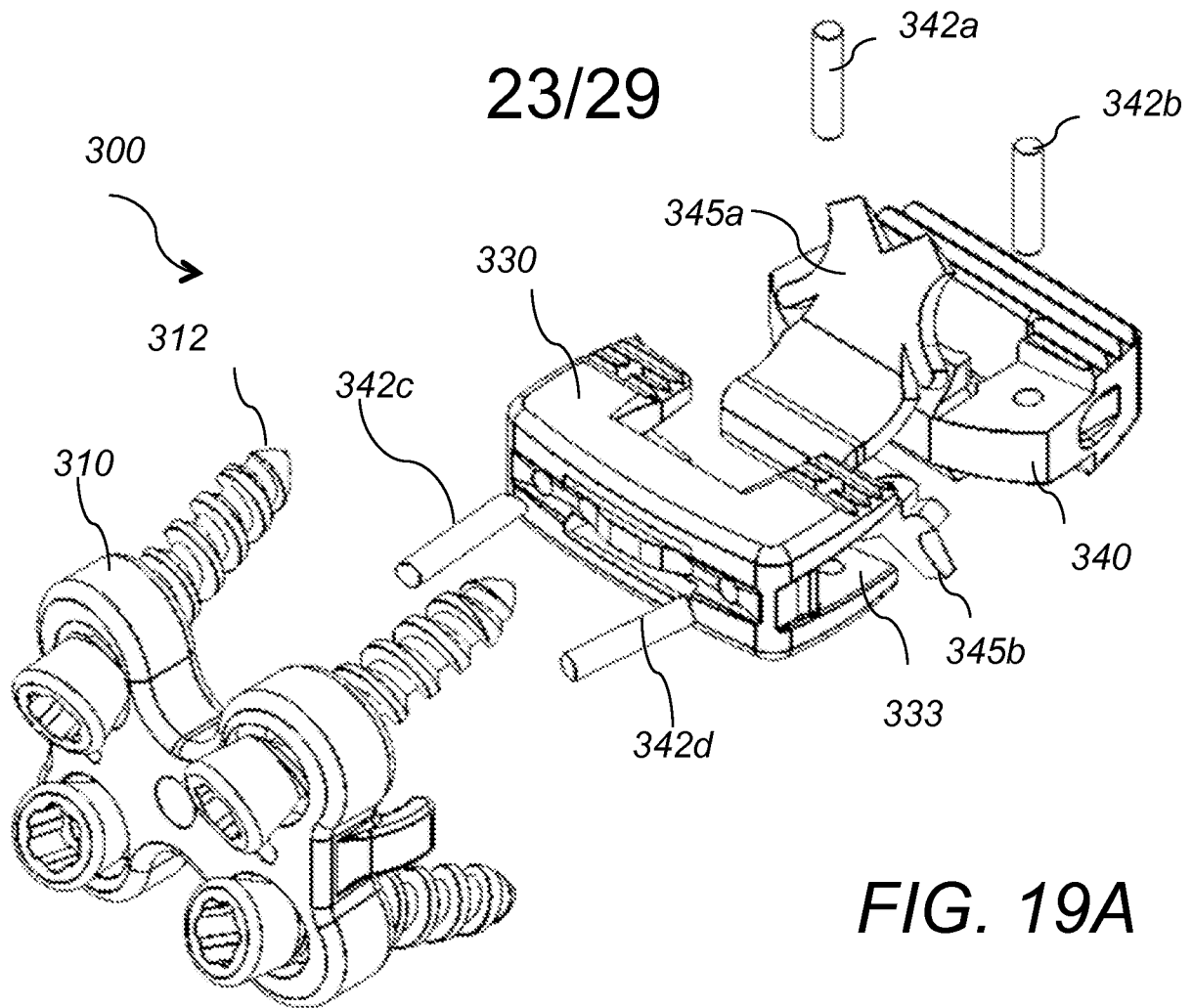

FIG. 19A

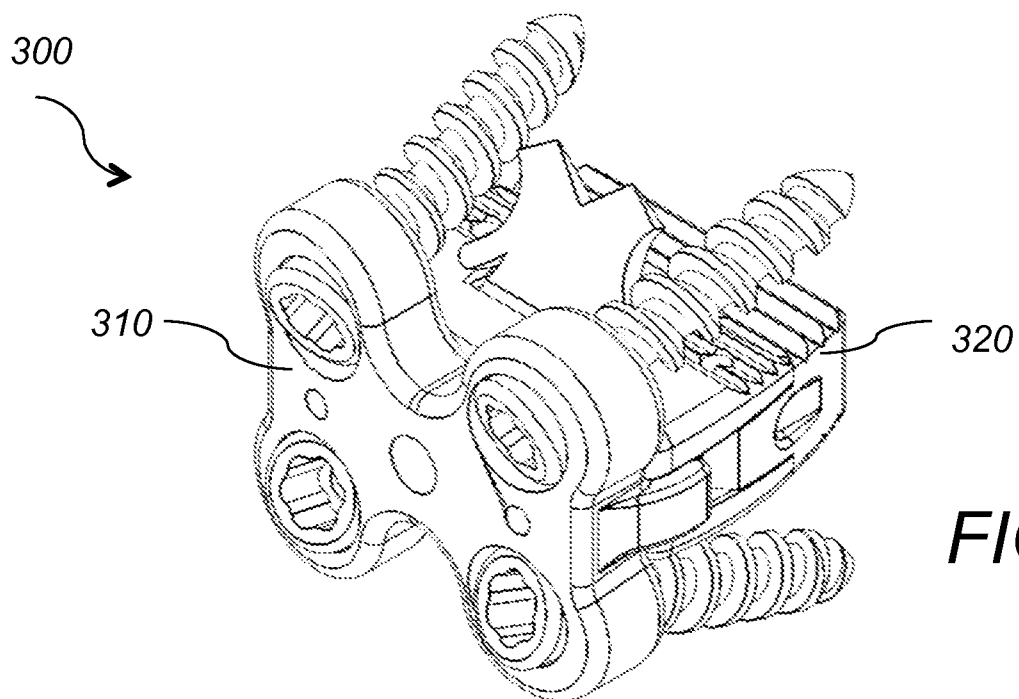

FIG. 19F

24/29

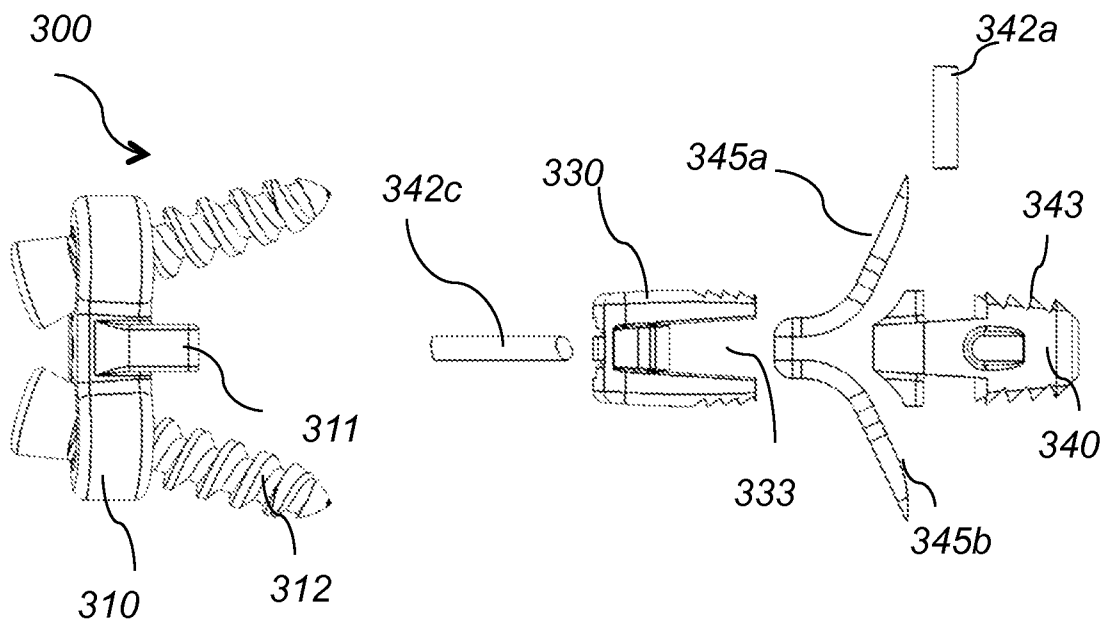

FIG. 19B

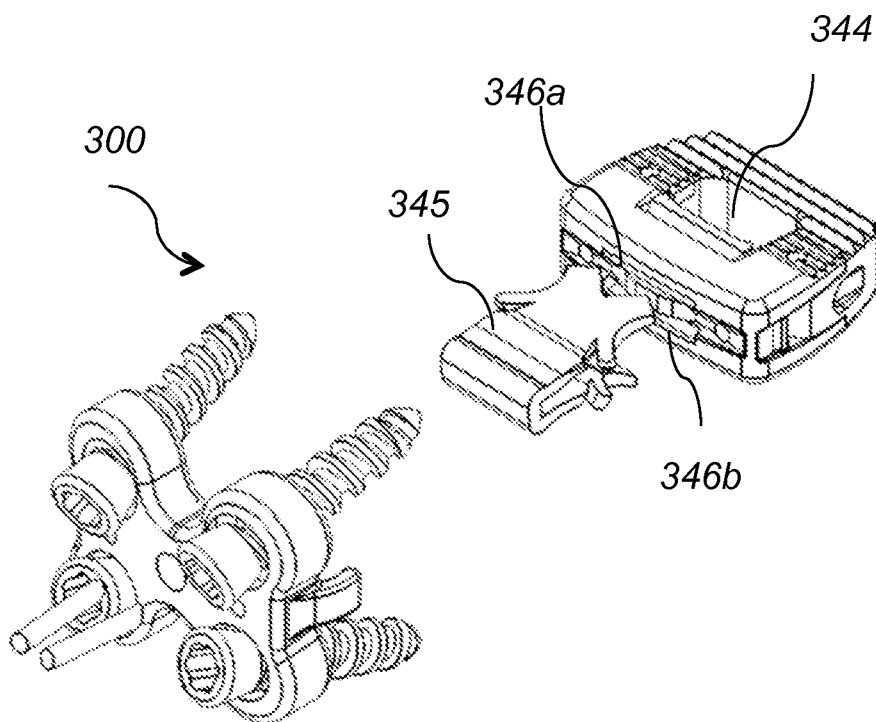
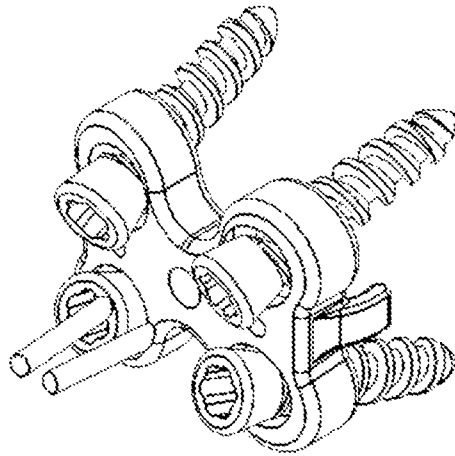

FIG. 19

25/29

300



345a

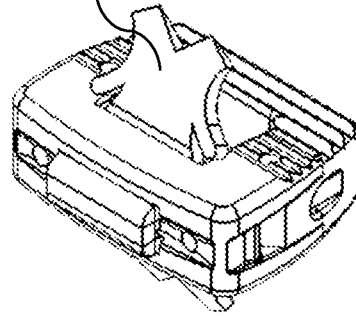
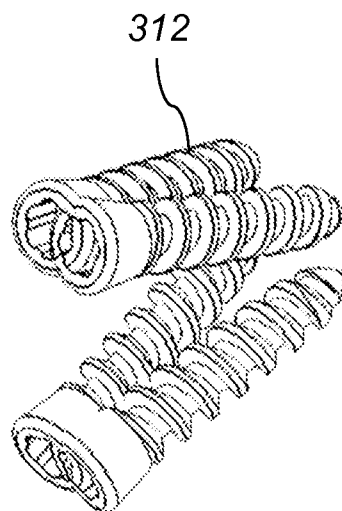

FIG. 19D

300



312

310

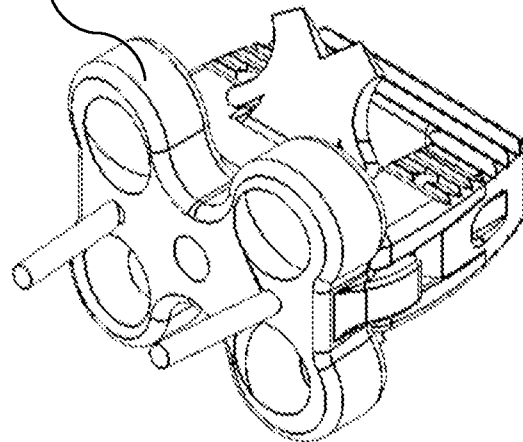

FIG. 19E

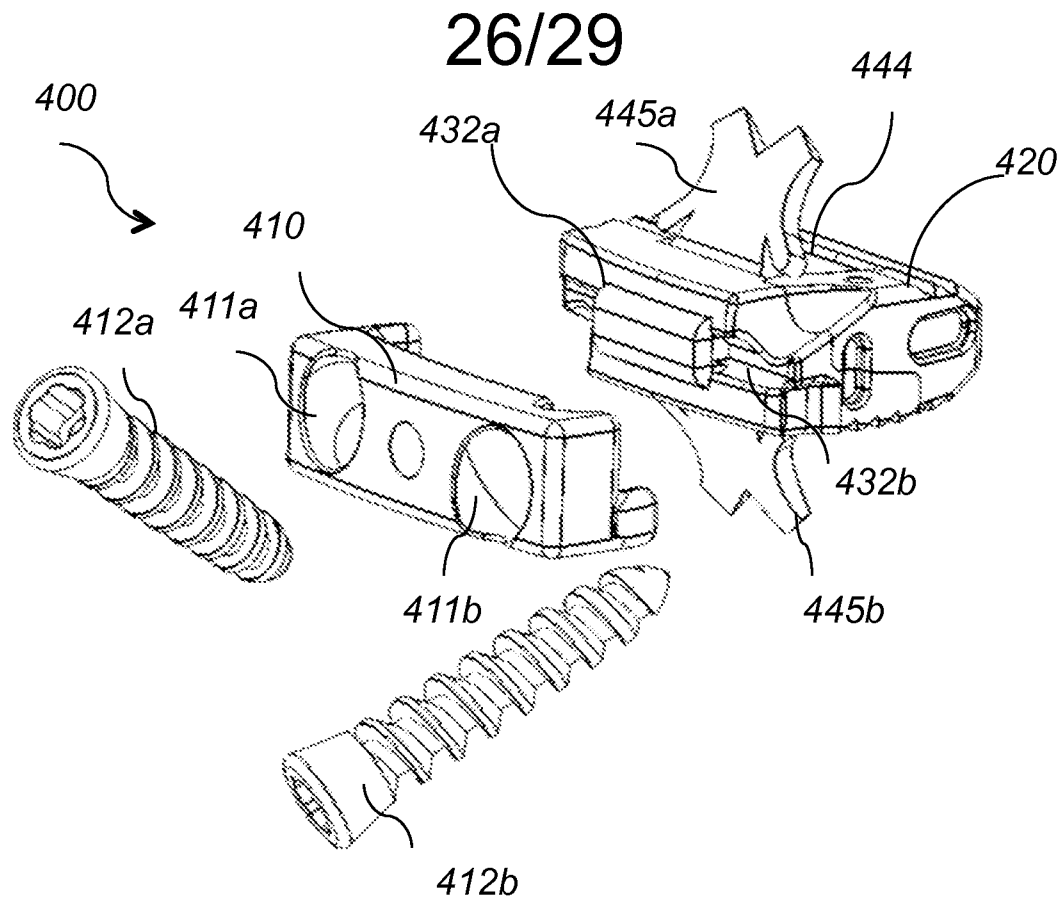

FIG. 20A

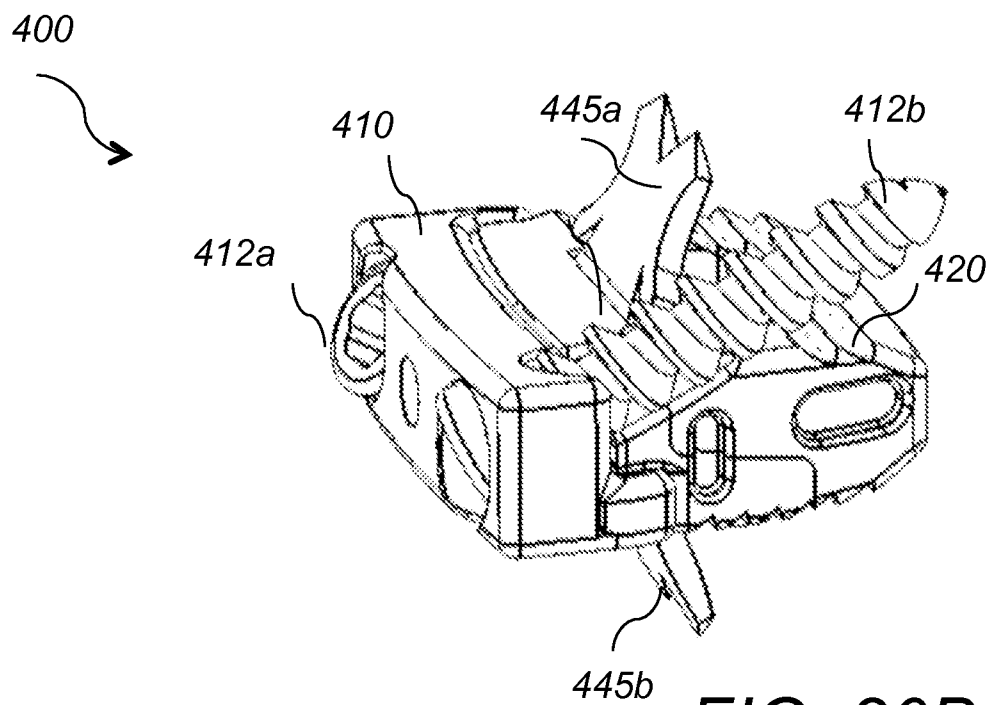

FIG. 20B

27/29

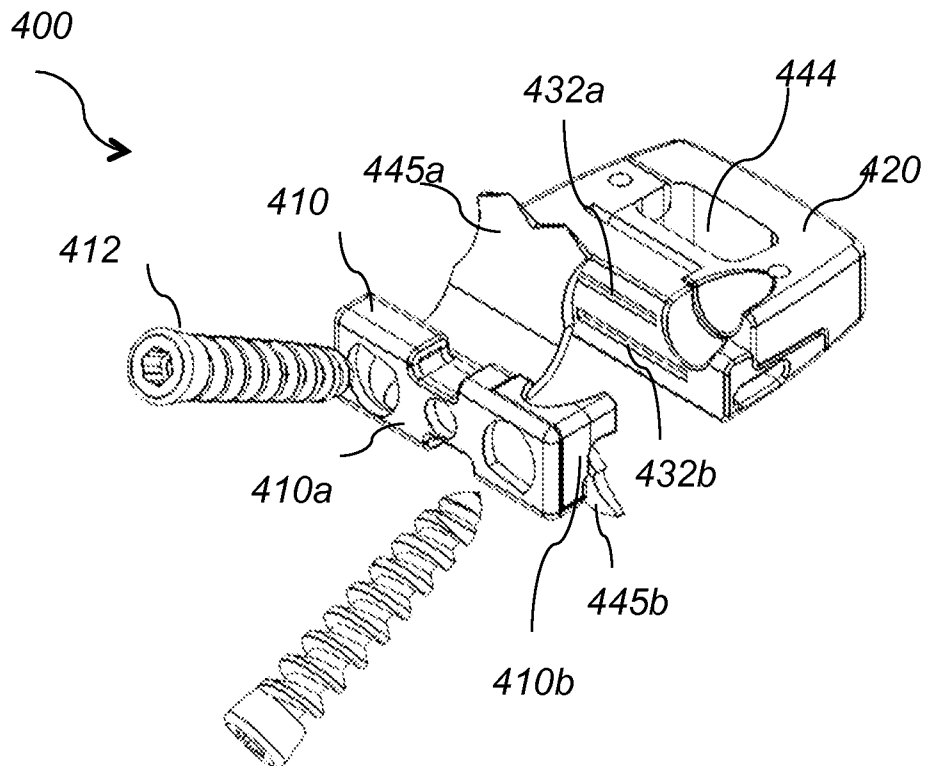

FIG. 21A

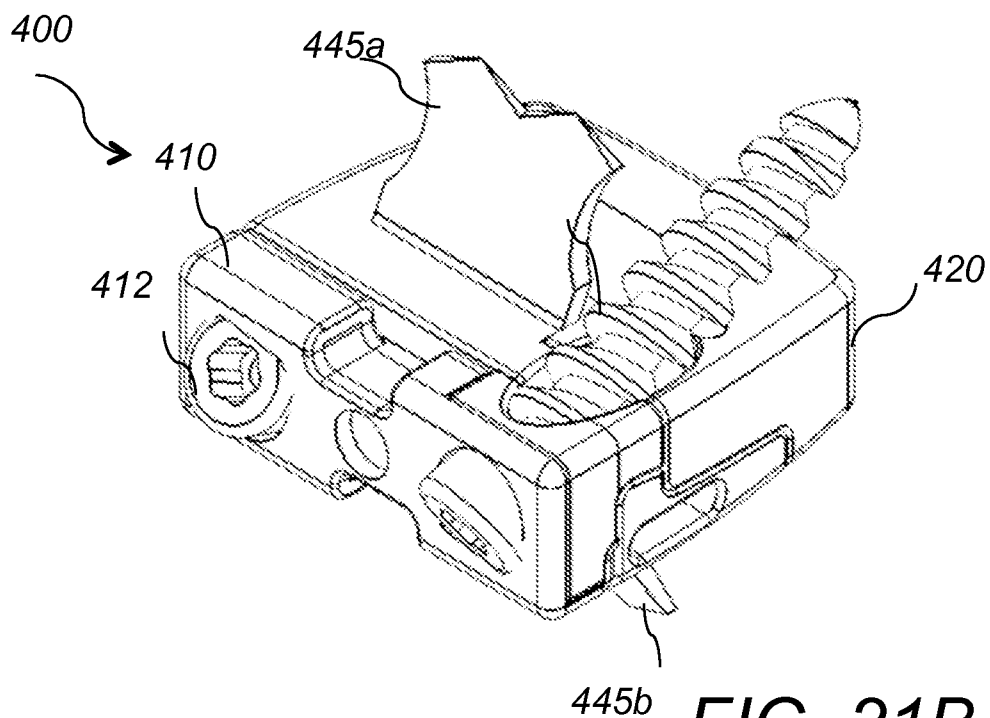

FIG. 21B

28/29

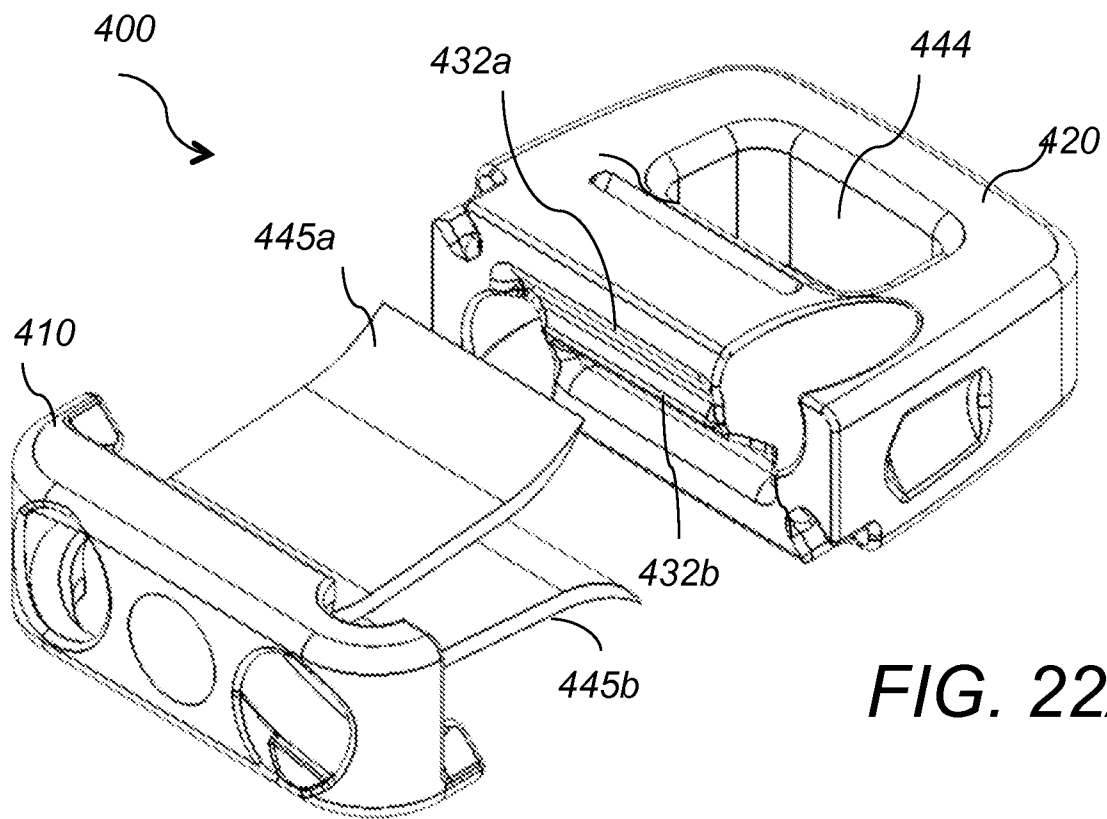

FIG. 22A

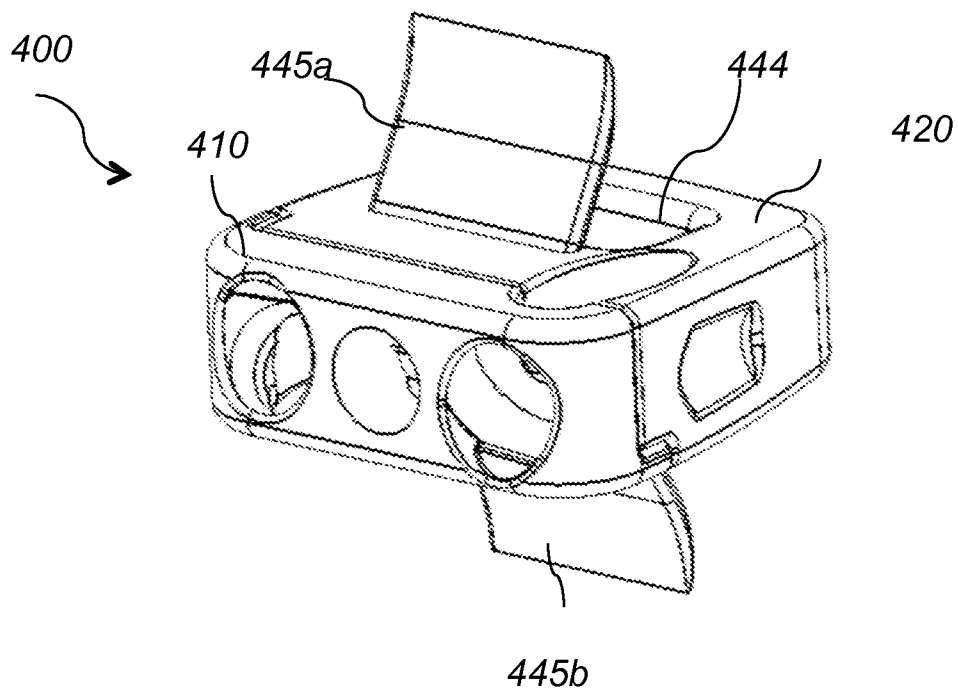

FIG. 22B

29/29

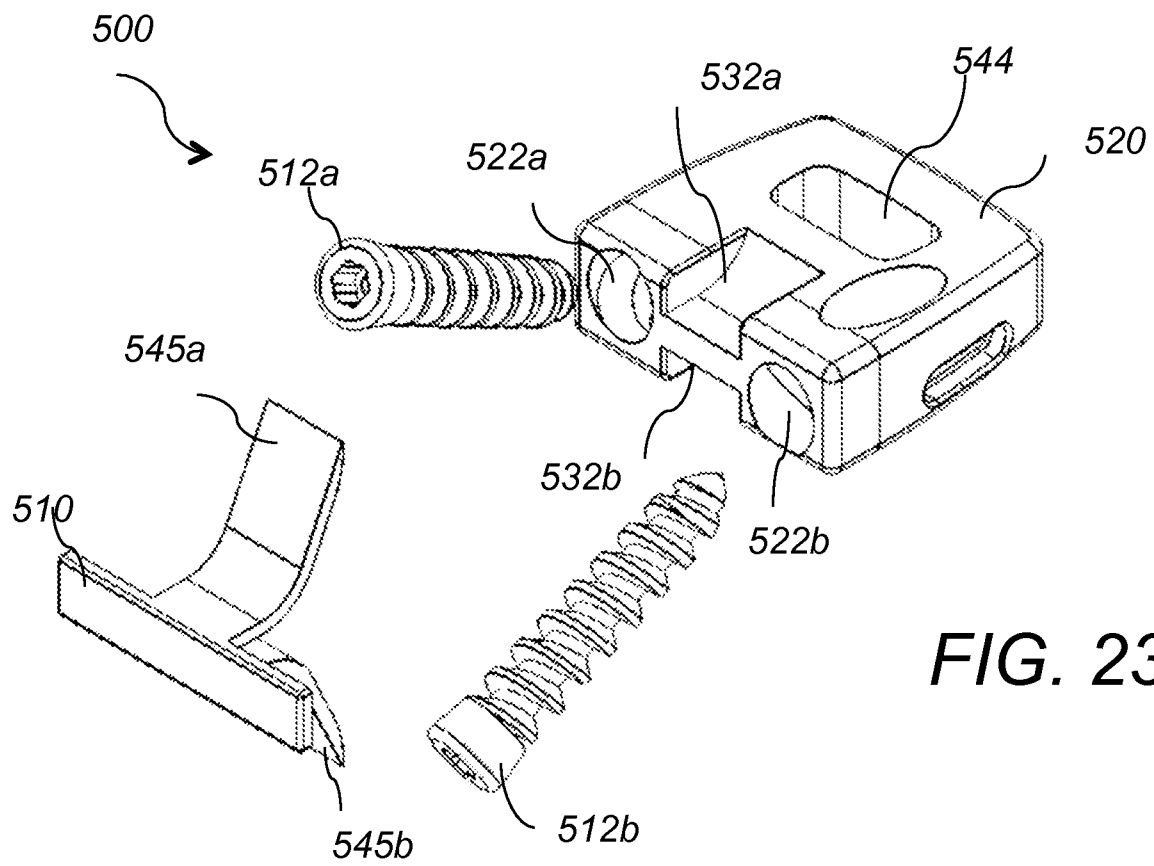

FIG. 23A

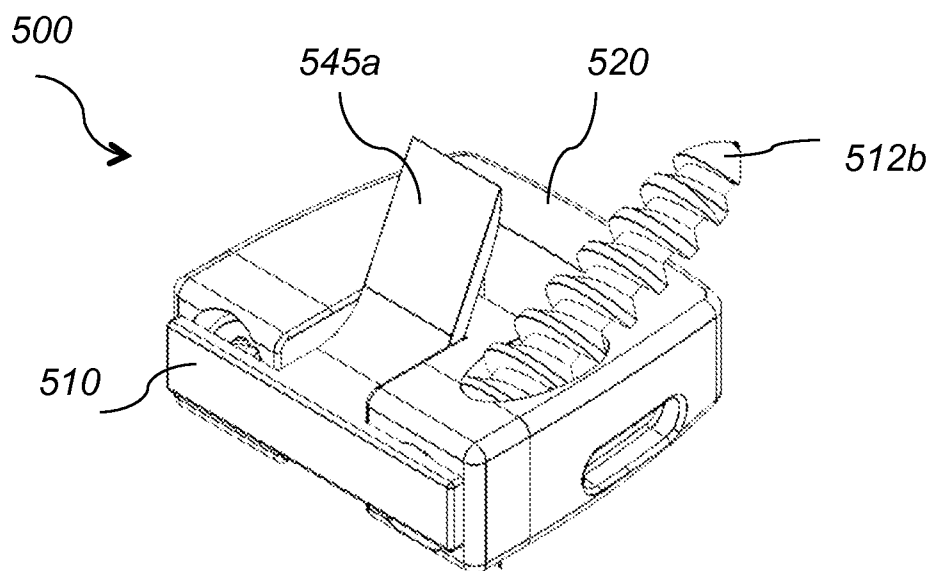

FIG. 23B

INTERNATIONAL SEARCH REPORT

International application No.
PCT/US2013/061323**A. CLASSIFICATION OF SUBJECT MATTER****A61B 17/70(2006.01)i, A61F 2/44(2006.01)i, A61L 27/04(2006.01)i, A61L 27/14(2006.01)i**

According to International Patent Classification (IPC) or to both national classification and IPC

B. FIELDS SEARCHED

Minimum documentation searched (classification system followed by classification symbols)

A61B 17/70; A61F 2/44; A61B 17/04; A61L 27/04; A61L 27/14

Documentation searched other than minimum documentation to the extent that such documents are included in the fields searched

Korean utility models and applications for utility models

Japanese utility models and applications for utility models

Electronic data base consulted during the international search (name of data base and, where practicable, search terms used)

eKOMPASS(KIPO internal) & Keywords: interbody fusion cage, peek, metal, insert

C. DOCUMENTS CONSIDERED TO BE RELEVANT

| Category* | Citation of document, with indication, where appropriate, of the relevant passages | Relevant to claim No. |
|-----------|--|-----------------------|
| A | US 2009-0105832 A1 (ALLAIN, J. et al.) 23 April 2009 See paragraphs [0022]-[0024]; figures 10A-11D. | 1-11 |
| A | US 2009-0157188 A1 (ZEEGERS, M. W.) 18 June 2009 See paragraphs [0015], [0016], [0030]-[0033]; figures 2A-2D. | 1-11 |
| A | WO 02-13732 A2 (BRAMLET, D. G.) 21 February 2002 See abstract; page 4; figures 1-4. | 1-11 |
| A | US 2012-0150300 A1 (NIHALANI, R.) 14 June 2012 See abstract; paragraphs [0025]-[0041]; figures 1A, 2A. | 1-11 |
| A | US 2010-0087925 A1 (KOSTUIK, J. and MCCLINTOCK, L.) 08 April 2010 See abstract; paragraphs [0025]-[0027]; figures 1, 2. | 1-11 |



Further documents are listed in the continuation of Box C.



See patent family annex.

* Special categories of cited documents:

"A" document defining the general state of the art which is not considered to be of particular relevance

"E" earlier application or patent but published on or after the international filing date

"L" document which may throw doubts on priority claim(s) or which is cited to establish the publication date of another citation or other special reason (as specified)

"O" document referring to an oral disclosure, use, exhibition or other means

"P" document published prior to the international filing date but later than the priority date claimed

"T" later document published after the international filing date or priority date and not in conflict with the application but cited to understand the principle or theory underlying the invention

"X" document of particular relevance; the claimed invention cannot be considered novel or cannot be considered to involve an inventive step when the document is taken alone

"Y" document of particular relevance; the claimed invention cannot be considered to involve an inventive step when the document is combined with one or more other such documents, such combination being obvious to a person skilled in the art

"&" document member of the same patent family

Date of the actual completion of the international search

24 December 2013 (24.12.2013)

Date of mailing of the international search report

26 December 2013 (26.12.2013)

Name and mailing address of the ISA/KR

Korean Intellectual Property Office
189 Cheongsa-ro, Seo-gu, Daejeon Metropolitan City,
302-701, Republic of Korea

Facsimile No. +82-42-472-7140

Authorized officer

Han, Inho

Telephone No. +82-42-481-3362



INTERNATIONAL SEARCH REPORTInternational application No.
PCT/US2013/061323**Box No. II Observations where certain claims were found unsearchable (Continuation of item 2 of first sheet)**

This international search report has not been established in respect of certain claims under Article 17(2)(a) for the following reasons:

1. ☒ Claims Nos.: 12-22
because they relate to subject matter not required to be searched by this Authority, namely:
Claims 12-22 pertain to a method for treatment of the human body and thus relate to a subject matter which this International Searching Authority is not required, under Article 17(2)(a)(i) of the PCT and Rule 39.1(iv) of the Regulation under the PCT, to search.
2. ☐ Claims Nos.:
because they relate to parts of the international application that do not comply with the prescribed requirements to such an extent that no meaningful international search can be carried out, specifically:
3. ☐ Claims Nos.:
because they are dependent claims and are not drafted in accordance with the second and third sentences of Rule 6.4(a).

Box No. III Observations where unity of invention is lacking (Continuation of item 3 of first sheet)

This International Searching Authority found multiple inventions in this international application, as follows:

1. ☐ As all required additional search fees were timely paid by the applicant, this international search report covers all searchable claims.
2. ☐ As all searchable claims could be searched without effort justifying an additional fees, this Authority did not invite payment of any additional fees.
3. ☐ As only some of the required additional search fees were timely paid by the applicant, this international search report covers only those claims for which fees were paid, specifically claims Nos.:
4. ☐ No required additional search fees were timely paid by the applicant. Consequently, this international search report is restricted to the invention first mentioned in the claims; it is covered by claims Nos.:

Remark on Protest

- ☐ The additional search fees were accompanied by the applicant's protest and, where applicable, the payment of a protest fee.
- ☐ The additional search fees were accompanied by the applicant's protest but the applicable protest fee was not paid within the time limit specified in the invitation.
- ☐ No protest accompanied the payment of additional search fees.

INTERNATIONAL SEARCH REPORT

Information on patent family members

International application No.

PCT/US2013/061323

| Patent document cited in search report | Publication date | Patent family member(s) | Publication date |
|---|---------------------|---|--|
| US 2009-0105832 A1 | 23/04/2009 | AU 2008-259499 A1 CA 2689236 A1 CN 101878007 A EP 2162098 A2 FR 2916956 A1 FR 2916956 B1 JP 2010-538683 A KR 10-2010-0029755 A MX 2009013368 A RU 2009145294 A US 8343219 B2 WO 2008-149223 A2 WO 2008-149223 A3 | 11/12/2008 11/12/2008 03/11/2010 17/03/2010 12/12/2008 14/12/2012 16/12/2010 17/03/2010 18/02/2010 20/07/2011 01/01/2013 11/12/2008 02/04/2009 |
| US 2009-0157188 A1 | 18/06/2009 | CA 2564987 A1 CN 1964681 A CN 1964681 B EP 1750624 A1 FR 2869528 A1 FR 2869528 B1 IL 178842 A JP 2007-534410 A JP 2012-115681 A KR 10-1197655 B1 KR 10-2007-0004069 A RU 2006141843 A US 2005-0246024 A1 US 2012-0053693 A1 US 7494508 B2 US 8002835 B2 WO 2005-104996 A1 ZA 200608883 A | 10/11/2005 16/05/2007 02/06/2010 14/02/2007 04/11/2005 02/02/2007 30/11/2011 29/11/2007 21/06/2012 07/11/2012 05/01/2007 10/06/2008 03/11/2005 01/03/2012 24/02/2009 23/08/2011 10/11/2005 26/11/2008 |
| WO 02-13732 A2 | 21/02/2002 | US 6447546 B1 WO 02-13732 A3 | 10/09/2002 30/05/2002 |
| US 2012-0150300 A1 | 14/06/2012 | WO 2012-078657 A2 WO 2012-078657 A3 | 14/06/2012 02/08/2012 |
| US 2010-0087925 A1 | 08/04/2010 | US 2012-158149 A1 US 8137405 B2 US 8439977 B2 | 21/06/2012 20/03/2012 14/05/2013 |